

F.B. 810

810

LIB. 3007

810

Sewers on Profiles

MICROFILMED

DEC 15 1964

12075

36- oliv to thorn  
55 Thorn to anderson

1	L 25°-00'-00	128:3	Soft
2	L 24°-26'-00	233.2	
3	L 26°-52'-00	255.3	
4	26°-20'-00	16.0	✓
		239.3	
		1404	
		128.3	
		12175.7	
100			
16	174		
15	125		
12	157		
57	227	74	
65	231	66	
1	32	17	
2	30	27	
2	312	21	5420
33	339	18	692
5	281	74	586
126	100		
174	98	95	
167	86	107	
115	190	55	
		33	

Buttfall Foot of Olive Street.

Sta.	H.I.	Rod	Ground
0+00	13.20	5.2	18.0
+25		7.66	15.54
+40		1.2	22.0
+50	1.63 0.34	12.07 +0.10	12.76 10.44 -0.24 3.61 -8.51
+62			
+74			
+86			
+98			
+110			
+122			
+34			
+46			
+58			
+70			
+82			
+94			
2+06			
+18			

Grade cut

-0.66
-0.76
-0.82
-0.86 1st pier 2.5' low
-0.91 2nd " 4' low
-0.96 3rd " 4.5' low
-1.00 4th " 5.0' low
-1.05 5th " 5.5' low
-1.11 5+06 -2.75
-1.16 5+18 -2.80
-1.20 5+30 -2.85
-1.25 5+42 -2.90
-1.30 5+54 -2.95
-1.35 5+66 -3.00
-1.40 5+78 -3.05
-1.45 5+90 -3.10
-1.50 6+02 -3.15
-1.55 6+14 -3.17
-1.60 6+26 -3.20
-1.65 6+38 -3.25
-1.70 6+50 -3.30
-1.75 6+62 -3.35
-1.80 6+74 -3.40
-1.85 6+86 -3.45
-1.90 6+98 -3.50
-1.95 7+10 -3.55
-2.00 7+22 -3.60
-2.05 7+34 -3.65
-2.10 7+46 -3.70
-2.15 7+58 -3.75
-2.20 7+70 -3.80
-2.25 7+82 -3.85
-2.30 7+94 -3.90
-2.35 8+06 -3.95
-2.40 8+18 -4.00
-2.45 8+30 -4.05
-2.50 8+42 -4.10
-2.55 8+54 -4.15
-2.60 8+66 -4.20
-2.65 8+78 -4.25
-2.70 8+90 -4.30

4.03  
3.42  
+ .61

-3.42  
5.92  
+ .50  
-1.34  
- .84

4.31

-3.42  
3.34  
-0.08  
-0.82  
0.74

1.02  
37  
139  
134

3.52  
-3.42 R.M. Gov. man.  
No. 20.

Main sewer from outfall m.H.

To center of Kalnia and Calif. then

Sta.	M.H. center alive	H.I.	Rod	Ground
0+00	4104 west of main 50' east of west line of Calif.	23.20	5.2	18.0
+25			6.81	16.39
+50			7.4	15.8
+75	POSTED		6.7	16.5
1+00			2.8	20.4
+25			1.4	21.8
+50			2.1	21.1
+75			2.8	20.4
2+00			2.7	20.5
+25			4.2	19.0
+50			5.0	18.2
+73.5	M.H. center of rutting + 25' east of west line of Calif.		6.0	17.2
3+00			7.00	16.20
+25			8.5	14.7
+50			10.2	13.0
+75			11.4	11.8
4+00			13.10	10.10
J.8	2.30	12.40		
+25			3.0	9.4

foot of alive Street May, 12/11  
up brickyard canyon

Grade cut

-0.66	18.7
-0.56	17.0
-0.46	16.3
-0.36	16.9
-0.26	20.7
-0.16	22.0
-0.06	21.2
+0.04	20.4
0.14	20.4
0.24	18.8
0.34	17.9
0.43	16.8
0.54	15.7
0.64	14.1
0.74	12.3
0.84	11.0
0.94	9.2
1.04	8.4

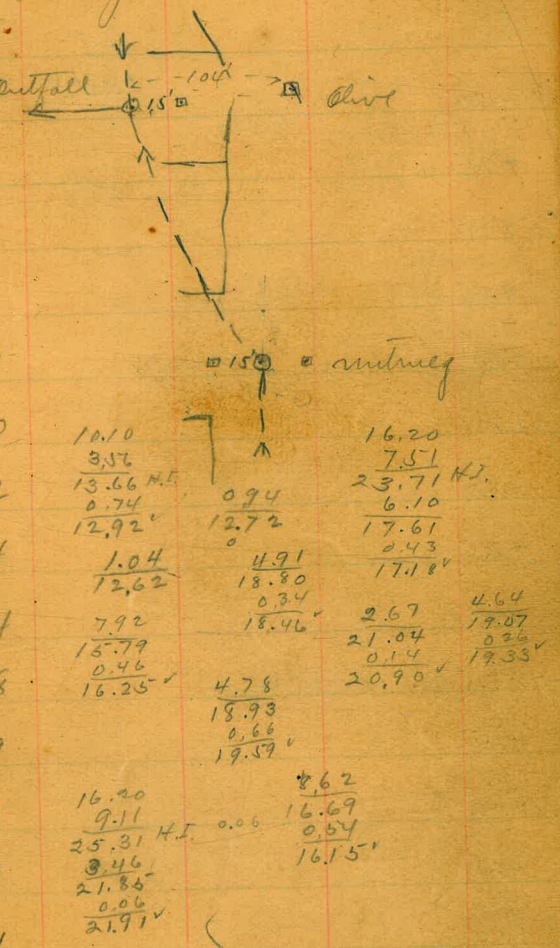

Cont. from page 3.

Sta	H.I.	Rod	Ground	Grade	Cut
4+50	<u>12.40</u>	3.8	8.6	✓ 1.14	7.5
+75		4.3	8.1	1.24	6.9
5+00		4.5	7.9	✓ 1.34	6.6
+25		4.2	8.2	1.44	6.8
+50		4.0	8.4	✓ 1.54	6.9
+75		3.9	8.5	1.64	6.9
6+00		4.1	8.3	✓ 1.74	6.6
+25	no hub. 12	6.2	6.2	1.84	4.4
+50		3.5	8.9	1.94	7.0
+53.75	m.k. center maple.	4.5	7.9	✓ 1.96	5.9
+75		4.1	8.3	2.04	6.3
7+00		4.77	7.63	✓ 2.14	5.5
+25		5.5	6.9	2.24	4.7
+50		4.7	7.7	✓ 2.34	5.4
+75		5.8	6.6	2.44	4.2
8+00		5.2	7.2	✓ 2.54	4.7
+25		6.4	6.0	2.64	3.4
+50		7.0	5.4	✓ 2.74	2.7

May 17/11

Childs  
Taylor  
Bunker

10.10		134	1.54	1.74
333	14.2	12.09	11.89	11.69
13.43			7.63	
1.14		1.96	7.04	
12.29		11.47	14.67	12.34
			2.14	12.33
2.54	2.74		12.53	
12.13	11.93			

grades June 30/11

Childs  
Taylor  
Bunker

Cut from page 4

Sta.	H.I.	Rod	Ground	Grade	cut
8+75	<u>18.40</u>	6.90	5.50	2.84	2.7
9+00		6.5	5.9	✓ 2.94	3.0
+25		6.0	6.4	3.04	3.4
+50		6.7	5.7	✓ 3.14	2.6
+75		5.9	6.5	3.24	3.3
10+00		4.4	8.0	✓ 3.34	4.7
+34.75	74 H. Center of J.P. Laurel. 729	1.67	10.73	✓ 3.48	7.2
+50	<u>18.02</u>	5.95	12.07	✓ 3.54	8.6
+75		4.4	13.6	3.64	10.0
11+00		4.4	13.6	✓ 3.74	9.9
+25		3.7	14.3	3.84	10.5
+50		3.2	14.8	✓ 3.94	10.9
+75		3.1	14.9	4.04	10.9
12+00		2.9	15.1	✓ 4.14	11.0
+25		2.43	15.59	4.24	11.4
+50		2.0	16.0	✓ 4.34	11.7
+75		7.0	11.0	4.44	6.6
13+00		9.3	8.9	✓ 4.54	4.4

may 17/11

Childs  
Taylor  
Bunker

14.67	3.14	3.34	3.48
2.94	11.53	17.33	11.19
11.73		3.54	
	4.54	11.13	
3.94	16.57	2.61	
12.93	3.74	12.00	
	13.13		
4.14	4.34	4.54	
12.73	12.53	12.33	

grades

June 30/11

Childs  
Taylor  
Bunker

1.2

Cont. - from page 5.

Sta.	H.I.	Rod	Ground	Grade	cut
13+25	18.02	2.99	15.03	4.64	10.4
+50		2.9	15.1	4.74	10.4
+75		3.1	14.9	4.84	10.1
14+00		3.51	14.51	4.94	9.6
+15.20	m.H. center Kalnia	4.85	13.17	5.00	8.2
J.P.	+25' east of the west line of Cal.	23.85			
+25	10.68	10.4	13.4	5.09	8.3
+50		9.4	14.4	5.32	9.1
+75		10.0	13.8	5.56	8.2
15+00		7.0	16.8	5.80	11.0
+25		1.2	22.6	6.03	16.6
+50		11.4	12.4	6.26	6.1
+75		12.5	11.3	6.50	4.8
16+00		8.79	15.06	6.74	8.4
+25		9.5	14.3	6.97	7.3
+50		12.2	11.6	7.20	4.4
+75	J.P.	5.35	19.66	7.44	6.9
17+00		11.0	8.7	7.68	1.0
		12.5	7.2	7.85	
+25.2	m.H. 22 1/2' east center of antic	10.8	8.9	7.91	1.0

May 18/11  
 Childs  
 Taylor  
 Blumberg

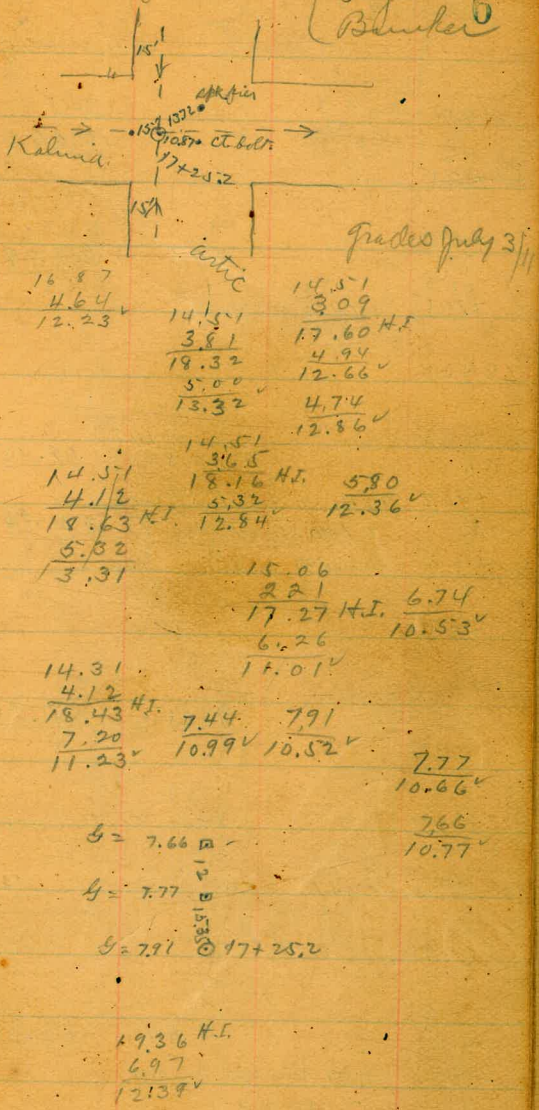

Grades July 3/11

Cont. - from page 6.

Sta.	H.I.	Rod	Gravel	Grade	cut
17+25	19.66	70.3	9.4	7.91	1.5
+50	9.96	3.00	16.7	8.14	8.6
J.P.	29.29	0.33	19.33	8.27	18.43 H.I.
+63		7.3	22.0	8.38	8.27
+75		0.47	28.82	8.62	13.6
18+00		11.19	18.10	8.85	9.3
+25	10.5	19.15	6.6	12.6	9.00
J.P.		20.93	7.7	13.2	9.26
+40.2		6.6	15.5	9.90	5.6
J.P.		5.4	16.0	10.54	5.5
+50		11.52	17.43	11.18	6.2
+75		10.4	18.5	11.82	6.7
19+00		11.4	17.5	12.46	5.0
J.P.	9.15	29.95	11.07	17.89	13.10
+25		5.6	23.3	13.74	9.6
+35		4.66	24.29	14.00	10.8
+50		7.6	24.8	14.68	4.3
+75		13.4	19.0	15.82	3.2
20+00		13.4	19.0	15.82	3.2
+25		8.34	24.04	16.97	7.0

June 22/11  
 Lehigh  
 Taylor  
 Blunk  
 India

18.43 H.I. 32  
 8.27  
 10.16  
 14.31  
 5.05  
 19.36 H.I.  
 8.27  
 11.09  
 15.10  
 0.78  
 18.88 H.I.  
 8.85  
 10.03  
 18.10  
 2.14  
 20.24 H.I.  
 9.00  
 11.24  
 9.26 10.50  
 10.98 9.70  
 17.43  
 7.44  
 24.87 H.I. 13.10  
 10.84  
 27.87 H.I. 11.77  
 11.82  
 13.05  
 14.00  
 10.87  
 24.00  
 1.51  
 25.59 H.I. 14.68  
 14.00  
 11.59 10.91  
 16.97  
 8.62



cont - from page 7

Sta.	H.I.	Rod	Ground	Grade	cut.
21+25	32.38				
J.P.	5.70	0.14	32.24	18.11	14.1
+50		2.3	35.6	19.26	16.3
+66.28 m.H. lot line bet India + Columbia		4.55	33.39	20.00	13.4
+75		4.2	33.7	20.08	13.6
22+00		13.3	24.6	20.31	4.3
+25		12.53	25.41	20.54	4.9
+50		6.4	31.5	20.77	10.7
+75	0.31	33.41	10.35	21.01	2.4
23+00		37.94			
J.P.	10.45	43.55	4.84	33.10	21.24
+25			1.4	42.1	21.47
+50			3.7	39.8	21.70
+75			4.6	38.9	21.94
+81.07 m.H. center Columbia 18.45 009 line of Laurel.			4.62	38.93	22.00
24+00			5.1	38.4	22.09
+25			5.39	38.16	22.21
+50			8.1	35.4	22.34
+75 not in			10		22.46
25+00			10.24	33.31	22.59

From Sta 23+81.07 to Sta 25+27.37 does not  
10ft. seems to be 10' off. Taken 10-16-23  
It seems to be 10' off to me, too.  
McCarty 4-29-31  
The motion has been seconded all in favor say Yeal.

146.3  
131  
21.45  
345.5  
22.31

June 22/11  
Childs  
Taylor  
Bunker

11

32.24  
8.68  
40.92 H.I.  
6.30  
34.62  
20.00  
14.62

25.41  
1.37  
26.78 H.I.  
20.31  
6.47  
21.01  
5.77  
6.24

33.31  
5.71  
39.02 H.I. 34.97  
23.15  
36.77  
22.34  
13.43  
33.10  
10.37  
43.47 H.I.  
22.00  
27.47  
11.60  
16.87

33.10  
10.91  
44.01 H.I.  
22.00  
22.01  
5.48  
16.53

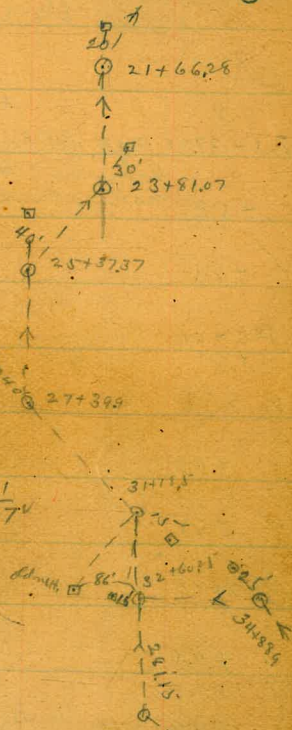

Cont from page 8.

Sta.	H.I.	Rod	Ground
J.P.	5.89	44.82	38.93
25+37.37		8.8	36.0
+50		9.1	35.7
✓ +75		8.6	36.2
26+00		9.93	34.89
J.P.	9.75	41.67	31.92
✓ +25		10.4	31.3
+50		13.5	28.2
✓ +75		12.5	29.2
✓ 27+00		7.0	34.7
+25		4.03	37.64
✓ 28+9		4.64	37.03
+50		4.2	37.5
✓ +75		9.7	32.0
28+00		5.2	36.5
J.P.	12.98	54.20	41.22
✓ +25		11.9	42.3
+50		1.98	52.22
+75		1.4	52.8
29+00		1.2	53.0

June 23/11  
 Bluffs  
 Taylor  
 Bluffs

Grade	cut	39.02 H.I.
22.78	13.2	1.77
23.17	12.6	37.25
23.94	12.3	22.78
24.70	10.2	14.47
25.47	5.8	
26.24	2.0	
27.00	2.2	
27.77	6.9	
28.54	9.1	
29.00	8.0	
29.29	8.2	
30.02	2.0	
30.74	5.8	
31.47	10.8	
32.19	20.0	
32.92	19.9	
33.64	19.4	

Cont. from page 9

June 26/11

Childs  
Taylor  
Bull 10

(281.15)

Sta.		H.I.	Rod	Ground
✓ 29+25		<u>54.20</u>	1.5	52.7
✓ +50			7.22	46.98
+75	3.90	<u>50.88</u>	12.8	38.1
30+00		<u>54.20</u>	12.4	41.8
✓ +25			11.2	43.0
+50			6.73	47.47
✓ +75			5.9	48.3
31+00			13.6	40.6
✓ +18.75	M.H. lot line bet.		4.73	49.47
J.P.	State & mine	61.87		
+25			10.2	51.7
+50			5.34	56.53
✓ +75			3.70	58.17
J.P.	6.40	<u>64.57</u>		
32+00			2.4	62.2
✓ +25			2.3	62.3
+50			2.13	62.44
+60.25	M.H. center mine		2.5	62.1
33+00			2.4	62.2

Grade cut

34.37	18.3
35.09	11.9
35.82	2.3
36.55	5.3
37.28	5.7
38.01	9.5
38.74	9.6
39.47	1.1
40.0	9.5
40.14	11.6
40.66	15.8
41.19	17.0
41.72	20.5
42.25	20.1
42.78	19.6
43.00	19.1
43.55	18.9

Cont. from page 10

Sta.	H.I.	Red	Level
33+50	64.57	2.61	64.86
+75		2.7	64.86
J.P.	2.69	54.32	12.94 51.63
34+25		6.04	48.26
+50		5.4	48.2
+75		3.89	50.43
488.9	M.H. Center Minn 7.08	4.08	50.24
J.P.	7.33.75 no. center	57.32	
+99	of mixture	7.5	49.8
35+24		6.5	50.8
+50		6.6	50.7
+75		5.27	52.05
36+00		3.11	54.21
J.P.	6.01	60.22	
+25		2.9	57.3
+50		4.2	56.0
+75		6.4	53.8
37+00		5.8	54.4
+13.7	M.H. lot line bet. Minn & Horton	2.70	57.52
+25		1.05	59.17

Level	cut
43.75	18.2
44.00	17.9
44.43	3.9
44.65	4.3
44.87	5.5
45.00	5.2
45.27	4.5
45.94	4.9
46.63	4.1
47.30	4.7
47.96	6.2
48.63	8.7
49.29	6.7
49.96	3.8
50.62	3.8
51.00	6.5
51.13	8.0

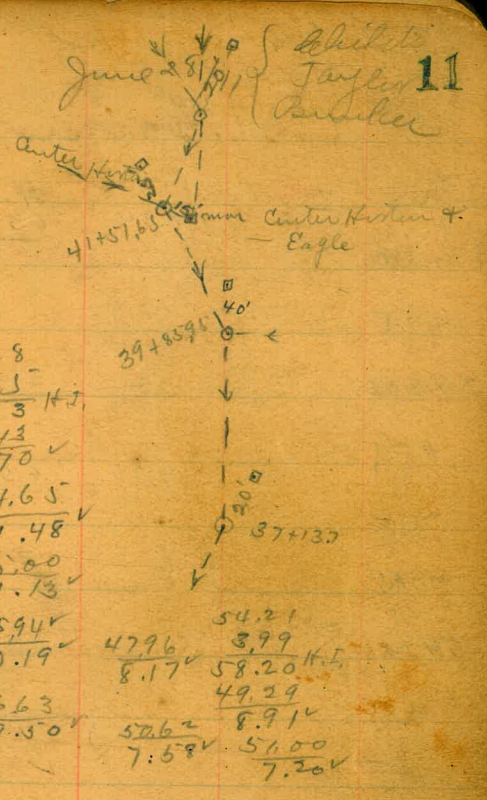

Cut from page 11

Sta.	H.I.	Rod	Inch
J.P. 37+50	4.34 63.57	3.8	59.7
+75		4.4	59.1
38+00		5.58	57.93
+25 J.P. +50	7.37 65.30	4.03	59.48
+75		4.8	60.5
		6.3	59.0
39+00		3.8	61.5
+25		5.0	60.3
+50		4.66	60.64
+75		4.6	60.7
*48.95 M.H. Centerline		5.95	59.35
40+00		6.0	59.3
+25		6.5	58.8
+50		6.2	59.1
+75		6.1	59.2
41+00		5.7	59.6
+25 J.P.	72.59	5.64	59.66
+51.65		12.4	60.2

Abandoned  
About 1915.

1283

Center Station  
or 15' from center of E. 46

June 29/11

Childs  
Taylor 13

Blumber

Inch	cut		
57.93		62.37	60.64
6.37		4.05	4.05
51.40	8.3	64.30	64.69 H.I.
51.68	7.4	51.40	52.50
57.95	6.0	12.90	12.35
52.23	7.3	53.05	53.60
52.50	8.0	11.64	11.09
52.78	6.2	54.20	54.00
53.05	8.5	10.49	10.69
53.33	7.0	54.92	55.64
53.60	7.0	9.77	9.05
53.88	6.8		8.29
54.00	5.4		
54.20	5.1		
54.56	4.2		
54.92	4.2		
55.28	3.9		
55.64	4.0		
56.01	3.7		
56.40	3.8		

3985.95

3713.70

272.25

3985.95

3713.70

272.25

7151.65

3985.95

165.70

142.25



Cont. from page 12

Sta.	H.I.	Rod	Ground	Grade	cut	
41+75	72.59	12.3	60.3	56.83	3.5	
42+00		9.2	63.4	57.28	6.1	
+25		8.4	64.2	57.74	6.5	
+50		8.22	64.37	58.20	6.2	
+75		9.7	62.9	58.65	4.3	
+939 m.H. center Eagle + bottom of canyon		7.66	64.93	59.0	5.9	
43+00		9.9	62.7	59.16	3.5	
+25		10.3	62.3	59.88	2.5	
+50		10.2	62.4	60.49	1.9	
+75		5.2	67.4	61.15	6.3	
44+00		3.6	69.0	61.81	7.2	
+20		14.9	71.10	62.48	8.6	
J.P. +50	7.60	78.70	4.1	74.6	63.14	11.5
+75		2.2	76.5	63.80	12.7	
45+00		4.4	74.3	64.47	9.8	
+25		9.0	69.7	65.13	4.6	
+50		7.09	71.61	65.79	5.8	

June 29/11

Lehilds  
Taylor -  
Bunker

13

64.37	
4.76	
69.13 H.I.	
57.28	
11.85	
58.20	
10.93	
59.0	
10.13	
64.37	
8.47	
72.84 H.I.	
59.83	61.15
13.81	11.69
62.48	75.52
10.36	76.62
54.0	71.61
76.50 H.I.	4.96 H.I.
63.14	76.57
13.36	64.47
	12.10

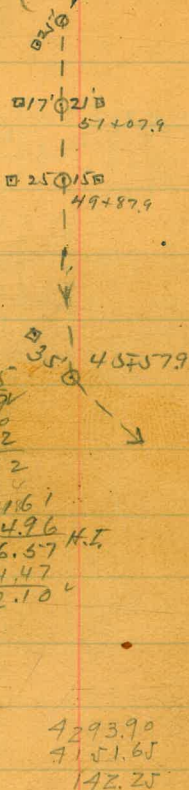

Cont. from page 13

Sta.	H.I.	Rod	Ground	Grade	cut
45+579 T.P. +75	79.70 83.67	72.1	71.49	√66.00	5.5
		11.4	72.3	66.60	5.7
46+00 +25		9.0	74.7	√67.47	7.2
		8.1	75.6	68.35	7.3
+50		7.8	75.9	√69.22	6.7
+75		3.8	79.9	70.10	9.8
47+00		1.69	81.98	√70.97	11.0
+25		1.1	82.6	71.85	10.8
+50		0.9	82.8	72.72	10.1
+58		1.2	82.5	√73.00	9.5
+75		1.4	82.3	73.15	9.2
48+00		1.21	82.46	√73.37	9.1
+25		1.7	82.0	73.58	8.4
+50		4.0	79.7	√73.80	5.9
+75		3.2	80.5	74.02	6.5
49+00		4.0	79.7	√74.24	5.5
+25		6.53	77.14	74.45	2.7
+50		6.8	76.9	√74.67	2.2
+75		5.5	78.2	74.89	3.3

July 24/11

Childs  
Taylor  
Boulder 14

76.57	H.I.	67.47	69.22
66.00		9.10	7.33
10.57			
		81.98	129
		3.04	
		85.02	H.I. 83.27
		70.97	70.97
		14.05	12.30
73.00		82.46	73.80
10.27		2.68	
		85.14	H.I. 11.34
74.67		73.37	74.24
10.47		11.77	10.90
		76.8	

Cut from page 14

July 20/11  
 Skilids  
 Taylor 15  
 Bunker

Sta.		H.I.	Rod	Gromet	Grade	cut
49+87.9	m.H. canyon line from east.	83.67	3.9	79.8	√75.00	4.8
50+00			3.1	80.6	√75.25	5.4
+25			2.7	81.0	75.77	5.2
+50			1.51	82.16	√76.29	5.9
J.P.	12.47	94.63				
+75			11.1	83.5	76.81	6.7
51+00			10.6	84.0	77.34	6.7
+07.9	m.H. line from Falcon.		10.02	84.61	√77.50	7.1
+25			12.6	82.0	77.85	4.2
+50			12.2	82.4	√78.37	4.0
+75			10.63	84.00	78.90	5.1
52+00			8.6	86.0	√79.42	6.6
+25			7.4	87.2	79.95	7.3
+50			6.5	88.1	√80.47	7.6
+75			5.1	89.5	81.00	8.5
53+00			4.5	90.1	√81.52	8.6
+25			3.11	91.52	82.05	9.5
+50			2.4	92.2	√82.57	9.6
+75			3.4	91.2	83.10	8.1

82.16		
4.69	75.25	77.50
86.85	11.60	9.35
75.00	76.29	78.37
11.85	10.56	8.48
79.42	80.47	81.52
7.43	6.38	5.33
2.96		
91.52	H.I. 82.57	
94.48	11.91	
82.05		
12.43		

55.129  
 51.079  
 405.

86.00  
 77.50  
 405.8.50 0021  
 810  
 400



cont. from page 15

July 24/11  
 J. Childs  
 Taylor  
 Blunked 15

Sta.	H.I.	Rod	Ground	Grade	cut	
49 54+00	94.63	5.5	89.1	83.62	5.5	94.48 H.I. 91.04 421
+25		6.1	88.5	84.15	4.4	83.62 10.86 ✓
+50		4.5	90.1	84.67	5.4	95.25 H.I. 85.20 84.67 ✓ 10.05 ✓
+75		4.1	90.5	85.20	5.3	86.00 ✓ 9.25 ✓
55+00		3.59	91.04	85.73	5.3	86.93 8.32 ✓
+129 M.H. 805' no center marks & no lot lines	✓	3.2	91.4	86.00	5.4	88.15 7.10 ✓
+25 bet. Eagle & Falcon		3.5	91.1	86.32	4.8	90.61 4.64 ✓
+50		3.6	91.0	86.93	4.1	98.64 4.33
+75		2.7	91.9	87.54	4.4	102.97 H.I. 93.06 91.83 11.14 ✓
56+00 J.P.	11.11 104.34	1.40	93.23	88.15	5.1	
+25		10.5	93.8	88.77	5.0	
+50		12.3	92.0	89.38	2.6	
+75		9.9	94.4	90.00	4.4	
57+00		8.8	95.5	90.61	4.9	
+25		7.6	96.7	91.22	5.5	
+50		6.9	97.4	91.83	5.6	
+75		6.6	97.7	92.45	5.3	
58+00		6.1	98.2	93.06	5.1	

Cont. from page 16

Sta.	H.I.	Rod	Ground	Grade	cut
57+25	104.34	5.70	98.64	93.66	5.0
+39.2		5.20	99.14	✓ 94.00	5.1
+50	✓	5.3	99.0	✓ 94.30	4.7
+75		6.1	98.2	94.99	3.2
59+00		5.0	99.3	✓ 95.67	3.6
+25		3.6	100.7	96.36	4.3
+50		2.08	102.26	✓ 97.05	5.2
J.P.	11.34	10.0	103.6	97.74	5.9
+75		8.2	105.4	✓ 98.42	7.0
60+00		7.3	106.3	99.11	7.2
+25		6.08	107.52	✓ 99.80	7.7
+50		5.59	108.01	100.49	7.5
+75		6.2	107.4	✓ 101.17	6.2
61+00		6.86	106.74	✓ 102.00	4.7
+30.2		6.9	106.7	✓ 102.23	4.5
+50		6.8	106.8	102.52	4.3
+75		5.7	107.9	✓ 102.80	5.1
62+00					

Childs  
Taylor  
B. Lee  
July 26/11

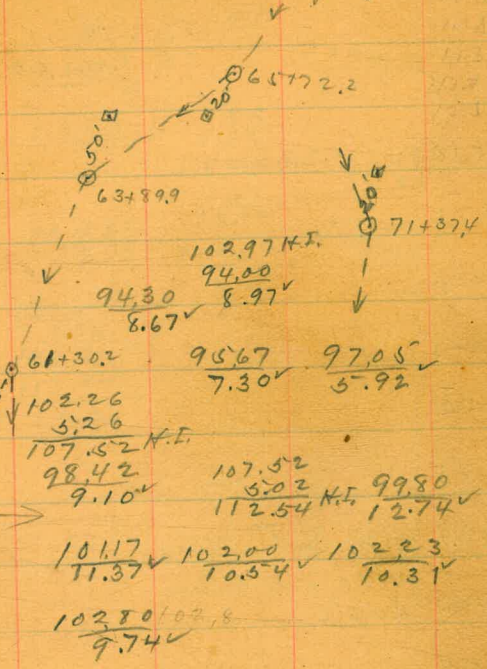

Cont. from page 17

July 26/11  
 J. Blais  
 Taylor  
 Bunker 13

Sta.	H.I.	Rod	Ground	Grade	Cut	
62+25	113.60	4.0	109.6	103.09	6.5	112.54 H.I. 103.38 9.16
+50		2.5	111.1	✓ 103.38	7.7	103.96 ✓ 104.54 8.58 ✓ 8.00
+75		1.69	111.91	103.67	8.2	109.83 8.53 ✓
63+00		2.2	111.4	✓ 103.96	7.4	111.83 6.53 118.36 H.I. 107.63 105.44 ✓ 70.73 ✓
+25		3.3	110.3	104.25	6.1	12.92 ✓ 112.02 ✓ 6.34 ✓
+50		5.1	108.5	✓ 104.54	4.0	121.54 2.16 123.70 H.I. 113.44 ✓
+75		4.0	109.6	104.83	4.8	10.26 ✓
+89.9		3.07	110.53	✓ 105.00	5.5	
64+00		3.2	110.4	✓ 105.44	5.0	
+25		1.77	111.83	106.54	5.3	
J.P.	12.75	11.9	112.7	✓ 107.63	5.1	
+50		11.0	113.6	108.73	4.9	
+75		9.9	114.7	✓ 109.83	4.9	
65+00		8.8	115.8	110.93	4.9	
+25		7.4	117.2	✓ 112.02	5.2	
+50		6.6	118.0	✓ 113.00	5.0	
+72.2		4.2	120.4	✓ 113.44	7.0	
66+00		3.04	121.54	113.84	7.7	

Cont. from page 8

Shields  
Taylor  
Bunker

Sta.	H.I.	Rod	Ground	Grade	cut	
66+50	124.58	3.7	120.9	✓ 114.24	6.7	123.70 H.I. 114.24 ✓ 9.46
+75		5.4	119.2	✓ 114.64	4.6	115.03 ✓ 8.67 ✓ 115.83 ✓ 7.87 ✓
67+00		5.9	118.7	✓ 115.03	3.7	116.63 ✓ 7.07 ✓ 117.00 ✓ 6.70 ✓ 122.86 7.22 130.08 H.I. 117.68 12.40 ✓
+25		4.1	120.5	✓ 115.43	5.1	120.23 ✓ 9.86 ✓ 121.80 ✓ 8.58 ✓
+50		3.34	121.24	✓ 115.83	5.4	136.08 H.I. 122.78 13.30 ✓
+75		2.4	122.2	✓ 116.23	6.0	
68+00		1.72	122.86	✓ 116.63	6.3	
+23.4	M.H. bottom of	1.72	122.86	✓ 117.00	5.9	
J.P. camp near Walnut	134.27	12.4	121.9	✓ 117.68	4.2	
+50	11.41	13.5	120.8	✓ 118.32	2.5	
+75		11.1	123.2	✓ 118.95	4.3	
69+00		9.3	125.0	✓ 119.59	5.4	
+25		8.3	126.0	✓ 120.23	5.8	
+50		7.65	126.62	✓ 120.87	5.7	
+75		7.3	127.0	✓ 121.50	5.5	
70+00		8.3	126.0	✓ 122.14	3.9	
+25		7.5	126.8	✓ 122.78	4.0	
+50		4.7	129.6	✓ 123.42	6.2	

Main sewer on University ave.  
west. I

Sta.	J.P.	1.97	H.I. 291.91	Rod	Gr.
0+00	M.H. just east of ejector.			1.9	289.9 290.0
+15				1.7	290.2
+45.1	M.H. 5' So. of no. curb. +20' east of west line of 5th + University.			2.1	289.8
1+00				2.9	289.0
+50				3.2	288.7
2+00				3.4	288.5
+50				4.1	287.8
3+00				4.6	287.3
+50				5.0	286.9
4+00				5.4	286.5
+50				5.7	286.2
5+00				6.1	285.8
+50				6.4	285.5
6+00				6.5	285.4
+50				7.1	284.8
7+00				7.50	284.41
J.P.					284.52
+39.75	M.H. center of 3rd street	0.50	285.02	0.8	284.2
+50				1.0	284.0

from M.H. east of ejector  
May 13/11  
Childs  
Taylor  
Bunker

Grade	cut	Notes
289.94	20.0	B.M. 5th + Univ.
289.94	20.3	Univ. ave.
269.82	20.0	
289.60	19.4	
269.40	19.3	Childs Taylor Bunker June 6/11
269.20	19.3	
269.00	18.8	
268.80	18.5	
268.60	18.3	
268.40	18.1	
268.20	18.0	
268.00	17.8	
267.80	17.7	
267.60	17.8	
267.40	17.4	
267.20	17.2	
267.04	17.2	
267.00	17.0	

U  
25  
25

Cont. from page 20

Sta.	H.I.	Rod	Ground
8+00	285.02	2.0	283.0
+50		3.1	281.9
9+00		3.8	281.2
+50		4.8	280.2
10+00		6.0	279.0
+50		6.8	278.2
11+00		6.3	278.7
+50		8.0	277.0
12+00		8.5	276.5
+50		8.7	276.3
13+00		9.4	275.6
+50		10.1	274.9
14+00		11.15	273.87
J.P.	1.66		275.53
+33.0	M.H. Center of Street		(Front.) 1.9 273.6
+51		2.7	272.6
+75			272.7
15+00		4.3	271.2
+35	M.H. Top of Hill		6.2 269.3
+50		7.21	268.32

1433  
273.12  
695.2

1530  
1433  
10.70

1720  
1433  
12.12

may 15/11  
Childs  
Taylor 21  
Bunker

Grade	cut		
266.80	16.2	290.42 HI	284.52
		8.00	277.0
		282.42	287.29 HI
		266.60	3.92 6.67
		15.82	283.37 280.62
266.60	15.3	5.70	266.80 266.20
		281.59	18.57 14.42
		266.40	7.94 8.46 8.44
		15.19	279.35 278.83 275.85
266.40	14.8		266.00 265.80 265.60
			13.35 13.03 13.25
266.20	14.0		
266.00	13.0	273.87	
		8.61	273.87 5.30
		282.48 HI	4.36 277.78
		3.51	278.23 265.00
265.80	12.4	278.97	5.5 12.18
		265.40	17.27 6.22
		13.57 4.25	276.26
265.60	13.1	278.23	264.86
		265.20	11.46
		13.03	9.44 273.04 7.19
265.40	11.6	8.42	264.20 275.80
		274.06	8.84 264.60
265.20	11.3	264.40	10.70
		9.66	11.76 10.70
265.00	11.3		270.72 10.70
			4.76
264.80	10.8	264.0	275.48 HI
		11.48	263.86
			11.62
264.60	10.3		
264.40	9.5		
264.27	9.3		
264.20	8.6		
264.10	8.6		
264.00	7.2		
263.86	5.4		
259.02	9.3		

grades  
Childs  
Taylor  
Bunker  
June 17/11

140.5

Cont. from page 21

Sta.	J.P.	H.I.	Rod	Ground
15+75	J.P.	0.23	268.55	258.0
16+00	J.P.	0.29	256.84	256.55
+30	V. curve	0.05	244.17	247.8
+40	break in grade		6.8	237.4
+50	V. curve		10.3	233.9
+75	J.P.	0.93	232.31	231.38
17+00			4.5	227.6
+25			7.68	224.63
+29.5	M.H.	1.71	226.54	224.1
+50			3.6	222.9
+75			3.4	223.1
18+00			5.5	221.0
+25			8.2	218.3
+50			8.36	218.18
+70	M.H.		9.4	217.1
19+00			11.07	215.47
+25			12.4	214.1

1970  
1720  
140.5

June 20/11  
Lehigh  
Taylor  
Bunker

Grade	cut
250.96	7.0
242.90	4.9
233.23	4.2
230.0	
228.88	3.4
226.09	5.3
223.30	4.5
220.51	4.1
220.00	4.1
219.06	3.8
217.93	5.2
216.79	4.2
215.66	2.6
214.53	3.7
213.62	3.5
212.26	3.2
211.13	3.0

17+29.5

224.63  
8.66  
233.29 H.I.  
220.51  
12.78  
228.88 233.23 263.86  
4.41 0.06 33.86 32.24  
12.62  
245.91 H.I.  
233.33  
12.68  
242.90  
3.01

226.09 7.20  
226.09 230  
224.78 210  
224.78 210  
224.78 210  
224.78 210

220.06 H.I. 213.62  
211.13 6.44  
8.93

218.18  
5.49 H.I. 216.79 219.06  
223.67 6.88 4.61  
214.53  
9.14

Sta.	H.I.	Rod	Ground
19750 not in	<u>226.54</u>		
+75	8.98	12.58	213.96
+943 m.H. alley bet albatross & Summit.	<u>222.84</u>	10.1	212.7

Grade cut.

✓ 208.87	5.1	214.25
✓ 208.0	4.7	5.81
		<u>230.06 H.I.</u>
		208.87
		<u>11.19</u>

8.59

214.25

23





cont. from page 19

Sta.	H.I.	Rod	Ground	Grade	cut
71+00	134.27	3.7	130.6	124.05	6.6
+25		3.17	131.10	124.68	6.4
+37.4	12.39	3.38	130.89	125.00	5.9
+50	143.49	12.2	131.3	125.43	5.9
+75		11.3	132.2	126.28	5.9
72+00		11.8	131.7	127.12	4.6
+25		10.0	133.5	127.97	5.5
+50		7.47	136.02	128.81	7.2
+75		6.2	137.3	129.66	7.6
73+00		5.0	138.5	130.50	8.0
+25		4.9	138.6	131.35	7.3
+50		5.44	138.05	132.20	5.9
+75		5.5	138.0	133.05	5.0
74+00		4.6	138.9	133.89	5.0
+25		3.22	140.27	134.74	5.6
+50		1.6	141.9	135.58	6.3
+75		4.3	139.2	136.43	2.8

3.25%

Oct. 2/11

Schields  
Taylor  
Bunker

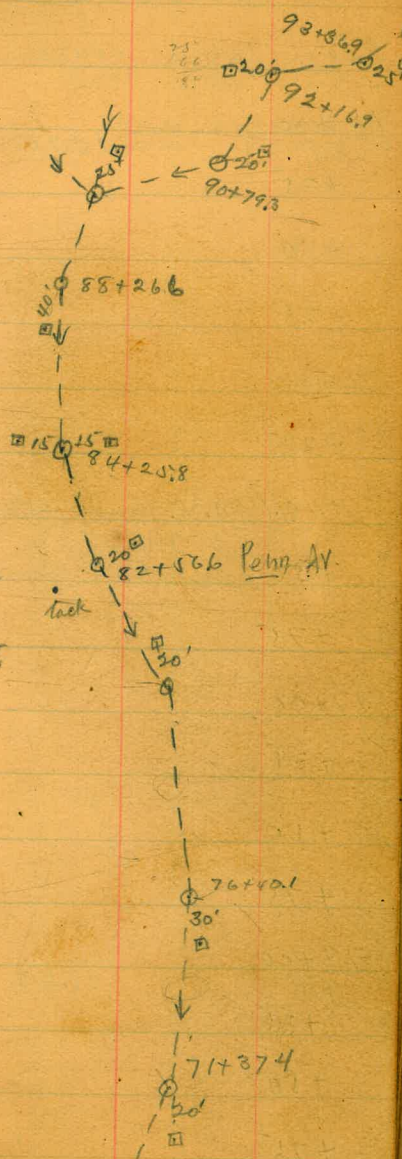

Cont. from page 24

Oct. 2/11  
 Lehigh  
 Taylor  
 Bunker

Sta.	H.I.	Rod	Ground	Grade	cut					
75+00	143.49					146.80 H.I.	137.27	138.97	140.66	142.00
J.P.						9.53	9.53	7.83	6.14	4.80
+25	10.70	153.40	0.79	142.70	137.27	5.4	146.19	144.07	145.80	147.53
+50			8.9	144.5	138.12	6.4	9.61	11.73	10.00	8.27
+75			9.7	143.7	138.97	4.7	155.80 H.I.			6.53
76+00			9.2	144.2	139.82	4.4	142.34			
+25			7.21	146.19	140.66	5.5	13.46			
+40.1 m.H. center alley bet. Millers & Brooks produced.			6.7	146.7	141.49	5.2				
+50			6.55	146.85	142.00	4.9				
+75			6.1	147.3	142.34	5.0				
77+00			1.8	151.6	143.21	8.4				
+25			4.2	149.2	144.07	5.1				
+50			2.52	150.88	144.94	6.0				
+75			0.7	152.7	145.80	6.9				
78+00			4.1	149.3	146.67	2.6				
J.P.	11.62	163.47	1.55	151.85	147.53	4.3				
+25			9.5	154.0	148.40	5.6				
+50			8.6	154.9	149.27	5.6				
+75			8.00	155.47	150.14	5.3				

346%



cont. from page 26

Sta.	H.I.	Rod	Ground	Grade	cut
83+50	175.87	5.0	170.9	✓163.97	6.9
+75		4.49	171.38	✓164.64	6.7
84+00		5.8	170.1	✓165.31	4.8
+25.8 M.H. alley bet. J.P. market & Sutter	184.43	4.18	171.69	✓166.00	5.7
+50	12.74	12.9	171.5	✓166.85	4.7
+75		12.0	172.4	✓167.72	4.7
85+00		9.2	175.2	✓168.60	6.6
+25		7.76	176.67	✓169.47	7.2
+50		5.6	178.8	✓170.34	8.5
+75		5.80	179.13	✓171.21	7.9
86+00		3.9	180.5	✓172.09	8.4
+25		2.5	181.9	✓172.96	8.9
+50		1.17	183.26	✓173.83	9.5
J.P. market	6.84	190.10		✓174.70	9.0
+75		6.4	183.7	✓175.58	8.5
87+00		6.0	184.1	✓176.45	7.9
+25		5.8	184.3	✓177.32	7.1
+50		5.66	184.44		

Oct. 5/11 } Schulz  
Taylor 21  
Blumber

169.22	171.38	
163.97	4.47	H.I.
5.25	175.85	
	165.31	166.00
	10.54	9.85
166.85	168.60	176.67
9.00	7.25	5.11
		181.78 H.I.
		170.34
		11.44
183.26		
156		
184.82 H.I.	173.83	188.26
172.09	10.99	4.05
12.73		187.31 H.I.
		175.58
		11.73
177.32		
9.99		

cont. from page 27

Oct. 6/11  
 Lehigh  
 Taylor  
 Blumberg

Sta.	H.I.	Rod	Ground	Grade	cut.	
87+75	190.10	5.5	184.6	178.19	6.4	187.31 H.I. 180.00 179.07 7.31 ✓
88+00		7.5	182.6	✓179.107	3.5	8.24 ✓ 180.78 6.58 ✓
+26.6 m/H alley bet. Lutter & Bush		5.75	184.35	✓180.00	4.4	186.36 5.85 H.I. 183.28 184.11 192.21 H.I. 8.93 ✓ 8.10 182.45 9.76 ✓ 185.78 6.43 ✓
+50		4.35	185.75	✓180.78	5.0	190.06 10.31 H.I. 188.42 200.37 H.I. 11.95 ✓
+75		4.3	185.8	181.61	4.2	187.44 12.93 ✓ 189.11 190.78 11.26 ✓ 9.59 ✓
89+00		3.74	186.36	✓182.45	3.9	
+27.7 m/H. junctional J.P. drive in Halls +50 track. 10.57	197.33	3.34	186.76	✓183.28	3.5	
+75		9.1	188.2	✓184.11	4.1	
90+00		7.93	189.40	184.94	4.5	
+25		5.8	191.5	✓185.78	5.7	
+50		5.0	192.3	186.61	5.7	
T.P. +79.3 m/H. angle.	11.24 203.90	7.27	190.06	✓187.44	2.7	
91+00		4.67	192.66	✓188.42	3.2	
+25		12.25	191.65	✓189.11	4.4	
+50		10.4	193.5	189.94	4.9	
+75		9.07	194.83	✓190.78	5.5	
		7.6	196.3	191.61	3.7	
		8.6	195.3			

T.P.

cont. from page 28

Sta	H.I. Rod	Ground
92+00	<u>203.90</u>	7.94 195.96
+16.9 m.H. angle		6.94 196.96
+25		7.1 196.8
+50		4.0 199.9
+75		1.5 202.4
93+00		0.97 202.93
J.P.	11.12 <u>214.05</u>	
+25		11.7 202.4
+36.9 m.H. center Brant & campfire		13.05 201.00
+50		12.07 201.98
+75		9.1 205.0
94+00		5.7 208.4
+25		6.5 207.6
+50		6.8 207.3
+75		6.52 207.53
95+00		5.8 208.3
+25		4.8 209.3
+50		4.1 210.0

Oct. 6/11

Hildes  
Taylor  
Brant

Grade	cut	195.96
✓192.45	3.5	9.38 205.34 H.I. 192.45 12.89 ✓
✓193.01	4.0	193.01 194.11 12.33 ✓ 11.23 ✓
193.28	3.5	195.78 197.00 9.56 ✓ 8.34 ✓
✓194.11	5.8	197.52 ✓ 207.03 7.82 ✓ 5.05
194.94	7.5	212.58 H.I. 199.52 ✓ 201.51 13.06 ✓ 11.07 ✓
✓195.78	7.1	203.51 ✓ 205.50 9.07 ✓ 7.08 ✓
196.61	5.8	
✓197.00	4.0	
✓197.52	4.5	
198.52	6.5	
✓199.52	8.9	
200.52	7.1	
✓201.51	5.8	
202.51	5.0	
✓203.51	4.8	
204.51	4.8	
✓205.50	4.5	

cont. from page 29

Sta	H.I.	Rod	Ground
95+75	<u>214.05</u>	2.80	211.25
96+00		1.6	212.5
+12.4 M. Halley bet. Brant & albatross		1.31	212.74

Oct. 6/11

Childs  
Page 30  
Bunker

Grade cut	H.I.	
212.59	H.I.	208.00
206.50	4.7	4.58 ✓
207.50	5.0	
208.00	4.7	

Sever on market, + Robinson from  
 ✓ to alley west of albatross.

Sta	J.P.	H.I.	Rod	Ground
0+00	12.97	179.07	12.8	166.3
+25			11.2	167.9
+50			4.80	174.27
J.P.	11.99	190.71	0.35	178.72
+75			10.9	179.8
1+00			7.13	183.58
J.P.	10.84	201.40	0.15	190.56
+50			10.30	191.10
2+00			2.41	198.99
+08.6			1.30	200.10
J.P.	12.28	212.38	7.11	205.27
+50			2.36	210.02
3+00	11.59	223.32	0.65	211.73
J.P.			8.6	214.7
+50			3.69	219.63
4+00	11.37	234.37	0.32	223.00
J.P.			10.76	223.61
+50			7.3	227.1
5+00			6.7	227.7
+10.1			19.4	232.43
J.P.	10.15	242.58	4.93	237.65
+50			4.50	238.05
6+00				238.05
+01.6				238.05

main line in canyon  
 Oct. 14/11

Chubb  
 Taylor  
 Bunker

Grade	cut	H.I.	Ground
174.27		177.71	
8.51		5.07	
182.78			
161.80	4.5	169.76	
		13.02	
165.78	2.1	191.10	
		7.89	
198.99		211.73	
169.76	4.5	185.67	
		13.32	
173.74	6.1	195.00	
		3.99	
177.71	5.9	219.63	
		6.52	
185.67	5.4	225.15	
		212.13	
		13.02	
193.62	5.4	216.61	
		8.54	
195.00	5.1	221.09	
		4.06	
198.71	6.6	222.00	
		3.15	
203.18	6.8	232.42	
		6.12	
207.66	7.0	238.55	
		225.50	
		13.05	
212.13	7.5	230.00	
		8.53	
216.61	7.0		
221.09	6.0		
222.00	5.7		
226.50	6.9		
229.86	7.8		
230.00	8.1		

Set next page for change

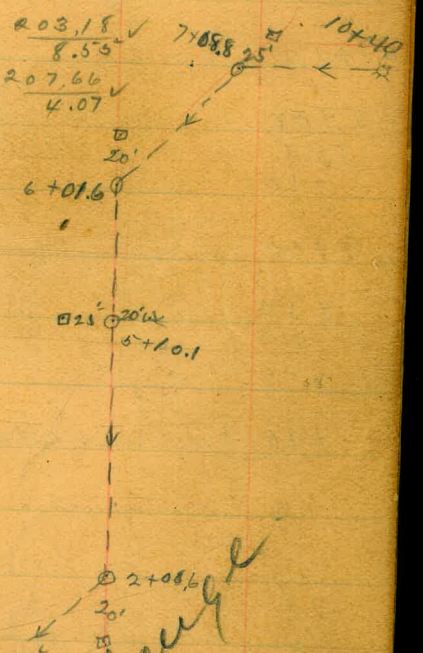



cont. from page 31

Sta.		H.I.	Rod	Ground
	12.69	<u>250.34</u>		227.65
6+50			2.15	248.19
J.P.	12.86	<u>263.09</u>	0.11	250.23
7+00			5.35	257.74
+08.8	M.H. angle.		4.18	258.91
+50			1.6	261.5
8+00	5		0.83	262.26
J.P.	5.96	<u>268.22</u>		
+50			5.4	262.8
9+00	5		4.7	263.5
+50			4.1	264.1
10+00			3.47	264.75
+40	F.I. near albatross.		3.0	265.2

See page 33 in  
change of grade

Oct. 16/1911  
Childs  
Taylor  
Bunker

Grade	cut			
		248.19	257.74	
		3.62	7.11	
240.61	7.6	251.81 H.I.	264.85 H.I.	
		239.73	251.57	
		12.08	13.28	253.50
251.57	6.1	21.92	239.73	11.30
		3.76		255.29
253.50	5.4		10.54	9.56
			258.37	257.25
254.31	7.2		8.58	7.60
		264.75		
		4.59		
255.29	7.0	269.34 H.I.		
		258.23	260.00	
256.27	6.5	11.11	9.34	
		2		
257.25	6.3		10.96	21.92
			21.92	31
258.23	5.9		21.92	8.7680
		70.88	6.576	253.50
259.21	5.6	601.6	6.795.2	7.72
		107.2	253.50	244.73
260.00	5.2		6.50	
			256.70	21.92
			244.70	1096.00
		253.50		
		10.96		
		242.54		

Change of Sewer in Robinson

Sta.	H.I.	Roads	Ground
0+00. = M.H. 7+58.8 page 32	257.92	- 0.02	258.0
+24.8		2.11	258.81
+49.6		4.8	253.1
+74.4 <i>curve</i>		8.60	249.32
+99.2 = Sta 6+58.8 page 32		12.60	245.32

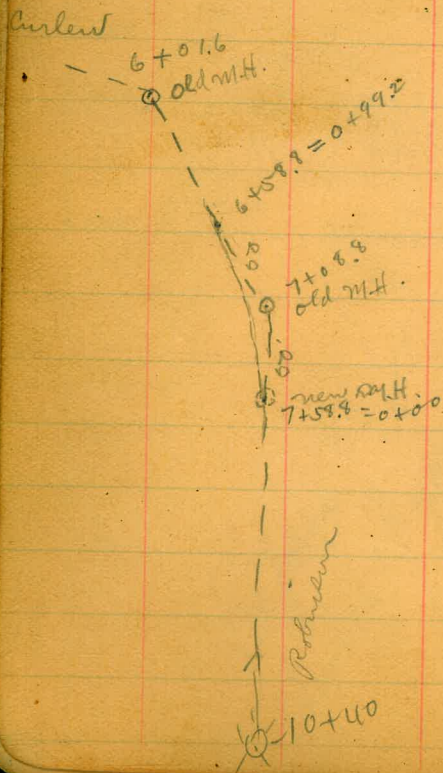

Curlew.

apr. 14/15

Childs  
Allen  
Kerr 33

Grade.	cut
254.38	3.6
251.43	4.4
248.48	4.6
245.53	3.8
242.58	2.7

588  
076  
572

Miss  
Summer Myer  
Sago  
Alulor

Line Change.. Sewer To West of  
& California St from 12+75<sup>2</sup> Childs. Original  
Line South of Spruce to a pt on original line  
104.9 N. of the & of Spruce 15+18<sup>5</sup> = 15+08.9

Top ex. Pipe 128.3 S. of ex M.H. & Spruce 9.78 <sup>15.78</sup> <sup>New Elev. Stake</sup> <sup>Old Elev. Grade</sup> 6.00

12+75 <sup>7</sup> M.H. L 1283 S of ex M.H.	4.94	10.84	4.91	5.93
13+23 <sup>35</sup> M.H. L	1.12	14.66	5.09	9.57
13+50	1.30	14.48 <sup>3</sup>	5.18	9.30
14+00	2.13	13.650	5.36	8.29
+35	0.96	14.82 <sup>9</sup>	5.43	9.39
+69 <sup>95</sup> M.H. L	1.47	14.31	5.57	8.74
15+18 <sup>5</sup> = 15+08 <sup>9</sup> M.H. L	5.05	10.73	5.75	4.98

Top of ex Pipe 127 N of ex M.H. & Spruce

Profile for above line

12+75 <sup>7</sup> L.Rt 25°-00'-00	4.9	10.9
13+23 <sup>35</sup> L.Lt 24°-26'-00	4.9	10.9
13+50	4.9	10.9
14+00	4.8	11.0
+35	4.9	10.9
+69 <sup>95</sup> L.Lt 26°-52'-00	4.9	10.9
15+18 <sup>5</sup> = 15+08 <sup>9</sup> L.Rt 26°-20'-00	5.1	9.7

Childs original line

34

S&BP  
1st Ad.  
Over Ryan  
12.175  
3.85 +  
16.035 A  
3.35 0 -  
12.685 TP.  
1.45 +  
14.135 X  
3.20 -  
10.935 T  
4.25 +  
15.785 X  
5.63 -  
10.155  
10.14  
check BM set by  
Consolidated Top M  
300 S of Serrano  
West Side of Pacific.

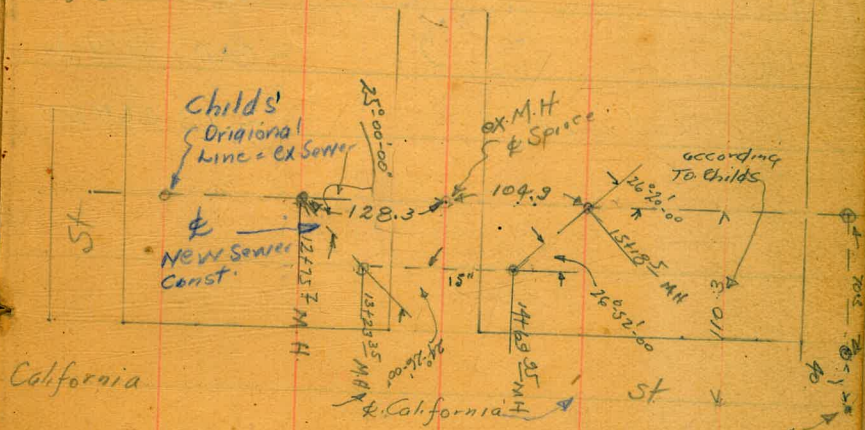

California

Redwood

Spruce

See Page 37.  
"Childs" Notes  
This Book

Serrano

✓ Severn Valley bet. Brant &  
 Campyur North toward Robinson  
 Sta. Rod Grand  
 J.P. 4.76 H.I. 221.06 216.30  
 2+00 m.H. bottom 6.7 214.4  
 +25 Campyur 5.27 215.79  
 +50 2.25 218.81  
 J.P. 13.57 231.38  
 +75 6.74 224.64  
 1+00 x 0.75 230.63  
 J.P. 13.02 243.65 3.5 240.2  
 +25 18.10 256.63 0.12 243.53  
 J.P. 10.93 267.56 5.20 251.43  
 +50 0.00 256.63  
 J.P. 5.89 261.67  
 +75 4.17 263.39  
 2+00 3.0 264.6  
 +50 2.93 264.63  
 +80 dead end

albatross from bottom of } Childs  
 } Taylor  
 } (other)  
 Aug 5/12  
 216.85 5.6 17.65  
 211.92 3.87 241  
 215.00 3.81 3/31.5  
 220.75 3.89 10.5  
 226.50 4.13 105 / 2.60 (2.83)  
 237.00 3.2 210  
 247.50 3.93 400  
 258.00 3.67 315  
 258.58 4.80 350  
 259.16 5.4 5.8  
 260.50 4.13 116

✓ Sewer line main along old Totus Road  
to center of fence

Sta.	J.P.	H.I.	Rod	Ground
0+00	9.03	24.57		15.54
+25			6.48	18.09
+65			7.5	17.1
1+00			7.5	17.1
+50			7.1	17.5
2+00			6.1	18.5
+50			6.5	19.1
3+00			5.18	19.39
+50			6.0	18.6
4+00			5.5	19.1
+50			6.9	17.7
5+00			7.1	17.5
+50			6.4	18.2
6+00			5.73	18.84
J.P.	2.11	20.95		
+42.6			2.5	18.4
+50			2.5	18.4
7+00			3.2	17.7

railroad bed from center alive

July 3/11

Shultz  
Fayer  
Bunker

Grade	cut			
-0.66		15.54		
-0.56	18.7	6.69		
-0.40	17.5	22.23 H.I.		
-0.26	17.4	4.44		
-0.06	17.6	17.79		
+0.14	18.4	1.40	375	288
+0.34	18.8	15.19	1848	19.35
+0.54	18.9	4.35	.06	19.44
+0.74	17.9	17.88	18.54	19.21
+0.94	18.2	26		19.10
1.14	16.6	18.14		
1.34	16.2	5.00	19.39	
1.54	16.7	19.62	5.23	18.54
1.74	17.1	0.74	24.62 H.I.	4.93
1.91	16.5	18.88	4.17	23.77 H.I.
2.14	15.6	4.60	20.45	4.69
		20.02	.54	19.08
		0.94	19.91	1.14
		19.08	5.12	5.33
			18.65	18.44
			1.54	1.34
			17.11	17.10
		18.84	3.72	2.58
		22.56 H.I.		
		2.58	3.92	3.62
		19.98	18.64	18.94
		1.74	2.14	2.34
		18.24	16.50	16.60
		3.10		
		19.46		
		1.91		
		17.55		

July 25/11

Shultz  
Fayer  
Bunker

Cut from page 36.

Sta.	H.I.	Rod	Ground	Grade	cut
7+50	<u>20.95</u>	3.3	17.6	✓ 2.34	15.3
8+00		2.3	18.6	✓ 2.54	16.1
+50		2.78	18.17	✓ 2.74	15.5
9+00		4.0	16.9	✓ 2.94	14.0
+50		4.0	16.9	3.14	13.8
+70	17.15	12.82	4.3	✓ 3.22	1.1
10+00	<u>20.95</u>	4.48	16.47	✓ 3.34	13.2
+50	+ note E of Redwood		3.4	✓ 3.54	14.0
+75		5.9	15.0	3.64	11.4
11+00		9.4	11.5	✓ 3.74	7.8
+20	m.H. angle. 5.30		3.29	✓ 3.82	13.9
J.P.		<u>22.96</u>	17.66		
+50		5.1	17.9	✓ 3.94	14.0
12+00		4.90	18.06	✓ 4.14	13.9
+50		6.3	16.7	✓ 4.34	12.4
13+00		6.5	16.5	✓ 4.54	12.0
+50		7.9	15.1	✓ 4.74	10.4
14+00		6.16	16.80	4.94	11.9
+04	m.H. center Spruce		5.7	✓ 4.96	12.3

center from 10200

July 10/11

Lahille's  
Taylor  
Bridges

17+54.6

20' 9" 72.20 40' 0" center

18+54.9 base of pas.

center of fence 114704

22.57 H.I.

2.60

19.96

2.54

17.42

3.98

18.58

2.94

15.64

3.50

19.46

2.74

16.32

16.47

6.33

16.80 H.I.

3.20

13.60

16.47

5.38

21.85 H.I.

2.58

19.27

3.54

15.73

2.46

19.39

4.14

15.25

4.24

81

16.80

4.51

21.31 H.I.

4.34

16.97

2.68

14.29

3.63

17.68

4.54

13.14

10.28

11.57

3.74

7.83

2.53

19.32

3.94

15.38

5.20

18.65

3.82

14.83

16.47

0.68

17.15 H.I.

4.9

16.4

4.5

11.7

3.00

17.81

4.96

12.85

cont. from page 37

Sta.	H.I.	Rod	Ground	Grade	cut
14+50	5.82	22.62	16.80	5.14	10.7
15+00		21.11	15.8	5.34	11.8
+50			18.2	5.54	12.7
16+00			17.5	5.74	11.8
+50			16.7	5.94	10.8
17+00			16.7	6.14	10.6
+50			15.71	6.34	9.4
+84.6 M.H. center Sassafras + old RR. Grade			15.7	6.48	9.2
18+20			19.8	6.62	13.2
+54.9 M.H. center Sassafras 425' east west line of Calif.			22.0	6.76	15.2
19+00			20.6	6.94	13.7
+50			20.22	7.14	13.1
20+00			19.7	7.34	12.4
+50			17.44	7.54	9.9
21+00			15.0	7.74	7.3
+50			13.5	7.94	5.6
22+00			13.09	8.14	5.0
+35.6 M.H. center Thom + 25' east of west line of Calif.			13.6	8.28	5.3

July 10/11  
 Schiller  
 Taylor  
 Bunker  
 33  
 rerun July 19/11

21.31	H.I. 3.3	
2.18	3.30	
19.13	18.01	
5.14	5.34	
13.99	12.67	
15.71		
4.86		
20.57	H.I.	1.30
1.02		2.41
19.55		19.27
5.84		18.16
14.01		5.74
		5.94
		13.53
		12.22
	2.57	4.26
15.71	18.00	16.31
8.79	6.14	6.34
24.50	H.I.	11.86
		9.97
3.61		
20.89	8.39	
6.62	16.11	23.40
14.27	6.48	
	9.63	
0.77		
23.73	2.59	18.09
6.76	21.91	6.96
16.97	6.94	20.05
	14.97	8.28
		11.77
8.14	7.94	7.74
11.91	12.11	12.31
		7.54
		12.51
17.44		
6.46		
23.90	H.I.	1.99
3.67		21.91
20.23		7.14
7.34		14.77
12.89		

Denver line Center Kalnia from 137' west  
 to center of India to Juniper  
 Sta. J.P. H.I. R.S. Grand  
 9.99 28.09 18.10  
 0+00 m.H. center Kalnia  
 + lot line bet. India  
 + artch. POSTED 11.1 17.0  
 4+5 J.P. 12.69 40.17 0.61 27.48  
 7+5 J.P. 10.57 49.24 5.74 34.43  
 1+00 14.4 38.73 8.2 41.0  
 7+25 6.6 42.6  
 137.5 m.H. center Kalnia  
 + India. 6.4 42.8  
 4+50 6.1 43.1  
 2+00 5.5 43.7  
 4+50 J.P. 5.34 49.79 4.79 44.45  
 3+00 4.5 45.3  
 7+50 3.9 45.8  
 4+00 3.01 46.78  
 4+00 F.S. near juniper 2.0 47.8

center India to center India  
 Grade cut. Aug 3/11  
 9.00 10.00  
 14.35 2.7  
 18.63 8.90 15.50  
 25.05 9.4  
 30.41 10.6  
 35.76 6.8  
 38.44 4.4  
 38.5 4.6  
 39.65 9.85 39.80 9.60 39.00 9.50  
 38.75 5.0  
 39.90  
 39.25 9.25 39.50 9.50 39.75 8.75 40.00 8.50  
 39.0 5.4  
 39.25 6.1  
 39.5 6.3  
 39.75 7.0  
 40.0 7.8  
 Kalnia  
 4687  
 292  
 4979  
 27.48  
 124  
 29.22 H.I.  
 18.63  
 10.59  
 44.05  
 3.44  
 47.89 H.I.  
 6.33  
 41.06 T.R.  
 2.51  
 43.37 H.I.  
 3.44  
 12.96  
 44.45  
 4.05  
 48.50 H.I.  
 39.40  
 10.06  
 35.76  
 12.74  
 39.00  
 9.50



Laurel St. from lot line bet. India  
 of India & north in India to Quince

Sta.	J.P.	H.T.	Rod	Grade
0+00		4.68	61.01	56.33
+50	center Laurel & 100 west of India on lot line			49.14
1+00	POSTED			52.4
+50				52.4
+58	M.H. center Laurel			54.6
2+00	+5' west of east curb line of India			54.4
+50				55.3
3+00				55.3
+50				55.8
4+00				55.2
J.P.	1290	72.18		55.88
+50				59.28
5+00				63.0
+50				66.4
6+00				70.06
J.P.	1236	82.42		73.0
+50				73.7
7+00				77.0
+38.15	M.H. center maple			78.1
+50				79.1
8+00				79.0
+50				81.24
J.P.	1201	93.25		83.6
+50				85.7

of arctic to 5' west of east curb  
 - ✓  
 Aug. 4/11

Grade	Cut
43.00	6.1
41.00	8.1
44.90	7.5
46.80	7.8
48.70	6.6
49.00	6.2
51.65	4.2
54.80	4.5
57.96	5.0
61.11	5.3
64.27	5.8
67.42	6.3
70.57	6.4
73.00	5.1
73.42	4.7
75.26	3.7
77.10	4.2
78.94	4.7
80.75	4.9

Change of Grade

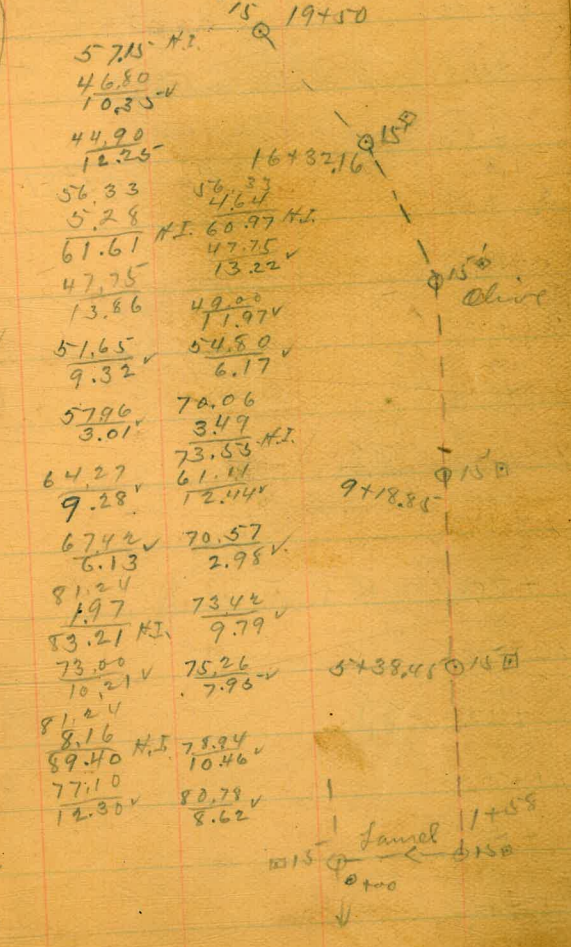

John Childs  
 Taylor  
 Bunker

190  
 75

15' Laurel 1+58  
 0+00 150

Cont. from page 40

Sta.	H.I.	Rod	Ground
8+00	<u>93.25</u>	5.3	87.9
+50		3.3	89.9
9+00		1.6	91.6
+18.85 m.H. center nutmeg		1.2	92.0
+50 I.P.	12.96 <u>105.51</u>	0.70	92.55
10+00		11.9	93.6
+50		10.7	94.8
11+00		9.2	96.3
+50		7.8	97.7
12+00 I.P.		6.2	99.3
+50		4.9	100.6
+75.85 m.H. center olive		4.6	100.9
13+00		4.7	100.9
+50 I.P.		5.2	100.3
14+00		5.3	100.2
+50		5.5	100.0
15+00		5.6	99.9

Aug. 8/11  
 L. L. W. Taylor  
 Brother

Grade cut			
89.40 H.I.	84.46	87.0	
82.62	4.94	2.40	
6.78			
92.55	86.30	87.8	
7.77	3.10	1.62	
100.32 H.I.	90.27	91.51	
89.02	10.05	8.81	
11.30			
92.76	94.0		
7.56	6.32		
87.0	5.0		
87.78	4.8		
89.02	4.6		
90.27	4.5		
91.51	4.8		
92.76	4.7		
94.0	5.3		
	6		
96.0	4.3		
95.74	4.5		
95.47	4.5		
95.20	4.7		

1200  
918.85  
 281.15

Cut from page 41

Sta.	H.I.	Rod	Ground
15+50	<u>105.51</u>	5.8	99.7
16+00		5.7	99.8
+32.16 m.k. center Palm		5.9	99.6
+50		6.0	99.5
17+00		5.3	100.2
+50		4.1	101.4
18+00		2.8	102.7
+50		2.3	103.2
19+00		2.7	102.8
+50 F.S.		3.0	102.5

Grall cut

✓94.94	4.8
✓94.67	5.1
✓94.5	5.2
✓85.00	14.6 drop m.H.
✓94.70	4.8
✓95.25	5.0
✓95.80	5.6
✓96.35	6.4
✓96.90	6.3
✓97.45	5.4
✓98.0	4.5

Aug. 8/11

Schields  
Taylor  
Bunker

99.91 B.M.	94.67
4.38	9.62 ✓
104.29 H.I.	94.94
94.5	9.35 ✓
9.79 ✓	
94.70	95.25 ✓
9.59 ✓	9.04 ✓

95.80 ✓	96.35	96.90	97.45
8.49 ✓	7.94 ✓	7.39 ✓	6.84 ✓
98.00			
6.29 ✓			

Schields  
Taylor  
Bunker

Sept. 6/11

99.91	grades
2.95	
102.86 H.I.	
85.00	
17.86	
2.55	
15.31 ✓	

Line 'A' 34-Lot Line between India & Artie  
Halmia to Laurel

Sta	+ H	H.I	- R.L	Elev Top of Rec	Grade
5+0	I	+ H	H.I	- R.L	Elev Top of Rec
6+0		10.44	28.59	18.10	11

POSTED

0+0				9.0	
T.P.	11.43	39.75	0.22	38.32	17.5
0+40	breathing grade				
			7.1	31.6	20.0
0+70			6.0	33.2	22.0
0+75			6.7	33.0	22.37
0+80			6.40	33.3	24.20
1+0	change of Grade				
	dunkle				
			6.1	33.6	24.07
			6.3	33.4	26.07
1+20			6.3	33.4	27.40
			6.1	33.6	27.44
1+50			6.1	33.6	28.73
			5.56	33.87	29.13
			5.26	33.57	30.06
			5.6	34.1	30.83
2+0			5.6	34.1	31.40
			3.1	36.6	32.52
2+25			3.1	36.6	32.74
T.P.	11.46	50.84	0.37	39.38	34.21
			10.0	40.8	34.07
2+50			6.2	44.6	35.91
			6.2	44.6	35.40
2+75			5.9	46.96	37.60
3+0			3.9	46.9	36.75
			2.9	47.9	39.29
3+25			2.9	47.9	38.07
			2.3	48.5	40.98
3+50			2.2	48.5	39.40
			1.7	49.1	43.00
3+80	M.H. Laurel				
			1.7	49.1	46.00

cut.

43

12.4					
10.2					
10.6					
9.1					
9.5					
7.2					
6.2					
4.9					
4.8					
3.3					
2.2					
4.1					
3.7					
6.6					
6.2					
3.7					
4.2					
9.3					
10.2					
5.6					
7.5					
6.1					
2.1					

  

56.33					
0.82					
57.15	H.I.				
79.6					
49.19	J.P.	39.29	10.66	J.P.	30.52
2.28	H.I.	12.18	36.67	J.P.	6.50
57.47			2.43		
43.00			39.10	H.I.	
8.47			4.21		5.22
40.98			4.89		33.88
10.49			8.27		1.66
			27.44		35.54
			17.66		11.47
			3.70		22.37
			31.84	J.P.	13.17
			0.19		
			32.03	H.I.	
			19.30		
			12.83		

Sewer line on palm from lot line  
lot. line bet. India & Columbia

Sta. &	H.T.	Rod	Ground	Grade	cut
0+00 M.H. center palm & lot line bet. India & artie.	79.69	9.85	69.84	65.00	4.8
+25		6.60	73.09	68.16	4.9
+50		8.75	75.94	71.33	4.6
+75	POSTED 89.86	8.6	81.3	74.50	6.8
+100	101.53	3.62	97.91	77.66	20.2
+25		3.2	98.3	80.82	17.5
+58 M.H. center of palm & 5' west of east		1.9	99.6	85.00	14.6
+200 center line of India		11.9	89.6	86.37	3.2
+25		12.3	89.2	87.18	2.0
+50		9.96	91.57	88.00	3.6
+80.5 M.H. lot line bet. India & Columbia		5.80	95.73	89.00	6.7

bet. India & artie to  
aug 24/11  
Childs  
Taylor  
Bunker

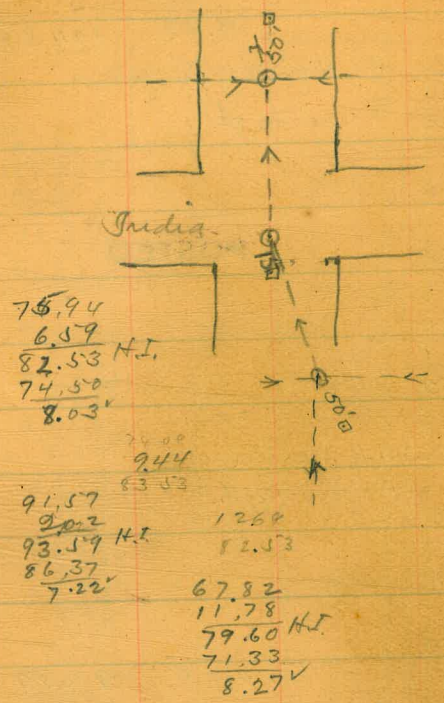

✓ Sewer line on India from  
Thom.

Sta.	J.P.	H.T.	Rod	Ground
0+00		4.93	3.0	99.91
+50			3.65	101.19
1+00			4.4	100.4
+50			5.1	99.7
2+00			5.7	99.1
+50			6.37	98.47
3+00			6.9	97.9
+50			7.9	96.9
4+00			10.0	94.8
+50			11.95	92.89
5+00			2.2	90.7
+50			4.08	88.81
6+00			5.9	87.0
+50			7.1	85.8
+80.45			7.3	85.6
7+00			7.13	83.76
+50			7.4	83.5

Quince ✓

aug. 25/11

Blills  
Taylor  
Bills

Grade	cut.		
✓97.00	4.8		
✓96.33	4.9		
✓95.67	4.7		
✓95.00	4.7		
✓94.33	4.8		
✓93.66	4.8		
✓93.00	4.9		
✓91.43	5.5		
✓89.85	5.0		
✓88.28	4.6		
✓86.70	4.0		
✓85.12	3.7		
✓83.54	3.5		
✓81.96	3.8		
✓81.00	4.6		
✓80.83	5.0		
✓80.40	5.1		

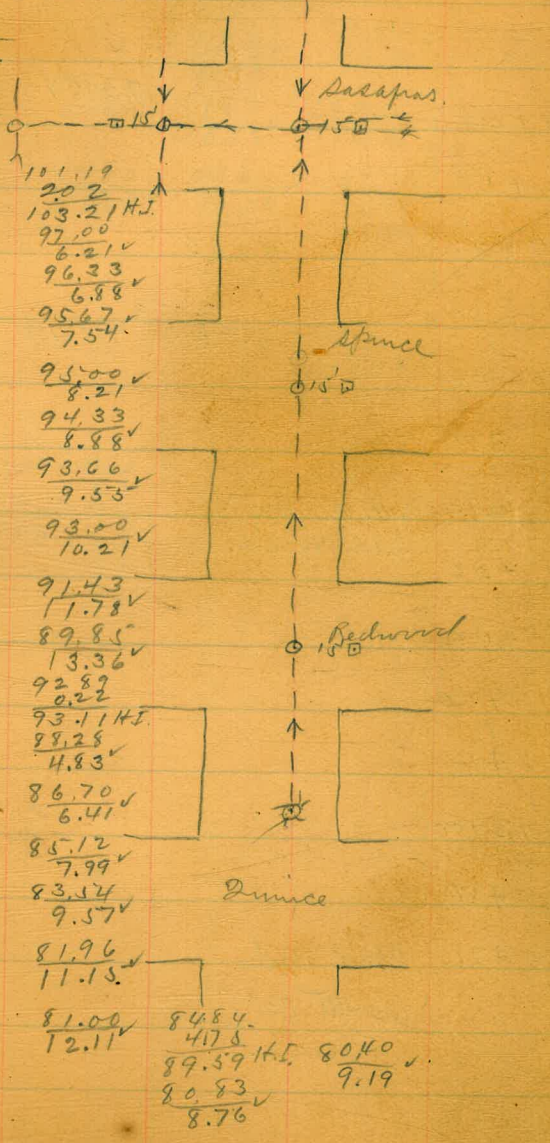

POSTED

5

Quince

8484.  
4178  
89.59 H.T. 8040 ✓  
80.83 ✓  
8.76 ✓  
9.19 ✓

Cont. from page 45

Sta.	H.I.	Red	Ground	Grade	cut
8+00	92.89	7.3	85.6	79.96	5.6
+50		7.7	85.2	79.53	5.7
9+00		7.9	85.0	79.10	5.9
+50		8.05	84.84	78.67	6.1
J.P.	6.38	91.12			
10+00		6.4	84.7	78.23	6.5
+50		6.8	84.3	77.80	6.5
+66.2	M.H. center	6.8	84.3	73.00	11.3 → west
	Sassafras.			77.70	6.6 → knittle
11+00		6.6	84.5	79.00	5.3 → No. + East
				79.43	5.1
+50		6.2	84.9	80.00	4.9
12+00		5.40	85.72	80.56	5.1
+50		4.8	86.3	81.13	5.2
13+00		4.2	86.9	81.70	5.2
+50		3.40	87.72	82.27	5.4
170	dead end	3.1	88.0	82.50	5.5
	about 32' from				
	Thom.				

Aug. 28/11

J. Shields  
Taylor #3  
Bunker

89.59 H.I.	79.53
79.96	10.06
9.63	
79.10	78.23
10.49	11.36
	77.80
	10.92
	11.79
77.70	79.43
11.89	10.16
	85.72
	5.81
	91.33 H.I.
80.56	80.00
10.97	11.53
81.13	
10.40	84.54
	3.22
	88.06 H.I.
	73.00
	15.06
	3.08
	11.98

✓✓ <sup>1</sup> Sewer line on Sassafras from  
 ✓ to lot line bet. India & Columbia

Sta.		N.I.	Rod	Ground
		70.48		
0+00	m.H. lot line bet artie & India + center of Sassafras.		9.62	60.86
+25			7.56	62.92
+50			5.4	65.1
+75		79.15	11.28	67.87
	POSTED	91.12		
1+00			9.2	81.9
+25			7.4	83.7
+50	m.H. center Sassafras + 5' west of east curb of India		6.8	84.3
2+00			5.2	85.9
+50			1.83	89.29
T.P.		5.27 94.56		
+75.15	m.H. lot line bet. India & Columbia		2.92	91.64
0+00	m.H. same as 0+00 top of page.	61.47	0.61	60.86
+50			4.63	56.84
1+00			8.98	52.49
+17	m.H. 20 1/2 east center of artie.		10.37	51.10

lot line bet. artie & India  
 aug. 25/11

Childs  
 Taylor  
 B. H. Allen

Grade	cut.		
		89.59	10.76
		81.86	30
		7.73	32.280
56.00	4.9	67.87	67.87
		3.77	1.80
		71.64	69.67 H.I.
		64.07	67.30
		7.57	2.37
			67.30
61.38	3.7	56.84	
		59.5	
		62.79	H.I.
		56.00	
		6.79	
			11.7 / 14.85 / 2.2
			11.7
			26.5
			234
			310
			234
			760
69.45	14.3	61.38	49.87
		1.41	12.92
73.00	11.3		
79.00	5.3	52.49	
		3.42	
		55.91	H.I.
		43.74	
		12.17	
81.86	4.0		
85.27	4.0		
87.00	4.6		
56.00	4.9		
49.87	7.0		
43.74	8.8		
41.65	9.5		



1 Sewer line up spruce street Canyon  
 artic + India to lot line bet. India  
 Kettner

Sta.	H.I.	Rod	Ground
0+00	<u>67.17</u>	9.56	57.61
+25		7.6	59.6
+50		5.24	61.93
+75	<u>79.10</u>	8.5	70.6
1+00	<u>91.13</u>	34.1	87.72
+25		3.0	88.1
+50		1.9	89.2
+75		2.50	88.63
J.R.	1.42	<u>80.10</u>	124.5
2+01		8.03	72.07
+50		7.48	72.62
+76.5			

M.H. lot line bet  
 artic + India 120'  
 so. of spruce.  
 India + Columbia

front lot line bet.  
 + Columbia  
 Aug. 31/11

Childs  
 Taylor  
 Bonicker

Grade cut

54.00	3.6
55.35	4.3
56.71	5.2
58.06	12.5
59.42	28.3
60.77	27.3
62.13	27.1
63.49	25.1
64.90	7.2
67.56	5.0
69.00	

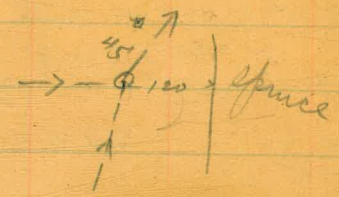

X?

✓ *Saver line on India from <sup>300120</sup> center of Chalmers.*

Sta.		H.I.	Rod	Ground
0+00	F.S. 300' So. center of upas.	2.44 88.54	0.9	86.80 87.6
+50			1.64	86.90 81.06
1+00		5.42 86.48	0.38	86.10
+50			1.1	85.4
2+00		POSTED	1.95	84.53
+50			2.7	83.8
3+00	M.H. center of upas.		3.2	83.3
+50			3.3	83.2
4+00			3.2	83.3
+50			3.49	82.99
5+00			3.5	83.0
+50			3.7	82.8
6+00			3.83	82.65
+50			4.5	82.0
+80.35	M.H. center of vine 1.971	82.97	4.8	81.7 81.06
7+00			1.3	81.7
+50			2.49	80.48

*of upas to center Sept. 7/11*

*Chields Taylor Bunker*

Grade	cut		
82.50	5.1	0+00	84.53 3.95 88.48 H.I. 82.50 5.98
81.75	5.2	3+00	81.75
81.00	5.1	0.159 center upas.	6.73 ✓
80.25	5.2		81.00 7.48 ✓
79.50	5.0	6+80.35 center vine	80.25 8.23 ✓
78.75	5.1	0.2563	79.50 8.98 ✓
78.00	5.3	0.00	78.75 9.73 ✓
76.00	7.3	0.00	76.0 12.48 ✓
75.73	7.5	0.00	75.73 12.75 ✓
75.47	7.8	0.00	75.47 13.01 ✓
75.21	7.8	0.00	82.99 74.94 ✓
74.94	8.1	0.00	87.5 86.74 H.I. 11.80 ✓
74.68	8.1	0.00	75.21 74.68 12.06 ✓
74.42	8.2	0.00	74.42 12.32 ✓
74.16	7.8	0.00	74.16 12.58 ✓
74.00	7.7	0.00	74.00 12.74 ✓
73.46	8.2	0.00	Chalmers 73.46 13.28 ✓
72.07	8.4	0.00	80.48 2.23 82.70 H.I. 72.07 10.63 ✓
		0.150	82.65 1.30 83.95 74.15 9.79 ✓



Cont. from page 49

Sta.	H.I.	Rod	Invert	Grade	Cut
8+00	82.97	4.3	78.7	70.68	8.0
+50	82.0	5.9	77.1	69.28	7.8
+60. m.H. at Glenwood		6.3	76.7	69.00	7.7
9+00		7.75	75.22	68.57	6.6
+50		9.3	73.7	68.04	5.7
10+00		10.9	72.1	67.50	4.6
+50		11.6	71.4	66.96	4.4
11+00		11.79	71.18	66.42	4.8
50. +50	3.42	74.60	71.18	65.88	4.9
12+00		3.8	70.8	65.34	4.7
+50		4.6	70.0	64.80	4.5
13+00		5.29	69.31	64.26	4.4
+50	5.70	72.99	68.7	63.72	4.4
14+00		4.9	68.1	63.18	4.3
+41.25 m.H. Center of behaviors 45' west of east end of bridge		5.49	67.50	62.74	4.6
		5.7	67.3		

(See page 80, this book.)  
G.R.H.

50

Sept. 7/11  
Behlids  
Lafayette  
Bridges

82.70 H.I.	80.48		
	1.35		
70.68	81.83 H.I.		
12.02	69.00		
	12.83		
75.22			
1.18			
76.40 H.I.	68.04	67.50	66.96
	8.36	8.90	9.44
68.57			
7.83	66.42	65.88	65.34
	9.98	10.52	11.06
64.80	64.26	63.72	63.18
11.60	12.14	12.68	13.22
			8.39
62.74			
9.37			

Willow + India N.W. Plug Carb  
BM 70.06



Survey line from upas & India

Sta.		H.T.	Red Ground	Grade	cut
0+00	M.H. Center upas	86.48	3.2	83.3	76.00
+25	7.5 West East curb of India	5	3.76	83.32	76.38

1+29.5

Survey line up Glenwood

0+00	M.H. at India	82.97	6.3	76.7	69.0
+25	+ Glenwood drive	5	6.3	76.7	69.68

2+66.9

East

Grade cut

76.00 7.3

76.38 7.0

78.00

drive

69.0 7.7

69.68 7.0

76.0

83.32  
5.04 H.T.  
88.36  
76.38  
11.98

81.83 H.T.  
69.68  
12.15

Sept. 7/11  
Schultz  
Tupper  
Bunker

India  
129.5  
Grade 78.0

Grade 76.0

Thom

Willow

Glenwood drive  
10  
256.9  
69.0  
76.0

1/5 line

CPJ Sewer line on Chalmers from  
East. I

Sta.		H.I.	Rod	Ground
0+00	M.H. center Chalmers	63.62	12.81	50.81
+50	45' east center artic.		9.86	53.76
1+00			6.9	56.7
+50	POSTED		3.57	60.05
2+00		72.99	9.47	63.52
+50			6.68	66.31
+69	M.H. center Chalmers & India		5.9	67.1
+89.5	M.H. center Chalmers & 5' west of east curb of India	76.56	3.31	69.68
3+25			4.91	71.65
+50			1.28	75.28
4+00			1.14	75.42
+07	M.H. lot line bet. India & Columbia			

5' east center artic

April 23/12

Childs  
Taylor  
Bunker

Grade	cut			
44.00	6.8	67.50		
		45.1		
47.35	6.4	72.01 H.I.	64.03	60.72
		62.00	7.98	11.29
50.69	6.0	10.01	67.50	
			2.41	
54.04	6.0	53.76	69.91 H.I.	69.68
		3.76	57.38	
57.38	6.1	57.32 H.I.	12.53	
		47.35		
60.72	5.6	10.17	6.70	
		50.69	3.35	
62.00	5.1	6.83		
62.74	4.6	54.04		
		3.48		
64.03	5.7			
64.93	6.7			
66.74	8.6			
67.00	8.4			

407.55  
29.55  
378

sewer line on California from  
 I  
 Haystack & up canyon to east.

Sta.	Washington St.	H.I.	Rod	Ground
	7.42	24.86		17.44
0+00	MMH center Thom & 25' east west line			
+55	MMH center Thom		10.4	14.5
1+00	+80 east of west line		10.76	14.10
+25			11.5	13.4
+50	POSTED		9.5	15.4
+75			9.1	15.8
2+00			9.62	15.24
+50			8.7	16.2
3+00			7.5	17.4
+50			7.74	17.12
4+00			7.1	17.8
+36.4	MMH center ripas		9.1	15.8
+50	+55 east of west line by cut.		7.9	17.0
5+00			8.3	16.6
+50			8.74	16.12
6+00			8.1	16.8
+50			7.9	17.0

Center Thom to Oct. 18/11

Lehilds  
 Taylor  
 Bunker 55

Grade	cut	14.10	5.78	20.08 H.I.	9.43	10.65	9.92	10.16	10.90	9.18	11.89	8.19	12.38	7.70	16.12	8.42	24.54 H.I.	13.36	11.18	14.34	10.20	
8.28	5.3	8.50	11.58	8.94	11.14	10.41	9.67	11.39	8.69	12.25	7.83	12.57	7.21	13.85	10.69	14.34	10.20					
8.50	6.0																					
8.94	5.2																					
9.19	4.2																					
9.43	6.0																					
9.68	6.1																					
9.92	5.3																					
10.41	5.8																					
10.90	6.5																					
11.39	5.7																					
11.89	5.9																					
12.25	3.6																					
12.38	4.6																					
12.87	3.7																					
13.36	2.7																					
13.85	3.0																					
14.34	2.7																					

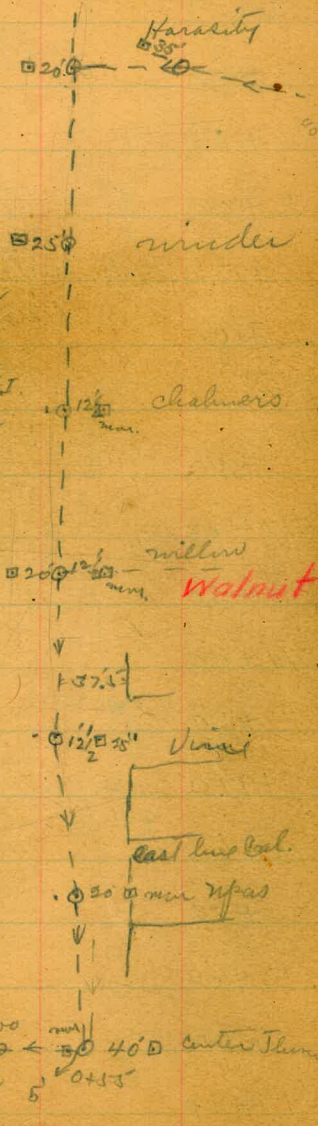

Cont. from page 55

Sta.	H.I	Rod	Ground	Grade	cut
7+00	<u>24.86</u>	6.8	18.1	✓14.84	3.3
+50		5.5	19.4	✓15.33	4.1
8+00		4.7	20.2	✓15.83	4.4
+17.35	M.H. center of Vire	3.3	21.6	✓16.00	5.6
+50	+ California	3.20	21.66	✓16.34	5.4
J.P.	10.42	<u>32.08</u>			
9+00		10.0	22.1	✓16.87	5.2
+50		10.2	21.9	✓17.40	4.5
10+00		9.9	22.2	✓17.93	4.3
+50		9.7	22.4	✓18.45	4.0
11+00		8.19	23.89	✓18.98	4.9
+50		8.2	23.9	✓19.50	4.4
+97.55	M.H. center <i>Walnut</i>	7.4	24.7	✓20.00	4.7
	+ California				
12+00				20.06	
+50		6.6	25.5	✓21.37	4.1
13+00		4.83	27.25	✓22.68	4.5
+50		4.1	28.0	✓24.00	4.0
14+00		3.8	28.3	✓25.31	3.0

Oct. 18/11  
 Blair 56  
 Taylor  
 Barber  
 Center Hooker  
 35+48.8

24.54 H.I.  
 14.84  
 9.70 ✓  
 15.83  
 8.71 ✓  
 16.34  
 8.20 ✓  
 17.40  
 7.14 ✓  
 18.45  
 6.09 ✓  
 19.50  
 5.04 ✓  
 27.25  
 6.08 ✓  
 33.33 H.I.  
 21.37 ✓  
 11.96  
 23.59  
 6.29  
 30.18 H.I.  
 20.00  
 10.18 ✓

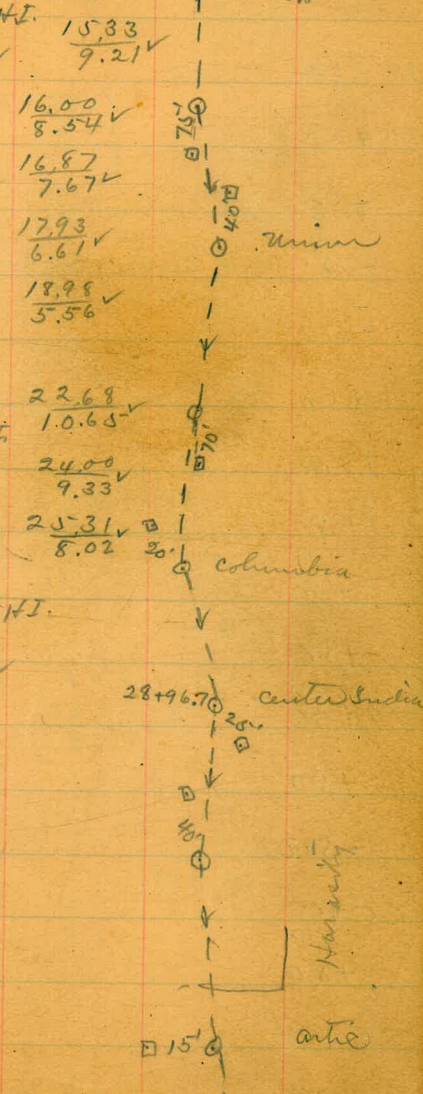



cont. from page 56

Sta.	H.I.	Rod	Ground	Grade	cut				
	32.08					33.33	H.I.	27.94	29.26
						26.63		5.39	4.07
						6.70			
14+50		1.41	30.67	26.63	4.1				
J.P.	9.00	39.67				30.00		39.02	
15+00		6.9	32.8	27.94	4.9	8.33		2.01	31.51
+50		5.39	34.28	29.26	5.0		41.03	H.I.	9.52
+78	M.H. center Chalmers	4.35	35.32	30.00	5.3		30.46		32.56
J.P.	4 bal. 12.03	47.35					10.57		8.47
16+00		11.7	35.7	30.46	5.2		33.61		46.79
+50		8.33	39.02	31.51	7.5		7.42		3.71
17+00		7.5	39.9	32.56	7.3		40.24		50.50
+50		7.4	40.0	33.61	6.4		10.26		39.45
18+00		5.06	42.29	34.66	7.6		41.03		11.05
+50		4.7	42.7	35.71	7.0		9.47		42.29
19+00		4.8	42.6	36.76	5.8		35.71		4.80
+50		4.4	43.0	37.82	5.2		11.38		47.09
+58.2	M.H. center under	4.2	43.2	38.00	5.2		34.66		36.76
20+00	4 bal.	4.52	42.83	38.66	4.1		12.43		10.38
+50		1.9	45.5	39.45	6.0				42.83
21+00		1.1	46.3	40.24	6.1				4.50
+50		0.56	46.79	41.03	5.8				47.33
									38.00
									9.33
									38.66
									8.67

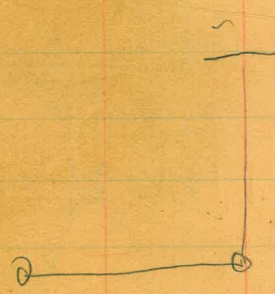

1579  
1497.55  
380.45

Oct. 19/11

Childs  
Tayler 57  
Bunker

61

one

1

1

1

1

1

1

1

1

1

1

1

1

1

1

1

1

1

1

cont. from page 57

Sta.	H.I.	Rod	Ground	Grade	cut
J.P. 22+00	12.92 59.71	12.5	47.2	41.82 <sup>v</sup>	5.4
+50		11.7	48.0	42.61 <sup>v</sup>	5.4
23+00		12.0	47.7	43.39 <sup>v</sup>	4.3
+38.5 M.H. Center <del>Unity</del> +50 + California	Andrews <sup>v</sup>	9.56	50.15	44.00 <sup>v</sup>	6.2
+50		8.31	51.40	44.33 <sup>v</sup>	7.1
24+00		7.8	51.9	45.74 <sup>v</sup>	6.2
+50		6.1	53.6	47.16 <sup>v</sup>	6.4
+81.3 M.H. lot line bet. J.P. Artic + bal. 25+00	* 65.79 9.11	3.03	56.68	48.05 <sup>v</sup>	8.7
+25		8.5	57.3	48.57 <sup>v</sup>	8.7
+50		9.7	56.1	49.28 <sup>v</sup>	6.8
+75		11.96	53.83	50.00	3.8
+75		13.5	52.3	50.71 <sup>v</sup>	1.6
26+00		11.2	54.6	51.41	3.2
+20.7 M.H. center artic	25 ft N of Pierce.	9.5	56.3	52.08 <sup>v</sup>	4.3
+50		4.96	60.83	53.27 <sup>v</sup>	7.5
+75		3.6	62.2	54.36	7.8
27+00		2.02	63.77	55.44 <sup>v</sup>	8.4

Oct. 19/11  
Childs  
Taylor 58  
Bunker

50.60 H.I.	42.61
41.82 <sup>v</sup>	7.89 <sup>v</sup>
8.68 <sup>v</sup>	
53.83	
76.3	
61.46 H.I.	50.71
49.28	10.75 <sup>v</sup>
12.18 <sup>v</sup>	
52.00 <sup>v</sup>	53.27
9.46	8.19 <sup>v</sup>
63.77	51.40
44.1	4.64 H.I.
68.18 H.I.	56.04 <sup>v</sup>
55.44 <sup>v</sup>	44.00
12.74 <sup>v</sup>	12.04 <sup>v</sup>
45.74 <sup>v</sup>	44.33 <sup>v</sup>
10.30 <sup>v</sup>	11.71 <sup>v</sup>
	47.16
	8.88 <sup>v</sup>
51.40	
5.43	47.16
56.83 H.I.	9.67
48.05 <sup>v</sup>	36
8.78	10.23
	53.83
	75.7
	61.34 H.I.
46.79	48.57 <sup>v</sup>
6.06	12.77 <sup>v</sup>
52.85 H.I.	
43.39 <sup>v</sup>	
9.46 <sup>v</sup>	

Cont. from page 58

Oct. 23/11  
 Bluffs  
 Taylor 53  
 Bunker

Sta.	H.I.	Rod	Ground	Grade	cut
27+25	65.79	2.3	63.5	56.53	7.0
+50		2.02	63.77	57.62	6.2
+60.1 m.H. cot line		2.19	63.60	58.06	5.5
+75 bet. India + antic	129.5 76.72	11.5	65.2	58.71	6.5
28+00		9.2	67.5	59.79	7.7
+25		1.42	75.30	60.88	14.4
+50		0.5	76.2	61.97	14.2
+75		7.08	69.64	63.06	6.5
+96.7 m.H. center India		6.5	70.2	64.00	6.2
+50 north Harasity		6.8	69.9	64.11	5.8
29+00		8.6	68.1	64.98	3.1
+25		9.7	67.0	65.86	1.1
+50		4.4	72.3	66.73	5.6
+75		2.91	73.81	67.61	6.2
30+00	12.67	86.48			
T.P.					
+35		11.4	75.1	68.83	6.3
+39.8 m.H. Columbia		11.2	75.3	69.00	6.3
st.		9.9	76.6	69.41	7.2

68.18 H.I.  
 57.62 ✓  
 10.56 ✓  
 69.64  
 5.97  
 75.61 H.I.  
 63.06 ✓  
 12.55 ✓  
 67.61  
 8.00 ✓  
 69.41 ✓  
 6.20 ✓

58.06  
 59.79  
 8.39 ✓  
 64.00  
 11.61 ✓  
 65.86  
 9.75 ✓  
 69.00  
 6.61 ✓

58.71  
 5.29

Cont. from page 59

Sta	H.I.	Rod	Ground
30+75	<u>86.48</u>	8.49	77.99
31+00		7.5	79.0
+25		7.6	78.9
+50		9.0	77.5
+64.8 m.H. lot line		6.5	80.0
+75 bet. Columbia <del>main</del> Linwood		8.2	78.3
32+00		6.8	79.7
+25		4.63	81.85
+50		3.5	83.0
+75		1.40	85.08
+90 m.H. center <del>main</del> <sup>Linwood</sup> <sup>125 P.H. at</sup> <sup>Marshall</sup>	<u>12.99</u>	1.00	85.48
J.P.			
33+00		12.1	86.4
+25		11.7	86.8
+50		9.50	88.97
+75		7.4	91.1
34+00		5.8	92.7
+18.6 m.H. lot line bet. <del>main</del> <sup>Horton</sup> <sup>Guy</sup>		5.3	93.2

Oct. 23/11 } <sup>leholds</sup>  
 Taylor <sup>60</sup>  
 Bunker

Grade	cut			
70.41	7.6	77.99	73.41	74.00
71.41	7.6	5.94	10.52	75.55
72.41	6.5	83.93	9.93	8.38
73.41	4.1	71.41	77.75	79.50
74.00	6.0	12.52	6.18	4.43
74.45	3.9	85.08	83.14	85.00
75.55	4.2	82.2	10.16	8.30
76.65	5.2	93.30		
77.75	5.3	81.00		
78.84	6.3	12.30		
79.50	6.0			
79.93	6.5			
81.00	5.8			
82.07	6.9			
83.14	8.0			
84.20	8.5			
85.00	8.2			

Cont. from page 60

Sta	H.I.	Rod	Ground
34+50	98.47	7.1	91.4
+75		5.92	92.55
35+00		3.1	95.4
+25		2.18	96.29
J.P. +48.8	10.33 106.62 195 N 4 Guy	10.9	95.7
+75		7.02	99.60
36+00		6.9	99.7
+25		6.5	100.1
+50		4.84	101.78
+73.8	m.H. lot line bet.	4.08	102.54
J.P. 37+00	Guy + Peterbaugh 12.68 115.22	13.0	102.2
+25		10.2	105.0
+50		10.1	105.1
+75		7.14	108.08
+99.4	m.H. Center Peterbaugh 2072 N 45 Guy	5.4	109.8
38+25		5.1	110.1
+50		3.3	111.9

Oct. 24/11

Belvidere  
May 61  
Bunker

Grade	cut		
86.21	5.2	93.30 HI 86.21 7.09	87.17 6.13
87.17	5.4	89.09 4.21	90.00 3.30
88.13	7.3	101.78 4.37 106.15 HI	96.07 10.08
89.09	7.2	93.07 13.08	97.50 8.65
90.00	5.7	98.85 7.30	101.44 4.71
91.57	8.0	104.00 2.15	105.82 0.33
93.07	6.6		
94.57	5.5		
96.07	5.7		
97.50	5.0		
98.85	3.4		
100.14	4.9		
101.44	3.7		
102.73	5.4		
104.00	5.8		
104.92	5.2		
105.82	6.1		

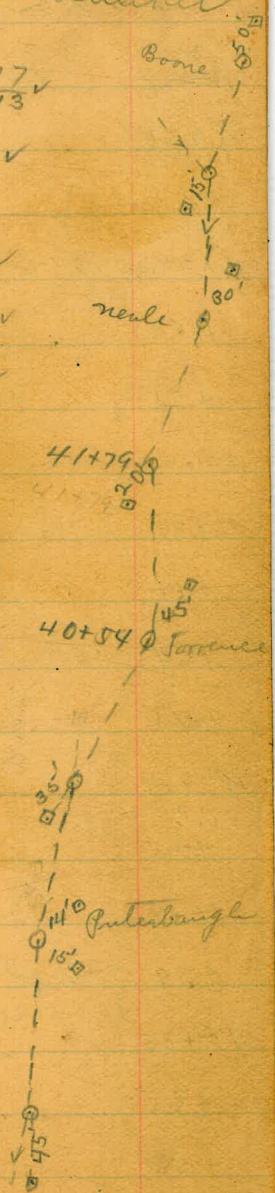



cont. from page 62

Sta.	H.I.	Rod	Ground
42+75	135.54	3.9	131.6
43+00		5.17	130.37
+07 m.H. Center of Neale.	157.9 Not Hunt	5.9	129.6
+25		8.7	126.8
+50		7.4	128.1
+75		2.71	132.83
J.P.	10.61	143.44	
44+00		8.35	135.09
+80.3 m.H. lot. line bet.	12.14	150.07	5.51
J.P. Neale + Sutter			137.93
+50		11.7	138.4
+75		12.9	137.2
45+00		13.7	136.4
+25		14.0	136.1
+50		15.0	135.1
+75		14.4	135.7
+85.9 m.H. center	Sutter	6.0	138.5
Boare		11.6	138.5
46+00		13.5	136.6
+25		6.76	143.31

Oct. 28/11 } Schields  
Taylor 63  
Blumber

Grade	cut		
123.25	8.4	134.92 H.I.	124.00 ✓
		123.83 ✓	10.92 ✓
		11.09	
123.83	6.6	125.39 ✓	126.20 ✓
		9.53	8.72
124.00	5.6	135.09	
		5.48	
		140.57 H.I.	129.15 ✓
		128.00 ✓	130.44 ✓
		12.57	11.42 ✓
124.58	2.2		10.13 ✓
125.39	2.7	136.08	132.00
		9.49 ✓	8.57 ✓
126.20	6.6	143.31	
		3.34	
		146.65 H.I.	
		133.93 ✓	
		12.72	
127.01	8.1		
128.00	9.9		
128.51	9.9		
129.15	8.1		
129.80	6.6		
130.44	5.7		
131.08	4.0		
131.72	4.0		
132.00	6.5		
132.70	3.9		
133.93	9.4		

cont. from page 63

Sta.	H.I.	Rod	Ground	Grade	cut	
46+50	150.07	2.3	147.8	135.17	12.6	146.65 HT 135.17 11.48 ✓
+75		1.15	148.92	136.40	12.5	149.31 6.51 149.86 HT 137.63 12.23 ✓
47+00		2.5	147.6	137.63	10.0	147.17 3.44 HT 150.61 HT 139.00 ✓ 11.61 ✓
+27.8	M.H. lot line bet. 10th St & NK Hawthorne	5.6	144.5	139.00	5.5	147.17 3.44 HT 150.61 HT 139.00 ✓ 11.61 ✓
+50	Boone + Truffer. J.P.	2.90	147.17	140.24	7.0	147.17 5.36 HT 152.53 140.24 ✓ 12.29 ✓
+75	12.71 162.14	0.64	149.43	141.63	5.5	147.17 5.36 HT 152.53 140.24 ✓ 12.29 ✓
48+00		15.00	147.1	141.63	5.5	147.17 5.36 HT 152.53 140.24 ✓ 12.29 ✓
+25		14.5	147.6	143.03	4.6	143.03 9.50 ✓
+50		12.71	149.43	144.42	5.0	145.81 6.72
+75		12.5	149.6	145.81	3.8	156.31 2.92 HT 159.23 149.00 ✓ 10.23 ✓
49+00		9.2	152.9	147.20	5.7	150.58 8.65 ✓
+07.2	M.H. center Truffer St Hawthorne	5.83	156.31	148.60	7.7	158.91 1.49 HT 160.40 HT 152.43 ✓ 7.97 ✓
+25		6.4	155.7	149.00	6.7	158.91 1.49 HT 160.40 HT 152.43 ✓ 7.97 ✓
+50		6.0	156.1	149.66	6.4	158.91 1.49 HT 160.40 HT 152.43 ✓ 7.97 ✓
+75		7.7	154.4	150.58	3.8	158.91 1.49 HT 160.40 HT 152.43 ✓ 7.97 ✓
50+00		6.8	155.3	151.51	3.8	158.91 1.49 HT 160.40 HT 152.43 ✓ 7.97 ✓
+25		3.23	158.91	152.43	6.5	158.91 1.49 HT 160.40 HT 152.43 ✓ 7.97 ✓
		1.6	160.5	153.35	7.2	158.91 1.49 HT 160.40 HT 152.43 ✓ 7.97 ✓

Oct. 30/11

Blill 61  
Taylor  
Bunker

Ingalls

Hooker

Sublett

Truffer

See Book 400 p. 25

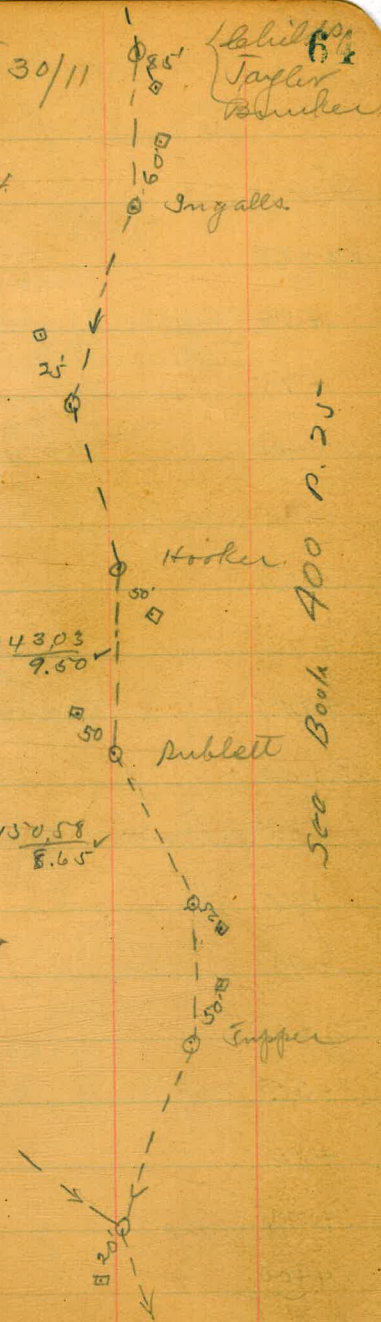



Oct. 30/11 } Leibold  
 Taylor 65  
 Brunker

cont. from page 64

Sta.	H.Z.	Rod	Ground	Grade	cut	
50+00 J.P.	162.14	1.68	160.46	154.28	6.2	$\begin{array}{r} 160.46 \\ 6.79 \\ \hline 167.25 \text{ H.I.} \\ 154.50 \\ \hline 12.75 \checkmark \end{array}$
+56 m.H. lot line bet. Truffer + Sublett	11.92 172.38	9.8	162.6	154.50	8.1	$\begin{array}{r} 171.40 \\ 13.1 \\ \hline 173.21 \text{ H.I.} \\ 160.89 \\ \hline 12.32 \checkmark \end{array}$
+75		11.2	161.2	155.16	6.0	$\begin{array}{r} 163.30 \\ 9.91 \\ \hline 164.51 \\ 8.70 \checkmark \end{array}$
51+00		11.5	160.9	156.02	4.9	$\begin{array}{r} 172.04 \\ 6.61 \\ \hline 178.65 \text{ H.I.} \\ 166.00 \\ \hline 12.65 \checkmark \end{array}$
+25	132.9	11.9	160.5	156.89	3.6	$\begin{array}{r} 166.73 \\ 11.92 \\ \hline 168.63 \\ 10.02 \checkmark \end{array}$
+50		8.72	163.66	157.75	5.9	
+75		6.4	166.0	158.62	7.4	
+85.8 m.H. Center of Sublett Pringle		7.6	164.8	159.00	5.8	
52+00		5.6	166.8	159.68	7.1	
+25		3.0	169.4	160.89	8.5	See Book 566 P. 26.
+50	145.0	0.98	171.40	162.09	9.3	
+75		1.9	170.5	163.30	7.2	
53+00 J.P.	10.99 183.03	0.34	172.04	164.51	7.5	
+30.8 m.H. center Hooker & Lark		12.3	170.7	166.00	4.7	
+50		10.4	172.6	166.73	5.9	
+75		10.2	172.8	167.68	5.1	
54+00	184.1	9.47	173.56	168.63	5.0	

Cont. from page 65

Sta.	H.I.	Rod	Ground	Grade	cut			
	<u>183.03</u>					178.65 <sup>H.I.</sup>	172.43	173.00
54+25		9.2	173.8	169.58	4.2	170.53 <sup>✓</sup>	6.22 <sup>✓</sup>	5.65 <sup>✓</sup>
+50		8.1	174.9	170.53 <sup>✓</sup>	4.4	174.87		
+75		8.01	175.02	171.48	3.5	10.80	175.74	178.01
55+00		8.16	174.87	172.43 <sup>✓</sup>	2.5	185.67 <sup>H.I.</sup>	9.93 <sup>✓</sup>	7.66
+14.9	M.H. lot line bet. S.P. Ingalls & Hooker	4.74	178.29	173.00 <sup>✓</sup>	5.3	174.60		
+25	1244	9.72	181.01	173.46	7.5	11.07 <sup>✓</sup>	185.81	178.01
+50		7.7	183.0	174.60 <sup>✓</sup>	8.4	2.03 <sup>H.I.</sup>	9.83 <sup>✓</sup>	
+75		8.5	182.2	175.74 <sup>✓</sup>	6.5	187.84	188.20	
56+00		6.9	183.8	176.88	6.9	178.74	4.67	
+25		4.92	185.81	178.01 <sup>✓</sup>	7.8	12.10 <sup>✓</sup>	192.87 <sup>H.I.</sup>	181.09
+50		3.5	187.2	179.15 <sup>✓</sup>	8.0	182.83	180.00	11.78 <sup>✓</sup>
+68.6	M.H. center Ingalls	5.91	184.82	180.00 <sup>✓</sup>	4.8	10.04 <sup>✓</sup>	12.87 <sup>✓</sup>	
57+00		2.53	188.20	181.09 <sup>✓</sup>	7.1		193.29	
+25	13.00	0.98	189.75	181.96	9.0	4.18	197.47 <sup>H.I.</sup>	
+50		11.8	191.0	182.83 <sup>✓</sup>	9.4	184.57	12.90 <sup>✓</sup>	
+75		10.6	192.2	183.70	5.6			
58+00		11.2	191.6	184.57 <sup>✓</sup>	7.0			

184.1  
52.808  
55.74.7

5741  
Oct. 31/11  
Blidds  
Tay 65  
Bunker

Oct 31/11 Childs  
 Jay 67  
 Bunker

cont. from page 66

Sta.	H.I.	Rod	Ground	Ground cut		197.47 H.I.	
58+75	202.75	9.46	193.29	195.44	7.9	186.00 ✓	
+41.1						11.47 ✓	
						187.90	190.70
						9.57 ✓	6.77
+50		11.10	191.65	186.00 ✓	5.7		
						198.13	
						5.87	193.57
+75		10.9	191.9	186.50	5.4	204.00 H.I.	10.49 ✓
						190.70	196.00 ✓
						13.30 ✓	8.00 ✓
59+00		11.8	191.0	187.90 ✓	3.1		
						208.83	197.69 ✓
+25		6.76	195.99	199.30	6.7	2.02	13.16
						210.85 H.I.	200.13
+50		5.8	197.0	190.70 ✓	6.3	208.83	10.42 ✓
						7.33	
+75		8.1	194.7	192.11	2.6	218.10 H.I.	
						203.18	205.92 ✓
						12.98 ✓	10.24 ✓
60+00		6.5	197.3	193.51 ✓	3.8		
+192		4.62	198.13	194.91	3.2		
+192		1.10	201.65	196.00 ✓	5.7		
J.P.							
+50	12.93	214.58	206.6	197.69 ✓	8.9		
+75		8.0	206.6	197.69 ✓	8.9		
+75		5.75	208.83	199.06	9.7		
61+00		4.3	210.3	200.43 ✓	9.9		
+25		3.5	211.1	201.80	9.3		
+50		4.4	210.2	203.18 ✓	7.0		
+75		2.2	212.4	204.55	7.9		
62+00		1.87	212.71	205.92 ✓	6.8		



cont. from page 67

Sta		H.I.	Red	Ground	Grade	cut
J.P.	12.91	<u>225.62</u>		212.71		
62+25			13.1	212.5	207.29	5.2
+50			10.0	215.6	208.66	6.9
+56	m.H. lot line bet. Jackdown & this		9.56	216.06	209.00	7.1
+75			8.45	217.17	210.28	6.9
63+00			7.9	217.7	211.97	5.7
+25			7.4	218.2	213.66	4.5
+75			3.81	221.81	217.03	4.8
J.P.	11.53	<u>236.76</u>	0.39	225.23		
64+00			10.08	226.68	218.72	8.0
+04.1	m.H. center this		10.56	226.20	219.00	7.2
+25			9.6	227.2	220.80	6.4
+50			8.9	227.9	222.95	5.0
+75			3.5	233.3	225.11	8.2
65+00			2.36	234.40	227.26	7.1
J.P.	12.95	<u>247.35</u>				
+20.1	m.H. angle		13.15	234.20	229.00	5.2
+50			9.8	237.6	231.04	6.6
+75			8.69	238.66	232.74	6.0
66+00			7.0	240.4	234.45	6.0

Nov. 2/11  
 Shields  
 Taylor 63  
 Bahler

216.16	H.I.	209.00
208.66	✓	7.16
7.50		
217.17		217.17
6.27		11.47
223.44	H.I.	228.64
211.97		217.17
11.47	✓	8.99
217.03		226.16
9.13	✓	213.66
226.68		12.50
7.28		219.00
233.96	H.I.	229.00
222.95		4.96
11.01	✓	
7.89		
234.40		234.45
242.29	H.I.	7.84
231.04	✓	
11.25		

cont. from page 68

Sta.	H.I.	Rod	Ground	Grade	cut
66+25	<u>247.35</u>	5.0	242.4	236.15	6.3
+50		2.7	244.7	237.86	6.8
+75		2.09	245.26	239.57	5.7
+95.9 M.H. center Hawk		-0.64	247.99	241.00	7.0

Nov. 2/11

242.29 H.I.  
237.86 ✓  
4.43

241.00 ✓  
1.29 ✓

Lehille  
J. A. Lin  
Blumberg

✓ Silver line or lot. line bet.  
 from bottom of canyon north of Harasity

Sta.	H.I.	Red	Ground
J.P. 0+00 M.H. main canyon	11.88	<u>93.73</u>	81.85
+25 just north of Harasity			
+50	<b>POSTED</b>		
+75			
J.P. 1+00	11.75	<u>104.76</u>	93.01
+25			
J.P. 1+50 - & Harasity	12.59	<u>115.89</u>	103.30
+75			
J.P. 2+00	11.45	<u>126.91</u>	115.46
+25			
+50			
3+00			
+50			
4+00 M.H. Canyon line from east.			
+50			
5+00 E willow on Winder			
J.P. +50	12.93	<u>139.56</u>	126.63

Columbia & Union Nov. 2/11

Childs  
 Taylor  
 Butler

Grade cut			
74.30	81.85	103.30	
78.25	6.12	17.2	
82.20	87.97 H.I.	105.02 H.I.	
86.15	82.20 ✓	94.05	
90.10	5.77	10.97	
94.05	91.35	115.46	
98.00	2.53	0.71	
103.50	93.88 H.I.	116.17 H.I.	
109.25	86.15 ✓	3.29	
115.46	7.73 ✓	112.88	
121.66	103.50	98.00	
126.66	12.67 ✓	14.88	
129.25	115.46		
132.41	6.20		
135.05	121.66 H.I.	109.25	
138.00	109.00 ✓	12.41	
141.00	12.66		
144.00	122.49		
147.00	0.20		
150.00	122.49 H.I.		
153.00	109.50		
156.00	12.99 ✓		
159.00	118.71		
162.00	4.17	110.50	
165.00	122.88 H.I.	12.38	
168.00	110.00 ✓		
171.00	12.88	111.00	
174.00	115.00	11.88	
177.00	7.88 ✓	119.00	
180.00		3.88	
183.00			
186.00			
189.00	122.41		
192.00	12.64		
195.00	135.05 H.I.		
198.00	123.00		
201.00	12.05 ✓		

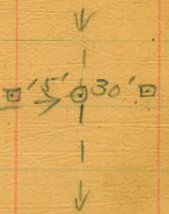

cont. from page 70

Sta	H.I.	Rod	Ground
6+00	<u>139.56</u>	8.63	130.93
+50 J.P.	10.14	4.71	134.85
7+00	<u>144.99</u>	3.8	141.2
F.T. near pueblo line So. Grande			

Grade cut

127.00 ✓	3.9
131.00 ✓	3.9
135.00	6.2

Nov. 2/11

Chick  
Taylor  
Bunker

135.05 H.I.	131.00	135.00
127.00 ✓	4.05 ✓	0.05
8.05 ✓		
134.85		
7.51 H.I.		
142.36		
135.00 ✓		
7.36		

7.00  
5.00

2.00  
25

175

I  
 lower line of canyon from  
 to Trupper up trupper to pringle

Sta.		H.I.	Rod	Ground
J.P.	10.56	<u>157.73</u>	13.3	147.17
0+00			13.3	144.5
+25			9.3	148.4
			3.86	153.87
+50			0.43	157.30
J.P.	12.85	<u>170.15</u>	8.23	161.92
+75			2.52	167.65
1+00			1.66	168.49
+25			1.80	168.33
+50	13.33	<u>181.68</u>	7.65	174.03
J.P.			0.57	181.17
+75	12.81	<u>193.98</u>	11.2	182.8
J.P.			5.32	188.66
+99			0.86	193.12
2+00	13.04	<u>206.16</u>	6.28	199.88
J.P.			0.00	206.16
+25	12.82	<u>218.98</u>	11.04	207.71
J.P.			3.62	215.36
+50			0.31	215.67
+75	12.95	<u>231.62</u>	6.78	224.84
J.P.			0.66	230.76
3+00	12.40	<u>243.36</u>	10.63	232.73
J.P.			2.28	241.08
+25			0.17	243.19
+50	13.00	<u>256.19</u>	7.58	248.61

POSTED

with center of  
 Trupper

Sta. 47+27.8 on main line  
 + on pringle  
 no. 3/11

Grade cut		H.I.	
150.61		167.63	
147.38		0.34	
139.30	0.2	167.97 H.I.	207.94
		3.23	0.92
		158.46	208.86 H.I.
143.34	5.1	12.57	209.00
		4.60	
147.38	6.5	172.95 H.I.	174.02
		7.05	8.86
		163.54	181.08 H.I.
		9.41	224.84
		170.00	0.10
151.42	10.5	11.08	224.94 H.I.
		199.88	216.00
		0.30	8.94
		200.18 H.I.	
155.46	12.1	187.50	242.00 H.I.
		12.68	232.00
			10.00
159.50	9.0		
163.54	4.8		
167.58	6.4		
170.00	12.8		
175.00	13.7		
187.50	12.4		
200.00	7.9		
208.00	7.4		
216.00	8.8		
224.00	8.7		
232.00	9.1		
240.00	8.6		

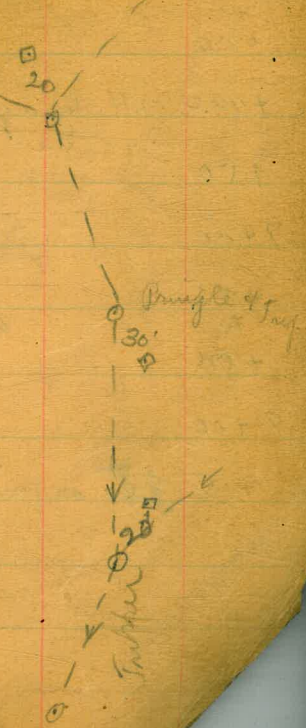



cont. from page 72

Sta		H.I.	Rod	Ground
		256.19		
4+00			2.14	254.05
J.R.	8.82	262.87		
+25			5.7	257.2
+50			4.13	258.74
+73.2	M.H. Jupper &		3.5	259.4
5+00	Pringle		6.1	256.8
+50	b		6.8	256.1
6+00			5.83	257.04
+42.2	M.H. Pringle &		4.66	258.21
+50	Portata		4.6	258.3
7+00			4.2	258.7
+25			2.5	260.35
J.R.	6.58	266.93		
+50			6.0	260.9
8+00			3.25	263.68
+15	J.T. or Pringle		2.8	264.1

Nov. 3/11  
 J. L. ...  
 J. L. ...  
 B. ...

Grade cut

248.00	6.1
249.36	7.8
250.73	8.0
252.00	7.4
252.52	4.5
252.91	3.2
253.50	3.5
254.00	4.2
254.23	4.1
255.68	3.0
256.40	4.0
257.12	3.8
258.57	5.1
259.00	5.1

254.05		
6.65		
260.70	H.I.	
248.00		250.73
12.70		9.97
252.00		257.04
8.70		5.81
252.91		262.85
9.94		10.53
253.50		254.00
9.35		8.80
254.23		255.68
8.62		7.17
266.16	H.I.	257.12
259.00		5.73
7.16		







cont. from page 76

Nov. 6/11  
 Shields  
 Taylor  
 Bunker

Sta	Sta.	H.I.	Rod	Ground	Grade	cut	
		279.72					278.52 H.I.
33	13+00		4.4	275.3	270.18 ✓	5.1	270.18 ✓ 271.00 ✓ 8.64 ✓ 7.82
	+ 750						
	5.0		3.73	275.99	270.73 ✓	5.3	270.73 ✓ 8.09
34	+75	E.S. about 25' So. of Lewis		3.3	276.4	271.00 ✓	5.4
	+ 7						
	+ 7						
	+ 8						
	+ 9						
35							
	+ 7						
	+ 7						
	+ 8						
	+ 9						
36							
	+ 7						
	+ 7						
	+ 8						
	+ 9						
37							
	+ 13.5						
	+ 2.5						

271.00 dev F.T.  
 270.00  
 268.00  
 269.00  
 276.90  
 270.00  
 6.90  
 4.00  
 2.90

277.05  
 275.87  
 5.50  
 281.37 H.I.  
 6.74  
 274.63  
 2.77  
 276.90 H.I.  
 9.62  
 272.30  
 276.90  
 270.00

281.37  
 276.00  
 10.37

✓<sup>1</sup> Sewer line on Ingalls from  
Douglas to Lewis.

main canyon rd. of Nov. 5/11

Childs  
Taylor 73  
Bunker

Sta.	H.I.	Rod	Ground	Grade	cut		
55	12.99	198.80	185.81		✓	192.87 H.I.	
3 0+00	M.H. Sta. 56+68.6		14.0	184.8	180.00	4.8	199.79
							156.22 ✓
							6.65 ✓
+25			6.63	192.17	186.22	6.0	0.59 H.I.
J.P.	12.72	211.37	0.15	198.65			200.38 H.I.
3 +50			11.58	199.79	192.45	7.3	192.45 ✓
							17.93 ✓
							204.90 H.I.
							204.90
							12.09 ✓
							223.41
							5.54
+75			3.78	207.59	198.67	8.9	228.96 H.I.
J.P.	12.46	223.16	0.67	210.70			141
1+00			7.39	215.77	204.90	10.9	237.87 H.I.
J.P.	12.93	235.33	0.76	222.40			229.80
+25			11.92	223.41	211.12	12.3	11.60 ✓
							250.35
							8.61 H.I.
							253.96 H.I.
							245.15
							8.81 ✓
							241.00
							12.96 ✓
							250.35
							74.7 H.I.
							248.23
							9.59 ✓
							257.82 H.I.
							249.77
							256.90
							6.84
							246.69
							11.13 ✓
							256.74 H.I.
							263.74
							251.31 ✓
							12.43
							241.0 ✓
							59.1
							245.0 ✓
							5.1
							252.85
							10.89 ✓
							256.90
							6.84
							246.69 ✓
							5.3
							248.23 ✓
							5.4
							241.0 ✓
							59.1
							245.0 ✓
							5.1
							252.85
							10.89 ✓
							256.90
							6.84
							246.69 ✓
							5.3
							248.23 ✓
							5.4
							241.0 ✓
							59.1
							245.0 ✓
							5.1
							252.85
							10.89 ✓
							256.90
							6.84
							246.69 ✓
							5.3
							248.23 ✓
							5.4
							241.0 ✓
							59.1
							245.0 ✓
							5.1
							252.85
							10.89 ✓
							256.90
							6.84
							246.69 ✓
							5.3
							248.23 ✓
							5.4
							241.0 ✓
							59.1
							245.0 ✓
							5.1
							252.85
							10.89 ✓
							256.90
							6.84
							246.69 ✓
							5.3
							248.23 ✓
							5.4
							241.0 ✓
							59.1
							245.0 ✓
							5.1
							252.85
							10.89 ✓
							256.90
							6.84
							246.69 ✓
							5.3
							248.23 ✓
							5.4
							241.0 ✓
							59.1
							245.0 ✓
							5.1
							252.85
							10.89 ✓
							256.90
							6.84
							246.69 ✓
							5.3
							248.23 ✓
							5.4
							241.0 ✓
							59.1
							245.0 ✓
							5.1
							252.85
							10.89 ✓
							256.90
							6.84
							246.69 ✓
							5.3
							248.23 ✓
							5.4
							241.0 ✓
							59.1
							245.0 ✓
							5.1
							252.85
							10.89 ✓
							256.90
							6.84
							246.69 ✓
							5.3
							248.23 ✓
							5.4
							241.0 ✓
							59.1
							245.0 ✓
							5.1
							252.85
							10.89 ✓
							256.90
							6.84
							246.69 ✓
							5.3
							248.23 ✓
							5.4
							241.0 ✓
							59.1
							245.0 ✓
							5.1
							252.85
							10.89 ✓
							256.90
							6.84
							246.69 ✓
							5.3
							248.23 ✓
							5.4
							241.0 ✓
							59.1
							245.0 ✓
							5.1
							252.85
							10.89 ✓
							256.90
							6.84
							246.69 ✓
							5.3
							248.23 ✓
							5.4
							241.0 ✓
							59.1
							245.0 ✓
							5.1
							252.85
							10.89 ✓
							256.90
							6.84
							246.69 ✓
							5.3
							248.23 ✓
							5.4
							241.0 ✓
							59.1
							245.0 ✓
							5.1
							252.85
							10.89 ✓
							256.90
							6.84
							246.69 ✓
							5.3
							248.23 ✓
							5.4
							241.0 ✓
							59.1
							245.0 ✓
							5.1
							252.85
							10.89 ✓
							256.90
							6.84
							246.69 ✓
							5.3
							248.23 ✓
							5.4
							241.0 ✓
							59.1
							245.0 ✓

cont. from page 78

Sta.	H.I.	Rod	Ground	Grade	cut
5+50	268.71	9.01	259.70	254.38	5.3
+69.8		8.6	260.1	255.00	5.1
6+00		7.6	261.1	256.11	5.0
+50		4.1	264.6	257.97	6.6
7+00		0.70	267.96	259.82	8.2
5.P. +50	10.51 278.47	7.5	271.0	261.68	9.3
8+00		6.1	272.4	263.53	8.9
+50		5.68	272.79	265.34	7.4
9+00		5.3	273.2	267.25	6.0
+20		5.0	273.5	269.00	5.5
+50		5.1	273.4	268.22	5.2
10+00		4.74	273.73	268.58	5.1
+50		4.3	274.2	268.94	5.3
11+00		3.8	274.7	269.30	5.4
3 +50		3.38	275.09	269.67	5.4
+ 95.8		3.0	275.5	270.00	5.5

257  
27570 0.00

Nov. 8/11 } Blair  
Taylor  
Banker

263.74 H.I.	2550
254.38	8.74
9.36	
257.97	256.11
5.77	7.63
267.96	
4.49	
272.45 H.I.	261.68
259.82	10.77
12.63	
272.79	
4.79	
277.58 H.I.	
276.79	267.25
263.53	10.33
13.26	
268.00	272.79
9.58	4.51
	268.22
	9.38
	268.58
	9.02
272.79	
4.70	
277.49 H.I.	278.73
265.39	5.34
12.10	279.32 H.I.
	268.94
	10.38
269.30	
10.02	
269.67	270.00
9.65	9.32

Note: This sewer extended north  
150.0' on .05% grade 7-21-19.

Levels at India & Walnut for Experimental Sewerage  
Plant - Block 155 Middletown.

Hayler & Haelsig  
8/14/34

80

Sta	7.68	77.68	70.00	Curb at N.W. Cor. India and Walnut Streets.
33			8.23	69.45 Flow line of sewer M.H.-Glenwood & India (69.00)
+			12.14	65.54 " " Cleanout E. side of India at Walnut (65.50)
34			7.60	70.08 Rim of cleanout W. " " " " "
+			14.08	63.60 Flow line " W. " " " " (63.00)
+			9.90	67.78 Rim of Manhole Chalmers and India.
+8			14.63	63.05 Flow line " " " " (62.74)

Note: See also Field Book #810, page 50.  
G.R.H.

35+  
+  
+  
36+  
5.8  
+  
+  
+7  
37+  
+13.  
+25





