

824

FB 824

410



180

180

3158
190.7
506.5
490.1
16.4

824

~~598.5~~
~~505.8~~
287

3158
3

MICROFILMED
DEC 15 1964

15840
2640
4200
8400
12600
16800
21000
25200
29400
33600
37800
42000
46200
50400
54600
58800
63000
67200
71400
75600
79800
84000
88200
92400
96600
100800

3350
025
6750
6700
3750

183.5 center down
about 190.6

198.0 center Eagle

drop: 253.0 center alley bed
248.5

254.0 about center Lewis
257

69.40 62.60 lower

2.31
71.71 H.
3.11
68.60 walk

0.50
1445
442
3.11
1.31

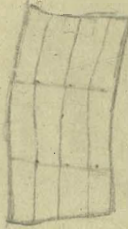

1
1
x = check for card index.

✓ 2 ✓
 sewer line on jackdaws
 Getti

Sta.		H.I.	Rod.	Ground
J.P.	11.57	220.40		208.83
0+00	M.H. bottom of Canyon at Douglas Stn.		18.75	201.65
+25	60 ft 19.2		12.05	208.35
+50			5.33	215.07
J.P.	12.33	232.69	0.04	220.36
+75			10.4	222.3
1+00			3.28	229.41
J.P.	12.47	244.83	0.33	232.36
+25			9.7	235.1
+50			3.26	241.57
J.P.	12.21	256.73	0.31	244.32
+75			8.76	247.97
2+00	M.H.		3.0	253.7
+50			1.1	255.6
3+00			0.55	256.18
J.P.	12.00	268.18		
+50			11.0	257.2
4+00			9.5	258.7
+50			7.32	260.86
5+00			5.3	262.9
+50			3.2	265.0

from Douglas to 2 J.P. 11/11
 POSTED
 215.07
 3.28
 218.35 H.I.
 208.50
 9.85 ✓

Grade cut		H.I.	
210.85		H.I.	215.07
202.25			3.28
8.60 ✓			218.35 H.I.
196.00	5.6		208.50
202.25	6.1	229.41	9.85 ✓
208.50	6.6	224	
214.75	7.6	231.65 H.I.	241.57
221.00	8.4	221.00	1.23
227.25	7.9	10.65	242.80 H.I.
233.50	8.1	247.97	233.50
239.75	8.2	8.70	9.30
246.00	7.7	258.67 H.I.	256.18
247.17	8.4	246.00	4.01
248.34	7.9	10.67	260.19 H.I.
249.51	7.7	249.51	247.17
250.69	8.0	10.68	13.02
251.86	9.0	260.86	248.84
253.04	9.9	8.84	11.85
254.21	10.8	264.70 H.I.	250.69
		251.86	9.50
		12.84	
		253.04	
		11.66	
		260.86	
		6.56	
		267.42 H.I.	
		254.21	
		13.21	

Nov. 14/11

Childs
Taylor 3
Bunker 3

Cont. from page 2

Sta.		H.I.	Rod	Ground	Grade	cut		
6+00		268.18	0.91	267.27	255.39	17.9	267.27	267.27
JP							2.12	1.00
+50	7.80	275.07	5.6	269.5	256.56	12.9	269.39	268.27 H.I.
							256.56	251.89
							12.83	12.88
7+00			4.15	270.92	257.74	13.2	267.27	
							390	
							271.17 H.I.	
							257.87	
							13.30	
+05.5	M.H. Center of Setts		3.97	271.10	257.87	13.2		

24

Sewer line on Getti from alley bet. Jackdaw & Ingalls

Nov. 14/11
 Lechilds
 Taylor
 Brunker

4

Sta	H.I.	Rod	Ground	Grade	cut
0+00	275.07	3.78	271.29	258.40	12.9
+50		3.60	271.47	258.20	13.3
1+00		3.4	271.7	258.00	13.7
+32.5		3.97	271.10	257.87	13.2
+50		4.5	270.6	265.13	5.5
2+00		4.54	270.53	265.50	5.0
+50		3.9	271.2	265.88	5.3
+65		3.49	271.58	266.00	5.6

270.53		
4.63		
275.16	H.I.	265.80
265.13		9.66
10.03		
270.53		265.88
5.85		9.28
276.38	H.I.	266.00
265.88		9.16
10.50		
266.00		
10.39		
271.47		
57.2		
277.19	H.I.	5.32
5.52		272.02
271.67		258.40
258.20		13.97
13.97		73.62

POSTED

✓
 alley line bet Jackdaws &
 center Gethi to 25' 20.0'

Ingallo from Nov. 17/11
 Broadway
 Childs
 Taylor
 Bunker 5

Sta.		H.I.	Red	Ground	Grade	cut		
		275.07					272.93	266.77
0+00	M.H. center of Gethi		3.49	271.58	266.00	5.6	3.42 - H.I. 276.33 - H.I. 266.38 9.97	9.58
+50	J.P.		2.14	272.93	266.38	6.5	274.83	273.74
	J.P.	7.32	280.25				4.20 279.03 H.I.	
1+00			7.5	272.8	266.77	6.0	268.60 10.43	268.81 10.72
+50			6.8	273.5	267.15	6.4	268.69 10.34	267.92 11.11
2+00	POSTED		5.51	274.74	267.54	7.2	268.69 10.34	275.90 5.58 281.53 H.I.
+50			5.5	274.8	267.92	6.9	269.46 12.07	269.08 12.45
3+00	5		5.42	274.83	268.31	6.5	269.85 11.68	270.23 11.30
+38.3	M.H. center of Lewis		5.9	274.4	268.60	5.8	270.61 10.92	271.00 10.53
+50			6.1	274.2	268.69	5.5		
4+00			4.30	275.95	269.08	6.9		
+50			3.2	277.1	269.46	7.6		
5+00			2.6	277.7	269.85	7.9		
+50			2.5	277.8	270.23	7.6		
6+00			2.70	277.55	270.61	7.0		
+50	F.S. about 25' No. of Broadway		4.9	275.4	271.00	4.4		

NI ✓

Sewer in alley bet. 9th St. & center of Bethu to about 25'

Jackdaws from No. of Broadway.

Nov. 17/11

Childs Taylor & Brunker

Sta.		H.I.	Rod	Ground	Grade	cut					
J.P.		1.57	275.29	273.72			277.19 H.I.				
0+00	M.H. center of		4.03	271.26	258.40	12.9	4.72	4.31	3.84	4.20	
+50	Bethu + alley bet. 9 th St. & Jackdaws.		2.99	272.34	258.60	13.7	272.47	272.88	273.35	272.79	
							258.60	258.80	259.00	259.20	
							13.87	14.08	14.38	13.79	
1+00			3.2	272.1	258.80	13.3	4.41	6.06	270.07	4.87	
							272.78	271.53	5.21	4.72	
+50	POSTED		2.7	272.6	259.00	13.6	259.40	259.60	275.28	270.41	
							13.33	11.53	5.84	260.50	
									269.44	10.41	
2+00			2.47	272.82	259.20	13.6			259.86	5.72	
								3.75	9.58	270.6	
+50			2.8	272.5	259.40	13.1	271.33	260.40	5.42	260.20	
							11.13		269.86	9.96	
									10.11		
3+00			4.43	270.86	259.60	11.3	271.45				
							4.80		5.36	5.91	
+38.3	M.H. center of Lewis		5.6	269.7	259.75	10.0	276.25 H.I.	4.88	270.89	270.34	
							4.84		271.37	261.00	
+50			6.0	269.3	259.80	9.5	271.71	260.80	7.89	9.14	
							260.60	10.67			
							11.11				
4+00			4.9	270.4	260.00	10.4					
+50			5.22	270.07	260.20	9.9					
5+00			4.0	271.3	260.40	10.9					
+50			3.6	271.7	260.60	11.1					
6+00			3.84	271.45	260.80	10.6					
+50			4.5	270.8	261.00	9.8					
7+00.9	M.H. center of Broadway.	275.28	5.1	270.2	261.20	9.0					

20'

9

POSTED

5

H.I.

✓ TH
 & Server line on Ibis from Canyon rd. of Washington - Behlids
 to 25' so. of Lewis. Mr. 18/11 Taylor Bunker

Sta.		H.I.	Rod	Ground	Grade	cut	
J.P.	12.21	238.89		226.68			242.78
0+00	M.H. Main camp		12.7	226.2	219.00	7.2	244.00 H.I. 259.26
+25	So. of Washington		4.38	234.37	226.45	8.1	232.91 266 H.I.
J.P.	12.53	250.59	0.83	238.06			10.09 261.92 H.I.
+50			7.81	242.78	233.91	8.9	256.00 13.11
J.P.	12.99	263.13	0.45	250.14			5.92 256.44
+75			10.23	252.90	241.36	11.5	261.34 5.48
1+00.			3.87	259.26	248.81	10.5	8.26 H.I. 258.15
+24.1	M.H. Center of Washington		3.4	259.7	256.00	3.7	269.60 11.45
+50			1.79	261.34	256.44	4.9	257.29 269.32
J.P.	13.02	274.36					12.31 269.32
2+00			7.9	266.5	257.29	9.2	289.82 378 H.I.
+50	POSTED		5.9	268.5	258.15	10.4	284 272.16 H.I. 273.10 H.I.
3+00			5.04	269.32	259.00	10.3	259.00 259.00 260.21
+50			4.5	269.9	259.86	10.0	13.16 259.86 11.45
4+00			4.8	269.6	260.71	8.9	261.57 270.66
+50			3.70	270.66	261.57	9.1	10.59 396 H.I. 262.14
+74.4	M.H. Center of Gethi H. Station		3.7	270.7	262.00	8.7	274.62 H.I. 262.14
5+00			3.7	270.7	262.14	8.6	262.00 12.62 12.48
+50			3.5	270.9	262.41	8.5	262.41 12.21

Nov. 20/11
 Schields
 Taylor
 Brinker

cont. from page 7

Sta.	H.I.	Rod	Ground	Grade	cut	
6+00	274.36	3.54	270.82	262.68 ^v	8.1	$\begin{array}{r} 274.62 \text{ H.I. } 262.95 \\ 262.68 \checkmark \\ \hline 11.94 \\ 263.22 \checkmark \end{array}$
+50		3.0	271.4	262.95 ^v	8.5	$\begin{array}{r} 263.50 \checkmark \\ \hline 11.52 \\ 263.22 \checkmark \\ \hline 11.40 \end{array}$
7+00		3.49	270.87	263.22 ^v	7.7	
+50	F.I. about 25' So. of Lewis	4.8	269.6	263.50 ^v	6.1	

150
 330
 215
 6

✓ Hawk street line from bottom
 of Washington to 25' po. of Lewis

of Canyon Co. Nov. 21/11
 Builds Taylor
 Blumberg

Sta.	H.T.	Rod	Ground	Grade	cut		
0+00	m.H. Sta. 66+95	261.03	13.04	247.99	241.00	7.0	249.52
+25	on main line		11.51	249.52	244.53	5.0	252.70
+50	J.P.	11.11	0.92	260.11	248.07	12.0	244.53
+75			10.4	260.8	251.60	9.2	254.00
+92	m.H. center of Washington		9.4	261.8	254.00	7.8	260.11
1+00			9.3	261.9	254.17	7.7	254.00
+35			8.55	262.65	254.90	7.7	254.00
+80			7.8	263.4	255.83	7.6	254.00
2+50			6.1	265.1	257.27	7.8	254.00
3+00			4.95	266.27	258.30	8.0	254.00
+50			3.8	267.4	259.33	8.1	254.00
4+00			2.8	268.4	260.37	8.0	254.00
+50			2.25	268.97	261.40	7.6	254.00
+55	m.H. Center of better		2.2	269.0	261.50	7.5	254.00
5+00			2.0	269.2	261.74	7.5	254.00
+25	Spike		1.9	269.3	261.88	7.4	254.00
+75			2.3	268.9	262.05	6.9	254.00

POSTED

255
363

260.11
 4.14
 264.25 H.T.
 251.60
 12.65
 260.11
 6.84
 266.95 H.T.
 254.90
 12.05
 12.95
 255.83
 11.12
 266.27
 5.02 H.T.
 271.29
 259.33
 11.96
 261.88
 9.41
 257.27
 9.68
 260.37
 10.92
 261.50
 9.79
 261.74
 9.55
 485
 92
 363
 92
 375
 546

Cut from page 9

Sta.	H.I.	Rod	Ground	Grade	Cut
6+00	271.22	2.5	268.7	262.28 ^v	6.4
+50		2.6	268.6	262.55 ^v	6.1
7+00		2.86	268.36	262.83 ^v	5.6
+31	F.I. about 25' Rd. Lewis	3.1	268.1	263.00 ^v	5.1

48

Nov. 2/11

Schields
Taylor
Bunker

269.36	
483	H.I. 262.28
273.19	10.91 ^v
262.05	262.55 ^v
11.14	10.64 ^v
262.83	263.00 ^v
10.36	10.19

Swerved on Harv. R. from
line to Pueblo line S. of

Sta. 66+95.9 on main
Douglas.

Sta.	Ht. Red Ground	Grade cut
0+00	M.H. Sta. 66+95.9 on main line	241.00
+25		
+50		
+70		254.00
1+00	POSTED	
+50		
2+00		
+50	M.H. center of Douglas.	258.00
3+00	↳	
+50		
4+00		
+50		
+69	P.I. near Pueblo line	261.00

✓ Sewer line on California Hills from center Harasity north

Sta		H.I.	Roof	Ground
	0.18	63.61	63.43	
0+00	M.H. center Calif + Harasity		13.6	50.0
+50			14.8	48.8
1+05	POSTED		12.80	50.81
+50			12.2	51.4
2+00			11.3	52.3
+180	M.H. center Calif + 15' east center of Moore.		10.5	53.1
+50			9.98	53.63
3+00			8.7	54.9
+50			7.8	55.8
4+00			6.99	56.62
+50			6.4	57.2
5+00			5.4	58.2
+07.55	M.H. lot line bet. Moore + Jafollawre.		4.55	59.06
+50			3.94	59.67
6+00			2.6	61.0
+50			1.4	62.2

up canyon to mission
to lot line bet. Cal. + Harasity

Grade	cut
44.20	6.0
44.93	3.9
45.95	4.9
46.78	4.6
47.71	4.6
48.05	5.1
48.59	5.0
49.45	5.5
50.30	5.5
51.16	5.4
52.01	5.2
52.87	5.3
53.00	6.1
53.74	6.0
54.62	6.4
55.49	6.7

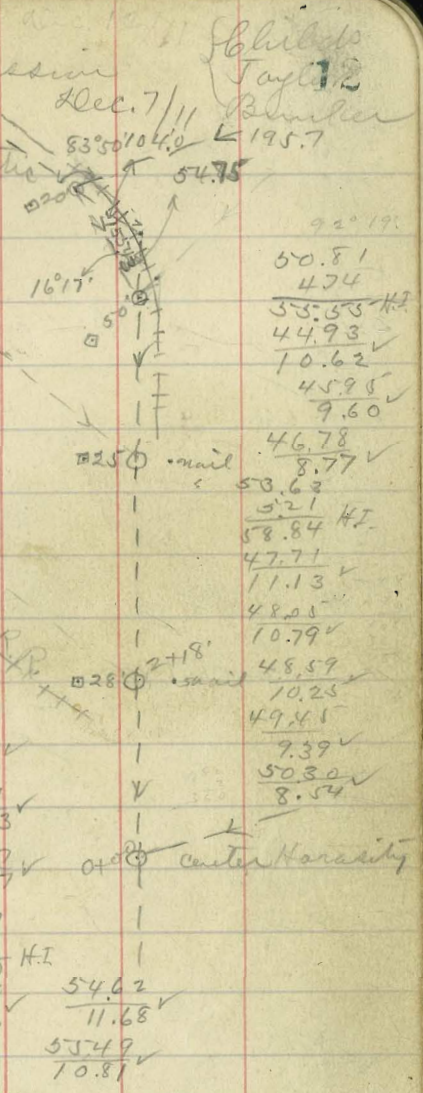

See F.B.
No. 481, p. 44

See Book 481 for details

Dec. 12/11

Blair's
Taylor
Bunker

cont. from page 12

Sta.	Sta.	H.I.	Rod	Level	Grade	cut
0	7+00 J.P. +50	63.61 4.84 68.39	0.06	63.55	56.37	7.2
			4.06	64.33	57.24	7.1
1	+80 J.P. 8+00 Lafolla av.	16 ⁰⁹ ✓ 77.52	3.68	64.71	57.77	6.9
			12.8	64.7	58.12	6.6
2	+150 9+00		12.7	64.8	58.99	5.8
			12.2	65.3	59.87	5.4
	+35.43 m.H. center Lafolla ave. just no. of bal.	83 ⁵⁰ R	11.6	65.9	60.50	5.4
3	+50 +75		11.70	65.82	61.13	4.7
			10.5	67.0	62.22	4.8
4	10+00 +25		9.5	68.0	63.30	4.7
			9.0	68.5	64.39	4.1
5	+50 +75		8.0	69.5	65.47	4.0
			6.25	71.27	66.56	4.7
6	+11+00 +31.13 m.H. lot line bet bal. & arch		4.7	72.8	67.65	5.2
			2.58	74.94	69.00	5.9

64.83		
533 H.I.	57.24	
69.66	72.42	
56.37	57.77	
13.29	11.89	
58.12	58.99	59.87
11.54	10.67	9.79
60.50	61.13	65.82
9.16	8.53	10.02
		75.84 H.I.
65.47	63.30	
10.37	12.54	
67.65	69.00	
8.19	6.84	

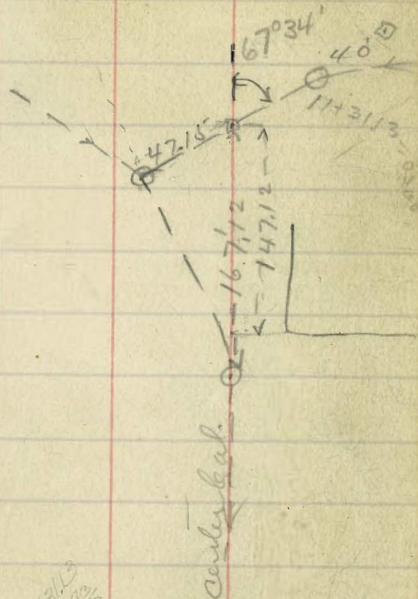

113/12
2502
18570

✓
Seiver line of mission

lot line bet. Cal. & artie to

Sta.	H.J.	Rod	Ground	Grade	cut
	77.71				
0+00 m.H. lot line		2.77	74.94	69.00	5.9
+25 - bet Cal & artie.		0.86	76.85	70.06	6.8
J.P.	7.24	84.09			
+50		5.5	78.6	71.13	7.5
+75	POSTED	6.1	78.0	72.20	5.8
1+00		6.9	77.2	73.27	3.9
+25		3.96	80.13	74.34	5.8
+40.6 m.H. center of artie	4.22	86.09	81.87	75.00	6.9
+50		4.1	82.0	75.41	6.6
+75		7.8	78.3	76.50	1.8
2+00		5.7	80.4	77.60	2.8
+25		4.29	81.80	78.69	3.1
+50		1.69	84.40	79.78	4.6
+54.92 m.H. center of columbian	2.34	97.13	84.69	80.00	4.7
+75		10.9	86.2	80.80	5.4
3+00		10.0	87.1	81.80	5.3
+25		10.5	86.6	82.79	3.8

Hills Canyon from Dec. 13/11

Randolph

Grade	cut
75.84 H.I.	
71.13	
4.71	
70.06	
5.78	✓
72.20	✓
3.64	
73.27	✓
2.57	✓
80.13	
7.70	
87.83 H.I.	
75.00	✓
12.83	
76.50	✓
11.33	
78.69	✓
9.14	
80.00	✓
7.83	
5.77	
94.24 H.I.	
81.80	
12.44	✓

Childs Taylor Buntz

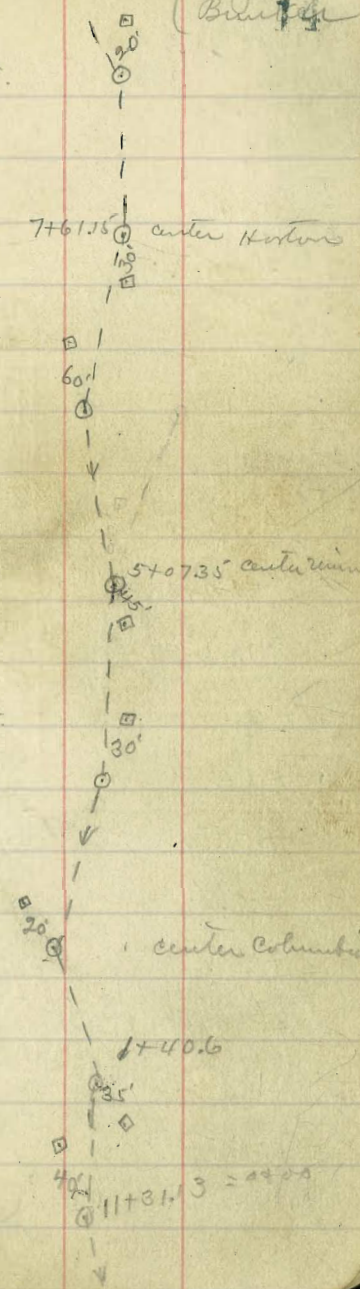

Dec. 13/11

Childs
Taylor
Brinker 15

cont. from page 14

Sta.	H.I.	Rod	Ground	Grade	cut
3+50	97.13	8.66	88.47	83.78	4.7
+80.75		6.4	90.7	85.00	5.7
4+00		5.08	92.05	86.06	6.0
+25		3.5	93.6	87.44	6.2
+50	10.48 102.71	4.90	92.23	88.82	3.4
+75		4.6	98.1	90.20	7.9
5+00		3.23	99.48	91.59	7.9
5+07.35	11.08 111.37	2.42	100.29	92.00	8.3
+25		14.0	97.4	93.24	4.2
+50		9.51	101.9	95.00	6.9
+75		7.7	103.7	96.75	7.0
6+00		7.9	103.5	98.50	5.0
+25		4.6	106.8	100.26	6.5
+35.75		2.5	108.9	101.00	7.9
+50		1.03	110.34	101.81	8.5
+75	8.79 119.13	9.4	109.7	103.20	6.5

88.47
5.27
94.24 H.I. 85.00
83.78 ✓ 9.24 ✓ 88.82
10.46 ✓ 86.06 5.42 ✓
8.18 ✓

99.48
2.60
102.08 H.I. 95.00
92.00 7.08 ✓
10.08 ✓

110.34
1.33
111.47 H.I. 101.00
98.50 10.47 ✓ 115.26 H.I.
12.97 ✓ 103.20 ✓ 103.20
8.27 ✓ 12.06 ✓

M.H. lot line bet.
Columbia & Union

M.H. center of
J.P. Union 11.08

M.H. lot line bet.
Union & Horton

Dec. 14/11

 Childs
 Taylor
 Butler
 16

cont. from page 15

Sta.	H.I.	Rod	Ground	Grade	cut		HI.	
	119.13					115.26	110.34	
7+00		8.6	110.5	104.60	5.9	105.99	6.34	
+25		10.6	108.5	105.99	2.5	9.27	116.68	H.I.
+50		5.94	113.19	107.38	5.8	117.87	108.00	
+61.15		5.1	114.0	108.00	6.0	5.67	8.68	
+75		4.0	115.1	108.89	6.2	123.54	113.69	116.00
8+00		1.26	117.87	110.49	7.4	110.49	9.85	7.54
+25		4.5	114.6	112.09	2.5	13.05	116.76	126.97
+50		0.22	118.91	113.69	5.2		6.78	5.26
J.P.	11.09	130.00						132.23
+75		11.2	118.8	115.29	3.5	132.24		119.50
+86.15		9.3	120.7	116.00	4.7	9.99		12.73
9+00		5.7	124.3	116.76	7.5			123.00
+25		3.03	126.97	118.13	8.9			9.23
+50		2.3	127.7	119.50	8.2			
+75		3.1	126.9	120.87	6.0			
10+00		1.33	128.29	122.24	6.04			
J.P.	12.43	141.10						
+13.8		13.3	127.8	123.00	4.8			

 M.H. Center of
 Puterbaugh
 90 ft N of M.H.

Cont. from page 16

Sta.	H.I.	Rod Ground	Grade	cut
10+25	141.10	12.7	128.4	123.62 4.8
+50		10.3	130.8	125.00 ✓ 5.8
+75		8.51	132.59	126.39 6.2
11+00		7.0	134.1	127.78 ✓ 6.3
+25		5.22	135.88	129.16 6.7
+40	M.H. lot line bet. Paterbaugh & Torrence	4.9	136.2	130.00 ✓ 6.2
+50		4.7	136.4	130.47 ✓ 5.9
+80	1.2	6.4	134.7	131.87 ✓ 2.8
12+00		2.90	138.20	132.80 ✓ 5.4
+25		0.42	140.68	133.97 ✓ 6.7
J.P.	4.40	145.08		
+50		3.4	141.7	135.14 ✓ 6.6
+68.5	M.H. center of Torrence	2.56	142.52	136.00 ✓ 6.5
J.P.	155.48			
+75		12.8	142.7	136.30 ✓ 6.4
13+00		11.47	142.6 144.01	137.44 ✓ 5.2 6.6
+25		9.3	146.2	138.57 ✓ 7.6
+50		11.5	144.0	139.71 ✓ 4.3

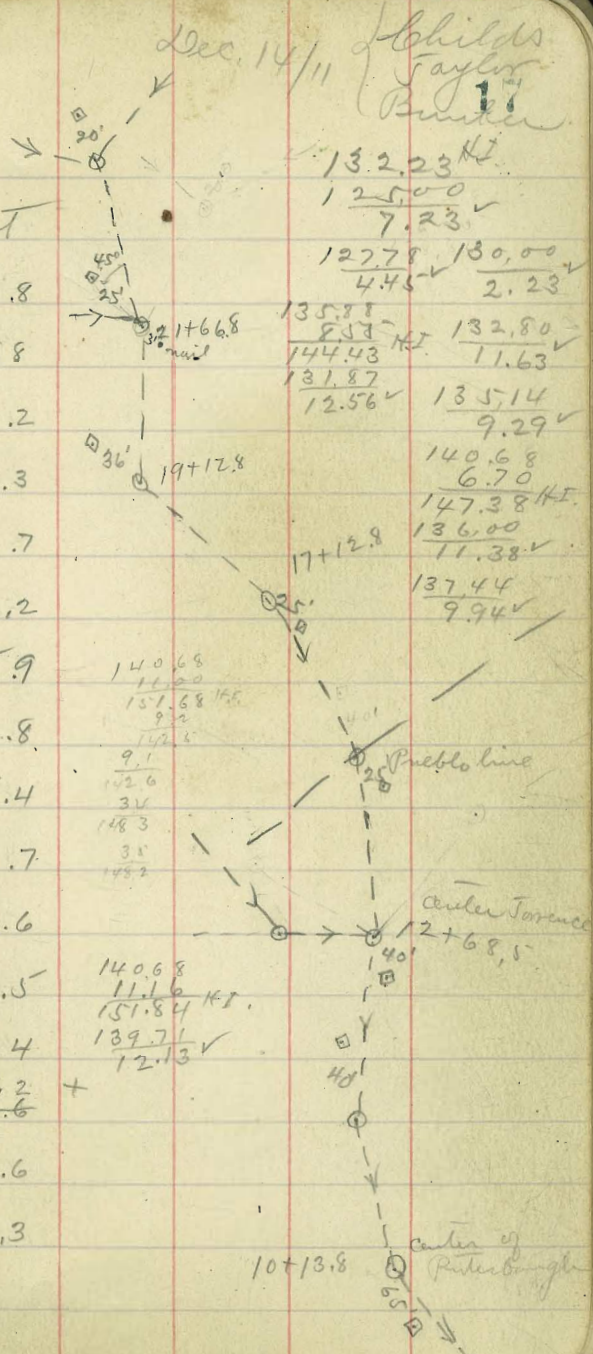

Dec. 15/11
 Childs
 Taylor
 Bunker 18

cont. from page 17

Sta.	H.I.	Rod Ground	Grade	cut		
	150.98				151.84 H.I.	143.00
					140.85	8.84
					10.99	
13+75		8.2	147.3	140.85	6.5	153.07
			148.3		6.3	3.68
14+00		5.61	149.87	141.99	7.9	156.75 H.I.
			148.2		5.2	10.14
+22.5		7.6	147.9	143.00	4.9	159.49 H.I.
			147.9			163.21
						146.74
						12.75
						149.15
						10.34
						151.56
						7.93
+50		3.7	151.8	144.33	7.5	158.88
						4.52
						163.40 H.I.
+75		2.41	153.07	145.53	7.6	153.97
						156.38
						7.02
						9.43
						169.99 H.I.
15+00		3.0	152.5	146.74	5.8	157.00
						12.99
+25		2.30	153.18	147.94	5.3	
+50		2.51	152.97	149.15	3.8	
J.P.	11.58	164.55				
+75		8.1	156.5	150.35	6.2	
16+00		5.67	158.88	151.56	7.3	
+25		8.0	156.6	152.76	3.8	
+50		7.6	157.0	153.97	3.0	
+75		6.5	158.1	155.17	2.9	
17+00		1.34	162.8	156.38	6.4	
			163.21		6.8	
J.P.	12.52	175.73				
+12.8		11.02	164.9	157.00	7.9	
			164.71		7.7	
+25		11.5	164.2	157.55	6.7	

Cont. from page 18

Sta.	H.I.	Rod	Ground	Grade	cut
17+50	<u>175.73</u>	12.3	163.4	158.67	4.7
+75		8.31	167.42	159.80	7.6
18+00		8.8	166.9	160.92	6.0
+25		8.1	167.6	162.05	5.6
+50		7.60	168.13	163.17	5.0
+75		7.4	168.3	164.30	4.0
19+00		5.08	170.65	165.42	5.2
+12.8 M.H. J.P.	12.11	3.59	^{172.3} 172.14	166.00	^{6.3} 6.7 +
+25		14.5	169.8	166.58	3.2
+50		14.5	169.8	167.76	2.0
+75		12.6	171.7	168.94	2.8
20+00		8.50	175.75	170.12	5.6
+25	1.4	9.4	174.9	171.30	3.6
+50		4.41	179.84	172.48	7.3
+75		2.7	181.6	178.66	7.9
21+00		2.73	181.52	174.84	6.7

Dec 16/11

Childs
Taylor
Bunker

167.42
5.67
173.09

10.3
162.8

8.2
164.9

88
172.3

160.92
9.07
103.17
6.82
168.94
9.38
171.30
7.02

167.42
2.58
169.99
158.67
11.32
168.13
10.19
178.32 H.I.
166.00
12.32

Feb. 29/12
 Shields
 Taylor
 Am 20

Cont. from page 19

Sta.	H.I.	Rod	Ground	Grade	cut.
21+25	<u>184.25</u>	6.7	177.5	176.02	1.5
+50		1.96	182.29	177.20	5.1
+66.8	M.H. Junct. 13.35	1.86	182.39	178.00	4.4
22+00	<u>195.74</u>	12.75	182.99	179.56	3.4
+25		11.1	184.6	180.73	3.9
+50		10.0	185.7	181.91	3.8
+75		7.9	187.8	183.08	4.7
23+00		5.62	190.12	184.25	5.9
+25	3' offset	3.6	192.1	185.42	6.7
+37.3	M.H. Junct.	4.64	191.10	186.00	5.1
+50	2' offset	5.0	190.7	186.75	4.0
+75		5.5	190.2	188.23	2.0
24+00	⁹⁰ 5' 13.04	2.66	193.08	189.71	3.4
J.P.		0.03	195.71		
+25	<u>208.75</u>	12.8	196.0	191.19	4.8
+50		11.7	197.1	192.68	4.4
+75		9.9	198.9	194.16	4.7
25+00		7.71	201.04	195.64	5.4

193.08	185.42
3.02	10.68
196.10 H.I.	
186.00	182.99
10.10	8.60
	191.59 H.I.
	179.56
	12.03
	181.91
	9.68
	184.25
	7.34

Feb. 29/12

Lehilla
Taylor
Bunker
21

Cont. from page 20

Sta.		H.I.	Rod	Ground.	Grade	cut
25+22.8	M.H. angle.	208.75	6.12	202.63	197.00	5.6
+50			7.5	201.3	198.44	2.9
+75			5.47	203.28	199.77	3.5
26+00			4.22	204.53	201.09	3.4
J.P.	10.31	218.25	0.81	207.94		
+25			12.1	206.2	202.42	3.8
+55			12.8	205.5	204.01	1.5
+75			9.55	208.70	205.07	3.6
27+00			6.7	211.6	206.40	5.2
+25			3.99	214.26	207.73	6.6
+49	M.H. center of		2.90	215.35	209.00	6.4
	Stephens st.	227.93				
+75			11.10	216.83	210.87	6.0
28+00			8.7	219.2	212.67	6.5
+25			5.7	222.2	214.47	7.7
+50			4.42	223.51	216.27	7.2
+75			2.26	225.67	218.08	7.6
J.P.	12.35	238.02				
29+00			11.1	226.9	219.88	7.0

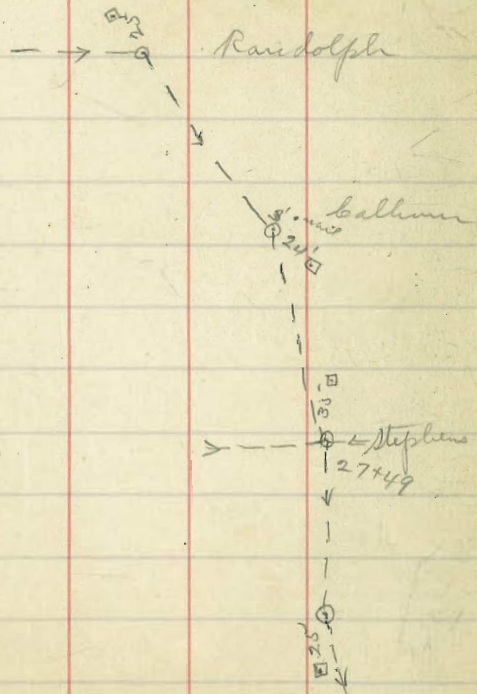

cont. from page 21

Sta.	H.I.	Rod	Ground	Grade	cut
	<u>238.02</u>				
29+25		10.4	227.6	221.68	5.9
+50		10.77	227.25	223.48	3.8
+75		9.8	228.2	225.28	2.9
30+00		6.97	231.05	227.08	4.0 ✓
+12.7	M.H. center of ballroom	4.83	233.19	228.00	5.2 ✓
+25		5.6	232.4	229.56	2.8
+50		1.58	236.44	232.73	3.7 ✓
J.P.	12.92	<u>249.36</u>			
+75		7.08	242.28	236.91	6.4 ✓
31+00		0.27	249.09	239.08	10.0
	12.30	<u>261.39</u>			
+25		11.0	250.4	242.26	8.1 ✓
+50		7.27	254.12	246.43	8.7 ✓
+75		4.5	256.9	248.67	8.3
32+00		2.09	259.30	251.78	7.5 ✓
J.P.	12.12	<u>271.42</u>			
+25		6.26	265.16	254.96	10.2
+40			268.68	256.87	11.8
+50		2.55	268.87	258.14	10.7
+80.4	M.H. center of Randolph.	2.6	268.8	262.00	6.8 ✓

Feb. 29/12
Lalindo
Taylor
Bunker

6.36	
236.44	40.82
231.05	27.08
9.77	<u>13.74</u> ✓
240.82	40.82
228.00	32.73
12.82 ✓	8.07 ✓
236.44	
7.44	
243.88	
235.91	
7.97 ✓	
254.12	
1.29	
255.41	
242.26 ✓	55.41
13.15 ✓	<u>45.43</u> ✓
	7.98 ✓
254.12	
7.32	268.68
267.44 H.I.	1.80 H.I.
251.78	270.48 H.I.
9.66 ✓	<u>252.87</u> 131
268.68	61 269.97 H.I.
394 H.I.	256.87
272.62	130.12 ✓
262.00	
10.62	

Darest sewer continued from Page 41

B.M. N.W. B.P. Dore & Wash	264.96	=
B.M. 5.24 269.70		
+75	5.3	264.9 255.11
10+0	6.0	263.7 255.22
+25	5.8	263.9 255.33
+50	5.8	263.9 255.44
11+0	5.0	264.7 255.65
+50	4.8	264.9 255.87
+90	4.0	265.7 256.04
12+10=160 N. of Wash D.E.	5.2	269.5 256.13

POSTED

264.46			
3.32			
267.78 = 264.46 + 3.32			
255.11	67.78	67.78	67.78
12.67 ✓	55.22	5.533	5.544
5	12.56 ✓	12.45 ✓	12.340
67.78	67.78	67.78	67.78
55.65	55.22	56.00	56.13
12.13 ✓	11.91 ✓	11.74	11.65

28

cont. from page 24

Jan 13/2
Schilders
Taylor
Glynn

Sta.	H.I.	Red. Ground	Grade	cut
J.P. 5+50	5.73 265.54	259.81	248.66	12.8
6+00		3.41 262.13	248.86	13.4
+50		6.5 259.2	249.06	10.1
7+00		7.6 258.1	249.26	8.8
+50		7.43 258.11	249.46	8.8
8+00		7.0 258.7	249.66	9.0
+50		6.78 258.76	249.86	9.0
9+00		6.7 259.0	250.06	8.9
+07.1 m.H. center of J.P. Douglas ³	267.39	6.48 259.23	250.09	9.1
+50		8.1 259.3	250.26	9.0
10+00		7.60 259.79	250.46	9.3
+50		7.0 260.4	250.66	9.7
11+00		6.7 260.7	250.86	9.8
+50		6.1 261.3	251.06	10.2
12+00		5.56 261.83	251.26	10.5
+44.16 m.H. center of Washington		4.9 262.5	251.44	11.1

262.13		258.11
4.39 H.I.		372
266.52	4.21	261.88 H.I.
4.95		248.86
261.57		12.77
248.66	13.44	
12.91		249.26
		12.57
249.66		249.86
12.17		11.97
		250.09
		11.74
258.76		250.26
3.26		11.76
262.02 H.I.		258.76
250.09		4.07
11.93		262.83 H.I.
		250.26
		12.57
259.79		259.79
4.25		3.92
264.04 H.I.		5.84
250.64		263.71 H.I.
13.40		250.76
		12.95
		250.76
		14.17
259.79		4.10
4.55		1263.89 H.I.
264.34		257.06
250.86		12.83
250.86		250.86
3.48		13.03
		251.26
		12.63
261.83		
4.38		
266.21 H.I.		
251.44		3.11
		14.77
		3.11
		11.22

Jan. 16/12 *Abilado Taylor Bricker 26*

cont. from page 25

Sta.	H.I.	Rod	Ground	Grade	cut
	<u>267.39</u>				✓
12+7.5		4.7	26.2.7	251.56	11.1
13+00		4.56	262.83	251.66	11.1
+50		4.9	262.5	251.86	10.6
14+00		5.3	262.1	252.06	10.0
+50		5.67	261.72	252.26	9.4
15+00		5.8	261.6	252.46	9.1
+50		6.20	261.19	252.66	8.5
16+00		5.9	261.5	252.86	8.6
+07.42	M.H. center of <i>Getti</i>	5.7	261.7	252.89	8.8
+50		4.45	262.94	253.06	9.9
JOB,	8.31 · 271.25				✓
17+00		7.0	264.3	253.26	11.0
+50		6.0	265.3	253.46	11.8
18+00	0.4 <i>grade</i>	5.02	266.23	253.66	12.5
+50		4.2	267.1	253.86	13.2
19+00		3.6	267.7	254.06	13.6
+50		3.15	268.10	254.26	13.8
+58.12	M.H. center of <i>Lewis</i>	3.2	268.1	254.29	13.8

266.21 H.I.	263.05
3.15	3404.34
263.06	262.81
251.56 ✓	251.86 ✓
11.50	10.95
3.19	3.05
263.02	262.66
251.66 ✓	252.06 ✓
11.36	10.60
4.27	4.22
261.94	261.19 H.I.
252.26 ✓	252.46 ✓
9.68	12.95
252.66 ✓	252.89 ✓
12.75	12.52
253.06	253.26
12.35 ✓	12.15
268.10	253.46
4.39	11.95
272.47 H.I.	
5.66	5.33
266.83	267.16
253.66 ✓	253.86 ✓
13.17	13.30
265.00	3.95
4.75	268.90
272.85 H.I.	254.29
5.12	14.61
267.73	
254.06	
13.67 ✓	

Jan. 16/12 J Childs
Taylor
Bunker 27

Cont. from page 26

Sta.	H.I.	Rod	Ground	Grade	Cut		H.I.
	271.25						272.85
20+00		3.5	267.8	254.71	13.1	5.48	265.84
+50		4.5	266.8	255.21	11.6	267.37	268.80 HI
21+00		5.41	265.84	255.71	10.1	255.21	256.21
+50	1% grade	6.5	264.8	256.21	8.6	13.59	12.59
22+00		7.57	263.68	256.71	7.0	12.16	256.71
+45	F.I. about 39'	8.5	262.8	257.16	5.6	6.91	257.16
	from Broadway.					265.84	11.64
						2.82	
						268.66 HI	
						255.71	
						12.95	

✓ Alley line bet. Bush &

Douglas,

Jan. 17/12

Childs
Taylor
Bunker
28

from 12' east Center of Eagle to center Goldfinch

Sta.		H.I.	Roll	Ground	Grade cut.			
		4.92	263.94	259.02			261.00	
0+00	M.H. 12' east center of Eagle.		4.13	259.81	248.50	11.3	134	H.I. 257.50
+50			4.1	259.8-	249.50	10.3	262.34	10.84
+69				249.88			250.50	252.10
+75			4.40	259.54	250.00	9.5	11.84	9.84
1+00	POSTED		6.5	257.4-	250.50	6.9	261.00	
+25			9.2	254.7-	257.00	3.7	149	
+50			9.8	254.1-	257.50	2.6	262.49 H.I.	266.32 H.I. 254.24
+75			4.86	259.08-	252.00	7.1	249.88	253.50
2+00			2.94	261.00	252.50	8.5	12.61	11.98
J.P. +50		5.77	266.77				254.39	254.69
+92.2	M.H. center of Falcon.		5.1	261.7-	254.34	7.4	11.93	254.98
3+00			4.9	261.9-	254.39	7.5	10.75	255.82
+50			4.6	262.2-	254.69	7.5	10.75	10.45
4+00			5.02	261.75-	254.98	6.8		
+50			5.0	261.8-	255.28	6.5		
5+00			5.3	261.5-	255.57	5.9		
+50			5.97	260.80	255.87	4.9		
+72.5	M.H. center of Goldfinch		5.50	261.27-	256.00	5.3		

✓ 1/ Goldfinch line from alley bet.
to near Lewis

Bush & Douglas Jan 17/12 Childs
Taylor
29
Bunker

Sta.	H.T.	Road	Ground	Grade cut			
J.P.	3.95		267.02			262.28	
0+00	M.H. center alley bet. Bush & Douglas	9.70	261.27	256.00	5.3	4.44	256.40 ✓
+50		9.3	261.7	256.20	5.5	266.72 H.I.	10.32 ✓
1+00		8.69	262.28	256.40	5.9	256.20	256.60 ✓
+50	POSTED	8.2	262.8	256.60	6.2	10.52	10.12 ✓
2+00		7.7	263.3	256.80	6.5	256.80	263.74 ✓
+50		7.23	263.74	257.00	6.7	9.92	6.80 ✓
3+00		6.6	264.4	257.20	7.2	257.20	270.04 H.I.
+50		6.1	264.9	257.40	7.5	12.84	257.00 ✓
+95.27	M.H. center of Douglas	5.4	265.6	257.58	8.0	257.20	15.04 ✓
4+00		5.26	265.71	257.60	8.1	12.84	257.40 ✓
+50		4.8	266.2	257.80	8.4	12.64	257.58 ✓
5+00		4.7	266.3	258.00	8.3	12.64	12.46 ✓
+50		4.42	266.55	258.20	8.3	265.71	
6+00		4.3	266.7	258.40	8.3	4.80	
+50		4.3	266.7	258.60	8.1	270.51 H.I.	258.00 ✓
7+00		4.22	266.75	258.80	8.0	12.51	12.31 ✓
+32.7	M.H. center of Washington	4.1	266.9	258.93	8.0	257.80	258.40 ✓
						12.71	258.60 ✓
						258.93	258.80 ✓
						11.58	11.71 ✓

Jan 22/12
 Shields
 Taylor 30
 Baker

cont. from page 29

Sta.	H.I.	Rod	Ground	Grade	cut			
J.P. 7+50	5.46	272.48	267.02	259.00	7.8	266.75 4.60 271.35	H.I. 259.20 12.15	259.40 11.95
8+00			266.8	259.00	7.8	259.00 12.85		259.80 11.55
+50			5.7	267.3	8.1	260.00	260.20 11.35	260.38 11.75
9+00			5.1	267.4	8.0	268.56 4.33 272.99	H.I. 260.54 12.45	10.97 58/2 13 1626
+50			4.88	267.60	8.0	260.69 12.39	267.41 3.42 270.83	H.I. 260.84 9.99
10+00			4.5	268.0	8.2	260.69	260.84 10.14	260.99 9.84
+50			4.2	268.3	8.3	261.14 9.69		
✓ 10+50			3.82	268.66	8.5			
✓ 11+00	195.83	M.H. center of Gettin	3.6	268.9	8.5			
+50		at Stockton Dr.	3.6	268.9	8.5			
12+00			3.8	268.7	8.2			
+50			4.5	268.0	7.3			
13+00			5.07	267.41	6.6			
+50			5.7	266.8	5.8			
+50	F.S.		6.60	265.88	4.8			
+50					4.0			

1350
 1096
 254

✓
 ✓
 sewer line lot line bet.
 from center Laurel to

Sta.		H.I.	Rod	Ground	Grade	dist
J.P.	5.77	<u>62.10</u>		56.33		
0+00	M.H. center of		12.7	49.4	43.00	6.4
+50	Laurel.		10.12	51.98	44.25	7.7
+75	POSTED		8.4	53.7	44.87	8.8
1+00			10.3	51.8	45.49	6.3
+50			10.5	51.6	46.74	4.9
2+00			9.04	53.06	47.99	5.1
+50			9.2	52.9	49.24	3.7
3+00			7.8	54.3	50.48	3.8
+50			6.02	56.08	51.73	4.4
+81	M.H. center of		4.2	57.9	52.50	5.4
4+00	maple.		4.4	57.7	52.97	4.7
+50			2.68	59.42	54.22	5.2
J.P.	11.73	<u>72.43</u>	1.40	60.70		
5+00			8.53	63.90	55.47	8.4
+50			4.5	67.9	56.72	11.2
+75			3.92	68.51	57.34	11.2
6+00	4' west		8.7	63.7	57.96	5.7

India + Arctic
 Olive.

Jan. 19/12
 Leibold
 Taylor
 Bank 31

51.98	45.49	47.99
46.0	11.09	8.59
56.58 H.I.		
44.25	46.74	49.24
12.33	9.84	7.34
50.48	51.73	52.60
6.10	4.85	4.08
52.97	54.22	63.90
3.61	2.36	4.81
		68.41 K.I.
		55.47
56.72	68.51	12.94
71.69	0.65	
	69.16 K.I.	
	57.34	
	11.82	

Cont. from page 31

Sta		H.I.	Rod	Ground	Grade	cut
6+50	4' west	<u>72.43</u>	10.5	61.9	59.21	2.7
7+00	4' west		10.5	61.9	60.46	1.4
+50			6.10	66.33	61.71	4.6
J.P.	12.68	<u>79.01</u>				
+61.55	W.H. center of Mudney.		10.5	68.5	62.00	6.5
8+00	3' east		10.0	69.0	63.24	5.8
+50	"		8.19	70.82	64.85	6.0
9+00	"		8.3	70.7	66.47	4.2
+50	"		6.2	72.8	68.08	4.7
10+00	3' east		3.08	75.93	69.69	6.2
+50	3' east		0.38	78.63	71.30	7.3
+56	F.I. about 2' no. of so. line of Chis		0.56	78.45	71.50	7.0

Jan. 19/12

Childs
Taylor
Bunker 32

69.16 H.I.	66.33
59.21	0.80
9.95	67.13 H.I.
04	60.46
9.91	6.67
66.33	
7.15	62.00
73.48 H.I.	11.48
61.71	63.24
11.77	10.24
	64.85
	8.63
66.47	
7.01	68.08
	5.40
75.93	
5.36	
81.29 H.I.	71.50
69.69	9.79
11.60	

✓ Sewer on lot line bet. India
Center of palm to Olive.

4 articles from Jan 20/12
Childs
Taylor
Bunker

Sta.		H.I.	Rod	Ground	Grade cut			
J.P.	2.00	80.45		78.45		79.60	H.I. 70.00	
0+00	M.H. center of Palm.		10.6	69.9	65.00	4.9	67.50	9.60
+25			7.02	73.43	66.25	7.2	72.10	70.25 9.35
							70.50	9.10
+50	POSTED		4.7	75.8	67.50	8.3	70.76	71.00
							8.84	8.60
1+00			2.14	78.31	70.00	8.3		
+50	5		4.0	76.5	70.25	6.2		
2+00			4.7	75.8	70.00	5.3		
+50			4.53	75.92	70.76	5.1		
+98	F.I. about 2' so. of north line of Olive		3.2	77.3	71.00	6.3		

✓ 3
 Sewer line artic 15' from
 from center Kalunia to
 Sta. H.I. Rod Ground

Sta.	H.I.	Rod	Ground
0+00	<u>20.04</u>	6.4	13.6
+25		8.58	11.46
+50		6.5	13.5
+85	<u>30.25</u>	1.6	28.6
1+00		0.60	29.65
J.P.	6.05	<u>35.70</u>	
+50		4.4	31.3
2+00		3.68	32.02
+50		3.4	32.3
3+00	F.S.	3.7	32.0

east line
 jumper

Grule cut

Grule	cut
8.00	5.6
8.10	3.4
8.20	5.3
19.26	9.3
24.00	5.6
24.25	7.1
24.50	7.5
24.75	7.6
25.00	7.0

Jan 22/12
 Schultz
 Sayre
 34
 Bunker

29.65		
8.60	H.I.	24.75
33.25		8.50
25.00		24.50
8.25		8.75
11.46		
9.62		
21.08	H.I.	8.48
8.20		12.60
12.88		

✓ Sewer line on arctic frame
to palm & up palm to lot line

center Kalunia north
bet. arctic & India

Jan 26/12

J Childs
Taylor
Bunker 35

Sta.	Ht	Rod	Ground	Grade	cut			
0+00	20.04	6.4	13.6	8.00	5.6	33.25 H.I.	51.98	
+25		3.36	16.68	12.00	4.7	24.00 9.25	0.63 H.I.	52.61 H.I.
+50	30.25	8.92	21.33	16.00	5.3	24.80 8.45	12.94	tie out → 39.67 J.P.
+75	POSTED	5.8	24.4	20.00	4.4	21.08 H.I.	3.81	47.98 H.I.
1+00	41.98	12.81	29.17	24.00	5.2	8.48 12.60	12.81	29.17 J.P.
+50		11.2	30.8	24.80	6.0	31.76 7.10	1.02	30.25 H.I.
2+00		10.22	31.76	25.60	6.2	38.86 H.I.	11.06	19.19 J.P.
+50		5.8	36.7	26.40	10.3	26.40 12.46	16.00 5.08	0.85
3+00		4.44	37.54	27.20	10.3	39.46 0.45	20.04 H.I.	20.04 H.I.
+50		2.9	39.1	28.00	11.1	39.91 H.I.	27.20	28.00
+80.6		3.07	38.91	28.50	10.4	28.68 11.23	11.66	10.86
4+00	41.94	2.48	39.46	28.58	10.9	35.75 3.62	28.50	10.36
+25		3.1	38.8	28.68	10.1	39.37 H.I.	28.78	28.98
+50		6.1	35.8	28.78	7.0	28.78 10.59	28.98 10.39	
5+00		4.2	37.7	28.98	8.7	29.18	29.18	29.38
+50		6.19	35.75	29.18	6.5	10.19	9.99	
6+00		6.1	35.8	29.38	6.4			

Jan 26/10
 Shields
 Taylor
 Printer
 36
 35' 0"

Cont. from page 35

Sta.	H.I.	Rod	Ground	Grade	cut			
	41.94					39.37 H.I.		
						29.58		
						9.79		
6+50		6.27	35.67	29.58	6.1	29.78	29.98	num 15.01 5.57
						9.59	9.59	
7+00		6.9	35.0	29.78	5.2	30.03		
						9.34	32.11	
+50		6.63	35.31	29.98	5.3	30.93	7.26	
						8.44		
+61.45	M.H. center of maple	7.0	34.9	30.03	4.9	32.70	33.88	cutting 15"
						6.67	5.49	
8+00		6.4	35.5	30.93	4.6	34.47	40.57	
						4.90	5.80	
+50		5.73	36.21	32.11	4.1	36.83	46.37 H.I.	
						9.54	35.61	
+75		4.32	37.62	32.70	4.9	38.01	10.72	
						8.36	38.01	maple 11"
9+25		1.33	40.61	33.88	6.7	39.00	8.36	
						7.37	39.18	40.28
							7.19	6.09
+50		1.37	40.57	34.47	6.1	41.38	50.30	57.23
J.P.	11.05	51.62				4.99	5.78	7.14
10+00		11.2	40.4	35.65	4.8	53.4	56.08 H.I.	64.37 H.I.
						50.30	42.48	
+50		10.2	41.4	36.83	4.6	55.60 H.I.	43.58	
						42.48	12.06	
11+00		5.60	46.02	38.01	8.0	13.16		
+41.82	M.H. center of nutmeg.	5.8	45.8	39.00	6.8			
+50		4.4	47.2	39.18	8.0			
12+00		3.2	48.4	40.28	8.1			
+50		1.32	50.30	41.38	8.9			
J.P.	12.91	63.21						
13+00		9.0	54.2	42.48	11.7			
+50		5.98	57.23	43.58	13.6			

Jan 27/12 }
 Colville
 Taylor
 Bunker 36

Cont. from page 36

Sta.	H.I.	Rod	Ground	Grade	cut			
	63.21					67.82	67.82	65.00
14+00		4.3	58.9	44.68	14.2	0.43	4.85	7.67
+50		3.78	59.43	45.78	13.6	68.25 H.I.	72.67 H.I.	
+59.58 m.H. center of Olive		4.3	58.9	46.00	12.9	54.93	60.30	
15+00		4.5	58.7	46.82	11.9	13.32	12.37	
+50		5.90	57.31	47.84	9.5	59.43	57.23	
16+00		6.0	57.2	48.87	8.3	55.58	3.49	
+50		4.1	59.1	49.90	9.2	65.01 H.I.	60.72 H.I.	
17+00		3.78	59.43	50.92	8.5	52.50	2.15	
J.P.	12.20	71.63				12.57	58.57	
+50		6.8	64.8	51.94	12.9	57.23	13.89	
+77.4 m.H. center of Palm..		5.1	66.5	52.50	14.0	160		
18+00		3.81	67.82	54.93	12.9	58.83 H.I.	46.82	47.84
+50		1.2	70.4	60.30	10.1	46.00	12.01	10.99
+93.7 m.H. center of Palm & 67' like bet. art's & Ind's		1.77	69.86	65.00	4.9	12.83	59.43	
						48.87	2.08	
						9.96	61.51 H.I.	50.92
						59.43	49.90	10.59
						54.8	11.61	
						64.91 H.I.	57.31	
						51.94	2.71	
						12.97	60.02 H.I.	
							48.87	47.84
							11.55	12.18

✓ Falcon Street from Center alley bet. Bush Jan 25/12 } blights
 and Douglas to Getti Taylor
 38
 Bunker

Sta.		H.I.	Rod	Ground	Grade	cut			
	J.S. 8.43	269.43		261.00			262.89		
0 + 00	M.H. alley bet.		7.7	261.7	254.34	7.4	4.79	262.89	256.11
	Bush & Douglas						267.68 H.I.	5.00	11.57
+ 50			6.54	262.89	254.93	8.0	254.93	267.89 H.I.	255.52
							12.75	12.37	257.88
1 + 00			6.1	263.3	255.52	7.8	256.70	257.29	10.01
							11.19	10.60	
+ 50	POSTED		5.5	263.9	256.11	7.8	265.46	259.00	259.02
							4.19	10.65	10.63
2 + 00			4.50	264.93	256.70	8.2	269.65 H.I.		
							259.47		
+ 50			4.3	265.1	257.29	7.8	11.78		
3 + 00			4.1	265.3	257.88	7.4	265.56	259.49	3.93
							4.29 H.I.	10.36	4.19
+ 50			3.97	265.46	258.47	7.0	269.85		8.12
							259.25		
4 + 00	M.H. Center of Douglas		3.7	265.7	259.00	6.7	10.60		
							265.01		
+ 50			3.7	265.7	259.02	6.7	4.40		
							269.41 H.I.		
5 + 00			3.5	265.9	259.25	6.7	260.18	259.95	259.72
							9.23	9.46	9.69
5 + 00			3.87	265.56	259.49	6.1			
	J.S. 4.26	269.82							
+ 50			4.5	265.3	259.72	5.6			
6 + 00			4.7	265.1	259.95	5.2			
+ 50	F.S. 4225 20. of Washington		4.81	265.01	260.18	4.8			
7 + 00			5.2	264.6	260.42	4.2			
+ 32.25	M.H. Center of Washington		4.8	265.0	260.57	4.4			

Jan 25/12
 Schields
 Taylor 39
 Bunker

Cont from page 38

Sta.	H.I.	Rod	Ground	Grade	cut			
7+50	269.82	4.7	265.1	260.65		265.90 4.48 270.38 H.I. 260.90 9.48 ✓	265.90 3.69 269.59 H.I. 8.12 261.47 260.53	
8+00 dead end		3.92	265.90	260.90	5.0	260.70 9.68 ✓	260.50 9.88	8.6 260.50 ✓
+50		3.6	266.2	260.70	5.5	260.30 10.08 ✓	266.69 4.04 H.I.	
9+00		3.5	266.3	260.50	5.8		270.73 H.I.	
+50		3.40	266.42	260.30	6.1	259.90 10.83 ✓	260.10 10.63 ✓	260.10 10.63 ✓
10+00		3.3	266.5	260.10	6.4	260.91 4.38 265.29 H.I.	259.72 ✓ 11.01	259.03 11.70 ✓
+40		3.1	266.7	259.94	6.8	255.33 ✓	255.91 9.38	256.53 8.76 ✓
S.P.	275	269.17	266.42			259.90 ✓ 9.96	257.16 8.13 ✓	257.78 ✓ 7.51 ✓
+50		2.48	266.69	259.90	6.8			
+95.37 M.H. Center of Getti + Fulam		2.8	266.4	259.72	6.7			
11+00		2.9	266.3	259.66	6.6	258.41 6.88 ✓		
+50		3.96	265.21	259.03	6.2			
12+00		5.06	264.11	258.41	5.7			
+50		6.1	263.1	257.78	5.3			
13+00		7.3	261.9	257.16	4.7			
+50		8.26	260.91	256.53	4.4			
14+00		9.3	259.9	255.91	4.0			
+46.5 M.H. center of Ben's + 5 west of east limb of Fulam		10.6	258.6	255.33	3.3			

✓ P.D.A.

J.

Low. Street line from
line to Washington St

Junctions of ejectors

Jan 29/12

Builds
Taylor 40
Bunker

Sta	H.I.	Rod	Ground	Grade	cut		H.I.	
J.P.	8.40	203.34	194.94			191.74		
0+00		M.H. at junction	15.0	188.5	183.50	5.0	5.41	187.21
		with ejector line.	13.9	189.4	184.43	5.0	197.13	9.94
+25			11.60	191.74	185.36	6.3	185.36	186.29
+50			9.31	194.03	186.29	7.7	11.79	10.86
+75	POSTED		9.8	193.5	187.21	6.3	188.14	190.00
1+00			10.1	193.2	188.14	5.1	19.01	7.15
+25			8.4	194.9	189.07	5.8	11.39	196.10
+50			7.24	196.10	190.00	6.1	207.49	9.11
+75	break		5.3	198.0	193.42	4.6	193.42	205.21 H.I.
2+00			1.52	201.82	196.84	5.0	200.26	198.42
+25			10.39	204.51	200.26	4.2	4.95	11.79
J.P.	13.08	214.90						
+50			3.4	209.5	203.00	6.5	219.68	
+70	M.H.		2.11	212.79	206.75	6.0	3.99	
3+00			0.00	214.90	209.87	5.0	223.67	H.I.
+25			9.7	217.8	213.00	4.8	215.87	
J.P.	12.62	227.52					7.80	
+50	break		7.3	220.2	214.43	5.8		
+75			7.84	219.68	215.87	3.8		
4+00								

212.79
4.62
217.41
212.79
2.66
215.45 H.I.
203.00
12.48
206.75
8.70
213.00
2.48

Feb. 1/12
 Lechild
 Taylor
 Blumber

cont. from page 40

Sta.		H.I.	Rod	Ground	Grade	cut		
		227.52					220.58	1
4+25			6.94	220.58	217.30	3.3	8.40	150
J.P.	8.14	234.50	1.16	226.36			228.98 H.I.	alley bet. wash. & Douglas
+50			6.5	228.0	218.74	9.3	218.74	
							10.24	
+75			0.44	234.06	220.17	13.9	231.53	
							0.60	
5+00			0.0	234.5	221.61	12.9	232.13 H.I.	150
							223.04	
+25			9.4	225.1	223.04	2.1	9.09	
							224.00	
+41.5	M.H. Central		6.1	228.4	224.00	4.4	8.13	
							226.59	
+50	bet. University & Douglas		2.97	231.53	226.59	4.9	5.54	264.46 B.M.
J.P.	12.82	247.18	0.14	234.36			252.67	
+75			5.57	241.61	234.22	7.4	0.65	
J.P.	13.00	260.14	0.04	247.14			253.32 H.I.	259.4
6+00			7.47	252.67	241.85	10.8	241.85	3.31 H.I. 251.25
							11.47	262.71 H.I. 11.46
+30	break		0.87	259.40	251.00	8.4	260.09	257.00
J.P.	10.42	269.69					3.60	11.71
+50			9.60	260.09	251.25	8.9	264.25 H.I.	265.77 H.I.
							257.87	3.05
							12.58	265.72
7+00			7.0	262.7	251.87	10.8	266.03	252.50
							2.24	13.22
+50			4.3	265.4	252.80	12.9	268.27 H.I.	266.03
							255.00	1.50
8+00			4.52	265.17	253.12	12.1	13.27	267.53 H.I.
							265.17	254.32
+50			4.3	265.4	253.78	11.7	0.89	13.16
							266.06 H.I.	
+63.25	M.H. Center alley		4.15	265.54	253.92	11.6	253.12	
	bet. Washington & Douglas						12.94	
9+00	Break		3.66	266.03	254.37	11.6		
+50			4.0	265.7	255.00	10.7		

Continued on page 23

✓
P. 42

Sewer in alley bet. Washington & Douglas, from
Center Ave. to alley east. Line Palm Hts. Feb 7/12

blinds
42
Bunker

Sta		H.I.	Rod	Ground	Grade	Cut			
J.P.		6.88	271.34	264.46			267.15		
0+00	M.H. center of Ave.		5.82	265.52	253.92	11.6	4.73 271.88 H.I.	4.34	366
+50			4.82	266.52	254.63	11.9	4.42 267.46 256.05	267.54 256.76	268.22 257.47
1+00	POSTED		4.6	266.7	255.34	11.4	11.41 266.52 3.88	10.78	10.76
+50			4.1	267.2	256.05	11.2	3.88 H.I.	3.47	330
2+00			4.19	267.15	256.76	10.4	3.72 266.68 253.92	266.93 254.63	267.15 255.34
+50			3.4	267.9	257.47	10.4	12.76	12.30	11.81
3+00	M.H.		3.6	267.7	258.18	9.5	267.42 3.17	258.89	11.70
+50			3.92	267.42	258.89	8.5	270.59 H.I.	259.59	11.00
4+00			8.0	263.3	259.59	3.7	258.18 12.41	260.30	261.01
+25			10.7	260.6	259.94	0.7	268.17 4.42	10.29	9.58
+50			10.4	260.9	260.30	0.6	272.59 H.I.	271.04	
5+00			3.17	268.17	261.01	7.2	262.00 10.59	1.48	
+50			0.30	271.04	261.72	9.3		272.52 H.I.	
+70	F.I. about 28 1/2 west of alley.		-0.2	271.5	262.00	9.5		261.62	10.90

✓ 17 from east property
 Sever of Columbia from
 to Olive.

28.5 So. Laurel

Jan. 31/12

Childs
 Taylor
 B. 43

Sta.	J.P.	H.I.	Rod	Ground	Grade	cut	Laurel.
0+00	12.89	53.36	13.3	40.47	35.00	5.0	44.64 333 47.97 HI. 35.50 12.47
+50	Laurel.		14.0	39.4	35.50	3.9	91.88 193 93.81 HI. 36.00 11.97
1+00	break	POSTED	12.82	40.54	36.00	4.5	81.48 12.33 44.20 3.77
+50			4.53	48.83	44.20	4.6	57.57 6.98 64.53 HI. 52.40
2+00	12.68	65.78	0.26	53.10	52.40	5.2	100.86 12.15 60.60
+50	12.40	77.78	0.40	65.38	60.60	5.7	6.89 107.45 HI. 3.95 74.95
3+00			2.83	74.95	68.80	6.2	96.12 11.33 7.71
+50	12.82	89.68	0.42	77.36	76.00	6.5	101.06 82.66 HI. 6.39 68.80
4+00	12.20	101.85	0.03	89.65	76.60	6.8	95.10 3.86 6.31 74.95
+50			9.97	91.88	81.48	10.4	76.00 5.26 68.80 12.46
+50			9.45	92.4	86.36	6.0	112.90 6.18 HI. 119.08 106.06 13.02
5+00			6.94	94.91	91.24	3.7	
+50			0.99	100.86	96.12	4.8	
+74		109.67	5.8	103.9	98.50	5.4	
6+00			2.71	106.96	101.06	5.9	
+50	12.60	122.04	0.23	109.14	106.06	6.8	

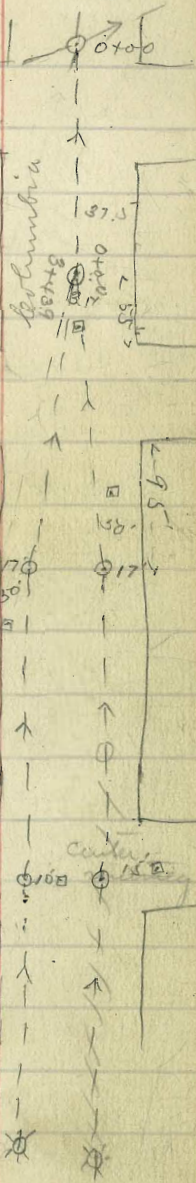

cont. from page 43

Sta.		H.I.	Rod Ground	Grade cut
		<u>122.04</u>		
7+00			2.91 119.13	111.06 8.1
J.P.	12.78	<u>134.68</u>	0.14 121.90	
+50			9.68 125.00	116.06 8.9
8+00			5.9 128.8	121.06 7.7
+19.6	M.H. Center of		5.2 129.5	123.00 6.5
+50	nutmeg.		4.50 130.18	124.25 6.0
9+00			2.8 131.9	126.31 5.6
+50			0.99 133.69	128.37 5.3
J.P.	9.18	<u>142.87</u>		
10+00			7.2 135.7	130.43 5.3
+50			5.4 137.5	132.50 5.0
11+00			3.48 139.39	134.56 4.8
+35	F.S. about 30'		1.9 141.0	136.00 5.0
	from Oliver			

Jan 31/12
 Builds
 Taylor
 Blumber

119.08 H.I.	125.00
111.06 ✓	8.92 H.I.
8.02	133.92 H.I.
125.00	123.00 ✓
621	10.92
131.21	3.26
	128.26 H.I.
	124.25
	116.06 ✓
	9.67 ✓
	12.20 ✓
126.31 ✓	128.37 ✓
7.61 ✓	5.55 ✓
132.50	130.43
7.42 ✓	3.49 ✓
	139.39
	4.38 H.I.
	143.77
	134.56
	9.21 ✓
	136.00
	7.77 ✓

✓ Columbia St. from 18.5 to

Kalua

Sta.		H.I.	Rod	Ground
0+00	M.H. 18.5 to	<u>50.25</u>	10.2	40.0
+50	Laurel.		5.61	44.64
1+00			1.30	48.95
+50	POSTED	<u>61.83</u>	8.78	53.05
2+00			4.68	57.15
+50	F.I. near Kalua		0.1	61.7

5

Laurel to

Grade	cut
35.00	5.0
39.20	5.4
43.40	5.5
47.60	5.4
51.80	5.4
56.00	5.7

Feb. 2/12

45

Childs
Jay
Baker

58.33		
53.0		
61.83 H.I.	44.64	
12.33	66.5	
49.50 T.P.	57.29 H.I.	
0.75	39.20	
50.25 H.I.	12.09	
43.40	47.60	
7.89	3.69	
57.15		
6.27	56.00	
63.42 H.I.	7.42	
61.80		
11.62		

17' east of west line of
 from 105' so. maple to drive
 diagram page 43

Sta.	H.I.	Rod	Ground	Grade	cut		
0+00 = m.H. Sta. 3+43.9	89.68	7.2	82.5	76.00	6.5	76.00	6.5
+50 of Columbia st so. of maple	101.85	10.54	91.31	80.34	11.0	86.00	5.3 break
1+00		9.6	92.3	84.67	7.6	87.5	4.8
+50 break	POSTED	7.88	93.97	89.01	5.0	89.00	5.0
2+00		3.8	98.1	93.35	4.8	93.34	4.8
+30.65 m.H. 95' no. of S.P. maple 12.87	break 113.96	0.76	101.09	96.00	5.1	96.00	5.1
+50		11.07	102.89	97.50	5.4	97.86	5.0
3+00		6.26	107.70	101.37	6.3	102.63	5.1
+50 dead end S.P.	12.83 125.27	1.52	112.44	105.24	7.2	107.40	5.0
4+00 S.P.		8.23	117.04	109.11	7.9		
+50		4.39	120.88	112.98	7.9		
+76.1 m.H. center of miting.		3.9	121.4	115.00	6.4		
5+00		3.4	121.9	115.91	6.0		
+50 S.P.	11.79 135.22	1.84	123.43	117.82	5.6		
6+00		9.9	125.3	119.73	5.6		
+50		7.78	127.44	121.64	5.8		

Columbia see

Feb. 2/12

Lehills
 Taylor
 146
 1311

break

91.31

5.68

96.99

8.60

10.99

87.50

9.49

89.00

7.99

93.34

3.65

102.59

8.88

106.77

96.00

10.77

97.86

8.91

102.63

4.14

Feb. 2/12
J. Childs
Taylor
Bunker

cont. from page 46.

Sta.	H.I.	Rod	Ground	Grade	cut
7+00	<u>135.22</u>	6.0	129.2	123.56	5.6
+50		4.06	131.16	125.47	5.7
+90	F.S. nail 4' west,	2.23	132.99	127.00	6.0

132.99
8.51
141.50
2.03
139.47

✓ 2

Center of State Street from main sewer to north of Olive

bet. Kalmia & Laurel & Maple builds Taylor 48
Feb. 16/12 Brunker

Sta.		H.I.	Rod Ground	Grade	Cut
J.P.	8.65	46.29	37.64		
0 + 00	mk bottom of		9.4 36.9	29.00	7.9
+ 25	curb bet. Kalmia & Laurel		8.58 37.71	30.66	7.0
+ 50			10.05 36.24	32.33	3.9
+ 60	break	POSTED	6.9 39.4	33.00	6.4
+ 75			0.32 45.97	37.50	8.5
J.P.	12.26	58.23			
1 + 00	break		6.3 51.9	45.00	6.9
+ 50			4.96 53.27	46.96	6.3
2 + 02	mk 5' north center of mfl.		4.7 53.5	49.00	4.5
+ 50			3.81 54.42	51.45	3.0
+ 75			0.23 58.00	52.72	5.3
J.P.	12.82	70.82			
3 + 00	break		11.98 58.84	54.00	4.8
+ 25			3.55 67.27	59.07	8.3
J.P.	13.03	83.85	0.00 70.82		
+ 50			6.54 77.31	64.08	13.2
J.P.	12.73	96.57	0.01 83.84		
+ 75			12.8 83.8	69.12	14.7
4 + 00			7.12 89.46	74.15	15.3
+ 25			3.43 93.14	79.19	14.0
J.P.	12.69	109.16	0.10 96.47		
+ 50			11.74 97.42	84.23	13.2

37.71
1.04
38.75 - H.I. 33.00 ✓
30.66 ✓ 5.75
8.07 53.27
4.71 6.07
57.98 H.I.
45.00 ✓ 46.96 ✓ 49.00
12.98 11.02 8.98 ✓
67.27
67.45 ✓ 54.00 ✓ 8.24 H.I.
6.53 ✓ 3.98 75.51
77.31 64.08 ✓
7.67 17.43 ✓
86.98 H.I.
74.15 ✓ 89.45
12.83 77.0 H.I.
97.15 H.I.
84.23 ✓
12.92 ✓

Feb 16/12
 Childs
 Taylor
 Blunker

cont. from page 48

Sta.	H.I.	Rod Ground	Grade cut
4+75	109.16	7.22 101.94	89.27 12.6
5+00		2.24 106.92	94.30 12.6
J.P.	12.76	0.14 109.02	
+25		9.75 112.03	99.34 12.7
+50		7.41 114.37	104.38 10.0
+82.8		5.3 116.5	111.00 5.5
6+00		2.74 119.04	113.83 5.2
J.P.	12.79	0.48 121.30	117.94 3.4
+50		10.99 123.10	122.05 1.1
+75		6.51 127.58	126.16 1.4
7+00		2.29 131.80	130.27 1.5
J.P.	12.55	0.32 133.77	
+25		10.80 135.52	134.38 1.1
+50		4.15 142.17	138.49 3.7
J.P.	12.94	0.40 145.92	
+75		9.56 149.30	142.60 6.7
8+00		1.53 157.33	146.71 10.6
J.P.	12.69	0.00 158.86	
+20 break		8.06 163.49	150.00 13.5
+50		3.06 168.49	153.23 15.3
J.P.	12.84	0.00 171.53	
9+00		10.28 174.11	158.61 15.5

97.42	114.37
8.20	8.99
105.62 H.I.	123.36 H.I.
94.30	111.00
11.32 v	12.36 v
106.92	122.05
9.70	1.31
116.62 H.I.	131.80
104.38	9.38
12.24 v	141.18 H.I.
113.83	130.27
2.79 v	10.91
138.49	157.33
2.69 v	0.30
149.30	157.63 H.I.
13.17 H.I.	146.71 v
162.47	10.92
150.00	168.49
12.47	11.30
	179.79 H.I.
	11.08
5.34	168.74
174.45	153.23 v
158.61	15.51
15.84 v	

cont. on page 54

Mar. 18/12
 Childs
 Taylor 51
 Bunker

Cont. from page 50.

Sta.	H.I.	Rod	Ground	Grade	cut	
7+23.55	82.28	6.8	75.5	67.00	8.5	
+50	78.88	3.4	76.02	66.87	8.6	
+75		2.9	76.0	66.74	9.3	
8+00		3.50	75.38	66.60	8.8	
+25		5.0	73.9	64.89	9.0	
+50		5.9	73.0	63.18	9.8	
+75		7.3	71.6	61.46	10.1	
9+00		9.30	69.58	59.75	9.8	
+25		12.06	66.82	58.03	8.8	
+50	0.24 69.82	9.59	60.23	56.32	3.9	
+83.8		12.22	57.60	54.00	3.6	
10+00	59.28	1.40	57.98	53.48	4.4	
+50		3.1	56.2	51.89	4.3	
11+00		6.24	53.04	50.31	2.7	
+50.7		8.8	50.5	48.70	1.8	

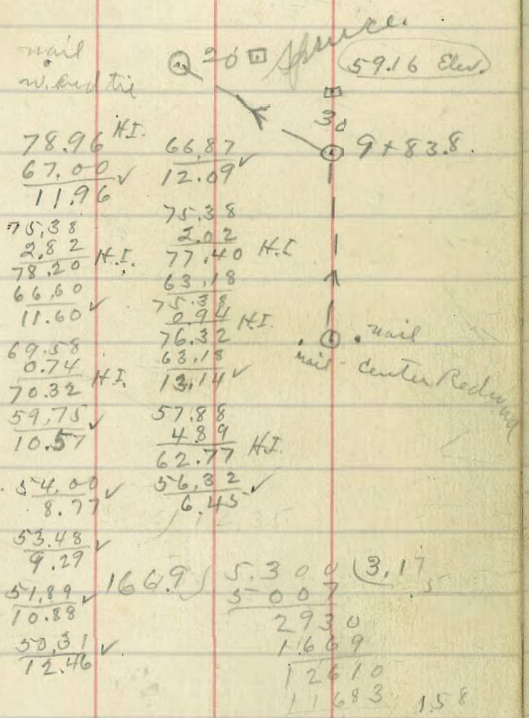

✓ Sewer line center of
India + Columbia from 5' west of east

Mutney + lot line bet.
curb to No. 9 20. line of curb.

John D. ...
Jan 52
Bunker

Sta		H.I.	Rod	Ground	Grade	cut		
J.P.	6.66	106.57		99.91 BM			110.50	102.14
0+00	M.H. center mutney		14.7	91.9	87.00	4.9	2.30	4.62
	+ 5' west of east curb						112.80	106.76 H.I.
+28	of India		9.47	97.10	90.42	6.7	100.68	12.92
	2' offset						12.12	119.91
+50	J.P.	12.23	118.82	-0.02	102.14	4.43	117.38 H.I.	6.42
					106.59	103.84	105.99	126.33 H.I.
1+00					110.50	100.68	11.39	112.25
								114.00
+18	M.H. center mutney		6.1	112.7	103.00	9.7		115.75
	1' east lot line bet.							10.58
+51	India + (California) Columbia		4.56	114.26	103.98	10.3	119.25	117.50
							7.08	8.83
2+01								8.3
								7.10
+51								7.47
								2300
2+01								
J.P.	9.30	124.97						
+51								
3+01	POSTED							
+51								
4+01								
+52								

452
118
334

2 ~~LP~~ Lewis street from Eagle to Falcon.

Feb. 15/12
 Leibold
 Taylor
 Bunker

Sta.		H.I.	Rod	Ground	Grade cut		
J.P.		1.50		268.10		265.29 H.I.	
0+00	M.H. center of Eagle.	269.60	1.5	268.1	254.29 13.8	255.19	
+50			0.90	268.70	254.49 14.2	10.10	
1+00	POSTED		2.75	266.85	254.69 12.2	7.64	254.89
+50			4.7	264.9	254.89 10.0	260.56	13.31
2+00			6.94	262.66	255.09 7.6	268.20 H.I.	
+25			9.04	260.56	255.19 5.4	255.09	266.85
+59.2	M.H. 5 west of east curb of Falcon at Lewis St		11.0	258.6	255.33 3.3	13.11	4.61
						2.16	271.46 H.I.
						269.30	4.48
						254.49	267.02
						14.81	254.69
							12.33

5

cut. from Page 49

Sta.	H.I.	Rod	Ground	Grade	cut		
	184.39					7.21	179.79
9+50		4.83	179.56	164.00	15.6		
10+00		0.42	183.97	169.38	14.6		
	8.15		192.12				
+15	M.H. 5' no. center	7.0	185.1	171.00	14.1		
	@live						
+50		6.4	185.7	171.70	14.0		
11+00		6.11	186.01	172.70	13.3		
+50		5.75	186.37	173.70	12.7		
+65	F.I. about 15'	5.5	186.6	174.00	12.6		
	no. center @live						

82.8
23.5
817.8

L.V.D. P. 1/2

Sever in alley bet. Brant + albatross
 from bottom of canyon to Washington

Feb. 19/12

Childs
 Taylor 50
 Brinker

Sta	H.I.	Rod	Ground	Grade	cut		
J.P.						110	264.46 BM
0+00	228.71	14.4	214.3	208.8	6.3	216.30	12.83
+25		12.4	216.30	214.25	2.0	8.33	277.29 HI
+50		5.2	223.5	220.50	3.0	224.63 HI	11.75
+75	241.24	7.43	233.81	229.93	3.9	220.50	256.38
1+00	253.80	9.46	244.34	239.36	5.0	4.13	0.77
+25	266.31	9.93	256.38	248.80	7.6	244.34	257.15 HI
+50	277.29	11.75	265.54	258.23	7.3	0.42	248.80
+60		11.0	266.3	262.00	4.3	244.76 HI	8.33
2+00		9.3	268.0	263.39	4.6	239.36	253.64 SP
+46.24		8.1	269.2	265.00	4.2	239.36	270.60
+50		7.9	269.4	265.04	4.4	5.40	284
3+00		6.65	270.64	265.51	5.1	273.48 HI	0.76
+50		5.3	272.0	265.97	6.0	273.48 HI	253.80 HI
4+00		4.9	272.4	266.44	6.0	263.39	12.56
+50		3.93	273.36	266.90	6.5	263.39	247.29 SP
5+00		4.7	272.6	267.37	5.2	8.48	0.00

POSTED

M.H. Center alley
 bet. Univ. &
 Douglas

Handwritten calculations and notes on the right side of the page, including various numbers and small annotations like 'HI', 'SP', and 'BM'.

~~27~~

cont. from page 55

Sta.	H.I.	Rod	Ground	Grade	cut
5450	277.29	4.2	273.1	267.84	5.3
+69.3			272.7	268.03	
+50		3.91	273.38	268.77	4.6
+75		3.2	274.1	269.00	5.1

F.I. center of
both alleys

F.I.

Feb 21/12
Shields
Taylor 56
Parker

277.41	H.I.
267.84	✓
9.57	
268.03	
9.38	✓

93
1860

67
206
428

Brant Street from M.H.

Sta.		H.T.	Ground
J.P.	12.58	214.56	201.99
0+00	M.H. bottom of		11.5 203.1
+25	campus & center of Brant		12.18 202.38
+50			6.11 208.45
+75			1.33 213.23
J.P.	12.34	225.57	4.08 221.49
1+00			0.08 225.49
J.P.	12.69	238.18	7.06 231.12
+25			
+50			1.04 237.14
J.P.	10.04	247.18	6.64 240.54
+70	deadend		

Feb. 23/12
 bottom of campus
 University
 Childs
 Taylor
 Brunker
 5th

Grade cut.		
240.54		231.12
1.08		0.96
241.62		232.08 H.I.
233.03		223.14
8.59 ✓		8.94 ✓
213.23		96.56
1.90		202.39
215.13 H.I.		6.96
211.07 ✓		209.34 H.I.
4.06		199.00 ✓
		10.34 ✓
217.10	4.4	
223.14	8.0	
229.17	8.0	
234.00	6.5	

Cont. from page 59.

Mar. 1/12 } Childs
 Taylor 60
 Bunker.

Sta.	H.T.	Rod	Ground	Grade	cut.		
7+00	139.86	1.90	137.96	130.69	7.3	137.96	
						5.80	
						143.76	H.T. 130.69
						134.00	73.07
						9.76	138.01
						155.68	5.70
+28.38	M.H. center of 1263	0.72	139.14	134.00	5.1	144	H.T. 161.71
J.P.	State 7 192.70	6.48	145.29	138.01	7.3	157.12	4.79
+50	center of Quise	2.22	149.55	142.65	6.9	147.28	168.50 H.T.
		0.00	151.77			9.84	156.55
+75		8.87	155.68	147.28	8.4	165.82	11.95
J.P.	12.78 164.53	7.1	157.5	151.92	5.6	2.68	
8+00		2.84	161.71	156.65	5.2	177.70	
		0.25	164.30			1.11	
+25		10.7	166.7	161.19	5.5	178.81	H.T.
		5.71	171.67	165.82	5.9	171.39	
+50	13.08 177.38	0.00	177.38			7.42	
J.P.		12.18	177.70	171.39	6.3		
+75		1.93	187.95	175.10	12.9		
9+00		0.30	189.58				
J.P.	12.50 189.88	1.48	199.50	179.74	19.8		
+30		0.61	200.37	185.00	15.4		
+50							
J.P.	11.40 200.98						
+75							
10+03.4	M.H. center of union 7 192.7 So. center Quise						

1250

Leaving line from main line to
then to Fort Stockton.

Sunset Blvd. and
mar. 4/12

Chillico
Taylor 62
Bisher

Sta.	H.T.	Rod	Ground	Grade	cut
0+00	m.H. main camp	202.78	11.68	191.10	186.00 5.1
+25	line 3' offset		8.45	194.33	188.16 6.1
+50			6.4	196.4	190.31 6.1
+75	POSTED		5.27	197.51	192.47 5.0
1+00			2.71	200.07	194.62 5.5
+25			0.45	202.33	196.78 5.5
S.P.	12.49	214.82			
+50			11.2	203.6	198.93 4.7
+75			7.98	206.84	201.09 5.7
2+00			8.9	205.9	203.25 2.7
+25			4.03	210.79	205.41 5.4
S.P.	12.59	217.40	0.01	214.81	
+55	m.H. angle.		12.55	214.85	208.00 6.9
+75			12.7	214.7	210.19 4.5
3+00			7.54	219.86	212.93 7.0
+25			6.0	221.4	215.67 5.7
+50			5.27	222.13	218.41 3.7
+75			1.71	225.69	221.16 4.5

230.45 H.T.	210.79
218.41	5.45
12.04	216.24 H.T.
210.79	208.00
7.71	8.24
218.50 H.T.	205.41
212.93	10.83
5.57	202.33
206.84	0.88
5.92	203.21 H.T.
212.76 H.T.	196.78
201.09	6.43
11.67	194.62
190.31	8.59
12.90	

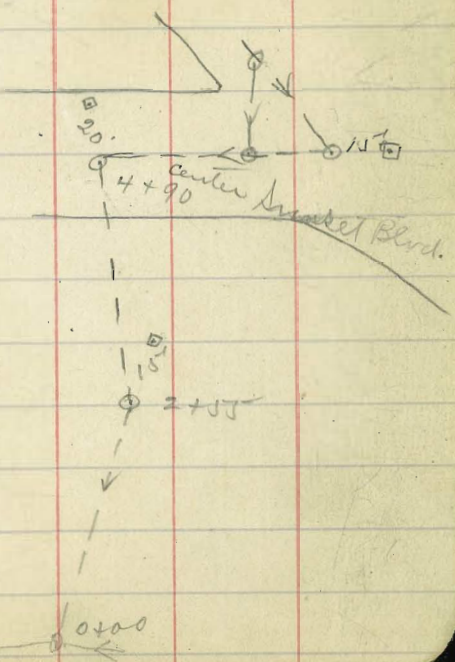

✓

cont. from page 62

Mar. 5/12 } Childs
Taylor
Bunker 65

Sta.	H.I.	Rod	Ground	Grade	Cut.
J.P. 4+00	12.02	237.71	7.33	230.38	223.90 6.6
+10 break			3.51	234.20	225.00 9.2
J.P. +25	12.98	250.40	0.29	237.42	228.28 13.9
J.P. +50	11.70	261.99	0.11	250.19	233.75 23.6
+90			4.69	257.30	{ 242.50 14.9 248.50 8.9
5+00			4.20	257.79	248.54 9.4
+50		0.4% grade	2.8	259.2	248.74 10.6
6+00			0.87	261.12	248.94 12.3
J.P. +50	0.93	267.05	4.75	262.30	249.14 13.3
7+00			4.07	262.98	249.34 13.8
6+15		266.98	5.5	261.5	249.00 12.5
+50			4.4	262.6	249.31 13.3
+91.7			3.9	263.1	249.69 13.4

≡ Sta. 1+15 on
fit stockton line
See page 69

230.38	230.38
0.07	1.90
230.45 - H.I.	232.28 H.I.
223.90	225.00
6.55 ✓	7.28 ✓
237.32	
6.12	
263.44 H.I.	
242.50	
20.94	
5.12 ✓	3.84
15.82	262.83
257.32	4.68 249.31 ✓
9.35	261.99 13.52
266.67 H.I.	249.00
7.03	12.99
259.64	3.39
248.74 ✓	263.29
10.90	249.69
	13.60 ✓

Side canyon from main line to Sheridan &
 on Sheridan to alley bet. Sunset & Sheridan

Mar. 5/12
 Childs
 Taylor 64
 Banker

Sta.		H.I.	Rod	Ground	Grade	Cut			
0+00	M.H. main canyon	194.64	12.25	192.39	178.00	4.4	232.85	210.80	208.00
J.P.	line sta 21+66.8	197.44		184.41			0.36	7.77	10.57
+25	2' offset	13.03	13.5	183.9	181.75	2.2	233.21	218.57	
+50	POSTED		9.0.2	188.42	185.50	2.9	223.00	215.50	
+75			5.6	191.8	189.25	2.6	10.21	3.07	
1+00			2.88	194.56	193.00	1.6	202.39	193.00	
J.P.	13.20	209.67	0.97	196.47			1.30	10.69	
+25			12.1	197.6	196.75	0.9	503.69		5+31.7
+50			7.28	202.39	200.50	1.9	200.50		
+75			4.70	204.97	204.25	0.7	3.19		
J.P.	13.00	222.12	0.58	209.12			188.42	178.00	
2+00			11.32	210.80	208.00	2.8	189.43	11.43	
+25			4.99	217.1	211.75	5.4	185.50	237.73	
+50			0.27	221.85	215.50	6.3	3.93	0.45	
+75			6.55	227.62	219.25	8.3	264.62	238.18	
3+00			1.22	232.85	223.00	9.8	260.68	226.75	
J.P.	13.09	245.94					244.00	17.43	
+25	break		8.21	237.73	226.75	11.0	16.68		
+50			11.79	247.10	236.50	10.6			
+75			4.78	259.47					
4+00	M.H. in Sheridan		4.4	259.9	244.00	15.9			

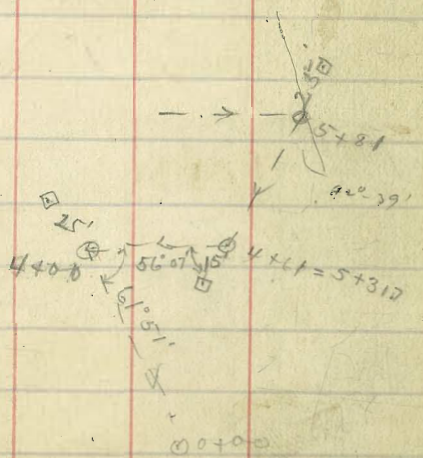

cont. from page 64

Sta.	H.I.	Rod	Ground	Grade cut
4+50	264.25	4.78	259.47	254.37 ✓ 5.1
5+00		4.15	260.10	254.78 ✓ 5.4
+317 M.H. in	265.18	4.61	260.57	255.00 ✓ 5.6
5+70.2 Sheridan		4.10	261.08	255.98 ✓ 5.1
6+20.7		3.22	261.96	257.23 ✓ 4.8
+517 M.H. center alley bet. Sheridan & Sunset.		2.93	262.25	258.00 ✓ 4.3

near 8/12
 Childs
 Taylor 65
 Bunker

259.47	254.75
5.15	9.87 ✓
264.62 H.I.	255.00 ✓
254.37 ✓	9.62 ✓
10.25	
261.08	257.23 ✓
6.28 H.I.	10.13 ✓
267.36	
255.98 ✓	258.00 ✓
11.38	9.36

651.7
 521.7
 1200

✓
1

Stephens Street from
to Stockton

center of Boone

Mar. 6/12

Blill's
Taylor 68
Bunker

Sta.		H.I.	Rod	Ground	Grade	Cut		
0+00	M.H. Center of Boone & Stephens	264.82	0.16	264.16	253.30	10.9	218.58 3.87 222.45	263.21 2.05 265.26 254.48 10.78
+50			3.43	260.89	253.10	7.8	209.00 12.76 219.36 2.40	258.00 7.26
+75	break		7.07	257.25	253.00	4.3	244.54 12.5	
1+00	POSTED	252.81	1.30	251.51	244.86	6.6	246.09 H.I. 236.92	30' R. roadway
+25		12.89	8.78	244.03	236.72	7.3	9.17 259.06	
+50		240.09	3.21	236.88	228.58	8.3	6.20 218.58 12.4	3' 15" Center Lewis
+75		227.73	0.53	227.20	220.44	6.8	219.72 H.I. 309.04 10.88	12.30 7.62
2+00			9.15	218.58	212.30	6.3	236.89	
+10	break	222.53	11.8	210.7	209.04	1.6	2.15	
+20.5	M.H. bottom of Canyon mainline	227.73	12.48	215.25	209.00	6.3	239.03 H.I. 228.59	20' center alley
+50		6.17	3.6	224.1	219.36	4.7	10.45 251.57 6.49	
+75			11.87	234.33	228.14	6.2	257.80 H.I. 244.86 12.94	
3+00			1.36	244.84	236.92	7.9	253.00	mainline
J.P.		12.93	257.77				4.80	
+25			2.32	255.45	245.70	9.8	253.10	
J.P.		12.56	270.02	0.31	257.46		4.70	
+50			7.8	262.2	254.48	7.7		
+60	break		6.81	263.21	258.00	5.2		center Boone
4+00			4.30	265.72	259.06	6.6		15'

Cont. from page 66

Sta	H.I	Rod	Ground	Grade	cut
4+50	270.02	4.3	265.7	260.38	5.3
5+00		3.85	266.17	261.70	4.5
750		1.9	268.1	263.02	5.1
6+00		0.15	269.87	264.34	5.6
J.P.	11.48	281.35			
+25.13		10.6	270.8	265.00	5.8
M.H. Centerally bet. Lewis & Fr. Street		9.7	271.7	265.57	6.1
+50		7.83	273.52	266.71	6.8
7+00		6.0	275.4	267.85	7.6
+50		5.2	276.2	269.00	7.2
8+00	M.H. Center of Lewis	4.09	277.26	269.20	8.1
+50		3.1	278.3	269.40	8.9
9+00		4.24	277.11	269.60	7.5
+50		5.3	276.1	269.80	6.3
10+00		6.94	274.41	270.00	4.4
+50		8.4	273.0	270.20	2.8
11+00		7.25	274.10	270.40	3.7
+50		6.8	274.6	270.45	4.2
+63.2	M.H. Center of Broadway				

Mar 7/120 Bluffs
Taylor 66
Bunker

27636					
4.99					
265.26	H.I.	266.17			
260.38		5.87			
4.88		272.04	H.I.		
263.02		261.70			
9.02		10.34			
264.34		265.00		266.71	
7.70		7.04		5.33	
273.52					
6.83		269.0		269.20	
280.35	H.I.	11.35		11.15	
267.85		269.40		269.60	
12.50		10.95		10.75	
277.11					
29.2	H.I.	270.00		270.20	270.40
280.03		10.02		9.83	9.63
269.80		270.45			
10.23		9.58			

Cont. from page 67

Sta.	H.I.	Rod	Ground	Grade	cut
12+00	281.35	5.3	276.1	270.60	5.5
+50		4.30	277.05	270.80	6.3
13+00		4.7	276.7	271.00	5.7
+50		5.1	276.3	271.20	5.1
14+00		5.6	275.8	271.40	4.4
+50		4.67	276.68	271.60	5.1
+87.5	F.I. A. line of Stockton	3.6	277.8	271.75	6.0

Mar. 7/12
Lehille
Taylor
Pember

277.05	270.80
4.53	10.78
281.58 HI	
270.60	271.00
10.98	10.58
271.20	271.40
10.38	10.18
277.05	271.75
3.80	9.83
280.85 HI	
271.60	
9.25	

cont. from page 69

Sta.	H.I.	Rod	Invert	Grade	Cut
7+00	276.93	3.38	273.55	257.44	22.1
+50		4.6	272.3	257.59	20.7
8+00		5.68	271.25	257.74	19.5
+50		7.1	269.8	251.89	17.9
9+00		8.28	268.65	252.04	16.6
+50	3' offset	9.40	267.53	252.19	15.3
+58.9	M.H. center alley 7.114 dist to center	9.89	267.04	252.22	14.8
10+00	gully in vista	1.48	266.50	252.34	14.2
+50	2' offset	2.7	265.3	252.49	12.8
+96.5	min.	3.7	264.3	252.64	11.7
11+00		5.0	263.0	252.79	10.2
12+00		5.98	262.00	252.94	9.1
+48.5	M.H. center alley bet. Harvard & order way.	7.4	260.16	253.09	7.5
13+00		8.27	259.71	253.24	6.5
+07.3	M.H. center of Hickory.	8.51	259.47	253.26	6.2
+50		8.8	259.5	253.39	6.1
+76.6	min.				

Mar. 12/12

Builds
Rayburn
Bunker

278.40 H.I.	271.25	
42.1	123.49	
274.19	274.74 H.I.	5.0
251.44	1.64	266.50
22.75		262.42
262.00	273.10	268.92 H.I.
2.80	251.59	1.22
264.80 H.I.	21.51	267.65
252.94	3.28	252.34
11.86	271.46	15.31
253.09	19.72	3.26
11.71	251.74	265.66
259.71	3.74	252.49
4.70 H.I.	271.00	13.17
264.41	251.89	3.59
252.26	19.11	265.33
11.15	5.23	252.64
253.39	269.57	12.69
11.02	252.04	5.54
	17.47	263.38
	6.1	252.79
	268.33	10.59
	252.22	
	16.11	

Mar. 13/12

Childs
Taylor
Bunker

Cont. from page 70.

Sta.	H.I.	Rod	Ground	Grade	cut	264.41 H.I.	262.62	1307.3
14+00	<u>267.98</u>	8.3	259.7	253.54 [✓]	6.2	253.54 [✓]	8.70	371.3
+50		7.8	260.2	253.69 [✓]	6.5	10.87	271.32 ^{KT}	1674.4
15+00		7.22	260.76	253.84 [✓]	7.0	253.69	11.12	
+50		6.6	261.4	253.99 [✓]	7.4	10.72 [✓]	260.2	
about 15+948 m.w.		6.1	261.9	254.14 [✓]	7.8	253.84 [✓]	253.99	254.14
16+00		5.55	262.43	254.29 [✓]	8.1	10.42	10.42	10.27 [✓]
+50		5.36	262.62	254.37	8.2	10.57	254.37	
+786 m.H. center of Pine street						254.29 [✓]	10.12	10.04

$$\begin{array}{r} 1678.6 \\ 1307.3 \\ \hline 371.3 \end{array}$$

✓ Alley line bet. Sunset.
 from Hermosa way to Howard.

Blvd. + Ft. Stockton

Mar. 15/12

Schilder
 Taylor
 Bunker

Sta.		H.I.	Rod	Ground	Grade cut			
J.P.		9.13	274.98				266.26	
0+00	M.H. Center Hermosa way + Ft. Stockton		9.5	265.85	259.00	6.5	271.68	265.83
+50			8.72	266.26	260.57	5.7	260.55	266.91
1+00	POSTED		8.5	266.5	262.16	4.3	262.16	274.34
+50			6.7	268.3	263.74	4.6	263.74	274.34
2+00			3.64	271.34	265.33	6.0	263.74	274.34
+50			0.64	274.34	266.91	7.4	263.74	274.34
J.P.		10.23	284.57				263.74	274.34
3+00			8.6	276.0	268.50	7.5	263.74	274.34
+47.5	M.H.		6.1	278.5	270.00	8.5	263.74	274.34
4+00			3.55	281.02	270.26	10.7	263.74	274.34
+25			4.6	280.0	270.38	9.6	263.74	274.34
+50			8.32	276.25	270.51	5.8	263.74	274.34
5+00			10.5	274.1	270.76	3.3	263.74	274.34
+50			11.05	273.52	271.01	2.5	263.74	274.34
6+00			10.1	274.5	271.26	3.2	263.74	274.34
+50			9.1	275.5	271.51	4.0	263.74	274.34
7+00			7.95	276.62	271.76	4.8	263.74	274.34
+47.5	F.S.		7.63	276.94	272.00	4.9	263.74	274.34

Boone street line from center of Stephens mar. 25/12
 to Pringle. } Schillo
 Taylor
 Bunker

Sta.	HT.	Rod	Ground	Grade	cut	
J.P. 0 + 00 m.H. Center of Stephens.	4.05 265.71	1.58	261.66 B.M. 264.13	253.30	10.9	261.66 4.94 253.50 13.07 266.57 HT 20.66 3.24 264.90 HT 253.92 10.98
+50		4.6	261.1	253.50	7.6	265.05 253.30 11.75
1 + 00 +50 (100 m.H.)	POSTED	4.8	260.9	253.70	7.2	254.10 10.50 254.30 10.60 254.70 10.20
+50		5.85	259.96	253.90	6.0	253.70 11.20 266.28 HT 254.90
+55 m.H.		5.7	260.0	253.92	6.1	11.38
2 + 00		5.5	260.2	254.10	6.1	254.18 3.98 266.16 HT 255.11 11.05
+50		5.62	260.09	254.30	5.8	255.30 10.86
+92.2 m.H. at Portala		5.6	260.1	254.49	5.6	255.70 10.66
3 + 50		6.3	259.4	254.70	4.7	255.86 10.39
4 + 00 +47.2 m.H.		6.50	259.21	254.90	4.3	256.05 9.61
+52.2 m.H. Boone		5.7	260.0	255.11	4.9	
5 + 00		5.71	260.00	255.30	4.7	
+50 +52.2 m.H.		4.3	261.4	255.50	5.9	
6 + 00		3.53	262.18	255.70	6.5	
+40 m.H.		3.6	262.1	255.86	6.2	
+50		3.2	262.5	256.09	6.4	

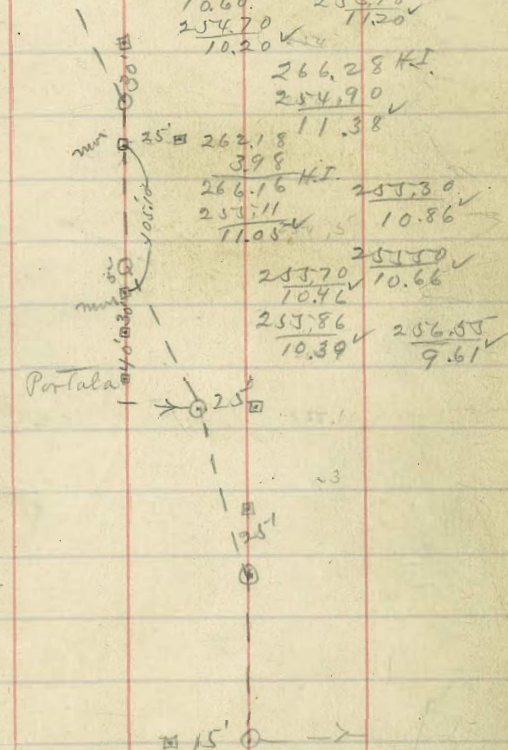

cont. from page 73

Sta.	H.I.	Rod	Ground	Grade cut
7+00	265.71			
JR.	3.77	267.01	2117	263.24
+50			3.0	264.0
+75			2.66	264.35
				259.00

Mar. 25/12
 Lehibbs
 Taylor 74
 Bunker

266.16 H.I.	258.41 ✓
257.25 ✓	7.75
8.91 ✓	259.00 ✓
	7.16

1.16
 332

1912

Mar. 25/12
 Toluid
 Taylor 75
 Bunker

Potata Street from Boone 200' South.

Sta.	H.I.	Rod	Ground	Grade	cut	
0+00 MH. in Boone	265.71	5.6	260.1	254.49	5.6	260.97 5.31 266.28 H.I. 257.75 8.53
+50		4.74	260.97	256.12	4.9	256.12 ✓ 259.37 ✓ 10.16 6.91
1+00 (401 mm)		3.1	262.6	257.75	4.9	261.0 ✓ 5.28
+50		1.80	263.91	259.37	4.5	
2+00 dead end.		-0.3	266.0	261.00	5.0	

POSTED

2. Arctic Street from 25' no. Palm to Willow
 (20.5 east of center)

Mar. 21/20 Childs
 Taylor 78
 Barber

Sta.	H.I.	Rod	Ground	Grade	cut		
J.P.	1.92	69.74	67.82			63.94	
0+00	F.I. 25' no. of Palm 20.5 east of center of Arctic	3.6	66.1	53.00	13.1	8.21 72.15 5.08 67.07 52.80 14.27	54.5 66.70 53.00 13.70
+50		2.3	67.4	52.80	14.6	63.94 12.4 65.18 52.38 12.80	6.20 65.98 52.60 13.35
1+00		3.7	66.0	52.60	13.4	52.00 13.18	52.20 12.98
+50	POSTED	5.80	63.94	52.40	11.5	62.74 2.07 64.81 51.74	51.60 13.21
2+00		6.5	63.2	52.20	11.0	13.07 62.74 1.69	
+50		6.6	63.1	52.00	11.1	64.43 51.40 13.03	64.22 4.22 68.44 4.04
3+00		7.00	62.74	51.80	10.9	64.22 4.18 68.40 3.43	64.40 51.20 13.20
+15.5 m.H. center of Quince		7.2	62.5	51.74	10.8	64.95 51.00 13.95	
+50		6.7	63.0	51.60	11.4	3.64 64.76	
4+00		5.5	64.2	51.40	12.8	52.80 13.96	
+50		5.52	64.22	51.20	13.0	4.73 63.67	
5+00		5.2	64.5	51.00	13.5	50.60 13.07	
+50		5.1	64.6	50.80	13.8	4.56 63.84	
6+00		6.2	63.5	50.60	12.9	50.40 13.44	
+50		6.28	63.46	50.40	13.1	3.89 64.57	
6+96.15 m.H. center of Redwood		5.4	64.3	50.22	14.1	50.22 14.29	
7+00		5.4	64.3	50.20	14.1		

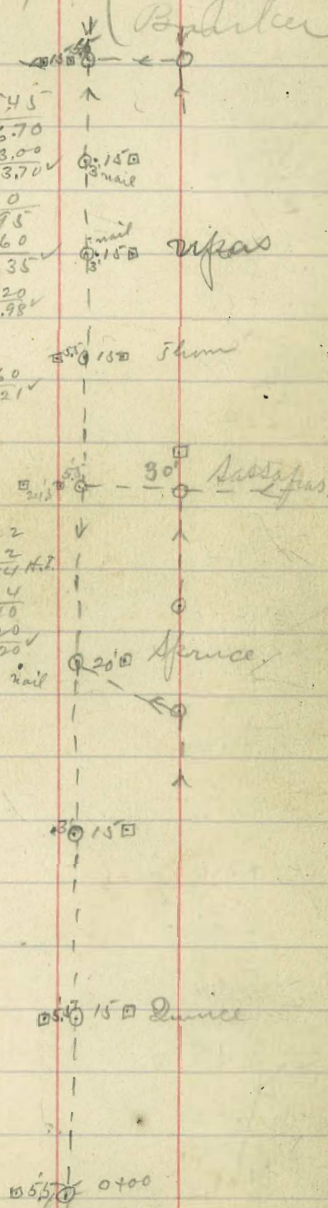

cont. from page 76

Sta.	H.I.	Rod	Ground	Grade	cut
7+50	<u>69.74</u>	6.0	63.7	50.00 [✓]	13.7
8+00		6.67	63.07	49.80 [✓]	13.3
+50		6.6	63.1	49.60 [✓]	13.5
9+00		10.0	59.7	49.40 [✓]	10.3
+25		11.93	57.81	49.30	8.5
J.P.	147	<u>59.28</u>			
+50		4.1	55.2	49.20 [✓]	6.0
+75		7.2	52.1	49.10	3.0
10+00		8.1	51.2	49.00 [✓]	2.2
+25		8.4	50.9	48.90	2.0
+50		8.2	51.1	48.80 [✓]	2.3
+76.3	M.H. center of spruce.	8.8	50.5	48.70 [✓]	1.8
11+00		8.5	50.8	48.26 [✓]	2.5
+25		5.58	53.70	47.79 [✓]	5.9
+50		4.6	54.7	47.33 [✓]	7.4
12+00		6.7	53.6	46.40 [✓]	7.2
+50		6.27	53.01	45.48 [✓]	7.5
13+00		6.1	53.2	44.55 [✓]	8.7
+50		6.2	53.1	43.63 [✓]	9.5

Mar. 22/12 *Blind Taylor*
Bulker

68.40 H.I.	57.81	H.I. 48.70
4.43	2.25	11.36
63.97	60.06	49.40
50.00	49.40	10.66 [✓]
13.97 [✓]	49.20	48.26 [✓]
4.92	10.86 [✓]	71.80
63.48	49.00 [✓]	
49.80	11.06 [✓]	
13.68 [✓]	48.80	
5.01	11.26 [✓]	
63.39	7.050 (1.85)	
49.60	38.07	
13.79	32.430	
63.70	30.456	12.96 [✓]
4.36 H.I.	19.740	
58.06 H.I.	17.030	
47.33 [✓]	7.050	
10.73	53.59 H.I.	
	43.63 [✓]	44.55 [✓]
	9.96	9.04
	45.48 [✓]	46.40 [✓]
	8.11	7.19

Jun. 29/12 } Childs
 Taylor
 Brainerd 78

Cont. from page 77

Sta.	H.L.	Rod	Ground	Grade	cut			
14+00	<u>59.28</u>	7.06	52.22	42.70	9.5	48.70	48.70	42.70 ✓
+50		9.0	50.3	41.78	8.5	56.5	48.9	10.89 ✓
+57	M.H. Center of Sassafras.	7.99	51.29	41.65	9.6	54.35	41.65	11.94 ✓
15+00		9.0	50.3	40.85	9.5	41.65	41.78	40.85 ✓
+50		10.58	48.70	39.92	8.8	70	11.81	12.74 ✓
J.P.	1.50	<u>50.20</u>				43.91		
16+00		3.7	46.5	39.00	7.5	2.13		
+50		4.8	45.4	38.08	7.3	46.04		
17+00		6.29	43.91	37.15	6.8	39.92	39.00	38.08 ✓
+50		8.0	42.2	36.22	6.0	6.12	7.04	7.96 ✓
18+00		9.72	40.48	35.30	5.2	37.15	36.22	35.30 ✓
+37.8	M.H. center of Thorn.	10.41	39.79	34.60	5.2	8.89	9.82	10.74 ✓
+50		10.3	39.9	34.54	5.4	34.60		
19+00		11.5	38.7	34.34	4.4	44.55		
+50		12.02	38.18	34.14	4.0	0.67		
20+00		11.9	38.3	33.94	4.4	45.22	33.54	33.74 ✓
+50		9.6	40.6	33.74	6.9	33.33	11.68	11.48 ✓
21+00		9.21	40.99	33.54	7.5	11.89		
+50		8.4	41.8	33.33	8.5	34.14	34.34	34.54 ✓

levit. from page 78

Sta.		H.I.	Rod	Ground	Grade	cut
22+00		50.20	5.65	44.55	33.13	11.4
J.P.	2.06	46.61				
+18.4	M.H. center of		2.0	44.6	33.06	11.5
+50	Upas.		1.58	45.03	32.93	12.1
23+00			2.9	43.7	32.73	11.0
+50			3.9	42.7	32.53	10.2
24+00			6.44	40.17	32.33	7.9
+50			8.9	37.7	32.13	5.6
25+00			7.2	39.4	31.93	7.5
+50			5.62	40.99	31.72	9.3
+99	M.H. center of		5.8	40.8	31.52	9.3
	Vine.		6.5	40.1	31.32	8.8
26+50						
27+00			5.80	40.81	31.12	9.7
J.P.	2.04	42.85				
+50			2.4	40.5	30.92	9.6
28+00			4.1	38.8	30.72	8.1
+50			5.04	37.81	30.52	7.3
29+00			5.1	37.8	30.32	7.5
+50			4.46	38.39	30.12	8.3
+79.6	M.H. center of willow		3.47	39.38	30.00	9.4

Mar. 29/12 } blields
Taylor 79
Barker

45.22 H.I.						
33.06		33.13				
12.16		12.09				
32.93	32.73	32.53				
12.29	12.49	12.69				
32.33	40.17					
12.89	3.18					
	43.35 H.I.					
	32.13	31.93				
	11.22	11.42				
31.72	31.52	31.32	31.12			
11.63	11.83	12.03	12.23			
30.92	30.72	37.81				
12.43	12.63	4.64				
		42.45 H.I.				
30.32	30.12	30.52				
12.13	12.33	11.93				
30.00						
12.45						

✓ Lot line bet. arctic & India
of Sassafras to 25' North of

Sta.		H.I.	Red	Ground
J.P. 0+00	mt. center	66.90	6.04	60.86
+25	of Sassafras.		3.89	63.01
+50	3' offset west		3.3	63.6
1+00			2.3	64.6
+50			2.72	64.18
2+00			3.5	63.4
+50			3.5	63.4
3+00			2.45	64.45
+15.5	dead end.		1.6	65.3

POSTED

Mar. 22/124 Childs
from center
Spruce.

Grade	cut				
56.00	4.9	63.01	2.77	31.55	5000 01.586
56.40	6.6	65.78	56.79		31.55
56.79	6.8	8.99	57.58		18.450
57.58	7.0	8.20	64.18		15.775
58.37	5.8	59.16	4.05		2475.01
59.16	4.2	9.07	68.23		20240
59.95	3.5	59.95	58.37		
60.75	3.7	8.28	9.86		
61.00	4.3	61.00	7.48		

265.16
5.20
273.46
4.78
268.68

14065
10934
351.1

25972
25533
351.1 / 4.390 (125)
351.1

8790
2022
17680
17535

1.25
4.6
750
500
25750

125
465
625
750
58125

62

6345 / 115

16/60 18
75 126 140.6 / 60000 (4.26)
5624

32 16.5 4.26
30 160 9.4
960 9900 1704
126 165 3834
108626400 40044

3760
2812
9480
8436
10440

11.00 114.32 / 50000 (4.375)
45728

1.06

22005 2800 42720
280 34296
2450 84240
437 80024
9.4 42160

12583 / 50000 (3.97)
37749
122510
113247

43560 1748 2.18
3933 8.97 126.6 / 70000 (5.53)
4041078 20.1
1742400 1320 397

6330
6700
6330
3700

74 794
69 79797 5.53
125.7 / 7000 3566 1106
6285 190 4977 128.1 / 9000 (7.9)
27150 553
16283 106176

8967
3300

150 8630.51 17.7
467 754275 7.02
1295 14.55 278 354
1110 5.57 1239

740 10185
86395 7275 124254
7275
810435

12408000 (6.40)
750
500 46
500 23

4.67 13.85 13.85
15 64 15.49
2335 5540 11080
467 8310 5340
7005 98640 6925

127.65 / 70000 5.48 58980
63828

61780 274 126.2 / 7000 (5.52)
51060 137 6310 11.2

1283 / 6000 (4.67) 06900 1.39
5140
8600 466
7710 234
8900 117
8995

6900 110.8
6310 5.4
59584
62048

