

F.B.  
828

LEVEL BOOK

No. 410

MICROFILMED

DEC 15 1964

116.10 SE Cave-Exchange  
183.259 mm - NW State - Tetanus

3pk  
24825

27.68  
1.50  
26.18

27.68  
4.57  
23.11  
22.165  
68.20  
4.00



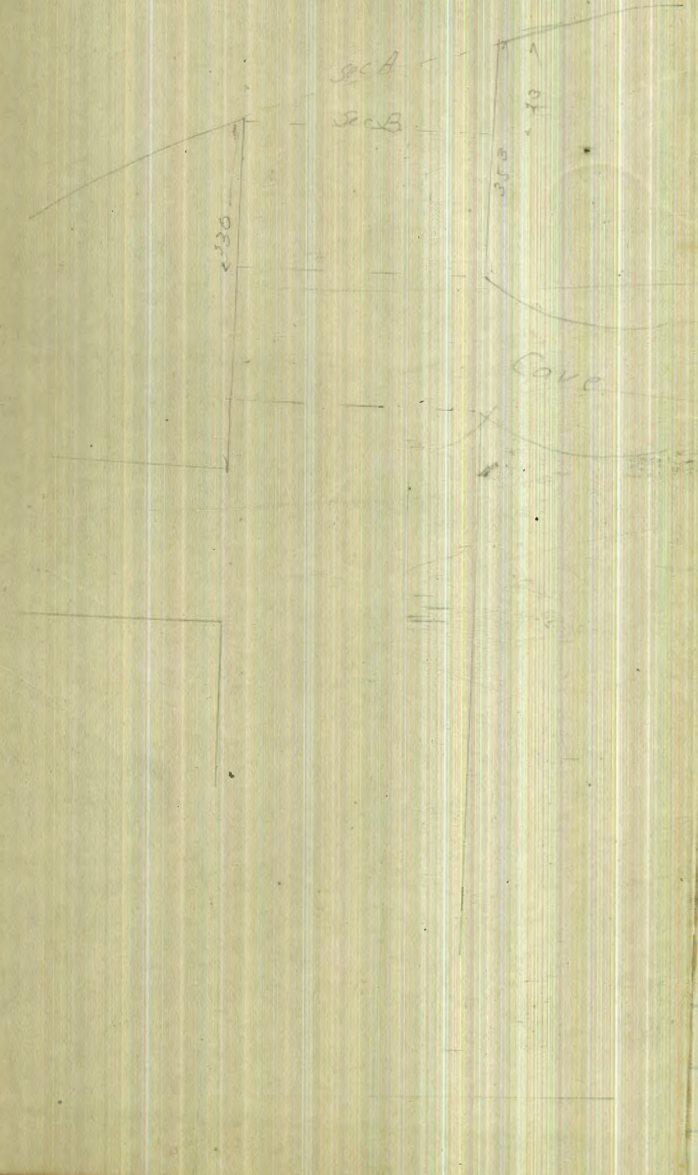

3/1 Hotel  
13/11/18  
12 Hall Prospect to State  
20' Curbs, 10' quarters

BM			133.259	State - Jettin
BM	303	119.13	116.10	Mon-AW Spk SE Curbs Exchange
	473	113.80	109.07	
St. Prospect (Sec A)				
W			75	106.3
cb			80	105.8
1/4			82	105.6
c			83	105.5
1/4			83	105.5
cb			82	105.6
E			77	106.1
Sec B				
E			68	107.0
d			71	106.7
1/4			73	106.5
c			73	106.5
1/4			77	106.1
d			77	106.1
v			75	106.3

11380

300' N of Cave.

W	6.8	107.0
cb	6.9	106.9
1/2	7.1	106.7
S	6.7	107.1
1/2	6.7	107.1
cb	6.4	107.4
E	6.0	107.8

275' N

E	5.7	108.1
cb	5.9	107.9
1/2	6.2	107.6
c	6.2	107.6
1/4	6.4	107.4
cb	6.3	107.5
W	6.2	107.6

250' N

W	6.2	107.6
cb	6.0	107.8

11380

2

1/2	6.1	107.7
c	5.9	107.9
1/2	5.9	107.9
cb	5.7	108.1
E	5.5	108.3

225' N

E	5.2	108.6
cb	5.6	108.2
1/2	5.9	108.1
c	5.6	108.2
1/4	5.9	107.9
cb	5.9	107.9
W	6.0	107.8

200' N

W	5.9	107.9
cb	5.8	108.0
1/2	5.7	108.1
c	5.5	108.3
1/4	5.5	108.3

113.80

cb 53 108.5

E 50 108.8

175' N

E 45 109.3

cb 49 108.9

1/2 48 109.0

c 52 108.6

1/4 56 108.2

cb 55 108.3

W 57 108.1

150' N

W 56 108.2

cb 54 108.4

1/2 54 108.4

c 49 108.9

1/2 50 108.8

cb 49 108.9

E 45 109.3

113.80

125' N

E 4.2 108.6

cb 48 109.0

1/2 4.9 108.9

c 4.7 109.1

1/2 5.3 108.5

cb 5.3 108.5

W 5.5 108.3

100' N

W 5.5 108.3

cb 5.3 108.5

1/2 5.1 108.7

c 4.9 108.9

1/2 4.7 109.1

cb 4.7 109.1

E 4.1 109.7

75' N

E 4.0 109.8

cb 4.7 109.1

11380

1/2	4.7	109.1
c	4.7	109.1
1/2	5.2	108.6
cb	5.2	108.6
W	5.3	108.5

50 N

W	5.4	108.4
cb	5.1	108.7
1/2	5.0	108.8
c	4.8	109.0
1/2	4.6	109.2
cb	4.8	109.0
E	4.0	109.8

25 W

F	4.3	109.5
cb	4.3	109.5
1/2	4.1	109.7
c	4.6	109.2
1/2	5.2	108.6

11380

cb	5.3	108.5
W	5.4	108.4
N. Cave St.		
W	5.4	108.4
cb	5.1	108.7

1/2	5.2	108.6
c	4.8	109.0
1/2	4.8	109.0
cb	4.8	109.0
E	4.5	109.3

Ncb

E	4.6	109.2
cb	5.1	108.7
1/2	5.0	108.8
c	5.1	108.7
1/2	5.1	108.7
cb	5.1	108.7
+4	5.1	108.7
+6	5.95	107.8

Amount carb.

113.80

N 1/4

W	55	108.3
+14 cement carb	58	108.0
+17	52	108.6
cb	52	108.6
1/6	53	108.5
c	51	108.7
1/6	48	109.0
cb	47	109.1
E	46	109.3
or.		
E	48	109.0
	49	108.9
	51	108.7
	51	108.7
	51	108.7
	52	108.6
+3	52	108.6
+6 cement carb.	56.5	108.15

113.80

W

	55	108.3
	5 1/4	
W	54	108.4
+14 cement carb	55.5	108.25
+17	53	108.5
cb	53	108.5
1/6	54	108.4
c	51	108.7
1/6	51	108.7
cb	50	108.8
E	49	108.9
scb.		
E	50	108.8
cb	52	108.6
1/6	53	108.5
c	52	108.6
1/6	55	108.3
cb	54	108.4
+6 cement carb.	54.3	108.37

113.50

113.70

W	5.5	108.3
	5L. Cave St.	
W	5.2	108.6
+14	amercant	5.3 108.5
cb	5.3	108.5
1/2	5.5	108.3
c	5.5	108.3
1/2	5.2	108.6
cb	5.3	108.5
E	5.0	108.8
	25' 5	
E	5.1	108.7
cb	5.8	108.0
1/2	5.7	108.1
c	5.7	108.1
1/2	5.9	107.9
cb	5.9	107.9
W	6.1	107.7

W	6.1	107.7
cb	5.9	107.9
1/2	5.9	107.9
c	5.7	108.1
1/2	5.7	108.1
cb	5.5	108.3
E	5.2	108.6
	75' 5	
E	5.2	108.6
cb	5.6	108.2
1/2	5.5	108.3
c	5.8	108.0
1/2	5.9	107.9
cb	6.0	107.8
W	6.1	107.7
TP	4.79	719.15 5.41 108.39



11318

100's

W	5.3	1077
cb	5.2	1080
1/2	5.2	1080
c	5.1	1081
1/2	4.9	1083
cb	4.8	1084
E	4.5	1087

116.5 of Calc = NW Wall St.

E	4.4	1088
cb	4.7	1085
1/2	4.8	1084
s	4.8	1084
1/2	5.2	1089
cb	5.2	1080
W	5.5	1077

N of Wall

W	5.2	1089
	5.2	1080

11318

7

1/2	4.9	1083
c	4.6	1086
1/2	4.7	1085
cb	4.7	1085
E	4.1	1091

N 1/4

E	4.0	1092
J	4.5	1087
1/2	4.5	1087
c	4.5	1087
1/2	4.7	1085
cb	4.8	1084
W	5.4	1078

Cr.

W	5.0	1082
cb	4.8	1084
1/2	4.6	1086
c	4.4	1088
1/2	4.3	1089

11318

cb	42	108.9
E	38	109.4
	5 1/4	
E	36	109.6
cb	41	109.1
1/4	42	109.0
c	42	109.0
1/4	45	108.7
cb	46	108.6
1/4	50	108.2
	5cb	
W	47	108.5
cb	46	108.6
1/4	43	108.9
c	42	109.0
1/4	40	109.2
cb	38	109.4
E	34	109.8

11318

SL Wall Street

E	31	110.1
cb	39	109.3
1/4	39	109.3
c	39	109.3
1/4	40	109.2
cb	43	108.9
1/4	46	108.6
TP	738	11722
	534	10984
	25'5	
N	82	109.0
cb	78	109.4
1/4	77	109.5
c	76	109.6
1/4	75	109.7
cb	73	109.9
E	69	100.3

11722

50' S

E	6.5	110.7
cb	7.1	110.1
1/2	7.1	110.1
c	7.1	110.1
1/4	7.3	109.9
cb	7.4	109.8
W	7.7	109.5

75' S

W	7.2	110.0
cb	7.0	110.2
1/2	6.7	110.5
c	6.6	110.6
1/2	6.7	110.5
cb	6.5	110.7
E	6.1	111.1

100' S

E	5.3	111.9
cb	6.0	111.2

11722

1/4

c

1/2

cb

W

W

cb

1/2

c

1/2

cb

E

E

cb

1/4

c

W

6.0 111.2

6.2 111.0

6.3 110.9

6.4 110.8

6.8 110.4

6.2 111.0

5.7 111.5

5.5 111.7

5.4 111.8

5.1 112.1

5.2 112.0

4.5 112.7

3.7 113.5

4.4 112.8

4.6 112.6

4.7 112.5

4.9 112.3

9

130' S

160' S

	117.22	
cb	50	112.2
W	54	111.8
	185 S	
VV	4.7	112.0
cb	4.4	112.8
1/2	4.0	113.2
c	3.7	113.5
1/4	3.6	113.6
cb	3.5	113.7
1/2	2.9	114.3
	210 S	
E	1.8	115.4
cb	2.4	114.8
1/2	2.7	114.5
c	2.8	114.4
1/2	3.1	114.1
cb	3.3	113.9
W	3.7	113.5

	117.22	
	235 S	
W	2.7	114.5
cb	2.0	115.2
1/2	1.8	115.4
c	1.6	115.6
1/2	1.4	115.8
cb	1.0	116.2
E	0.2	117.0
TP	926	126.43
	260 S	117.17
E	7.9	118.0
cb	8.9	117.5
1/2	9.1	117.3
c	9.4	117.0
1/4	9.6	116.8
cb	9.9	116.5
W	10.4	116.0

12643

385 S

W	90	117.4
cb	83	118.1
1/2	78	118.6
.	75	118.9
1/2	73	119.1
cb	69	119.5
F	61	120.3

310' S = W h. Irving

F	40	122.4
cb	46	121.8
1/2	56	120.8
c	60	120.4
1/2	61	120.3
cb	67	119.7
W	78	118.6

335' S

W	70	119.4
cb	55	120.9

12643:

1/2	49	121.5
c	42	122.4
1/2	40	122.6
cb	35	122.9
F	29	123.9

360 S

F	37	123.3
cb	26	123.8
1/2	30	123.4
c	38	122.6
1/2	45	121.9
cb	51	121.3
W	59	120.5

385' S

W	50	121.4
cb	43	122.1
1/2	37	122.7
c	36	122.8
1/4	37	122.7

	12643		
cb	Rail	443	122.0
E		59	122.5
TP	10.83	13347	379 122.64
		410	5
W		11.4	122.1
cb		11.5	122.0
1/2		12.0	121.5
c		12.0	121.5
1/2		11.7	121.8
cb		11.1	122.4
+10		6.8	126.7
E		6.2	124.3
		435	5
E		6.0	122.5
cb		7.7	125.8
+5		7.9	125.6
1/4		10.8	122.7
c		11.6	121.9
1/2		12.3	121.2
10		12.5	121.0

	13347		
W	(Rail)	12.96	120.51
		460	5
W		12.8	120.7
cb		12.0	121.5
1/2		9.9	124.1
c		9.5	124.0
1/2		9.8	124.1
+5		7.4	126.1
cb		7.0	126.5
E		4.7	128.8
		485	3
E		3.2	130.3
cb		5.4	128.1
1/2		6.6	126.9
c		7.0	126.5
1/2		9.8	125.7
cb		8.7	124.8
N		10.8	122.7

		13347	
cb		500' S - Nk. Comm. St.	
E	W	10.1	122.4
TT	cb	7.7	125.8
	1/2	7.0	126.5
W	c	6.1	127.4
cb	1/2	5.5	128.0
1/2	cb	4.6	128.9
c	E	2.1	131.4
1/2		x cb.	
cb	E	1.8	131.4
+10	cb	3.9	129.4
E	1/2	5.2	128.3
E	c	5.6	127.9
cb	1/2	6.7	126.8
+5	cb	7.4	126.1
1/9	W	9.1	124.4
c		1/2	
1/2	W	8.5	125.0
W	cb	6.7	126.8

		13347	
	1/2	6.0	127.5
	c	5.1	128.4
	1/2	4.8	128.7
	cb	3.9	129.6
	E	1.8	131.4
		cr.	
	E	1.1	132.4
	cb	3.3	130.2
	1/2	4.5	129.0
	c	4.9	128.6
	1/2	5.4	128.1
	cb	6.4	127.1
	W	8.0	125.5
		S 1/4	
	W	7.6	125.9
	cb	5.9	127.6
	1/2	5.1	128.4
	c	4.2	129.3
	1/2	3.8	

13347

cb	27	130.8
E	05	1330
T.P.	816	13929 234
	5cb	13113
E	64	132.9
cb	85	130.8
1/2	95	129.8
c	98	129.5
1/2	108	128.5
1cb	117	127.6
W	135	125.8
	SL Conn.	
W	133	1260
cb	111	128.2
1/2	100	129.3
c	90	130.3
1/2	85	130.8
cb	79	131.4
E	57	133.6

13929

	25.5	
E	47	134.6
cb	67	132.6
1/2	74	131.9
c	83	131.0
1/2	95	129.8
cb	102	129.1
W	113	128.0
	57.5	
W	112	128.1
cb	98	129.5
1/2	86	130.7
c	76	131.7
1/2	71	132.2
cb	62	133.1
E	41	135.2
	75.5	
E	39	135.4
cb	61	133.2



139.29

1/2	66	132.7
c	71	132.2
1/2	82	131.1
cb	92	130.1
W	109	128.4

90's

W	10.7	128.6
cb	89	130.4
1/2	79	131.4
c	68	132.3
1/2	63	133.0
cb	56	133.7
F	40	135.3

110's

E	34	135.9
cb	53	134.0
1/2	60	133.3
c	68	132.5
1/2	76	131.7

139.29

cb	85	130.8
W	10.0	129.3

135's

W	9.8	129.5
cb	7.8	131.5
1/2	6.9	132.4
c	5.7	133.6
1/2	5.5	133.8
cb	4.7	134.6
E	3.3	136.0

160's

E	2.3	137.0
cb	4.9	134.9
1/2	5.4	133.9
c	5.6	133.7
1/2	6.9	132.4
+5	7.9	131.7
cb	9.4	129.9
W	9.9	129.4

13929

185's

W	10.0	129.3
cb	8.1	131.2
1/2	6.8	132.5
c	6.0	133.3
1/4	5.4	133.9
d	3.7	135.6
F	1.6	137.7

210's

E	2.5	136.8
d	4.9	134.4
1/2	5.8	133.5
c	6.6	132.7
1/4	7.8	131.5
d	8.9	130.4
W	10.3	129.0

235's

W	10.0	129.3
cb	8.7	130.6

13929

1/2

c

1/4

cb

E

F

d

1/2

c

1/4

cb

W

W

d

1/2

c

1/4

7.6 131.7

6.0 133.3

5.7 133.6

5.0 134.3

2.9 136.4

245's - F1 Magnolia

3.0 136.3

4.8 134.5

5.8 133.5

6.2 133.1

7.8 131.5

8.5 130.7

9.5 129.8

260's

8.5 130.8

8.1 131.2

7.5 131.8

6.7 132.6

6.2 133.1

16

13929

cb	53	134.0
E	36	135.7
285's		
E	44	134.9
cb	57	133.6
1/2	61	133.2
c	64	132.9
1/2	67	132.6
cb	73	132.0
W	74	131.9
370's		
W	68	133.0
cb	57	133.6
1/2	54	133.9
c	52	134.1
1/2	53	134.0
cb	52	134.1
E	44	134.9

13929

17

335's		
E	43	135.0
cb	55	133.8
1/2	56	133.7
c	52	134.1
1/2	59	133.4
cb	58	133.5
1/2	61	133.2
360's		
W	76	131.7
cb	81	131.2
1/2	80	131.3
c	72	132.1
1/2	74	131.9
cb	73	132.0
E	64	132.9
385's		
E	55	133.8
cb	69	132.4

	139.29	
1/2	7.5	131.8
c	8.2	131.1
1/2	9.1	130.2
cb	8.7	130.6
W	9.2	130.1
	410'S	
W	9.5	129.8
cb	9.2	130.1
1/2	5.5	130.8
1/2	7.1	132.7
1/2	6.4	132.9
cb	5.6	133.7
E	3.9	135.4
	135'S	
E	3.9	135.4
cb	5.4	133.9
1/2	6.3	133.0
c	6.7	132.6
1/2	8.3	131.0

	139.29	
cb	9.1	130.2
W	9.8	129.5
T-10	570	135.9
	9.20	130.09
	460'S	
W	5.7	129.5
cb	5.0	130.2
1/2	4.4	130.8
c	2.9	132.3
1/2	3.2	132.0
cb	2.2	133.0
E	1.0	134.2
	485'S	
E	2.1	133.1
cb	3.5	131.7
1/2	4.3	130.9
c	4.3	130.9
1/2	5.3	129.9
cb	5.8	129.4
W	6.6	128.6

13519

500's = NW Kline St

W	7.8	127.8
cb	6.1	129.1
1/2	5.5	129.7
c	4.2	131.0
1/4	4.5	130.7
cb	3.7	131.5
E	2.1	133.1

Ncb Kline

E	1.8	133.4
cb	3.7	131.5
1/2	4.6	130.6
c	4.4	130.8
1/2	5.5	129.7
cb	6.0	129.2
W	7.4	127.8

1 1/2

W	7.4	127.8
cb	6.2	129.0

13519

19

1/2	5.6	129.6
c	4.7	130.5
1/2	4.0	130.8
cb	3.5	131.7
E	1.5	133.7

cb

E	1.8	133.4
J	3.5	131.7

1/2	3.2	131.4
-----	-----	-------

c	4.6	130.6
---	-----	-------

1/2	5.0	130.2
-----	-----	-------

cb	5.7	129.5
----	-----	-------

W	7.5	127.7
---	-----	-------

5/2

W	7.4	127.8
---	-----	-------

cb	5.3	129.9
----	-----	-------

1/2	4.9	130.3
-----	-----	-------

c	4.5	130.7
---	-----	-------

1/2	3.8	131.4
-----	-----	-------

135.19

cb	3.0	132.2
E	1.5	133.7
scb		
E	1.8	133.4
cb	3.3	131.9
1/2	3.7	131.4
c	4.5	130.7
1/2	4.6	130.6
cb	5.3	129.9
W	7.2	128.0
S.L. Kline		
W	7.2	128.0
cb	6.0	129.2
1/2	5.8	129.4
c	5.7	130.1
1/2	4.5	130.7
cb	3.8	131.4
E	2.4	132.8

135.19

B7M State-Tetanus 193, 133.26 133.259

5' Sof Kline. (Sec A)

Check — 20

E	2.9	132.3
cb	4.5	130.8
1/2	5.2	130.0
c	5.7	129.5
1/2	6.0	129.2
cb	6.3	128.9
W	7.5	127.7
Sec B		
W	9.2	126.0
cb	7.7	127.5
1/2	6.9	128.3
c	6.1	129.1
1/2	5.0	130.2
cb	4.8	130.4
E	2.9	132.3

13519

Sec C

E	29	132.3
cb	49	130.3
1/c	57	129.4
c	70	128.2
1/d	82	127.0
cb	89	126.3
W	103	124.9

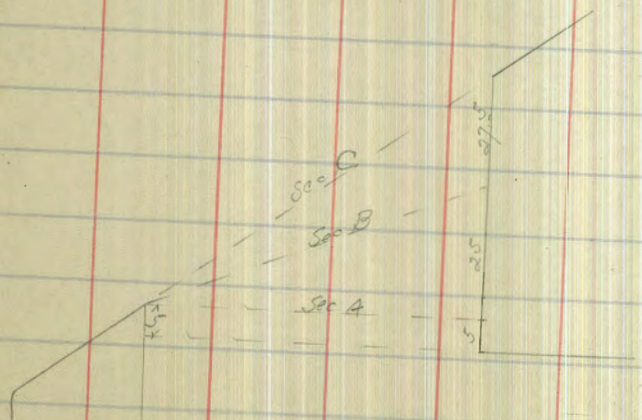

Kline

22



x-section Thorn 30<sup>th</sup> to 32<sup>nd</sup>  
 " 60' wide 10' walk 310' 1/2

7/4 sample  
 17 Evans  
 1/2 m

Form 318 323.01 319.83

0+50

25

T.P. 720 327.78 243 320.52

E.L. 30<sup>th</sup>

N 7.2 320.6

crk 7.6 320.2

1/4 8.3 319.5

M 7.8 320.0

1/4 8.3 319.5

crk 8.0 319.8

S 7.6 320.2

0+75 E

S 7.9 319.9

crk 7.9 319.9

1/4 8.2 319.6

M 7.6 320.2

1/4 7.9 319.9

crk 7.2 320.6

N 6.9 320.9

N 6.7 321.1

crk 7.2 320.6

1/4 7.2 320.6

M 7.5 320.3

1/4 7.6 320.2

crk 7.5 320.3

S 7.6 320.2

0+75

S 6.8 321.0

crk 6.7 321.1

1/4 6.6 321.2

M 6.6 321.2

1/4 6.4 321.4

crk 6.5 321.3

N 6.3 321.5

327.78

170

N	6.1	321.7
crk	6.1	321.7
"A	6.4	321.4
M	6.6	321.2
"4	6.6	321.2
crk	6.7	321.1
S	6.7	321.1

1725

S	6.3	321.5
crk	6.4	321.4
"A	6.1	321.9
M	6.1	321.7
"A	6.3	321.5
crk	5.7	322.1
N	5.7	322.1

327.78

1750

24

N	5.6	322.2
crk	5.6	322.2
"A	6.0	321.8
M	6.0	321.8
"4	5.9	321.9
crk	5.9	321.9
S	6.2	321.6

1775

S	5.5	322.3
crk	5.7	322.1
"A	5.7	322.1
M	5.7	322.1
"A	5.7	322.1
crk	5.5	322.3
N	5.3	322.5

327.78

240

N	5.0	322.8
erb	5.1	322.7
1/4	5.1	322.7
M	5.1	322.7
1/4	5.3	322.5
erb	5.4	322.4
S	5.6	322.2

2425

S	4.8	323.0
erb	5.0	322.8
1/4	5.1	322.7
M	5.2	322.6
1/4	4.9	322.9
erb	4.8	323.0
N	4.8	323.0

327.78

2450

25

N	4.7	323.1
erb	4.7	323.1
1/4	4.9	322.9
M	5.0	322.8
1/4	5.1	322.7
erb	5.3	322.5
S	5.4	322.4

2467<sup>6</sup> - M.L. Grim st + 10 - str on Grim 65

S	5.1	322.7
erb	4.9	322.9
1/4	4.7	323.1
M	4.4	323.4
1/4	4.4	323.4
erb	4.1	323.7
N	4.1	323.7

317.75

E.L. GRIMM

0750

26

N	5.2	322.6
crk	5.3	322.5
1/4	5.3	322.5
M	5.5	322.0
1/4	5.7	322.1
crk	5.7	322.1
S	5.8	322.0

0725 E

S	6.7	321.1
crk	6.5	321.3
1/4	6.8	321.0
M	6.8	321.0
1/4	6.6	321.2
crk	6.5	321.3
N	6.2	321.6

N	7.4	320.4
crk	8.3	319.5
1/4	8.3	319.5
M	8.2	319.6
1/4	8.2	319.6
crk	7.8	320.0
S	8.2	319.5

0725

S	10.0	317.8
crk	10.0	317.8
1/4	10.5	317.3
M	10.7	317.1
1/4	10.6	317.2
crk	11.0	316.8
1/4	10.0	317.8
N	9.9	317.9

327.75

170

319.86

1450

27

N		13.3	314.5
+5		13.3	314.5
erb		14.4	312.4
11A		14.2	312.6
M		13.7	314.1
11A		13.4	314.4
erb		12.6	315.2
S		12.5	315.3
T.P.	465	319.86	12.57 315.21
	1725		
-25		17.5	302.1
5		16.9	303.0
erb		16.8	302.1
11A		15.0	304.9
M		10.8	309.1
11A		10.3	309.6
+3		10.4	309.5
erb		15.2	306.7
N		14.1	305.5
+25		13.2	306.7

✓		5.2	314.7
+6		5.4	314.5
erb		6.1	312.8
11A		7.1	312.8
M		7.5	312.4
11A		8.2	311.7
erb		9.4	310.5
S		10.3	309.6
	1765	319.86	1450
S		5.8	314.1
erb		5.7	314.2
11A		5.6	314.30
M		5.7	314.2
11A		6.0	313.9
erb		6.1	312.8
N		5.2	314.7

319.86

1775

N	3.2	316.7
+6	3.2	316.7
erb	4.7	215.2
14	4.3	315.6
M	4.6	315.3
14	4.6	215.3
erb	4.7	215.2
S	5.2	314.9

240

2	4.4	315.5
erb	4.0	315.9
14	3.9	316.0
M	3.6	316.3
14	3.5	316.4
erb	3.7	316.2
N	3.2	316.7

2725

28

N	2.3	317.6
+6	2.5	317.6
erb	3.3	316.6
14	3.0	316.9
M	3.0	316.9
14	3.3	316.6
erb	3.5	316.4
S	3.8	316.1

2750

S	2.8	317.1
erb	2.9	317.0
14	2.5	317.4
M	2.2	317.7
14	2.0	317.9
erb	2.4	317.5
+4	1.7	318.2
N	1.7	318.2

Note - should be 2+65  
according to 17993

319.86

2+67 = W.L. 312° 57' 45" wide 10 walls 11.25' 1/48

W 1/4

29

N	1.10	318.8
+6	1.2	318.7
crk	2.3	317.6
1/4	1.3	318.6
M	1.4	318.5
1/4	1.7	318.2
crk	2.2	317.7
S	2.2	317.7

N	8.3	319.9
+5	8.4	319.8
crk	9.1	319.1
1/4	8.7	319.5
M	8.9	319.3
1/4	9.3	318.9
crk	9.4	318.8
S	8.7	318.5

T.P. rail in crk = 10.05 328.24 1.67 318.19

Center

W. Crk

S	10.0	317.9
crk	10.1	318.1
1/4	9.9	318.3
M	9.3	318.9
1/4	9.2	319.0
crk	9.5	318.4
+5	9.0	319.2
1/4	9.0	319.2

S	9.2	319.0
crk	9.0	319.2
1/4	8.9	319.3
M	8.6	319.6
1/4	7.8	320.4
crk	8.1	320.1
N	7.5	320.4

E "4

N	7.3	320.9
crk	7.5	320.7
"4	7.7	320.5
M	8.1	320.1
"4	8.4	319.8
crk	8.5	319.7
S	8.8	319.6

E. curve

S	8.2	320.0
crk	8.0	320.2
"4	7.8	320.6
M	7.6	320.6
"4	7.4	320.8
crk	7.2	321.0
N	7.3	320.8

E.L. 31st st

30

N	6.2	322.0
+5	6.2	
crk	7.1	321.1
"4	6.9	321.3
M	7.3	320.9
"4	7.5	320.7
crk	7.7	320.5
S	7.6	320.6

+25' E

S	7.2	321.0
crk	6.9	321.4
"4	6.6	321.6
M	6.3	321.9
"4	6.0	322.2
crk	6.1	322.1
+5	5.6	322.6
N	5.6	322.6



328.24

0750

N	4.9	323.3
+7	4.9	323.3
erb	5.5	322.7
1/4	5.4	322.8
M	5.3	322.9
1/4	5.2	323.0
erb	5.5	322.7
S	6.1	322.1

0775

S	5.8	322.4
erb	5.0	323.2
1/4	4.8	323.4
M	4.8	323.4
1/4	4.9	323.3
erb	4.9	323.3
+3	4.3	323.9
N	4.4	323.8

170

31

N	3.7	324.5
+7	3.9	324.3
erb	4.6	323.6
1/4	4.5	323.7
M	4.6	323.6
1/4	4.6	323.6
erb	4.7	323.5
S	5.0	323.2

1725

S	4.7	323.5
erb	4.1	324.1
1/4	3.9	324.3
M	4.0	324.2
1/4	4.1	324.1
erb	4.3	323.9
+3	3.7	324.5
N	3.7	324.5

328.26

1750

N	3.8	324.4
+7	3.7	324.5
crk	4.1	324.1
1/4	3.9	324.3
M	4.0	324.2
1/4	4.2	324.0
crk	4.4	323.8
S	4.5	323.7

1775

S	5.0	323.2
crk	4.8	323.5
1/4	4.6	323.6
M	4.3	323.9
1/4	4.5	323.7
crk	4.6	323.6
N	4.1	324.1

240

32

N	4.6	323.6
crk	5.3	322.9
1/4	5.1	323.1
M	4.9	323.3
1/4	5.3	322.9
crk	5.6	322.6
S	5.7	322.5

2425

S	6.4	321.8
crk	6.2	322.0
1/4	6.1	322.1
M	5.9	322.3
1/4	5.5	322.7
crk	5.4	322.8
N	5.1	323.1

328.24

2750

N	6.3	321.9
erb	6.9	321.3
"A	6.7	321.5
M	7.0	321.2
"A	7.4	320.8
erb	7.5	320.7
S	7.8	320.4

map shows 265'

2 + 63' = n.b. Herman st 65' wide

S	8.5	319.7
erb	8.3	319.9
"A	7.9	320.3
M	7.6	320.6
"A	7.7	320.5
erb	7.8	320.4
N	7.3	320.9

n. curb

33

N	8.2	320.0
erb	8.1	320.1
"A	8.5	319.7
M	8.2	320.0
"A	8.5	319.7
erb	8.9	319.3
S	9.7	319.1

N "A

S	9.7	318.3
erb	9.8	318.4
"A	9.7	318.5
M	9.5	318.7
"A	9.1	319.1
erb	9.0	319.2
N	8.7	319.5

328.24

## Center

N	9.4	318.8
wh	9.4	318.8
"A	9.5	318.7
M	9.8	318.4
"A	9.8	318.4
wh	10.0	318.7
S	10.3	317.9

## E "A

S	10.8	317.4
wh	10.6	317.6
"A	10.4	317.8
M	10.1	318.1
"A	10.0	318.2
wh	9.9	318.3
N	9.8	318.4

## E Curly

34

N	10.1	318.1
wh	10.4	317.8
"A	10.7	317.5
M	10.8	317.4
"A	10.9	317.3
wh	11.0	317.7
S	11.3	316.9

## E. L. Herman

S	11.9	316.3
wh	11.5	316.7
"A	11.0	317.7
M	10.8	317.4
"A	10.6	317.6
wh	10.4	317.8
N	10.3	317.9

328.29

0+75 E

N		10.8	317.4
crk		10.9	317.3
1/4		10.7	317.5
M		11.0	317.2
1/4		11.6	316.6
crk		12.0	316.2
S		12.5	315.7
T.P.	3.29	319.44	12.09 316.15
		0+50	
1/4		4.2	315.2
crk		3.7	315.7
1/4		3.2	316.2
M		3.0	316.4
1/4		2.6	316.8
crk		2.1	317.3
N		1.9	317.5

319.44

0+75

35

N		2.6	316.8
crk		2.7	316.7
1/4		2.9	316.5
M		3.0	316.4
1/4		3.3	316.1
crk		3.5	315.6
S		4.3	315.1
		1+0	
S		4.8	314.6
crk		4.0	315.1
1/4		3.9	315.5
M		3.7	315.7
1/4		3.6	315.8
crk		3.6	315.8
N		3.3	316.1

319.44

1725

N	4.1	315.3
crk	4.3	315.1
"A	4.3	315.1
M	4.5	314.9
"A	4.8	314.6
crk	5.1	314.3
S	5.3	314.1

1750

S	6.1	313.3
crk	5.7	313.7
"A	5.5	313.9
M	5.5	312.9
"A	5.6	313.8
crk	5.6	310.8
N	5.9	314.0

36

1725

N	6.5	312.9
crk	6.9	313.0
"A	6.6	312.8
M	6.5	312.9
"A	6.5	312.9
crk	6.5	312.9
S	6.9	312.5

210

S	6.2	311.2
crk	8.1	311.3
"A	8.0	311.4
M	7.8	311.6
"A	7.6	311.8
crk	7.5	311.9
N	7.5	311.9

319.44

2+25

N	9.0	310.4
orb	9.0	310.4
"A	8.8	310.6
M	8.8	310.6
"A	9.1	310.3
orb	9.2	310.2
S	9.1	310.3

2+50

S	10.3	309.1
orb	10.2	309.2
"A	9.9	309.5
M	10.2	309.2
"A	10.5	308.9
orb	11.4	308.0
N	13.7	305.7

2+65<sup>3</sup> = W.L. 37<sup>nd</sup> of

37

N	19.7	299.7
orb	15.5	303.9
"A	13.0	306.4
M	11.2	308.2
"A	10.8	308.6
orb	10.9	308.5
S	10.9	308.7

5/16/48  
 25/12/48  
 12/12/48  
 El bazon to adams  
 El bazon am

3390  
 33900  
 125  
 339125  
 125  
 339250  
 125  
 339375  
 125  
 339500  
 125  
 339625  
 125  
 339750  
 125  
 339875  
 125  
 340000  
 125  
 340125  
 125  
 340250  
 125  
 340375  
 125  
 340500

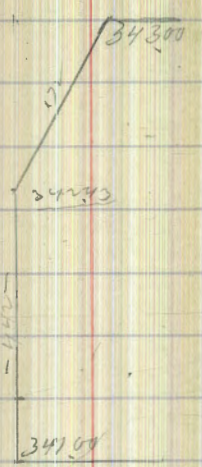

34287 293 34690 34250  
 2 E.H. El bazon 750  
 50' N E L 7.04  
 100' " " 7.55  
 150' " " 7.90  
 Angkor W L 4.50 342,30  
 100' " " 4.57  
 200' " E L 7.35  
 170' " " 7.20  
 170' " W L 4.75  
 200' " W L 4.90  
 300' " E L 7.05  
 T P 600 345-75 7.05 33975  
 350' " " 5.80  
 350' " " W L 4.05  
 400' " " W L 4.15  
 400' " " E L 5.75  
 450' " E L 5.65  
 470' " W L 4.30  
 500' " W L 4.45  
 500' " E L 5.50  
 550' " E L 5.35  
 550' " W L 4.60  
 50' grade W L 4.75 341.00  
 50' " E L 5.20

Grade am

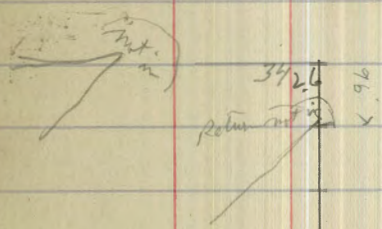

curbs in all in + OK exact  
 Return at El bazon, 1st grade + 1st Indian

3450

3450

mon



Monroe av

3456

3456

3504

3504

Madison

3512

3512

Shoulder Place

20' Bot lvs

3551

3551

Adams av n 1/2 Dutcher Parcel

P	C	1/4	C	1/4	Act	P
45.22749		Bush St				260.00
41.27170						
00=220.00						
11525						
2	261.00	260.65	261.05	260.65	261.05	261.30
12670.26100						
177023						
3	262.00	261.70	261.05	260.75	261.35	261.70
24023						
4	262.29	262.08	261.63		262.03	262.29
233420						
5	262.63	262.38	261.78	261.42	261.92	262.22
7	263.49	263.24	262.04	262.92	262.36	262.90
70.44032						
9	264.51	264.26	263.76	263.75	263.11	263.26
44425						
10	264.76	264.51	263.91	264.01	263.31	263.51
44725						
11	265.03	264.93	264.23	264.33	263.63	263.83
245215						
12	265.68	265.44	264.94	264.94	264.29	264.44
5.0925						
13	266.16	265.91	265.31	265.41	264.76	264.91
WL Kite St.						
14	266.64	266.39	265.79	265.89	265.24	265.39
444925						
15	267.12	266.87	266.27	266.37	265.72	265.87
6.0925						
16	267.60	267.35	266.75	266.85	266.20	266.35
774825						
17						
End grade.						

VOID

Donnatti, Shaw, Devine. 39

FOV 262.100

Break 262.29

Break 263.51

NO Return

3021-4663

W.  
P

cb

Kite St. Prop levels,  
(DANA PL.)

1/4

c

1/4

cb

E.  
P.

W.P.

H.I.  
271.70  
- 2.70  
269.00  
+ 7.87  
276.87 H.I.

June 7-12

Donnan  
Shaw,  
Devine

E.F.

South line of Birch St.

00+ 266.16

65.91

65.73

66.15

65.75

66.39

266.44

20-

266.16

H.I.  
271.70

266.64

40

0+40

2.9

268.9

H.I.  
276.87

2.3

269.40

0+80

6.1

270.8

5.6

271.3

1+30

4.6

272.3

4.5

272.4

1+80

4.0

272.9

4.6

272.5  
272.3X

2+20

4.2

272.7X

4.9

272.2  
272.0Y

2+69.5

4.7

272.4  
272.2X

5.1

271.2  
271.8X

S.L

Bush St. Grades.

NL

cb 1/4 c 1/4 cb

June 7-12

Thornan,  
Shaw,  
Devine

Sta

10 0	260.00	259.75	259.35	259.75	259.35	259.75	260.00
---------	--------	--------	--------	--------	--------	--------	--------

41

Street grading accepted to here:

1 FC 1+15 30	261.29	261.03	260.63	261.03	260.63	261.03	261.29
--------------------	--------	--------	--------	--------	--------	--------	--------

2 1+74 03	262.01	261.76	261.36	261.76	261.36	261.76	262.01
--------------	--------	--------	--------	--------	--------	--------	--------

3 2+04 23	262.30	262.05	261.65	262.05	261.65	262.05	262.30
--------------	--------	--------	--------	--------	--------	--------	--------

4 RC 2+34 35	262.64	262.39	261.79	262.39	261.79	262.39	262.64
--------------------	--------	--------	--------	--------	--------	--------	--------

5 W.L. Lark 2+54 23 St.	262.86	262.61	262.01	262.46	261.99	262.31	262.52
-------------------------------	--------	--------	--------	--------	--------	--------	--------

6 3+10 15 E.L. Lark St.	263.49	263.24	262.64	262.92	262.36	262.61	262.96
----------------------------------	--------	--------	--------	--------	--------	--------	--------

7 FC 4+03 3	264.36	264.11	263.51	263.61	262.96	263.11	263.36
-------------------	--------	--------	--------	--------	--------	--------	--------

8 4+24 23 WL Alley	264.75	264.50	263.90	264.00	263.35	263.50	263.75
--------------------------	--------	--------	--------	--------	--------	--------	--------

9 4+77 24	265.06	264.81	264.21	264.31	263.66	263.81	264.06
--------------	--------	--------	--------	--------	--------	--------	--------

10 5+41 23 RC	265.66	265.41	264.81	264.91	264.26	264.41	264.66
---------------------	--------	--------	--------	--------	--------	--------	--------

11 5+58 56 WL Kite St	266.19	265.94	265.34	265.44	264.79	264.94	265.19
-----------------------------	--------	--------	--------	--------	--------	--------	--------

12 6+28 56 FL Kite St	266.66	266.41	265.81	265.91	265.26	265.41	265.66
-----------------------------	--------	--------	--------	--------	--------	--------	--------

13 6+98 56	267.12	266.87	266.27	266.37	265.72	265.87	266.12
---------------	--------	--------	--------	--------	--------	--------	--------

14 7+28 56	267.60	267.35	266.75	266.85	266.20	266.35	266.60
---------------	--------	--------	--------	--------	--------	--------	--------

End Grade.

Sta. W.L. cl Kite St. 50' Wide.  $\frac{1}{4}$  c  $\frac{1}{4}$  cl EL

BM 256.99 SW. Cor Goldfinch & Sutter.

Grades.

June 10-12 {Donnan, Shaw, Deanne}

19.14  
265.63  
-0.88  
264.75  
271.78  
274.58  
-2.88  
271.70  
-1.20  
270.50  
273.79 H.T.

42

00= South line of Bush St

00 266.19 265.94 265.65 266.17 265.81 266.91 266.66 ✓

+40 268.90 268.65 268.38 268.90 268.55 269.15 269.40 ✓

+80 270.80 270.55 270.27 270.80 270.45 271.05 271.30 ✓

+130 272.30 272.05 271.67 272.10 271.55 271.72 272.15 272.40 ✓

+180 272.90 272.65 272.05 272.45 271.95 272.25 272.50 ✓

+230 273.00 272.75 272.15 272.35 271.75 271.95 272.20 ✓

+269 272.40 272.15 271.55 271.55 270.95 270.95 271.20 ✓

End Grade.

276.78 276.78 276.78 276.78 276.78 276.78 276.78 276.78 276.78 276.78  
26.25 20.91 26.17 20.45 25.74 29.60 29.39 29.90 29.55 29.15  
10.37 12.97 10.61 11.15 10.84 8.13 8.40 7.93 8.23 7.63  
276.78 276.78 276.78 276.78 276.78 276.78 276.78 276.78 276.78 276.78  
5.73 6.33 5.95 6.51 6.23 4.79 5.08 4.68 5.06 4.63  
276.78 276.78 276.78 276.78 276.78 276.78 276.78 276.78 276.78 276.78  
71.25 70.45 72.90 70.17 70.85 72.05 71.70 72.15 71.72 72.15  
4.53 4.83 4.33 4.73 4.13 4.03 4.63 4.43 5.03 4.93  
276.78 276.78 276.78 276.78 276.78 276.78 276.78 276.78 276.78 276.78  
70.95 70.85 71.55 71.55 72.15 72.15 71.55 71.55 71.55 71.55  
5.83 5.93 5.23 5.23 4.63 5.23 5.23 5.23

All stakes. June 11-12, {Donnan, Shaw, Deanne}

Xsection 15 Alley 3<sup>rd</sup> & 4<sup>th</sup> Brooks & Walnut Sts.

June 12-12  
Donnan  
Shaw.  
Devine.

BNC 2727 Hwy XVI. Cor 3<sup>rd</sup> & Brooks.

HI  
290.30

43

	+	HI	-				
				E.L.			1.1
00 = South line of Brooks St.				#	3.30	292.13	1.47
				11400			288.83
	13.03	290.30	272.27	E.L.			3.1
00				c			3.5
E.L.			3.7				
c			3.7	OK L.			3.3
OK L.			3.7	1+75			
+25				OK L.			3.6
OK L.			6.0	c			3.8
c			6.4	E.L.			2.9
E.L.			5.9	2+00			
+50				E.L.			3.3
E.L.			3.5	c			3.9
10			4.0	OK L.			3.6
OK L.			3.8	2+25			
+75				OK L.			3.8
OK L.			2.4	c			4.0
c			2.8	E.L.			3.5
E.L.			2.5	2+50			
1+00				E.L.			3.5
E.L.			2.1	c			4.0
c			2.4	OK L.			3.9
OK L.			1.9	3+75			
1+25				OK L.			4.1
OK L.			1.3	c			3.8
c			1.5	E.L.			3.4

H.I.  
292.13

15' alley between Walnut &  
Brimley & 344 St.

H.I.  
292.13

292.13  
9.26  
check 282.87 = 292.97

44

3700 B.L.	3.8
c	4.1
OK.L. 3720	4.3
OK.L.	4.4
c	4.4
B.L. 3780	4.3
B.L.	4.4
c	4.6
OK.L. 3775	4.6
OK.L.	4.7
OK.L.	4.6
B.L. 4700	4.6
B.L.	4.7
c	4.9
OK.L. 4725	5.0
OK.L.	5.1
c	5.1
B.L. 4750	4.9
B.L.	4.9
c	5.1

OK.L. 4775	5.0
OK.L.	5.1
c	5.2
B.L. 5700	5.1
B.L.	5.0
c	4.9
OK.L. 5725	5.5
OK.L.	5.6
c	5.2
B.L.	5.3
B.L. 5780	5.5
B.L.	5.6
c	5.6
OK.L. 5775	6.0
OK.L.	5.7
c	5.8
B.L.	5.4
6700 = North line of Walnut St.	
6700	
B.L.	6.3
c	6.4
OK.L.	6.5

section Hermann St N.L. Redwood to S.L. Dwight,  
 " " 65' wide 10 walks 11.25' gtr's

311.77

45

B.M. 1.71 319.61 317.90

T.P. 3.90 311.77 11.74 307.87

N.L. Redwood

E 13.8 298.5

erb 12.5 299.3

" 11.7 300.1

N 10.9 300.9

" 10.1 301.7

erb 9.5 302.3

" 8.9 302.9

0425

" 7.9 303.9

erb 8.4 303.4

" 9.1 302.7

N 9.6 302.2

" 10.5 301.3

erb 11.1 300.7

E 12.1 299.7

0450

E 11.2 300.6

erb 10.1 301.7

" 9.4 302.4

N 8.7 303.1

" 8.2 303.6

erb 7.6 304.2

N 6.9 304.9

0475

" 6.7 305.7

erb 6.5 305.3

" 7.1 304.7

N 7.7 304.1

" 8.3 303.5

erb 8.9 302.9

E 9.9 301.9

PLOTTED

311.77

170

F	8.0	309.8
crk	7.6	304.2
"A	7.1	304.7
M	6.4	305.4
"A	6.0	305.8
crk	5.4	306.4
W	4.8	309.0

PLOTTED

1725

W	3.9	307.9
crk	4.3	307.5
"A	4.8	307.0
M	5.3	306.5
"A	5.9	305.9
crk	6.2	305.6
F	6.7	305.1

311.77

1750

F	5.5	306.3
crk	5.1	306.7
"A	4.7	307.1
M	4.1	307.7
"A	3.6	308.2
crk	3.1	308.7
W	2.8	309.0

PLOTTED

1775

W	1.5	310.7
crk	2.1	309.7
"A	2.5	309.3
M	3.0	308.8
"A	3.6	308.2
crk	4.0	307.8
F	4.4	307.4

46



311.77

210

F	3.7	308.1
erb	3.4	308.4
"a	2.8	309.0
M	2.2	309.6
"b	1.7	310.1
erb	1.1	310.7
W	0.8	311.0

PLOTTED

2125

W	7 0.2	312.0
erb	0.4	311.4
"a	1.0	310.8
M	1.6	310.2
"b	2.2	309.6
erb	2.6	309.0
F	2.9	308.4
T.P.	11.18	321.18
	1.77	310.00

321.2

2150

F	11.7	309.5
erb	11.4	309.8
"a	11.0	310.2
M	10.4	310.8
"b	9.7	311.5
erb	9.2	312.0
W	8.7	312.5

PLOTTED

2175

W	8.1	313.1
erb	8.7	312.5
"a	9.3	311.9
M	9.8	311.4
"b	10.3	310.9
erb	10.7	310.5
F	11.3	309.9

47

321.2

3+0

E	10.9	310.3
crk	10.1	311.1
"	9.4	311.8
M	9.3	311.9
"	8.9	312.3
crk	8.1	313.1
W	7.4	313.5

PLOTTED

3+25

W	7.0	314.4
crk	7.6	313.6
"	8.4	312.8
M	9.1	312.1
"	9.7	311.5
crk	10.1	311.1
E	10.5	310.7

321.2

3+50

E	10.1	311.1
crk	9.6	311.6
"	9.2	312.0
M	8.6	312.6
"	7.8	313.4
crk	7.1	314.0
W	6.8	314.4

PLOTTED

3+75

W	6.4	315.0
crk	6.5	314.7
"	7.3	313.9
M	8.1	313.1
"	8.6	312.6
crk	9.3	311.9
E	9.9	311.3

48

321.2

440

E 9.2 312.0

erb 8.9 312.3

1/4 8.5 312.7

M 7.7 313.5

1/4 7.2 314.0

erb 6.4 314.8

W 5.9 315.2

4425

W 5.3 315.9

erb 6.1 315.1

1/4 6.9 314.3

M 7.6 313.6

1/4 8.0 313.7

erb 8.6 312.6

E 9.2 312.0

PLOTTED

321.2

4450

49

E 8.7 312.5

erb 8.1 313.1

1/4 7.5 313.7

M 6.6 314.6

1/4 6.1 315.1

erb 5.5 315.7

W 5.0 316.2

4475

M 9.2 317.0

erb 4.6 316.6

1/4 5.6 315.6

M 6.6 314.6

1/4 7.3 313.9

erb 7.8 313.4

E 8.3 312.2

PLOTTED

321.2

570

E	2.8	313.4
crk	2.2	314.0
"A	6.7	314.5
M	6.0	315.2
"A	5.3	315.9
crk	4.6	316.6
W	4.1	317.1

PLOTTED

5725

W	3.2	318.0
crk	4.0	317.2
"A	4.9	316.3
M	5.5	315.7
"A	6.1	315.1
crk	6.9	314.3
E	7.1	314.1

321.2

5750

50

E	6.1	315.1
crk	6.0	315.2
"A	5.6	315.6
M	4.7	316.5
"A	4.1	317.1
crk	3.1	318.1
W	2.2	319.0

PLOTTED

5775

W	2.2	319.0
crk	2.8	318.4
"A	3.4	317.8
M	4.1	317.1
"A	4.7	316.5
crk	5.4	315.8
E	5.1	316.1

321.18

670 = S.L. Thorn st 60' wide

E	4.7	316.5
crk	4.3	316.9
1/4	3.6	317.6
M	3.3	317.9
1/4	2.6	318.6
crk	2.0	319.7
W	1.5	319.7

PLOTTED

Note - for intersection see Page 33 this book

N.L. Thorn

W	0.4	320.8
crk	7.1	320.1
1/4	1.7	319.5
M	2.2	319.0
1/4	2.7	318.5
crk	3.1	318.1
E	3.3	317.9
T.P.	8.27	326.20
	3.25	317.93

326.2

51

0725 N

E	6.6	319.6
crk	6.8	319.4
1/4	7.0	319.7
M	6.5	319.7
1/4	6.3	319.9
crk	5.8	320.4
W	5.2	321.0

PLOTTED

0750

W	4.8	321.4
crk	5.4	321.0
1/4	5.8	320.4
M	6.7	319.5
1/4	7.0	319.7
crk	7.1	319.1
E	7.2	318.0

326.2

0+25

E	6.8	319.4
crk	6.6	319.6
"4	6.5	319.7
M	6.2	320.0
"4	5.8	320.4
crk	5.4	320.8
W	4.7	321.5

PLOTTED

1+0

W	4.9	321.8
crk	5.3	320.9
"4	5.7	320.5
M	6.1	320.1
"4	6.5	319.7
crk	6.4	319.8
E	6.9	319.8

326.2

1+25

E	6.1	320.1
crk	6.1	320.1
"4	6.1	320.1
M	5.9	320.3
"4	5.7	320.5
crk	5.0	321.2
W	4.6	321.6

PLOTTED

1+50

W	4.7	321.5
crk	5.3	320.9
"4	5.5	320.4
M	6.1	320.1
"4	6.3	319.9
crk	6.3	319.9
E	6.6	319.6

52

326.2

1+75

E	6.9	319.3
crk	6.3	319.9
"A	5.9	320.3
M	5.9	320.8
"A	5.7	320.5
crk	5.3	320.9
W	5.0	321.2

PLOTTED

2+0

W	5.0	321.2
crk	5.6	320.6
"A	5.7	320.5
M	5.8	320.4
"A	5.8	320.4
crk	6.3	319.9
E	6.6	319.6

326.2

2+25

53

E	6.4	319.8
crk	6.2	320.0
"A	6.1	320.1
M	6.1	320.1
"A	5.7	320.5
crk	5.3	320.9
W	4.6	321.6

PLOTTED

2+50

W	4.9	321.3
crk	5.3	320.9
"A	5.2	321.0
M	5.3	320.9
"A	5.7	320.5
crk	6.2	320.0
E	6.4	319.8

326.2

3+75

F	6.2	320.0
erb	6.0	320.2
"	5.9	320.3
M	5.7	320.5
"	5.3	320.9
erb	5.2	321.0
W	4.7	321.5

PLOTTED

3+0

W	4.7	321.5
erb	5.4	320.8
"	5.2	321.0
M	5.5	320.4
"	6.0	320.2
erb	6.1	320.1
F	6.3	319.9

326.2

3+25

54

F	6.2	319.9
erb	6.3	319.9
"	6.1	320.1
M	5.8	320.4
"	5.4	320.8
erb	5.6	320.6
W	5.0	321.4

PLOTTED

3+50

W	4.9	321.8
erb	5.7	320.5
"	5.8	320.6
M	5.9	320.3
"	6.1	320.1
erb	6.3	319.9
F	6.4	319.8



320.2

3175

F	6.5	319.7
crk	5.9	320.3
"A	5.6	320.6
M	5.3	320.9
"A	5.4	320.8
crk	5.6	320.6
W	5.0	321.2

PLOTTED

440

W	4.6	321.6
crk	5.2	321.0
"A	4.8	321.4
M	5.2	321.0
"A	5.7	320.5
crk	6.4	319.8
F	6.8	319.4

320.2

4425

55

E	6.9	319.3
crk	6.7	319.5
"A	6.3	319.9
M	6.0	320.2
"A	5.3	320.9
crk	5.9	320.8
W	4.7	321.5

PLOTTED

4450

W	5.0	321.2
crk	5.6	320.6
"A	5.8	320.4
M	6.3	319.9
"A	6.4	319.8
crk	6.6	319.6
F	6.6	319.6

326.2

4475

E	5.8	320.4
erb	5.6	320.6
1/4	5.5	320.7
M	5.6	320.6
1/4	5.6	320.6
erb	5.7	320.5
W	5.3	320.9

PLOTTED

510

W	4.8	321.4
erb	5.4	320.8
1/4	5.3	320.9
M	5.3	320.9
1/4	5.5	320.7
erb	5.6	320.6
E	6.0	320.2

326.2

5115

50

E	6.5	319.7
erb	5.9	320.3
1/4	5.5	320.7
M	5.4	320.8
1/4	5.2	321.0
erb	5.2	321.0
W	4.7	321.5

PLOTTED

5150

W	4.6	321.6
erb	5.0	321.7
1/4	5.2	321.0
M	5.5	320.7
1/4	5.7	320.5
erb	6.3	319.9
E	7.0	319.2

326.20

5775

E	6.8	319.4
Crk	6.0	320.7
"	5.7	320.5
M	5.5	320.7
"	5.1	321.1
Crk	5.0	321.7
"	4.5	321.7

PLOTTED

640 = 5.6 UFBs 30' wide

W	4.2	322.0
Crk	4.8	321.4
"	5.0	321.2
M	5.5	320.7
"	6.0	320.2
Crk	6.6	319.6
E	8.8	317.4
T.B	11.37	328.79
	8.78	317.42

328.8

5 UFBs

57 3

E	12.2	316.0
Crk	11.0	317.8
"	8.8	320.0
M	8.1	320.7
"	7.7	321.1
Crk	7.3	321.5
"	7.0	321.8

PLOTTED

N.L. UFBs

"	7.4	321.7
Crk	7.5	321.3
"	8.0	320.8
M	8.9	320.4
"	9.9	318.9
Crk	12.1	316.7
E	11.6	317.2

328.79

0+25 N

F	2.6	320.2
crk	10.4	318.4
"A	11.3	317.5
M	9.3	319.5
"A	8.4	320.4
crk	7.7	321.1
W	7.3	321.5

PLOTTED

0+50

W	7.5	321.3
crk	8.1	320.7
"A	9.5	319.3
M	11.1	319.7
"A	9.9	318.9
crk	7.9	320.9
F	7.1	321.7

328.8

0+75

F	6.0	322.8
crk	6.7	322.1
"A	7.7	321.1
M	9.0	319.8
"A	10.4	318.4
crk	9.1	319.7
W	7.8	321.0

PLOTTED

1+0

W	8.7	320.1
crk	9.6	319.2
"A	8.6	320.2
M	7.7	321.1
"A	6.4	322.4
crk	5.6	323.2
F	5.2	323.6

58

6.

1+25

E	4.4	322.4
crk	4.9	323.9
1/4	5.6	323.2
M	6.8	322.0
1/4	7.7	321.1
crk	8.6	320.2
W	9.2	319.6

PLOTTED

1+50

W	8.0	320.8
crk	7.4	321.4
1/4	6.5	322.3
M	5.8	323.0
1/4	4.7	324.1
crk	4.0	324.8
E	3.7	325.1

1+75

E	3.3	325.5
crk	3.6	325.2
1/4	4.0	324.8
M	4.8	324.0
1/4	5.3	323.5
crk	5.8	323.0
W	6.6	321.9

PLOTTED

2+0

W	5.2	323.6
crk	4.8	324.0
1/4	4.4	324.4
M	4.2	324.6
1/4	3.7	325.1
crk	3.5	325.3
E	3.3	325.5

328.79

2+75

E	3.0	325.8
erb	3.2	325.6
"A	3.5	325.3
M	3.9	324.9
"A	4.0	324.8
erb	4.3	324.5
W	4.5	324.3

PLOTTED

2+50

W	4.0	324.8
erb	3.6	325.4
"A	3.4	325.4
M	3.3	325.5
"A	2.9	325.9
erb	2.8	326.0
E	2.5	326.3

328.8

2+75

60

E	2.0	326.8
erb	2.3	326.5
"A	2.5	326.3
M	2.8	326.0
"A	2.9	325.9
erb	3.1	325.7
W	3.2	325.6

PLOTTED

3+0 = S. L. Myrtle st 60 wide

W	2.5	326.3
erb	2.4	326.4
"A	2.3	326.5
M	2.0	326.8
"A	1.8	327.0
erb	1.6	327.2
E	1.4	327.4

S. CURB

F	1.4	327.4
crk	1.6	327.2
"A	1.7	327.1
M	2.0	326.8
"A	2.0	326.8
crk	2.2	326.6
W	2.3	326.5
S. "A		
W	2.4	326.4
crk	2.2	326.6
"A	2.0	326.8
M	1.8	327.0
"A	1.6	327.2
crk	1.6	327.2
F	1.5	327.2

PLOTTED

F	1.4	327.4
crk	1.6	327.2
"A	1.7	327.1
M	1.9	326.8
"A	2.1	326.7
crk	2.1	326.7
W	2.2	326.6
S. "A		
W	2.1	326.7
crk	1.8	327.0
"A	1.8	327.0
M	1.9	326.8
"A	1.7	327.1
crk	1.2	327.6
F	0.8	328.0

PLOTTED

32879

N. C. V. G.

F	0.9	327.9
orb	1.3	327.5
"	1.4	327.6
M	1.2	327.6
"	1.2	327.6
orb	1.2	327.6
W	1.5	327.3

PLOTTED

N. L. Myrtle

W	1.4	327.6
orb	1.1	327.7
"	1.2	327.6
M	0.7	328.1
"	1.1	327.7
orb	1.1	327.7
F	1.1	327.7

T.P. 7.53 335.62 0.70 328.09

3356

0+25 W

62

F	7.3	328.3
orb	7.4	328.2
"	7.5	328.1
M	7.6	328.0
"	7.9	327.7
orb	7.9	327.7
W	7.8	327.8

PLOTTED

0+50

W	7.5	328.1
orb	7.5	328.1
"	7.5	328.1
M	7.2	328.4
"	6.9	328.7
orb	6.5	329.1
F	6.6	329.0



335.62

0475

E	6.3	329.3
crb	6.4	329.2
"A	6.5	329.1
M	6.9	329.7
"A	7.2	328.4
crb	7.5	328.1
W	7.3	328.3

PLOTTED

140

W	7.1	328.5
crb	6.9	328.7
"A	6.7	328.9
M	6.5	329.1
"A	6.4	329.2
crb	6.4	329.2
E	6.2	329.4

335.62

1425

63

E	5.8	329.8
crb	6.0	329.6
"A	5.9	329.7
M	6.1	329.5
"A	6.3	329.3
crb	6.5	329.1
W	6.5	329.1

PLOTTED

1450

W	6.1	329.5
crb	6.0	329.6
"A	5.8	329.8
M	5.5	330.1
"A	5.6	330.0
crb	5.6	330.0
E	5.5	330.1

335.62

1775

F	5.0	330.6
code	5.3	330.3
"A	5.4	330.7
M	5.2	330.4
"A	5.3	330.3
code	5.5	330.1
W	5.6	330.2

PLOTTED

240

W	5.5	330.1
code	5.3	330.3
"A	5.1	330.5
M	5.1	330.5
"A	5.2	330.6
code	5.1	330.5
F	5.0	330.6

335.6

2725

64

F	4.8	330.8
code	4.8	330.8
"A	4.5	
M	4.8	330.8
"A	4.8	330.8
code	4.9	330.7
W	5.1	330.5

PLOTTED

2750

W	4.8	330.8
code	4.6	331.0
"A	4.7	330.9
M	4.6	331.0
"A	4.5	331.1
code	4.4	331.2
F	4.4	331.2

335.62

2175

PLOTTED

E	4.1	331.5
crk	4.2	331.4
"	4.3	331.3
M	4.3	331.3
"	4.5	331.1
crk	4.5	331.1
W	4.6	331.0

310

W	4.2	331.4
crk	4.2	331.4
"	3.8	331.8
M	4.0	331.6
"	4.1	331.5
crk	4.0	331.6
E	3.8	331.8

335.62

3125

65

E	3.5	332.1
crk	3.7	331.9
"	3.8	331.8
M	3.9	331.7
"	3.9	331.7
crk	3.9	331.7
H	4.2	331.4

PLOTTED

3150

W	4.1	331.5
crk	3.6	332.0
"	3.7	331.9
M	3.8	331.8
"	3.5	332.1
crk	3.7	331.9
E	3.5	332.1

33562

3170

PLOTTED

E	3.1	332.5
crk	3.2	332.4
"	3.5	332.1
M	3.7	331.9
"	3.8	331.8
crk	3.7	331.9
W	3.6	332.0
W	3.4	332.2
crk	3.5	332.1
"	3.6	332.0
M	3.3	332.3
"	3.2	332.4
crk	3.1	332.5
E	3.0	332.6

440

3356

4425

PLOTTED

E	2.9	332.7
crk	2.8	332.8
"	3.0	332.6
M	3.0	332.6
"	3.3	332.3
crk	3.4	332.2
W	3.1	332.5
W	3.2	332.4
crk	3.0	332.6
"	2.8	332.8
M	2.8	332.8
"	2.9	332.7
crk	2.7	332.9
E	2.6	333.0
T.P	5.26	332.97
	1.91	333.71

4450

66

338.97

4 + 75

E	5.5	333.5
erb	5.8	333.2
"A	5.9	333.1
M	5.9	333.1
"A	6.0	333.7
erb	6.4	332.6
W	6.6	332.4

PLOTTED

5 + 0

W	6.0	333.0
erb	6.0	333.0
"A	5.9	333.1
M	5.5	333.5
"A	5.1	333.9
erb	5.1	333.9
E	5.2	333.8

338.97

5 + 25

67

E	4.8	334.2
erb	5.0	334.0
"A	5.1	333.9
M	5.2	333.8
"A	5.0	333.5
erb	5.7	333.3
W	5.9	333.1

PLOTTED

5 + 50

W	5.4	333.6
erb	4.9	334.1
"A	4.9	334.1
M	4.9	334.1
"A	4.9	334.1
erb	4.6	334.4
E	4.4	334.6

338.97

5775

68

E 4.6 334.4

crb 4.6 334.4

"A 4.6 334.4

M 4.6 334.4

"A 4.6 334.4

crb 4.6 334.4

W 4.9 334.4

PLOTTED

670 = S.L. Dwight of

W 4.8 334.2

crb 4.7 334.3

"A 4.7 334.3

M 4.3 334.7

"A 4.3 334.7

crb 4.4 334.6

E 4.5 334.5

Levels in Alley BIK 26 University Heights  
 " 20' wide

B.M. S.F.B.R Campus & Madison 352.59

B.M. 6.09 358.63

040 = N.L. Madison

E 5.6 353.0

M 5.8 352.8

W 5.7 352.9

0425

W 5.1 353.5

M 4.7 353.9

E 4.0 354.6

0450

E 6.1 352.5

M 6.3 352.3

W 5.9 352.7

0475

W 6.2 352.4

M 6.3 352.3

E 5.7 352.9

Grade book 67. p. 55

69

1+0

E 5.6 353.0

M 5.6 353.0

W 5.7 352.9

1+25

W 5.7 352.9

M 6.1 352.5

E 5.7 352.9

1+50

E 6.0 352.6

M 6.5 352.1

W 6.0 352.6

1+75

W 5.7 352.9

M 6.2 352.4

E 6.1 352.5

2+0

E 5.8 352.8

M 5.8 352.8

W 5.4 353.2

35263

2+25

W	5.2	352.8
M	6.4	352.2
E	6.3	352.3

2+50

E	6.2	352.4
M	6.3	352.3
W	6.0	352.6

2+75

W	6.5	352.1
M	6.1	352.5
E	5.9	352.7

3+0

E	4.8	353.8
M	5.5	353.1
W	5.7	352.9

3+25

W	5.9	352.9
M	5.3	353.3
E	4.7	353.9

3+50

E	4.3	354.3
M	4.9	353.7
W	5.5	353.1

3+75

W	5.6	353.0
M	5.1	353.5
E	4.8	353.8

4+0

E	4.8	353.8
M	5.3	353.3
W	5.4	353.4

4+25

W	4.8	353.8
M	5.3	353.3
E	4.8	353.8

4+50

E	4.4	354.2
M	4.2	354.4
W	4.8	353.8

70



4+69 = S.L. Adams

W

4.1 354.8

M

4.1 354.5

E

3.9 354.7

72



74



76







Xsection of Hunter St, from Jackdaw to Ingalls St,  
 50' wide - 10' curbs - 7 1/2' quarters,  
 B.M. 269.09 near S.W. Cor Hunter & Jackdaw.  
 May 18-12 } Dutton,  
 Showers,  
 Irvine

+ H.I.  
 269.70

79

	+	H.I.	-			
	0.62	269.70	269.09	+2		4.2
00 = West line of Jackdaw St.				1/4		3.9
00				c		4.0
D.L.		0.6	269.1			265.7
cl		0.9		1/4		3.9
+2		1.6		cl		3.6
1/4		1.9		1/4		3.5
c		2.1	267.6	+20		266.2
1/4		2.5		1/4		5.1
cl		2.5		cl		264.6
M.L.		2.5	267.2	cl		4.6
+20				1/4		4.6
M.L.		2.6	267.1	c		4.8
cl		3.0				264.9
1/4		3.2		1/4		4.9
c		3.3	266.4	+5		5.1
1/4		3.9		cl		4.4
+5		3.1		1/4		4.1
cl		2.0		cl		265.6
D.L.		2.5	268.2	+20		4.1
+50				1/4		5.6
D.L.		2.9	266.8	1/4		264.1
cl		3.3		cl		5.7
				+2		6.1
				1/4		6.1
				c		5.7
				1/4		264.0
						5.7

+ H.I. 269.70

Howard St. 50' wide

cl	5.4	
M.L. 1+25	5.4	264.3
M.L.	6.1	263.6
cl	6.0	
1/4	6.3	
c	6.9	262.9
1/4	7.1	
+5	7.5	
cl	6.6	
M.L. 1+50	6.3	263.4
M.L.	7.6	262.1
cl	8.3	
1/4	8.4	
c	8.2	261.5
1/4	8.0	
cl	8.0	
M.L. 1+75	8.2	261.5
M.L.	12.0	257.7
cl	12.8	
1/4	13.9	

+ H.I. 269.70

c		14.0	255.7	
1/4		13.1		
cl		11.2		
M.L.		10.2	259.5	
# 1+83	0.27	257.82	12.15	257.53
M.L.		0.0	257.8	
cl		2.6		
1/4		4.6		
c		5.1	252.7	
1/4		4.3		
cl		3.5		
M.L.		2.4	255.4	
2+00 = East line of Ingalls St.				
Cut 2+00 slope 15' north of M line				
2+00		6.6		
M.L.		8.8	249.0	
cl		9.2		
1/4		10.2		
c		11.2	246.6	
1/4		12.0		
cl		13.0		
M.L.		10.5	247.3	

+ H.I.  
267.52

- Hunter Vt. 100 wide

268.24  
1.27  
274.12  
3.93  
270.57

at 2100 slope 15° South of South line 6.6

B7K 256.99	270.59
+ 8.64	+ 1.12
265.63	271.70 H.I.
- 4.33	
263.25	
+ 11.13	
274.38	
- 3.30	
270.58	
+ 1.27	
271.85 H.I.	
- 7.92	
263.93	
+ 3.56	
267.49 H.I.	

Chalk Hunter & Jackson 269  
" " " " 259

119 18  
19 18  
29 36  

---

167.54

32929  
31933  

---

896

267.60

338.97  
5.66

---

333.37

810.10  
207.03  

---

603.07

90  
25  

---

65  
32  

---

25  
87

72.15  
70.85  

---

1.30

72.15  
60  

---

12.15

403.30  
810.10  

---

1213.40

70.95  
65  

---

71.60

