

883

883

F.B.

FIELD BOOK.

No. 400

IND

MICROFILMED

DEC 15 1964

1

2

56.0 = Curb on Cor 108

44.00 - Bot MH  
12.52  
56.52 = Tap Cover Ring

B.M.

6.72 63.24

0-56<sup>+</sup> - MH\*95 H.A.T. 44.00

0+00 WL 15ft. 66 56.6 45.33 11.3v

+50 64 56.8 46.5 10.3v

1+00 62 57.0 47.69 9.3v

+50 60 57.2 48.87 8.3v

2+00 - E 15ft. 58 57.4 50.05 7.3v

2+40 - E 15ft - MH\*96 56 57.6 51.00 6.6v

2+80 WL 15ft. 57 57.5 51.16 6.3v

3+00 57 57.5 51.24 6.3v

+50 54 57.8 51.4 6.4v

4+00 51 58.1 51.64 6.5v

+50 T.P. curb stake. 533 57.91 51.83 6.5v  
5.51 63.42 5.1 58.3

5+00 50 58.4 52.03 6.4v

+50 54 58.0 52.2 5.8v

6+00 56 57.8 52.4 5.4v

6+20 - MH\*94 56 57.8 52.5 5.3v

+50 60 57.4 52.6 4.8v

7+00 59 57.5 52.8 4.7v

+50 59 57.5 53.0 4.5v

8+00 58 57.6 53.2 4.4v

+50 55 57.9 53.4 4.5v

9+00 T.P. curb. 52 58.2 53.6 4.6v  
562 57.80

+50 10.69 68.49 10.1 58.1 53.8 4.6v

10+00<sup>+</sup> - E 13ft - MH\*93 94 59.1 54.0 5.1v

6849

10+01 <sup>2</sup> 1/2 St-MH <sup>93</sup>	9.4	59.1	54.00	5.1
+50	8.5	60.0	54.37	5.6
11+00	5.3	63.2	54.73	8.5
+50	2.3	66.2	55.10	11.1
TPCurb.	0.99	67.50		
12+00 11.33 78.83	9.6	69.2	55.47	13.7
+50	7.0	71.8	55.83	16.0
13+00	6.4	72.4	56.20	16.2
	*			
+50	6.5	72.3	56.57	15.7
14+00	6.0	72.8	56.94	15.9
+50	6.0	72.8	57.30	15.5
15+00	6.2	72.6	57.67	14.9
15+50 <sup>2</sup> 5'E of 1/2 St-MH <sup>91</sup>	6.4	72.4	58.00	14.4
TP End Ref. SE Cor 11&12	6.74	72.09		

10.43 82.52

72.09

15+56 <sup>3</sup> -5'E & 115' - MH*91	10.2	72.3	58.00	14.3
16+00	9.5	73.0	58.33	14.7
+50	8.6	73.9	58.71	15.2
17+00	7.7	74.8	59.09	15.7
+50	6.7	75.8	59.47	16.3
18+00	5.9	76.6	59.85	16.7
+50	5.0	77.5	60.23	17.3
19+00	4.1	78.4	60.61	17.8
19+50 <sup>2</sup> -E CST. 85'E & 115' - MH*90	3.9	78.6	61.00	17.6
20+00	3.6	78.9	61.66	17.2
+50	2.5	80.0	62.32	17.7
21+00	1.6	80.7	62.97	17.9
+50 T.P. curb. 7.49 89.02	0.99	81.53	63.63	18.3
22+00	7.1	81.9	64.29	18.6
+50	6.1	82.9	64.29	18.6
23+00	5.1	83.9	64.94	19.0
23+30 <sup>2</sup> -E B 85'E & 115' - MH*92	4.2	84.8	65.59	19.2
+50	4.2	84.8	66.00	18.8
24+00	4.6	84.4	66.16	18.2
+50	4.1	84.9	66.55	18.3
25+00	4.0	85.0	66.95	18.0
+50 T.P. curb. 4/16	3.7	85.3	67.34	18.0

89.02

25100	3.7	85.3	67.34	18.0
+50	3.4	85.6	67.74	17.9
26100	3.1	85.9	68.13	17.8
+50	2.9	86.1	68.52	17.6
<sup>27100</sup>	2.9	86.1	68.92	17.2
27+103 E Ast. MH*89	2.7	86.3	69.00	17.3
5'E & 115'				
T.P. Cover MH.	3.10	85.92		

4.20 90.12

27+103 MH*89				
=0400	3.8	86.3	69.00	17.3
0+50	4.1	86.0	69.50	16.5
1+00	4.6	85.5	70.00	15.5
1+50	5.4	84.7	70.50	14.2
2+00	5.9	84.2	71.00	13.2
2+50	6.2	83.9	71.50	12.4
3+00	5.90	84.22	72.00	12.2
+50	5.64	84.48	72.50	12.0
4+00	5.07	85.05	73.00	12.0
+50	4.90	85.22	73.50	11.7
5+05 = MH* 10'00' East	4.87	85.25	74.10	11.1
= 17'E & 115'				

89.52  
4.87  
84.65

12" Main Sewer Line  
 from -0+56<sup>±</sup> MH #1680 to 47+10 =  
 MH\* under Laurel St Bridge.

June 1913  
 West  
 Evidis  
 Moore.

6

Top Curb. 16+0.			56.00		
	560	61.60			
Top Ring M.H. 6.72		5.68	55.92		
Bot. F. line M.H.	62.64	18.20	43.40	Flon.	
Gr. Bot pipe = 0-56 <sup>±</sup> = MH*95			43.20	Flon. 2.40 = Bot	
0+00 N.L. 16 <sup>th</sup> ?		6.6	56.0	44.56	11.44
+50		6.4	56.2	45.77	10.4
1+00		6.2	56.4	46.98	9.4
+50	5	6.0	56.6	48.19	8.4
2+00 = FL 15 St.		5.8	56.8	49.42	7.4
+40 = E " = MH*96		5.6	57.0	50.40	6.6
+80 WL " "		5.7	56.9	50.56	6.3
3+00		5.7	56.9	50.64	6.3
+50		5.4	57.2	50.84	6.4
4+00		5.1	57.5	51.04	6.5
T.P. Curb.		5.33	57.31		
	5.51	62.82			
4+50		5.1	57.7	51.23	6.5
5+00		5.0	57.8	51.43	6.4
+50		5.4	57.4	51.63	5.8
6+00		5.6	57.2	51.83	5.4
6+20 = MH*94		5.60	57.2	51.90	5.3
				52.50	4.7
+50		6.0	56.8	52.62	4.2
7+00		5.9	56.9	52.81	4.1
+50		5.9	56.9	53.01	3.9

62.82

3K  
200  
30  
164  
950  
1227

8+00		5.8	57.0	53.21	3.8	✓
+50		5.5	57.3	53.41	3.9	✓
9+00	T.P. curb	5.2	57.6	53.61	4.0	✓
+50	10.69	5.62	57.20			
	67.89	10.1	57.8	53.81	4.0	✓
9+96 <sup>3</sup>	MH 9 <sup>3</sup> E 13 st.	9.4	58.5	54.00	4.5	✓
10+50		8.5	59.4	54.39	5.0	✓
11+00		5.3	62.6	54.75	7.8	✓
+50		2.3	65.6	55.11	9.5	✓
T.P. curb		0.99	66.90			

11.33 78.23

12+00		9.6	68.6	55.47	13.1	✓
+50		7.0	71.2	55.83	13.4	✓
13+00		6.4	71.8	56.19	15.6	✓
+50		6.5	71.7	56.54	15.2	✓
14+00		6.0	72.2	56.90	15.3	✓ ✓
+50		6.0	72.2	57.26	14.9	✓
15+00		6.2	72.0	57.61	14.4	✓
15+56 <sup>2</sup>	5 E 11 st - MH 91	6.4	71.8	58.00	13.8	✓ ✓
T.P. curb return	S.E. 11 st.	6.74	71.49			
	10.43	81.92				
16+00	up 11 st 5 E 11 st.	9.5	72.4	58.33	14.7	✓
+50		8.6	73.3	58.71	14.6	✓
17+00		7.7	74.2	59.09	15.1	✓
+50		6.7	75.2	59.47	15.7	✓
18+00		5.9	76.0	59.85	16.1	✓



81.92

18+50	5.0	76.9	60.23	16.7	✓
19+00	4.1	77.8	60.61	17.2	✓
19+50 <sup>7</sup> - 2CST-NH*90	3.9	78.0	61.00	17.0	✓
20+00	3.6	78.3	61.66	16.6	✓
+50	2.5	79.4	62.32	17.1	✓
21+00	1.6	80.3	62.97	17.3	✓
TP Curb.	0.99	80.93			
7.49	88.42				
21+50	7.1	81.3	63.63	17.7	✓
22+00	6.1	82.3	64.27	18.0	✓
+50	5.1	83.3	64.94	18.4	✓
23+00	4.2	84.2	65.59	18.6	✓
23+50 <sup>8</sup> - 2B St-NH*92	4.2	84.2	66.00	18.2	✓
23+50	4.6	83.8	66.16	17.6	✓
24+00	4.1	84.3	66.55	17.7	✓
+50	4.0	84.4	66.95	17.4	✓
25+00	3.7	84.7	67.35	17.3	✓
+50	3.4	85.0	67.74	17.3	✓
26+00	3.1	85.3	68.14	17.2	✓
+50	2.9	85.5	68.53	17.0	✓
+80 = 50ft			68.77		
27+00	2.9	85.5	68.92	16.6	
27+10 <sup>3</sup> - 1st-NH*79	2.7	85.7	69.00	16.7	✓
= 0+100 Rail line through Park.					
TP Cover NH	2.10	85.32			

↑ curbs  
park

000'

↓ A



10+50		872	78.16	9.2 <sup>✓</sup>	
11+00		878	79.24	8.6 <sup>✓</sup>	
+50		886	80.32	8.3 <sup>✓</sup>	
12+00		900	81.40	8.6 <sup>✓</sup>	
+50		913	82.48	8.8 <sup>✓</sup>	
12+65 = MH #86 Δ TOT R.T.P.		91.17	82.80	8.4 <sup>✓</sup>	
	7.64	98.81			
13+00		8.4	90.4	82.95	7.4 <sup>✓</sup>
+50		7.1	91.7	83.15	8.5 <sup>✓</sup>
14+00 Hub. - (92.61)		6.2	92.6	83.36	9.2 <sup>✓</sup>
+50		5.10	93.71	83.57	10.1 <sup>✓</sup>
15+00		4.8	94.0	83.78	10.2 <sup>✓</sup>
+50		8.89	89.92	83.99	5.9 <sup>✓</sup>
16+00		5.69	93.12	84.20	8.9 <sup>✓</sup>
+50		3.15	95.66	84.41	11.3 <sup>✓</sup>
17+00		6.07	92.74	84.62	8.1 <sup>✓</sup>
+50		4.37	94.44	84.84	9.6 <sup>✓</sup>
17+90 = MH #85 T.P. Hub. S15424.		2.57	96.24	85.00	11.2 <sup>✓</sup>
	5.84	102.08			
18+00		8.5	93.6	85.12	8.5 <sup>-</sup>
+50		10.8	91.3	85.73	5.6 <sup>✓</sup>
19+00		10.17	91.91	86.34	5.6 <sup>✓</sup>
+50		7.70	94.38	86.95	7.4 <sup>✓</sup>
20+00		6.68	95.40	87.56	7.8 <sup>✓</sup>
+50		7.10	94.98	88.17	6.8 <sup>✓</sup>
21+00		5.40	96.68	88.78	7.9 <sup>✓</sup>

92.61  
 3.56  
 96.17 = 41

96.17 96.17 96.17 96.17 96.17 96.17 84.20  
 83.78 83.78 83.78 83.78 83.78 83.78 12.71  
 13.02 12.81 12.60 12.39 12.18 11.97 92.91 = 43

96.91 96.91 96.91 96.91  
 84.41 84.41 84.41 84.41  
 12.50 12.29 12.08 11.91

84.99 97.03 97.03 97.03 97.03 97.03 97.03  
 72.04 85.73 86.34 86.95 87.56 88.17 97.03  
 97.03 = 41 11.30 12.69 12.08 9.47 8.86 94.98 = 7 P. Hub.

94.98  
 5.40  
 100.38  
 100.38 = 41 88.78  
 14.60

2265.00  
 1790.00  
 475.00



	119.75			
32+00		6.92	112.83	104.30
32+50		7.10	112.83	105.15
33+00 = MH #82.		7.74	112.01	106.00
T.P.		3.95	115.80	
	7.43	123.23		
33+50		7.2	116.0	106.44
34+00		6.3	116.9	106.88
+50		8.04	115.19	107.31
35+00		8.86	114.37	107.74
+50		8.89	114.34	108.18
36+00		10.0	113.2	108.62
+50		7.46	113.83	109.06
37+00	See PLANS 409-S SHEET #4 25° 29' - L - Calculated	6.06	117.17	109.50
37+55 = MH #81 T.P.		3.84	119.37	110.00
	7.17	126.56		
38+00		10.8	115.8	110.74
+50		9.56	117.00	111.99
39+00		9.00	117.56	113.04
+50		8.7	117.9	114.09
40+00		6.8	119.8	115.13
+50		7.38	119.18	116.18
41+00		6.7	119.9	117.22
+50 T.P. Hub.		1.90	124.66	118.27
41+85 = MH #80.	137.31	9.51	127.80	119.00

July 25-1913  
West  
Evans  
Moore

8.5v	$\frac{11569}{104.30} = 119.74$	$\frac{11569}{105.15} = 10.54v$	$\frac{11569}{106.00} = 9.69v$	$\frac{11569}{107.00} = 10.65$	T.P. H. 6 32.450.
7.5v				119.74 = H.	
6.0v	$\frac{119.74}{100.00} = 1.1974$	$\frac{119.74}{106.44} = 1.1254$	$\frac{119.74}{106.88} = 1.1204$	$\frac{119.74}{107.74} = 1.1114$	$\frac{119.74}{108.18} = 1.1066$
	$\frac{119.74}{108.62} = 1.1014$	$\frac{119.74}{109.06} = 1.0981$	$\frac{119.74}{109.50} = 1.0935$	$\frac{119.74}{110.00} = 1.0885$	$\frac{119.74}{110.74} = 1.0811$
9.6v	$\frac{119.74}{111.99} = 1.0694$	$\frac{119.74}{113.04} = 1.0594$	$\frac{119.74}{114.09} = 1.0494$	$\frac{119.74}{115.13} = 1.0394$	$\frac{119.74}{116.18} = 1.0294$
10.0v	$\frac{119.74}{117.22} = 1.0214$	$\frac{119.74}{118.27} = 1.0114$	$\frac{119.74}{119.00} = 1.0014$	$\frac{119.74}{120.00} = 0.9914$	$\frac{119.74}{121.00} = 0.9814$
7.9v	$\frac{119.74}{121.63} = 0.9844$	$\frac{119.74}{122.63} = 0.9744$	$\frac{119.74}{123.63} = 0.9644$	$\frac{119.74}{124.63} = 0.9544$	$\frac{119.74}{125.63} = 0.9444$
6.6v	$\frac{119.74}{126.56} = 0.9464$	$\frac{119.74}{127.56} = 0.9364$	$\frac{119.74}{128.56} = 0.9264$	$\frac{119.74}{129.56} = 0.9164$	$\frac{119.74}{130.56} = 0.9064$
6.1v	$\frac{119.74}{131.56} = 0.9064$	$\frac{119.74}{132.56} = 0.8964$	$\frac{119.74}{133.56} = 0.8864$	$\frac{119.74}{134.56} = 0.8764$	$\frac{119.74}{135.56} = 0.8664$
4.6v	$\frac{119.74}{136.56} = 0.8664$	$\frac{119.74}{137.56} = 0.8564$	$\frac{119.74}{138.56} = 0.8464$	$\frac{119.74}{139.56} = 0.8364$	$\frac{119.74}{140.56} = 0.8264$
4.7v	$\frac{119.74}{141.56} = 0.8264$	$\frac{119.74}{142.56} = 0.8164$	$\frac{119.74}{143.56} = 0.8064$	$\frac{119.74}{144.56} = 0.7964$	$\frac{119.74}{145.56} = 0.7864$
7.7v	$\frac{119.74}{146.56} = 0.7864$	$\frac{119.74}{147.56} = 0.7764$	$\frac{119.74}{148.56} = 0.7664$	$\frac{119.74}{149.56} = 0.7564$	$\frac{119.74}{150.56} = 0.7464$
9.4v	$\frac{119.74}{151.56} = 0.7464$	$\frac{119.74}{152.56} = 0.7364$	$\frac{119.74}{153.56} = 0.7264$	$\frac{119.74}{154.56} = 0.7164$	$\frac{119.74}{155.56} = 0.7064$
4.9v	$\frac{119.74}{156.56} = 0.7064$	$\frac{119.74}{157.56} = 0.6964$	$\frac{119.74}{158.56} = 0.6864$	$\frac{119.74}{159.56} = 0.6764$	$\frac{119.74}{160.56} = 0.6664$
5.0v	$\frac{119.74}{161.56} = 0.6664$	$\frac{119.74}{162.56} = 0.6564$	$\frac{119.74}{163.56} = 0.6464$	$\frac{119.74}{164.56} = 0.6364$	$\frac{119.74}{165.56} = 0.6264$
4.5v	$\frac{119.74}{166.56} = 0.6264$	$\frac{119.74}{167.56} = 0.6164$	$\frac{119.74}{168.56} = 0.6064$	$\frac{119.74}{169.56} = 0.5964$	$\frac{119.74}{170.56} = 0.5864$
3.8v	$\frac{119.74}{171.56} = 0.5864$	$\frac{119.74}{172.56} = 0.5764$	$\frac{119.74}{173.56} = 0.5664$	$\frac{119.74}{174.56} = 0.5564$	$\frac{119.74}{175.56} = 0.5464$
4.7v	$\frac{119.74}{176.56} = 0.5464$	$\frac{119.74}{177.56} = 0.5364$	$\frac{119.74}{178.56} = 0.5264$	$\frac{119.74}{179.56} = 0.5164$	$\frac{119.74}{180.56} = 0.5064$
3.0v	$\frac{119.74}{181.56} = 0.5064$	$\frac{119.74}{182.56} = 0.4964$	$\frac{119.74}{183.56} = 0.4864$	$\frac{119.74}{184.56} = 0.4764$	$\frac{119.74}{185.56} = 0.4664$
2.7v	$\frac{119.74}{186.56} = 0.4664$	$\frac{119.74}{187.56} = 0.4564$	$\frac{119.74}{188.56} = 0.4464$	$\frac{119.74}{189.56} = 0.4364$	$\frac{119.74}{190.56} = 0.4264$
6.4v	$\frac{119.74}{191.56} = 0.4264$	$\frac{119.74}{192.56} = 0.4164$	$\frac{119.74}{193.56} = 0.4064$	$\frac{119.74}{194.56} = 0.3964$	$\frac{119.74}{195.56} = 0.3864$
8.8v	$\frac{119.74}{196.56} = 0.3864$	$\frac{119.74}{197.56} = 0.3764$	$\frac{119.74}{198.56} = 0.3664$	$\frac{119.74}{199.56} = 0.3564$	$\frac{119.74}{200.56} = 0.3464$



13892

52757

454

13438

128.69

5.7 ✓

53702 = MH#78  
= 53700

3.73

135.19

129.00

6.2 ✓

137.07	137.07
128.69	129.00
8.408	8.09 ✓

5302
4777
5225

See #18

5302

4777

5225

53

Sewer Construction  
 to Vermont from E. of Alley  
 N. of Pennsylv. to E. of Cypress  
 Thence to M.H. & Alley S. of ✓

	2.35	287.31		284.96	BP NE Vt + Pennsylv.	
0+00			6.18	281.2	present MH Flow Line	
+50			2.21	285.10	280.77	+4.33
1			2.81	284.50	280.34	+4.16
+50			2.99	284.32	279.91	+4.41
2			3.52	283.79	279.48	+4.31
+50			3.84	283.47	279.05	+4.42
3			3.59	283.72	278.63	+5.09
+50			3.31	284.0	278.20	+5.80
+80			4.60	282.7	Flow Line Present M.H.	
✓			3.30	284.0	Tot. Rm Present M.H.	277.94
4 -			3.83	283.48	277.77	+5.71
+50			5.13	282.18	277.34	+4.84
+75 Ground +90 Break			6.0	281.3	277.0	
5			7.02	280.29	275.14	+5.14
+11 ✓			8.0	279.3		
T.P.	0.83	275.63	12.51	274.80		
+55.67 M.H. 17°42' Lt			5.15	270.45	264.85	+5.60
✓ E ground			7.6	268.0		
+81 ✓ ✓			12.9	262.7		
+81 intersection of #03 water Main			14.3	261.3		
T.P.	0.10	263.23	12.50	263.13		
6 ground			3.50	259.7		
✓ stub			2.08	261.15	256.66	+4.49
+18 ground			5.2	258.0		

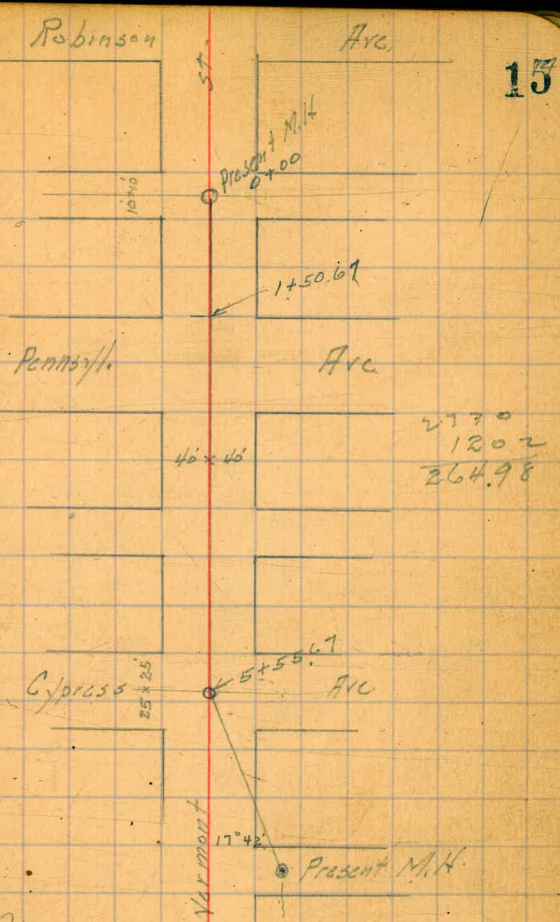

81.257  
 18.63  
 81.257  
 18.63  
 100.00



b+50	± ground	263.23	12.0	251.2°		
✓	stub		11.07	252.16°	247.13	+4.73
TP	0.10	250.32	13.01	250.22		
+65	± ground		2.0	248.3°		
+80	✓		3.9	246.4°		
7	✓		6.8	243.5°		
✓	stub		5.83	244.49°	238.19	+6.30
TP	0.00	237.77	12.55	237.77		
+50	± ground		5.4	232.3°		
✓	stub		4.06	233.71°	228.96	+4.75
+69.30	Rin M.H.		6.57	231.2°	Rin M.H.	
✓	Howlone		12.36	225.4°	Flow trap Present M.H.	

264  
490  
274

277  
23.6  
51.6

278.2  
277.33

16



Pound Canyon sewer

9/10 sample  
1/3 flow  
run

E. 10.

18

Sta	+ R	M. 1	- R	ele Top stakes	grade	cut
513				13443		
B.M. nail in post about 50' S of 47+10						
46+96						
47+10	13.11	5.50		139.93		
31' x 45' E Laurel						
47+10 = N.H. # 79		27° 02' L	7.0	132.9	126.0	6.9
+50			6.4	133.5	126.70	7.3
48			5.9	134.0	126.45	7.6
50			5.5	134.4	126.71	7.7
49			5.2	134.7	126.96	7.7
50			4.8	135.1	127.22	7.9
50+0			9.7	130.2	127.47	2.7
+50			8.0	131.9	127.72	4.2
51+0			8.0	131.9	127.78	3.9
50			8.2	131.7	128.23	3.5
52			5.5	134.4	128.49	5.9
+50			5.7	134.2	128.74	5.5
53+0 = N.H. # 78			4.23	135.20	129.0	6.2
TIP	10.95	146.13	4.73	135.20		
50			9.1	137.0	129.78	7.2
54			9.05	137.08	130.57	6.5
50			8.3	137.8	131.37	6.4
55			10.9	135.2	132.16	3.0
50			6.4	139.7	132.95	6.7
56			6.21	139.92	133.73	6.2
50			4.9	141.2	134.52	6.7
57			4.4	141.7	135.30	6.4
50			4.3	141.8	136.09	5.7
58			4.4	141.7	136.88	4.8

See P. 14

57.35  
53.00  
6.35

129.00						
129.33						
141.33	141.33	141.33	141.33	141.33	141.33	
129.78	130.57	131.37	132.16	132.95	1.19	
11.55	10.76	9.96	9.17	8.38	139.84	6.42
					146.25	
146.36	146.26	146.26	146.26	146.26	146.26	
133.73	134.52	135.30	136.09	136.78		
12.53	11.74	10.96	10.17	9.38		

14613

58+50			2.77	143.36	137.66	5.7 ✓
T.P.	11.67	155.05		143.36		
59+0			10.9	144.1	138.45	5.7 ✓
# 77						
59+35 M.H. 25° 12' R.			10.50	144.5	139.0	5.5 ✓
50			10.1	144.9	139.23	5.7 -
60+0			10.1	142.9	139.99	2.9 ✓
50			7.9	147.1	140.75	6.4 ✓
61			7.6	147.4	141.51	5.9 ✓
50			6.8	148.2	142.27	5.9 ✓
62			4.83	150.22	143.04	7.2 ✓
50			4.0	151.0	143.80	7.2 ✓
63			3.8	151.2	144.56	6.5 ✓
50			4.2	151.0	145.32	5.7 ✓
64			3.0	152.0	146.08	5.9 ✓
64+50			2.14	152.1	146.85	6.1 ✓
	12.17	165.02	2.14	152.91		
64+60 M.H. #76 11° 33' L.			12.1	153.0	147.0	6.0 ✓
65			11.5	153.6	147.64	6.0 ✓
50			10.2	154.9	148.44	6.5 ✓
66			12.8	152.3	149.24	3.1 ✓
50			8.97	156.11	150.04	6.1 ✓
67			8.8	156.3	150.84	5.5 ✓
50			8.2	156.9	151.64	5.3 ✓
68			8.4	156.7	152.44	4.3 ✓
50			5.4	159.7	153.24	6.5 ✓

E 10

19

cut

14626	14626	14626	14626	
13766	13845	13900	1.31	
8.60 ✓	7.81 ✓	7.26 ✓	144.95	
			504	
			149.99	
14999	14999	14999	149.99	149.99
13999	14075	14151	14227	14304
10000 ✓	9.24 ✓	8.48 ✓	7.72	6.75 ✓
150.22				
465				
154.87 - A)				
15487	15487	15487	15487	15487
14304	14380	14456	14532	14608
11.83 ✓	11.07 ✓	10.31 ✓	9.55 ✓	8.79
			6460	
			5735	
			525	

165.08

69.0			3.3	161.8	157.04
50			3.1	162.0	157.84
69+60 = M.H. 75			3.0	162.1	155.0
70			2.1	163.0	155.64
50			3.9	161.2	156.44
71			2.74	162.34	157.24
T.P.	12.68	175.02	2.74	162.34	157.24
50			11.3	163.7	158.04
72			10.4	164.6	158.84
50			9.18	165.84	159.64
73			8.6	166.4	160.44
50			11.4	163.6	161.24
74			7.6	166.4	162.04
50			6.0	169.0	162.84
74+60 = M.H. 74			6.0	169.0	163.0
75			4.8	170.2	163.62
50			4.14	170.28	163.9
76			7.40	173.62	165.17
T.P.	5.75	182.37	11.40	173.62	
50			8.0	174.4	165.94
77			10.6	171.8	166.72
50			9.0	173.4	167.49
78			8.35	174.02	168.27
50			8.4	174.0	169.04
79			5.9	176.5	169.81
50			3.88	178.49	170.59
79+77 = M.H. 1073 4° 08' L			3.0	174.4	171.00
T.P.			3.88	178.49	

E 10

20

7.8	Not down	15.5.64 10.70 166.34 158.00 77.34	
7.2	Not down		
7.1			74.60 69.60
7.4	✓		5.00
7.8	✓		79.77 74.60
5.1	✓		5.17
5.7	✓		
5.8	✓		
6.2	✓		
6.0	✓		
7.4	✓		
4.4	✓		
6.2	-		
6.0	✓		
6.6	Not dug	171.8 4.34 176.10 166.72 9.38	176.10 176.10 176.10 176.10 165.95 165.17 164.39 163.62 10.15 ✓ 10.93 ✓ 11.71 ✓ 12.48
6.5	✓		
2.4	✓	176.10 163.00 13.10	176.10 162.04 14.06 ✓
8.0	✓		
5.1	✓		
5.9	✓		
5.7	✓		
5.0	✓		
6.7	✓		
7.9	✓		
8.4	✓		

			+	Hub. Surface	Bot Cr	Cuts.	
5.77+50 Hub.	111		6.61	176.49	Checks	OK	June 2-1913
7.9+77-18.73			5.7	177.4	171.20	9.4 ✓	Waaf
80+0			8.9	176.2	171.54	4.7 ✓	Excels
50	5.39	185.10	9.4	175.7	172.71	3.0 ✓	Mura
81+0 T.P. Hub.			12.61	179.71	173.83	5.8 ✓	
50			11.7	180.6	175.05	5.5 ✓	
82+0			12.4	179.9	176.22	3.7 ✓	
50			11.6	180.7	177.31	3.3 ✓	
83+0	2.95	192.32	5.9	186.4	178.50	7.8 ✓	
50 T.P. Hub.			3.84	189.37	179.74	9.6 ✓	
83+60 = M.H. = 472 42° 49' A = 81997			3.5	189.7	180.00	9.7 ✓	
84+0			5.0	188.2	180.43	7.8 ✓	
50			6.6	186.6	180.99	5.6 ✓	
85+0			6.2	187.0	181.56	5.4 ✓	
50			5.8	187.4	182.11	5.3 ✓	
86+0			7.8	185.4	182.66	2.7 ✓	
86+30 = 64392 = 3rd bank 400 page 55			4.2	189.0	183.00	6.0 ✓	
86+30 = M.H. = 1 43° 06' L							

sheet E 10 21

83.61  
79.77  

---

384

See F.B. 400 Pg (55)  
1522 Pg (6)

19321  
Levels road bottom, up, page

5

June 2 - 1913

West  
Evans  
Moore

Sheet E. 8

22

5+50	1.91	202.82		200.71	
2					
2+0 = M.H.	43° 42' L.	Section 44 074	4.16	198.66	199.00
2+0 = M.H. 485	<del>43° 42' L.</del>	<del>Section 44 074</del>	3.3	199.5	192.40
+50			4.2	198.6	190.81
3+0			5.7	197.1	189.21
+50			8.39	194.43	187.62
4+0 =			8.9	193.9	187.00
4+19 = M.H. 6	72° 00' L.		10.3	192.5	186.43
4+50			12.94	189.88	185.50
5+0	T.P. Hob.		2.0	191.2	184.58
+50	3.33	193.21	3.4	189.8	183.65
6+0			4.2	189.0	183.00
6+34	36° 30' L.	M.H. 1			

See FB 400 Pg 55

FB 1522 Pg 6

Hub. MH 2477:	3.95	238.04	234.77			
TP	0.51	226.57	11.91	226.06		
TP	10.43	214.60	12.40	214.17		
TP	8.43	210.18	12.85	211.75		
BM						
2400						
0+00 = NH #48.		11.52	198.66	194.00	4.7 ✓	
+50 BM		9.27	200.91	195.93	5.0 ✓	
1+00		6.96	203.22	197.87	5.3 ✓	
+50		7.4	202.8	199.81	3.0 ✓	
2+00		4.0	206.2	201.74	4.5 ✓	
+50 TP		0.33	209.85			
+50	12.18	222.03	12.13	207.90	203.68	6.2 ✓
3+00			8.6	213.4	205.62	7.8 ✓
+50			5.2	216.8	207.55	9.2 ✓
3+873 = NH #49.			8.43	213.60	209.00	4.6 ✓
4+00			8.2	213.8	209.58	4.3 ✓
+50			5.6	216.4	211.57	4.8 ✓
5+00 TP			5.70	216.33	213.61	2.7 ✓
+50	12.20	228.53	7.4	221.1	215.66	5.1 ✓
+67 = MH for 7st. south.		119/2	4.1	224.4	216.35	8.0 ✓
6+00			6.4	222.1	217.70	4.4 ✓
+50			4.4	224.1	217.75	4.3 ✓
7+00 TP			1.94	227.49		
7+00	12.42	239.9	12.1	227.8	221.79	6.0 ✓
7+54 = NH #52.						
= 6700 of Alley Line			10.5	229.4	224.00	5.4 ✓
between 6st + 7st.			4.3	235.6	225.55	10.0 ✓
8+00			1.9	238.0	227.23	10.8 ✓
+50			3.7	236.2	226.92	7.3 ✓
9+00			4.92	234.99	230.00	5.0 ✓
9+315 = NH #56.						
= 2179 on 6st line.					230.00	

Hubs offset 2 West L.

Hubs offset 2 North L.

May 31 - 1913. Brook St Canon Line 23  
 West Evans Moore  
 9+315 to 0+00.  
 Sheet E.7.

See page 51



95<sup>th</sup> Sewer from 2+00 Brooks to 2+184  
 & 20+84 to 1+27 below treated at 10<sup>th</sup> St.  
 sheets E 8 + E 9.

June 5-1913  
 West.  
 Evans.  
 Moore.

24

Sta.	+ H.I.	-	Surface Elev.	Bot. Gr.	Cuts
B.M. Hub 0+50 Brooks St.			200.91		
00-200-NH <sup>56</sup> 10.13	211.04			194.00	
1+50		11.63	199.41	194.50	4.9 ✓
1+00		10.50	200.54	195.00	5.5 ✓
0+50		8.15	202.89	195.50	7.4 ✓
00-20+84-NH <sup>57</sup>		6.0	205.0	196.00	9.0 ✓
20+50		6.77	204.27	196.88	7.4 ✓
20+00	3	7.37	203.67	196.16	5.5 ✓
19+50		7.83	203.21	199.47	3.7 ✓
19+15-NH <sup>58</sup>		6.62	204.42	201.34	4.1 ✓
18+50		4.50	206.54	202.02	4.5 ✓
18+00 TR Hub.		3.06	207.98	203.22	4.7 ✓
	13.01	220.99			
17+73-NH <sup>59</sup>		13.3	207.6	204.10	3.6 ✓
17+50		12.0	209.0	204.60	4.4 ✓
17+00		11.5	209.5	215.90	3.6 ✓
16+50		12.2	208.8	207.20	1.6 ✓
16+18-NH <sup>60</sup>		9.23	211.76	208.00	3.8 ✓
16+00		7.3	213.7	218.56	5.1 ✓
15+50		6.3	214.7	209.86	4.8 ✓
15+00		3.3	217.7	211.5	6.5 ✓
14+50		5.77	215.02	212.43	2.6 ✓
14+00		3.47	217.52	213.72	3.8 ✓
13+89-NH <sup>63</sup> TR Hub.		2.91	218.01	214.00	4.0 ✓

E.9.

15+89 MH*63		218.01	214.00	4.0 <sup>v</sup>	
	12.58	230.59			
13+50		10.9	219.7	215.03	4.7 <sup>v</sup>
13+00		7.0	223.6	216.35	7.2 <sup>v</sup>
12+68 MH*65		5.57	225.02	217.21	7.8 <sup>v</sup>
12+50		3.9	226.7	217.82	8.9 <sup>v</sup>
12+00		8.0	222.6	219.53	3.1 <sup>v</sup>
11+50 T.P. H66		2.75	227.84	221.25	6.6 <sup>v</sup>
	12.99	240.83			
11+00		5.0	235.8	222.97	12.8 <sup>v</sup> w/ant.
10+50		3.3	237.5	224.68	12.8 <sup>v</sup>
10+00		1.5	239.3	226.40	12.9 <sup>v</sup>
9+61 MH*66		0.3	240.5	227.74	12.8 <sup>v</sup>
9+00		0.4	240.79	229.83	11.0 <sup>v</sup>
8+37 MH*67 T.P. H66		4.68	236.15	232.00	4.2 <sup>v</sup>
	12.68	248.83			
8+00		11.47	237.36	233.10	4.3 <sup>v</sup>
7+50		10.0	238.8	234.60	4.2 <sup>v</sup>
7+00		7.34	241.49	236.10	5.4 <sup>v</sup>
6+50		6.65	242.18	237.60	4.6 <sup>v</sup>
6+00		6.04	242.79	239.10	3.7 <sup>v</sup>
5+70 MH*69		3.80	245.03	240.00	5.0 <sup>v</sup>
5+50 T.P. H66		1.47	247.36	240.63	6.8 <sup>v</sup>
	7.74	255.10			

Sheet E9.

255.10

5+00		8.74	246.36	242.19	4.2 <sup>✓</sup>
4+42 MH <sup>90</sup>		6.93	248.17	244.00	4.2 <sup>✓</sup>
4+00		4.15	250.95	246.31	4.6 <sup>✓</sup>
3+50 TP Hub.		1.88	253.22	249.05	4.2 <sup>✓</sup>
	8.88	262.10			
3+00		5.1	257.0	251.80	5.2 <sup>✓</sup>
2+50		1.8	260.3	254.54	5.8 <sup>✓</sup>
2+00 TP Hub.		0.20	261.90	257.29	4.6 <sup>✓</sup>
1+87 = MH <sup>91</sup> <sup>5.22</sup> <sub>267.12</sub> under trestle.		3.97	263.15	258.00	5.2 <sup>✓</sup>

8<sup>th</sup> St Sewer from 8+37 N.H. 67 to  
D.E. 100's. of lot line bet 182

Prel. 400-73

27

9-100 Hdb.

Sheet E 7. 240-71

8+37 MH*67-3+61 <sup>2</sup> on 8 <sup>th</sup> St Lrk	236.15	292.00	4.1	✓
10.29 246.44				
3+20 break	5.5	240.9	237.00	3.9
3+00 T.P. Hdb.	1.23	245.21	240.57	4.6
+75 North Tunnel	12.64	257.85	245.03	✓
2+50 T.P. Hdb.	0.43	257.42	249.50	7.9
2+35 North Tunnel	11.89	269.31	252.18	✓
2+00	3.51	265.80	258.43	7.4
1+60 MH*68 TP	3.34	265.97	262.00	4.0
11.50 277.47				
1+50	9.0	268.5	264.00	4.5
1+20 break	6.7	270.8	266.00	4.8
1+00	5.8	271.7	264.34	5.4
0+50	5.1	272.4	267.17	5.2
0+00 D.E.	5.36	272.11	268.00	4.1

8<sup>th</sup> St from 125's. of line bet lots 1+2 to 1+89 on  
9<sup>th</sup> St line.

0+00 D.E.	5.7	271.8	268.00	3.8
+50	6.1	271.4	266.75	4.6
1+00	6.6	270.9	265.50	5.4
1+20 break	6.8	270.7	265.00	5.7
1+50	9.0	268.5	258.57	10.4
T.P.	11.44	266.03		
1.07 267.10				
2+00 T.P.	12.72	254.38	246.53	7.9
1.00 255.38				

E.7

255.38

T.P.		12.79	242.59		
	2.09		244.68		
2+37-NH*64		3.17	241.51	238.00	3.5 ✓
2+50		5.17	239.51	234.98	4.5 ✓
2+80 break.		11.7	233.0	228.00	5.0 ✓
3+00	b	13.8	230.9	226.24	4.7 ✓
T.P.		11.86	232.82		
3+93	1.74		234.56	225.10	
3+50		3.5	231.1	221.84	9.3 ✓
4+00		6.53	228.03	217.44	10.6 ✓
T.P.		12.33	222.23		
	4.93		227.16		
4+39-MH 3+13+89 in 3rd line.		9.13	218.03	214.00	4.0 ✓

Line from MH 5+20 in Marston tract.  
to J.E. 100' East of Cannon

	12'00" R.			237.65	230.00	8.7.6r
5+20-0+100-MH. 12.41		250.06				7.7 ✓
0+50		9.92	240.14	234.00		6.1 ✓
1+00-0E.	b	6.41	243.65	238.00		5.0 ✓

July 2-1913.  
West  
Evans  
Moore

240.14  
6.80  
246.94  
234.00  
12.94 ✓

246.94  
238.00  
8.94 ✓

Alley line bet Penn & Cypress.  
9.54 to 25 W. of Vermont.

Sheet E.6.

For Profile  
purpose  
- EL. E

EL. Hobbs. Bot. Gr.

14750 - Hub.	+	HI						
M.H. 16 + 18.35 = M.H. 8 + 49.6 Alley line.	10.10	225.12	215.22	211.76	208.00	3.8	✓	
= 9 + 92 Cotton line L R = 69.25'								
9 + 50		10.3	214.8	10.23	214.89	209.96	4.9	
9 + 00		5.6	219.5	4.99	220.13	212.31	7.8	
8 + 50 TP Hub.		1.2	223.9	0.54	224.58	214.64	9.9	
+23 12.73		11.4	220.9					
8 + 00		12.0	225.3	11.41	225.90	216.78	8.9	
+25		13.8	223.5					
7 + 50		12.1	225.2	11.57	225.74	219.31	6.4	
7 + 35 - M.H.* < 925'R.				10.72	226.61	220.00	6.6	
+21		12.4	224.9					
7 + 00		10.2	227.1	10.91	226.40	221.63	4.8	
+85		5.8	231.5					
6 + 50		6.0	231.3	6.90	230.41	223.96	6.4	
+25		7.8	227.5					
6 + 00		5.3	232.0	4.25	233.96	226.98	6.8	
+75 TP 10.22		1.4	235.7	0.35	236.76			
5 + 50		8.8	238.4	7.71	239.47	228.61	10.9	
5 + 20 = M.H.* < 8500'R.				9.53	237.65	230.00	7.7	
+15 bottom Corn		11.1	236.1					
5 + 00		6.1	241.1	6.22	240.96	236.57	4.4	
+10 TP rock.				0.77	246.41			
Break A + 50 TP Hub.	12.10	258.51	6.0	252.5	0.81	257.70	253.00	4.7
+30			0.5	258.0				
Break A + 10 TP rock.	12.48	270.18	3.6	266.6	1.81	268.37	273.00	3.6
+40			6.2	274.2	4.82	276.55		
3 + 50		281.37	3.5	277.9				
+40			2.8	280.6	1.43	279.90	273.75	6.2
+40			1.5	277.1				
TP. 3 + 20 - M.H.* < 5600'L				0.36	281.01	274.20	6.8	
6.34		287.35	6.5	286.9	6.60	280.75	274.53	6.2
3 + 00			5.8	281.6	5.78	281.57	275.34	6.2
2 + 50					5.78	281.57	276.15	5.4
2 + 00					4.75	282.40	276.96	5.4
1 + 50					4.33	283.02	277.78	5.2
1 + 00					3.47	283.18	278.59	5.3
0 + 50					3.40	283.95	279.00	5.0
0 + 25 - NE 50' W Vermont.								

7/6/10  
West  
Evans  
Moore.

Bottom stakes 8/9/13.

29

283.95							
2.66							
286.61 - 10	8661	8661	8661	8661	8661	8661	8661
279.00	7857	77.38	76.76	72.15	75.34	74.53	74.20
7.61	8.02	8.33	9.65	10.46	11.27	12.08	12.41
286.61							
5.86							
286.75 = TP							
9.93							
284.68 - 10	28468	28468					
	273.75	273.00					
	10.93	11.68					

166  
1020

Main Canon line thru Marston tract

Sheet E.A.

6/13/10. West.  
Evans.  
Moore.

BM 4+00	1062	205.05	194.43		
MH 6+19 <sup>3</sup> = 7+67 <sup>2</sup> <small>Canon line L 80°30' R.</small>		11.15	193.90	187.00	6.9 <sup>✓</sup>
7+00		11.5	193.6	187.90	5.7 <sup>✓</sup>
6+50		10.5	194.6	188.56	6.0 <sup>✓</sup>
6+00		11.3	193.8	189.22	4.6 <sup>✓</sup>
5+50		12.25	192.8	189.88	2.9 <sup>✓</sup>
5		9.45	195.6	190.54	5.1 <sup>✓</sup>
4+50		7.83	197.22	191.20	6.0 <sup>✓</sup>
4		8.13	196.92	191.86	5.0 <sup>✓</sup>
3+50		8.24	196.81	192.52	4.3 <sup>✓</sup>
3+12 <sup>8</sup> - MH 7 <sup>14</sup> <small>14°50' L. Alley bet Branks + Myrtle.</small>		7.26	197.79	193.00	4.8 <sup>✓</sup>
2+50		6.23	198.82	194.61	4.2 <sup>✓</sup>
2+00 TP Hub.		3.18	201.87	195.89	6.0 <sup>✓</sup>
	11.69	213.56			
1+50		10.7	202.9	197.17	5.7 <sup>✓</sup>
1+00		6.3	207.3	198.45	8.8 <sup>✓</sup>
0+50		8.1	205.5	199.73	5.8 <sup>✓</sup>
0+00 = MH 8 <sup>36</sup> <small>36°24' R. m &amp; Branks</small>		7.4	206.2	201.00	5.2 <sup>✓</sup>
4+00		5.6	208.0	201.74	6.3 <sup>✓</sup>
3+50		7.0	206.6	202.90	3.7 <sup>✓</sup>
2+97 - MH 10 <sup>10</sup> <small>10°00' to Alley line North</small>		2.57	211.0	204.13	6.9 <sup>✓</sup>
2+50 TP Hub.		0.46	213.10	205.22	7.7 <sup>✓</sup>
	10.84	223.94			
2+00 <small>Everment Ave</small>		13.7	210.2	206.38	3.8 <sup>✓</sup>
1+50		10.57	213.37	207.54	5.8 <sup>✓</sup>
1+22 MH 12 <sup>12</sup> <small>End of 8" Pipe. 8+45 = 500' 23' 7"</small>		9.27	214.67	208.19	6.5 <sup>✓</sup>

	223.94					
1+22-NH <sup>#</sup> 12		9.27	214.67	208.19	6.5 ✓	
1+00		7.8	216.1	208.70	7.4 ✓	
0+50		5.5	218.4	209.85	8.5 ✓	
0+00-NH <sup>#</sup> 13	Δ 35°50' L. -142' E. of monument in E of brook	7.8	216.1	211.00	5.1 ✓	
0+50		5.5	218.4	211.77	6.6 ✓	
1+00		3.40	220.54	212.54	8.0 ✓	
1+50 T.P. Hub.		5.00	218.94	213.31	5.6 ✓	
	12.24	231.18				
2+00		10.6	220.6	214.08	6.5 ✓	
2+50		7.77	223.41	214.85	8.5 ✓	
3+00		7.02	224.16	215.62	8.6 ✓	
3+24-NH <sup>#</sup> 28	Δ 2°49' L. = 1140' along	6.71	224.47	216.00	8.5 ✓	
				219.00	5.5 ✓ trench.	
3+50		9.1	222.1	219.40	2.7 ✓	
4+00		5.5	225.7	220.17	5.5 ✓	
4+50		3.02	228.16	220.94	7.2 ✓	
5+00 T.P. Hub.		1.18	230.00	221.71	8.3 ✓	
	5.44	235.44				
5+50		4.82	230.62	222.47	8.1 ✓	
5+85-NH <sup>#</sup> 32	Δ 30°50' R.	7.60	227.84	223.00	4.8 ✓	
6+00	12.87	240.71	11.33	229.38	223.32	6.1 ✓
6+50		9.50	231.21	224.37	6.8 ✓	
7+00		7.30	233.41	225.48	8.0 ✓	
+50		6.88	233.83	226.48	7.3 ✓	
7+69 <sup>L</sup> -NH <sup>#</sup> 33	Δ 26°05' L.	8.93	232.78	226.88	5.9 ✓	

See PAL for Canon line to Alley bet Penn &amp; Gorge



		240.71			
7+69 <sup>L</sup> -MH <sup>33</sup>			8.93	231.78	226.88
6+00			9.71	231.00	227.53
+50			6.82	233.89	228.59
9+00	TPHub.		3.02	237.69	229.64
9+50	10.23	247.92	9.00	238.92	230.70
10+00			8.43	239.49	231.75
+50			9.88	238.04	232.81
11+00	NH <sup>34</sup> 563°05'L.		9.25	238.67	234.00
11+50			5.48	242.44	235.85
12+00			1.64	246.28	237.91
+50	TPHub. 11.32	256.74	2.50	245.42	239.99
12+972	NH <sup>36</sup> 96°57'L. 5100 ft.		9.24	247.50	242.00
3+231			7.86	246.88	243.42
3+260			6.04	250.70	245.87
2+50			3.23	253.51	248.32
2+00			2.55	254.19	250.77
1+50	TPHub.		11.34	255.99	252.00
1+25	NH <sup>35</sup> 12.54	266.73	7.33	259.40	256.60
1+00			0.80	265.93	
0+50	TP 12.56	278.49	6.25	272.24	265.80
0+00	TP 9.78	286.80	1.47	277.02	
			6.37	280.43	275.00

4.9 ✓  
3.5 ✓  
5.3 ✓  
8.4 ✓  
8.2 ✓  
7.7 ✓  
5.2 ✓  
4.7 ✓  
6.6 ✓  
8.4 ✓  
5.4 ✓  
5.5 ✓  
3.5 ✓  
4.8 ✓  
5.2 ✓  
3.4 ✓  
3.4 ✓  
2.8 ✓  
6.4 ✓  
5.4 ✓

Line E thru Bl. 218 from 3+12<sup>3</sup> MH\* J  
 = 14+49 to 10+15. Sheet EA  
 Alley bet Myrtle + Brooks.

BM 3+12 <sup>3</sup> Hub	10.49	207.30		196.81	
3+12 <sup>3</sup> = 14+49 - MH*				197.79	193.00
14+00 TP Hub.			2.76	204.54	199.60
13+60 break.	11.29	215.83	5.54	210.29	205.00
13+50 TP Hub			2.65	213.18	206.75
13+00 TP Hub.	11.21	224.39	3.37	221.02	215.50
12+50	12.38	233.40	4.88	229.32	224.25
12+00 break.	TP rock 11.46	244.53	0.33 6.52	233.97 238.01	233.00
11+60 - break	TP rock 12.32	256.07	0.78 7.02	243.76 249.05	243.00
11+50			3.64	252.43	243.25
11+00	5		5.17	250.90	244.50
10+80 - break			7.32	248.75	245.00
10+50 TP rock	11.64	267.40	0.33 6.70	255.74 260.70	256.10
10+15 - TP Rock	12.14	277.91	1.63 3.95	265.77 273.96	267.00
-25' W. Vermont.			6.29	271.62	

1449  
10 15  
23 1/2

6/13/72 West  
Evans  
Moore.

4.8 ✓  
4.9 ✓  
5.3 ✓  
6.4 ✓  
5.5 ✓  
5.1 ✓  
5.0 ✓  
6.0 ✓  
9.2 ✓  
6.4 ✓  
3.8 ✓  
4.6 ✓  
5.0 ✓

Alley line thru Bl. 217 Bet. Brooks & Cypress  
to M.H. #10 Sta. 2+97 M.L. = 0+00 Alley line.

Sheet E 3.

2+50 - B.N. Hub.	12.94	226.04		213.10	
2+97 = 0+00 = M.H. #10				211.00	204.60
0+50			9.18	216.86	211.00
1+00 T.P. Hub.			2.31	223.73	217.90
+50	13.13	236.86	4.15	232.71	224.91
1+94 M.H. #9 - E Alley bet Brooks & Cypress = Sta 17+12 Alley line			0.70	236.16	231.00
17+00 east of Alley T.P. rack.	10.51	246.27	0.70	236.16	231.00
16+50 T.P. rack	12.58	258.15	7.06	239.21	235.04
16+20 = D.E. 25 W. Vermont	11.97	269.84	0.70	245.57	
			0.30	257.85	251.89
			11.76	258.68	
			1.97	267.87	262.00

Alley line West up hill to D.E.

17+12 = M.H. #9 T.P. rack.	11.97	248.13		236.16	
17+50 T.P. Hub.	11.60	259.40	0.33	247.80	231.00
17+80 break	11.77	270.11	1.06	258.34	252.77
18+00	11.97	281.73	0.37	269.74	270.00
+50			5.10	276.63	270.00
19+00 T.P. Hub.			3.00	278.73	270.15
+50			4.45	277.28	270.53
20+00	4.97	285.19	1.52	280.21	270.72
20+40 = D.E. east 105 ft.			5.40	279.79	271.30
			6.70	278.49	271.69
			8.30	276.89	272.00

6/12/13 West  
Evans.  
Moore.

34

Note: - M.H. Contractor was instructed by Taylor, foreman for sewer Co. to put this at D.M.H. but had no orders from Engr. Elev pipe at M.H. is 204.60 so on next heavy fall allowed them to connect as constructed.

6.9 ✓  
5.8 ✓  
5.7 ✓  
7.8 ✓  
5.2 ✓  
5.2 ✓  
4.2 ✓  
6.8 ✓  
5.9 ✓

E.3

Bottom stakes 9/13 West  
Levine  
Evans.

276.63					
423					
230.86	280.86	280.86	280.86	280.86	280.86
272.80	270.53	278.92	271.30	271.69	272.00
10.86	10.33	9.94	9.56	9.17	8.86

5.6 ✓  
6.6 ✓  
8.5 ✓  
6.8 ✓  
9.3 ✓  
8.5 ✓  
6.8 ✓  
4.9 ✓

17.2  
10.0  
9.2

From NH<sup>#</sup> 12 sta 1+22 = 3+45 to sta 0+00 on E  
 Alley bet Myrtle + Brooks from Vermont to Richmond  
 Sheet E 4

4/13/13. West  
 Evans  
 Moore

35

1+22 - DNH <sup>#</sup> 12 = 3+45		11.17	214.64	208.19	4.6 6.5 ✓
3+00		11.26	214.55	209.47	5.1 ✓
2+50		10.40	215.41	210.89	4.5 ✓
2+00		9.02	216.79	212.31	4.5 ✓
1+50	5	6.69	219.12	213.73	5.4 ✓
1+00		6.47	219.34	215.15	4.2 ✓
0+50		4.68	221.13	216.58	4.6 ✓
0+00 = 6+00 = NH <sup>#</sup> 14 & Alley	2.12 225.81		223.69	218.00 220.00	5.7 ✓ 3.7 ✓

West on Alley from 6+00 to 8+85 DE

0+00 = 6+00 NH <sup>#</sup> 4	1.67	229.75	6.06	223.69	220.00	2.7 ✓
6+50 TP Hub.			11.47	228.88	224.17	3.9 ✓
6+60 - break			10.97	229.48	225.00	4.5 ✓
7+00	0.92	239.55	3.32	236.23	233.34	2.9 ✓
7+50 TP Hub.	1.50	250.77	12.74	238.63		5.5 ✓
7+80 - break			6.20	254.12	250.00	4.7 ✓
8+00		260.32	4.0	256.3	252.86	3.4 ✓
8+50 TP rock	0.40		12.57	259.92	260.00	4.5 ✓
8+85 = DE 25E Vermont			2.36	270.13	265.00	5.1 ✓

East on Alley from 6+00 to 0+00

6+00 = NH <sup>#</sup> 4	12.51	236.20		223.69	220.00	3.7 ✓
5+50			8.13	228.07	221.25	6.8 ✓
5+00	5		7.94	228.26	222.50	5.8 ✓
4+50			8.73	227.47	223.75	3.7 ✓
4+00 break			6.81	229.39	225.00	4.4 ✓
3+50 TP rock	12.71	248.25	0.66	235.54	234.38	3.9 ✓
3+20 break			10.00	238.25	240.00	3.7 ✓
3+00			4.57	243.68	240.72	6.2 ✓
2+69 = Sta 5+68 = E Richmond = NH <sup>#</sup> 15			0.71	247.54	240.32	7.2 ✓

June 13 1913  
West  
Evans  
Maore

Canon line from 0+00 Alley bet Brooks +  
N of the W. of Albert. to 0+75 Alley bet Brooks +  
N of the E of Herbert. 246.25 E. 5

2+69 = MH #15 = 54672 Richmond St. 10.88	RP. Hub.	258.42	0.71	247.54	240.32	7.2 ✓
2+50			11.34	247.08	240.43	6.7 ✓
2+00			6.7	251.7	240.74	11.0 ✓
1+50			9.27	249.15	241.05	8.1 ✓
1+00			9.70	248.72	241.37	7.4 ✓
0+50			10.07	248.35	241.68	6.7 ✓
0+00 = NH #17 = 5449	442' 21" R. TR Hub. 254.91		13.00	245.42	242.00	3.4 ✓
0+50			4.5	250.4	242.57	7.8 ✓
0+88.5 = MH #18 = 1+90 Hwy St. 100 = E. Albert.	423' 22" L.		4.8	250.1	243.00	7.1 ✓
1+00			7.0	247.9	243.69	4.2 ✓
1+50 TR Hub.			3.85	251.06	246.49	4.6 ✓
2+00	12.06	263.12	6.7	256.4	249.28	7.1 ✓
2+50			4.06	259.06	252.06	7.0 ✓
3+00			4.5	258.6	254.84	3.8 ✓
3+50 TR Hub.			1.28	261.84	257.62	4.2 ✓
3+93 = 5442493 = NH #19 = 54434142 on Herbert St. Survey	10.68 Marta line	272.52	3.82	268.70	260.00	8.7 ✓
4+00			<del>6.9</del>		260.30	
+50	E. 5		6.9	265.6	262.42	3.2 ✓
5+00 TR Hub.			6.21	266.31	264.54	1.8 ✓
+50	13.16	279.47	8.4	271.1	266.66	4.4 ✓
6+00			5.94	273.53	268.77	4.7 ✓
6+29			4.7	274.8	270.00	4.8 ✓

See P. 76 for Albert St. line



= 1+75 Alley line bet  
Brooks + N of the

Alley line bet Herbert & Park Road.  
 From 0+00 - 25'S Cypress to 10+10 25'N Upgs.  
 Sheet E Z.

JUN 23-1930  
 West  
 Evans  
 Moore

0+00 - F.T. 25'S of Cypress	3.8	295.4	291.00	4.4
0+50	4.00	295.16	290.57	4.6
1+00	4.8	294.4	290.14	4.3
1+50	5.08	294.05	289.71	4.4
2+00	5.6	293.6	289.28	4.3
2+50	5.4	293.8	288.84	5.0
3+00	4.85	294.31	288.41	5.9
3+14 - NH* 21 - E Decks	5.3	293.9	288.32	5.6
3+50	6.3	292.9	287.93	4.9
4+00	6.45	292.71	287.55	5.2
4+50	7.2	292.0	287.12	5.0
5+00	8.94	299.16	286.69	4.0
450 TP Hub	8.29	290.22	286.75	4.0
6+00	11.1	287.4	285.82	1.6
450	11.7	286.8	285.09	1.4
6+93 - NH* 22 & Martha	8.5	290.0	285.00	5.0
7+50	6.4	292.1	285.36	6.7
8+00	6.16	292.35	285.61	6.7
450	5.36	293.15	286.01	7.1
9+00	5.5	293.0	286.35	6.6
450	5.31	293.20	286.68	6.5
10+00	6.4	292.1	287.00	5.1
450	6.54	298.51	287.33	5.3
10+73 NH* & Upgs.		291.97	287.50	4.5

7+50	292.10	5.91
298.01	7801	7801
87.50	8700	8700
10.51	10.68	11.01
11.33	11.66	11.99
12.32	12.65	
9801	9801	9801
85.00	1281	
1301	285.02	9.00
	294.02	
29402	9402	9402
285.39	85.82	86.25
8.63	8.20	7.77
	7.33	6.70
	6.44	6.24
	5.70	
9794	9794	9794
8884	89.28	89.71
9.10	8.66	8.23
	7.80	7.37
	6.94	

Alley line bet Brooks & Cypress from  
 MH #12. - 1+22.7 = 3+45. Sheet E-3

1+50 B.M. Hub.	1300	226.37		213.07			
3+45 = 1+22 B.M. #12				214.67	208.19 210.60	46 6.5 ✓	
4+00		6.54		219.83	214.30	5.5 ✓	
+50 T.P. Hub.		2.88		223.49	218.29	5.2 ✓ 1.0 high	
5+00	12.88	236.37		8.83	227.54	222.24	5.3 ✓
5+35 = MH #11 - $\phi$ Alley.				5.47	230.90	225.00	5.9 ✓
bet Brooks & Cypress.		T.P. rock.		0.76	235.61		
= 14+89 Alley 176 $\phi$						225.00	
14+50 on Alley East	12.12	247.73		1.80	245.93	242.97	3.0 ✓
T.P. rock 12.56		258.49		0.71	257.78		
T.P. rock 11.67		269.75		0.14	269.31		
14+00 B.F.	8.72	278.03		4.94	273.07	266.00	7.1 ✓

3 ✓

June 13-1913. Friday

West  
 Moore  
 Evans.

38

Alley line bet Cypress & Brooks from <sup>NE</sup> 2511 d  
 Alley bet Herbert + Park Blvd to 11+10 NH<sup>2</sup> & Richmond  
 and up hill to 13+75 = DE. Sheet E-3

June - 1913

39

West  
 Evans  
 Moore

0+00 = DE - 225 E Herbert.	5.01	294.70	290.00	4.7 ✓	
+50	5.12	294.59	289.04	5.6 ✓	
1+00	5.60	294.11	288.08	6.0 ✓	
+50	6.19	293.52	287.12	6.4 ✓	
2+00	4.25	292.94	287.12	6.4 ✓	
+50	4.81	292.39	286.16	6.2 ✓	
2+64 = NH <sup>2</sup> 30 1/2 - E Herbert	7.28	289.92	286.20	4.7 ✓	
3+00	7.73	297.20	289.40	4.4 ✓	
+50 J.P. Hob.	7.87	289.33	284.58	4.7 ✓	
4+00	3.80	289.47	284.06	5.4 ✓	
+50	2.73	290.54	283.53	7.0 ✓	
5+00	2.98	290.29	283.00	7.3 ✓	
5+44 = NH <sup>2</sup> 33 - E Albert.	4.23	289.04	282.47	6.5 ✓	
6+00	5.45	287.82	282.30	5.8 ✓	
+50	5.46	287.81	280.72	7.1 ✓	
7+00	6.06	287.21	279.55	7.6 ✓	
+50	7.77	285.30	278.39	6.9 ✓	
7+60 break	10.47	282.80	277.23	5.5 ✓	
8+00	12.37	293.27	281.6	4.6 ✓	
+50	7 P. rock	0.42	280.90	277.00	4.6 ✓
8+80	12.76	281.32	274.42	268.00	6.4 ✓
+50	T.P. rock.	0.76	268.36		
8+80 = NH <sup>2</sup> 21.	7.79	261.33	256.75	4.6 ✓	
	12.50	256.62	250.00	6.6 ✓	
	269.12				



Alley bet Cypress & Brooks.  
Cont'd from last page.

40

8+80-MH #29	12.50	256.62	250.00	6.6 ✓
T.P. rock	0.17	255.97		
9+00	3.52	252.62	247.50	5.3 ✓

+50	12.40	256.14	11.8 244.3	240.57	3.7 ✓	
T.P. rock.			0.18	243.74		
10+00			4.72	239.20	233.83	5.4 ✓

+50 T.P. Hob. break.	13.01	243.92	0.00	230.91	227.10	3.8 ✓
----------------------	-------	--------	------	--------	--------	-------

11+10 DMH #28 = 2+24 Main line			224.5	<del>216.00</del> 216.00	8.5 ✓	
+50	10.27	220.64	7.41	223.50	217.71	2.9 ✓

11+80 break	1.42	230.91	12.38	229.49	219.00	4.5 ✓
12+00 break	1.41	241.87	14.0	227.9	222.00	5.9 ✓

T.P. rock.	4.76	253.34	12.88	240.46		
+50 T.P. Hob.			13.08	248.58	240.34	8.2 ✓

12+60 break.			10.8	250.9	244.00	6.9 ✓
--------------	--	--	------	-------	--------	-------

13+00	2.04	261.66	3.6	258.1	248.80	9.3 ✓
-------	------	--------	-----	-------	--------	-------

13+10 break. T.P. Hob.			12.12	259.62	250.00	9.6 ✓
------------------------	--	--	-------	--------	--------	-------

13+25	2.06	271.74	6.05	265.69	255.77	9.9 ✓
-------	------	--------	------	--------	--------	-------

13+50 T.P. Hob.			11.53	269.68	265.38	4.3 ✓
-----------------	--	--	-------	--------	--------	-------

13+75 = DE.			1.31	279.90	275.00	4.9 ✓
-------------	--	--	------	--------	--------	-------

14+00 = R.V.	8.12	284.21		273.09		
--------------	------	--------	--	--------	--	--

Herbert St. Sewer & Herbert.  
 25' S. NL Brooks to 25' N. NL Upds.  
 Sheet E. 3 Later Extended  
 See p 77

286.91	92.91	92.91	92.91	92.91	92.91
6.00	10.00	81.00	72.00	83.00	84.00
292.91	102.91	173.91	164.91	176.91	178.91

3+00	Hub. N/61/170 bet Cypress - Brooks	4.99	294.32	287.33		
0+00	- 25' S. Brooks.			4.8	289.5	284.00 5.5 ✓
+50				6.10	288.22	283.00 5.2 ✓
1+00				6.8	287.5	282.00 5.5 ✓
+50				6.64	287.68	281.00 6.7 ✓
2+00	break.			7.41	286.91	280.00 6.9 ✓
TP. rock.		5.69	282.24	12.77	281.55	
TP. rock.				12.69	269.55	
+60	break.	7.02	276.57			
+60	break.			9.38	267.19	262.00 5.2 ✓
3+00						
3+14.3	M.H. #19 = E. Herbert. Myrtle			7.88	268.69	(260.00 8.7 ✓)
TP.				1.04	275.53	(263.00 5.7 ✓)
3+50	12.53	288.06		8.93	279.13	272.82 6.3 ✓
3+80	break. TP. Hub.			2.20	285.86	281.00 4.9 ✓
4+00		9.57	295.43	7.95	287.48	281.32 6.2 -
+50				6.9	288.5	282.13 6.4 ✓
5+03	E. M.H. #19 E. Alley bet Upds. Myrtle			7.04	288.39	283.00 5.4 ✓
+50				6.3	289.1	283.73 5.4 ✓
6+00				5.00	290.43	284.53 5.9 ✓
6+30	= NE. 25' N. Upds.			4.56	291.87	285.00 5.9 ✓
6+50						
7+09	= M.H. & Upds so wide Δ					

see page 77  
 for change  
 of grade  
 from M.H.  
 5.0th.

279.13					
7.21					
286.34	286.34	86.34	86.34	86.34	
272.82	281.00	81.32	82.13	83.00	
13.52 ✓	5.34 ✓	5.02 ✓	4.21 ✓	3.34 ✓	
86.34	86.34	86.34			
83.73	84.53	85.00			
2.61 ✓	1.81 ✓	1.34 ✓			

Alley bet Brooks & Myrtle.  
From 25'E Herbert to Alley W. Park. B/Vol.  
Sheet E 3.

July 24-1913  
West  
Evans  
Moore.

42

0+00 - D.E. 25'E Herbert.	→ 6.35	285.18	280.00	5.2 ✓
+50 TP.	2.78	276.69	273.34	3.4 ✓
	279.47			
0+75 = MH #20	4.7	274.8	270.00	4.8 ✓
	5			
1+00 TP Hub.	0.80	278.67	274.62	4.0 ✓
	12.86	291.53		
1+40 break.	5.4	286.1	282.00	4.1 ✓
1+50			282.50	
2+00 DE.	1.40	290.13	285.00	5.1 ✓

L Myrtle St Sewer & Myrtle  
 Sta 2+993 = MH #19 to 0+00 & Alley bet  
 Herbert + Park Blvd = 6+93 = Alley Line - MH #22  
 Street \* E 4.

6+93 = 0+00 = MH #22 = & Alley + Myrtle.	5.77	290.16	285.00	5.0 ✓
+50	4.74	291.19	284.06	7.1 ✓
5.53 295.93				
1+50 T.P. Hob.	0.58	290.40	283.13	7.3 ✓
b				
+50	2.7	288.3	282.19	6.1 ✓
1+60 break.	4.1	286.9	282.00	4.9 ✓
12.64 290.98				
2+00 T.P. Hob.	1.58	278.34	273.50	4.8 ✓
			273.50	
2+40 - break.	12.15	267.77	265.00	2.8 ✓
+50			264.77	
11.22 279.92				
2+9925 = MH #19 - & Myrtle + Herbert.		268.70	260.00	8.7 ✓
= 3+935 = 3+4				

July 24 - 1913.

West  
 Evans  
 Moore

267.77	270.10	28.43	93.43	93.43
7.72	270.10	22.05	22.19	83.13
275.51	3.03	✓	11.24	103.0
10.51	293.23	✓	✓	

43

282.13
12.84
295.97
284.06
11.91

Alley bet Myrtle & Upas Sts.  
 From E Herbert 265' East.  
 Sheet E4.

5+038  
 0+00 = MH\*23.

7#2 295.81

+50

5.54 290.27 283.66

1+00

5.7 290.1 284.32

+50

5

8.2 287.6 284.98

2+00

6.83 288.98 285.64

+50

286.30

2+65 NE.

3.97 291.84 286.50

✓

July 24-1913

West.  
 Evans  
 Moore.

44

283.00  
 292.00 292.00 92.00 72.00 72.00 92.00  
 83.66 84.32 84.98 85.64 86.50  
 8.34 7.68 7.02 6.36 5.50  
 c.o.s

5.4 ✓

6.6 ✓

5.8 ✓

2.6 ✓

3.3 ✓

5.3 ✓ c.o.s

Richmond St Sewer  
 & Upas to & Alley bet. Myrtle & Brooks.

Sheet E.A.

		283 ±		
0+00 = 25' E. Right on Alley line.		281.90		
0+00 = Was MH #6 but cut out			278.00	
+50 = DE	7.00	288.90		
1+00		5.07	283.83	277.50
+50		5.49	283.47	277.00
2+00		5.73	283.17	276.50
+50		5.00	283.90	276.00
3+00 = MH #5 1/2		5.24	283.66	275.50
+50		6.54	282.36	275.00
4+00		11.14	277.76	274.50
+50		10.04	278.86	274.00
5+00 break TP Hub.		7.59	281.31	273.50
	0.87		278.13	273.00
TP rock		11.77	267.23	
	0.85		268.08	
+50 TP Hub.		11.59	256.49	249.22
	0.91		257.40	
5+68 I = MH #15		9.86	247.54	240.32
= & Alley bet Myrtle & Brooks.				
= 2+69 = Alley line.				
		247.54		

June 21 - 1913.

West  
 Evans  
 Moore.

45

6.3 ✓

6.5 ✓

6.7 ✓

7.9 ✓

8.2 ✓

7.4 ✓

3.3 ✓

4.9 ✓

7.8 not dug

5.1 ✓

✓

7.7

7.2 ✓

Canon line Sta 5+85<sup>0+700</sup> Main line to  
 Sta 6+60 Alley line bet Cypress + Penn.  
 Sheet E.4

6+00 Hub.		5.85	229.38 229.34	229.38 229.34	
0+00 = 5+85 = MH #32	4.04			227.84	223.00
T.P. rock.		12.95	231.15		
0+50		9.48	234.62	228.92	
1+00	0.91	4.75	239.35	234.84	
T.P. rock.		12.00	243.19		
1+50		8.29	246.90	240.76	
2+00		3.90	251.29	246.68	
	0.00		255.19		
2+28 = MH #31 = Alley			255.19	250.00	
bet Cypress + Penn.					
- Sta 6+60 Alley line.					

Levels bottom up.

June 25-1913  
 West  
 Moore  
 Evans

234.62 4.94 239.56	239.56 228.92 10.64	39.56 34.84 4.72	39.56 4.72 34.84 = 70 12.02 247.86 = 40	247.86 240.76 7.10	247.86 246.68 1.18
247.86 1.18 246.68 = 70 12.13 258.81 = 40 0.17 258.37 = 70		258.81 50.00 8.81			

See P. 48 for Alley line

Alley bet Cypress & Penn.  
25' W Herbert to 25' E Richmond.

Sheet E-2.

0+00 = NE 25' W Herbert.			277.00		
0+25 = E. Stopped here acct shute.	0.17	273.32	267.81	5.5 ✓	
+40 break	6.68	266.81	262.30	4.5 ✓	
+50	12.51 TP rock	273.49	262.38	3.8 ✓	
+100	12.51 TP rock	261.31	258.63	3.8 ✓	
		0.84	248.80		
		7.07	242.57	2.3 ✓	
	11.60 ←	249.64			
1+17 = NH #34 - 11+06 Main line Hub.		238.67	234.00	4.7 ✓	
10+51 Hub TP	10.11	248.15	238.04		
+50		1.42	240.73	235.84	4.9 ✓
2+00		6.61	241.54	238.64	2.9 ✓
TP rock	11.66	254.92	4.89	243.26	
+50		9.38	245.54	241.44	4.1 ✓
2+60 break		5.9	249.0	242.00	7.0 ✓
TP rock	12.24	266.83	0.33	254.59	
3+00		8.55	258.28	246.40	11.9 ✓
+50		13.05	253.78	251.90	1.9 ✓
3+60 break		8.94	257.89	253.00	4.9 ✓
TP rock	13.51	279.43	0.41	266.42	
4+00 TP Hub		0.11	279.32	272.64	6.7 ✓
	9.40	288.72			

June 24 - 1913

West  
EVANS

47

Moore. Note. Changed gr. acct. error in orig profile as plotted.

240.73	5.15			
245.88	245.88	245.88	245.88	245.88
235.84	238.64	241.42	242.00	0.24
10.04	7.24	4.46	3.88	240.54 - TP
Not down				11.52
				257.06 - 19.
				0.47
				256.59 + 10
				4.53
				261.12 - 49.
				2.82
				2700 258.30 = 1/16.
258.28				
2.30				
260.58 - 49				
260.58	260.58	260.58	260.58	
246.20	251.98	253.00	269	
14.18	8.68	7.58	257.87 - 44.	
			12.33	
			270.22 - 49.	
			0.62	
			269.60 - TP	
			11.87	
			281.47 - 49	
281.47	281.47			
272.64	8.86			
8.83	272.64 - TP			



Alley bet Cypress & Penn.  
Sheet E.2.

288.72

4+15 brock. 0.88 287.84 280.00

+50 = D.E. 1.56 287.16 281.07

No need running further as this gets both houses

+80 = DE 25' Richmond. 1.64 287.08 282.00

25' W Richmond St 6+10 to 7+50.

T.P. Hub. DE 4+80 288.91 287.08

6+10 = DE. 1.83 T.P. rock. 0.22 277.17 11.96 276.95 1.89 275.28 270.00 5.3 ✓

T.P. rock. 12.16 265.01

+50 0.70 265.71 254.00

6+60 = NH\*31-2+28 Canon line = 2+28 Canon line 10.52 255.19 250.00 5.2 ✓

7+50 T.P. Hub. 0.54 265.17 263.34 1.8 ✓

+25 12.25 277.42 273.95 271.67 2.3

T.P. rock. 0.50 276.92  
7+50 = DE. 10.79 287.71 2.00 285.71 280.00 5.7 ✓ 0.10

June 25-1913

West 279.32  
Evans 11.35  
More 290.67 290.67  
280.00 281.07  
10.67 9.60

48

7.8 ✓

6.1 ✓

Note I cutout this last 30' & D.E. pipe at 4+50

275.28 DE Hub.  
1.26  
276.74 - 49  
270.00  
6.74

258.24 = TP. 270.60  
12.26 0.67  
270.60 - 11. 269.3 - TP.  
263.34 12.34  
7.26 282.27 - 17.  
280.00  
2.27

See p 29

Note: - Can be DE at 7+25 + catch all property not already connected to Alley line running West.

West  
5/25/12.

Alley Line between 7<sup>th</sup> & 8<sup>th</sup> St from 5<sup>th</sup> to 10<sup>th</sup> S of 3<sup>rd</sup> Ave

see book 400 page 69

Sheet E.7

Sta	+R	H.I.	-R	ele to P 575/43	grade	cut
B.M. Bottom Step Post on E of Alley.			2.71	271.21		
0+0 = P. End 10' S of Penn			5.60	268.32	264.00	4.3'
50			5.07	268.85	262.96	5.9'
1+0			5.2	268.7	261.92	6.8'
1.50 T.P. Hob.	5.64	273.92	1.18	268.28	260.88	7.4'
2+0			1.9	267.6	259.84	7.8'
2+40 break			3.7	265.8	259.00	6.8'
2+50	T.P. 11.53	269.46	5.1	264.4	257.42	7.0'
3+0 = M.H. 12.07	12.07	259.30	3.11	257.93	247.53	6.4'
3.50 T.P. Hob.			2.89	247.21	241.64	5.6'
4+0			13.1	237.0	233.75	3.2'
4+30 break 11.29	11.29	250.10	14.0	236.1	229.00	7.1'
4+50 T.P. Hob.			0.32	238.81	228.15	10.6'
5+0 break T.P.	13.06	239.13	8.7	230.24	226.00	4.2'
5+50			2.18	226.07	213.50	4.4'
6+0 break			8.4	217.7	211.00	4.3'
6+90 M.H. 12.65	12.65	226.25	11.0	215.3	206.00	4.6'
6+0				212.15		
7+0				227.92		
7+0				243.69		
7+20 break				250.00		
7+50				252.25		
8+0 D.E.				256.00		

Note: - From M.H. at 5+90 the line south to D.E. at 8+00 goes thru Marston chicken houses. Marston can connect to 7<sup>th</sup> St sewer, and Burnam can connect direct to main line sewer east of his place & do away with this line, as they are only houses.

Line bet 7 & 8 South - Abandoned  
as A Marston can connect to  
7<sup>th</sup> St sewer.

Align Line between 62<sup>nd</sup> St from 11<sup>th</sup> to 12<sup>th</sup> of Penna To E. 11<sup>th</sup>  
 155<sup>th</sup> N. 15<sup>th</sup> up to see sheet 8 E.

See book 920 page 70

May 29-1913  
 West  
 Evans  
 Moore

E. 8

Sta	HT	H.I.	-H	Dist. Top of Road	grade	cut
9 + 40 - FT.			4.24	285.43	280.00 ✓	5.4
0 + 50			4.15	285.35	279.60 ✓	5.8 ✓
100			3.55	286.12	279.00 ✓	6.0 ✓
150			4.22	285.45	278.50 ✓	7.1 ✓
200 break			5.90	283.71	278.00 ✓	7.0 ✓
50			8.07	281.60	276.50 ✓	5.8 ✓
200			9.47	280.20	275.00 ✓	5.1 ✓
+ 50	12.91	289.67	11.00	278.67	273.50 ✓	5.2 ✓
410 N.H. break			0.19	276.76	272.00 ✓	4.9 ✓
100			1.68	275.27	269.00 ✓	6.3 ✓
100	13.05	276.95	5.15	271.80	269.00 ✓	5.8 ✓
100	12.30	264.07	0.17	263.90	262.00 ✓	6.0 ✓
100	11.50	254.60	3.33	257.27	245.00 ✓	5.3 ✓
100			0.29	243.10	245.00 ✓	5.3 ✓
100			14.15	229.34	225.00 ✓	5.3 ✓
100	8.50	243.49			225.00 ✓	
8 N.H. 2 + 79.6 St				234.99		

Hwy offset 2 to W of R

Levels read bottom-up

560.0 ft

Center Line 60 ft from D.E. 3000 ... E.T. 1000 ...

see book 400 page 72

West  
Exits  
More  
May 29 - 1913  
51

Sheet S.E.  
Hubs set on 2' Offset to W.

Station	Offset	Hub	Reading	Reading	Reading	Reading
2+00 DE 3000 S of Pen 10	0.84	0+00 Hub	284.38	284.38	279.00	Bottom Gts
+50			2.90	282.32	276.82	
1+0			4.59	280.63	274.63	
+50			6.47	278.75	272.44	
1+80 break			9.49	275.73	272.00	
2+10	TP 0.20	TP 13.04	272.38	272.18	272.00	
		TP 11.08		261.30	257.88	
4+0	TP 0.87		262.17	12.87	249.30	240.23
	0.55		247.85	5.83	247.0	
2+79 M.W. 56	TP 4.21		243.49	10.57	239.28	
				8.44	235.95	230.00
3+0	TP			2.67	240.82	237.67
	TP 12.27		253.87	1.47	251.62	
+50	TP		264.48	2.72	261.76	256.91
	12.48		274.24			
+20 break	TP			3.10	271.14	
9+0				8.9	273.7	267.86
4+10 DE	11.68		282.82	8.0	274.8	268.21
+50				6.2	276.6	269.98
7+0				4.18	278.6	272.10
+50	TP			2.47	280.35	274.22
6+0	8.50		288.85	6.65	282.20	276.34
+50				5.07	283.78	278.46
7+0				3.15	285.70	280.58
7+12 M.W. of Ivy Lane Top Cover ring				2.75	286.10	281.00
+50				1.33	275.88	

Hubs Offset 2' to W of E.

Station	Offset	Hub	Reading	Reading
Cuto.	2.43	4.9	284.75	
54				
55				
60				
63				
3.7				
3.4				
3.2				
5.1				
3.1				
5.8				
4.1				
6.0				
6.5				
6.6				
6.5				
6.1				
5.9				
5.3				
5.1				
5.1				

Gr. Ref.  
7.93

SE

See page 23

Note: Pipe should be stopped here as U.E. 7+40 with X on each side. Only 1 house each side needs connections, as they tap Ivy Lane Sewer.

(constructed)  
Note: - Houses in this block say they are connected with 3rd Sewer.

280.00

107.50 FT. 40 x 40 pipes

1st Sewer from N.H. 5+77<sup>2</sup> Main Line, South on E 7st.

5+67<sup>2</sup>? See page 23

June 2, 1913

West.  
Evans.  
Moore.

Sheet 8E

52

B.N. 5+00 Hdb. 12.91, 229.24

216.33

2  
0+00 = N.H. 49 1/2

5+67<sup>2</sup> N.H. for 7st. South

	4.8	224.4	220.00	4.4
T.P.	2.33	226.91		
T.P.	10.76	237.67	1.19	236.48
T.P.	12.25	248.73		
0+50	9.12	239.61	237.18	2.4
T.P.	1.48	247.25		
	12.46	259.71		
T.P.	0.38	259.33		
	12.50	271.83		
1+00	7.4	264.4	254.36	10.0 ✓
T.P.	2.04	269.79		
	11.43	281.22		
+80	8.25	272.97		
+40 Break.	8.1	273.1	268.10	5.0 ✓
+50	8.0	273.2	268.25	4.9 ✓
2+00	7.1	274.1	269.00	5.1 ✓
+50	6.4	274.8	269.75	5.0 ✓
3	6.0	275.2	270.50	4.7 ✓
+50	5.7	275.5	271.10	4.4 ✓
	5.5	275.7	271.25	4.4 ✓
4	4.8	276.4	272.00	4.4 ✓
+50	4.2	277.0	272.75	4.2 ✓
5	3.5	277.7	273.50	4.2 ✓
+50	2.7	278.5	274.25	4.2 ✓
6	2.1	279.1	275.00	4.1 ✓
+50	1.1	280.1	275.75	4.3 ✓
+90 = DE.	0.63	280.59	276.35	4.2

Alley bet Robinson & Penn  
& Albert to D.E. 110' W and Alley.

Sheet E. J.

1+50 - Hub.	11.01	270.41	259.40		
0+00 - NH 25 = 1425 on Albert St			255.39	252.00	3.4 ✓
0+50 T.P. Hub.	5	0.47	269.94	266.37	3.6 ✓
	1223	282.17			
0+80 break T.P. Hub		2.08	280.09	275.00	5.1 ✓
	12.19	292.28			
1+00		5.21	287.07	283.00	4.1 ✓
1+10 - D.E.		1.02	291.26	287.00	4.3 not any at

July 29 - 1913

West  
Evdns.  
Moore

53

Penn Ave Sewer  
 & Herbert & Penn to MH #36 - Sta 12+17.2  
 North Side.

Sheet E-1.

July 3-1913  
 West.

54

0+00 - MH #37 = <del>241.5</del> Penn + Herbert	12.57	247.75	244.00	38 ✓
0+50	9.00	251.32	243.50	7.8 ✓
+75			243.25	✓
1+00	5.83	254.49	243.00	11.5 ✓
+75			242.75	✓
1+50	0.88	259.44	242.50	17.0 ✓
1+75			242.25	✓
2+00				

2+04 - MH #36 = Sta 12+17.2 + P.	6.60	260.32	247.50	242.00	55 ✓
12+50 Hub	8.66	254.08	253.92	245.42	

Herbert St. Sewer.  
 & Robinson to & Penn.  
 Sheet E. 1.

July 11-1913  
 West  
 Evidis  
 Moore

55

0+75 D.E.=50's & Robinson+Herbert.	4.07	292.74	287.50	5.2 <sup>not dug out</sup>	
5.04 296.81					
1+00 break. T.P.	3.04	291.77	287.00	4.8 ✓	
12.25 294.81	0.33	282.56			
T.P.	8.73	274.16	272.00	2.2 ✓	
1+50					
12.60 282.89	0.57	270.29	269.00	1.3 ✓	
1+60 break. T.P.					
2+00 break.	7.84	263.02	260.00	3.0 ✓	
+50	5	6.37	264.49	259.38	5.1 ✓
2+80 break.	5.18	265.68	259.00	6.7 ✓	
3+00	8.92	261.94	254.67	7.3 ✓	
12.17 270.86					
T.P. break.	0.80	258.69			
3+40 break.	8.35	251.14	246.00	5.1 ✓	
11.74 259.49					
3+78.5 = MH #37		247.75	244.00	3.8 ✓	
= & Penn + Herbert.					
-6+13 main line.					



Cannon line from E Tenn & Herbert.  
to E Alley W of Park Blvd.

July 10-1913  
West  
Everts  
Moore.

56

0+00 - MH*37 - E Herbert + Tenn.	247.75	244.00	3.8 ✓			
12.96	260.71					
0+50	6.33	254.38	247.61	6.8 ✓		
1+00	2.53	258.18	251.22	7.0 ✓		
T.P.	0.24	260.47				
1+50	10.62	271.09	12.10	258.99	254.83	4.2 ✓
1+80 - MH*38	7.39	263.70	257.00	6.7 ✓		
2+00	6.50	264.59	259.05	5.5 ✓		
2+50 T.P. Hub.	0.91	270.18	264.16	6.0 ✓		
11.82	282.00					
3+07 <sup>2</sup> - MH*39	6.23	275.77	270.00	5.8 ✓		
E Alley bet. Tenn & Cypress.						
- 1+60 Alley line.						
+50 T.P. H16.	2.06	279.94	274.33	5.6 Carved in.		
12.19	292.13					
4+00	5.94	286.19	279.36	6.8 ✓		
+50			284.21			
4+56 <sup>4</sup> - MH*40 T.P.	1.68	290.45	285.00	5.5 ✓		
- 3+2+50 Alley W of Park Blvd.						

Alley W of Clark Blvd.  
From 25'S Penn to 25'N Cypress.

Sheet E.2.

0+00 = JE 25'S Penn.	5.12	295.14	290.00	5.1	not dug out.
0+50	5.03	295.23	289.00	6.2	✓
1+00	5	5.14	295.12	288.00	7.1 ✓
1+50	6.78	293.48	287.00	6.5	✓
2+00	8.84	291.42	286.00	5.4	✓
9.81	300.26				
2+50 = MH <sup>#40</sup> T.P. = 4+56" + 1+50 Alley loc.		290.45	285.00	5.5	✓

Alley bet Penn & Cypress  
from DE 25'E Herbert to MH<sup>#39</sup>.  
Sheet E.2.

0+00 = DE 25'E Herbert.	4.39	293.58	289.00	4.6	not dug out.		
0+50	3.56	294.41	287.00	7.4	✓		
1+00 break.	11.52	297.97	9.00	288.77	285.00	4.0	✓
T.P. rock	10.95	286.72	0.27	286.45			
1+50 = MH <sup>#39</sup> = 3+57" on line.		275.77	270.00	5.8	✓		

July 10-1913

West  
Evans  
Moore.

57

Canon Line Sewer from  
 @ Herbert & Penn to @ Robinson bet  
 Park Blvd + Center Sts.  
 Sheet E.2.

19+25 = 0-56.5 Alley from north = 0+35 MH #13		268.8	260.00	88.4
0+50		267.2	259.59	7.6
1+00		262.3	258.22	4.1
1+10		260.11	257.95	2.1
1+50	6.10	265.00	256.85	8.1
2+00	9.87	261.23	255.48	5.7
2+50	9.53	261.57	254.11	7.5
3+00 T.P. Hub.	12.42 271.10	0.40	258.68 252.74	5.9
3+262 = MH #121345R. = Alley bet Penn + Robins = 0-56.5 1+50 on Alley.	2.14	256.94	252.00	4.9
3+50	4.67	254.41	251.36	3.1
4+00	5.36	253.72	249.94	3.8
4+50	5.81	253.27	248.55	4.7
5+00	5.62	253.46	247.15	6.3
5+50	5.72	253.36	245.95	7.6
6+00	11.17	247.91	244.36	3.6
6+13 = MH #3724106L = Penn + Herbert.	11.53 259.08	247.75	244.00	3.8
Old 6+00				

July-3-1913  
 West  
 Evans  
 Moore

58

① 6+65 - FT. Alley E Park Blvd S of Univ.



Sketch showing new location of  
 M.H. near Robinson + Alley W of Park Blvd.

July 21-1913  
 West

376.9  
 35  
 291.9

Alley bet Robinson & Penn.  
 From 25'E Herbert to Sta 2+85'E.  
 Sheet E.1.

0+00-DE 25'E Herbert.	1.99	287.93	282.00	5.9 ✓		
+50	11.58	289.92	8.79	281.13	272.00	9.1 ✓
TP			0.67	278.34		
1+00	11.69	279.51	9.49	267.52	262.00	7.5 ✓
T.P. rock.	11.37	268.31	0.99	267.32		
1+50 = MH 2/1				256.94	252.00	4.9 ✓
-3+262 other line	11.38	268.32				
2+00 break			9.88	258.44	255.00	3.4 ✓
TP rock.			2.12	266.20		
+50	11.46	277.66	8.73	268.93	264.70	4.2 ✓
2+85 DE.			1.60	276.06	271.50	4.6 ✓

5 ✓

July 11-1913  
 West.  
 Evans.  
 Moore.

Bottoms 9/3/13. West.  
 Evans.  
 Devine.

269.52		
6.84		
276.36 = H	276.36	272.00
262.00	272.00	10.86
14.36 ✓	4.36 ✓	282.86 = H
		282.00
		0.86 ✓
258.44		
11.93		
270.37 = H	270.37	270.37
255.00	264.70	1.44
15.37 ✓	5.67 ✓	268.93 = TP sub.
		3.98
		272.91
		271.50
		1.41

Canon Line  
 ↓ & Alley bet Center & Far Blvd with Robin  
 to DE in alley bet Indiana & Park Blvd  
 25' N. Cypress. Sheet 2F.

19+25 <sup>5</sup> MH #43		268.80	260.00 262.00	8.8 ✓ 5.8 ✓
	11.72	280.52		
19+00		4.01	276.51	265.16 ✓
T.P. rock		1.38	279.14	
18+MH = MH #44 & Alley	9.97	289.11		
		11.00	278.11	270.00 ✓
18+00		7.21	281.90	273.42 ✓
		3.70	285.41	277.30 ✓
17+00	T.P. Hub.	1.10	288.01	281.18 ✓
	11.77	299.78		
16+50		5.70	294.08	285.06 ✓
16+00		1.14	298.64	288.94 ✓
	8.51	307.15		
15+50		8.56	298.59	292.82 ✓
15+22 = MH #45 = & Alley bet Park Blvd & Indiana		7.63	299.52	295.00 ✓
15+00		7.05	300.10	295.29 ✓
14+50		5.12	302.03	295.94 ✓
14+00		5.30	301.85	296.60 ✓

July 21-1913

West  
 Evans  
 Moore

60

555  
 187  
 248

1200  
 803  
 388

281.90  
 4.83  
 286.73 = H9

86.73 86.73 86.73 86.73 85.06  
 78.42 77.30 81.18 85.06 12.44  
 13.31 ✓ 9.43 ✓ 6.55 ✓ 1.67 ✓ 97.50 = H9

297.50 297.50  
 8874 033  
 856 ✓ 297.17 = TP.  
 698  
 304.15 = H9

304.15 304.15  
 292.82 295.06  
 11.33 ✓ 9.15 ✓

295.00  
 210.05  
 305.05

305.05 305.05 305.05 305.05  
 295.29 295.94 291.11  
 9.76 ✓ 9.11 ✓ 8.95 ✓

6

307.15

13+50			3.48	303.67	297.25	
13+00	7.23	310.90	7.48	303.42	297.91	
12+50			6.33	304.57	298.56	
12+00			6.70	304.20	299.22	
11+50					299.87	
11+40 - DE No Cypress.		6.34	304.56	300.00		

Alley bet Indiana + Park Blvd  
Street E2

10+00 - F.T.			5.70	305.20	299.00	
9+50			5.76	305.14	298.71	
9+00			5.75	305.75	298.42	
8+50			5.95	304.90	298.12	
8+00 TR Hub.	4.83	308.57	7.16	303.74	297.83	
7+50			4.32	304.25	297.54	
7+00			4.30	304.27	297.24	
6+60 - MH #27			4.57	304.00	297.00	
6+00			5.37	303.20	296.74	
5+50			5.67	302.90	296.53	
5+00			5.46	303.11	296.32	
4+50			5.77	302.80	296.11	
4+00			6.54	302.03	295.89	
3+50			6.62	301.95	295.68	
3+14 MH #26			6.38	302.19	295.50	
	3:17	305.36				

July 21 - 1913  
West  
Evans  
Moore

295.00						
11.85						
306.85 - HJ	306.85	306.85	306.85	306.85	306.85	
	296.60	297.25	297.91	298.56		
	14.25	9.60	8.94	8.29		
	306.85	306.85				
	299.22	300.00				
	7.60	6.85				

295.50 - lot MH #14.  
12.87  
308.07 - HJ.

308.07	308.07	308.07	308.07	308.07	308.07	308.07
295.70	295.89	296.15	296.37	296.55	296.74	297.00
12.37	12.18	11.94	11.75	11.52	11.33	11.07

308.07 308.07 297.54  
297.27 297.54 12.29  
10.80 10.50 309.83 - HJ

309.83 309.83 309.83 309.83 309.83  
297.86 298.12 298.44 298.71 299.00  
11.97 11.71 11.35 11.12 10.83

Alley bet Indiana & Park Blvd  
Sheet E2  
+ Upds of Sewer

305.36

3+14 = MH #26 - E Myrtle.		302.19	295.50	
3+00	3.71	301.65	295.43	
2+50	3.95	301.41	295.17	
2+00	4.54	300.82	294.90	
1+50	5.77	299.59	294.63	
1+00	5.82	299.54	294.37	
0+50	6.21	299.15	294.10	
0+00	6.39	298.77	293.84	
0+7.50	6.01	299.35	293.58	
0+65 = E Upds = MH #25	6.12	299.24	293.50	
1+00	2.63	301.87		
+50		4.40	297.47	292.60
+90		7.30	294.57	291.30
2+00 break	Brk.	9.1	292.8	
+50		8.41	293.46	290.00
3+00		6.20	295.67	289.60
+50		5.51	296.36	289.20
4+00		6.20	295.67	288.80
+50		6.64	295.23	288.40
5+00		8.00	293.87	288.00
5+15 = MH & Upds		9.36	292.51	287.60
& Alley bet Rich + PK Blvd.		9.90	291.77	287.50

July 21-1913  
West  
Evans  
Moore.

62

287.50					
11.89					
279.37	99.39	99.39	99.39		
288.00	88.40	88.50	87.20		
11.89	10.99	10.59	10.19		
300.21	200.21	200.21	200.21	300.21	
289.60	290.01	291.00	292.60	293.50	
10.61	10.21	8.91	7.61	6.71	
293.50					
0.20					
297.94	297.94	297.94	297.94	297.94	
292.20	291.30	292.00	294.00	299.20	
	6.54		7.94	8.04	7.74
293.50					
10.00					
303.50	203.50	303.50	203.50	303.50	303.50
293.58	293.84	294.10	294.37	294.63	294.90
9.92	9.66	9.40	9.13	8.87	8.60

flow grade

val. w/d

val. h. o

val. o. b

val. r. o

303.50	303.50	303.50
296.17	296.43	295.50
8.33	8.07	8.00

298.64 C.T. in wall 20' Upds + Indracc

302.83	291	290.6
10.99	11.20	11.63

bottoms for change grade 5/11/13

George Moore Miller

Alley West of Park Blvd.  
From MH #44-16<sup>3</sup> S of Robinson to Penn.

↓ Street E. 1.

July 17-1913

West  
Everts  
Moore.

63

8/23/13 Bottoms.

18+44°  
=0+00 MH #44-16<sup>3</sup> Rob. 278.11 270.00 1 9.1 ✓

12.61 290.72

0+40 break. 1.06 289.66 283.00 6.6 ✓

10.46 300.12

0+50 8.46 291.66 283.10 8.5 -

1+00 3.39 296.73 283.62 13.1 ✓

1+50 5.62 294.50 284.15 10.3 ✓

2+00 9.25 290.87 284.67 6.2 ✓

2+30 break. 11.82 288.30 285.00 3.3 ✓

2+50 10.24 289.88 286.43 3.4 ✓

2+75 = UE 7.70 292.21 288.21 4.0 Not dig.

3+00 = 1.00 290.00

289.88  
278

293.66  
286.43

7.23 ✓

293.66  
285.00

8.66 ✓

293.66  
284.67

8.99 ✓

293.66  
284.15

9.51

284.15  
12.87

297.02

283.62

13.40 ✓

297.02

283.00

14.02 ✓

↓  
With 2+75 = end file = J.F. to connect both lots.



Center Alley E. of Villa Tract  
From Robinson to Univ Ave.

Sheet E-1

17+25 =0+35 =0-56t-MH*43.	272.91				
0+00		268.8	260.00	8.8 ✓	
0+50 TP Hub.	1.00	265.70	262.12	3.6 ✓	
	10.74	271.98	264.01	8.0 ✓	
1+00		2.96	279.76	265.91	13.8 ✓
+25			266.85		
1+50		11.26	271.46	267.80	3.7 ✓
2+00	5	7.77	274.95	269.70	5.2 ✓
+50		6.95	275.77	271.59	4.2 ✓
3+00 TP Hub.		3.34	279.38	273.49	5.9 ✓
	11.54		290.92		
+50		7.68	283.24	275.38	7.8 ✓
4+00		2.95	287.91	277.28	10.7 ✓
4+18 <sup>2</sup> -MH*46-ESSRTP.	0.05	290.87	278.00		12.9 ✓
	12.12	302.99			
4+50		11.12	291.87	279.44	12.4 ✓
5+00		11.54	291.40	281.76	9.7 ✓

July 17, 1910

West  
Everts  
Norse

265.91  
267.80  
533.71  
266.85

64

	279.76			
	2.09			
✓	281.85	281.85	281.85	281.85
	264.01	265.91	266.85	267.80
	266.85	269.70	271.59	
✓	17.84	15.94	15.00	14.25
			12.15	10.26
	281.85	281.85	281.85	
	273.49	275.38	277.28	
	8.36	6.47	4.57	
			277.28	TP Hub 4+00
			12.37	
			289.85	
			1.67	
			287.98	TP Hub 4+00
			2.18	
			294.76	-11)

July 17-1913

West  
Evans  
Moore

302.99

5+50

11.48

294.51

284.08

7.4 ✓

 $\begin{array}{r} 294.16 \\ 284.08 \\ \hline 10.08 \end{array}$  $\begin{array}{r} 294.16 \\ 285.00 \\ \hline 9.16 \end{array}$  $\begin{array}{r} 285.00 \\ 282.99 \\ \hline 2.01 \end{array}$ 5+70-break.

11.10

291.89

285.00

6.9 ✓

6+00 T.R. Hub.

2.17

300.82

289.10

11.7 ✓

 $\begin{array}{r} 297.99 \\ 289.10 \\ \hline 8.89 \end{array}$  $\begin{array}{r} 297.99 \\ 2.30 \\ \hline 295.69 \end{array}$  $\begin{array}{r} 295.69 \\ 7.18 \\ \hline 302.87 \end{array}$ 

302.87 = 49

10.32 311.14

6+50

7.36

303.78

295.94

7.8 ✓

 $\begin{array}{r} 302.87 \\ 295.94 \\ \hline 6.93 \end{array}$  $\begin{array}{r} 302.87 \\ 298.00 \\ \hline 4.87 \end{array}$ 6+65 FT.  
2015 Univ.

5.38

305.76

298.00

7.8 ✓

Essex St Sewer.  
 £ Alley E. Good's Villa Tract to £ Alley  
 West of Park Blvd. Street E. J.

47182 = 0+00 = MH #46. = £ Essex.	29092	0.05	290.87	278.00	
0+50		10.04	280.88	278.40	
1+00	5	9.40	281.52	278.81	
1+20 break.		6.40	284.52	279.00	
1+50 T.P. Hub.		0.50	290.42	284.25	
1+60 break. 11.94	302.36	10.21	292.15	286.00	
2+00		6.92	295.44	289.08	
2+24.5 = MH #47 £ Alley + Essex St.		5.06	297.30	291.00	

July 17-1913  
 West  
 Evans  
 Moore

66

Bottoms 7/2/13.

12.9 ✓	287.98 - Hub 4700 Alley line 1.33 289.31 - H7
2.5 ✓	289.31 289.31 289.31 289.31 286.00 278.40 278.81 279.00 286.00 12.67 10.91 ✓ 10.50 ✓ 10.31 ✓ 3.31 ✓ 298.67 - H7
2.7 ✓	
5.5 ✓	
6.2 -	298.67 298.67 291.00 1.76
6.2 ✓	7.67 ✓ 296.91 - TP. 4.46 301.37 - H7
6.3 -	
6.3 ✓	

♀ Alley N & S - W. of Park Blvd.  
 ♀ From ♀ Essex 132' N.  
 " " " 132' S.

Sheet E. 1.

302.36

0+00 = MH #17 - 5.06 297.30 291.00 6.3 ✓  
 ♀ Essex & Alley.

0+50 Running N. 6.74 295.62 291.38 4.2 ✓

1+00 5 8.44 293.92 291.76 2.2 -

1+32 NE North 5.53 296.83 292.00 4.8 ✓

302.36

0+00 = MH #17 5.06 297.30 291.00 6.3 ✓

0+50 Running S. 5 4.26 298.10 291.76 6.3 ✓

1+00 4.93 297.43 292.52 4.9 ✓

1+32 NE South 4.56 297.80 293.00 4.8 ✓

July 17, 1913

West  
Evans  
Moore.

67

Bottoms 7/2/13 West - Evans - Devine

$$\begin{array}{r} 301.37 \\ 291.38 \\ \hline 9.99 \end{array}$$

$$\begin{array}{r} 301.37 \\ 291.76 \\ \hline 9.61 \end{array}$$

$$\begin{array}{r} 301.37 \\ 292.00 \\ \hline 9.37 \end{array}$$

$$\begin{array}{r} 297.43 \\ 273 \\ \hline 20.13 \end{array}$$

$$\begin{array}{r} 301.16 \\ 293.00 \\ \hline 8.16 \end{array}$$

$$\begin{array}{r} 301.37 \\ 291.76 \\ \hline 9.61 \end{array}$$

$$\begin{array}{r} 301.37 \\ 292.52 \\ \hline 8.85 \end{array}$$

$$\begin{array}{r} 301.37 \\ 293.00 \\ \hline 8.37 \end{array}$$

Alley bet Myrtle & Upgro  
 MH<sup>1</sup> Sta 14+92 W of 1st to 0+00 - 25' W of Richm

Sheet 5E.

5+00 TP Hub.	851	198.39		187.88			
<sup>6+34.2 =</sup> -14+92-MH <sup>1</sup> Can line.				189.0	183.00	6.0	✓
14+50 break			6.17	192.20	185.00	7.2	✓
TP rock.			0.05	198.34			
14+45 break	12.41	210.75		6.31	204.44	200.00	4.4
TP rock.			0.42	210.33			
14+00 break	11.71	222.04		7.17	214.87	210.00	4.9
13+50			3.52	218.52	214.25	4.3	✓
13+00 TP Hub.			0.97	221.07	218.50	2.6	✓
	10.93	232.00					
12+50			7.36	224.64	222.75	1.9	✓
TP rock.			0.58	231.42			
12+00 MH <sup>2</sup> - Alley	<sup>12.56</sup>	243.98		11.83	232.15	227.00	5.2
TP rock.			0.77	243.01			
+50	12.57	255.58		6.07	249.51	243.50	6.0
TP rock.			0.50	255.08			
11+00 break	11.58	266.66		0.61	266.05	260.00	6.1
	12.16	278.21					
+50			7.96	270.25	262.50	7.8	✓
11+00			7.25	270.96	265.00	6.0	✓

Aug 2 - 1913.

West  
Evans  
Moore

9+50			5.67	272.54	267.50	5.0 ✓
9+00 - MH*3. = 10's of $\Delta$ 164 TP			3.11	275.10	270.00	5.1 ✓
8+50	9.18	284.28	6.93	277.35	270.70	6.7 ✓
8+00			5.44	278.84	271.40	7.4 Not dug.
7+50			5.41	278.87	272.10	6.8 ✓
7+00			5.38	278.90	272.80	6.1 ✓
6+50			5.64	278.64	272.50	5.1 ✓
6+15 MH*4 = $\Delta$ Vermont			5.33	278.95	274.20	5.0 ✓
6+00			5.02	279.26	274.07	5.2 ✓
5+50			3.56	280.72	274.31	6.4 Not dug.
5+00 TP. Hub.			2.93	281.35	274.55	6.8 ✓
4+50	5.65	287.00	5.42	281.58	274.79	6.8 ✓
4+00			5.05	281.95	275.03	6.9 ✓
3+50			5.38	281.62	275.27	6.3 ✓
3+00 - MH*5			5.81	281.19	275.50	5.7 ✓
2+50			5.14	281.86	275.75	6.1 ✓
2+00			4.54	282.46	276.00	6.5 ✓
1+50			3.8	283.2	276.25	7.0 ✓
1+00			2.88	284.12	276.50	7.6 ✓
0+50			3.62	283.38	276.75	6.6 ✓
0+00 = 25' W Richmond = FT.			5.10	281.90	277.00	4.9 ✓

Alley line bet Flort &amp; Grim. Surface Elevs.

25' N. Alley south of Univ to M.H. N.L. Upas.

4.84 355.84  
 Top Curb. NE Cor Grim & Wightman. 351.00

0+00 = 25' N. Alley S of Univ -0.3 356.1

+50 0.1 355.7

1+00 0.5 355.3

+50 1.2 354.6

2+00 2.0 353.8

+50 4.5 351.3

2+70 = E Wightman 4.6 351.2

3+00 4.2 351.6

+50 3.0 352.8

4+00 3.5 352.3

+50 4.5 351.3

5+00 T.P. 4.89 350.95

1.10 352.05

+50 2.8 349.2

6+00 3.7 348.3

+50 4.7 347.3

7+00 5.3 346.7

+50 6.4 345.6

8+00 7.1 344.9

+50 7.8 344.2

9+00 10.6 341.4

T.P. 11.36 340.69

1.52 342.21

9+30 = E Gunn St. 1.7 340.5

9+50 2.6 339.6

June 18-1913.

West

Evans

Moore.

Alley bet Hart & Grim.

342.21

10+00		0.6	341.6
+50		2.4	339.8
11+00		2.4	339.8
+50		3.6	338.6
12+00		4.8	337.4
+50		6.1	336.1
13+00		6.6	335.6
+50		7.9	334.3
14+00		8.9	333.3
+50		9.2	333.0
15+00		10.0	332.2
+50		10.6	331.6
+55		10.5	331.7
+61		8.6	333.6
+90 = Dwight		9.0	333.2
16+00		9.5	332.7
T.P.		9.31	332.90

2.98    335.88

+20		3.1	332.8
+24		4.8	331.4
+50		5.0	330.9
17+00		5.3	330.6
+50		5.4	330.5
18+00		5.1	330.8



Alley bet Hart & Grim

72

335.88

18+50 4.9 331.0

19+00 5.1 330.8

+50 4.5 331.4

20+00 4.0 331.9

+50 4.1 331.8

21+00 4.2 331.7

+50 3.8 332.1

T.P. 3.17 332.71

2.32 335.03

22+00 3.2 331.8

+50 = ~~4~~ Myrtle 4.1 330.9

23+00 4.4 330.6

+50 4.9 330.1

24+00 5.8 329.2

+50 6.2 328.8

25+00 7.3 327.7

+50 8.4 326.6

+79 = <sup>Tap.</sup> M.H. = NL. Ugas.  
= Pueblo line. 8.8 326.2

T.P. 8.97 326.06

5.07 331.13

Bot M.H. 10.08 321.05

T.P. 3.45 327.68

2.63 230.31

Gr. Hub. Herman + Ugas. PL-SW. Cor. 9.06 321.25 OK. Check

2. Alley bet Hart & Herman  
 25' N. of Alley S. of Univ to M.H. NL. Upas  
 Surface E's.

Curb. NE Cor. Hart & Wightman 352.46

3.05 355.51

0+00 = 25' N. Alleys of Univ. 1.1

+50 0.9

1+00 0.9

+50 1.2

2+00 0.9

+39 NL Wightman 3.3

+50 4.6

+69 = E Wightman. 4.6

3+00 4.0

+50 2.6

4+00 3.6

+50 4.3

5+00 5.1

+50 5.5

6+00 6.0

T.P. 6.05 349.46

0.41 349.87

+50 0.9

7+00 1.8

+50 2.4

8+00 2.8

+50 3.2

+70 4.3

9+00 NL Gym. 5.5

June 23 - 1913  
 West  
 Evans  
 Moore

73

349.87

9+30 = $\text{\$}$ Gunn St.	6.8	
+60 = SL. " "	5.9	
10+60	5.4	
+50	6.2	
11+00	7.1	
+50	8.2	
12+00	9.0	
+50	10.4	
13+00	12.2	
T.P.	12.22	337.65
	0.92	338.57
13+50	1.6	
14+00	2.5	
+50	3.5	
15+00	4.2	
+60 = NL	4.9	
+90 = $\text{\$}$ Dwight	5.4	
16+00	5.6	
+20 = SL	5.2	
+28	3.8	
+50	3.9	
17+00	4.8	
+50	4.5	
18+00	5.8	
+50	6.9	

		338.57		
19+00			8.2	
T.P.			8.30	330.27
	0.87	331.14		
+50			1.4	
20+00			2.4	
+50			2.8	
21+00			3.5	
+50			4.3	
22+00			4.8	
+20	NL Myrtle		5.2	
+50	♀ "		6.1	
+80	5L "		7.6	
23+00			8.7	
+50			6.6	
24+00			6.0	
+50			6.5	
25+00			6.2	
T.P.			6.17	324.97
	4.17	329.14		
+50			4.1	
+78	Top M.H. Cover rings		37.4	
	Bottom M.H.		10.78	
Gr. Hub. Herman & Co. P.L. SW. Cor.			7.89	321.25 <sup>✓</sup>

Albert St Sewer  
From 25's S.L. Brooks - to DE at 6+30

Bottom stakes 9/6/13.

0+00 = J.E. 25's Brooks		3.12	287.43	282.00	5.4	
0+40 break	8.81	290.55	7.06	283.49	6.5	
TR break	11.89	282.11	0.37	281.74	277.00	
TR break	11.73	270.45	0.23	270.22		
1+00 break T.P. Hub.		1.88	258.72	253.00	5.7	
1+50		10.6	250.0	247.45	2.6	
1+90 - MH #18		10.5	250.1	243.00	7.1	
2+00 TR	1.01	260.60	7.93	252.67	6.4	
+50 TR	0.06	272.18	12.59	259.59	246.27	
	0.80	283.91	4.3	267.9	262.63	
3+00 break T.P. Hub.		11.13	272.12	279.20	4.1	
4+50		7.5	283.11	279.20	7.1	
4+00	5	6.4	286.7	279.60	7.1	
4+50		5.97	287.8	280.21	7.6	
5+00		5.10	288.27	280.81	7.5	
5+50		5.10	289.14	281.42	7.7	
6+00		5.21	289.03	282.02	7.0	
6+00		6.26	287.98	282.63	5.4	
6+30 Hub-DE	6.40	294.24	6.40	287.84	283.00	4.8

267.9 = 2+50 Hub Albert St.

1.25	275.16	275.16
0.29	262.63	274.77
12.53		286.53
		279.00
		7.53

2500	259.22	259.22
9.22	247.45	258.00
	11.77	6.22

283.49	290.37	290.37
6.88	277.00	282.00
	13.37	8.37

282.11	291.94	291.94	291.94	291.94	291.94
8.83	277.00	277.60	280.21	280.81	281.43
	12.94	12.34	11.73	11.13	10.52

291.94	291.94	291.94
7.92	282.63	283.00
	9.31	8.74

6/30/24  
 Gregory  
 Moore  
 Ellis  
 Sand

Change of grade, sewer of Herbert  
 St. from MH bet Myrtle + Upas to d Upas

	1413	48	Stakes	Grade	
5+03.8 M.H. (see page 41)	297.13			283.0	
+50		8.16	288.97	283.45	+5.52
6		6.79	290.34	283.94	+6.40
+50		6.51	290.62	284.43	+6.19
7+09 M.H. to Upas @ 45° P. break	7.10	290.03	285.0		+5.03
7+44 1/2 = S.L. Upas D.E	7.18	289.95	285.48		+4.47

Construction Notes  
Relocation of Sewer Main  
bet Park Blvd + Center  
N. of Univ. Ave

1088

310.94

stab at 2442 L  
300.04

0+00 = M.H. #130 Book 195-63

30600

0+50

0.74

310.18

304.23

5.15

1

3.79

307.63

302.86

4.77

+50

4.96

305.96

301.29

4.67

2

7.11

303.81

299.73

4.08

+50

10.49

300.43

298.19

3.26

3

11.07

299.85

296.60

3.25

+rd Δ M.H.

386

303.90

10.88

300.04

295.85

7.76

0.29

303.61

295.85

7.76

+50

3.41

300.49

295.04

5.45

751

302.55

386

300.04

295.04

5.45

4

3.40

297.15

293.47

5.68

+14.6 M.H. A 84°05' L

6.42

296.13

293.0

3.13

9.90

292.65

1023°

Present pipe

0+00 = M.H. #130

Book 195 page 63 78

M.H. #130  
A 84°05' L

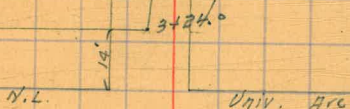

As near as can be  
told by surface  
indications } N.B.

Connects with old sewer  
here?

1 Sewer line from  $\perp$  Alley 95' W. WL  
27 St. bet K & L sts. 715' S to D.E.

Hubs are 2' offset to W.

W.L. 27 St.  
140' S. of K St. 4.35  
Top Curb.

0+00 =  $\perp$  Alley. 5.07  
197' W. WL 27 St.

0+50 8.25

1+00 11.21

1+15 = D.E. 11.93

June 23 - 1913.

West

Evidns

Moore

79



✓ Lewis St. Sewer. E Alley bet Jack  
 daw & Ibis to 50' E of Ibis. & trend  
 = 5' S of N. Curb line.

	H.I.	EL	Gr.
no. Bot M.H. & Lewis + Alley bet Ibis & Jackdaw.		264.70	264.70
11.04	275.74		
0+25 - angle then 5' S Curb line.	3.1	272.6	264.90
0+50	3.5	372.2	265.00
1+00	4.8	270.9	265.20
1+50			265.40
1+54.9 E Ibis St. N.H.	5.3	270.4	265.42
2+05 - Opposite House cor.	6.5	269.2	265.65
+			

5

June 14/13.

West  
 Evans  
 Moore

80

7.7  
 7.2  
 5.7  
 5.0  
 3.5

✓

Bot FT.	11.10		
100 Bot M.	£ 65	5.0	
Frithman Cass.	5.9		
0+25	Frithman Cass.	8.0	
0+50		0.6	106.60
		9	6.50
		15	100.10
1+00			8.37
1+50		100.00	6.07
1+50		6.60	
	5.10		
2+00	1.50	106.60	7.30
	6.60	6.40	
		100.20	
		4.83	
		105.03	105.03
		5.07	
		99.96	

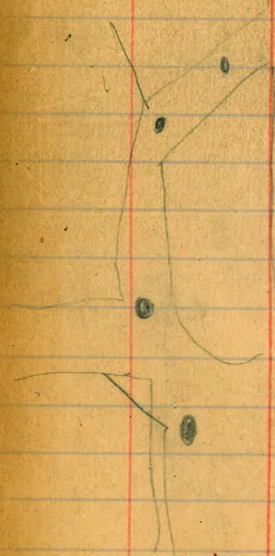

351 700 N3  
Eagan

1+00	NL	2+11 NL	8.67
0+25	5.7	0+25	5.0
4+00	4.1	1+50	5.3
1+00	4.2		5.7
4+50	5.8	1+00	5.9
1+00	6.1	2+00	6.4
4+50	6.6	2+50	6.5
1+00	6.2	2+75	6.5
2+65	7.1	2+00	7.0
NL 3+00	8.2		

25.00  
15.00  
5.00  
25.00

1300  
5752 5739  
4754  
210  
118.27  
119.21  
47  
95  
277.0  
273.50  
4.50  
272.50  
273.50  
4.50  
272.50  
273.50  
4.50  
187  
11.72  
276.32  
273.50  
2.82  
276.32  
273.50  
2.82  
1078



✓

Bot 7.T.

Bot. Bot M. \$ 65

Front house

0+2 Front house

0+5

1+0

1+5

1+8

2+

+

1925 ... 318

1492 = 2514  
8446 = 2776  
0+34 = 2774  
0+15 = 2774

278.20  
5.37  
278.57

278.57  
7.61

278.57  
7.61

278.57  
7.61

278.57  
7.61

100.20  
4.83  
105.03

105.03  
5.07  
99.96

105.03  
5.07  
99.96

105.03  
5.07  
99.96

105.03  
5.07  
99.96

105.03  
5.07  
99.96

105.03  
5.07  
99.96

105.03  
5.07  
99.96

105.03  
5.07  
99.96

105.03  
5.07  
99.96

105.03  
5.07  
99.96

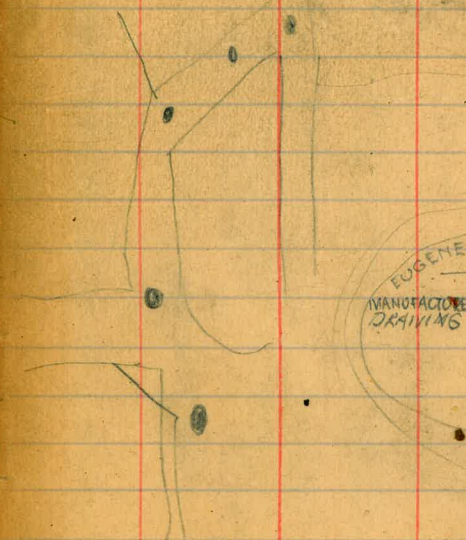

EUGENE DIETZGEN CO.  
MANUFACTURERS & IMPORTERS OF  
DRAWING MATERIALS

6.80  
7.00  
7.15

207.14  
12.70  
221.10

2938  
1211.60  
10196

13443  
100.93  
13200

137.75  
157.13  
243

157.13  
243  
157.13

157.13  
243  
157.13

157.13  
243  
157.13

157.13  
243  
157.13

157.13  
243  
157.13

157.13  
243  
157.13

157.13  
243  
157.13

157.13  
243  
157.13

157.13  
243  
157.13

157.13  
243  
157.13

157.13  
243  
157.13

157.13  
243  
157.13

157.13  
243  
157.13



72.2  
15.13  
209  
18.81  
16.500

246.32  
290.17  
388  
1978