

924  
F.B.

---

LEVEL BOOK.

No. 410

---



MICROFILMED  
DEC 16 1964



1) blayl X Sec of Cottonwood st (80')  
 6. Taylor  
 14 City Boston st to Marine Villa add

1

Bm. B 896  
 P 9

873 1663 840

E end of Yama st

|   |  |    |     |
|---|--|----|-----|
| n |  | 78 | 88  |
|   |  | 83 | 8.3 |
|   |  | 83 | 8.3 |
| t |  | 83 | 8.3 |
|   |  | 84 | 8.7 |
|   |  | 86 | 8.0 |
| s |  | 88 | 7.8 |

50 W of Yama st

|   |  |    |     |
|---|--|----|-----|
| s |  | 88 | 7.8 |
|   |  | 87 | 7.9 |
|   |  | 87 |     |
| t |  | 84 | 8.3 |
|   |  | 83 | 8.3 |
|   |  | 82 | 8.4 |
| n |  | 82 | 8.4 |

**PLOTTED**



1663

75' w of Yama

n 70 9.6

68 9.8

68 9.8

s 70 9.6

70 9.6

74 9.2

s 80 8.6

100' w of Yama

s 54 11.2

48 11.8

46 12.0

b 43 12.3

43 12.3

44 12.2

n 50 11.6

PLOTTED

16.63

bottom wind

2

150' w of Yama

n 18 14.8

19 14.7

18 14.8

b 20 14.6

28 13.8

33 13.3

s 44 12.2

TP 890 2322 231 14.32

200' w of Yama

s 98 13.4

94 14.0

81 15.1

b 70 16.2

65 16.7

54 17.8

n 44 18.8

1663  
201  
14.32  
890  
2322



2322

250 w of Yama

|   |    |      |
|---|----|------|
| n | 23 | 20.9 |
|   | 33 | 19.9 |
|   | 42 | 19.0 |
| b | 53 | 17.7 |
|   | 68 | 16.4 |
|   | 70 | 16.2 |
| s | 72 | 16.0 |

300 w of Yama

|   |    |      |
|---|----|------|
| s | 64 | 16.8 |
|   | 55 | 17.7 |
|   | 50 | 18.3 |
| b | 41 | 19.1 |
|   | 28 | 20.4 |
|   | 20 | 21.2 |
| n | 21 | 21.1 |

PLOTTED

2322

bottomland

3

350 w of Yama

|   |    |      |
|---|----|------|
| n | 26 | 20.6 |
|   | 29 | 20.3 |
|   | 26 | 20.6 |
| b | 37 | 19.8 |
|   | 47 | 18.5 |
|   | 52 | 18.0 |
| s | 61 | 17.1 |

400 w of Yama

|   |    |      |
|---|----|------|
| s | 87 | 14.5 |
|   | 76 | 15.6 |
|   | 67 | 16.5 |
| b | 52 | 17.6 |
|   | 46 | 18.6 |
|   | 37 | 19.5 |
| n | 28 | 20.4 |



2322

2657

Bottom wood

4

450 W of Yama

550 W of Yama

|   |    |      |
|---|----|------|
| n | 27 | 20.5 |
|   | 40 | 19.2 |
|   | 47 | 18.5 |
| b | 57 | 17.5 |
|   | 66 | 16.6 |
|   | 69 | 16.3 |
| s | 74 | 15.8 |

|   |    |      |
|---|----|------|
| n | 66 | 20.0 |
|   | 67 | 19.9 |
|   | 67 | 19.9 |
| b | 70 | 19.6 |
|   | 70 | 19.6 |
|   | 74 | 19.2 |
| s | 75 | 19.1 |

500 W of Yama

600 W = E of 39th St (60')

|   |    |      |
|---|----|------|
| s | 35 | 19.7 |
|   | 36 | 19.6 |
|   | 36 | 19.4 |
| b | 35 | 19.7 |
|   | 30 | 20.2 |
|   | 24 | 20.8 |
| 2 | 17 | 21.5 |

|   |    |      |
|---|----|------|
| s | 86 | 18.0 |
|   | 82 | 18.4 |
|   | 75 | 19.1 |
| b | 68 | 19.8 |
|   | 65 | 20.1 |
|   | 58 | 20.8 |
| n | 46 | 22.0 |

TP 562 2657 227 2095

PLOTTED



2657

2657

bottom

5

E 1/4 39A

|   |    |      |
|---|----|------|
| n | 42 | 22.4 |
|   | 52 | 21.4 |
|   | 57 | 20.9 |
| s | 63 | 20.3 |
|   | 70 | 19.6 |
|   | 77 | 18.9 |
| s | 82 | 18.4 |

E 1/4 39A

|   |    |      |
|---|----|------|
| s | 75 | 19.1 |
|   | 70 | 19.6 |
|   | 66 | 20.0 |
| t | 60 | 20.6 |
|   | 52 | 21.4 |
|   | 46 | 22.0 |
| n | 38 | 22.8 |

PLOTTED

center 1/4 39A

|   |    |      |
|---|----|------|
| n | 36 | 23.0 |
|   | 41 | 22.5 |
|   | 46 | 22.0 |
| t | 54 | 21.2 |
|   | 60 | 20.6 |
|   | 64 | 20.2 |
| s | 67 | 19.9 |

W 1/4 39A

|   |    |      |
|---|----|------|
| s | 58 | 20.8 |
|   | 57 | 20.9 |
|   | 52 | 21.4 |
| t | 48 | 21.8 |
|   | 44 | 22.2 |
|   | 39 | 22.7 |
| n | 36 | 23.0 |

22.2  
22.7  
20.95  
26.5  
26.57

22.2 20.95



2657

2657

bottom row

6

W 66 f 39.2

n 35 23.1

38 22.8

42 22.4

b 45 22.1

47 21.9

52 21.4

S 53 21.3

W line f 39.2

S 50 21.6

48 21.8

45 22.1

b 44 22.2

41 22.5

40 22.6

n 36 23.0

PLOTTED

50 W f 39.2

n 41 22.5

42 22.4

43 22.3

b 44 22.2

46 22.0

48 21.8

S 51 21.5

100 W f 39.2

S 61 20.5

58 20.8

53 21.3

b 52 21.4

50 21.6

49 21.7

n 46 22.0



2657

2637

bottomwood

7

150' W J 39 ft

n 48 21.8

53 21.3

56 21.0

l 60 20.6

63 20.3

64 20.2

s 66 20.0

200' W J 39 ft

s 67 19.9

65 20.1

66 20.0

l 60 20.6

57 20.9

55 21.1

n 56 21.0

PLOTTED

250' W J 39 ft

n 53 21.3

57 20.9

60 20.6

62 20.4

64 20.2

63 20.3

65 20.1

300' W J 39 ft

s 66 20.0

66 20.0

64 20.2

62 20.4

61 20.5

57 20.9

54 21.2

TP 400' 257 ft 482 21.57

2657

482

21.57

400

2577



2577  
25.77

|   | 350 | WJ | 39.2     |  |
|---|-----|----|----------|--|
| n |     |    | 4.3 21.5 |  |
|   |     |    | 4.7 21.1 |  |
|   |     |    | 5.2 20.6 |  |
| b |     |    | 5.3 20.5 |  |
|   |     |    | 5.6 20.2 |  |
|   |     |    | 5.9 19.9 |  |
| s |     |    | 6.2 19.6 |  |
|   | 400 | WJ | 39       |  |
| s |     |    | 6.3 19.6 |  |
|   |     |    | 6.1 19.7 |  |
|   |     |    | 5.6 20.2 |  |
| b |     |    | 5.5 20.3 |  |
|   |     |    | 5.5 20.3 |  |
|   |     |    | 5.4 20.4 |  |
| n |     |    | 4.9 20.9 |  |

PLOTTED

2577

25.77

8

|   | 450 | WJ | 39.2     |  |
|---|-----|----|----------|--|
| n |     |    | 4.8 21.0 |  |
|   |     |    | 5.4 20.4 |  |
|   |     |    | 5.6 20.2 |  |
| b |     |    | 5.6 20.2 |  |
|   |     |    | 6.0 19.8 |  |
|   |     |    | 6.0 19.8 |  |
| s |     |    | 5.5 20.3 |  |
|   | 500 | WJ | 39.2     |  |
| s |     |    | 5.7 20.8 |  |
|   |     |    | 5.0 20.8 |  |
|   |     |    | 5.2 20.6 |  |
| b |     |    | 5.2 20.6 |  |
|   |     |    | 5.5 20.3 |  |
|   |     |    | 5.4 20.4 |  |
| n |     |    | 4.8 21.0 |  |



25.77

550 w f 39d

n 54 20.4

50 20.8

50 20.8

b 50 20.8

51 20.7

52 20.6

s 54 20.4

600 w = E line Vestal (60)

s 56 20.2

60 19.8

54 20.4

b 57 20.1

54 20.4

53 20.5

n 52 20.6

PLOTTED

25.77

bottom 2 m

9

E 60 f Vestal

n 51 20.7

54 20.4

55 20.3

b 56 20.2

60 19.8

63 19.5

s 60 19.8

E 14 f Vestal

s 66 19.2

63 19.5

60 19.8

b 52 20.2

55 20.3

54 20.4

n 52 20.6



2577

Center of Vista

|   |    |      |
|---|----|------|
| n | 52 | 20.6 |
|   | 54 | 20.4 |
|   | 56 | 20.2 |
| b | 58 | 20.0 |
|   | 60 | 19.8 |
|   | 64 | 19.4 |
| s | 69 | 18.9 |

W 1/4 of Vista

|   |    |      |
|---|----|------|
| s | 70 | 18.8 |
|   | 63 | 19.5 |
|   | 61 | 19.7 |
| b | 60 | 19.8 |
|   | 60 | 19.8 |
|   | 59 | 19.9 |
| n | 59 | 19.9 |

PLOTTED

2577

W 1/4 of Vista

|   |    |      |
|---|----|------|
| n | 57 | 20.1 |
|   | 59 | 19.9 |
|   | 61 | 19.7 |
| b | 63 | 19.5 |
|   | 65 | 19.3 |
|   | 67 | 19.1 |
| s | 70 | 18.8 |

W 1/4 of Vista

|   |    |      |
|---|----|------|
| s | 71 | 18.7 |
|   | 69 | 18.9 |
|   | 67 | 19.1 |
| b | 62 | 19.6 |
|   | 59 | 19.9 |
|   | 60 | 19.8 |
| n | 60 | 19.8 |

Bostonwood

10



2577

|    |     |            |     |       |
|----|-----|------------|-----|-------|
|    | 50  | w of Vista |     |       |
| n  |     |            | 67  | 19.1  |
|    |     |            | 70  | 18.8  |
|    |     |            | 70  | 18.8  |
| b  |     |            | 73  | 18.5  |
|    |     |            | 76  | 18.2  |
|    |     |            | 79  | 17.9  |
| s  |     |            | 80  | 17.8  |
| TP | 218 | 2004       | 791 | 17.86 |
|    | 100 | w of Vista |     |       |
| s  |     |            | 33  | 14.7  |
|    |     |            | 33  | 16.7  |
|    |     |            | 30  | 17.0  |
| b  |     |            | 29  | 17.1  |
|    |     |            | 25  | 17.5  |
|    |     |            | 21  | 17.9  |
| n  |     |            | 15  | 18.5  |

PLOTTED

2004  
2004

bottom row  
11

|   |     |            |    |      |
|---|-----|------------|----|------|
|   | 150 | w of Vista |    |      |
| n |     |            | 24 | 17.6 |
|   |     |            | 28 | 17.3 |
|   |     |            | 30 | 17.0 |
| b |     |            | 34 | 16.6 |
|   |     |            | 35 | 16.5 |
|   |     |            | 36 | 16.4 |
| s |     |            | 40 | 16.0 |
|   | 200 | w of Vista |    |      |
| s |     |            | 50 | 15.0 |
|   |     |            | 46 | 15.4 |
|   |     |            | 43 | 15.7 |
| b |     |            | 44 | 15.6 |
|   |     |            | 43 | 15.7 |
|   |     |            | 40 | 16.0 |
| n |     |            | 34 | 16.6 |

2577  
291  
17.86  
218  
20.104



2004

|   | 250 | n of | Vista   |
|---|-----|------|---------|
| n |     |      | 40 14.0 |
|   |     |      | 44 15.6 |
|   |     |      | 51 14.9 |
| b |     |      | 55 14.5 |
|   |     |      | 57 14.3 |
|   |     |      | 62 13.8 |
| g |     |      | 65 13.5 |
|   | 300 | n of | Vista   |
| s |     |      | 70 13.0 |
|   |     |      | 63 13.7 |
|   |     |      | 60 14.0 |
| b |     |      | 57 14.3 |
|   |     |      | 53 14.7 |
|   |     |      | 48 15.2 |
| n |     |      | 44 15.6 |

PLOTTED

2004

Cottonwood  
12

|   | 350 | n of | Vista   |
|---|-----|------|---------|
| n |     |      | 54 14.6 |
|   |     |      | 53 14.7 |
|   |     |      | 56 14.4 |
| b |     |      | 61 13.9 |
|   |     |      | 66 13.4 |
|   |     |      | 74 12.6 |
| s |     |      | 85 11.5 |
|   | 575 | n of | Vista   |
| s |     |      | 102 9.8 |
|   |     |      | 85 11.5 |
|   |     |      | 63 13.9 |
| b |     |      | 56 14.4 |
|   |     |      | 59 14.1 |
|   |     |      | 60 14.0 |
| n |     |      | 66 13.4 |



2004

|     | 400 | W of | Westa    |  |
|-----|-----|------|----------|--|
| n e |     |      | 86 11.4  |  |
|     |     |      | 70 13.0  |  |
|     |     |      | 62 13.8  |  |
| b b |     |      | 74 12.6  |  |
|     |     |      | 88 11.2  |  |
|     |     |      | 100 10.0 |  |
| g s |     |      | 110 9.0  |  |
|     | 450 | W of | Westa    |  |
| s s |     |      | 120 8.0  |  |
|     |     |      | 118 8.2  |  |
|     |     |      | 118 8.2  |  |
| b b |     |      | 113 8.7  |  |
|     |     |      | 107 9.3  |  |
|     |     |      | 110 9.0  |  |
| n n |     |      | 112 8.8  |  |

PLOTTED

2004

Cottontail

13

|   | 500 | W of | Westa   |  |
|---|-----|------|---------|--|
| n |     |      | 140 6.0 |  |
|   |     |      | 140 6.0 |  |
|   |     |      | 140 6.0 |  |
| b |     |      | 126 7.4 |  |
|   |     |      | 130 7.0 |  |
|   |     |      | 131 6.9 |  |
| s |     |      | 113 8.7 |  |
|   | 525 | W of | Westa   |  |
|   | 550 | W of | Westa   |  |
|   |     |      | 110 9.0 |  |
| s |     |      | 90 11.0 |  |
|   |     |      | 103 9.7 |  |
|   |     |      | 115 8.5 |  |
| b |     |      | 133 6.7 |  |
|   |     |      | 142 5.8 |  |
|   |     |      | 146 5.4 |  |
| n |     |      | 144 5.6 |  |



2004

600 W = E of Una (60)

N 144 5.6

133 6.7

125 7.5

b 115 8.5

94 10.6

71 12.9

S 48 15.2

TP 727 2254 487 15.0

E Center of Una st

S 67 15.8

82 14.3

106 11.9

c 126 9.9

131 9.4

146 7.9

n 157 6.8

PLOTTED

2254

14

E 147 Center

n 148 7.7

127 9.8

112 11.3

b 107 11.8

97 12.8

75 15.0

S 63 16.2

Center of Una st

S 63 16.2

75 15.0

84 14.1

b 90 13.5

102 12.3

118 10.7

n 138 8.7

2004

487

15.0

727

2254



2254

W 1/4 of Area

n 123 10.2

108 11.7

92 13.3

b 75 15.0

68 15.7

66 15.9

s 60 14.5

W Cont Area

s 35 17.0

58 14.7

60 14.5

b 66 15.9

80 14.5

95 13.0

n 113 11.2

PLOTTED

2254

• Cotton wood  
15

W Side of Area

n 105 12.0

86 13.9

71 15.4

b 58 16.7

52 17.3

51 17.4

s 49 17.6

TP 760 2222 222 20.32

50 W of Area

s 67 21.2

74 20.5

80 19.9

b 81 19.8

92 18.7

105 17.4

n 119 16.0

2254  
232  
2432  
2760  
2792



2792

30.15

30.15

Continued

16

100 w of Ana

n 83 19.6

79 20.0

76 20.3

b 72 20.7

67 21.2

63 21.6

s 56 22.3

150 w of Ana

s 37 24.5

38 24.1

40 23.9

l 41 23.8

42 23.7

42 23.7

n 42 23.7

TP 235 30.15 014 2780

PLOTTED

200 w of Ana

n 19 28.3

22 28.0

21 28.1

b 21 28.1

21 28.1

21 28.1

s 24 27.8

250 w of Ana

s 13 28.9

12 29.0

14 28.8

b 13 28.9

13 28.9

08 29.4

n 09 29.3

2792

12

2780

235

30.15



30.15

300 W of Una

N 33 26.9

29 27.3

27 27.5

S 24 27.8

22 28.0

21 28.1

S 20 27.9

350 W of Una

S 76 22.6

78 22.4

76 22.6

S 73 22.9

74 22.8

70 23.2

N 69 23.3

PLOTTED

30.15

Bottomwood

17

400 W of Una

N 98 20.4

106 19.6

113 18.9

S 115 18.7

117 18.5

118 18.4

S 126 17.6

1848

7P 011 1848 1178 18.37

450 W of Una

S 63 12.2

58 12.7

48 13.7

S 40 14.5

30 15.5

21 16.4

N 12 17.3

30.15

1178

18.37

11

18.48



1848

681

bottom

18

|   | 500 | Wf  | Una |      |
|---|-----|-----|-----|------|
| n |     |     | 56  | 12.9 |
|   |     |     | 69  | 11.6 |
|   |     |     | 79  | 10.6 |
| b |     |     | 88  | 9.7  |
|   |     |     | 92  | 9.3  |
|   |     |     | 99  | 8.6  |
| S |     |     | 102 | 8.3  |
|   | 77  | 068 | 681 | 1235 |
|   |     |     |     | 5.3  |
|   | 550 | Wf  | Una |      |
| S |     |     | 25  | 4.3  |
|   |     |     | 25  | 4.3  |
|   |     |     | 22  | 4.6  |
| b |     |     | 21  | 4.7  |
|   |     |     | 15  | 5.3  |
|   |     |     | 15  | 5.3  |
| n |     |     | 11  | 5.7  |

PLOTTED

|   | 600 | W = Edin | Thor   | (60) |
|---|-----|----------|--------|------|
| n |     |          | 53     | 1.5  |
|   |     |          | 50     | 1.8  |
|   |     |          | 53     | 1.5  |
| b |     |          | 54     | 1.4  |
|   |     |          | 53     | 1.5  |
|   |     |          | 53     | 1.5  |
| S |     |          | 50     | 1.8  |
|   | E   | Bank     | f Thor |      |
| S |     |          | 54     | 1.2  |
|   |     |          | 57     | 1.1  |
|   |     |          | 55     | 1.3  |
| b |     |          | 56     | 1.2  |
|   |     |          | 55     | 1.3  |
|   |     |          | 53     | 1.5  |
| n |     |          | 53     | 1.5  |

1848

1235

5.12

6.81



681

|   | E      | 1/4 of Thor |     |
|---|--------|-------------|-----|
| n |        | 52          | 1.6 |
|   |        | 52          | 1.6 |
|   |        | 55          | 1.3 |
| b |        | 55          | 1.3 |
|   |        | 55          | 1.3 |
|   |        | 55          | 1.3 |
| s |        | 56          | 1.2 |
|   | center |             |     |
| s |        | 55          | 1.3 |
|   |        | 53          | 1.5 |
|   |        | 53          | 1.5 |
| b |        | 53          | 1.5 |
|   |        | 53          | 1.5 |
|   |        | 50          | 1.8 |
| n |        | 50          | 1.8 |

PLOTTED

681

Boston area  
19

|   | W             | 1/4 of Thor |     |
|---|---------------|-------------|-----|
| n |               | 50          | 1.8 |
|   |               | 50          | 1.8 |
|   |               | 50          | 1.8 |
| b |               | 50          | 1.8 |
|   |               | 52          | 1.6 |
|   |               | 54          | 1.4 |
| s |               | 53          | 1.5 |
|   | W 1/4 of Thor |             |     |
| s |               | 53          | 1.5 |
|   |               | 53          | 1.5 |
|   |               | 52          | 1.6 |
| b |               | 51          | 1.7 |
|   |               | 51          | 1.7 |
|   |               | 50          | 1.8 |
| n |               | 51          | 1.7 |



681

W. Sin. f Thor

n 52 1.6

52 1.6

52 1.6

b 53 1.5

52 1.6

53 1.5

S 53 1.5

50 W f Thor

S 47 2.1

45 2.3

47 2.1

b 45 2.3

45 2.3

45 2.3

n 45 2.3

PLOTTED

681

Cottonwood

20

100 W f Thor

n 46 2.3

45 2.3

47 2.1

b 47 2.1

48 2.0

49 1.9

S 49 1.9

150 W f Thor

S 49 1.9

49 1.9

45 2.3

b 45 2.3

45 2.3

46 2.3

n 45 2.3



681

|    | 200 | W of       | 7hor |      |
|----|-----|------------|------|------|
| n  |     |            | 44   | 2.4  |
|    |     |            | 43   | 2.5  |
|    |     |            | 44   | 2.4  |
| l  |     |            | 44   | 2.4  |
|    |     |            | 46   | 2.7  |
|    |     |            | 45   | 2.3  |
| S  |     |            | 45   | 2.3  |
| TP | 607 | <u>846</u> | 44   | 2.39 |
|    | 250 |            |      |      |
| S  |     |            | 49   | 3.6  |
|    |     |            | 50   | 3.5  |
|    |     |            | 52   | 3.3  |
| b  |     |            | 53   | 3.7  |
|    |     |            | 52   | 3.3  |
|    |     |            | 52   | 3.3  |
| n  |     |            | 53   | 3.7  |

PLOTTER

846

21

|   | 300 | W of | 7hor |     |
|---|-----|------|------|-----|
| n |     |      | 46   | 3.9 |
|   |     |      | 47   | 3.8 |
|   |     |      | 47   | 3.8 |
| b |     |      | 48   | 3.7 |
|   |     |      | 50   | 3.5 |
|   |     |      | 50   | 3.5 |
| S |     |      | 52   | 3.3 |
|   | 315 | W    |      |     |
| S |     |      | 50   | 3.5 |
|   |     |      | 50   | 3.5 |
|   |     |      | 49   | 3.6 |
| b |     |      | 50   | 3.5 |
|   |     |      | 49   | 3.6 |
|   |     |      | 51   | 3.4 |
| n |     |      | 53   | 3.7 |

681  
44  
2.39  
607  
8.46



846

330 w of 7hr

|   |    |      |
|---|----|------|
| n | 96 | -1.1 |
|   | 94 | -0.9 |
|   | 94 | -0.9 |
| b | 93 | -0.8 |
|   | 92 | -0.7 |
|   | 95 | -1.0 |
| s | 95 | -1.0 |

350 w of 7hr

|   |    |     |
|---|----|-----|
| s | 64 | 2.1 |
|   | 66 | 1.9 |
|   | 70 | 1.5 |
| b | 70 | 1.5 |
|   | 70 | 1.5 |
|   | 70 | 1.5 |
| n | 70 | 1.5 |

PLOTTED

846

22

360 w of 7hr

|   |    |     |
|---|----|-----|
| n | 52 | 3.3 |
|   | 51 | 3.4 |
|   | 51 | 3.4 |
| l | 50 | 3.5 |
|   | 52 | 3.3 |
|   | 52 | 3.3 |
| s | 50 | 3.5 |

400 w of 7hr

|   |    |     |
|---|----|-----|
| s | 54 | 3.1 |
|   | 52 | 3.3 |
|   | 51 | 3.4 |
| b | 48 | 3.7 |
|   | 49 | 3.6 |
|   | 49 | 3.6 |
| n | 50 | 3.5 |



846

450 w of Thor

|    |     |           |
|----|-----|-----------|
| n  | 60  | 2.5       |
|    | 62  | 2.3       |
|    | 60  | 2.5       |
| b  | 60  | 2.5       |
|    | 60  | 2.5       |
|    | 60  | 2.5       |
| S  | 61  | 2.4       |
| TP | 371 | 605 2.91  |
|    | 500 | w of Thor |
| S  | 41  | 2.0       |
|    | 40  | 2.1       |
|    | 40  | 2.1       |
| b  | 43  | 1.8       |
|    | 42  | 1.9       |
|    | 41  | 2.0       |
| n  | 40  | 2.1       |

PLOTTED

612

550 w of Thor

|   |     |                         |
|---|-----|-------------------------|
| n | 42  | 1.9                     |
|   | 43  | 1.8                     |
|   | 44  | 1.7                     |
| b | 41  | 2.0                     |
|   | 44  | 1.7                     |
|   | 46  | 1.5                     |
| S | 49  | 1.3                     |
|   | 500 | w = E of Sina. or (60') |
| S | 51  | 1.0                     |
|   | 51  | 1.0                     |
|   | 51  | 1.0                     |
| b | 49  | 1.2                     |
|   | 48  | 1.3                     |
|   | 47  | 1.4                     |
| n | 47  | 1.4                     |

butterwood

23

846

~~605~~

2.91

~~2.71~~

2.72



612

E burby Sine st

n 47 1.4

47 1.4

46 1.5

b 47 1.4

47 1.4

50 1.1

s 50 1.1

E 1/4 of Sine st

s 52 0.9

51 1.0

51 1.0

b 50 1.1

50 1.1

48 1.3

n 47 1.4

PLOTTED

612

bottomwood

24

center of Sine

n. 46 1.5

48 1.3

48 1.3

b 48 1.3

50 1.1

52 0.9

s 52 0.9

W 1/4 of Sine

s 52 0.9

53 0.8

53 0.8

b 50 1.1

47 1.4

47 1.4

n. 45 1.6



612

|   | W | bbf | Sine |
|---|---|-----|------|
| n |   | 47  | 1.4  |
|   |   | 49  | 1.3  |
|   |   | 50  | 1.1  |
| b |   | 51  | 1.0  |
|   |   | 53  | 0.8  |
|   |   | 54  | 0.7  |
| S |   | 53  | 0.8  |
|   | W | sin | Sine |
| S |   | 53  | 0.8  |
|   |   | 54  | 0.7  |
|   |   | 57  | 1.0  |
| b |   | 57  | 1.0  |
|   |   | 57  | 1.0  |
|   |   | 48  | 1.3  |
| n |   | 45  | 1.6  |

PLOTTED

662

bottomwood

.25

|   | 50  | wf | Sine   |
|---|-----|----|--------|
| n |     |    | 47 1.4 |
|   |     |    | 52 0.9 |
|   |     |    | 52 0.9 |
| b |     |    | 52 0.9 |
|   |     |    | 52 0.9 |
|   |     |    | 54 0.7 |
| S |     |    | 54 0.7 |
|   | 100 | wf | Sine   |
| S |     |    | 54 0.7 |
|   |     |    | 55 0.6 |
|   |     |    | 54 0.7 |
| b |     |    | 52 0.9 |
|   |     |    | 53 0.8 |
|   |     |    | 48 1.3 |
| n |     |    | 49 1.2 |

PLOTTED



612

1308

612

26

|   | 150 | WJ | Sin |     |
|---|-----|----|-----|-----|
| n |     |    | 52  | 0.9 |
|   |     |    | 51  | 1.0 |
|   |     |    | 54  | 0.7 |
| b |     |    | 54  | 0.7 |
|   |     |    | 55  | 0.6 |
|   |     |    | 55  | 0.6 |
| S |     |    | 55  | 0.6 |

|   | 200 | WJ | Sin |     |
|---|-----|----|-----|-----|
| S |     |    | 55  | 0.6 |
|   |     |    | 55  | 0.6 |
|   |     |    | 55  | 0.6 |
| b |     |    | 53  | 0.8 |
|   |     |    | 52  | 0.9 |
|   |     |    | 52  | 0.9 |
| n |     |    | 52  | 0.9 |

TP 1250 1308 554 0.58

PLOTTED

|   | 250 | WJ | Sin |     |
|---|-----|----|-----|-----|
| n |     |    | 127 | 0.4 |
|   |     |    | 127 | 0.4 |
|   |     |    | 129 | 0.3 |
| b |     |    | 128 | 0.3 |
|   |     |    | 127 | 0.4 |
|   |     |    | 126 | 0.5 |
| S |     |    | 127 | 0.4 |

|   | 280 | WJ | Sin |      |
|---|-----|----|-----|------|
| S |     |    | 130 | 0.1  |
|   |     |    | 131 | 0.0  |
|   |     |    | 132 | -0.1 |
| b |     |    | 130 | 0.1  |
|   |     |    | 130 | 0.1  |
|   |     |    | 127 | 0.4  |
| n |     |    | 125 | 0.6  |

612  
554  
0.58  
1250  
13.08



1308

300 W of Siva

n 8.5 4.6

9.4 3.7

10.4 2.7

b 11.3 1.8

12.3 0.8

12.6 0.5

s 13.0 0.1

320 W of Siva

s 8.0 5.1

6.0 7.1

4.7 8.4

b 3.5 9.6

2.0 11.1

1.1 12.0

n 0.5 12.6

PLOTTED

1308

bottom  
27

350 W of Siva

n 7.5 13.6

0.0 13.1

0.2 12.9

0.6 12.5

1.5 11.6

2.0 11.1

3.7 9.4

3.75 W of Siva

s 5.0 8.1

2.0 11.1

1.4 11.7

1.2 11.9

1.1 12.0

0.8 12.3

0.0 13.1



1308

400 W of Siro

n 37 9.4

46 8.5

52 7.9

b 65 6.6

80 5.1

90 4.1

s 110 2.1

425 W of Siro

s 143 -1.2

142 -1.1

130 0.1

b 124 0.7

112 1.9

105 2.6

n 105 2.6

PLOTTED

1308

450 W of Siro

n 125 0.6

130 0.1

133 -0.2

b 139 -0.8

140 -0.9

133 -0.2

s 133 -0.7

475 W of Siro

s 81 5.0

88 4.3

92 3.9

b 163 2.8

107 2.4

109 2.2

n 106 2.5

Bellman  
28



1308

500 Wf Siva

n 43 8.8

37 9.4

35 9.6

b 29 10.2

26 10.5

28 10.3

S 29 10.2

TP 929 1983 254 10.54

525 Wf Siva

S 66 13.2

63 13.5

61 13.7

b 60 13.8

58 14.0

56 14.2

n 58 14.0

PLOTTED

1983

550 Wf Siva

n 31 16.7

33 16.5

34 16.4

b 38 16.0

40 15.8

45 15.3

S 43 15.5

575 Wf Siva

S 36 14.3

35 14.3

31 16.7

b 27 17.1

23 17.5

20 17.8

n 17 18.1

bottomwood

29

1308

254

10.54

929

19.83



1983

600 W = E of Rigel St (60')

|   |             |      |
|---|-------------|------|
| n | 16          | 18.2 |
|   | 21          | 17.7 |
|   | 25          | 17.3 |
| b | 28          | 17.0 |
|   | 34          | 16.4 |
|   | 38          | 16.0 |
| s | 44          | 15.4 |
|   | E Sub Rigel |      |
| S | 48          | 15.0 |
|   | 43          | 15.5 |
|   | 37          | 16.1 |
| b | 35          | 16.3 |
|   | 29          | 16.9 |
|   | 21          | 17.7 |
| n | 16          | 18.2 |

PLOTTED

1983

Bottomwood

30

E 1/4 of Rigel

|   |                 |      |
|---|-----------------|------|
| n | 16              | 18.2 |
|   | 22              | 17.6 |
|   | 30              | 16.8 |
| b | 36              | 16.2 |
|   | 41              | 15.7 |
|   | 47              | 15.1 |
| S | 57              | 14.7 |
|   | Center of Rigel |      |
| S | 62              | 13.4 |
|   | 49              | 14.9 |
|   | 44              | 15.4 |
| b | 40              | 15.8 |
|   | 35              | 16.3 |
|   | 30              | 16.8 |
| n | 20              | 17.8 |



1983

|   | W | 1/4 of Rigal |      |
|---|---|--------------|------|
| N |   | 23           | 17.5 |
|   |   | 32           | 14.6 |
|   |   | 37           | 14.1 |
| b |   | 40           | 15.8 |
|   |   | 46           | 15.3 |
|   |   | 57           | 14.1 |
| S |   | 63           | 13.5 |
|   | W | 1/2 of Rigal |      |
| S |   | 62           | 13.6 |
|   |   | 64           | 13.4 |
|   |   | 51           | 14.7 |
| b |   | 44           | 15.4 |
|   |   | 40           | 15.8 |
|   |   | 33           | 16.5 |
| q |   | 26           | 17.2 |

PLOTTED

1983

bottom wood

31

|   | W  | 1/2 of Rigal |       |
|---|----|--------------|-------|
| N |    | 30           | 14.8  |
|   |    | 36           | 14.2  |
|   |    | 42           | 15.6  |
| b |    | 51           | 14.7  |
|   |    | 62           | 13.6  |
|   |    | 61           | 13.7  |
| S |    | 67           | 13.1  |
|   | BM | 476          | 15.07 |
|   | 50 | 1/2 of Rigal |       |
| S |    | 88           | 11.0  |
|   |    | 77           | 12.1  |
|   |    | 84           | 11.4  |
| b |    | 70           | 12.8  |
|   |    | 77           | 12.1  |
|   |    | 67           | 13.1  |
| q |    | 55           | 14.3  |

 1983  
 476  
 15.07

 13' max Rigal  
 bottom wood



1983

|    | 100 | wf  | Right |      |
|----|-----|-----|-------|------|
| n  |     |     | 67    | 13.1 |
|    |     |     | 95    | 10.3 |
|    |     |     | 99    | 9.9  |
| b  |     |     | 103   | 9.5  |
|    |     |     | 107   | 9.1  |
|    |     |     | 107   | 9.1  |
| S  |     |     | 113   | 8.5  |
| TP | 189 | 997 | 1175  | 808  |
|    | 150 | wf  | Right |      |
| S  |     |     | 20    | 8.0  |
|    |     |     | 32    | 6.8  |
|    |     |     | 26    | 7.4  |
| b  |     |     | 22    | 7.8  |
|    |     |     | 23    | 7.7  |
|    |     |     | 20    | 8.0  |
| n  |     |     | 00    | 10.0 |

PLOTTED

997

Bottom  
32

|   | 175 | wf | Right |      |
|---|-----|----|-------|------|
| n |     |    | 07    | 9.3  |
|   |     |    | 31    | 6.9  |
|   |     |    | 31    | 6.9  |
| b |     |    | 30    | 7.0  |
|   |     |    | 38    | 6.7  |
|   |     |    | 40    | 6.0  |
| S |     |    | 45    | 5.5  |
|   |     |    | 20    | wf   |
| S |     |    | 107   | -0.7 |
|   |     |    | 87    | 1.3  |
|   |     |    | 67    | 3.3  |
| b |     |    | 42    | 5.8  |
|   |     |    | 40    | 6.0  |
|   |     |    | 30    | 7.0  |
| n |     |    | 10    | 9.0  |

1982

1175

808

189

997

9.97



225' W = ERH + ORR on S

|            |     |      |
|------------|-----|------|
| n          | 40  | 6.0  |
|            | 52  | 4.8  |
|            | 73  | 2.7  |
| b          | 103 | -0.3 |
|            | 110 | -1.0 |
|            | 113 | -1.3 |
| South Rail | 78  | 2.2  |

250' W

|              |     |      |
|--------------|-----|------|
| n            | 109 | -0.9 |
| h            | 116 | -1.4 |
| 4            | 115 | -1.5 |
| Cent on Rail | 79  | 2.1  |

270' W on N 2

|   |     |      |
|---|-----|------|
| n | 119 | -1.9 |
|---|-----|------|

290' W = ERH + ORR

|           |    |     |
|-----------|----|-----|
| n on Rail | 78 | 2.2 |
|-----------|----|-----|

PLOTTED

Salt works pond west of  
RR track

|      |      |     |     |
|------|------|-----|-----|
| 579  | 665  | 086 |     |
| 1120 | 1630 | 105 | 560 |

|       |      |      |     |      |  |
|-------|------|------|-----|------|--|
| Sched | 1010 | 2513 | 178 | 1503 |  |
|       |      |      | 633 | 1850 |  |

Bm Reg'd  
Main st

86  
B'm on 5.79  
Bottom 6.65  
Reg'd 1.95  
13' on 5.60  
B'm 11.20  
Reg'd 16.80  
1.95  
15.03  
25.13  
6.33  
18.80

PLOTTED



7/14 Clay X sec of Birch St (80')  
 Boston St to Manns View  
 July

610 24.90 18.80 <sup>13' min</sup> Birch St  
 W line of Rigel St

|   |         |    |       |
|---|---------|----|-------|
| S |         | 49 | 20.0  |
|   |         | 50 | 19.9  |
|   |         | 53 | 19.6  |
| b |         | 51 | 19.8  |
|   |         | 60 | 18.9  |
|   |         | 55 | 19.4  |
| n |         | 50 | 19.9  |
|   | 50' w/b |    | Rigel |
| n |         | 24 | 22.5  |
|   |         | 28 | 22.1  |
|   |         | 33 | 21.6  |
| b |         | 38 | 21.1  |
|   |         | 39 | 21.0  |
|   |         | 37 | 21.2  |
| S |         | 40 | 20.9  |

24.90

Birch St  
34

100' w/b Rigel

|   |  |    |      |
|---|--|----|------|
| S |  | 56 | 19.3 |
|   |  | 54 | 19.5 |
|   |  | 48 | 20.1 |
| b |  | 40 | 20.9 |
|   |  | 34 | 21.0 |
|   |  | 31 | 21.8 |
| n |  | 32 | 21.7 |

150' w/b Rigel

|   |  |    |      |
|---|--|----|------|
| n |  | 35 | 21.4 |
|   |  | 40 | 20.9 |
|   |  | 53 | 19.6 |
| b |  | 62 | 18.7 |
|   |  | 66 | 18.3 |
|   |  | 72 | 17.7 |
| S |  | 67 | 18.2 |

PLOTTED



2490

200 W of Rigel

|   |    |      |
|---|----|------|
| S | 69 | 18.0 |
|   | 77 | 17.3 |
|   | 73 | 17.6 |
| b | 67 | 18.3 |
|   | 63 | 18.6 |
|   | 49 | 20.0 |
| n | 25 | 22.4 |

250 W of Rigel

|   |    |      |
|---|----|------|
| n | 25 | 22.4 |
|   | 40 | 20.9 |
|   | 50 | 19.9 |
| b | 62 | 18.7 |
|   | 67 | 18.3 |
|   | 70 | 17.9 |
| S | 69 | 18.0 |

PLOTTED

2490

Birch

35

300 W of Rigel

|    |     |              |
|----|-----|--------------|
| S  | 75  | 17.4         |
|    | 75  | 17.4         |
|    | 71  | 17.8         |
| b  | 67  | 18.3         |
|    | 57  | 19.3         |
|    | 54  | 19.5         |
| n  | 44  | 20.5         |
| TP | 151 | <u>17.49</u> |
|    | 89  | <u>15.98</u> |

350 W of Rigel

|   |     |      |
|---|-----|------|
| n | 405 | 18.0 |
|   | 10  | 16.5 |
|   | 14  | 16.1 |
| b | 15  | 16.0 |
|   | 15  | 16.0 |
|   | 20  | 15.5 |
| S | 210 | 15.5 |

2490  
832  
15.98  
151  
17.49



1749

400 W of Rigel

|   |    |      |
|---|----|------|
| S | 52 | 12.3 |
|   | 42 | 13.3 |
|   | 37 | 13.8 |
| b | 44 | 13.1 |
|   | 41 | 13.4 |
|   | 63 | 11.2 |
| n | 90 | 8.5  |

425 W of Rigel

|   |     |      |
|---|-----|------|
| n | 124 | 5.1  |
|   | 106 | 6.9  |
|   | 70  | 10.5 |
| b | 47  | 12.8 |
|   | 48  | 12.7 |
|   | 60  | 11.5 |
| S | 70  | 10.5 |

TP 00 920 84 920

PLOTTED

930

Binch

36

430 W of Rigel

|   |    |     |
|---|----|-----|
| S | 15 | 7.7 |
|   | 26 | 6.6 |
|   | 28 | 6.4 |
| b | 32 | 6.0 |
|   | 50 | 4.2 |
|   | 66 | 2.6 |
| n | 63 | 2.9 |

TP 500 W of Rigel

|   |     |      |
|---|-----|------|
| n | 90  | 0.2  |
| b | 88  | 0.4  |
| 4 | 87  | 0.5  |
| b | 84  | 0.8  |
| 4 | 92  | 0.0  |
| 4 | 96  | -0.4 |
| S | 102 | -1.0 |

530' W = n to E Rail on S L

S a Rail 70 2.2

550 W = E Rail on S L

n 104 -1.2

583' W

n 105 -1.3

592' W = n to E Rail on S L

n a Rail 67 2.5



X on Burt St (80)

2018

Burt

37

138 2018

1880

13' man  
Burt + Rigel

Center of Rigel

1880  
138  
2018

W curb of Rigel

S

22 180

S

06 196

24 178

06 196

26 176

08 194

S

24 178

S

03 199

15 187

13 189

10 193

02 200

N

08 194

N

03 199

E 14' of Rigel

W 14' of Rigel

N

15 187

N

04 198

18 184

05 197

23 179

08 194

S

27 175

S

20 183

36 166

15 187

32 170

15 187

S

35 167

S

13 189

PLOTTED



2018

## E curb of Rigol

S 43 15.9

47 15.5

42 16.0

b 38 16.4

34 16.8

30 17.2

n 26 17.6

## E line of Rigol

n 40 16.2

41 16.1

44 15.8

b 46 15.6

50 15.3

S 50 15.2

S 52 15.0

PLOTTED

2018

Buch 2

38

## 50 E of Rigol

S 67 13.5

61 14.1

53 14.9

b 43 15.9

36 16.6

30 17.2

n 22 18.0

## 100 E of Rigol

n 44 16.2

38 16.4

43 15.9

b 48 16.4

52 15.0

50 15.2

S 55 14.7



2018

150 E f Right

S 78 12.4

82 12.0

86 11.6

b 85 11.7

81 12.1

77 12.5

n 70 13.2

200 E f Right

n 44 16.0

47 15.5

52 15.0

b 60 14.2

72 13.0

86 11.6

S 104 9.8

PLOTTED

2018

Bucket  
39

250 E f Right

S 104 9.8

96 10.6

85 11.7

b 76 12.6

68 13.4

61 14.1

n 59 14.3

TP 1016 2418 616 14.02

300 E f Right

n 79 16.3

82 16.0

87 15.5

b 94 14.8

102 14.0

117 12.5

S 115 12.7

2018  
6.6  
14.02  
10.18  
24.18



2418

350 E of Ridge

|   |    |      |
|---|----|------|
| S | 73 | 16.9 |
|   | 73 | 16.9 |
|   | 73 | 16.9 |
| b | 63 | 17.9 |
|   | 63 | 17.9 |
|   | 62 | 18.0 |
| n | 54 | 18.8 |

400 E of Ridge

|   |    |      |
|---|----|------|
| n | 40 | 20.2 |
|   | 41 | 20.1 |
|   | 39 | 20.3 |
| b | 36 | 20.6 |
|   | 40 | 20.2 |
|   | 38 | 20.4 |
| S | 30 | 21.2 |

PLOTTED

2418

Brid  
40

450 E of Ridge

|   |    |      |
|---|----|------|
| S | 35 | 20.7 |
|   | 45 | 19.7 |
|   | 46 | 19.6 |
| b | 40 | 20.2 |
|   | 41 | 20.1 |
|   | 36 | 20.6 |
| n | 32 | 21.0 |

500 E of Ridge

|   |    |      |
|---|----|------|
| n | 35 | 18.7 |
|   | 60 | 18.2 |
|   | 58 | 18.4 |
| b | 62 | 18.0 |
|   | 59 | 18.3 |
|   | 58 | 18.4 |
| S | 53 | 18.9 |



2418

550 E of Ridge

|   |    |      |
|---|----|------|
| S | 91 | 15.1 |
|   | 95 | 14.7 |
|   | 90 | 15.2 |
| b | 88 | 15.4 |
|   | 92 | 15.0 |
|   | 89 | 15.3 |
| n | 75 | 14.7 |

TP 015  $\frac{1603}{1603}$  8.30 15.84

600 E = W of Siva (60')

|   |    |      |
|---|----|------|
| n | 18 | 14.2 |
|   | 26 | 13.4 |
|   | 30 | 13.0 |
| b | 35 | 12.5 |
|   | 43 | 11.7 |
|   | 50 | 11.0 |
| S | 51 | 10.9 |

PLOTTED

1603

W of Siva

|   |    |      |
|---|----|------|
| S | 60 | 10.0 |
|   | 55 | 10.6 |
|   | 47 | 11.3 |
| b | 40 | 12.0 |
|   | 38 | 12.2 |
|   | 32 | 12.8 |
| n | 23 | 13.7 |

W 1/4 of Siva

|    |     |       |
|----|-----|-------|
| n  | 29  | 13.1  |
|    | 37  | 12.3  |
|    | 42  | 11.8  |
| b  | 45  | 11.5  |
|    | 50  | 11.0  |
|    | 59  | 10.1  |
| S  | 64  | 9.6   |
| BM | 504 | 11.00 |

Binet

41

2418  
8.30  
15.84  
16.00

13<sup>th</sup> Area  
Sivat Binet



1603

Center of Siva

S 67 9.3

60 10.0

56 10.4

b 48 11.2

41 11.9

41 11.9

n 32 12.8

E 1/4 of Siva

n 34 12.6

42 11.8

48 11.2

b 53 10.7

62 9.8

68 9.2

S 70 9.0

PLOTTED

1603

Bunch  
42

E 1/4 of Siva

S 78 8.2

73 8.7

68 9.2

b 58 10.2

50 11.0

40 12.0

n 37 12.3

E line of Siva

n 41 11.9

49 11.1

59 10.1

b 70 9.0

77 8.3

84 7.6

S 85 7.5



1603

50 E of Siva

S 126 3.4

110 5.0

97 6.3

b 81 7.9

68 9.2

60 10.0

n 56 10.4

100 E of Siva

n 79 8.1

73 8.7

80 8.0

b 91 6.9

103 5.7

118 4.2

S 126 3.4

PLOTTED

1603

150 E of Siva

S 123 3.7

120 3.7

119 4.1

b 106 5.4

101 5.9

105 5.5

n 112 4.8

200 E of Siva

n 112 4.8

113 4.7

114 4.6

b 115 4.5

116 4.4

116 4.4

S 117 4.3

TP 350 818  
828 1135 4.68

Buck

43

1603  
1235  
4.88  
350  
8.48



838

818

215' E of Siva

|   |    |      |
|---|----|------|
| S | 91 | -0.9 |
|   | 83 | -0.1 |
|   | 76 | 0.6  |
| b | 78 | 0.9  |
|   | 78 | 0.4  |
|   | 79 | 0.3  |
| n | 83 | -0.1 |

250' E of Siva

|   |    |     |
|---|----|-----|
| n | 40 | 4.3 |
|   | 43 | 3.9 |
|   | 57 | 3.1 |
| b | 55 | 2.7 |
|   | 60 | 2.2 |
|   | 61 | 2.1 |
| S | 63 | 1.9 |

260' E

PLOTTED

|   |    |     |
|---|----|-----|
| S | 40 | 4.3 |
|---|----|-----|

838

818

Burch

44

300' E of Siva

|   |    |     |
|---|----|-----|
| S | 37 | 4.5 |
|   | 36 | 4.6 |
|   | 38 | 4.6 |
| b | 36 | 4.6 |
|   | 36 | 4.6 |
|   | 37 | 4.5 |
| n | 35 | 4.7 |

350' E of Siva

|   |    |     |
|---|----|-----|
| n | 42 | 4.0 |
|   | 43 | 3.9 |
|   | 44 | 3.8 |
| b | 44 | 3.8 |
|   | 44 | 3.8 |
|   | 44 | 3.8 |
| S | 44 | 3.8 |

394' E on h = Pueblo

|   |    |  |
|---|----|--|
| n | 44 |  |
|---|----|--|



8.38

8.18

400 E of Sira

S 46 3.4

48 3.4

47 3.5

b 46 3.4

45 3.7

45 3.7

n 45 3.7

450 E of Sira

n 45 3.7

46 3.6

46 3.6

b 46 3.6

46 3.6

47 3.5

S 44 3.8

4555 E on S = Purple line

S 44 3.8

PLOTTED

8.38

8.18

Birch  
45

500 E of Sira

S 48 3.4

47 3.5

45 3.7

b 46 3.6

44 3.8

42 4.0

n 40 4.2

530 E of Sira

n 45 3.7

45 3.7

45 3.7

b 47 3.5

45 3.7

46 3.6

S 44 3.8

535 E on S = Purple line

S 45 3.7



838  
818

600 E - W of Thurst (60)

S 52 3.0

49 3.3

48 3.4

b 45 3.7

45 3.7

44 3.8

n 44 3.8

W of Thurst

n 44 3.8

44 3.8

44 3.8

b 46 3.6

48 3.4

50 3.2

S 53 2.9

PLOTTED

838  
818

Buck  
46

W 4 of Thurst

S 53 2.9

51 3.1

49 3.3

b 48 3.4

47 3.5

45 3.7

n 44 3.8

Center of Thurst

n 45 3.7

44 3.8

47 3.5

b 48 3.4

50 3.2

53 2.9

S 53 2.9

center + 3' = possible site on W

n 45 3.8



838  
818

E 1/4 of Thurst

|   |    |     |
|---|----|-----|
| S | 53 | 2.9 |
|   | 53 | 2.9 |
|   | 53 | 2.9 |
| l | 50 | 3.2 |
|   | 48 | 3.4 |
|   | 48 | 3.4 |
| n | 47 | 3.5 |

E 1/4 of Thurst

|   |    |     |
|---|----|-----|
| n | 49 | 3.3 |
|   | 48 | 3.4 |
|   | 49 | 3.3 |
| l | 51 | 3.1 |
|   | 54 | 2.8 |
|   | 53 | 2.9 |
| n | 53 | 2.9 |

PLOTTED

838  
818

Birch 47

E 1/4 of Thurst

|   |    |     |
|---|----|-----|
| S | 53 | 2.9 |
|   | 53 | 2.9 |
|   | 52 | 3.0 |
| l | 52 | 3.0 |
|   | 50 | 3.2 |
|   | 50 | 3.2 |
| n | 50 | 3.2 |

818  
520  
298  
204  
1202

7p 904 1202 520 298 13' min Thurst + Birch

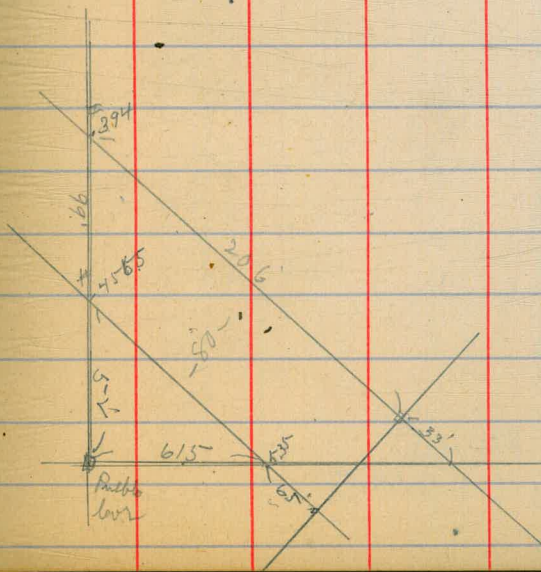



1202

50' E of 7hr 15

S 92 2.8

92 2.8

90 3.0

b 87 3.3

88 3.3

88 3.3

n 90 3.0

100 E of 7hr

n 85 3.5

87 3.3

86 3.4

b 88 3.3

88 3.3

90 3.0

S 88 3.3

PLOTTED

1202

Birch 48

150 E of 7hr

S 68 5.2

78 4.2

84 3.4

b 85 3.5

86 3.4

83 3.7

n 83 3.7

200 E of 7hr

n 84 3.6

81 3.9

83 3.7

b 86 3.4

75 4.5

60 6.0

S 33 8.7



Nov

250 E of Thor

S 07 11.3

40 8.0

66 5.6

b 82 3.8

89 3.1

87 3.3

n 83 3.7

300 E of Thor

n 83 3.7

82 3.8

86 3.4

b 88 3.3

92 2.8

93 2.7

S 80 4.0

PLOTTED

Nov

Burst 49

350 E of Thor

S 95 2.5

93 2.7

90 3.0

b 88 3.3

83 3.7

80 4.0

n 78 4.2

400 E of Thor

n 73 10.7

10 11.0

44 7.6

b 24 9.6

40 8.0

65 5.5

S 83 3.7

JP 121 17.45 668 5.34

Nov  
668  
5.34  
1211  
17.45



1745

450 E of 7hr

|   |     |      |
|---|-----|------|
| S | 105 | 7.0  |
|   | 88  | 8.7  |
|   | 70  | 10.5 |
| b | 59  | 11.6 |
|   | 53  | 12.0 |
|   | 55  | 12.0 |
| n | 58  | 11.7 |

500 E of 7hr

|   |    |      |
|---|----|------|
| n | 40 | 13.5 |
|   | 36 | 13.9 |
|   | 41 | 13.4 |
| b | 46 | 12.9 |
|   | 55 | 12.0 |
|   | 64 | 11.1 |
| S | 79 | 9.6  |

PLOTTED

1745

Buck  
50

550 E of 7hr

|   |    |      |
|---|----|------|
| S | 73 | 10.3 |
|   | 63 | 11.3 |
|   | 47 | 12.8 |
| b | 41 | 13.4 |
|   | 36 | 13.9 |
|   | 29 | 14.6 |
| n | 16 | 15.9 |

600 E = W of Ana St (60)

|   |    |      |
|---|----|------|
| n | 25 | 15.0 |
|   | 27 | 14.8 |
|   | 29 | 14.6 |
| b | 29 | 14.6 |
|   | 30 | 14.5 |
|   | 30 | 14.5 |
| S | 42 | 13.3 |
| S | 42 |      |



1745

W limb of Ana st

|   |                 |      |
|---|-----------------|------|
| S | 42              | 13.3 |
|   | 34              | 14.1 |
|   | 29              | 14.6 |
| b | 26              | 14.9 |
|   | 24              | 15.3 |
|   | 22              | 15.3 |
| n | 22              | 15.3 |
|   | W 1/4 of Ana st |      |
| n | 18              | 15.7 |
|   | 19              | 15.6 |
|   | 19              | 15.6 |
|   | 20              | 15.5 |
| b | 27              | 14.8 |
|   | 30              | 14.5 |
|   | 36              | 13.9 |
| S | 42              | 13.3 |

PLOTTED

1745

center of Ana st.

|   |              |      |
|---|--------------|------|
| S | 41           | 13.4 |
|   | 32           | 14.3 |
|   | 26           | 14.9 |
| b | 19           | 15.6 |
|   | 16           | 15.9 |
|   | 15           | 16.0 |
| n | 15           | 16.0 |
|   | E 1/4 of Ana |      |
| n | 10           | 16.5 |
|   | 08           | 16.7 |
|   | 07           | 16.8 |
| b | 13           | 16.2 |
|   | 21           | 15.4 |
|   | 30           | 14.5 |
| S | 40           | 13.8 |

Buck

51



1745

2192

Book

52

|   | E | Cent of | Area |
|---|---|---------|------|
| S |   | 39      | 13.6 |
|   |   | 29      | 14.6 |
|   |   | 17      | 15.8 |
| b |   | 05      | 17.0 |
|   |   | 03      | 17.2 |
|   |   | 02      | 17.3 |
| n |   | 02      | 17.3 |

TP 447 2192 00 1745

E Sin of Area

|   |  |    |      |
|---|--|----|------|
| n |  | 38 | 18.1 |
|   |  | 34 | 18.5 |
|   |  | 42 | 17.7 |
| b |  | 44 | 17.5 |
|   |  | 57 | 16.8 |
|   |  | 66 | 15.3 |
| S |  | 80 | 13.9 |

|   | S | E of | Area |
|---|---|------|------|
|   |   | 63   | 15.6 |
|   |   | 57   | 16.2 |
|   |   | 53   | 16.6 |
| b |   | 50   | 16.9 |
|   |   | 50   | 16.9 |
|   |   | 47   | 17.2 |
| n |   | 45   | 17.4 |

100 E of Area

|   |  |    |      |
|---|--|----|------|
| n |  | 42 | 17.7 |
|   |  | 47 | 17.2 |
|   |  | 50 | 16.9 |
| b |  | 56 | 16.3 |
|   |  | 63 | 15.6 |
|   |  | 70 | 14.9 |
| S |  | 76 | 14.3 |

1745  
407  
2192

PLOTTED



21.92

|   | 150 | E f | Area |
|---|-----|-----|------|
| S |     | 75  | 14.4 |
|   |     | 65  | 15.4 |
|   |     | 64  | 15.5 |
| b |     | 64  | 15.5 |
|   |     | 58  | 16.1 |
|   |     | 50  | 16.9 |
| n |     | 47  | 17.7 |
|   | 200 | E f | Area |
| n |     | 45  | 17.4 |
|   |     | 52  | 16.7 |
|   |     | 56  | 16.3 |
| b |     | 58  | 16.1 |
|   |     | 60  | 15.9 |
|   |     | 65  | 15.4 |
| S |     | 68  | 15.1 |

PLOTTED

21.92

Burch

58

|   | 250 | E f | Area |
|---|-----|-----|------|
| S |     | 65  | 15.4 |
|   |     | 60  | 15.9 |
|   |     | 58  | 16.1 |
| b |     | 55  | 16.4 |
|   |     | 53  | 16.6 |
|   |     | 50  | 16.9 |
| n |     | 47  | 17.7 |
|   | 300 | E f | Area |
| n |     | 35  | 18.4 |
|   |     | 34  | 18.5 |
|   |     | 39  | 18.0 |
| b |     | 47  | 17.3 |
|   |     | 48  | 17.1 |
|   |     | 45  | 17.4 |
| S |     | 43  | 17.6 |



21.92

350 E of Anna

|     |           |     |
|-----|-----------|-----|
| S   | 63        | 156 |
|     | 61        | 158 |
|     | 52        | 167 |
| b   | 46        | 173 |
|     | 40        | 179 |
|     | 37        | 182 |
| n   | 32        | 187 |
| 400 | E of Anna |     |
| n   | 37        | 182 |
|     | 45        | 174 |
|     | 53        | 166 |
| b   | 48        | 171 |
|     | 41        | 178 |
|     | 35        | 184 |
| S   | 30        | 189 |

PLOTTED

21.92

Birch

54

450 E of Anna

|     |           |      |
|-----|-----------|------|
| S   | 13        | 206  |
|     | 10        | 209  |
|     | 15        | 204  |
| b   | 18        | 201  |
|     | 27        | 192  |
|     | 34        | 185  |
| n   | 34        | 185  |
| TP  | 744       | 2882 |
|     | 054       | 2138 |
| 500 | E of Anna |      |
| n   | 90        | 198  |
|     | 84        | 204  |
|     | 79        | 209  |
| b   | 79        | 209  |
|     | 82        | 206  |
|     | 83        | 205  |
| S   | 87        | 201  |

21.92  
~~21.38~~  
 21.38  
 44  
 28.82



2882

550 E of Puna

|   |    |      |
|---|----|------|
| S | 79 | 20.9 |
|   | 77 | 21.1 |
|   | 73 | 21.5 |
| b | 69 | 21.9 |
|   | 66 | 22.2 |
|   | 69 | 21.9 |
| n | 62 | 22.6 |

600 E = W S of Vesta St (60)

|   |    |      |
|---|----|------|
| n | 60 | 22.8 |
|   | 62 | 22.6 |
|   | 64 | 22.4 |
| b | 66 | 22.2 |
|   | 71 | 21.7 |
|   | 71 | 21.7 |
| S | 74 | 21.4 |

PLOTTED

2882

Buel

55

W curb of Vesta

|   |    |      |
|---|----|------|
| S | 73 | 21.5 |
|   | 72 | 21.6 |
|   | 68 | 22.0 |
| b | 63 | 22.5 |
|   | 64 | 22.4 |
|   | 62 | 22.6 |
| n | 58 | 23.0 |

W 1/4 of Vesta

|    |     |       |
|----|-----|-------|
| n  | 57  | 23.1  |
|    | 61  | 22.7  |
|    | 63  | 22.5  |
| b  | 66  | 22.2  |
|    | 68  | 22.0  |
|    | 70  | 21.8  |
| S  | 72  | 21.6  |
| Bm | 680 | 22.02 |

15' man  
Vesta + Buel



2882

Center of Vista

|   |    |      |
|---|----|------|
| S | 70 | 21.6 |
|   | 71 | 21.7 |
|   | 69 | 21.9 |
| b | 68 | 22.0 |
|   | 65 | 22.3 |
|   | 64 | 22.4 |
| n | 60 | 22.8 |

E 1/4 of Vista

|   |    |      |
|---|----|------|
| n | 60 | 22.8 |
|   | 63 | 22.5 |
|   | 65 | 22.3 |
| b | 66 | 22.2 |
|   | 68 | 22.0 |
|   | 69 | 21.9 |
| S | 71 | 21.7 |

PLOTTED

2882

Buck  
56

E curb of Vista

|   |    |      |
|---|----|------|
| S | 68 | 22.0 |
|   | 63 | 22.5 |
|   | 63 | 22.5 |
| b | 59 | 22.9 |
|   | 59 | 22.9 |
|   | 58 | 23.0 |
| n | 55 | 23.3 |

E Side Vista

|   |    |      |
|---|----|------|
| n | 55 | 23.3 |
|   | 56 | 23.2 |
|   | 59 | 22.9 |
| b | 60 | 22.8 |
|   | 61 | 22.7 |
|   | 63 | 22.5 |
| S | 65 | 22.3 |



50' E of Vesta

|   |    |     |
|---|----|-----|
| S | 52 | 236 |
|   | 50 | 238 |
|   | 49 | 239 |
| b | 50 | 238 |
| c | 50 | 238 |
|   | 49 | 239 |
| n | 46 | 242 |

100' E of Vesta

|   |    |     |
|---|----|-----|
| n | 27 | 261 |
|   | 37 | 251 |
|   | 39 | 249 |
| b | 40 | 248 |
|   | 41 | 247 |
|   | 43 | 245 |
| S | 44 | 244 |

PLOTTED

150' E of Vesta

|   |    |     |
|---|----|-----|
| S | 33 | 255 |
|   | 33 | 255 |
|   | 31 | 257 |
| b | 28 | 240 |
|   | 26 | 263 |
|   | 17 | 271 |
| n | 10 | 278 |

TP 645 3463 664 2818

200' E of Vesta

|   |    |     |
|---|----|-----|
| n | 47 | 299 |
|   | 53 | 293 |
|   | 67 | 279 |
| b | 79 | 267 |
|   | 84 | 263 |
|   | 87 | 259 |
| S | 89 | 257 |

2882  
2818  
664  
3463



3463

|   | 250 | E 8 | Wedge |      |
|---|-----|-----|-------|------|
| S |     |     | 80    | 26.6 |
|   |     |     | 81    | 26.5 |
|   |     |     | 77    | 26.9 |
| b |     |     | 68    | 27.8 |
|   |     |     | 57    | 28.9 |
|   |     |     | 48    | 29.8 |
| n |     |     | 40    | 30.6 |
|   | 300 | E 8 | Wedge |      |
| n |     |     | 40    | 30.6 |
|   |     |     | 48    | 29.8 |
|   |     |     | 50    | 29.6 |
| b |     |     | 55    | 29.1 |
|   |     |     | 65    | 28.1 |
|   |     |     | 73    | 27.3 |
| S |     |     | 73    | 27.3 |

PLOTTED

3463

Buck

58

|   | 350 | E 8 | Wedge |      |
|---|-----|-----|-------|------|
| S |     |     | 67    | 27.9 |
|   |     |     | 65    | 28.1 |
|   |     |     | 60    | 28.6 |
| b |     |     | 52    | 29.4 |
|   |     |     | 44    | 30.2 |
|   |     |     | 44    | 30.2 |
| n |     |     | 40    | 30.6 |
|   | 400 | E 8 | Wedge |      |
| n |     |     | 33    | 31.3 |
|   |     |     | 41    | 30.5 |
|   |     |     | 44    | 30.2 |
| b |     |     | 52    | 29.4 |
|   |     |     | 55    | 29.1 |
|   |     |     | 57    | 28.9 |
| S |     |     | 57    | 28.9 |



3463

450 E of Vista

|   |    |     |
|---|----|-----|
| S | 48 | 298 |
|   | 44 | 303 |
|   | 42 | 304 |
| b | 35 | 311 |
|   | 30 | 316 |
|   | 35 | 311 |
| n | 30 | 316 |

500 E of Vista

|   |    |     |
|---|----|-----|
| n | 20 | 326 |
|   | 21 | 325 |
|   | 20 | 326 |
| b | 26 | 320 |
|   | 36 | 310 |
|   | 38 | 308 |
| S | 44 | 302 |

PLOTTED

3463

Buck

59

550 E of Vista

|    |     |          |
|----|-----|----------|
| S  | 35  | 311      |
|    | 25  | 321      |
|    | 18  | 328      |
| b  | 13  | 333      |
|    | 14  | 332      |
|    | 07  | 339      |
| n  | 02  | 344      |
| TP | 220 | 3557     |
|    | 600 | E = W of |
| n  | 15  | 341      |
|    | 13  | 343      |
|    | 18  | 338      |
| b  | 21  | 335      |
|    | 24  | 332      |
|    | 25  | 331      |
| S  | 30  | 326      |

3463  
126  
3337  
220  
3557

135 mms  
39 + Buck

(60)



3557

W bank of 397

S 28 328

25 331

22 334

6 20 336

14 342

10 346

n 16 340

W 1/4 of 397

n 14 343

15 341

15 341

6 18 338

20 336

25 331

S 23 333

PLOTTED

3557

Busch  
60

Center of 397

S 20 336

19 337

18 338

6 17 339

18 338

17 339

n 10 346

E 1/4 of 39

n 00 356

11 345

18 338

6 18 338

19 337

17 339

S 18 338



3557

|   | E | Curve | b  | 39  |
|---|---|-------|----|-----|
| S |   |       | 17 | 339 |
|   |   |       | 15 | 341 |
|   |   |       | 15 | 341 |
| b |   |       | 17 | 339 |
|   |   |       | 16 | 340 |
|   |   |       | 07 | 349 |
| n |   |       | 00 | 356 |
|   | E | Line  | 8  | 39  |
| n |   |       | 02 | 354 |
|   |   |       | 12 | 344 |
|   |   |       | 16 | 340 |
| b |   |       | 18 | 338 |
|   |   |       | 15 | 341 |
|   |   |       | 14 | 342 |
| S |   |       | 16 | 340 |

PLOTTED

3557

Binet

61

|   | 50  | E | 8  | 39  |
|---|-----|---|----|-----|
| S |     |   | 20 | 336 |
|   |     |   | 19 | 337 |
|   |     |   | 21 | 335 |
| b |     |   | 22 | 334 |
|   |     |   | 18 | 338 |
|   |     |   | 17 | 339 |
| n |     |   | 16 | 340 |
|   | 100 | E | 8  | 39  |
| n |     |   | 20 | 336 |
|   |     |   | 21 | 335 |
|   |     |   | 26 | 330 |
| b |     |   | 34 | 329 |
|   |     |   | 40 | 316 |
|   |     |   | 42 | 314 |
| S |     |   | 45 | 311 |



3557

|   |     |   |    |                 |
|---|-----|---|----|-----------------|
|   | 150 | E | 4  | 39              |
| S |     |   | 48 | 30.8            |
|   |     |   | 40 | 31.6            |
|   |     |   | 34 | 32.2            |
| b |     |   | 31 | 32.5            |
|   |     |   | 30 | 32.6            |
|   |     |   | 26 | 33.0            |
| n |     |   | 23 | 33.3            |
|   | 200 | E | 9  | 39 <sup>2</sup> |
| n |     |   | 14 | 34.2            |
|   |     |   | 20 | 33.6            |
|   |     |   | 24 | 33.2            |
| b |     |   | 30 | 32.6            |
|   |     |   | 38 | 31.8            |
|   |     |   | 42 | 31.4            |
| S |     |   | 44 | 31.2            |

PLOTTED

3557

Bird

62

|   |     |                     |    |      |
|---|-----|---------------------|----|------|
|   | 250 | E                   | 7  | 39.2 |
| S |     |                     | 36 | 32.0 |
|   |     |                     | 36 | 32.0 |
|   |     |                     | 38 | 31.8 |
| b |     |                     | 35 | 32.1 |
|   |     |                     | 32 | 32.4 |
|   |     |                     | 28 | 32.8 |
| n |     |                     | 21 | 33.5 |
|   | 270 | E = Prediction on n |    |      |
| n |     |                     | 26 | 33.0 |
|   |     |                     | 28 | 32.8 |
|   |     |                     | 28 | 32.8 |
| b |     |                     | 26 | 33.0 |
|   |     |                     | 24 | 33.2 |
|   |     |                     | 25 | 33.1 |
| S |     |                     | 27 | 32.9 |

3557  
 268  
 32.89  
 310  
 35.99

310    35.99    268    32.89



300' E of 39A

S 30 33.0

357'  
357' E = Pueblo line on S

S 71 28.9

(103') Diagonal on Pueblo line 3599  
34.67

S 71 28.9

center 26 33.4

n 30 33.0

check 132 34.67 14V Bm 702 post

PLOTTED



1/2  
3/ Taylor Levels for Profile Dallingia St (100)  
City 250' E of Yama to Boundary

32.13  
32.13

64

|            | 985  | 2229      | 1244 | Bm - Busby | 400   | E of Yama                       |      |      |
|------------|------|-----------|------|------------|-------|---------------------------------|------|------|
| 180'       |      |           |      |            |       |                                 | 77   | 24.4 |
| n          |      |           | 138  | 8.5        | -1244 | b track                         | 11.2 | 20.9 |
| b track    |      |           | 58   | 16.5       | 985   | n                               | 30   | 29.1 |
| S          |      |           | 164  | 5.9        | 2229  |                                 |      |      |
|            |      |           |      |            | 19.06 | 450' E = Mid of Osborne St (77) |      |      |
|            | 300  | E of Yama |      |            | 13.22 |                                 | 27   | 29.4 |
| S          |      |           | 11.0 | 11.3       | 32.13 | 450' E                          |      |      |
| b track    |      |           | 4.3  | 18.0       |       |                                 | 32   | 28.9 |
| n          |      |           | 6.0  | 16.3       |       | b track                         | 95   | 22.6 |
| 7p         | 1307 | 32.13     | 323  | 19.06      |       | S                               | 4.0  | 28.1 |
|            | 325  | E         | 7.6  | 24.5       |       |                                 |      |      |
| n          |      |           |      |            |       | 500' E of Yama                  | 27   | 29.9 |
|            | 350  | E of Yama |      |            |       |                                 | 8.3  | 23.8 |
| n          |      |           | 4.7  | 27.4       |       |                                 | 37   | 28.4 |
| bent track |      |           | 12.6 | 19.5       |       | 500' E = E of Osborne St        |      |      |
| S          |      |           | 9.8  | 22.3       |       |                                 | 30   | 29.1 |

**PLOTTED**



3213  
3213

3081

65

Boundary line but of st

550' E of Tama = 49.22 E above on n

n 2

6.0 24.8

n 3.2 28.9

b 7.6 24.5

check  
End of walk

4.5 26.3

s 3.6 28.5

576' E on S of angle  
595' E on n do

s 4.3 27.8

Track 7.5 24.6

b 5.0 27.1

n 2.5 29.6

TP 0.68 3081 2.00 3013

1844 E of angle = P 2

n 1.5 29.3

60' E of angle on n

n on bank but st good (20) 28.8  
(5.7) 25.1

50' E of angle on s

s 3.3 27.5

69.9 E of angle on s = Boundary line

PLOTTED

s 4.0 26.8

PLOTTED

cut on track 6.4 24.4



L  
19  
14

X loc of 39it st (60)  
Main st to Acacia

41.68

39.2

66

|   | 255 | 41.68 | 3913   | 13' m m<br>39it +<br>acacia | 100' | S of | Acacia | 3913<br>232<br>41.68 |
|---|-----|-------|--------|-----------------------------|------|------|--------|----------------------|
|   |     |       |        |                             |      |      | 38     | 37.9                 |
| E |     |       | 20     | 39.7                        |      |      | 40     | 37.7                 |
|   |     |       | 21     | 39.6                        |      |      | 45     | 37.2                 |
|   |     |       | 23     | 39.4                        |      |      | 47     | 37.0                 |
| b |     |       | 26     | 39.1                        |      |      | 48     | 36.9                 |
|   |     |       | 30     | 38.7                        |      |      | 49     | 36.8                 |
|   |     |       | 31     | 38.6                        |      |      | 49     | 36.8                 |
| W |     |       | 32     | 38.5                        |      | 150' | S of   | Acacia               |
|   | 50  | S of  | Acacia |                             |      |      | 67     | 35.0                 |
| W |     |       | 38     | 37.9                        |      |      | 64     | 35.3                 |
|   |     |       | 35     | 38.2                        |      |      | 60     | 35.7                 |
|   |     |       | 32     | 38.5                        |      |      | 50     | 36.7                 |
| b |     |       | 29     | 38.8                        |      |      | 45     | 37.2                 |
|   |     |       | 30     | 38.7                        |      |      | 45     | 37.2                 |
|   |     |       | 30     | 38.7                        |      |      | 48     | 36.9                 |
| E |     |       | 29     | 38.8                        |      |      |        |                      |

PLOTTED



41.68

200' E of Acacia

|   |     |             |
|---|-----|-------------|
| E | 46  | 37.1        |
|   | 52  | 36.5        |
|   | 58  | 35.9        |
| b | 60  | 35.7        |
|   | 63  | 35.4        |
|   | 69  | 34.8        |
| W | 73  | 34.4        |
|   | 750 | 8 ft Acacia |
| W | 65  | 35.2        |
|   | 70  | 34.7        |
|   | 70  | 34.7        |
| b | 71  | 34.6        |
|   | 72  | 34.5        |
| b | 72  | 34.5        |
| E | 73  | 34.4        |

PLOTTED

41.68

300' S = 249' Birch V (80')

|    |     |                    |
|----|-----|--------------------|
| E  | 63  | 35.4               |
|    | 60  | 35.7               |
|    | 60  | 35.7               |
| b  | 69  | 34.8               |
|    | 74  | 34.3               |
|    | 77  | 34.0               |
| W  | 76  | 34.1               |
| TP | 180 | 35.17              |
|    | 831 | 33.37              |
|    |     | 13' min 394' Birch |
| W  | 26  | 32.6               |
|    | 21  | 33.1               |
|    | 17  | 33.5               |
| b  | 16  | 33.6               |
|    | 15  | 33.7               |
|    | 13  | 33.9               |
| E  | 12  | 34.0               |

39.7

67

41.25  
~~838~~  
 33.37  
 180  
 35.17



3517

|   | 50'  | Sq   | Binch | W    |
|---|------|------|-------|------|
| E |      |      | 34    | 31.8 |
|   |      |      | 35    | 31.7 |
|   |      |      | 39    | 31.3 |
| b |      |      | 40    | 31.3 |
|   |      |      | 40    | 31.3 |
|   |      |      | 47    | 30.5 |
| W |      |      | 54    | 29.8 |
|   | 100' | S of | Binch |      |
| W |      |      | 68    | 28.4 |
|   |      |      | 70    | 28.2 |
|   |      |      | 70    | 28.2 |
| b |      |      | 68    | 28.4 |
|   |      |      | 66    | 28.6 |
|   |      |      | 66    | 28.6 |
| E |      |      | 66    | 28.6 |

PLOTTED

3517

3912  
68

|   | 150' | Sq   | Binch | W    |
|---|------|------|-------|------|
| E |      |      | 82    | 27.0 |
|   |      |      | 85    | 26.7 |
|   |      |      | 83    | 26.9 |
| b |      |      | 82    | 27.0 |
|   |      |      | 83    | 26.9 |
|   |      |      | 82    | 27.0 |
| W |      |      | 83    | 26.9 |
|   | 200' | S of | Binch |      |
| W |      |      | 106   | 24.6 |
|   |      |      | 105   | 24.7 |
|   |      |      | 106   | 24.6 |
| b |      |      | 108   | 24.4 |
|   |      |      | 106   | 24.6 |
|   |      |      | 105   | 24.7 |
| E |      |      | 102   | 25.0 |



3517

2321

392

69

250 S of Bird

S line of bottomwood

E 115 237

E 53 17.9

3517

1206

23.11

10

2321

115 237

47 18.5

115 237

40 19.2

b 114 238

b 34 19.8

114 238

25 20.7

114 238

19 21.3

W 113 239

W 16 21.5

TP 010 2321 1206 2311

Bm 155 21.66

131 m

394 bottom

300 S of N 2 of bottomwood (80)

50 S of bottomwood

W 01 23.1

W 31 20.1

01 23.1

43 18.9

02 23.0

52 18.0

b 03 22.9

b 57 17.5

07 22.5

63 16.9

W 1.0 22.2

68 16.4

E 1.1 22.1

E 73 15.9

PLOTTED



2321

|   | 100 | S of | Ballinwood |     |
|---|-----|------|------------|-----|
| E |     |      | 76         | 156 |
|   |     |      | 85         | 147 |
|   |     |      | 86         | 146 |
| S |     |      | 78         | 154 |
|   |     |      | 70         | 162 |
|   |     |      | 63         | 169 |
| W |     |      | 50         | 182 |
|   | 150 | S of | Ballinwood |     |
| W |     |      | 55         | 177 |
|   |     |      | 72         | 160 |
|   |     |      | 83         | 149 |
| S |     |      | 92         | 140 |
|   |     |      | 100        | 133 |
|   |     |      | 107        | 125 |
| E |     |      | 104        | 128 |

PLOTTED

2321

3907

10

|    | 200 | S of | Ballinwood |      |
|----|-----|------|------------|------|
| E  |     |      | 120        | 113  |
|    |     |      | 111        | 121  |
|    |     |      | 102        | 130  |
| S  |     |      | 95         | 137  |
|    |     |      | 87         | 145  |
|    |     |      | 75         | 157  |
| W  |     |      | 59         | 173  |
|    | 250 | S of | Ballinwood |      |
| W  |     |      | 58         | 174  |
|    |     |      | 60         | 172  |
|    |     |      | 60         | 172  |
| S  |     |      | 66         | 166  |
|    |     |      | 76         | 156  |
|    |     |      | 90         | 142  |
| E  |     |      | 105        | 127  |
| TP | 636 | 187  | 1136       | 1185 |

2321  
 1136  
 1185  
 689  
 1517



300' S = N of Dalbergia (100')

|   |    |      |
|---|----|------|
| E | 69 | 11.8 |
|   | 60 | 12.7 |
|   | 49 | 13.8 |
| b | 38 | 14.9 |
|   | 28 | 15.9 |
|   | 21 | 16.6 |
| W | 18 | 16.9 |

Lantern

|             |    |      |
|-------------|----|------|
| W on S Rail | 55 | 13.2 |
| E on S Rail | 68 | 11.9 |

S line of Dalbergia

|   |    |      |
|---|----|------|
| E | 75 | 11.2 |
|   | 69 | 11.8 |
|   | 62 | 12.5 |
| b | 55 | 13.2 |
|   | 50 | 13.7 |
|   | 43 | 14.4 |
| W | 35 | 15.2 |

PLOTTED

50' S of Dalbergia

|   |    |      |
|---|----|------|
| W | 40 | 14.7 |
|   | 41 | 14.6 |
|   | 46 | 14.1 |
| b | 51 | 13.6 |
|   | 59 | 12.8 |
|   | 72 | 11.5 |
| E | 76 | 11.1 |

100' S of Dalbergia

|   |    |      |
|---|----|------|
| E | 50 | 13.7 |
|   | 46 | 14.1 |
|   | 45 | 14.2 |
| b | 44 | 14.3 |
|   | 44 | 14.3 |
|   | 41 | 14.6 |
| W | 40 | 14.7 |



1871

150 S of Dalbergia

|   |    |      |
|---|----|------|
| N | 33 | 15.4 |
|   | 34 | 15.3 |
|   | 34 | 15.3 |
| b | 35 | 15.3 |
|   | 38 | 14.9 |
|   | 41 | 14.6 |
| E | 43 | 14.4 |

200 S of Dalbergia

|   |    |      |
|---|----|------|
| E | 34 | 15.3 |
|   | 33 | 15.4 |
|   | 31 | 15.6 |
| b | 27 | 16.0 |
|   | 25 | 16.3 |
|   | 22 | 16.5 |
| W | 20 | 16.7 |

PLOTTED

1871

392

72

250 S of Dalbergia

|   |    |      |
|---|----|------|
| W | 43 | 14.4 |
|   | 41 | 14.6 |
|   | 40 | 14.7 |
| b | 42 | 14.5 |
|   | 40 | 14.7 |
|   | 40 | 14.7 |
| E | 39 | 14.8 |

300 S of Dalbergia = rd main

|    |     |       |
|----|-----|-------|
| E  | 63  | 13.4  |
|    | 60  | 13.7  |
|    | 56  | 13.1  |
| b  | 54  | 13.3  |
|    | 64  | 13.3  |
|    | 59  | 13.8  |
| W  | 55  | 13.2  |
| Bm | 665 | 12.06 |

PLOTTED

new Bench SE  
39 + main1871  
6.65  
12.06



1/19/14  
 X sec of Vista St (60')  
 Taylor Main St to acacia  
 July

32.75

Vista

78

|   | 450 | 3275 | 2825   | SW of Vista<br>+<br>acacia | 100 S of | Acacia | 2825<br>450<br>3275 |
|---|-----|------|--------|----------------------------|----------|--------|---------------------|
|   | S   | S of | Acacia | W                          |          | 47     | 28.1                |
| W |     |      | 45     | 28.3                       |          | 42     | 28.6                |
|   |     |      | 43     | 28.5                       |          | 38     | 29.0                |
|   |     |      | 39     | 28.9                       | b        | 39     | 28.9                |
| b |     |      | 36     | 29.2                       |          | 42     | 28.6                |
|   |     |      | 33     | 29.5                       |          | 40     | 28.8                |
|   |     |      | 31     | 29.7                       | E        | 33     | 29.5                |
| E |     |      | 26     | 30.3                       |          |        |                     |
|   | 50  | S of | acacia | E                          | 150 S of | Acacia |                     |
|   |     |      |        |                            |          | 52     | 27.6                |
| E |     |      | 34     | 29.4                       |          | 48     | 28.0                |
|   |     |      | 36     | 29.2                       |          | 56     | 27.2                |
|   |     |      | 37     | 29.1                       | b        | 55     | 27.3                |
| b |     |      | 37     | 29.1                       |          | 65     | 26.3                |
|   |     |      | 40     | 28.8                       |          | 65     | 26.3                |
|   |     |      | 45     | 28.3                       | W        | 68     | 26.0                |
| W |     |      | 47     | 28.1                       |          |        |                     |

PLOTTED



3275

|   | 200 | S of | Acacia |
|---|-----|------|--------|
| W |     |      | 80 248 |
|   |     |      | 83 245 |
|   |     |      | 83 245 |
| b |     |      | 78 250 |
|   |     |      | 79 249 |
|   |     |      | 74 254 |
| E |     |      | 70 258 |
|   | 250 | S of | Acacia |
| E |     |      | 76 253 |
|   |     |      | 78 250 |
|   |     |      | 77 251 |
| b |     |      | 88 240 |
|   |     |      | 90 238 |
| v |     |      | 91 237 |
| W |     |      | 92 236 |

PLOTTED

3275

Nest

74

|   | 300 | S = | N of | Birch | V (80) |
|---|-----|-----|------|-------|--------|
| W |     |     |      | 97    | 231    |
|   |     |     |      | 96    | 233    |
|   |     |     |      | 96    | 233    |
| b |     |     |      | 97    | 231    |
|   |     |     |      | 100   | 228    |
|   |     |     |      | 99    | 234    |
| E |     |     |      | 94    | 234    |
|   | TP  | 412 | 26.5 | 1070  | 2203   |
|   |     |     | S    | S     | S      |
|   |     |     |      |       |        |
| E |     |     |      | 37    | 22.5   |
|   |     |     |      | 42    | 22.0   |
|   |     |     |      | 44    | 21.8   |
| b |     |     |      | 46    | 21.6   |
|   |     |     |      | 46    | 21.6   |
|   |     |     |      | 47    | 21.5   |
| W |     |     |      | 47    | 21.5   |

3275  
1070  
2203  
4/2  
26.55

13' man  
Nest Birch



26.15

|   | 50  | Sq | Birch |      |
|---|-----|----|-------|------|
| W |     |    | 53    | 20.9 |
|   |     |    | 52    | 21.0 |
|   |     |    | 50    | 21.2 |
| b |     |    | 48    | 21.4 |
|   |     |    | 48    | 21.4 |
|   |     |    | 48    | 21.4 |
| E |     |    | 42    | 22.0 |
|   | 100 | Sq | Birch |      |
| E |     |    | 46    | 21.6 |
|   |     |    | 46    | 21.6 |
|   |     |    | 47    | 21.5 |
| b |     |    | 45    | 21.7 |
|   |     |    | 43    | 21.9 |
|   |     |    | 50    | 21.3 |
| W |     |    | 56    | 20.6 |

PLOTTED

26.15

Vista

75

|   | 150 | Sq | Birch |      |
|---|-----|----|-------|------|
| W |     |    | 52    | 21.0 |
|   |     |    | 47    | 21.5 |
|   |     |    | 47    | 21.5 |
| b |     |    | 56    | 20.6 |
|   |     |    | 57    | 20.5 |
|   |     |    | 54    | 20.8 |
| E |     |    | 51    | 21.1 |
|   | 200 | Sq | Birch |      |
| E |     |    | 52    | 21.0 |
|   |     |    | 55    | 20.7 |
|   |     |    | 60    | 20.3 |
| b |     |    | 60    | 20.3 |
|   |     |    | 60    | 20.3 |
|   |     |    | 61    | 20.1 |
| W |     |    | 63    | 19.9 |



2615

250 S of Birch St

W

6.0 20.2

5.8 20.4

5.6 20.5

L

6.0 20.2

5.6 20.6

5.3 20.9

E

5.8 20.4

300 S of 2nd of bottomwood st @

E

5.6 20.6

5.5 20.7

5.5 20.7

L

5.5 20.7

6.2 20.0

6.0 20.2

W

6.3 19.9

TP

311

2258

6.8

19.7

13' m  
Nest  
bottomwood

PLOTTED

2258

S of bottomwood

W

39 18.7

37 18.9

37 18.9

L

36 19.0

34 19.2

27 19.9

E

26 20.0

50 S of bottomwood

E

35 19.1

34 19.2

40 18.6

L

42 18.4

43 18.3

43 18.3

W

44 18.2

Nest  
76

2615-  
6.8  
19.7  
3.1  
2258



2258

|   | 100 | S of | Cottonwood |
|---|-----|------|------------|
| W |     |      | 48 17.8    |
|   |     |      | 49 17.7    |
|   |     |      | 48 17.8    |
| b |     |      | 48 17.8    |
|   |     |      | 46 18.0    |
|   |     |      | 47 17.9    |
| E |     |      | 44 18.3    |
|   | 150 | S of | Cottonwood |
| E |     |      | 52 17.4    |
|   |     |      | 53 17.3    |
|   |     |      | 53 17.3    |
| b |     |      | 52 17.4    |
|   |     |      | 52 17.4    |
|   |     |      | 53 17.3    |
| W |     |      | 52 17.3    |

PLOTTED

2258

Nesta

77

|   | 200 | S of | Cottonwood |
|---|-----|------|------------|
| W |     |      | 55 17.1    |
|   |     |      | 55 17.0    |
|   |     |      | 56 17.0    |
| b |     |      | 54 17.3    |
|   |     |      | 54 17.3    |
|   |     |      | 57 16.9    |
| E |     |      | 57 16.9    |
|   | 250 | S of | Cottonwood |
| E |     |      | 67 15.9    |
|   |     |      | 67 15.9    |
|   |     |      | 67 15.9    |
| b |     |      | 67 15.9    |
|   |     |      | 67 15.9    |
|   |     |      | 67 15.9    |
| W |     |      | 67 15.9    |



2258

300 S = 2 Lg Dalbergia (100')

W 62 16.4

64 16.2

69 15.7

b 72 15.4

72 15.4

71 15.5

E 73 15.3

TP 626 2338 546 17.2

beats on Trunk A 640

W do Pair 59 17.5

E do Pair 63 17.1

S line of Dalbergia

PLOTED

2338

Nesta

78

S line of Dalbergia

E 91 14.3

89 14.5

87 14.7

87 14.7

88 14.6

86 14.8

W 86 14.8

50 S of Dalbergia

W 58 17.6

58 17.6

55 17.9

54 18.0

62 17.3

73 16.1

E 80 15.4

2258  
546  
17.2  
17.26  
23.38



2328

|   |     |      |           |      |
|---|-----|------|-----------|------|
|   | 100 | S of | Dalbergia |      |
| E |     |      | 55        | 17.9 |
|   |     |      | 55        | 17.9 |
|   |     |      | 55        | 17.9 |
| L |     |      | 53        | 18.1 |
|   |     |      | 50        | 18.4 |
|   |     |      | 43        | 19.1 |
| W |     |      | 39        | 19.5 |
|   | 130 | S of | Dalbergia |      |
| W |     |      | 57        | 18.2 |
|   |     |      | 51        | 18.3 |
|   |     |      | 45        | 18.9 |
| L |     |      | 43        | 19.1 |
|   |     |      | 44        | 19.0 |
|   |     |      | 43        | 19.1 |
| E |     |      | 40        | 19.4 |

PLOTTED

2328

Vista

79

|   |     |      |           |      |
|---|-----|------|-----------|------|
|   | 200 | S of | Dalbergia |      |
| E |     |      | 41        | 19.3 |
|   |     |      | 44        | 19.0 |
|   |     |      | 46        | 18.8 |
| L |     |      | 47        | 18.7 |
|   |     |      | 49        | 18.5 |
|   |     |      | 49        | 18.5 |
| W |     |      | 49        | 18.5 |
|   | 250 | S of | Dalbergia |      |
| W |     |      | 58        | 17.6 |
|   |     |      | 56        | 17.8 |
|   |     |      | 54        | 18.0 |
| L |     |      | 53        | 18.1 |
|   |     |      | 51        | 18.3 |
|   |     |      | 52        | 18.3 |
| E |     |      | 51        | 18.3 |



300 S = N of Mainst

|       |      |      |                            |
|-------|------|------|----------------------------|
| E     | 56   | 178  |                            |
|       | 55   | 179  | 2338<br>664<br>16.84       |
|       | 55   | 179  |                            |
| b     | 58   | 176  | 2338<br>1132<br>12.06      |
|       | 63   | 171  |                            |
|       | 67   | 167  |                            |
| N     | 69   | 165  |                            |
| Bm    | 664  | 1674 | new Benet<br>Main + 4 vata |
| Chick | 1132 | 1206 | new Benet<br>Main + 39     |

PLOTTED



1  
19  
14  
X sec of Ana St (60')  
Taylor Main to Acadia  
July

2209

Ana

31

|   | 744 | 2204 | 1460    | Bm Ana<br>Main      | 100 | n of | Main St |         |
|---|-----|------|---------|---------------------|-----|------|---------|---------|
|   |     |      |         | 1460<br>790<br>2204 |     |      |         | 69 15.1 |
| N |     |      | 73 14.7 |                     |     |      |         | 65 15.5 |
|   |     |      | 67 15.3 |                     |     |      |         | 65 15.5 |
|   |     |      | 82 13.8 |                     |     |      |         | 63 15.7 |
| L |     |      | 81 13.9 |                     |     |      |         | 61 15.9 |
|   |     |      | 75 14.5 |                     |     |      |         | 66 15.4 |
|   |     |      | 73 14.7 |                     |     |      |         | 67 15.3 |
| E |     |      | 73 14.7 |                     |     |      |         |         |
|   | 50  |      |         |                     | 150 | n of | Main St |         |
|   |     |      |         |                     |     |      |         | 66 15.4 |
| E |     |      | 74 14.6 |                     |     |      |         | 65 15.5 |
|   |     |      | 74 14.6 |                     |     |      |         | 58 16.3 |
|   |     |      | 73 14.7 |                     |     |      |         | 58 16.3 |
| L |     |      | 74 14.6 |                     |     |      |         | 58 16.3 |
|   |     |      | 73 14.7 |                     |     |      |         | 57 16.4 |
|   |     |      | 70 15.0 |                     |     |      |         | 58 16.3 |
| W |     |      | 70 15.0 |                     |     |      |         |         |

PLOTTED



2204

200 n of Main st

W 55 14.5

56 14.4

58 14.3

L 55 14.5

52 14.8

58 14.2

E 58 14.2

250 n of Main st

E 54 14.6

52 14.8

47 17.3

L 49 17.1

51 14.9

53 14.7

W 52 14.8

PLOTTED

2204

ma

82

300 n of Sal of Dalbergia (100')

W 41 17.9

44 17.6

46 17.4

46 17.4

48 17.2

46 17.4

E 43 17.7

Center N 64° 0' RR

E on Road 11 20.9

W on Road 115 20.89

Continued in Book 916 P 76

PLOTTED



1277 T P in Bridge

840 Br. H Sw better wood 1/2

4212 15' mm Bastin + 36

3468 Top of Post Ashburn + Birch

Σ 92  
3457

286  
103  
333  
349

