

GRADE

135

1880

1880

1880

Alley vs Normal Hgts ?

Our Leather Bound Engineers Note Books are carried in the following rulings:

- No. 380 LEVEL BOOK. Left and Right Hand Page the same as Left Hand Page of this Book.
- No. 382 FIELD BOOK. Left Hand Page as in this Book, Right Hand Page 4 x 4 to the inch, Center Line Red.
- No. 384 MINING TRANSIT BOOK. Left Hand Page as in this Book, Right Hand Page 8x8 to the inch, Center Line Red.
- No. 385 FIELD BOOK. Left Hand Page as in this Book, Right Hand Page 8 vertical and 4 horizontal lines to the inch, Center Line Red.

We also carry the Note Books listed above, bound in extra strong Fabri-Hide (otherwise the same quality of book), which can be furnished at a somewhat lower price.

In ordering Fabri-Hide covered books, add the letter "F" to catalog number.

THE FREDERICK POST CO.
ENGINEERING and DRAFTING SUPPLIES

IRVING PARK STATION

CHICAGO, ILL.

MICROFILMED

APR 8 1965

Copeland Ave prmt	P 44
Alley 42 U.H.	P 45
Ebers St Paving	P 46
Newell St Grading	P 48
Oliver & Gresham Water	P 50
Runnymede Lane prmt	P 53
Golden Gate Dr "	P 54
N.Y. St "	P 57
Pt Loma B Ms Willow St	P 58
Madison Ave Prmt	P 60
1st & Nutmeg "	P 67
Westborne & Neptune prmt	P 68
Extas on sewer Wall Neptune Place	P 74
Alley 36 C.H.	P 75
Kalmia prmt India	P 76
Alley 195 U.H.	P 77
Madison & Georgia r prmt	P 79
Imperial & 65th Prmt	P 80

Insured
12/30/29
H.K.

Kearney & Sigsbee Pr.	P 1
Santa Cruz Grading & Pr.	P 4
1st St. Spring old Trackage	P 7
Alley 72 Park Villas	P 9
" 73 " "	P 10
" 39 " "	P 11
" 8 Frary Hghts	P 12
El Cajon prmt	P. 13
32nd St " & Bancroft	P 15
Essex St "	P 17
31st St "	P 19
Myrtle Ave "	P 20
38th St "	P 21
Aux. Sewer Cap May	P 22
Nichols St. Prmt	P 23
Lamont St "	P 24
Alley 117 U.H.	P 28
" 1 Fairmont Annex	P 29
" 7 Wilshire Place	P 30
" 63 Park Villas	P 31
" 5 Blairs Highland	P 32
" 2 St Louis Hghts	P 33
Berry & Kendall Waterline	P 34
19th St Prmt	P 35
Sampson St prmt	P 38
Ebers St. Sewer	P 43

1263
576 327
1076 891

Commercial



17th St

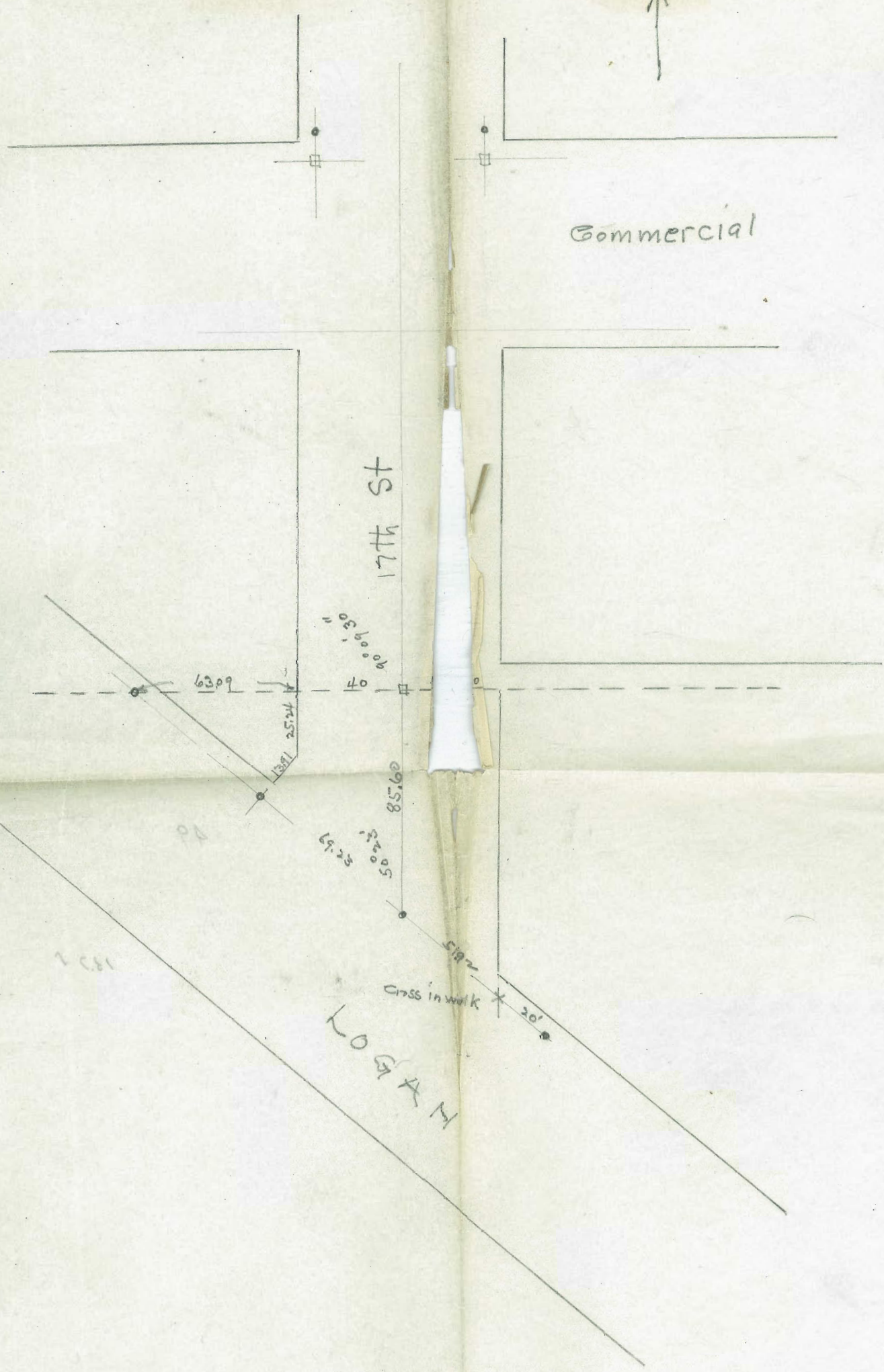

LOGAN

Cross in work X 20'

6309

25.24

13.97

85.60

51.92

69.33

32.05

90.00
90.00

40

2 CBI

PA

Kearney Arc PAVING
 8" curb face
 6" crown

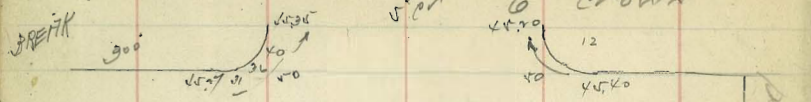

Dewdney

CRABBY EXCEPTED

Kearney



Dewdney

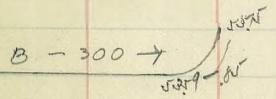
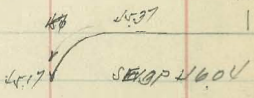

Dewdney

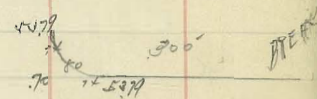

Kearney

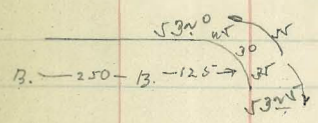

Dewdney

370 351 376 = 6.00

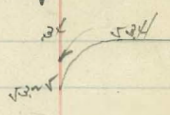

Cross 575 = 5" crown



Kearney

EVANS

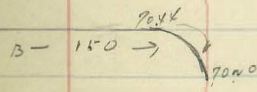

CRABBY

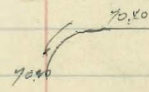

Kearney

Sampson

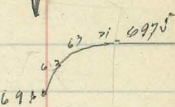
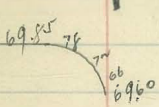
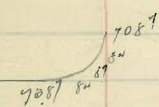

Kearney Fire paving

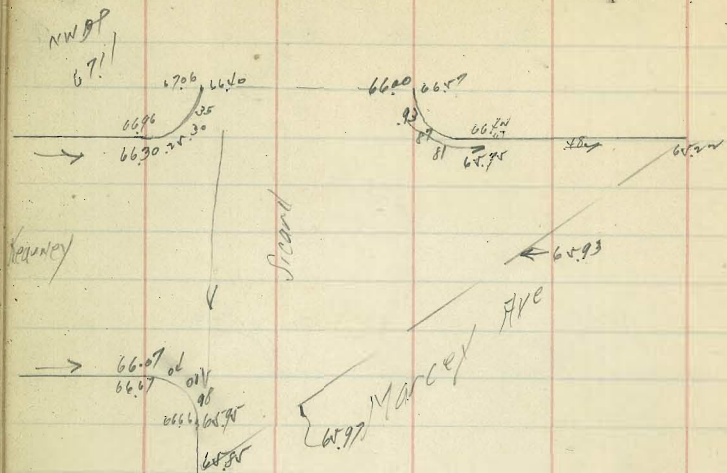

6" Sewer Construction 1942 N. of Kearney

Station	FL	Grade
0+00 = EV Sewer	17.30	18.68 = Grade
0+35 = DE	17.84	
0+70 = DE. WRONG	14.00	

See plan

Kearney Culvert CONST.

Station	FL	Notes
00 = EV. Storm Drain at Sigbee	17.30	
0+45	17.54	
0+90	17.73	
1+35	17.95	
1+80	18.16	
2+05 = P.C.	18.30	
2+30 = EXISTING CULVERT at SE Cor 18th + A1ST.	18.44	
0+45 = BREAK	18.17	
+90	18.43	
1+35	18.28	
1+80	18.34	
2+05 = P.C.	18.39	
2+30 = EX CULVERT	18.44	

Grub raised
acct of sewer
line

Santa Cruz Ave. grading

	Job	Nob
EL Sunset Cliff end	54.0	53.0
+40	58.46	57.46
+80	64.94	61.94
+120	67.38	66.38
+160	71.84	70.84
N = P.V.C.	76.3 ✓	75.3 ✓
+200	78.3 ✓	77.3 ✓
+400	80.2 ✓	79.2 ✓
+600	81.8	80.8 ✓
+800	83.3 ✓	82.3 ✓
3	84.6 ✓	83.6 ✓
+200	85.6 ✓	84.6 ✓
+400	86.5	85.5
3 +60 = E.V.C.	87.1	86.1
+418	88.65	87.65
+476	90.20	89.20
5 +434	91.75	90.75
5 +492 = P.C. of curb	93.3	92.3
6 = WLEBERS	93.5	92.5

5317 SW 7th C.T. Santa Cruz + Sunset cliff end

cl. Sunset cliffs.

	D.V.C.							
sl.	54.0	58.5	62.9	67.4	71.8	76.3	78.3	
	12.02	19.7	15.3	10.8	6.5	21.4	19.4	
		11.4	5.8	0.6	5.0	9.0	7.5	
		+8.3	+9.3	+10.2	+11.5	+12.4	+11.9	
N.I.	53.0	57.5	61.9	66.4	70.8	75.3	77.3	
	13.0	8.5	4.1	1.8	7.4	2.9	11.0	
		8.2	6.5	1.8	2.4	2.9	10.5	
		+0.3	-2.4	-1.8	-1.0	0.0	+0.3	
sl.	80.2	81.8	83.3	84.6	85.6	86.5	87.1	88.6
	17.5	15.9	14.4	13.1	12.1	11.2	10.6	9.1
	5.9	4.1	4.3	3.7	3.8	4.5	5.5	8.4
	+11.6	+11.0	+10.1	+9.4	+8.3	+6.7	+5.1	+0.7
N.I.	79.2	80.8	82.3	83.6	84.6	85.5	86.1	87.6
	9.1	7.5	6.9	6.0	5.2	4.2	3.6	3.0
	3.7	4.7	4.9	4.1	3.1	2.1	1.6	1.0
	+0.4	+2.8	+4.1	+4.0	+3.9	+3.1	+2.9	+1.6
			P.C.	N.I.				
sl.	90.2	91.7	93.3	93.5				
	7.5	6.0	4.5	4.3				
	2.4	2.7	1.9	1.5				
	-6.9	+3.3	+3.6	+1.8				
N.I.	89.2	90.7	92.3	92.5				
	8.5	7.0	5.4	5.2				
	7.8	9.2	6.3	6.2				
	+0.7	-2.2	-0.9	-1.6				

531.2
+12.28
660.0
-0.10
65.90 T.P.
+12.29
78.19
-2.24
75.95 T.P.
+12.95
88.90
-0.41
87.89 T.P.
+9.86
97.75
-1.23
96.52
+11.31
107.83
-2.46
105.37

N.W. spike in pole
96.46 correct.

SANTA CRUZ paving 8" curb face
5" crown

See page 2
for V.C.

96.26
9 nails/in
NW pole

EBERL

Queen Blvd
no crown curb

Bacon
excepted

Cable
excepted

Sumner Childs Blvd.
excepted

2001R

W.L.

201-50 → 2 THUB

E.L. Bacon St.

Coronado

James
E.L.

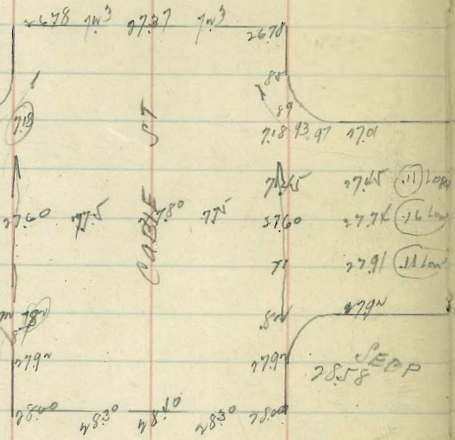

Sumner Childs Blvd

EXISTING SANTA CRUZ water line
10' J of #

EXISTING	FL	To be lowered
00 = EL Sunset cliff Blvd	50.5	
0 + 50	56.1	
1	61.7	
+ 50	67.2	
2 = PVC	71.8	
+ 20	74.8	
+ 40	76.7	
+ 60	78.3	
+ 80	79.8	
3	81.1	
+ 20	82.1	
+ 40	83.0	
3 + 60 EVC	83.6	153 139 14.3
+ 400	85.2	12.7 + 1.3 14.0
+ 20	86.8	10.5 7.1 3.4
+ 80	88.4	8.9 8.7 14.2
6 = WLEDERS ST	90.0	7.4 3.2 4.1
00 = EL " "	91.5	
0 + 60	95.8	13.5 10.7 + 4.9 11.2 6.4 + 4.8 6.7 0.6 + 0.1 14.6 8.3 + 6.3 10.0 3.4 + 6.1 17.2 1.2 + 6.0 12.0 6.3 + 6.3 8.0 1.7 + 6.3
1 + 20	100.2	
1 + 80 = BREAK	104.5	
+ 30	109.1	
+ 80	113.7	
3 + 36	118.3	
+ 88	122.9	
4 + 40 = BREAK	127.5	

96.46
+ 2.42
98.88
- 0.28
98.60 T.P.
+ 12.81
111.41
- 0.65
110.76 T.P.
- 12.93
123.69
- 0.68
123.01 T.P.
+ 12.48
135.49
- 0.16
135.33 T.P.
+ 13.02
148.35
- 0.07
148.28 Sta. 6. W.J. Froude
+ 6.35
154.63

✓ 93.3 132.9 15.4
+ 5.6
75.8
10.0
4.7
+ 5.3
4.5
0.1
+ 4.4
8.9
3.2
+ 5.7

1st paving of Abandoned R.R.
B. to Laurel

00 = NLBST	W	E
0+20	0.0	0.00
0+60	0.0	0.00
1	-0.02	-0.02
+50	-0.07	0.0
2	-0.08	0.0
+50	-0.06	0.0
3 = SL AST = MH	0.0	0.0
φ "	-0.04	-0.04
00 = NL "	-0.03	-0.02
0+50	-0.04	-0.02
1	-0.05	-0.04
+50	-0.03	+0.02
2	-0.07	-0.04
+50	-0.01	0.0
3 = SL AST = MH	0.0	0.0
φ "	0.0	0.0
00 = NL AST	-0.02	-0.01
0+50	-0.03	+0.01
1	-0.03	-0.02
+50	-0.06	+0.01
2	-0.05	+0.01
+50	-0.06	-0.02
3 = SL Geoch = MH	0.0	0.0
φ	-0.03	0.0
00 = NL "	-0.02	-0.02

	W	E
0+50	0.0	0.0
1	0.0	0.0
+50	+0.01	0.0
2	0.0	0.0
+50	+0.02	0.0
3 = SL Cedar	-0.04	-0.02
φ	0.0	0.0
00 = NL "	0.0	-0.03
0+15		-0.10
0+50		-0.05
+50		+0.01
1		0.0
+50		0.0
+50		-0.03
+50		+0.02
2		-0.02
+50		-0.02
+50		-0.10
+50		-0.05
3 = SL Darp = MH	0.0	0.0
φ	0.0	0.0
00 = NL "	0.0	-0.03
0+15	0.0	-0.04
0+50	-0.02	-0.05
1	-0.15	-0.07
+50	-0.12	-0.10
2	-0.02	-0.07
+50	-0.02	-0.06
+50	0.0	-0.03
3 = SL ELM = MH	0.0	-0.02
φ	0.0	-0.06
00 = NL "	0.0	-0.04
0+15	0.0	-0.04
0+50	-0.03	-0.06
1	-0.03	-0.05

1st paving
ON West

old
SWITCH

		W	E
00	1+50	-0.07	-0.14
0+50	γ	-0.05	-0.10
0+50	+50	-0.02	-0.04
1	+50 3 = SL Fir = MH	0.0	-0.05
+	♀	0.0	-0.05
∞	00 = NL "	0.0	-0.03
+	0+50	-0.04	-0.05
3 =	1	-0.03	-0.05
♀	1+50	0.0	-0.05
	1+50	0.0	-0.06
00	∞	0.0	-0.06
0+50	+50	0.0	-0.06
1	3 = SL Grapes	0.0	-0.04
+	♀	0.0	-0.04
∞	00 = NL "	0.0	-0.07
+	0+50	0.0	-0.07
3 =	1	0.0	-0.07
♀	+50	0.0	-0.10
00 =	∞	0.0	-0.04
0+50	+50	0.0	-0.04
1	3 = SL Hawthorn MH	0.0	-0.06
+	♀	0.0	-0.05
∞	00 = NL "	0.0	-0.04
+	0+50	0.0	-0.10
3 =	1	0.0	-0.06
♀	+50	0.0	-0.10
00 =	∞	0.0	-0.14

		W	E
0+50		0.0	-0.10
3 = SL	1+50 = MH	0.0	-0.05
♀		0.0	-0.05
00 = NL	"	0.0	-0.05
0+50		0.0	-0.05
1		0.0	-0.04
+50		0.0	-0.04
2		0.0	0.0
+50		0.0	0.0
3 = SL	Juniper	0.0	0.0
♀		0.0	0.0
00 = NL	"	0.0	0.0
0+50		0.0	-0.03
1		0.0	0.0
+50		0.0	-0.04
∞		0.0	-0.04
+50		0.0	-0.04
3 = SL	Kalmia	0.0	0.0
♀		0.0	0.0
00 = NL	"	0.0	0.0
0+50		0.0	0.0
1		0.0	-0.04
+50		0.0	-0.03
∞		0.0	-0.03
+50		0.0	0.0
3 = SL	Laurel	0.0	0.0

EL Canyon Ave paving

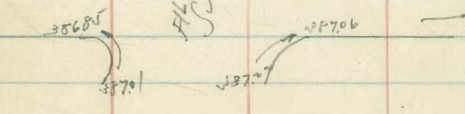
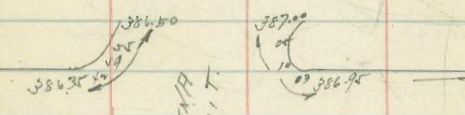
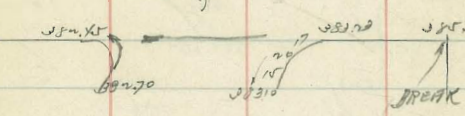
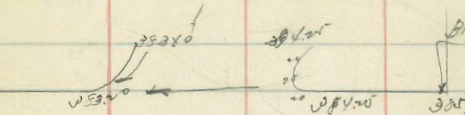
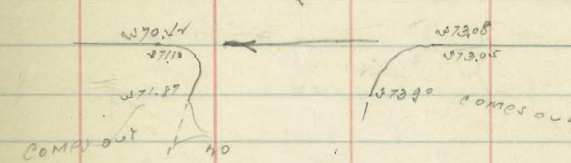
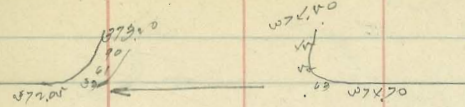
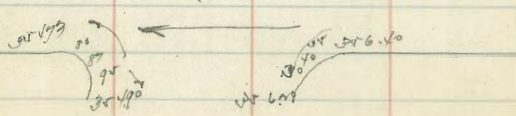
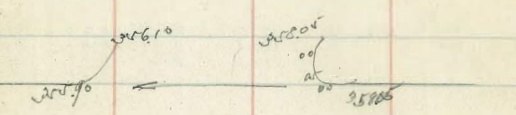
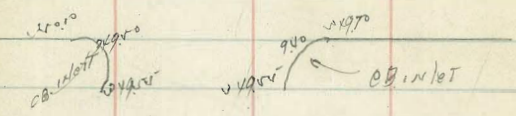
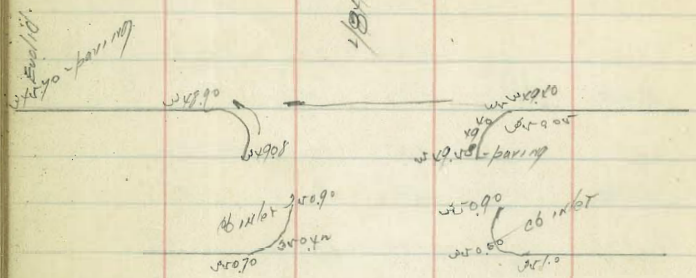
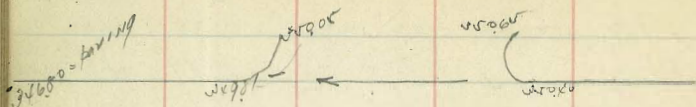

WINONA

WINONA

50 ft

ALTITUDE SUMMIT

BREAK

BREAK

COMES OUT

COMES OUT

35090

35090

35090

35090

35090

37900

37900

35300

35300

35300

35680

34900

34900

34900

34900

34900

37900

37900

35300

35300

35300

35700

34900

34900

34900

34900

34900

37900

37900

35300

35300

35300

35680

34900

34900

34900

34900

34900

37900

37900

35300

35300

35300

35680

34900

34900

34900

34900

34900

37900

37900

35300

35300

35300

35680

34900

34900

34900

34900

34900

37900

37900

35300

35300

35300

35680

34900

34900

34900

34900

34900

37900

37900

35300

35300

35300

35680

34900

34900

34900

34900

34900

37900

37900

35300

35300

35300

35680

34900

34900

34900

34900

34900

37900

37900

35300

35300

35300

35680

34900

34900

34900

34900

34900

37900

37900

35300

35300

35300

35680

34900

34900

34900

34900

34900

37900

37900

35300

35300

35300

35680

34900

34900

34900

34900

34900

37900

37900

35300

35300

35300

35680

34900

34900

34900

34900

34900

37900

37900

35300

35300

35300

35680

34900

34900

34900

34900

34900

37900

37900

35300

35300

35300

35680

34900

34900

34900

34900

34900

37900

37900

35300

35300

35300

35680

34900

34900

34900

34900

34900

37900

37900

35300

35300

35300

35680

34900

34900

34900

34900

34900

37900

37900

35300

35300

35300

35680

34900

34900

34900

34900

34900

37900

37900

35300

35300

35300

35680

34900

34900

34900

34900

34900

37900

37900

35300

35300

35300

35680

34900

34900

34900

34900

34900

37900

37900

35300

35300

35300

35680

34900

34900

34900

34900

34900

37900

37900

35300

35300

35300

35680

34900

34900

34900

34900

34900

37900

37900

35300

35300

35300

35680

34900

34900

34900

34900

34900

37900

37900

35300

35300

35300

35680

34900

34900

34900

El Cayan Ave. Paving

W. H. Moore

12

T.P. Top
end curb



5.5

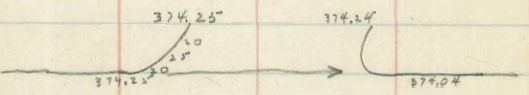
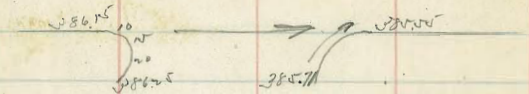

5.2

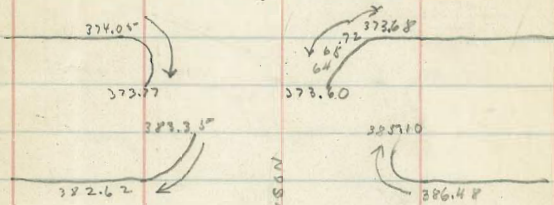

DOWNSON

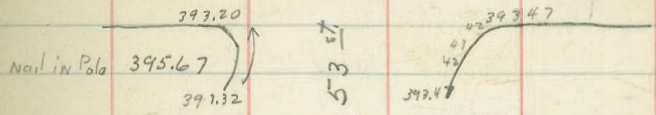

5.3

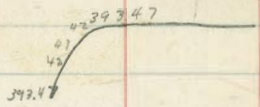

3rd and 5th Paving 6" curb face
N of El Canyon 4" crown

G.R. Daley

15

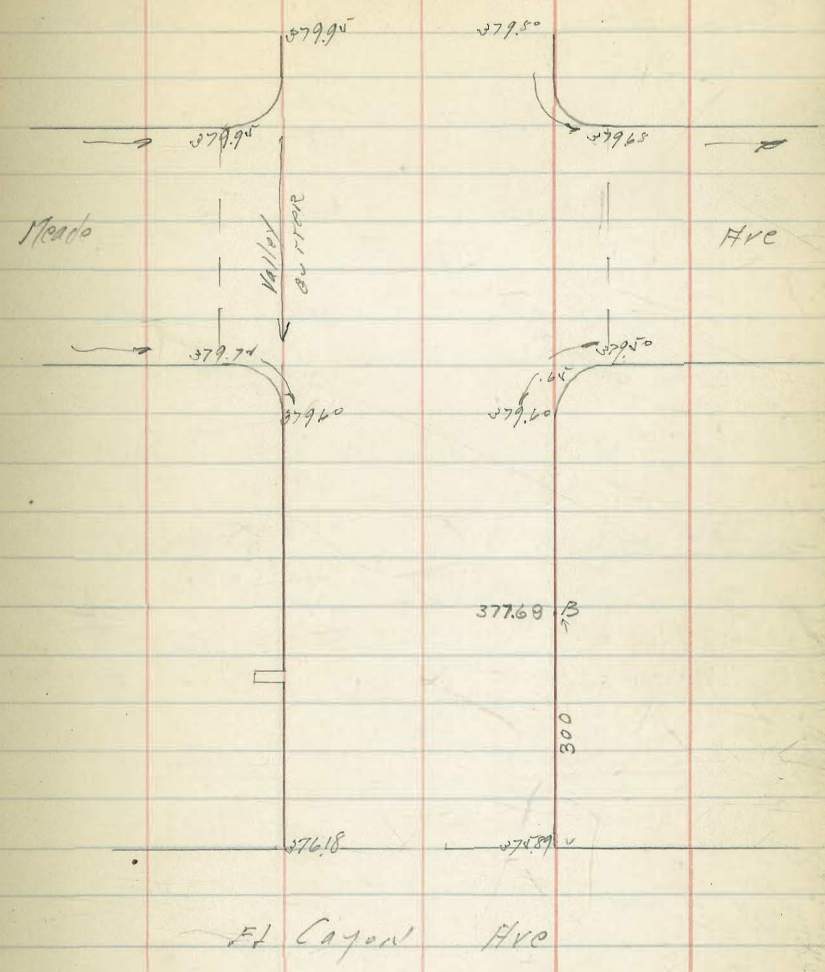
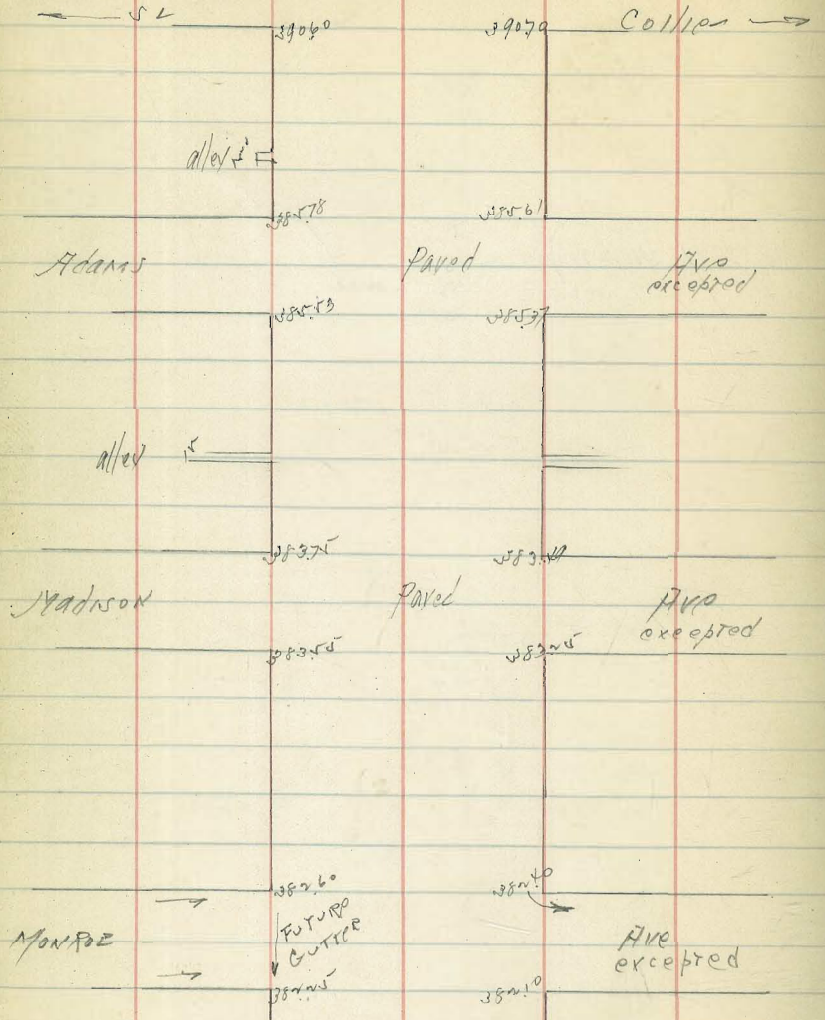

Bancroft St PAVING 6" curb face
 N of EL CAYON 4" crown

G.R. Daley

Cobley →

MONROE AVE

377.69

377.74

FUTURE CUTTERS

EXCEPTED

378.46

378.51

4+75

3+25

2+50

175' 394.60
 394.35
 391.96
 390.44

389.70

389.70

376.50

376.50

COLLIER

Ave

MONROE

Ave

389.40
 389.20

389.20
 389.30
 389.30

376.50
 376.30
 376.26

376.50
 376.30
 376.46

SW Cof Tact

B = 4+50

B = 3+25

B = 3+00

D = 2+00

D = 0+50

ADAMS

Ave excepted

384.76

384.69

378.08

378.11

200' 383.88

383.61

384.00

VALLEY

BREAK

383.31

383.39

EL CAYON AVE

MADISON

Ave excepted

220' 380.44

380.51

B = 2+25

Whiting
Moore

ESSEX ST PAVING

	Ncb	Scb
WL Park Blvd=00	310.30	309.30
0 + 40	306.85	306.33
0 + 80 8.6"	303.40	303.36
1 + 20	299.95	300.29
1 + 60 = BREAK	296.50	297.24
2 + 10	293.0	293.71
2 + 60 = BREAK	289.50	290.0
3 + 80 = BREAK	285.0	288.50
3 + 10 = BREAK	286.80	286.50
3 + 30 = BREAK	286.30	285.80
3 + 50 = BREAK	286.30	285.80
3 + 60.80 =	286.50	286.0

cb Strakes set @ offset

6" curb face
4" crown
Good body = Cont.

see page 18 for sketches

316.84 NEOP UNIV. 4' part dnd 307.25 on 17
 1.80
 318.64
 9.32
 309.28
 1.19
 310.47
 13.06
 497.39
 1.26
 498.65
 10.29
 488.36
 2.97
 491.37

N	10.3	06.8	03.4	99.9	96.5	93.0	89.5
	0.15	3.6	7.0	10.5	17.0	23.6	30.1
	0.26	4.0	6.5	19.5	13.0	6.0	1.8
	cb +112	0.01	+0.3	+0.5	+1.0	-0.2	-0.1
S	09.3	06.3	03.4	300.4	27.4	23.7	20.0
	1.15	11.1	7.0	10.0	1.1	1.9	8.6
	1.98	4.5	7.1	9.0	1.0	3.5	11.9
	cb +131	0.2	-0.1	+1.0	+0.2	+1.0	-3.1
N	88.0	86.8	86.3	86.3	86.5		
	3.3	4.5	5.0	5.0	5.8		
	2.9	4.8	5.1	4.6	3.7		
	1.2	-0.2	-0.1	+0.2	+1.4		
S	88.5	86.5	85.8	85.8	86.0		
	10.1	12.1	12.8	5.5	5.3		
	1.2	12.7	12.8	6.6	6.2		
	-1.9	-0.6	0.0	-1.1	-0.9		

309.28
 206
 311.24
 1304
 496.28
 1.39
 497.67
 1.86
 499.53
 1.24
 498.29
 491.05
 491.28
 496.30
 2.81
 499.11

296.30
 296.60
 289.50
 288.0
 286.80
 286.30
 286.30
 286.50
 286.0

297.24
 1.96
 299.20
 9.11
 288.50
 10.61
 286.50
 12.67
 285.50
 15.31
 285.80
 13.31
 286.00
 15.11
 286.00
 40.80

W alley
 296.30
 3.37
 299.67
 1.86
 298.81
 1.24
 297.57
 1.64
 295.93

W alley
 283.20
 14.91
 13.31
 +1.6

ESSEX ST CULVERT

CURB INLET #1	T CURB	FL.	
285.80	283.20		
clean out #1 - 00 = BOTTOM BOX.	279.0		
0 + 50	277.3		
1	275.6		
+ 50	273.9		
2	272.2		
+ 50	270.5		
3	268.7		
+ 50 = EX. CURB	267.0		

Water Line

WLPB	203.5	200.4	297.4	294.3	290.6	286.9
306.5	6.8	4.9	17.9	4.3	8.0	11.7
	1.2	7.3	10.6	1.9	5.0	10.0
	+2.6	+2.6	+2.8	+2.8	+2.1	+1.8
295.4	292.4	289.8	287.8	285.8		
15.0	14.2	15.8	15.8			
10.0	14.0	10.3	10.3			
+2.3	+0.2	+0.2	+2.2			

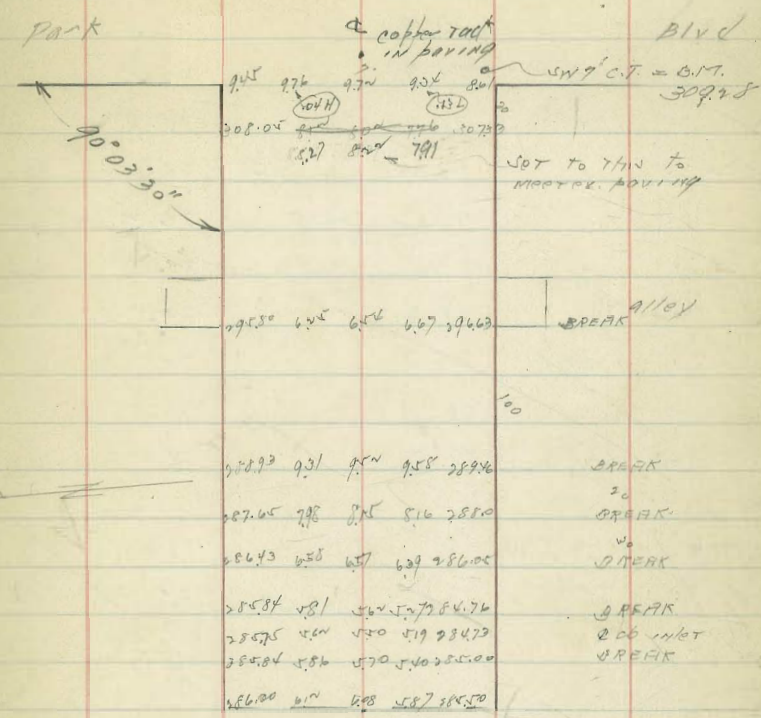

309.25
 1.25
 311.13
 11.23
 1.25
 309.88
 1.25
 311.13
 1.25
 309.88
 1.25
 311.13
 1.25
 309.88

○ spike in tele pole 290.01
 ○ Cop. tack in porch step

Wm/28
Moore

31ST PAVING

Logan to NATL. Ave

8TH CURB TO GO

5TH crown

3RD on alloy
RETURN

73.97

78.7

81.84

Logan to 31ST NWBP

WCB

E CB

06

SL Logan

74.08

73.30

W

74.0

74.9

75.8

76.1

76.4

76.1

75.8

75.3

0 + 55

74.94

74.40

73.97

5.76

79.73

E

73.0

74.4

75.5

75.8

76.1

76.2

75.9

75.4

0 + 90 - BREAK

75.8

75.5

N

74.7

73.1

71.5

WCB

1 + 10

76.1

75.9

W

74.7

73.1

71.5

1 + 20

76.2

76.1

E

74.7

73.1

71.5

1 + 50

76.1

+40 = NL Alloy

76.15

76.4

76.15

E

74.7

73.1

71.5

1 + 70

75.8

+60 = SL Alloy

75.95

75.9

76.05

E

74.7

73.1

71.5

1 + 90

75.3

75.4

N

74.7

73.1

71.5

2 + 10 BREAK

76.7

76.7

National

2 + 55

73.1

73.1

3 = NL National

71.5

71.5

0 + 94 =

71.71

10.13

10.10

.03 H

Griffith CONT.

Logan

MOORE
9/12/58

MYRTLE AVE PAVING
Jct to Chamounie

8" ed face
.6" crown

Goodbody = Center

NO

3450.89 NW 1/4 Myrtle & Chamounie
3451.00
3451.11

15.77

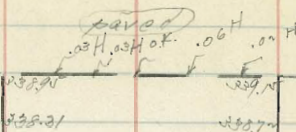

17.

paved

335.20 335.21

CHAMOUNIE

AVE.

38^{1/2} St. Paving

8" curb face
5" crown

G.R. Daley - cont.

el. on To. Monroe

71

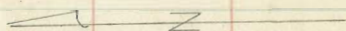

Meade Ave

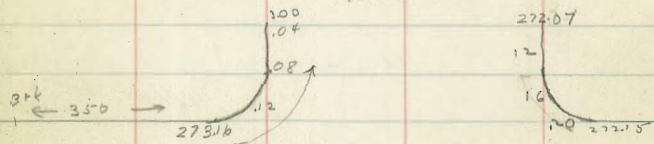

38^{7/8}

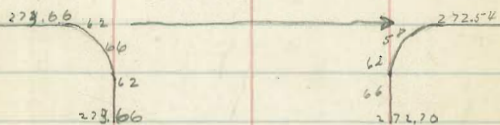

Flk. Sewer on Cape May Bacon to
HOBOTT

FL
0.66
0.83
1.09
1.24
1.44
1.65
1.86
2.08
2.30
2.52
2.74
3.15
3.40

EXMH =
MH #1

5-11
11-16
11-16
= DE

6.76
5.11
11.87

N.E. RR across Cape May

2nd

M.H. 1.

0.83	1.03	1.24	1.44	1.65	1.86
11.04	10.84	10.63	10.43	10.22	10.01
5.23	4.96	4.83	4.58	4.44	4.32
+ 5.81	+ 5.88	+ 5.80	+ 5.85	+ 5.73	+ 5.69

M.H. 2.

2.02	2.30	2.52	2.74	2.96	3.18	3.40 = D.E.
9.79	9.38	9.13	9.13	8.91	8.69	8.47
4.12	4.01	3.83	3.63	3.51	3.26	3.17
+ 5.67	+ 5.50	+ 5.52	+ 5.50	+ 5.40	+ 5.33	+ 5.30

.00 1/2

Nichols St paving 3' dip in paving
 Rosecrans to San Antonio

= back edge CURB	J. 06	✓ 06	
0.5 EL ROSECRANS	41.0	41.5	
0 + 14.5 = EC RETURN from face of CURB	40.0	40.5	
0 + 5°	37.15	37.5	
1	33.30	33.50	
+50	29.46	29.5	8.00%
2	25.61	25.5	
3 back edge of / +50 = cross CURB	21.77	21.50	Δ = 21.63 OPEN CURB

Culvert #1 F.L. 81' of 12" pipe.

Top CURB inlet 10' wide	21.63	
Bottom " " = 00	12.14	16.0
0 + 45 = Δ BREAK	11.60	14.0
0 + 75	10.5	0.0 - 1.0 = 3.6 3.2 = 0.2°

Water Line

00 = EL ROSECRANS	37.2	37.2
0 + 50	33.4	33.4
1	29.5	29.5
+50	25.6	25.6
2	21.7	21.7
+50	18.0	18.0

4.63
 3.89
 50.26
 17.80
 37.60
 37.11
 33.72
 12.83
 10.94
 1.89
 12.54
 1.80
 7.74
 2.14
 2.60

Cure to curb grade 23

S	✓ 1.0	✓ 0.0	27.1	33.3	29.6	25.6	21.7
	3.1	2.5	7.4	11.2	8.5	5.5	12.1
	0.124	2.1	3.4	10.3	2.0	2.5	11.5
		4.2	4.7	20.9	40.6	40.9	
N	✓ 1.5	✓ 0.5	27.5	33.5	29.5	25.5	21.5
	4.0	7.0	11.0	4.5	3.3	3.3	12.3
	0.124	3.0	6.8	10.9	4.1	2.8	11.7
		40.8	40.8	40.1	40.5	40.5	40.6

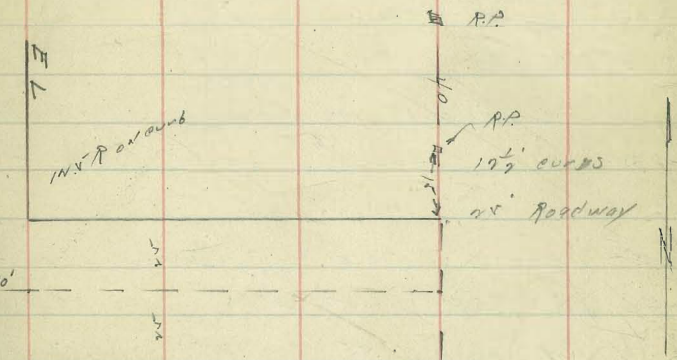

12" R curb

853

S	✓ 1.10	✓ 1.00	✓ 0.80	✓ 0.50	✓ 0.00
	3.83	3.43	2.63	3.23	4.09
N	✓ 1.60	✓ 1.50	✓ 1.20	✓ 0.95	✓ 0.50
	4.81	4.93	3.15	3.28	3.93

1/25/18
MOORE

LAMONT ST Sowers

Sowers

24

	FL.		DOWN CONTR.
00 = MH #1	201.53	10.70 1.16 +8.27	189.75 1.25 188.50
0 + 43.75	198.62	13.67 6.25 +7.42	174.94 12.00 162.94
0 + 87.5	195.75	16.51 8.39 +7.12	157.92 13.11 174.81
1 + 91.25	194.87	19.39 12.51 +6.88	175.30 13.10 162.20
1 + 75 = MH #2 called	189.95	10.38 4.26 +6.12	190.26 = plug end E.L.
2 + 15.75	187.50	12.56 7.11 +5.45	10.10 0.39 +9.71
2 + 62.50	184.00	15.06 10.4 +4.66	
3 + 06.25	184.50	17.86 13.20 +4.66	
3 + 50 = D.M.H. #3	180.0	7.94 1.50 +6.44	
" " " = Drop	176.05	11.87 10.35 +1.52	176.03 = plug end E.L.
3 + 99.75	174.04	10.88 2.80 +11.08	11.59 1.23 +10.36
4 + 37.50	174.04	15.90 6.65 +9.25	
4 + 81.25	170.01	17.91 10.85 +7.06	
5 + 25 = D.M.H. #4	168.00	7.00 2.00 +5.00	
" " " = Drop	161.55	13.25 0.06 +11.67	161.83 = plug end E.L.
5 + 68.75	159.67	15.63 4.26 +11.37	13.47 1.15 +12.32
6 + 12.5	157.78	17.52 9.68 +7.84	
6 + 56.25	155.90	19.50 13.10 +6.40	11.10 3.58 +7.52
7 + 00 = MH #5	154.02	10.80 3.80 +7.00	153.76 = plug end E.L.
			11.10 10.14 +7.41
			11.10 = " " W.L.
			13.24 1.66 +11.68

	called short F.L.		
MH #6 = 00 of Diamond	101.16	14.87 5.30 +9.57	101.20 = plug end W.L.
0 + 40	100.88	15.15 6.75 +8.40	14.59 3.00 +11.57
0 + 80	100.60	15.23 7.97 +7.26	
1 + 20	100.32	15.71 9.25 +6.46	
1 + 60 = M.H. #7	100.04	15.91 9.26 +6.65	99.60 = plug end E.L.
			16.43 10.23 +6.20
MH #8	95.91	13.77 7.25 +6.52	95.46 = plug end E.L.
			14.25 0.92 +17.31
MH #9	85.98	16.85 9.85 +7.00	84.86 = plug end E.L.
			17.97 8.98 +1.99
Bench Marks			
SWCP Corner of LAMONT	65.83		65.83 12.29 78.62 0.35 78.27
NE Cap. T. Feldspar	88.11		13.26 97.01 0.28 97.29
SE Cap. T. Emerald	99.02		12.10 108.53 0.98 109.51
SWCP Diamond	105.82		101.84 3.98 105.82
SE 10' Cap. T. Missouri	116.00		109.71 6.29 116.00
SE 7' Cap. T. Chukotony	126.03		150.25 0.15 150.10
SW 10' " " LAW	142.36		12.06 138.30 4.76 143.06
NE 7' " " Beryl	164.09		192.76 28.67 164.09
SE 7' " " Wilbur	186.06		108.27 0.81 109.08
SE Cap. T. INOURB LORING	206.90		148.35 5.74 154.09
			142.36 = T.P. 11.78 154.14

OUT
+
GONE

167.19
2.05
167.11
13.24
180.35

162.09

LAMONT ST PAVING

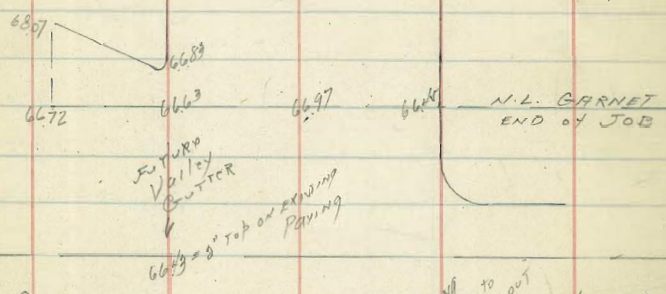
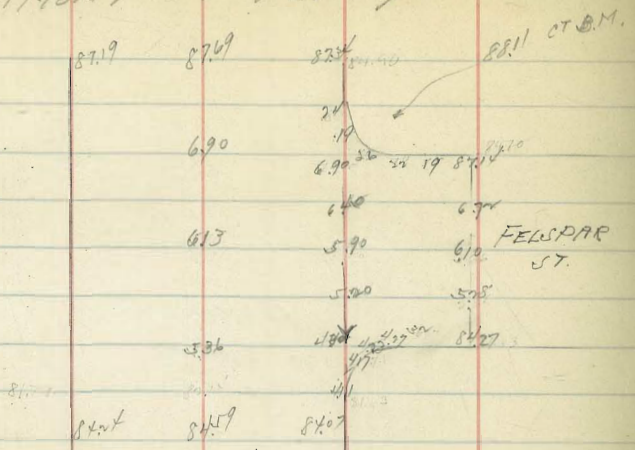

to EXISTING

PAVING will have to be taken out for CUTTER PAVING

6/29/88
Moore

Alley BIK 117 U.H. 20' wide 3' dip
Archos - CONTR

363.10 S.E. 22° E/Cejon + Ohio
5.45
368.55
4.43
364.12
2.63
366.75

00 = EL OHIO	363.74	363.80	= PAROUMENT
0 + 40 = BREAK	364.20	364.40	
0 + 90	363.99	364.15	
1 + 40 = W Alley South	363.78	363.91	
1 + 60 = EL " "	363.70	363.84	= BREAK on South
2 + 15	363.95	363.56	
2 + 70 = BREAK	363.00	363.30	
3 = WL Illinois	361.70	361.60	= PAROUMENT

363.60 = elev of st alley
and E alley South

78

ON ST

363.74	64.20	63.99	63.78	63.70	63.35
4.83	4.35	4.50	4.77	4.85	3.45
4.97	4.47	4.90	4.96	4.94	2.73
4.77	-0.12	-0.38	-0.19	-0.09	+0.72
363.80	64.40	64.15	63.91	63.84	63.56
4.75	4.15	4.40	4.64	4.73	3.19
4.93	3.78	4.20	4.32	3.73	2.73
	+0.37	+0.10	+0.32	+1.00	+0.46
363.00	361.70				
3.75	3.05				
3.22					
+0.53					
363.30	361.60		363.60		
3.45	5.15		4.40		
2.87	5.17		4.67		
+0.58			+0.23		

E alley South

6/30/28
Moore

ALLEY BIK 1. Fairmount Annex
15' wide } as Dip
20' wide }
McBean - Cont.

	W		E
0+0 = N.W. Orange	358.5		358.5
0+45	358.32		358.32
0+90	358.15		358.15
1+35	357.98		357.98
1+80 = Break	357.8	357.50	357.8
2+26.66	357.3		357.3
2+73.32	356.8		356.8
3+20.8 = Break	356.3	356.10	356.3
3+63.33	356.2		356.19
4+06.66	356.1		356.04
4+50 = S. Alley East	356.0	355.68	355.90
4+65 = N.W. Alley = N.	355.9		355.90
Alley East	N.		S.
00 = East line Alley	355.80	355.75	355.80
0+41.66	355.70		355.79
0+83.32	355.62		355.67
1+25 = W. 44 th St.	355.55	355.50	355.55

355.55
= 1/2 paving on 44th St

355.55
360.57
358.16
358.00
356.87
356.69
356.50
356.30
355.28
355.19 = 355.19
Orange + 44th

	W	E	W	E	W	E
	358.50	358.50	358.50	358.50	358.50	358.50
	358.32	358.32	358.32	358.32	358.32	358.32
	358.15	358.15	358.15	358.15	358.15	358.15
	357.98	357.98	357.98	357.98	357.98	357.98
	357.8	357.8	357.8	357.8	357.8	357.8
	357.3	357.3	357.3	357.3	357.3	357.3
	356.8	356.8	356.8	356.8	356.8	356.8
	356.3	356.3	356.3	356.3	356.3	356.3
	356.2	356.2	356.2	356.2	356.2	356.2
	356.1	356.1	356.1	356.1	356.1	356.1
	356.0	356.0	356.0	356.0	356.0	356.0
	355.9	355.9	355.9	355.9	355.9	355.9
	355.80	355.80	355.80	355.80	355.80	355.80
	355.70	355.70	355.70	355.70	355.70	355.70
	355.62	355.62	355.62	355.62	355.62	355.62
	355.55	355.55	355.55	355.55	355.55	355.55

FOR DIST
ON SOUTH

Alley D1K 7 Wiltshire Place N^w wide 3" dip

	W	on paving	E
JL MONROE	368.95		368.83
0+40 = BREAK	369.80		369.80
(1-10.12)	369.25		
	368.70		
	368.15		
2+50 = BREAK	367.60		367.60
	367.43		
(6-10.12)	367.26		
	367.10		
	366.93		
	366.77		
6+5+71.12 c. XL Meade	366.60		366.60

FB 1405

Restaked 8/14/28 Moore
grade changed

	W	E	90	Floor
373.63				
368.12				
3.62				
371.74	W 368.95			
3.80				
368.24				
3.86	E 368.83			
374.10				
6.10				
366.00				
W 37.26				
4.28				
366.00				
4.06				
+0.42				
NHBP E. 4.48				
4.78				
-0.76				
Meade +				
Marlborough				

Alley Blk 5 Blair's Highland 16 wide

W
 1070 = 12.7

SL Pains 000	302.4	303.0	having
0470 BREAK	304.0	304.30	
0440 "	304.60	304.90	
0480	305.0	305.30	
1470 = "	305.40	305.70	
440 = "	305.60	305.80	
460 = "	305.50	305.70	
480 = "	305.30	305.50	
7400 = "	305.0	305.20	
"	304.15	304.33	
"	303.30	303.45	
3	302.45	302.57	
5	301.60	301.70	
6	300.75	300.82	
7	299.90	299.95	
7	299.05	299.07	
8 = 5440 = BREAK	298.20	298.20	
5460 "	297.60	297.60	
5480 "	296.80	296.80	
5497.85 ALL WITNES	295.78	295.66 = having	

NE. 30 25' of Grounds

29495	304.41	304.60	304.60	305.00	305.40	305.60	305.50	305.30
11.89	4.42	2.24	2.24	1.82	4.88	4.68	4.78	4.78
306.84	4.45	3.25	3.06	0.82	4.87	4.68	4.68	4.78
0.79	-0.31	-0.82	-0.82	1.0	+0.01	-0.02	+0.10	+0.20
306.05 W.	303.02	304.30	304.90	305.30	305.70	305.80	305.70	305.50
4.72	3.82	2.74	1.94	1.52	4.58	4.48	4.58	4.78
310.78	3.15	3.33	1.99	0.61	4.11	3.83	3.95	4.78
5.72	-0.31	+1.01	+0.85	+1.0	+0.47	+1.0	+0.63	+1.0
304.56	305.0	304.15	303.30	302.45	301.60	300.75	299.90	
3.60	7.2	4.01	4.80	5.71	6.52	7.41	5.12	
308.16 E.	4.28	3.64	3.50	4.71	5.56	6.41	5.00	
5.51	4.0	+0.39	+1.0	+1.0	+1.0	+1.0	+0.12	
307.65	305.70	304.99	304.45	303.57	301.50	300.82	299.95	
1.27	5.08	5.95	5.71	5.57	6.46	6.20	5.07	
305.04 W.	7.08	5.42	4.91	5.80	6.73	3.49	5.05	
5.91	4.0	+0.53	0.0	-0.45	-0.07	+0.61	+0.02	
499.11	99.05	98.20	97.60	96.80	95.78	95.26	94.14	
3.25	5.97	4.66	5.26	6.06	7.03	7.20	7.07	
302.86	6.01	4.41	4.91	5.06	7.12	7.03	7.03	
	-0.04	+0.08	+0.35	+1.0	-1.04			
	99.07	98.20	97.60	96.80	95.66	95.26	94.14	
	5.95	4.66	5.26	6.06	7.20	7.07	7.07	
	6.36	4.85	4.36	5.06	7.17	7.07	7.07	
	-0.31	+0.11	+1.00	+1.0	7.03			

Newton = Cont.
 8/15/78
 Moore

		FL		162.00
WL LAMONT = 0.0		158.3 ✓		161.4
0 + 50		157.7	1.5	162.00
1		159.1	1.9	162.00
+ 50		159.5	1.7	162.00
2 = BREAK		160.0	1.0	162.00
+ 50 = EMLINE LINE	161.5 ^{WL Beryl}	160.9	1.1	162.00
3		161.7	1.0	162.00
+ 50		162.1	1.0	162.00
4		163.5	1.4	162.00
+ 50		164.3	1.0	162.00
5		165.2	1.0	162.00
+ 44.73 = Kendall line	166.0 ^{WL Kendall}	166.0	1.0	162.00
Beryl Line = 0.0		166.0 ✓		162.00
0 + 50 = Break		169.9	1.5	162.00
0 + 90		173.5	1.6	162.00
1 + 30		177.1	1.2	162.00
1 + 90		180.7	1.0	162.00
2 + 10 = BREAK		184.4	1.0	162.00
2 + 30		185.0	1.0	162.00
2 + 50		186.6	1.6	162.00
2 + 70		187.6	1.0	162.00
2 + 90		188.8	1.2	162.00
3 + 29.7		190.6	1.6	162.00
3 + 69.1 = Tree Coltrigwood	192.0	192.5	1.7	162.00
3 + 90 = BREAK		193.5	1.0	162.00
4 + 10		194.7	1.2	162.00

4 + 30 BREAK	196.1	10.1	
4 + 70 "	199.3	3.2	
4 + 90 "	201.2	1.9	
5 + 10 "	202.6	1.4	
5 + 74.4 = Tree West Malden	211.4	8.8	
6 + 08.1 = 90° RT EAST "	215.5	4.1	

177.93		
3.8		
168.41 = EIV of STUB	SE Beryl & Kendall	(F.H.)
170.6		
- 2.76		
218.6	= " " "	" Kendall & Malden (F.H.)
117.50		
316.67		
+ 1.13		

3207 L

LOCATION ?

119th St Grades

	Web	ECB	
3 (1-56.6W)	330.07	331.05	709
V = 2 + 40 = PVC	329.0	330.0	81A
	328.6	329.6	83A
	328.0	329.0	71A
90' SPARKS	327.3	328.3	72A
	326.5	327.5	106A
	325.6	326.6	115A
6 = 3460 = FVC	324.6	325.7	153
	321.93	323.07	220
W (5-48)	319.6	320.32	688
	316.60	317.66	766
	313.92	314.98	1277
5 = 6700 ALL UNIV	311.28	312.30	

SWAP UNIV. 4

	PVC							EV
32668	W 30.1	29.0	28.6	28.0	27.3	26.5	25.6	24.6
0.67	4.7	4.8	6.1	6.8	7.5	8.3	9.2	10.2
327.35	0.17	0.8	1.5	2.5	3.8	5.2	6.8	8.5
12.40	-0.8	-1.0	-1.3	-1.0	-0.3	+0.5	+0.2	+0.2
312.93	E 31.0	30.0	29.6	29.0	28.3	27.5	26.6	25.7
8.10	4.8	4.8	5.2	5.8	6.5	7.3	8.2	9.1
323.03	0.17	0.8	1.5	2.5	3.8	5.2	6.8	8.5
11.24	-0.8	-1.0	-1.3	-1.0	-0.3	+0.5	+0.2	+0.2
324.80	W 21.9	19.2	16.6	13.9				
2.03	10.9	3.8	6.4	9.1				
322.77	10.6	5.0	9.3	13.9				
8.00	-0.3	-1.4	-2.9	-4.5				
320.77	E 23.0	20.3	17.6	15.0				
	11.8	12.5	12.9	11.0				
	2.4	10.9	2.9	1.7				
	4.2	7.6	2.5	-0.7				
340.51	Finish stakes							
1.52	-PVC							
329.00 = TP	W 32.07	32.00	32.60	32.00	32.30	32.50	32.60	32.60
1.67	10.95	11.52	2.07	2.67	3.37	4.17	5.07	6.07
330.67						2.90	4.1	5.43
130.1						10.27	10.66	10.62
317.66	E 33.05	33.00	32.60	32.00	32.30	32.50	32.60	32.60
1.06	9.97	10.52	1.07	1.67	2.37	3.17	4.07	4.97
318.72								
	W 32.193	32.26	31.60	31.94	31.28			
	8.74	11.41	2.12	4.78	7.44			
	2.80			5.41	2.50			
	4.87			0.63	0.66			
	E 32.807	32.84	31.66	31.98	31.20			
	7.65	10.35	13.01	3.74	6.42			
				2.51	6.42			
				-2.77	0.05			

4947 St. Paving
Orange

2x4
E
2x4

Are

37

8" CURB FACE
6" CROWN

B. Carroll
9/31/28

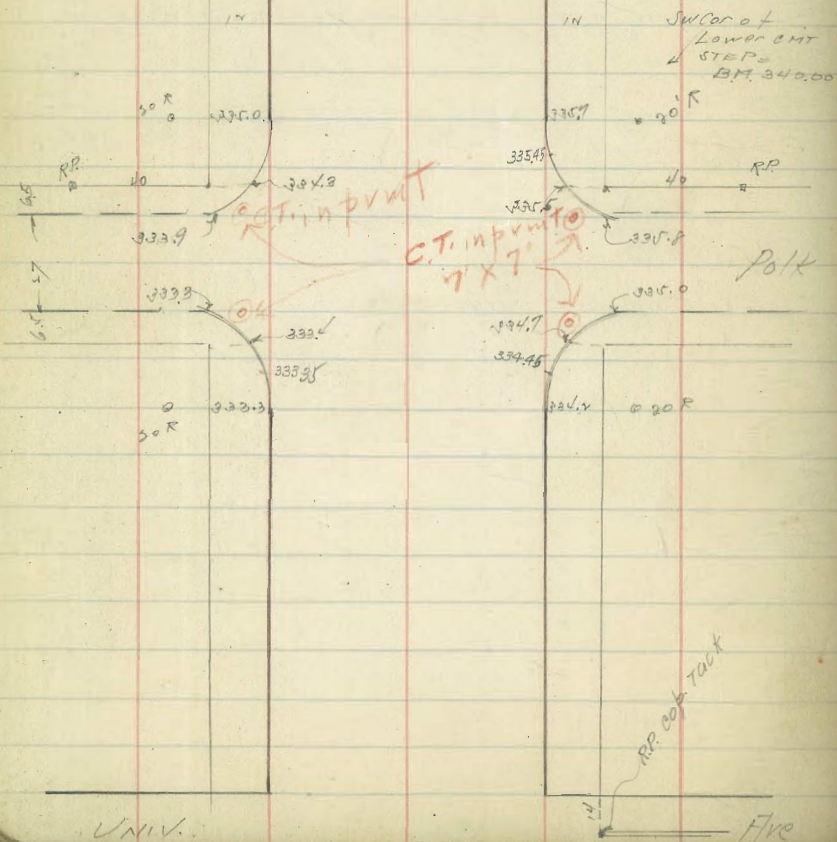

Sampson St paving

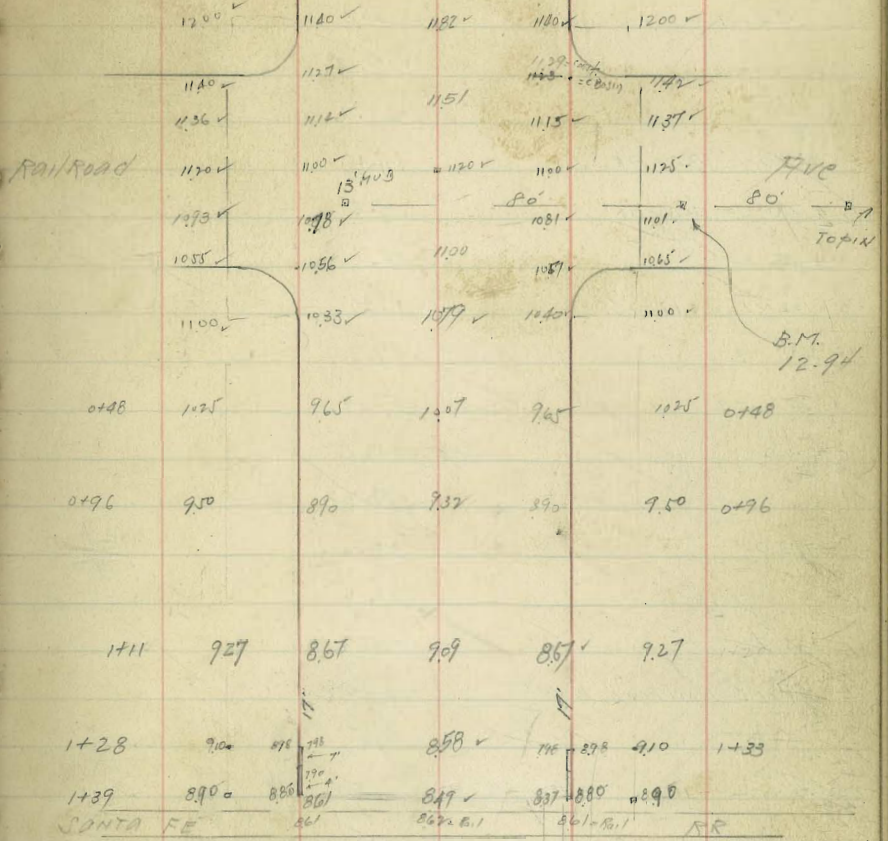
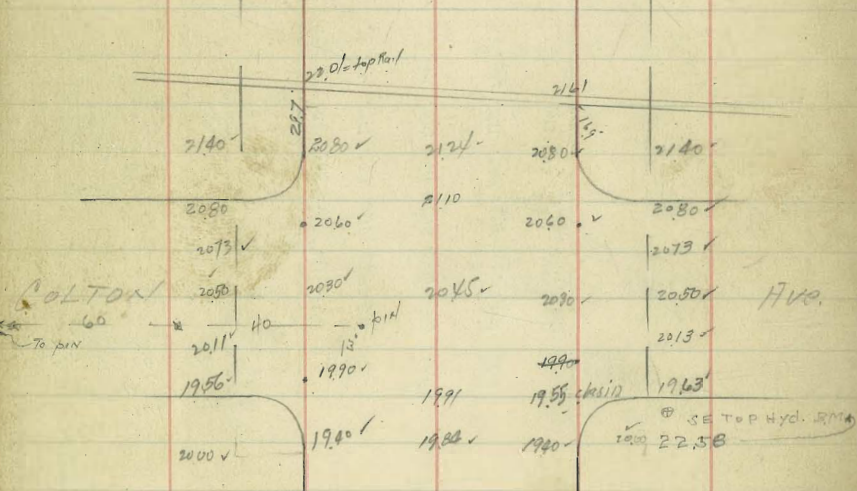
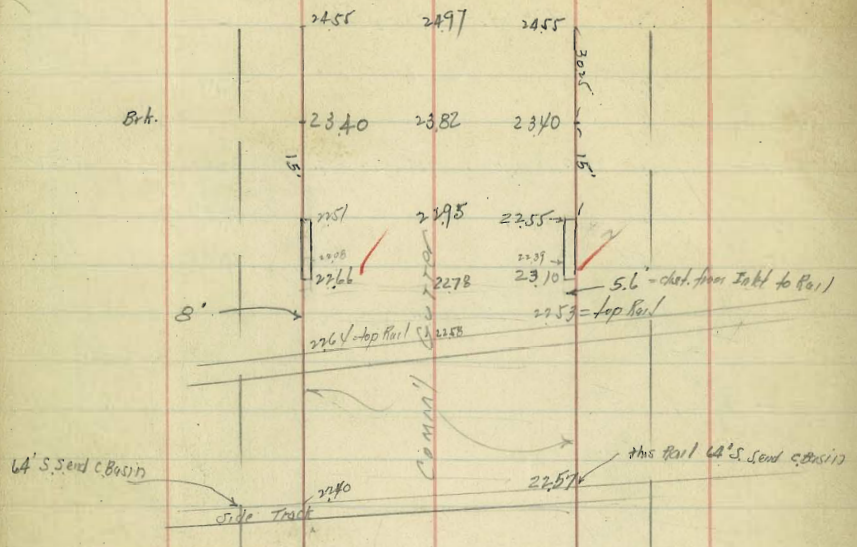

SAMPSON WATER MAIN

40

	FL
SL MAIN = 00	26.0
0 + 50	23.8
1	21.6
1 + 50 = BREAK	19.4
2 + 30 = BREAK	19.0
+ 65	18.7
3 = NL COLTON	18.4
+ 40 & "	17.7
+ 80 = SL " = 00	17.00
0 + 50	15.6
1	14.33
+ 50	13.00
2	11.6
+ 50	10.3
3 = NL RAILROAD FIVE	9.00
& " "	8.5
00 = SL " "	8.00
0 + 48	6.5
0 + 96	5.1
1 + 44	3.7

11/14/88
Moore

COPELAND AVE PAVING MEADE TO MONROE

of Feet
4th crown

NL Meade = 00

+50

+50 BFK

p-v. 0.67

5+50 = BFK

+70.68 = NL MONROE

FCB

363.90

364.26

364.62

365.0

364.62

364.25

363.88

363.50

363.12

362.75

362.37

362.0

361.50

364.36 = NW COR
4.56
368.92
6.36
363.86
4.70
367.56

364.36	63.5	63.1	62.7	62.4	62.0	61.50
3.98	4.7	6.1	6.5	6.8	7.4	8.0
368.34	1.0	6.8	7.8	8.2	8.9	9.5
	-0.3	-0.7	-1.3	-1.5	-1.9	-2.5

363.90	364.0	361.50	365.00
4.44	6.34	6.84	8.34
		6.94	

6.94 set to THIS

363.12 = paving NE Meade + 4th crown

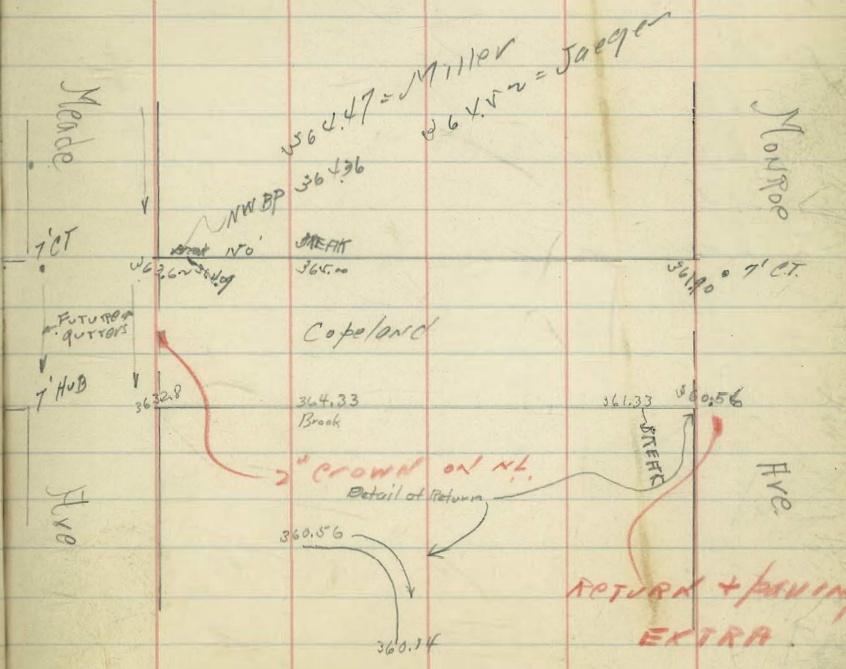

RETURN + PAVING
EXTRA

Moore

EBERS ST PAVING

C.R. Dalry

DEL MONTE AVE

DEER 83.5°

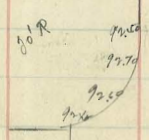

84.50

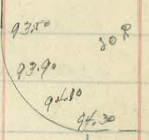

SANTA CRUZ

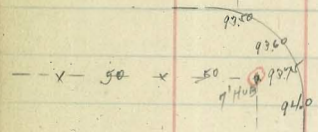

101.50

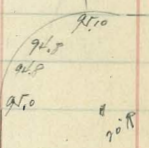

102.50

7 Trucks replaced @ 3/10/29

46

N.W. Man. 105.31

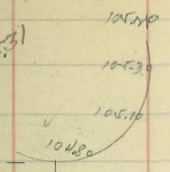

CORONADO

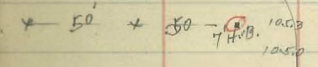

DEL MAR

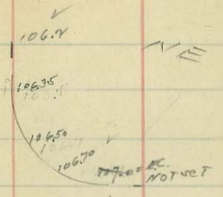
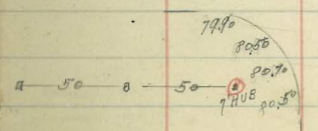

FLY

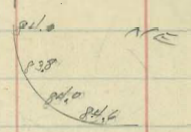
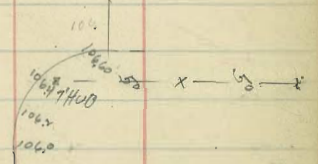

FLY

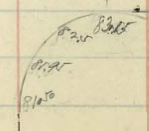

12/2/78 Newell ST. Grading Goodbody
Moore

	Job.	Job.
WL Rosecrans	9.00 ✓	8.90 ✓
0+27 = PC of CURB = DRETTK	9.30 ✓ 9.75 ✓	8.50 ✓
0+605	9.55 ✓ 9.50 ✓	9.05 10.00 ✓
1+10 ✓ = DRETTK	9.50 ✓ 9.25 ✓	9.60 9.55 ✓
1+50 "	10.20 ✓ 8.85 ✓	10.10 8.85 ✓
1+90 "	11.0 ✓ ✓	11.0 ✓ 8.05 ✓
2+32.5	12.0 ✓ ✓	12.0 ✓ 7.25 ✓
2+75 = PC of CURB	13.0 ✓	13.0 6.0 ✓
3+00 = EL LOCUST ST	13.60 ✓	13.60 ✓
end of CURB ENT side Locust	13.90	13.85
" " " WRT " "	15.00	14.90
WL LOCUST = 0+00	15.30 ✓	15.30 ✓
0+25 = PC of CURB	16.50 ✓	16.50 ✓
1/4 WAY	18.20 ✓ 10.87 ✓	18.25 ✓ 10.7 ✓
0+90 = RYC	19.90 ✓ 9.7 ✓	20.20 ✓ 8.87 ✓
1+10	21.10 ✓ 10.7 ✓	21.40 ✓ 7.67 ✓
1+30	22.40 ✓ 10.67 ✓	22.90 ✓ 6.7 ✓
1+50	24.10 ✓ 10.97 ✓	24.20 ✓ 4.7 ✓
1+70	26.00 ✓ 10.7 ✓	26.60 ✓ 3.7 ✓
1+90	28.10 ✓ 10.87 ✓	28.80 ✓ 0.7 ✓ T.P.
2+10 = PC	30.50 ✓ 10.97 ✓	31.30 ✓ 10.13 ✓
1/4 WAY	32.50 ✓ 10.9 ✓	32.40 ✓ 0.03 ✓
2+75 = PC of CURB	38.50 ✓ 10.9 ✓	39.50 ✓ 1.9 ✓
4+88 on South - 8.88	39.80	
3+00 = EL Evergreen	40.60 ✓	43.00 ✓
end of st on east side Evergreen	40.80	44.9
WL Evergreen	45.60 ✓ 1.10	48.10 ✓ 1.6

+1.0 = 0.6 grade
wall in pole

8.06 ramp Rosecrans + Lowell

	9.2	9.3	9.5	9.8	10.2	11.0	12.0	13.0	13.6
15.65									
7.83									
8.12 = CT. IN Paving = AM.									
11.50									
19.50									
0.30									
19.20									
16.85									
51.67									
0.14									
31.53									
12.54									
42.99									
0.29									
42.00									
12.60									
10.65									
11.05									
45.60 = spike									
0.14									
45.74									
15.29									
37.56									
0.16									
33.02									
12.69									
20.33									
0.06									
20.39									
12.25									
8.11									
8.11 = ad arrow									
56.6									
5.1									
6.7									
-1.6									
8.14									
10.93									
19.05									
16.50									
10.57									
19.07									
0.07									
18.80									
12.63									
41.43									
0.26									
40.67									
10.09									
50.76									

41.05 = spike in elec. pole SW Cor. Newell + Evergreen

NOTE page for RETURN Grades

Newell ST Grading

PC	PT	ST	ST	ST	ST	PC
6.0	6.7	7.0	7.5	8.0	9.0	
15.6	13.4	12.7	12.2	11.9	10.8	
+3.1	+3.3	+4.9	+3.3	+3.7	+3.7	

13.06 F.H.
6.31
5.91
+0.40

PC	PT	ST	ST	ST	ST	PC
16.8	18.0	19.4	21.0	23.0	25.0	
14.4	13.4	11.7	10.4	9.2	6.0	
+4.0	+4.6	+3.0	+2.0	+2.7	+4.0	

F.V.C
27.1
3.7
4.1
-0.4

PC	EL Evergreen	EL	EL
38.0	43.0 = WL	38.6 = F.H.	
4.5	8.0	4.9	
-1.7	1.9	1.7	
	+6.1		

38.6 = F.H.
4.9
1.7 = top marks edge of

8.14
16.24
19.37
0.80
10.97
10.21
1.18
3 0.33
30.8
1.20
43.48
0.48
43.07
7.96
1.03
44.04

8.14
6.44
14.64
1.90
12.64
8.39
40.73
1.14
19.81
12.37
30.18
1.22
30.96
16.64
43.61
2.09
41.59
5.12
46.71

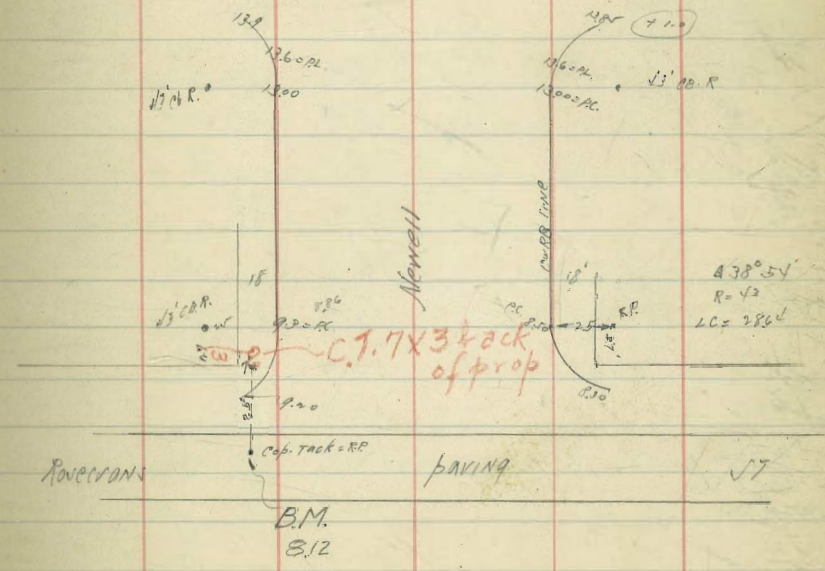
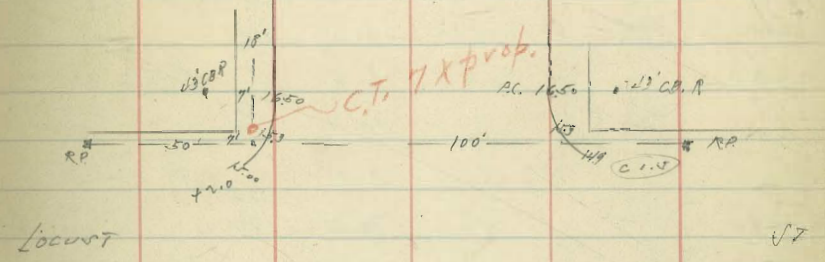
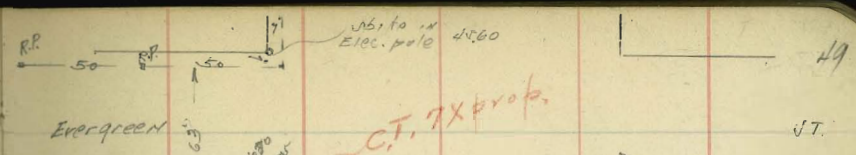

Moore 6" Water Main
Oliver & Gresham

Petersen
28.54
0.09
NEED
Circuit Case

Station	F.H. NE. Cor.	FL	Notes
WL DAWES = 0+00	3.63	-0.5	
0+40	4.76	-0.3	
0+80 = EL DAWES BREAK		-0.1	
1+30		+0.2	
1+80 = BREAK		0.6	
2+20		1.0	
+60		1.6	
3		2.3	
+40		3.1	
4+00		4.6	
+60		6.1	
5+20		7.6	
+80 = WL Everett	F.H. SE COR	9.2	
6+20		9.9	
6+60 = EL "		10.7	
7+10		11.3	
+60		12.0	
8+10		12.6	
+60		13.2	
9+10		13.9	
+60		14.5	
10+10		15.2	
+60		15.8	
11+10		16.4	
+60 = WL FANUEL		17.1	

Station	F.H. NE. Cor	FL	Notes
14+10 = 6"x8" CIRCROSS	31.10	17.8	
+40 = EL FANUEL		18.3	
		19.3	
		20.4	
		21.4	
		22.4	
15+00 = P.V.C.		23.5	
+40 BREAK		24.0	
+80 "		24.3	
16+20 "		24.3	
+60 = E.V.C		24.1	
17		23.1	
+40 = WL Gresham	F.H. SE COR	22.1	
+90 = 6" CIRCROSS		22.0	
18+20 = EL Gresham		21.8	
25+0 = T			

18.1 17.8 17.7 210 = ch grade 31.10
7.6 8.0 8.1 4.60
7.7 Low 8.1 4.00
0.1 Low 10.58

should be
16.63

next page for Gresham to south

Water Main Grasham ST cont.

1350 ft

	FL		
6 7 (60)	5.0	8.5 3.5	
7 14+00 = N.W. Estrella Pl.	3.7	10.1 7.7 +2.4	
+20 = BREAK 2" "	2.0	12.8 10.8 +2.0	
+30 = 6" C.I. Tee A 90° LT.	2.0	1.5 2.0 +0.5	F.H. N.E. Cor.
14 +60 = E.L. Grasham ST.	3.0	10.8 7.8 3.0	6" N
		10.0 7.0 +3.0 = 6 grade	
1	3.8	9.1 2.0 +7.1	
4 (55.15)	4.7	8.3 5.6 +2.7	
2	5.5	7.4 2.9 +4.5	
4 = 16+80.6 = W.L. Frontera ST EX. 4" Gate Valve.	6.4		

9.22
4.97
14.19

6.4
7.79
6.26
+1.53
14.19

Top of stem
of 4" Gate Valve

Moore 1/8/89 Runnymede Lane. Floyd-GRIMES

Sewer Main

Ex. Sewer Nk of Harbor View Dr 200

+ 50
+ 90
1 + 50
1 + 80 = DE

FL.	157.0	1911.9
	10.80	1913.4
	1.17	13.04
	+ 2.70	178.19
	+ 2.70	0.66
	153.0	178.95
	16.51	166.90
	6.60	13.71
	+ 2.70	169.80
	16.19	16.38
	6.29	157.44
	+ 2.70	0.67
	153.0	158.11
	15.88	6.55
	2.00	157.56
	15.88	1.91
	9.89	153.47
	+ 2.70	

STORM DRAIN #1

CD. inlet Box = 00 FL. of pipe
0 + 0.45 = angle
0 + 49 = BREAK
0 + 94 = " N7.50 = ct.
1 + 32.5
1 + 75 = "
1 + 88.7 = outlet

	148.0	51.50	51.50
	5.47	1.97	1.97
	1.03	1.06	1.03
	+ 4.24	+ 0.91	+ 0.32
	47.62	44.00	
	5.85	7.50	
	1.91	5.4	
	+ 3.94	+ 4.1	
	144.0		
	37.4		
	3.7	14.3	
	1.6	14.2	
	+ 2.1	2.5	
	114.3	+ 5.7	
	91.3		
	12.2	90.0	
	4.0	13.5	
	+ 4.2	13.5	
	90.0	0.0	

1 + 88 = 90.9
2.6
2.54

153.47
- 12.88
140.59
+ 0.83
141.12
- 12.85
128.27
+ 0.22
128.55
- 12.93
115.62
+ 0.07
115.63
- 12.92
102.71
+ 0.23
103.54

DE = 00

+ 45

+ 40

1 + 50

180 = EX Sewer

①	②	③	④
154.60	155.5	155.1	155.6
13.70	12.0	14.5	13.7
3.0	2.1	10.3	9.6
+ 10.7	+ 6.7	+ 3.9	+ 4.7

155.40

155.17

154.95

154.74

154.50

169.07

138.7
9.32
14.10
2.50
6.60

142.2
6.22
6.03
+ 8.10
6.60

147.7

509
32
477

52

Bunnyread Laxe

55

1/24/29
Moore

Golden Gate Drive Carroll

347.97 - SE corner Golden Gate + Cleveland

	PRE	PRE	PRE	PRE	PRE	PRE	PRE	PRE	PAC	
N	47.99	47.85	47.77	47.88	47.85	47.81	47.77	47.74	47.61	47.56
	4.84	4.78	4.91	4.95	4.78	4.80	4.86	5.11	4.00	4.93
										4.93
										4.10
N	47.78	48.06	48.14	48.20	48.30	48.38	48.46	48.54	48.65	
	4.85	4.77	4.69	4.61	4.53	4.45	4.37	4.28	4.18	
		4.41	3.99	3.91	4.03	4.45	4.27	3.87	3.78	
		4.15	3.90	3.7	4.5		3.87	3.88	3.78	
N	48.75	48.80	48.81	48.90	= cb and					
	4.05	4.03	3.95	3.93						

ELCLOWLAND

S	48.80	48.81	48.82	48.83	48.84	48.85	48.86	48.87	48.88	48.89	48.90
	4.83	4.77	4.61	4.50	4.39	4.28	4.17	4.06	3.95	3.83	3.72
				4.30	4.09	3.88	3.67	3.46	3.20	3.02	2.75
				4.02	4.03	4.04	4.07	4.06	4.04	4.03	4.10

inlet Culvert

343.0	342.0 = outlet
389	10.83
4.0	7.23
	4.38

curb cuts

347.97 B.M.
5.24
353.21 X
5.83
359.04 N.W. PC
5.77

347.97
5.47
353.44

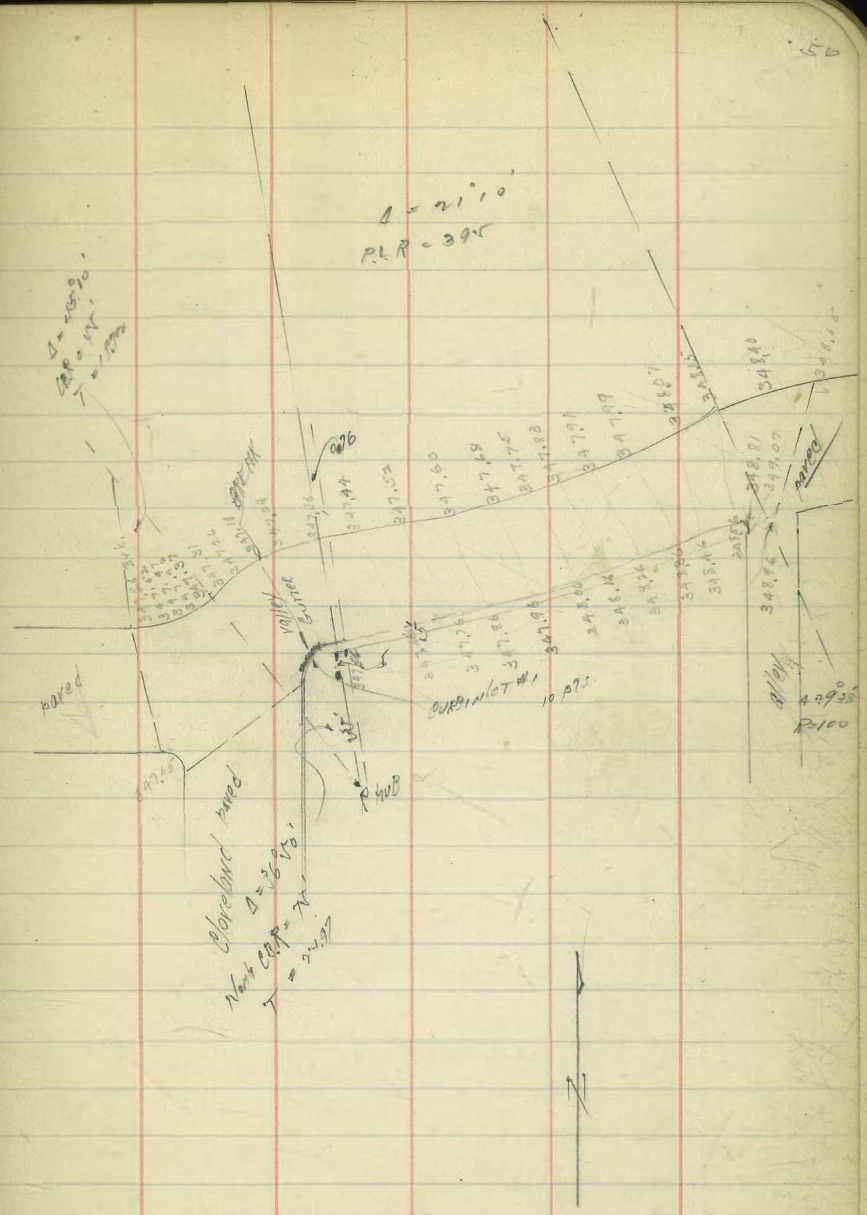

1/17/21
MOORE

New York St Paving
8" CURB EDGE 10' CURBS
5" CROWN

Carroll's Curve

	WCB	W. gut.	ECB	E. gut.
J.L. Madison +00	340.50		341.10	
	340.28		340.85	
+65	340.04		340.60	
+70 BREAK	339.60	338.93	340.10	339.43
+75	339.20	38.53	339.60	38.13
+70	338.70	37.53	338.50	38.13
+90	336.80	36.73	337.40	36.73
	335.0	34.33		
+10	334.60		335.40	34.73
	330.5			330.88
+150 end job	330.0		331.0	

Curv #1 = Top Curved
ENT 330.80
edge opening 2.98
+2.22

what edge opening
FL Ake
3.43
7.1.5
3.3
+8.2

J.L. Madison HVC

RP # 30 RP # 30

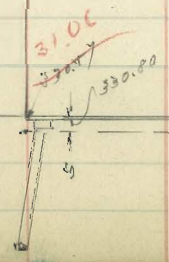

6 inches
10' from
prop line

W	40.50	40.0	39.6	39.2	38.4	36.8	34.6	30.0
	5.7	6.1	6.5	7.3	8.7	11.1	6.0	
	4.2	5.6	6.0	4.9	7.8	8.3	7.0	
	+1.3	+0.5	+0.5	+0.6	+1.1	+1.8	-1.0	

E	41.10	40.6	40.10	39.60	38.80	37.40	35.40	31.0
	5.1	5.6	6.1	6.9	4.3	12.3	5.0	
	4.2	5.0	5.7	4.6	7.2	11.6	5.5	
	+0.9	+0.6	+0.4	+0.3	+0.4	+1.3	-0.5	

340.51 R.M.S.W.
9.01

11.52
9.13
35.40
1.80
37.20

W	40.50	40.0	39.6	39.2	38.4	36.8	34.6	30.0
	5.7	6.1	6.5	7.3	8.7	11.1	6.0	
	4.2	5.6	6.0	4.9	7.8	8.3	7.0	
	+1.3	+0.5	+0.5	+0.6	+1.1	+1.8	-1.0	

340.51
5.22
343.73
12.69
333.04
2.90

336.02
12.67
323.38
1.44
324.82

342.51
5.11
345.62
9.62
335.09
308.09

E	41.10	40.6	40.1	39.6	38.8	37.4	35.4	31.0
	5.1	5.6	6.1	6.9	4.3	12.3	5.0	
	4.2	5.0	5.7	4.6	7.2	11.6	5.5	
	+0.9	+0.6	+0.4	+0.3	+0.4	+1.3	-0.5	

W. cb changed Grades

38.09
35.0
3.09

35.09
31.06
4.03

37.20 T W. End Cb inlet 6.61
E End Cb inlet 6.77

PT. LOMA B.M. 5

2/5/29 Moore
Flood
Colpman

Chapman Elliott	2.845	133.065		128.22	NEBP
T.P.	7.765	136.490	4.30	128.725	
Curtis + Clove			1.975	134.515	SWBP
CURTIS + PUM			5.205	131.285	SWBP
T.P.	0.51	132.17	4.83	126.6	
CURTIS Willow	0.585	119.730	13.025	119.145	SWBP
T.P.	0.22	107.01	12.94	106.79	
CURTIS Evergreen	0.46	95.845	11.625	95.385	SWBP
T.P.	0.37	83.205	13.01	82.835	
T.P.	0.225	70.77	12.73	70.475	
CURTIS Locust			1.46	69.31	SWBP
T.P.	0.18	58.17	12.78	57.99	
T.P.	4.0	51.295	10.975	47.195	
CURTIS + ROSEBANK			6.945	44.35	SWBP

South on Willow ST from Curtis

CURTIS Willow	12.235	131.38		119.145	SWBP
BROWNING Willow			1.51	129.87	SWBP
T.P.	5.845	121.29	12.945	118.425	
HICOTT Willow			8.54	112.75	SWBP
T.P.	12.375	133.51	0.155	121.135	
T.P.	7.965	141.24	0.225	133.275	
Willow Zola			3.095	138.145	SWBP
T.P.	14.28	153.155	0.365	140.875	
T.P.	14.47	165.615	0.01	153.145	
Willow Zephaniah			11.49	154.125	SWBP
T.P.	7.23	173.505	0.34	165.275	

PT. LOMA B.P.					30.60 Ros Canyon S.W.B.P. 61.70 Willow Canyon N.W.B.P.					
Willow Whittier		173.505	7.15	166.09	N.W.B.P.	Rosecrans & Lowell S.W.B.P.	17.235	9.17	8.065	Harro 3.06 Bliss = 2.05
T.P.	12.69	186.02	0.175	173.33		T.P.	12.66	29.715	0.15	17.085
T.P.	11.535	197.49	0.165	185.955		T.P.	12.37	41.865	0.25	29.425
Willow & Vidal			10.33	187.16	S.W.B.P.	T.P.	12.545	54.49	0.02	41.895
Willow Tomson			3.60	183.39	S.W.B.P.	Willow & Lowell	1.42	53.76	2.15	52.31
T.P.	0.26	185.65	12.12	185.27		T.P.	0.395	42.28	11.875	41.885
T.P.	0.31	172.875	13.045	192.585		Willow & Jarris			4.925	37.355 S.W.B.P.
Willow Russell			11.54	161.355	S.W.B.P.	T.P.	5.87	16.60	1.55	40.73
T.P.	9.305	181.355	0.945	172.05		T.P.	9.79	54.525	1.865	41.735
Willow Quimby			8.145	173.21	S.W.B.P.	Willow & Hugo			10.10	44.225 S.W.B.P.
Willow Tee			3.545	177.81	S.W.B.P.	" & Goethe			2.995	51.53 S.W.B.P.
T.P.	0.335	169.325	12.365	168.99		" & Fenelon	8.885	60.57	2.84	51.685 S.W.B.P.
T.P.	0.75	157.42	12.655	156.67		" & Emerson			2.80	57.72 S.W.B.P.
Willow Chapman			1.765	152.65	N.W.B.P.	T.P.	12.25	72.36	0.46	60.11
T.P.	0.475	144.915	12.92	144.50		T.P.	9.73	81.715	0.315	71.985
T.P.	1.115	133.485	12.605	132.37		Willow & Dickens?			5.185	76.53 Set 5.2. S.W. end of set.
T.P.	0.38	120.96	12.905	120.58		T.P.	10.37	91.405	0.68	81.035
T.P.	0.28	108.855	12.385	108.575		Willow & Carleton?			1.93	86.475 S.W.B.P.
T.P.	0.415	96.695	12.575	96.28		T.P.	6.32	96.99	0.735	90.67
T.P.	0.33	84.165	12.86	83.835		cut out — Not recorded — New Plug Set within year 1953			95.16	S.W.B.P. West of set
T.P.	0.21	72.195	12.78	71.385		Willow & Byron			2.41	94.58 S.W.B.P. & set
T.P.	1.415	60.88	12.73	59.465		T.P.	0.37	84.545	12.815	81.175
Willow Lowell			1.88	54.215	S.W.B.P.	T.P.	0.28	72.69	12.135	72.41
T.P.	0.00	41.255	12.960	41.255		Willow & Addison			1.095	71.595 S.W.B.P.
T.P.	0.185	28.39	12.95	28.105		" - Canyon Rd.	0.96	62.25	11.40	61.29 N.W.B.P.
T.P.	1.79	17.325	12.895	15.495		Canyon & Evergreen	0.37	49.97	12.65	49.60 S.W.B.P.
						T.P.	0.87	37.895	10.945	39.025
						Canyon & Locust	0.85	31.83	8.915	30.98 N.W.B.P.
						" & Rosecrans			11.10	20.73 S.W.B.P.

7-06 face
5-Crown

Madison Ave. GRADES

NL STA.	N CB	SL STA.	S CB
W.L. Mass. North of Madison	331.0		319.0
0	328.80		↑
0	326.65		↑ CURB IN
0	324.47		↓
0 2405.8 = New Hampsh.	322.30 ✓		321.50
0 +55.8 = WL	320.80 ✓		320.0
0	319.34		318.5
0	317.88		317.0
0	316.42		315.50
0	314.96		314.0
0 = 5+10	313.50		312.50
			↓ P.C. of CURB
			E.L. Golden Gate Jc = 8.12 P.C. 312.10 ON CURB

POWER CONSTRUCTION

EX MH	311.50	15.00	
0+40	312.0	5.00	
1+00 = DE	312.50	14.00	
		2.5	
		11.6	

321.50	320.0	15.5	17.0	15.5	14.0	13.5	12.1
320.0	319.0	1.0	1.0	1.0	1.0	1.0	1.0
319.0	318.0	1.0	1.0	1.0	1.0	1.0	1.0
318.0	317.0	1.0	1.0	1.0	1.0	1.0	1.0
317.0	316.0	1.0	1.0	1.0	1.0	1.0	1.0
316.0	315.0	1.0	1.0	1.0	1.0	1.0	1.0
315.0	314.0	1.0	1.0	1.0	1.0	1.0	1.0
314.0	313.0	1.0	1.0	1.0	1.0	1.0	1.0
313.0	312.0	1.0	1.0	1.0	1.0	1.0	1.0
312.0	311.0	1.0	1.0	1.0	1.0	1.0	1.0
311.0	310.0	1.0	1.0	1.0	1.0	1.0	1.0
310.0	309.0	1.0	1.0	1.0	1.0	1.0	1.0
309.0	308.0	1.0	1.0	1.0	1.0	1.0	1.0
308.0	307.0	1.0	1.0	1.0	1.0	1.0	1.0
307.0	306.0	1.0	1.0	1.0	1.0	1.0	1.0
306.0	305.0	1.0	1.0	1.0	1.0	1.0	1.0
305.0	304.0	1.0	1.0	1.0	1.0	1.0	1.0
304.0	303.0	1.0	1.0	1.0	1.0	1.0	1.0
303.0	302.0	1.0	1.0	1.0	1.0	1.0	1.0
302.0	301.0	1.0	1.0	1.0	1.0	1.0	1.0
301.0	300.0	1.0	1.0	1.0	1.0	1.0	1.0
300.0	299.0	1.0	1.0	1.0	1.0	1.0	1.0
299.0	298.0	1.0	1.0	1.0	1.0	1.0	1.0
298.0	297.0	1.0	1.0	1.0	1.0	1.0	1.0
297.0	296.0	1.0	1.0	1.0	1.0	1.0	1.0
296.0	295.0	1.0	1.0	1.0	1.0	1.0	1.0
295.0	294.0	1.0	1.0	1.0	1.0	1.0	1.0
294.0	293.0	1.0	1.0	1.0	1.0	1.0	1.0
293.0	292.0	1.0	1.0	1.0	1.0	1.0	1.0
292.0	291.0	1.0	1.0	1.0	1.0	1.0	1.0
291.0	290.0	1.0	1.0	1.0	1.0	1.0	1.0
290.0	289.0	1.0	1.0	1.0	1.0	1.0	1.0
289.0	288.0	1.0	1.0	1.0	1.0	1.0	1.0
288.0	287.0	1.0	1.0	1.0	1.0	1.0	1.0
287.0	286.0	1.0	1.0	1.0	1.0	1.0	1.0
286.0	285.0	1.0	1.0	1.0	1.0	1.0	1.0
285.0	284.0	1.0	1.0	1.0	1.0	1.0	1.0
284.0	283.0	1.0	1.0	1.0	1.0	1.0	1.0
283.0	282.0	1.0	1.0	1.0	1.0	1.0	1.0
282.0	281.0	1.0	1.0	1.0	1.0	1.0	1.0
281.0	280.0	1.0	1.0	1.0	1.0	1.0	1.0
280.0	279.0	1.0	1.0	1.0	1.0	1.0	1.0
279.0	278.0	1.0	1.0	1.0	1.0	1.0	1.0
278.0	277.0	1.0	1.0	1.0	1.0	1.0	1.0
277.0	276.0	1.0	1.0	1.0	1.0	1.0	1.0
276.0	275.0	1.0	1.0	1.0	1.0	1.0	1.0
275.0	274.0	1.0	1.0	1.0	1.0	1.0	1.0
274.0	273.0	1.0	1.0	1.0	1.0	1.0	1.0
273.0	272.0	1.0	1.0	1.0	1.0	1.0	1.0
272.0	271.0	1.0	1.0	1.0	1.0	1.0	1.0
271.0	270.0	1.0	1.0	1.0	1.0	1.0	1.0
270.0	269.0	1.0	1.0	1.0	1.0	1.0	1.0
269.0	268.0	1.0	1.0	1.0	1.0	1.0	1.0
268.0	267.0	1.0	1.0	1.0	1.0	1.0	1.0
267.0	266.0	1.0	1.0	1.0	1.0	1.0	1.0
266.0	265.0	1.0	1.0	1.0	1.0	1.0	1.0
265.0	264.0	1.0	1.0	1.0	1.0	1.0	1.0
264.0	263.0	1.0	1.0	1.0	1.0	1.0	1.0
263.0	262.0	1.0	1.0	1.0	1.0	1.0	1.0
262.0	261.0	1.0	1.0	1.0	1.0	1.0	1.0
261.0	260.0	1.0	1.0	1.0	1.0	1.0	1.0
260.0	259.0	1.0	1.0	1.0	1.0	1.0	1.0
259.0	258.0	1.0	1.0	1.0	1.0	1.0	1.0
258.0	257.0	1.0	1.0	1.0	1.0	1.0	1.0
257.0	256.0	1.0	1.0	1.0	1.0	1.0	1.0
256.0	255.0	1.0	1.0	1.0	1.0	1.0	1.0
255.0	254.0	1.0	1.0	1.0	1.0	1.0	1.0
254.0	253.0	1.0	1.0	1.0	1.0	1.0	1.0
253.0	252.0	1.0	1.0	1.0	1.0	1.0	1.0
252.0	251.0	1.0	1.0	1.0	1.0	1.0	1.0
251.0	250.0	1.0	1.0	1.0	1.0	1.0	1.0
250.0	249.0	1.0	1.0	1.0	1.0	1.0	1.0
249.0	248.0	1.0	1.0	1.0	1.0	1.0	1.0
248.0	247.0	1.0	1.0	1.0	1.0	1.0	1.0
247.0	246.0	1.0	1.0	1.0	1.0	1.0	1.0
246.0	245.0	1.0	1.0	1.0	1.0	1.0	1.0
245.0	244.0	1.0	1.0	1.0	1.0	1.0	1.0
244.0	243.0	1.0	1.0	1.0	1.0	1.0	1.0
243.0	242.0	1.0	1.0	1.0	1.0	1.0	1.0
242.0	241.0	1.0	1.0	1.0	1.0	1.0	1.0
241.0	240.0	1.0	1.0	1.0	1.0	1.0	1.0
240.0	239.0	1.0	1.0	1.0	1.0	1.0	1.0
239.0	238.0	1.0	1.0	1.0	1.0	1.0	1.0
238.0	237.0	1.0	1.0	1.0	1.0	1.0	1.0
237.0	236.0	1.0	1.0	1.0	1.0	1.0	1.0
236.0	235.0	1.0	1.0	1.0	1.0	1.0	1.0
235.0	234.0	1.0	1.0	1.0	1.0	1.0	1.0
234.0	233.0	1.0	1.0	1.0	1.0	1.0	1.0
233.0	232.0	1.0	1.0	1.0	1.0	1.0	1.0
232.0	231.0	1.0	1.0	1.0	1.0	1.0	1.0
231.0	230.0	1.0	1.0	1.0	1.0	1.0	1.0
230.0	229.0	1.0	1.0	1.0	1.0	1.0	1.0
229.0	228.0	1.0	1.0	1.0	1.0	1.0	1.0
228.0	227.0	1.0	1.0	1.0	1.0	1.0	1.0
227.0	226.0	1.0	1.0	1.0	1.0	1.0	1.0
226.0	225.0	1.0	1.0	1.0	1.0	1.0	1.0
225.0	224.0	1.0	1.0	1.0	1.0	1.0	1.0
224.0	223.0	1.0	1.0	1.0	1.0	1.0	1.0
223.0	222.0	1.0	1.0	1.0	1.0	1.0	1.0
222.0	221.0	1.0	1.0	1.0	1.0	1.0	1.0
221.0	220.0	1.0	1.0	1.0	1.0	1.0	1.0
220.0	219.0	1.0	1.0	1.0	1.0	1.0	1.0
219.0	218.0	1.0	1.0	1.0	1.0	1.0	1.0
218.0	217.0	1.0	1.0	1.0	1.0	1.0	1.0
217.0	216.0	1.0	1.0	1.0	1.0	1.0	1.0
216.0	215.0	1.0	1.0	1.0	1.0	1.0	1.0
215.0	214.0	1.0	1.0	1.0	1.0	1.0	1.0
214.0	213.0	1.0	1.0	1.0	1.0	1.0	1.0
213.0	212.0	1.0	1.0	1.0	1.0	1.0	1.0
212.0	211.0	1.0	1.0	1.0	1.0	1.0	1.0
211.0	210.0	1.0	1.0	1.0	1.0	1.0	1.0
210.0	209.0	1.0	1.0	1.0	1.0	1.0	1.0
209.0	208.0	1.0	1.0	1.0	1.0	1.0	1.0
208.0	207.0	1.0	1.0	1.0	1.0	1.0	1.0
207.0	206.0	1.0	1.0	1.0	1.0	1.0	1.0
206.0	205.0	1.0	1.0	1.0	1.0	1.0	1.0
205.0	204.0	1.0	1.0	1.0	1.0	1.0	1.0
204.0	203.0	1.0	1.0	1.0	1.0	1.0	1.0
203.0	202.0	1.0	1.0	1.0	1.0	1.0	1.0
202.0	201.0	1.0	1.0	1.0	1.0	1.0	1.0
201.0	200.0	1.0	1.0	1.0	1.0	1.0	1.0
200.0	199.0	1.0	1.0	1.0	1.0	1.0	1.0
199.0	198.0	1.0	1.0	1.0	1.0	1.0	1.0
198.0	197.0	1.0	1.0	1.0	1.0	1.0	1.0
197.0	196.0	1.0	1.0	1.0	1.0	1.0	1.0
196.0	195.0	1.0	1.0	1.0	1.0	1.0	1.0
195.0	194.0	1.0	1.0	1.0	1.0	1.0	1.0
194.0	193.0	1.0	1.0	1.0	1.0	1.0	1.0
193.0	192.0	1.0	1.0	1.0	1.0	1.0	1.0
192.0	191.0	1.0	1.0	1.0	1.0	1.0	1.0
191.0	190.0	1.0	1.0	1.0	1.0	1.0	1.0
190.0	189.0	1.0	1.0	1.0	1.0	1.0	1.0
189.0	188.0	1.0	1.0	1.0	1.0	1.0	1.0
188.0	187.0	1.0	1.0	1.0	1.0	1.0	1.0
187.0	186.0	1.0	1.0	1.0	1.0	1.0	1.0
186.0	185.0	1.0	1.0	1.0	1.0	1.0	1.0

Job Face
 Approved
 Mass. St. North of Madron

W.L. STA.	W.C.B.	EL. W.T.O.	E. C.B.
N.L. Mad. Ave. = 0+00	331.70		332.76
		0+10	332.85
		0+20	333.0
		0+50	334.0
1+00 = P.V.C.	334.60	1+00	334.60
+20	335.0		336.0
+40	335.40		336.40
+60	335.60		336.60
+80	335.70		336.70
2+00 = E.V.C.	335.60		336.60
+375			336.84
			336.0
			335.78
2+75 = S.L. Golden Gate	334.60		335.40

Curve in

33303
 719
 340.24
 DP
 NE Cor Mad + Madcs

R	32.7	32.3	33.0	34.0	34.5	36.0	36.0	36.6	36.7
	7.2	7.2	7.2	6.2	4.6	4.2	3.8	3.6	3.5
	6.1	5.0	4.6	4.0	3.4	3.6	3.0	3.0	3.2
	+1.4	+2.4	+2.6	+2.2	+0.7	+0.6	+0.8	+0.6	+0.3
W					34.6				
					5.6				
E	36.60	36.0	35.4						
	5.6	4.2	4.8						
	3.2	4.0	4.2						
	2.1	4.0	4.2						
W	34.6								
	4.6								

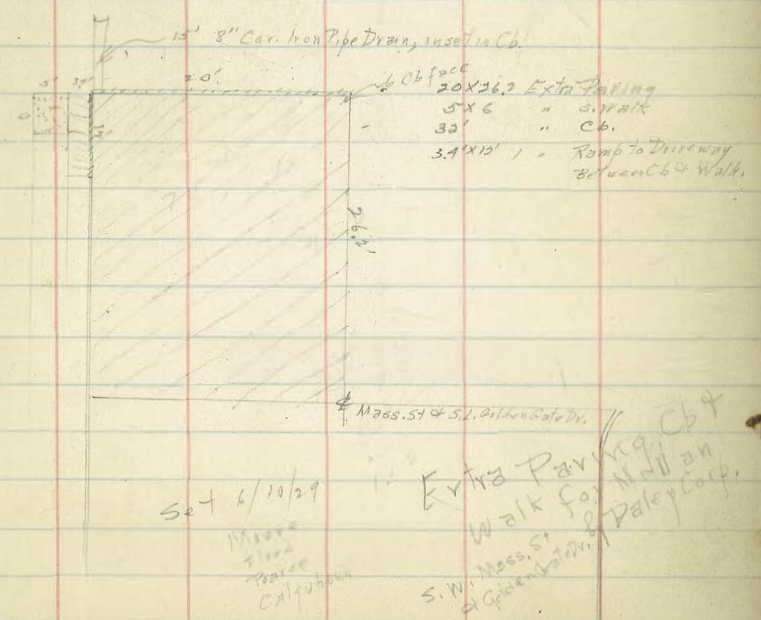

7-66 Face
at crown

Mass. ST South of Mad.

64

	W/CB	ECB
L Mad = 0+00	332.0	333.0
0+50	329.20	330.40
1	326.40	327.40
+50	323.60	324.60
2	320.80	321.80
3 +50 = PC. ONE L. opposite Curb	OUT	319.56 PC. RETURN
4 +50 = PC. of Curb W.	318.0	N.L. Hoffman 319.0

333.03
1.26
334.99
12.05
347.04
0.7
343.21
12.89
310.32
0.46
310.78
12.93
327.85
0.53
328.38 = π
12.73
324.65
1.77
326.42

	W	332.0	329.2	26.2	23.4	20.8	18.0	N.L. Hoffman
		2.99	7.8	8.6	11.4	2.4	7.1	
			6.1	9.3	11.2	2.0	7.1	
			-0.3	-0.7	+0.2	+0.4	-7.1	
	E	333.0	302	27.4	24.6	21.8	19.0	19.0 = N
			1.99	4.8	7.6	10.4	14	4.2
				2.8	7.0	10.1	12.2	5.2
				+2.0	+0.6	+0.3	+1.2	3.0
								0.0

SE for Hoffman + Mass = 317.5
6.7
3.2
-14.4
318.0
317.5
317.0
316.5
316.0
315.5
315.0
314.5
314.0
313.5
313.0
312.5
312.0
311.5
311.0
310.5
310.0
309.5
309.0
308.5
308.0
307.5
307.0
306.5
306.0
305.5
305.0
304.5
304.0
303.5
303.0
302.5
302.0
301.5
301.0
300.5
300.0
299.5
299.0
298.5
298.0
297.5
297.0
296.5
296.0
295.5
295.0
294.5
294.0
293.5
293.0
292.5
292.0
291.5
291.0
290.5
290.0
289.5
289.0
288.5
288.0
287.5
287.0
286.5
286.0
285.5
285.0
284.5
284.0
283.5
283.0
282.5
282.0
281.5
281.0
280.5
280.0
279.5
279.0
278.5
278.0
277.5
277.0
276.5
276.0
275.5
275.0
274.5
274.0
273.5
273.0
272.5
272.0
271.5
271.0
270.5
270.0
269.5
269.0
268.5
268.0
267.5
267.0
266.5
266.0
265.5
265.0
264.5
264.0
263.5
263.0
262.5
262.0
261.5
261.0
260.5
260.0
259.5
259.0
258.5
258.0
257.5
257.0
256.5
256.0
255.5
255.0
254.5
254.0
253.5
253.0
252.5
252.0
251.5
251.0
250.5
250.0
249.5
249.0
248.5
248.0
247.5
247.0
246.5
246.0
245.5
245.0
244.5
244.0
243.5
243.0
242.5
242.0
241.5
241.0
240.5
240.0
239.5
239.0
238.5
238.0
237.5
237.0
236.5
236.0
235.5
235.0
234.5
234.0
233.5
233.0
232.5
232.0
231.5
231.0
230.5
230.0
229.5
229.0
228.5
228.0
227.5
227.0
226.5
226.0
225.5
225.0
224.5
224.0
223.5
223.0
222.5
222.0
221.5
221.0
220.5
220.0
219.5
219.0
218.5
218.0
217.5
217.0
216.5
216.0
215.5
215.0
214.5
214.0
213.5
213.0
212.5
212.0
211.5
211.0
210.5
210.0
209.5
209.0
208.5
208.0
207.5
207.0
206.5
206.0
205.5
205.0
204.5
204.0
203.5
203.0
202.5
202.0
201.5
201.0
200.5
200.0
199.5
199.0
198.5
198.0
197.5
197.0
196.5
196.0
195.5
195.0
194.5
194.0
193.5
193.0
192.5
192.0
191.5
191.0
190.5
190.0
189.5
189.0
188.5
188.0
187.5
187.0
186.5
186.0
185.5
185.0
184.5
184.0
183.5
183.0
182.5
182.0
181.5
181.0
180.5
180.0
179.5
179.0
178.5
178.0
177.5
177.0
176.5
176.0
175.5
175.0
174.5
174.0
173.5
173.0
172.5
172.0
171.5
171.0
170.5
170.0
169.5
169.0
168.5
168.0
167.5
167.0
166.5
166.0
165.5
165.0
164.5
164.0
163.5
163.0
162.5
162.0
161.5
161.0
160.5
160.0
159.5
159.0
158.5
158.0
157.5
157.0
156.5
156.0
155.5
155.0
154.5
154.0
153.5
153.0
152.5
152.0
151.5
151.0
150.5
150.0
149.5
149.0
148.5
148.0
147.5
147.0
146.5
146.0
145.5
145.0
144.5
144.0
143.5
143.0
142.5
142.0
141.5
141.0
140.5
140.0
139.5
139.0
138.5
138.0
137.5
137.0
136.5
136.0
135.5
135.0
134.5
134.0
133.5
133.0
132.5
132.0
131.5
131.0
130.5
130.0
129.5
129.0
128.5
128.0
127.5
127.0
126.5
126.0
125.5
125.0
124.5
124.0
123.5
123.0
122.5
122.0
121.5
121.0
120.5
120.0
119.5
119.0
118.5
118.0
117.5
117.0
116.5
116.0
115.5
115.0
114.5
114.0
113.5
113.0
112.5
112.0
111.5
111.0
110.5
110.0
109.5
109.0
108.5
108.0
107.5
107.0
106.5
106.0
105.5
105.0
104.5
104.0
103.5
103.0
102.5
102.0
101.5
101.0
100.5
100.0
99.5
99.0
98.5
98.0
97.5
97.0
96.5
96.0
95.5
95.0
94.5
94.0
93.5
93.0
92.5
92.0
91.5
91.0
90.5
90.0
89.5
89.0
88.5
88.0
87.5
87.0
86.5
86.0
85.5
85.0
84.5
84.0
83.5
83.0
82.5
82.0
81.5
81.0
80.5
80.0
79.5
79.0
78.5
78.0
77.5
77.0
76.5
76.0
75.5
75.0
74.5
74.0
73.5
73.0
72.5
72.0
71.5
71.0
70.5
70.0
69.5
69.0
68.5
68.0
67.5
67.0
66.5
66.0
65.5
65.0
64.5
64.0
63.5
63.0
62.5
62.0
61.5
61.0
60.5
60.0
59.5
59.0
58.5
58.0
57.5
57.0
56.5
56.0
55.5
55.0
54.5
54.0
53.5
53.0
52.5
52.0
51.5
51.0
50.5
50.0
49.5
49.0
48.5
48.0
47.5
47.0
46.5
46.0
45.5
45.0
44.5
44.0
43.5
43.0
42.5
42.0
41.5
41.0
40.5
40.0
39.5
39.0
38.5
38.0
37.5
37.0
36.5
36.0
35.5
35.0
34.5
34.0
33.5
33.0
32.5
32.0
31.5
31.0
30.5
30.0
29.5
29.0
28.5
28.0
27.5
27.0
26.5
26.0
25.5
25.0
24.5
24.0
23.5
23.0
22.5
22.0
21.5
21.0
20.5
20.0
19.5
19.0
18.5
18.0
17.5
17.0
16.5
16.0
15.5
15.0
14.5
14.0
13.5
13.0
12.5
12.0
11.5
11.0
10.5
10.0
9.5
9.0
8.5
8.0
7.5
7.0
6.5
6.0
5.5
5.0
4.5
4.0
3.5
3.0
2.5
2.0
1.5
1.0
0.5
0.0

333.03
2.80
335.83
11.35
329.94
3.23
327.71
2.10
314.90
4.73
323.13

8

Convent #1	Fr. Box	Brk	0+66.33	1+09.7	OUTLET
0+00	0+00	0+23			1+53
316.75	299.00	289.0	283.0	277.0	271.0
5.97	11.8	9.4	6.4	3.4	1.6
6.03	6.0	3.5	0.6	1.1	
14.00	17.8	13.0	8.8	4.5	
299.0	288.0	280.0	276.0		
	9.9	13.9	17.1	20.9	
	1.8	6.0	1.9	7.6	
	1.0	7.8	2.0	15.5	

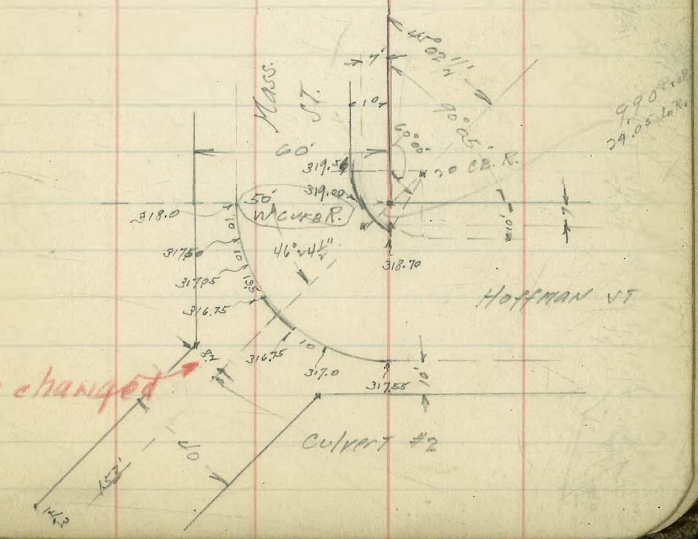

Alley PAVING

Between MASS. + New Hamp - Madison South
0.3 DIP ON E SIDE

	W.L.	F.L.
V.L. Mad = 0400	326.40	326.70
0 + 50	323.74	323.96
1	321.04	321.22
+ 50	318.36	318.48
2	315.68	315.74
+ 50 = South end alley	313.0	313.0

Sewer Construction

on Mad. Ave at New Hampshire
F.L.

Upper Fl. at Ex. Mt. = 0400	311.50
0 + 50	312.0
1 + 00 = D.E.	312.50

338,037 N. W. Madison + Mass.

63

1.78							
324.82							
12.85							
321.97							
2.01	W	20.40	23.72	21.04	18.26	15.68	313.0
323.98		1.92	11.18	2.94	5.62	8.30	10.98
7.86		8.11	10.82	2.71	3.93	6.43	11.38
316.12		+ 3.8	+ 1.22	+ 1.25	+ 1.47	- 1.12	- 1.40
7.39							
323.73	E	26.70	23.96	21.22	18.48	15.74	313.0
1.85		8.12	10.86	13.60	5.50	8.24	10.98
321.88		7.92	9.33	12.44	4.82	7.64	10.98
321.56		+ 7.0	+ 1.53	+ 1.16	+ 0.68	+ 0.60	
1.01							

3.61	1.37	19.25
0.60	12	
3.01	4.25	1.95
15.74	15.69	
18.75	19.95	
1.20		
19.95		
19.94		
7.48		
12.48		

Reference Points Madison Ave
New Hampshire + Mass. Ave.

Golden Gate Dr.

64

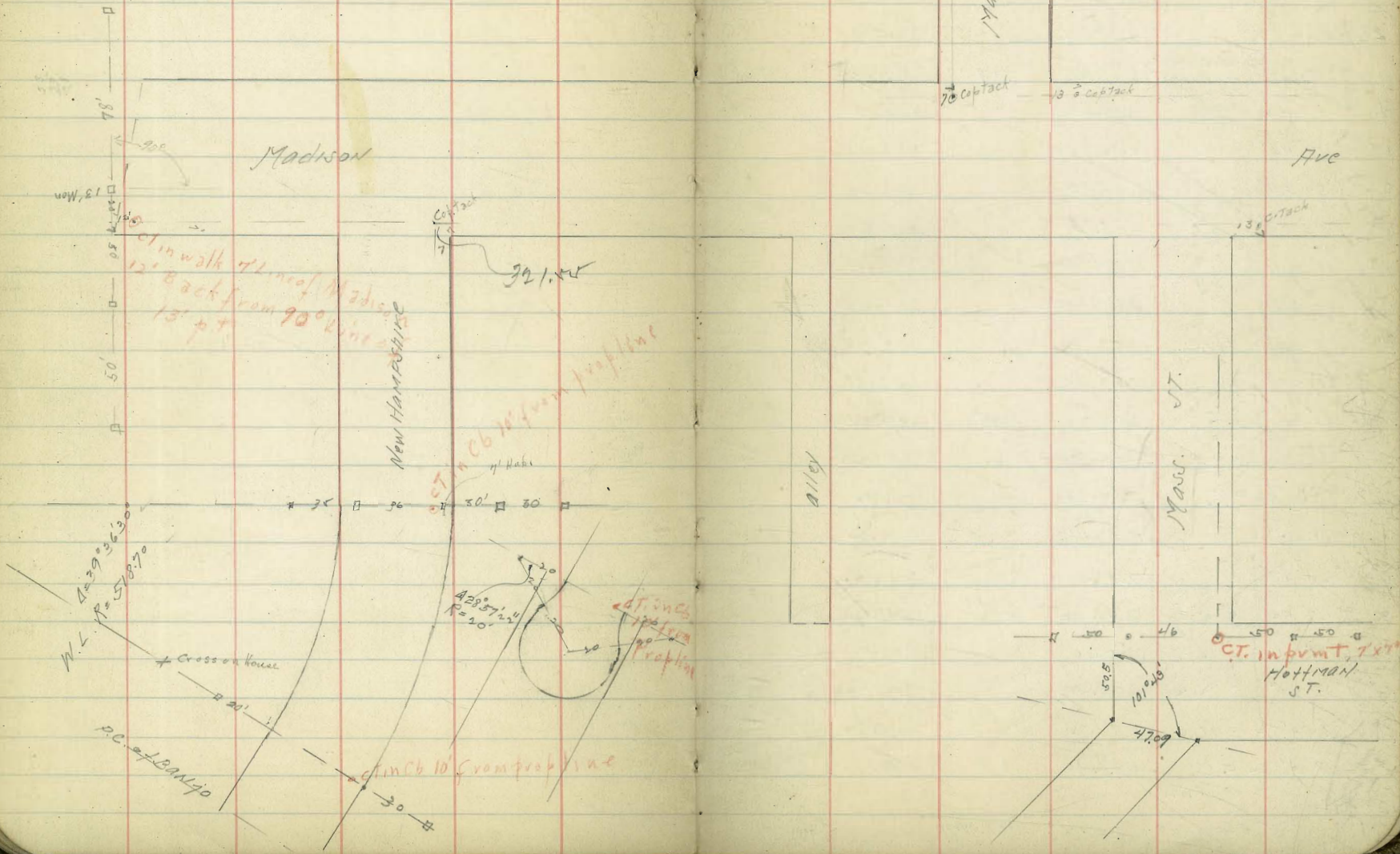

0.5 = ob. face New Hampshire ST
0.3 = crown

	W.C.B.	E.C.B.	
N.L. Madison = 0+00	320.50	321.50	
0+40	317.55	318.55	
1 = BREAK	314.60	315.60	
7+50	311.95	312.85	
8+00 = P.C.	309.30 ✓	310.10 ✓	
0 0° 54' 13" def=0°54'13" WL=16.25	308.45 ✓ 16.67	309.10 ✓ 17.67	
0 1° 48' 26" EL=17.95 = P.V.C.	307.60 ✓	308.10 ✓	
0 2° 51' 40"	306.70 ✓	307.40 ✓	
0 3° 54' 54"	305.80 ✓	306.30 ✓	
0 4° 58' 08" def=1°23'14" WL=19.10 EL=30.90	305.10 ✓ 19.11	305.60 ✓ 20.55	
0 6° 01' 22"	304.50 ✓	305.0 ✓	
0 7° 04' 36"	304.10 ✓	304.60 ✓	
0 8° 07' 50" = E.V.C.	303.70 ✓	304.20 ✓	
0 9° 10' 25"	303.45 ✓	303.87 ✓	
0 10° 13' 00" def=1°07'55" WL=18.04 EL=20.75	303.20 ✓ 18.25	303.55 ✓ 20.34	
0 11° 15' 35"	302.95 ✓	303.22 ✓	
0 12° 18' 10" = P.V.C.	302.70 ✓	302.90 ✓	
0 13° 21' 24"	302.40 ✓	302.60 ✓	
0 14° 24' 38"	302.0 ✓	302.20 ✓	
0 15° 27' 52" def=1°02'14" WL=19.10 EL=20.90	301.60 ✓ 19.41	301.60 ✓ 20.34	
0 16° 31' 06"	301.0 ✓	301.0 ✓	
0 17° 34' 20"	300.40 ✓	300.40 ✓	
0 18° 37' 34" = E.V.C.	299.70 ✓	299.70 ✓	
19° 48' 15" = E.C. 5+58.57 def=1°10'41" WL=21.33 EL=23.38	298.90 ✓ 23.74	298.90 ✓ 23.99	

CON'T. NEXT PAGE

321.55 S.E. Tack 1000.004 1/4

	320.50	317.55	314.60	311.95	309.30
	323.71 12.22 310.49 2.07 312.54 W. 12.87 325.41	317.55 5.86 5.70 +1.90	314.60 8.81 8.3 +0.5	311.95 11.16 10.80 +0.4	309.30 3.2 3.2
	308.45 4.1 4.0 +0.1	307.6 4.7 4.7 +0.2	306.7 5.9 5.2 +0.1	305.8 6.7 7.1 -0.4	305.1 7.2 7.8 -0.4
	304.5 8.0 8.2 +0.5	304.5 4.1 8.4 8.3 +0.1	303.7 8.8 8.4 +0.8	302.8 9.1 8.9 +0.2	302.2 8.3 8.0 +0.3
	302.95 4.6 4.2 30.4 301.0 11.0 9.8 +1.2	302.95 2.7 9.8 9.2 +0.6 300.1 10.1 10.5 +1.0	302.7 2.7 10.1 8.9 +1.2 299.7 12.1 12.5 +1.5	302.0 2.0 10.5 9.0 +1.5 299.7 13.6 13.1 +1.5	301.6 1.6 10.7 9.9 +1.6
	308.1 1.44 3.2 +1.7	318.55 7.3 5.34 +4.2	315.60 7.71 7.78 +2.0	312.55 10.56 8.0 +2.0	310.10 3.44 0.8 +2.7
	304.2 9.34 19.1 -5.1	309.55 3.81 8.67 12.0 -4.1	305.60 3.55 7.0 12.8 -3.5	302.55 3.62 9.32 17.8 -2.5	309.10 3.40 2.8 +1.4
	302.2 10.3 10.5 +0.1	302.2 1.6 10.9 10.5 +0.4	300.40 1.0 11.0 12.3 +0.7	299.70 300.40 12.1 12.5 +0.9	298.9 2.6 7.7 12.8 12.8 +0.7

64

New Hampshire

58 WCB Ecb
 6+14.57 = P.C. of Banjo 296.75 296.75
 56 P.R.C. 296.37 296.37
 opposite Cr. of Banjo 296.0 296.0
 Top of E inlet 295.0

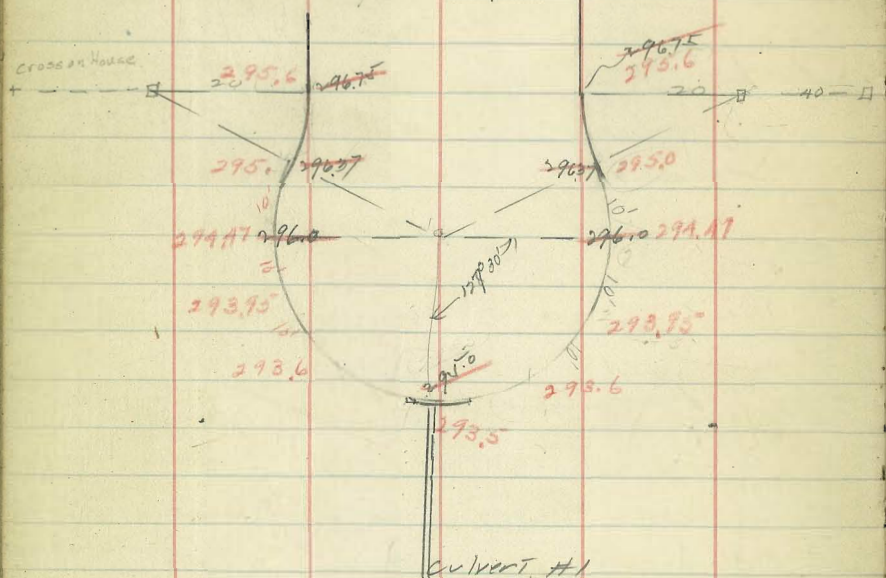

Culvert #1

Culvert #1

Top of RAs $\frac{295.0}{8.23}$ $\frac{11.97}{-1.74}$	FL Box $\frac{304.28}{289.5}$ $\frac{14.73}{10.27}$ $\frac{3.00}{+3.76}$	$\frac{0+32.5}{291.3}$ $\frac{289.7}{7.6}$ $\frac{5.0}{+2.1}$	$\frac{0+65}{291.3}$ $\frac{288.0 = outlet}{13.3}$ $\frac{12.1}{+1.2}$
---	---	---	--

304.08 N.E. Cor. Porch Pillar

66

$\frac{304.23}{12.82}$
 $\frac{291.31}{0.03}$
 $\frac{291.28}{0.04}$
 $\frac{291.30}{12.90}$
 $\frac{304.20}{7.57}$
 $\frac{296.63}{299.50}$
 $\frac{296.65}{0.05}$

~~$\frac{304.23}{21.75}$
 $\frac{7.77}{8.1}$
 $\frac{-0.7}{-1.9}$~~

$\frac{304.2}{296.0}$
 $\frac{8.2}{8.6}$
 $\frac{-1.4}{-1.4}$

~~$\frac{304.2}{296.0}$
 $\frac{8.2}{8.6}$
 $\frac{-1.4}{-1.4}$~~

~~$\frac{304.2}{296.75}$
 $\frac{7.5}{4.3}$
 $\frac{+1.9}{+1.9}$~~

~~$\frac{304.2}{296.0}$
 $\frac{8.2}{8.6}$
 $\frac{-1.4}{-1.4}$~~

$\frac{304.08}{0.20}$
 $\frac{304.28}{0.20}$

W. $\frac{04.28}{95.6}$ 1.78
 $\frac{8.68}{9.97}$ 11.3
 $\frac{15.25}{+0.4}$ 15.25
 $\frac{-9.2}{-9.2}$

$\frac{304.08}{0.24}$
 $\frac{304.32}{0.24}$

E $\frac{04.28}{5.6}$ 0.78
 $\frac{8.68}{6.87}$ 11.3
 $\frac{11.76}{+2.3}$ 11.76
 $\frac{+3.0}{+3.0}$

$\frac{304.32}{293.8}$ 304.02
 $\frac{11.02}{293.5}$ 11.02

1st & Nutmeg

		W. Side Paving Grade	East Side
0+00 = 150' S. of 1st Nutmeg		223.3	223.51
0+25	Brk	223.1	223.0
0+50	"	223.0	222.7 on grating
0+70		223.1	222.9
0+90		224.1	223.8
1+10		225.3	225.0
1+30		226.9	226.0
1+40		227.9	227.4
1+50 = 5L Nutmeg		228.9	228.2
1+50	cb. grade	228.9	
1+70 = 4 inch on vics. top		228.9	
1+90 = 1/2 Nutmeg		228.9	
2+30 = N.L. Nutmeg		228.9	229.5 raised
2+80	Brk	229.5	230.3
3+30	"	229.8	230.8
3+80	"	229.2	230.3
4+30	End Job	227.0 on grating	229.3

Culvert #1

Top grating = Pavt grade	227.0
Flow line Box	225.0
Flow line outlet	212.5

Culvert #2

Cb Grade	228.9
Grating	227.9
Flow line	To be determined by existing pipe

N.W. 1st Maple

W. Side	W. Side	W. Side	W. Side	W. Side	W. Side	W. Side	W. Side	W. Side
23.97	23.62	23.62	23.62	23.62	23.62	23.62	23.62	23.62
9.65	23.1	23.1	23.1	24.1	25.2	26.2	27.2	27.8
233.62	10.32	10.52	10.62	10.72	9.52	8.72	6.72	5.72

W. Side

33.62	33.62	33.62	33.62	33.62	33.62	33.62	33.62	33.62
25.7	25.7	25.7	25.7	25.7	25.7	25.7	25.7	25.7
4.72	4.72	4.66	5.22	4.12	3.72	4.22	4.22	6.62

E. Side

23.2	22.7	22.7	23.2	25.0	26.5	27.4	28.2	29.5
10.62	10.92	10.72	9.82	8.62	7.12	6.22	5.82	4.12

30.3	30.8	30.3	29.3
5.32	7.82	8.32	4.32

Culvert #1

33.62	23.62	33.62
27.1	27.1	18.72
6.62	6.62	10.72
		73.96
		+1.2

Culvert #2

33.62
27.1
5.72
5.22
+1.50

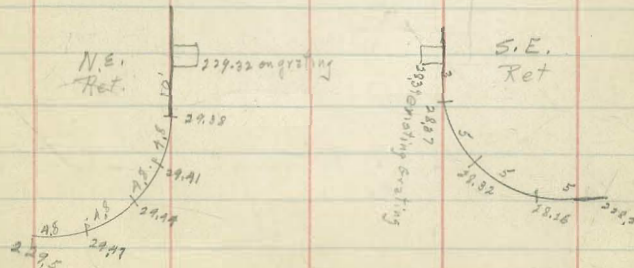

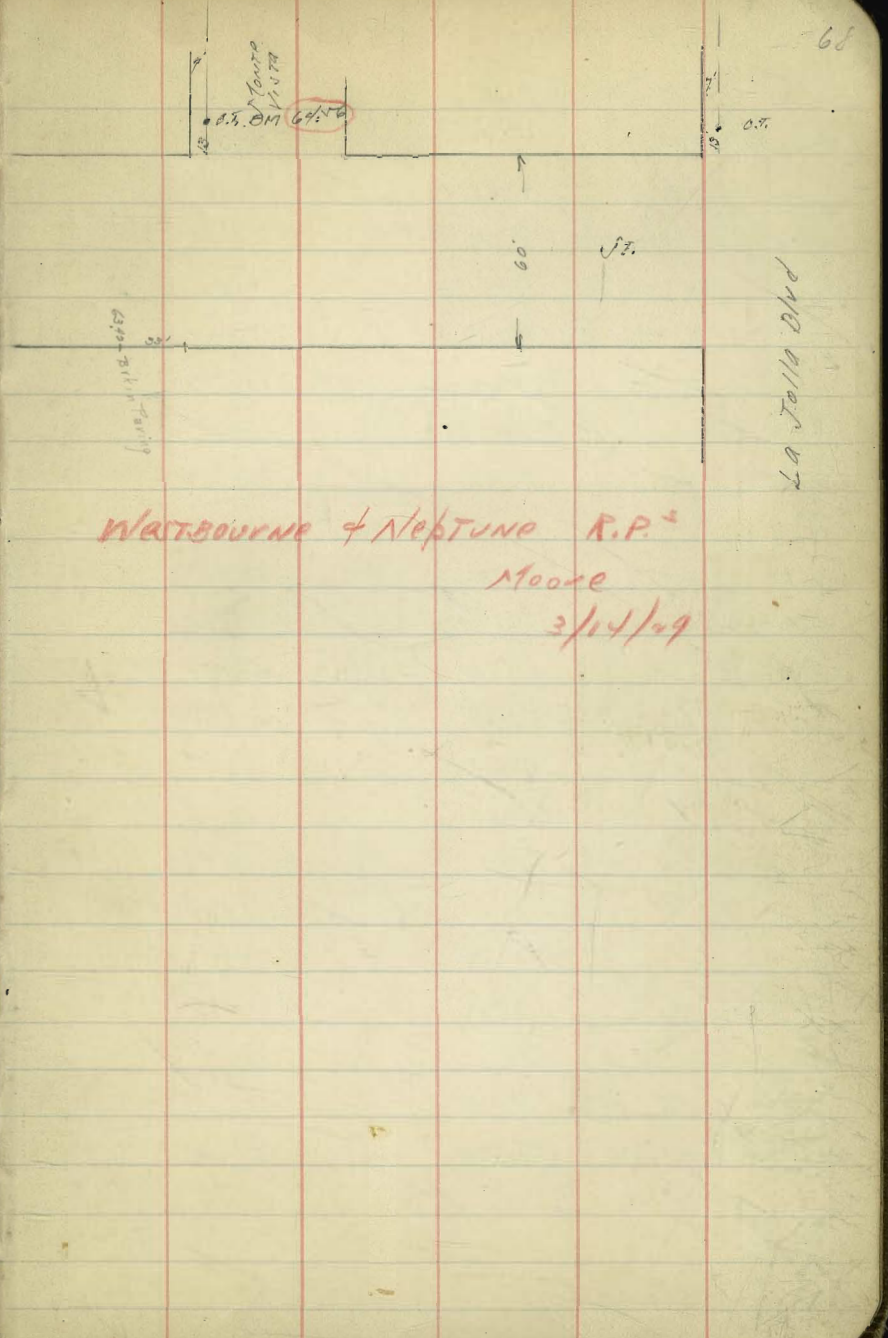
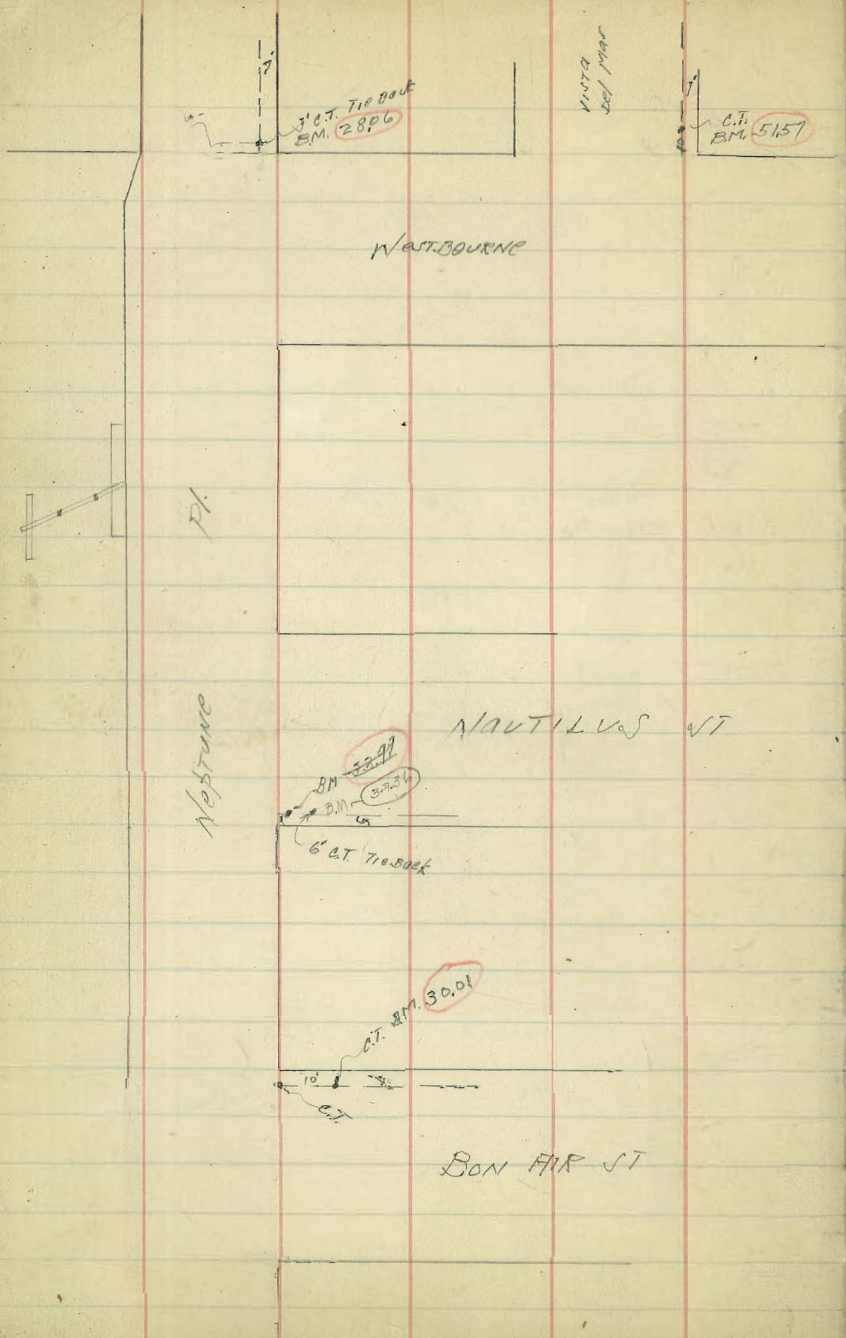

W. BOURNE & NEPTUNE R.P.
 MOORE
 3/14/29

Warrbourne ST Grades

79.01 Westbourne of La Jolla Blvd

0.26
79.277
63.24
42.53
1.78
15.01 N
13.04
34.99
1.64
38.61

	N 06	N 06
WL La Jolla Blvd	78.80	78.30
0	77.77	76.99
0	76.14	75.69
9	74.81	74.38
0	73.48	73.08
0	72.15	71.77
10 (16)	70.82	70.47
0	69.49	69.16
0	68.16	67.86
9	66.83	66.55
10 + 60 = E.L. Monte Vista	65.50	65.25
5 + 10 = W.L. " "	65.0	64.50
1	63.75	63.25
1	62.50	62.00
3	61.25	60.75
4	60.0	59.50
10 (16)	58.75	58.25
6	57.50	57.
0	56.25	55.75
0	55.	54.50
9	53.75	53.25
10 + 70 = EL Vista Del Mar	52.50	52.0

S. 78.8	77.5	76.1	74.8	73.5	72.2	70.9	69.5	68.2
1.5	1.8	1.2	1.5	1.8	1.1	1.5	1.8	1.1
0.3	0.4	0.3	0.4	0.5	0.4	0.3	0.4	0.3
+1.2	-1.1	-1.1	-1.5	-1.1	+1.2	+1.3	+1.5	+1.6
N. 78.3	77.0	75.7	74.4	73.1	71.8	70.5	69.2	67.9
1.0	1.3	1.6	1.9	2.2	1.5	1.8	1.1	1.4
0.8	1.0	1.2	1.4	1.6	1.3	1.5	1.0	1.2
+1.1	+1.3	+1.1	-1.1	-1.1	-0.3	-1.5	-1.3	-0.8
S. 66.8	65.5	64.2	62.9	61.6	60.3	59.0	57.7	56.4
1.5	1.8	1.2	1.5	1.8	1.1	1.5	1.8	1.1
1.2	1.5	1.0	1.3	1.6	1.3	1.5	1.0	1.2
+1.7	+1.8	+0.8	+1.4	+1.7	+1.8	+1.3	+1.2	+1.7
N. 66.4	65.1	63.8	62.5	61.2	59.9	58.6	57.3	56.0
1.2	1.5	1.0	1.3	1.6	1.3	1.5	1.0	1.2
1.2	1.5	1.0	1.3	1.6	1.3	1.5	1.0	1.2
+1.2	+1.3	+1.5	+1.8	+1.6	+1.1	+1.0	+1.8	+1.8
S. 56.3	55.0	53.7	52.4	51.1	49.8	48.5	47.2	45.9
1.7	1.8	1.2	1.5	1.8	1.1	1.5	1.8	1.1
1.7	1.8	1.2	1.5	1.8	1.1	1.5	1.8	1.1
+2.0	+2.7	+2.4	+2.5					
N. 55.8	54.5	53.2	51.9	50.6	49.3	48.0	46.7	45.4
1.2	1.5	1.0	1.3	1.6	1.3	1.5	1.0	1.2
1.2	1.5	1.0	1.3	1.6	1.3	1.5	1.0	1.2
+1.2	+1.7	+1.6	+1.6	+1.6				

Westbourne St Grades

	Sub	Net
ML Vista Del Mar	50.50	50.2
0+20	49.60	49.10
0+40	48.20	47.70
0+60	46.50	46.0
0+80 CONC	44.40	44.0
	39.23	38.9
3 (4x33)	34.10	33.81
216 PCS. 7+8-PCNL.	28.95	28.77

56.67
13.07
43.54
0.51
44.05
12.72
31.33
3.01
37.34

S.	505	496	487	465	444	39.3	34.1	28.95
	2.1	7.0	8.4	10.1	12.2	4.7	9.9	15.1
	3.8	2.4	5.7	7.2	7.8	3.0	9.0	11.8
	+2.2	+2.6	+2.7	+2.3	+2.4	+1.7	+1.7	+3.3
N.	505	491	477	440	440	38.9	33.8	28.72
	2.6	7.6	8.9	10.6	12.2	5.1	10.2	15.6
	5.8	1.9	3.0	7.8	11.8	4.8	12.2	18.6
	+1.8	+5.7	+6.7	+1.8	+1.8	+1.3	grade	+2.0

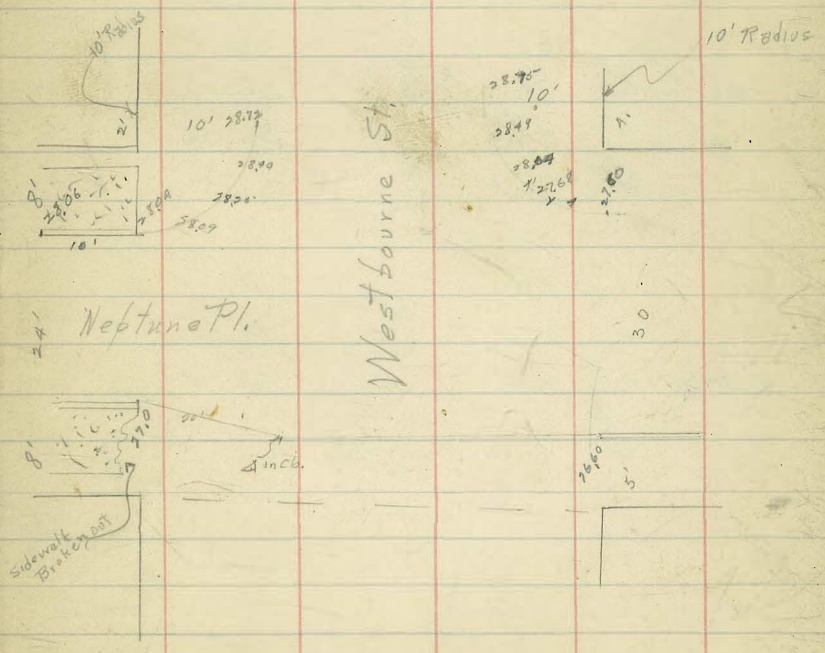
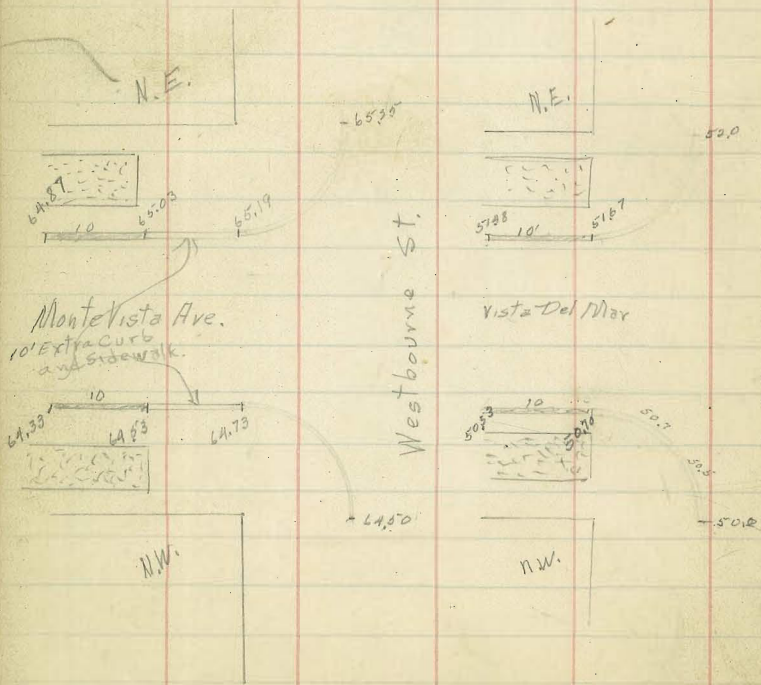

Neptune Pl.

	W/06	EC6
NL Westbourne	27.0	28.04
SL " = 00 = EG.	26.60	27.60
0 + 60 = PVC	26.40	27.10
0 + 80	26.40	27.0
1 + 00	26.50	27.10
1 + 20	26.70	27.30
1 + 40	27.0	27.60
1 + 60	27.60	28.10
1 + 80 = EVC	28.30	28.80
4 + 30	29.65	30.15
4 + 80 = NL Nautilus	29.0	29.50
00 = SL "	29.0	29.50
	31.2	31.7
N	30.4	30.9
S	29.6	30.1
W	28.8	29.3
⊙ = NL Don Air	28.0	28.50

Grades changed See next page

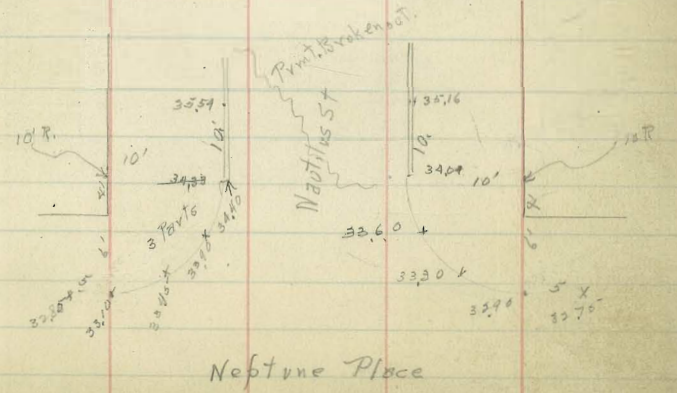

	270	266	249	264	265	267	270	276	283	297
W.	7.3	7.9	7.9	7.9	7.8	7.6	7.3	6.7	6.0	7.6
	+1.7	-1.1	+2.2	-4.1	-7.6	-4.9	+2.2	+2.0	+1.5	-2.6
E.	2804	276	271	270	271	273	276	281	288	30.2
	6.8	7.2	7.3	7.2	7.0	6.7	7.3	7.8	12.7	11.3
	+4.6	+3.3	+5.8	+6.1	+6.6	+6.2	+6.1	+5.5	+4.1	
W.	32.0	31.2	30.4	29.6	28.8	28.0	27.9	28.0	28.1	
	10.1	6.9	7.7	8.5	7.3	10.1	10.2	10.1	10.1	
	-7.8	-1.8	-0.8	+1.3	-1.7	-1.6	+1.0	-1.6	-6.0	
E.	32.5	32.5	31.7	30.8	30.1	29.3	28.5			
	9.0	3.6	2.7	7.2	8.0	8.8	9.6			
	+2.3	+2.0	+3.6	+5.7	+7.1	+1.4	+1.7			
W.	282	284	288							
	5.0	9.7	1.4							
	-6.4	-5.9	-6.1							

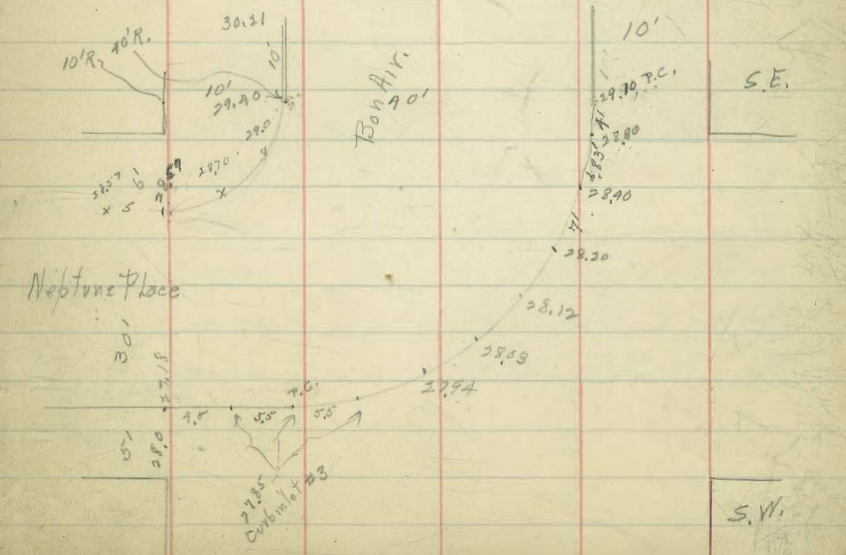

Neptune Pt Westbourne to Bon Air

33.91 ct. Neptune
6.56 + 700 lbs
10.47

	W. eb.	ECB.	
N.L. + 20	26.87	5.92	
S.L.	26.80	5.99	27.90
0 + 60 = P.V.C.	26.30	6.39	27.05
0 + 80	26.28	6.41	26.90
1 + 00	26.41	6.28	27.01
1 + 20	26.69	6.00	27.15
1 + 40	27.13	5.56	27.69
1 + 60	27.72	4.97	28.22
1 + 80 = F.V.C.	28.46	4.23	28.96
2 + 40 = P.V.C.	30.90	1.75 + 30	30.90
2 + 60	31.70	0.95	30.95
2 + 80 N.L. Nautilus	32.20	0.91	31.80
+ 20	32.40		
+ 40	32.40		
+ 60 = S.L. Nautilus	32.30		
East S.L. Nautilus			32.90
0 + 05			32.75
0 + 55	31.44		31.97
1 + 10	30.58		31.10
1 + 65	29.72		30.23
2 + 20	28.86		29.36
2 + 75 = N.L. Bon Air	28.00		28.50

33.91
2.18
32.07

27.40	40.47	47	27.01	27.25	27.69	28.22	28.76	30.90	32.85	33.10
27.40	27.00	26.80	27.01	27.25	27.69	28.22	28.76	30.90	32.85	33.10
13.4	18.4	18.6	18.2	12.8	12.2	11.5	9.6	7.6	7.4	
7.1	7.2	7.6	6.9	6.5	6.4	6.2	5.6	5.8	5.7	
25.3	25.4	25.9	26.3	26.2	25.8	25.9	23.4	23.4	21.8	21.7
W.	26.8	26.8	26.4	26.69	27.18	27.22	28.46	30.90	31.70	32.20
	9.8	9.81	9.68	9.4	9.0	8.4	7.6	5.2	4.4	3.9
	2.16	2.07	10.20	10.35	7.3	6.8	6.3	3.2	5.3	6.7
	+2.2	7.44	-0.5	-7.1	+1.7	+1.6	+1.13	-2.0	-0.7	-2.8
E	32.8	27.0	1.27	1.1	2.0, 2.3	2.0, 2.6	2.85			
	7.6	7.7	8.5	9.4	10.2	11.1				
	6.6	5.6	5.7	3.9	3.3	2.5				
	+1.6	+2.1	+3.8	-3.5	+6.9	+1.3				
W.	32.30	31.44	30.58	29.70	28.86	28.00				
	3.0	1.7	5.5	4.9	7.2	8.1				
	2.0	5.8	5.0	5.3	8.6	8.7				
	-2.2	-1.1	+0.5	1.1	-1.8	-1.6				

32.80
28.76
3.89
18.7
20.0

30.91
1.7
5.8
20.1
1.1
28.4

32.6

Culvert #1 39.91 ft

curb inlet #1	Top of	= 27.0	
		<u>12.91</u>	
FL pipe "	"	<u>24.1</u>	
	32.01 ft	<u>21.5</u>	
		<u>18.41</u>	
		<u>7.46</u>	
Curb inlet #2	CG =	26.50	+10.94
		<u>6.11</u>	
		<u>10.08</u>	
		<u>-3.97</u>	
F.L. Box		<u>14.50</u>	
		<u>18.11</u>	
		<u>10.08</u>	
		<u>12.09</u>	

22.61
<u>10.08</u>
<u>12.53</u>
<u>2.77</u>
<u>25.00</u>
<u>11.62</u>
<u>13.38</u>
<u>12.77</u>
<u>15.85</u>

Sea Wall

		S. End	N. End
Top of Wall Elev.	9.0	25.0	25.0
		<u>9.0</u>	<u>3.5</u>
		<u>16.0</u>	<u>21.5</u>
Flow line of Pipe Through Wall	3.5	<u>11.63</u>	<u>11.25</u>
		<u>+7.37</u>	<u>+9.25</u>

End Wall

Top of Wall Elev.	5.0	15.38	15.38
		<u>3.0</u>	<u>3.0</u>
		<u>12.38</u>	<u>12.38</u>
Flow line of pipe	3.0	<u>8.38</u>	<u>9.38</u>
		<u>+2.40</u>	<u>+3.00</u>

30.01 10' Tip Ban Air
0.27
 30.68

Culvert #3

curb inlet #3	Top CG	27.85	grade	
" " "	Flow line pipe	23.85	+4.0	30.28
Culvert #3	" " pipe outlet	17.0		17.0
				<u>18.68</u>
				<u>11.37</u>
				<u>+2.3</u>

Notes for Extras on Sea Wall
Neptune Pt. S. of Westbourne

9.		
1.75		
13.75 N. End of stake.		
1.75		
13.907 5.227		
N. End Bottom of Cut.	2.42	9.18
+ 1.0	4.66	9.21
+ 1.9	7.60	6.30
	7.79	6.11
+ 2.4	8.99	4.91
+ 3.4	9.08	4.92
+ 3.6	10.21	3.69
+ 5.5	10.27	3.63
+ 6.6	12.54	1.36
+ 9.2	12.83	1.07
	8.77	-3.55
+ 11.1	8.87	-3.65
+ 13.0	10.65	-5.93
13.1	12.20	-6.98
13.7	11.85	-6.64
17.0	9.50	-4.52
18.3	8.39	-3.17
19.0	5.93	-0.71
22.7		-0.33
23.5	B. 5.55	
	T. 12.80	1.10
26.5	12.13	1.77
29.4	8.4	5.50
33 = SE Bottom	7.72	6.18
Bottom end wall	3.45	-8.23

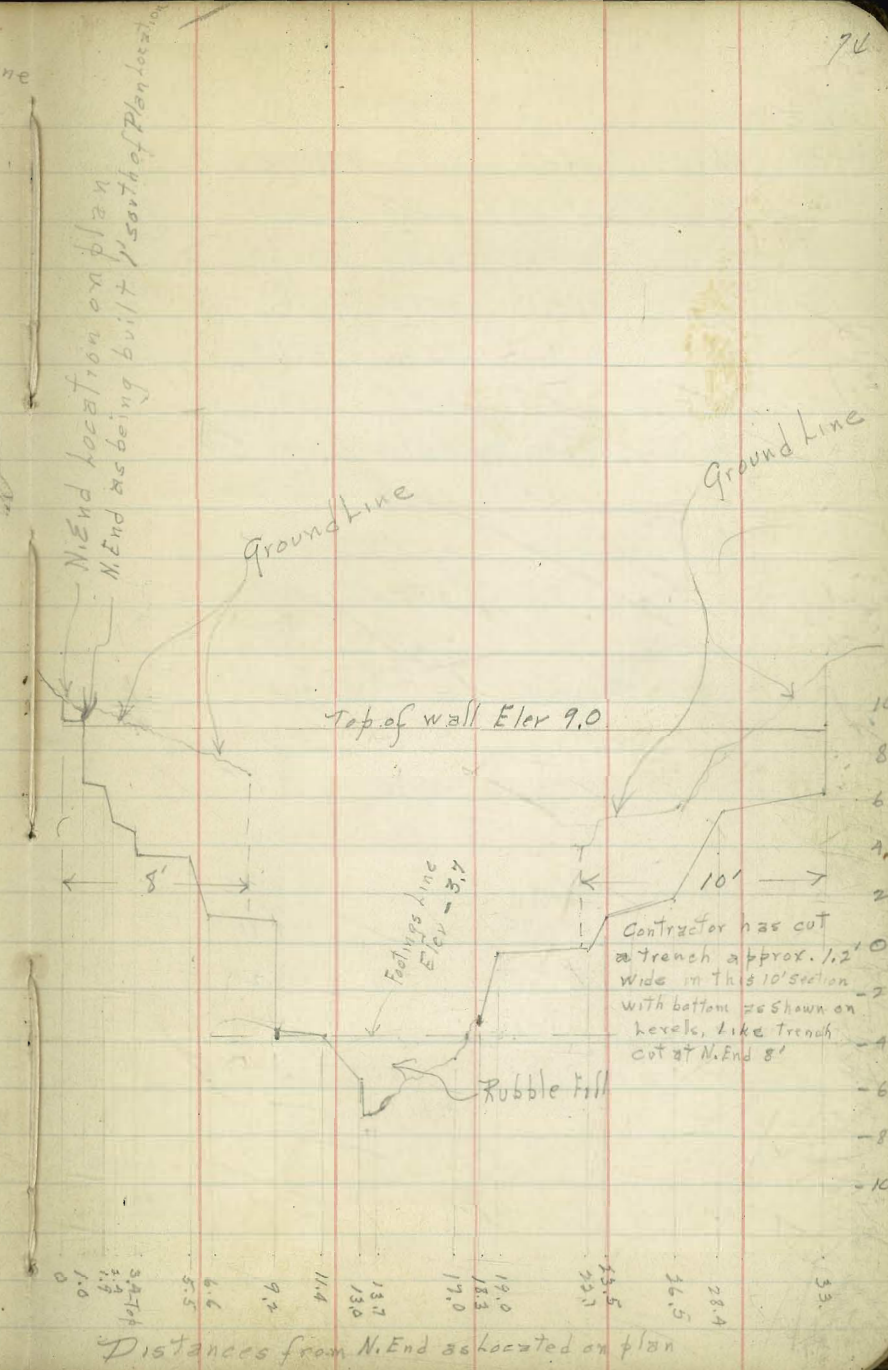

Paving Alley 36 City Hghts. 30' Wide
Univ. to Polk Between 37th & Cherokee

Flood
France
Collection 5/10/29

	E. line	waterline	W. line
0+00 = N.L. Univ.	354.5	351.5	354.8
+ 10	354.85	351.85	355.05
+ 20 = Bk R.K.C.	355.2	352.2	355.3
+ 30	355.5	352.5	355.5
+ 40 = Bk E.V.C.	356.0	353.0	356.0
+ 50	356.8	353.8	356.8
+ 60 = Bk R.K.C.	357.6	354.6	357.6
1+00	358.1	355.1	358.1
2+20 = Bk E.V.C.	358.3	355.3	358.3
+ 60	358.5	355.5	358.5
3+00	358.7	355.7	358.7
+ 10 = Bk R.K.C.	358.9	355.9	358.9
+ 60	359.1	356.1	359.1
+ 80 = Bk E.V.C.	359.4	356.4	359.4
4+10	359.9	356.9	360.0
4+40 = Bk	360.4	357.4	360.64 out 5000
4+60 = Bk	360.8	357.8	361.0
+ 80	360.94	357.9	361.11
5+20	361.23	358.2	361.34
+ 60	361.55	358.5	361.57
6+00 = S. L. Polk Ave.	361.8	358.8	361.8

S.L. #2 12" N.L. Univ. on W. 1"
S.L. #3 1" S.L. Univ. on W. 2"
W.S. 15" S.L. Univ. on W.

140
0087
0300
7000
198
200

60.76
61.66
41.83
16.00
12.33
66.03
60.80
5.23 E
2.06
4.67
66.03
5.11
5.03 W
2.13
-1.10
16.23
360.74

352.09 N.W. 77' Univ. 9 27 75

6.76	58.85	61.74	61.94	61.94	61.94	61.94	61.94	63.09	63.29	63.29
358.85	354.5	351.5	352	353.5	356.0	358	357.6	358.7	358.3	358.5
2.06	3.35	4.09	4.74	4.44	5.14	5.74	6.04	5.84	5.34	5.14
355.79	354.5	351.5	352	353.5	356.0	358	357.6	358.7	358.3	358.5
6.10	7.33	7.50	7.40	6.35	6.12	5.07	6.02	5.77	5.60	5.33
355.79	354.5	351.5	352	353.5	356.0	358	357.6	358.7	358.3	358.5
6.10	7.33	7.50	7.40	6.35	6.12	5.07	6.02	5.77	5.60	5.33
355.79	354.5	351.5	352	353.5	356.0	358	357.6	358.7	358.3	358.5
6.10	7.33	7.50	7.40	6.35	6.12	5.07	6.02	5.77	5.60	5.33
355.79	354.5	351.5	352	353.5	356.0	358	357.6	358.7	358.3	358.5
6.10	7.33	7.50	7.40	6.35	6.12	5.07	6.02	5.77	5.60	5.33
355.79	354.5	351.5	352	353.5	356.0	358	357.6	358.7	358.3	358.5
6.10	7.33	7.50	7.40	6.35	6.12	5.07	6.02	5.77	5.60	5.33
355.79	354.5	351.5	352	353.5	356.0	358	357.6	358.7	358.3	358.5
6.10	7.33	7.50	7.40	6.35	6.12	5.07	6.02	5.77	5.60	5.33
355.79	354.5	351.5	352	353.5	356.0	358	357.6	358.7	358.3	358.5
6.10	7.33	7.50	7.40	6.35	6.12	5.07	6.02	5.77	5.60	5.33
355.79	354.5	351.5	352	353.5	356.0	358	357.6	358.7	358.3	358.5
6.10	7.33	7.50	7.40	6.35	6.12	5.07	6.02	5.77	5.60	5.33
355.79	354.5	351.5	352	353.5	356.0	358	357.6	358.7	358.3	358.5
6.10	7.33	7.50	7.40	6.35	6.12	5.07	6.02	5.77	5.60	5.33
355.79	354.5	351.5	352	353.5	356.0	358	357.6	358.7	358.3	358.5
6.10	7.33	7.50	7.40	6.35	6.12	5.07	6.02	5.77	5.60	5.33
355.79	354.5	351.5	352	353.5	356.0	358	357.6	358.7	358.3	358.5
6.10	7.33	7.50	7.40	6.35	6.12	5.07	6.02	5.77	5.60	5.33
355.79	354.5	351.5	352	353.5	356.0	358	357.6	358.7	358.3	358.5
6.10	7.33	7.50	7.40	6.35	6.12	5.07	6.02	5.77	5.60	5.33
355.79	354.5	351.5	352	353.5	356.0	358	357.6	358.7	358.3	358.5
6.10	7.33	7.50	7.40	6.35	6.12	5.07	6.02	5.77	5.60	5.33
355.79	354.5	351.5	352	353.5	356.0	358	357.6	358.7	358.3	358.5
6.10	7.33	7.50	7.40	6.35	6.12	5.07	6.02	5.77	5.60	5.33
355.79	354.5	351.5	352	353.5	356.0	358	357.6	358.7	358.3	358.5
6.10	7.33	7.50	7.40	6.35	6.12	5.07	6.02	5.77	5.60	5.33
355.79	354.5	351.5	352	353.5	356.0	358	357.6	358.7	358.3	358.5
6.10	7.33	7.50	7.40	6.35	6.12	5.07	6.02	5.77	5.60	5.33
355.79	354.5	351.5	352	353.5	356.0	358	357.6	358.7	358.3	358.5
6.10	7.33	7.50	7.40	6.35	6.12	5.07	6.02	5.77	5.60	5.33
355.79	354.5	351.5	352	353.5	356.0	358	357.6	358.7	358.3	358.5
6.10	7.33	7.50	7.40	6.35	6.12	5.07	6.02	5.77	5.60	5.33
355.79	354.5	351.5	352	353.5	356.0	358	357.6	358.7	358.3	358.5
6.10	7.33	7.50	7.40	6.35	6.12	5.07	6.02	5.77	5.60	5.33
355.79	354.5	351.5	352	353.5	356.0	358	357.6	358.7	358.3	358.5
6.10	7.33	7.50	7.40	6.35	6.12	5.07	6.02	5.77	5.60	5.33
355.79	354.5	351.5	352	353.5	356.0	358	357.6	358.7	358.3	358.5
6.10	7.33	7.50	7.40	6.35	6.12	5.07	6.02	5.77	5.60	5.33
355.79	354.5	351.5	352	353.5	356.0	358	357.6	358.7	358.3	358.5
6.10	7.33	7.50	7.40	6.35	6.12	5.07	6.02	5.77	5.60	5.33
355.79	354.5	351.5	352	353.5	356.0	358	357.6	358.7	358.3	358.5
6.10	7.33	7.50	7.40	6.35	6.12	5.07	6.02	5.77	5.60	5.33
355.79	354.5	351.5	352	353.5	356.0	358	357.6	358.7	358.3	358.5
6.10	7.33	7.50	7.40	6.35	6.12	5.07	6.02	5.77	5.60	5.33
355.79	354.5	351.5	352	353.5	356.0	358	357.6	358.7	358.3	358.5
6.10	7.33	7.50	7.40	6.35	6.12	5.07	6.02	5.77	5.60	5.33
355.79	354.5	351.5	352	353.5	356.0	358	357.6	358.7	358.3	358.5
6.10	7.33	7.50	7.40	6.35	6.12	5.07	6.02	5.77	5.60	5.33
355.79	354.5	351.5	352	353.5	356.0	358	357.6	358.7	358.3	358.5
6.10	7.33	7.50	7.40	6.35	6.12	5.07	6.02	5.77	5.60	5.33
355.79	354.5	351.5	352	353.5	356.0	358	357.6	358.7	358.3	358.5
6.10	7.33	7.50	7.40	6.35	6.12	5.07	6.02	5.77	5.60	5.33
355.79	354.5	351.5	352	353.5	356.0	358	357.6	358.7	358.3	358.5
6.10	7.33	7.50	7.40	6.35	6.12	5.07	6.02	5.77	5.60	5.33
355.79	354.5	351.5	352	353.5	356.0	358	357.6	358.7	358.3	358.5
6.10	7.33	7.50	7.40	6.35	6.12	5.07	6.02	5.77	5.60	5.33
355.79	354.5	351.5	352	353.5	356.0	358	357.6	358.7	358.3	358.5
6.10	7.33	7.50	7.40	6.35	6.12	5.07	6.02	5.77	5.60	5.33
355.79	354.5	351.5	352	353.5	356.0	358	357.6	358.7	358.3	358.5
6.10	7.33	7.50	7.40	6.35	6.12	5.07	6.02	5.77	5.60	5.33
355.79	354.5	351.5	352	353.5	356.0	358	357.6	358.7	358.3	358.5
6.10	7.33	7.50	7.40	6.35	6.12	5.07	6.02	5.77	5.60	5.33
355.79	354.5	351.5	352	353.5	356.0	358	357.6	358.7	358.3	358.5
6.10	7.33	7.50	7.40	6.35	6.12	5.07	6.02	5.77	5.60	5.33
355.79	354.5	351.5	352	353.5	356.0	358	357.6	358.7	358.3	358.5
6.10	7.33	7.50	7.40	6.35	6.12	5.07	6.02	5.77	5.60	5.33
355.79	354.5	351.5	352	353.5	356.0	358	357.6	358.7	358.3	358.5
6.10	7.33	7.50	7.40	6.35	6.12	5.07	6.02	5.77	5.60	5.33
355.79	354.5	351.5	352	353.5	356.0	358	357.6	358.7	358.3	358.5
6.10	7.33	7.50	7.40	6.35	6.12	5.07	6.02	5.77	5.60	5.33
355.79	354.5	351.5	352	353.5	356.0	358	357.6	358.7	358.3	358.5
6.10	7.33	7.50	7.40	6.35	6.12	5.07	6.02	5.77	5.60	5.33
355.79	354.5	351.5	352	353.5	356.0	358	357.6	358.7	358.3	358.5
6.10	7.33	7.50	7.40	6.35	6.12	5.07	6.02	5.77	5.60	5.33
355.79	354.5	351.5	352	353.5	356.0	358	357.6	358.7	358.3	358.5
6.10	7.33	7.50	7.40	6.35	6.12	5.07	6.02	5.77	5.60	5.33
355.79	354.5	351.5	352	353.5	356.0	358	357.6	358.7	358.3	358.5
6.10	7.33	7.50	7.40	6.35	6.12	5.07	6.02	5.77	5.60	5.33
355.79	354.5	351.5	352	353.5	356.0	358	357.6	358.7	358.3	358.5
6.10	7.33	7.50	7.40	6.35	6.12	5.07	6.02	5.77	5.60	5.33
355.79	354.5	351.5	352	353.5	356.0	358	357.6	358.7	358.3	358.5
6.10	7.33	7.50								

More
Blacks
to
California

Kalmia St India to Kettner Nelson, Contractor

	N. gut.	S. gut.
W.L. India = 0100	41.7 ^{41.8} 41.4	42.02
0425 Brk	39.9 ^{39.1}	40.0
150 Brk	38.1	
175 Brk	31.7	
2400 - E. Kettner	30.5 ^{30.7} 30.40	30.8 ^{30.76}

Kettner 2202

B.M. SW.B.P. Juniper India

46.87	40.0	33.7	43.37	43.37	33.7
2.30	3.37	1.97	27.5	27.5	30.72
19.17		3.97	20.62	20.62	28.92
7.04		3.47			23.97
12.13	7.33	7.33	2.87	2.87	13.97
1.24	1.9	1.5	8.4	8.4	2.00
43.137	5.43	5.83	4.97	4.97	9.71
8.25					7.33
33.82					6.93
2.01					39.40
37.33					

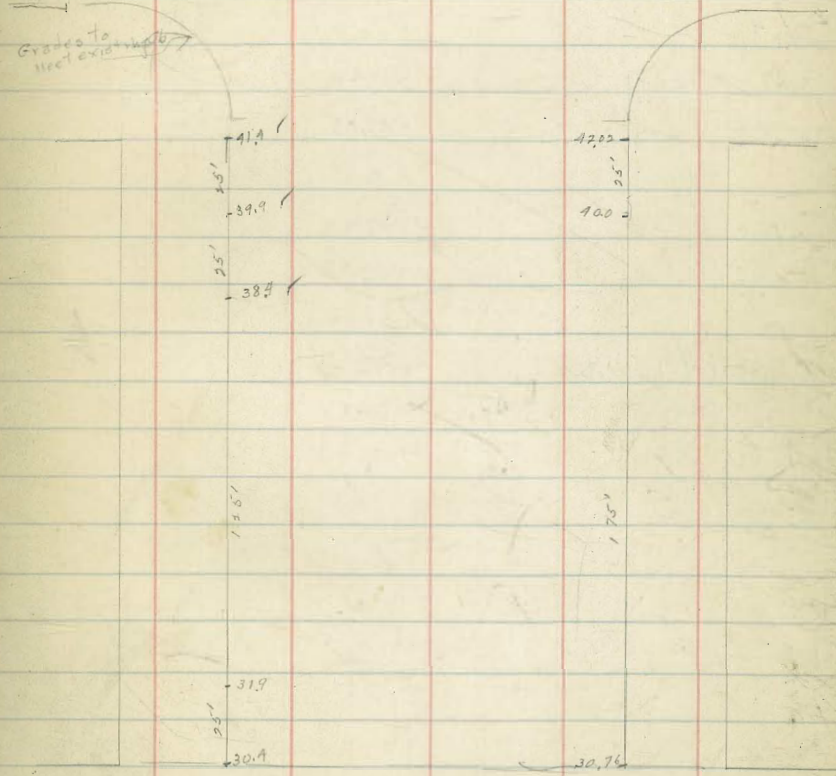

4/1/29

Alley 195 V.H.
TOWER CONSTRUCTION

Moore Billie Harper

DE=00	310.00
0+47	208.120
0+97	306.00
1+47	304.0
1+97	302.00
2+47	300.0
2+97 = MH cas	298.0
0+50	294.33
1	290.67
+50	287.0
2	283.33
+50	279.67
3 = MH & Lincoln	276.00

313.08
 3.08
 316.16
 12.13
 304.03
 0.74
 304.78
 12.04
 292.73
 0.84
 293.57
 0.97
 284.18
 0.22
 284.56

310.00	308.0	306.0	304.0	302.0	300.0
6.16	8.16	10.16	12.16	14.16	16.16
2.30	4.0	4.76	7.36	8.16	10.16
+2.86	+4.1	45.40	+4.80	+6.22	+6.04
298.0	298.00	294.33	290.67	287.0	283.33
18.16	6.78	10.45	14.17	16.15	9.82
12.22	6.38	5.95	9.41	1.65	5.0
14.9	+4.0	2.50	+4.7	+4.0	+4.0
279.67	276.0				
13.48	17.15				
7.68	8.40				
+5.8	+8.75				

Alley 1st U.H.

Change of grade on acct of anchor on
UNIV. Fire retaining wall.

30' N of NL
UNIV. Ave

W	$\frac{313.24}{5.70}$	west side 2" higher
E	$\frac{313.04}{5.50}$	nail in house 0.00

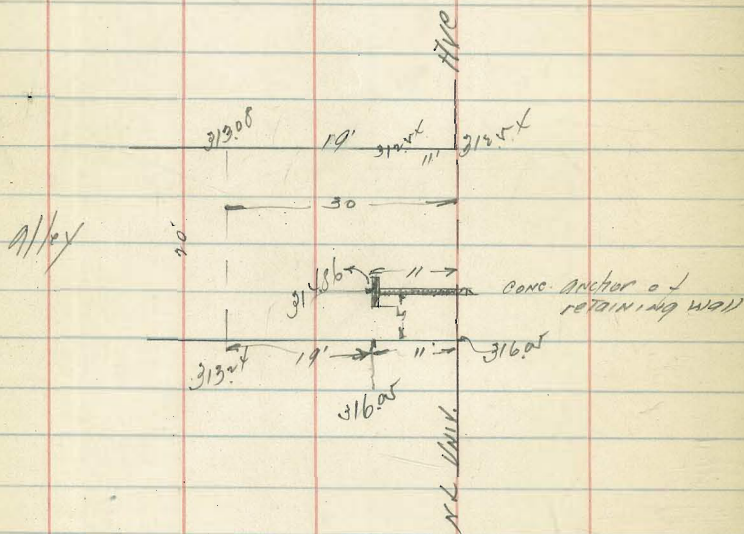

Sw Univ Georgia St

78

$\frac{241.46}{14.73}$
 $\frac{378.73}{0.51}$
 $\frac{378.22}{13.10}$
 $\frac{316.34}{2.60}$
 $\frac{318.94}{}$

$\frac{314.00}{4.94}$
 $\frac{26.99}{2.01}$

$\frac{313.80}{6.14}$ = NL UNIV
 $\frac{6.40}{-0.26}$ staked marked - 0.25

$\frac{313.00}{5.94}$
 $\frac{20.04}{4.59}$

$\frac{312.50}{6.14}$ = 40' N of NL UNIV
 $\frac{9.10}{-0.96}$ marked - 30"

Staked marked + 6.0

$\frac{4.08}{314.86}$ = elev
 $\frac{2.89}{316.05}$ = edge sidewalk on WEST on NL UNIV. Ave
 Top of anchor

$\frac{6.40}{314.54}$ = elev. sidewalk on east on NL UNIV.

Repairing of intersection of Madison + Georgia

NOTE.

Figures within Rings = EXISTING paving elev.

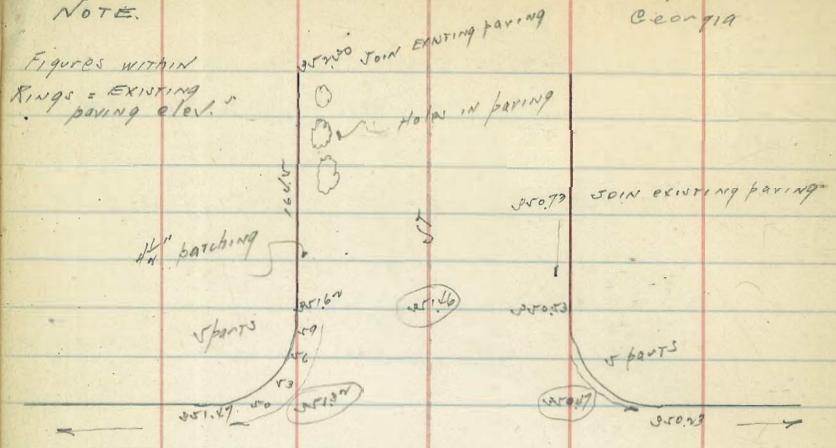

Madison Ave

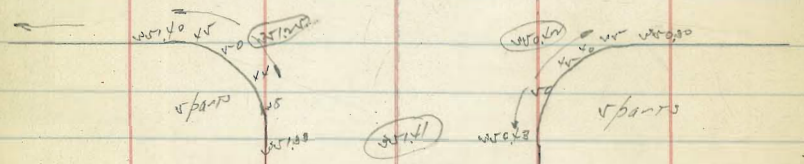
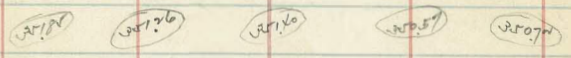

Georgia

Moore

TABLE II—Continued
TRIGONOMETRIC FORMULAE (continued)

In any triangle:

Given a, b, C; to find c, B, A.

Use Law of Tangents.

Given A, B, c; to find a, b, C.

Use Law of Sines.

Given a, b, c; to find A, B, C.

$$\text{Let } \frac{a+b+c}{2} = s, \sqrt{\frac{(s-a)(s-b)(s-c)}{s}} = r$$

$$\cos \frac{1}{2} A = \sqrt{\frac{s(s-a)}{bc}}$$

$$\tan \frac{1}{2} A = \frac{r}{s-a}$$

$$\tan \frac{1}{2} B = \frac{r}{s-b}$$

$$\tan \frac{1}{2} C = \frac{r}{s-c}$$

Area of a triangle:

$$\text{Area} = \frac{1}{2} ab \sin C$$

$$\text{Area} = \sqrt{s(s-a)(s-b)(s-c)}$$

PRISMOIDAL FORMULA.

$$\text{Vol.} = \frac{h}{6} (B+b+m)$$

h = altitude; b, B = bases; M = midsection

TABLE III

INCHES AND FRACTIONS OF AN INCH IN DECIMALS OF A FOOT

	0	1	2	3	4	5	6	7	8	9	10	11
$\frac{1}{16}$.0052	.0885	.1719	.2552	.3385	.4219	.5052	.5885	.6719	.7552	.8385	.9219
$\frac{1}{8}$.0104	.0938	.1771	.2604	.3438	.4271	.5104	.5938	.6771	.7604	.8438	.9271
$\frac{3}{16}$.0156	.0990	.1823	.2656	.3490	.4323	.5156	.5990	.6823	.7656	.8490	.9323
$\frac{1}{4}$.0208	.1042	.1875	.2708	.3542	.4375	.5208	.6042	.6875	.7708	.8542	.9375
$\frac{5}{16}$.0260	.1094	.1927	.2760	.3594	.4427	.5260	.6094	.6927	.7760	.8594	.9427
$\frac{3}{8}$.0313	.1146	.1979	.2813	.3646	.4479	.5313	.6146	.6979	.7813	.8646	.9479
$\frac{7}{16}$.0365	.1198	.2031	.2865	.3698	.4531	.5365	.6198	.7031	.7865	.8698	.9531
$\frac{1}{2}$.0417	.1250	.2083	.2917	.3750	.4583	.5417	.6250	.7083	.7917	.8750	.9583
$\frac{9}{16}$.0469	.1302	.2135	.2969	.3803	.4635	.5469	.6302	.7135	.7969	.8802	.9635
$\frac{5}{8}$.0521	.1354	.2188	.3021	.3854	.4688	.5521	.6354	.7188	.8021	.8854	.9688
$\frac{11}{16}$.0573	.1406	.2240	.3073	.3906	.4740	.5573	.6406	.7240	.8073	.8906	.9740
$\frac{3}{4}$.0625	.1458	.2292	.3125	.3958	.4792	.5625	.6458	.7292	.8125	.8958	.9792
$\frac{13}{16}$.0677	.1510	.2344	.3177	.4010	.4844	.5677	.6510	.7344	.8177	.9010	.9844
$\frac{7}{8}$.0729	.1563	.2396	.3229	.4063	.4896	.5729	.6563	.7396	.8229	.9063	.9896
$\frac{15}{16}$.0781	.1615	.2448	.3281	.4115	.4948	.5781	.6615	.7448	.8281	.9115	.9948
1	.0833	.1667	.2500	.3333	.4167	.5000	.5833	.6667	.7500	.8333	.9167	1.0000
	0	1	2	3	4	5	6	7	8	9	10	11

TABLE IV
USEFUL RELATIONS.

Lineal feet	× .00019	= miles
Lineal yards	× .0006	= miles
Square inches	× .007	= square feet
Square feet	× .111	= square yards
Square yards	× .0002067	= acres
Acres	× 4840	= square yards
Cubic inches	× .00058	= cubic feet
Cubic feet	× .03704	= cubic yards
Links	× .22	= yards
Links	× .66	= feet
Feet	× 1.5	= links
350°	= 21600' = 1296000"	
Radius	= arc of 57.2957790°	
Arc of 1° (radius = 1)	= .017453292	
Arc of 1' (radius = 1)	= .000290888	
Arc of 1" (radius = 1)	= .000004848	

$$\pi = 3.141592654 \quad \sqrt{\frac{1}{4}} = 0.564190$$

$$\frac{\pi}{4} = 0.785398163 \quad \sqrt[3]{\frac{6}{\pi}} = 1.240700982$$

$$\frac{\pi}{6} = 0.523598776 \quad \pi^2 = 9.869604401$$

$$\sqrt{\frac{4}{\pi}} = 1.128379167 \quad \frac{1}{\pi^2} = 0.101321184$$

$$\frac{\pi}{6} = 0.523598776 \quad \sqrt{\pi} = 1.772453851$$

$$\frac{4\pi}{3} = 4.188790205 \quad \frac{1}{\pi} = 0.3183099$$

Curvature of Earth's surface = about 0.7 feet in 1 mile

Curvature in feet = 0.667 (Dist. in miles)²

Difference between arc and chord length, 0.05 feet in 11½ miles

$$\text{Probable error of a single observation} = 0.6754 \sqrt{\frac{\sum v^2}{n-1}}$$

Error in chaining of 0.01 feet in 100 feet:

Due to—

1. Length of tape error of 0.01 feet
2. Alignment. One end 1.4 feet out of line
3. Sag of tape at centre of 0.61 feet.
4. Temperature difference of 15°
5. Difference of pull of 15 lbs.

STADIA REDUCTION FORMULAE.

Horizontal Distance = R - R sin² a + C cos a

Vertical Distance = R ½ sin 2 a + C sin a

distance from Object glass to cross hairs

R = Reading × $\frac{\text{distance from Object glass to cross hairs}}{\text{distance between cross hairs}}$

C = distance from Object glass to cross hairs + distance from Object glass to center of instrument.

a = angle of elevation for mid Reading

540
 321.70
 320.05
 320.00
 320.00

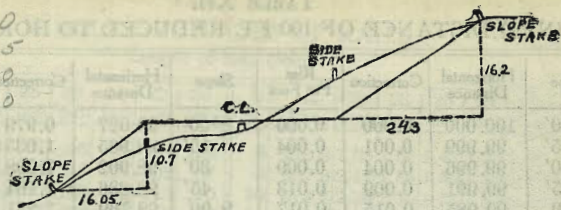

DISTANCES FROM SIDE STAKES FOR CROSS-SECTIONING.

SLOPE 1 1/2 TO 1. ROADWAY OF ANY WIDTH.

	0	.1	.2	.3	.4	.5	.6	.7	.8	.9	
0	0 00	0 15	0 30	0 45	0 60	0 75	0 90	1 05	1 20	1 35	0
1	1 50	1 65	1 80	1 95	2 10	2 25	2 40	2 55	2 70	2 85	1
2	3 00	3 15	3 30	3 45	3 60	3 75	3 90	4 05	4 20	4 35	2
3	4 50	4 65	4 80	4 95	5 10	5 25	5 40	5 55	5 70	5 85	3
4	6 00	6 15	6 30	6 45	6 60	6 75	6 90	7 05	7 20	7 35	4
5	7 50	7 65	7 80	7 95	8 10	8 25	8 40	8 55	8 70	8 85	5
6	9 00	9 15	9 30	9 45	9 60	9 75	9 90	10 05	10 20	10 35	6
7	10 50	10 65	10 80	10 95	11 10	11 25	11 40	11 55	11 70	11 85	7
8	12 00	12 15	12 30	12 45	12 60	12 75	12 90	13 05	13 20	13 35	8
9	13 50	13 65	13 80	13 95	14 10	14 25	14 40	14 55	14 70	14 85	9
10	15 00	15 15	15 30	15 45	15 60	15 75	15 90	16 05	16 20	16 35	10
11	16 50	16 65	16 80	16 95	17 10	17 25	17 40	17 55	17 70	17 85	11
12	18 00	18 15	18 30	18 45	18 60	18 75	18 90	19 05	19 20	19 35	12
13	19 50	19 65	19 80	19 95	20 10	20 25	20 40	20 55	20 70	20 85	13
14	21 00	21 15	21 30	21 45	21 60	21 75	21 90	22 05	22 20	22 35	14
15	22 50	22 65	22 80	22 95	23 10	23 25	23 40	23 55	23 70	23 85	15
16	24 00	24 15	24 30	24 45	24 60	24 75	24 90	25 05	25 20	25 35	16
17	25 50	25 65	25 80	25 95	26 10	26 25	26 40	26 55	26 70	26 85	17
18	27 00	27 15	27 30	27 45	27 60	27 75	27 90	28 05	28 20	28 35	18
19	28 50	28 65	28 80	28 95	29 10	29 25	29 40	29 55	29 70	29 85	19
20	30 00	30 15	30 30	30 45	30 60	30 75	30 90	31 05	31 20	31 35	20
21	31 50	31 65	31 80	31 95	32 10	32 25	32 40	32 55	32 70	32 85	21
22	33 00	33 15	33 30	33 45	33 60	33 75	33 90	34 05	34 20	34 35	22
23	34 50	34 65	34 80	34 95	35 10	35 25	35 40	35 55	35 70	35 85	23
24	36 00	36 15	36 30	36 45	36 60	36 75	36 90	37 05	37 20	37 35	24
25	37 50	37 65	37 80	37 95	38 10	38 25	38 40	38 55	38 70	38 85	25
26	39 00	39 15	39 30	39 45	39 60	39 75	39 90	40 05	40 20	40 35	26
27	40 50	40 65	40 80	40 95	41 10	41 25	41 40	41 55	41 70	41 85	27
28	42 00	42 15	42 30	42 45	42 60	42 75	42 90	43 05	43 20	43 35	28
29	43 50	43 65	43 80	43 95	44 10	44 25	44 40	44 55	44 70	44 85	29
30	45 00	45 15	45 30	45 45	45 60	45 75	45 90	46 05	46 20	46 35	30
31	46 50	46 65	46 80	46 95	47 10	47 25	47 40	47 55	47 70	47 85	31
32	48 00	48 15	48 30	48 45	48 60	48 75	48 90	49 05	49 20	49 35	32
33	49 50	49 65	49 80	49 95	50 10	50 25	50 40	50 55	50 70	50 85	33
34	51 00	51 15	51 30	51 45	51 60	51 75	51 90	52 05	52 20	52 35	34
35	52 50	52 65	52 80	52 95	53 10	53 25	53 40	53 55	53 70	53 85	35
36	54 00	54 15	54 30	54 45	54 60	54 75	54 90	55 05	55 20	55 35	36
37	55 50	55 65	55 80	55 95	56 10	56 25	56 40	56 55	56 70	56 85	37
38	57 00	57 15	57 30	57 45	57 60	57 75	57 90	58 05	58 20	58 35	38
39	58 50	58 65	58 80	58 95	59 10	59 25	59 40	59 55	59 70	59 85	39
40	60 00	60 15	60 30	60 45	60 60	60 75	60 90	61 05	61 20	61 35	40
41	61 50	61 65	61 80	61 95	62 10	62 25	62 40	62 55	62 70	62 85	41
42	63 00	63 15	63 30	63 45	63 60	63 75	63 90	64 05	64 20	64 35	42
43	64 50	64 65	64 80	64 95	65 10	65 25	65 40	65 55	65 70	65 85	43
44	66 00	66 15	66 30	66 45	66 60	66 75	66 90	67 05	67 20	67 35	44
45	67 50	67 65	67 80	67 95	68 10	68 25	68 40	68 55	68 70	68 85	45
46	69 00	69 15	69 30	69 45	69 60	69 75	69 90	70 05	70 20	70 35	46
47	70 50	70 65	70 80	70 95	71 10	71 25	71 40	71 55	71 70	71 85	47
48	72 00	72 15	72 30	72 45	72 60	72 75	72 90	73 05	73 20	73 35	48
49	73 50	73 65	73 80	73 95	74 10	74 25	74 40	74 55	74 70	74 85	49
50	75 00	75 15	75 30	75 45	75 60	75 75	75 90	76 05	76 20	76 35	50

Computed by L. Leland Locke.

321.55
 326
 324.81
 107.401
 88
 19.44

608
 940175
 80
 1.48
 80
 600
 58
 107.401
 83
 2.44

2809
 27.18
 55.27
 27.64
 28.04

10175
 105250

28.44
 28.09
 35

2807
 18
 28.27

5/785

365

157

376

471

628

785

48
27
75

113
25
725

290
636.25
633.7

363
515
55.13

814
708
1570
7.63
807

806

80

17

7.3

3

10.3

64.98
58.40
6.58
59
0.7

64.98
8.9
6.28

188
607

168

84

61.04

84

61.88

67
56.9
5.2

16
100
250

12.85
7.12
13.97

16
40
690

898 910

145
65
80

25
40
65

128 / 20200
128
750
640
1000
996

110

126
1314

598

27
925

15503
274

153.725

158.260

133

1900

133

570

345

537

905

6

875

13

12

182

27 / 1100
374
340
34

0.017

45

261

348

374

1494

145.7

10120

280

168

18

186

0.19

24

5.6

28

338



Dalboa Const. Co.
Have destroyed
S.P. Loring + Lament
" Case + Grand
R.P. in Case Loring + Lament