

George F. Roberts

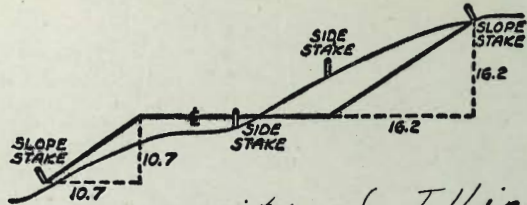

University of Illinois
class of 1939

DISTANCES FROM SIDE STAKES FOR CROSS-SECTIONING
SLOPE 1 TO 1, ROADWAY OF ANY WIDTH

	0	.1	.2	.3	.4	.5	.6	.7	.8	9	
0	0.00	0.10	0.20	0.30	0.40	0.50	0.60	0.70	0.80	0.90	0
1	1.00	1.10	1.20	1.30	1.40	1.50	1.60	1.70	1.80	1.90	1
2	2.00	2.10	2.20	2.30	2.40	2.50	2.60	2.70	2.80	2.90	2
3	3.00	3.10	3.20	3.30	3.40	3.50	3.60	3.70	3.80	3.90	3
4	4.00	4.10	4.20	4.30	4.40	4.50	4.60	4.70	4.80	4.90	4
5	5.00	5.10	5.20	5.30	5.40	5.50	5.60	5.70	5.80	5.90	5
6	6.00	6.10	6.20	6.30	6.40	6.50	6.60	6.70	6.80	6.90	6
7	7.00	7.10	7.20	7.30	7.40	7.50	7.60	7.70	7.80	7.90	7
8	8.00	8.10	8.20	8.30	8.40	8.50	8.60	8.70	8.80	8.90	8
9	9.00	9.10	9.20	9.30	9.40	9.50	9.60	9.70	9.80	9.90	9
10	10.00	10.10	10.20	10.30	10.40	10.50	10.60	10.70	10.80	10.90	10
11	11.00	11.10	11.20	11.30	11.40	11.50	11.60	11.70	11.80	11.90	11
12	12.00	12.10	12.20	12.30	12.40	12.50	12.60	12.70	12.80	12.90	12
13	13.00	13.10	13.20	13.30	13.40	13.50	13.60	13.70	13.80	13.90	13
14	14.00	14.10	14.20	14.30	14.40	14.50	14.60	14.70	14.80	14.90	14
15	15.00	15.10	15.20	15.30	15.40	15.50	15.60	15.70	15.80	15.90	15
16	16.00	16.10	16.20	16.30	16.40	16.50	16.60	16.70	16.80	16.90	16
17	17.00	17.10	17.20	17.30	17.40	17.50	17.60	17.70	17.80	17.90	17
18	18.00	18.10	18.20	18.30	18.40	18.50	18.60	18.70	18.80	18.90	18
19	19.00	19.10	19.20	19.30	19.40	19.50	19.60	19.70	19.80	19.90	19
20	20.00	20.10	20.20	20.30	20.40	20.50	20.60	20.70	20.80	20.90	20
21	21.00	21.10	21.20	21.30	21.40	21.50	21.60	21.70	21.80	21.90	21
22	22.00	22.10	22.20	22.30	22.40	22.50	22.60	22.70	22.80	22.90	22
23	23.00	23.10	23.20	23.30	23.40	23.50	23.60	23.70	23.80	23.90	23
24	24.00	24.10	24.20	24.30	24.40	24.50	24.60	24.70	24.80	24.90	24
25	25.00	25.10	25.20	25.30	25.40	25.50	25.60	25.70	25.80	25.90	25
26	26.00	26.10	26.20	26.30	26.40	26.50	26.60	26.70	26.80	26.90	26
27	27.00	27.10	27.20	27.30	27.40	27.50	27.60	27.70	27.80	27.90	27
28	28.00	28.10	28.20	28.30	28.40	28.50	28.60	28.70	28.80	28.90	28
29	29.00	29.10	29.20	29.30	29.40	29.50	29.60	29.70	29.80	29.90	29
30	30.00	30.10	30.20	30.30	30.40	30.50	30.60	30.70	30.80	30.90	30
31	31.00	31.10	31.20	31.30	31.40	31.50	31.60	31.70	31.80	31.90	31
32	32.00	32.10	32.20	32.30	32.40	32.50	32.60	32.70	32.80	32.90	32
33	33.00	33.10	33.20	33.30	33.40	33.50	33.60	33.70	33.80	33.90	33
34	34.00	34.10	34.20	34.30	34.40	34.50	34.60	34.70	34.80	34.90	34
35	35.00	35.10	35.20	35.30	35.40	35.50	35.60	35.70	35.80	35.90	35
36	36.00	36.10	36.20	36.30	36.40	36.50	36.60	36.70	36.80	36.90	36
37	37.00	37.10	37.20	37.30	37.40	37.50	37.60	37.70	37.80	37.90	37
38	38.00	38.10	38.20	38.30	38.40	38.50	38.60	38.70	38.80	38.90	38
39	39.00	39.10	39.20	39.30	39.40	39.50	39.60	39.70	39.80	39.90	39
40	40.00	40.10	40.20	40.30	40.40	40.50	40.60	40.70	40.80	40.90	40
41	41.00	41.10	41.20	41.30	41.40	41.50	41.60	41.70	41.80	41.90	41
42	42.00	42.10	42.20	42.30	42.40	42.50	42.60	42.70	42.80	42.90	42
43	43.00	43.10	43.20	43.30	43.40	43.50	43.60	43.70	43.80	43.90	43
44	44.00	44.10	44.20	44.30	44.40	44.50	44.60	44.70	44.80	44.90	44
45	45.00	45.10	45.20	45.30	45.40	45.50	45.60	45.70	45.80	45.90	45
46	46.00	46.10	46.20	46.30	46.40	46.50	46.60	46.70	46.80	46.90	46
47	47.00	47.10	47.20	47.30	47.40	47.50	47.60	47.70	47.80	47.90	47
48	48.00	48.10	48.20	48.30	48.40	48.50	48.60	48.70	48.80	48.90	48
49	49.00	49.10	49.20	49.30	49.40	49.50	49.60	49.70	49.80	49.90	49
50	50.00	50.10	50.20	50.30	50.40	50.50	50.60	50.70	50.80	50.90	50

Distance of slope stake from side or shoulder stake for any width roadway, slope 1 to 1. If ground is nearly level, the out or fill at side stake is located by the double entry method in left column and top row. The number in body of table in same row and column gives distance from side stake to slope stake. If ground is not level estimate the difference in elevation between the side stake and slope stake, lower target by this amount if cut, elevate if fill. Add this amount to cut or fill and find distance in table. Set up rod at this point, and line of sight should cut target. If it does not make the slight adjustment necessary.

G 369

MICROFILMED

APR 16 1965

	0
0	0.00
1	1.00
2	2.00
3	3.00
4	4.00
5	5.00
6	6.00
7	7.00
8	8.00
9	9.00
10	10.00
11	11.00
12	12.00
13	13.00
14	14.00
15	15.00
16	16.00
17	17.00
18	18.00
19	19.00
20	20.00
21	21.00
22	22.00
23	23.00
24	24.00
25	25.00
26	26.00
27	27.00
28	28.00
29	29.00
30	30.00
31	31.00
32	32.00
33	33.00
34	34.00
35	35.00
36	36.00
37	37.00
38	38.00
39	39.00
40	40.00
41	41.00
42	42.00
43	43.00
44	44.00
45	45.00
46	46.00
47	47.00
48	48.00
49	49.00
50	50.00

Distance
ground is in
column and
side stake to
side stake a
cut or fill at
If it does not

DIRECTIONS FOR USE OF TABLES

TABLE No. XIV

Distance of slope stake from side or opposite
stake for any width roadway slope 1N to 1.
If ground is level level the cut or fill at

IMPROVED TABLES
AND
INFORMATION

TABLE No. VIII

To find Tangent and External for curve of
any other degree divide by degree of curve and
add percentage found in column of tangents.
Degree of curve with a given T may be found
by dividing tangent (or external) opposite by
given tangent (or external).
The distance from a point on the tangent to
the curve is very nearly the square of the tangent
length divided by twice the radius of curve.

Roberts
Rorer
Moore
Morales
7-19-56
IND. #20118

Grade Stakes for Storm Drain
in Block 434, C. Seaman's Subd.

12880-L FB 22447929

1729 BRK
222.59
217.40
C 5.19
3711.4
176.39
163.6
C 12.79

0+97.75
231.06
226.40
C 4.66
2+86.4 BRK
178.91
166.00
C 12.91

0+66.50 BRK
243.42
235.40
C 8.02
2+73.9 BRK
182.66
168.00
C 14.66

0+54 BRK
243.66
236.80
C 6.86
2+40.60 Angle point left
Hub = 181.20V
187.18
180.00
C 7.18

0+27
242.93
237.07
C 5.86
2+02.60 BRK
192.55
187.60
C 4.95

Make Connection
0+00 Brookes & Hawk INV 237.34 Curb 242.89
242.93
1465.80
209.32
202.50
C 6.82

4767.65

152.19
196.26
C 5.93

~~152.19~~
~~151.80~~
146.33
~~C 5.47~~

~~C 6.86~~
15862

15824
151.60

~~C 6.64~~
C 7.02

16290
~~16249~~

15400
~~C 8.49~~

C 8.90
16383

~~16341~~
156.4

~~C 7.01~~
C 7.43

16612
158.8
C 7.32

17181
161.2
C 1061

4736.4 BRK

4711.4

3786.4

3761.4

3736.4

Due to Wrong elevation for

Rim of MH in F.B. 2244

15324
12.31
14093

15160
~~140.93~~
29253
146.26

Exist. Clean out INK 141.07 Rim 152.87
4798.90 Goldfinch 140.93 153.24
Ours

F.B. 2244

Roberts
Koper
Moore
Morales
7-20-56
W.R. #32607

Grade Stakes for Alley in Block
16, Ocean Beach

3075-D F.B. 2347 pg. 19

3

0+80	8315 81.84 C 1.31	8368 82.14 C 1.54	2710	7311 72.75 C 0.36	7418 73.05 C 1.13
------	-------------------------	-------------------------	------	-------------------------	-------------------------

0+55	8436 83.78 C 0.58	85.33 84.08 C 1.25	1785	7469 74.34 C 0.35	7534 74.64 C 0.70
------	-------------------------	--------------------------	------	-------------------------	-------------------------

0+30 E.V.C.	8583 85.72 C 0.11	86.78 86.02 C 0.76	1760 E.V.C.	7696 75.93 C 1.03	7721 76.23 C 0.98
-------------	-------------------------	--------------------------	-------------	-------------------------	-------------------------

0+20	8645 86.41 C 0.04	8785 86.75 C 1.10	1740	7764 77.27 C 0.37	7843 77.57 C 0.86
------	-------------------------	-------------------------	------	-------------------------	-------------------------

0+10	8697 86.92 C 0.05	8791 87.38 C 0.53	1720 P.V.C.	7979 78.75 C 1.04	8128 79.05 C 2.23
------	-------------------------	-------------------------	-------------	-------------------------	-------------------------

0+00 Fraude	87.34	87.95 ✓	1705	8076 79.91 C 0.85	8196 80.21 C 1.75
-------------	-------	------------	------	-------------------------	-------------------------

3+40	64.79 64.57 C0.22	66.97 64.87 C2.10	4+85	57.34 56.80 F0.54	59.35 57.64 C1.71
------	-------------------------	-------------------------	------	-------------------------	-------------------------

3+20 PVC	65.77 65.57 F0.20	67.56 66.07 C1.49	4+60	58.58 57.70 F0.88	60.55 58.88 C1.67
----------	-------------------------	-------------------------	------	-------------------------	-------------------------

3+10	66.68 66.40 C0.28	67.88 66.70 C1.18	4+35	59.97 59.81 C0.16	60.67 60.11 C0.56
------	-------------------------	-------------------------	------	-------------------------	-------------------------

2+85	67.99 67.99 GRADE	69.42 68.29 C1.13	4+10	61.07 61.04 C0.04	62.58 61.34 C1.24
------	-------------------------	-------------------------	------	-------------------------	-------------------------

2+60	L 69.58 69.35 F0.23	70.83 69.88 C0.95	3+85	62.44 62.27 C0.17	63.94 62.57 C1.37
------	------------------------------	-------------------------	------	-------------------------	-------------------------

2+35	71.16 70.70 F0.46	72.44 71.46 C0.98	3+60 E.V.C.	64.76 63.51 C1.25	64.67 63.81 C0.86
------	-------------------------	-------------------------	-------------	-------------------------	-------------------------

Roberts
 7-20-19
 W.O.#32617

Grade Stakes for Alley in Block 35
 13, Ocean Beach and Block 97,
 Point Loma Heights

3076-D

FB.2347 Pg 8

5+98.72 Ebers

49.26
 ✓

49.52

0+20 EIC

142.84
 142.37
 C0.47

//////

5+80

5246
 51.86
 C0.60

5428
 52.16
 C2.12

0+16 EIC

//////

144.61
 143.66
 C0.95

5+70

5296
 52.96
 GRADE

5487
 53.26
 C1.61

0+14

143.39
 143.22
 F0.17

//////

5+60 EIC.

5385
 53.65
 C0.20

5547
 53.95
 C1.52

Prop.
 Line
 0+12

//////

145.07
 144.46
 C0.61

5+35

5504
 54.88
 C0.16

5750
 55.18
 C2.32

0+08

143.66
 143.48
 C0.18

145.05
 144.58
 C0.47

5+10

5618
 56.11
 C0.57

5788
 56.41
 C1.47

Curb Line 143.42
 0+00 Gizot

144.50

TBM 143.90 @ Alley 7' Line Gizot P.K. Nail

1+52 BRK	119.94 119.59 F0.35	121.75 120.24 C1.51	Angle R. 2+86.58 L. 2+86.58		
1+27	122.47 121.91 F0.56	122.77 122.71 F0.06	2+72 PVC	113.12 112.70 C1.02	115.71 112.40 C3.31
1+02 EVC	125.00 124.40 F0.60	127.65 125.30 C2.35	2+37	115.14 114.50 C0.64	117.61 114.80 C2.81
0+82	127.74 126.68 F1.06	128.04 127.84 F0.20	Angle R. 2+36.53 R. 2+32.53	115.25 114.81 C0.44	118.18 115.11 C3.07
0+62 PVC	131.96 128.69 F3.27	132.26 128.69 F3.57	2+02 BRK	116.11 116.90 F0.79	118.05 117.20 C0.85
0+41	137.16 134.56 F2.60	137.45 136.43 F1.02	1+77	118.42 117.03 F1.39	118.98 118.72 C0.26

4+02 EVC	100.67 100.35 F 0.32	101.28 100.97 C 0.31	5+32 EVC	94.11 93.70 C 0.41	96.88 94.00 C 2.88
----------	----------------------------	----------------------------	----------	--------------------------	--------------------------

3+82	102.70 101.95 C 0.75	103.05 102.25 C 0.80	5+12	94.93 94.64 F 0.29	96.72 95.23 C 1.49
------	----------------------------	----------------------------	------	--------------------------	--------------------------

3+62 PVC	103.97 103.70 C 0.27	106.61 104.00 C 2.61	4+92 PVC	96.07 96.03 C 0.04	97.61 96.33 C 1.28
----------	----------------------------	----------------------------	----------	--------------------------	--------------------------

3+32	106.97 106.70 C 0.27	108.20 107.00 C 1.20	4+62	98.45 97.58 C 0.87	98.84 97.88 C 0.96
------	----------------------------	----------------------------	------	--------------------------	--------------------------

3+02 EVC	111.13 109.70 C 1.43	113.24 110.60 C 3.24 11-5	4+42	Sewer Lat. ① //////	99.49 ZNV. 94.90 C 4.59
----------	----------------------------	---------------------------------	------	------------------------	-------------------------------

2+87	112.65 111.05 C 1.60	114.43 111.35 C 7.08	4+32	99.55 99.13 C 0.42	99.49 99.43 C 0.06
------	----------------------------	----------------------------	------	--------------------------	--------------------------

2+20 E.V.C.
96.33
96.18
C0.15

96.57
96.48
C0.09

3+00 BRK.
89.62
89.30
C0.32

89.80
89.60
C0.20

2+00
98.18
97.62
F0.56

98.77
98.48
C0.29

Angle Pt. Rt.
2+85.14
90.59
89.74
F0.85

91.01
90.89
C0.12

1+80 P.V.C.
100.72
100.34
F0.38

100.77
101.02
F0.25

2+60
92.74
89.66
F3.08

93.04
92.40
F0.64

1+45
105.65
105.39
F0.26

107.88
105.95
C1.93

Sewer
2+75 Lat. (2) // // //

91.51
86.75
C4.76

1+10 E.V.C.
111.02
110.59
C0.43

111.40
110.89
C0.51

~~Sewer
2+70 Lat. (3)~~ 86.88

~~OMIT~~ owner's orders

1+00
112.14
112.12
F0.02

112.61
112.44
C0.17

Angle Pt. Lt.
2+49.18
93.67
93.66
F0.01

93.97
93.57
F0.40

6 + 00.13 Froude 73.66

73.87

2 4710

8498
84.46
C 0.52

8728
84.76
C 2.52

5470

7848
77.28
C 1.20

7847
77.58
C 0.89

2 3780

8669
85.47
C 1.21

8717
85.77
C 1.40

5450

7963
79.27
C 0.36

8140
79.57
C 1.83

1 3750 BRK

8650
86.41
F 0.09

8750
86.80
C 0.70

5430 P.V.C.

80.42
80.12
F 0.30

8280
80.72
C 2.08

Sewer
1 3740 Lat. ①

//////

8796
82.36
C 5.60

5400

81.43
81.07
F 0.36

8418
81.73
C 2.45

Sewer
1 3732 Lat. ④

OMIT

82.62
Chat Nelson's

orders

4470

82.44
81.75
F 0.69

8477
82.74
C 2.03

1 3725

8827
87.90
C 0.37

8834
88.20
C 0.14

4440

8435
83.45
C 0.90

8585
83.75
C 2.10

Roberts

Stake Curb Returns at
Mo. & Ingraham8-6-56
MO# 32602

3284-D

South

~~South~~

North

~~North~~

Ingraham

#4

8990
88.87
C1.039128
91.20
C0.08

#3

8996
89.25
C0.919110
91.04
F0.06

#2

9030
89.65
C0.659119
91.10
C0.09

#1

9060
90.10
C0.509132
91.22
C0.1090.51
90.50

91.44/91.49



Missouri

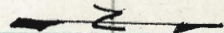

Roberts Grade Stakes for Sewer from
Rarer
Moore
Harold
8-9-56
W.O. #32582

Amherst #67th to 68th St.

3/48-D F.B. 2334 pg. 13

12

1+18.31 MH #2

5th

43013
427.86
C 2.27

2+50

428.26
427.74
F 0.52

1+00

431.18
427.81
C 3.37

2+25

428.18
427.07
F 1.11

0+75

432.04
427.73
C 4.31

2+00

428.11
426.79
F 1.32

0+50

433.00
427.66
C 5.34

1+75

428.03
426.88
F 1.15

0+25

433.19
427.58
C 5.61

1+50

427.96
427.68
F 0.28

0+00 MH #1

Amherst
#67th

432.76
427.57
C 5.19

1+25

427.88
424.98
F 2.90

453.70

3+75

43272
428.69
C 4.03

5+25

44146
429.89
C 11.57

3+62.61 MA*3

43162
428.59
C 3.03

5+00

44194
429.69
C 12.25

3+50

43123
428.56
C 2.67

4+75

44021
429.49
C 10.72

3+25

42864
428.48
C 0.16

4+50

43840
429.29
C 9.11

3+00

42911
428.91
C 0.70

4+25

43651
429.09
C 7.42

2+75

42833
42832
F 0.01

4+00

43450
428.89
C 5.61

6+75

439.80
431.09
C 8.71

8+25

443.23
434.67
C 8.56

6+50

437.63
430.89
C 6.74

8+00

440.58
433.98
C 6.60

6+25

436.88
430.67
C 6.19

7+75

439.20
433.30
C 5.90

6+00

438.11
430.49
C 7.62

7+50

439.25
432.61
C 6.64

5+75

439.50
430.29
C 9.21

7+25

438.92
431.93
C 6.99

5+50

440.04
430.09
C 9.95

7+0235 MH#4

↳ 0+00 to North
see pg. 16438.79
431.31
C 7.48

9+50

44609
438.12
C 7.97

11+00

45242
442.62
C 9.809+40.77 MH#5 (68th SE.)↖ 0+00 to North
see pg. 1644596
437.84
C 8.12

10+75

45743
441.27
C 9.56

9+25

44599
437.41
C 8.58

10+50

45031
441.12
C 9.19

9+00

44607
436.72
C 9.35

10+25

44922
440.37
C 8.85

8+75

44538
436.04
C 9.34

10+00

44792
439.62
C 8.30

8+50

44497
435.35
C 9.62

9+75

44680
438.87
C 7.99

0+50

445.43
435.07
C18.360+00 = 9+40.77 MH#5
see pg. 15437.80
C8.12

0+25

441.02
433.19
C7.93

1+43.07 DE

447.26
442.05
C5.210+00 = 7+02.35 MH#4
see pg. 14431.32
C7.48

1+25

446.55
440.69
C5.86

11+52 D.E.

454.41
~~444.18~~
C10.23

1+00

447.71
438.82
C8.89

11+25

453.38
443.37
C10.01

0+75

447.37
436.94
C10.43

1+52 D.E.

44543
438.41
C 7.02

1+25

44516
438.30
C 6.86

1+00

438.20
~~44495~~
438.20
C 6.75

0+75

44499
438.10
C 6.89

0+50

44510
438.00
C 7.10

0+25

44538
437.90
C 7.48

Roberts
Korer
Moore
Morales
8-8-56
WD # 32544

Grade Stakes for Curb in
33rd St. From "A" St. North.

3173-D

FB 2349 pg. 62
FB 2372 pg. 18

	165.36	165.86	165.27	165.27
0+55 BRK	164.54	164.40	164.96	164.70
	C 0.82	C 0.96	C 0.31	C 0.57

	163.77	163.77	164.05	164.05
0+32.5	162.65	162.58	163.11	162.98
	C 1.12	C 1.19	C 0.94	C 1.07

	161.42	161.80	161.92	161.92
0+00 B.C.	160.76	161.27	161.27	161.27
	C 0.66	C 0.53	C 0.65	C 0.65

#2	161.13	161.58	170.24	170.12
	159.95	160.78	± EXIST. 170.03	169.28
	C 1.18	C 0.80	1+20 Curb. CO.09	C 0.84

#1	160.51	161.30	168.94	168.94
	159.25	160.85	168.32	167.78
	C 1.26	C 0.45	1+00 C 0.62	C 1.16

EC. on "A" St.	160.46	161.50	166.96	166.96
	159.00	161.30	166.43	166.09
	C 1.46	FO.20	0+77.5 C 0.53	C 0.87

158.58 9.2% in comparison

Grade change
per Gilson 8-13-56

Set 160.3 at M.H.

checked our rough grade stakes within 0.5'.
something wrong with plans.

FB does not agree - same bench mark used too!

1+21.6 EXIST = 170.54

Broken 170.09 Exist 169.71

	168.80	168.80	168.80	168.80
	168.65	168.17	168.65	168.17
	C 0.25	C 0.63	C 0.25	C 0.63

	167.16	167.16	167.16	167.16
	166.80	166.43	166.80	166.43
	C 0.36	C 0.73	C 0.36	C 0.73

Roberts Grade Stakes for Curb Ash St.

8-8-56

Bancroft to 33rd

M.G. #32544

3174-D FB2349 pg 60

#5	190.75	19124 190.75 C 0.49	0+40	19448 194.25 C 0.23	19305 192.75 C 0.30
#4	190.70	19145 190.70 C 0.75	0+20	19386 193.70 C 0.16	19300 192.20 C 0.80
#3	190.50	19138 190.50 C 0.88	0+00 EC	19308 193.00 C 0.08	19265 191.50 cb. C 1.15
#2	19282 192.80 C 0.02	190.28 19135 190.28 C 1.07	#8		19245 190.90 C 1.55
#1	193.00 192.93 F 0.07	190.45 19185 190.45 C 1.40	#7		19099 190.85 C 0.14
BC, Bancroft	193.56 190.50	191.56 cb. 191.52	#6	19080 190.49 F 0.31	190.80 190.46 F 0.34

90 v 124 x

Paint

F 8 M					
	1+60	19174 191.35 C 0.39	19052 190.30 C 0.12		
	* 1+40	19265 192.57 C 0.08	19136 191.30 C 0.06		
	# 1+20	19355 193.50 C 0.05	192.00 191.84 F 0.16		
	* 1+00	194.13 194.11 F 0.02	192.63 192.46 F 0.17	WL. 33 rd 2+10.37 Exist. G.	188.00 188.05 186.89 186.98
	# 0+80	19456 194.47 C 0.09	192.87 192.69 F 0.18	1+90	189.49 189.00 C 0.49 188.74 188.49 C 0.25
	E 0+60	19451 194.51 GRADE	195.01 192.78 F 0.23	1+80	19024 189.85 C 0.71 189.74 189.00 C 0.74

Roberts Grade Stakes for Curb in Ash
8-9-56 St., 33rd to Felton

W.O. #32544

3174-D F.B. 2349 pg. 60

1+07.5	19628 196.15 C 0.13	19460 194.50 C 0.10		
0+80 EVC	19400 194.00 GRADE	192.00 191.90 F 0.10	Exist cb. Felton 2+10.05	203.51 203.47 203.00 202.94
0+60	19259 192.38 C 0.21	19068 190.45 C 0.23	203.15 203.15 2+00 202.89 F 0.26	203.15 203.15 202.65 202.65 202.40 202.55 F 0.25 F 0.10
0+40	19103 191.00 C 0.03	18951 189.38 C 0.13	1+90 PVC	202.70 202.60 C 0.10 202.00 201.92 F 0.08
0+20	189.95 189.87 F 0.08	18881 188.00 C 0.81	1+62.5	200.70 200.45 C 0.25 199.50 199.44 F 0.06
EL. 3357 0+00	189.00 188.90 Exist cb	187.98 187.95	1+35	198.44 198.30 C 0.14 197.09 197.00 C 0.09

Roberts
Moore
Moralez
W.P. #32600
10-15-56

Rough Grade Stakes
Hartford - Milton South
12374-L
No Field Book!

Midpoint C/D Sec

142.59
142.26
F 0.3
22

144.70
142.72
3 + 38.72 Cb. BC.
20' Rad. Sect. C 2.0

142.23
142.22
GRADE

53
53
0 + 93.53 EC

146.27
140.64
C 2.6

142.99
140.14
C 2.9

2 + 83.53

145.50
142.45
C 3.0

143.93
141.95
C 2.0

30' RP Both Ways
West
50' RP of RP to West
right is uplot - Haly
Luther ball

0 + 53.53 C 8.7

145.62
137.82
C 1.8

139.83
137.32
C 2.5

2 + 33.53

145.95
142.20
C 3.8

143.66
141.70
C 2.0

0 + 31.17 C 10.8

144.79
135.75
C 9.0

137.45
135.25
C 2.2

1 + 83.53

146.51
141.95
C 4.6

144.34
141.45
C 2.9

146.1 - Elev
sub grade - 140.1
C 6.0

1 + 33.53 EC

147.13
141.70
C 5.4

144.78
141.20
C 3.6

0 + 00 PCC
PCC C 10.0

136.59
134.12
C 2.5

135.06
131.84
C 3.2

1 + 13.53

146.90
141.39
C 5.5

144.25
140.89
C 3.4

Griffith is grading lots and will take
out all lot pipes. on EAST.

chisel SW Ret. Hartford & Milton 128.56

141.3
12
140.1

Roberts
Moore
Morales
10-17-56
WG# 32125

Grade Stakes for Alley in
Block 9, Bird Rock City by the Sea
3242-D

23

1+00 EK	124.95 124.88 F0.07	125.67 125.20 C0.47	2+37.75 G Type G Cleanout	123.12 Parment 120.95 C2.17	123.12 INVERT 118.10 C5.02
0+80	125.75 125.71 C0.04	126.64 125.96 C0.68	2+20	120.70 120.10 F0.60	122.16 120.95 C1.21
0+60	126.38 126.12 C0.26	128.94 126.37 C2.53	2+10 G Type D Catch Basin	122.03 Parmit 120.34 C1.71	122.05 INVERT 118.40 C3.65
0+40	126.24 126.18 C0.06	127.32 126.73 C0.89	2+00	121.48 120.75 C0.73	122.23 121.00 C1.23
0+20	127.38 125.90 C1.48	127.15 126.15 C1.00	1+80 FVC	121.40 121.34 C0.06	122.52 121.59 C0.93
N.L. 0+00 Birdrock	125.28	125.64	1+40	123.39 123.14 C0.25	124.02 123.39 C0.63

135.12 SEBP. Birdrock \neq Bellvue

*					
3+70	13066 128.80 C 1.86	13083 129.05 C 1.78	5+30	13059 129.90 C 0.69	13182 130.15 C 1.67
3+50	12940 127.96 C 2.44	12964 128.21 C 1.43	5+00	129.81 129.56 F 0.25	13162 130.06 C 1.56
3+30 PVC	12725 126.81 C 0.44	12871 127.06 C 1.65	4+70	130.00 129.72 C 0.28	13277 129.97 C 2.80
2+95	12489 124.57 C 0.30	12690 124.77 C 2.13	4+40	129.63 129.43 F 0.20	13206 129.88 C 2.18
2+60 EVC	122.24 120.99 F 1.25	12359 122.49 C 1.10	4+10 EVC	13060 129.54 C 1.06	13252 129.77 C 2.73
2+40	12198 121.20 C 0.78	12325 121.45 C 1.80	3+90	13084 129.32 C 1.52	13125 129.57 C 1.68

Drain

1+33.10 } East Curb Line
 } of Waverly

11284
112.82 Gutter

1+17.71

11450
113.00
C 1.50

1+00

11532
113.78
C 1.54

0+75

11641
114.86
C 1.55

0+50

11742
115.94
C 1.48

5+71.79 END 160 BK
PAVING Pav

13222
130.03
C 2.19

13177
130.28
C 1.49

0+25

11938
117.02
C 2.36

5+60

150 BK Pav

13246
129.99
C 2.47

13219
130.24
C 1.95

0+00 = 2+37.75 Type G
Cleanout See PAGE 23 118.10

Roberts
Moore
Morales
10-18-56
W.O.#62411

Grade Stakes Landis Street,
39th to 40th
2822-D

26

Midpoint	329.48 329.38 C0.10	//////	2+00.30	///	329.24 32890 F034
0+57.32	///	32891 328.70 C0.21	1+77.44	///	329.18 32883 F033
0+28.66	///	32868 328.48 C0.20	1+54.58	///	329.11 32879 F032
Mid point	328.66 32817 F0.49	//////	1+31.72	///	329.05 32866 F0.39
0+06 B.C.cb	328.57 32781 F0.76	//////	1+08.86	///	328.98 32856 F0.42
0+00 Begin ch 39th	328.51 32726 F1.25	328.27 32763 F0.64	0+86	///	328.92 32871 F0.21

332.15 NEBP 40th & Landis

#3

///

329.59
329.31
F0.28

#2 PRC

///

329.53
329.34
F0.19

#1

///

329.50
329.25
F0.25

EC

////

329.95
329.40
C0.552+68.88^{cb}_{BC}

///

329.47
329.12
F0.35

3' Rad Point PRC

////

329.95
329.42
C0.53

2+46.02

///

329.37
329.34
F0.03

#5

////

329.47
329.41
F0.06

2+23.16

///

329.31
329.05
F0.26

#4

///

329.53
329.51
F0.02

Roberts
Moore
Morales
10-30-36
NO # 21125

Grade Stakes for Drain in P.L. 1782,
Near La Jolla Mesa Dr. & Tereno R.d.

See 6032-B

B-13

1+04 END
25084
243.70
C7.14

1+00
25074
243.96
C6.78

0+75
25530
245.59
C9.71

0+50
25620
247.22
C8.98

0+25
25402
248.85
C5.17

0+00
25634
250.50
C5.84

28

Set bench on iron pin =
Elev. 257.59

Roberts

Curb Grades Hartford St.

12374-L

11-9-56
H.O. # 32600

FB. 1759 pg. 2

0+53.53 FV

137.82
137.40
F 0.42

137.67
137.32
C 0.35

1+13.53

141.66
141.39
C 0.27

140.89
140.86
F 0.03

0+31.17

135.80
135.75
C 0.05

135.83
135.25
C 0.58

0+93.53 EC

141.00
140.64
C 0.36

140.14
140.05
F 0.09

0+16.5

135.37
134.55
C 0.82

///

0+83.53

140.30
140.10
C 0.20

139.62
139.60
C 0.02

0+06.6

135.22
134.20
C 1.02

///

0+73.53

139.17
139.45
F 0.28

139.09
138.95
C 0.14

PCC
0+00 PRC

135.46
134.12
C 1.34

132.18
131.84
C 0.34

0+63.53

138.69
138.35
F 0.34

138.47
138.19
C 0.28

11-
W.C.

2+25	14225 142.15 C0.10	141.65 141.58 F0.07	#1-PRC	142.76 142.53 F0.23	142.76
2+00	142.03 142.01 F0.02	141.63 141.53 C0.10	3+38.72 BC	142.77 142.72 C0.05	142.22 142.21 F0.01
1+75	141.94 141.90 C0.04	141.52 141.40 C0.12	3+25	142.75 142.63 C0.10	142.15 142.10 F0.05
1+50	141.85 141.78 C0.07	141.36 141.28 C0.08	3+00	142.53 142.31 F0.22	142.03 142.01 F0.02
1+33.53 EVC	141.83 141.70 C0.13	141.20 141.20 GRADE	2+75	142.40 142.40 GRADE	141.90 141.82 F0.08
1+23.53	141.69 141.60 C0.09	141.10 141.02 F0.08	2+50	142.44 142.28 C0.16	141.78 141.69 F0.09

#7 - Midpoint

142.72
142.59
C 0.13

#6

14339
142.67 142.67
C 0.72

#5

14358
142.73 142.73
C 0.85

#11 - FRC

142.28
142.25
F 0.03

#4

14347
142.78 142.78
C 0.69

#10

14184
142.35
F 0.51

#3

142.83 142.83
142.75
F 0.08

#9

142.43
142.19
F 0.24

#2

14323
142.76 142.77
C 0.46

#8

142.51
142.47
F 0.04

Roberts Rough Grades Loring St.

1113-56

Lamont to Ely D.E.

W.O. #31826

See 76/0.6

1460

22630
217.90
C 8.4

21828
217.40
C 0.9

4400

23385
223.00
C 10.9

222.50
221.92
F 0.6

1420

22068
214.62
C 6.1

21412
212.59
F 1.5

3450

23201
222.75
C 9.2

22322
222.25
C 1.0

0+80

21561
212.10
C 3.5

211.60
210.85
F 0.7

3400

23306
222.50
C 10.6

22322
222.00
C 1.2

0+40

21411
211.04
C 3.1

210.05
209.19
F 0.9

2400 EVC

23478
222.30
C 12.5

22223
221.80
C 0.4

E.L.
0+00 Lamont

21319
210.70
C 2.5

208.70
208.44
F 0.3

2440

23434
222.00
C 12.3

22207
221.50
C 0.6

0-1477

← 21310 21310
20. Per. 210.70 Lr. 212.00 Per.
C 2.8 C 1.1

2400

23118
220.50
C 10.7

22056
220.00
C 0.6

206.85 246 CT

1406.58 END Q

212.30
211.06
F 1.2

0+86

2105
210.75
F 0.3

0+66

20978
209.50
C 0.30

0+66

~~20847~~
208.17
C 0.30

4498.95 DE

229.40
223.50
C 5.9223.00 Mon
219.42
F 3.6

0+26

206.75
174

4450

233.55
223.25
C 10.3222.75
221.45
F 1.30+00 N.L.
Malden

F 1.1

Roberts

Grade Stakes Alley Block 40,
Ocean Beach

34

71-19-56

WA#32670

3366-D

1+24	2969 29.59 C0.10	30.18 29.29 C0.89	2+64	3652 34.79 C1.73	3494 34.89 C0.05
0+98	29.51 29.47 F0.04	29.21 28.62 F0.59	2+30EVC	3324 32.46 C0.78	3250 32.41 C0.09
0+72	29.43 29.38 F0.05	29.13 28.57 F0.56	2+10	3235 31.28 C1.07	3274 31.26 C1.48
0+46	29.35 29.00 F0.35	29.05 28.59 F0.46	1+90	3093 30.42 C0.51	3070 30.41 C0.29
0+20BRK	2920 29.27 F0.07	28.97 28.78 F0.19	1+70	3024 29.88 C0.36	2990 29.73 C0.17
0+00 Sunset Cliffs Blvd.	29.09	28.88	1+50.PVC	3070 29.66 C1.04	3057 29.36 C1.21

28.1 3NWBP P₂ SS

			5+40	54.80 54.44 C 0.36	54.14 52.60 F 1.54
4400 PVC	44.59 44.10 C 0.49	44.51 43.83 C 0.68	5+15	53.49 52.58 C 0.91	52.43 52.28 C 0.15
3+66	42.86 41.78 C 1.08 ON Garage Apron U	42.33 41.00 F 1.33	4+90	51.66 50.72 C 0.94	50.42 49.75 F 0.67
3+62.5 Sewer Lat on left ①	36.40 IN	NEW Apt.	4+65	50.19 48.86 C 1.33	48.56 48.33 F 0.23
3+32	40.82 39.45 C 1.37	39.85 38.92 F 0.93	4+40 EVC	47.23 47.00 C 0.23	46.92 46.70 C 0.22
2+98	38.47 37.12 C 1.35	37.37 36.69 F 0.68	4+20	46.57 45.53 C 1.04	47.90 45.24 C 2.66

56.40 NEBP Pes Eb

579851 EBERS

58.90

58.48
✓

5790BRK

59.87
58.17
C 1.70

5836
57.87
C 0.49

5765

5639
56.30
C 0.09

5620
56.00
C 0.20

Roberts
Korol
Moore
Moore
11-26-56
W.D. #21534

Stake Drain at Fern Glen
and Neptune Place.

6268-B

37

1428 DE

115
7.9
C 3.6

0488.75

135
10.1
C 3.4

0449.5 EG

154
12.4
C 3.0

0432 BC

144
13.4
C 1.0

END EXISTING
0400 15" C MP

15.3
✓

27

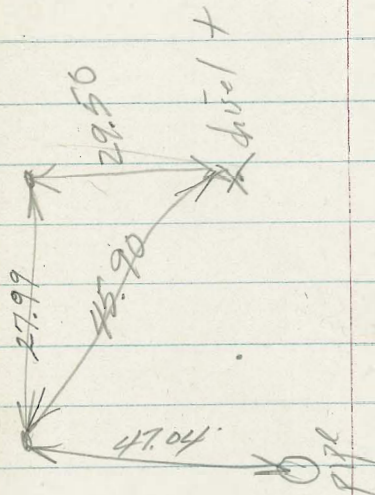

29.67 + in walk

Roberts
Foster
Moore
Morales
11-27-56
40.#31826

Curb Stakes Loring Street

Lamont Ely to D.E.

7610-L

38

0-14.74 ^{EC on} Left	21158 * 210.28 C 1.30	//////	0+80	21263 212.10 C 0.53	211.60 211.55 F 0.05
#5	21167 * 210.40 C 1.27	//////	0+60	21180 211.20 C 0.60	210.86 210.70 C 0.16
#4	21196 * 210.70 C 1.26	//////	0+40	21122 211.04 C 0.18	210.07 210.05 C 0.02
#3	21237 * 211.11 C 1.26	//////	0+20	21100 210.87 C 0.13	209.53 209.53 GRADE
#2 PRC on Left	21296 * 211.52 C 1.44	208.18 207.85 F 0.33	0+00 ^{EC on} Right	21118 210.70 C 0.48	208.94 208.70 C 0.24
#1	21334 * 212.00 C 1.34	207.55 207.43 F 0.12	0-07.37	211.43 * 210.20 C 1.23	//////

* Pavement Grade

2+00	220.68 220.50 C0.18	220.23 220.00 C0.23	3+25	222.93 222.63 C0.30	222.36 222.13 C0.23
1+80	219.35 219.35 GRADE	219.09 218.85 C0.24	3+00	222.55 222.50 C0.05	222.26 222.00 C0.26
1+60	218.13 217.90 C0.23	217.53 217.40 C0.13	2+75	222.41 222.38 C0.03	222.15 221.88 C0.27
1+40	216.62 216.26 C0.36	215.76 215.68 F0.08	2+60 ETC	222.30 222.30 GRADE	221.80 221.80 GRADE
1+20	215.03 214.62 C0.41	214.34 214.12 C0.22	2+40	222.00 221.81 F0.19	221.50 221.14 F0.36
1+00	213.70 213.24 C0.46	212.78 212.74 C0.04	2+20	221.40 221.18 F0.22	220.78 220.90 C0.08

			# 7 North End	212.71 212.30 C0.41	
2 4475	223.75 223.38 C0.37	222.72 222.88 F0.06	# 6	210.93 210.75 C0.18	
1 4450	223.36 223.25 C0.11	222.79 222.75 C0.04	# 5	210.18 210.13 C0.05	
			# 4	209.53 209.50 C0.05	
1 4425	223.17 223.13 C0.04	222.83 222.63 C0.20	# 3	208.88 208.83 C0.05	
1 4400	223.16 223.00 C0.16	222.59 222.50 C0.09	# 2	208.20 208.17 C0.13	208.17
			# 1 South End	206.73 206.73 GRADE	
1 3475	223.20 222.88 C0.32	222.63 222.38 C0.25			
1 3450	223.00 222.75 C0.25	222.40 222.25 C0.15	4498.95 DE.	226.79 223.50 C3.29	223.00 221.82 F 1.18

Lamont (Wly Side)

Roberts
Roser
Moore
Morales
11-29-56
WO# 21571

Stake Drain in Lots 45 & 46,
Blk. #22, Helpingstines Addition

6320-B

47

0+49.88 DE

4336
4172
C 1.64

0+49.88

39.85
39.63
C 0.22

0+19.88 EC

39.76
37.53
C 2.23

0+04 BC

39.22
36.41
C 2.81

0+00 Exist.

36.13

Roberts
Racer
Moore

12-4-56
IND. #32623

1+20

0+90

0+60 EVC

0+40

0+20

N.L.
0+00 EVC

Grade Stakes For Alley Block R,
Front of 1282 Milshire Place

Roberts

Retake Aly

(Paricks) as
per marked
print in

Parsons possession

Geo

All Grades are for
Top of Pavement.

42

2+90

2+55

2+20 EVC

2+00

1+80 FVC

1+50

357.44

355.25

C 2.19

358.04

357.00

C 1.04

359.50

358.75

C 0.75

360.41

359.62

C 0.79

361.02

360.21

C 0.81

361.68

360.91

C 0.77

354.95

354.59

F 0.36

356.70

355.02

F 1.68

358.45

357.38

F 1.07

359.32

358.14

F 1.18

359.91

358.88

F 1.03

36

360.61

360.10

F 0.51

Roberts
Roser
Moore

Grade Stakes For Alley Block R,
Tract No. 1382 Wilshire Place

All Grades are for
Top of Pavement.

42

12-4-56
IND. # 22623

3368-D

1+20

³⁶³⁰⁸
361.61
C 1.47

361.31
³⁶¹²⁵
F 0.06

2+90

³⁵⁷⁴⁴
355.25
C 2.19

354.95
³⁵⁴⁵⁹
F 0.36

0+90

³⁶³³⁸
362.31
C 1.07

³⁶³⁵⁹
362.01
C 1.58

2+55

³⁵⁸⁰⁴
357.00
C 1.04

³⁵⁷⁴⁴
356.70
³⁵⁵⁰²
F 1.68

0+60 EVC

³⁶⁴⁰⁰
363.00
C 1.00

³⁶³³⁰
362.70
C 0.60

2+20 EVC

³⁵⁹⁵⁰
358.75
C 0.75

358.45
³⁵⁷³⁸
F 1.07

0+40

³⁶⁴⁵⁸
363.20
C 1.38

³⁶³⁷⁶
362.90
C 0.86

2+00

³⁶⁰⁴¹
359.62
C 0.79

359.32
³⁵⁸¹⁴
F 1.18

0+20

³⁶⁴⁴⁷
362.90
C 1.57

³⁶³⁷⁶
362.60
C 1.16

1+80 P/C

³⁶¹⁰²
360.21
C 0.81

359.91
³⁵⁸⁸⁸
F 1.03

N. Line
0+00 El Cajon

362.35
Crown

362.10
Crown

1+50

³⁶¹⁶⁸
360.91
C 0.77

36
360.61
³⁶⁰¹⁰
F 0.51

4450 350.93 350.68 350.77 350.33
 350.54 350.54 349.46 349.46
 F0.39 F0.12 F1.31 F0.87

4425 33 350.85 350.54
 350.97 350.72 350.89 350.39
 350.85 C0.13 350.54 C0.15
 F0.12 F0.35

4400 EVC 35111 35111 35076
 351.00 350.76 351.00 350.46
 C0.11 C0.35 35076 C0.30
 F0.24

3780 35166 35166
 351.30 350.99 351.35 350.69
 C0.36 C0.67 34975 34975
 F1.60 F0.97

3760 FVC 35415 35475
 352.00 351.75 351.85 351.45
 C2.75 C2.00 351.13 351.13
 F0.72 F0.32

3725 35628 35434
 353.50 353.20
 C2.78 C1.14

*
 35211 35211
 6700 351.05 351.05
 C1.06 C1.06

35137 35137
 5775 351.00 350.94
 C0.37 C0.73

35257 35257
 5750 350.95 350.83
 C1.62 C1.77

35192 35192
 5725 350.90 350.72
 C1.02 C1.20

35280 35280
 5700 BRK 350.85 350.61
 C1.95 C2.19
 Begin Curb
 on Right

35130 35130
 4775 350.89 350.64
 C0.41 C0.66

Grade ↑
 350.04 350.02
 34930 34930
 F0.77 F0.72

350.16 350.06
 34887 34887
 F1.29 F1.19

35013
 350.29 350.11
 35013 C0.02
 F0.16

Grade ↓
 350.41 350.16
 34994 34994
 F0.47 F0.22

350.53 350.21
 34934 34934
 F1.19 F0.87

350.65 350.27
 34875 34875
 F1.90 F1.52

↑ Pavement Grade ↓

Midpoint Curb Return

35082
34971 Pavement GRADE
C1.11

6+07.47 ^{ELINE}
Meade
TOP CB → C0.64

Curb
E 35000 Pavement GRADE
34971
F0.29

Roberts
Rorer
Moore
12-6-56

Rough Grades Nogal Street
47th to 49th

45

WCF 32439

3308 & 3309 D

1+40 PVC

76.65
744
F 2.3

76.62
751
F 1.5

0+00 Radii
E. Escuela

78.65
7800
F 0.7

794
79.30
60.1

1+00

76.32
742
F 2.1

76.32
750
F 1.3

2+10.15 Radii
W. ESCUELA

77.45
759
F 1.6

77.77
77.3
F 0.5

0+80.7 water
Lateral (2) on Right

76.18
746
F 1.6

24.03 @ 75'
Tic 13 Mon

2+00
77.37
756
F 1.8

77.58
770
F 0.6

0+50

75.96
749
F 1.1

75.94
743
F 1.6

1+80
77.07
754
F 1.7

77.12
762
F 0.9

0+07 Rad. on
Right

//////

75.61
748
F 0.8

1+60
76.88
748
F 2.1

75.8
76.82
F 1.0

0+02 Rad. on
Left

75.92
75.62
60.3

//////

EL.
0+00 47th

1+50.7 water
Lateral (2) on Right

76.72
754
F 1.3

1+48	839 83.62 C0.3	84.96 84.3 F0.7	2+73	898 89.42 C0.4	917 90.76 C0.9
1+08 EVC	820 81.81 C0.2	83.13 830 F0.1	2+58	893 89.68 C0.6	910 90.04 C1.0
0+88	813 80.97 C0.3	82.25 821 F0.2	2+43	895 87.92 C0.6	899 89.30 C0.6
0+68	80.29 80.3 GRADE	816 81.49 C0.1	2+28 PVC	876 87.24 C0.4	88.63 88.5 F0.1
0+48	79.73 793 F0.4	812 80.80 C0.1	2+20 ^{Water} Lateral (3) on Right		88.27 881 F0.2
0+28 PVC	79.33 790 F0.3	808 80.20 C0.6	1+88	858 85.43 C0.4	86.79 863 F0.5

water
3+88 Lateral (4)

1019
97.40
C 4.5

on Left

30 1/2
4 3/4

47

73
3+67.21 Alley

97.3
95.96
C 1.3

//////

1+65

1123.5
110.65
110.05
C 1.6

111.4
110.08
C 1.3

53
3+48.21 Alley

94.21
94.04
F 0.2

//////

1+25

Water
0+90 Lateral (6)

111.4
108.43
110.8
106.0
C 4.8

on Left

107.86
106.2
F 1.6

3+43.21 Rad.
on Right
W. Haya
50' e line
13' above

//////

95.4
94.40
C 1.0

0+85

110.42
105.56
C 4.8

106.0
105.30
C 0.7

3+23

92.24
92.2
GRADE

93.70
93.30
C 0.4

0+45 PVC

Water
0+40 Lateral (5)

109.6
102.43
107.4
101.8
C 7.2

on Left

104.4
102.38
C 1.0

3+08

91.5
91.35
C 0.1

92.9
92.50
C 0.4

0+05

107.3
97.50
C 9.8

//////

2+81

9
90.25
900
F 0.3

920
91.50
C 0.5

Rad.
0+00 on Right
E. Haya

//////

100.8
98.96
C 1.8

4405	1185 118.00 C0.5	1202 118.05 C2.1
------	------------------------	------------------------

3465	1175 117.20 C0.3	1188 117.19 C1.6
------	------------------------	------------------------

3425	1173 116.33 C1.0	1197 116.15 C3.5
------	------------------------	------------------------

2485	1165 115.28 C1.2	1179 114.96 C2.9
------	------------------------	------------------------

2445	1146 114.10 C0.5	1164 113.61 C2.8
------	------------------------	------------------------

2405	1135 112.64 C0.9	1137 112.01 C1.7
------	------------------------	------------------------

6402.55 - Radii 49th	1264 125.02 C1.4
-------------------------	------------------------

5465 EVK	1267 122.68 122.6 F0.1	126.8 125.44 C1.4
----------	---------------------------------	-------------------------

5425	1228 120.52 1192 F1.3	120.57 C2.2
------	--------------------------------	----------------

4485 PVK	119.38 118.6 F0.8	1233 119.38 C3.9
----------	-------------------------	------------------------

4445 EVK Wally on 10.55	1192 118.76 C0.4	1218 118.76 C3.0
----------------------------	------------------------	------------------------

Roberts
Rocel
Moore
Morales
12-14-56
MO21511

Grade Stakes for Drain in
Benicia St. at Gaines

49

13062-L

0+50

23.80
23.38
F 0.42

2+04 P/C

31.24
22.26
C 8.98

0+25

24.37
24.05
C 0.32

1+75

30.72
22.55
C 8.17

0+00

Same →

24.30

1+50

30.48
22.80
C 7.68

Same stake
w/ly effect

Wly Inlet

cb 32.17
28.47
F 3.70

INV.

28.47
24.30
C 4.17

1+25

32.28
23.05
C 9.23

Ely Inlet

No. Stake

cb 32.67
27.96
F 4.71

INV.

27.96
27.00
C 0.96

1+00

28.45
23.30
C 5.15

Inlet End
12" RCP

28.40
28.20
C 0.20

0+75

23.55
22.83
F 0.72

37.87

Roberts Curb Stakes Nogal Street

12-19-56
W.O.# 32439

3308D & 3309D

0+22.5 ?
~~100.03 100.63 101.67~~
~~99.60 100.46 100.67~~
~~C 0.03 C 0.17 C 1.00~~

10942
109.67
1+45 F 0.25

109.01
109.01
GRADE

0+05 ?
~~99.10 99.10~~
~~98.50 98.90~~
~~C 1.60 C 0.20~~ 

108.61
108.43
1+25 C 0.18

107.86
107.74
F 0.12

0+00 EC.
Haya 

99.25
98.96
C 0.29

106.94
107.09
1+05 F 0.15

106.71
106.61
C 0.10

#2 → 96.55 96.55
along 96.00 shot 96.06
0-28 Alley Rad. → C 0.55 C 0.49

99.03
98.25
C 0.78

103.94
104.09
0+65 F 0.15

104.55
103.90
C 0.65

#1 → 97.55
END Alley Return → 96.10
C 1.45

99.98
97.70
C 2.28

102.43
102.43
0+45 FVC GRADE

103.56
102.38
C 1.18

2+65	114.74 114.70 C 0.04	114.57 114.30 C 0.27	3+85	117.30 117.68 F 0.38	117.73 117.64 C 0.09
2+45	114.02 114.10 F 0.08	113.76 113.61 C 0.15	3+65	117.11 117.20 F 0.09	117.34 117.19 C 0.15
2+25	113.35 113.43 F 0.08	113.08 112.85 C 0.23	3+45	116.66 116.82 F 0.16	116.80 116.69 C 0.11
2+05	112.57 112.64 F 0.07	112.16 112.01 C 0.09	3+25	116.46 116.33 C 0.13	116.39 116.15 C 0.24
1+85	111.41 111.76 F 0.35	111.09 110.93 F 0.16	3+05	116.03 115.82 C 0.21	115.97 115.58 C 0.39
1+65	110.67 110.65 C 0.02	110.08 109.98 F 0.10	2+85	115.22 115.28 F 0.06	115.19 114.96 C 0.23

4445 ~~118.76~~ 118.98
118.76
C0.22

5445 121.22
121.47
F0.25

121.78
121.60
C0.18

END Ret. East 119.43
119.06
C0.37

5425 120.42
120.52
F0.10

120.61
120.57
C0.04

END Ret. West 118.98
118.76
C0.23

5405 119.82
119.82
Grade

119.92
119.83
C0.09

4435.34 Rad. Alley 118.69
118.64 118.69
118.58
C0.05 C0.11

4485 119.26
119.38
F0.12

119.64
119.38
C0.26

4425 118.61
118.42
C0.19

118.60
118.43
C0.17

4465 119.61
119.07
C0.54

119.36
119.07
C0.29

4405 117.92
118.00
F0.08

118.13
118.05
C0.08

4459.34 Alley 118.62
118.96
Rad. 118.62
118.95
F0.34 F0.33

2+73	8945 89.42 C003	91.11 90.76 C 0.35	3+73.21 Alley	95.96 ✓	9425 alley 94.25	9425 94.178t C0.08
------	-----------------------	--------------------------	---------------	---------	---------------------	--------------------------

2+58	8880 88.68 C0.12	90.18 90.04 C0.14	3+53.21 Alley	94.21 -	End ✓ 94.35 Curb 93.83 F0.52	
------	------------------------	-------------------------	---------------	---------	------------------------------------	--

2+43	8792 87.84 F008	89.49 89.30 C0.19	Rad 3+43.21 oh Right W. Haya	94.40	94.78 #1 94.72 C0.06	94.63 94.40 C0.23 95.05 #2 C0.31 Prop
------	-----------------------	-------------------------	------------------------------------	------------------	----------------------------	--

2+28 PVC	87.24 87.15 F0.09	88.78 88.63 C0.15	3+23	92.24 92.21 F0.03		93.34 93.30 C0.04
----------	-------------------------	-------------------------	------	-------------------------	--	-------------------------

1+88	85.43 85.40 F0.03	86.60 86.79 F0.19	3+08	91.44 91.35 C0.09		92.53 92.50 C0.03
------	-------------------------	-------------------------	------	-------------------------	--	-------------------------

1+48	83.89 83.62 C0.27	84.70 84.96 F0.26	2+88	90.25 90.22 F0.03		91.46 91.50 F0.04
------	-------------------------	-------------------------	------	-------------------------	--	-------------------------

54' pipe

Inlet Inv. ^{74.43} 73.25
C 1.18

Outlet Inv. ^{73.66} 72.98
C 2.87

56

EC 0+20Lt. → 76.05
0+07Rt. → 75.75
C 0.30

76.00
75.58
F 0.42

1+40PVC 76.65
76.59
F 0.08

76.84
76.62
C 0.22

#5 75.63
75.69
F 0.06

~~76.00~~

1+20

76.51
76.20
F 0.31

76.57
76.52
C 0.05

#4 75.94
75.63
C 0.31

~~76.00~~

1+00

76.36
76.12
F 0.24

76.42
76.38
F 0.04

#3 75.82
75.57
C 0.25

~~76.00~~

0+75

76.17
76.17
GRADE

76.31
76.18
F 0.13

#2 75.72
75.51
C 0.21

76.11
75.65
F 0.46

0+50

76.11
75.98
C 0.13

76.19
75.93
F 0.26

#1 75.58
75.45
C 0.13

76.22
76.02
F 0.20

0+25

76.10
75.79
C 0.31

76.08
75.56
F 0.52

47th

#2

77.12
76.09
F 1.0378.25
77.80
F0.45

#1

77.33
77.33
GRADE78.01
77.96
F0.052+10.15 BC
Escuela77.49
77.45
C0.0477.80
77.77
C0.03

2+00

77.46
77.37
C0.0977.58
77.53
F0.05

1480

77.30
77.07
C0.2377.17
77.12
C0.05

1460

76.88
76.82
F0.0676.82
76.62
F0.20

Roberts
Rarer
Moore
Morales
12-28-56
W.O. #32646

Rough Grades 5th Street
Folk to Orange

3554-D

2+00	336.07 335.00 C1.1	339.31 336.00 C3.3 C4.0	4+32	354.00 353.02 F1.0	356.84 355.00 C1.8
1+75					
1+50	331.76 331.60 C0.9	334.50 332.10 C2.4 C3.2	4+12	351.80 350.68 F1.1	356.80 352.80 C4.0 C6.2
1+25					
0+92.71	326.76 326.63 C0.1	329.15 327.63 C1.5 C1.9	3+92 PVC	352.00 348.37 F1.6	356.57 351.00 C5.6 C7.6
0+72.71	325.29 325.05 C0.2	326.65 326.07 C0.6 C1.6	3+75 3+50	347.62 346.70 C0.9	354.97 347.70 C7.3 C9.0
0+59.58	324.38 324.01 C0.4	325.32 324.97 C0.3 C0.9	3+25 3+00	344.72 342.80 C1.9	349.80 343.80 C6.00 C7.3
0+27.79					
0+00 EC Ret Folk	321.09 319.31 C1.8	320.84 320.45 C0.4	2+75 2+50	340.37 338.90 C1.5	344.22 339.90 C4.3 C5.7
	319.49 spike	*4099 Pg 52	2+25		
				315.32 NWBP U #52	

5752

375.91
375.38
F0.5375.80
375.00
F0.8

5742

374.46
374.31
C0.2374.66
373.53
F1.1NW Corner
C.B.E.C.379.61
378.70
C1.5

NE Corner

379.72
379.65
GRADE

5732 P/C

372.83
372.20
C0.6373.20
371.91
F1.35785.35 ^{CB} BC // // // //
ORANGE378.45
377.90
C0.6

5702

366.42
366.10
C0.3367.10
366.39
F0.7

5775.95 // // // //

377.81
377.70
C0.1

4772 EVC

360.00
358.98
F1.0361.19
361.00
00.257463.54 ^{st. Orange} on left // // //376.80
376.47
F0.3

4452

356.80
355.82
F1.0358.81
357.80
~~357.80~~
C1.05758.54 ^{CB} BC 376.45
375.69
F0.8

Roberts Rough Grades Orange Ave.

12-31-56
W.O.#32646

54th to 52nd

3555-D & 3556-D plus changes

= 2+14.7

38875
386.60
C 2.2

39023
386.60
C 3.6

4+54.7

383.60
382.95
F 0.6

38549
383.55
C 1.9

= 1+74.7

C 3.1
9 BK
1:1

38799
385.30
C 2.7

38856
385.30
C 3.3

4+14.7

385.30
384.51
F 0.8

38618
385.20
C 1.0

= 1+34.7

C 6.9
12 BK
1:1

39194
383.60
C 8.8

38412
383.36
383.10
~~C 0.3~~
C 1.0

3+74.7

386.80
38518
F 1.6

386.80
38582
F 0.1

= 0+94.7

C 6.1
12 BK
1:1

38514
379.30
C 5.8

38089
379.30
C 1.6

3+34.7

381.70
38566
F 2.0

38811
387.70
C 0.4

= 0+54.7 PK

C 4.6
10 BK
1:1

37852
37401
C 4.5

3
373.40
373.22
F 0.2

2+94.7

388.00
38646
F 1.5

38958
388.00
C 1.6

= 0+00 EC
54th St.

C 8

36765
366.88
C 0.8

366.06
36528
F 0.8

2+54.7

38846
387.60
C 0.9

38890
387.60
C 1.3

6+91.7	372.58 372.29 F 0.3	373.29 373.08 C 0.2	9+51.72	372.05 371.85 F 0.2	373.04 372.55 C 0.5
6+54.7	373.50 373.40 F 0.1	374.21 374.00 C 0.2	9+11.72	370.93 370.73 F 0.2	371.80 371.43 C 0.4
6+14.7	374.86 374.72 F 0.2	376.52 375.36 C 1.1	8+71.72	370.36 370.24 F 0.1	370.92 370.86 GRADE
5+74.7	376.92 376.50 F 0.4	377.46 T.P. 377.42 C 0.1	8+41.72	370.10 370.08 GRADE	370.91 370.58 C 0.3
5+34.7	379.35 379.32 GRADE	382.30 379.85 C 2.4	8+11.72	370.09 369.84 F 0.3	371.10 370.59 C 0.5
4+94.7	381.72 381.60 C 0.1	384.38 381.86 C 2.5	7+81.72	370.40 370.33 F 0.1	371.04 370.90 C 0.1
			7+51.72	371.08 371.00 C 0.1	371.87 371.50 C 0.4

11+81.72		38727 387.20 C 0.1	38922 387.70 C 1.5	13+91.72	390.68 39022 F 0.5	39120 391.18 C 0.6
----------	---	--------------------------	--------------------------	----------	--------------------------	--------------------------

11+51.72	38550 385.35 C 0.1	387.41 385.85 C 1.5	13+51.72	390.77 39061 F 0.2	391.35 391.27 C 0.1
----------	--------------------------	---------------------------	----------	--------------------------	---------------------------

11+11.72	382.58 38227 F 0.3	383.08 381.90 F 1.2	13+11.72	390.53 390.41 C 0.1	391.14 390.91 C 0.2
----------	--------------------------	---------------------------	----------	---------------------------	---------------------------

10+71.72	379.81 37895 F 0.9	380.31 38010 F 0.2	12+71.72	39023 390.05 C 0.2	39060 390.55 GRADE
----------	--------------------------	--------------------------	----------	--------------------------	--------------------------

10+31.72	377.04 37587 F 1.1	377.54 37717 F 0.3	12+41.72	38976 389.55 C 0.2	391.56 390.05 C 1.5
----------	--------------------------	--------------------------	----------	--------------------------	---------------------------

9+91.72 F 1.4	374.27 37108 F 3.2	37515 374.77 C 0.4	12+11.72	38863 388.60 GRADE	391.27 389.10 C 2.2
---------------	--------------------------	--------------------------	----------	--------------------------	---------------------------

BC
at 52nd

380.20
379.93
F0.3

~~380.20~~

EC

383.90
383.87
GRADE

382.80
381.99
F0.8

#3

385.55
385.42
F0.1

384.95
384.02
F0.9

#2

387.00
386.90
F0.1

387.57
386.95
C0.6

#1

388.25
388.14
F0.1

388.74
388.65
C0.1

14+37.43 BC

389.40
388.57
F0.8

392.34
387.90
C2.4

Roberts Curb Grades Orange Ave

1-22-57
 WD.#32646

0+27.35	370.44 37010. F0.34	37032 379.63 369.63 F0.69.	1+54.7	384.44 384.40 C0.04	386.13 384.40 C1.73
---------	---------------------------	--	--------	---------------------------	---------------------------

0+00 EC	366.91 366.88 C0.03	366.06 365.05 F 1.01	1+34.7	383.12 383.10 C0.02	383.10 383.01 F0.09
---------	---------------------------	----------------------------	--------	---------------------------	---------------------------

#3	366.39 365.20 36620 C0.19	365.85 364.56 F1.29	1+14.7	381.55 381.50 C0.05	382.26 381.50 C0.76
----	---------------------------------	---------------------------	--------	---------------------------	---------------------------

#2	367.92 365.80 C2.12	363.85 363.57 F0.28	0+94.7	379.30 379.08 F0.22	379.75 379.30 C0.45
----	---------------------------	---------------------------	--------	---------------------------	---------------------------

#1	366.26 365.10 C1.16	363.06 363.00 C0.06	0+74.7	376.60 376.07 C0.53	377.28 376.57 C0.71
----	---------------------------	---------------------------	--------	---------------------------	---------------------------

BC on 54th	365.80 365.80 GRADE	362.73 362.20 C0.53	0+54.79 VC	374.01 373.69 F0.32	373.40 373.13 F0.27
------------	---------------------------	---------------------------	------------	---------------------------	---------------------------

3+60.77 ROW
NEW
54th

~~11777~~

387.05

BRIDGE

4+74.7

382.21
382.60
F0.39

384.15
382.75
C1.40

2+40.77 ROW
NEW
54th

387.30

387.30

4+54.7

383.60
382.97
F0.63

385.03
383.55
C1.48

2+34.7

387.10
386.73
F0.37

388.84
387.10
C1.74
1.74

4+34.7

~~11777~~

384.19
384.30
F0.11

2+14.7

386.70
386.60
C0.10

389.17
386.60
C2.57

4+44.7

~~11777~~

385.71
385.20
C0.51

1+94.7

386.08
386.00
C0.08

389.71
386.00
C3.71

3+94.7

~~11777~~

386.31
386.00
C0.31

1+74.7

385.30
385.21
F0.09

388.60
385.30
C3.30

3+74.7

~~11777~~

386.80
385.59
F1.21

PK

8+71.72	37044 370.36 C0.08	37112 370.86 C0.26	9+71.72	37415 373.52 C0.63
---------	--------------------------	--------------------------	---------	---------------------------------------

8+41.72	37025 370.08 C0.17	37082 370.58 C0.24	9+62.29 ^{BL}	37278 372.60 C0.18
---------	--------------------------	--------------------------	-----------------------	---------------------------------------

8+11.72	37032 370.09 C0.23	37086 370.59 C0.27	9+51.72	37234 372.05 C0.29
---------	--------------------------	--------------------------	---------	---------------------------------------

7+81.72	37064 370.40 C0.24	37118 370.90 C0.28	9+31.72	37249 371.85 C0.64
---------	--------------------------	--------------------------	---------	---------------------------------------

7+51.72	37109 371.00 C0.09	37181 371.50 C0.31	9+11.72	37122 370.93 C0.29
---------	--------------------------	--------------------------	---------	---------------------------------------

7+21.71	37184 371.79 C0.65	37252 372.29 C0.23	8+91.72	37136 371.14 C0.22
---------	--------------------------	--------------------------	---------	---------------------------------------

10+71.72	38004 379.81 C0.23	38071 380.31 C0.40	12+11.72	38863 388.60 C0.03	39115 389.10 C2.05
10+51.72	37870 378.42 C0.28	37963 378.92 C0.71	11+86.72	38740 387.20 C0.20	38839 387.70 C0.69
10+31.72	37734 377.04 C0.30	37785 377.54 C0.31	11+51.72	38568 385.35 C0.33	38641 385.85 C0.56
10+11.72	37607 375.65 C0.42	37626 376.15 C0.11	11+45.02 Willard's West Lot Line	38431 383.96 C0.35	38376 384.46 F0.70
9+91.72	37429 374.27 C0.02	37500 374.77 C0.23	11+11.72	38285 382.58 C0.27	38328 383.08 C0.20
9+85.43 2 nd rd	373.88 373.79 F0.09	77777	10+91.72	38135 381.19 C0.16	38216 381.69 C0.47

✓	39086 390.77 C0.09	39130 391.27 C0.03	#1	38841 388.25 C0.16	38872 388.65 C0.07
---	--------------------------	--------------------------	----	--------------------------	--------------------------

39064 390.59 C0.05	39118 391.09 C0.09	14+37.43 BC	38940 389.40	39021 389.90 C0.31
--------------------------	--------------------------	-------------	-----------------	--------------------------

39060 390.41 C0.19	39102 390.91 C0.11	14+31.72	389.68 389.57 F0.09	39096 390.18 C0.78
--------------------------	--------------------------	----------	---------------------------	--------------------------

39048 390.23 C0.25	39119 390.73 C0.46	14+11.72	390.25 390.17 F0.08	39133 390.75 C0.58
--------------------------	--------------------------	----------	---------------------------	--------------------------

39032 390.05 C0.27	39047 390.55 F0.08	13+91.72	39068 390.68	39150 391.18 C0.32
--------------------------	--------------------------	----------	-----------------	--------------------------

38973 389.55 C0.18	39134 390.05 C1.29	13+71.72	39080 390.72 C0.08	39172 391.22 C0.50
--------------------------	--------------------------	----------	--------------------------	--------------------------

#1
 380.40
 37997
 F0.43

BC
 38035
~~380.20~~
 C0.15
 #2
 381.05
 38075
 F0.30

EC. +2392
 38225
 382.05
 C0.20
 #1
 381.85
 38161
 F0.24

EC.
 38420
 383.90
 C0.30
 PR
 382.80
 38270
 F0.10

#3
 38591
 385.55
 C0.36
 38503
 384.95
 C0.08

END #5
 CB.

379.65
 37958
 F0.07

#2
 38724
 387.00
 C0.24
 38731
 386.95
 C0.36

#4

379.90
 37976
 F0.14

Roberts
2-1-57
W.O.#32646

Corb Grades 52nd St.

3554-D

1+25

32927
328.86
C 0.41

33050
329.86
C 0.64

2+75

34116
340.85
C 0.31

34192
341.85
C 0.07

0+94.37

opp.
2' Rad.
on
Rt.

32681
326.63
C 0.18

32793
327.63
C 0.30

2+50

33933
338.90
C 0.43

34016
339.90
C 0.26

0+72.71 See page 13

0+59.58

EC
d. on
Rt.

32418
324.01
C 0.17

32497
324.95
FO.02

2+25

33717
336.95
C 0.22

33819
337.95
C 0.24

0+27.29

321.66
321.63
FO.03

322.95
322.59
FO.36

2+00

33513
335.00
C 0.13

33632
336.00
C 0.32

0+00 P.O.K

CEC

31955
319.30
C 0.25

|||||

1+75

33320
333.05
C 0.15

33431
334.05
C 0.26

#1

31906
318.60
C 0.46

|||||

1+50

33130
331.10
C 0.20

33250
332.10
C 0.40

4+12	35190 351.80 C0.10	352.80	5+42	374.31 374.19 F0.12	374.57 374.60 F0.03
* See Page 74					
3+92PVC	350.03 350.00 C0.03	351.00 350.80 F0.20	5+32PVC	372.42 372.20 C0.22	373.20 373.11 F0.09
3+75	34909 348.65 C0.44	349.65 349.63 F0.02	5+02	366.39 366.10 C0.29	367.10 366.89 F0.21
3+50	34709 346.70 C0.39	34790 347.70 C0.20	4+72EVC	360.25 360.00 C0.25	361.14 361.00 C0.14
3+25	34519 344.75 C0.44	34597 345.75 C0.22	4+52	357.03 356.80 C0.23	357.80 357.80 GRADE
3+00	343.21 342.80 C0.41	343.93 343.80 C0.13	4+32	354.23 354.00 C0.23	355.30 355.00 C0.30

	32530	32607
0+72.71	325.05	526.07
off P-0 2' P-0 on RT	00.25	GRADE

EC Exists

376.33 #1 379.25
378.79
F0.46

N.W. Return 52' Orange

#3

37704
376.90 5+85.35 378.30
C0.14 378.01
F0.29

END CURB

378.65
378.61
F0.04

#2

37749
377.20 5+75.95 377.70
C0.29 377.49
F0.23

EC

378.82
378.55
C0.27

#1

377.05 5+63.54 376.80
376.92 C0.02
F0.13

#3

378.67
378.45
C0.22

5+58.54 EC
Orange

376.53
376.45
C0.08

#2

378.33
378.30
C0.03

5+52

375.91 375.80
375.85 375.73
F0.06 F0.07

#1

377.75 378.30
377.95 377.20
377.57
F0.78 75350
377.5



See Page 70

4 + 15.54 ^{opposite}
2' Rad. on Right

353.11
522.11
F0.00

4 + 11.54 ^{opposite}
2' Rad. on Right

352.76
357.49
F1.27

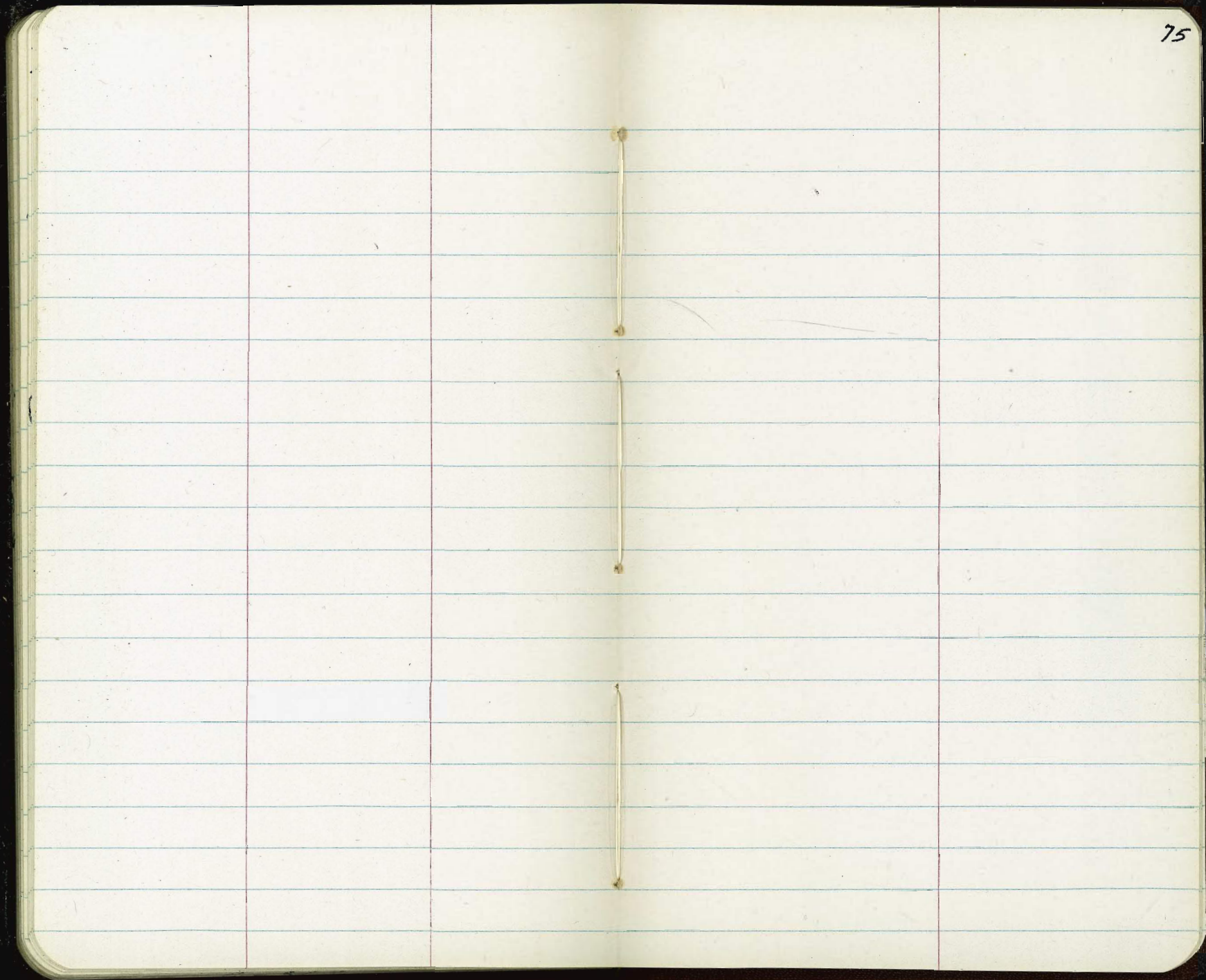

$$40 \overline{) 2.9} \begin{array}{r} .07 \\ \underline{2.80} \\ 100 \\ \underline{100} \\ 0 \end{array}$$

4 151 4
 358
 4030
 138
 3892
 4
 4
 4
 163.77
 C.O. 71
 163.06
 51
 163.57
 190.20
 1917
 7.51
 6.51
 6.63
 1.82
 0.87
 164.05
 163.57
 C.O. 48
 230
 0.92
 1.38

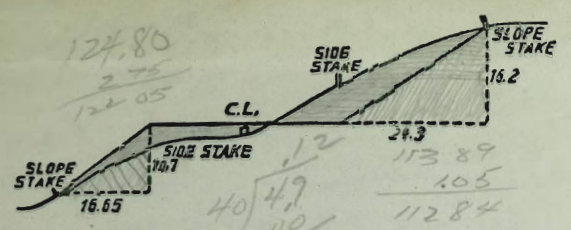

DISTANCES FROM SIDE STAKES FOR CROSS-SECTIONING.
SLOPE 1 1/2 TO 1. ROADWAY OF ANY WIDTH.

	0	.1	.2	.3	.4	.5	.6	.7	.8	.9	
0	0.00	0.15	0.30	0.45	0.60	0.75	0.90	1.05	1.20	1.35	0
1	1.50	1.65	1.80	1.95	2.10	2.25	2.40	2.55	2.70	2.85	1
2	3.00	3.15	3.30	3.45	3.60	3.75	3.90	4.05	4.20	4.35	2
3	4.50	4.65	4.80	4.95	5.10	5.25	5.40	5.55	5.70	5.85	3
4	6.00	6.15	6.30	6.45	6.60	6.75	6.90	7.05	7.20	7.35	4
5	7.50	7.65	7.80	7.95	8.10	8.25	8.40	8.55	8.70	8.85	5
6	9.00	9.15	9.30	9.45	9.60	9.75	9.90	10.05	10.20	10.35	6
7	10.50	10.65	10.80	10.95	11.10	11.25	11.40	11.55	11.70	11.85	7
8	12.00	12.15	12.30	12.45	12.60	12.75	12.90	13.05	13.20	13.35	8
9	13.50	13.65	13.80	13.95	14.10	14.25	14.40	14.55	14.70	14.85	9
10	15.00	15.15	15.30	15.45	15.60	15.75	15.90	16.05	16.20	16.35	10
11	16.50	16.65	16.80	16.95	17.10	17.25	17.40	17.55	17.70	17.85	11
12	18.00	18.15	18.30	18.45	18.60	18.75	18.90	19.05	19.20	19.35	12
13	19.50	19.65	19.80	19.95	20.10	20.25	20.40	20.55	20.70	20.85	13
14	21.00	21.15	21.30	21.45	21.60	21.75	21.90	22.05	22.20	22.35	14
15	22.50	22.65	22.80	22.95	23.10	23.25	23.40	23.55	23.70	23.85	15
16	24.00	24.15	24.30	24.45	24.60	24.75	24.90	25.05	25.20	25.35	16
17	25.50	25.65	25.80	25.95	26.10	26.25	26.40	26.55	26.70	26.85	17
18	27.00	27.15	27.30	27.45	27.60	27.75	27.90	28.05	28.20	28.35	18
19	28.50	28.65	28.80	28.95	29.10	29.25	29.40	29.55	29.70	29.85	19
20	30.00	30.15	30.30	30.45	30.60	30.75	30.90	31.05	31.20	31.35	20
21	31.50	31.65	31.80	31.95	32.10	32.25	32.40	32.55	32.70	32.85	21
22	33.00	33.15	33.30	33.45	33.60	33.75	33.90	34.05	34.20	34.35	22
23	34.50	34.65	34.80	34.95	35.10	35.25	35.40	35.55	35.70	35.85	23
24	36.00	36.15	36.30	36.45	36.60	36.75	36.90	37.05	37.20	37.35	24
25	37.50	37.65	37.80	37.95	38.10	38.25	38.40	38.55	38.70	38.85	25
26	39.00	39.15	39.30	39.45	39.60	39.75	39.90	40.05	40.20	40.35	26
27	40.50	40.65	40.80	40.95	41.10	41.25	41.40	41.55	41.70	41.85	27
28	42.00	42.15	42.30	42.45	42.60	42.75	42.90	43.05	43.20	43.35	28
29	43.50	43.65	43.80	43.95	44.10	44.25	44.40	44.55	44.70	44.85	29
30	45.00	45.15	45.30	45.45	45.60	45.75	45.90	46.05	46.20	46.35	30
31	46.50	46.65	46.80	46.95	47.10	47.25	47.40	47.55	47.70	47.85	31
32	48.00	48.15	48.30	48.45	48.60	48.75	48.90	49.05	49.20	49.35	32
33	49.50	49.65	49.80	49.95	50.10	50.25	50.40	50.55	50.70	50.85	33
34	51.00	51.15	51.30	51.45	51.60	51.75	51.90	52.05	52.20	52.35	34
35	52.50	52.65	52.80	52.95	53.10	53.25	53.40	53.55	53.70	53.85	35
36	54.00	54.15	54.30	54.45	54.60	54.75	54.90	55.05	55.20	55.35	36
37	55.50	55.65	55.80	55.95	56.10	56.25	56.40	56.55	56.70	56.85	37
38	57.00	57.15	57.30	57.45	57.60	57.75	57.90	58.05	58.20	58.35	38
39	58.50	58.65	58.80	58.95	59.10	59.25	59.40	59.55	59.70	59.85	39
40	60.00	60.15	60.30	60.45	60.60	60.75	60.90	61.05	61.20	61.35	40
41	61.50	61.65	61.80	61.95	62.10	62.25	62.40	62.55	62.70	62.85	41
42	63.00	63.15	63.30	63.45	63.60	63.75	63.90	64.05	64.20	64.35	42
43	64.50	64.65	64.80	64.95	65.10	65.25	65.40	65.55	65.70	65.85	43
44	66.00	66.15	66.30	66.45	66.60	66.75	66.90	67.05	67.20	67.35	44
45	67.50	67.65	67.80	67.95	68.10	68.25	68.40	68.55	68.70	68.85	45
46	69.00	69.15	69.30	69.45	69.60	69.75	69.90	70.05	70.20	70.35	46
47	70.50	70.65	70.80	70.95	71.10	71.25	71.40	71.55	71.70	71.85	47
48	72.00	72.15	72.30	72.45	72.60	72.75	72.90	73.05	73.20	73.35	48
49	73.50	73.65	73.80	73.95	74.10	74.25	74.40	74.55	74.70	74.85	49
50	75.00	75.15	75.30	75.45	75.60	75.75	75.90	76.05	76.20	76.35	50

THE NATIONAL BLANK BOOK COMPANY
 HOLYOKE MASSACHUSETTS
 NEW YORK CHICAGO BOSTON SAN FRANCISCO