

G-398

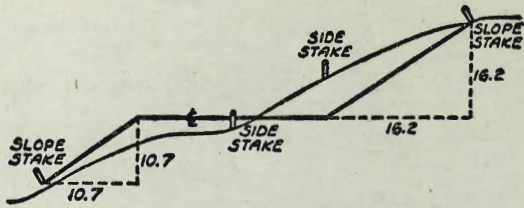

DISTANCES FROM SIDE STAKES FOR CROSS-SECTIONING
SLOPE 1 TO 1. ROADWAY OF ANY WIDTH

	0	.1	.2	.3	.4	.5	.6	.7	.8	.9	
0	0.00	0.10	0.20	0.30	0.40	0.50	0.60	0.70	0.80	0.90	0
1	1.00	1.10	1.20	1.30	1.40	1.50	1.60	1.70	1.80	1.90	1
2	2.00	2.10	2.20	2.30	2.40	2.50	2.60	2.70	2.80	2.90	2
3	3.00	3.10	3.20	3.30	3.40	3.50	3.60	3.70	3.80	3.90	3
4	4.00	4.10	4.20	4.30	4.40	4.50	4.60	4.70	4.80	4.90	4
5	5.00	5.10	5.20	5.30	5.40	5.50	5.60	5.70	5.80	5.90	5
6	6.00	6.10	6.20	6.30	6.40	6.50	6.60	6.70	6.80	6.90	6
7	7.00	7.10	7.20	7.30	7.40	7.50	7.60	7.70	7.80	7.90	7
8	8.00	8.10	8.20	8.30	8.40	8.50	8.60	8.70	8.80	8.90	8
9	9.00	9.10	9.20	9.30	9.40	9.50	9.60	9.70	9.80	9.90	9
10	10.00	10.10	10.20	10.30	10.40	10.50	10.60	10.70	10.80	10.90	10
11	11.00	11.10	11.20	11.30	11.40	11.50	11.60	11.70	11.80	11.90	11
12	12.00	12.10	12.20	12.30	12.40	12.50	12.60	12.70	12.80	12.90	12
13	13.00	13.10	13.20	13.30	13.40	13.50	13.60	13.70	13.80	13.90	13
14	14.00	14.10	14.20	14.30	14.40	14.50	14.60	14.70	14.80	14.90	14
15	15.00	15.10	15.20	15.30	15.40	15.50	15.60	15.70	15.80	15.90	15
16	16.00	16.10	16.20	16.30	16.40	16.50	16.60	16.70	16.80	16.90	16
17	17.00	17.10	17.20	17.30	17.40	17.50	17.60	17.70	17.80	17.90	17
18	18.00	18.10	18.20	18.30	18.40	18.50	18.60	18.70	18.80	18.90	18
19	19.00	19.10	19.20	19.30	19.40	19.50	19.60	19.70	19.80	19.90	19
20	20.00	20.10	20.20	20.30	20.40	20.50	20.60	20.70	20.80	20.90	20
21	21.00	21.10	21.20	21.30	21.40	21.50	21.60	21.70	21.80	21.90	21
22	22.00	22.10	22.20	22.30	22.40	22.50	22.60	22.70	22.80	22.90	22
23	23.00	23.10	23.20	23.30	23.40	23.50	23.60	23.70	23.80	23.90	23
24	24.00	24.10	24.20	24.30	24.40	24.50	24.60	24.70	24.80	24.90	24
25	25.00	25.10	25.20	25.30	25.40	25.50	25.60	25.70	25.80	25.90	25
26	26.00	26.10	26.20	26.30	26.40	26.50	26.60	26.70	26.80	26.90	26
27	27.00	27.10	27.20	27.30	27.40	27.50	27.60	27.70	27.80	27.90	27
28	28.00	28.10	28.20	28.30	28.40	28.50	28.60	28.70	28.80	28.90	28
29	29.00	29.10	29.20	29.30	29.40	29.50	29.60	29.70	29.80	29.90	29
30	30.00	30.10	30.20	30.30	30.40	30.50	30.60	30.70	30.80	30.90	30
31	31.00	31.10	31.20	31.30	31.40	31.50	31.60	31.70	31.80	31.90	31
32	32.00	32.10	32.20	32.30	32.40	32.50	32.60	32.70	32.80	32.90	32
33	33.00	33.10	33.20	33.30	33.40	33.50	33.60	33.70	33.80	33.90	33
34	34.00	34.10	34.20	34.30	34.40	34.50	34.60	34.70	34.80	34.90	34
35	35.00	35.10	35.20	35.30	35.40	35.50	35.60	35.70	35.80	35.90	35
36	36.00	36.10	36.20	36.30	36.40	36.50	36.60	36.70	36.80	36.90	36
37	37.00	37.10	37.20	37.30	37.40	37.50	37.60	37.70	37.80	37.90	37
38	38.00	38.10	38.20	38.30	38.40	38.50	38.60	38.70	38.80	38.90	38
39	39.00	39.10	39.20	39.30	39.40	39.50	39.60	39.70	39.80	39.90	39
40	40.00	40.10	40.20	40.30	40.40	40.50	40.60	40.70	40.80	40.90	40
41	41.00	41.10	41.20	41.30	41.40	41.50	41.60	41.70	41.80	41.90	41
42	42.00	42.10	42.20	42.30	42.40	42.50	42.60	42.70	42.80	42.90	42
43	43.00	43.10	43.20	43.30	43.40	43.50	43.60	43.70	43.80	43.90	43
44	44.00	44.10	44.20	44.30	44.40	44.50	44.60	44.70	44.80	44.90	44
45	45.00	45.10	45.20	45.30	45.40	45.50	45.60	45.70	45.80	45.90	45
46	46.00	46.10	46.20	46.30	46.40	46.50	46.60	46.70	46.80	46.90	46
47	47.00	47.10	47.20	47.30	47.40	47.50	47.60	47.70	47.80	47.90	47
48	48.00	48.10	48.20	48.30	48.40	48.50	48.60	48.70	48.80	48.90	48
49	49.00	49.10	49.20	49.30	49.40	49.50	49.60	49.70	49.80	49.90	49
50	50.00	50.10	50.20	50.30	50.40	50.50	50.60	50.70	50.80	50.90	50

Distance of slope stake from side or shoulder stake for any width roadway, slope 1 to 1. If ground is nearly level, the cut or fill at side stake is located by the double entry method in left column and top row. The number in body of table in same row and column gives distance from side stake to slope stake. If ground is not level estimate the difference in elevation between the side stake and slope stake, lower target by this amount if cut, elevate if fill. Add this amount to cut or fill and find distance in table. Set up rod at this point, and line of sight should cut target. If it does not make the slight adjustment necessary.

MICROFILMED

APR 19 1965

0	0
1	1
2	2
3	3
4	4
5	5
6	6
7	7
8	8
9	9
10	10
11	11
12	12
13	13
14	14
15	15
16	16
17	17
18	18
19	19
20	20
21	21
22	22
23	23
24	24
25	25
26	26
27	27
28	28
29	29
30	30
31	31
32	32
33	33
34	34
35	35
36	36
37	37
38	38
39	39
40	40
41	41
42	42
43	43
44	44
45	45
46	46
47	47
48	48
49	49
50	50

Distance
ground is
column at
side stake
side stake
cut or fill
If it does

DIRECTIONS FOR USE OF TABLES

TABLE No. XIV

Distance of slope stake from side or shoulder
stake for any width roadway, slope 1% to 1%
If ground is level, level the cut or fill at the
stake is located by the number entry, and the

IMPROVED TABLES
AND
INFORMATION

from side stake to stake. If ground is not
level estimate the difference in elevation between
the side stake and the stake to be located by
this table. This amount to cut or fill and distance to stake
amount to cut or fill and distance to stake.

TO FIND TANGENT AND ESTIMATE FOR CURVE OF
any other degree, divide by degree of curve and
add correction found in column of corrections.
Degree of curve with a given L may be found
by dividing tangent (or external) opposite L by
given tangent (or external).

The distance from a point on the tangent to
the curve is very nearly the square of the tangent
length divided by twice the radius.

TO FIND TANGENT AND ESTIMATE FOR CURVE OF
any other degree, divide by degree of curve and
add correction found in column of corrections.
Degree of curve with a given L may be found
by dividing tangent (or external) opposite L by
given tangent (or external).

Roberts
Korer
Morales
6-16-58
W.P. 32437

Grade Stakes For Alley In
Block 1, Alhambra Park
(See 5113-D sheet)

East and West Alley
1+02.5 ^{391.24}
390.57 }
C 0.67 391.67
390.57
C 1.10

0+80 EYC ^{391.04}
390.36
C 0.68 391.29
390.36
C 0.93

0+60 ^{390.68}
389.97
C 0.71 391.20
389.97
C 1.23

0+40 ^{390.26}
389.13
C 1.13 390.60
389.13
C 1.47

0+20 ^{389.73}
387.86
C 1.87 390.33
387.86
C 2.47

E.L. of
0+00 Dawson 386.15 386.15

2+70 DEAD END 393.07

393.09 ①

2+60 BRK ^{392.55}
392.41
C 0.14

^{393.07}
392.71
C 0.36

2+37 ^{392.32}
392.12
C 0.20

393.00
392.36
C 0.64

2+14 ^{391.97}
391.83
C 0.14

392.56
392.02
C 0.54

1+91 ^{391.87}
391.55
C 0.32

392.67
391.67
C 1.00

1+68 ^{391.62}
391.26
C 0.36

392.61
391.33
C 1.28

E.L. of
1+45 N.E.S. Alley ^{391.45}
390.98
C 0.47

391.94
390.98
C 0.96

1+25 ^{391.61}
390.78
C 0.83
W.L. of
N.E.S. Alley

391.78
390.78
C 1.00

North and South Alley

(2)

			2+40	391.08 391.01 F0.07	390.88 390.80 F0.08
1+00	391.71 390.80 C0.91	391.43 390.55 C0.88			
			2+20 BRK	391.12 390.93 F0.19	390.92 390.76 F0.16
0+80	391.68 390.75 C0.93	391.00 390.49 C0.51			
			2+00	391.06 391.03 F0.03	390.85 390.63 F0.22
0+60	391.73 390.70 C1.03	391.52 390.43 C1.09			
			1+80	391.51 391.00 C0.51	390.79 390.79 GRADE
0+40	391.80 390.65 C1.15	391.73 390.37 C1.36			
			1+60	391.66 390.95 C0.71	390.73 390.73 GRADE
0+20	391.82 390.60 C1.22	391.99 390.31 C1.68			
			1+40	391.71 390.90 C0.81	390.67 390.67 GRADE
S.L. of 0+00 Manroe	390.55	390.25			
			1+20	391.75 390.85 C0.90	390.28 390.61 F0.33

1725 1/2 145

3+00 N.L. of E. & W. Alley.

390.98

390.78

2+80

391.12
391.01
C011

390.81
390.76
F0.05

2+60

391.05
391.00
F0.05

390.85
390.83
F0.02

Roberts
W.O.#20020
6-19-58

Grade Stakes For Lot Grading
of Lots 5 & 6, Blk. 52, Middletown.
(Guy between Mission Hills Blvd. & Clark)
See 4148-G

138
6

Prop. Line
Curb Grade

1450 Sly Line
Lot 6

133.00
1323
E 0.7

1425 Lot 6
Lot 5

1394
138.00
C 1.4

1400 Nly Line
Lot 5

1452
14300
C 2.2

0+00 Nly Line of Clark

144.25

BM

153.31 Top Curb West end of the South curb at Clark & Guy.

Roberts
W.O. 20020
6-19-58

Grade Stakes For Lot Grading
Where Payne St. is closed on
North side of Greely.

See 3884

Prop. Line
Curb Grade

old N.W. Corner
0+80 Greely & Payne

886
7.70
C 1.16

0+60

890
7.76
C 1.14

0+40

909
7.82
C 1.27

0+20

930
7.88
C 1.42

old N.E. Corner
0+00 Greely & Payne

980
7.94
C 1.86

Roberts
W.O. 32293
7-7-58

Stakes For Storm Drain In
Blocks 1 & 4 Emerson Heights

See 13037-L

6

0+96 BRK

26.75
18.76
C 7.99

2+00

25.27
17.32
C 7.95

0+75

27.40
20.02
C 7.38

1+75

25.13
17.57
C 7.56

0+50

28.08
21.52
C 6.56

1+50

25.39
17.82
C 7.57

0+30.20 E.C.

28.78
22.71
C 6.07

1+25

25.89
18.07
C 7.82

0+15.10 Mid

29.66
23.61
C 6.05

1+12 BRK

26.20
18.20
C 8.00

0+00 B.C.

Existing 24" C.M. Pipe

24.52

1+04 BRK

26.52
18.38
C 8.14

B.M. 36.98 S.E. B.P. National $\frac{1}{4}$ 36 $\frac{1}{4}$.

3+50

1978
15.48
C4.30

4+75

2113
14.05
C7.08

3+25

2024
15.77
C4.47

4+65.93 E.C.

2222
14.17
C8.05

3+00

2097
16.05
C4.92

4+46.07 M.d.

2454
14.39
C10.15

2+76.22 Cleanout.

2335
16.56
C6.792335
16.31
C7.04

4+26.22 B.C.

2246
14.62
C7.78

2+50

2472
16.82
C7.90

4+00

2110
14.91
C6.19

2+25

2480
17.07
C7.73

3+75

1974
15.20
C4.54

INVERT PIPE SLY INLET ON NEWTON

6+13.93 END
 13.68
 12.50
 C 1.18

INV. No. 2207
 No. 18.13
 C 3.94

21.21
 S. 18.13
 C 3.08

6+00
 13.95
 12.63
 C 1.32

INVERT PIPE NLY INLET ON NEWTON

5+75
 14.83
 12.91
 C 1.92

INV. 2213
 WEST 18.50
 C 3.63

2216
 EAST 18.50
 C 3.66

5+50
 15.36
 13.20
 C 2.16

5+25
 16.39
 13.48
 C 2.91

5+00
 18.16
 13.77
 C 4.39

W.O. 32293
7-10-58
Roberts

36th Street, National to Newton
13032-L

9

Rough

curb

curb

Rough

1+00 E.V.C.

39.64
39.64
GRADE

4228
40.34
C 1.94

0+80

406
39.23
C 1.4

39.23
39.13
F 0.10

4185
39.98
C 1.87

525
59.98
C 12.5

0+60

~~0+65~~ water lateral
on left

38.65
38.65
GRADE

4175
39.58
C 2.17

0+40

38.01
37.3
F 0.7

38.01
37.91
F 0.10

4076
39.17
C 1.59

452
39.17
C 6.0

0+20

37.75
37.43
C 0.32

39.79
38.81
C 0.98

0+01

curb E.C.

37.2
37.01
C 0.2

37.29
37.01
C 0.28

38.56
38.20
F 0.36

38.56
38.2
F 0.4

So. Line
0+00 National

	Rough	Curb	Curb	Rough	10
2+4555	✓ 42.66 421 FO.6	42.66 42.52 FO.14	4352 4336 C 0.16	514 43.36 C 8.0	0.22
2+20EVC		41.93 41.93 GRADE	4378 42.63 C 1.15		
2+00	415 41.41 C 0.1	4141 41.41 GRADE	4248 42.11 C 0.37	515 42.11 C 9.4	
1+80PVC		4127 41.00 C 0.27	4230 41.70 C 0.60		
1+60	✓ 411 40.66 C 0.4	40.66 40.56 FO.10	4174 41.36 C 0.38	518 41.36 C 10.4	
1+40		4044 40.32 C 0.12	4237 41.02 C 1.35		
1+20	✓ 411 39.98 C 1.1	39.98 39.86 FO.12	4254 40.68 C 1.86	521 40.68 C 11.4	

Rough

Curb

Curb

Rough

11

EC on Newton

0+08

4287
42.70
C0.17

Newton
to
Boston
0+00
"
3+64.65

4674
45.63
C 1.11

499
45.63
C 4.3

#2

4413
43.65
C0.48

3+32.65

4664
45.44
C 1.20

502
45.44
C 4.8

#1

4474
44.15
C0.59

3+14.65

4666
45.24
C 1.42

3+06.65 Curb EC Lt.

446
44.30
C0.3

4479
44.30
C0.49

2+96.65 PVC on the Right

443
44.11
C0.2

4518
44.11
C 1.07

4596
44.81
C 1.15

508
44.81
C 6.0

2+71.10

4339
43.11
F0.28

4422
44.09
C 0.13

Rough
36th St., Newton to Boston
13037-k

Curb

Curb

Rough

12

0+50.78 ✓
454
45.13
C 0.3

4540
45.13
C 0.27

45.91 4768
45.91
C 1.77

490
45.91
C 3.1

0+25.39

4568
44.98
C 0.70

45.79 4775
45.77
C 1.98

0+08 Curb B.C.I

467
44.88
C 1.8

4542
44.88
C 0.54

#2

4729
44.49
C 2.80

#1

4684
43.70
C 3.14

EC on Newton
SE Corner

0+08

4568
42.45
C 3.23

	Rough	Curb	Curb	Rough
2+12.35		46.01 45.60 C 0.41	4780 46.31 C 1.49	
1+92.35	485 45.76 C 2.7	4585 45.76 C 0.09	4791 46.47 C 1.44	487 46.47 C 2.2
1+80 Water lateral on left.				
1+72.35		45.81 45.74 F 0.07	4814 46.53 C 1.61	
1+52.35 PVC	466 45.74 C 0.9	4614 45.74 C 0.40	4797 46.46 C 1.51	491 46.46 C 2.6
1+26.95	45.58	4618 45.58 C 0.60	4748 46.32 C 1.16	
1+01.56	458 45.43 C 0.4	4557 45.43 C 0.14	46.88 4785 46.18 C 1.67	490 46.18 C 2.8
0+76.17		4546 45.28 C 0.18	4772 46.04 C 1.68	
0+60 Water lateral on left.				

Rough

Curb

Curb

Rough

14

3+14.85 END Boston.

449
43.24
C 1.7

4522
43.24
C 1.98

4527
43.94
C 1.33

453
43.94
C 1.4

2+93.60

4510
43.83
C 1.27

4615
44.53
C 1.62

2+72.35 EVC

459
44.42
C 1.5

4541
44.42
C 0.99

4696
45.12
C 1.84

472
45.12
C 2.1

2+52.35

4590
44.93
C 0.97

4753
45.63
C 1.90

2+32.35

478
45.32
C 2.5

4621
45.32
C 0.89

4762
46.02
C 1.60

482
46.02
C 2.2

Goodyear St.,
Newton to North.
13035-L

Rough

Curb

Curb

Rough

15

1+20

27.77
27.64
F0.13

28.22
27.30
F0.92

1+00PVC

27.46
26.2
F1.3

27.46
26.00
F1.46

27.91
27.07
F0.84

27.91
27.8
F0.1

0+77

27.30
25.80
F1.50

30.74
27.74
C3.00

0+54

✓ 27.13
26.6
F0.5

27.13
26.62
F0.51

31.58
27.57
C4.01

35.5
27.57
C7.9

0+31

29.69
26.96
C2.73

31.84
27.40
C4.44

0+08 Curb B.C. at
Newton

31.4
26.79
C4.6

31.59
26.79
C4.80

31.92
27.23
C4.69

35.0
27.23
C7.8

	Rough	Curb	Curb	Rough
2+38 curb B.C.	353 34.71 C 0.6	3523 34.71 C 0.52	3576 35.16 C 0.60	360 35.16 C 0.8
2+28		3530 34.28 C 1.02	3547 34.73 C 0.74	
2+20 water lateral on left ✓	348 33.63 C 1.2	3562 33.63 C 1.99	3440 34.08 C 0.32	348 34.08 C 0.7
2+18 PVC				
1+99		3391 32.20 C 1.71	3284 32.65 C 0.19	
1+80 EVC water lateral on Right	335 30.77 C 2.7	3277 30.77 C 2.00	3122 31.19 F 0.03	323 31.22 C 1.1
1+60		3071 29.43 C 1.28	2988 29.68 C 0.20	
1+40 water lateral on Right	292 28.43 C 0.8	2917 28.43 C 0.74	2888 28.75 F 0.13	292 28.88 C 0.3

Goodyear St,
Newton to Boston.

Rough

Curb

Curb

Rough

17

0+75

2728
26.17
C 1.11

2687
25.66
C 1.21

0+60 water lateral
on left

0+50

30.4
26.43
C 4.0

2763
26.43
C 1.20

2772
25.92
C 1.80

272
25.92
C 1.3

0+25

2824
26.68
C 1.56

2889
26.17
C 2.72

0+08 Curb BC at
Newton

310
26.85
C 4.1

3078
26.85
C 3.93

2920
26.34
C 2.86

294
26.34
C 3.1

58
2+65 END Pav. GRADE
APPL. 368
35.25
C 1.5

3659
35.25
C 1.34

3775
35.70
C 2.05

380
35.70
C 2.3

2+45 Curb E.C.

3550
34.71
C 0.79

3595
35.53
C 0.42

Rough

Curb

Curb

Rough

2+50 ✓ 304
24.39
C 6.0

~~2734~~ 2734
~~24.39~~ 24.39
C 2.95

2495
23.88
C 1.07

23.88
226
F 1.3

2+25

Water lateral
on Right
2+20

~~2468~~ 2468
~~24.64~~ 24.64
C 0.04

2505
24.13
C 0.92

2+00 ✓

24.90
239
F 1.0

~~2496~~ 2496
2411
F 0.79

2518
24.39
C 0.79

24.39
206
F 3.8

Water lateral
on Right
1+80

1+75

~~2515~~ 2515
2480
F 0.35

24.64
~~24.64~~
GRADE

1+50 ✓

276
25.41
C 2.2

~~2590~~ 2590
~~25.41~~ 25.41
C 0.79

2568
24.90
C 0.78

253
24.90
C 0.4

Water lateral
on left
1+40

1+25

~~2671~~ 2671
~~25.66~~ 25.66
C 1.05

2616
25.15
C 1.01

1+00

Water lateral
on left
295
25.92
C 3.6

~~2700~~ 2700
~~25.92~~ 25.92
C 1.08

2583
25.41
C 0.42

259
25.41
C 0.5

Rough

Curb

Curb

Rough

19

3+16.24 Curb B.C. on
Left at Boston

292
23.72
C 5.5

2685
23.72
C 3.13

2495
23.18
C 1.77

244
23.18
C 1.2

3+00 water lateral
on Right

2752
23.88
C 3.64

2592
23.37
C 2.55

2+75

2814
24.13
C 4.01

2668
23.62
C 3.06

2+60 water lateral
on Right

Newton, 36 to Goodyear
13033-L

Rough

Curb

Curb

Rough

20

1+10

292
26.33
C 2.9

2815
26.33
C 1.82

2710
26.13
C 0.97

268
26.13
C 0.7

0+85

309
29.45
C 1.4

3037
29.45
C 0.92

2967
29.25
C 0.42

296
29.25
C 0.3

0+60 P.C.

335
33.49
GRADE

3037
33.49
3317
F 0.32

3392
33.29
C 0.63

358
33.29
C 2.5

0+36.5

381
37.72
C 0.4

3789
37.72
C 0.17

3752
37.24
C 0.28

3752
369
F 0.6

0+13

41.95
41.91
F 0.04

4256
41.75
C 2.81

0+08

cb. EC

428
42.70
C 0.1

42.70
C 0.17

42.45
C 3.23

451
42.45
C 2.6

0+00 East Line of
36th St.

Rough

Curb

Curb

Rough

21

2+62

27.86
25.22
C 2.64

26.85
25.02
C 1.83

2+36

24.15
23.34
F 0.81

23.95
22.72
F 1.23

2+10 EVC

23.08
224
F 0.7

23.08
22.97
F 0.11

22.88
22.31
F 0.57

22.88
219
F 1.0

1+85

{ 22.50

22.50

See Page 29

22.30

22.30 }
}

1+60

23.2
22.86
C 0.3

23.16
22.86
C 0.30

23.35
22.66
C 0.69

22.9
22.66
C 0.2

1+35

24.6
24.14
C 0.5

24.64
24.14
C 0.50

23.94
23.94
GRAPE

23.94
230
F 0.9

Newton-Goodyear
to
37th
13034-L

Rough

curb

curb

Rough

22

#2

3334
27.10
C6.24

3159
27.05
C4.54

#1

3345
27.14
C6.31

3107
26.96
C4.11

#2

3177
26.72
C5.05

2990
26.35
C3.55

#1

3148
26.58
C4.90

2973
26.28
C3.45

2+88 cb BC
at Goodyear

308
26.29
C4.5

2972
26.29
C3.63

2925
26.09
C3.16

290
26.09
C2.9

Rough

Curb

Curb

Rough

23

1+04.99

3471
32.86
C1.85

3427
32.66
C1.61

0+77.66

357
31.25
C4.4

3346
31.25
C2.21

3239
31.05
C1.34

344
31.05
C3.3

0+50.33

3342
29.64
C3.78

3148
29.44
C2.04

0+23 BRK

350
28.03
C7.0

3242
28.03
C4.39

3242
27.83
C4.59

324
27.83
C4.6

0+13

3250
27.50
C5.06

3200
27.35
C4.65

0+08 cb BC
at 600 year

348
27.25
C7.5

3250
27.25
C5.25

3179
27.20
C4.59

317
27.20
C4.5

Rough

Curb

Curb

Rough

24

2+51.64^{cb RC}
at 37th

41.35
41.11
F 0.24

41.29
41.02
F 0.27

2+41.64 BRK

40.90
40.6
F 0.3

40.90
40.37
F 0.53

40.70
40.00
F 0.70

40.70
40.3
F 0.4

2+14.31

39.30
38.59
F 0.71

39.10
38.42
F 0.68

1+86.98

38.6
37.69
C 0.9

37.69
37.26
F 0.43

37.49
36.86
F 0.63

37.6
37.49
C 0.1

1+59.65

36.08
36.06
F 0.02

35.88
35.60
F 0.28

1+32.32

36.7
34.47
C 2.2

34.82
34.47
F 0.35

34.51
34.27
C 0.24

35.7
34.27
C 1.4

Boston -
Goodyear
(13036-L) To
37th

Rough

Curb

Curb

Rough

25

#6

2385
Gut 22.60
C 1.25

#5

2346
Gut 22.48
C 0.98

#4

2351
Gut 22.40
C 1.11

#3

2380
Gut 22.44
C 1.36

#2

2586
23.68
C 2.18

#2

2392
Gut 22.49
C 1.43

#1

2804
23.60
C 4.44

#1

2443
cb 23.02
C 1.41

Rough

Curb

Curb

Rough

#8
B.C.
0-1823.34
23.00
F0.34

#11

23.29
23.19
F0.10

#10*

23.10
23.24
F0.1423.24 (0-50)
16.8
F6.4

#9

23.23
cb 23.19
C0.04

#8E

23.61
cb 23.12
C0.49

#7

23.89
cb 23.11
C0.78

Rough

Curb

Curb

Rough

1+01.48

2780
27.38
C 0.4226.78
26.67
FO.11

0+75.32 ✓

310
26.42
C 4.62690
26.42
C 0.482597
25.82
C 0.15262
25.82
C 0.4

0+49.16

2613
25.46
C 0.722570
24.86
C 0.840+35 Water lateral
on Right

0+23 BRK

299
24.50
C 5.42533
24.50
C 0.832558
23.90
C 1.68254
23.90
C 1.50+13 B.C. Curb
on left
at Goodyear2960
24.10
C 5.52526
24.10
C 1.16

0+13

2409
23.59
C 0.50252
23.59
C 1.6

0+03

2372
23.45
C 0.27

2+34.92

33.60
32.92
F0.6832.80
32.28
F0.52

2+20

340
32.60
C1.432.60
31.72
F0.8831.69
31.58
F0.11325
31.69
C0.8

2+00

31.23
30.96
F0.2730.54
30.24
F0.30

1+80 P.V.C.

331
30.26
C2.83031
30.26
C0.0529.66
28.68
F0.9829.66
288
F0.9

1+53.86

2954
29.30
C0.2428.70
27.72
F0.98

1+27.64

325
28.34
C4.22875
28.34
C0.4127.74
27.49
F0.252
27.74
276
F0.1

	Rough	Curb	Curb	Rough
Inlets North side	West 22.50 22.20 F0.30	East 22.71 22.50 C0.21		

Newton
Ave.

36 to Good year

South Side	22.30 21.03 F 1.27	22.30 21.71 F0.59		
------------	--------------------------	-------------------------	--	--

EC Existing

35.13
✓

33.61
✓

#2

34.98

33.82

#1

34.75

33.90

2+46.92 B.C. curbs
at 37th

347
34.35
C0.3

34.35
33.63
F0.72

337
33.60
33.13
F0.47

337
33.60
C0.1

Roberts Grade Stakes For Library
W.D.#20017 31st & Wightman
8-6-58

5719-D

30

Wightman

St.

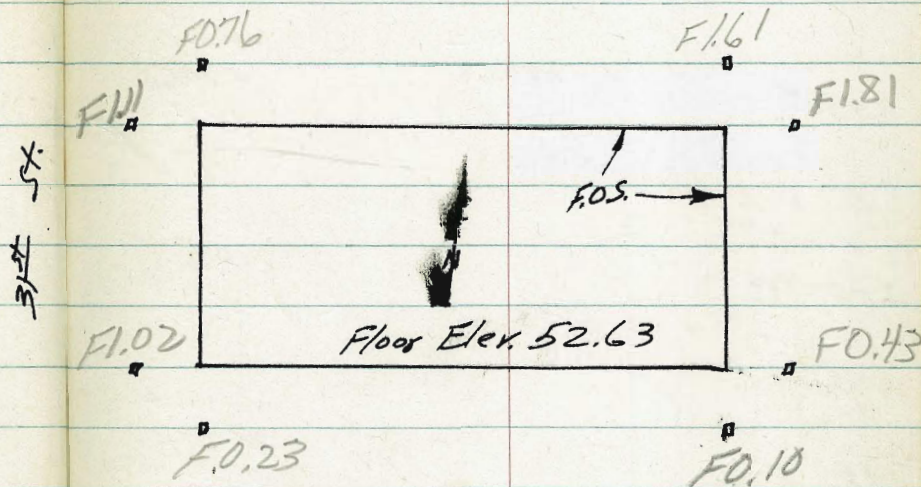

BH SE 787' DET 51.84

Roberts
8-8-58

Rough Grades For Ryan Rd.

54th to East.

Borrow Pit for Rock Place.

See #510-D

3+00

~~282.73~~
272.93
C 9.6

~~285.60~~
272.93
C 12.7

2+50^v

28112
270.68
C 10.4

28283
270.68
C 12.1

2+00^{91C}

28134
269.14
C 12.2

5+50

291.52
289.65
A 1.8

294.85
291.52
C 3.3

1+50

27994
267.94
C 12.0

5+00

28980
287.52
C 2.3

29317
287.52
C 5.7

0+90^{BRL}

27324
266.52
C 6.7

4+50

28905
283.52
C 5.5

29153
283.52
C 8.0

0+70

27296
266.00
C 7.0

4+00^{EVC}

28590
279.52
C 6.4

29008
279.52
C 10.6

0+00^{54th}

3+50

28504
275.87
C 9.1

28796
275.87
C 12.1

W.O. 32807
8-12-58

Grade Stakes For Alley in
Block 55, La Jolla Park

5170-D

0+80	7007 69.59 C 0.48	7118 69.89 C 1.29	2+56	6695 64.50 C 2.45	71.61 6695 F 4.66	7331 71.91 C 1.40
------	-------------------------	-------------------------	------	-------------------------	-------------------------	-------------------------

0+60	6863 68.67 C 0.04	7017 68.97 C 1.20	2+28 Foot	6548 6548 BRK } 64.50 63.50 C 0.98 C 1.98	71.33 6548 F 5.85	7290 71.63 C 1.27
------	-------------------------	-------------------------	-----------	---	-------------------------	-------------------------

0+40	6785 67.31 C 0.54	6962 67.61 C 2.01	1+96	6481 63.50 C 1.31	71.01 6481 F 6.20	7241 71.31 C 1.10
------	-------------------------	-------------------------	------	-------------------------	-------------------------	-------------------------

0+20	6600 65.52 C 0.48	6922 65.82 C 3.40	1+64	7057 Begin } 63.50 Ret. } 7.07 Wall }	70.69 7057 F 0.12	7222 70.99 C 1.23
------	-------------------------	-------------------------	------	--	-------------------------	-------------------------

0+10	6480 64.41 C 0.39	6912 64.71 C 1.41	1+32	70.37 7016 F 0.21	7215 70.67 C 1.38
------	-------------------------	-------------------------	------	-------------------------	-------------------------

0+00	Nly Line Eads 61.81	64.41	1+00 EVC	7007 70.05 C 0.02	7040 70.35 C 0.05
------	---------------------------	-------	----------	-------------------------	-------------------------

62.98

Top of Wall

Bottom of Ret. Wall

Ret. Grade

3+64 END }
ALLEY }

6824
66.50
C 1.74

72.70
6824
F 4.46

73.00
72.86
F 0.14

3+12

72.67
6560
F 7.07

2+84

72.39
6563
F 6.74

3+36 BRK }
Foot }

6759 6759
66.50 65.50
C 1.09 C 2.09

72.61
6759
F 5.02

72.91
72.84
F 0.07

2+56

72.11
6566
F 6.45

3+40 BRK }
Foot }

6839 6839
65.50 64.50
C 2.89 C 3.89

72.45
6839
F 4.06

72.79
72.75
C 0.04

2+28

71.83
6559
F 6.24

3+64 END

073.20
7268
F 0.52

3+12

6598
64.50
C 1.48

72.17
6598
F 6.19

72.97
72.47
C 0.50

1+96

71.51
6446
F 7.05

3+56

73.11
6800
F 3.11

2+84

6671
64.50
C 2.21

71.89
6671
F 5.18

72.19
72.09
F 0.10

Begin
1+64 Ret.
wall

071.20
✓

3+40

72.95
6682
F 6.13

8-18-58
W.O.32351

Grade Stakes For Sewer
Detroit Ave., et al.
4217 D thru 4220 D

1+75

24817
245.48
C 2.69

24982
245.04
C 4.78

2+10

26201
254.91
C 7.10

26201
254.71
C 7.30

1+40

24762
245.38
C 2.24

24945
244.94
C 4.51

1+40

25721
251.80
C 5.41

25721
251.52
C 5.69

1+05

24896
245.27
C 3.69

24901
244.83
C 4.18

1+05

25490
250.24
C 4.66

25490
249.93
C 4.97

0+70

24936
245.17
C 4.19

24937
244.73
C 4.64

0+70

25306
248.69
C 4.37

25306
248.33
C 4.73

0+35

24935
245.06
C 4.29

24950
244.62
C 4.88

0+35

25176
247.13
C 4.63

25176
246.74
C 5.02

2+05 = 0+00 To East
M.H.# 22

250.64
245.58
C 5.06

250.64
~~245.58~~
C 5.50

Make Connection
0+00 Detroit between
Radio and 59th St.

244.96
Actual Elev.
of Existing D.E.

24963
244.52
C 4.11

(0+00 P.K. Nail
249.35)

New
Stakes

4+40

27550
265.41
C1009

6+85

28806
277.31
C10.75

4+05

27338
263.71
C9.67

6+50

28684
275.61
C11.23

3+70 NH#23

262.01
Same →

27132
262.01
C9.31

6+15

28538
273.91
C11.47

3+50

27029
261.13
C9.16

27029
261.09
C9.20

5+80

28360
272.21
C11.39

3+15

26838
259.57
C8.81

26838
259.50
C8.88

5+45

28181
270.51
C11.30

2+80

26635
258.02
C8.33

26635
257.90
C8.45

5+10

27958
268.81
C10.77

2+45

26431
256.46
C7.85

26431
256.31
C8.00

4+75

27747
267.11
C10.36

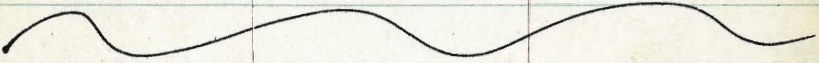
3710	25110 245.89 C 5.21	25110 245.45 C 5.65	5+53	25485 246.60 C 8.25	246.16
2+75	24940 245.79 C 3.61	24940 245.35 C 4.05	5+18 NH.21 50 RP stub = 251.84	25229 246.50 C 5.79	25229 246.06 C 6.23
2+40	24613 245.68 C 0.45	24613 245.24 C 0.89	4+85	25209 246.42 C 5.67	25209 245.98 C 6.11
2+05 NH.22 See page 34	24558 C 5.66	245.14 C 5.50	4+50	25146 246.31 C 5.15	25146 245.87 C 5.59
			4+15	25144 246.21 C 5.23	25144 245.77 C 5.67
7+40 NH.24 END	28815 279.99 C 8.46		3+80	25112 246.10 C 5.02	25112 245.66 C 5.46
7+20	28832 279.01 C 9.31		3+45	25146 246.00 C 5.46	25146 245.56 C 5.90

			10+10	26054 247.99 C12.55
7+63	25790 247.24 C10.66	246.80	9+75	25910 247.89 C11.21
7+28	25941 247.13 C12.28	246.69	9+40	25781 247.78 C10.03
6+93	26010 247.02 C13.08	246.58	9+05	25770 247.68 C10.02
6+58	25956 246.92 C12.64	246.48	8+70	25579 247.57 C8.22
6+23	25782 246.81 C11.01	246.37	8+35	25583 247.47 C8.36
5+88	25602 246.71 C9.31	246.27	Equation 8+10 = 8+04 ⁹⁵ MH 20	25644 247.38 C9.06

12+60

26091
248.74
C 12.17

1780 P.E.

276.09

267.90
C 8.19

38

1740

272.05
263.92
C 8.13

12+25

26027
248.64
C 11.63

1705

26847
260.30
C 8.17

11+90

26026
248.53
C 11.73

0+70

26522
256.68
C 8.54

11+55

26076
248.43
C 12.33

0+35

26189
253.06
C 8.81

11+20

26103
248.32
C 12.71

0+00 to North
11
13+77.77 MH #18

25880
249.10
C 9.70

25880
249.44
C 9.36 ↑

10+85 MH #19

26181
248.22
C 13.59

13+30

26093
248.95
C 11.98

10+45

26129
248.10
C 13.19

12+95

26102
248.85
C 12.17

16+10

25568
249.78
C 5.90

18+40

25479
250.49
C 4.30

39

15+75

25398
249.68
C 4.30

18+05

25272
250.38
C 2.34

15+40

25397
249.57
C 4.40

17+70

25095
250.28
C 0.67

15+05

25593
249.47
C 6.46

17+35

25036
250.17
C 0.19

14+70

25810
249.36
C 8.74

17+00 NH#17

25316
250.07
C 3.09

14+35

25920
249.26
C 9.94

16+80

25499
249.99
C 5.00

14+00

25955
249.16
C 10.39

16+45

25665
249.89
C 6.76

13+77.77 NH#18

249.10
C 9.70

249.10

20+63 N/A #16

26474
251.16
C 13.58

23+08

26195
253.40
C 8.55

20+50

26285
251.12
C 11.13

22+73

26063
253.08
C 7.55

20+15

26154
251.01
C 10.53

22+38

25987
252.76
C 7.11

19+80

26069
250.91
C 9.78

22+03

25966
252.44
C 7.22

19+45

25937
250.80
C 8.57

21+68

25957
252.12
C 7.45

19+10

25795
250.70
C 7.25

21+33

26120
251.80
C 9.40

18+75

25675
250.59
C 6.16

20+98

26332
251.48
C 11.84

1+40

270.16 ✓
258.74
C 11.42

3+85

27630 ✓
267.07
C 9.73

1+05

26935 ✓
257.55
C 11.80

3+50

27497 ✓
265.88
C 9.09

0+70

26883 ✓
256.36
C 12.47

2+80

27400 ✓
264.69
C 9.31

0+35

26830 ✓
255.17
C 13.13

2+45

27311 ✓
263.50
C 9.61

0+00



NH #14

23+70.82 = 0+00 To WEST

267.55

26796 ✓
253.98
C 13.98

2+10

27225 ✓
262.31
C 9.94

23+43

26543 ✓
253.72
C 11.71

1+75

27167 ✓
261.12
C 10.55

27086 ✓
259.93
C 10.93

			25+80	26782 25972 C 8.10
5+60 DEAD END	28466 ✓ 275.39 C 9.27		25+45	26720 258.76 C 8.44
5+40	28402 ✓ 274.42 C 9.60		25+10	26663 257.80 C 8.83
5+05	28244 ✓ 272.71 C 9.73		24+75	26640 256.84 C 9.56
4+70	28068 ✓ 271.00 C 9.68		24+40	26674 255.88 C 10.86
4+35	27875 ✓ 269.29 C 9.46		24+05	26720 254.92 C 12.78
4+00 MH# 15	27695 ✓ 267.58 C 9.37		23+70.82 MH# 14	253.98 C 13.98

28+35

27541
268.47
C 6.94

30+95

28909
280.55
C 8.54

28+00

27412
267.16
C 6.96

30+60

28711
278.66
C 8.45

27+65

27288
265.84
C 7.04

30+25

28512
276.77
C 8.35

27+30

27185
264.53
C 7.32

29+90

28301
274.88
C 8.13

26+95

27085
263.21
C 7.64

29+55 NH#12

28105
272.99
C 8.06

26+60 NH#13

26987
261.90
C 7.97

29+05

27847
271.10
C 7.37

26+15

26870
260.68
C 8.02

28+70

27681
269.79
C 7.02

33+55

30367
294.59
C 9.08

0+37

31488
307.19
C 7.69

33+20

30165
292.70
C 8.95

0+31

31428
306.65
C 7.63

32+85

29963
290.81
C 8.820+00 TO NORTH IN PATTEN ST.
11
35+44.97 MH# 1031435
304.85
C 9.50

32+50 MH# 11

29770
288.92
C 8.78

34+95

31140
302.15
C 9.25

32+00

29481
286.22
C 8.59

34+60

30932
300.26
C 9.06

31+65

29285
284.33
C 8.52

34+25

30729
298.37
C 8.92

31+30

29098
282.44
C 8.54

33+90

30541
296.48
C 8.93

2+53	34370 335.23 C 8.47	34370 339.83 C 7.87	37+20	322.51 312.55 C 9.96
2+18	33925 330.67 C 8.58	33925 334.51 C 4.94	36+85	321.02 311.01 C 10.01
1+83	33473 326.12 C 8.61	33473 329.19 C 5.54	36+50	319.45 309.47 C 9.98
1+48	33003 321.57 C 8.46	33003 323.87 C 6.16	36+15	317.80 307.93 C 9.87
1+13	32496 317.01 C 7.95	32496 318.55 C 6.41	35+80	316.23 306.39 C 9.84
0+78	32013 312.46 C 7.67	32013 313.23 C 6.90	35+ 44.97 NH #10	304.85 C 9.50
0+43 BRK	307.91 SAME	31556 307.91 C 7.65	2+72 NH #10A (END)	34548 337.72 C 7.76
				30548 342.72 C 2.76

39+50	32993 320.69 C9.24	42+08	33657 328.00 C8.57
39+15	32897 319.82 C9.15	41+73	33550 326.84 C8.66
38+80	32797 318.94 C9.03	41+38	33452 325.68 C8.84
38+45.35 MH#9 <u>Equals 0+00 To The North.</u>	32693 318.07 C8.96	41+03.24 MH#8	33360 324.52 C9.08
38+25	32634 317.17 C9.17	40+55	33245 323.32 C9.13
37+90	32504 315.63 C9.41	40+20	33170 322.44 C9.26
37+55	32370 314.09 C9.61	39+85	33082 321.57 C9.25

44+35

345.72
336.82
C 8.90

46+80.

35832
349.32
C 9.00

44+00

344.56
335.04
C 9.52

46+45.

35640
347.53
C 8.87

43+61.13 NH#2 ANGLE POINT LEFT
65TH STREET.

342.95
333.06
C 9.89

46+10.

35452
345.75
C 8.77

43+48

342.24
332.64
C 9.60

45+75.

35283
343.96
C 8.87

43+13

340.60
331.48
C 9.12

45+40.

35160
342.18
C 8.82

42+78

339.13
330.32
C 8.81

45+05.

34905
340.39
C 8.66

42+43

337.90
329.16
C 8.64

44+70

34708
338.61
C 8.47

48+30 ..

36670
357.81
C 8.89

0+64.92

33079
321.38
C 9.41

47+95 ..

36477
355.74
C 9.03

0+32.46

32767
319.72
C 7.95

47+60 ..

36292
353.68
C 9.24

38+45.35 Detroit
0+00 = MH# 9

318.07
C 8.86

0+59 D.E.

36595
356.99
C 8.96

~~36595~~
Easements ↑

0+29.5

36348
354.33
C 9.15

49+02 D.E.

371.11
362.06
C 9.05

47+26.13 MH#1 = 0+00 To West
of Edmonds

36118
351.68
C 9.50

48+65.

368.85
359.87
C 8.98

2+97.84

35038
340.57
C 9.81

5+37.60 NH #3 (0+00 to {East
West})

49
37361
362.01
C 11.61

2+63.49

34602
336.38
C 9.64

5+03.37

371.61
359.40
C 12.21

2+29.14

34123
332.19
C 9.04

4+69.17

36845
356.79
C 11.66

1+94.79 NH #7 (0+00 to {East
West})

33644
328.00
C 8.44

4+34.97

36558
354.18
C 11.40

1+62.30

33469
326.34
C 8.35

4+00.77

36217
351.57
C 10.60

1+29.84

33214
324.69
C 7.45

358.57
on Hub
3+66.57 NH #5 (0+00 to {East
West})
& Edmonds

35924
348.96
C 10.28

0+97.38

33075
323.03
C 7.72

3+32.19

35352
344.76
C 8.76

0+77 chimney #1

50

0+63.6

346.50
335.20
C 11.30

0+31.8

339.68
331.60
C 8.08

7+09.93 DEAD END
E Medio

379.05
367.97
C 11.08

0+00 to East

328.00

6+75.40

377.12
366.77
C 10.35

(1+94.79 MH #7)

6+40.95

375.04
365.58
C 9.46

0+82 D.E.

350.19
341.12
C 9.07

6+06.50

376.53
364.39
C 12.14

0+41

343.13
334.56
C 8.57

5+72.05

375.45
363.20
C 12.25

0+00 to West

328.00

(1+94.79 MH #7)

2+82.2

35272
346.86
C 5.86

1+39 D.E.

36378
355.63
C 8.15

2+51.4

35316
346.64
C 6.52

1+04.25

36241
353.97
C 8.44

2+20.6

35483
346.43
C 8.40

0+69.50

36056
352.30
C 8.26

1+89.8

35578
346.21
C 9.57

0+34.75

35964
350.63
C 9.01

1+59.0 NH#6

35579
346.00
C 9.79

0+00 to West

348.96

1+27.2

35527
342.40
C 12.87

(3+66.57 NH#5)

0+95.4

35194
338.80
C 13.14

3+13.0 D.E.

35230
347.08
C 5.22

1+66.65

36957
358.96
C10.61

0+34.75

37279
362.18
C10.61

1+33.32

36774
356.96
C10.78

0+00 to West
(5+37.60 NH#3)

362.01

0+99.99

36531
354.96
C10.35

3+13.0 D.E.

37227
364.61
C7.66

0+66.66

36255
352.96
C9.59

2+75.32

37242
363.40
C9.02

0+33.33

36000
350.96
C9.04

2+37.66

37202
362.18
C9.84

0+00 to East
(3+66.57 NH#5)

348.96
C10.28

2+00 NH#4

37087
360.96
C9.91

0+82 D.E.

375.85
369.74
C 6.11

0+84 Chimney # 2

434.25
420.00

0+41

374.01
374.01
365.87
C 8.14

0+62.5 E.V.C.

C 14.25

0+00 To East
(5+37.60 M.H.#3)

362.01

0+56.2

434.35
419.86
C 14.49

0+50

428.94
419.44
C 9.50

1+39 D.E.

371.29
362.70
C 8.59

0+43.7

428.88
418.74
C 10.14

1+04.25

371.40
362.52
C 8.88

0+37.5 PVC

429.22
417.77
C 11.45

0+69.50

371.44
362.35
C 9.090+00 Existing M.H. in
Medjo St. and
Bishop Drive426.49
411.09
C 15.40

2+52.26 MH #1A
Eleanor Dr.

43190
421.00
C1090

4+02.61 DEAD END.

43928
424.01
C1527

2+20.60

43238
420.83
C1155

3+97 Chimney #4

44164
423.40
C1824

1+88.98

43389
420.66
C1323

3+62 Chimney #3

1+57.36

43607
420.50
C1557

3+42.47

43604
422.80
C1324

1+25.74

43663
420.33
C1630

3+12.40

43650
422.20
C1430

0+94.12

43765
420.17
C1748

2+82.33

43382
421.60
C1222

The image shows an open notebook with two facing pages. Both pages are cream-colored and feature light blue horizontal ruling. A metal fastener, consisting of a thin wire with small circular ends, is positioned vertically in the center gutter, passing through the pages. The right page has the number '55' handwritten in the top right corner. The notebook is set against a dark background.

8-25-58
M.O.# 21444
Roberts

Grade Stakes For Rock
See 4769XD sheet

Place

Rough

Curb

Curb

Rough

#6

313.28
313.26
F0.02

EC on
#5 60th St.

~~313.45~~

313.50
313.45
C0.05

313.6
313.5
C0.3

#4

Outlet
E 314.10 W 313.96
313.65 313.65
C0.45 C0.31

~~313.60~~
~~313.55~~

313.60
313.44
F0.16

#3

314.07
313.79 ~~313.75~~
C0.28 ~~313.72~~

313.85
313.72
F0.13

#2

314.05
313.93 ~~314.10~~
C0.18 ~~314.00~~

314.10
314.10
GRADE

PC
#1 Rock St.

314.19
~~314.28~~
314.09 } 60th St.
C0.10

314.38

520.25

Rough

Curb

Curb

Rough

60

0+04.22 EC on
Rock PI. Lt.

313.8 313.77 Inlet
~~3105~~ 3093
F33

~~West East~~
~~31471 31107~~
313.77 313.77
C0.44 C0.30

313.62
313.50 313.08
C0.54

313.50 313.5
3093 3106
F4.2 F2.9

✓ 0+00 Sub'd Line

313.75
312.92
F0.83

0-10.52 Inlet
E 313.50 312.77
W 313.35 312.77
C0.73 C0.58

0-28.14 EC on
Rock PI. Nts

422
3236

~~West East~~
~~31270 31311~~
312.88 Inlet
C0.22 C0.23
312.88
312.46
F0.42

312.88 312.9
311.9 312.0
F1.0 F0.9

#10

⊗

313.13
312.94
C0.19

#9

⊗

313.31
313.00
C0.31

#8

⊗

313.17
313.06
C0.11

#7 BC on
60th

⊗

313.18
313.12
C0.06

314.6
313.1
C1.5

Rough

Curb

Curb

Rough

61

1+22.96

316.80
316.33
C 0.47

317.12
312.07
C 0.05

0+97.96 PVC

316.18
F2.5 @ 3.1 } 312.3
F 3.9

316.20
316.18
C 0.02

316.54
316.37
C 0.17

316.37
312.3 F2.8 @ 4.2
F 4.1

0+77.96

315.76
315.62
C 0.14

315.84
~~315.75~~ 315.66
C 0.18

0+57.96

315.05
F2.4 @ 3.6 } 311.3
F 3.8

315.28
315.05
C 0.23

315.27
~~315.14~~ 314.96
C 0.31

315.14
311.3 F3.0 @ 4.5
F 3.8

0+37.96

314.73
314.48
C 0.25

314.62
~~314.53~~ 314.26
C 0.36

0+17.96

F3.0 @ 4.5 } 313.91
F 4.1

314.06
313.91
C 0.15

313.98
~~313.92~~ 313.56
C 0.42

313.92
309.8 F2.3 @ 3.5
F 4.1

Rough

Curb

Curb

Rough

62

3+00 F3.4@5.1 319.07
3143
F4.8

31919
319.07
C0.12

31965
319.36
C0.29

319.36
3143 F2.3@3.4
F5.1

2+75

31902
318.83
C0.19

31938
319.12
C0.26

2+50

F3.3@5.0 318.59
3139
F4.7

31871
318.59
C0.12

31910
318.88
C0.22

318.28
3139 C21 PL.
F5.0

2+25

31856
318.35
C0.21

31875
318.64
C0.11

1+97.96 EVC

F3.3@5.0 318.09
3135
F4.6

31817
318.09
C0.08

31841
318.38
C0.03

318.28
3135 F1.2@1.8
F4.9

1+72.96

31771
317.78
F0.07

31800
318.07
F0.07

1+47.96

F2.9@4.3 317.37
3129
F4.5

31744
317.37
C0.07

31764
317.61
F0.03

317.64
3129 F2.8@4.2
F4.7

Rough

Curb

Curb

Rough.

63

4+75

32077
320.95 .75
C0.02

321.04
321.00
F0.04

4+50

F3.3@50
320.51
315.8
F4.7

32057
320.51 .51
C0.06

32097
320.80
C0.17

320.80
315.9 F4.0@60
F5.0

4+25

32027
320.29 .21
GRADE

32062
320.56
C0.06

4+00

F3.3@50
320.03
315.4
F4.6

32011
320.07 .03
C0.08

32049
320.32
C0.17

320.32
315.4 F4.0@60
F4.9

3+75

31998
319.99 .79
C0.19

32012
320.08
C0.04

3+50

F3.7@50
319.55
314.8
F4.8

31950
319.55 .55
F0.05

31996
319.84
C0.12

319.84
314.8 F3.0@45
F5.0

3+25

31937
319.37 .31
C0.06

31988
319.60
C0.28

Rough

Curb

Curb

Rough

64

6+50

F3.6 @ 5.4
322.43
3177
F4.7322.49 .43
322.12
F0.31322.89
322.72
C0.17

322.72

3177 C1.2 PL.
F5.0

6+25

322.99 .19
321.43
F0.76322.68
322.48
C0.20

6+00

F3.9 @ 5.9
321.95
3172
F4.8321.97
321.95
C0.02322.28
322.24
~~322.24~~
C0.04

322.24

3172 GRADE 10R
F5.0

5+75

321.93
321.91 .11
C0.22322.03
322.00
C0.03

5+50

F3.4 @ 5.1
321.47
3168
F4.7321.55
321.79 .47
C0.08321.88
321.76
C0.12

321.76

3168 F27-@40
F5.0

5+25

321.28
320.29 .23
C0.05321.52
321.52
GRADE

5+00

F3.3 @ 5.0
320.99
3163
F4.7321.07
320.99 .11
C0.08321.41
321.28
C0.13

321.28

3163 F38 @ 5.7
F5.0

See page 73

PCC
#4 FRC 10x00
college

Rough

323.35
321.7
F 1.7

Curb

323.35
322.87
F 0.48

Curb

324.96
323.70
C 1.26

No. End Inlet

Rough

3250
FCC 323.70
C 1.3

324.9 65
R 323.80
C 1.1

#3

323.32
322.90
F 0.42

#2

323.28
322.75
F 0.53

#1
Mid.

323.45
323.25
F 0.20

#1

323.24
323.24
GRADE

7+16.63 BC
college

Lt

323.20
323.20
323.0
318.4
F 4.8

323.20
323.10
F 0.10

/ / / / / / /

6+91.18 BC
College

Rt

F 3.1 @ 4.7

322.90
318.1
F 4.8

322.90
322.65
F 0.25

323.32
323.20
C 0.12

323.20 323.8
318.1 323.20
F 5.1 C 0.6

6+75

322.67
322.60
F 0.07

323.10
322.96
C 0.14

W.O. 32855
8-28-58
Roberts

GRADE STAKES FOR ALLEY
Block 96, O.B. Park
5440-D

66

			2+92	2.34 2.33 F0.01	2.34 2.20 F0.14
1+06.5	242 1.60 C0.82	241 1.60 C0.81	2+65.5	2.73 2.23 C0.50	2 2.23 2.11 F0.12
0+80 BRK	1.00 1.50 C0.40	172 1.50 C0.22	2+39	2.54 2.13 C0.41	2.57 2.13 C0.44
0+60	245 1.65 C0.80	292 1.65 C1.27	2+12.5	2.82 2.02 C0.80	2.34 2.02 C0.32
0+40	323 1.80 C1.43	237 1.80 C0.57	1+86	200 1.92 C0.08	220 1.92 C0.28
0+20 BRK.	259 1.96 C0.63	240 1.96 C0.44	1+59.5	206 1.81 C0.25	204 1.81 C0.23
0+00 Abbott	1.98	1.95	1+33	1.81 1.71 C0.10	1.85 1.71 C0.14

NWBP Abbott & Muir 1.94

3 ± 92.24 WEST POINT LOMA BLVD	1.31	1.37
---	------	------

3+85 LEFT	345 1.73 C 1.72	11171
-----------	-----------------------	-------

3+65	345 2.40 C 1.05	272 2.40 C 0.32
------	-----------------------	-----------------------

3+45 BRK	339 2.56 C 0.83	268 2.56 C 0.12
----------	-----------------------	-----------------------

3+18.5	245 2.44 C 0.01	246 2.44 C 0.02
--------	-----------------------	-----------------------

W.O.21656
9-2-58
Roberts

Curb Stakes in La Jolla Mesa
Drive - skylark Dr. to North
5850-D sheet

Rough

Curb

18+74.02

Rough

Curb

68

341.90

341.90

341.90

341.54
F0.36

340.18
F1.72

17+00

323.52

323.52

323.52

18+49.02

339.40

339.40

323.37

322.46

338.90

339.97

F0.15

F1.06

F0.60

F1.43

25.25'

16+75

320.92

320.85

320.85

18+24.02BC

336.75

336.75

336.75

C0.07

319.93

336.63

335.63

F0.92

F0.12

F1.12

16+50

318.18

318.18

318.18

334.20

334.20

334.20

318.21

317.36

18+00

334.02

333.16

C0.03

F0.82

F0.18

F1.04

16+25

315.42

315.42

315.12

314.52

F0.30

F0.87

16+00 EC

312.66

312.66

312.66

17+75

331.53

331.53

311.44

311.93

331.12

330.35

F1.22

F0.73

F0.41

F1.18

15+75

309.96

309.90

17+50

328.86

328.86

328.86

309.78

309.42

328.63

327.67

F0.12

F0.48

F0.23

F1.19

15+63.76 Curb
EC
skylark

308.60

308.60

17+25

326.19

326.19

326.01

325.05

F0.18

F1.14

BM-301.12
sheet

sw ret skylark & La Jolla Mesa Dr

Rough

Curb

Rough

Curb

69

20+49.02

357.98 357.98
 357.51 358.25
 F 0.47 F 2.73

22+24.28 END

373.40

373.40

373.71

25.23

20+24.02

355.70 355.70 355.70
 355.40 353.35
 F 0.30 F 2.35

21+99.28

371.28

371.28

370.61

370.88

F 0.67

F 1.20

19+99.02

353.42 353.42
 353.21 351.48
 F 0.21 F 1.94

21+74.28

369.15

369.15

369.15

368.88

367.87

F 0.27

F 1.28

19+74.02

351.14 351.14 351.14
 350.85 349.21
 F 0.29 F 1.93

21+49.28

367.00

367.00

366.65

365.10

F 0.35

F 1.90

25.23

19+49.02

348.86 348.86
 348.38 346.90
 F 0.48 F 1.96

21+24.28

364.88

364.88

364.88

364.28

362.08

F 0.60

F 2.80

25.49

19+24.02

346.58 346.58 346.58
 346.08 344.76
 F 0.50 F 1.82

20+99.02

362.54

362.54

361.95

359.36

F 0.59

F 3.18

25.23

18+99.02

344.30 344.30
 343.81 342.47
 F 0.50 F 1.83

20+74.02

360.26

360.26

360.26

359.72

357.02

F 0.54

F 3.24

W.D. 21658
9-3-58
Roberts

Grade Stakes For Storm Drain
in Lot 10, Amantea Mar Vista.
See 7075-B

70

0+68

126.29
120.85
C 5.44

0+52 Break

116.60
111.70
C 4.90

0+39

112.92
108.05
C 4.87

1+39 END DITCH

133.69
133.00
C 0.69

0+26 Break

112.05
104.40
C 7.65

1+16.5

133.60
132.50
C 1.10

0+08 Break

110.74
102.20
C 8.54

0+94 END PIPE
BEGIN DITCH

134.34
132.00
C 2.34

134.76

0+00 Curtain
Wall

110.82
101.60
C 9.22

0+84 Break

134.07
130.00
C 4.07

W.O. 20020
Roberts
9-18-58

Grade Stakes For Lots 15, 16
Blk 31, Fairmount Add. to
City Hts.

71

2+25.10

328.89
328.62
F 0.27

2+20

328.65
328.20
F 0.45

2+00

327.98
326.94
F 1.04

1+80

327.74
326.95
F 0.79

1+75.10

327.77
327.57
F 0.20

0+00 No. Line Polk

BM NEBP 34327 - 48th 1/2 Polk

W.O. 21542
Roberts
9-18-58

Grade Stakes For Bleachers
Colina Del Sol Park

72

5342-D

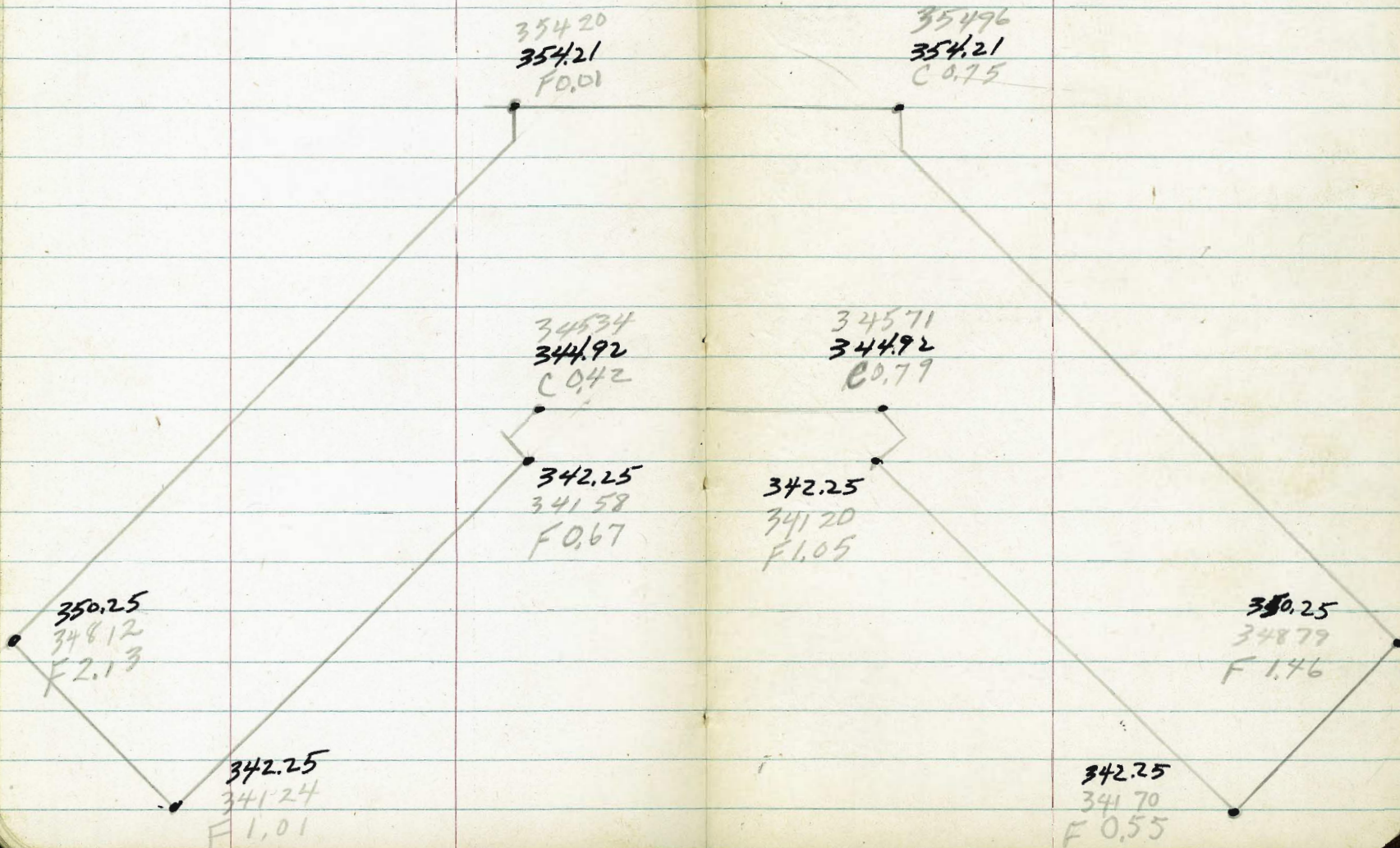

Rock Face Cont'd
Rough

curb

curb

Rough

Existing cb.
 142032 SW. corner
 college & Univ.

322.00
~~322.04~~

32426
 324.20

#6

Existing curb Rock St.

1400

32267
~~322.50~~
 C0.17

32263
 322.50
 C0.13

0490

32273
 322.60
 C0.13

32275
 322.60
 C0.15

#5

324.06
 324.06
 GRADE

32460
 324.06
 C0.54

0460

32361
~~322.85~~
 C0.76

32305
 322.85
 C0.20

#4

323.93
 32370
 F0.23

32473
 323.93
 C0.80

0430

32315
 323.10
 C0.05

323.10
 32290
 F0.20

#3
 10' End Inlet

32497
 323.80
 C1.17

323.80
 C1.1

20-10-58
W.O. 32328

Grades For Alley in Block B, Riviera Villas

5040-D

~~1752 Water Lateral~~
~~delete~~ on left.

1+17.65

27894
278.25
C 0.69

27907
278.32
C 0.75

2+60

2+40

28750
285.98
C 1.52

28609
285.18
C 0.89

28693
286.23
C 0.70

28586
285.43
C 0.43

0+92.07

27758
276.79
C 0.79

276.81
276.27
F 0.54

2+20 PVC

28491
284.12
C 0.79

28483
284.37
C 0.46

0+66.49

27633
275.32
C 1.01

275.30
275.04
F 0.26

~~2+12 Sewer ① delete~~ / / / / /

0+40.91

27504
273.86
C 1.18

27391
273.79
C 0.12

1+94.39

28314
282.65
C 0.49

28353
282.85
C 0.68

0+15.33

Angle
Point

27331
272.39
C 0.92

27333
272.28
C 1.05

1+68.81

28120
281.18
C 0.02

28224
281.34
C 0.90

0+00

Santa
Barbara

270.93

271.26

1+43.23

28039
279.72
C 0.67

28059
279.83
C 0.76

BN 258.92 NEBP Trieste & Santa Barbara

4+20	28755 287.40 C 0.15	28793 287.65 C 0.28			
4+00 PVC	28743 287.12 C 0.31	287.37 287.18 F 0.19	5+20 PVC	292.60 292.25 F 0.35	29332 292.85 C 0.47
3+75	287.05 285.45 F 1.60	287.30 286.66 F 0.64	5+00	291.43 291.20 F 0.23	29198 291.69 C 0.29
3+50	Problem 28697 286.97 GRADE	28785 287.22 C 0.63	4+80	290.27 288.96 F 1.31	29053 290.53 GRADE
			4+72 Water lateral on Rt.	No Grade	
3+25	28852 286.90 C 1.62	28973 287.15 C 2.58	4+62 Sewer @ 1/1/1		2899 285.0 C 4.9
3+00 EVC	28782 286.82 C 1.00	28907 287.07 C 2.00	4+60	289.11 288.87 F 0.24	289.37 289.33 F 0.04
2+80	28767 286.53 C 1.14	28841 286.78 C 1.63	4+40 EVC	287.95 287.79 F 0.16	288.61 288.21 C 0.40

6+40 EVC	29556 293.42 C 2.14	29626 293.64 C 2.62		
6+20	29514 294.75 C 0.39	29620 295.00 C 1.20		
6+00	295.09 294.62 F 0.47	29634 295.34 C 1.00		
5+80	294.90 294.78 F 0.12	295.67 295.15 F 0.52		
5+60	294.42 294.22 F 0.20	29531 294.65 C 0.66	6+92.86 LaPaloma 289.19	289.87 ✓
5+40	293.64 293.35 F 0.29	294.67 293.88 C 0.79	6+66.43	29267 291.30 C 1.37 29624 291.75 C 4.49

Wo #20020

7/24/58

78

Curb Stakes blk 114 Roseville

Lots 3+4

stakes 3' BK Cb Face
grades top curb

1+00

14.81
14.14
FO.67

0+75

14.27
13.63
FO.64

0+50

13.73
13.16
FO.57

0+25

13.19
12.92
FO.27

0+00

12.65 existing
curb

WO 20855

7-22-58

Rover
Moralez

79

storm drain Yonge St.

existing pipe 33.80

1+52 33.44 39.42 C 5.98

1+20 31.29 36.06 C 4.77

0+88 29.15 34.55 C 5.40

0+56 27.02 32.17 C 5.15

0+28 25.14 30.08 C 4.94

existing pipe 23.27

we

7-

exi

1+

1+

0+

0+

0+

exi

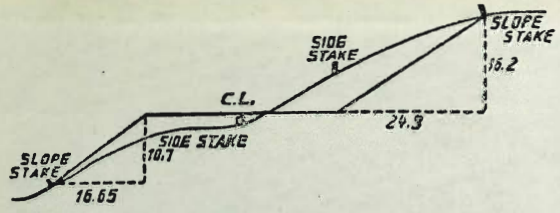

DISTANCES FROM SIDE STAKES FOR CROSS-SECTIONING.
 SLOPE 1 1/2 TO 1. ROADWAY OF ANY WIDTH.

	0	.1	.2	.3	.4	.5	.6	.7	.8	.9	
0	0.00	0.15	0.30	0.45	0.60	0.75	0.90	1.05	1.20	1.35	0
1	1.50	1.65	1.80	1.95	2.10	2.25	2.40	2.55	2.70	2.85	1
2	3.00	3.15	3.30	3.45	3.60	3.75	3.90	4.05	4.20	4.35	2
3	4.50	4.65	4.80	4.95	5.10	5.25	5.40	5.55	5.70	5.85	3
4	6.00	6.15	6.30	6.45	6.60	6.75	6.90	7.05	7.20	7.35	4
5	7.50	7.65	7.80	7.95	8.10	8.25	8.40	8.55	8.70	8.85	5
6	9.00	9.15	9.30	9.45	9.60	9.75	9.90	10.05	10.20	10.35	6
7	10.50	10.65	10.80	10.95	11.10	11.25	11.40	11.55	11.70	11.85	7
8	12.00	12.15	12.30	12.45	12.60	12.75	12.90	13.05	13.20	13.35	8
9	13.50	13.65	13.80	13.95	14.10	14.25	14.40	14.55	14.70	14.85	9
10	15.00	15.15	15.30	15.45	15.60	15.75	15.90	16.05	16.20	16.35	10
11	16.50	16.65	16.80	16.95	17.10	17.25	17.40	17.55	17.70	17.85	11
12	18.00	18.15	18.30	18.45	18.60	18.75	18.90	19.05	19.20	19.35	12
13	19.50	19.65	19.80	19.95	20.10	20.25	20.40	20.55	20.70	20.85	13
14	21.00	21.15	21.30	21.45	21.60	21.75	21.90	22.05	22.20	22.35	14
15	22.50	22.65	22.80	22.95	23.10	23.25	23.40	23.55	23.70	23.85	15
16	24.00	24.15	24.30	24.45	24.60	24.75	24.90	25.05	25.20	25.35	16
17	25.50	25.65	25.80	25.95	26.10	26.25	26.40	26.55	26.70	26.85	17
18	27.00	27.15	27.30	27.45	27.60	27.75	27.90	28.05	28.20	28.35	18
19	28.50	28.65	28.80	28.95	29.10	29.25	29.40	29.55	29.70	29.85	19
20	30.00	30.15	30.30	30.45	30.60	30.75	30.90	31.05	31.20	31.35	20
21	31.50	31.65	31.80	31.95	32.10	32.25	32.40	32.55	32.70	32.85	21
22	33.00	33.15	33.30	33.45	33.60	33.75	33.90	34.05	34.20	34.35	22
23	34.50	34.65	34.80	34.95	35.10	35.25	35.40	35.55	35.70	35.85	23
24	36.00	36.15	36.30	36.45	36.60	36.75	36.90	37.05	37.20	37.35	24
25	37.50	37.65	37.80	37.95	38.10	38.25	38.40	38.55	38.70	38.85	25
26	39.00	39.15	39.30	39.45	39.60	39.75	39.90	40.05	40.20	40.35	26
27	40.50	40.65	40.80	40.95	41.10	41.25	41.40	41.55	41.70	41.85	27
28	42.00	42.15	42.30	42.45	42.60	42.75	42.90	43.05	43.20	43.35	28
29	43.50	43.65	43.80	43.95	44.10	44.25	44.40	44.55	44.70	44.85	29
30	45.00	45.15	45.30	45.45	45.60	45.75	45.90	46.05	46.20	46.35	30
31	46.50	46.65	46.80	46.95	47.10	47.25	47.40	47.55	47.70	47.85	31
32	48.00	48.15	48.30	48.45	48.60	48.75	48.90	49.05	49.20	49.35	32
33	49.50	49.65	49.80	49.95	50.10	50.25	50.40	50.55	50.70	50.85	33
34	51.00	51.15	51.30	51.45	51.60	51.75	51.90	52.05	52.20	52.35	34
35	52.50	52.65	52.80	52.95	53.10	53.25	53.40	53.55	53.70	53.85	35
36	54.00	54.15	54.30	54.45	54.60	54.75	54.90	55.05	55.20	55.35	36
37	55.50	55.65	55.80	55.95	56.10	56.25	56.40	56.55	56.70	56.85	37
38	57.00	57.15	57.30	57.45	57.60	57.75	57.90	58.05	58.20	58.35	38
39	58.50	58.65	58.80	58.95	59.10	59.25	59.40	59.55	59.70	59.85	39
40	60.00	60.15	60.30	60.45	60.60	60.75	60.90	61.05	61.20	61.35	40
41	61.50	61.65	61.80	61.95	62.10	62.25	62.40	62.55	62.70	62.85	41
42	63.00	63.15	63.30	63.45	63.60	63.75	63.90	64.05	64.20	64.35	42
43	64.50	64.65	64.80	64.95	65.10	65.25	65.40	65.55	65.70	65.85	43
44	66.00	66.15	66.30	66.45	66.60	66.75	66.90	67.05	67.20	67.35	44
45	67.50	67.65	67.80	67.95	68.10	68.25	68.40	68.55	68.70	68.85	45
46	69.00	69.15	69.30	69.45	69.60	69.75	69.90	70.05	70.20	70.35	46
47	70.50	70.65	70.80	70.95	71.10	71.20	71.40	71.55	71.70	71.85	47
48	72.00	72.15	72.30	72.45	72.60	72.75	72.90	73.05	73.20	73.35	48
49	73.50	73.65	73.80	73.95	74.10	74.25	74.40	74.55	74.70	74.85	49
50	75.00	75.15	75.30	75.45	75.60	75.75	75.90	76.05	76.20	76.35	50

THE NATIONAL BLANK BOOK COMPANY
 HOLYOKE MASSACHUSETTS
 NEW YORK CHICAGO BOSTON SAN FRANCISCO