

61

115 - 400	St. Univ. to Adams	1
116 - 500	St. Univ. to Colfax	21
117 - 600	St. Univ. to Hendricks	32
118 - 700	St. Idaho to 3000 ft	42
119 - 800	St. Idaho to 3000 ft	50
120 - 900	St. Univ. to F. M. St	55
121 - 1000	St. Univ. to F. M. St	63

of the work and the collection  
 but providing the existing quantities of the same  
 in the collection  
 in the collection  
 in the collection

115 St. Univ. to 3000 ft 70  
 116 St. Univ. to 3000 ft 75

FIELD

661



TRAVERSE TABLE FOR TRANSIT BOOK.

From 1° to 90° for a distance of 100.

Degrees.	DEGREES.		½ DEGREE.		¼ DEGREE.		¼ DEGREE.		Degrees.
	Lat.	Dep.	Lat.	Dep.	Lat.	Dep.	Lat.	Dep.	
	DEGREES		½ DEGREE.		¼ DEGREE.		¼ DEGREE.		
0	99.98	1.75	100.00	0.44	100.00	0.87	99.99	1.31	89
1	99.98	1.75	99.98	2.18	99.97	2.62	99.95	3.05	88
2	99.94	3.49	99.92	3.93	99.91	4.36	99.88	4.80	87
3	99.86	5.23	99.84	5.67	99.81	6.10	99.79	6.54	86
4	99.76	6.98	99.73	7.41	99.69	7.85	99.66	8.28	85
5	99.62	8.72	99.58	9.15	99.54	9.58	99.50	10.02	84
6	99.45	10.45	99.41	10.89	99.36	11.32	99.31	11.75	83
7	99.25	12.19	99.20	12.62	99.14	13.05	99.09	13.49	82
8	99.03	13.92	98.97	14.35	98.90	14.78	98.84	15.21	81
9	98.77	15.64	98.70	16.07	98.63	16.50	98.56	16.93	80
10	98.48	17.36	98.40	17.79	98.33	18.22	98.25	18.65	79
11	98.16	19.08	98.08	19.51	97.99	19.94	97.90	20.36	78
12	97.81	20.79	97.72	21.22	97.63	21.64	97.53	22.07	77
13	97.44	22.50	97.34	22.92	97.24	23.34	97.13	23.77	76
14	97.03	24.19	96.92	24.62	96.81	25.04	96.70	25.46	75
15	96.59	25.88	96.48	26.30	96.36	26.72	96.25	27.14	74
16	96.13	27.56	96.00	27.98	95.88	28.40	95.76	28.82	73
17	95.63	29.24	95.50	29.65	95.37	30.07	95.24	30.49	72
18	95.11	30.90	94.97	31.32	94.83	31.73	94.69	32.14	71
19	94.55	32.56	94.41	32.97	94.26	33.38	94.12	33.79	70
20	93.97	34.20	93.82	34.61	93.67	35.02	93.51	35.43	69
21	93.36	35.84	93.20	36.24	93.04	36.65	92.88	37.06	68
22	92.72	37.46	92.55	37.86	92.39	38.27	92.22	38.67	67
23	92.05	39.07	91.88	39.47	91.71	39.87	91.53	40.27	66
24	91.35	40.67	91.18	41.07	91.00	41.47	90.81	41.87	65
25	90.63	42.26	90.45	42.66	90.26	43.05	90.07	43.44	64
26	89.88	43.84	89.69	44.23	89.49	44.62	89.30	45.01	63
27	89.10	45.40	88.90	45.79	88.70	46.17	88.50	46.56	62
28	88.29	46.95	88.09	47.33	87.88	47.72	87.67	48.10	61
29	87.46	48.48	87.25	48.86	87.04	49.24	86.82	49.62	60
30	86.60	50.00	86.38	50.38	86.16	50.75	85.94	51.13	59
31	85.72	51.50	85.49	51.88	85.26	52.25	85.04	52.62	58
32	84.80	52.99	84.57	53.36	84.34	53.73	84.10	54.10	57
33	83.87	54.46	83.63	54.83	83.39	55.19	83.15	55.56	56
34	82.90	55.92	82.66	56.28	82.41	56.64	82.16	57.00	55
35	81.92	57.36	81.66	57.71	81.41	58.07	81.16	58.42	54
36	80.90	58.78	80.64	59.13	80.39	59.48	80.13	59.83	53
37	79.86	60.18	79.60	60.53	79.34	60.88	79.07	61.22	52
38	78.80	61.57	78.53	61.91	78.26	62.25	77.99	62.59	51
39	77.71	62.93	77.44	63.27	77.16	63.61	76.88	63.94	50
40	76.60	64.28	76.32	64.61	76.04	64.94	75.76	65.28	49
41	75.47	65.61	75.18	65.93	74.90	66.26	74.61	66.59	48
42	74.31	66.91	74.02	67.24	73.73	67.56	73.43	67.88	47
43	73.14	68.20	72.84	68.52	72.54	68.84	72.24	69.15	46
44	71.93	69.47	71.63	69.78	71.33	70.09	71.02	70.40	45
45	70.71	70.71							
Degrees.	Dep.	Lat.	Dep.	Lat.	Dep.	Lat.	Dep.	Lat.	Degrees.

Published by H. S. CROCKER COMPANY, Stationers, Drawing Materials, Mathematical Instruments, etc., San Francisco.

5.77 20.00  
5.40  
20.10 =

5.47  
20.10  
20.10

Crocker Quality

FIELD BOOK



No. \_\_\_\_\_

225.6  
219  
292.80 H.I.

292.80 292.80  
85.50 290.50  
7.30

MANUFACTURED BY

H. S. CROCKER CO.

SAN FRANCISCO AND SACRAMENTO CALIFORNIA

280.5

285.5

291.0

291.5

FROM LORINGS BOOK STORE San Diego, Cal.

MICROFILMED  
DEC 4 1964



Adams

Ave

Madison

Ave.

350.8

350.6

Mission Drive

342.5

342.9

341.4

ST

Louisiana

471.9

324.9

342.0

343.0

338.6

338.0

Madison

Ave

Monroe

Ave.

Monte

Ave

Meade

Ave.

338.0

337.4

333.4

332.8

ST.

Louisiana

334.0

333.4

327.0

326.0

Meade

Ave.

El Cajon

Ave.



El Cajon Ave.

Howard Ave.

Howard Ave.

Polk Ave.

Lincoln Ave.

30' 10'  
327.5

30' 30'  
326.5

331.0

330.0

301.5

301.5

299.0

300.0

St.

326.17

325.34

From Univ. Ave to El Cajon Ave.

14' WALKS 13 1/4'

323.27

322.54

El Cajon to Adams 300.0  
20' WALKS - 5' (1/4 5)

302.0

329.96

329.67

Louisiana

331.0

331.0

Howard Ave

Ave

Tack in post for line, or fore-sight to SW Cor Hamilton.

Louisiana

331.0

330.0

West alley H.W. 302.0

Polk Ave.

302.0

Ave.

298.0

Lincoln Ave.

299.0

Univ. Ave.

297.0

300.0

Ave.

Copper tack in base-board of fence.

Copper tack base-board of fence







West.

LOUISIANA ST

E.

5

298.25 298.00 297.85 298.50 298.40 299.00 299.25

296.78	98.00	99.00	303.00
6.87	5.88	4.56	3.60
303.65			

298.00 298.00 298.03 298.68 298.58 299.00 299.00  
297.00 298.00

297.85 297.25 298.19 298.84 298.74 298.25 298.85

LINCOLN

298.50 297.50 298.35 299.00 298.90 298.50 299.50

Ave.

298.40 297.75 298.51 299.16 299.06 298.75 299.40

299.00 298.00 298.67 299.32 299.22 299.00 300.00  
298.00 300.00

299.25 299.00 298.85 298.50 299.40 300.00 300.25



So. Line Park Ave

301.75	301.50	301.10	301.50	301.50	301.75
301.60	301.35	300.95	301.37	300.99	301.39
301.46	301.21	300.82	301.25	300.87	301.29
301.31	301.06	300.68	301.12	300.76	301.19
301.17	300.92	300.55	301.00	300.65	301.08
301.02	300.77	300.44	300.87	300.54	300.98
300.87	300.62	300.28	300.75	300.42	300.87
300.73	300.48	300.14	300.62	300.31	300.77
300.58	300.33	300.01	300.50	300.20	300.67
300.44	300.19	299.87	300.37	300.09	300.56
300.29	300.04	299.73	300.25	299.97	300.46
300.15	299.90	299.60	300.12	299.86	300.35
300.00	299.75	299.46	300.00	299.75	300.25
299.85	299.60	299.34	299.87	299.64	300.14
299.71	299.46	299.20	299.75	299.52	300.04
299.56	299.31	299.07	299.62	299.41	299.94
299.42	299.17	298.93	299.50	299.30	299.83
299.27	299.02	298.80	299.37	299.19	299.73
299.12	298.87	298.66	299.25	299.07	299.62
298.98	298.73	298.53	299.12	298.96	299.52
298.83	298.58	298.39	299.00	298.85	299.42
298.69	298.44	298.25	298.87	298.74	299.31
298.54	298.29	298.12	298.75	298.62	299.21
298.39	298.14	297.98	298.62	298.51	299.10
298.25	298.00	297.85	298.50	298.40	299.00

No. Line Lincoln Ave

302.81	302.81	302.81	302.81	302.81	302.81	302.81	302.81	302.81	302.81	302.81
01.35	01.70	01.84	01.46	01.17	01.33	01.12	00.87	00.59	00.92	
0.56	0.96	0.77	0.85	1.14	0.88	1.19	1.24	1.73	1.39	
1.11	0.78	0.6	0.7	0.6	0.9	0.1	1.16	2.4	0.2	
F0.6	F0.2	6.0	F9.7	F7.3	0.8	0.1	F9.9	F2.7	0.12	
302.81	302.81	302.81	302.81	302.81	302.81	302.81	302.81	302.81	302.81	302.81
00.71	00.27	00.00	00.80	00.29	99.71	99.42	00.09	99.87	99.12	
1.60	0.92	0.81	1.41	2.02	2.60	2.89	2.23	2.44	3.19	
0.6	0.0	0.0	1.8	0.6	2.3	0.7	2.7	0.3	6.0	
0.10	F4.0	F3.7	0.4	0.14	F0.2	F2.9	0.18	0.16	F2.9	
302.81	302.81	302.81	302.81	302.81	302.81	302.81	302.81	302.81	302.81	302.81
98.83	99.67	99.46	98.54	98.20	99.20					
3.49	2.64	2.85	3.77	4.06	3.65					
5.6	0.6	10.3	5.8	4.7	10.3					
F2.1	0.74	0.02	F1.0	F0.6	0.34					

BM 196.79 20 tie-ins for NW Cor of Lincoln & Louisiana corrected 09-71

303.55	303.55	303.55	303.55	303.55	303.55	303.55	303.55	303.55	303.55	303.55
78.00	99.00	99.21	99.29	99.59	99.42	99.62	99.97	99.17	99.83	
5.85	4.85	4.64	5.54	5.77	4.43	4.23	4.99	4.69	4.04	
303.55	303.55	303.55	303.55	303.55	303.55	303.55	303.55	303.55	303.55	303.55
00.04	99.46	99.75	00.25	00.46	00.04	00.33	00.67	00.97	00.64	
0.81	4.39	4.10	3.69	3.37	3.21	3.52	3.19	2.98	3.23	
303.55	303.55	303.55	303.55	303.55	303.55	303.55	303.55	303.55	303.55	303.55
00.92	01.09	01.29	01.21	01.00	01.50					
2.93	2.77	2.53	2.64	2.30	2.05					

Cont'd page 7  
Jul 26-13 (Command) (Shaw) (Terrell)

Red. books 4-22-13 (Shaw)

303.90	303.90	303.90	303.90	303.90	303.90	303.90	303.90	303.90	303.90	303.90
98.00	77.85	98.50	73.40	79.00	301.50	301.10	301.50	301.10	301.50	301.50
5.90	6.10	5.90	5.50	4.90	4.62	4.92	4.52	4.92	4.52	

BM 302.34  
306.02 HI checked 0 1/2 May 5-1915 (Command) (Shaw) (Terrell)



W.

LOUISIANA ST

E.

302.25	302.00	301.60	302.00	301.60	302.00	302.25
--------	--------	--------	--------	--------	--------	--------

302.24
4.25
306.62

302.20	301.50
4.62	5.12

302.00	302.00	301.51	301.91	301.51	302.00	302.00
	301.00				301.00	

301.60	300.87	301.43	301.83	301.43	300.87	301.60
--------	--------	--------	--------	--------	--------	--------

POLK

301.75	300.75	301.35	301.75	301.35	300.75	301.75
--------	--------	--------	--------	--------	--------	--------

Ave.

301.22	300.62	301.27	301.67	301.27	300.62	301.22
--------	--------	--------	--------	--------	--------	--------

301.50	300.50	301.19	301.59	301.19	300.50	301.50
	301.50				301.50	

301.75	301.50	301.10	301.50	301.10	301.50	301.75
--------	--------	--------	--------	--------	--------	--------







11.

LOUISIANA ST.

E.

M. L. Mc. Howard

331.25 331.00 330.60 331.00 330.60 331.00 331.25

331.00 331.00 330.56 330.91 330.47 331.00 331.00  
330.00

330.60 330.60 330.58 330.83 330.35 329.75 330.40

HOWARD

331.00 331.00 330.50 330.75 330.23 329.50 330.50

ST.

330.60 330.86 330.47 330.17 330.11 329.25 329.85

331.00 331.00 330.44 330.59 329.99 329.00 330.00  
330.00

331.25 331.00 330.40 330.50 329.85 330.00 330.25

S. L. Howard

9



Ward 12/12

S.L. El Cajon

328	327.75	327.50	326.90	327.00	326.35	326.50	326.75
329	327.88	327.63	327.03	327.15	326.51	326.67	326.92
300	328.14	327.89	327.29	327.45	326.83	327.01	327.26
75	328.40	328.15	327.55	327.74	327.14	327.34	327.59
150	328.66	328.41	327.81	328.04	327.44	327.67	327.92
225	328.92	328.67	328.07	328.33	327.77	328.01	328.26
300	329.18	328.93	328.33	328.63	328.08	328.34	328.59
45	329.43	329.18	328.58	328.92	328.40	328.67	328.92
50	329.69	329.44	328.84	329.22	328.71	329.00	329.25
75	329.95	329.70	329.10	329.67	329.03	329.34	329.59
100	329.21	329.96	329.36	329.81	329.34	329.67	329.92
BREAK							
75	330.17	330.22	329.67	330.11	329.60	330.00	330.25
50	330.73	330.48	329.98	330.41	329.97	330.34	330.59
75	330.99	330.74	330.29	330.70	330.29	330.67	330.92
100	331.25	331.00	330.60	331.00	330.60	331.00	331.25

N.L. Howard

BM 332.77 Sta Pic at alley between El Cajon & Wreath.

332.77 HI	332.77	332.77	332.77	332.77	332.77	332.77	332.77
332.77	332.77	332.77	332.77	332.77	332.77	332.77	332.77
332.77	332.77	332.77	332.77	332.77	332.77	332.77	332.77
332.77	332.77	332.77	332.77	332.77	332.77	332.77	332.77
332.77	332.77	332.77	332.77	332.77	332.77	332.77	332.77
332.77	332.77	332.77	332.77	332.77	332.77	332.77	332.77
332.77	332.77	332.77	332.77	332.77	332.77	332.77	332.77
332.77	332.77	332.77	332.77	332.77	332.77	332.77	332.77
332.77	332.77	332.77	332.77	332.77	332.77	332.77	332.77
332.77	332.77	332.77	332.77	332.77	332.77	332.77	332.77

diff. +4 - Nov 12-1912, Domain, Shaw, Devine

BM 332.77 to tie into for N.W. Cor of Howard & Louisiana, corrected 332.71

332.77	332.77	332.77	332.77	332.77	332.77	332.77	332.77
332.77	332.77	332.77	332.77	332.77	332.77	332.77	332.77
332.77	332.77	332.77	332.77	332.77	332.77	332.77	332.77
332.77	332.77	332.77	332.77	332.77	332.77	332.77	332.77
332.77	332.77	332.77	332.77	332.77	332.77	332.77	332.77
332.77	332.77	332.77	332.77	332.77	332.77	332.77	332.77
332.77	332.77	332.77	332.77	332.77	332.77	332.77	332.77
332.77	332.77	332.77	332.77	332.77	332.77	332.77	332.77
332.77	332.77	332.77	332.77	332.77	332.77	332.77	332.77
332.77	332.77	332.77	332.77	332.77	332.77	332.77	332.77

332.77	332.77	332.77	332.77	332.77	332.77	332.77	332.77
332.77	332.77	332.77	332.77	332.77	332.77	332.77	332.77
332.77	332.77	332.77	332.77	332.77	332.77	332.77	332.77
332.77	332.77	332.77	332.77	332.77	332.77	332.77	332.77
332.77	332.77	332.77	332.77	332.77	332.77	332.77	332.77
332.77	332.77	332.77	332.77	332.77	332.77	332.77	332.77
332.77	332.77	332.77	332.77	332.77	332.77	332.77	332.77
332.77	332.77	332.77	332.77	332.77	332.77	332.77	332.77
332.77	332.77	332.77	332.77	332.77	332.77	332.77	332.77
332.77	332.77	332.77	332.77	332.77	332.77	332.77	332.77

Will have to check this well again

O.J. May 6-1913

Domain Bedford Devine



10 L EC

11

31 EC











W.

No. 1. Meade Ave E

334.25 334.00 333.40 333.70 332.90 333.40 333.65

334.10 334.00 333.30 333.60 332.80 333.40 333.40  
 333.0 332.4

333.40 332.85 333.26 333.56 332.76 332.25 332.80

Meade

333.70 332.70 333.10 333.40 332.60 332.10 333.10

Ave

332.80 332.55 332.94 333.24 332.56 331.95 332.30

333.40 332.4 333.40 332.90 333.20 332.40 331.80 332.80 332.80

333.65 333.40 332.80 333.10 332.80 332.80 333.05

9-23-12 St. Paul's Returns



Louisiana Ave

West.

East.

So. Line Monroe Ave

400	338.25	338.00	337.40	337.70	336.90	337.40	337.65
	338.08	337.83	337.28	337.53	336.73	337.23	337.48
✓	337.91	337.66	337.06	337.36	336.56	337.06	337.31
	337.74	337.49	336.89	337.19	336.39	336.89	337.14
400	✓ 337.58	337.33	336.73	337.03	336.23	336.73	336.98
	337.41	337.16	336.56	336.86	336.06	336.56	336.81
✓	337.24	336.99	336.39	336.69	335.89	336.39	336.64
	337.08	336.83	336.23	336.53	335.73	336.23	336.48
400	✓ 336.91	336.66	336.06	336.36	335.56	336.06	336.31
	336.74	336.49	335.89	336.19	335.39	335.89	336.14
✓	336.58	336.33	335.73	336.03	335.23	335.73	335.98
	336.41	336.16	335.56	335.86	335.06	335.56	335.81
400	✓ 336.24	335.99	335.39	335.69	334.89	335.39	335.64
	336.08	335.83	335.23	335.53	334.73	335.23	335.48
✓	335.91	335.66	335.06	335.36	334.56	335.06	335.31
	335.74	335.49	334.89	335.19	334.39	334.89	335.14
200	✓ 335.58	335.33	334.73	335.03	334.23	334.73	334.98
	335.41	335.16	334.56	334.86	334.06	334.56	334.81
✓	335.24	334.99	334.39	334.69	333.89	334.39	334.64
	335.08	334.83	334.23	334.53	333.73	334.23	334.48
100	✓ 334.91	334.66	334.06	334.36	333.56	334.06	334.31
75	334.74	334.49	333.89	334.19	333.39	333.89	334.14
50	✓ 334.58	334.33	333.73	334.03	333.23	333.73	333.98
25	334.41	334.16	333.56	333.86	333.06	333.56	333.81
00	334.25	334.00	333.40	333.70	332.90	333.40	333.65

N.L. Meade Ave

Topot Point post SE Monroe - Louisiana  
341.83  
341.88

337.84	337.59	337.34	337.09	336.84	336.59	336.34	336.09	335.84	335.59	335.34	335.09	334.84	334.59	334.34	334.09	333.84	333.59	333.34	333.09	332.84	332.59	332.34	332.09	331.84	331.59	331.34	331.09	330.84	330.59	330.34	330.09	329.84	329.59	329.34	329.09	328.84	328.59	328.34	328.09	327.84	327.59	327.34	327.09	326.84	326.59	326.34	326.09	325.84	325.59	325.34	325.09	324.84	324.59	324.34	324.09	323.84	323.59	323.34	323.09	322.84	322.59	322.34	322.09	321.84	321.59	321.34	321.09	320.84	320.59	320.34	320.09	319.84	319.59	319.34	319.09	318.84	318.59	318.34	318.09	317.84	317.59	317.34	317.09	316.84	316.59	316.34	316.09	315.84	315.59	315.34	315.09	314.84	314.59	314.34	314.09	313.84	313.59	313.34	313.09	312.84	312.59	312.34	312.09	311.84	311.59	311.34	311.09	310.84	310.59	310.34	310.09	309.84	309.59	309.34	309.09	308.84	308.59	308.34	308.09	307.84	307.59	307.34	307.09	306.84	306.59	306.34	306.09	305.84	305.59	305.34	305.09	304.84	304.59	304.34	304.09	303.84	303.59	303.34	303.09	302.84	302.59	302.34	302.09	301.84	301.59	301.34	301.09	300.84	300.59	300.34	300.09	299.84	299.59	299.34	299.09	298.84	298.59	298.34	298.09	297.84	297.59	297.34	297.09	296.84	296.59	296.34	296.09	295.84	295.59	295.34	295.09	294.84	294.59	294.34	294.09	293.84	293.59	293.34	293.09	292.84	292.59	292.34	292.09	291.84	291.59	291.34	291.09	290.84	290.59	290.34	290.09	289.84	289.59	289.34	289.09	288.84	288.59	288.34	288.09	287.84	287.59	287.34	287.09	286.84	286.59	286.34	286.09	285.84	285.59	285.34	285.09	284.84	284.59	284.34	284.09	283.84	283.59	283.34	283.09	282.84	282.59	282.34	282.09	281.84	281.59	281.34	281.09	280.84	280.59	280.34	280.09	279.84	279.59	279.34	279.09	278.84	278.59	278.34	278.09	277.84	277.59	277.34	277.09	276.84	276.59	276.34	276.09	275.84	275.59	275.34	275.09	274.84	274.59	274.34	274.09	273.84	273.59	273.34	273.09	272.84	272.59	272.34	272.09	271.84	271.59	271.34	271.09	270.84	270.59	270.34	270.09	269.84	269.59	269.34	269.09	268.84	268.59	268.34	268.09	267.84	267.59	267.34	267.09	266.84	266.59	266.34	266.09	265.84	265.59	265.34	265.09	264.84	264.59	264.34	264.09	263.84	263.59	263.34	263.09	262.84	262.59	262.34	262.09	261.84	261.59	261.34	261.09	260.84	260.59	260.34	260.09	259.84	259.59	259.34	259.09	258.84	258.59	258.34	258.09	257.84	257.59	257.34	257.09	256.84	256.59	256.34	256.09	255.84	255.59	255.34	255.09	254.84	254.59	254.34	254.09	253.84	253.59	253.34	253.09	252.84	252.59	252.34	252.09	251.84	251.59	251.34	251.09	250.84	250.59	250.34	250.09	249.84	249.59	249.34	249.09	248.84	248.59	248.34	248.09	247.84	247.59	247.34	247.09	246.84	246.59	246.34	246.09	245.84	245.59	245.34	245.09	244.84	244.59	244.34	244.09	243.84	243.59	243.34	243.09	242.84	242.59	242.34	242.09	241.84	241.59	241.34	241.09	240.84	240.59	240.34	240.09	239.84	239.59	239.34	239.09	238.84	238.59	238.34	238.09	237.84	237.59	237.34	237.09	236.84	236.59	236.34	236.09	235.84	235.59	235.34	235.09	234.84	234.59	234.34	234.09	233.84	233.59	233.34	233.09	232.84	232.59	232.34	232.09	231.84	231.59	231.34	231.09	230.84	230.59	230.34	230.09	229.84	229.59	229.34	229.09	228.84	228.59	228.34	228.09	227.84	227.59	227.34	227.09	226.84	226.59	226.34	226.09	225.84	225.59	225.34	225.09	224.84	224.59	224.34	224.09	223.84	223.59	223.34	223.09	222.84	222.59	222.34	222.09	221.84	221.59	221.34	221.09	220.84	220.59	220.34	220.09	219.84	219.59	219.34	219.09	218.84	218.59	218.34	218.09	217.84	217.59	217.34	217.09	216.84	216.59	216.34	216.09	215.84	215.59	215.34	215.09	214.84	214.59	214.34	214.09	213.84	213.59	213.34	213.09	212.84	212.59	212.34	212.09	211.84	211.59	211.34	211.09	210.84	210.59	210.34	210.09	209.84	209.59	209.34	209.09	208.84	208.59	208.34	208.09	207.84	207.59	207.34	207.09	206.84	206.59	206.34	206.09	205.84	205.59	205.34	205.09	204.84	204.59	204.34	204.09	203.84	203.59	203.34	203.09	202.84	202.59	202.34	202.09	201.84	201.59	201.34	201.09	200.84	200.59	200.34	200.09	199.84	199.59	199.34	199.09	198.84	198.59	198.34	198.09	197.84	197.59	197.34	197.09	196.84	196.59	196.34	196.09	195.84	195.59	195.34	195.09	194.84	194.59	194.34	194.09	193.84	193.59	193.34	193.09	192.84	192.59	192.34	192.09	191.84	191.59	191.34	191.09	190.84	190.59	190.34	190.09	189.84	189.59	189.34	189.09	188.84	188.59	188.34	188.09	187.84	187.59	187.34	187.09	186.84	186.59	186.34	186.09	185.84	185.59	185.34	185.09	184.84	184.59	184.34	184.09	183.84	183.59	183.34	183.09	182.84	182.59	182.34	182.09	181.84	181.59	181.34	181.09	180.84	180.59	180.34	180.09	179.84	179.59	179.34	179.09	178.84	178.59	178.34	178.09	177.84	177.59	177.34	177.09	176.84	176.59	176.34	176.09	175.84	175.59	175.34	175.09	174.84	174.59	174.34	174.09	173.84	173.59	173.34	173.09	172.84	172.59	172.34	172.09	171.84	171.59	171.34	171.09	170.84	170.59	170.34	170.09	169.84	169.59	169.34	169.09	168.84	168.59	168.34	168.09	167.84	167.59	167.34	167.09	166.84	166.59	166.34	166.09	165.84	165.59	165.34	165.09	164.84	164.59	164.34	164.09	163.84	163.59	163.34	163.09	162.84	162.59	162.34	162.09	161.84	161.59	161.34	161.09	160.84	160.59	160.34	160.09	159.84	159.59	159.34	159.09	158.84	158.59	158.34	158.09	157.84	157.59	157.34	157.09	156.84	156.59	156.34	156.09	155.84	155.59	155.34	155.09	154.84	154.59	154.34	154.09	153.84	153.59	153.34	153.09	152.84	152.59	152.34	152.09	151.84	151.59	151.34	151.09	150.84	150.59	150.34	150.09	149.84	149.59	149.34	149.09	148.84	148.59	148.34	148.09	147.84	147.59	147.34	147.09	146.84	146.59	146.34	146.09	145.84	145.59	145.34	145.09	144.84	144.59	144.34	144.09	143.84	143.59	143.34	143.09	142.84	142.59	142.34	142.09	141.84	141.59	141.34	141.09	140.84	140.59	140.34	140.09	139.84	139.59	139.34	139.09
--------	--------	--------	--------	--------	--------	--------	--------	--------	--------	--------	--------	--------	--------	--------	--------	--------	--------	--------	--------	--------	--------	--------	--------	--------	--------	--------	--------	--------	--------	--------	--------	--------	--------	--------	--------	--------	--------	--------	--------	--------	--------	--------	--------	--------	--------	--------	--------	--------	--------	--------	--------	--------	--------	--------	--------	--------	--------	--------	--------	--------	--------	--------	--------	--------	--------	--------	--------	--------	--------	--------	--------	--------	--------	--------	--------	--------	--------	--------	--------	--------	--------	--------	--------	--------	--------	--------	--------	--------	--------	--------	--------	--------	--------	--------	--------	--------	--------	--------	--------	--------	--------	--------	--------	--------	--------	--------	--------	--------	--------	--------	--------	--------	--------	--------	--------	--------	--------	--------	--------	--------	--------	--------	--------	--------	--------	--------	--------	--------	--------	--------	--------	--------	--------	--------	--------	--------	--------	--------	--------	--------	--------	--------	--------	--------	--------	--------	--------	--------	--------	--------	--------	--------	--------	--------	--------	--------	--------	--------	--------	--------	--------	--------	--------	--------	--------	--------	--------	--------	--------	--------	--------	--------	--------	--------	--------	--------	--------	--------	--------	--------	--------	--------	--------	--------	--------	--------	--------	--------	--------	--------	--------	--------	--------	--------	--------	--------	--------	--------	--------	--------	--------	--------	--------	--------	--------	--------	--------	--------	--------	--------	--------	--------	--------	--------	--------	--------	--------	--------	--------	--------	--------	--------	--------	--------	--------	--------	--------	--------	--------	--------	--------	--------	--------	--------	--------	--------	--------	--------	--------	--------	--------	--------	--------	--------	--------	--------	--------	--------	--------	--------	--------	--------	--------	--------	--------	--------	--------	--------	--------	--------	--------	--------	--------	--------	--------	--------	--------	--------	--------	--------	--------	--------	--------	--------	--------	--------	--------	--------	--------	--------	--------	--------	--------	--------	--------	--------	--------	--------	--------	--------	--------	--------	--------	--------	--------	--------	--------	--------	--------	--------	--------	--------	--------	--------	--------	--------	--------	--------	--------	--------	--------	--------	--------	--------	--------	--------	--------	--------	--------	--------	--------	--------	--------	--------	--------	--------	--------	--------	--------	--------	--------	--------	--------	--------	--------	--------	--------	--------	--------	--------	--------	--------	--------	--------	--------	--------	--------	--------	--------	--------	--------	--------	--------	--------	--------	--------	--------	--------	--------	--------	--------	--------	--------	--------	--------	--------	--------	--------	--------	--------	--------	--------	--------	--------	--------	--------	--------	--------	--------	--------	--------	--------	--------	--------	--------	--------	--------	--------	--------	--------	--------	--------	--------	--------	--------	--------	--------	--------	--------	--------	--------	--------	--------	--------	--------	--------	--------	--------	--------	--------	--------	--------	--------	--------	--------	--------	--------	--------	--------	--------	--------	--------	--------	--------	--------	--------	--------	--------	--------	--------	--------	--------	--------	--------	--------	--------	--------	--------	--------	--------	--------	--------	--------	--------	--------	--------	--------	--------	--------	--------	--------	--------	--------	--------	--------	--------	--------	--------	--------	--------	--------	--------	--------	--------	--------	--------	--------	--------	--------	--------	--------	--------	--------	--------	--------	--------	--------	--------	--------	--------	--------	--------	--------	--------	--------	--------	--------	--------	--------	--------	--------	--------	--------	--------	--------	--------	--------	--------	--------	--------	--------	--------	--------	--------	--------	--------	--------	--------	--------	--------	--------	--------	--------	--------	--------	--------	--------	--------	--------	--------	--------	--------	--------	--------	--------	--------	--------	--------	--------	--------	--------	--------	--------	--------	--------	--------	--------	--------	--------	--------	--------	--------	--------	--------	--------	--------	--------	--------	--------	--------	--------	--------	--------	--------	--------	--------	--------	--------	--------	--------	--------	--------	--------	--------	--------	--------	--------	--------	--------	--------	--------	--------	--------	--------	--------	--------	--------	--------	--------	--------	--------	--------	--------	--------	--------	--------	--------	--------	--------	--------	--------	--------	--------	--------	--------	--------	--------	--------	--------	--------	--------	--------	--------	--------	--------	--------	--------	--------	--------	--------	--------	--------	--------	--------	--------	--------	--------	--------	--------	--------	--------	--------	--------	--------	--------	--------	--------	--------	--------	--------	--------	--------	--------	--------	--------	--------	--------	--------	--------	--------	--------	--------	--------	--------	--------	--------	--------	--------	--------	--------	--------	--------	--------	--------	--------	--------	--------	--------	--------	--------	--------	--------	--------	--------	--------	--------	--------	--------	--------	--------	--------	--------	--------	--------	--------	--------	--------	--------	--------	--------	--------	--------	--------	--------	--------	--------	--------	--------	--------	--------	--------	--------	--------	--------	--------	--------	--------	--------	--------	--------	--------	--------	--------	--------	--------	--------	--------	--------	--------	--------	--------	--------	--------	--------	--------	--------	--------	--------	--------	--------	--------	--------	--------	--------	--------	--------	--------	--------	--------	--------	--------	--------	--------	--------	--------	--------	--------	--------	--------	--------	--------	--------	--------	--------	--------	--------	--------	--------	--------	--------	--------	--------	--------	--------	--------	--------	--------	--------	--------	--------	--------	--------	--------	--------	--------	--------	--------	--------	--------	--------	--------	--------	--------	--------	--------	--------	--------	--------	--------	--------	--------	--------	--------	--------	--------	--------	--------	--------	--------	--------	--------	--------	--------	--------	--------



No. Nine Monroe Ave

338.25 338.60 338.00 338.30 337.50 338.00 338.25

338.60 338.60 337.90 338.20 337.40 338.00 338.00  
337.60 337.00

338.00 337.45 337.86 338.16 337.36 336.25 337.40

Monroe

338.30 337.20 337.70 338.00 337.20 336.70 337.70

Ave.

337.50 337.15 337.54 337.84 337.04 336.55 336.90

338.00 337.00 337.50 337.80 337.00 336.40 337.40  
337.00 336.40

338.25 338.00 337.40 337.70 336.90 337.40 337.65

So. L. Monroe Ave.

339.76	- 38.91	37.15	37.40	36.65	37.40
5.20	5.30	5.85	5.55	6.95	5.60
3 43.00	37.66	36.91	37.11	36.31	35.66
	5.34	6.19	5.87	6.03	5.94

337 339.76 25' 116.7mb for NW Cor Monroe & Louisiana

6.03  
333.29 H.I.

343.26	342.59	343.29	343.29
38.60	39.00	38.00	37.40
4.69	5.29	5.29	5.89

Oct 9-12

Grinnell  
Pharm.  
Deming

Not available on 3-11-12



West

East

524.69							
500	341.65	341.40	341.08	341.95	341.80	342.43	342.75
479	341.65	341.40	341.08	341.76	341.83	342.13	342.38
450	341.51	341.26	340.85	341.61	341.33	341.93	342.18
425	341.27	341.12	340.69	341.43	341.12	341.71	341.96
400	341.22	340.97	340.54	341.24	340.91	341.50	341.75
	341.07	340.82	340.38	341.06	340.69	341.28	341.53
	340.92	340.67	340.22	340.87	340.48	341.06	341.31
	340.77	340.52	340.06	340.69	340.27	340.84	341.09
300	340.62	340.37	339.90	340.51	340.05	340.62	340.87
	340.48	340.23	339.74	340.32	339.84	340.40	340.65
	340.33	340.08	339.58	340.14	339.63	340.18	340.43
	340.18	339.93	339.42	339.95	339.41	339.96	340.21
200	340.03	339.78	339.27	339.77	339.20	339.75	340.00
	339.88	339.63	339.11	339.58	338.99	339.53	339.78
	339.73	339.48	338.96	339.40	338.77	339.31	339.56
	339.59	339.34	338.97	339.22	338.56	339.09	339.34
100	339.34	339.19	338.63	339.03	338.35	338.87	339.12
75	339.29	339.04	338.47	338.85	338.13	338.65	338.90
50	339.14	338.89	338.31	338.66	337.92	338.43	338.68
25	338.99	338.74	338.15	338.48	337.71	338.21	338.46
	338.85	338.60	338.00	338.30	337.50	338.00	338.25

N. Line MONTGOMERY AVE.

341.83 TP	57.50	37.25	39.14	38.68	39.34	39.12	39.72	39.56	40.03	40.00
55.0	8.43	7.13	8.17	8.65	9.00	8.21	7.60	7.77	7.80	7.33
347.53 H	46.3	47.2	46.0	46.0	47.8	47.7	46.6	47.7	46.9	47.5
386	+1.96	+1.06	+1.59		+2.15	+1.4	+1.79		+0.86	+0.55
343.7	40.83	41.43	40.62	40.87	40.92	41.31	41.22	41.76	41.51	42.15
350	7.10	6.90	6.71	6.46	6.41	6.02	6.1	5.87	5.78	5.15
357.7	50.9	51.2	49.5	49.1	49.1	48.7	48.5	48.2	47.2	47.5
	+1.0	+1.76	+0.30		1.06	1.10	+0.1	-0.14	+0.1	-0.35
	41.6	42.57	42.75		cut stake 1/4 1/2					
	5.65	4.57	4.75							
	50.2	53.1	53.5							
	4.06	0.5	0.7							

341.8376 - 20' tie to NW Cor. Monroe & Louisiana.

342.91 TP	342.81	342.81	342.81	342.81	342.81	342.81	342.81	342.81	342.81	342.81
340.43	38.00	38.87	38.43	38.97	39.19	39.48	39.31	39.75	39.78	
346.48 TP	4.31	4.81	3.92	4.38	3.97	3.62	3.33	3.50	3.04	3.03
	342.81	346.19	346.19	346.18	346.18	346.18	346.18	346.18	346.18	346.18
	40.18	40.09	40.37	40.62	41.06	40.67	40.97	41.50	41.93	41.26
	2.63	2.10	5.81	5.54	5.12	5.81	5.21	4.68	4.25	9.92
	346.19	346.19	346.18							
	4.03	3.45	3.70							

343.51 TP	41.26	41.30	41.26	41.08	41.93
503	5.04	5.74	4.98	5.34	4.41
346.34					
339.75 TP	38.60	37.75	38.05	37.75	38.44
339.75	4.38	5.12	4.93	5.73	4.78

345.13 Bm	5.71	6.28	5.41	5.46	4.61
-----------	------	------	------	------	------

Sat. Grade Stake Potted in

9-23-12 Prof + 66 blocked bludge

341.8376 - 20' tie to NW Cor. Madison & Louisiana.

343.31 TP	343.82	343.82	343.82	343.82	343.82
343.31	41.40	41.03	41.95	41.90	42.43
343.31 TP	4.79	4.81	3.94	4.09	3.46
343.31 TP	343.82	343.82	343.82	343.82	343.82
343.31	38.60	38.00	38.30	37.50	38.20
343.31 TP	3.72	4.32	4.62	4.93	4.32

Checked 6th, Roman, Shaw, Davis, Dec 5-12



West

East

N. I. Madison Ave

342.25 342.00

343.00

341.40

342.90

342.00

42.00

342.90

341.40

342.75

342.00

342.22

341.90

342.50

341.70

342.75

341.15

341.92

341.90

341.65 341.90

Sohive Mission Drive

B.T. 343.31 - 1st tie-hub for NW Cor Madison & Louisiana

24.15	347.46	347.46	347.46	347.46	347.96	347.46
347.46 H.I.	42.00	43.00	42.70	42.25	42.50	
	5.46	6.06	4.77	5.24	5.06	

342.81	346.01	346.41	346.41	346.41		
43.70	41.40	42.92	41.70	41.40	346.41	
342.41 H.I.	5.01	5.29	4.71	5.01	41.10	
					5.56	

346.41	346.01	346.41	346.41		346.41	346.91
42.00	42.22	42.75	42.90		41.00	41.40
3.91	4.19	3.66	4.01		4.41	5.01

B.T. 343.31	346.32	346.32	346.32	346.32	346.32	346.32	346.32
43.01	42.22	41.40	42.00	41.26	43.00	42.22	43.00
346.32 H.I.	4.32	4.12	4.32	4.92	3.02	3.72	3.72

Aug 26-12 subgrade stakes, common, show, Fernie

343.81	346.49	346.49	346.49	346.49	346.49	346.49
43.18	41.40	41.70	41.13	42.22	42.70	42.80
341.69 H.I.	5.29	4.77	5.29	4.27	3.75	4.20

subgrade stakes

common show Fernie











286.0  
Lincoln Ave  
30' 40' 120'

285.0  
287.0  
286.0  
308.0

St

306.0

299.0

Mississippi

280.0  
Univ. Ave.  
283.0  
286.0  
Lincoln Ave.

Ave  
Howard St.  
30' 20' 70'

310.0  
316.0  
318.0

St

308.0

311.0

301.0

Mississippi

287.0  
309.0  
311.0  
Polk Ave.

El Cajon Ave

313.0

320.6

322.2

St

Mississippi

317.0  
Howard Ave.  
319.0



Hwy 282.55 40' tie. Hub for 13' point Mississippi & Lincoln

20.00	284.99	286.95
282.71 HI	282.71	282.71
	2.27	3.74

April 1st 1913 Roman, Shaw, Decire

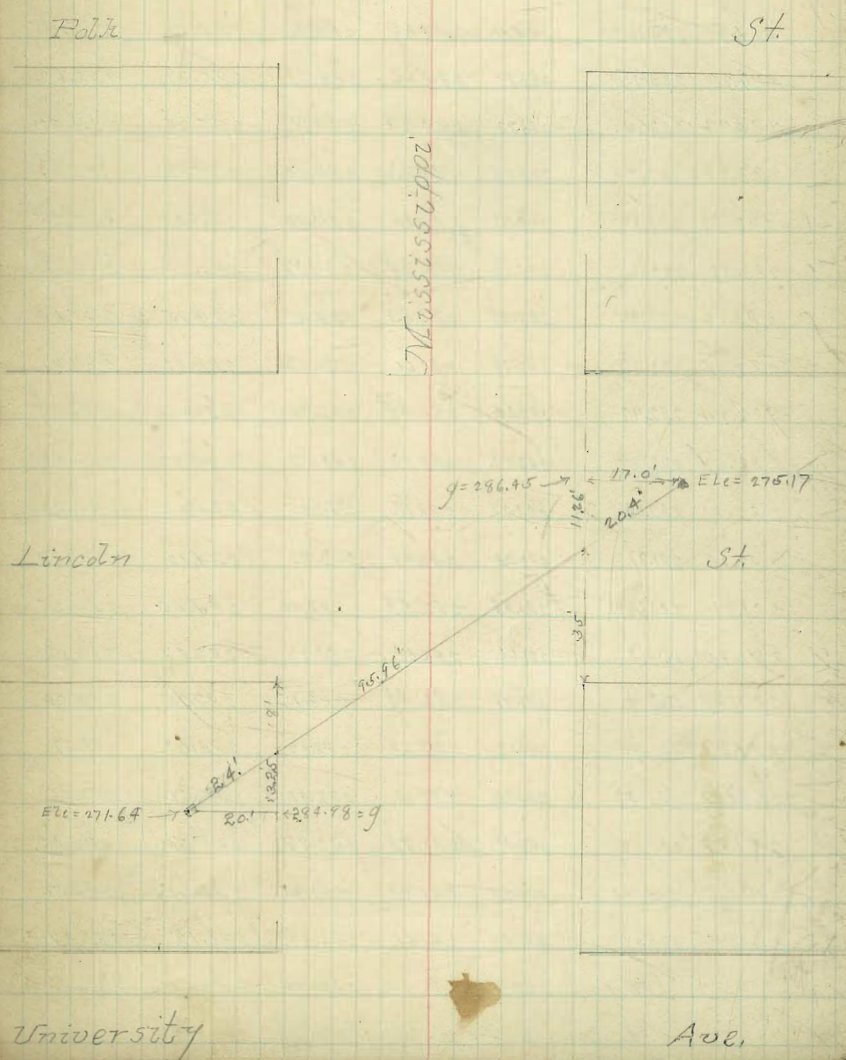







West.

East

N. L. Lincoln Ave.

286.25 286.00 285.85 286.50 286.40 287.00 287.25

286.00 286.00 285.67 286.32 286.22 287.00 287.00  
285.00 286.00

285.40 284.75 285.51 286.16 286.06 285.75 286.40

Lincoln

285.50 284.50 285.35 286.00 285.90 285.50 286.50

Ave.

284.85 284.25 285.19 285.84 285.74 285.25 285.85

285.00 284.00 285.08 285.68 285.58 285.00 286.00 286.00

285.25 285.00 284.85 285.50 285.40 286.00 286.25

So. Line Lincoln

282.35 Sp 1/2 File NE Cor Mississippi University Ave.

" 282.35 4<sup>th</sup> west tie rejoin " " Lincoln.

" 309.29 " " " " " " " Park.

" 315.28 " " " " " " " Howard.

" 317.65 Sp 1/2 File SW Cor " " El Cajon.

Check OK  
blouye







West

East

No. Line Polk Ave

309.25 309.00 309.10 309.00 310.40 311.00 311.25

309.00 309.00  
308.0 308.92 309.02 310.22 311.00 311.00  
310.0

308.40 307.75 308.76 309.66 310.06 309.75 310.40

Polk

308.50 307.50 308.60 307.50 308.90 307.50 310.50

Ave.

307.85 307.25 308.44 309.34 309.74 309.75 309.85

308.00 307.0 308.00 308.28 309.18 308.58 309.0 310.00 310.00

308.25 308.00 308.10 309.00 309.40 310.00 310.25

So. Line Polk Ave

214.75

811 2.50 10.50 ✓  
700 600 500

Check OK Bought



Mississippi St.

West.

So. Line Howard Ave

East.

600	316.25	316.00	316.40	317.00	317.40	318.00	318.25
	315.80	315.55	315.95	316.55	316.95	317.55	317.80
	315.35	315.10	315.50	316.10	316.50	317.10	317.35
	314.90	314.65	315.05	315.65	316.05	316.65	316.90
500	314.46	314.21	314.61	315.21	315.61	316.21	316.46
	314.01	313.76	314.16	314.76	315.16	315.76	316.01
	313.57	313.32	313.72	314.32	314.72	315.32	315.57
	313.12	312.87	313.27	313.87	314.27	314.87	315.12
400	312.67	312.42	312.82	313.42	313.82	314.42	314.67
	312.23	311.98	312.38	312.98	313.38	313.98	314.23
300	311.78	311.53	311.93	312.53	312.93	313.53	313.78
200	311.25	311.00	311.40	312.00	312.40	313.00	313.25
100	311.12	310.87	311.27	311.87	312.27	312.87	313.12
	310.96	310.71	311.11	311.71	312.11	312.71	312.96
	310.81	310.56	310.96	311.56	311.96	312.56	312.81
	310.65	310.40	310.80	311.40	311.80	312.40	312.65
0	310.49	310.25	310.65	311.25	311.65	312.25	312.50
	310.34	310.09	310.49	311.09	311.49	312.09	312.34
	310.18	309.93	310.33	310.93	311.33	311.93	312.18
	310.03	309.78	310.18	310.78	311.18	311.78	312.03
100	309.87	309.62	310.02	310.62	311.02	311.62	311.87
	309.71	309.46	309.86	310.46	310.86	311.46	311.71
	309.56	309.31	309.71	310.31	310.71	311.31	311.56
	309.40	309.15	309.55	310.15	310.55	311.15	311.40
0	309.25	309.00	309.40	310.00	310.40	311.00	311.25

No. Line Polk Ave.

317.87	317.87	317.87	317.87	317.87	317.87	317.87	317.87	317.87	317.87
11.25	09.25	09.25	11.25	11.25	09.25	10.18	12.13	12.50	10.50
6.62	9.62	8.31	6.31	6.00	9.00	7.67	5.67	5.37	7.37
1.3	2.3	3.9	5.9	9.0	9.0	9.0	4.4	4.9	7.9
-2.159	1.0	-0.7	-0.4	1.0	1.0	-0.6	1.13	4.05	-0.5

27

317.97	317.97	317.97	317.97	317.97	317.97	317.97	317.97	317.97	317.97
10.91	12.81	13.12	11.12	11.78	13.74	14.67	12.67	13.57	15.57
7.06	5.06	4.75	6.75	6.09	4.09	3.20	5.20	4.30	2.30
7.9	3.9	3.9	7.5	6.1	3.4	3.7	5.7	4.2	1.9
-0.5	4.3	1.9	-0.7	0.0	10.7	-0.5	-0.5	10.1	10.0

40-stake, Downman, Shant.  
Deane, March 29-1913

315.27	315.27	315.27	315.27	315.27	315.27	315.27	315.27	315.27	315.27
16.00	15.00	17.10	15.10	14.21	16.21	10.32	13.32	12.42	14.42
3.14	1.14	2.04	4.04	4.93	2.93	0.49	2.19	3.09	1.09
315.28	315.28	315.28	315.28	315.28	315.28	315.28	315.28	315.28	315.28
13.53	11.53	11.00	13.00	12.97	10.97	10.56	12.56	12.25	10.25
7.99	3.99	4.01	2.51	2.64	4.64	4.95	2.95	3.26	0.26
315.29	315.29	315.29	315.29	315.29	315.29	315.29	315.29	315.29	315.29
09.90	11.93	11.62	09.62	09.31	11.31	11.00	09.00		
5.68	3.68	3.89	5.89	6.20	4.20	4.51	6.51		

Finish stakes May 8-1913, Downman, Redford, Deane

308.29	309.0	309.40	310.0	310.40	311.0
7.50	6.80	6.70	5.8	5.70	4.80
21.79	30.86	10.74	10.62	11.2	11.62
5.11	6.17	6.17	5.17	4.77	4.77
311.68	10.25	1.85	11.2	11.65	12.25
6.20	5.53	1.24	4.34	4.74	3.34
311.68	11.00	11.1	12.0	12.40	13.0
311.68	4.8	4.7	3.8	3.4	2.8
311.68	12.94	12.52	13.42	13.82	14.22
311.68	3.87	3.27	2.37	1.92	1.37
311.68	14.51	14.21	15.21	15.21	16.21
311.68	4.60	4.27	3.67	3.27	2.67
311.68	16.2	16.1	17.2	17.40	18.0
311.68	2.85	2.7	1.89	1.49	0.89

Checked OK enough

6-16-13



W.

E.

No. Line Polk

317.25 317.00 317.40 318.00 319.40 319.00 319.25

317.00 317.00 317.22 317.82 318.22 319.00 319.00  
316.0 318.00

316.40 315.75 317.06 317.66 318.06 317.25 318.40

Howard

316.50 315.50 316.90 317.50 317.90 317.50 318.50

Ave

315.85 315.25 316.74 317.34 317.74 317.25 317.85

316.00 315.00 316.58 317.18 317.58 318.00 318.00  
316.00 317.00

316.25 316.00 316.40 317.00 317.40 318.00 318.25

So. Line Polk.

314.72

1650

1720

1650

5m

7m

6m

Check Mr. Gouge



West So. Line El Cajon Ave East

20 320.85 320.60 320.60 321.40 321.60 322.20 322.45  
 25 320.57 320.32 320.36 321.14 321.36 321.96 322.21  
 50 320.31 320.06 320.13 320.89 321.13 321.73 321.98  
 75 320.04 319.79 319.89 320.64 320.89 321.49 321.74  
 100 319.77 319.52 319.65 320.39 320.65 321.25 321.50  
 125 319.51 319.26 319.41 320.13 320.41 321.01 321.26  
 150 319.24 318.99 319.18 319.88 320.18 320.78 321.03  
 175 318.98 318.73 318.94 319.63 319.94 320.54 320.79  
 200 318.71 318.46 318.70 319.38 319.70 320.30 320.55  
 225 318.44 318.19 318.46 319.13 319.46 320.06 320.31  
 250 318.18 317.93 318.23 318.88 319.23 319.83 320.08  
 275 317.91 317.66 317.99 318.62 318.99 319.59 319.84  
 300 317.64 317.39 317.75 318.37 318.75 319.35 319.60  
 325 317.25 317.00 317.40 318.00 318.40 319.00 319.25

No. Line Howard

Point 20	225.95	225.85	225.95	225.85	225.95	225.85	225.95	225.85	225.95
+10.57	19.28	19.28	19.60	17.64	18.18	20.09	20.55	18.71	
325.18.5 HI	8.610	6.160	6.25	9.21	7.67	5.77	5.30	7.19	
-8.20	10.3	6.5	6.1	9.9	8.4	4.1	3.0	7.9	
317.65 TR	-1.7	40.1	70.1	-1.7	-0.7	7.7	7.3	-0.7	
+1.36									
319.71	225.85	225.95	225.95	225.85	225.85	225.95	225.85	225.95	
12.25	19.24	21.03	21.00	19.77	20.31	21.98	22.45	20.95	
366.46	6.161	9.82	4.35	6.08	5.54	3.87	3.40	5.00	
	7.8	7.8	2.2	6.8	5.0	2.8	1.8	6.8	
	-1.2	7.20	4.2	-0.7	40.5	7.6	7.6	-1.5	

taken, toman, Shans, Deane, March 29-1913.

TP 317.65	324.96	322.96	324.46	324.96	324.46	324.46	322.96	324.46	324.96	324.96
46.81	20.60	22.20	21.78	20.06	19.52	21.25	20.78	18.99	18.46	20.30
324.46 HI	3.86	2.26	2.73	4.40	4.94	3.21	3.68	5.47	6.40	4.16
8.18										
315.12.8	324.46	322.46	324.46	324.46	324.46	324.46	324.46	324.46	324.46	324.46
	19.83	17.93	17.39	19.05	19.40	17.00				
	4.63	6.53	7.07	5.11	5.46	7.46				

Finish taken May 7-1913.

316.28 TP	170	1710	180	1840	1900				
8.45	7.72	7.62	6.72	6.32	5.72				
324.70	1702	1823	1888	1923	1882				
17.10	6.19	6.59	5.84	5.49	4.89				
317.35	1899	1914	19.84	20.8	19.78				
	37	4.44	4.34	4.54	3.94				
	19.52	19.52	20.39	20.65	21.55				
	5.5	5.4	4.3	4.1	3.47				
	20.6	20.13	20.89	21.10	21.73				
	4.86	4.6	3.83	3.2	3				
	20.0	20.60	21.40	21.60	22.10				
	4.12	4.1	3.32	3.12	2.72				

Checked OK

6-16-13

Belought



















RICHMOND ST.

W.	Curb	1/4	1/2	3/4	Curb	E.
	So. to Robinson Arc.					
300	294.25	294.00	293.72	294.25	293.90	294.50
						294.75
275	293.91	293.66	293.42	293.97	293.69	294.29
			293.39	293.93	293.60	294.20
250	293.58	293.33	293.12	293.70	293.48	294.08
			293.07	293.62	293.31	293.91
						294.16
225	293.24	292.99	292.81	293.43	293.27	293.87
			292.75	293.31	293.02	293.62
						293.87
200	292.91	292.66	292.51	293.16	292.96	293.66
			292.43	293.00	292.73	293.33
						293.58
175	292.58	292.33	292.21	292.89	292.86	293.46
			292.10	292.68	292.44	293.04
						293.71
150	292.24	291.99	291.90	292.60	292.65	293.25
			291.78	292.37	292.14	292.74
						293.50
125	291.91	291.66	291.60	292.35	292.44	293.04
			291.46	292.06	291.85	292.45
						293.29
100	291.58	291.33	291.30	292.08	292.23	292.83
			291.14	291.75	291.56	292.16
						293.08
75	291.24	290.99	291.00	291.80	292.02	292.62
			290.84	291.43	291.27	291.87
						292.12
50	290.91	290.66	290.70	291.54	291.82	292.42
			290.54	291.12	290.98	291.58
						292.67
25	290.58	290.33	290.40	291.27	291.61	292.21
			290.27	290.84	290.68	291.29
						292.46
00	290.25	290.00	290.10	291.00	291.40	292.00
			289.85	290.60	290.44	291.00
						291.25

No. 1016 Penn. Arc. Notes changed 5-15-14

294.38 B.M. spk. pole S.W. cor Robinson

294.38	294.44	293.58	292.91	292.22	291.58	290.91
2.06	4.5	2.86	3.53	4.70	4.86	5.83
296.44	294.25	293.58	292.91	292.22	291.58	290.91
2.06	2.19	3.4	4.03	4.50	5.46	5.93
2.06	2.19	3.4	4.03	4.50	5.46	5.93
0.1	0.1	0.5	0.5	0.6	0.6	0.4
290.25	291.25	291.93	292.41	292.99	293.58	294.16
6.19	5.79	4.61	4.03	3.45	2.86	2.28
6.07	4.09	4.11	3.83	3.45	2.26	0.88
40.1	41.1	40.6	40.2	0.0	40.6	41.4
294.75	294.75	294.75	294.75	294.75	294.75	294.75
1.69	1.69	1.69	1.69	1.69	1.69	1.69
1.89	1.89	1.89	1.89	1.89	1.89	1.89
40.1	40.1	40.1	40.1	40.1	40.1	40.1

294.38 B.M. 294.44 293.58 292.91 292.22 291.58 290.91

294.38 B.M. 294.44 293.58 292.91 292.22 291.58 290.91

294.38 B.M. 294.44 293.58 292.91 292.22 291.58 290.91

294.38 B.M. 294.44 293.58 292.91 292.22 291.58 290.91

294.38 B.M. 294.44 293.58 292.91 292.22 291.58 290.91

294.38 B.M. 294.44 293.58 292.91 292.22 291.58 290.91

294.38 B.M. 294.44 293.58 292.91 292.22 291.58 290.91

294.38 B.M. 294.44 293.58 292.91 292.22 291.58 290.91

294.38 B.M. 294.44 293.58 292.91 292.22 291.58 290.91

294.38 B.M. 294.44 293.58 292.91 292.22 291.58 290.91

294.38 B.M. 294.44 293.58 292.91 292.22 291.58 290.91

34

Curbst Props 6/4/14 Gregory Shoemaker Moore



Richmond St.

West

East

No. Line Robinson

294.25 294.00 293.72 294.25 293.90 294.50 294.75

294.00 294.00 293.12 293.25 293.62 294.50 294.50  
293.00 293.50

293.60 293.69 293.77 293.85 293.93 294.01 294.10

Robinson

294.00 294.09 294.17 294.25 294.33 294.41 294.50

+07 +17

Ave.

293.60 293.69 293.77 293.85 293.93 294.01 294.10

294.00 294.00 293.12 293.25 293.62 294.50 294.50  
293.00 293.50

294.25 294.00 293.72 294.25 293.90 294.50 294.75

So. Line Robinson



Richmond St.

W

E

So. Line Essex St

300 295.25 295.00 294.72 295.25 294.90 295.50 295.75

+0.3 +0.1

275 295.16 294.91 294.63 295.16 294.81 295.41 295.66

21

250 295.08 294.83 294.55 295.08 294.73 295.33 295.58

+0.1 +0.9

225 294.99 294.74 294.46 294.99 294.64 295.24 295.49

200 294.91 294.66 294.38 294.91 294.56 295.16 295.41

+0.4 +0.6

175 294.83 294.58 294.20 294.83 294.48 295.08 295.33

150 294.74 294.49 294.21 294.74 294.39 294.99 295.24

+0.4 +0.5

125 294.66 294.41 294.13 294.66 294.31 294.91 295.16

100 294.58 294.33 294.05 294.58 294.23 294.83 295.08

+0.9 +0.7

75 294.49 294.24 293.96 294.49 294.14 294.74 294.99

50 294.41 294.16 293.88 294.41 294.06 294.66 294.91

+0.7 +0.6

25 294.33 294.08 293.80 294.33 293.98 294.58 294.83

0 294.25 294.00 293.72 294.25 293.90 294.50 294.75

+0.9 +0.4

No. Line Robinson Arc

300.51	295.08	294.91	294.74	294.58	294.41
295.25	5.43	5.60	5.77	5.93	6.10
5.26	5.23	5.3	5.47	5.63	5.8
4.96	18.2	40.3	40.3	40.8	40.8
+0.3					
294.25	294.75	294.91	295.08	295.24	295.41
6.26	5.76	5.60	5.43	5.27	5.10
6.26	5.76	5.1	4.73	4.97	4.6
0.0	0.0	40.5	40.7	40.3	40.5
295.75	6.13				
4.76	4.76	294.38			
0.0					

300.51 295.08 294.91 294.74 294.58 294.41 294.25 294.75 294.91 295.08 295.24 295.41 295.75 6.13 4.76 4.76 0.0



## Richmond St.

W.

E.

37

## North Essex St.

295.25 295.50 295.22 295.75 295.40 296.00 296.25

295.50 <sup>294.50</sup> 295.13 295.66 295.31 296.00 <sup>295.10</sup> 296.00

294.90 294.37 295.05 295.58 295.23 294.87 295.40

## Essex

295.25 294.25 294.87 295.50 295.15 294.75 295.75 +0.1 -0.2

## St.

294.72 294.13 294.89 295.42 295.07 294.63 295.22

295.00 <sup>294.00</sup> 295.00 294.81 295.34 294.99 <sup>294.50</sup> 295.50 295.50

295.25 295.00 294.72 295.25 294.90 295.50 295.75



So. Line Univ. Arc.

297.16									
335	H.I.	29736	29698	29671	29689	29607			
300.51		3.15	3.63	3.80	4.12	4.44			
297.45		3.25	3.03	3.6	4.12	4.64			
		-0.1	40.5	10.2	0.0	-0.2			
3.06		29625	29663	29701	29739	29777	29815	29825	
29575		4.26	3.88	3.00	3.12	2.74	2.36	2.26	
4.76		5.06	4.48	4.8	4.62	3.44	2.26	2.26	
4.96		-0.8	-0.6	-1.3	-1.5	-0.7	-0.4	0.0	
-0.2									

264 297.45 297.20 297.00 297.60 297.40 298.00 298.25

+0.3 0.0

250 297.36 297.11 296.90 297.50 297.30 297.90 297.15

+0.1 -0.8

225 297.19 296.94 296.73 297.32 297.11 297.71 297.96

200 296.98 296.78 296.56 297.15 296.92 297.52 297.77

-0.7 -0.5

175 296.87 296.62 296.39 296.97 296.73 297.33 297.58

150 296.71 296.46 296.23 296.80 296.54 297.14 297.39

+0.4 -0.5

125 296.55 296.30 296.06 296.62 296.35 296.95 297.20

100 296.39 296.14 295.89 296.45 296.16 296.76 297.01

0.0 -1.2

75 296.23 295.98 295.72 296.27 295.97 296.57 296.82

50 296.07 295.82 295.55 296.10 295.78 296.38 296.63

-0.1 -1.0

25 295.91 295.66 295.38 295.92 295.59 296.19 296.44

.161 .1685 .175 .19

00 295.75 295.50 295.22 295.75 295.40 296.00 296.25

-0.2 -0.7

No. Line Esset







West

Richmond St.

East

	Curb	1/4	1/2	3/4	Curb	East
300	298.50	298.52	298.58	298.65	298.72	300.25
275	298.62	298.37	298.31	299.05	299.15	299.69
250	298.51	298.26	298.21	298.96	299.08	299.68
225	298.39	298.14	298.11	298.87	298.91	299.61
200	298.28	298.03	298.01	298.78	298.94	299.54
175	298.18	297.93	297.90	298.69	298.87	299.44
150	298.05	297.80	297.80	298.60	298.81	299.38
125	297.94	297.69	297.70	298.51	298.74	299.31
100	297.82	297.57	297.60	298.42	298.67	299.25
75	297.71	297.46	297.50	298.33	298.60	299.19
50	297.59	297.34	297.39	298.24	298.53	299.13
25	297.48	297.23	297.29	298.15	298.46	299.06
00	297.37	297.12	297.19	298.06	298.40	299.00

Cleveland

No. Line

Notes changed May 13 '14

302.38	H.I.	297.82	298.05	298.28	298.51
297.25	297.59	4.56	4.33	4.10	3.87
5.13	4.79	4.46	4.23	4.00	3.77
297.37	4.59	4.1	3.9	3.6	3.4
5.01	4.02	3.8	3.6	3.4	3.2
298.75	2.99	2.38	2.15	1.92	1.72
3.63	3.00	2.38	2.15	1.92	1.72
299.52	299.38	299.24	299.10	298.96	298.82
3.96	3.00	3.13	2.90	2.67	2.44
3.16					
-0.3					

+0.1	+0.6	301.46	297.12	297.27	297.42	297.57	297.72	297.87	298.02	298.17	298.32	298.47	298.62	298.77	298.92	299.07
------	------	--------	--------	--------	--------	--------	--------	--------	--------	--------	--------	--------	--------	--------	--------	--------

Curbs + Props  
Gregory  
Shoemaker  
Moore

+0.1 +0.6

+0.2 -0.3

+0.1 0.0

+0.1 0.0

0.0

Lot 117  
Cleveland







Granada

St

30<sup>th</sup>

St.

333.0

in 50th  
St  
AK

332.5

336.0

335.5

St.

St

335.0

334.5

334.0

332.5

Utah

St.

Kansas

St.

335.5

334.0

334.0

333.5

Capps

Capps

334.5

334.0

333.0

332.5

Idaho

St

Granada

St.



North  
West Line Utah St. South

200	335.75	335.50	334.90	335.25	334.72	335.0	335.25
175	335.62	335.37	334.77	335.12	334.59	334.87	335.12
150	335.50	335.25	334.65	335.00	334.47	334.75	335.00
125	335.37	335.12	334.52	334.87	334.34	334.62	334.87
100	335.25	335.00	334.40	334.75	334.22	334.50	334.75
75	335.12	334.87	334.27	334.62	334.09	334.37	334.62
50	335.00	334.75	334.15	334.50	333.97	334.25	334.50
25	334.87	334.62	334.02	334.37	333.84	334.12	334.37
00	334.75	334.50	333.90	334.25	333.72	334.00	334.25

East Line Idaho St

33108 Pm SE Linnestad Goffe

339.41	3550	3490	3525	3472	3500
4.20	421	4.71	4.56	5.09	4.81
335.21	3525	3465	3500	3447	3475
4.60	426	5.16	4.89	5.34	5.06
339.81	3500	3440	3475	3412	3450
4.81	481	5.41	5.06	5.57	5.31
3475	3475	3413	3450	3393	3425
5.06	5.06	5.66	5.31	5.84	5.56
3450	3450	3390	3425	3372	3400
5.31	5.31	5.91	5.56	6.09	5.81

11-1-11 All in blough

338.74	3550	3490	3525	3472	3500
3.80	4.50	4.80	4.40	4.94	4.70
335.74	3525	3465	3500	3447	3475
3.96	4.41	5.05	4.70	5.23	4.95
339.70	3500	3440	3475	3412	3450
4.70	4.70	5.30	4.91	5.48	5.20
3475	3475	3415	3450	3397	3425
4.95	4.95	5.55	5.20	5.73	5.45
3450	3450	3390	3425	3372	3400
5.20	5.20	5.80	5.45	5.98	5.70

11-18-11 Check OK blough







No.

So.

333.25 333.00 332.40 332.75 332.22 332.50 332.75

333.00 333.00 331.88 331.75 331.62 332.50 332.50  
 332.00 331.50 331.50

332.60 332.51 332.43 332.35 332.27 332.19 332.10

Granada

333.00 332.91 332.83 332.75 332.67 332.59 332.50

St.

332.60 332.51 332.43 332.35 332.27 332.19 332.10

333.00 333.00 331.88 331.75 331.62 331.50 332.50  
 332.00 332.50 332.50

333.25 333.00 332.40 332.75 332.22 332.50 332.75

No Intersecting Checked  
 Along







Capps St.

No.	W. Wine 30th St.						
200	336.25	336.00	335.40	335.75	335.22	335.50	335.75
175	336.00	335.75	335.15	335.50	334.97	335.25	335.50
150	335.75	335.50	334.90	335.25	334.72	335.00	335.25
125	335.50	335.25	334.65	335.00	334.47	334.75	335.00
100	335.25	335.00	334.40	334.75	334.22	334.50	334.75
75	335.00	334.75	334.15	334.50	333.97	334.25	334.50
50	334.75	334.50	333.90	334.25	333.72	334.00	334.25
25	334.50	334.25	333.65	334.00	333.47	333.75	334.00
00	334.25	334.00	333.40	333.75	333.22	333.50	333.75

E. W. Kansas St.

236.76 min 30 Capps  
332  
340.08

336.00	335.40	335.75	335.22	335.50	335.00	335.25	335.50	335.75	336.00
4.08	4.68	4.33	4.86	4.51	4.46	4.06	4.71	4.40	4.96
3525	3465	3500	3447	3471	3467	3427	3412	3401	3437
4.0	5.40	5.04	5.6	5.33	5.21	5.81	5.16	6.07	5.71
11-20-11	2470	2270	2425	2372	2400	all set	all set	6.88E	
2225	2400	2240	2425	2322	2350				
488	4.35	4.95	4.80	5.13	4.85				
338.35									

10-18-11 all set blough D & E

236.76 min  
246  
339.22

34.00	33.40	33.75	33.72	33.50	33.50
5.22	5.82	5.47	6.00	5.72	5.72
3450	3390	3415	3372	3411	3411
4.72	5.22	4.97	5.50	5.12	5.12
3500	3440	3475	3422	3450	3450
4.72	4.82	4.47	5.00	4.72	4.72
3530	3490	3525	3472	3500	3500
5.72	4.32	5.77	4.50	4.52	4.52
36.00	3540	3575	3522	3550	3550
5.22	5.72	5.47	4.00	5.72	5.72

11-1-11 blough @ 12 blough + Pennan











Granada St 30<sup>th</sup> St

342.0

341.5

345.0

344.0

St.

St.

343.0

342.5

344.0

343.0

Utah

St

Kansas

St.

343.0

342.5

344.0

343.0

Gunn

Gunn

343.5

343.0

342.0

341.5

Idaho

St

Granada

St.

345.0

344.0

13  
1/2 m

343.93 SW 30<sup>th</sup> Gunn  
616  
350.07

Wt. Ray 346.75 346.0

346.0

345.95

345.80

Et 30<sup>th</sup> 345.75 345

346.0

345.0

St.

Gunn

345.0

344.0

50

344.75 345 345.25 345.5  
5.84 5.09 4.84 4.89  
+0.5 +0.2 +0.1 +0.5

346.0 346.0 345.95 345.50  
3.84 4.09 4.84 4.89  
-0.3 -0.3 -0.3 +0.3

GUTS & FILLS 3/20

Gregor  
Mauro  
Miller

345.5

345.45

345.10

344.75

344.5



Gunn St

200	34525	34560	34410	34450	34385	34400	34425
-----	-------	-------	-------	-------	-------	-------	-------

150	34560	34475	34415	34425	34560	34375	34400
-----	-------	-------	-------	-------	-------	-------	-------

100	34475	34450	34395	34400	34335	34350	34375
-----	-------	-------	-------	-------	-------	-------	-------

50	34450	34445	34365	34375	34310	34325	34350
----	-------	-------	-------	-------	-------	-------	-------

00	34425	34400	34340	34350	34285	34300	34325
----	-------	-------	-------	-------	-------	-------	-------

E d of Kansas

34307 Bm 13 Mon Kansas + Gunn

51

35443 Bm 12 Kansas  
 0120  
 5478  
 897  
 34661  
 314  
 34977  
 670  
 34300 TR  
 423  
 34780 AD  
 235  
 445  
 361  
 34307  
 625  
 34782 H

34410	34340	43570	4285	4300
34500	34340	4362	4385	4360
4478	4415	4425	4360	4375
445	4365	4371	4310	4321
361	368	374	420	405

140	184	195	4285	430
532	592	582	647	632
425	436	4375	4310	4325
507	567	557	622	601
445	4375	440	4335	4350
482	531	532	597	582
4478	4215	4235	4360	4375
457	517	507	572	557
450	447	445	4385	446
432	472	482	547	532

check 10/11  
Hatch

check OK  
10-15-11 Blount







Gunn St

W line of Granddast

200 34225 34200 4140 4175 4122 34150 34175

150 34250 34225 4165 4201 4147 34175 34200

100 34275 34250 4190 4225 4172 34200 34225

50 34300 34275 4215 4250 4197 34225 34250

00 34325 34300 4240 4275 4222 34250 34275

E line of Utah

Bm 34141 Nov 13' West of Gunn

53

34267 Bm 13' West of Gunn

34267 5.87 348.94 6.09 342.85	348.94 5.7 342.24 4.2 341.0	348.94 6.2 342.7 4.1 341.0	48.94 5.7 43.8 4.2 41.5	48.94 5.9 43.0 4.2 41.0	48.94 6.5 42.4 4.1 39.3	48.94 5.7 43.8 4.2 41.5
---	---	--	-------------------------------------	-------------------------------------	-------------------------------------	-------------------------------------

48.94 4.4 44.5 4.5 41.5	48.94 5.9 43.0 4.2 41.0	10-11-11	647	694E
-------------------------------------	-------------------------------------	----------	-----	------

34267  
4.57  
347.37  
4.97  
341.41  
5.23  
347.34

4300 4.34 4255 4.39 4250 4.84	4240 4.94 4215 5.19 4200 5.44	4275 4.59 4250 4.84 4225 5.09	4222 5.14 4197 5.37 4172 5.62	4250 4.84 4225 5.09 4200 5.34
--	--	--	--	--

34141 Bm  
5.88  
347.29

34300 4.79 4225 4.54 4190 4.79 4225 5.04 4250 5.29	4240 4.89 4215 5.14 4190 5.39 4215 5.64 4240 5.89	4275 4.54 4250 4.79 4225 5.04 4200 5.29	4222 5.10 4197 5.32 4172 5.59 4147 5.82	4250 4.89 4225 5.14 4200 5.39 4175 5.64
---	--	--	--	--

11-15-11

all in Gunn

694E



Sunn St

Mar 341.41 Am Wata Gum

W line of Wata St S

200	343.25	343.00	4240	4275	4222	342.50	342.75
-----	--------	--------	------	------	------	--------	--------

342.85 TP	248.25	4875	4875	4875	4875	48.25	4875	4875	4875
5.25	6.75	5.25	5.25	5.25	5.25	5.25	5.25	5.25	5.25
348.25	428	428	428	428	428	428	428	428	428
4.11	4.11	4.11	4.11	4.11	4.11	4.11	4.11	4.11	4.11
244.10 TP	428	428	428	428	428	428	428	428	428
7.22	6.7	6.7	6.7	6.7	6.7	6.7	6.7	6.7	6.7

150	343.38	343.13	4253	4288	4235	342.63	342.88
-----	--------	--------	------	------	------	--------	--------

10-11-11 147 69 + 6

341.41 Am 13 mm Wata Gum

347.58 43	343.00	4240	4275	4222	342.50	342.75
4.55	5.15	480	5.25	5.25	5.25	5.25
4313	4253	4288	4235	4263	4288	4235
4.72	5.02	4.67	5.20	4.82	4.82	4.82
4325	4245	4325	4245	4271	4271	4271
4.30	4.90	4.35	5.08	4.40	4.40	4.40
4324	4278	4313	4260	4288	4288	4288
4.17	4.77	4.42	4.85	4.67	4.67	4.67
4050	4290	4225	4272	4300	4300	4300
4.05	4.15	4.20	4.62	4.55	4.55	4.55

all in  
69 + 6  
10-24-11

100	343.50	343.25	4265	4300	4247	342.75	343.00
-----	--------	--------	------	------	------	--------	--------

50	343.63	343.38	4274	4313	4260	342.88	343.13
----	--------	--------	------	------	------	--------	--------

00	343.75	343.50	4290	4325	4272	343.00	343.25
----	--------	--------	------	------	------	--------	--------

E line of Idaho St







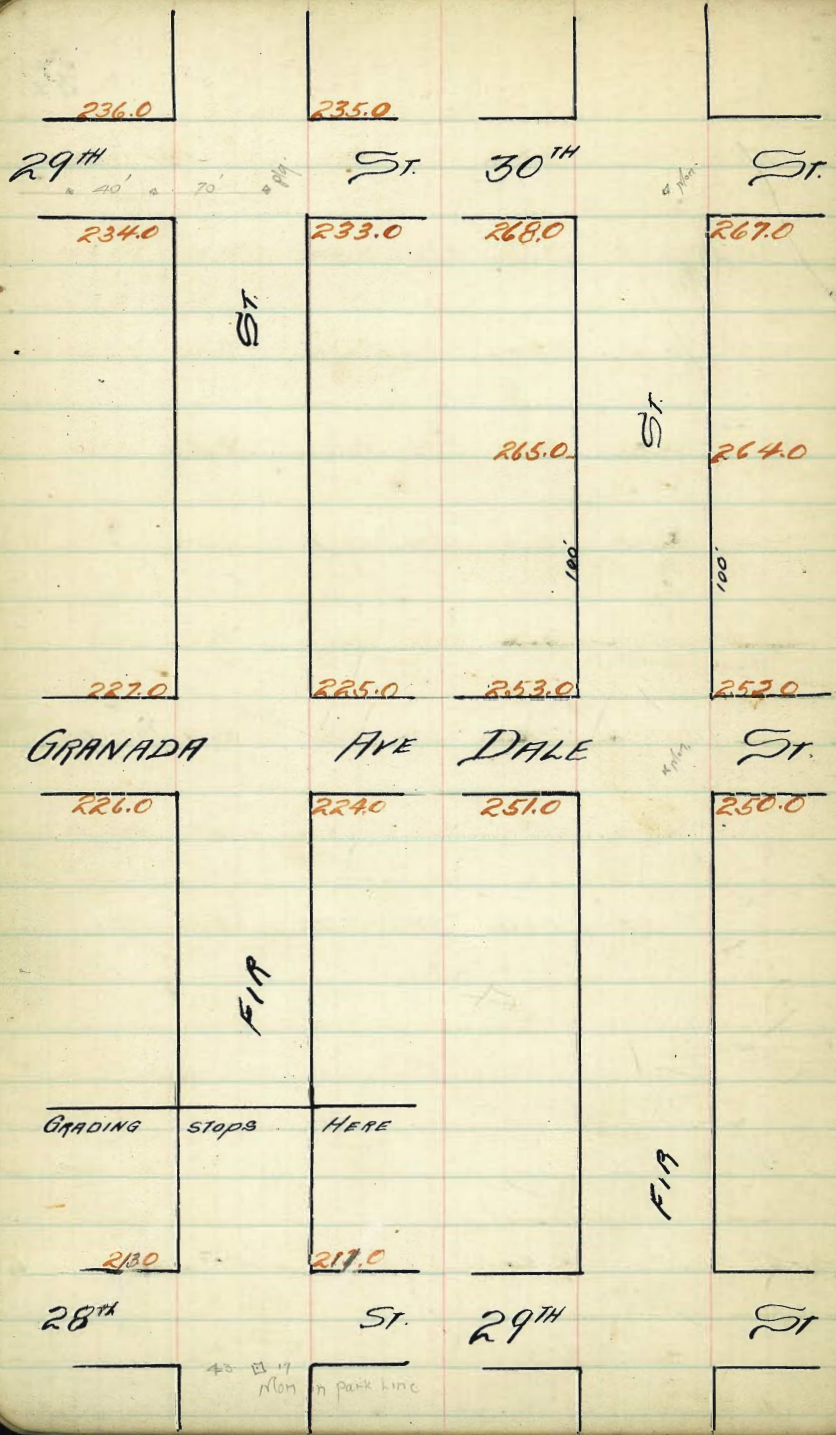







West Line of GRANADA Ave

00 226.25 226.00 225.40 225.00 224.10 224.00 224.25

25 224.70 224.45 223.85 223.45 222.55 222.45 222.70

50 223.15 222.90 222.30 221.90 221.00 220.90 221.15

75 221.61 221.36 220.76 220.36 219.46 219.36 219.61

100 220.06 219.81 219.21 218.81 217.91 217.81 218.06

125 218.51 216.51

150 218.20 217.95 217.35 216.95 216.05 215.95 216.20  
 GRADE TO HERE

175 216.96 216.71 216.11 215.71 214.81 214.71

200 215.42 215.17 214.57 214.17 213.27 213.17

225 213.87 213.62 213.02 212.62 211.72 211.62

250 213.25 213.00 212.40 212.00 211.10 211.00 211.25

E. Line 28<sup>th</sup> St.

237.27 H	224.25	224.25	224.15	224.15	224.06	180 C
6.15	11.02	18.02	8.23	10.42	11.51	13.51
237.09	5.82	6.15	2.91	8.89	7.51	8.90
5.49	7.52	6.54	7.51	7.53	7.40	7.46
235.74	15.20	16.70	18.37	15.37	18.76	12.80
225.25	1.27	3.07	2.44	2.65	2.55	2.54
1.75	2.45	2.85	2.64	2.65	2.55	2.54
227.00 H	2.6	2.82	3.15	2.6	2.5	1.15
	2.54	2.50	2.40	2.20	2.20	2.10
	1.6	2.00	2.00	4.1	4.7	5.1
	1.91	1.92	1.81	1.71	1.75	1.78
	7.17	7.77	8.19	9.09	9.19	9.05

all stakes  $\frac{1}{8}$ " H  
 Hatcher  
 Moore  
 Stall

222.25	24.65	24.65	24.65
0.90	21.15	20.96	16.92
224.65 H	5.50	4.84	5.25
	8.75	4.84	8.70
	3.65	5.44	8.60
	2.75	5.34	7.70
	2.35	6.74	7.00
	1.50	6.59	6.45
	1.75	6.34	6.70

229.78 H	26.00	25.40	25.00	24.00	24.00
16.42	2.78	4.38	4.88	4.68	4.78
219.38	17.25	17.35	16.55	16.15	15.55
4.60	16.84	6.83	7.03	7.33	8.05
223.98					

9-18-12 checked OK Hayer



No.

W.L. 29<sup>th</sup>

St.

So.

00 234.25 234.00 233.40 233.50 232.85 233.00 233.25

25 233.45 233.20 232.60 232.65 231.97 232.09 232.34

50 232.66 232.41 231.81 231.79 231.09 231.18 231.43

75 231.86 231.61 231.01 230.94 230.21 230.27 230.52

100 231.07 230.82 230.22 230.09 229.33 229.36 229.61

125 230.27 230.02 229.42 229.24 228.45 228.45 228.70

150 229.48 229.23 228.63 228.39 227.57 227.54 227.79

175 228.68 228.43 227.83 227.53 226.68 226.64 226.89

200 227.89 227.64 227.04 226.68 225.80 225.73 225.98

220 227.25 227.00 226.40 226.00 225.10 225.00 225.25

E. Line GRAHAM AVE.

Cutstakes 1/2 1/4

53

245.74 N	34.25	83.55	102.66	31.43	31.07	29.61
12.67	14.49	4.02	16.08	5.54	6.20	7.66
236.07	10.72	5.80	13.30	5.84	5.77	5.56
1.26						
207.07 N	+3.77	-1.8	+2.77	0.00	+2.4	+2.1

29.45	27.79	27.25	25.25
7.97	9.45	10.02	12.00
4.19	4.45	4.65	4.06
+3.6	+5.0	+5.37	+7.56

240.12 N	34.41	31.14	30.82	29.30	29.13	27.54	27.00	26.00
10.46	7.11	8.94	9.30	10.74	1.38	4.07	4.21	4.61

231.61  
227.01 N

236.73 N	34.0	32.4	32.5	32.5	32.0	32.1	31.7	31.5	31.0	30.5
27.0	30.3	32.3	33.3	31.0	33.2	49.2	44.1	51.4	50.5	
30.2	30.2	30.0	30.5	30.2	30.2	29.3	28.3	28.3	27.5	27.0
5.91	6.51	6.4	7.40	4.2	4.50	5.10	3.84	4.16	4.19	
27.6	27.04	26.63	25.30	25.73	27.0	26.4	26.0	25.0	25.0	25.0
9.09	9.69	10.05	10.93	11.0	9.76	10.83	10.73	11.63	11.73	

27.06 N	27.06	27.06	27.06	27.06	27.06	27.06	27.06	27.06	27.06	27.06
21.43	21.43	21.43	21.43	21.43	21.43	21.43	21.43	21.43	21.43	21.43
5.83	5.83	5.83	5.83	5.83	5.83	5.83	5.83	5.83	5.83	5.83
5.93	6.24	6.53	6.82	7.11	7.40	7.69	7.98	8.27	8.56	8.85
22.06	22.06	22.06	22.06	22.06	22.06	22.06	22.06	22.06	22.06	22.06
21.07	21.07	21.07	21.07	21.07	21.07	21.07	21.07	21.07	21.07	21.07
5.77	6.52	7.27	8.02	8.77	9.52	10.27	11.02	11.77	12.52	13.27
37.06	37.06	37.06	37.06	37.06	37.06	37.06	37.06	37.06	37.06	37.06
31.22	31.22	31.22	31.22	31.22	31.22	31.22	31.22	31.22	31.22	31.22
5.27	6.02	6.77	7.52	8.27	9.02	9.77	10.52	11.27	12.02	12.77
37.06	37.06	37.06	37.06	37.06	37.06	37.06	37.06	37.06	37.06	37.06
31.22	31.22	31.22	31.22	31.22	31.22	31.22	31.22	31.22	31.22	31.22
5.27	6.02	6.77	7.52	8.27	9.02	9.77	10.52	11.27	12.02	12.77
37.06	37.06	37.06	37.06	37.06	37.06	37.06	37.06	37.06	37.06	37.06
31.22	31.22	31.22	31.22	31.22	31.22	31.22	31.22	31.22	31.22	31.22
5.27	6.02	6.77	7.52	8.27	9.02	9.77	10.52	11.27	12.02	12.77
37.06	37.06	37.06	37.06	37.06	37.06	37.06	37.06	37.06	37.06	37.06
31.22	31.22	31.22	31.22	31.22	31.22	31.22	31.22	31.22	31.22	31.22
5.27	6.02	6.77	7.52	8.27	9.02	9.77	10.52	11.27	12.02	12.77
37.06	37.06	37.06	37.06	37.06	37.06	37.06	37.06	37.06	37.06	37.06
31.22	31.22	31.22	31.22	31.22	31.22	31.22	31.22	31.22	31.22	31.22
5.27	6.02	6.77	7.52	8.27	9.02	9.77	10.52	11.27	12.02	12.77
37.06	37.06	37.06	37.06	37.06	37.06	37.06	37.06	37.06	37.06	37.06
31.22	31.22	31.22	31.22	31.22	31.22	31.22	31.22	31.22	31.22	31.22
5.27	6.02	6.77	7.52	8.27	9.02	9.77	10.52	11.27	12.02	12.77
37.06	37.06	37.06	37.06	37.06	37.06	37.06	37.06	37.06	37.06	37.06
31.22	31.22	31.22	31.22	31.22	31.22	31.22	31.22	31.22	31.22	31.22
5.27	6.02	6.77	7.52	8.27	9.02	9.77	10.52	11.27	12.02	12.77
37.06	37.06	37.06	37.06	37.06	37.06	37.06	37.06	37.06	37.06	37.06
31.22	31.22	31.22	31.22	31.22	31.22	31.22	31.22	31.22	31.22	31.22
5.27	6.02	6.77	7.52	8.27	9.02	9.77	10.52	11.27	12.02	12.77
37.06	37.06	37.06	37.06	37.06	37.06	37.06	37.06	37.06	37.06	37.06
31.22	31.22	31.22	31.22	31.22	31.22	31.22	31.22	31.22	31.22	31.22
5.27	6.02	6.77	7.52	8.27	9.02	9.77	10.52	11.27	12.02	12.77
37.06	37.06	37.06	37.06	37.06	37.06	37.06	37.06	37.06	37.06	37.06
31.22	31.22	31.22	31.22	31.22	31.22	31.22	31.22	31.22	31.22	31.22
5.27	6.02	6.77	7.52	8.27	9.02	9.77	10.52	11.27	12.02	12.77
37.06	37.06	37.06	37.06	37.06	37.06	37.06	37.06	37.06	37.06	37.06
31.22	31.22	31.22	31.22	31.22	31.22	31.22	31.22	31.22	31.22	31.22
5.27	6.02	6.77	7.52	8.27	9.02	9.77	10.52	11.27	12.02	12.77
37.06	37.06	37.06	37.06	37.06	37.06	37.06	37.06	37.06	37.06	37.06
31.22	31.22	31.22	31.22	31.22	31.22	31.22	31.22	31.22	31.22	31.22
5.27	6.02	6.77	7.52	8.27	9.02	9.77	10.52	11.27	12.02	12.77
37.06	37.06	37.06	37.06	37.06	37.06	37.06	37.06	37.06	37.06	37.06
31.22	31.22	31.22	31.22	31.22	31.22	31.22	31.22	31.22	31.22	31.22
5.27	6.02	6.77	7.52	8.27	9.02	9.77	10.52	11.27	12.02	12.77
37.06	37.06	37.06	37.06	37.06	37.06	37.06	37.06	37.06	37.06	37.06
31.22	31.22	31.22	31.22	31.22	31.22	31.22	31.22	31.22	31.22	31.22
5.27	6.02	6.77	7.52	8.27	9.02	9.77	10.52	11.27	12.02	12.77
37.06	37.06	37.06	37.06	37.06	37.06	37.06	37.06	37.06	37.06	37.06
31.22	31.22	31.22	31.22	31.22	31.22	31.22	31.22	31.22	31.22	31.22
5.27	6.02	6.77	7.52	8.27	9.02	9.77	10.52	11.27	12.02	12.77
37.06	37.06	37.06	37.06	37.06	37.06	37.06	37.06	37.06	37.06	37.06
31.22	31.22	31.22	31.22	31.22	31.22	31.22	31.22	31.22	31.22	31.22
5.27	6.02	6.77	7.52	8.27	9.02	9.77	10.52	11.27	12.02	12.77
37.06	37.06	37.06	37.06	37.06	37.06	37.06	37.06	37.06	37.06	37.06
31.22	31.22	31.22	31.22	31.22	31.22	31.22	31.22	31.22	31.22	31.22
5.27	6.02	6.77	7.52	8.27	9.02	9.77	10.52	11.27	12.02	12.77
37.06	37.06	37.06	37.06	37.06	37.06	37.06	37.06	37.06	37.06	37.06
31.22	31.22	31.22	31.22	31.22	31.22	31.22	31.22	31.22	31.22	31.22
5.27	6.02	6.77	7.52	8.27	9.02	9.77	10.52	11.27	12.02	12.77
37.06	37.06	37.06	37.06	37.06	37.06	37.06	37.06	37.06	37.06	37.06
31.22	31.22	31.22	31.22	31.22	31.22	31.22	31.22	31.22	31.22	31.22
5.27	6.02	6.77	7.52	8.27	9.02	9.77	10.52	11.27	12.02	12.77
37.06	37.06	37.06	37.06	37.06	37.06	37.06	37.06	37.06	37.06	37.06
31.22	31.22	31.22	31.22	31.22	31.22	31.22	31.22	31.22	31.22	31.22
5.27	6.02	6.77	7.52	8.27	9.02	9.77	10.52	11.27	12.02	12.77
37.06	37.06	37.06	37.06	37.06	37.06	37.06	37.06	37.06	37.06	37.06
31.22	31.22	31.22	31.22	31.22	31.22	31.22	31.22	31.22	31.22	31.22
5.27	6.02	6.77	7.52	8.27	9.02	9.77	10.52	11.27	12.02	12.77
37.06	37.06	37.06	37.06	37.06	37.06	37.06	37.06	37.06	37.06	37.06
31.22	31.22	31.22	31.22	31.22	31.22	31.22	31.22	31.22	31.22	31.22
5.27	6.02	6.77	7.52	8.27	9.02	9.77	10.52	11.27	12.02	12.77
37.06	37.06	37.06	37.06	37.06	37.06	37.06	37.06	37.06	37.06	37.06
31.22	31.22	31.22	31.22	31.22	31.22	31.22	31.22	31.22	31.22	31.22
5.27	6.02	6.77	7.52	8.27	9.02	9.77	10.52	11.27	12.02	12.77
37.06	37.06	37.06	37.06	37.06	37.06	37.06	37.06	37.06	37.06	37.06
31.22	31.22	31.22	31.22	31.22	31.22	31.22	31.22	31.22	31.22	31.22
5.27	6.02	6.77	7.52	8.27	9.02	9.77	10.52	11.27	12.02	12.77
37.06	37.06	37.06	37.06	37.06	37.06	37.06	37.06	37.06	37.06	37.06
31.22	31.22	31.22	31.22	31.22	31.22	31.22	31.22	31.22	31.22	31.22
5.27	6.02	6.77	7.52	8.27	9.02	9.77	10.52	11.27	12.02	12.77
37.06	37.06	37.06	37.06	37.06	37.06	37.06	37.06	37.06	37.06	37.06
31.22	31.22	31.22	31.22	31.22	31.22	31.22	31.22	31.22	31.22	31.22
5.27	6.02	6.77	7.52	8.27	9.02	9.77	10.52	11.27	12.02	12.77
37.06	37.06	37.06	37.06	37.06	37.06	37.06	37.06	37.06	37.06	37.06
31.22	31.22	31.22	31.22	31.22						



No.

Fit St

So.

cut stakes 1/12 Hatch  
1/12 Moore  
Hall

59

W. LINE DALE ST

251.25 251.00 250.40 250.50 249.85 250.00 250.25

257.82 HJ 57.25 57.25 47.63 46.63 / 2011 1311 / 100.3 37.3-3  
177.9 8.57 8.57 10.14 11.74 14.63 3.21 9.21  
276.54 10.8 10.8 11.92 14.0 60.4 15.2  
270 0.20 -1.76 0.0 +2.17 =6.0

249.46 249.21 248.61 248.71 248.01 248.21 248.46

043744H 36.25 35.25  
1249 1349  
1909 1539  
34 -2.1  
24409 Ban in SW 1/4 Dale  
10.62  
254.71 250.0 251.01 47.43 46.43 / 4386 4286 / 40.48 37.9 /  
47.2 4.71 1.34 4.87 5.87 8.44 9.44 12.00

247.68 247.43 246.83 246.93 246.28 246.43 246.68

249.98 26.0 25.0 34.0 32.0  
232 4.0 5.0 7.0 7.0  
225.0  
275.0  
237.52  
237.52  
242.12

245.89 245.64 245.04 245.14 244.49 244.64 244.89

289.50 HJ  
1.51  
249.24 57.0 50.0 50.0 49.50 50.0 / 4743 4633 4493 4623 4663  
876 85.0 70.0 70.0 96.0 95.0 / 1201 1201 1267 1322 1407  
245.54  
1.50 22.86 22.26 22.26 22.71 22.66 / 2027 2068 2078 2073 2038  
23.68 4.59 5.19 5.07 5.4 5.58 8.17 8.77 5.67 9.32 9.17  
237.54

244.11 243.86 243.26 243.36 242.71 242.86 243.11

237.32  
23.4 23.5 24.10 / 32.0 34.7 24.5 20.85 22.0  
1.72 2.12 3.02 3.1 2.74 2.2 3.27 4.22

242.26 242.01 241.41 241.51 240.92 241.01 241.26

257.50 HJ 57.50 57.50 46.63 46.63 46.63 37.06 37.06 37.06 37.06 all stakes  
12.27 50.25 47.63 43.11 40.53 35.25 24.27 24.27 24.25  
244.61 7.25 9.82 3.87 6.04 11.43 2.81 2.81 2.81 7  
2.09 7.50 10.47 3.82 6.00 11.68 1.06 2.06 3.06 107  
246.67 HJ 2.65 10.67 3.97 7.00 11.93 1.66 3.06 3.06 112  
22.52 7.00 10.57 3.32 6.92 11.78 2.96 3.96 4.21  
11.57 7.10 11.23 3.42 7.55 11.28 2.81 3.81 3.81  
237.06 HJ 6.25 10.82 2.57 7.15 10.43 3.06 4.06 4.06  
6.50 11.07 2.22 7.00 10.68

238.75 238.50 237.90 238.00 237.35 237.50 237.75

258.04 HJ 57.00 50.00 1-45.0 49.65 40.00  
11.42 7.04 7.04 7.04 8.0 8.0  
246.61 43.86 43.86 43.86 42.71 42.86  
1.42 4.17 4.17 4.27 5.27 5.17  
258.03 36.00 35.40 25.00 34.85 30.00  
13 12.03 12.63 14.5 15.18 5.03  
1.00

236.96 236.71 236.11 236.21 235.56 235.71 235.96

232.03  
9-18-12 checked OK blange

236.25 236.00 235.40 235.50 234.85 235.00 235.25

F. Line 29th St

236.00 236.00 235.07 235.17 234.52 235.00 235.00

234.50 234.50 234.73 234.83 234.18 233.50 234.40

234.00 234.00 234.40 234.50 233.85 233.00 234.00

234.10 233.50 234.07 234.17 233.52 232.50 233.10

234.00 234.00 233.73 233.83 233.18 233.00 233.00

234.25 234.00 233.40 233.50 232.85 233.00 233.25



No

FIR ST.

So.

W. Line 30th St.

00 268.25 268.00 267.40 267.50 266.85 267.00 267.25

25 267.50 267.25 266.65 266.75 266.10 266.25 266.50

50 266.75 266.50 265.90 266.00 265.35 265.50 265.75

75 266.00 265.75 265.15 265.25 264.60 264.75 265.00

100 265.25 265.00 264.40 264.50 263.85 264.00 264.25

125 262.25 262.00 261.40 261.50 260.85 261.00 261.25

150 259.25 259.00 258.40 258.50 257.85 258.00 258.25

175 256.25 256.00 255.40 255.50 254.85 255.00 255.25

200 253.25 253.00 252.40 252.50 251.85 252.00 252.25

E. Line DALE ST.

Cut Stakes 1/2 Hatch 1/2 Moore Hall 60

267.90 Stake N.W. Cor 672.6 672.5 / 667.5 657.5 / 652.5 622.5 / 572.0 572.0  
1.45 1.13 2.03 3.63 4.13 5.13 10.13 11.13  
269.35 H 582.5 572.5 7.0 20.3 12.3 3.3 3.3 4.70 6.57 7.53  
11.81 4.71 6.7 1.37 5.67  
257.67 7.02 -0.1  
267.92 H 680.6 674.6 67.5 668.5 670 / 665 659 660 653.5 658  
271.97 H 650 649 645 635 630 / 620 582 575 575 580  
267.90 647 781.74 812 797 1967 1827 1817 1812 1847  
268.49 H 530 522 525 51.85 520 all stakes 1/2 N.W.  
268.25 650 710 7.9 765 7.50  
268.25  
259.50

268.08 B.M. S.E. COR SPA 22.40 69.53 69.53 69.53 57.50  
-9.32 67.20 65.75 65.25 58.25 43.15  
272.90 H 1.15 4.25  
268.08 1.00 3.78 4.29 11.28 4.50  
1.95 4.03 4.53 11.53 5.10  
269.53 H 4.92 4.78 5.13 11.68 5.00  
12.70 3.53 5.03 11.03 5.65  
256.63 5.58 3.63 5.68 11.13 5.75  
0.57 5.15 2.78 5.28 10.23 5.50  
257.50 H 3.23 5.53 10.53

7/11 all stakes complete except property Evans Hall

672.6 672.5 / 667.5 657.5 / 652.5 622.5 / 572.0 572.0  
1.13 2.03 3.63 4.13 5.13 10.13 11.13  
7.0 20.3 12.3 3.3 3.3 4.70 6.57 7.53  
4.71 6.7 1.37 5.67  
7.02 -0.1  
680.6 674.6 67.5 668.5 670 / 665 659 660 653.5 658  
647 781.74 812 797 1967 1827 1817 1812 1847  
530 522 525 51.85 520 all stakes 1/2 N.W.  
650 710 7.9 765 7.50

268.08 672.6 674.0 675.1 668.5 670 / 670 640 640 1385 1400  
296 304 364 314 419 404 615 664 64 717 700  
271.04

258.04 520 520 520 51.85 520  
584 264 530 1.15 6.89

9-18-12 checked OK Blanche 7th + Stone



No. *Fix St.* So.

*We Line Form*

218 262.25 262.00 261.40 261.50 260.85 261.00 261.25

100 263.16 262.91 262.31 262.41 261.76 261.91 262.16

178 264.44 264.19 263.59 263.69 263.04 263.19 263.44

150 265.71 265.46 264.86 264.96 264.31 264.46 264.71

125 266.98 266.73 266.13 266.23 265.58 265.73 265.98

100 268.25 268.00 267.40 267.50 266.85 267.00 267.25  
*Break .25*

125 268.50 268.25 267.65 267.75 267.10 267.25 267.50

50 268.75 268.50 267.90 268.00 267.35 267.50 267.75

25 269.00 268.75 268.15 268.25 267.60 267.75 268.00

25 269.25 269.00 268.40 268.50 267.85 268.00 268.25  
*E. Line 30<sup>th</sup> St.*

cut stakes <sup>1/2</sup> H <sub>1/2</sub> M <sub>1/2</sub> H 61

26790 6925 6325 / 6175 6775 / 6325 6720 / 6571 6471  
 542 462 442 512 462 562 716 516  
 322 462 332 492 362 502 466 656  
 272.874 +02 00 +02 +02 +1.0 +46 12.00 +1.3

6316 6216 6225 6125  
 271 1071 10 62 11.62  
 418 1141 10 02 13  
 +8.58 -07 00 -1.38

26790 6808 *Box* 6800 6800 6850 6850 7260 7260  
 575 583 483 532 632 632 583  
 72.83 190 184 185 6755 630 655 679 680 6785 675  
 1297 357 347 412 397 397 407 397 462 447

26700 650 674 675 6685 670 6526 656 696 643 649  
 107 397 457 447 512 497 651 711 701 746 751  
 271.97 H 6391 6331 6241 6176 6191 6206 614 615 6055 610  
 9.26 9.66 9.56 10.31 10.06 9.97 10.57 10.97 11.12 10.97  
 all stakes <sup>1/2</sup> H <sub>1/2</sub> M

272.40 H 72.40 72.40 72.40 72.40 72.40 72.40 9/16 all stakes  
 65.25 65.75 67.25 65.71 67.16 67.25 11/16  
 4.15 3.65 5.15 6.69 10.24 10.15  
 4.40 3.90 5.40 6.94 10.49 10.40  
 4.65 4.50 5.55 7.09 10.64 11.00  
 3.90 4.40 4.90 7.54 9.89 10.90  
 4.00 5.05 5.00 7.44 9.89 10.90  
 3.15 4.65 4.15 5.09 10.09 11.55  
 3.40 4.90 4.40 7.69 9.44 11.15  
 3.40 4.90 4.40 7.69 9.44 11.40

26808 *Box* 6900 6840 6850 6855 6800 6800 6840 6710 6685 6700  
 565 571 531 540 592 571 571 631 641 684 671  
 273.11  
 273.44  
 268.25  
 1.25  
 270.02 6296 6140 6150 6285 6100  
 6.00 8.00 8.10 9.15 9.00

9-18-12 *checked OK blank*







29<sup>th</sup>

St.

30<sup>th</sup>

St.

221.0

220.0

239.0

237.0

St.

St.

209.0

208.0

237.0

234.0

GRABADA

St.

DALE

St.

209.0

208.0

236.0

234.0

DATE

DATE

211.0

211.0

222.0

221.0

28<sup>th</sup>

St.

29<sup>th</sup>

St.

GRABING STOPS FETE 220<sup>th</sup> line  
236.0 235.0

St.

220

239.0

237.0

DATE

30<sup>th</sup>

St.



GRADES ON  
HENRICK AVE  
RICHMOND WEST.

W. Richmond on S. N.L.

v ✓ ✓ N<sup>+0.9</sup> 299.95

50' W +15 296.89

100' ✓ +11 296.98

150' ✓ +0.8 295.16

200' ✓ -22 294.29

209.3' on N. -51 294.13

210.5' -5

290' W break 292.75

3.06 S.L.

v 298.75

v 298.27<sup>+0.5</sup>

297.32<sup>+0.5</sup>

296.37<sup>+1.0</sup>

295.42<sup>+1.3</sup>

294.47<sup>-1.1</sup>

294.27<sup>-2.8</sup>

292.75

298.48  
2.5  
301.03

298.48  
3.0  
301.48

S 298.27

2.8  
2.3  
+0.5

N 297.75

3.3  
2.6  
+0.7

297.22

3.7  
3.2  
+0.5

296.34

4.7  
3.7  
+1.0

295.42

5.6  
5.3  
+0.3

294.47

6.6  
5.3  
-1.7

294.48

6.5  
5.2  
-1.3

294.65  
6.4

19.5  
2.0  
37.00

64

N 297.75

4.2  
3.9  
+0.7

296.89

4.2  
2.7  
+1.5

296.02

5.0  
3.9  
+1.1

295.16

5.9  
5.4  
+0.5

294.47

6.8  
5.0  
-2.2

294.13

6.7  
5.0  
-1.7

ob stakes 298.27

3.08  
3.37  
50.27

297.95

3.63  
3.51  
4.40

297.09

4.51  
4.47  
4.00

296.20

5.87  
5.65  
5.27

295.32

6.26  
6.58  
-0.32

294.48

7.13  
7.50  
-0.37

297.95

5.77  
4.40

295.72

5.86  
5.17

294.83

6.75  
6.17

292.23

7.65  
7.15

292.23

7.65  
7.15

4.40

-0.20

5.17

+0.28

294.83

+0.58

292.23

+0.20



W. Line GRANADA

No.	20925	20920	20840	20850	20786		
110	20935	20910	20850	20856	20788	20800	20825
25	20949	20924	20864	20873	20808	20822	20847
35	20959	20934	20874	20886	20822	20838	20863
60	20983	20958	20888	20916	20856	20876	20901
85	21004	20981	20921	20947	20890	20913	20938
110	21030	21008	20945	20977	20924	20951	20976
135	21054	21029	20969	21008	20958	20988	21013
145	21064	21039	20979	20996	20972	21003	21028
160	21078	21053	20993	21039	20992	21026	21051
180	21102	21077	21017	21069	21026	21063	21088
210	21125	21100	21060	21100	21060	21100	21125

East Line of 28<sup>th</sup> St

cut stakes 1/2 Hatch

2180 H	925	525	757	803	1006	938	1054	1013	1162	1185	1125	1135
	435	535	497	359	422	347	257	272	235	256		
		570	582	185	567	171	733	644	225	43		
		-02	41	-15.0	-1.46		-13.67	-6.25	-17	+0.28	+2.0	
2165 H	825	925	759	813	1006	938	1054	1013	1162	1185	1125	1135
	525	726	693	788	625	713	577					
21167	16.21	16.21	16.21	16.21	16.21	16.21	16.21	16.21	16.21	16.21	16.21	16.21
2162 H	0528	09.59	9.38	10.59	10.88	11.25						
	7.76	6.26	6.03	5.67	5.33	4.96						
	8.21	6.87	7.02	5.72	5.38	5.21						
	16.21	16.21	16.21	16.21	16.21	16.21						
	07.88	8.79	8.92	9.69	10.26	10.60						
	8.36	7.47	7.31	6.52	5.75	5.61						
	16.21	16.21	16.21	16.21	16.21	16.21						
	3.52	3.86	3.47	3.02	2.69	2.60						
	7.71	7.35	6.74	6.13	5.52	5.21						
	16.21	16.21	16.21	16.21	16.21	16.21						
	7.81	8.22	7.21	6.62	6.04	5.71						
		7.87	7.00	6.39	5.72	5.41						
	16.21	16.21	16.21	16.21	16.21	16.21						
	9.25	8.63	10.06	10.13	11.02	11.21						
	7.21	7.52	6.75	6.08	5.19	5.44						
		7.83	6.40	6.33	5.44							

21672							
209107	951	871	947	820	913		
520	456	514	499	547	524		
21427	1100	1060					
	3.37	3.77					

9-21-12 Checked OK through



DATE ST.

No

So

209.25 209.00 208.40 208.50 207.85 208.00 208.25

209.00 209.00 207.75 207.50 207.25 208.00 208.00  
208.00 207.00

208.60 208.43 208.27 208.10 207.93 207.77 207.60

GRANADA

209.00 208.83 208.67 208.50 208.33 208.17 208.00

HVE

208.60 208.43 208.27 208.10 207.93 207.77 207.60

209.0 208.0 209.00 207.75 207.50 207.25 208.00 208.00  
207.0209.25 209.00 208.40 208.50 207.85 208.00 208.25  
60 60 70 80

West Line of Granada

66

Checked OK along

9-11-12



No.

W.L. 29th

ST

Cut stakes 4/21/12 Hatch Moore Hall - Red

67

00	221.25	221.00	220.40	220.50	219.85	220.00	220.25
10	220.69	220.44	219.84	220.22	219.71	220.00	220.25
35	219.33	219.08	218.48	218.79	218.25	218.50	218.75
60	217.97	217.72	217.12	217.35	216.87	217.00	217.25
85	216.61	216.36	215.76	215.92	215.31	215.50	215.75
110	215.24	214.99	214.39	214.49	213.84	214.00	214.25
135	213.88	213.63	213.03	213.06	212.38	212.50	212.75
160	212.52	212.27	211.67	211.63	210.91	211.00	211.25
185	211.15	210.90	210.30	210.20	209.45	209.50	209.75
210	209.79	209.54	208.94	208.77	207.98	208.00	208.25
220	209.25	209.00	208.40	208.50	207.85		

EAST LINE GRANADA

220.40	212.5	202.5	192.2	187.5	16.61	15.75	13.58	12.75	11.5	9.05	9.25	8.25
10.89	4.15	5.15	6.07	6.65	7.79	8.65	10.65	12.5	15.5	18.5	20.5	22.5
213.81	3.20	5.75	6.67	7.41	7.25	8.26	9.65	10.3	11.5	12.5	13.5	14.5
207	2.75	0.58	1.4	0.76	1.54	2.6	2.35	3.24	4.1	5.0	5.9	6.8
2136.0	2.25	20.25	19.2	18.75	16.61	15.75	13.58	12.75	11.5	9.05	9.25	8.25
227.5	7.25	3.25	9.2	17.75	11.25	12.75	10.65	3.75	10.1	9.75	9.75	9.75
212.3	9.25	2.5	Prop. Lines 7/20/12 F.M.H.									
216.5	7.26	8.26										
211.67	17.76	15.76	18.76	18.76	18.76	31.07	31.07	31.07	31.07	31.07	31.07	31.07
2.89	0.85	11.19	11.74	11.61	15.75	19.83	21.25	19.85	20.50	20.40		
218.76	10.81	7.61	6.01	2.15	0.81	11.79	10.07	12.2	10.87	10.87		
10.89	10.76	7.86	6.26	2.40	0.86		10.07					
215.76	9.51	18.76					10.07					
12.31	9.76	9.75	18.76	18.76			11.07					
231.07	9.26	9.26	15.75	15.75								
			4.8	3.01								
			5.13	3.26								
224.38	4.5	228.20	220.40	203.0	219.85	220.00	220.00	220.00	220.00	220.00	220.00	220.00
11.59		3.35	3.95	3.45	4.55	4.35						
212.78	18.08	14.4	18.79	14.4	18.50	16.36	15.76	15.92	15.31	15.50		
2.40	5.27	5.85	8.2	6.40	5.85	7.75	8.39	8.43	9.04	8.8		
215.14	13.63	13.03	12.26	12.28	12.50							
	10.27	11.50	11.29	11.77	11.85							
	10.90	12.20	10.20	9.45	9.50	9.50	8.40	8.30	7.85	8.54		
	4.28	4.88	4.78	5.73	5.68	6.19	6.79	6.69	7.33	7.18		
			9-13-12	1/4	6	blough						
226.36	4.5	210	204.0	201.0	185.5	200						
10.82		5.06	6.2	5.66	6.51	6.56						
215.49		11.26	15.76	15.76	15.51	15.50						
1.23		5.6	1.2	5.0	1.4	1.22						
216.72		9.00	8.40	8.50	7.85	8.50						
		7.72	8.32	8.22	8.17	8.1						

9-21-12 blocked off blough



DATE ST.

No.

So.

East Line of 29th St

222.25 222.00 221.40 221.50 220.85 221.00 221.25

222.00 222.00  
221.00 221.23 221.33 220.68 221.00 221.00  
220.00

221.40 220.75 221.07 221.17 220.52 219.25 220.40

29th

221.50 220.50 220.90 221.00 220.35 219.50 220.50

220.85 220.25 220.73 220.83 220.18 219.25 219.85

220.00 220.00  
221.00 220.57 220.67 220.02 219.00 220.00 220.00221.25 221.00 220.40 220.50 219.85 220.00 220.25  
60 65 70 75 80

68

9-24-12 blocked NE Clump



No. DATE ST. So.

W.L. DALE ST

00 236.25 236.0 235.40 235.00 234.10 234.00 234.25

21 236.12 235.87 235.27 234.87 233.97 233.87 234.22

25 234.58 234.33 233.73 233.35 232.47 232.38 232.63

50 232.91 232.66 232.06 231.71 230.83 230.76 231.00

75 231.25 231.00 230.40 230.06 229.20 229.13 229.38

100 229.58 229.33 228.73 228.41 227.56 227.50 227.25

125 227.91 227.66 227.06 226.77 225.93 225.88 226.13

150 226.25 226.00 225.40 225.12 224.29 224.25 224.50

175 224.58 224.33 223.73 223.48 222.66 222.63 222.88

200 222.91 222.66 222.06 221.83 221.02 221.00 221.25

216 222.25 222.00 221.40 221.50 220.85

East Line of 29<sup>th</sup> Street

20 236.25 236.0 235.40 235.00 234.10 234.00 234.25

21 236.12 235.87 235.27 234.87 233.97 233.87 234.22

25 234.58 234.33 233.73 233.35 232.47 232.38 232.63

50 232.91 232.66 232.06 231.71 230.83 230.76 231.00

75 231.25 231.00 230.40 230.06 229.20 229.13 229.38

100 229.58 229.33 228.73 228.41 227.56 227.50 227.25

125 227.91 227.66 227.06 226.77 225.93 225.88 226.13

150 226.25 226.00 225.40 225.12 224.29 224.25 224.50

175 224.58 224.33 223.73 223.48 222.66 222.63 222.88

200 222.91 222.66 222.06 221.83 221.02 221.00 221.25

216 222.25 222.00 221.40 221.50 220.85

220 222.25 222.00 221.40 221.50 220.85

225 222.25 222.00 221.40 221.50 220.85

230 222.25 222.00 221.40 221.50 220.85

235 222.25 222.00 221.40 221.50 220.85

240 222.25 222.00 221.40 221.50 220.85

245 222.25 222.00 221.40 221.50 220.85

250 222.25 222.00 221.40 221.50 220.85

255 222.25 222.00 221.40 221.50 220.85

260 222.25 222.00 221.40 221.50 220.85

265 222.25 222.00 221.40 221.50 220.85

270 222.25 222.00 221.40 221.50 220.85

275 222.25 222.00 221.40 221.50 220.85

280 222.25 222.00 221.40 221.50 220.85

285 222.25 222.00 221.40 221.50 220.85

290 222.25 222.00 221.40 221.50 220.85

295 222.25 222.00 221.40 221.50 220.85

300 222.25 222.00 221.40 221.50 220.85

305 222.25 222.00 221.40 221.50 220.85

310 222.25 222.00 221.40 221.50 220.85

315 222.25 222.00 221.40 221.50 220.85

320 222.25 222.00 221.40 221.50 220.85

325 222.25 222.00 221.40 221.50 220.85

330 222.25 222.00 221.40 221.50 220.85

335 222.25 222.00 221.40 221.50 220.85

340 222.25 222.00 221.40 221.50 220.85

345 222.25 222.00 221.40 221.50 220.85

350 222.25 222.00 221.40 221.50 220.85

355 222.25 222.00 221.40 221.50 220.85

360 222.25 222.00 221.40 221.50 220.85

365 222.25 222.00 221.40 221.50 220.85

370 222.25 222.00 221.40 221.50 220.85

375 222.25 222.00 221.40 221.50 220.85

380 222.25 222.00 221.40 221.50 220.85

385 222.25 222.00 221.40 221.50 220.85

390 222.25 222.00 221.40 221.50 220.85

395 222.25 222.00 221.40 221.50 220.85

400 222.25 222.00 221.40 221.50 220.85

405 222.25 222.00 221.40 221.50 220.85

410 222.25 222.00 221.40 221.50 220.85

415 222.25 222.00 221.40 221.50 220.85

420 222.25 222.00 221.40 221.50 220.85

425 222.25 222.00 221.40 221.50 220.85

430 222.25 222.00 221.40 221.50 220.85

435 222.25 222.00 221.40 221.50 220.85

440 222.25 222.00 221.40 221.50 220.85

445 222.25 222.00 221.40 221.50 220.85

450 222.25 222.00 221.40 221.50 220.85

455 222.25 222.00 221.40 221.50 220.85

460 222.25 222.00 221.40 221.50 220.85

465 222.25 222.00 221.40 221.50 220.85

470 222.25 222.00 221.40 221.50 220.85

475 222.25 222.00 221.40 221.50 220.85

480 222.25 222.00 221.40 221.50 220.85

485 222.25 222.00 221.40 221.50 220.85

490 222.25 222.00 221.40 221.50 220.85

495 222.25 222.00 221.40 221.50 220.85

500 222.25 222.00 221.40 221.50 220.85

9-21-12 Check'd OK Along



No.

So

W. Line 30th St

00	239.25	239.00	238.40	238.00	237.10	237.00	237.25
105	239.00	238.75	238.15	237.69	236.75	236.62	236.87
150	238.25	238.50	237.90	237.38	236.41	236.25	236.50
175	238.50	238.25	237.65	237.07	236.07	235.87	236.12
100	238.25	238.00	237.4	236.75	235.72	235.50	235.75
125	238.00	237.75	237.15	236.43	235.38	235.13	235.38
150	237.75	237.50	236.90	236.12	235.04	234.75	235.00
175	237.50	237.25	236.65	235.81	234.69	234.37	234.62
200	237.25	237.00	236.40	235.50	234.35	234.00	234.25

F. Line DALE St.

70

cut stakes 1/2 in Hatch

237.99	237.75	237.50	237.25	237.00	236.75	236.50	236.25	236.00	235.75	235.50	235.25	235.00	234.75	234.50	234.25	234.00	233.75	233.50	233.25	233.00	232.75	232.50	232.25	232.00	231.75	231.50	231.25	231.00	230.75	230.50	230.25	230.00	229.75	229.50	229.25	229.00	228.75	228.50	228.25	228.00	227.75	227.50	227.25	227.00	226.75	226.50	226.25	226.00	225.75	225.50	225.25	225.00	224.75	224.50	224.25	224.00	223.75	223.50	223.25	223.00	222.75	222.50	222.25	222.00	221.75	221.50	221.25	221.00	220.75	220.50	220.25	220.00	219.75	219.50	219.25	219.00	218.75	218.50	218.25	218.00	217.75	217.50	217.25	217.00	216.75	216.50	216.25	216.00	215.75	215.50	215.25	215.00	214.75	214.50	214.25	214.00	213.75	213.50	213.25	213.00	212.75	212.50	212.25	212.00	211.75	211.50	211.25	211.00	210.75	210.50	210.25	210.00	209.75	209.50	209.25	209.00	208.75	208.50	208.25	208.00	207.75	207.50	207.25	207.00	206.75	206.50	206.25	206.00	205.75	205.50	205.25	205.00	204.75	204.50	204.25	204.00	203.75	203.50	203.25	203.00	202.75	202.50	202.25	202.00	201.75	201.50	201.25	201.00	200.75	200.50	200.25	200.00	199.75	199.50	199.25	199.00	198.75	198.50	198.25	198.00	197.75	197.50	197.25	197.00	196.75	196.50	196.25	196.00	195.75	195.50	195.25	195.00	194.75	194.50	194.25	194.00	193.75	193.50	193.25	193.00	192.75	192.50	192.25	192.00	191.75	191.50	191.25	191.00	190.75	190.50	190.25	190.00	189.75	189.50	189.25	189.00	188.75	188.50	188.25	188.00	187.75	187.50	187.25	187.00	186.75	186.50	186.25	186.00	185.75	185.50	185.25	185.00	184.75	184.50	184.25	184.00	183.75	183.50	183.25	183.00	182.75	182.50	182.25	182.00	181.75	181.50	181.25	181.00	180.75	180.50	180.25	180.00	179.75	179.50	179.25	179.00	178.75	178.50	178.25	178.00	177.75	177.50	177.25	177.00	176.75	176.50	176.25	176.00	175.75	175.50	175.25	175.00	174.75	174.50	174.25	174.00	173.75	173.50	173.25	173.00	172.75	172.50	172.25	172.00	171.75	171.50	171.25	171.00	170.75	170.50	170.25	170.00	169.75	169.50	169.25	169.00	168.75	168.50	168.25	168.00	167.75	167.50	167.25	167.00	166.75	166.50	166.25	166.00	165.75	165.50	165.25	165.00	164.75	164.50	164.25	164.00	163.75	163.50	163.25	163.00	162.75	162.50	162.25	162.00	161.75	161.50	161.25	161.00	160.75	160.50	160.25	160.00	159.75	159.50	159.25	159.00	158.75	158.50	158.25	158.00	157.75	157.50	157.25	157.00	156.75	156.50	156.25	156.00	155.75	155.50	155.25	155.00	154.75	154.50	154.25	154.00	153.75	153.50	153.25	153.00	152.75	152.50	152.25	152.00	151.75	151.50	151.25	151.00	150.75	150.50	150.25	150.00	149.75	149.50	149.25	149.00	148.75	148.50	148.25	148.00	147.75	147.50	147.25	147.00	146.75	146.50	146.25	146.00	145.75	145.50	145.25	145.00	144.75	144.50	144.25	144.00	143.75	143.50	143.25	143.00	142.75	142.50	142.25	142.00	141.75	141.50	141.25	141.00	140.75	140.50	140.25	140.00	139.75	139.50	139.25	139.00	138.75	138.50	138.25	138.00	137.75	137.50	137.25	137.00	136.75	136.50	136.25	136.00	135.75	135.50	135.25	135.00	134.75	134.50	134.25	134.00	133.75	133.50	133.25	133.00	132.75	132.50	132.25	132.00	131.75	131.50	131.25	131.00	130.75	130.50	130.25	130.00	129.75	129.50	129.25	129.00	128.75	128.50	128.25	128.00	127.75	127.50	127.25	127.00	126.75	126.50	126.25	126.00	125.75	125.50	125.25	125.00	124.75	124.50	124.25	124.00	123.75	123.50	123.25	123.00	122.75	122.50	122.25	122.00	121.75	121.50	121.25	121.00	120.75	120.50	120.25	120.00	119.75	119.50	119.25	119.00	118.75	118.50	118.25	118.00	117.75	117.50	117.25	117.00	116.75	116.50	116.25	116.00	115.75	115.50	115.25	115.00	114.75	114.50	114.25	114.00	113.75	113.50	113.25	113.00	112.75	112.50	112.25	112.00	111.75	111.50	111.25	111.00	110.75	110.50	110.25	110.00	109.75	109.50	109.25	109.00	108.75	108.50	108.25	108.00	107.75	107.50	107.25	107.00	106.75	106.50	106.25	106.00	105.75	105.50	105.25	105.00	104.75	104.50	104.25	104.00	103.75	103.50	103.25	103.00	102.75	102.50	102.25	102.00	101.75	101.50	101.25	101.00	100.75	100.50	100.25	100.00	99.75	99.50	99.25	99.00	98.75	98.50	98.25	98.00	97.75	97.50	97.25	97.00	96.75	96.50	96.25	96.00	95.75	95.50	95.25	95.00	94.75	94.50	94.25	94.00	93.75	93.50	93.25	93.00	92.75	92.50	92.25	92.00	91.75	91.50	91.25	91.00	90.75	90.50	90.25	90.00	89.75	89.50	89.25	89.00	88.75	88.50	88.25	88.00	87.75	87.50	87.25	87.00	86.75	86.50	86.25	86.00	85.75	85.50	85.25	85.00	84.75	84.50	84.25	84.00	83.75	83.50	83.25	83.00	82.75	82.50	82.25	82.00	81.75	81.50	81.25	81.00	80.75	80.50	80.25	80.00	79.75	79.50	79.25	79.00	78.75	78.50	78.25	78.00	77.75	77.50	77.25	77.00	76.75	76.50	76.25	76.00	75.75	75.50	75.25	75.00	74.75	74.50	74.25	74.00	73.75	73.50	73.25	73.00	72.75	72.50	72.25	72.00	71.75	71.50	71.25	71.00	70.75	70.50	70.25	70.00	69.75	69.50	69.25	69.00	68.75	68.50	68.25	68.00	67.75	67.50	67.25	67.00	66.75	66.50	66.25	66.00	65.75	65.50	65.25	65.00	64.75	64.50	64.25	64.00	63.75	63.50	63.25	63.00	62.75	62.50	62.25	62.00	61.75	61.50	61.25	61.00	60.75	60.50	60.25	60.00	59.75	59.50	59.25	59.00	58.75	58.50	58.25	58.00	57.75	57.50	57.25	57.00	56.75	56.50	56.25	56.00	55.75	55.50	55.25	55.00	54.75	54.50	54.25	54.00	53.75	53.50	53.25	53.00	52.75	52.50	52.25	52.00	51.75	51.50	51.25	51.00	50.75	50.50	50.25	50.00	49.75	49.50	49.25	49.00	48.75	48.50	48.25	48.00	47.75	47.50	47.25	47.00	46.75	46.50	46.25	46.00	45.75	45.50	45.25	45.00	44.75	44.50	44.25	44.00	43.75	43.50	43.25	43.00	42.75	42.50	42.25	42.00	41.75	41.50	41.25	41.00	40.75	40.50	40.25	40.00	39.75	39.50	39.25	39.00	38.75	38.50	38.25	38.00	37.75	37.50	37.25	37.00	36.75	36.50	36.25	36.00	35.75	35.50	35.25	35.00	34.75	34.50	34.25	34.00	33.75	33.50	33.25	33.00	32.75	32.50	32.25	32.00	31.75	31.50	31.25	31.00	30.75	30.50	30.25	30.00	29.75	29.50	29.25	29.00	28.75	28.50	28.25	28.00	27.75	27.50	27.25	27.00	26.75	26.50	26.25	26.00	25.75	25.50	25.25	25.00	24.75	24.50	24.25	24.00	23.75	23.50	23.25	23.00	22.75	22.50	22.25	22.00	21.75	21.50	21.25	21.00	20.75	20.50	20.25	20.00	19.75	19.50	19.25	19.00	18.75	18.50	18.25	18.00	17.75	17.50	17.25	17.00	16.75	16.50	16.25	16.00	15.75	15.50	15.25	15.00	14.75	14.50	14.25	14.00	13.75	13.50	13.25	13.00	12.75	12.50	12.25	12.00	11.75	11.50	11.25	11.00	10.75	10.50	10.25	10.00	9.75	9.50	9.25	9.00	8.75	8.50	8.25	8.00	7.75	7.50	7.25	7.00	6.75	6.50	6.25	6.00	5.75	5.50	5.25	5.00	4.75	4.50	4.25	4.00	3.75	3.50	3.25	3.00	2.75	2.50	2.25	2.00	1.75	1.50	1.25	1.00	0.75	0.50	0.25	0.00
--------	--------	--------	--------	--------	--------	--------	--------	--------	--------	--------	--------	--------	--------	--------	--------	--------	--------	--------	--------	--------	--------	--------	--------	--------	--------	--------	--------	--------	--------	--------	--------	--------	--------	--------	--------	--------	--------	--------	--------	--------	--------	--------	--------	--------	--------	--------	--------	--------	--------	--------	--------	--------	--------	--------	--------	--------	--------	--------	--------	--------	--------	--------	--------	--------	--------	--------	--------	--------	--------	--------	--------	--------	--------	--------	--------	--------	--------	--------	--------	--------	--------	--------	--------	--------	--------	--------	--------	--------	--------	--------	--------	--------	--------	--------	--------	--------	--------	--------	--------	--------	--------	--------	--------	--------	--------	--------	--------	--------	--------	--------	--------	--------	--------	--------	--------	--------	--------	--------	--------	--------	--------	--------	--------	--------	--------	--------	--------	--------	--------	--------	--------	--------	--------	--------	--------	--------	--------	--------	--------	--------	--------	--------	--------	--------	--------	--------	--------	--------	--------	--------	--------	--------	--------	--------	--------	--------	--------	--------	--------	--------	--------	--------	--------	--------	--------	--------	--------	--------	--------	--------	--------	--------	--------	--------	--------	--------	--------	--------	--------	--------	--------	--------	--------	--------	--------	--------	--------	--------	--------	--------	--------	--------	--------	--------	--------	--------	--------	--------	--------	--------	--------	--------	--------	--------	--------	--------	--------	--------	--------	--------	--------	--------	--------	--------	--------	--------	--------	--------	--------	--------	--------	--------	--------	--------	--------	--------	--------	--------	--------	--------	--------	--------	--------	--------	--------	--------	--------	--------	--------	--------	--------	--------	--------	--------	--------	--------	--------	--------	--------	--------	--------	--------	--------	--------	--------	--------	--------	--------	--------	--------	--------	--------	--------	--------	--------	--------	--------	--------	--------	--------	--------	--------	--------	--------	--------	--------	--------	--------	--------	--------	--------	--------	--------	--------	--------	--------	--------	--------	--------	--------	--------	--------	--------	--------	--------	--------	--------	--------	--------	--------	--------	--------	--------	--------	--------	--------	--------	--------	--------	--------	--------	--------	--------	--------	--------	--------	--------	--------	--------	--------	--------	--------	--------	--------	--------	--------	--------	--------	--------	--------	--------	--------	--------	--------	--------	--------	--------	--------	--------	--------	--------	--------	--------	--------	--------	--------	--------	--------	--------	--------	--------	--------	--------	--------	--------	--------	--------	--------	--------	--------	--------	--------	--------	--------	--------	--------	--------	--------	--------	--------	--------	--------	--------	--------	--------	--------	--------	--------	--------	--------	--------	--------	--------	--------	--------	--------	--------	--------	--------	--------	--------	--------	--------	--------	--------	--------	--------	--------	--------	--------	--------	--------	--------	--------	--------	--------	--------	--------	--------	--------	--------	--------	--------	--------	--------	--------	--------	--------	--------	--------	--------	--------	--------	--------	--------	--------	--------	--------	--------	--------	--------	--------	--------	--------	--------	--------	--------	--------	--------	--------	--------	--------	--------	--------	--------	--------	--------	--------	--------	--------	--------	--------	--------	--------	--------	--------	--------	--------	--------	--------	--------	--------	--------	--------	--------	--------	--------	--------	--------	--------	--------	--------	--------	--------	--------	--------	--------	--------	--------	--------	--------	--------	--------	--------	--------	--------	--------	--------	--------	--------	--------	--------	--------	--------	--------	--------	--------	--------	--------	--------	--------	--------	--------	--------	--------	--------	--------	--------	--------	--------	--------	--------	--------	--------	--------	--------	--------	--------	--------	--------	--------	--------	--------	--------	--------	--------	--------	--------	--------	--------	--------	--------	--------	--------	--------	--------	--------	--------	--------	--------	--------	--------	--------	--------	--------	--------	--------	--------	--------	--------	--------	--------	-------	-------	-------	-------	-------	-------	-------	-------	-------	-------	-------	-------	-------	-------	-------	-------	-------	-------	-------	-------	-------	-------	-------	-------	-------	-------	-------	-------	-------	-------	-------	-------	-------	-------	-------	-------	-------	-------	-------	-------	-------	-------	-------	-------	-------	-------	-------	-------	-------	-------	-------	-------	-------	-------	-------	-------	-------	-------	-------	-------	-------	-------	-------	-------	-------	-------	-------	-------	-------	-------	-------	-------	-------	-------	-------	-------	-------	-------	-------	-------	-------	-------	-------	-------	-------	-------	-------	-------	-------	-------	-------	-------	-------	-------	-------	-------	-------	-------	-------	-------	-------	-------	-------	-------	-------	-------	-------	-------	-------	-------	-------	-------	-------	-------	-------	-------	-------	-------	-------	-------	-------	-------	-------	-------	-------	-------	-------	-------	-------	-------	-------	-------	-------	-------	-------	-------	-------	-------	-------	-------	-------	-------	-------	-------	-------	-------	-------	-------	-------	-------	-------	-------	-------	-------	-------	-------	-------	-------	-------	-------	-------	-------	-------	-------	-------	-------	-------	-------	-------	-------	-------	-------	-------	-------	-------	-------	-------	-------	-------	-------	-------	-------	-------	-------	-------	-------	-------	-------	-------	-------	-------	-------	-------	-------	-------	-------	-------	-------	-------	-------	-------	-------	-------	-------	-------	-------	-------	-------	-------	-------	-------	-------	-------	-------	-------	-------	-------	-------	-------	-------	-------	-------	-------	-------	-------	-------	-------	-------	-------	-------	-------	-------	-------	-------	-------	-------	-------	-------	-------	-------	-------	-------	-------	-------	-------	-------	-------	-------	-------	-------	-------	-------	-------	-------	-------	-------	-------	-------	-------	-------	-------	-------	-------	-------	-------	-------	-------	-------	-------	-------	-------	-------	-------	-------	-------	-------	-------	-------	-------	-------	-------	-------	-------	-------	-------	-------	-------	-------	-------	-------	-------	-------	-------	-------	-------	-------	-------	-------	-------	-------	-------	-------	-------	-------	-------	-------	-------	-------	-------	-------	-------	-------	-------	-------	-------	-------	-------	-------	-------	-------	-------	-------	-------	-------	-------	-------	-------	-------	-------	-------	-------	-------	-------	-------	-------	-------	-------	-------	-------	-------	-------	-------	-------	-------	-------	-------	-------	-------	-------	-------	-------	-------	-------	-------	-------	-------	-------	-------	-------	-------	------	------	------	------	------	------	------	------	------	------	------	------	------	------	------	------	------	------	------	------	------	------	------	------	------	------	------	------	------	------	------	------	------	------	------	------	------	------	------	------

9-11-12 checked OK Blaylock



No.	DATE	ST.	So.
	Fern		
210	236.25	236.00	235.40 235.50 234.85 235.00 235.25
110	236.53	236.28	235.68 235.73-235.06 235.18 235.43 341 .284 .256 .227
175	236.87	236.62	236.02 236.01 235.31 235.41 235.66
150	237.21	236.96	236.36 236.30 235.57 235.63 235.88
125	237.55	237.30	236.70 236.58 235.82 235.86 236.11
100	237.89	237.64	237.04 236.86 236.08 236.09 236.34
75	238.23	237.98	237.38 237.15 236.34 236.31 236.56
50	238.58	238.33	237.73 237.43 236.59 236.54 236.79
25	238.92	238.67	238.07 237.72 236.85 236.77 237.02
00	239.25	239.00	238.40 238.00 237.10 237.00 237.25

35th Street

cut stakes 7/12 Matt  
Woods  
Lal - Rod

71

Date	236.50	236.25	236.00	235.75	235.50	235.25	235.00	234.75	234.50	234.25	234.00	233.75	233.50	233.25	233.00	232.75	232.50	232.25	232.00	231.75	231.50	231.25	231.00	230.75	230.50	230.25	230.00	229.75	229.50	229.25	229.00	228.75	228.50	228.25	228.00	227.75	227.50	227.25	227.00	226.75	226.50	226.25	226.00	225.75	225.50	225.25	225.00	224.75	224.50	224.25	224.00	223.75	223.50	223.25	223.00	222.75	222.50	222.25	222.00	221.75	221.50	221.25	221.00	220.75	220.50	220.25	220.00	219.75	219.50	219.25	219.00	218.75	218.50	218.25	218.00	217.75	217.50	217.25	217.00	216.75	216.50	216.25	216.00	215.75	215.50	215.25	215.00	214.75	214.50	214.25	214.00	213.75	213.50	213.25	213.00	212.75	212.50	212.25	212.00	211.75	211.50	211.25	211.00	210.75	210.50	210.25	210.00	209.75	209.50	209.25	209.00	208.75	208.50	208.25	208.00	207.75	207.50	207.25	207.00	206.75	206.50	206.25	206.00	205.75	205.50	205.25	205.00	204.75	204.50	204.25	204.00	203.75	203.50	203.25	203.00	202.75	202.50	202.25	202.00	201.75	201.50	201.25	201.00	200.75	200.50	200.25	200.00	199.75	199.50	199.25	199.00	198.75	198.50	198.25	198.00	197.75	197.50	197.25	197.00	196.75	196.50	196.25	196.00	195.75	195.50	195.25	195.00	194.75	194.50	194.25	194.00	193.75	193.50	193.25	193.00	192.75	192.50	192.25	192.00	191.75	191.50	191.25	191.00	190.75	190.50	190.25	190.00	189.75	189.50	189.25	189.00	188.75	188.50	188.25	188.00	187.75	187.50	187.25	187.00	186.75	186.50	186.25	186.00	185.75	185.50	185.25	185.00	184.75	184.50	184.25	184.00	183.75	183.50	183.25	183.00	182.75	182.50	182.25	182.00	181.75	181.50	181.25	181.00	180.75	180.50	180.25	180.00	179.75	179.50	179.25	179.00	178.75	178.50	178.25	178.00	177.75	177.50	177.25	177.00	176.75	176.50	176.25	176.00	175.75	175.50	175.25	175.00	174.75	174.50	174.25	174.00	173.75	173.50	173.25	173.00	172.75	172.50	172.25	172.00	171.75	171.50	171.25	171.00	170.75	170.50	170.25	170.00	169.75	169.50	169.25	169.00	168.75	168.50	168.25	168.00	167.75	167.50	167.25	167.00	166.75	166.50	166.25	166.00	165.75	165.50	165.25	165.00	164.75	164.50	164.25	164.00	163.75	163.50	163.25	163.00	162.75	162.50	162.25	162.00	161.75	161.50	161.25	161.00	160.75	160.50	160.25	160.00	159.75	159.50	159.25	159.00	158.75	158.50	158.25	158.00	157.75	157.50	157.25	157.00	156.75	156.50	156.25	156.00	155.75	155.50	155.25	155.00	154.75	154.50	154.25	154.00	153.75	153.50	153.25	153.00	152.75	152.50	152.25	152.00	151.75	151.50	151.25	151.00	150.75	150.50	150.25	150.00	149.75	149.50	149.25	149.00	148.75	148.50	148.25	148.00	147.75	147.50	147.25	147.00	146.75	146.50	146.25	146.00	145.75	145.50	145.25	145.00	144.75	144.50	144.25	144.00	143.75	143.50	143.25	143.00	142.75	142.50	142.25	142.00	141.75	141.50	141.25	141.00	140.75	140.50	140.25	140.00	139.75	139.50	139.25	139.00	138.75	138.50	138.25	138.00	137.75	137.50	137.25	137.00	136.75	136.50	136.25	136.00	135.75	135.50	135.25	135.00	134.75	134.50	134.25	134.00	133.75	133.50	133.25	133.00	132.75	132.50	132.25	132.00	131.75	131.50	131.25	131.00	130.75	130.50	130.25	130.00	129.75	129.50	129.25	129.00	128.75	128.50	128.25	128.00	127.75	127.50	127.25	127.00	126.75	126.50	126.25	126.00	125.75	125.50	125.25	125.00	124.75	124.50	124.25	124.00	123.75	123.50	123.25	123.00	122.75	122.50	122.25	122.00	121.75	121.50	121.25	121.00	120.75	120.50	120.25	120.00	119.75	119.50	119.25	119.00	118.75	118.50	118.25	118.00	117.75	117.50	117.25	117.00	116.75	116.50	116.25	116.00	115.75	115.50	115.25	115.00	114.75	114.50	114.25	114.00	113.75	113.50	113.25	113.00	112.75	112.50	112.25	112.00	111.75	111.50	111.25	111.00	110.75	110.50	110.25	110.00	109.75	109.50	109.25	109.00	108.75	108.50	108.25	108.00	107.75	107.50	107.25	107.00	106.75	106.50	106.25	106.00	105.75	105.50	105.25	105.00	104.75	104.50	104.25	104.00	103.75	103.50	103.25	103.00	102.75	102.50	102.25	102.00	101.75	101.50	101.25	101.00	100.75	100.50	100.25	100.00	99.75	99.50	99.25	99.00	98.75	98.50	98.25	98.00	97.75	97.50	97.25	97.00	96.75	96.50	96.25	96.00	95.75	95.50	95.25	95.00	94.75	94.50	94.25	94.00	93.75	93.50	93.25	93.00	92.75	92.50	92.25	92.00	91.75	91.50	91.25	91.00	90.75	90.50	90.25	90.00	89.75	89.50	89.25	89.00	88.75	88.50	88.25	88.00	87.75	87.50	87.25	87.00	86.75	86.50	86.25	86.00	85.75	85.50	85.25	85.00	84.75	84.50	84.25	84.00	83.75	83.50	83.25	83.00	82.75	82.50	82.25	82.00	81.75	81.50	81.25	81.00	80.75	80.50	80.25	80.00	79.75	79.50	79.25	79.00	78.75	78.50	78.25	78.00	77.75	77.50	77.25	77.00	76.75	76.50	76.25	76.00	75.75	75.50	75.25	75.00	74.75	74.50	74.25	74.00	73.75	73.50	73.25	73.00	72.75	72.50	72.25	72.00	71.75	71.50	71.25	71.00	70.75	70.50	70.25	70.00	69.75	69.50	69.25	69.00	68.75	68.50	68.25	68.00	67.75	67.50	67.25	67.00	66.75	66.50	66.25	66.00	65.75	65.50	65.25	65.00	64.75	64.50	64.25	64.00	63.75	63.50	63.25	63.00	62.75	62.50	62.25	62.00	61.75	61.50	61.25	61.00	60.75	60.50	60.25	60.00	59.75	59.50	59.25	59.00	58.75	58.50	58.25	58.00	57.75	57.50	57.25	57.00	56.75	56.50	56.25	56.00	55.75	55.50	55.25	55.00	54.75	54.50	54.25	54.00	53.75	53.50	53.25	53.00	52.75	52.50	52.25	52.00	51.75	51.50	51.25	51.00	50.75	50.50	50.25	50.00	49.75	49.50	49.25	49.00	48.75	48.50	48.25	48.00	47.75	47.50	47.25	47.00	46.75	46.50	46.25	46.00	45.75	45.50	45.25	45.00	44.75	44.50	44.25	44.00	43.75	43.50	43.25	43.00	42.75	42.50	42.25	42.00	41.75	41.50	41.25	41.00	40.75	40.50	40.25	40.00	39.75	39.50	39.25	39.00	38.75	38.50	38.25	38.00	37.75	37.50	37.25	37.00	36.75	36.50	36.25	36.00	35.75	35.50	35.25	35.00	34.75	34.50	34.25	34.00	33.75	33.50	33.25	33.00	32.75	32.50	32.25	32.00	31.75	31.50	31.25	31.00	30.75	30.50	30.25	30.00	29.75	29.50	29.25	29.00	28.75	28.50	28.25	28.00	27.75	27.50	27.25	27.00	26.75	26.50	26.25	26.00	25.75	25.50	25.25	25.00	24.75	24.50	24.25	24.00	23.75	23.50	23.25	23.00	22.75	22.50	22.25	22.00	21.75	21.50	21.25	21.00	20.75	20.50	20.25	20.00	19.75	19.50	19.25	19.00	18.75	18.50	18.25	18.00	17.75	17.50	17.25	17.00	16.75	16.50	16.25	16.00	15.75	15.50	15.25	15.00	14.75	14.50	14.25	14.00	13.75	13.50	13.25	13.00	12.75	12.50	12.25	12.00	11.75	11.50	11.25	11.00	10.75	10.50	10.25	10.00	9.75	9.50	9.25	9.00	8.75	8.50	8.25	8.00	7.75	7.50	7.25	7.00	6.75	6.50	6.25	6.00	5.75	5.50	5.25	5.00	4.75	4.50	4.25	4.00	3.75	3.50	3.25	3.00	2.75	2.50	2.25	2.00	1.75	1.50	1.25	1.00	0.75	0.50	0.25	0.00
236.50	236.25	236.00	235.75	235.50	235.25	235.00	234.75	234.50	234.25	234.00	233.75	233.50	233.25	233.00	232.75	232.50	232.25	232.00	231.75	231.50	231.25	231.00	230.75	230.50	230.25	230.00	229.75	229.50	229.25	229.00	228.75	228.50	228.2																																																																																																																																																																																																																																																																																																																																																																																																																																																																																																																																																																																																																																																																																																																																																																																																																																																																																																																																																		







GRANADA AVE 30<sup>th</sup> St.

339.0

338.0

340.0

339.0

St

St

340.0

339.5

341.0

340.0

UTAH

St. KANSAS

St.

340.5

340.0

341.0

340.0

LANDIS

LANDIS

341.5

341.0

339.5

338.5

Idaho

St GRANADA

St.







No.

LANDIS ST.

So.

75

W. L. BRANADA AVE

100 339.25 339.00 338.40 338.50 338.85 338.00 338.25

75 339.37 339.12 338.52 338.66 338.02 338.19 338.44

50 339.50 339.25 338.65 338.81 338.19 338.37 338.62

25 339.62 339.37 338.77 338.97 338.36 338.56 338.81

100 339.75 339.50 338.90 339.12 338.53 338.75 339.00

75 339.87 339.62 339.02 339.28 338.71 338.94 339.19

50 339.00 339.75 339.15 339.44 338.88 339.12 339.37

25 340.12 339.87 339.27 339.59 339.05 339.31 339.56

100 340.25 340.00 339.40 339.75 339.22 339.50 339.75

E. L. UTAH ST.



No

Landis St.

So

76

339.75 339.50 338.90 339.00 338.35 338.50 338.75

338.50 339.50  
338.5 338.81 338.91 338.26 338.50 338.50  
337.50

338.90 338.38 338.73 338.83 338.18 337.38 337.90

GRANADA

339.25 338.25 338.65 338.75 338.10 337.25 338.15

Five

338.85 338.12 338.57 338.67 338.02 337.12 337.85

339.00 338.0  
339.00 338.49 338.59 337.94 338.00 338.00

339.25 339.00 338.40 338.50 337.25 338.00 338.25



No.

LANDIS ST.

So.

W. Line KANSAS

341.25 341.00 340.40 340.50 339.85 340.00 340.25

341.06 340.81 340.21 340.31 339.66 339.81 340.06

340.87 340.62 340.02 340.12 339.47 339.62 339.87

340.69 340.44 339.84 339.94 339.29 339.44 339.69

340.50 340.25 339.65 339.75 339.10 339.25 339.50

340.31 340.06 339.46 339.56 338.91 339.06 339.31

340.12 339.87 339.27 339.37 338.72 338.87 339.12

339.94 339.69 339.09 339.19 338.54 338.69 338.94

339.75 339.50 338.90 339.00 338.35 338.50 338.75

E. Line GRANADA

77



No.

LANDIS ST.

So.

78

125 W. Line / 30th ST

10	340.25	340.00	339.40	339.50	338.85	339.00	339.25
25	340.37	340.12	339.52	339.62	338.97	339.12	339.37
40	340.50	340.25	339.65	339.75	339.10	339.25	339.50
55	340.62	340.37	339.77	339.87	339.22	339.37	339.62
70	340.75	340.50	339.90	340.00	339.35	339.50	339.75
85	340.87	340.62	340.02	340.12	339.47	339.62	339.87
100	340.00	340.75	340.15	340.25	339.60	339.75	340.00
115	341.12	340.87	340.27	340.37	339.72	339.87	340.12
130	341.25	341.00	340.40	340.50	339.85	340.00	340.25

E. L. HANSH'S ST.







Published by H. S. CROCKER COMPANY, Stationers, Drawing Materials, and Mathematical Instruments, San Francisco.

Table showing the difference of latitude and departure in running 80 chains at any course from 1 to 60 minutes.

MINUTES.	LKS.	MINUTES.	LKS.	MINUTES.	LKS.
1.....	2 $\frac{1}{2}$	21.....	49	41.....	95 $\frac{1}{2}$
2.....	4 $\frac{1}{2}$	22.....	51 $\frac{1}{2}$	42.....	98
3.....	7	23.....	53 $\frac{1}{2}$	43.....	100 $\frac{1}{2}$
4.....	9 $\frac{1}{2}$	24.....	56	44.....	102 $\frac{1}{2}$
5.....	11 $\frac{1}{2}$	25.....	58 $\frac{1}{2}$	45.....	105
6.....	14	26.....	60 $\frac{1}{2}$	46.....	107 $\frac{1}{2}$
7.....	16 $\frac{1}{2}$	27.....	63	47.....	109 $\frac{1}{2}$
8.....	18 $\frac{1}{2}$	28.....	65 $\frac{1}{2}$	48.....	112
9.....	21	29.....	67 $\frac{1}{2}$	49.....	114 $\frac{1}{2}$
10.....	23 $\frac{1}{2}$	30.....	70	50.....	116 $\frac{1}{2}$
11.....	25 $\frac{1}{2}$	31.....	72 $\frac{1}{2}$	51.....	119
12.....	28	32.....	74 $\frac{1}{2}$	52.....	121 $\frac{1}{2}$
13.....	30 $\frac{1}{2}$	33.....	77	53.....	123 $\frac{1}{2}$
14.....	32 $\frac{1}{2}$	34.....	79 $\frac{1}{2}$	54.....	126
15.....	35	35.....	81 $\frac{1}{2}$	55.....	128 $\frac{1}{2}$
16.....	37 $\frac{1}{2}$	36.....	84	56.....	130 $\frac{1}{2}$
17.....	39 $\frac{1}{2}$	37.....	86 $\frac{1}{2}$	57.....	133
18.....	42	38.....	88 $\frac{1}{2}$	58.....	135 $\frac{1}{2}$
19.....	44 $\frac{1}{2}$	39.....	91	59.....	137 $\frac{1}{2}$
20.....	46 $\frac{1}{2}$	40.....	93 $\frac{1}{2}$	60.....	140

TABLE FOR RUNNING ON SLOPES.

In the following table the first column shows the angle, the second the number of links to be added to a chain on the slopes, to make one chain, horizontal measurement.

ANGLE	COR. IN LINKS	ANGLE	COR. IN LINKS	ANGLE	COR. IN LINKS	ANGLE	COR. IN LINKS
0		0		0		0	
4	0.24	11	1.88	18	5.14	25	10.54
5	0.38	12	2.24	19	5.76	26	11.26
6	0.55	13	2.63	20	6.42	27	12.24
7	0.76	14	3.06	21	7.11	28	13.37
8	0.98	15	3.53	22	7.85	29	14.34
9	1.24	16	4.02	23	8.64	30	15.47
10	1.55	17	4.56	24	9.47	35	22.07

Handwritten survey notes and calculations on the left page of the notebook. The page is filled with various numbers, lines, and text, including:

- State names: Idaho, Utah, Nevada, Kansas
- Survey points and bearings: 34.616, 2.87, 343.81, 372.81, 2.93, 391.88, 337.01, 39.97, 33.20, 6.47, 71.80, 42.98, 57.4.6.6, 236.83, 48.07, 40.91, 2.60, 5.27, 5.11, 5.22, 5.19, 5.22, 341.40, 340.18, 297.45, .98, 298.43
- Geometric diagrams: Several rectangular plots with lines and points, some labeled with numbers like 70, 49, 36, 286, 285, 288, 289, 290, 291, 292, 293, 294, 295, 296, 297, 298, 299, 300, 301, 302, 303, 304, 305, 306, 307, 308, 309, 310, 311, 312, 313, 314, 315, 316, 317, 318, 319, 320, 321, 322, 323, 324, 325, 326, 327, 328, 329, 330, 331, 332, 333, 334, 335, 336, 337, 338, 339, 340, 341, 342, 343, 344, 345, 346, 347, 348, 349, 350, 351, 352, 353, 354, 355, 356, 357, 358, 359, 360, 361, 362, 363, 364, 365, 366, 367, 368, 369, 370, 371, 372, 373, 374, 375, 376, 377, 378, 379, 380, 381, 382, 383, 384, 385, 386, 387, 388, 389, 390, 391, 392, 393, 394, 395, 396, 397, 398, 399, 400, 401, 402, 403, 404, 405, 406, 407, 408, 409, 410, 411, 412, 413, 414, 415, 416, 417, 418, 419, 420, 421, 422, 423, 424, 425, 426, 427, 428, 429, 430, 431, 432, 433, 434, 435, 436, 437, 438, 439, 440, 441, 442, 443, 444, 445, 446, 447, 448, 449, 450, 451, 452, 453, 454, 455, 456, 457, 458, 459, 460, 461, 462, 463, 464, 465, 466, 467, 468, 469, 470, 471, 472, 473, 474, 475, 476, 477, 478, 479, 480, 481, 482, 483, 484, 485, 486, 487, 488, 489, 490, 491, 492, 493, 494, 495, 496, 497, 498, 499, 500, 501, 502, 503, 504, 505, 506, 507, 508, 509, 510, 511, 512, 513, 514, 515, 516, 517, 518, 519, 520, 521, 522, 523, 524, 525, 526, 527, 528, 529, 530, 531, 532, 533, 534, 535, 536, 537, 538, 539, 540, 541, 542, 543, 544, 545, 546, 547, 548, 549, 550, 551, 552, 553, 554, 555, 556, 557, 558, 559, 560, 561, 562, 563, 564, 565, 566, 567, 568, 569, 570, 571, 572, 573, 574, 575, 576, 577, 578, 579, 580, 581, 582, 583, 584, 585, 586, 587, 588, 589, 590, 591, 592, 593, 594, 595, 596, 597, 598, 599, 600