

MB 118

MICROFILMED
JAN 8 1965

MB 118

THIS BOOK INDEXED
2/7/62

INDEX

B.L. + X-loc in SFLY ACER M. 13 1-13
N 1116⁴⁰⁰ 1117⁴⁰⁰ 1118⁴⁰⁰
SOUND ELY SANTA CLARA - 1116⁴⁵⁰ 1117⁴⁵⁰ 13-20

ALLEN
BLUNT & POWELL
STANOLEY
BADDY-

BASE LINE FOR X-SEC IN SELV SECTION

CONT ON FACING PAGE

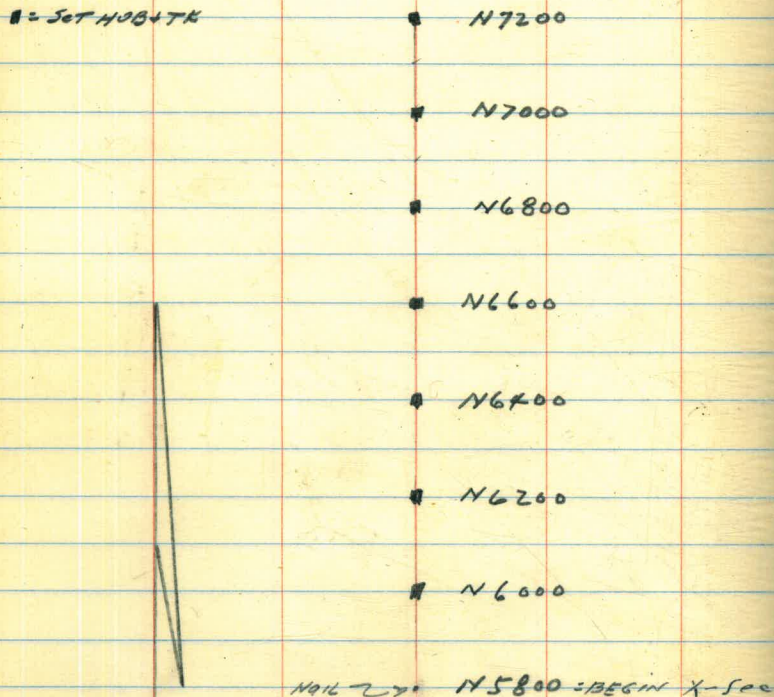

10-2-59

①

OF MISSION BAY

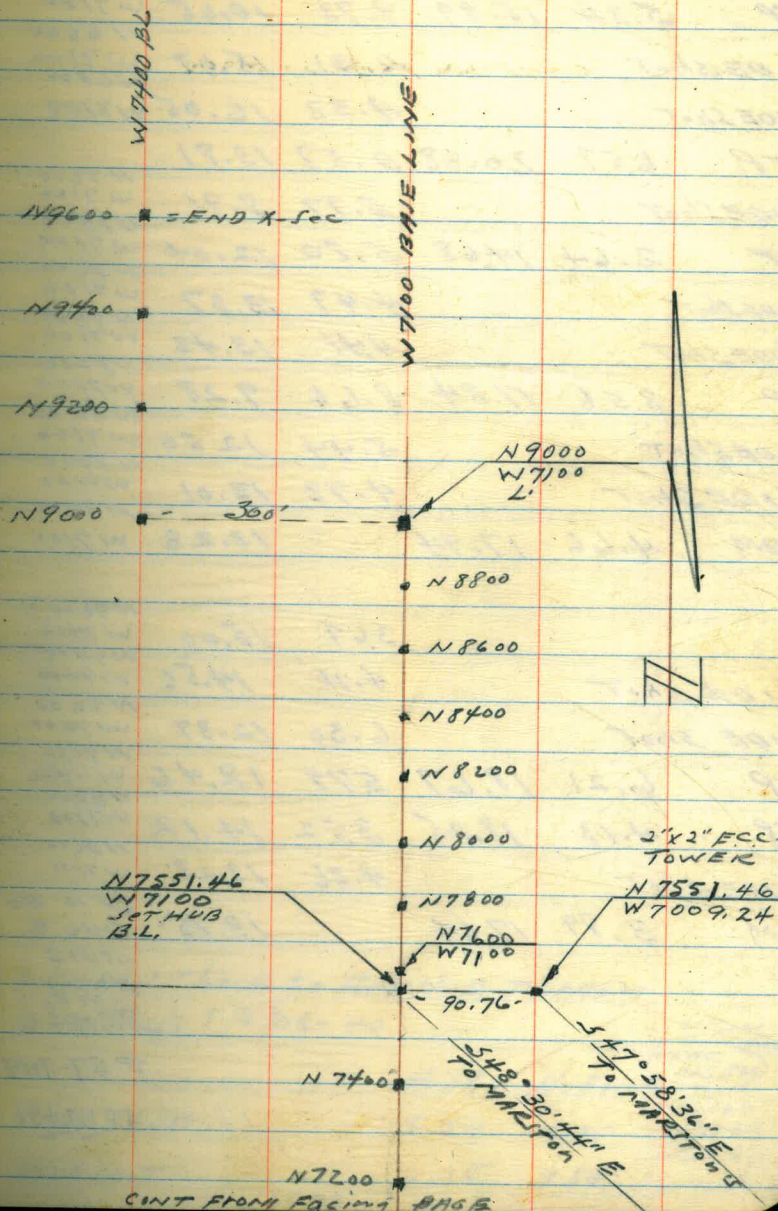

LEVELS FOR X-SECTIONING OF
SELF AREA OF MILLION BAY-

STA	+	HI	-	ELEV	
TP	5.34	15.99	9.73	10.65	N6400 W7100
SIDE SHOT			2.31	18.07	N6600 W7100 N6800
SIDE SHOT			4.33	16.05	W7100
TP	6.57	20.38	0.87	13.81	
SIDE SHOT			5.77	8.91	N7200 W7100
TP	2.64	14.68	5.80	12.04	N7400 W7100
SIDE SHOT			4.47	13.37	N7600 W7100
SIDE SHOT			4.41	13.43	N7800 W7100
TP	8.56	17.84	8.66	9.28	N8000 W7100
SIDE SHOT			5.44	12.50	N8200 W7100
SIDE SHOT			4.93	13.01	N8400 W7100
TBM	4.66	17.94		13.28	N8600 W7100
			3.67	15.00	N9600 W7400
SIDE SHOT			4.11	14.56	N9400 W7400
SIDE SHOT			6.30	12.37	N9200 W7400
TP	6.21	18.67	5.79	12.46	N9000 W7400
TP	4.13	18.25	3.52	14.12	N8800 W7100
SIDE SHOT			4.36	13.28	N8600 W7100
BM	3.89	17.64		13.75	BP IN BL SIDE 2

STATE
HIGHWAY
BRIDGE #57-144
SP 112+90
-JTA

ALLEN
BLUNT
STANDLEY
GADDY-

STA + HI - elev

LEVELS check to Ref HUB To Million
N 5099.20 }
W 7599.94 } FIB 106-40

TP	4.18	11.81		
SIDE SHOT	5.24	10.75		
SIDE SHOT	6.15	9.84		

15.99

ONCE IN
BLK
NEAR
N5800

N6000
W7100
N6200
W7100

N58+00; 0+00 = W7100

STA	WESTING	ELEV.
0+00	W7100	10.6
W100	W7200	9.0
W200	W7300	9.7
W300	W7400	9.2
W400	W7500	10.0
W500	W7600	8.3

N6000; 0+00 = W7100

0+00		10.5
W100		10.1
W200		9.9
W300		9.3
W400		10.0
W500		9.2
W600		8.6
W700		9.1
W800		7.6
W900		8.9

N6200; 0+00 = W7100

0+00		9.4
W65		9.3
W200		10.6
W300		10.4

N6200 (CONT)

STA	WESTING	ELEV.
W400		10.1
W500		9.5
W600		9.7
W700		8.8
W800		8.4
W900		7.5
W1000		8.0

N6400; 0+00 = W7100

0+00	7100	10.6
W100	7200	11.9
W200	7300	9.7
W300	7400	9.0
W400	7500	10.2
W500	7600	10.0
W600	7700	9.7
W700	7800	9.8
W800	7900	9.2
W900	8000	7.7

N66+00; 0+00 = W7100 -

0		10.3
W100	7200	10.3
W200	7300	10.5
W300	7400	10.3
W400	7500	9.8

STA N66+00 Cont
10/8/59-

ALLEN
BLUNT
GARDY
STANDLEY

X-SECTION AREA MILLION BAY - 10/8/59 (4)

STA 70+00 Cont

STA	width	ELEV
W500	7600	8.9
W600	7700	8.5
W700	7800	9.5
W800	7900	9.8
W900	8000	10.0

STA	width	ELEV
W500	7600	9.0
W600	7700	8.4
W700	7800	8.9
W800	7900	9.2
W900	8000	8.5

STA N68+00; 0+00 = W7100

0	7100	9.9
W100	7200	9.9
W200	7300	9.7
W300	7400	9.7
W400	7500	9.6
W500	7600	8.9
W600	7700	9.7
W700	7800	9.1
W800	7900	8.7
W900	8000	9.3

STA N70+00; 0+00 = W7100

0	7100	9.5
W100	7200	9.6
W200	7300	9.4
W300	7400	9.7
W400	7500	9.0

STA N72+00; 0+00 = W7100

0	7100	9.9
W100	7200	9.5
W200	7300	9.4
W300	7400	9.6
W400	7500	9.2
W500	7600	9.1
W600	7700	8.5
W700	7800	8.6
W800	7900	8.6
W900	8000	9.1

STA N74+00; 0+00 = W7100 -

0	7100	9.7
W52	7152	10.1
W64	7164	6.1
W83	7183	6.8
W93	7193	10.2
W100	7200	10.1

STA N74+00 cont
10/8/59

STA	WEST	ELEV
W200	7300	9.4
W300	7400	9.1
W400	7500	8.9
W500	7600	8.7
W600	7700	8.9
W700	7800	9.1
W800	7900	8.7
W863	7963	7.2
W869	7969	5.4
W879	7979	6.0
W885	7985	7.9
W900	8000	8.3

STA N 76+00; 0+00 = W 7100

0	7100	9.6
W100	7200	10.0
W200	7300	9.6
W300	7400	9.1
W400	7500	8.8
W500	7600	8.6
W570	7670	7.9
W575	7675	5.6
W582	7682	8.3
W600	7700	9.3
W700	7800	8.1
W800	7900	8.1
W900	8000	8.5

10/8/59

STA N78+00; 0+00 = W7100

STA	WESTING	ELEV.
0	7100	10.1
W100	7200	8.7
W200	7300	8.7
W276	7376	9.1
W290	7390	12.3
W310	7410	12.0
W340	7440	9.3
W364	7464	8.6
W400	7500	5.0
W409	7509	8.9
W500	7600	8.9
W513	7613	8.4
W524	7624	5.7
W526	7626	9.2
W600	7700	8.7
W700	7800	8.1
W800	7900	8.0
W900	8000	8.2

STA N 80+00; 0+00 = W7100

0	7100	8.8
W100	72	8.8
W200	73	8.8
W300	74	8.5
W400	75	8.6
W500	76	8.4

10/8/59

STA N80+00 Cont West

STA WESTING ELEV

W600	77	8.3
W700	78	8.1
W800	79	8.0
W900	8000	8.0
W1000	81	7.8
W1100	82	7.8
W1200	83	7.7
W1300	84	8.0
W1400	85	8.1
W1500	86	8.2
W1596	8796	8.0
W1600	8800	5.0

N 82+00; 0+00 = W7100 - OCT 9, 59

0	2100	12.3 = ON FRANK'S FILL (SAND)
W46		12.2 = TOP OF FRANK'S SAND FILL
W58		8.5 = TOE OF FRANK'S FILL
W100		8.4
W200	73	8.4
W300	74	8.3
W400	75	8.1
W500	76	8.0
W600	77	7.9
W700	78	7.8
W800	79	8.2
W900	8000	8.0
W1000	81	7.0
W1100	82	7.2
W1200	83	7.3

OCT 9 59

STA N82+00 Cont WEST (6)

STA WESTING ELEV

W1300	8400	7.6
W1342	8442	7.2
W1348	8448	2.7
W1385	8485	4.5
W1387	8487	8.0
W1400	8500	7.8
W1500	86	7.2
W1553	8653	6.2
W1560	8660	4.7
W1600	8700	1.7
W1630	8730	2.2
W1669	8769	4.1
W1673	8773	7.0
W1700	8800	7.6
W1800	8900	7.4
W1900	9000	7.1
W2000	9100	8.0

STA N 84+00; 0+00 = W7100 10/9/59

0		12.8' ON FRANK'S SAND FILL
W128		11.0 = TOP FRANK'S SAND FILL
W140		8.0 = TOE " " "
W200	73	7.9
W300	74	7.7
W400	75	7.4
W500	76	7.6
W600	77	7.4
W700	78	7.9

10/19/59
STAN 84+00 CONT WEST

STA WEST TO ELEV

W	W1800	7900	7.8
W	W1900	8000	7.2
W	W1961	8061	7.4
W	W1970	8070	5.8
W	W1985	8085	5.8
W	W1995	8095	7.4
W	W1000	8100	7.6
W	W1100	8200	7.0
W	W1200	83	7.2
W	W1295	83.95	7.0
W	W1303	8403	4.4
W	W1317	8417	5.1
W	W1322	8422	7.4
W	W1400	8500	7.0
W	W1452	8552	7.2
W	W1452	8552	4.8
W	W1458	8558	4.8
W	W1460	8560	7.6
W	W1500	8600	7.7
W	W1600	8700	7.4
W	W1630	8730	6.7
W	W1634	8734	2.8
W	W1672	8772	2.0
W	W1680	8780	6.7
W	W1700	8800	7.3

STAN 84+00 CONT WEST
10/19/59

Sta Westing elev

W1800	89	7.0
W1900	9000	7.5
W2000	91	7.1
W2095	9195	7.3
W2100	9200	4.8
W2122	9222	5.3
W2127	9227	6.6
W2200	93	7.0
W2300	94	7.3

STAN 86+00; 0+00 = W7100 10/13/59

W100	13.1 = ON SAND - FRANKS FILL
W184	13.0 " " " "
W197	11.2 TOP OF SAND FILL
W200	7.3 Toe " " "
W300	7.3
W400	7.1
W500	7.0
W600	7.3
W700	7.2
W800	7.5
W900	7.9
W1000	7.2
W1100	8000
W1200	81
W1300	82
W1400	83
W1500	84
W1600	85
W1700	86
W1800	87
W1900	88
W2000	89
W2100	90
W2200	91
W2300	92
W2400	93
W2500	94
W2600	95
W2700	96
W2800	97
W2900	98
W3000	99
W3100	100
W3200	101
W3300	102
W3400	103
W3500	104
W3600	105
W3700	106
W3800	107
W3900	108
W4000	109
W4100	110
W4200	111
W4300	112
W4400	113
W4500	114
W4600	115
W4700	116
W4800	117
W4900	118
W5000	119
W5100	120
W5200	121
W5300	122
W5400	123
W5500	124
W5600	125
W5700	126
W5800	127
W5900	128
W6000	129
W6100	130
W6200	131
W6300	132
W6400	133
W6500	134
W6600	135
W6700	136
W6800	137
W6900	138
W7000	139
W7100	140

10/13/59
STAN 88¹⁰⁰ CONT WEST

STA	ELEV
W1983	7.0
W1990	3.9
W2000	3.0
W2010	2.7
W2020	2.7
W2030	2.3
W2040	1.8
W2050	1.6
W2060	1.3
W2070	1.5
W2080	1.8
W2090	2.6
W2100	3.1
W2110	4.3

CONT ON PAGE

10/13/59
STAN 90¹⁰⁰; 0400W 7100

STA	ELEV	
0	13.3	ON FRANK'S SAND FILL
W100	13.9	" " " "
W200	13.0	" " " "
W300	12.3	" " " "
W310	12.2	Top of SAND FILL
W338	7.3	Toe of SAND FILL
W350	5.4	
W360	6.8	
W392	7.3	
W394	5.6	
W400	5.4	
W402	6.7	
W411	6.8	
W415	5.1	
W419	6.6	
W454	7.0	
W457	4.8	
W467	4.7	
W469	6.8	
W500	7.0	
W515	6.6	
W519	4.5	
W527	4.8	
W531	6.9	
W552	6.6	

STAN 90+00 cont West

STA	ELEV	STA	ELEV
W 555	4.6	W 2300	5.8
W 608	4.4	W 2400	6.0
W 609	6.5	W 2500	6.0
W 700	6.6	W 2600	6.0
W 800	6.2	W 2700	5.4
W 900 W 8000	6.2	W 2800	5.3
W 950	6.2	W 2900	5.0
W 967	4.0		
W 1050	5.1		
W 1142	4.6		
W 1164	6.7		
W 1250	5.7		
W 1350	5.0		
W 1377	5.0		
W 1382	7.0		
W 1450	6.6		
W 1450	6.2		
W 1650	6.0		
W 1750	6.0		
W 1850	6.4		
W 1900 W 9000	6.2		
W 1935	5.4		
W 2017	5.4		
W 2100 W 9200	6.0		
W 2200	5.6		

CONT ON TOP OF PAGE

10/13/59. (10)
STAN 92+00; 0+00 = W 7400

STA	ELEV	STA	ELEV
0	12.1	ON FRANKS SAND	
W 87	10.5	TOP OF FILL SAND	
W 97	6.8	TOE OF SAND	
W 141	6.5		
W 241	6.5		
W 341	6.2		
W 344	6.2		
W 360	5.2		
W 400	4.5		
W 500	4.1		
W 600 W 8000	3.7		
W 700 W 8100	4.3		
W 800 W 8200	5.0		
W 900	4.5		
W 915	4.6		
W 917	4.3		
W 960	2.1		
W 965	4.2		
W 1000	5.2		
W 1100	4.8		
W 1200	5.0		
W 1300	5.0		
W 1400	5.5		
W 1500 W 8900	5.8		
W 1600 W 9000	6.0		

CONT NEXT PAGE

STAN 92400 CONT WEST

STA	ELEV
W1694	5.5
W1700 W9100	4.7
W1730	0.8
W1740	2.3
W1770	3.3
W1840 9240	5.0
W1865	6.1
W1900	5.5
W2000	5.5
W2100	5.5
W2200	5.4
W2300	5.3
W2400	5.1
W2500	5.2
W2600 W10000	5.3

10/13/59 - ALLEN -
STAN 94400 10400 = W 7400

STA	WESTING	ELEV	FILL
0		14.3	ON FRANKS SAND
W100		12.0	" " "
W170		11.1	Top Sand FILL
W185		7.9	Toe " "
W200		6.0	
W245 7645		5.3	
W300 7700		3.7	
W350		2.6	
W400		3.9	
W500		4.3	
W600		3.9	
W700		3.4	
W800 8200		4.8	
W900		4.4	
W954		3.8	
W955		2.1	
W972		2.1	
W973		4.5	
W1000 8400		5.0	
W1100		5.0	
W1200		5.1	
W1300		5.2	
W1400		5.4	
W1500		5.6	
W1600		6.0	

STA 94400 cont west

STA	ELEV
W1700	5.8
W1780	5.5
W1800 W9200	4.7
W1830	0.9
W1870	3.2
W1900 9300	3.6
W1990 W9390	4.7
W2000	4.7
W2100	5.3
W2200	5.3
W2300	5.1
W2400	4.8
W2500	4.9
W2600 ^W 10000	4.8
W2625	3.9
W2631	1.6
W2634	4.1
W2700	4.5
W2797	4.0
W2802	1.8
W2807	3.7
W2900	4.1

STAN 96400; 0400 = W7400
10/11/56 - 10/13/59

(12)

STA	WESTING	ELEV			
0		15.0	ON FRANKS	FILL SAND	
W100		13.6	"	"	"
W200		12.8	"	"	"
W300		8.1	"	"	"
W325		7.5	"	"	"
W365		5.3	"	"	"
W400		3.2			
W450		3.2			
W500		2.9			
W600 W8000		2.3			
W650		3.8			
W700		3.1			
W750		3.6			
W800		4.0			
W900 W8300		4.0			
W1000		4.7			
W1100		4.9			
W1200		4.9			
W1300		5.0			
W1400		5.2			
W1500		5.3			
W1600 W9000		5.5			
W1700		5.6			
W1800		5.6			
W1900		5.5			

STA 96+00 Cont WEST
10/13/56

RESOUNDING ON ELY SHORE SANTA
CLARA POINT - OCT 20, 59-

(13)

STA	WESTING	ELEV
W2000	9400	4.8
W2030		4.7
W2040		3.3
W2070		1.0
W2110		2.4
W2160	W 9560	3.1
W2178		5.3
W2200		5.1
W2300		4.9
W2400		4.7
W2500		4.7
W2591		3.4
W2600	W 10000	2.0
W2608		2.2
W2614		3.4
W2642		4.4
W2700		4.3
W2800		4.3
W2814		3.4
W2817		1.6
W2823		1.2
W2826		3.4
W2860		4.5
W2900		4.5
W2978		4.2
W3000	W 10400	3.1

STA	WESTING	ELEV	DIST	SOUND	ELEV	DIST	SOUND	ELEV
W116400	0400	W19140.0						
0							14.1	8.7
11:40	0.1	+5.3	50				14.3	8.9
(5.4)	1.3	+4.1					14.2	8.8
	2.3	+3.1					14.3	8.9
	2.9	+2.5					14.1	8.7
50	3.5	+1.9					14.2	8.8
	4.0	+1.4	3700				14.1	8.7
	4.4	+1.0					14.0	8.6
	5.0	+0.4					14.0	8.6
	5.4	0.0					14.2	8.8
1700	7.2	1.8					13.9	8.5
	10.2	4.8	50				14.1	8.7
	11.6	6.2					14.1	8.7
	12.4	7.0					14.0	8.6
	12.3	6.9					14.1	8.7
50	12.5	7.1					14.3	8.9
	12.5		4700				13.7	8.3
	12.5						13.8	8.4
	12.5						13.7	8.3
	12.5						13.8	8.4
2700	12.5						13.8	8.4
	12.5	7.1	50				13.8	8.4
	12.8	7.4					13.7	8.3
	13.4	8.0					13.8	8.4

STAN 116400 CONT EAST
10-20-59

DIST	SOUND	ELEV	DIST	SOUND	ELEV
	13.9	8.5		13.3	7.9
	14.0	8.6		13.1	7.7
5400	14.0	8.6	50	12.9	7.5
	14.0	8.6		12.9	7.5
	14.1	8.7		13.0	7.6
	14.2	8.8		13.2	7.8
	14.1	8.7		13.0	7.6
50	14.0	8.6	8400	12.5	7.1
	14.3	8.9		12.5	7.1
	14.5	9.1		12.5	7.1
	17.0	11.6		13.3	7.9
	17.5	12.1		13.4	8.0
6400	17.0	11.6	50	13.3	7.9
	16.9	11.5		13.3	7.9
	16.9	11.5		13.3	7.9
(5.4)	16.5	11.1		13.2	7.8
11:45	16.5	11.1		13.3	7.9
50	16.3	10.9	9400	13.4	8.0
	16.2	10.8		13.4	8.0
	15.5	10.1		13.2	7.8
	14.6	9.2		13.2	7.8
	14.5	9.1		13.4	8.0
7400	14.3	8.9	50	13.0	7.6
	14.3	8.9		12.8	7.4
	13.6	8.2		12.5	7.1

STAN 116400 CONT EAST
10-20-59

(14)

DIST	SOUND	ELEV	DIST	SOUND	ELEV
	12.6	7.2			
	12.8	7.4			
10400	13.0	7.6			
11:50	13.1	7.8			
(5.3)	13.0	7.7			
	13.1	7.8			
	13.0	7.7			
50	12.9	7.6			
	13.0	7.7			
	13.0	7.7			
	13.2	7.9			
	13.0	7.7			
11400	12.5	7.2			
	12.2	6.9			
	12.2	6.9			
	12.2	6.9			
	12.2	6.9			
50	12.3	7.0			
	12.3	7.0			
	12.7	7.4			
	12.8	7.5			
	12.9	7.6			
119940-					
12400	13.1	7.8			

To Be Cont

RE SOUND ON ELY SHORE
SANTA CLARA POINT
10-20-59.

SOUND
EAST

STAN 116450 CONT EAST (15)

STAN 116450; 0+00 = 119140.0

DIST SOUND ELEV DIST SOUND ELEV

DIST SOUND ELEV DIST SOUND ELEV

12.5

12.5

0

13.0

12.5

12.7

12:50 0.5 +4.1 50 13.0

5+00 12.5 50 13.0

(4.6) 1.2 +3.4 13.0

12.5 12.9

2.0 +2.6 13.3

12.5 12.5

2.5 13.3

(4.6) 12.5

12.3

50 3.2 13.0

112:55 12.5 12.7

3.7 3+00 13.0

50 13.5 8+00 12.7

4.2 13.1

15.6 12.6

4.5 13.3

17.0 12.7

6.9 13.0

16.0 12.8

1+00 10.1 5.5 12.7

15.4 13.0

11.0 6.4 50 13.0

6+00 15.5 50 13.0

11.5 6.9 13.0

15.5 12.8

11.7 7.1 13.0

15.5 12.8

12.0 13.1

15.3 (4.5) 12.9

50 12.2 13.2

15.2 11+00 13.0

12.3 4+00 13.2

50 14.9 9+00 13.0

12.2 13.2

14.2 13.0

12.1 13.0

13.7 13.0

12.1 13.0

13.5 13.0

2+00 12.2 13.0

13.6 13.0

12.5 50 13.0

7+00 13.1 50 12.7

13.0 13.0

13.0 12.5

13.0 12.8

12.9 12.5

STAN 116750 CONT EAST
10-20-59 -

DIST SOUND ELEV

	12.5	
	12.6	
10+00	12.8	
	12.7	
	12.9	
	12.6	
	12.8	
50	12.9	
	12.7	
	12.6	
	12.5	
	12.3	
11+00	12.3	
	12.5	
	12.5	
	12.6	
	12.8	
50	12.9	
	12.9	
	13.0	
	13.0	
W17940	13.1	
12+00	13.2	

ELY OF SANTA CLARA - 10-20-59

V6
SOUND
EAST

STAN 117+00; 0+00 = W 19150.0

DIST SOUND ELEV DIST SOUND ELEV

0				12.9	
1+10	0.1		50	12.3	
(4.3)	1.1			13.0	
	1.9			12.9	
	2.2			12.8	
50	2.9			12.8	
	3.6		3+00	12.7	
	4.1			12.2	
	4.9			12.1	
	8.1			12.1	
1+00	10.3			12.1	
	10.7		50	12.1	
	11.2			12.5	
	11.3	7.0		12.5	
	11.6			12.6	
50	11.8			12.7	
	11.9		4+00	12.6	
	11.9			12.6	
	11.9			12.8	
	11.7			12.9	
2+00	12.0			13.0	
	12.1		50	13.0	
	12.0			12.8	
	12.1			12.7	

STA N117+00 CONT EAST

STA N117+00 CONT EAST 17

DIST	SOUND	ELEV	DIST	SOUND	ELEV	DIST	SOUND	ELEV
	12.6			12.5			12.8	
	12.5			12.6			12.9	
5+00	12.4		50	12.8		10+00	12.9	
	12.5			12.7			12.9	
	12.5			12.8			12.9	
	12.5			12.8			12.9	
	12.3			12.9			12.9	
50	12.3		8+00	13.0		50	13.0	
	13.2			12.9			12.9	
	16.2			13.0			12.6	
(4.2)	15.5			13.0			12.2	
11+5	15.0			13.0			12.3	
6+00	15.2		50	13.0		11+00	12.3	
	15.3			13.0			12.4	
	15.0			13.0			12.5	
	14.0			13.0			12.6	
	13.6			13.0			12.7	
50	13.5		9+00	13.0		50	12.8	
	13.3			13.0		(4.1)	13.0	
	12.8			13.0		11+20	13.0	
	12.8			13.1			13.3	
	13.0			13.2			13.5	
7+00	13.0		50	12.9		12+00	13.5	
	12.6			12.8				
	12.5			12.8				

ELY SANTA CLARA - 10 - 20 - 59

SOUND

DIST	SOUND	ELEV	DIST	SOUND	ELEV
0				12.3	
1125	0.5	50		12.3	
(4.0)	1.1			12.3	
	1.9			12.2	
	2.3			12.3	
50	3.2			12.3	
	4.0	3700		12.0	
	6.2			12.1	
	9.1			12.2	
	10.2	(4.0)		12.2	
1700	10.7	1130		12.2	
	11.0	7.0	50	12.0	
	11.2			12.5	
	11.2			12.0	
	11.3			11.9	
50	11.5			11.7	
	11.5	4700		12.0	
	11.5			12.0	
	11.7			12.2	
	11.7			12.4	
2700	11.9			12.5	
	11.7	50		12.5	
	12.2			12.6	
	12.1			12.5	

STAN 117450 CONT EAST 118

DIST	SOUND	ELEV	DIST	SOUND	ELEV
	12.5			12.5	
	12.6			12.4	
5700	12.7	50		12.5	
	12.6			12.5	
	12.3			12.4	
	12.5		(3.9)	12.7	
	12.0		1135	12.7	
50	12.0		8700	12.7	
	12.4			12.6	
	15.2			12.4	
	16.0			12.6	
	16.0			12.8	
6700	14.2		50	13.1	
	14.2			13.0	
	14.1			12.9	
	14.0			13.0	
	13.2			12.9	
50	12.9		9700	13.0	
	12.5			13.0	
	12.3			12.5	
	12.4			12.3	
	12.4			12.6	
7700	12.9		50	12.5	
	12.9			12.3	
	12.5			12.3	

STAN 117+50 CONT EAST
10-20-59

DIST SOUND ELEV

	12.3
	12.7
10+00	12.6
	12.6
	12.6
	12.5
	12.5
50	12.5
	12.5
	12.3
	12.3
	12.0
11+00	12.2
	12.2
	12.2
	12.3
	12.5
50	12.8
	12.9
	13.1
	13.1
	13.0
12+00	13.0

ELY SANTA CLARA-10-20-59 (119)
SEE FB 117-

STAN 118+00; 0+00=W 19160.0 SOUND EAST

DIST SOUND ELEV DIST SOUND ELEV

0				12.0	8.2
1.45	0.4	+3.4	50	11.7	7.9
(3.8)	1.1	+2.7		11.6	7.8
	1.5	+2.3		11.5	7.7
	2.2	+1.6		11.5	}
50	2.9	+0.9		11.5	
	3.4	+0.4	3+00	11.5	7.7
	5.5	1.7		11.2	7.4
	7.6	3.8		11.0	7.2
	9.0	5.2		11.5	7.7
14+00	10.0	6.2		11.3	7.5
	10.2	6.4	50	11.2	7.4
	10.5	6.7		11.2	7.4
	10.7	6.9		11.7	7.9
	10.9	7.1		11.5	7.7
50	10.9	7.1		12.0	8.2
	11.0	7.2	4+00	12.1	8.3
	11.1	7.3		12.5	8.7
	11.1	7.3		12.7	8.9
	11.1	7.3		12.8	9.0
2+00	11.0	7.2		12.5	8.7
	11.0	7.2	50	12.5	}
	11.3	7.5		12.5	
	11.5	7.7		12.5	8.7

STAN 118+00 CONT EAST

DIST	SOUND	ELEV	DIST	SOUND	ELEV
(3.7)	12.5	8.8		12.5	8.8
1150	12.4	8.7		12.5	8.8
5+00	12.2	8.5	50	12.5	8.8
	12.2	8.5		12.4	8.7
	12.1	8.4		12.5	8.8
	12.0	8.3		12.7	9.0
	12.2	8.5		12.7	
50	12.6	8.9	8+00	12.7	
	12.5	8.8		12.7	
	12.0	8.3		12.7	
	13.5	9.8		12.7	9.0
	13.3	9.6		12.6	8.9
6+00	14.2	10.5	50	12.7	9.0
	16.0	12.3		13.0	9.3
	15.0	11.3		13.0	
	14.8	11.1		13.0	
	14.0	10.3		13.0	
50	13.4	9.7	9+00	13.0	9.3
	13.3	9.6		12.8	9.1
	13.2	9.5		13.0	9.3
	12.7	9.0		13.0	9.3
	12.5	8.8		13.0	9.3
7+00	12.5	8.8	50	12.9	9.2
	12.5	8.8		12.9	9.2
	12.7	9.0		12.9	9.2

STAN 118+00 CONT EAST 20
10-20-59.

DIST	SOUND	ELEV
	12.5	8.9
	12.0	8.4
10+00	12.2	8.6
	12.3	8.7
(3.6)	12.6	9.0
1155	12.1	8.5
	12.0	8.4
50	12.2	8.6
	12.2	8.6
	12.1	8.5
	12.2	8.6
	12.0	8.4
11+00	12.0	8.4
	11.9	8.3
	11.8	8.2
	12.0	8.4
	11.9	8.3
50	11.9	8.3
	12.0	8.4
	12.2	8.6
	12.3	8.7
	12.2	8.6
12+00	12.2	8.6

SEE FB 117-

SOUNDINGS IN NWLY SHORE

10-21-59

SEE PAGE 65-

STAN 130+00; 0+00 = W 20310.0

SOUND EAST

DIST SOUND ELEV DIST SOUND ELEV

0

12.5 7.8

1115

50 12.5 7.8

(4.7)

1.0 +3.7

12.5 7.8

2.0 +2.7

13.0 8.3

2.6 +2.1

SOFT
BOTTOM 15.5 10.8

50

3.5 +1.2

1:20 15.0 10.3

4.3 +0.4

3+00 15.0 10.4

5.4 0.7

(4.6) 14.5 9.9

6.5 1.8

14.6 10.0

7.3 2.6

14.7 10.1

1400

8.2 3.5

14.5 9.9

9.2 4.5

50 14.5

10.4 5.7

14.5

11.5 6.8

14.5 9.9

12.5 7.8

14.2 9.6

50

12.4 7.7

14.3 9.7

12.5 7.8

4+00 14.2 9.6

12.5

14.2 9.6

12.5

14.2 9.6

12.5

14.0 9.4

2400

12.5

14.0 9.4

12.5

50 14.0 9.4

12.5

14.3 9.7

12.5 7.8

14.3 9.7

CRESCENT BAY - OCT 21, 1959 (21)

STAN 130+00 CONT EAST

DIST SOUND ELEV DIST SOUND ELEV

14.5 9.9

13.1 8.5

14.7 10.1

13.0 8.4

5+00 15.0 10.4

50 13.0

15.0 10.4

13.0

15.1 10.5

13.0

15.0 10.4

13.0

15.5 10.9

13.0

50 16.0 11.4

8+00 13.0

15.0 10.4

13.0

SOFT 15.0 10.4

13.0

BOTTOM 13.0 8.4

13.0

11:25 13.8 9.2

13.0 8.4

6+00 13.6 9.0

50 13.2 8.6

(4.6) 13.7 9.1

13.2

13.5 8.9

13.2

13.5 8.9

13.2 8.6

HARD 13.3 8.7

13.5 8.9

50 13.2 8.6

9+00 14.0 9.4

BOTTOM 13.5 8.9

14.2 9.6

13.7 9.1

14.2 9.6

13.6 9.0

14.3 9.7

13.5 8.9

14.0 9.4

7+00 13.0 8.4

50 12.3 7.7

13.0 8.4

12.6 8.0

13.0 8.4

13.2 8.6

10-21-59

STAN 130+00 CONT EAST

DIST	SOUND	ELEV	DIST	SOUND	ELEV
	13.2	8.6		12.8	8.3
	13.2	8.6		12.8	8.3
10+00	13.2	8.6	50	12.8	8.3
	12.8	8.2		12.9	8.4
	13.2	8.6		12.9	8.4
(4.5)	13.0	8.4		13.0	8.5
1130	12.8	8.2		13.0	8.5
50	12.5	8.0	13+00	13.0	8.5
	12.5	8.0		12.7	8.2
	12.5	8.0		12.8	8.3
	12.8	8.3		12.6	8.1
	13.0	8.5		12.5	8.0
11+00	13.1	8.6	50	12.7	8.2
	13.0	8.5		13.0	8.5
	13.0			13.0	8.5
	13.0			13.0	8.5
	13.0	8.5		13.1	8.6
50	12.9	8.4	14+00	13.5	9.0
	13.0	8.5		13.6	9.1
	13.0			13.7	9.2
	13.0			13.8	9.3
	13.0			13.9	9.4
12+00	13.0	8.5	50	14.0	9.5
	12.7	8.2		14.0	9.5
	12.8	8.3		14.0	9.5

(22)

STAN 130+00 CONT EAST

DIST	SOUND	ELEV	DIST	SOUND	ELEV
	14.8	10.3		13.8	9.4
	14.9	10.4		14.2	9.8
15+00	15.0	10.5	50	14.3	9.9
	15.0	10.5		14.0	9.6
	15.1	10.6		14.3	9.9
	15.2	10.7		14.6	10.2
	15.2	10.7		14.5	10.1
50	15.1	10.6	18+00	14.4	10.0
	15.2	10.7		14.5	10.1
	15.2	10.7		14.5	10.1
	15.1	10.6		14.4	10.0
	15.0	10.5		14.5	10.1
16+00	15.0	10.5	50	14.5	10.1
	14.7	10.2		14.6	10.2
(4.4)	14.8	10.3		14.7	10.3
	15.0	10.6		14.7	10.3
1135	15.0	10.6		14.7	10.3
50	15.0	10.6	19+00	14.6	10.2
	15.2	10.8		14.6	10.2
	15.6	11.2		14.4	10.0
	15.7	11.3		14.3	9.9
	16.0	11.6		14.2	9.8
17+00	16.0	11.6	50	13.7	9.3
	16.0	11.6		13.8	9.4
	14.0	9.6		14.0	9.6

STAN 130+00 CONT EAST

	DIST	SOUND	ELEV	DIST	SOUND	ELEV
		14.0	9.6			
		13.9	9.5			
10	20+00	13.9	9.5	50		
		14.0	9.6			
	(4.3)	13.7	9.4			
		13.3	9.0			
11	1:40	13.0	8.7			
2	50	13.0	8.7	23+00		

W/182+60
DREPPGE
PIPE

SEE PAGE 65

11	21+00			50		
2	50			24+00		
1	22+00			50		

NWLY CRESENT BAY -
10-21-59
SEE PAGE 63

123
SOUND

		STAN 130+50; 0+00 = W 203/0.0 EAST			
DIST	SOUND	ELEV	DIST	SOUND	ELEV
0	0.1			12.5	
2:00	1.5		50	13.0	
(4.0)	2.0		SOFT	15.9	
	2.5		BOTTOM	15.0	
	3.2			14.9	
50	3.8			14.5	
	4.3		3+00	14.0	
	5.2			13.9	
	6.7			13.4	
	8.2			13.5	
1+00	10.3			13.7	
	10.8	6.8	50	14.0	
	11.2			13.5	
	11.9			13.0	
	12.0		HARD	12.8	
50	12.0		BOTTOM	13.0	
	12.0		4+00	13.0	
	12.0			13.0	
	12.0			13.0	
	12.0			12.9	
2+00	12.2			12.9	
	12.3		50	13.0	
	12.5			13.5	
	12.5			14.0	

NWLY AREA CRESENT BAY -

10-21-59

SEE PAGE 61 -

STAN 131400; 0400 = W 20320.0

Sound
EAST

DIST	SOUND	ELEV	DIST	SOUND	ELEV
0	0.0			13.5	
2:30	0.9		50	13.6	
(3.6)	1.4			14.2	
	2.1			14.2	
	2.7			14.0	
50	3.4			14.1	
	4.1		3400	12.9	
	4.8			12.9	
	6.2			13.0	
	7.5			12.4	
1400	8.5	ok		11.9	ok
	10.4		50	12.0	
	11.0			12.0	
	11.5			12.0	
	11.5			12.0	
50	11.5			12.0	
	11.5		4400	12.0	
	11.5			12.2	
(3.8)	11.5			12.2	
2:35	11.5			12.5	
2400	12.0			12.4	
	13.1		50	12.4	
	13.0			12.4	
	13.5			12.3	

STAN 131400 CONT EAST

126

DIST	SOUND	ELEV	DIST	SOUND	ELEV
(3.4)	12.3			12.5	
2:40	12.3			12.2	
5400	12.3		50	12.0	
	12.3			12.0	
	12.4			12.1	
	12.4			12.0	
	12.4			12.2	
50	12.5		8400	12.2	
	12.3			12.2	
	12.5			12.0	
	12.5			12.0	
	12.5			12.0	
6400	12.5		50	12.0	
	12.5			12.0	
	12.5			12.0	
	12.5			12.2	
	12.5			12.5	
50	12.4		9400	12.9	
	12.5			13.0	
	12.5			13.0	
	12.5			13.0	
	12.5			11.5	
7400	12.5		50	12.2	
	12.5			12.3	
	12.5			12.0	

STAN 131400 CONTEAST
10-21-59

DIST	SOUND	ELEV	DIST	SOUND	ELEV
(3.4)	12.0			12.0	
2:45	12.0			11.5	
10400	12.2		50	11.4	
	12.2			11.5	
	12.1			11.5	
	12.0			11.5	
	12.0			11.5	
50	11.9		13400	11.5	
	11.7			11.5	
	11.5			11.5	
	11.5			11.4	
	11.7			11.5	
11400	11.6		50	11.5	
	11.7			11.6	
	12.0			12.0	
	12.0			12.0	
	12.1			12.1	
50	12.2		14400	12.3	
	12.2			12.3	
	12.2			12.4	
	12.2			12.5	
	12.2			12.5	
12400	12.2		50	12.5	
	12.2			12.5	
	12.0			12.4	

STAN 131400 CONTEAST

(27)

DIST	SOUND	ELEV	DIST	SOUND	ELEV
	12.3			11.8	
	12.2			12.0	
15400	12.2		50	12.0	
	12.5			12.0	
	12.5			12.2	
	12.2			12.0	
	12.5			12.2	
50	13.3		18400	12.2	
	13.0			12.5	
	13.0			12.2	
(3.3)	13.1			12.5	
2:50	12.9			12.5	
16400	12.9		50	12.5	
	12.8			12.7	
	12.5			12.5	
	12.3			12.3	
	12.4			12.0	
50	12.5		19400	11.9	
	13.8			11.8	
	13.9			11.8	
	14.0			11.8	
	14.2			11.8	
17400	14.3		50	11.8	
	13.7			11.7	
	11.8			11.7	

STAN 131400 CONT EAST

DIST SOUND ELEV DIST SOUND ELEV

	11.7				
	11.7				
20400	11.5		50		
	11.5				
	11.4				
(3.2)	11.3				
2155	11.5				
50	11.5		23400		

W18270

Dredge
pipe

SEE PAGE 61

21400 50

50 24400

22400 50

NWLY AREA CRESENT 13A7

128

10-21-59
See Page 59

SOUND

STAN 131450; 0410=W 20330.0 EAST

DIST SOUND ELEV DIST SOUND ELEV

0				13.2	
3105	0.5		50	13.4	
(3.1)	1.0			12.5	
	1.6			12.7	
	2.2		(3.1)	12.8	
50	3.3		3110	13.0	
	4.2		3410	13.0	
	4.5			13.0	
	5.6			13.2	
	6.5			13.3	
1400	8.6			13.3	
	10.0		50	13.3	
	10.6			13.3	
	10.5			13.3	
	10.6			13.0	
50	10.6			13.0	
	10.6		4400	12.3	
	10.5			12.2	
	10.5			12.3	
	12.0			12.2	
2400	13.5			12.2	
	13.4		50	12.0	
	13.3			12.0	
	13.2			11.5	

STAN 131450 CONT EAST

DIST	SOUND	ELEV	DIST	SOUND	ELEV
		11.5			12.2
		11.5			12.0
5700		11.5	50		12.0
		11.5			11.7
		11.3			11.2
(3.0)		11.2			11.5
3:15		11.2			11.5
50		11.2	8700		11.5
		11.2			11.4
		11.5	(2.9)		11.2
		11.5	3:20		11.0
		11.6			11.2
6700		11.5	50		11.0
		11.5			11.0
		11.7			11.2
		12.0			11.0
		12.0			11.1
50		12.0	9700		11.2
		12.1			11.9
		12.1			12.0
		12.2			12.0
		12.3			12.1
7700		12.3	50		11.8
		12.2			12.0
		12.3			12.0

STAN 131450 CONT EAST 29

DIST	SOUND	ELEV	DIST	SOUND	ELEV
		12.0			11.4
		12.0			11.3
10700		12.0	50		11.3
		12.1			11.3
		12.1			11.3
		12.0			11.5
		11.9			11.5
50		11.9	13700		11.5
		11.9			11.5
		11.7			11.5
		11.2			11.0
		11.2			10.5
11700		11.2	50		10.7
		11.2			11.0
		11.2			11.1
		11.2			11.5
		11.2			11.7
50		11.2	14700		12.0
		11.2			12.0
		11.2			12.0
(2.8)		11.2			12.0
3:25		11.2			12.0
12700		11.2	50		12.1
		11.3			12.0
		11.3			12.3

STAN 131450 CONT EAST

DIST	SOUND	ELEV	DIST	SOUND	ELEV
	12.3			12.2	
	12.2			11.5	
15400	12.2		50	11.3	
	12.2			11.3	
	12.2			11.4	
	12.2			11.3	
	11.7			11.9	
50	12.0		18400	11.7	
	12.2			11.7	
	12.5			11.7	
	12.2		(2.8)	11.7	
	12.2		3130	11.8	
16400	12.0		19400	11.8	
	11.5			11.8	
	11.0			11.7	
	11.1			11.8	
	11.8			11.7	
50	11.8		50	11.8	
	11.5			11.8	
	12.4			11.5	
	13.0			11.3	
	13.2			11.3	
17400	13.3		20400	11.5	
	13.3			11.5	
	13.0			11.2	

STA 131450 CONT EAST 130

DIST	SOUND	ELEV
	11.1	
	11.1	
50	11.1	
	11.2	
	11.0	
	11.0	
	11.0	
21400 WISL30	10.5	

SEE PAGE 59-

50

22400

STA N132+00 CONT EAST

STA N132+00 CONT EAST

132

DIST	SOUND	ELEV	DIST	SOUND	ELEV	DIST	SOUND	ELEV	DIST	SOUND	ELEV
2:30	13.2	8.4		13.5	8.7		14.5	9.7		14.5	9.7
4.8	13.0	8.2		13.5			14.2	9.4		14.5	9.7
10+00	13.0	8.2	50	13.5		15+00	14.0	9.2	50	14.5	9.7
	13.2	8.4		13.5	8.7		14.0			14.8	10.0
	13.3	8.5		14.0	9.2		14.0			14.8	10.0
	14.0	9.2		13.7	8.9		14.0			15.0	10.2
	14.0	9.2		13.6	8.8		14.0			14.5	9.7
50	14.1	9.3	13+00	13.8	9.0	50	14.0	9.2	18+00	14.2	9.4
	14.2	9.4		14.2	9.4		13.8	9.0		14.5	9.7
	14.5	9.7		15.0	10.2		14.0	9.2		14.5	9.7
	14.5	9.7		15.0	10.2		14.0	9.2		14.5	9.7
	14.5	9.7		14.8	10.0	4.8	14.2	9.4		14.6	9.8
11+00	14.5	9.7	50	14.3	9.5	16+00	14.2	9.4	50	14.8	10.0
	14.6	9.8		14.5	9.7	2:35	14.3	9.5		14.8	10.0
	14.6	9.8		14.5	9.7		14.4	9.6		14.8	10.0
	14.7	9.9		14.3	9.5		14.5	9.7		14.8	10.0
	14.7	9.9		14.3	9.5		14.5			14.8	10.0
50	14.5	9.7	14+00	14.2	9.4	50	14.5		19+00	14.9	10.1
	14.5	9.7		14.5	9.7		14.5	9.7		15.0	10.2
	13.9	9.1		14.5	9.7		14.6	9.8		15.0	
	13.8	9.0		14.7	9.9		14.8	10.0		15.0	
	13.5	8.7		14.7	9.9		14.7	9.9	4.7	15.0	10.2
12+00	13.5	8.7	50	14.8	10.0	17+00	14.4	9.6	50	15.0	10.3
	13.4	8.6		15.0	10.2		14.5	9.7		15.0	
	13.5	8.7		14.9	10.1		14.5	9.7		15.0	
							W18390		2.40	15.0	10.3

NWLY AREA CRESENT BAY

OCT 23, 1959

SOUND

EAST

STAN 132+50, 10+00=W 20370.0

DIST	SOUND	ELEV	DIST	SOUND	ELEV
0				13.0	
1:40	0.1		50	14.0	
(5.0)	1.4			14.8	
	2.2			14.8	
	3.0			14.8	
50	3.5			14.8	
	4.5		3+00	14.5	
	5.5			14.5	
	6.5			14.5	
	7.2			13.5	
1+00	9.0			13.5	
	10.2		50	13.5	
	12.0	7.0		13.0	
	12.2			13.5	
	12.5			13.5	
50	12.5			14.0	
	12.5		4+00	14.2	
	12.5			14.2	
	12.8			14.0	
	12.8		(5.0)	14.0	
2+00	12.8		1+45	13.2	
	12.8		50	14.0	
	13.0			14.0	
	13.0			14.5	

STAN 132+50 CONT EAST

133

10-23-59-

DNT SOUND ELEV DNT SOUND ELEV

		14.0			14.5
		14.0			14.5
5+00		14.0		50	14.5
		14.2			14.5
		14.2			14.5
		14.2			14.3
		14.0			14.5
50		14.0		8+00	14.4
		13.8			14.2
		14.0			14.2
		14.0			14.2
		14.0			14.2
		14.0		50	14.0
6+00		14.0			14.0
		14.0			14.0
		14.2			13.0
		14.2			13.0
50		14.2		9+00	13.2
		14.2			13.4
		14.8			14.8
		14.8			13.0
		14.5			13.0
7+00		14.8		50	13.2
		15.0			13.2
		14.8			13.0

STAN 132+50 CONT EAST

STAN 132+50 CONT EAST 134

DIST	SOUND	ELEV	DIST	SOUND	ELEV	DIST	SOUND	ELEV	DIST	SOUND	ELEV
(5.0)	13.5			14.0			14.0			13.5	
1:50	14.0			13.8			13.5			13.5	
10+00	13.8		50	14.0		15+00	13.0		50	13.5	
	13.5			14.5			13.2			13.5	
	14.0			15.2			13.2			13.5	
	14.0			15.0			13.3		(4.9)	13.5	
	14.2			15.0			13.2		2:00	13.5	
50	14.0		13+00	15.0		50	13.5		18+00	13.5	
	14.0			14.8			13.5			13.5	
	14.0			15.0			13.2			13.5	
	14.8			14.5			13.2			14.0	
	15.0			13.5			13.3			14.0	
11+00	14.7		50	13.5		16+00	13.5		50	14.0	
	14.5			14.2			13.5			14.0	
	14.5			14.2			13.5			14.0	
	14.0			14.5			13.4			14.0	
	14.0		(4.9)	14.5			13.3			14.2	
50	14.0		11:55	14.2		50	13.2		19+00	14.2	
	14.5		14+00	13.8			13.4			14.5	
	14.2			13.2			13.4			14.5	
	14.2			14.2			13.2			14.5	
	14.3			14.8			13.2			14.5	
12+00	14.5		50	15.2		17+00	13.4		50	14.5	
	14.5			15.2			13.4			14.5	
	14.0			15.0			13.4			14.0	

NWLY AREA CRESENT BAY

OCT 23, 59

SOUND
EAST

10 - 23 - 59

135

STAN 133+00 CONT EAST

STAN 133+00, 0+10 = W 20370.0

DIST	SOUND	ELEV	DIST	SOUND	ELEV
6	0.0			13.8	
1110	1.5		50	14.0	
(5.1)	2.4			15.0	
	2.9			14.4	
	5.1			14.5	
50	5.1			14.4	
	6.0		3+00	14.5	
	6.8			14.0	
	8.5			12.5	
	9.0			14.0	
1400	10.0			15.0	
	11.0		50	14.5	
	11.8			15.0	
	12.0			15.0	
	12.5	7.4		15.0	
50	12.4			14.4	
	12.2		4+00	14.4	
	12.2			14.0	
	12.2			14.5	
	12.3			14.0	
2+00	14.2			14.0	
	13.2		50	14.0	
	12.8			14.2	
	12.8			14.4	

DIST	SOUND	ELEV	DIST	SOUND	ELEV
	14.2			14.2	
	14.2			14.1	
5+00	14.0		50	14.1	
	14.1			14.0	
	14.1			14.3	
	13.8			14.3	
	13.8			14.3	
50	13.8		8+00	14.3	
1115	14.0			14.5	
(5.1)	14.0			14.4	
	14.0			14.1	
	14.0			14.0	
	14.0			14.0	
6+00	14.4		50	13.9	
	14.0			13.8	
	14.0			13.4	
	14.1			13.6	
	13.8			14.0	
50	14.1		9+00	14.0	
	14.2			13.4	
	14.3			14.0	
	14.3			13.2	
	14.5			13.7	
7+00	14.8		50	13.5	
	14.5			13.5	
	14.3			14.0	

STAN 133+00 CONT EAST

DIST	SOUND	ELEV	DIST	SOUND	ELEV
	13.5		1120	13.0	
	14.1			14.0	
10+00	13.8		50	14.8	
	14.8			15.0	
	14.7			14.8	
	14.0			14.5	
	14.0			15.0	
50	14.0		13+00	15.0	
	15.0			14.1	
	14.5			13.5	
	14.5			14.8	
	14.4			14.4	
11+00	14.7		50	14.2	
	14.5			14.2	
	14.2			14.5	
	14.0			14.0	
	15.0			14.5	
50	14.5		14+00	14.8	
	14.5			14.5	
	14.1			14.5	
	14.8			15.2	
	14.0			15.7	
12+00	13.5		50	15.7	
	14.0			15.4	
	13.8			15.4	

STAN 133+00 CONT EAST 136

DIST	SOUND	ELEV	DIST	SOUND	ELEV
	13.2			14.8	
	13.5			13.0	
15+00	13.2		50	13.0	
	13.8			13.0	
	13.9			13.5	
(5.0)	13.7			13.7	
1125	13.8			13.4	
50	13.8		18+00	13.8	
	13.8			13.7	
	13.8			14.0	
	13.8			14.0	
	13.8			14.0	
16+00	13.5		50	14.0	
	13.5			14.0	
	13.5			14.0	
	13.7		(5.0)	14.0	
	15.4		1130	14.0	
50	14.0		19+00	14.2	
	16.0			14.0	
	13.7			14.0	
	13.7			14.0	
	13.3			13.7	
17+00	13.3		50	13.4	
	13.3			13.7	
	14.8			14.0	

NW AREA CRESCENT BAY.

SOUND
EAST

STAN 133+50 CONT EAST

137

STAN 133+50; 6+00 = W 20380.0

DIST SOUND ELEV DIST SOUND ELEV

DIST	SOUND	ELEV	DIST	SOUND	ELEV
0				14.0	
11.05	0.1		50	14.0	
5.0	1.8			14.5	
	2.4			14.0	
	3.0			14.0	
50	3.5			13.8	
	4.0		3+00	13.8	
	4.9			13.8	
	6.0			13.5	
	7.1			13.5	
1+00	9.5			13.8	
	12.0	7.0	50	14.5	
	11.0	6.0		14.5	
	12.0	7.0		15.0	
	12.2			14.5	
50	12.3			14.5	
	12.3		4+00	14.2	
	12.3			14.3	
	12.5			14.3	
	12.5			14.3	
2+00	13.2			14.3	
	12.8		50	14.1	
	13.2			14.5	
	13.2			14.8	

DIST SOUND ELEV DIST SOUND ELEV

DIST	SOUND	ELEV	DIST	SOUND	ELEV
		14.8			14.0
		14.2			14.0
5+00		14.2		50	14.0
		14.0			14.2
		14.5			14.2
		14.0			14.5
		13.8			14.3
		14.0	50		14.0
		13.1		8+00	14.2
		14.5			14.5
		14.5			13.4
		14.7			13.7
		14.2	6+00		13.5
		14.2		50	13.7
		14.2			13.5
		14.0			13.4
		14.0			13.5
		14.0	50		13.0
		14.2		9+00	13.5
		14.0			13.5
		14.0			13.0
		14.0			13.0
		14.0			13.0
		14.0	7+00		13.5
		14.0		50	13.5
		14.2			13.2
		14.2			13.5

STAN 133+50 CONT EAST

DIST	SOUND	ELEV	DIST	SOUND	ELEV
	13.5			13.8	
(11:15)	14.0			13.2	
10+00	14.2		50	13.5	
(5.0)	14.0			14.5	
	14.0			15.0	
	13.8			15.0	
	13.9			15.0	
50	13.7		13+00	15.0	
	14.3			15.0	
	14.5			14.8	
	14.2		(5.0)	14.2	
	14.2		(11:20)	14.0	
11+00	14.3		50	14.8	
	13.9			13.8	
	13.8			14.8	
	14.0			15.0	
	13.2			14.1	
50	14.0		14+00	14.8	
	13.8			14.8	
	13.2			14.8	
	13.4			14.9	
	13.5			13.4	
12+00	13.4		50	14.4	
	13.0			15.4	
	13.7			15.8	

STAN 133+50 CONT EAST

38

DIST	SOUND	ELEV	DIST	SOUND	ELEV
	14.8		(11:25)	13.8	
	14.0			13.5	
15+00	14.0		50	13.5	
	13.5			13.5	
	14.0			14.0	
	15.0			14.0	
	15.1			14.1	
50	14.0		18+00	14.5	
	14.2			14.0	
	14.4			14.0	
	14.4			14.0	
	14.0			14.0	
16+00	14.0		50	14.0	
	14.0			14.0	
	14.0			14.0	
	14.0			14.0	
	14.0			14.0	
50	14.0		19+00	14.0	
	14.0			14.0	
	14.0			14.0	
	14.1			14.0	
	14.1			14.0	
17+00	13.9		50	13.8	
	14.0		(5.0)	13.8	
	14.0		(11:28)	13.5	

NWLY AREA CRESENT BAY -

OCT 23, 1959

SOUND

STAN 134400, 10400 = W 20380.0 EAST

DIST SOUND ELEV DIST SOUND ELEV

				13.5	8.7				
			50	14.0	9.2				
0				14.0	9.2				
(4.8)				13.9	9.1				
10:35	1.4	+3.4		14.0	9.2				
	2.2	+2.6		14.0	9.2				
	3.0	+1.8		14.1	9.3				
50	3.5	+1.3		14.0	9.2	3+00			
	4.5	+0.6		13.9	9.1				
	6.2	1.4		14.0	9.2				
	8.4	3.6		14.0	9.2				
	9.9	5.1		13.9	9.1				
1+00	11.0	6.2		14.0	9.2	50			
	12.1	7.3		14.0	9.2				
	12.2	7.4		13.9	9.1				
	12.3	7.5		15.0	10.2				
	12.5	7.7		14.9	10.1				
50	12.7	7.9		14.2	9.4	4+00			
	12.8	8.0		15.0	10.2				
	12.9	8.1		15.0					
	13.0	8.2		15.0					
	13.0	8.2		15.0	10.2				
2+00	13.2	8.4		15.5	10.7	50			
	13.3	8.5		14.8	10.0				
	13.6	8.8		14.5	9.7				

STAN 134400 CONT EAST (39)

10-23-59

DIST SOUND ELEV DIST SOUND ELEV

	14.7	9.9		14.2	9.3
	14.2	9.4		14.2	9.3
5+00	14.3	9.5	50	14.0	9.1
	15.0	10.2		14.0	
	14.2	9.4		14.0	
	14.0	9.2		14.0	
	14.0	9.2		14.0	9.1
50	14.0	9.2	8+00	14.1	9.2
	14.2	9.4		14.0	9.1
	14.2	9.4		14.1	9.2
(4.9)	14.6	9.8		14.2	9.3
10:40	15.0	10.1		14.0	9.1
6+00	15.0		50	13.7	8.8
	15.0			13.7	8.8
	15.0			13.5	8.6
	15.0	10.1		13.5	8.6
50	14.8	9.9		13.3	8.4
50	15.0	10.1	9+00	13.2	8.3
	14.7	9.8		13.0	8.1
	14.7	9.8		13.5	8.6
	14.7	9.8		13.8	8.9
	14.5	9.6		13.5	8.6
7+00	14.2	9.3	50	13.3	8.4
	14.2	9.3		13.0	8.1
	14.2	9.3		13.0	8.1

STAN 13400 CONT EAST

DIST	SOUND	ELEV	DIST	SOUND	ELEV
	13.2	8.3	(4.9)	14.0	9.1
	14.0	9.1	10:40	14.1	9.2
10+00	13.8	8.9	50	14.0	9.1
	14.0	9.1		14.1	9.2
	13.8	8.9		14.5	9.6
	14.0	9.1		15.0	10.1
	14.0	9.1		15.3	10.4
50	13.7	8.8	13+00	15.3	10.4
	14.0	9.1		15.3	10.4
	14.3	9.4		15.3	10.4
	14.4	9.5		15.4	10.5
	14.6	9.7		15.1	10.2
11+00	14.5	9.6	50	15.0	10.1
	14.3	9.4		15.0	10.1
	14.2	9.3		14.7	9.8
	14.2	9.3		14.7	9.8
	14.1	9.2		14.7	9.8
50	14.0	9.1	14+00	15.0	10.1
	14.0	9.1		14.7	9.8
	14.2	9.3		15.0	10.1
	14.2	9.3		15.0	10.1
	14.0	9.1		14.7	9.8
12+00	13.7	8.8	50	15.2	10.3
	13.7	8.8		15.5	10.6
	14.2	9.3		15.5	10.6

STAN 13400 CONT EAST 140

DIST	SOUND	ELEV	DIST	SOUND	ELEV
	15.5	10.6		14.2	9.3
	15.5	10.6		14.1	9.2
15+00	15.1	10.2	50	14.0	9.1
	15.0	10.1		14.0	
	14.5	9.6		14.0	
	14.5			14.0	
	14.5			14.0	
50	14.5	9.6	18+00	14.0	9.1
	14.3	9.4		14.2	9.3
	14.4	9.5		14.2	9.3
	14.3	9.4		14.1	9.2
	14.5	9.6		14.2	9.3
16+00	14.5		50	14.3	9.4
	14.5			14.2	9.3
	14.5			14.2	9.3
	14.5		(4.9)	14.2	9.3
	14.5		10:50	14.1	9.2
50	14.5	9.6	19+00	14.1	9.2
	14.7	9.8		14.1	9.2
	15.0	10.1		14.2	9.3
	14.8	9.9		14.1	9.2
	14.7	9.8		14.3	9.4
17+00	14.7	9.8	50	14.2	9.3
	14.7	9.8		14.0	9.1
	14.6	9.7	W18410	14.0	9.1

CONT Page 49

NWLY AREA CRESENT BAY

OCT 22, 59 SEEPAGE 47 SOUND

STAN 134450; 0+00 = W 20380 EAST

DIST	SOUND	ELEV	DIST	SOUND	ELEV
0	0.0	+5.4		14.2	
11:30	1.8	+3.6	50	14.0	
(5.4)	2.6	+2.8		14.0	
	3.2	+2.2		14.3	
	4.1	+1.3		14.0	
50	4.1	+1.3		14.0	
	5.2	+0.2	3+00	14.2	
	6.9	1.5		15.3	
	7.5	2.1		16.1	
	10.3	4.9		16.0	
1+00	11.7	6.3		15.5	
	12.0	6.6	50	14.7	
	12.2	6.8		12.5	
	12.3	6.9		13.7	
	12.5	7.1		14.5	
50	15.2	9.8		14.8	
	15.3		4+00	15.0	
	15.2			15.5	
	13.1			15.5	
	13.3			15.5	
2+00	13.9			15.5	
	13.5		50	15.5	
	15.0		11235	15.2	
	13.5		(5.4)	15.3	

STAN 134450 CONTRAST

10-22-59

DIST	SOUND	ELEV	DIST	SOUND	ELEV
	15.8			15.3	
	15.0			15.2	
5+00	13.7		50	15.1	
	14.3			15.0	
	14.0			14.9	
	15.1			14.9	
	14.5			14.9	
50	15.2		8+00	14.9	
	15.2			14.9	
	15.2			14.8	
	15.2			14.5	
	15.0			14.7	
6+00	15.5		50	14.9	
	15.7			15.0	
	15.5			15.0	
	16.0		(5.4)	15.2	
	16.2		11:40	15.3	
50	16.0		9+00	15.3	
	16.0			15.5	
	16.0			15.6	
	16.0			15.9	
	16.0			16.0	
7+00	16.0		80	15.9	
	15.5			15.9	
	15.4			15.8	

STA 134 + 50 CONT EAST

DIST	SOUND	ELEY	DIST	SOUND	ELEY
	15.8			14.5	
	16.0			14.6	
10+00	16.0		50	14.6	
	16.0			14.5	
	16.0			14.5	
	16.0			14.6	
	16.0			15.0	
50	15.5		13+00	15.2	
	14.7			15.2	
	15.2			15.5	
	14.8			15.0	
	16.0			15.0	
11+00	15.5		50	15.0	
	15.8			15.0	
	16.0			14.7	
	15.5			15.0	
	16.0			15.0	
50	16.0		14+00	15.2	
	16.2			15.2	
	15.5			15.2	
	14.5			15.2	
	14.5			15.2	
12+00	14.5		50	15.2	
	14.5			15.2	
	14.5			15.5	

STA 134 + 50 CONT EAST 42

DIST	SOUND	ELEY	DIST	SOUND	ELEY
(5.4)	15.9			14.5	
11+45	16.0			14.5	
15+00	16.0		50	14.7	
	15.5			14.6	
	15.4			14.5	
	15.4			14.3	
	15.5			14.3	
50	15.7		18+00	14.5	
	14.5			14.3	
	14.5			14.3	
	14.5			14.3	
	14.5			14.4	
16+00	14.5		50	14.4	
	14.5			14.3	
	14.5			14.4	
	14.5			14.5	
	14.5			14.5	
50	14.5		19+00	14.5	
	14.5			14.5	
	14.5		(5.4)	14.8	
	14.5		11+50	14.7	
	14.5			16.0	
17+00	14.5		50	16.0	
	14.5			16.0	
	14.6		118410	16.0	

CONT PAGE 47-

NWLY AREA CRESENT BAY -
OCT 22, 59-
SOUND

STAN 135+60; 0+00 = W 20380.0 EAST

DIST SOUND ELEV DIST SOUND ELEV

0 SEE Page 45 15.5

(5.2) 0.0 +5.2 50 15.2

10:20 1.3 +3.9 15.5

2.3 +2.9 15.5

3.0 +2.2 15.5

50 3.8 +1.4 16.0

4.8 +0.4 3+00 16.0

6.2 1.0 16.0

8.3 3.1 15.6

9.8 4.6 (5.2) 15.2

1700 10.5 5.3 10:25 14.6

11.0 5.8 50 14.8

11.2 6.0 14.6

15.0 9.8 14.2

14.0 8.8 14.6

50 14.8 14.8

15.0 4+00 14.8

15.0 14.8

15.0 14.8

15.0 15.0

2+00 15.0 15.0

15.1 50 15.0

15.2 15.0

15.2 14.2

STAN 135+00 CONT EAST 43
10-22-59-

DIST SOUND ELEV DIST SOUND ELEV

14.0 10:30 14.7

14.0 (5.2) 14.7

5+00 14.0 50 14.3

14.0 14.5

14.0 14.8

13.6 14.5

13.0 14.8

50 12.6 8+00 15.0

12.8 15.2

13.8 15.3

14.0 15.3

13.8 15.3

6+00 13.0 50 15.0

13.2 15.0

14.2 15.0

14.8 15.0

14.5 15.1

50 13.0 9+00 15.2

13.2 15.2

14.2 15.2

14.2 15.0

7+00 14.2 15.2

14.5 50 15.2

14.0 15.0

14.2 15.2

STAN 135+00 CONT EAST

DIST SOUND ELEV DIST SOUND ELEV

	15.2		(5.3) 14.0
	15.2		10:35 14.5
10+00	15.5		50 14.5
	15.5		14.5
	13.4		14.8
	14.0		14.8
	13.5		14.8
50	13.8		13+00 15.0
	13.2		14.8
	14.0		14.0
	14.5		13.0
	14.5		13.0
11+00	14.5		50 13.2
	15.0		13.2
	14.0		13.5
	14.5		13.5
	14.8		13.5
50	14.3		14+00 13.5
	14.2		14.2
	15.0		14.2
	14.6		14.6
	14.0		14.6
12+00	14.0		50 14.2
	13.2		14.8
	14.0		14.8

STAN 135+00 CONT EAST 44

DIST SOUND ELEV DIST SOUND ELEV

	15.2		15.0
	15.5		14.0
15+00	15.8		50 14.5
	15.8		14.8
	15.5		14.0
	15.0		14.8
	15.0		14.8
50	15.0		18+00 14.0
	15.8		14.2
	15.0		14.2
(5.3)	15.0		14.2
	15.0		14.2
16+00	15.2		50 14.2
	15.0	9.9	14.0
10:40	15.0	9.6	14.0
11:10	15.0	9.6	13.8
(5.4)	15.0	9.6	14.0
	15.0		14.0
50	14.2		19+00 14.5
	14.8		15.2
	14.8		15.2
	14.8		15.0
	14.2		(5.4) 15.0
	14.2		50 15.2
17+00	14.2		11:15 15.5
	15.0		15.0
	15.0		15.0
	15.0		15.0

ELY AREA CRESCENT Bay SOUND
OCT 22, 1959 WEST

STAN 135700, 0700 = W 16750.0

DIST SOUND ELEV DIST SOUND ELEV

0				12.0	
1:40	0.1	+4.7	50	12.0	
(4.8)	0.6	+4.2		12.1	
	1.1	+3.7		12.0	
	1.7	+3.1		12.0	
50	2.1	+2.7		12.3	
	2.7	+2.1	3700	12.3	
	3.5	+1.3		12.5	
	6.0	1.2		12.5	
	6.8	2.0		12.3	
1700	6.5	1.7		12.5	
	5.7	0.9	50	12.5	
	5.0	0.2		12.5	
	4.0	+0.8		12.5	
	3.2	+1.6		12.7	
50	3.2	+1.6		13.0	
	3.0	+1.8	4700	13.2	
	3.2	+1.6		13.2	
	3.1	+1.7		13.5	
	3.9	+0.9	(4.8)	13.5	
2700	9.6	4.8	1145	13.5	
	11.3	6.5	50	13.5	
	11.7	6.9		13.5	
	12.0	7.2		13.5	

STAN 135700 CONT WEST (40)

DIST SOUND ELEV DIST SOUND ELEV

	13.5			13.0	
	13.0			13.0	
5700	13.0		50	13.5	
	12.7			13.5	
	12.5			13.5	
	12.5		(4.8)	13.5	
	12.4		1150	13.5	
50	12.4		8700	13.5	
	12.2			13.5	
	12.3			13.5	
	12.3			13.5	
	12.3			13.5	
6700	12.8		50	13.5	
	12.5			13.5	
	12.5			13.5	
	12.5			13.5	
	12.5			13.6	
50	13.3		9700	13.5	
	14.0			13.5	
	14.0			13.5	
	14.0			13.5	
	13.9			13.5	
7700	13.5		50	13.5	
	12.8			13.0	
	12.8			13.0	

STAN 135400 CONT WEST

DIST	SOUND	ELEV	DIST	SOUND	ELEV
	13.0	(4.7)		14.0	
	13.0	1.55		14.0	
10400	13.0	50		14.0	
	13.0			13.8	
	12.8			13.8	
	12.7			13.8	
	12.7			13.7	
50	12.8	13400		13.5	
	12.8			13.5	
	12.9			13.7	
	12.9			14.0	
	13.0			14.1	
11400	13.1	50		14.1	
	13.1			14.2	
	13.3			14.4	
	13.2			14.3	
	13.3			14.0	
50	13.5	14400		14.1	
	13.5			14.1	
	13.5			14.0	
	13.5			13.9	
	13.5			14.0	
12400	13.6	50		14.0	
	13.5			14.0	
	13.6			14.0	

STAN 135400 CONT WEST

46

DIST	SOUND	ELEV	DIST	SOUND	ELEV
	14.0			14.0	
	14.0			14.0	
15400	13.7			13.2	
	13.2			13.0	
	13.2			13.2	
50	13.5			13.2	
	13.6			13.5	
	13.6			13.6	
	13.7			13.7	
	13.8			13.8	
16400	13.5			13.8	
	13.7			13.5	
	13.7			13.7	
	13.7			13.7	
	13.8			13.7	
50	13.9			13.8	
	14.5			13.9	
	14.7			14.5	
	14.0			14.7	
	14.0			14.0	
	14.0			14.0	
17400	14.2			14.2	
	15.0			15.0	
W18470	14.9			14.2	

See page 43.

This completes
N135400 after

Dredging 10-22-59

SEE page 43-

ELY AREA CRESENT BAY.
OCT 22, 59 (SEE PAGE 4) SOUND

STAN 134+50, 0+00 W 16730 WEST
DIST SOUND ELEV DIST SOUND ELEV

0 (See P 13 117)
page 72
11-3-59

0				11.0	6.5
(4.5)			50	11.0	6.5
2:20	0.1	+4.4		11.0	6.5
	0.5	+4.0		11.0	6.5
	1.0	+3.5		11.0	6.5
50	1.5	+3.0		11.2	6.7
	2.0	+2.5	3+00	11.5	7.0
	2.8	+1.7		11.5	7.0
	3.8	+0.7		12.0	7.5
	6.8	2.3		12.0	7.5
1400	6.5	2.0		10.8	6.3
	6.0	1.5	50	11.0	6.5
	5.0	0.5		11.8	7.3
	4.0	+0.5		11.7	
	3.0	+1.5		11.7	
50	2.8	+1.7		12.0	
	2.8	+1.7	4+00	12.0	
	2.8	+1.7		12.2	
	3.0	+1.5		12.5	
	3.0	+1.5		12.0	
2+00	3.0	+1.5		11.0	6.5
	3.8	+0.7	50	12.2	
2:25	9.8	5.3		12.0	
(4.5)	11.0	6.5		12.0	

STAN 134+50 CONT WEST

(47)

DIST SOUND ELEV DIST SOUND ELEV

			12.0			13.0
			11.8			13.0
			11.8		50	14.0
			11.5	7.0		14.0
			11.5	7.0		14.0
			(4.4) 11.5	7.0		14.0
			2:30 11.5	7.0		14.0
			50 11.5	7.0	8+00	14.0
			11.5	7.0		14.0
			12.0			14.0
			13.0			14.0
			13.0			14.0
			6+00 13.0		50	14.0
			13.0			14.0
			12.8			13.8
			13.0			13.8
			13.2			13.8
			50 13.5		9+00	13.8
			13.5			13.8
			13.5			13.5
			13.0			13.5
			13.0			13.0
			7+00 12.5		50	13.0
			12.5			13.0
			12.5			13.0

STAN 134+50 CONT WEST

DIST	SOUND	ELEV	DIST	SOUND	ELEV
(4.4)	13.0			12.5	
2:35	13.0			12.5	
10+00	12.5	50		12.5	
	12.3			12.5	
	12.0			13.0	
	12.0			13.0	
	12.0			13.0	
50	12.0	13+00		13.0	
	12.0			13.0	
	12.2			12.8	
	12.0			12.8	
	12.0			12.8	
11+00	12.0	50		12.8	
	12.0	2:40		13.0	
	12.0	(4.3)		13.8	
	12.2			14.0	
	12.2			14.2	
50	12.2	14+00		14.5	
	12.2			14.2	
	12.2			14.2	
	12.5			14.2	
	12.8			14.2	
12+00	13.2	50		14.2	
	13.2			14.2	
	13.5			14.0	

STAN 134+50 CONT WEST

48

DIST	SOUND	ELEV	DIST	SOUND	ELEV
				14.0	
				14.0	
			15+00	14.0	
				13.5	
				13.2	
				13.0	
				13.4	
			50	13.5	
				13.8	
				14.0	
				14.0	
			16+00	13.7	
				14.0	
				13.8	
				13.8	
				13.7	
			50	13.5	
				13.5	
			(4.2)	13.2	
			2:45	13.5	
				13.8	
			17+00	14.2	

SEE PAGE 41 - Completed
N134+50-10-2259

ELY CRESCENT BAY - 10-22-59

SOUND
West

STAN 134+00; 0+00 = W 76730.0

DIST SOUND ELEV DNT SOUND ELEV

0				10.6	6.5
(4.1)			50	10.8	6.7
3:00	0.1	+4.0		10.9	6.8
	0.6	+3.5		11.0	6.9
	1.1	+3.0		11.0	6.9
50	1.6	+2.5		11.4	7.3
	3.0	+1.1	3+00	11.2	7.1
	5.0	0.9		11.5	7.4
	5.5	1.1		11.3	7.2
	5.7	1.6		11.1	7.0
1400	5.0	0.9		11.0	6.9
	4.4	0.3	50	11.0	6.9
	3.5	+0.6		11.0	6.9
	2.3	+1.8		11.1	7.0
	2.3	+1.8	(4.0)	11.1	7.0
50	2.5	+1.6	3:05	11.0	7.0
	2.4	+1.7	4+00	11.0	7.0
	2.2	+1.6		11.0	7.0
	2.4	+1.7		10.9	6.9
	3.1	+1.0		10.6	6.6
2700	5.7	1.6		10.6	6.6
	9.5	5.4	50	10.6	6.6
	10.4	6.3		10.6	6.6
	10.6	6.5		10.6	6.6

STA 134+00 CONT WEST (49)

DNT SOUND ELEV DNT SOUND ELEV

	10.7	6.7		12.0	8.0
	11.0	7.0		12.0	8.0
5+00	11.0	7.0	50	11.8	7.8
	11.0	7.0		11.5	7.5
	11.1	7.1		11.7	7.7
	11.0	7.0		11.8	7.8
	11.0			12.0	8.0
50	11.0		8+00	11.8	7.8
	11.0			11.8	7.8
	11.0	7.0		11.8	7.8
	12.0	8.0		12.0	8.0
	12.1	8.1		12.0	
6+00	12.1	8.1	50	12.0	
	12.2	8.2		12.0	
	12.1	8.1		12.0	
	12.2	8.2		12.0	
	12.3	8.3		12.2	8.0
50	12.5	8.5	9+00	11.8	7.8
	13.0	9.0		12.0	8.0
	13.0	9.0		12.0	
	13.0	9.0	(4.0)	12.0	
	12.9	8.9	3:10	12.0	
7+00	12.7	8.7	50	12.0	
	12.4	8.4		12.0	
	12.1	8.1		12.0	8.0

STAN 134+00 CONT WEST

DIST	SOUND	ELEV	DIST	SOUND	ELEV
	12.0	8.0		12.9	8.9
	12.0			12.9	8.9
10+00	12.0		50	13.0	9.0
	12.0			12.8	8.8
	12.0			12.8	8.8
	12.0			12.7	8.7
	12.0			12.5	8.5
50	12.0		13+00	12.4	8.4
	12.0			12.3	8.3
	12.0			12.2	8.2
	12.0			12.1	8.1
	12.0			12.2	8.2
11+00	12.0		50	12.3	8.3
	12.0			12.3	8.3
	12.0			12.2	8.2
	12.0			12.4	8.4
	12.0			12.5	8.5
50	12.0		14+00	12.4	8.4
	12.0			12.5	8.5
	12.0	8.0		12.5	8.5
	12.1	8.1		12.4	8.4
	12.1	8.1		12.5	8.5
12+00	12.2	8.2	50	12.8	8.8
	12.5	8.5		12.7	8.7
	12.8	8.8		12.9	8.9

STAN 134+00 CONT WEST

DIST	SOUND	ELEV	DIST	SOUND	ELEV
(3.9)	13.2	9.3		12.9	9.0
3.15	13.4	9.5		12.9	9.0
15+00	13.2	9.3	15+00	13.2	9.3
	13.0	9.1		12.6	8.7
	12.6	8.7		12.3	8.4
	12.0	8.1		12.0	8.1
50	12.0	8.1	50	12.0	8.1
	12.0	8.1		11.9	8.0
	11.9	8.0		11.9	8.0
	12.0	8.1		12.0	8.1
16+00	12.0	8.1	50	12.0	8.1
	12.0	8.1		11.9	8.0
	11.9	8.0		11.9	8.0
	11.9	8.0		11.9	8.0
50	12.0	8.1	50	12.0	8.1
	12.0	8.1		12.0	8.1
	12.1	8.2		12.1	8.2
	12.1	8.2		12.2	8.3
17+00	12.4	8.5	50	12.4	8.5
	12.6	8.7		12.6	8.7
	12.8	8.9		12.8	8.9

CONT Page 39

FLY CRESENT 13A-
OCT 26, 59 MIST WEST

SOUND
WEST

STA N133+50 CONT WEST 151
10-26-59-

STA N133+50; 0+00=W/6720.0

DIST	SOUND	ELEV	DIST	SOUND	ELEV	DIST	SOUND	ELEV	DIST	SOUND	ELEV
0				10.5	7.2			6.9			11.4
9:30			50	10.5	7.2	5+00	10.3	7.0			11.4
(3.3)				10.5	7.2		10.5		50		11.3
	0.1	+3.2		10.5	7.2		10.8				11.1
	1.0	+2.3	(3.3)	10.6	7.2		10.7				11.1
50	1.6	+1.7	9:35	10.7			10.7				11.1
	3.0	+0.3	3+00	10.8			10.7				11.3
	4.5	1.2		10.8		50	10.7		8+00		11.1
	5.3	2.0		10.8			10.6				11.4
	5.0	1.7		10.7			10.7				11.3
1+00	4.2	0.9		10.7			10.9				11.3
	4.4	1.1	50	10.4			11.0				11.2
	2.0	+1.3		10.5		6+00	11.8		50		11.5
	1.8	+1.5		10.2			11.7				11.7
	2.0	+1.3		10.6			11.7				11.4
	2.0	+1.3		10.7			11.7				11.7
50	2.0	+1.3		10.4			11.7				12.0
	2.0	+1.3	4+00	10.4		50	11.7		9+00		11.5
	2.0	+1.3		10.3	7.0		11.8				11.7
	2.5	+0.8		10.2	6.9		12.4				11.4
	3.2	+0.1		10.0	6.7	(3.3)	12.3				11.5
2+00	9.3	6.0		10.1	6.8	9:40	12.2				11.5
	10.0	6.7	50	10.0	6.7	7+00	12.2		50		12.0
	10.2	6.9		10.1	6.8		12.1				12.0
	10.2	6.9		10.2	6.9		12.0				12.0

STA N133+50 CONT WEST
10-26-59

DIST	SOUND	ELEV	DIST	SOUND	ELEV
	12.0		(3.3)	12.0	
	12.0		9:45	12.1	
10+00	12.0		50	12.1	
	12.0			12.1	
	12.0			12.1	
	12.0			12.0	
	11.8			12.0	
50	11.8		13+00	12.0	
	12.0			12.0	
	11.9			12.0	
	11.9			12.0	
	11.9			12.0	
11+00	12.0		50	12.0	
	11.8			11.9	
	11.7			12.0	
	11.5			12.0	
	11.6			12.0	
50	11.6		14+00	12.3	
	11.6			12.6	
	11.8			12.5	
	11.7			12.3	
	12.0			12.2	
12+00	11.7		50	12.1	
	12.0			12.1	
	12.0			12.0	

STA N133+50 CONE WEST
10-26-59

DIST	SOUND	ELEV	DIST	SOUND	ELEV
	11.8				
	11.9				
15+00	12.0				
	(3.3)	12.0			
	9:50	12.0			
	12.0				
	12.0				
50	11.8				
	11.6				
	11.5				
	11.2				
	11.3				
16+00	11.3				
	11.5				
	11.5				
	11.3				
	11.4				
50	11.5				
	11.3				
	11.6				
	11.7				
	11.5				
118+20	11.5				
17+00	11.5				

DIRE
PIPE

FLY SHORE CRESENT BAY - SOUND EAST
OCT 26-59

STAN 133400 CONT WEST

153

STAN 133400; 0+00 = W 16720.0

DIST SOUND ELEV DIST SOUND ELEV

DIST	SOUND	ELEV	DIST	SOUND	ELEV
0			10:10	10.5	
(3.2)			50	10.5	7.3
10:05	0.2	+3.0	(3.2)	10.5	7.3
	0.3	+2.9		10.5	7.3
	1.2	+2.0		10.5	7.3
50	3.0	+0.2		10.5	7.3
	4.5	1.3	3700	10.6	7.4
	5.0	1.8		10.6	7.4
	4.5	1.3		10.6	7.4
	4.0	0.8		10.7	7.5
1700	3.0	+0.2		10.6	7.4
	2.0	+1.2	50	10.5	7.3
	2.2	+1.0		10.5	7.3
	2.2	+1.0		10.5	7.3
	2.0	+1.2		10.5	7.3
50	2.0	+1.2		10.5	7.3
	1.8	+1.4	4400	10.2	7.0
	2.5	+0.7		10.0	6.8
	4.0	0.8		10.0	6.8
	9.5	6.3		10.2	7.0
2700	10.0	6.8		10.5	
	10.0	6.8	50	10.5	
	10.2	7.0		10.2	7.0
	10.4	7.2		10.5	

DIST SOUND ELEV DIST SOUND ELEV

DIST	SOUND	ELEV	DIST	SOUND	ELEV
	10.2	7.0		11.5	
	10.6			11.5	
5700	10.5		50	11.2	
	10.5			11.0	
	10.8			11.0	
	10.8			11.0	
	10.8			11.0	
50	10.5		8700	11.2	
	10.8			11.2	
	10.5			11.2	
	10.5			11.2	
	10.9			11.2	
	12.0		50	11.5	
	12.0			11.2	
	12.0			11.2	
	12.0			11.5	
	12.0			11.8	
50	12.0		9700	11.8	
	12.0			11.8	
	12.0			11.8	
	12.2		(3.2)	11.8	
	12.3			11.8	
	12.3		7400	12.0	
	12.0		50	12.0	
	12.0			12.0	
	12.0			12.0	

STA N133+00 CONT WEST

DIST	SOUND	ELEV	DIST	SOUND	ELEV
	12.0			12.0	
	12.0			12.5	
10+00	12.0		50	12.5	
	12.0			12.2	
	12.0			12.2	
	12.0		(3.2)	12.2	
	12.0		10+20	12.2	
50	12.2		13+00	12.2	
	12.2			12.2	
	12.2			12.2	
	12.0			12.0	
	12.0			12.0	
11+00	12.0		50	12.0	
	12.0			12.0	
	12.0			12.0	
	11.8			12.2	
	11.8			12.5	
50	11.8		14+00	12.5	
	11.5			12.5	
	11.5			12.5	
	11.8			12.5	
	11.8			12.5	
12+00	11.8		50	12.5	
	11.8			12.6	
	11.8			12.8	

STA N133+00 CONT WEST

154

DIST	SOUND	ELEV
	12.8	
	12.8	
15+00	12.8	
	12.5	
	12.5	
	12.5	
	12.5	
	12.5	
50	12.5	
	12.5	
	12.0	
	12.0	
	12.0	
16+00	12.0	
	12.0	
	12.0	
	12.0	
	12.0	
50	12.0	
	12.0	
	12.2	
(3.2)	12.2	
10+25	12.2	
W18420	12.2	
17+00	12.2	

DREDGE PIPE

ELY SHOKE CRESENT BAY
OCT 26, 59 SOUND

STAN N132+50 CONT WEST 151

STAN N132+50, 0+10=2W 16710.0 WEST

DIST SOUND ELEV DIST SOUND ELEV

DIST SOUND ELEV DIST SOUND ELEV

0 10.2

50 10.2

10:30 0.6 +2.5 10.2

(3.1) 0.7 +2.4 10.3

1.0 +2.1 10.2

50 2.5 +0.6 10.3

4.0 0.9 3700 10.3

5.1 2.0 10.3

4.3 1.2 10.2

4.1 1.0 10.4

1700 3.6 0.5 10.4

(3.1) 3.2 0.1 50 10.4

10:45 1.2 +1.2 10.5

1.3 +1.8 10.6

1.6 +1.5 10.7

50 1.4 +1.7 10.8

3.0 +0.1 4700 10.4

8.2 5.8 10.6

9.6 6.5 10.1 7.0

10.0 6.9 10.1 7.0

2400 9.2 6.8 10.1 7.0

9.8 6.7 50 10.1 7.0

10.1 7.0 (3.1) 10.1 7.0

10.1 7.0 10:50 10.1 7.0

10.2 11.0

10.2 10.9

5700 10.2 50 10.8

10.2 10.7

10.2 10.8

10.2 10.8

10.1 7.0 10.9

50 10.2 6.9 8700 10.9

10.2 6.9 11.0

9.9 6.8 11.0

9.9 6.8 11.0

11.0 11.1

6700 11.0 50 11.0

11.2 11.0

11.5 11.0

11.6 11.2

11.6 11.2

50 11.5 9700 11.1

11.6 11.2

11.7 11.3

12.1 11.7

12.2 12.0

7700 12.2 50 12.2

12.1 12.2

11.2 12.3

STAN 132450 CONT WEST
10-26-59

DIST	SOUND	ELEV	DIST	SOUND	ELEV
10:55	12.1			12.2	
(3.1)	12.2			12.1	
10:00	12.2		50	12.2	
	12.2			12.0	
	12.2			12.2	
	12.1			12.1	
	11.2			12.2	
50	11.8		13:00	12.1	
	11.2			12.2	
	11.8			12.0	
	11.6			12.0	
	11.2			12.1	
11:00	11.8		50	12.1	
	11.8			12.1	
	11.4			12.1	
	11.5			12.1	
	11.6			12.1	
50	11.7		14:00	12.1	
	11.2			12.1	
	11.2			12.1	
	12.0			12.1	
	12.0			12.1	
12:00	12.0		50	12.1	
	12.2			12.1	
	12.2			12.1	

STAN 132450 CONT WEST 156
10-26-59

DIST	SOUND	ELEV	DIST	SOUND	ELEV
	12.1			12.1	
	12.1			12.1	
15:00	12.1			12.1	
	12.1			12.1	
	12.1		(3.0)	12.1	
11:00	12.0			12.0	
50	11.8			11.8	
	11.2			11.2	
	11.6			11.6	
	11.6			11.6	
	11.4			11.4	
16:00	11.3			11.3	
	11.2			11.2	
	11.2			11.2	
	11.2			11.2	
	11.4			11.4	
50	11.9			11.9	
	11.6			11.6	
	12.1			12.1	
	11.8			11.8	
	11.8			11.8	
17:00	12.0			12.0	
	12.2			12.2	

ELY SHORE CRESCENT BAY - SOUND WEST
OCT 26, 59

STA N/132+00 CONT WEST 57

STAN 132+00; 0+100 = W/67/10.0

DNT SOUND ELEV DNT SOUND ELEV

DNT SOUND ELEV DNT SOUND ELEV

0

10.1 7.1

10.8 7.8

11.5 8.5

50 10.3 7.3

5+00 11.0 8.0

50 11.3 8.3

10.4 7.4

11.0 8.0

11.0 8.0

3.0

10.2 7.2

11.2 8.2

11.0 8.0

11.15

10.5 7.5

11.2 8.2

3.0

11.0 8.0

50

4.0 1.0

10.2 7.2

10.8 7.8

11.20

11.0 8.0

4.5 1.5

3+00

10.1 7.1

50

10.9 7.9

8+00

11.0 8.0

4.5 1.5

10.1 7.1

11.1 8.1

11.1 8.1

4.0 1.0

10.2 7.2

11.1 8.1

10.8 7.8

4.0 1.0

10.5 7.5

11.7 8.7

10.7 7.7

1+00

3.2 0.2

10.5 7.5

11.2 8.2

10.6 7.6

2.8 +0.2

50

10.5 7.5

6+00

12.0 9.0

50

10.7 7.7

2.0 +1.0

10.7 7.7

12.1 9.1

10.7 7.7

1.8 +1.2

10.8 7.8

12.0 9.0

10.8 7.8

5.5 2.5

11.0 8.0

12.1 9.1

11.0 8.0

50

9.0 6.0

10.8 7.8

13.0 10.0

12.0 9.0

9.1 6.1

4+00

10.4 7.4

50

12.8 9.8

9+00

12.0 9.0

9.5 6.5

10.0 7.0

13.0 10.0

12.1 9.1

9.5 6.5

9.9 6.9

12.9 9.9

12.0 9.0

9.6 6.6

10.0 7.0

12.8 9.8

12.1 9.1

2+00

9.8 6.8

10.1 7.1

12.4 9.4

12.5 9.5

10.0 7.0

50

10.2 7.2

7+00

12.0 9.0

50

12.5 9.5

10.1 7.1

10.4 7.4

11.8 8.8

12.7 9.7

10.2 7.2

10.2 7.2

11.5 8.5

13.0 10.0

STAN 132400 CONT WEST

STAN 132400 CONT WEST

58

DIST	SOUND	ELEV	DIST	SOUND	ELEV	DIST	SOUND	ELEV	DIST	SOUND	ELEV
	13.0	10.0		14.0	11.0		12.5	9.5			
	13.0	10.0		14.0	11.0		12.8	9.8			
10400	13.0	10.0	50	14.0	11.0	15400	12.6	9.6			
	13.0	10.0		14.0	11.0		12.5	9.5			
	12.9	9.9		14.0	11.0		12.1	9.1			
	12.8	9.8		14.0	11.0		12.1	9.1			
	12.5	9.5		13.9	10.9		12.0	9.0			
50	12.0	9.0	13400	13.9	10.9	50	11.7	8.7			
	13.0	10.0		13.8	10.8		11.8	8.8			
	13.0	10.0		13.5	10.5		11.8	8.8			
	13.1	10.1		13.4	10.4		11.5	8.5			
	13.1	10.1		13.4	10.4		11.5	8.5			
11400	11.4	8.4	50	12.4	9.4	16400	11.4	8.4			
	11.8	8.8		11.1	8.1		11.1	8.1			
	13.0	10.0		11.0	8.0		11.5	8.5			
	12.4	9.4		11.5	8.5		12.0	9.0			
	12.0	9.0		12.5	9.5		12.0	9.0			
50	12.1	9.1	14400	12.0	9.0	50	11.5	8.5			
	13.0	10.0		11.9	8.9		11.7	8.7			
	13.0	10.0		11.5	8.5		11.6	8.6			
(3.0)	12.8	9.8		11.4	8.4	(3.0)	11.7	8.7			
11:25	13.3	10.3		11.5	8.5	11:30	11.5	8.5			
12400	13.5	10.5	50	12.1	9.1	17400	12.0	9.0			
	14.0	11.0		12.1	9.1		12.5	9.5			
	14.0	11.0		12.1	9.1						

ELY SHARP CRESENT BAY -
See page 28 - OCT 29, 59

SOUND
WEST

STAN 13/1+50 CONT WEST 159
10-29-59

STAN 13/1+50; 0+00 = W 1660.0

DIST	SOUND	ELEV	DIST	SOUND	ELEV
0				11.8	6.8
(5.0)			50	11.8	6.8
9:20	0.5	+4.5		11.8	6.8
	1.0	+4.0		11.8	6.8
	1.5	+3.5		11.8	6.8
50	2.0	+3.0		12.0	7.0
	2.3	+2.7	3+00	12.0	7.0
	3.0	+2.0		12.5	7.5
	3.5	+1.5		12.5	7.5
	5.2	0.2	(4.9)	13.0	
1+00	6.0	1.0	9:25	13.0	
	6.5	1.5	50	13.0	
	6.5	1.5		13.0	
	6.5	1.5		13.0	
	5.5	0.5		13.0	
50	5.0	0.0		13.0	
	4.0	+1.0	4+00	13.0	
	4.0	+1.0		13.0	
	4.2	+0.8		13.0	
	9.2	4.2		13.0	
2+00	11.2	6.2		12.5	
	11.5	6.5	50	12.0	
	11.8	6.8		12.0	
	11.8	6.8		12.0	

DIST	SOUND	ELEV	DIST	SOUND	ELEV
	11.5	6.6		13.0	
	11.8	6.9		13.0	
5+00	13.0		50	13.0	
	13.5			13.0	
	13.2			13.0	
	13.5		(4.8)	13.0	
	13.0		9:30	13.0	
50	13.0		8+00	13.0	
	13.0			13.0	
	13.0			13.0	
	12.5			13.0	
	12.5			13.0	
6+00	12.5		50	12.8	
	13.0			12.5	
	13.0			12.5	
	13.0			12.0	
	13.5			12.0	
50	13.2		9+00	12.0	
	13.2			12.0	
	13.0			12.0	
	13.0			12.0	
	12.8			12.0	
7+00	12.8		50	12.0	
	13.0			12.2	
	13.0			12.5	

STAN 131 + 50 CONT WEST
10-29-59

DIST	SOUND	ELEV	DIST	SOUND	ELEV
	12.8			13.8	
	12.8			13.8	
10400	13.0		50	13.9	
	12.8			14.0	
	13.0			14.0	
	13.0			14.0	
50	13.0		13400	13.5	
	13.0			13.0	
	13.0			13.0	
	13.0			13.0	
	13.0			13.0	
11400	13.0		50	13.0	
	13.0			13.0	
	13.0			13.0	
	13.0			13.0	
	13.0			13.0	
50	13.0		14410	12.5	
	13.0			13.0	
	13.0			13.0	
(4.7)	13.0			13.0	
9:35	13.2			12.5	
12400	13.5		50	13.0	
	13.5			13.0	
	13.5			13.0	

STAN 131 + 50 CONT WEST
10-29-59

(60)

DIST	SOUND	ELEV	DIST	SOUND	ELEV
	(4.6)			13.0	
	9:40			13.0	
	15400		50	13.0	
				13.0	
				13.0	
				13.0	
			50	13.0	
				13.0	
				13.0	
				12.5	
				12.8	
			16400	12.8	
				12.5	
				12.5	
				12.5	
				12.5	
			50	12.5	
				12.5	
				12.5	
				12.5	
				12.5	
			W/8360	12.5	
			17400	12.5	

SEE PAGE 28

ELY SHORE OREJENT BAY.

SEE PAGE 26
Nov. 2, 59.

SOUND

STAN 131400 CONT WEST
11-2-59.

(61)

STAN 131400; 0+0=W 16730.0 WEST

DIST SOUND ELEV DIST SOUND ELEV.

DIST SOUND ELEV DIST SOUND ELEV

0 0.0 +1.6 9.2 7.6

2:00 1.5 +0.1 50 9.2 7.6

(1.6) 2.8 1.2 10.0 8.4

3.2 1.6 10.0 8.4

3.2 1.6 9.5 7.9

50 3.0 1.4 9.5 7.9

3.0 1.4 3+00 10.0 8.4

2.8 1.2 10.2 8.6

1.2 +0.4 10.5 8.9

0.8 +0.8 10.5 8.9

1400 0.8 +0.8 9.5 7.9

6.0 4.4 50 8.2 6.6

8.0 6.4 8.0 6.4

8.2 6.6 8.2 6.6

8.2 6.6 (1.5) 8.0 6.4

50 8.2 { 2:05 8.0 6.5

8.2 { 4+00 8.0 6.5

8.2 { 7.8 6.3

8.5 6.9 8.0 6.5

9.0 7.4 9.0 7.5

2400 9.2 7.6 9.8 8.3

9.0 7.4 50 9.8 {

9.2 7.6 10.0 {

9.2 7.6 10.0 {

9.5 {

9.5 {

5+00 9.5 {

9.5 {

9.5 {

9.5 {

9.8 {

50 9.5 {

9.8 {

9.8 {

9.8 {

9.5 {

6+00 9.5 {

9.5 {

9.5 {

9.5 {

9.5 {

50 9.5 {

9.2 {

9.0 {

9.2 {

9.5 {

7+00 9.5 {

9.8 {

9.8 {

9.5 {

9.5 {

50 9.2 {

2:10 9.2 {

(1.4) 9.2 {

9.2 {

9.2 {

8+00 9.2 {

9.2 {

9.2 {

9.2 {

9.5 {

50 9.7 {

9.7 {

9.5 {

9.5 {

9.5 {

9+00 9.5 {

9.7 {

9.8 {

10.0 {

10.0 {

50 10.0 {

10.0 {

10.2 {

OK

OK

ELY CRESENT BAY area
SEE PAGE 23-
11-2-59

SOUND

STAN 130+50 CONT WEST (63)
11-2-59

STAN 130+50, 0+100=W 16710.0 WEST

DIST SOUND ELEV DIST SOUND ELEV

DIST	SOUND	ELEV	DIST	SOUND	ELEV
0				9.0	
(1.0)			50	9.0	
2:30	0.2	+0.8		9.0	
	1.3	0.3		9.0	
	2.0	1.0		9.0	
50	1.9	0.9		9.0	
	2.1	1.1	3+00	9.0	
	2.1	1.1		9.0	
	2.0	1.0		9.0	
	1.3	0.3		9.5	
1400	1.5	0.5		9.7	
	3.0	2.0	50	10.0	
	6.9	5.1		7.8	6.8
	7.9	6.9		6.9	5.9
	8.0	7.0		6.8	5.8
50	8.1	7.1		6.7	5.7
	8.1		4+00	6.3	5.3
	8.2			6.3	5.3
	8.3			6.5	5.5
	8.2			6.3	5.3
2+00	8.4			7.5	6.5
	8.9		50	7.6	6.6
	8.6			9.1	8.1
	8.9			9.5	8.5

DIST SOUND ELEV DIST SOUND ELEV

DIST	SOUND	ELEV	DIST	SOUND	ELEV
(0.9)	8.9	8.0		8.7	
2:35	8.8			9.0	
5+00	9.0		50	9.0	
	9.0			8.8	
	8.0			8.8	
	8.5			9.0	
	8.6			9.0	
50	9.0		8+00	9.1	
	8.5			9.0	
	8.7			9.0	
	9.0			9.0	
	9.0			9.0	
	9.0		50	9.1	
	9.0			9.3	
	8.9			9.2	
	8.9			9.3	
	8.8			9.3	
50	8.8		9+00	9.3	
	8.8			9.2	
	9.0			9.2	
	9.0		(0.8)	9.5	
	9.0		2:40	9.4	
	9.0		50	9.5	
	9.1			9.4	
	9.2			9.4	

STAN 130+50 CONT WEST
11-2-59

DIST	SOUND	ELEV	DIST	SOUND	ELEV
	9.5			10.0	
	9.5			10.0	
10+00	9.5		50	9.9	
	9.6			9.5	
	9.6			9.3	
	9.6			9.3	
	9.6			9.0	
50	9.7		13+00	9.1	
	9.8			9.0	
	10.0			9.0	
	9.9	OK		9.0	OK
	10.0			9.1	
11+00	9.9		50	9.1	
	9.9			8.8	
	10.0			8.9	
	10.0			9.0	
	10.1			9.0	
50	10.1		14+00	8.9	
	10.0			9.0	
	10.0			9.0	
	10.1			9.0	
	10.2			9.2	
12+00	10.1		50	9.0	
	10.1			9.0	
	10.0			9.0	

STAN 130+50 CONT WEST 164

DIST	SOUND	ELEV
	8.9	
	9.0	
15+00	8.7	OK
	8.9	OK
(0.7)	8.9	
2+45	8.5	
N18260	8.6	
50	8.7	

16+00

50

17+00

ELY CRESCENT BAY -

SEE PAGE 21

NOV 2, 59.

SOUND

STAN 130 + 100 CONT WEST

165

11-2-59.

STAN 130 + 100; 0 + 100 = W 16700.0 WEST

DIST SOUND ELEV DIST SOUND ELEV

DIST	SOUND	ELEV	DIST	SOUND	ELEV
0				8.0	7.4
			50	8.0	{
(0.6)				8.0	{
2.50	0.5	+0.1		8.0	{
	1.0	0.4	(0.5)	8.5	8.0
50	1.8	1.2	2.55	8.5	8.0
	2.0	1.4	3+00	9.0	8.5
	2.0	1.4		9.2	8.7
	1.8	1.2		9.5	9.0
	1.5	0.9		9.5	{
1+00	1.0	0.4		9.5	{
	3.5	2.9	50	9.5	{
	7.0	6.4		7.0	6.5
	7.0	6.4		7.0	{
	7.2	6.6		7.0	{
50	7.0	6.4		7.0	{
	7.2	6.6	4+00	7.0	{
	7.2	{		7.0	{
	7.2	{		7.0	{
	7.2	{		7.2	6.7
2+00	7.5	6.9		7.8	7.3
	7.5	{	50	9.5	9.0
	7.5	{		9.0	8.5
	8.0	7.4		9.2	8.7

DIST	SOUND	ELEV	DIST	SOUND	ELEV
	9.0	8.5		9.0	8.5
	9.0	{		9.0	{
5+00	9.0	{	50	9.0	{
	8.8	8.3		9.0	{
	9.0	8.5		8.8	8.3
	8.8	8.3		9.0	8.5
	9.0	8.5		9.0	8.5
50	9.0	{	8+00	9.2	8.7
	9.0	{		9.2	8.7
	9.0	{		8.0	7.5
	9.0	{	(0.4)	9.0	8.6
	9.0	{	3+00	9.2	8.8
6+00	9.0	{	50	9.2	{
	9.0	{		9.2	{
	9.0	{		9.2	{
	9.0	{		9.3	8.9
	9.0	{		9.4	9.0
50	9.0	{	9+00	9.2	8.8
	9.0	{		9.0	8.6
	9.0	{		9.0	{
	8.8	8.3		9.0	{
	9.0	8.5		9.0	{
7+00	9.0	{	50	9.2	8.8
	9.0	{		9.2	8.8
	9.0	{		9.5	9.1

RE SOUND ELY OF SANTA CLARA
EXTENSION - 10-27-59

SOUND
EAST

STA N 12200, 0+00 = W 19120

DIST SOUND ELEV DIST SOUND ELEV

0 8.8 6.4

(2.4) 50 8.8 6.4

11:40 0.5 + 1.9

2.8 0.4

4.0 1.6

50 5.8 2.4

6.2 3.8

7.2 4.8

7.3 4.9

7.8 5.4

1400 8.2 5.8

8.5 6.1

8.5 6.1

8.5 6.1

11:45 8.5 6.1

50 8.5 6.1

8.5 6.1

8.8 6.4

9.0 6.6

9.0 6.6

2+00 9.0 6.6

9.0 6.6

9.0 6.6

8.8 6.4

RE SOUND ELY OF SANTA CLARA EXT
10-27-59

167
SOUND
EAST

STA N 12100, 0+00 = W 19170.0

DIST SOUND ELEV DIST SOUND ELEV

0 9.7 7.2

(2.8) 50 9.7 7.2

0.8 + 1.7

50 1.5 + 1.0

2.5 0.0

4.0 1.5

5.0 2.5

6.0 3.5

1400 7.0 4.5

7.5 5.0

7.8 5.3

8.0 5.5

8.2 5.7

50 8.8 6.3

9.0 6.5

9.2 6.7

9.2 6.7

9.2 6.7

2400 9.5 7.0

9.5 7.0

9.7 7.2

9.7 7.2

RESOUND ELY OF SANTA CLARA EXT

10-27-59

SOUND
EAST

STAN 12000; 0+100=W 19180.0

DIST SOUND ELEV DIST SOUND ELEV

0

10.1 7.5

(2.6)

50 10.1 7.5

1.0 +1.6

2.2 +0.4

50 4.2 1.6

50 5.2 2.6

6.0 3.4 3+00

6.7 4.1

7.3 4.7

8.2 5.6

1400 9.2 6.6

9.6 7.0

9.6 7.0

9.8 7.2

10.0 7.4

50 10.2 7.6

10.5 7.9

10.5 7.9

10.5 7.9

10.7 8.1

2400 10.7 8.1

10.5 7.9

10.2 7.6

10.1 7.5

RESOUND ELY OF SANTA CLARA EXT

10-27-59

68
SOUND
EAST

STAN 11940; 0+100=W 19170.0

DIST SOUND ELEV DIST SOUND ELEV

0

10.5 7.9

(2.6)

0.0 +2.6 50 10.5 7.9

0.9 +1.7

1.5 +0.9

2.0 0.6

50 4.0 1.4

7.5 4.9 3+00

9.0 6.4

10.3 7.7

10.5 7.9

1400 10.5 7.9

10.7 8.1

10.5 7.9

10.5 7.9

10.5 7.9

50 10.5 7.9

10.4 7.8

10.3 7.7

10.3 7.7

10.4 7.8

2400 10.5 7.9

10.5 7.9

10.5 7.9

10.5 7.9

RESOUND ELY OF SANTA CLARA
10-27-59. SOUND EAST

STAN 118400; 0+00=W 19150.0

DIST SOUND ELEV DIST SOUND ELEV

0 11.0 8.4
 (2.6) 50 10.9 8.3

0.3 +2.3

1.0 +1.6

1.7 +0.9

50 2.2 +0.4

4.0 1.4

6.9 4.3

8.0 5.4

8.8 6.2

1400 9.2 6.6

9.5 6.9

9.8 7.2

10.0 7.4

10.1 7.5

50 10.0 7.4

10.1 7.5

10.1 7.5

10.0 7.4

10.0 7.4

2400 10.0 7.4

10.0 7.4

10.2 7.6

10.5 7.9

RESOUND ELY OF SANTA CLARA (69)
10-27-59 SOUND EAST

STAN 117400; 0+00=W 19130.0

DIST SOUND ELEV DIST SOUND ELEV

0 11.0 8.4
 (2.6) 50 11.0 8.4

0.4 +2.2

1.1 +1.5

1.8 +0.8

50 2.4 +0.2

3.2 0.6

6.5 3.9

8.5 5.9

9.2 6.6

1400 10.0 6.4

9.5 6.9

9.7 7.1

9.8 7.2

9.9 7.3

50 10.3 7.7

10.4 7.8

10.2 7.6

10.2 7.6

10.5 7.9

2400 10.2 7.6

10.3 7.7

10.7 8.1

10.7 8.1

RESOUND ELYON SANTA CLARA
10-27-59

STAN 116400; 0400 = W 19100.0 EAST

DIST SOUND ELEV DIST SOUND ELEV

0				11.4	8.7
(2.6)	0.2	+2.2	50	11.4	8.7
	0.6	+2.0			
	1.5	+1.1			
50	2.0	+0.6			
	2.5	+0.1			
	3.0	0.4			
(2.7)	5.9	3.2			
	8.9	6.2			
	9.6	6.9			
1400	7.8	7.1			
	10.2	7.5			
	9.9	7.2			
	10.0	7.3			
	10.0	7.3			
50	10.0	7.3			
	10.0	7.3			
	9.9	7.2			
	10.0	7.3			
	10.2	7.5			
2400	11.0	8.3			
	11.4	8.7			
	11.5	8.8			
	11.4	8.7			

RESOUND ASHER COVE - 10-27-59 (70)

OCT 27, 59

STAN 118400; 0400 = W 19900.0 EAST

DIST SOUND ELEV

0		
(3.1)		
	0.1	+3.0
	1.1	+2.0
50	1.8	+1.3
	2.5	+0.6
	2.8	+0.3
	3.0	+0.1
	3.0	+0.1
1400	4.0	0.9
	4.8	1.7
	4.8	1.7
	4.4	1.3
	4.0	0.9
50	3.7	0.6
	3.4	0.3
	3.3	0.2
	3.0	+0.1
	3.0	+0.1
2400	2.4	+0.7
	2.1	+1.0
	1.6	+1.5

RESOUND ASHER COVE
OCT 27, 59

SOUND
EAST

STAN 119 + 00; 0 + 00 = W 19920.0

DIST SOUND ELEV DIST SOUND ELEV

0			4.5	1.3	
(3.1)		50	4.1	1.9	
	0.3	+2.8	3.2	0.0	
	2.0	+1.1	2.5	+0.7	
	3.0	+0.1	1.1	+2.1	
50	5.7	2.5			
(3.2)	6.9	3.7	3+00		
50	7.8	4.6			
50	8.0	4.8			
50	8.7	5.5			
1400	11.5	8.3			
	11.5	8.3			
	11.5	8.3			
	11.8	8.6			
	12.0	8.8			
50	12.0	8.8			
	12.0	8.8			
	12.0	8.8			
	12.0	8.8			
	11.9	8.7			
2400	11.8	8.6			
	11.9	8.7			
	6.5	3.3			
	6.2	3.0			

RESOUND ASHER COVE
OCT 27, 59

(71)
SOUND
EAST

STAN 120 + 00; 0 + 00 = W 19950.0

DIST SOUND ELEV DIST SOUND ELEV

0			13.0	9.6	
(3.3)		50	10.7	7.3	
	0.0	+3.3	(3.4)	6.8	3.4
	0.5	+2.8		5.5	2.1
	1.3	+2.0		4.8	1.4
50	2.2	+1.1		3.8	0.4
	2.9	+0.4	3+00	2.5	+0.9
	4.0	0.7		2.0	+1.4
	7.2	3.9		1.0	+2.4
(3.4)	11.5	8.1			
1400	12.7	9.3			
	12.8	9.4			
	12.6	9.2			
	12.7	9.3			
	12.8	9.4			
50	12.5	9.1			
	12.7	9.3			
	12.9	9.5			
	13.0	9.6			
	13.1	9.7			
2400	13.1	9.7			
	12.8	9.4			
	13.2	9.8			
	13.0	9.6			

RESOUND FISHER COVE 10-27-59			SOUND EAST		
STAN 121400; 0400-W 19970.0					
DIST	SOUND	ELEV	DIST	SOUND	ELEV
0				14.0	10.6
(3.4)			50	13.8	10.4
	0.5	+2.9		13.8	10.4
	1.5	+1.9		13.8	10.4
	1.8	+1.6		8.0	4.6
50	2.5	+0.9		6.2	2.8
	3.5	0.1	3400	5.5	1.1
	5.5	2.1		4.2	0.8
	7.8	4.4		2.7	+0.7
	8.9	5.5		2.0	+1.4
1400	12.0	8.6		0.8	+2.6
	12.0	8.6	50		
	12.5	9.1			
	13.0	9.6			
	13.4	10.0			
50	13.5	10.1			
	13.8	10.4	4400		
	13.8	10.4			
	13.8	10.4			
	13.4	10.0			
2400	13.0	9.6			
	13.4	10.0			
	13.4	10.0			
	13.4	10.0			

RESOUND FISHER COVE 10-27-59			SOUND EAST		
STAN 122400; 0400-W 20000.0					
DIST	SOUND	ELEV	DIST	SOUND	ELEV
0				13.0	9.4
(3.6)			50	12.5	8.9
	0.5	+3.1		12.5	8.9
	1.2	+2.4		12.5	8.9
	2.0	+1.6		12.5	8.9
50	2.8	+0.8		12.5	8.9
	3.2	+0.4	3400	10.0	6.4
	4.2	0.6		5.5	1.9
	5.5	1.9		5.0	1.4
	6.2	2.6		4.0	0.4
1400	7.2	3.6		3.2	+0.4
	8.0	4.4	50	2.2	+1.4
	10.5	6.9		1.2	+2.4
	12.5	8.9			
	13.5	9.9			
50	14.0	10.4			
	14.0	10.4	4400		
	14.0	10.4			
	14.0	10.4			
	14.0	10.4			
2400	13.5	9.9			
	13.5	9.9			
	13.0	9.4			
	13.0	9.4			

RE SOUND ASHER COVE 10-27-59						SOUND
STATION 123400; 0400=W 20030.0 EAST						
DIST	SOUND	ELEV	DIST	SOUND	ELEV	
0				12.5	8.8	
(3.7)			50	12.5	8.8	
	0.3	+3.4		12.0	8.3	
	1.2	+2.5		12.0	8.3	
	2.2	+1.5		12.0	8.3	
50	3.0	+0.7		11.5	7.8	
	3.5	+0.2	3400	11.0	7.3	
	4.8	1.1		11.0	7.3	
	6.0	2.3		10.8	7.1	
	7.0	3.3		10.2	6.5	
1400	7.7	4.0		9.0	5.3	
	8.0	4.3	50	5.0	1.3	
	9.0	5.3		3.5	+0.2	
	11.5	7.8		3.5	+0.2	
	12.2	8.5		2.5	+1.2	
50	12.2	8.5		1.5	+2.2	
	13.2	8.5	4400			
	12.8	9.1				
	12.8	9.1				
	12.8	9.1				
2400	12.8	9.1				
	12.5	8.8	50			
	12.5	8.8				
	12.5	8.8				

RE SOUND ASHER COVE 10-27-59						SOUND
STATION 124400; 0400=W 20060 EAST						
DIST	SOUND	ELEV	DIST	SOUND	ELEV	
0				13.5	9.8	
			50	13.5	9.8	
(3.7)	0.2	+3.5		13.0	9.3	
	1.0	+2.7		13.0	9.3	
	1.2	2.5		13.0	9.3	
50	1.2	+2.5		13.0	9.3	
	2.2	+1.5	3400	13.0	9.3	
	3.0	+0.7		13.0	9.3	
	4.0	0.3		13.0	9.3	
	6.0	2.3		12.8	9.1	
1400	7.2	3.5		12.0	8.3	
	9.0	5.3	50	11.8	8.1	
	10.8	7.1		10.0	6.3	
	12.8	9.1		6.0	2.3	
	13.0	9.3		2.0	+1.7	
50	13.0	9.3		1.8	+1.9	
	13.0	9.3	4400	1.5	+2.2	
	13.0	9.3		1.2	+2.5	
	13.0	9.3		0.8	+2.9	
	13.0	9.3				
2400	13.0	9.3				
	13.0	9.3	50			
	13.0	9.3				
	13.5	9.8				

RESOUND ASHER COVE
10-27-59

SOUND
EAST

STAN 125400; 0+00=W 20100.0

DIST	SOUND	ELEV	DIST	SOUND	ELEV
0				13.5	9.7
			50	13.5	9.7
(3.8)	0.4	+3.4		14.0	10.2
	1.0	+2.8		14.0	}
	2.0	+1.8		14.0	
50	2.5	+1.3		14.0	
	3.5	+0.3	3+00	14.0	
	4.2	0.4		13.0	
	5.2	1.4		13.0	9.2
	6.2	2.4		12.5	8.7
1+00	8.0	4.2		12.0	8.2
	10.0	6.2	50	12.0	8.2
	10.5	6.7		12.0	8.2
	11.5	7.7		11.5	7.7
	13.0	9.2		10.0	6.2
50	14.0	10.2		10.0	6.2
	14.0	10.2	4+00	9.0	5.2
	14.0	10.2		3.5	+0.3
	14.0	10.2		0.2	+3.6
	14.0				
2+00	14.0				
	14.0		50		
	14.0				
	13.5	9.7			

RESOUND ASHER COVE
10-27-59

(64)
SOUND
EAST

STAN 126400; 0+00=W 20150.0

DIST	SOUND	ELEV	DIST	SOUND	ELEV
0				14.1	10.1
			50	14.0	10.0
(3.9)	0.8	+3.1		13.9	9.9
	1.6	+2.3		13.9	9.9
	2.1	+1.8		13.9	9.9
50	3.0	+0.9		13.5	9.5
	4.1	0.2	3+00	13.5	9.5
	5.2	1.3		13.4	9.4
	5.6	1.7		12.7	8.7
	6.2	2.3		12.0	8.0
1+00	6.7	2.7		12.5	8.5
	(4.0)	7.7	50	12.7	8.7
	9.1	5.1		12.5	8.5
	9.9	5.9		12.4	8.4
	10.3	6.3		12.5	8.5
50	10.5	6.5		12.4	8.4
	11.0	7.0	4+00	12.4	8.4
	11.3	7.3		12.3	8.3
	12.0	8.0		12.3	8.3
	11.8	7.8		12.0	8.0
2+00	14.0	10.0		12.1	8.1
	14.4	10.4	50	11.5	7.5
	14.5	10.5		6.0	2.0
	14.3	10.3		2.0	+2.0

STAN 126+00 Cont East

DIST.	SOUND	ELEV.
(4.0)	1.5	+2.5
	1.0	+3.0
5+00	0.5	+3.5

NWLY AREA PRESENT 1344- (75)
OCT 29, 59

X-sec

STAN 137+00; 0+00 = W 20390. EAST

STA	ELEV
E 0+00	7.7
E 0+10	7.3
E 0+20	6.5
E 0+30	5.1
E 0+40	4.0
E 0+50	3.3
E 0+60	2.8
E 70	2.2
E 80	1.8

STAN 137+50; 0+00 = W 20390.0 EAST X-sec

STA	ELEV
0	7.6
E 10	7.1
E 20	6.1
E 30	4.8
E 40	3.7
E 50	3.4
E 60	2.9
E 70	2.3
E 80	1.8
E 90	1.1

NWLY AREA CEMENT BAY
10-29-59

STA N138+00; 0+00 = 20390.0

X-sec
EAST

STA	ELEV
0	7.9
E10	7.3
E20	5.8
E30	4.7
E40	4.0
E50	3.7
E60	3.0
E70	2.3
E80	1.9
E90	1.3

10-29-59
STA N138+50; 0+00 = W 20390.0

X-sec
EAST

STA	ELEV
0	7.7
E10	6.7
E20	5.3
E30	4.1
E40	3.8
E50	3.5
E60	3.2
E70	2.9
E80	2.7
E90	2.5
E100	2.4

STA N138+50 CONT EAST

(76)

STA	ELEV
E110	2.3
E120	2.3
E130	2.2
E140	1.8

STA N139+00; 0+00 = W 20400

X-sec
EAST

STA	ELEV
0	7.2
E10	5.4
E20	5.1
E30	4.1
E40	3.6
E50	3.2
E60	3.0
E70	2.9
E80	2.8
E90	2.8
E100	2.6
E110	2.4
E120	2.3
E130	2.2
E140	2.0
E150	1.7
E160	1.5
E170	1.1 = W 20230

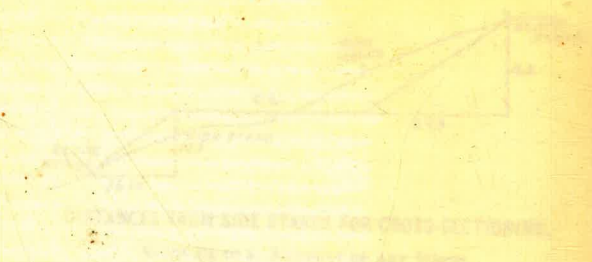

AMERICAN ENGINEERING STANDARDS SOCIETY

NO.	DESCRIPTION	DATE
1
2
3
4
5
6
7
8
9
10
11
12
13
14
15
16
17
18
19
20
21
22
23
24
25
26
27
28
29
30
31
32
33
34
35
36
37
38
39
40
41
42
43
44
45
46
47
48
49
50

Copyright © 1917 by American Engineering Standards Society

Faint, illegible text or markings on the right page, possibly bleed-through from the reverse side of the paper.