



Construction Notes,

Dulzyna Conduit,

Recrd. Camp Office
Chief Engineer.

MICROFILMED

JAN 6 1965

Diagram Tunnel #6	73
Tunnel BMS	73
197' Flume	74
Diagram # (Turn-table) Tunnel	74
Resurvey $\frac{1}{2}$ Tunnel	75
Plot $\frac{3}{16}$ (Cable) Tunnel	75

Index

	Page.
TRAILS - July 15 - Aug.	5
Yardage - August	5
Force $\frac{1}{2}$ Robt Sherer & Co. Sept.	6
Sketch showing tunnels etc	7
Flume Lumber	8
Force $\frac{1}{2}$ Sherer October	9
Force $\frac{1}{2}$ " November	10
Short TUNNELS. $\frac{1}{2}$ - $1\frac{3}{4}$	11
" " $\frac{1}{8}$ - $\frac{1}{2}$	12
DECEMBER. FORCE. $\frac{1}{2}$	14
Yardage. September - - - - -	15
" October - - - - -	16
" November	17
short tunnels $\frac{1}{2}$ - $1\frac{3}{4}$ - - - - -	13

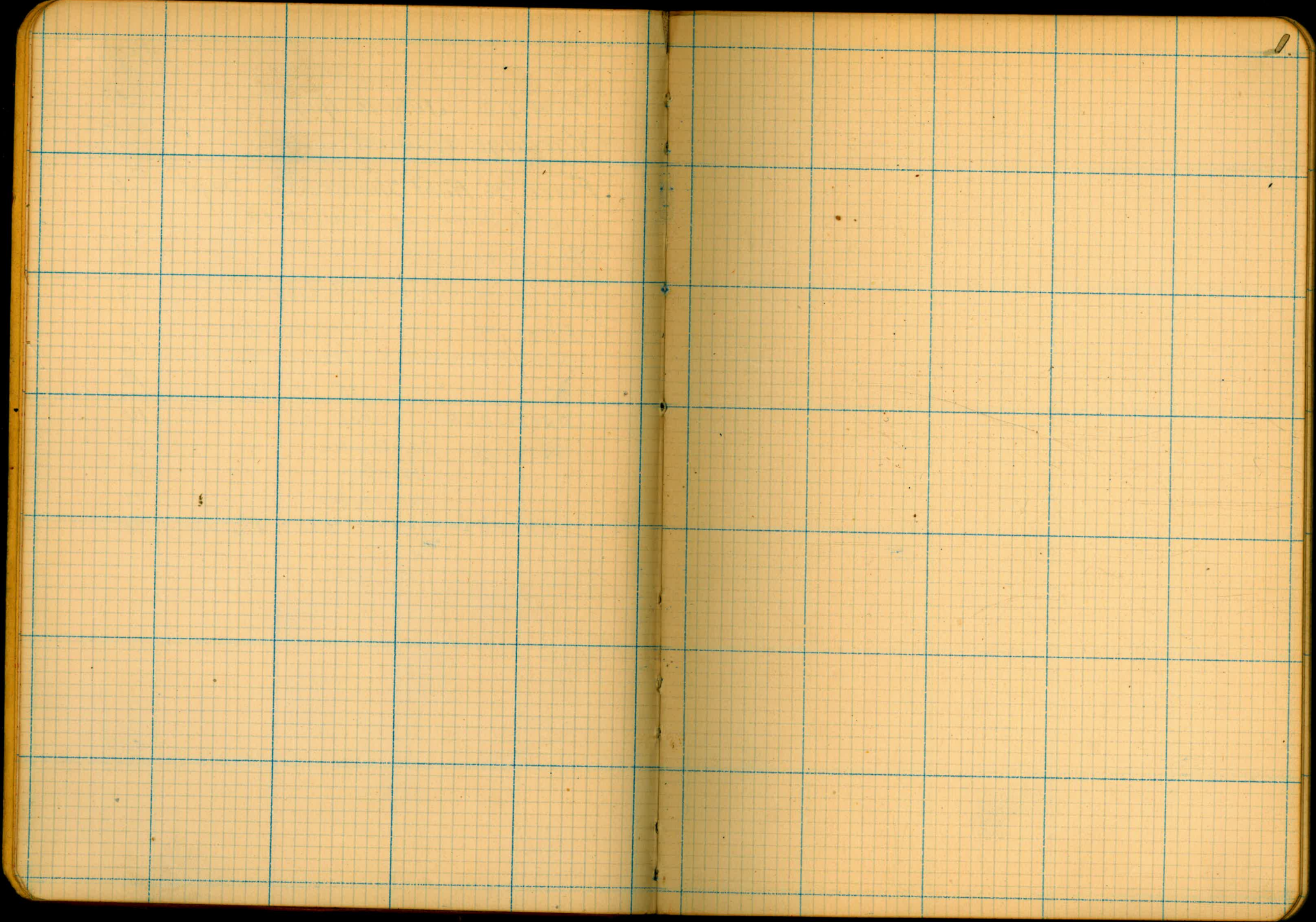

Contract prices.

\$13 per foot tunnel completed
#13 #4 #6

\$15 per m. for hauling & placing
mine timbering

\$0.75 per excavation per cu. yd.
working for fuel

\$12.50 per ton for hauling from
La Presa
other work labor + 10%

Progress payments tunnels.

1st	100	\$4.80
2	"	8.15
3	"	8.50
4	"	8.85
5	"	9.20
6	"	9.55
7	"	9.90
8	"	10.25
9	"	10.60
10	"	10.95
11	"	11.30

} 25% contract
paid

} 25% reserve

Arrangement for second extra
tunnels \$11.50 per foot flat.

TRAIL MILEAGE

Goodbody's to Large Boulder N#4	4600' Wagon
Over Tunnel #4	4878' Horse
Junction to S4	800' "
S4 to Well	300' "
North "Y" Goodbody's	250' "
Around #3	3750' "
#3 to wagon road	6550' Wagon
Cottonwood to Tunnel #1	3785' horse
Around Tunnel #1.	3100' "
" " #1 to Louis'	4743' "
" Louis Trail	2162' -

August

5

Johnson's work sta 299+67 to 336+30.

Page 16	298.5	
17	403.5	3663
18	526.0	
19	661.0	
20	499.5	
21	509.0	
22	347.0	
23	278.	
24	383.	
25	207.5	
26	308.	
27	<u>145.5</u>	4566.5

1st cut, in foot
in bench only

28	135	sta 282+40 to 287+50.
29	<u>45</u>	<u>180</u> <u>4746.5</u> cubic yds.

O'Byrne's Work sta 176+45 - 204+50

1	199.3	28 05
2	299.4	
3	551.9	
4	334.6	
5	391.2	
6	632.6	
7	457.0	
8	324.4	
9	426.0	
10	<u>325.0</u>	3941.4

McGuire's Work. 255+38 to 264.

12	216.	
13	509.	
14	195.	
15	<u>147.</u>	1067.

Total 9754.9 ^{cubic} yds.
on bench

1907 September 1 2 3 4 5 6 7 8 9 10 11 12 13

14 15 16 17 18 19 20 21 22 23 24 25 26 27 28 29 30

North #1 5 41 68 3 3 5 5

5 5 5 5 5 5 5 4 4 4 4 4 4 4 4

South #1 8 19 24 3 4 4 3 5 5 4

5 5 5 5 5 5 4 4 4 4 4 4 4 4 4

Ditch #1-2 - 23 23 23 23 24 24 - 24 5 19 18

21 - 20 21 22 22 18 20 - 26 33 31 29 28 28 - 29

North #3 16 41 82 - 3 3 3 3 3 2 3 6

3 5 5 5 5 5 4 1/2 5 5 5 5 5 5 5 5

South #3 15 32 40 - 3 3 4 4 3 3 3 3 6 6

5 5 5 5 5 5 5 4 4 5 5 7 7 7 7

North #4 - 4 4 4 4 4 4 4 4 3 3

4 - 3 3 3 3 3 3 3 5 5 5 5 5 5

South #4 18 50 69 - 3 3 3 6 6 6

6 3 5 5 5 3 1/2 4 4 4 4 4 4 5 5 5

62 183 288

Ditch #5-6 - 21 21 21 26 27 26 26 30 29 30

30 - 34 34 36 36 36 36 30 30 30 32 29 31 - 31

Totals

51 51 55 63 68 69 69 58 75 78

79 23 82 83 86 84 80 1/2 82 24 80 90 88 89 87 89 30 90

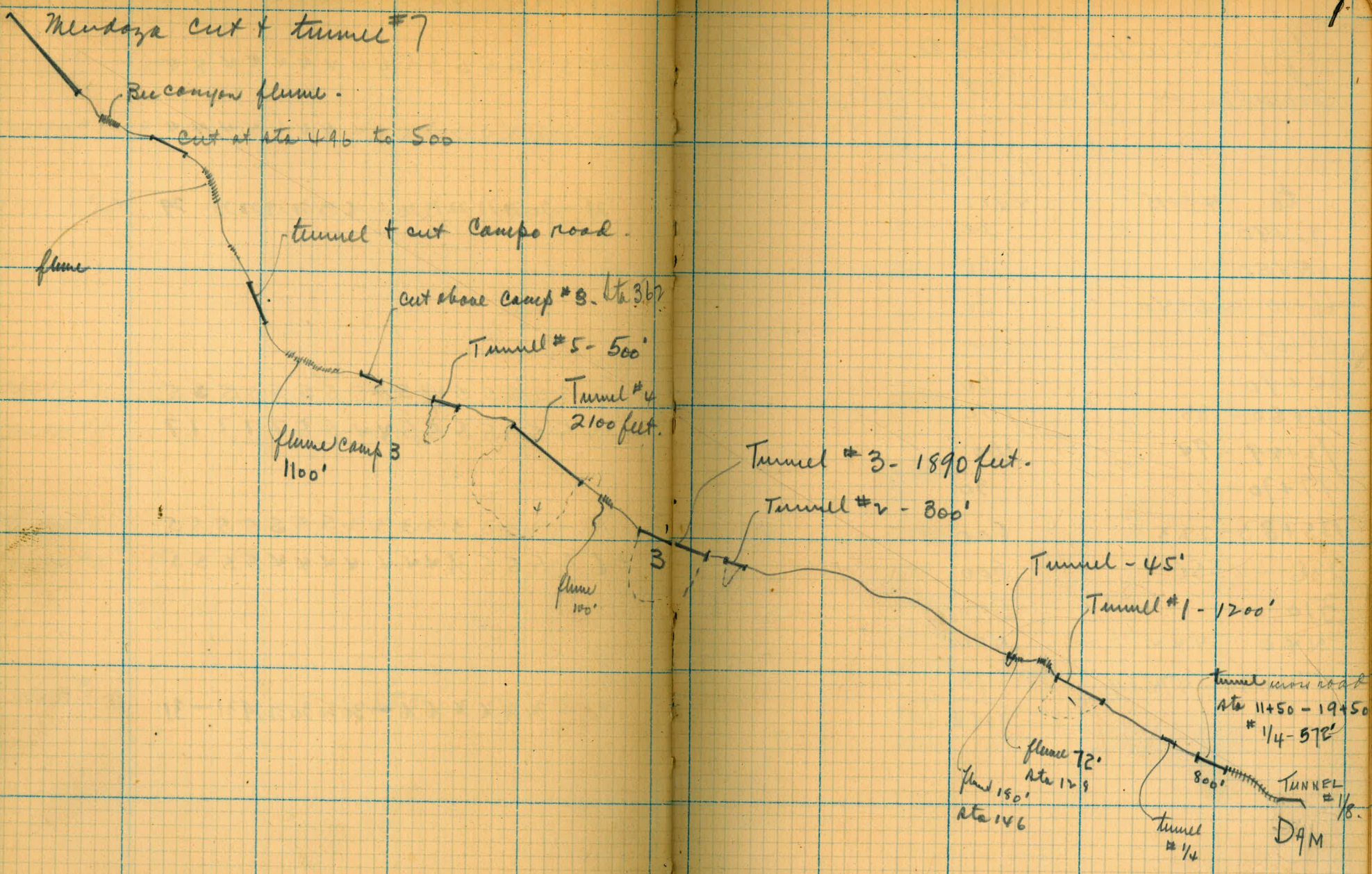

Approximate Estimate of Flume Lumber - Dam to Pulgura

	FLUME
to 48+15	4412
52+90	24
65+50	50
66+10 - 66+40	30
69+67	200
84+90	50
86+50 - 88	150
92+49 - 94	150
97+70 -	30
125+83 - 223	600
286 - 356	500
370	500
440 - 444	400
474+20 - 474+90	70
	<hr/> 7166 feet.

Along O - new Camp

1550

8

0 - 11+50	1150	
19+50 24+75	525	
27+20 32+80	560	
34+20 46+50	1220	
86+85 87+65	60	
92+50 -	70	
97+57 97+84	27	3612
128+50 -	72	Landed back
146 - to T1/4	180'	-
166+67 167+17	50	302
306 - 306+30 TS	30	
337+50 337+45	45	
339+05 341+14	209	
373+26 384+25	1100	375 - 385 1000
398+65	50	
406	75'	(76.5)
452+38 456+05	367	
464+18	47	
472+50	78	
482+20	36'	
528+62 530+15	153	2100
		7604
Additional	539	26'
	540+50	40'
	542+75	20'
	221	60'
	210	40'
		186

107 October 10 21 31 1 2 3 4 5 6 7 8 9

Sunday

N 1 89 102 114 = 4 4 4 4 4 4 4 4 4

S 1 33.5 39 47

1/4 shot 45' tunnel - - 10

Tecusan Ditch

Ditch

N 2 - 7 45.5

S 2 - 21 45.5

N 3 115 136 147.5 = 5 5 5 5 5 5 5 5 5

S 3 46 50 63

Ditch

N 4 - - -

S 4 86 103.5 120 = 5 5 5 5 5 5 5 5 5

S 5 - - -

Ditch

10 11 12 13 14 15 16 17 18 19 20 21 22 23 24 25 26 27 28 29 30 31 9

SUNDAY

SUNDAY

RAIN

Sunday

4 6 6 6 6 6 6 6 4 4 4 3 4

5 2 2 4 4 4 4 4 4 4 4 4 4

2 2 2

① ① ①

24 20 21

② - ② ② ② ② ② ②

22 -

②

23

- - 2 1 2 2 3 3 2 4 4 4 4 4 2 4

2 2 2 2 5 3 3 3 3 2 4

5 4 4 4 4 4 4 4 3 5 5 5 5 5 4 5

Machine

2 - 2 3

12 11 13 17 11 12 - 10 - 3 -

- 4 2 2 2 2 2 4 4 2

5 5 5 5 5 5 4 5 5 5 5 5 5 5 4

8 8

30 27 32 20 32 - 32

80 mins ② 22 28

Nov. 1907. 10. 20 30

$\frac{1}{8}$ - at least

$\frac{1}{2}$ - 9

N1 114 121' 141 161

S1 47 56' 67 89

N1 $\frac{1}{2}$ 46

¹¹⁻¹⁷⁴
Ditch Bench 1+2

N2 79' 107 149

S2 77' 114 158

N3 1475 162' 181 206

S3 63. 88' 121 151

Bench 2-3

N4 2' 21 38

S4 120 132' 150 165

N5 - at least 26

S5 - - 5

Bench 4+5

Ditch 4+5

Ditch 5+6

Japs began on ditch nov. 11.

1 2 3 4 5 6 7 8 9 10 11 12

4 4 4 4 4 4 5

4 4 4 4 4 4 5

2 2 2 2 2 3 3

2² 2² 15 13 18 30

2 2 3 2 2 2 2

4 4 5 4 2 2 2

4 4 3 4 4 4 6

6 6 4 4 6 6 4

- - - - -

3 3 3 - - 2 4

4 5 5 5 5 5

12 16 6 24 - 2 -

13 17

13 14 15 16 17 18 19 20 21 22 23 24 25 26 27 28 29 30

5 5 5 5 5 5 5 5 5 5 5 5 5 5 5 5 4

5 5 5 6 4 6 6 6 6 6 6 6 6 6 5 5 5

3 3 4 2 / FINISHED - - - - -

3² 3³ 3³ 3³ - 3¹ 3¹ 2³ 3³ 3³ 3³ - 14² 24³ 13 8 7 12

2 4 4 4 2 4 4 4 4 4 4 4 4 4 5 5 5

2 4 4 4 4 4 5 5 5 5 5 5 5 4 3 3 3

6 6 7 6 6 6 6 6 6 6 6 6 6 6 6 6

4 4 4 4 4 4 4 4 4 4 4 4 4 4 4 0 0

- - - - - 18 8 16³ 23³ 24³ 28³

4 4 6 6 6 6 6 6 6 6 6 6 6 6 6 6 0 0

5 5 5 7 5 7 7 7 7 7 7 7 7 7 7 7 6

2 2 2 2 3 3 3 3 3 3 3

2 2 - - - 4 4 4 4 4 4 2 2 2 2 2 2

- - - - -

18 19 20 22 - 12 - - - - -

14 24 24 26 26 26 - 23 42 4 38 41 0 windy.

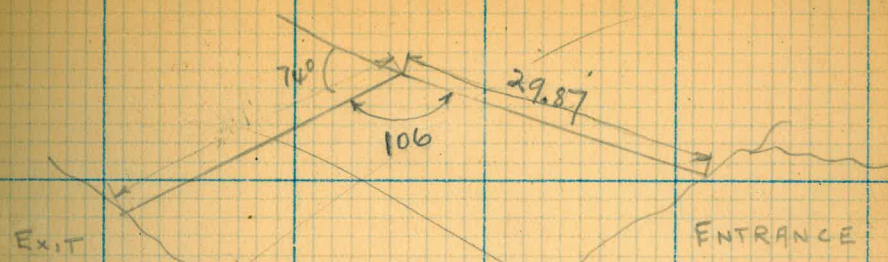

TUNNEL No 1 $\frac{1}{2}$

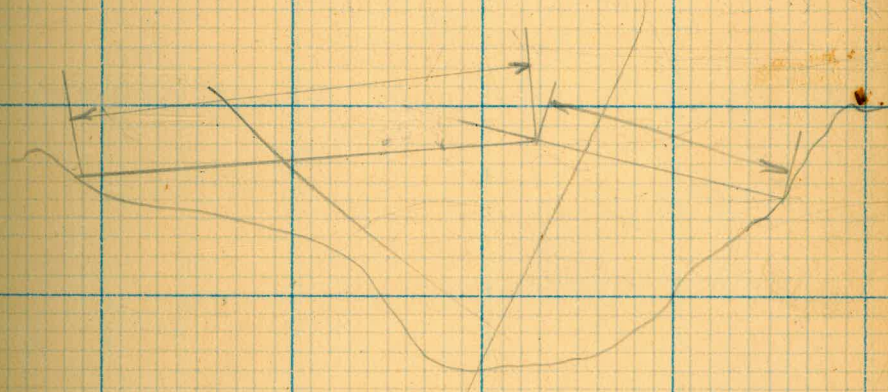

TUNNEL No 1 $\frac{3}{4}$

State across creek
 above and open cut

Pluquin roof - 17+70

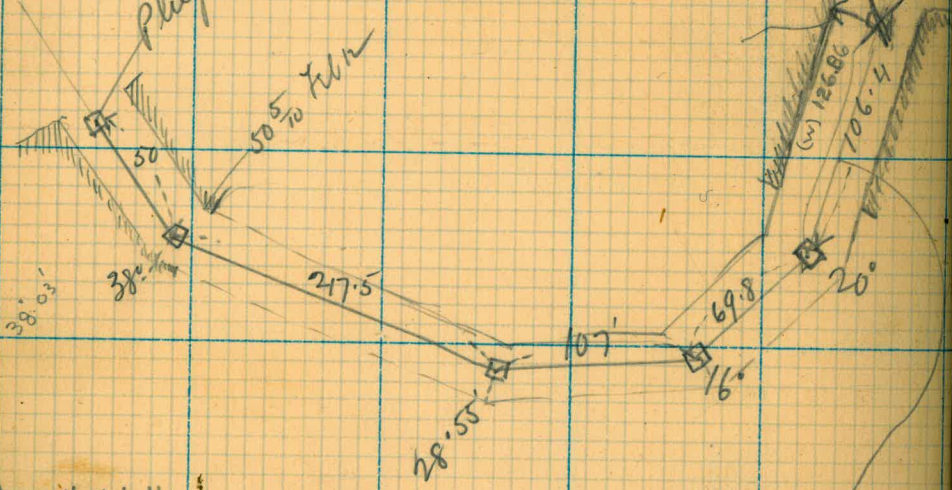

Length 106.4
 69.8
 167.
 217.5
 50
 550.7

Pluquin from Pluquin
 in surface

TUNNEL No. $\frac{1}{8}$ FT DAM.

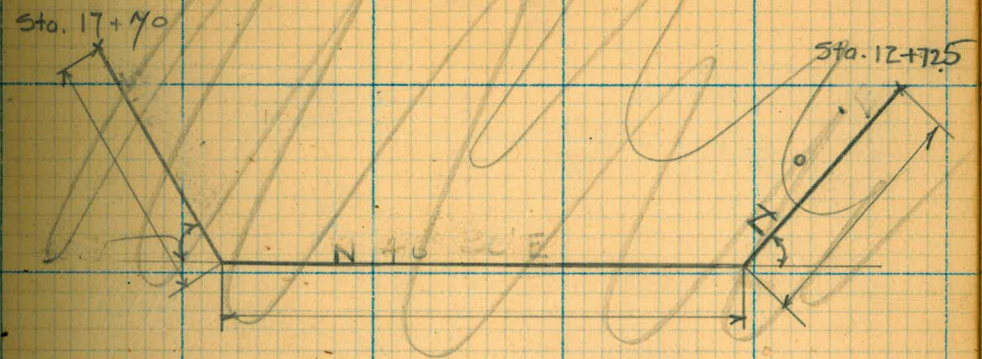

TUNNEL No. $\frac{1}{2}$ FT ROAD CROSSING.

STRAIGHT

March 2nd 1908

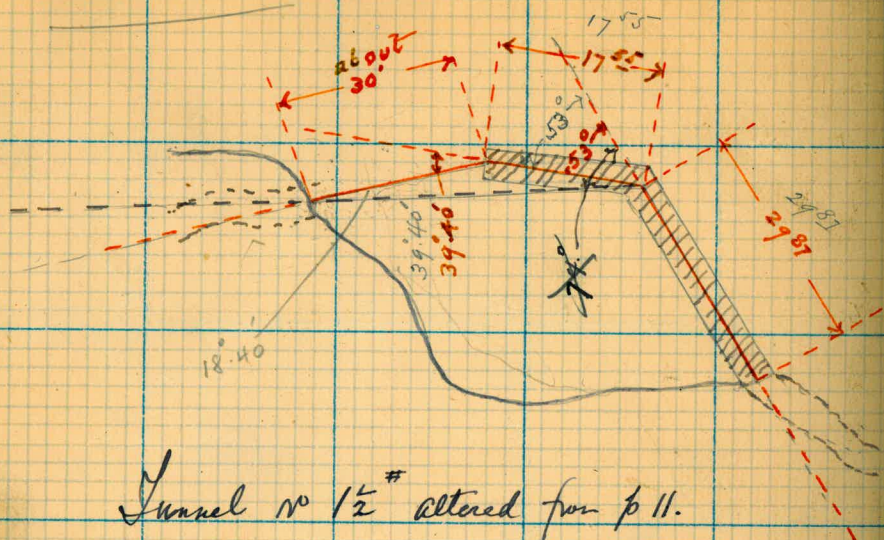

Channel No 1 1/2[#] altered from p 11.

29.87
 17.51
 32
 77 42

39.40
 21
 18.40

March 2nd 1908

Survey of Tunnel 1 3/4[#]

Center Stake in bank

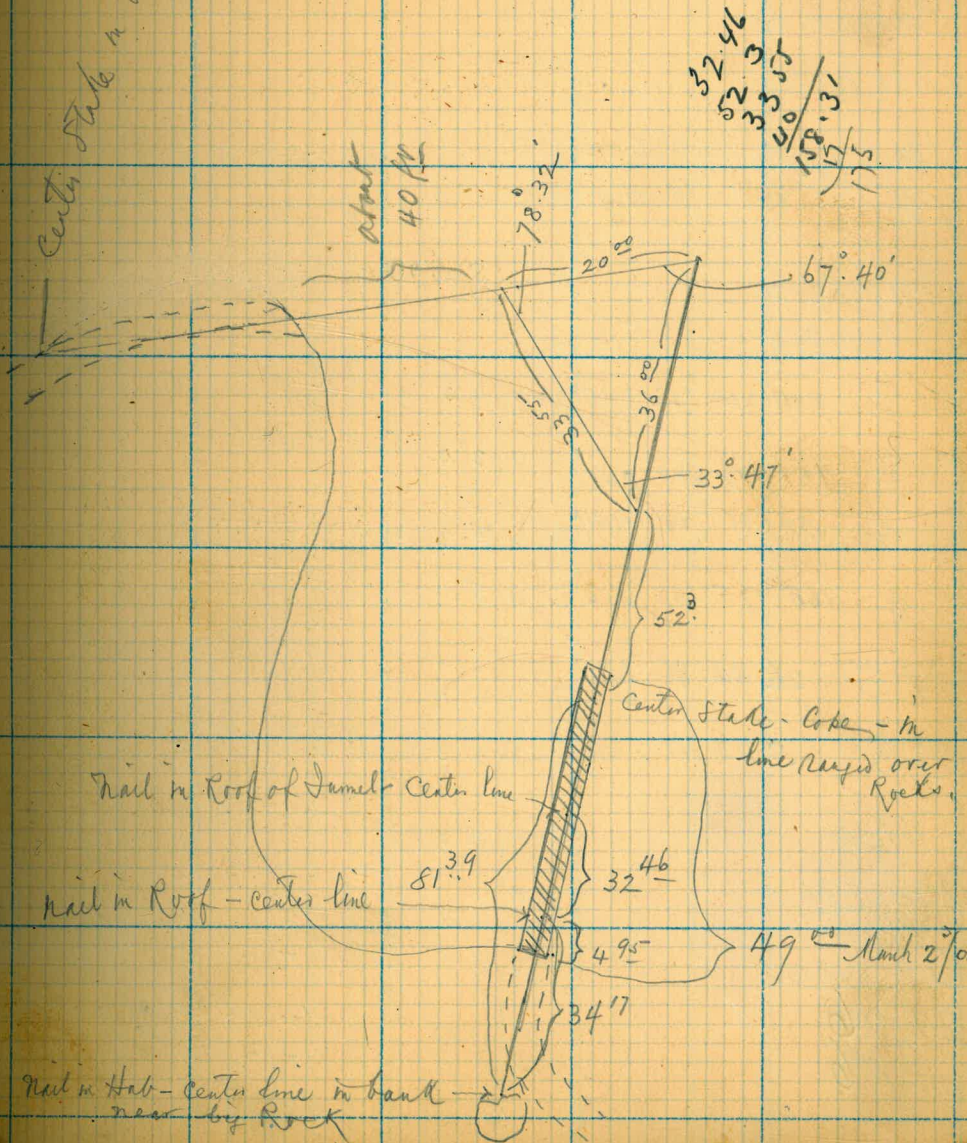

32.46
 52.95
 33.35
 50
 158.31
 175

Nail in Hub - Center line in bank near by Rock

March 2/08

Dec. 1907 10 20 31 / 2 3 4 5 6 7 8 9 10 11 12 13

TUN #2 309 Feet 8 8 Finished
N1 161 178 197 215 4 4 6 6 5 4 4 4 4 4 4 4 4
S1 89 105 118 129 4 4 5 5 4 5 5 5 5 5 3 3 3

Bench H2 0 0 - 14 14 0 14 14 12
Ditch H2 - - -

1 1/2 23 - - - 2 2 2
1 3/4 7 - - - 2 2 2

Bench 2+3 0 7 8 20 14 14 0 14 14 10
Ditch 2+3 - - -

N3 206 218 222 246 6 6 6 5 6 5 5 5 5 5 5

S3 151 177 200 242 0 0 2 0 4 4 4 4 4 4 4

N4 38 51 174 112 0 0 2 2 6 6 6 6 6 6 6

S4 165 175 189 206 2 2 5 5 5 5 5 5 5 4

N5 26 54 86 121 3 3 2 2 3 3 3 3 3 2

S5 5 23 41 68 2 2 3 3 2 2 2 2 2 3

Ditch J.A.P.S 43 38 35 31 30 35 55 55 55 50
Bench 5+6 - -

Cut 9a 496 - 26 26 26 26 26 26 - - -

Cut 5 #0 26 26 26 26 26 - 46 50 44 28
Cut N #0 7 7 7 7 7 - 21 21 11 14

14 15 16 17 18 19 20 21 22 23 24 25 26 27 28 29 30 31

4 4 4 4 4 4 4 4 4 4 4 4 4 4 4 4 4
0 4 4 6 6 6 6 6 6 6 6 6 6 6 6 6 6

125 54 } 94
155 40 }

2 - 2 2 2 2 2 - 2 2 2 2 2 - 2 0 34
2 - 2 2 2 2 2 - 2 2 2 2 2 - 2 2 36

Midage September.

Items.

N. 1. 68
 S. 1. 29
 N 3 82
 S. 3 40
 S. 4 69

288 @ 7.80

2246 40

Midage

130+92 148+97 Cords. 3/21.5

336+58 358+82 3482.9

cut N 4. 394.3

6998.7 C/A @ 75° 5249.02

7495.42

25% 1873.85

5621.57

Wednesday October #2

Contract Tunnels.

N 1	46
S 1	18
N 3	65.5
S 3	23
S 4	51
	<u>203.5</u>

410 feet tunnel	unit 100' #7.80	# 3 198
81.5 "	2nd 100' #8.15	664.22
<u>441.6</u>		<u># 3 862.22</u>

Wednesday previous months 6998.4 6998.4

Wed. Tuesday

147.94 -	1967.99 =	4 062.6
282+55 -	287+53	595.1
299+50 -	368+30	<u>2 329.5</u> 6987.2

Cut		
" Tunnel Sta.	147	62.7
"	N 2	118.4
"	P 2	61.8
"	N 4	119.
"	S 5	<u>94.6</u>

<u>456.5</u>
14.442 4 @ 75 # 10831.80

Freight hauler from LaRosa

120.06 tons @ 12.5 1500.75

deduct 25%

Previous Payment.

16.194.77
4.048.64
<u>12.146.08</u>
5621.57
<u># 6524.51</u>

#2A

Nov 10 1907

16

Sept 30	Board men.	#82
Oct 31		23
" 31		30.25
" 31		<u>8.25</u>

Short tunnels not included in 4 contract ms.

N 1/4	10
N 2	45 1/2
S 2	48.5
	<u>104 @ 11.50</u>

<u>1196</u>
1339.50

Tuesday Nov 11th

17

JANUARY 1. 10. 20. 31. MHP

NORTH 1 215 225

SOUTH 129 140

NORTH 2. 309. COMPLETED

SOUTH

1/4 46 COMPLETED

1/2 23 23

3/4 7 16

NORTH 3 246 258

SOUTH 242 280

NORTH 4 112 138

SOUTH 206 220

NORTH 5 121 141

SOUTH 268 83

NORTH 6

SOUTH

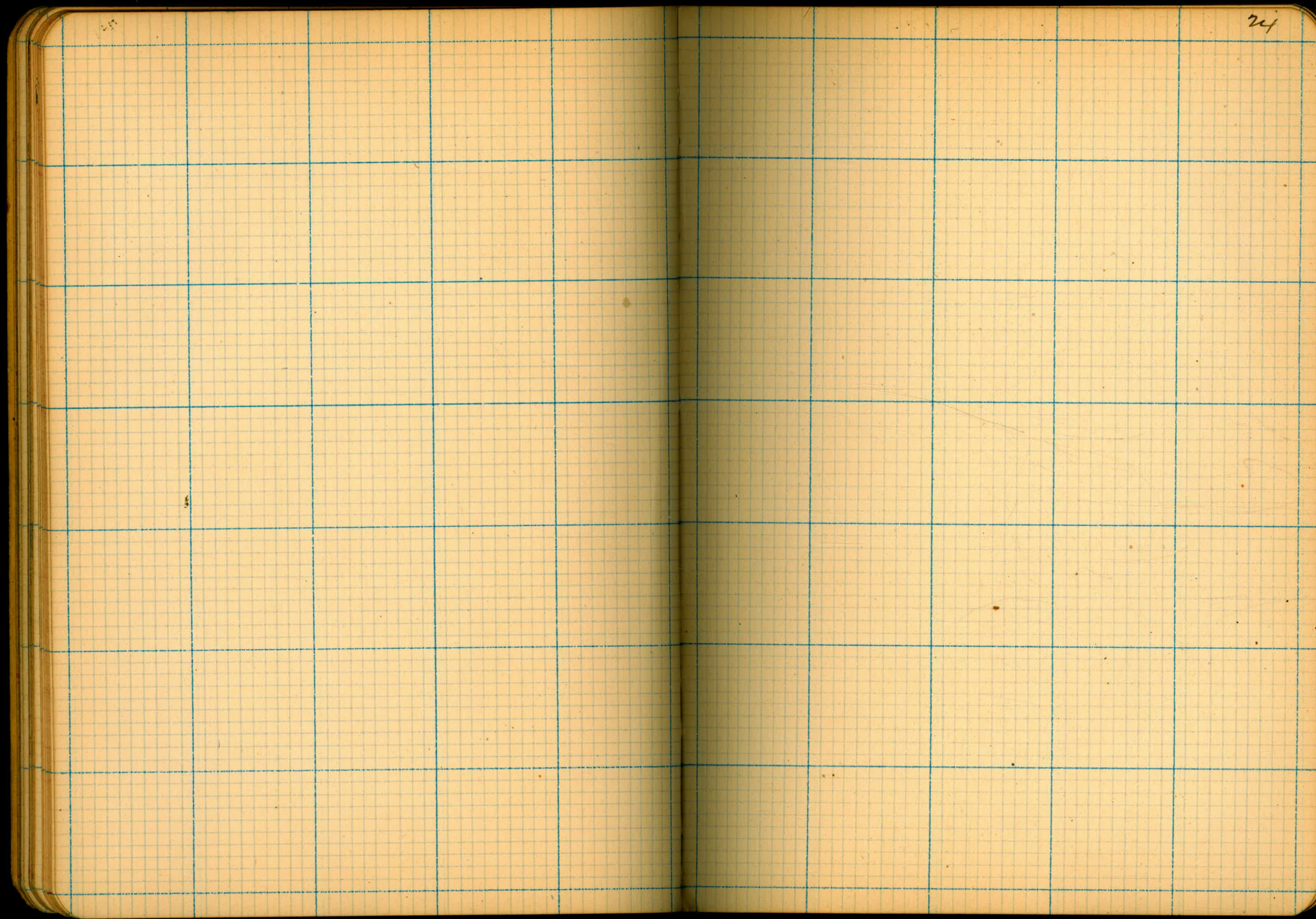

24

24.

29

Diagram Tunnel #6

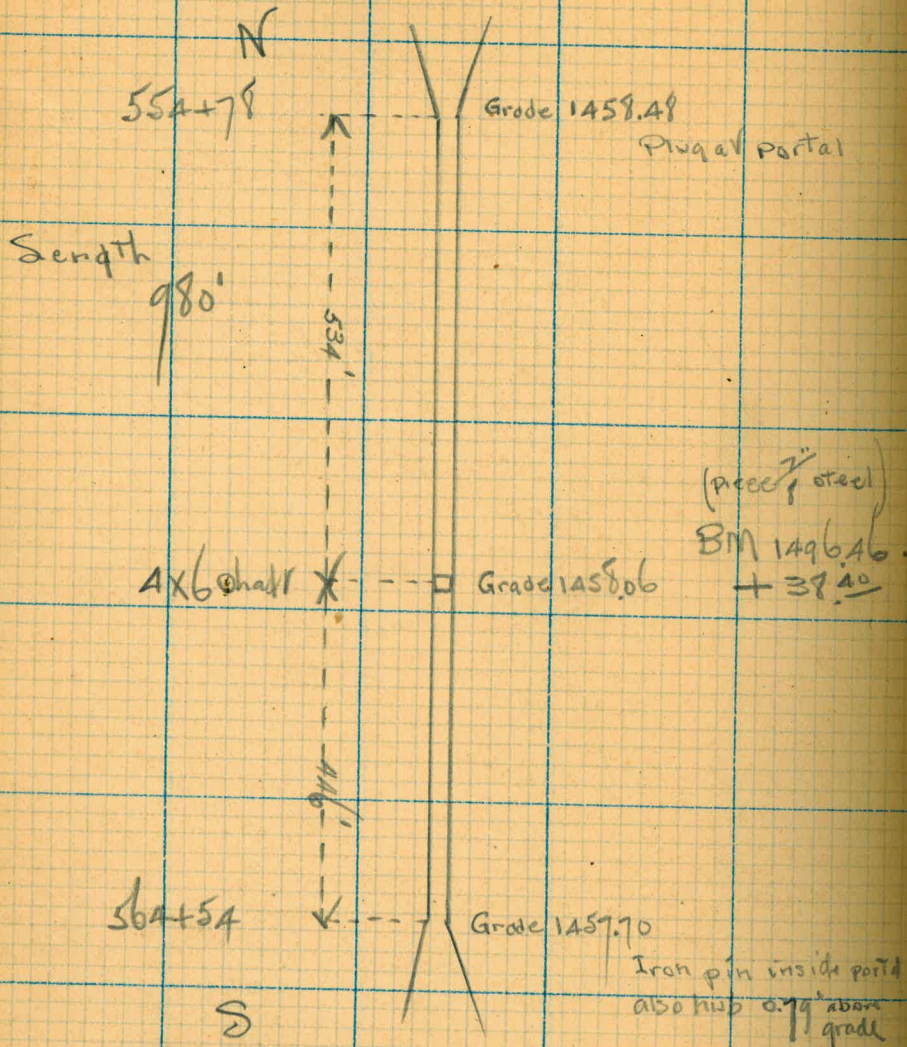

Tunnel Bench-Marks

73

1N	cut in rock opp	300' plug	+ 6.38'
1S	do	400'	+ 6.70'
3N	do	400'	+ 6.59'
3S	do	600'	+ 9.16'
4N	do	500'	+ 6.53'
4S	do	600'	+ 8.73'
6 shaft $\frac{7}{8}$ " steel in south bank			+ 38.40'

197 foot Plume north of Tunnel

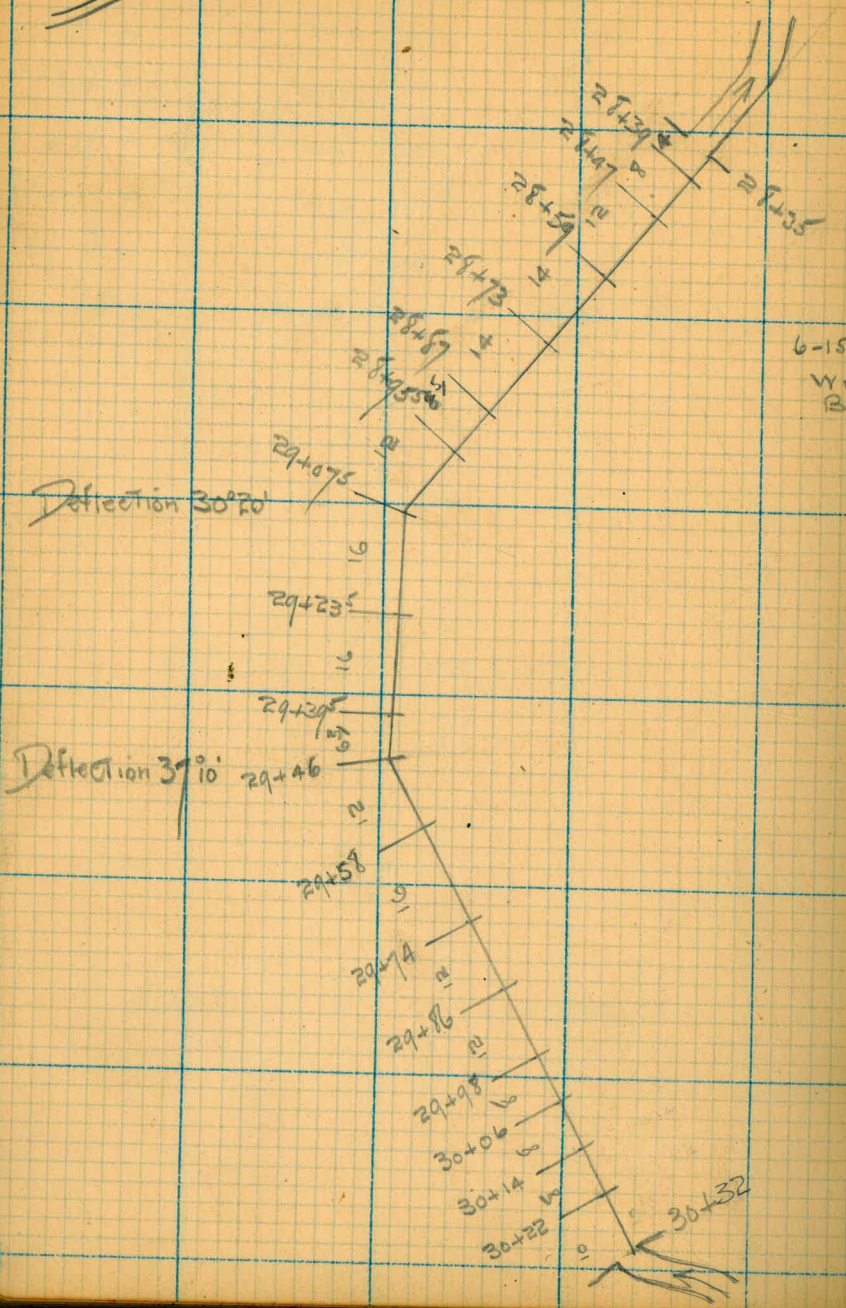

6-15-08
W. W. BAKER

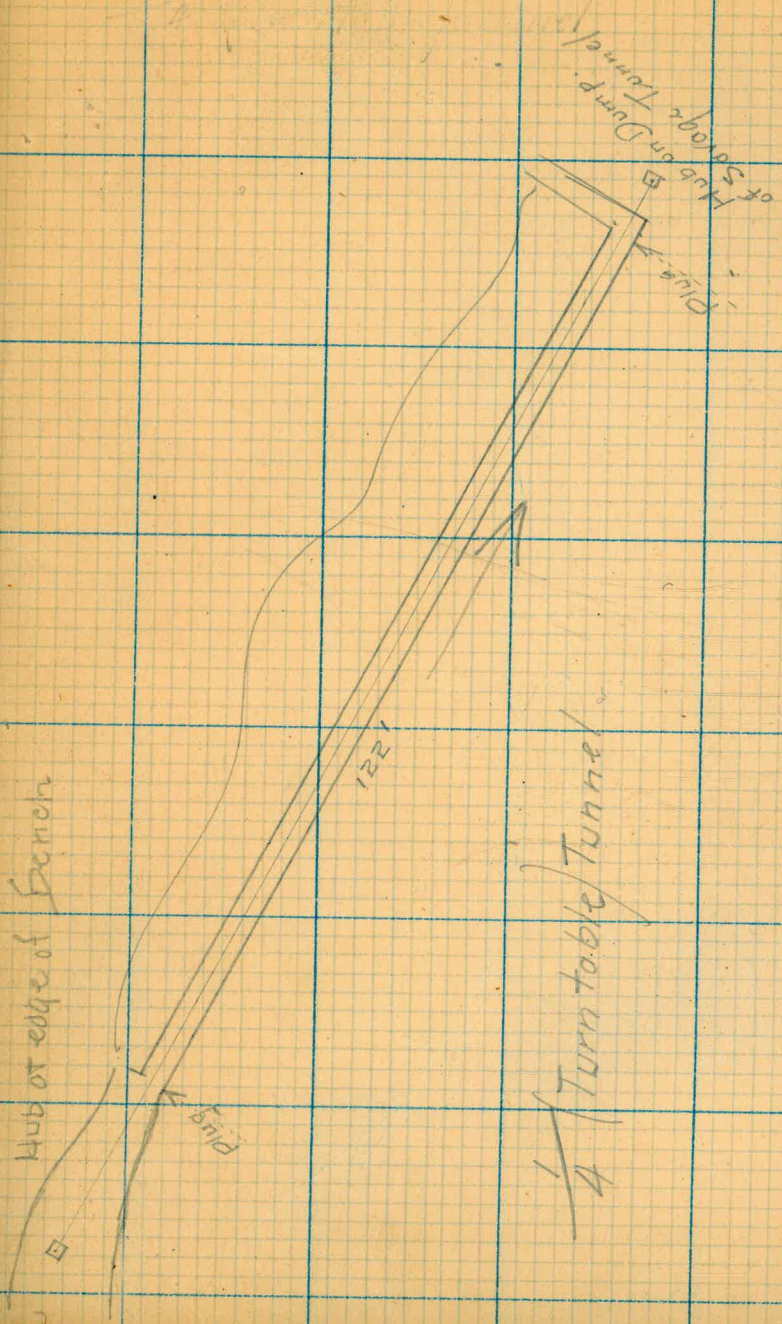

1/4 Turn table Tunnel

52.44
 215.75
 106.75
 69.67
 106.75
 531.01

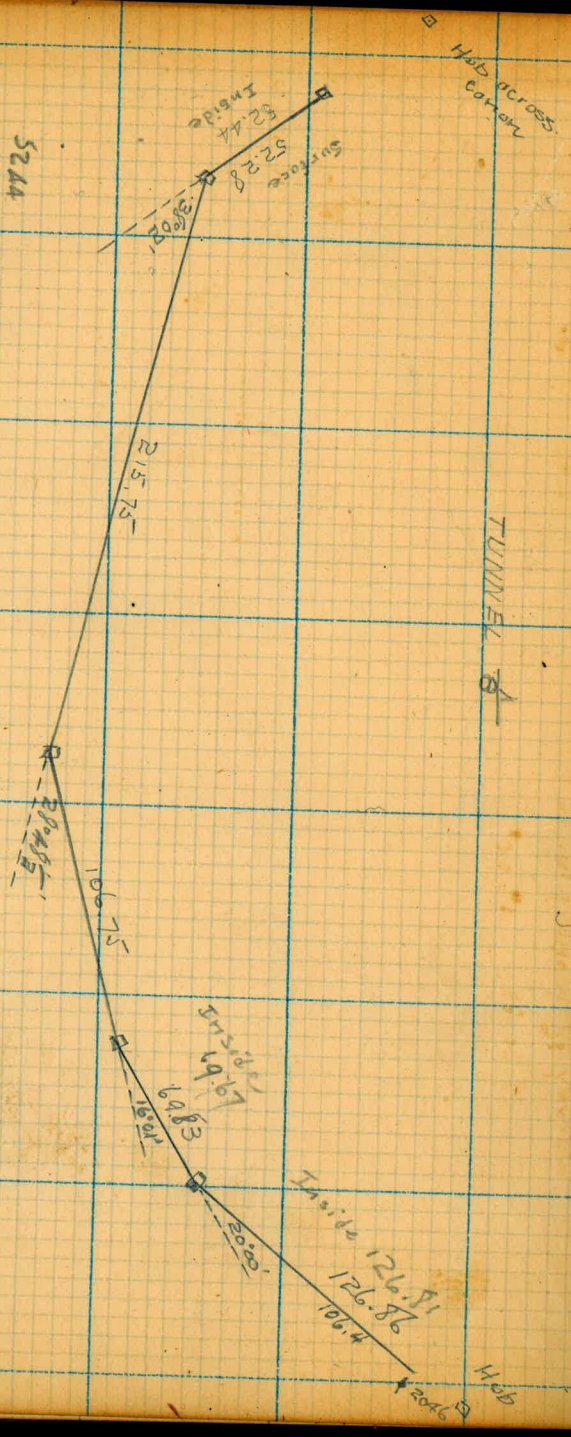

Survey 16 (Cable) Tunnel.

5-30-68 1" = 60'

Length 330.8'

