

314 A

FILE NO. 5-53

W314A

WITNESSES
TODAY

TRAVERSE TABLE FOR TRANSIT BOOK.

From 1° to 90° for a distance of 100.

Degrees.	DEGREES.		¼ DEGREE.		½ DEGREE.		¾ DEGREE.		Degrees.
	Lat.	Dep.	Lat.	Dep.	Lat.	Dep.	Lat.	Dep.	
0	99.98	1.75	100.00	0.44	100.00	0.87	99.99	1.31	89
1	99.94	3.49	99.98	0.88	99.97	2.62	99.95	3.05	88
2	99.86	5.23	99.92	1.33	99.91	4.36	99.88	4.80	87
3	99.76	6.97	99.84	1.78	99.81	6.10	99.79	6.54	86
4	99.62	8.72	99.73	2.23	99.69	7.85	99.66	8.28	85
5	99.45	10.45	99.59	2.68	99.54	9.58	99.50	10.02	84
6	99.25	12.19	99.41	3.13	99.36	11.32	99.31	11.75	83
7	99.03	13.92	99.20	3.58	99.14	13.05	99.09	13.49	82
8	98.77	15.64	98.97	4.03	98.90	14.78	98.84	15.21	81
9	98.48	17.36	98.70	4.48	98.63	16.50	98.55	16.93	80
10			98.40	4.93	98.33	18.22	98.25	18.65	79
11	98.16	19.08	98.08	5.38	97.99	19.94	97.90	20.36	78
12	97.81	20.79	97.72	5.83	97.63	21.64	97.53	22.07	77
13	97.44	22.50	97.34	6.28	97.24	23.34	97.13	23.77	76
14	97.03	24.19	96.92	6.73	96.81	25.04	96.70	25.46	75
15	96.59	25.88	96.48	7.18	96.36	26.72	96.25	27.14	74
16	96.18	27.56	96.00	7.63	95.88	28.40	95.76	28.82	73
17	95.63	29.24	95.50	8.08	95.37	30.07	95.24	30.49	72
18	95.11	30.90	94.97	8.53	94.83	31.73	94.69	32.14	71
19	94.55	32.56	94.41	8.98	94.26	33.38	94.12	33.79	70
20	93.97	34.20	93.82	9.43	93.67	35.02	93.51	35.43	69
21	93.36	35.84	93.20	9.88	93.04	36.65	92.88	37.06	68
22	92.72	37.46	92.55	10.33	92.39	38.27	92.22	38.67	67
23	92.05	39.07	91.88	10.78	91.71	39.87	91.53	40.27	66
24	91.35	40.67	91.18	11.23	91.00	41.47	90.81	41.87	65
25	90.63	42.26	90.45	11.68	90.26	43.05	90.07	43.44	64
26	89.88	43.84	89.69	12.13	89.49	44.62	89.30	45.01	63
27	89.10	45.40	88.90	12.58	88.70	46.17	88.50	46.56	62
28	88.29	46.95	88.09	13.03	87.88	47.72	87.67	48.10	61
29	87.46	48.48	87.25	13.48	87.04	49.24	86.82	49.62	60
30	86.60	50.00	86.38	13.93	86.16	50.75	85.94	51.13	59
31	85.72	51.50	85.49	14.38	85.26	52.25	85.04	52.62	58
32	84.80	52.99	84.57	14.83	84.34	53.73	84.10	54.10	57
33	83.87	54.46	83.63	15.28	83.39	55.19	83.15	55.56	56
34	82.90	55.92	82.66	15.73	82.41	56.64	82.16	57.00	55
35	81.92	57.36	81.66	16.18	81.41	58.07	81.16	58.42	54
36	80.90	58.78	80.64	16.63	80.39	59.48	80.13	59.83	53
37	79.86	60.18	79.60	17.08	79.34	60.88	79.07	61.22	52
38	78.80	61.57	78.53	17.53	78.26	62.25	77.99	62.59	51
39	77.71	62.93	77.44	17.98	77.16	63.61	76.88	63.94	50
40	76.60	64.28	76.32	18.43	76.04	64.94	75.76	65.28	49
41	75.47	65.61	75.18	18.88	74.90	66.26	74.61	66.59	48
42	74.31	66.91	74.02	19.33	73.73	67.56	73.43	67.88	47
43	73.14	68.20	72.84	19.78	72.54	68.84	72.24	69.15	46
44	71.93	69.47	71.63	20.23	71.33	70.09	71.02	70.40	45
45	70.71	70.71							

Published by the A. LITZ Co., San Francisco, Cal.

ENGINEERING OFFICES OF
J. B. LIPPINCOTT
 1104-1106 CENTRAL BLDG.
 LOS ANGELES, - CALIF.

Handwritten: ROD file
Handwritten: Personal
Handwritten: No 1 - 54° 3
 No 2 - 54.2

July 10-23

Rainfall record to date.

Max Temp.

Pt.	Std.	V _L	V	Rad +	BS	HI	- Rad	7.5	Elev	Course	Dist	L	R	Remarks
0+00	200	-1°-0"	+345	+52	845	10845			1000	N10°W				
1+00	300	+3°-0"	+156				-10		10345	N15°W				
							-20	+136	12205	N15°W				



Nomenclature -

< Left of line
> Right of line
D Dirt.

R_{SR} Solid Rock.

RO Rock Outcrop -

L_R Loose Rock

B Brush -

L_B Light Brush -

H_B Heavy "

T Timber

L_T Light Timber

H_T Heavy "

S_O Scrub oak

L_{S_O} Light Scrub Oak -

P_{O_T} Point on Trail.

9/3/22

Buttress # 18 South Side

Weather

Date	Hour	Temp	A.B.	BC	CA
9/3/22	2 ¹⁵	82'	14,1142	14,0804	14,3657

Clear

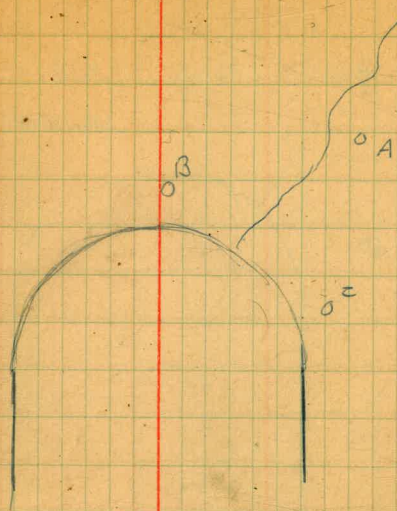

Date

Hour

Temp

A.B

AC

14.6080 ~~15~~1048

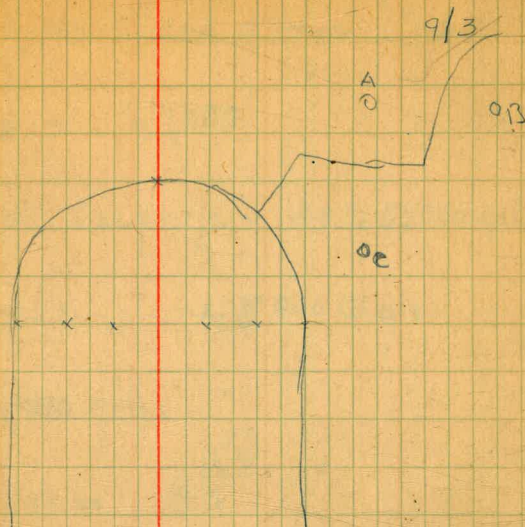

Losses on Wood-stave Pipe.

18" Line - 27,000'

Loss duct seepage = 40 to 50,000 gals/day

Avg Loss = 45,000' Gals-

1" = 13,000 gals =

45,000 gals = 3 1/2"

San Dieguito Mutual W. Co.
Del Mar.

Date	Hour		Temp	AB	Remarks
	AM	PM			
9/5/22	KQV W.M.F.	10 ⁰⁰	0	15.2.237	(B Loose)
9/9/22		10 ¹⁵		15.222	(A Loose) KQV
Set New Plugs 9/9/22					
9/10/22		1 ³⁰	Cool	14.695	KQV
10/1/22		3 ⁰⁰	Warm	14.696	KQV
10/24-22		2 ⁴⁵	Very warm	14.695	W.D.M.
11/7-22		12 ⁰⁰	Cool	14.7127	W.D.M.
11/10/22		4 ⁰⁰	Showers	14.7140	K.Q.V. & J.B.L
11/25-22		10 ³⁰	clear	14.7180	KQV
11/25/22		10 ³⁰	"	14.7179	W.D.M.
11/7-22		1 ⁴⁵	Cloudy	14.7205	KQV
11/7/22		1 ⁴⁵	"	14.7195	W.D.M.
12/22-22		11 ⁰⁰	clear Warm	14.7192	W.D.M.
12/30-22		9 ⁴⁰	" Cool	14.7210	KQV
12/30-22		9 ⁴⁰	" cool	14.7224	W.D.M.
1/1-23		11 ⁵⁰	Cool	14.7210	W.D.M.
1/26/23		3 ⁴⁰	Cool	14.7227	KQV
5/24/23		5 ⁴⁰	clear	14.7130	KQV
6/23/23		10	clear	14.7155	W.D.M.
6/30/23		4 ³⁵	clear	14.7100	KQV

See page 34

Buttress N°15
South Side below Walk.

8
9/5/22

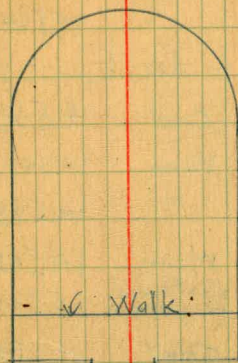

Temp atmosphere 65° - water 59°
at surface

152

✓ A • B

✓

Date	Time		Temp	A-B	Remarks
	AM	PM			
9/5/22	10-10		-	14.8634 W.M.S. 14.8640 K.Q.V.	
9/9/22	9:54			14.8640 K.Q.V.	
9/10/22		√ ²⁵		14.8640 K.Q.V.	
				Put in Set Round Heads	
9/10/22		√ ²⁵	Cool	14.5443 K.Q.V.	Round head.
9/18/22	6 P.M.		Warm	14.5495 K.Q.V.	
9/18-22	6 P.M.		"	14.5482 W.D.M.	
10/11/22			Warm	14.5481 K.Q.V.	
10/24/22	2 ³⁰		East wind very warm.	14.5475 W.D.M.	
11/7-22	1 ⁰⁰		Cool	14.5535 W.D.M.	
11/10/22	8:45		Showers	14.5535 K.Q.V. ✓ B.L.	
11/25-22	10 ⁴⁵		Clear	14.560 K.Q.V.	
11/25/22	"		"	14.5590 W.D.M.	
12/7-22	1 ⁴⁵		cloudy	14.5602 K.Q.V.	
12/7-22	1 ⁴⁵		"	14.5606 W.D.M.	
12/22-22	11 ⁴⁵		Clear Warm	14.5592 W.D.M.	
12-30-22	10 ³⁰		Clear Cool	14.5615 W.D.M.	
12-30-22	10 ³⁰		" "	14.5618 K.Q.V.	
1-1-23	11 ⁵⁰		Cool	14.5600 W.D.M.	
1/26/23	3 ³⁵		Cool	14.5605 K.Q.V.	
5/27/23	5 ³⁵		Clear	14.5570 K.Q.V.	
6/23-23	10		Clear	14.5575 W.D.M.	
6/30/23	4 ³⁰		Clear	14.5570 K.Q.V.	

SEE PAGE 33

Buttress No 16
South Side

9
9/5/22

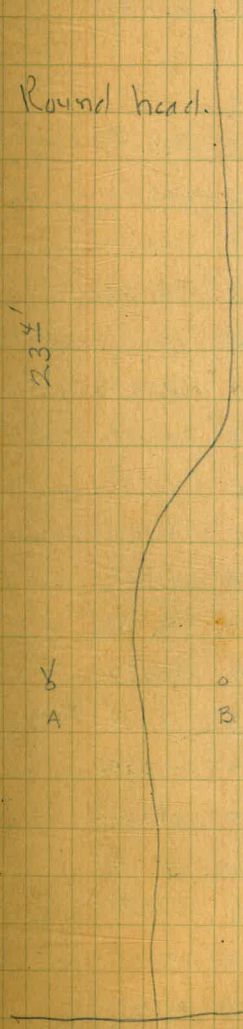

Date	Hour	Temp	A.B.	A.C.	Remarks	South Side	Buttress #
	AM. P.M.	-					
9/5/22	10 ²²		15.1041	14.6093	W.D.M.		
"			15.1046	14.6078	K.Q.V.		
9/9/22	9 ⁰²		15.1047	14.6090	K.Q.V.		
Changed Points							
9/10/22	1 ²⁰	Cool	14.6463	14.3212	K.Q.V.		
9/18/22	5 ⁴⁰	Warm	14.6482	14.3240	K.Q.V.		
9/18/22	5 ⁴⁰	"	14.6487	14.3244	W.D.M.		
10/1/22	2 ⁴⁵	"	14.6490	14.3240	K.Q.V.		
10/24-22	2 ⁰⁵	East wind very warm	14.6520	14.3230	W.D.M.		
11/7-22	1 ⁰⁰	Cool.	14.6687	14.3326	W.D.M.		
11/10/22	3:30	Showers	14.6675	14.3325	K.Q.V.	S.V.B.L.	
11/25/22	10 ²⁵	Clear	14.6708	14.3360	W.D.M.		
11/25/22	10 ⁵⁵	Clear	14.6700	14.3360	K.Q.V.		
11/29-22	2 ⁵⁵	Cloudy	14.6750	14.3375	K.Q.V.		
12/7-22		"	14.6750	14.3375	W.D.M.		
12/22-22	10 ⁵⁵	Clear Warm	14.6709	14.3302	W.D.M.		
12/30-22	9 ⁰⁰	Clear Cool	14.6793	14.3365	W.D.M.		
12/30-22		"	14.6790	14.3355	K.Q.V.		
1/1-17	11 ³⁰	Cool.	14.6740	14.3323	W.D.M.		
1-26-23	3 ¹⁰	Clear Warm	14.6800	14.3340	K.Q.V.	Temp 58°	K.Q.V.
2-3-23	10 ³⁰	Clear Cool	14.6897	14.3386	W.D.M.		
3-10-23	10	Cloudy "	14.6803	14.3350	W.D.M.		
3/20-23	10 ²⁰	" "	14.6740	14.3335			
4/24/23		Clear	14.6695	14.3300	K.Q.V.		
4/23-23	9 ³⁰	Clear	14.6715	14.3325	W.D.M.		

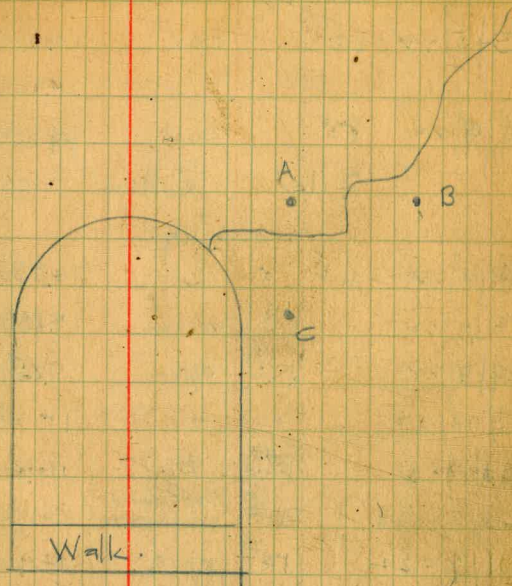

See page 29.

D	Date	Hour		Temp	AB	AC	Obs
		AM	PM				
9	9/5/22	10 ³⁰		Cool	14.8097	14.3303	W.D.M.
	"				14.8097	14.3300	KQV
9	9/9/22	8 ⁴⁵		Cool	14.8095	14.3303	KQV
		Filed		Rocks	Flat	to Fruit	late
				measuring.			
9	9/9/22	11 ¹⁵		Cool	14.8575	14.4135	KQV
9	9/12/22	5 ¹⁵		Warm	14.8582	14.4140	KQV
9	9/18/22	5 ⁴⁵		Warm	14.8590	14.4160	M ²
10	9/18/22	"		"	14.8588	14.4160	KQV
10	10/1/22	2 ⁴⁰		"	14.8665	14.4205	KQV
11	10/24-22	2 ¹⁵		East wind Very warm	14.9035	14.4245	W.D.M.
"	10/27-22	12 ³⁰		Cool	14.9030	14.4378	W.D.M.
11	11/10/22			Showers	14.9005	14.4370	K.Q.V. & J.B.L.
11	11/25-22	10 ⁵⁵		Clear	14.9030	14.4418	KQV
11	"	"		"	14.9030	14.4412	W.D.M.
12	12/7/22	1 ⁴⁵		cloudy	14.9107	14.4435	W.D.M.
12	12-7-22	1 ⁴⁵		"	14.9104	14.4436	W.D.M.
12	12-22-22	11 ⁰⁰		Clear Warm	14.9031	14.4385	W.D.M.
12	12-30-22	9 ¹⁵		Clear Cool	14.9150	14.4458	W.D.M.
11	12-30-22	9 ¹⁵		"	14.9150	14.4455	KQV
1	1/1-23	17 ⁵⁵		Cool	14.9120	14.4440	W.D.M.
2	1/26/23	3 ²⁰		Clear Warm	14.9190	14.4485	KQV
3	2/3/23	10 ²⁵		Clear Cool	14.9300	14.4523	W.D.M.
3	3/10-23	10		Cloudy Cool	14.9202	14.4505	W.D.M.
3	3/20-23	10		"	14.9090	14.4455	
4/2	5/29/23	5 ⁵⁰		Clear	14.9050	14.4450	KQV

Southside.

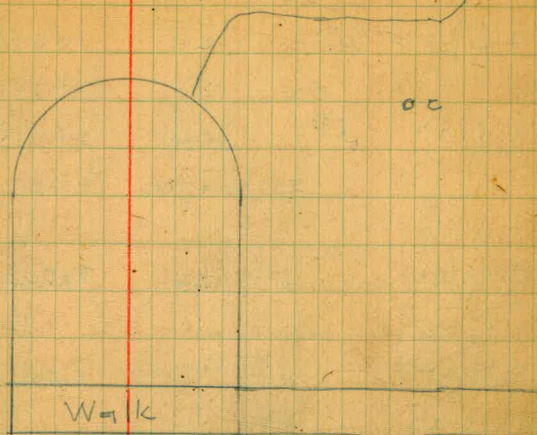
Buttress No 16
A B₀

See P. 18

Temp 57°

See page 30

Date	Hour	Temp	A.B.	B.C.	Obs.
	AM PM				
9/5/22	10 ⁴⁵	Cool	14.1015	14.0833	WDM
			14.1016	14.0830	KQV
9/8/22	8 ³⁰	Cool	14.1152	14.0835	KQV
Changed Points					
9/10/22	5 ⁰⁵	Cool	To close	14.0920	KQV
9/18/22	5 ³⁰	Warm day	To close	14.0907	M.F.
9/18/22	5 ³⁰	"	"	14.0907	KQV
10/1/22	2 ³⁰	"	"	14.100	KQV
10/24-22	2 ²⁰	East wind very warm	"	14.1087	WDM
11/7-22	12 ³⁰	Cool	"	14.1363	WDM
11/10/22	3 ⁴⁰	Showers	"	14.1355	KQV
11/25-22	10 ³⁰	Clear	"	14.1422	KQV
"	"	"	"	14.1378	WDM
12-7-22	2 ⁰⁰	Cloudy	"	14.1467	WDM
12-7-22	2 ⁰⁰	"	"	14.1470	KQV
12-22-22	11 ¹⁵	Clear Warm	"	14.1447	WDM
12-30-22	9 ²⁰	Clear Cool	"	14.1515	WDM
12-30-22	9 ¹⁰	"	"	14.1525	KQV
1/1-23	11 ⁴⁰	Cool	"	14.1480	WDM
1/26-23	3 ³⁰	Cool	"	14.1575	KQV
2/3/23	10 ⁵⁰	Clear Cool	"	14.1703	WDM
3/10-23	10 ¹⁰	Cloudy Cool	"	14.1587	WDM
6/23-23	10	Clear	"	14.1517	
6/23-23	5 ⁰⁰	Clear	"	14.1525	WDM

South Side Buttress # 18.

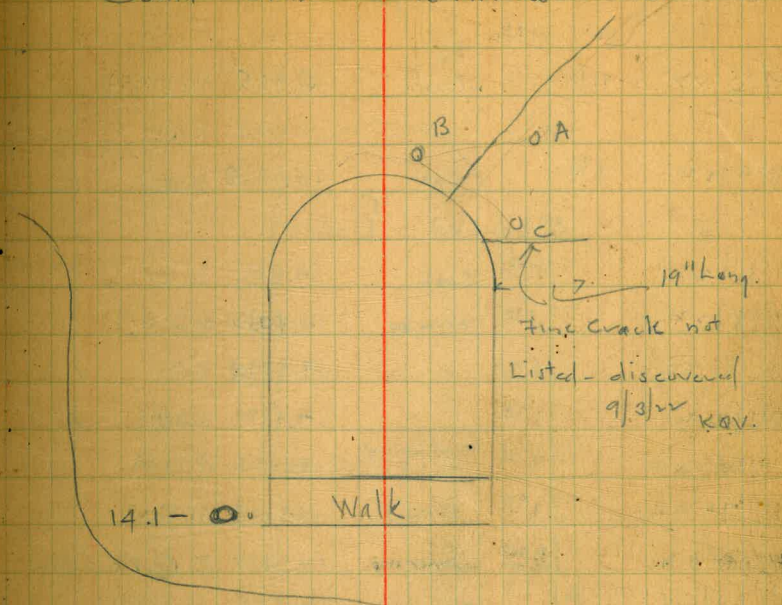

J.B.L

75
17
92

5/24/23 5¹⁵ PM Clear 14.1440 ✓ KQV
6/2/23 3 P.M. Clear 14.1537 L.V.A.

See page 31

Date	Hour		Temp	A.B.	Remarks
	AM	PM			
9/5/22	11 ¹⁵		Cool.	14.905	WDM ⁷
				14.905	KQV.
9/9/22	8 ³⁰		Cool	14.9060	KQV. ✓
Changed Rods-					
9/10/22	5 ⁰⁵		Cool	14.9030	KQV ✓
9/18/22	5 ²⁰		Warm Dry	14.9050	W.D.M. ⁷
9/18/22	5 ³⁰		" "	14.9010	KQV. ✓
10/1/22	2 ³⁰		" "	14.9120	KQV. ✓
10/24-22	2 ²⁰		East wind	14.9213	W.D.M.
11/7-22	1 ⁰⁰		Cool	14.9468	W.D.M.
11/10/22	3 ⁴⁰		showers	14.9450	K.Q.V. & J.B.G.
11/25/22	10 ³⁰		Clear	14.9469	W.D.M.
11/25/22	"		"	14.9470	KQV.
12/7-22	2 ⁰⁰		Cloudy	14.9545	KQV.
12/7-22	2 ⁰⁰		"	14.9545	W.D.M.
12/22-22	11 ²⁵		Clear Warm	14.9502	W.D.M.
12/30-22	9 ⁴⁰		" Cool	14.9605	KQV.
12/30-22	9 ⁴⁰		Clear Cool	14.9600	W.D.M.
1/1-23	11 ⁴⁵		cool. 64	14.9570	W.D.M.
1/26/23	3 ³⁵		Cool	14.9635	KQV.
2/3/23	10 ⁵⁰		Clear Cool	14.9710	W.D.M.
3/10-23	10 ¹⁵		cloudy Cool	14.9650	W.D.M.
				14.9538	
5/24/23	5 ¹⁰		Clear	14.9520	KQV.
6/23-23	10 AM		clear.	14.9595	W.D.M.
6/30-23	5 P.M.		"	14.9455	KQV.
7/5-23			clear.		

South Side

Buttress No 19

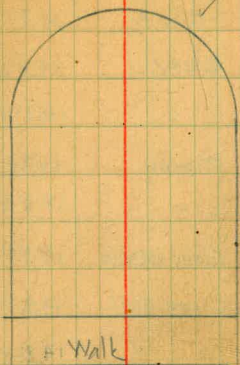

14.9 - 120.

See page 32

Buttress # 17

North Side

Date	Hour	Temp	A.B.		
9/16	AM 5 ³⁰	Cool	14.8096	KQV	
10/24-22	2:30	Hot day	14.8155	WDM	
11/7-22	12 ³⁰	Cool	14.8355	WDM	
11/25-22	10 ³⁰	Clear	14.8374	WDM	
11/25-22	10 ³⁰ AM	"	14.8373	KQV	
12/7-22	2 ¹⁰ PM	Cloudy	14.8425	WDM	
12/7-22	2 ¹⁰ PM	"	14.8430	KQV	
12/22-22	11 ¹⁰ A.M.	Clear Warm	14.8385	WDM	
12/30-22	9:25 AM	Clear Cool	14.8460	KQV	
1/30-22	9 ²⁵	" "	14.8462	WDM	
1/-1-23	11 ⁴⁵	Cool	14.8430	WDM	
1/26-23	3 ²⁵ PM	Clear Warm	14.8545	KQV	
2/3/23	10:45	Clear Cool	14.8650	WDM	
3/10-23	10 ¹⁰ A.M.	Cloudy Cool	14.8562	WDM	
			14.8487		
5/24/23	5 ³⁰ PM	Clear	14.8430	KQV	
6/22-23	10 AM	Clear	14.8475	WDM	
6/30-23	5 PM	"	14.8390	KQV	
7/9-23	10:40 AM	66°	14.8413	WDM	
7/15-23	11 ²⁰ AM	Clear 73°	14.8390	KQV	
8/11/23	10 ⁰³ AM	Clear 70°	14.8403	WDM	
8/26-23	3 P.M.	Warm	14.8395	WDM	Strain Gage.
9/-8-23	Noon	Warm	14.8362	WDM	8.204
9/-12-23	"	"	14.8378	WDM	8.200
9/-25-23	10:10 AM	Cool	14.8440	WDM	8.164

See page 36

8.134

11/10/12 ✓

KQV.

Temperatures Hodges Dam -

Extremes of Temp of Air by
Maxm + Min Thermometer 10/11/12.
11-11-12

Outside extremes = 48° to 88° F.

Inside extremes = 50 - 84° F.

Temps by - Stevens -

12-30-22

K & Volk

W D McFadden

Placed Two Max+Min Thermometers
at Dam. Marked #1 + #2

Therm # 1 placed under Walk
between buttresses # 14 + 15

Therm. # 2 placed behind most northerly
outlet gate at base of Dam between
Buttresses 16 + 17

Jan 1923

Noon 1/1-23	No 1		No 2	
	Temp Min	Max	Min	Max
1/1-23	51°	69°	52°	64°
(11009 2/3/23)	43°	55°)		
3	45	64	48	60
4	-	-	-	-
5	44½	64½	48½	60
6	47	64	49	59
7	49	67	51	61
8	49½	74	51	68
9	55	77	55	71½
10	52	72	53	67
11	49	73	52	65½
12	50	70	51	65
13	48	62	49	61
14	49	60	42	61
15	50	70	51	66
16	50	69	51	67
17	50	68	52	63½
18	52	69	53	66
19	55	66	55	62
20	54	61	55	60
21	49	61	51	59
22	54	64	54	59
23	-	-	-	-
24	55	62	52	58
25	50	54	51	56
26	50	56	50	56

 Plotted
 E.H.C. Jr.
 6-30-23

Feb 1923	#16		Cont'd	
	Min	Max	Min	Max
1	44	52		
2	43	51		
3	44	51		
4	44	52		
5	45	56		
6	46	58		
7	46	60		
8	44	51		
9	44	51		
10	44	52		
11	46	51		
12	46	53		
13	46	56		
14	46	57		
15	46	63		
16	50	72		
17	50	72		
18	52	74		
19	54	76		
20	54	68		
21	54	—		
22	54	62		
23	53	63		
24	52	64		
25	52	63		
26	50	62		
27	51	60		
28	52	60		

#2 Thermometer ^{22.7} Stolen -

March	Min	Max
1	52	65
2	50	63
3	51	58
4	49	55
5	49	55
6	48	60
7	50	62
8	54	63
9	53	60
10	51	64
11	48	59
12	49	65
13	51	66
14	54	64
15	53	66
16	53	67
17	54	66
18	54	67
19	54	71
20	54	63
21	53	68
22	54	68
23	52	70
24	50	72
25	50	69

March	Min	Max
26	54	75
27	52	73
28	52	72
29	54	72
30	52	70
31	54	67

Continued from page 19
#1

April 1923	Min	Max	A.S.	R.C.	O.C.
1	54	58	149107	144475	WDM
2	54	60			
3	54	62			
4	54	61			
5	-	-			
6	56	60			
7	54	62			
8	54	63			
9	54	66			
10	57	64			
11	56	62			
12	55	64			
13	54	64			
14	56	65			
15	57	66			
16	58	66			
17	54	65			
18	51	64			
19	53	58			
20	54	65			
21	54	62			
22	52	60			
23	52	60			
24	52	62			
25	53	63			

20

#1

April 1923 -	Min	Max
26	54	63
27	56	64
28	57	63
29	57	63
30	57	66
31		

May	Min	Max
1	57	67
2	56	70
3	55	75
4	58	78
5	57	75
6	57	76
7	58	78
8	61	81
9	65	83
10	62	81
11	61	69
12	60	69
13	60	66
14	61	66
15	60	68
16	61	67
17	60	68
18	57	66
19	57	67
20	57	66
21	58	68
22	58	70
23	57	71
24	57	72
25	57	72

May	Min	Max
26	57	67
27	58	69
28	57	68
29		
30		
31		

1923

June

Min

Max

1

✓

3

4

✓

6

7

8

9

10

11

12

13

14

15

16

17

18

19

20

21

22

23

24

25

57

59

58

64

60

61

58

60

72

62

64

68

66

68

68

65

#1

Min Max

26

60

66

27

62

73

29

60

70

27

60

78

30

62

77

1923

July

Min Max

1 63 76

2 62 74

3 61 76

4 61 75

5 63 70

6 62 69

7 62 68

8 62 67

9 62 68

10 61 71

11 61 71

12 62 74

13 62 75

14 63 75

15

16

17

18

19

20

21

22

23

24

25

Min

Max

26

27

28

29

30

31

Record Temperature Lake Hodges Dam -

1923 Date	Temp Air	Temp W.S.	Temp Water 90' deep
3/31	-	64	56
4/7	72	62	56
4/14	67	64	56
4/21	70	64	56
4/28	74	66	56
5/8	84	74	57
5/16	78	73	57
5/24	70	70	57
5/29	72	69	57
6/21			58
6/26			57
7/2			57
7/10			58

No Record
Taken.

Hodges Dam -
 Record Temperatures
 Concrete Buttress # #16

Date 1923	Foot Stairs #1	West East # 2
Mar. 18	54°	60°
19	55°	61
20	54	59
21	54	60
22	54	61
23	54	59
24	55	61
25	55	61
26	55	64
27	55	63
28	55	62
29	56	63
30	56	63
31	56	63

Kov.

Hodges Dam
 Record Buttress Temp #16

Date	Under Stairs	West End
Apr - 1923		
1	56	62
2	56	60.5
3	56	60.5
4	56	59
5	-	-
6	56	60
7	56	60
8	56	59
9	55	61
10	56	60.5
11	56	60.5
12	55	61.5
13	55	61
14	55	61.5
15	55	62
16	56	62
17	56	61
18	56	61
19	56	59
20	56	60
21	55	59.5
22	55	58
23	55	59

#16
 Cont'd.

26

Apr.	Under Stairs	W. End.
24	55	59
25	56	60
26	56	60
27	56	61
28	56	60
29	56	61
30	56	61

Hodges Dam

27

Record Temp Concrete
Buttress # 16

Date	Under Stairs	West End
May 1	56	62
2	56	62
3	57	63 $\frac{1}{2}$
4	57	64
5	57	64
6	57	65
7	57	66
8	58	67
9	60	68
10	61	69
11	61	68
12	61	67
13	60	66
14	60	65
15	60	66
16	60	67
17	60	66
18	60	67
19	60	66
20	59	66
21	59 $\frac{1}{2}$	65
22	59	66
23	60	65

	Under Stairs	West End
24	59 $\frac{1}{2}$	64
25	59 $\frac{1}{2}$	65
26	60	65
27	59	66
28	59 $\frac{1}{2}$	65

June 30 - 23

61.2°

69.8°

KQV-

July 15 - 1030 AM

62.5°

70°

KQV-

Hodges Dam

Record of Buttress Temp - #16

June Under stairs West End -

1
2
3
4
5
6
7
8
9
10
11
12
13
14
15
16
17
18
19
20
21
22
23
24

Record Not taken by
Stevens -

18	59	65
19	58 1/2	65 1/2
20	59 1/2	65
21	58 1/2	67
22	58 1/2	69
23	60	69 1/2
24	60	69 1/2

Under Stairs

25
26
27
28
29
30

61
59
58 1/2
60
60 1/2
61

West end -

66 1/2
67
67 1/2
68 1/2
69 1/2
69 1/2

Record Taken by Du Bois.

Continued on Page 40.

Buttress #15
Cont. from Pg 10

29

Date	Hour	Temp	AB	AC	OBS.	
6/23/23	9 ³⁰ AM	Clear	14.6715	14.3320	W.D.M.	
6/30/23	4 ¹⁵ PM	Clear	14.6648	14.3305	K.Q.V.	
7/9/23	10 A.M.	Cloudy 66°	14.6745	14.3295	W.D.M.	
7/15/23	11 AM	Clear 73°	14.6665	14.3315	K.Q.V.	Max 73° Min 60°
8/11/23	10 AM	Clear 70°	14.6560	14.3245	W.D.M.	
8/26-23	3 PM	Warm.	14.6562	14.3260	W.D.M.	AC. Strain gauge.
9/7-23	Noon	Hot	14.6610	14.3295	W.D.M.	8.177
9/12-23	Noon	Cool	14.6636	14.3315	W.D.M.	8.174
9/25-23	10 A.M.	"	14.6673	14.3345	W.D.M.	8.165
10/9-23	10 A.M.	cloudy Cool.	14.6716	14.3350	W.D.M.	8.155
10/19-23	1 P.M.	Warm.	14.6670	14.3325	W.D.M.	8.164
11-12-23	9 A.M.	Cool	14.6750	14.3385	W.D.M.	8.140
1/23-24	9 AM	Cool	14.6940	14.3470	W.D.M.	8.095
2/8-24	10 ⁵⁵ AM	Cool.	14.6883	14.3440	W.D.M.	8.104
2/29-24	9 ¹⁵ AM	Cool.	14.6923	14.3470	W.D.M.	8.083
4/24-24	2 P.M.	Cool.	14.6850	14.3450	A.R.M. W.D.M.	8.093
5/14-24	9 AM	Warm.	14.6831	14.3438	A.R.M.	8.094
6/3-24	10 ²⁰ AM	Warm	14.6828	14.3410	A.R.M.	8.107
6/15-24	2 ²⁰ PM	Warm	14.6712	14.3401	A.R.M.	8.114
7/2-24	2 ⁵⁰ PM	"	14.6750	14.3705	A.R.M.	8.108
8/1-24	3 ¹⁰ PM	"	14.6752	14.3710	A.R.M.	8.112
8/17-24	12 ³⁰ PM	"	14.6800	14.3401	A.R.M.	8.098
9/2-24	2 ³⁰ PM	"	14.6782	14.3398	A.R.M.	8.088
9/14-24	3 ¹⁰ PM	"	14.6717	14.3407	A.R.M.	8.099

Continued on page 42

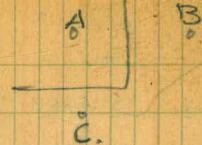

Date	Buttress # 16		A-B	AC	Obs	Strain Gauge		FB	HC
	Cont	P ₁ # 11							
6/23-23	10 AM	Clear	14.9107	14.4471	WDM				
6/30-23	4:25	Clear	14.8985	14.4415	K.Q.V.				
7/9-23	10:30 AM	Cloudy	14.9022	14.4459	WDM				
7/15-23	11:15 AM	Clear	14.9000	14.4421	K.Q.V.				
8/11/23	10 AM	Clear 70°	14.9005	14.4425	WDM				
8/26-23	3 P.M.	Warm	14.8970	14.4420	WDM				
9/5/23	3:20 PM	Hot	14.8915	14.4400	W.D.M.	8.203	8.178		
9/7-23	Noon	Hot	14.8908	14.4392	W.D.M.	8.191	8.189	rust, use small holes.	
9/12-23	Noon	Cloudy	14.8950	14.4416	W.D.M.	8.165	8.174		
9/25-23	10 AM	Cool Clear	14.9095	14.4463	W.D.M.	8.102	8.146		
10/7-23	10 AM	Cool Cloudy	14.9163	14.4511	W.D.M.	8.060	8.126		
10/19-23	1 P.M.	Warm	14.9045	14.4470	W.D.M.	8.108	8.148		
11/12-23	9 AM	Cool	14.9209	14.4537	Clarkson	8.031	8.113		
11/11	"	"	14.9211	14.4537	W.D.M.	8.035	8.113		
12/17-23	2:00 PM	Warm	14.9300	14.4555	W.D.M.	8.094	8.113	← Not possible to take measurement being less than 8.000	
12/17-23	"	"	14.9302	14.4554	Clarkson	8.094	8.113	↑	
1/23-24	9 A.M.	Cool	14.9425	14.4598	W.	8.076	8.113	Repunched 2/8/24 WDM.	
2/8/24	10:17 AM	Cool	14.9370	14.4575	WDM	8.182	8.088		
3/29-24	9:25	Cool	14.9445	14.4610	"	8.147	8.071		
4/29-24	2:20 PM	Cool	14.9347	14.4574	F.R.M. W.D.M.	8.196	8.086		
5/14-24	9:20 AM	Warm	14.9350	14.4560	F.R.M.	8.226	8.095		
6/3-24	10 P.M.	Warm	14.9371	14.4557	F.R.M.	8.222	8.085		
6/15-24	2:30 P.M.	Warm	14.9068	14.4453	F.R.M.	8.307	8.131		
7/2-24	2:40 P.M.	Warm	14.8700	14.4509	F.R.M.	8.321	8.136		
7/15-24	4:30 P.M.	Warm	14.9058	14.4507	F.R.M.	8.285	8.112		

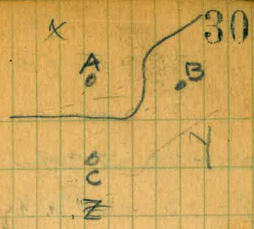

(Page 37)

Buttress No 18
From 1090-12

Hour Temp. B.C.

Hour	Temp.	B.C.	
6/30-23	5 P.M.	14.1368	KQV
7/9-23	10 ²⁰ A.M. 66°	14.1433	W.D.M.
7/11-23	11 ³⁰ ^{Clear} 73°	14.1385	KQV.
8/11/23	10 ⁰⁶ A.M. Cloudy 70°	14.1395	WDM.
8/26-23	5 PM Warm	14.1395	W.D.M.
9/7-23	Noon Hot	14.1282	W.D.M.
9/12-23	Noon cloudy	14.1356	W.D.M.
9/25-23	10:15 AM Cool	14.1490 ⁰¹²⁴	W.D.M.
10/9-23	10 AM Cloudy Cool	14.1564	W.D.M.
10/19-23	10 A.M. Warm.	14.1457	W.D.M.
11/12-23	9:40 AM Cool	14.1624	W.D.M.
"	"	14.1622	Clarkson
12/17-23	2 ³⁰ P.M. Warm.	14.1662	W.D.M.
"	"	14.1668	Clarkson
4/23-24	9 ²⁰ AM Cold	14.1803	W.D.M.
2/8/24	10:39 AM Cool	Pin loose No	WDM
3/29-24	9:40 AM Cool	"	W.D.M.
4-24-24	2:40 PM	"	W.D.M.
5-14-24	9 ⁴⁰ AM Warm	"	ARM.
6-3-24	10 ²⁵ AM Warm	14.0736	ARM.
6/11-24	3 P.M. Warm	14.0739	ARM.
7/2-24	3 ²⁵ P.M.	14.0723	ARM.
7/15-24	4 ⁵⁰ PM	14.0658	ARM.
8/1-24	3 ³⁵ P.M.	14.0629	ARM.
8/17-24	1:30 P.M.	14.0617	ARM.

(Continued on Page 38)

J.B. Lippincott T. Devleth Here Today

Strain Gage.

8.185

8.161

8.090⁰¹²²

8.051

8.108

8.020

8.021

No reading acct expansion over 8"

" " " " " "

8.181 Repunched 2/8/24 WDM.

8.145

8.200

8.228

8.231

8.309

8.311

8.291

8.299

8.292

BUTTRESS 19

Continued from page. 13



DATE	Hour	Temp.	A.B.	Observer
7/9-23	10:40 AM	65	14.9.518	W.D.M.
7/15-23	11:30 AM	73	14.9.470	W.D.M.
8/11/23	10 ¹⁰ AM	Cloudy 70°	14.9.500	W.D.M.
8/26-23	3 P.M.	Warm	14.9.495	W.D.M.
9/7-23	Noon	Hot	14.9.404	W.D.M.
9/12-23	Noon	Cloudy	14.9.454 ^{0.005}	W.D.M.
9/25-23	10:20	Cool	14.9.582 ^{0.0123}	W.D.M.
10/9-23	10 AM	Cool Cloudy	14.9.654	W.D.M.
10/19-23	1 P.M.	Warm	14.9.556	W.D.M.
11/12-23	9:45 AM	Cool	14.9.705	W.D.M.
"	"	"	14.9.708	Clarkson
12/17-23	2 ³⁵ PM	Warm	14.9.780	W.D.M.
"	"	"	14.9.787	Clarkson
1/23-24	9 ³⁰ AM	Cold	14.9.880	W.D.M.
2/8/24	10:38 AM	Cool	14.9.823	W.D.M.
3/29-24	9-45 AM	Cool	14.9.887	W.D.M.
4/24-24	2:50 PM	Cool	14.9.811	W.D.M.
5/14-24	10 ²⁰ AM	Warm	14.9.808	F.R.M.
6-3-24	10 ⁴⁵ AM	Warm	14.9.801	F.R.M.
6-N-24	3 ²⁰ PM	Warm	14.9.706	F.R.M.
7/2-24	3 ⁴⁰ PM	"	14.9.737	F.R.M.
7/N-24	5 P.M.	"	14.9.623	F.R.M.
8-1-24	3 ⁴⁰ PM	"	14.9.614	F.R.M.
8/17-24	1 ⁴⁵ PM	"	14.9.627	F.R.M.
9/2-24	4 ²⁵ PM	"	14.9.631	F.R.M.

A.C.	B.C.
8.177	8.173
^{.005} 8.152	^{.0028} 8.159
^{.0155} 8.077	^{.008} 8.119
8.038	8.096
8.093	8.119
8.009	8.077
8.009	8.076
No reading (over 2")	8.059
"	8.057
Repunched 2/8/24	8.042
8.172	8.056
8.132	8.028
8.183	8.048
8.212	8.058
8.198	8.039
8.328	8.092
8.341	8.107
8.281	8.079
8.287	8.081
8.278	8.076
8.281	8.077

(Continued on Page 39)

52
58
28

Base of BUTTRESS No 16

33

Continued from page 9.

DATE	TIME	Temp.	A.B.	OBSERVER
7/9-23	10:45	66°	14.5634	W.D.M.
7/15-23	11 45	73°	14.5570	K.Q.V.
8/11/23	10 ¹⁵ AM	Cloudy 70°	14.5530	W.D.M.
8/27-23	3 P.M.		14.5532	W.D.M.
9/7-23	Noon	Hot.	14.5503	W.D.M.
9/12-23	Noon	Cloudy.	14.5565	W.D.M.
9/25-23	10:35 AM	Cool	14.5582	W.D.M.
10/9-23	10 A.M.	Cloudy Cool	14.5594	W.D.M.
10/19-23	1 P.M.	Warm	14.5666	W.D.M.
11/12-23	10 A.M.	Cool	14.5592	W.D.M.
"	"	"	14.5592	Clarkson
12/17-23	2 ⁴⁵ PM	Warm.	14.5613	" "
12/17-23	2 ⁴⁵ "	"	14.5613	W.D.M.
1-23-24	9 ³⁰ AM	Cold	14.5656	W.D.M.
2/8/24	10/47 AM	Cool	14.5623	W.D.M.
3/29-24	10/55 AM	Cool.	14.5630	W.D.M.
4-29-24	3:10 PM.	Cool	14.5600	W.D.M.
5/14-24	10 ⁵⁰ AM	warm.	14.5598	A.R.M.
6/3-24	11 ¹⁰ AM	Warm	14.5601	A.R.M.
6/15-24	3 ⁴⁵ PM.	Warm	14.5542	A.R.M.
7/2-24	3 ⁵⁵ PM.	"	14.5563	A.R.M.
7/15-24	5 ¹⁰ P.M.	"	14.5611	A.R.M.
8-1-24	4 ¹⁰ PM.	"	14.5627	A.R.M.
8/17-24	2 ¹⁰ P.M.	"	14.5538	A.R.M.
9/2-24	5 ¹⁰ P.M.	"	14.5529	A.R.M.

Stain Gage.

8.220
8.223
8.215
8.211
8.218
8.208
8.208
8.193
8.194
8.178
8.190
8.185
8.200
8.202
8.210
8.211
8.229
8.219
8.210
8.211
8.214

(Continued on Page No 40)

Base of BUTTRESS No 15

Continued from page 8

34

DATE	Hour	Temp	A.B.	Observer
7/9-23	10:45AM	66°	14.7119	WDM
7/15-23	11-45AM	73°	14.7110	KQV
8/11/23	10 ¹⁹ AM	Cloudy 70°	14.7122	WDM
8/26-23	3 PM	Warm	14.7105	WDM
9/7-23	NOON	Hot	14.7080	WDM
9/12-23	NOON	Cloudy	14.7094	WDM
9/25-23	10:35AM	Cool	14.7111	WDM
10/9-23	10 AM	cloudy clear	14.7132	WDM
10/19-23	1 P.M.	Warm	14.7105	W.D.M.
11-12-23	10:15AM	Cool	14.7165	W.D.M.
"	"	"	14.7160	Clarkson
12-17-23	2 ⁵⁰ P.M.	Warm	14.7265	W.D.M.
"	"	"	14.7269	Clarkson
1/23-24	9 ³⁵ AM	Cold	14.7342	W.D.M.
2/8/24	10:50AM	Cool	14.7292	WDM
3/29/24	1100 AM	Cool	14.7305	WDM
4/24-24	3 P.M.	Cool	14.7250	WDM
5/14-24	10 ⁴⁰ AM	warm	14.7258	F.R.M.
6-3-24	11 ³⁰ AM	Warm	14.7239	F.R.M.
6/15-24	4 PM	Warm	14.7079	F.R.M.
7/2-24	4 ²⁰ PM	"	14.7066	F.R.M.
7/15-24	5 ²⁰ PM	"	14.7086	F.R.M.
8-1-24	4 ²⁵ PM	"	14.7082	F.R.M.
8/17-24	2 ²⁵ PM	"	14.7235	F.R.M.
9/2-24	5 ²⁵ PM	"	14.7220	F.R.M.

(Continued on Page 41)

Buttress No 21 Strain Gage.

DATE	Hour	Temp	Observer
9/7-23	Noon		8.267 W.D.M.
9/12-23	Noon	Cool cloudy	8.263 W.D.M.
9/25-23	10:30	Cool cloudy	8.245 W.D.M.
10/9-23	10 A.M.	Cool.	8.225 W.D.M.
10/19-23	1 P.M.	Warm.	8.245 W.D.M.
11/12-23	9 ⁵⁰ AM	Cool	8.208 W.D.M.
" " "	"	"	8.208 Clarkson.
" " "	"	"	8.208 Volk.
12/17-23	2 ⁴⁵ PM	Warm.	8.182 W.D.M.
" " "	"	"	8.182 Clarkson.
1/23-24	9 ²⁵ AM	Cold.	8.152 W.D.M.
2/9/24	10/42 AM.	Cool	8.169 W.D.M.
3/27-24	10:50 AM	Cool	8.159 "
4-24-24	3 P.M.	Cool	8.177 A.R.M. W.D.M.
5-14-24	10 ⁴⁰ AM.	Warm	8.168 A.R.M.
6/15-24	3 ⁴⁰ PM.	"	8.210 A.R.M.
7/2-24	4 ³⁵ PM.	"	8.219 A.R.M.
7/15-24	5 ¹⁰ PM.	"	8.221 A.R.M.
8-1-24	4 ⁴⁰ PM.	"	8.214 A.R.M.
8/17-24	1 ⁵⁵ PM.	"	8.236 A.R.M.
9/2-24	4 ⁴⁵ PM.	"	8.229 A.R.M.
9/14-24	4 ³⁰ PM.	"	8.226 A.R.M.
10/3-24	3 ⁴⁰ P.M.	Moderate	8.234 A.R.M.
10/20-24	2 ²⁵ P.M.	Moderate	8.196 A.R.M.

Continued on Page 43

Buttress No 17

North side. From pg. 14

36

DATE	Hour	Temp.	Micro.	Strain Gage	
10/9-23	10 AM	cloudy Cool	14.8506	8.134	W.D.M. ✓
10/19-23	1 P.M.	Warm.	14.8420	8.172	W.D.M.
11/12-23	9.30 AM	Cool	14.8549	8.107	W.D.M.
"	"	"	14.8542	8.108	Clarkson
12/17-23	2 ²⁰ PM	Warm.	14.8650	8.046	W.D.M.
12/17-23	2 ²⁰ PM	"	14.8647	8.044	Clarkson
1/23-24	9 ¹⁰ AM	Cold	14.8775	H.G.	W.D.M.
2/8/24	10:30 AM	Cool	14.8710	8.016	W.D.M.
3/29-24	9:30 AM	Cool	14.8761		W.D.M.
4/24-24	2-30 P.M.	Cool.	14.8698	8.189	W.D.M.
5/14-24	10 AM.	Warm.	14.8649	8.203	A.R.M.
6/3-24	10 ¹⁰ AM.	Warm	14.8692	8.227	A.R.M.
6/15-24	3 ⁴⁰ PM.	Warm	14.8723	8.258	A.R.M.
7/2-24	3 ²⁰ PM.	"	14.8627	8.274	A.R.M.
7/15-24	4 ²⁰ P.M.	"	14.8545	8.257	A.R.M.
8/1-24	5 P.M.	"	14.8532	8.252	A.R.M.
8/17-24	1 ¹⁰ PM	"	14.8439	8.265	A.R.M.
9/2-24	3 ²⁰ PM	"	14.8431	8.269	A.R.M.
9/14-24	3 ⁴⁵ P.M.	"	14.8421	8.262	A.R.M.
10/3-24	2 ⁵⁰ P.M.	Moderate	14.8418	8.269	A.R.M.
10/20-24	1 ⁴⁵ P.M.	Moderate	14.8568	8.182	A.R.M.
11/5-24	2 ²⁰ P.M.	Moderate	14.8593	8.187	A.R.M.
11/16-24	2 ¹⁰ P.M.	Warm	14.8722	8.109	A.R.M.
11/5-24	11 ²⁰ AM	Cool Cloudy	14.8717	8.107	A.R.M.
12/16-24	1 ⁰⁵ P.M.	Cool Rain	14.8713	8.109	A.R.M.

No reading on account of Expansion being over 8"
Repunched

Continued on Page 44

Buttress No 16

37

Continued From Page ³⁰ 29		A	B		
Date	Hour	Temp.	A.B.	F.C.	Obs
8/1-24	3:20 PM	warm	149052	144529	F.R.V.
					FB
					FC.
8/17-24	12 ⁵⁰ PM	"	149072	144507	F.R.M.
9/2-24	2 ⁵⁵ PM	"	149067	144513	F.R.M.
9/14-24	3 ²⁵ PM	"	149011	144500	F.R.M.
10/3-24	2:30 P.M.	Moderate	149014	144516	F.R.M.
10/20-24	1:40 P.M.	Moderate	149304	144554	F.R.M.
11/4-24	2:10 PM	"	149317	144590	F.R.M.
11/16-24	2 P.M.	warm	149418	144623	F.R.M.
12/5-24	11 ¹⁰ AM	cool	149426	144626	F.R.M.
12/16-24	12 ⁵⁰ P.M.	Cloudy	149439	144618	F.R.M.
		cool			
		Rain			
		clear			
1/2-25	11:10 AM	Moderate	149540	144581	F.R.M.
1/15-25	10:20 AM	clear	149527	144572	F.R.M.
2/4-25	10:40 AM	Moderate	149523	144575	F.R.M.
2/18-25	2:20 P.M.	clear	149543	144579	F.R.M.
		cool			
		Cloudy			
3/2-25	2:50 P.M.	clear	149553	144543	F.R.M.
		warm			
3/16-25	1:40 P.M.	clear	149488	144558	F.R.M.
		warm			
4/3-25	1:55 P.M.	clear	149553	144578	F.R.M.
		warm			
4/16-25	8:25 AM	1967 clouds	149221	144545	F.R.M.
		warm			
5-2-25	1:20 P.M.	clear	149278	144560	F.R.M.
		warm			
5/14-25	11:10 AM	clear	149279	144564	F.R.M.
		warm			
6/1-25	3:15 p.m.	Cloudy	149411	144511	C.L.M.
		cool			
6/13-25	3:10 PM	clear	149258	144510	C.L.M.
		warm			
7/1-25	3:05 PM	clear	149260	144514	C.L.M.
		warm			
7/17-25	7:19 AM	clear	149010	144523	C.L.M.
		hot			
8/12-25	2:35 PM	"	149016	144529	C.L.M.
8-16-25	3:40 P.M.	clear	149020	144520	C.L.M.
		warm			

Repunched strain Gage

Repunched strain gage. A.B

Contim PAGE 45

Buttress No 18

Date	Time	Temp.	B.C.	
9/2-24	3 ⁵⁰ PM	warm	14.0631	A.R.M.
9/14-24	3 ⁵⁵ PM	"	14.0614	A.R.M.
10/3-24	3.10 P.M.	Moderate	14.0631	A.R.M.
10/20-24	2 ⁰⁵ P.M.	Moderate	14.0707	A.R.M.
11/5-24	2.30 PM	"	14.0735	A.R.M.
11/16-24	2.20 AM	warm	14.0748	A.R.M.
12/5-24	11 ³⁰ AM.	cool cloudy	14.0829	A.R.M.
12/16-24	12.0 P.M.	cool Rain	14.0831	A.R.M.
1/2-25	11.30 AM.	clear Moderate	14.0785	A.R.M.
1/15-25	11 AM.	clear Moderate	14.0781	A.R.M.
2/4-25	11 ²⁰ AM.	clear Cool	14.0779	A.R.M.
2/18-25	2.45 PM.	cloudy Cool	14.0788	A.R.M.
3/2-25	3 ⁰⁵ P.M.	clear WARM	14.0587	A.R.M.
3/16-25	2 P.M.	clear WARM	14.0615	A.R.M.
4/3-25	2.15 P.M.	clear WARM	14.0747	A.R.M.
4/16-25	8.40 AM.	light clouds WARM	14.0691	A.R.M.
5-2-25	1.35 PM.	clear WARM	14.0726	A.R.M.
5/14-25	11 ²⁵ AM.	clear WARM	14.0727	A.R.M.
6/1-25	3 ³⁵ PM	cloudy Cool	14.0618	C.L.M.
6/15/25	3:30 PM	clear warm	14.0763	C.L.M.
7/1/25	3.20 PM	clear warm	14.0765	C.L.M.
7/7-25	7 ³⁰ AM	clear hot	14.0754	C.L.M.
8/2-25	2 ⁵⁰ PM	"	14.0760	C.L.M.
8-16-25	3 ⁵⁵ PM	clear warm	14.0760	C.L.M.
9-2-25	8 ⁵⁰ AM	"	14.0722	C.L.M.

CONTIN PAGE 46

Strain Gage.

8285

8301

8311

8198

8203

8110

8111

8104

8063

8055

8231

8233

8328

8326

8342

8327

8289

8289

8294

8332

8042

8096

8060

8020

8002

Repunched Strain Gage

Repunched strain gage

From Page 32
Buttress No 19

A.C. B.C.

A. / B. / C. 39

Date	Time	Temp.	A.B.	observer	Strain	Gage	
9/14-24	4 ¹⁵ PM	WARM.	149605	A.R.M. <small>CEMENT</small>	8280	8071	
10/3-24	3.30 PM	Moderate	149617	A.R.M.	8299	8076	
10/20-24	2.15 PM	Moderate	149737	A.R.M.	8180	8019	
11/5-24	2.45 PM	"	149720	A.R.M.	8207	8030	
11/16-24	2.35 PM	WARM.	149915	A.R.M.	8103	NO READING	
12/5-24	11.35 AM	Cool cloudy	15.0003	A.R.M.	8096	8232	BC Repunched strain Gage
12/16-24	1.30 PM	Cool Rain	-	A.R.M.	8093	8228	
1/2-25	11.35 AM	Clear Moderate	15.0028	A.R.M.	8055	8221	
1/15-25	11.10 AM	Clear Moderate	15.0036	A.R.M.	8057	8231	
2/4-25	11.30 AM	Clear Cool	14.3118	A.R.M.	8327	8225	AC Repunched
2/18-25	3 P.M.	Cloudy	15.0055	A.R.M.	8331	8237	
3/2-25	3.10 PM	Clear WARM.	14.9769	A.R.M.	8326	8274	
3/16-25	2.10 PM	Clear WARM.	14.9823	A.R.M.	8329	8245	
4/3-25	2.20 PM	Clear WARM.	14.9969	A.R.M.	8327	8219	
4/16-25	8.45 AM	light Clouds WARM.	14.9684	A.R.M.	8326	8271	
5-2-25	1.40 PM	Clear WARM.	14.9711	A.R.M.	8327	8232	
5/14-25	11.30 AM	Clear WARM.	14.9714	A.R.M.	8326	8228	
6/1-25	3.40 PM	Cloudy Cool	14.9834	C.L.M.	8320	8223	
6/1-25	1.30 PM	Clear	14.9878	W.D.H.			
6/18-25	3.40 PM	Clear WARM.	14.2767	C.L.M.	8332	8261	
7/1-25	3.30 PM	Clear WARM.	14.2781	C.L.M.	8009	8083	Repunched B.C and A.C
7/7-25	7.40 AM	Clear Hot	14.2614	C.L.M.	8060	8039	
8/2-25	3.00 PM	"	14.2750	C.L.M.	8092	8061	
8-16-25	4.05 PM	Clear WARM.	14.2741	C.L.M.	8021	8022	
9-2-25	9.00	"	14.2718	C.L.M.	8000	8002	

CONTIN PAGE 47

Base of Buttress No. 16

Strain Gage.

Date	Time	Temp.	A.B.	observer	Strain Gage
9/14-24	4:45 PM	warm	145505	A.R.M.	8211
10/3-24	4:25 P.M.	Moderate	145528	A.R.M.	8226
10/20-24	2:35 P.M.	Moderate	145537	A.R.M.	8198
11/5-24	3:25 PM	"	145571	A.R.M.	8179
11/16-24	2:50 PM	warm	145603	A.R.M.	8182
12/5-24	1:50 AM	cool cloudy	145611	A.R.M.	8177
12/16-24	2 P.M.	cool Rain	145633	A.R.M.	8175
1/2-25	1:50 AM	clear Moderate	145573	A.R.M.	8161
1/15-25	1:40 AM	clear Moderate	145570	A.R.M.	8154
2/4-25	1:50 AM	clear cool	145573	A.R.M.	8161
2/18-25	3:20 P.M.	cloudy cool	145591	A.R.M.	8167
3/8-25	3:20 PM	clear warm	145545	A.R.M.	8188
3/16-25	2:25 PM	clear warm	145549	A.R.M.	8167
4-3-25	2:30 PM	clear warm	145561	A.R.M.	8172
4/16-25	8:55 AM	light clouds warm	145544	A.R.M.	8188
5-2-25	1:50 PM	clear warm	145551	A.R.M.	8168
5/14-25	1:35 AM	clear warm	145551	A.R.M.	8179
6/1-25	4 P.M.	cloudy cool	145510	C.L.M.	8160
7/5-25	3:45 PM	clear warm	145510	C.L.M.	8196
7/1-25	3:40 PM	clear warm	145517	C.L.M.	8203
7/17-25	7:15 AM	clear hot	145516	C.L.M.	8215
8/2-25	2:10 PM	clear hot	145532	C.L.M.	8220
8-16-25	4:25 PM	clear warm	145550	C.L.M.	8190
9-2-25	9:20 AM	"	145540	C.L.M.	8179
9-19-25	9:60 AM	cloudy hot	145560	C.L.M.	8190

CONTIN PAGE 49

Base of Buttress No 15

41

Date	Time	Temp.	A.B.	observer
9/14-24	5 P.M.	warm	14.7312	F.R.M.
10/3-24	4:20 P.M.	Moderate	14.7309	F.R.M.
10/20-24	2:45 P.M.	Moderate	14.7216	F.R.M.
11/5-24	3-40 P.M.	"	14.7251	F.R.M.
11/16-24	3 P.M.	warm	14.7255	F.R.M.
12/5-24	11:55 AM	cool cloudy	14.7256	F.R.M.
12/16-24	2:20 P.M.	cool Rain	14.7239	F.R.M.
1/2-25	1 ⁵⁵ P.M.	clear Moderate	14.7293	F.R.M.
1/15-25	11 ⁵⁰ AM	clear Moderate	14.7281	F.R.M.
2/4-25	11:55 AM	clear Cool	14.7298	F.R.M.
2/18-25	3:30 P.M.	cloudy cool	14.7291	F.R.M.
3/2-25	3:25 P.M.	clear warm	14.7137	F.R.M.
3/16-25	2:35 P.M.	clear warm.	14.7139	F.R.M.
4/3-25	2:40 AM	clear warm.	14.7258	F.R.M.
4/16-25	9 ⁵ AM.	light clouds warm	14.7298	F.R.M.
5-2-25	1:55 PM.	clear warm	14.7298	F.R.M.
5/14-25	1:40 AM.	clear warm	14.7220	F.R.M.
6/1-25	4:05 P.M.	cloudy cool	14.7202	C.L.M.
6/15-25	4. P.M.	clear warm	14.7251	C.L.M.
7/1-25	3:45 P.M.	clear warm	14.7271	C.L.M.
7/17-25	7 a.m.	clear hot	14.7236	C.L.M.
8/2-25	2 P.M.	clear Hot	14.7242	C.L.M.
8-16-25	4:35 P.M.	clear warm	14.7195	C.L.M.
9-2-25	9 ²⁵ AM	clear warm	14.7155	C.L.M.
9/19, 25	9:50 AM	cloudy Hot	14.7181	C.L.M.

CONTIN PAGE 48

Buttress No 15

Continued From Page 10

A.C.

A/B42

C

Date	Hour	Temp	A.B.	A.C.	Obs.	Strain Gage
10/3-24	2.15 PM	Moderate	14.6729	14.3412	A.R.M.	8.103
10/20-24	1.30 PM	Moderate	14.6768	14.3427	A.R.M.	8.061
11/5-24	1.50 PM	"	14.6794	14.3456	A.R.M.	8.088
11/16-24	1.40 PM	Warm	14.6888	14.3524	A.R.M.	8.031
12/5-24	10.55 AM	Cool Cloudy	14.6928	14.3523	A.R.M.	8.147 Repunch
12/16-24	12.40 PM	Cool Rain	14.6907	14.3536	A.R.M.	8.153
1/2-25	11 AM	Clear Moderate	14.7048	14.3535	A.R.M.	8.134
1/15-25	10.10 AM	Clear Moderate	14.7057	14.3547	A.R.M.	8.128
2/4-25	10.45 AM	Clear Cool	14.7046	14.3548	A.R.M.	8.127
2/18-25	2.10 PM	Cloudy Cool	14.7071	14.3539	A.R.M.	8.131 ✓
3/2-25	2.35 PM	Clear Warm	14.6774	14.3500	A.R.M.	8.159
3/16-25	1.30 PM	Clear Warm	14.6833	14.3518	A.R.M.	8.144
4/3-25	1.40 PM	Clear Warm	14.7025	14.3551	A.R.M.	8.123
4/16-25	8.11 AM	Light Clouds Warm	14.6766	14.3542	A.R.M.	8.161
5/2-25	1.15 PM	Clear Warm	14.6793	14.3532	A.R.M.	8.136
5/14-25	10.50 AM	Clear Warm	14.6908	14.3526	A.R.M.	8.136
6/1-25	3 PM	Cloudy Cool	14.6714	14.3504	C.L.M.	8.113
6/15-25	3 PM	Clear Warm	14.6765	14.3504	C.L.M.	8.165
7/1-25	3.7 PM	Clear Warm	14.6767	14.3506	C.L.M.	8.164
7/17-25	7.9 AM	Clear Hot	14.6772	14.3521	C.L.M.	8.192
8/17-25	2.2 PM	"	14.6782	14.3533	C.L.M.	8.199
8/16-25	3.30 PM	Clear Warm	14.6753	14.3525	C.L.M.	8.138
9-2-25	8.15 AM	Clear Warm	14.6735	14.3509	C.L.M.	8.125
9-17-25	9.30 AM	Cloudy Hot	14.6780	14.354	C.L.M.	8.142
10-4-25	10.30 AM	Warm Raining	14.6772	14.350	C.L.M.	8.131

Continued on Page 50

(From Page 35)

43

DATE	BUTTRESS No 21	5train Cage	
DATE	HOURE	TEMP	Observer
11/5-24	3:15 P.M.	Moderate	8.319 A.R.M.
11/16-24	2:45 P.M.	Warm	8.259 A.R.M.
12/5-24	11:40 A.M.	Cool Cloudy	8.160 A.R.M.
12/16-24	1:45 P.M.	Cool Rain	8.153 A.R.M.
1/2-25	11:45 A.M.	Clear Moderate	8.138 A.R.M.
1/15-25	11:25 A.M.	Clear Moderate	8.137 A.R.M.
2/4-25	11:40 A.M.	Clear Cool	8.147 A.R.M.
2/18-25	3:10 P.M.	Cloudy Cool	8.151 A.R.M.
3/2-25	3:15 P.M.	Clear Warm	8.191 A.R.M.
3/16-25	2:15 P.M.	Clear Warm	8.176 A.R.M.
4/3-25	2:25 P.M.	Clear Warm	8.158 A.R.M.
4/16-25	8:50 A.M.	Light Clouds Warm	8.190 A.R.M.
5-2-25	1:45 P.M.	Clear Warm	8.171 A.R.M.
5/14-25	11:30 A.M.	Clear Warm	8.173 A.R.M.
6/1-25	3:50 P.M.	Cloudy Cool	8.157 C.L.M.
6/15-25	3:35 P.M.	Clear Warm	8.162 C.L.M.
7/1-25	3:40 P.M.	Clear Warm	8.170 C.L.M.
7/17-25	7:45 A.M.	Clear Hot	8.211 C.L.M.
8/2-25	3:15 P.M.	"	8.236 C.L.M.
8-16-25	4:20 P.M.	Clear Warm	8.202 C.L.M.
9.2.25	9:00 A.M.	"	8.184 C.L.M.
9-17-25	9:40 A.M.	Cloudy Hot	8.204 C.L.M.
10-4-25	11:15 A.M.	Rainy	8.191 C.L.M.
10-16-25	12:55 P.M.	Cloudy Cool	8.152 C.L.M.

(Contn Page 51)

Buttress No 17
North Side From page No. 36

Date	Hour	Temp.	MICRO	Strain Gage
1/2-25	11:25 AM	clear Moderate	14.8769	8.058 A.R.M.
1/15-25	10:35 AM	clear Moderate	14.8773	8.056 A.R.M.
2/4-25	11:10 AM	clear Cool	14.8760	8.249 A.R.M.
2/18-25	2:35 PM	Cloudy Cool	14.8759	8.241 A.R.M.
3/2-25	3 P.M.	clear WARM	14.8567	8.323 A.R.M.
3/16-25	1:55 PM	clear WARM	14.8596	8.305 A.R.M.
4/3-25	2:05 P.M.	clear WARM	14.8763	8.359 A.R.M.
4/16-25	8:35 A.M.	light clouds warm	14.8554	8.328 A.R.M.
5-2-25	1:30 PM.	clear WARM	14.8710	8.301 A.R.M.
5/14-25	11:20 AM	clear WARM	14.8696	8.307 A.R.M.
6/1-25	3:30 P.M.	cloudy cool	14.8614	8.298 C.L.M.
6/15-25	3:20 P.M.	clear warm	14.8512	8.332 C.L.M.
7/1-25	3:15 P.M.	clear warm	14.8514	8.102 C.L.M.
7/7-25	7:20 AM	clear hot	14.8423	8.133 C.L.M.
8/2-25	2:45 P.M.	"	14.8460	8.142 C.L.M.
8-16-25	3:55 P.M.	clear warm	14.8416	8.106 C.L.M.
9-2-25	8:45 AM	"	14.8400	8.065 C.L.M.
9-17-25	9:20 AM	cloudy hot	14.8447	8.096 C.L.M.
10-4-25	9:45 AM	Rain Went	14.8440	8.082 C.L.M.
10/16-25	12:20 P.M.	cloudy cool	14.8514	8.000 C.L.M.
11-2-25	3:10 P.M.	cloudy cool	14.8520	8.000 C.L.M.
11-17-25	9:25 AM	clear cool	14.8673	8.163 C.L.M.
12-4-25	3:35 P.M.	clear warm	14.8610	8.139 C.L.M.
12-16-25	3:20 P.M.	cloudy cool	14.8633	8.157 C.L.M.
1-3-26	9:20 AM	cloudy cool	14.8612	8.130 C.L.M.
1-1	Continued to Page 52			C.L.M.

Reponched Strain Gage

Reponched strain gauge

DATE	HOUR	TEMP	AB	AC	Obs	AB.	AC
9-2-25	8 ³⁰ AM	CLEAR WARM	149010	144500	CLM	8016	8242
9-17-25	9 ¹⁰ AM	Cloudy HOT	149162	144587	CLM	8067	8291
10-4-25	10 ³⁵ AM	Rainy Windy	149048	144543	CLM	8050	8278
10-16-25	12 ¹⁰ PM	Cloudy Cool	149140	144575	CLM	8009	8210
11-2-25	2 ⁵⁰ PM	Cloudy Cool	149152	144521	CLM	8000	8215
11-17-25	9 ¹⁰ AM	Clear Cool	149290	144760	CLM	8122	8294
12-4-25	3 ²⁵ PM	CLEAR WARM	149270	144705	CLM	8103	8252
12-16-25	3 ¹⁰ PM	CLOUDY COOL	149286	144721	CLM	8112	8265
1-3-26	9 ¹⁰ AM	CLOUDY COOL	149250	144700	CLM	8100	8251
1-17-26	2 ²⁵ PM	Cloudy Cool	149341	144802	CLM	8192	8322
2-3-26	11 ⁰⁵ AM	CLOUDY COOL	149420	144870	CLM	8211	—
2-16-26	10 ³⁰ AM	Rainy Cool	149440	144881	CLM	8230	—
3-1-26	11 ⁰⁰ AM	Clear WARM	149350	144790	CLM	8200	—
3-17-26	8 ²⁰ AM	CLOUDY WARM	149305	144761	CLM	8170	—
4-3-26	8 ¹⁰ "	CLOUDY COOL	149411	144879	CLM	8221	—
4-9-26	8 ²⁰ "		149316	144760			
5-1-26	no reading by order of Mr. Musard						
5-10-26	12 ¹⁰ PM	Clear warm	1495010	144523	CLM		
6-2-26	8 ¹⁰ AM	foggy warm	149498	144506	CLM		
7-19-26	10 ³⁵ AM	Clear HOT	149399	144410	"		
8-2-26	11 ¹⁰ AM	"	149409	144460	"		
8-18-26	12 ²⁵ PM	"	149378	144409	"		

DATE	TIME	TEMP	BC	Obsrv
9-17-25	9 ²⁵ AM	Cloudy Hot	140762	CLM
10-4-25	10 ⁵	Rainy Warm	140736	CLM
10-16-25	12 ³⁰ PM	Cloudy Cool	140700	CLM
11-2-25	3 ¹⁵ PM	"	140712	CLM
11-17-25	9 ³⁵ AM	Clear Cool	140901	CLM
12-4-25	3 ⁴⁵ PM	Clear Warm	140865	CLM
12-16-25	3 ³⁰ PM	CLOUDY Cool	140892	CLM
1-3-26	9 ³⁰ AM	CLOUDY Cool	140883	CLM
1-17-26	2 ⁴⁵ PM	Cloudy Cool	140990	CLM
2-3-26	11 ²⁰ a.m.	"	140998	CLM
2-16-26	10 ⁴⁵ a.m.	Rainy Cool	141013	CLM
3-2-26	11 ²⁵ AM	CLAY Warm	140922	CLM
3-17-26	8 ⁴⁰ AM	CLOUDY WARM	140900	CLM
4-3-26	8 ²⁵ "	CLOUDY Cool	140983	CLM
4-9-26	8 ³⁵ "	"	140881	
5-1-26	no reading by order, Mr. Kincaid			
5-10-26	12 ³⁰ PM	Clear warm	140810	CLM
6-2-26	8 ⁴⁰ AM	Foggy warm	140796	CLM
7-19-26		CLEAR Hot	140698	CLM
8-2-26	11 ³⁰ AM	"	140904	"
8-18-26	1 ²⁵ PM	"	140716	"
9-10-26	2 ³⁰ PM	Clear warm	140516	F.P.L.

Strain Gauge

From PAGE 38

8.041

8.023

8.000

8.000

8.091

8.060

8.079

8.063

8.162

8.192

8.203

8.131

8.113

8.147

From Page 39
Buttress No 19

Date	Time	Temp	AB	Observed
9-17-25	9:35 AM	Cloudy Hot	142743	CLM
10-9-25	11:10 AM	Rainy Wash	142727	CLM
10-16-25	12:35 PM	Cloudy Cool	142920	CLM
11-2-25	3:25 PM	"	142900	CLM
11-17-25	9:40 AM	Clear Cool	143960	CLM
12-4-25	3:55 PM	CLEAR WARM	142895	CLM
12-16-25	3:35 PM	CLOUDY COOL	142912	CLM
1-3-26	9:45 AM	CLOUDY COOL	142901	CLM
1-17-26	3:00 PM	Cloudy Cool	143019	CLM
2-3-26	11:25 AM	"	143087	CLM
2-16-26	10:55 AM	Rainy Cool	143092	CLM
3-2-26	11:35 "	CLEAR WARM	143002	CLM
3-17-26	8:50 AM	CLOUDY WARM	142981	CLM
4-3-26	8:35 "	CLOUDY COOL	143016	CLM
4-9-26	8:40 "	"	142993	
5-1-26	no reading	by order	Mr. Mucari	
5-10-26	12:40	clear warm	143270	CLM
6-2-26	8:50	foggy warm	143199	CLM
7-19-26	10:50 AM	Clear Hot	143104	CLM
8-2-26	11:40 AM	"	143122	"
8-18-26	1:40 PM	"	143100	"
9-10-26	2:40 PM	Clear Warm	143030	FRM

Strain Gauge

47

AC	BC
8028	8021
8001	8236
8070	8208
8023	8216
8151	8321
8101	8285
8116	8298
8100	8269
8201	8321
8203	8-
8251	-
8178	8-
8170	-
8204	-

B.C.
Repaired Strain Gauge
" " AC

BASE BUTTESS 71015

DATE	TIME	TEMP	WB	OBSERV.
10-4-25	11:45 AM	Rainy Wet	147164	CLM
10-16-25	11:5 PM	Cool cloudy	147603	CLM
11-2-25	4:10 PM	"	147621	CLM
11-17-25	10:10 AM	Clear cool	147135	CLM
12-4-25	4:25 PM	CLEAR WARM	147100	CLM
12-16-25	3:55 PM	CLOUDY COOL	147123	CLM
1-3-26	10:15 AM	CLOUDY COOL	147100	CLM
1-17-26	3:15 PM	cloudy cool	147202	CLM
2-3-26	11:45 AM	"	147268	CLM
2-16-26	10:00 AM	Rainy cool	147275	CLM
3-2-26	11:50 "	CLEAR WARM	147100	CLM
3-17-26	9:10 AM	CLOUDY WARM	147090	CLM
4-3-26	9:15 AM	CLOUDY COOL	148001	CLM
7-19-26	10:10 AM	CLEAR HOT	147910	CLM
8-2-26	No Reading			
8-18-26	No Reading			

From Page 40
BASE Buttress 71016

DATE	TIME	TEMP	AB	Observation
10-4-25	11 ⁴⁰ AM	Rainy warm	145535	CLM
10-16-25	1 ⁰⁰ PM	cloudy cool	145500	CLM
11-2-25	3 ⁵⁵ PM	"	145579	CLM
11-17-25	10 ⁰⁵ AM	clear cool	145702	CLM
12-4-25	4 ¹⁵ PM	CLOUDY WARM	145668	CLM
12-16-25	4 ¹⁰ PM	CLOUDY cool	145699	CLM
1-3-26	10 ¹⁰ AM	CLOUDY cool	145663	CLM
1-17-26	3 ²⁰ PM	cloudy cool	145730	CLM
2-3-26	12 ⁰⁰	"	145794	CLM
2-16-26	10 ⁰⁵	Rainy cool	145800	CLM
3-2-26	12 ⁰⁰	CLEAR WARM	145714	CLM
3-17-26	9 ⁰⁰	CLOUDY WARM	145700	CLM
4-3-26	9 ⁰⁵ AM	CLOUDY cool	145771	CLM
5-1-26	no reading			
5-10-26	12 ⁵⁰	clear warm	145613	CLM
6-2-26	9 AM	foggy warm	145306	CLM
7-19-26	11 ⁰⁵ AM	CLEAR HOT	195216	CLM
8-2-26				"
8-18-26	did not Read			"
9-10-26	2 ¹⁰ PM	clear warm	14.4513	F.R.L.

STAIR GAUGE

49

8176

8103

8122

8201

8157

8177

8163

8204

8240

8245

8164

8140

8183

From Page 42 Buttress No 15

STRIM GAUGE

A/B 50

DATE	HOURS	Temp	A B	A C		
10-16-25	12 noon	Cloudy Cool	146995	143531	CLM	8100
11-2-25	2 ⁴⁵ Pm	"	146819	143550	CLM	8141
11-17-25	9 ⁰⁰ AM	Clear Cool	147007	143615	CLM	8190
12-4-25	3 ¹⁵ Pm	CLEAR WARM	147000	143601	CLM	8128
12-16-25	3 ⁰⁰ Pm	CLOUDY COOL	147021	143631	CLM	8139
1-3-26	9 ¹⁰ AM	CLOUDY COOL	147000	143620	CLM	8130
1-17-26	2 ²⁰ Pm	CLOUDY COOL	147101	143701	CLM	8200
2-3-26	11 ⁰⁰ AM	CLOUDY COOL	147172	143783	CLM	8210
2-16-26	10 ³⁰ AM	COOL RAIN	147180	143792	CLM	8225
3-2-26	10 ⁵⁰ AM	CLEAR WARM	147091	143700	CLM	8121
3-17-26	8 ¹⁰ AM	CLOUDY WARM	147020	143673	CLM	8091
4-3-26	8 ⁰⁰ "	CLOUDY COOL	147121	143789	CLM	8110
4-9-26	8 ¹⁵ "	COOL CLOUDY	147010	143678		
5-1-26	no reading by order of Mr. Kincaid					
5-10-26	12 noon	Clear warm	147000	143680	CLM	
6-2-26	8.9 AM	Foggy warm	146992	143650	CLM	
7-19-26	10 ²⁰ AM	CLEAR HOT	146910	143528	CLM	
8-2-26	11 AM	"	146993	143564	"	
8-18-26	12 ⁰⁰ Pm	"	146921	143512	"	
9-10-26	2 ⁰⁰ P.M.	Clear warm	146767	143675	FR.L.	
10-7-26	Noon	—	14.619		H.C.R.	
10-8-26	✓	✓	14.695		✓	
10-9-26	✓	✓	14.695		✓	
10-10-26	✓	✓	14.7005		✓	
10-11-26	✓	✓	14.703		✓	

Continued on page 60

(From Page 43)

Buttress No 21

Strain Gauge

Date	Hour	Temp	Observed
11-2-25	3:40 Pm	Cloudy Cool	8169 CLM
11-17-25	9:55 Am	Clear Cool	8182 CLM
12-4-25	4:05 Pm	CLEAR WARM	8159 CLM
12-16-25	3:45 Pm	CLOUDY COOL	8169 CLM
1-3-26	10:00 Am	CLOUDY Cool	8153 CLM
1-17-26	3:05 Pm	Cloudy Cool	8193 CLM
2-3-26	11:35 Am	..	8200 CLM
2-16-26	11:05 Am	Rainy Cool	8212 CLM
3-2-26	11:45 Am	CLEAR WARM	8164 CLM
3-17-26	8:50 am	CLOUDY WARM	8170 CLM
4-3-26	8:45 "	CLOUDY Cool	8209 CLM
4-9-26			

51

Discontinued Reading Strain Gauge

Buttrick # 17

From PAGE # 44

52

Date	Hour	Temp.	micro	Strains
1-17-26	2:35 PM	cool cloudy	148714	8207 CLM
2-3-26	11:15 AM	"	148746	8223 CLM
2-16-26	10:30 AM	Rainy cool	148758	8232 CLM
3-2-26	11:20 AM	CLEAR WARM	148659	8148 CLM
3-17-26	8:30 AM	CLOUDY WARM	148619	8129 CLM
4-3-26	8:15 "	CLOUDY COOL	148723	8154 CLM
4-9-26	8:25 "		148609	
5-1-26		no reading	by order of Mr. Keweenaw	
5-10-26	12:20	clear warm	148812	CLM
6-2-26	8:20	foggy warm	148790	CLM
7-19-26	10:40 AM	CLEAR 14:56	148708	CLM
8-2-26	11:20 AM	"	148681	"
8-18-26	1:30 PM	"	148700	"
9-10-26	2:20 PM	clear warm	148514	FRM
10-7-26	Noon	—	14.866	A.C.R.
10-8-26	✓	✓	14.867	✓
10-9-26	✓	✓	14.8675	✓
10-10-26	✓	✓	14.8725	✓
10-11-26	✓	✓	14.874	✓
10-12-26	✓	✓	14.876	✓
10-13-26	✓	✓	14.8505	✓
10-14-26	✓	✓	14.877	✓
10-22-26	✓	✓	14.881	✓
11-2-26	✓	✓	14.880	✓
11-13-26	✓	✓	14.879	✓

Continued on next page

Buttress #17

53

Date	Hour	Temp	Micro	Observer
12-2-26	Noon	—	14.893	H.C.R.
12-8-26	✓	✓	14.901	✓
12-25-26	✓	✓	14.914	✓

Buttress #15

60

Continued from page 50

Date	Hour	Weather	^{A.B.} Micro	Observer
10-12-26	Noon	-	14.7005	H.C.R.
10-13-26	✓	✓	14.7005	H.C.R.
10-14-26	✓	✓	14.705	✓
10-22-26	✓	✓	14.706	✓
11-2-26	✓	✓	14.704	✓
11-13-26	✓	✓	14.7105	✓
12-2-26	✓	✓	14.716	✓
12-8-26	✓	✓	14.725	✓
12-25-26	✓	✓	14.736	✓

Readings to be taken.				page.
1-	North side	Buttress No 15	-	29
2-	South side	"		No 16 - 30
3-	North	"	"	No 17 - 34
4-	South	"	"	No 18 - 31
5	"	"	"	No 19 - 32
6	North	"	"	No 21 - 35

Base of Buttress

7	South side	Buttress No 16		33
8	"	"	"	No 15 34

Hourly Readings Buttress No 16

DATE	Time	Temp	A.B.	A.C.	Strap A.B.	70 AC
11/12-23	9:40 AM	66°	14.9210	14.4537	8.033	8.1125
"	10:45	67°	14.9215	14.4535	8.030	8.1135
"	noon	68°	14.9215	14.4532	8.032	8.114
"	1 P.M.	68°	14.9210	14.4536	8.032	8.115
"	2 P.M.	70°	14.9198	14.4524	8.036	8.117
"	3 P.M.	70°	14.9201	14.4528	8.039	8.118
"	4 P.M.	69°	14.9206	14.4529	8.041	8.117

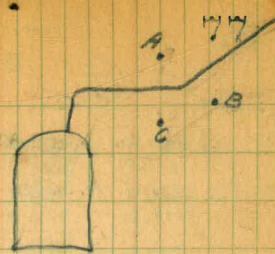

Records by Clarkson & McFadden

Hourly Readings Buttress No 19

			A.B.	A.C.	B.C.
11/12-23	9:50	66°	14.9707	8.009	8.077
"	11:00	67°	14.9708	8.008	8.077
"	12:30	68°	14.9708	8.011	8.077
"	1 P.M.	68°	14.9708	8.014	8.078
"	2 P.M.	70°	14.9693	8.021	8.081
"	3 P.M.	70°	14.9702	8.022	8.080
"	4 P.M.	69°	14.9703	8.024	8.081

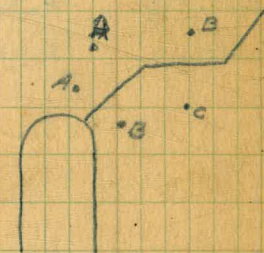

Hourly Readings Buttress No 16

			A.B.	A.B.
11/12-23	10:30	66°	14.5592	8.208
"	11:30	67°	14.5592	8.208
"	12:45	68°	14.5592	8.208
"	1 P.M.	68°	14.5589	8.208
"	2 P.M.	70°	14.5588	8.209
"	3 P.M.	69°	14.5585	8.210
"	4 P.M.	69°	14.5590	8.209

End - Temp - W. end

60° 66.5°
60° 66°

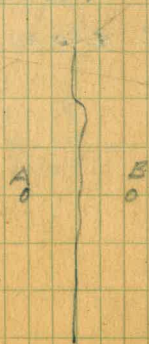

Hourly Readings
Buttress #16

Strain gauge

Date	Time	Temp	AB	AC	AB	AC
11/12/23	10:40 PM	60°	14.9198	14.4532	8.0380	8.115
11-13-23	4:20 AM	56°	14.9215	14.4544	8.0300	8.111

E.H.C. Jr.
K.G.U.

14.9288	14.4543	8.028	8.109
14.9210	14.4544	8.031	8.113
14.9212	14.4539	8.028	8.112
14.9219		8.037	8.111
59	174		
14.9215	14.4544		

94
86

AB AC AC

c 14.9697	8.077 c	8.027 c
14.9697	8.079	8.027
14.9710	8.078 v	8.017
14.9702	8.077	8.017
14.9700	8.078	8.0195

Buttress No 16 - Bottom -

AB

11-12-23	12:55 P.M.	60°	14.5589	8.208
11-13-23	9:30 AM	56°	14.5603	8.204

59.8 62.0

14.5589	8.208
14.5588	8.208
14.5590	8.208
14.5596	8.208

14.5604	8.202
14.5605	8.204
14.5602	8.204
14.5604	8.205

Sta Defl. Benning Rod

79

Station	+	H.I.	-	Elev	Grade
B.M.				100.00	
	5.00	105.00			
0+00			4.6	95.4	
1+00			4.5	95.5	
2+00			4.3	95.7	
			5.10	99.90	
	4.00	103.90			
3+00			4.6		

1.01
00.02
000.002

1492.50

1492.5

#19 4.50 1.04 - 11-13-23.

14.9722	8.078	8.013
14.9715	8.076	8.014
28	8.078	8.015
1.5		8.013
19		8.013

N 15 2
N 16 3
N 17 2
S 18 2v
N 19 3v
N 21 2
Baton 16 2

14.650
14.650

AC
14.4538
4537
14.4530
4530
14.4532

AB	AC	AD
14.9192	8.1150	8.038
14.9196	8.1140	8.037
14.9198	8.117	8.038
14.9200	8.115	8.038
786	451.0	
9198	.1123	.038

Tangents and Externals to a 1° Curve.

Angle	Tangent	External	Angle	Tangent	External	Angle	Tangent	External
1°	50.00	.22	11°	551.70	26.50	21°	1061.9	97.57
10'	53.34	.30	10'	560.11	27.31	10'	1070.6	99.16
20	66.67	.39	20	568.53	28.14	20	1079.2	100.75
30	75.01	.49	30	576.95	28.97	30	1087.8	102.35
40	83.34	.61	40	585.36	29.82	40	1096.4	103.97
50	91.68	.73	50	593.79	30.68	50	1105.1	105.60
2	100.01	.87	12	602.21	31.56	22	1113.7	107.24
10	108.35	1.02	10	610.64	32.45	10	1122.4	108.90
20	116.68	1.19	20	619.07	33.35	20	1131.0	110.57
30	125.02	1.36	30	627.50	34.26	30	1139.7	112.25
40	133.36	1.55	40	635.93	35.18	40	1148.4	113.95
50	141.70	1.75	50	644.37	36.12	50	1157.0	115.66
3	150.04	1.96	13	652.81	37.07	23	1165.7	117.38
10	158.38	2.19	10	661.25	38.03	10	1174.4	119.12
20	166.72	2.43	20	669.70	39.01	20	1183.1	120.87
30	175.06	2.67	30	678.15	39.99	30	1191.8	122.63
40	183.40	2.93	40	686.60	40.99	40	1200.5	124.41
50	191.74	3.21	50	695.06	42.00	50	1209.2	126.20
4	200.08	3.49	14	703.51	43.03	24	1217.9	128.00
10	208.43	3.79	10	711.97	44.07	10	1226.6	129.82
20	216.77	4.10	20	720.44	45.12	20	1235.3	131.65
30	225.12	4.42	30	728.90	46.18	30	1244.0	133.50
40	233.47	4.76	40	737.37	47.25	40	1252.8	135.35
50	241.81	5.10	50	745.85	48.34	50	1261.5	137.23
5	250.16	5.46	15	754.32	49.44	25	1270.2	139.11
10	258.51	5.83	10	762.80	50.55	10	1279.0	141.01
20	266.86	6.21	20	771.29	51.68	20	1287.7	142.93
30	275.21	6.61	30	779.77	52.89	30	1296.5	144.85
40	283.57	7.01	40	788.26	53.97	40	1305.3	146.79
50	291.92	7.43	50	796.75	55.13	50	1314.0	148.75
6	300.28	7.86	16	805.25	56.31	26	1322.8	150.71
10	308.64	8.31	10	813.75	57.50	10	1331.6	152.69
20	316.99	8.76	20	822.25	58.70	20	1340.4	154.69
30	325.35	9.23	30	830.76	59.91	30	1349.2	156.70
40	333.71	9.71	40	839.27	61.14	40	1358.0	158.72
50	342.08	10.20	50	847.78	62.38	50	1366.8	160.76
7	350.44	10.71	17	856.30	63.63	27	1375.6	162.81
10	358.81	11.22	10	864.82	64.90	10	1384.4	164.86
20	367.17	11.75	20	873.35	66.18	20	1393.2	166.95
30	375.54	12.29	30	881.88	67.47	30	1402.0	169.04
40	383.91	12.85	40	890.41	68.77	40	1410.9	171.15
50	392.28	13.41	50	898.95	70.09	50	1419.7	173.27
8	400.66	13.99	18	907.49	71.42	28	1428.6	175.41
10	409.03	14.58	10	916.03	72.76	10	1437.4	177.55
20	417.41	15.18	20	924.58	74.12	20	1446.3	179.72
30	425.79	15.80	30	933.13	75.49	30	1455.1	181.89
40	434.17	16.43	40	941.69	76.86	40	1464.0	184.08
50	442.55	17.07	50	950.25	78.26	50	1472.9	186.29
9	450.93	17.72	19	958.81	79.67	29	1481.8	188.51
10	459.32	18.38	10	967.38	81.09	10	1490.7	190.74
20	467.71	19.06	20	975.96	82.53	20	1499.6	192.99
30	476.10	19.75	30	984.53	83.97	30	1508.5	195.25
40	484.49	20.45	40	993.12	85.43	40	1517.4	197.53
50	492.88	21.16	50	1001.7	86.90	50	1526.3	199.82
10	501.28	21.89	20	1010.3	88.39	30	1535.3	202.12
10	509.68	22.62	10	1018.9	89.89	10	1544.2	204.44
20	518.08	23.38	20	1027.5	91.40	20	1553.1	206.77
30	526.48	24.14	30	1036.1	92.92	30	1562.1	209.12
40	534.89	24.91	40	1044.7	94.46	40	1571.0	211.48
50	543.29	25.70	50	1053.3	96.01	50	1580.0	213.86

TABLE OF STADIA REDUCTIONS.—Continued.

Min.	9°		10°		11°		12°		13°		14°		15°	
	Hor. Dist.	Diff. Elev.	Hor. Dist.	Diff. Elev.	Hor. Dist.	Diff. Elev.	Hor. Dist.	Diff. Elev.	Hor. Dist.	Diff. Elev.	Hor. Dist.	Diff. Elev.	Hor. Dist.	Diff. Elev.
0	98.06	13.78	97.55	15.45	96.86	17.10	95.84	18.73	94.54	21.32	92.98	23.87	91.19	26.50
2	98.05	13.84	97.52	15.51	96.85	17.16	95.83	18.79	94.53	21.38	92.97	23.93	91.18	26.55
4	98.04	13.89	97.49	15.56	96.84	17.21	95.82	18.84	94.52	21.44	92.96	24.00	91.17	26.60
6	98.03	13.95	97.46	15.62	96.83	17.26	95.81	18.89	94.51	21.50	92.95	24.06	91.16	26.65
8	98.00	14.00	97.43	15.67	96.82	17.31	95.80	18.94	94.50	21.56	92.94	24.12	91.15	26.70
10	97.98	14.06	97.40	15.73	96.81	17.37	95.79	18.99	94.49	21.62	92.93	24.18	91.14	26.75
12	97.95	14.12	97.37	15.78	96.80	17.43	95.78	19.05	94.48	21.68	92.92	24.24	91.13	26.80
14	97.93	14.18	97.34	15.84	96.79	17.49	95.77	19.11	94.47	21.74	92.91	24.30	91.12	26.85
16	97.91	14.23	97.31	15.89	96.78	17.54	95.76	19.17	94.46	21.80	92.90	24.36	91.11	26.90
18	97.89	14.28	97.28	15.95	96.77	17.59	95.75	19.23	94.45	21.86	92.89	24.42	91.10	26.95
20	97.86	14.34	97.25	16.00	96.76	17.65	95.74	19.29	94.44	21.92	92.88	24.48	91.09	27.00
22	97.84	14.40	97.22	16.06	96.75	17.70	95.73	19.35	94.43	21.98	92.87	24.54	91.08	27.05
24	97.82	14.45	97.19	16.11	96.74	17.76	95.72	19.41	94.42	22.04	92.86	24.60	91.07	27.10
26	97.80	14.51	97.16	16.17	96.73	17.81	95.71	19.47	94.41	22.10	92.85	24.66	91.06	27.15
28	97.78	14.56	97.13	16.22	96.72	17.87	95.70	19.53	94.40	22.16	92.84	24.72	91.05	27.20
30	97.76	14.62	97.10	16.28	96.71	17.92	95.69	19.59	94.39	22.22	92.83	24.78	91.04	27.25
32	97.74	14.67	97.07	16.33	96.70	17.98	95.68	19.65	94.38	22.28	92.82	24.84	91.03	27.30
34	97.72	14.73	97.04	16.39	96.69	18.03	95.67	19.71	94.37	22.34	92.81	24.90	91.02	27.35
36	97.70	14.79	97.01	16.44	96.68	18.09	95.66	19.77	94.36	22.40	92.80	24.96	91.01	27.40
38	97.68	14.84	96.98	16.50	96.67	18.14	95.65	19.83	94.35	22.46	92.79	25.02	91.00	27.45
40	97.66	14.90	96.95	16.56	96.66	18.19	95.64	19.89	94.34	22.52	92.78	25.08	90.99	27.50
42	97.64	14.95	96.92	16.61	96.65	18.24	95.63	19.95	94.33	22.58	92.77	25.14	90.98	27.55
44	97.62	15.01	96.89	16.66	96.64	18.30	95.62	20.01	94.32	22.64	92.76	25.20	90.97	27.60
46	97.60	15.06	96.86	16.72	96.63	18.35	95.61	20.07	94.31	22.70	92.75	25.26	90.96	27.65
48	97.58	15.12	96.83	16.77	96.62	18.41	95.60	20.13	94.30	22.76	92.74	25.32	90.95	27.70
50	97.56	15.17	96.80	16.83	96.61	18.46	95.59	20.19	94.29	22.82	92.73	25.38	90.94	27.75
52	97.54	15.23	96.77	16.88	96.60	18.51	95.58	20.25	94.28	22.88	92.72	25.44	90.93	27.80
54	97.52	15.28	96.74	16.94	96.59	18.57	95.57	20.31	94.27	22.94	92.71	25.50	90.92	27.85
56	97.50	15.34	96.71	17.00	96.58	18.62	95.56	20.37	94.26	23.00	92.70	25.56	90.91	27.90
58	97.48	15.40	96.68	17.05	96.57	18.68	95.55	20.43	94.25	23.06	92.69	25.62	90.90	27.95
60	97.46	15.45	96.65	17.10	96.56	18.73	95.54	20.49	94.24	23.12	92.68	25.68	90.89	28.00
c=.75	74	.31	74	.12	74	.14	.73	16	.73	16	.73	17	.73	19
c=1.15	1.14	.17	1.13	.19	1.13	.21	1.13	.23	1.12	.25	1.12	.27	1.11	.29
c=1.90	1.88	.28	1.87	.31	1.87	.35	1.86	.38	1.85	.41	1.84	.44	1.83	.48

Published by the A. LIETZ CO., San Francisco, Cal.

TABLE OF STADIA REDUCTIONS.—Continued.

Min.	16°		17°		18°		19°		20°		21°		22°		23°	
	Hor. Dist.	Diff. Elev.	Hor. Dist.	Diff. Elev.	Hor. Dist.	Diff. Elev.	Hor. Dist.	Diff. Elev.	Hor. Dist.	Diff. Elev.	Hor. Dist.	Diff. Elev.	Hor. Dist.	Diff. Elev.	Hor. Dist.	Diff. Elev.
0	92.40	26.79	91.26	28.25	90.24	29.67	89.18	31.06	88.08	32.41	86.92	33.72	85.72	34.98	84.48	36.21
2	92.37	26.84	91.23	28.30	90.21	29.72	89.15	31.11	88.05	32.46	86.89	33.77	85.77	35.02	84.44	36.25
4	92.34	26.89	91.20	28.35	90.18	29.77	89.12	31.16	88.02	32.51	86.86	33.82	85.84	35.07	84.40	36.29
6	92.31	26.94	91.17	28.40	90.15	29.82	89.09	31.21	87.99	32.56	86.83	33.87	85.91	35.12	84.36	36.33
8	92.28	26.99	91.14	28.45	90.12	29.87	89.06	31.26	87.96	32.61	86.80	33.92	85.98	35.17	84.32	36.37
10	92.25	27.04	91.11	28.50	90.09	29.92	89.03	31.31	87.93	32.66	86.77	33.97	86.05	35.22	84.28	36.41
12	92.22	27.09	91.08	28.55	90.06	29.97	89.00	31.36	87.90	32.71	86.74	34.02	86.12	35.27	84.24	36.45
14	92.19	27.14	91.05	28.60	90.03	30.02	88.97	31.41	87.87	32.76	86.71	34.07	86.19	35.32	84.20	36.49
16	92.16	27.19	91.02	28.65	90.00	30.07	88.94	31.46	87.84	32.81	86.68	34.12	86.26	35.37	84.16	36.53
18	92.13	27.24	90.99	28.70	89.97	30.12	88.91	31.51	87.81	32.86	86.65	34.17	86.33	35.42	84.12	36.57
20	92.10	27.29	90.96	28.75	89.94	30.17	88.88	31.56	87.78	32.91	86.62	34.22	86.40	35.47	84.08	36.61
22	92.07	27.34	90.93	28.80	89.91	30.22	88.85	31.61	87.75	32.96	86.59	34.27	86.47	35.52	84.04	36.65
24	92.04	27.39	90.90	28.85	89.88	30.27	88.82	31.66	87.72	33.01	86.56	34.32	86.54	35.57	84.00	36.69
26	92.01	27.44	90.87	28.90	89.85	30.32	88.79	31.71	87.69	33.06	86.53	34.37	86.61	35.62	83.96	36.73
28	91.98	27.49	90.84	28.95	89.82	30.37	88.76	31.76	87.66	33.11	86.50	34.42	86.68	35.67	83.92	36.77
30	91.95	27.54	90.81	29.00	89.79	30.42	88.73	31.81	87.63	33.16	86.47	34.47	86.75	35.72	83.88	36.81
32	91.92	27.59	90.78	29.05	89.76	30.47	88.70	31.86	87.60	33.21	86.44	34.52	86.82	35.77	83.84	36.85
34	91.89	27.64	90.75	29.10	89.73	30.52	88.67	31.91	87.57	33.26	86.41	34.57	86.89	35.82	83.80	36.89
36	91.86	27.69	90.72	29.15	89.70	30.57	88.64	31.96	87.54	33.31	86.38	34.62	86.96	35.87	83.76	36.93
38	91.83	27.74	90.69	29.20	89.67	30.62	88.61	32.01	87.51	33.36	86.35	34.67	87.03	35.92	83.72	36.97
40	91.80	27.79	90.66	29.25	89.64	30.67	88.58	32.06	87.48	33.41	86.32	34.72	87.10	35.97	83.68	37.01
42	91.77	27.84	90.63	29.30	89.61	30.72	88.55	32.11	87.45	33.46	86.29	34.77	87.17	36.02	83.64	37.05
44	91.74	27.89	90.60	29.35	89.58	30.77	88.52	32.16	87.42	33.51	86.26	34.82	87.24	36.07	83.60	37.09
46	91.71	27.94	90.57	29.40	89.55	30.82	88.49	32.21	87.39	33.56	86.23	34.87	87.31	36.12	83.56	37.13
48	91.68	27.99	90.54	29.45	89.52	30.87	88.46	32.26	87.36	33.61	86.20	34.92	87.38	36.17	83.52	37.17
50	91.65	28.04	90.51	29.50	89.49	30.92	88.43	32.31	87.33	33.66	86.17	34.97	87.45	36.22	83.48	37.21
c=.75	72	.21	72	.23	71	.24	.71	.25	.70	.26	.70	.27	.69	.29	.69	.30
c=1.15	1.10	.33	1.10	.35	1.09	.37	1.08	.38	1.08	.40	1.07	.42	1.06	.44	1.05	.46
c=1.90	1.82	.54	1.81	.57	1.80	.60	1.79	.63	1.78	.66	1.77	.70	1.76	.73	1.74	.76

Published by the A. LIETZ CO., San Francisco, Cal.

