

*Spillway Extension*  
*Final Spillway Cross Sections Extension*

W  
476

MINING  
TRANSIT BOOK

384

MICROFILMED  
JAN 13 1965

476



476

## Index

Spillway Extension X Sec Corner 7+40	2
" " " " Est 4	3-4
✓ Final Profile Cut Off Trenches + Cal	5, 13
" X Sec Spillway Ext floor Sub Gr 15+19	6-7, 9-13
" Profile Channel 15+50-24+00	8
X Sec + Measured Floor Sec for Bath Yield 14+20	
Blank	21-66 $\frac{1}{2}$
X Sec Overbreak Sta 15+50	67-69
" Ramp left in Sta 20 -	70



Spillway Extension X Sections of  
Corner Left For R.&C. Road at Sta.  
7+40, North Side.

Monthly Estimate #4

Aug. 30 - 1934

B.M. 3.92 645.67 641.75

8+50 - Finished 640.6 641.8 672.2

8+25 Subgrade North of This Shot 51 39 +26.5 65 90 102.5

B.M. 7.39 649.14 641.75

Subgrade North of this Shot 644.2 644.2 648.0 675.0

8+15 49 49 12 +25.9 65 80 91.5 100.5

B.M. 0.60 650.75 650.15 Finish Grade Pin 8+00

8+10 Subgrade No. of this shot 645.6 646.0 648.0 675.2 52 48 18 +24.2 65 82 92 98

Simpson  
Isabelle  
Salgado

46° 35' 14" = 37.5  
+26.5 Elev.

44° - 36° 00'  
Dist. = 35.6  
+ Elev. = 25.9

41° - 36° 29'  
Dist. = 33.0  
+ Elev. = 24.4

B.M. 11.11 707.47 696.36  
T.P. 1.71 709.18 0.00 707.47  
695.7  
135 703.7  
120 55 O.G.  
128

use this H.I. For  
This side of Page only

697.7 703.3 705.9  
11.5 5.9 3.3  
115 122 128

694.6 702.8 705.5  
14.6 6.4 3.2  
110 117 124

Elev. reduced by Machine & plotted by C.B.H. B.W. - 1-1934



Spillway Extension X Sections Contd.  
Monthly Estimate #4

Aug. 30-1934

3

709.18

41° - 34° 56'

Dist. = 336'  
+ Elev. = 235' ✓

B.M. 3.91 654.06 ✓ 650.15  
Subgrade No. 648.8 ✓  
of this shot 65 42 31 235  
65 82 91 985

696.1 ✓  
131  
105  
702.6 ✓  
65  
113 O.G.  
705.3 ✓  
32  
119 Fill  
705.3 ✓  
32  
132 Fill

B.M. 11.67 661.82 ✓ 650.15

35° - 32° 03'  
Dist. = 296' ✓  
+ Elev. = 186' ✓

7+75 Subgrade No. 656.9 ✓  
of this shot 49 09 72 186  
65 81 86 945

703.1 ✓  
61  
99 O.G.  
704.0 ✓  
52  
125 O.G.

B.M. 12.45 675.17 ✓ 662.72  
Finish  
Grade Pin  
7+60

7+60 Subgrade No. 661.2 ✓  
of this shot 14 92 72  
65 72

704.0 ✓  
52  
90 O.G.  
704.5 ✓  
47  
121 O.G.  
708.1 ✓  
11  
130

7+50 Subgrade No. 664.5 ✓  
of this shot 10 51 71  
54 71

704.5 ✓  
47  
90  
704.7 ✓  
45  
115 O.G.  
708.2 ✓  
10  
125 O.G.

Elev. reduced by Machine & Plotted by C. H. Bell 1-1934



Spillway Extension - Estimate #4

675.17

709.18

7+48 Subgrade No. 6656  
of this shot 96  
55 49  
70

7+43 Subgrade No. 6674  
of this shot 78  
53 19  
70

7+40 Subgrade No. 6680  
of this shot 667.1  
52 83  
70

Elev. reduced by Machine plotted by CBH 9/1-34

704.0  
52  
89

704.9  
43  
113

709.7  
105  
125

699.5  
97  
84

702.3  
62  
105

705.8  
32  
115

709.2  
02  
120

699.5  
97  
84

Subgrade  
95.5

Subgrade South

6.12 669.05 check on Grade Pin 7+40  
Rec. Elev. 669.01



Sept. 7-1934

Simpson  
Soper  
Isbell

See Sheet (9)  
Spillway Ext. Calc.  
North  
Interpolated for Elev. n.

5

Final Profile of Cut-off Trench At Sta. 15+50 (Bottom) of Excavation cut-off Trench 4' wide

B.M. 1.80 (736.80) (735.0)

South

30.9	31.0	31.2	31.0
52	58	56	58
103	80	40	0

31.2	31.2	30.7	30.6
56	56	61	63
40	80	103	106

Vol to Elev 541 = 8169.2 Cu ft. =  
" " 541 to 570 each side

302.56 Cu yds. n.

Theoretical end of Trench.

Final Profile of Cut-off Trench at Sta. 13+95.29 - Sept. 17-1934.

Cut-off Trench 30" wide

B.M. 4.29 546.58 542.29

541.9	547.2	545.5	544.1	543.1	542.2	541.2	540.2	539.6
47	94	95	95	95	75	70	94	90
75.9	75.5	60	40	24	23	16	15	0

368	372	372	5372	371	20	40	60	69	76	76
-----	-----	-----	------	-----	----	----	----	----	----	----

Notes Reduced 10-3-34

Concrete Vol. To Elev. 541.5 = 1454.375 Cu ft. = 160.334 cu yds.

5386 cu yds  
5938 Excavation Cu yds

See Sheet (9)  
Spillway Ext. Calc. n

Final Profile of Cut-off Trench At Sta. 12+30 - Sept. 21-1934

Cut-off Trench 30" wide

B.M. 3.44 546.30 542.86

542.4	535.4	535.4	535.5	538.0	535.5	535.6	539.0	539.6	535.5	535.7
37	109	109	108	83	108	107	73	67	108	106
75.9	75.2	60	14	38	36	22	17	12	11	0

535.7	535.7	539.3	540.0	539.3	70	106	50	60	65	69	74	75	75.9
-------	-------	-------	-------	-------	----	-----	----	----	----	----	----	----	------

Concrete Vol. to Elev. 542.0 = 1894.0 Cu ft. = 2042.07 cu yds.

70.04 Cu yds  
75.63 Excavation

3.39 542.91 check on

Grade Pin - 12+63 - Elev. 542.91

See Sheet (10)  
Spillway Ext. Calc. n

Reduced 10-3-34



Spillway Extension - Final X Sections  
Floor Subgrade:

B.M. 3.77 546.13 542.36

South.

	541.7	540.1	540.1	541.2	541.2	541.2	540.7	540.5
14+60	4.9	6.0	6.0	4.9	4.9	4.9	5.2	5.5
	75.9	75.8	73	73	60	40	20	0

	541.7	540.1	540.1	541.1	540.7	541.1	541.2	540.7	540.5
14+75	4.9	6.0	6.0	5.0	5.4	5.0	4.9	5.4	5.5
	75.9	75.9	73	73	65	60	30	20	0

3.90

542.23

Finish  
Grade Pin

Sept. - 14 - 1934

B.M. 4.55 546.29 541.74

	542.0	540.3	540.3	541.3	541.2	541.3	540.9	540.8
14+50	4.3	6.0	6.0	5.0	5.1	5.0	5.9	5.5
	75.9	75.9	73.5	73	60	40	20	0

	541.9	540.4	540.4	541.3	541.1	541.3	541.0	541.4
14+25	4.4	5.9	5.9	5.0	5.2	5.0	5.3	4.9
	75.9	75.9	73	73	50	40	20	0

Sept. 12 - 1934

Simpson  
Soper  
Isbell

Note: Drain Ditches not  
shown in X Sections

North.

	540.7	541.2	541.2	541.1	4.9	6.2	6.0	4.6
	5.4	4.9	4.9	5.0	72.9	73	75.2	75.9
	20	25	40	60				

	540.7	541.1	541.3	541.2	4.9	6.1	5.9	4.4
	5.4	5.0	4.8	4.9	72.9	73	75.8	75.9
	20	25	40	60				

Sta. 14+80 - Rec. Elev. 542.24.

542.29  
5.30  
547.64

6

Plotted on Spillway X Sec. - 10-3-34 B.M.

Notes Reduced 10-3-34 B.M.



Spillway Extension - Final X Sections  
Floor Subgrade.

Simpson  
Soper  
Isbell

Sept. 17-1934.

B.M. 4.29 546.58 542.29

South

14+00	542.0 4.6 75.9	540A 6.3 75.9	540A 6.3 73	541A 5.3 72.8	541S 5.1 60	541S 5.1 40	541Z 5.4 20
-------	----------------------	---------------------	-------------------	---------------------	-------------------	-------------------	-------------------

North

541S 5.1 4	541X 5.3 20	541A 5.3 40	541A 5.3 60	541A 5.3 72.8	5404 6.3 72.9	540A 6.3 75.8	5419 4.7 75.9
------------------	-------------------	-------------------	-------------------	---------------------	---------------------	---------------------	---------------------

See Profile of Cut-off Trench - Pg. 5

13+75	5419 4.7 75.9	540Z 6.4 75.8	540Z 6.4 73	5414 5.3 73	541S 5.1 60	541A 5.3 40	5411 5.5 20	5413 5.3 10
-------	---------------------	---------------------	-------------------	-------------------	-------------------	-------------------	-------------------	-------------------

Finish Grade  
Pin 13+50 &

5416 5.0 4	5416 5.0 20	541S 5.1 40	541A 5.3 60	541S 5.1 73	540S 6.1 73	540S 6.1 75.7	5420 4.5 75.9
------------------	-------------------	-------------------	-------------------	-------------------	-------------------	---------------------	---------------------

Elev. 542.64

Sept. 18-1934

B.M. 4.31 546.60 542.29

13+50	542.1 4.5 75.9	5406 6.0 75.8	5406 6.0 73	5416 5.0 73	541S 5.1 60	541S 5.1 40	541A 5.3 20
-------	----------------------	---------------------	-------------------	-------------------	-------------------	-------------------	-------------------

541A 5.3 4	5411 5.5 20	5413 5.3 40	541S 5.1 60	5416 5.0 73	5406 6.0 73.1	5406 6.0 75.8	5421 4.5 76.0
------------------	-------------------	-------------------	-------------------	-------------------	---------------------	---------------------	---------------------

13+40	542.1 4.5 75.9	540S 6.1 75.8	540S 6.1 73	5416 5.0 73	541S 5.1 60	5416 5.0 40	541S 5.1 20
-------	----------------------	---------------------	-------------------	-------------------	-------------------	-------------------	-------------------

541A 5.3 4	5413 5.3 20	541A 5.3 40	5413 5.3 60	541S 5.1 73	540S 6.1 73.2	540S 6.1 75.9	5423 4.3 76.0
------------------	-------------------	-------------------	-------------------	-------------------	---------------------	---------------------	---------------------

13+25	542.2 4.7 75.9	5406 6.0 75.7	5406 6.0 73.1	5418 4.8 73	5417 4.7 60	541S 5.1 40	5416 5.0 20
-------	----------------------	---------------------	---------------------	-------------------	-------------------	-------------------	-------------------

5416 5.0 4	5416 5.0 20	5411 5.5 40	541S 5.1 60	5416 5.0 73	540S 6.1 73.1	540S 6.1 75.9	5422 4.4 75.9
------------------	-------------------	-------------------	-------------------	-------------------	---------------------	---------------------	---------------------

3.99 542.61 check on

finish grade Pin 13+59  
Elev. 542.61

Spt. Notes Plotted on Spillway X Sec. 684  
 Notes Reduced 10-3-34 G.H.



Final Profile of channel cut West  
of Sta. 15+50.

Sept.-19-1934

Simpson  
Level  
136+11

B.M.	10.09	552.38	542.29	
15+50			7.7	544.7 F-13
16+00			6.0	546.4 C-04
17+00			6.0	546.4 C-04
18+00			5.2	547.2 C-12
T.P.			4.50	547.88
	3.95	551.83		
18+85			4.7	547.1 C-12
19+75			4.1	547.7 C-12
20+00			5.0	546.8 C-08
21+00			6.2	545.6 F-04
22+00			6.7	545.1 F-09
23+00			6.7	545.1 F-09
T.P.			6.68	545.15
	9.59	554.74		
24+00			8.9	545.8 F-03
24+50			8.7	546.0
			0.5	554.2 check on

Grade 546.0

Slope Stake 24+00  
Mkd. C-82

10/1/34.  
Reduced  
rechecked on Sec  
M



Spillway Extension - Final X Sections.  
Floor Subgrade.

Sept. 19-1934.

B.M. 3.83 546.14 542.29

South

15+00 541.6 540.0 540.0 541.0 541.0 540.1 540.4 540.8 541.0  
4.5 6.1 6.1 5.1 5.1 6.0 5.2 5.3 5.1  
75.8 75.8 73.2 73 70 65 60 40 20

15+25 541.9 539.8 539.8 540.9 540.7 540.1 540.5 540.9 540.9  
4.2 6.3 6.3 5.2 5.4 6.2 5.5 5.2 5.2  
76 76 73.6 73.2 70 65 60 40 20

15+46 4.5 6.3 539.8 541.0 539.9 540.8 541.0 540.9  
76 76 73.5 73.5 60 50 40 20

Note: This section taken along East edge of  
Cut-off Trench, Use this Section for Sta. 15+50  
See Profile of Cut-off Trench - Pg. 5

4.06 542.08 Check on

Finish Grade Pin, Sta. 15+20  
Elev. 542.08

North

540.8 540.7 540.9 541.0 541.1 540.0 540.0 541.9  
5.3 5.4 5.2 5.1 5.2 6.1 6.1 4.2  
20 40 60 73 73.1 76 76

540.8 540.8 541.0 541.0 541.1 540.0 540.0 541.9  
5.3 5.3 5.1 5.1 5.2 6.1 6.1 4.2  
20 40 60 73 73.1 76 76

541.0 541.0 540.9 541.0 541.0 539.8 539.8 541.6  
5.1 5.1 5.2 5.1 5.1 6.3 6.3 4.5  
20 40 60 73 73 76 76

Obtained on Spillway Ext. X-Sections 28X  
Notes Reduced 10-3-34 GBN



Spillway Extension - Final X Sections  
Floor Subgrade.

Sept. 20 - 1934.

B.M. 4.62 546.91 542.29

South.

13+10  
5422<sup>v</sup> 5408<sup>v</sup> 5408<sup>v</sup> 5418<sup>v</sup> 5417<sup>v</sup> 5417<sup>v</sup> 5418<sup>v</sup>  
4<sup>?</sup> 6<sup>?</sup> 6<sup>?</sup> 5<sup>!</sup> 5<sup>?</sup> 5<sup>?</sup> 5<sup>!</sup>  
75<sup>?</sup> 75<sup>?</sup> 73 73 60 40 20

North.

5416<sup>v</sup> 5415<sup>v</sup> 5415<sup>v</sup> 5417<sup>v</sup> 5416<sup>v</sup> 5407<sup>v</sup> 5407<sup>v</sup> 5423<sup>v</sup>  
5<sup>?</sup> 5<sup>?</sup> 5<sup>?</sup> 5<sup>?</sup> 5<sup>?</sup> 6<sup>?</sup> 6<sup>?</sup> 4<sup>?</sup>  
20 40 60 72<sup>?</sup> 72<sup>?</sup> 76<sup>?</sup> 76<sup>?</sup>

13+00

5422<sup>v</sup> 5409<sup>v</sup> 5409<sup>v</sup> 5419<sup>v</sup> 5418<sup>v</sup> 5418<sup>v</sup> 5418<sup>v</sup>  
4<sup>?</sup> 6<sup>?</sup> 6<sup>?</sup> 5<sup>?</sup> 5<sup>!</sup> 5<sup>!</sup> 5<sup>?</sup>  
75<sup>?</sup> 75<sup>?</sup> 73 73 60 40 20

5415<sup>v</sup> 5414<sup>v</sup> 5417<sup>v</sup> 5416<sup>v</sup> 5418<sup>v</sup> 5405<sup>v</sup> 5405<sup>v</sup> 5427<sup>v</sup>  
5<sup>?</sup> 5<sup>?</sup> 5<sup>?</sup> 5<sup>?</sup> 5<sup>!</sup> 6<sup>?</sup> 6<sup>?</sup> 4<sup>?</sup>  
20 40 50 72<sup>?</sup> 73<sup>?</sup> 76<sup>?</sup> 77<sup>?</sup>

12+75

5418<sup>v</sup> 5418<sup>v</sup> 5417<sup>v</sup>  
5<sup>!</sup> 5<sup>!</sup> 5<sup>?</sup>  
60 40 20

5415<sup>v</sup> 5415<sup>v</sup> 5419<sup>v</sup> 5417<sup>v</sup> 5419<sup>v</sup> 5419<sup>v</sup> 5404<sup>v</sup> 5404<sup>v</sup> 5423<sup>v</sup>  
5<sup>!</sup> 5<sup>?</sup> 5<sup>?</sup> 5<sup>?</sup> 5<sup>?</sup> 5<sup>?</sup> 6<sup>?</sup> 6<sup>?</sup> 4<sup>?</sup>  
10 20 40 50 71 72 76<sup>?</sup> 77<sup>?</sup>

4.13 542.78 check on

finish grade Pin 13+00  
Elev. 542.79.

Sept. 21 - 1934

B.M. 3.44 546.30 542.86

12+50

5423 5410 5410 5420 5421<sup>v</sup> 5418<sup>v</sup> 5419<sup>v</sup>  
4<sup>?</sup> 5<sup>?</sup> 5<sup>?</sup> 4<sup>?</sup> 4<sup>?</sup> 4<sup>?</sup> 4<sup>?</sup>  
76<sup>?</sup> 75<sup>?</sup> 73<sup>?</sup> 73 60 40 20

5419<sup>v</sup> 5419<sup>v</sup> 5416<sup>v</sup> 5417<sup>v</sup> 5417<sup>v</sup> 5407<sup>v</sup> 5407<sup>v</sup> 5422<sup>v</sup>  
4<sup>?</sup> 4<sup>?</sup> 4<sup>?</sup> 4<sup>?</sup> 4<sup>?</sup> 5<sup>?</sup> 5<sup>?</sup> 4<sup>?</sup>  
20 40 50 72<sup>?</sup> 72<sup>?</sup> 76<sup>?</sup> 77

West edge of  
cut-off Trench

12+30<sup>29</sup>

5424 5411 5411 5417 5420<sup>v</sup> 5421<sup>v</sup> 5420<sup>v</sup>  
3<sup>?</sup> 5<sup>?</sup> 5<sup>?</sup> 4<sup>?</sup> 4<sup>?</sup> 4<sup>?</sup> 4<sup>?</sup>  
75<sup>?</sup> 75<sup>?</sup> 72<sup>?</sup> 72 60 40 20

5420<sup>v</sup> 5421<sup>v</sup> 5416<sup>v</sup> 5420<sup>v</sup> 5420<sup>v</sup> 5419<sup>v</sup> 5413<sup>v</sup> 5402<sup>v</sup> 5407<sup>v</sup> 5423<sup>v</sup>  
4<sup>?</sup> 4<sup>?</sup> 4<sup>?</sup> 4<sup>?</sup> 4<sup>?</sup> 4<sup>?</sup> 5<sup>?</sup> 6<sup>?</sup> 5<sup>?</sup> 4<sup>?</sup>  
10 20 25 40 60 70 71 76<sup>?</sup> 76<sup>?</sup>

See Profile of Cut-off Trench - Pg. 5.

3.39 542.91 check on

Grade Pin 12+63 - Elev. 542.91

Notes Pertaining to Spillway Ext. X Sec. 684  
Notes Reduced 10-3-34. GBA



Spillway Extension - Final X Sections  
Floor Subgrade.

Sept. 22-1934

B.M. 4.32 547.18 542.86

South

East edge of  
cutoff Trench

12+27<sup>29</sup>

use this Section for Sta 12+25  
if Needed.

542.2 ✓ 540.9 ✓ 541.1 ✓ 541.0 ✓ 540.7 ✓  
5 6 6 6 6  
75 75 60 40 20

12+00 542.6 ✓ 541.0 ✓ 541.0 ✓ 541.1 ✓  
4 6 6 6  
75 75 60 20

4.12 543.06 check on

Sept. 25-1934

B.M. 3.56 546.42 542.86

11+80<sup>29</sup>

542.6 ✓ 541.2 ✓ 541.2 ✓ 541.1 ✓ 541.1 ✓  
3 5 5 5 5  
75 75 60 40 20

11+60

543.5 ✓ 541.9 ✓ 542.1 ✓ 542.0 ✓ 542.0 ✓  
2 4 4 4 4  
75 75 60 40 20

11+40

545.9 ✓ 544.2 ✓ 544.3 ✓ 544.3 ✓ 544.1 ✓  
0 2 2 2 2  
75 75 60 40 20

3.36 543.06 check on

North

540.8 ✓ 541.1 ✓ 541.0 ✓ 540.8 ✓ 540.8 ✓ 542.2 ✓  
6 6 6 6 6 5  
20 40 60 75 75 72

541.0 ✓ 541.1 ✓ 541.0 ✓ 540.9 ✓ 541.2 ✓ 542.2 ✓ 543.3 ✓  
6 6 6 6 6 5 3  
20 40 60 75 75 75 75

Finish grade Pn - Sta. 12+15  
Elev. 543.06

9/20/34

2.91

546.41

Use this H.I. For North  
Side of E. only.

543.50

541.2 ✓ 541.2 ✓ 541.3 ✓ 541.1 ✓ 541.2 ✓ 542.6 ✓  
5 5 5 5 5 3  
20 40 60 75 75 75

542.0 ✓ 542.0 ✓ 542.0 ✓ 542.1 ✓ 542.1 ✓ 543.5 ✓  
4 4 4 4 4 2  
20 40 60 75 75 75

544.3 ✓ 544.1 ✓ 544.2 ✓ 544.3 ✓ 544.5 ✓ 545.9 ✓  
2 2 2 2 1 0  
20 40 60 75 75 75

T.P.

0.39

546.02

Finish Grade Pn 12+15  
Elev. 543.06

Sections Plotted on Spillway Ext. 1 Sec. 28A  
Map Reduced 10-3-34 28A



Final X Sections - Floor Subgrade

Sept. 27-1934

B.M. 3.49 546.35 542.86  
 T.P. 0.28 546.07  
 11.03 557.10

South

11+30 547.5 546.1 545.8 546.3 545.6 546.0  
 9.5 11.0 11.0 10.8 11.5 11.1  
 76 76 60 40 20 0

11+20 549.9 548.5 548.5 548.0 548.4 547.8  
 7.2 8.6 8.6 9.1 8.7 9.3  
 75.9 75.8 60 40 20 0

11+10 552.4 551.1 551.0 550.2 550.3 549.9 550.6  
 4.7 6.0 6.1 6.2 6.8 7.2 6.5  
 75.9 75.9 60 55 40 20 0

11+00 29 555.9 553.8 554.0 553.7 553.7 553.0  
 1.8 3.3 3.1 3.7 3.4 3.3  
 75.9 75.7 60 40 20 0

1.29 555.81 check on

9/28/34

9.65 555.67 546.02  
 use this H.T. For North Side of R. only.

Revised X Sections Oct. 30, 1934

545.6 545.9 546.1 546.1 546.2 546.1 547.3  
 10.1 9.8 9.5 9.6 9.5 9.5 8.4  
 20 25 40 60 72 75.2 76

547.7 548.5 548.3 548.5 548.4 547.8 549.9  
 8.0 7.2 7.4 7.3 7.3 7.9 5.8  
 20 30 40 60 72 76.2 76.5

550.0 550.1 551.0 551.2 551.2 551.6 552.7  
 5.7 5.5 4.7 4.5 4.5 4.1 3.0  
 15 25 35 50 60 75.2 75.9

553.3 553.8 553.8 553.9 553.4  
 2.4 1.2 1.2 1.8 0.3  
 20 40 60 75.2 75.9

Plotted CBH

Plotted CBH

Finish Grade Pin - 11+00.29  
 Elev. 555.84

5.28 550.39 check on Finish Grade Pin 11+20 Elev. 550.40

Notes reduced 10-3-34 CBH



Final X Sections - Floor Subgrade

Sept. 28-1934

B.M.	6.55	549.41		542.86
T.P.			5.91	543.50
	2.91	546.41		
T.P.			0.39	546.02
	9.65	555.67		
T.P.			5.28	550.39
	11.74	562.13		

North

South

West edge of cut-off Trench

10+82.81

560.5	559.1	559.2	559.2	559.1	559.2
16	30	29	29	30	29
75?	75?	60	40	20	0

559.2	559.1	559.0	558.9	560.4
29	30	31	32	12
20	40	60	75.5	75?

Profile on Bottom of Cut-off Trench,

10+80.29. Cut-off Trench 30" Wide

0.1	554.7	554.6	554.4	554.5	554.3
72	75	72	75	78	
75?	75	60	40	20	0

554.3	554.3	554.4	554.4
78	78	72	72
20	40	60	75.5

Plotted on X See Sec's Spillway Extension

Conc. Vol. to Elev. 560.7 = 23,67.6 Cuft

= 87.69 Cuys

East edge of cut-off Trench

10+80.29

561.5	559.2	559.2	561.3	561.1	560.8	560.8
0.6	2.9	2.9	0.8	10	12	13
75?	75?	72	72	60	40	20

561.2	561.1	560.5	560.9	561.1	560.5	560.5	561.6
0.2	10	16	12	10	16	15	0.5
0	20	40	60	72.5	72?	75.8	76

0.03 562.10 check on

Finish Grade P.O. 10+80.28  
Elev. 562.12

Notes Reduced by G.A.H. 10-3-34



X Sections and Measurements of Section  
of concrete floor to be poured, to determine  
Batch Yield.

Sept. 29-1934

Simpson  
Super  
Isbell

14

B.M.	5.46					548.32					542.86						
	South					North											
11+80.6	541.2	541.2	541.2	541.2	541.2	541.3	541.3	541.3	541.1	541.7	541.6						
Grade 543.16	7' 16"	7' 10"	7' 4"	7' 10"	7' 20"	7' 30"	7' 40"	7' 50"	7' 60"	7' 62"	7' 65"						
11+92.6	541.0	541.0	541.0	541.1	541.2	541.1	541.0	541.2	540.8								
Grade 543.12	7' 16"	7' 10"	7' 4"	7' 10"	7' 20"	7' 30"	7' 40"	7' 50"	7' 60"								
12+04.2	540.9	541.0	541.0	541.1	541.0	541.0	541.0	540.8	541.0								
Grade 543.06	7' 16"	7' 10"	7' 4"	7' 10"	7' 20"	7' 30"	7' 40"	7' 50"	7' 60"	7' 67"							

5.17 543.15 check on

Finish Grade Pt. - Sta. 11+80.29  
Elev. 543.16

South

North

541.6  
67"  
67"  
541.0  
73"  
67"  
Reduced 10-3-34 68A

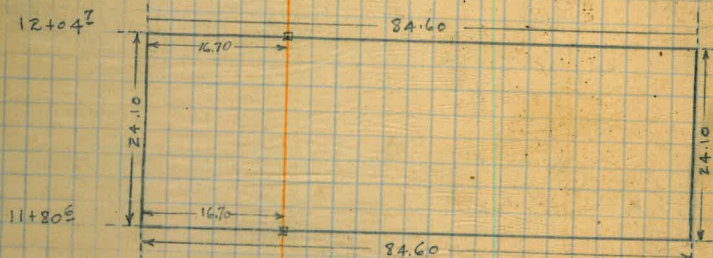



Final X Sections - Floor Subgrade.

Oct. 8. 1934.

B.M. 5.60 567.17 561.57

T.P. 1.20 565.97

7.69 573.66

South

10+70 564.8 563.3 563.3 564.7 564.0 564.5 564.4 564.3  
 8 10 10 9 9 9 9 9  
 76 76 72 72 69 60 40 20

10+56 569.8 568.0 568.0 568.8 568.9 568.7 568.3 568.8  
 3 5 5 4 4 5 5 4  
 75 75 72 72 60 45 35 20

Reduced 10/32 CRH.

10+45 572.9 571.2 571.2 572.2 572.0 572.1 571.5 572.4  
 0 2 2 1 1 1 2 1  
 75 75 72 72 60 43 33 20

T.P. 0.48 573.18

6.08 579.26

10+35 576.1 574.1 574.0 574.7 574.9 575.3 575.4 575.2  
 3 5 5 4 4 4 3 4  
 76 76 73 73 60 40 20 7

4.28 574.98 Check on

Note: Drain Ditches not shown.

North

564.4 564.0 564.0 564.2 564.4 563.5 563.5 564.4  
 9 9 9 9 9 10 10 8  
 20 40 60 72 72 75 75

568.8 568.6 568.3 568.4 568.5 568.9 569.3 569.2 567.7 567.7 569.2  
 4 5 5 5 5 4 4 4 6 6 4  
 20 25 40 60 68 69 73 73 75 76

571.9 571.2 570.9 571.5 572.0 571.8 572.3 572.3 571.5 571.5 572.9  
 18 2 2 2 1 1 1 2 2 2 0  
 2 2 2 1 1 1 2 2 2 0  
 10 20 32 45 50 60 72 73 75 76

574.6 574.2 573.8 574.3 574.8 575.4 574.8 575.1 574.1 574.1 576.1  
 4 5 5 5 4 3 4 4 5 5 3  
 2 5 25 40 50 60 70 73 73 76 76

Finish grade Pin 10+39.29  
 Rec. Elev 575.00



Final X Sections - Floor Subgrade.

578.94

16

Oct. 10-1934.

B.M. 2.78 570.12 587.34

South

North

10+20  
 580.8<sup>✓</sup> complete 579.1<sup>✓</sup> 579.1<sup>✓</sup> 580.1<sup>✓</sup> 579.4<sup>✓</sup> 579.9<sup>✓</sup> 579.8<sup>✓</sup>  
 9<sup>2</sup> 11<sup>2</sup> 11<sup>2</sup> 10<sup>2</sup> 10<sup>2</sup> 10<sup>2</sup> 10<sup>2</sup>  
 77<sup>2</sup> 77<sup>2</sup> 74<sup>2</sup> 74<sup>2</sup> 60 40 20

579.3<sup>✓</sup> 579.2<sup>✓</sup> 578.6<sup>✓</sup> 578.3<sup>✓</sup> 580.0<sup>✓</sup> 579.2<sup>✓</sup> 579.7<sup>✓</sup> 579.5<sup>✓</sup> 578.8<sup>✓</sup> 578.8<sup>✓</sup> 580.2<sup>✓</sup>  
 10<sup>2</sup> 10<sup>2</sup> 11<sup>2</sup> 11<sup>2</sup> 10<sup>2</sup> 10<sup>2</sup> 10<sup>2</sup> 11<sup>2</sup> 11<sup>2</sup> 9<sup>2</sup>  
 4 10 20 40 60 68 71 74 74<sup>2</sup> 77 77<sup>2</sup>

10+00 Plotted - 586.7<sup>✓</sup> complete 585.2<sup>✓</sup> 585.2<sup>✓</sup> 586.1<sup>✓</sup> 586.4<sup>✓</sup> 586.5<sup>✓</sup> 586.0<sup>✓</sup>  
 3<sup>2</sup> 4<sup>2</sup> 4<sup>2</sup> 4<sup>2</sup> 3<sup>2</sup> 3<sup>2</sup> 4<sup>2</sup>  
 78<sup>2</sup> 78<sup>2</sup> 78<sup>2</sup> 75<sup>2</sup> 60 40 20

586.3<sup>✓</sup> 585.6<sup>✓</sup> 585.2<sup>✓</sup> 584.9<sup>✓</sup> 585.8<sup>✓</sup> 586.4<sup>✓</sup> 585.4<sup>✓</sup> 585.4<sup>✓</sup> 586.7<sup>✓</sup>  
 3<sup>2</sup> 4<sup>2</sup> 4<sup>2</sup> 5<sup>2</sup> 4<sup>2</sup> 3<sup>2</sup> 4<sup>2</sup> 4<sup>2</sup> 3<sup>2</sup> complete  
 4 10 25 40 60 75<sup>2</sup> 75<sup>2</sup> 78<sup>2</sup> 78<sup>2</sup>

Reduced 10/12/34  
 10/12/34

T.P. 0.21 589.91

9.02 598.93

9+75 Plotted. 594.6<sup>✓</sup> complete 593.4<sup>✓</sup> 593.4<sup>✓</sup> 594.4<sup>✓</sup> 594.3<sup>✓</sup> 594.3<sup>✓</sup> 594.1<sup>✓</sup>  
 4<sup>2</sup> 5<sup>2</sup> 5<sup>2</sup> 4<sup>2</sup> 4<sup>2</sup> 4<sup>2</sup> 4<sup>2</sup>  
 80<sup>2</sup> 80<sup>2</sup> 77<sup>2</sup> 77<sup>2</sup> 60 40 20

594.2<sup>✓</sup> 593.3<sup>✓</sup> 594.0<sup>✓</sup> 593.5<sup>✓</sup> 594.0<sup>✓</sup> 593.2<sup>✓</sup> 594.1<sup>✓</sup> 594.1<sup>✓</sup> 593.2<sup>✓</sup> 593.2<sup>✓</sup> 594.5<sup>✓</sup>  
 4<sup>2</sup> 5<sup>2</sup> 4<sup>2</sup> 5<sup>2</sup> 4<sup>2</sup> 5<sup>2</sup> 4<sup>2</sup> 4<sup>2</sup> 5<sup>2</sup> 5<sup>2</sup> 4<sup>2</sup> complete  
 4 20 35 45 50 57 66 77 77<sup>2</sup> 80 80

+ 0.32 599.25 = check

on B.M. in No. Side wall, Sta. 9+70  
 Elev. 599.26

Oct. 15-1934

Finish Grade Pn

Sta. 9+50 3.51 606.55 603.04

9+60  
 599.1<sup>✓</sup> 597.9<sup>✓</sup> 597.8<sup>✓</sup> 599.0<sup>✓</sup> 598.7<sup>✓</sup> 599.0<sup>✓</sup> 598.8<sup>✓</sup>  
 7<sup>2</sup> 8<sup>2</sup> 8<sup>2</sup> 7<sup>2</sup> 7<sup>2</sup> 7<sup>2</sup> 7<sup>2</sup>  
 81 81 78 77<sup>2</sup> 60 40 20

598.9<sup>✓</sup> 598.4<sup>✓</sup> 598.9<sup>✓</sup> 598.7<sup>✓</sup> 598.3<sup>✓</sup> 599.0<sup>✓</sup> 598.9<sup>✓</sup> 597.6<sup>✓</sup> 597.7<sup>✓</sup> 599.0<sup>✓</sup> Reduced  
 7<sup>2</sup> 8<sup>2</sup> 7<sup>2</sup> 7<sup>2</sup> 8<sup>2</sup> 7<sup>2</sup> 7<sup>2</sup> 8<sup>2</sup> 8<sup>2</sup> 7<sup>2</sup> 11-7-34  
 4 10 20 45 50 65 78<sup>2</sup> 78<sup>2</sup> 81<sup>2</sup> 81<sup>2</sup> complete

9+50  
 602.5<sup>✓</sup> 600.8<sup>✓</sup> 600.7<sup>✓</sup> 602.1<sup>✓</sup> 601.9<sup>✓</sup> 602.0<sup>✓</sup> 602.0<sup>✓</sup>  
 4<sup>2</sup> 5<sup>2</sup> 5<sup>2</sup> 4<sup>2</sup> 4<sup>2</sup> 4<sup>2</sup> 4<sup>2</sup>  
 81<sup>2</sup> 81<sup>2</sup> 78<sup>2</sup> 78<sup>2</sup> 60 40 20

602.0<sup>✓</sup> 602.0<sup>✓</sup> 602.0<sup>✓</sup> 602.1<sup>✓</sup> 602.1<sup>✓</sup> 600.8<sup>✓</sup> 600.9<sup>✓</sup> 602.3<sup>✓</sup>  
 4<sup>2</sup> 4<sup>2</sup> 4<sup>2</sup> 4<sup>2</sup> 4<sup>2</sup> 5<sup>2</sup> 5<sup>2</sup> 4<sup>2</sup> complete  
 4 20 40 60 78<sup>2</sup> 79 81<sup>2</sup> 81<sup>2</sup>  
 ok - Reduced & plotted  
 Nov. 7-1934  
 6/24

T.P. 0.87 605.68

10.11 615.79



Oct. 15-1934

615.79

	608.5	607.0	607.0	608.1	608.4	608.4	608.3
9+30	7 <sup>2</sup> 8 <sup>8</sup>	8 <sup>8</sup>	7 <sup>7</sup>	7 <sup>4</sup>	7 <sup>4</sup>	7 <sup>5</sup>	
	83 <sup>2</sup> 83 <sup>1</sup>	80 <sup>3</sup>	80 <sup>2</sup>	60	40	20	

	612.5	611.9	611.9	612.8	612.8	612.9	613.0	612.9
West edge of Trench	2 <sup>3</sup>	3 <sup>9</sup>	3 <sup>9</sup>	3 <sup>0</sup>	3 <sup>0</sup>	2 <sup>9</sup>	2 <sup>8</sup>	2 <sup>9</sup>
9+14.8	84 <sup>2</sup>	84 <sup>2</sup>	81 <sup>1</sup>	81	77	60	40	20

Profile on Bottom of Cut-off Trench

Sta. 9+13.5 cut-off trench 30' wide

	614.3	610.1	609.9	609.5	609.4	609.7	611.8
	1 <sup>5</sup>	5 <sup>7</sup>	5 <sup>9</sup>	6 <sup>3</sup>	6 <sup>2</sup>	6 <sup>1</sup>	4 <sup>0</sup>
	84 <sup>4</sup>	84 <sup>0</sup>	77	60	40	12	7

	614.5	612.7	612.7	613.9	614.0	613.8	613.8
East edge of Trench	1 <sup>3</sup>	3 <sup>1</sup>	3 <sup>1</sup>	1 <sup>9</sup>	1 <sup>8</sup>	2 <sup>2</sup>	2 <sup>0</sup>
9+12.3	84 <sup>2</sup>	84 <sup>2</sup>	81 <sup>2</sup>	81 <sup>3</sup>	60	40	20

6.16 609.63 check on

Oct. 16-1934

B.M.	3.42	637.32		633.90
T.P.	4.64	630.60	11.36	625.96

	617.1	616.4	616.4	617.7	617.8	617.7	617.8
9+00	12 <sup>8</sup>	14 <sup>2</sup>	14 <sup>2</sup>	12 <sup>9</sup>	12 <sup>8</sup>	12 <sup>9</sup>	12 <sup>8</sup>
	85 <sup>3</sup>	85 <sup>0</sup>	82 <sup>4</sup>	82 <sup>3</sup>	60	40	20

	608.3	608.3	608.5	608.2	607.8	607.3	608.7
608.3	7 <sup>5</sup>	7 <sup>5</sup>	7 <sup>3</sup>	7 <sup>6</sup>	8 <sup>5</sup>	8 <sup>5</sup>	7 <sup>1</sup> complete
	20	40	60	80 <sup>4</sup>	80 <sup>6</sup>	83 <sup>1</sup>	83 <sup>3</sup>

	613.1	612.9	613.0	613.0	612.9	612.0	612.0	613.6
	2 <sup>7</sup>	2 <sup>7</sup>	2 <sup>8</sup>	2 <sup>8</sup>	2 <sup>9</sup>	3 <sup>8</sup>	3 <sup>8</sup>	2 <sup>2</sup> complete
	20	40	60	60	81	81 <sup>2</sup>	84	84 <sup>3</sup>

	609.6	609.6	609.5	609.7	609.6	609.7	613.4
	6 <sup>2</sup>	6 <sup>2</sup>	6 <sup>3</sup>	6 <sup>1</sup>	6 <sup>3</sup>	6 <sup>1</sup>	2 <sup>2</sup> complete
	20	20	20	40	60	84	84 <sup>2</sup>

	614.0	613.6	614.0	613.8	614.0	612.7	612.7	614.6
	1 <sup>8</sup>	2 <sup>3</sup>	1 <sup>8</sup>	2 <sup>0</sup>	1 <sup>8</sup>	3 <sup>4</sup>	3 <sup>1</sup>	1 <sup>2</sup> complete
	20	40	60	60	81 <sup>2</sup>	81 <sup>2</sup>	84 <sup>4</sup>	

Finish Grade Pin  
Sta. 9+29 - Elev. 609.63

	617.7	617.6	617.8	617.7	617.7	616.7	616.7	618.1
	12 <sup>9</sup>	13 <sup>0</sup>	12 <sup>8</sup>	12 <sup>9</sup>	12 <sup>9</sup>	13 <sup>9</sup>	13 <sup>9</sup>	12 <sup>5</sup> complete
	20	20	40	60	82 <sup>4</sup>	82 <sup>6</sup>	85 <sup>0</sup>	85 <sup>2</sup>

Plotted  
Reviewed  
11-1-34



Final X Sections - Floor Subgrade.

Oct. 16-1934.

630.60

South

	626.0 <sup>1</sup>	624.5 <sup>1</sup>	624.5 <sup>v</sup>	625.7 <sup>v</sup>	625.5 <sup>v</sup>	625.5 <sup>v</sup>	625.5 <sup>v</sup>
8+75	4.5	6.1	6.1	4.9	5.1	5.1	5.1
	86.8	86.7	84	84	60	40	20

11.86      618.74 = check on

Finish Grade P.O.  
Sta. 8+50      11.91

646.36

634.45

North

	625.5 <sup>v</sup>	625.6 <sup>v</sup>	625.6 <sup>v</sup>	625.6 <sup>v</sup>	625.2 <sup>v</sup>	624.4 <sup>v</sup>	624.4 <sup>v</sup>	626.0 <sup>v</sup>
	5.1	5.0	5.0	5.0	5.4	6.2	6.2	4.5
	4	20	40	60	83.7	83.8	86.7	86.8

Finish grade P.O. Sta. 9+00  
Elev. 618.74

Reduced-Plotted  
checked 11-7-34  
C.B.H.

8+50

	12.2 <sup>2</sup>	14.1 <sup>1</sup>	14.1 <sup>1</sup>	13.2 <sup>2</sup>	12.9 <sup>1</sup>	13.1 <sup>1</sup>	13.0 <sup>2</sup>	12.9 <sup>1</sup>
	88.5 <sup>5</sup>	88.3 <sup>3</sup>	85.7 <sup>7</sup>	85.5 <sup>5</sup>	80	60	40	20

633.5<sup>v</sup>    633.3<sup>v</sup>    633.4<sup>v</sup>    633.5<sup>v</sup>

	633.4 <sup>v</sup>	633.4 <sup>v</sup>	633.3 <sup>v</sup>	633.4 <sup>v</sup>	633.2 <sup>v</sup>	633.3 <sup>v</sup>	632.3 <sup>v</sup>	632.3 <sup>v</sup>	633.9 <sup>v</sup>
	13.0 <sup>0</sup>	13.0 <sup>0</sup>	13.1 <sup>1</sup>	13.0 <sup>0</sup>	13.2 <sup>2</sup>	13.1 <sup>1</sup>	14.1 <sup>1</sup>	14.1 <sup>1</sup>	12.5 <sup>5</sup>
	4	20	40	60	80	85.6	85.6	88.4	88.5

Reduced-Plotted  
checked 11-7-34  
C.B.H.

8+38

	9.1 <sup>1</sup>	10.7 <sup>7</sup>	10.7 <sup>7</sup>	9.6 <sup>6</sup>	9.7 <sup>7</sup>	9.2 <sup>2</sup>	9.2 <sup>2</sup>	9.2 <sup>2</sup>
	89.5 <sup>5</sup>	89.2 <sup>2</sup>	86.5 <sup>5</sup>	86.2 <sup>2</sup>	80	60	40	20

636.7<sup>v</sup>    637.2<sup>v</sup>    637.2<sup>v</sup>    637.2<sup>v</sup>

	637.2 <sup>v</sup>	637.3 <sup>v</sup>	637.1 <sup>v</sup>	637.0 <sup>v</sup>	636.8 <sup>v</sup>	636.7 <sup>v</sup>	636.1 <sup>v</sup>	636.1 <sup>v</sup>	637.6 <sup>v</sup>
	9.2 <sup>2</sup>	9.1 <sup>1</sup>	9.3 <sup>3</sup>	9.4 <sup>4</sup>	9.6 <sup>6</sup>	9.7 <sup>7</sup>	10.3 <sup>3</sup>	10.3 <sup>3</sup>	8.8 <sup>8</sup>
	4	20	40	60	80	86.2	86.2	89.2	89.2

complete

8+25

	4.6 <sup>6</sup>	6.5 <sup>5</sup>	6.5 <sup>5</sup>	5.4 <sup>4</sup>	5.3 <sup>3</sup>	5.7 <sup>7</sup>	5.6 <sup>6</sup>	5.5 <sup>5</sup>	5.5 <sup>5</sup>	5.1 <sup>1</sup>
	90.2 <sup>2</sup>	90	87.6 <sup>6</sup>	87.3 <sup>3</sup>	83	81.5 <sup>5</sup>	75	60	40	20

640.8<sup>v</sup>    640.9<sup>v</sup>    641.4<sup>v</sup>    641.3<sup>v</sup>

	641.3 <sup>v</sup>	641.4 <sup>v</sup>	641.1 <sup>v</sup>	641.2 <sup>v</sup>	640.8 <sup>v</sup>	640.8 <sup>v</sup>	640.2 <sup>v</sup>	640.2 <sup>v</sup>	641.8 <sup>v</sup>
	5.1 <sup>1</sup>	5.0 <sup>0</sup>	5.3 <sup>3</sup>	5.5 <sup>5</sup>	5.6 <sup>6</sup>	5.6 <sup>6</sup>	6.2 <sup>2</sup>	6.2 <sup>2</sup>	4.6 <sup>6</sup>
	4	20	40	60	80	87.2	87.3	90.1	90.1

Reduced-Plotted  
checked 11-7-34  
complete C.B.H.

4.62      641.74 = check on

Vertical cut, Sta. 8+25  
Elev. 641.75,



Final X Sections - Floor Subgrade.

Oct. 19 - 1934

Finish Grade Pin

Sta. 8+25	11.70	654.00						642.30												
			South						North											
			648.9	649.1	648.7	648.9	648.3	648.9	648.8	648.5	649.0	649.1	649.0	649.2	648.1	648.1	649.6			
8+00	4 <sup>3</sup> 918	5 <sup>2</sup> 916	5 <sup>7</sup> 893	4 <sup>6</sup> 891	5 <sup>1</sup> 80	5 <sup>5</sup> 70	4 <sup>9</sup> 60	5 <sup>3</sup> 40	5 <sup>1</sup> 20	5 <sup>7</sup> 10	5 <sup>1</sup> 4	5 <sup>2</sup> 20	5 <sup>5</sup> 40	5 <sup>0</sup> 50	4 <sup>9</sup> 60	5 <sup>0</sup> 80	4 <sup>8</sup> 887	5 <sup>2</sup> 887	5 <sup>9</sup> 918	4 <sup>4</sup> 918
T.P.	6.67	660.25	0.42					653.58												

7+80	4 <sup>2</sup> 932	5 <sup>1</sup> 93	5 <sup>9</sup> 907	4 <sup>8</sup> 906	4 <sup>8</sup> 80	4 <sup>9</sup> 70	4 <sup>9</sup> 58	5 <sup>0</sup> 45	5 <sup>6</sup> 40	5 <sup>1</sup> 20	654.9	654.6	654.9
------	-----------------------	----------------------	-----------------------	-----------------------	----------------------	----------------------	----------------------	----------------------	----------------------	----------------------	-------	-------	-------

654.9	655.4	655.1	655.2	655.1	655.1	655.4	655.4	654.3	654.2	656.1
5 <sup>3</sup> 4	4 <sup>9</sup> 15	5 <sup>1</sup> 20	5 <sup>1</sup> 35	5 <sup>2</sup> 50	5 <sup>1</sup> 60	4 <sup>8</sup> 80	4 <sup>8</sup> 90	6 <sup>0</sup> 90	6 <sup>0</sup> 93	4 <sup>2</sup> 93

Oct. 23 - 1934

Finish Grade Pin

Sta. 7+60	7.47	670.19						662.72					
								661.7	661.4				
7+60	8 <sup>5</sup> 942	9 <sup>6</sup> 946	9 <sup>5</sup> 912	8 <sup>5</sup> 916	8 <sup>6</sup> 84	8 <sup>7</sup> 75	8 <sup>7</sup> 67	9 <sup>7</sup> 57	8 <sup>6</sup> 45	8 <sup>5</sup> 40	8 <sup>8</sup> 20	668.1	668.1
7+40	1 <sup>2</sup> 963	3 <sup>2</sup> 95	3 <sup>0</sup> 923	2 <sup>1</sup> 92	2 <sup>2</sup> 80	2 <sup>2</sup> 60	2 <sup>1</sup> 45	2 <sup>1</sup> 20	667.9	667.9	668.0	668.1	668.0

661.2	661.4	661.4	661.3	661.1	661.6	660.7	660.7	662.6
9 <sup>0</sup> 4	8 <sup>8</sup> 20	8 <sup>8</sup> 40	8 <sup>2</sup> 60	9 <sup>1</sup> 80	8 <sup>6</sup> 917	9 <sup>5</sup> 917	9 <sup>5</sup> 945	7 <sup>6</sup> 947
667.9	667.9	668.0	668.1	668.0	667.9	667.0	667.0	667.0
2 <sup>3</sup> 4	2 <sup>3</sup> 20	2 <sup>2</sup> 40	2 <sup>1</sup> 60	2 <sup>2</sup> 80	2 <sup>3</sup> 928	3 <sup>2</sup> 928	3 <sup>2</sup> 957	1 <sup>2</sup> 959

Reduced Plotted  
Checked 11-24  
L.B.H.

Reduced Plotted  
Checked 11-7-34  
L.B.H.

Reduced Plotted  
Checked 11-7-34  
L.B.H.



X Sections And Measurements of Section of Concrete Floor to be poured, to Determine Batch Yield.

Simpson  
Sept  
1931

Oct. 25-1934.

Finish Grade Pin

Sta. 7+60 8.21 = 670.93 662.72

South

North

7+58 <sup>53</sup>	162.2	662.3	662.2	662.0	661.8	661.9	661.9	662.3	661.9	662.0	661.9	661.9	661.4	661.9	7.0	86.1
	8 <sup>7</sup>	8 <sup>6</sup>	8 <sup>3</sup>	8 <sup>2</sup>	9 <sup>1</sup>	9 <sup>0</sup>	9 <sup>0</sup>	8 <sup>2</sup>	9 <sup>0</sup>	8 <sup>7</sup>	9 <sup>0</sup>	9 <sup>0</sup>	9 <sup>0</sup>	9 <sup>0</sup>		
	34 <sup>2</sup>	30	20	10	4	10	20	30	40	50	60	70	80			

7+49<sup>25</sup>

	665.0	665.0	665.0	664.9	665.0	665.1	665.1	665.1	665.0	665.1	665.1	665.1	664.9	665.1	6.0	86.5
	5 <sup>9</sup>	5 <sup>8</sup>	5 <sup>9</sup>	6 <sup>0</sup>	5 <sup>9</sup>	5 <sup>8</sup>	5 <sup>8</sup>	5 <sup>8</sup>	5 <sup>9</sup>	5 <sup>8</sup>	5 <sup>8</sup>	5 <sup>8</sup>	5 <sup>8</sup>	5 <sup>8</sup>		
	34 <sup>4</sup>	30	20	10	4	10	20	30	40	50	60	70	80			

7+40

	668.0	668.0	668.0	668.0	667.9	668.0	667.8	667.9	668.0	668.1	668.0	667.9	668.0	667.9	2.9	86.7
	2 <sup>9</sup>	2 <sup>9</sup>	2 <sup>9</sup>	2 <sup>9</sup>	3 <sup>0</sup>	2 <sup>9</sup>	3 <sup>1</sup>	3 <sup>0</sup>	2 <sup>9</sup>	2 <sup>9</sup>	2 <sup>9</sup>	2 <sup>9</sup>	3 <sup>0</sup>	3 <sup>0</sup>		
	34 <sup>6</sup>	20	10	4	10	20	30	40	50	60						

Average  
Elev. of top of Header Board

At Sta. 7+58<sup>53</sup> 7.76 663.17

Average Elev. of Finished

Concrete at Sta. 7+40 1.82 769.11

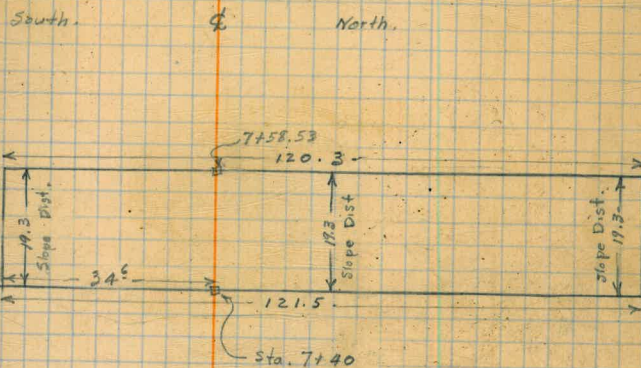



















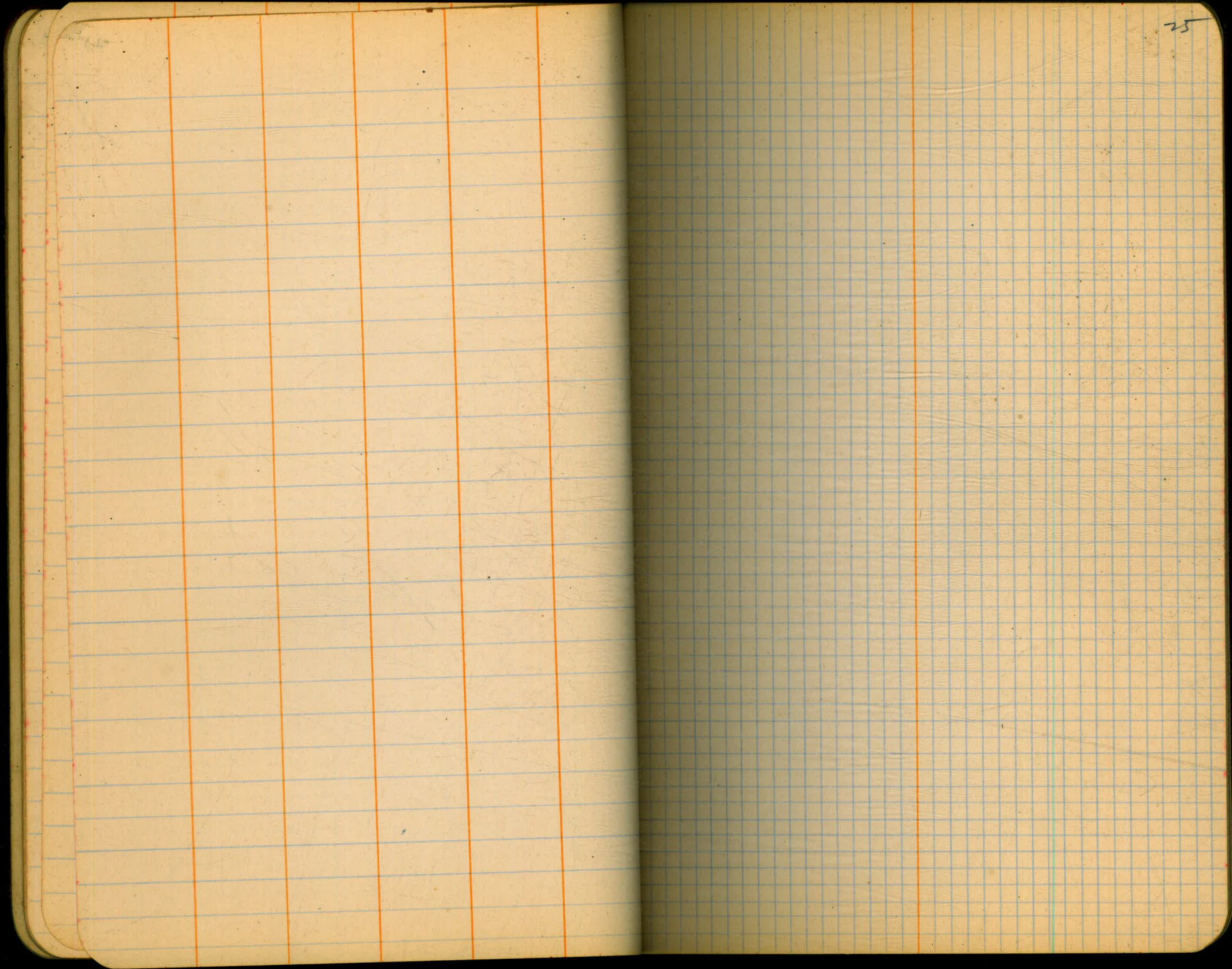







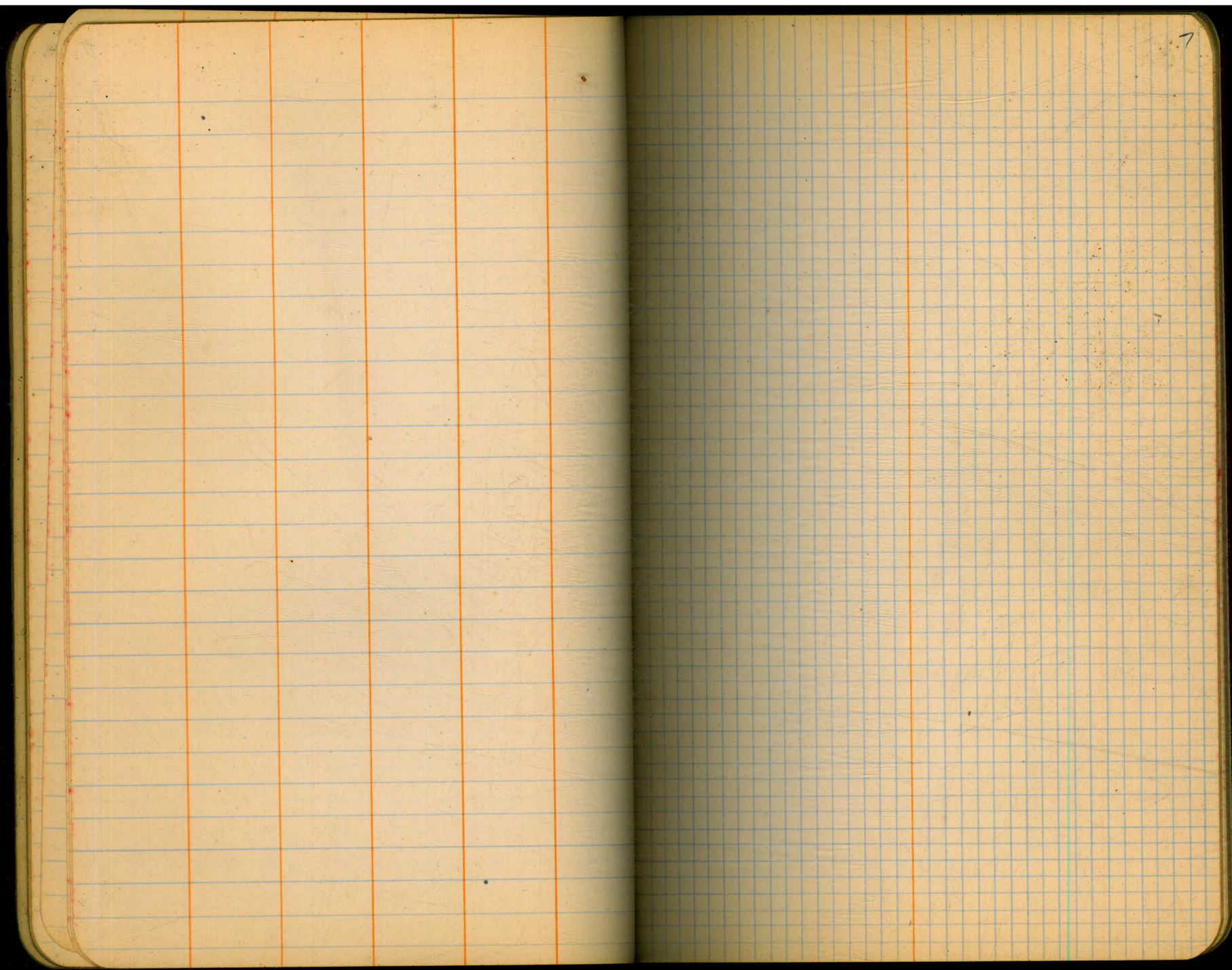



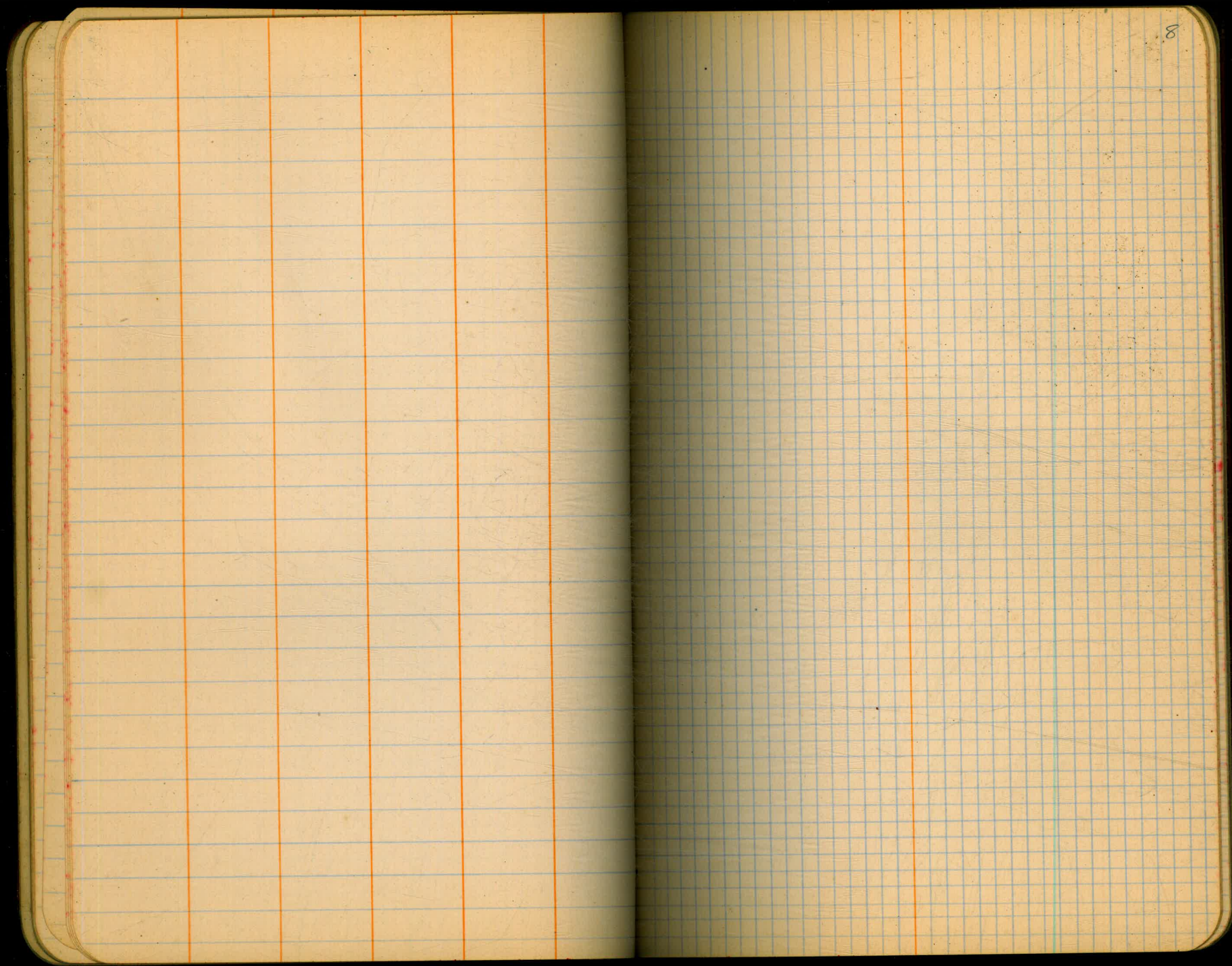

8



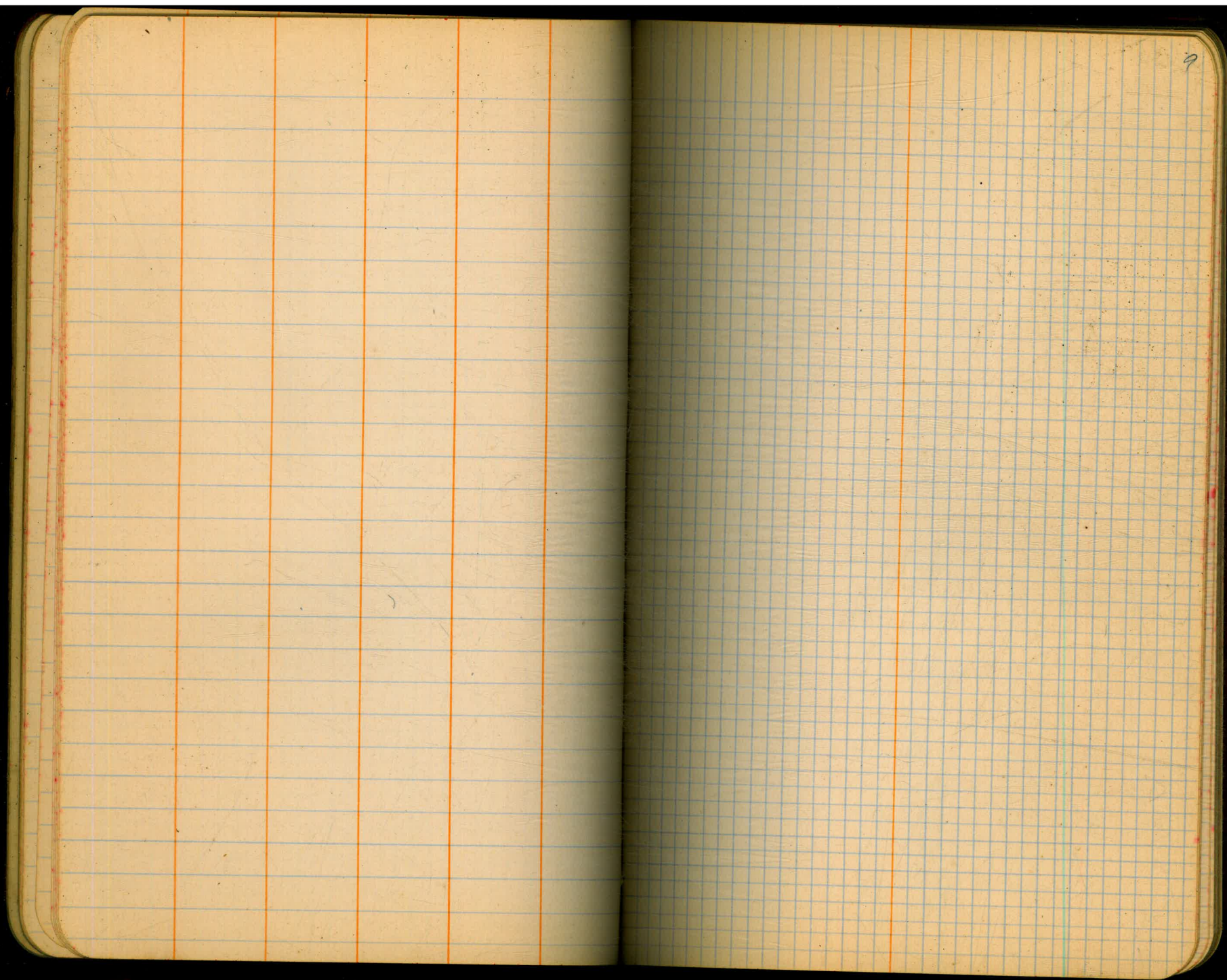



























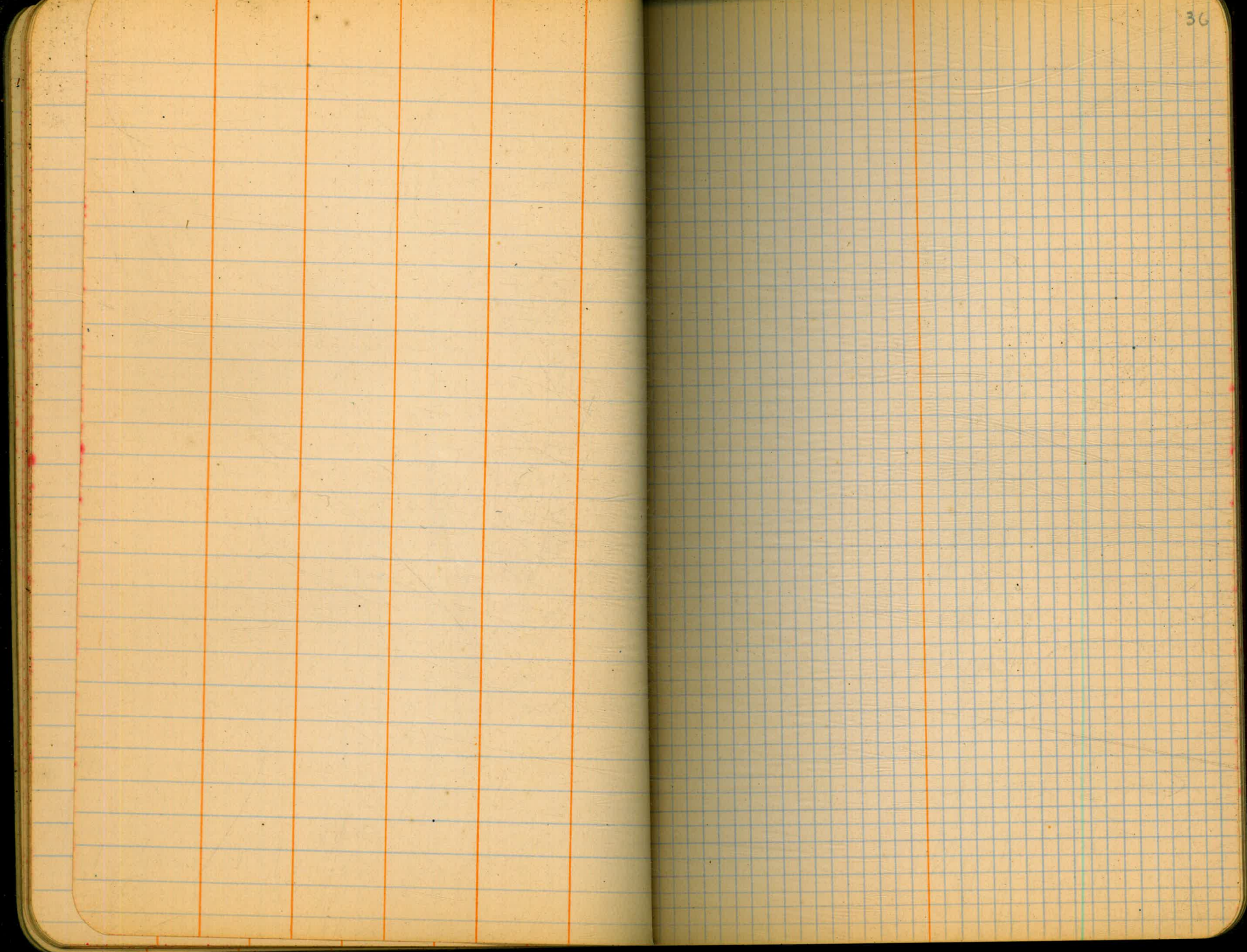















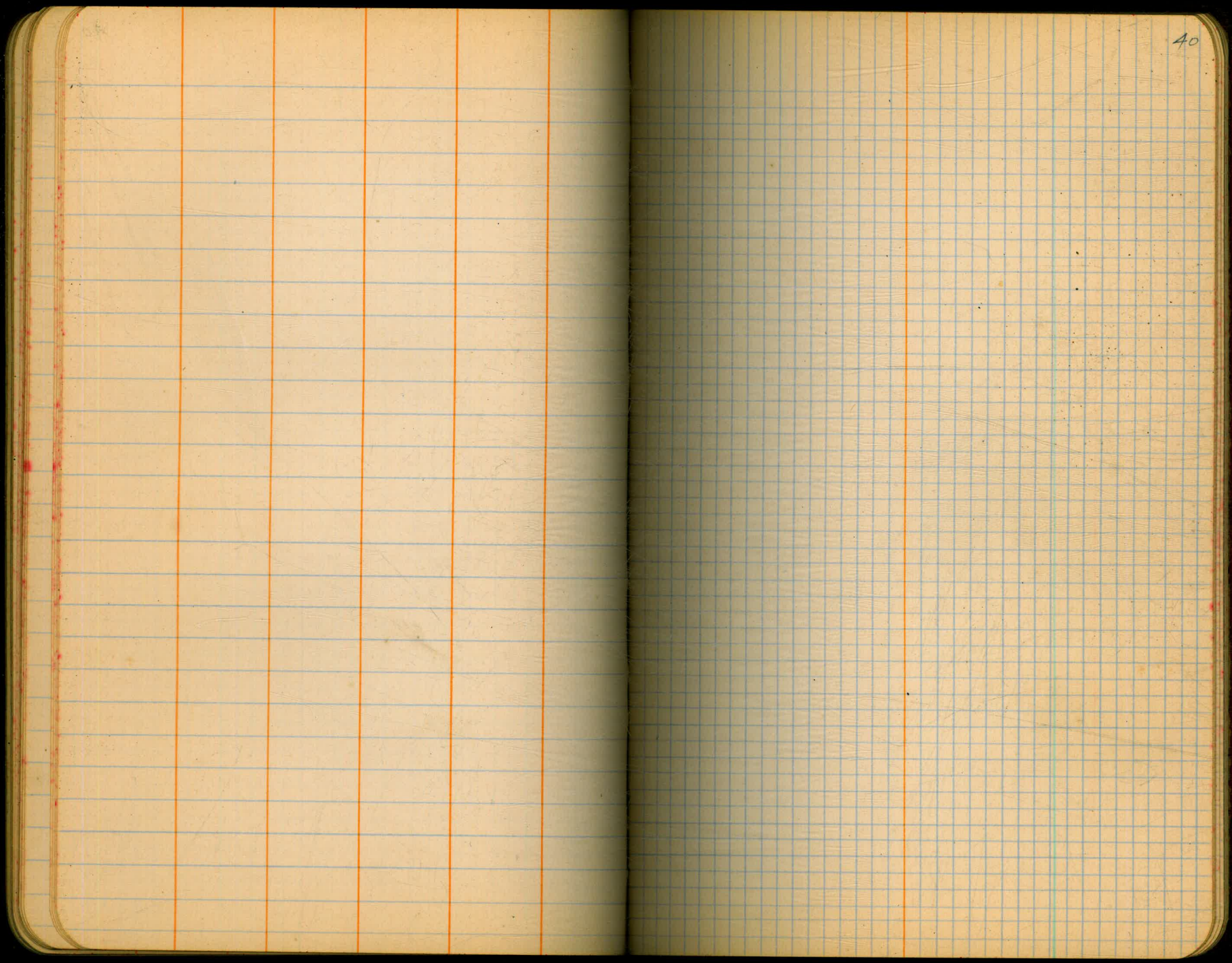







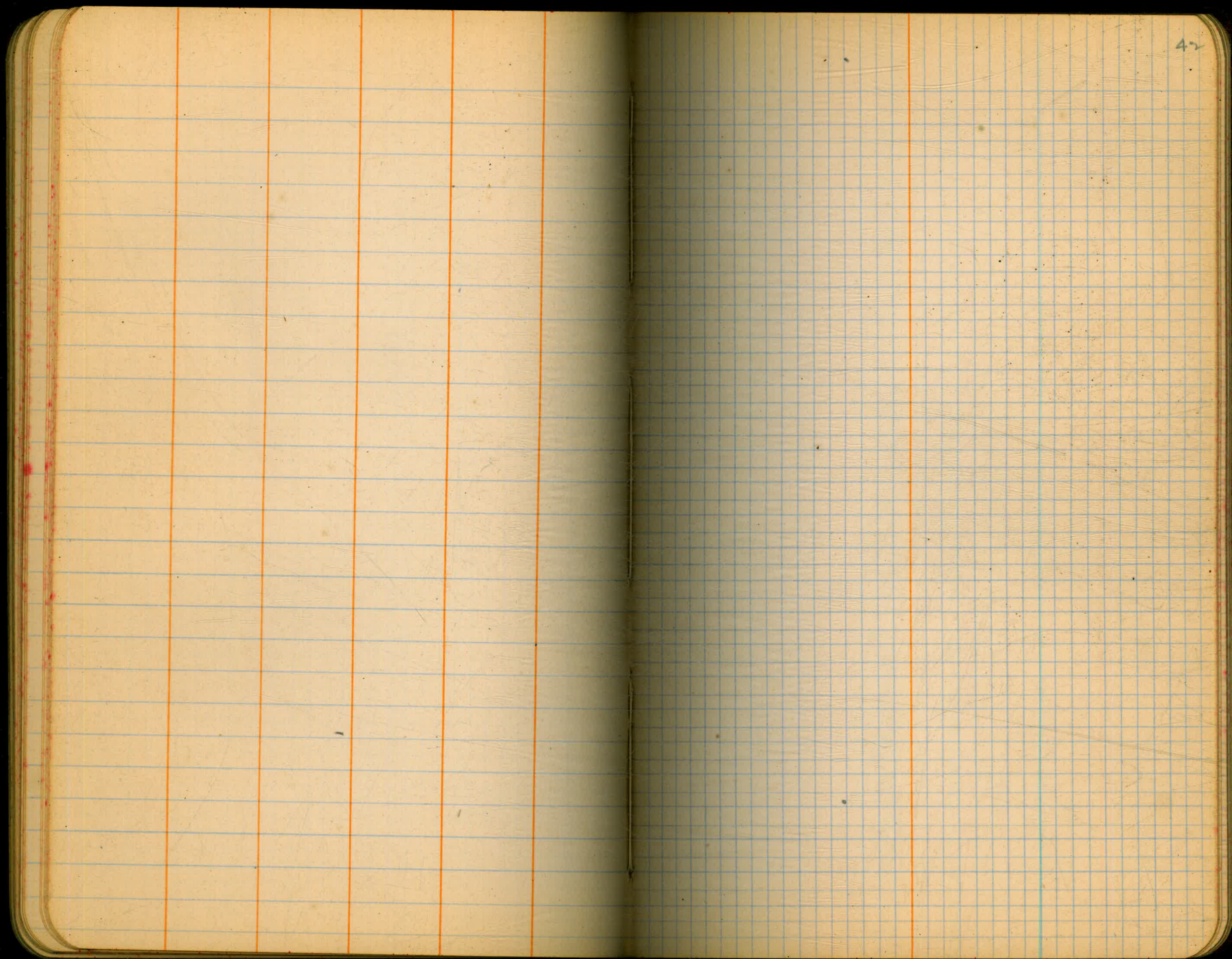

42







































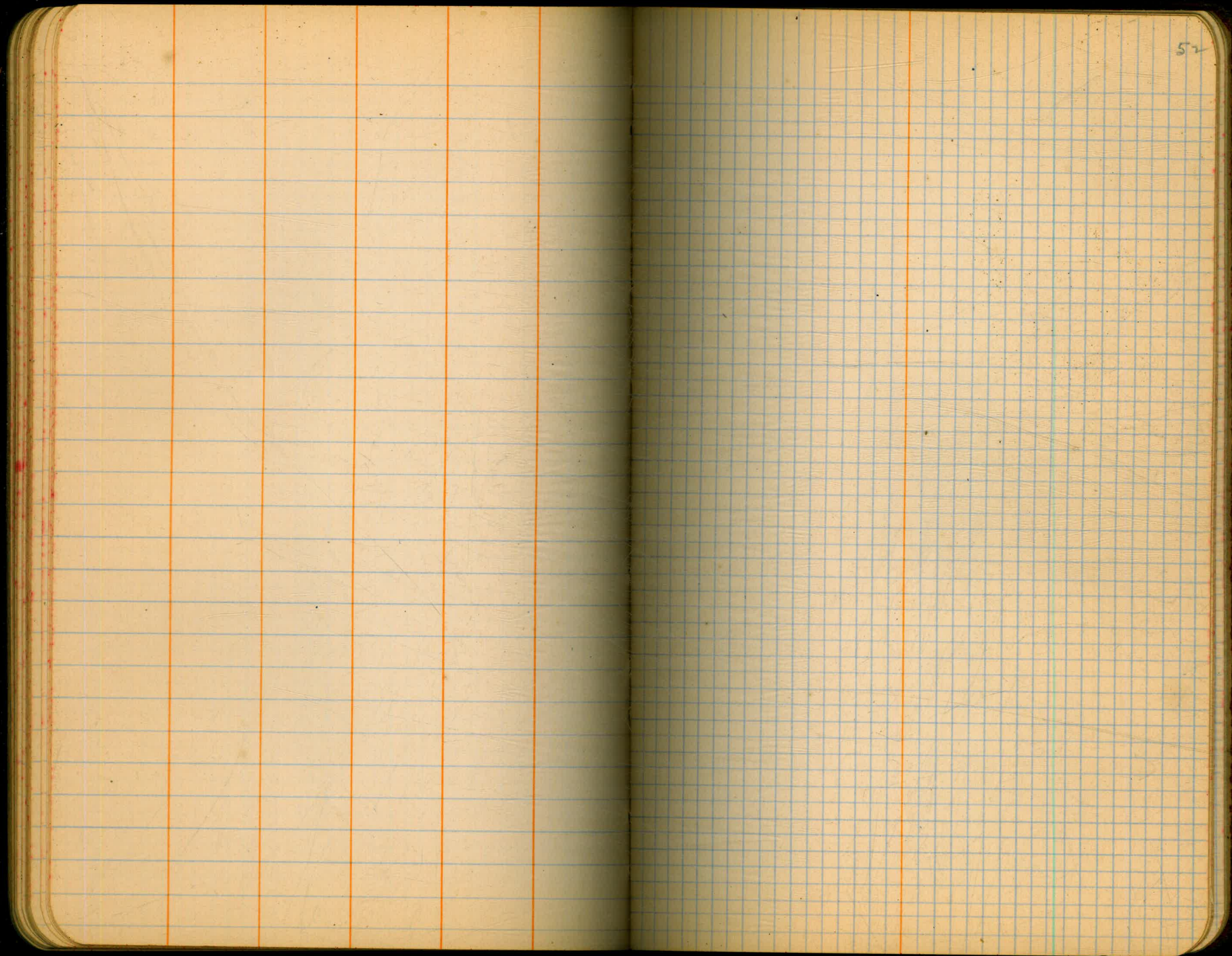







































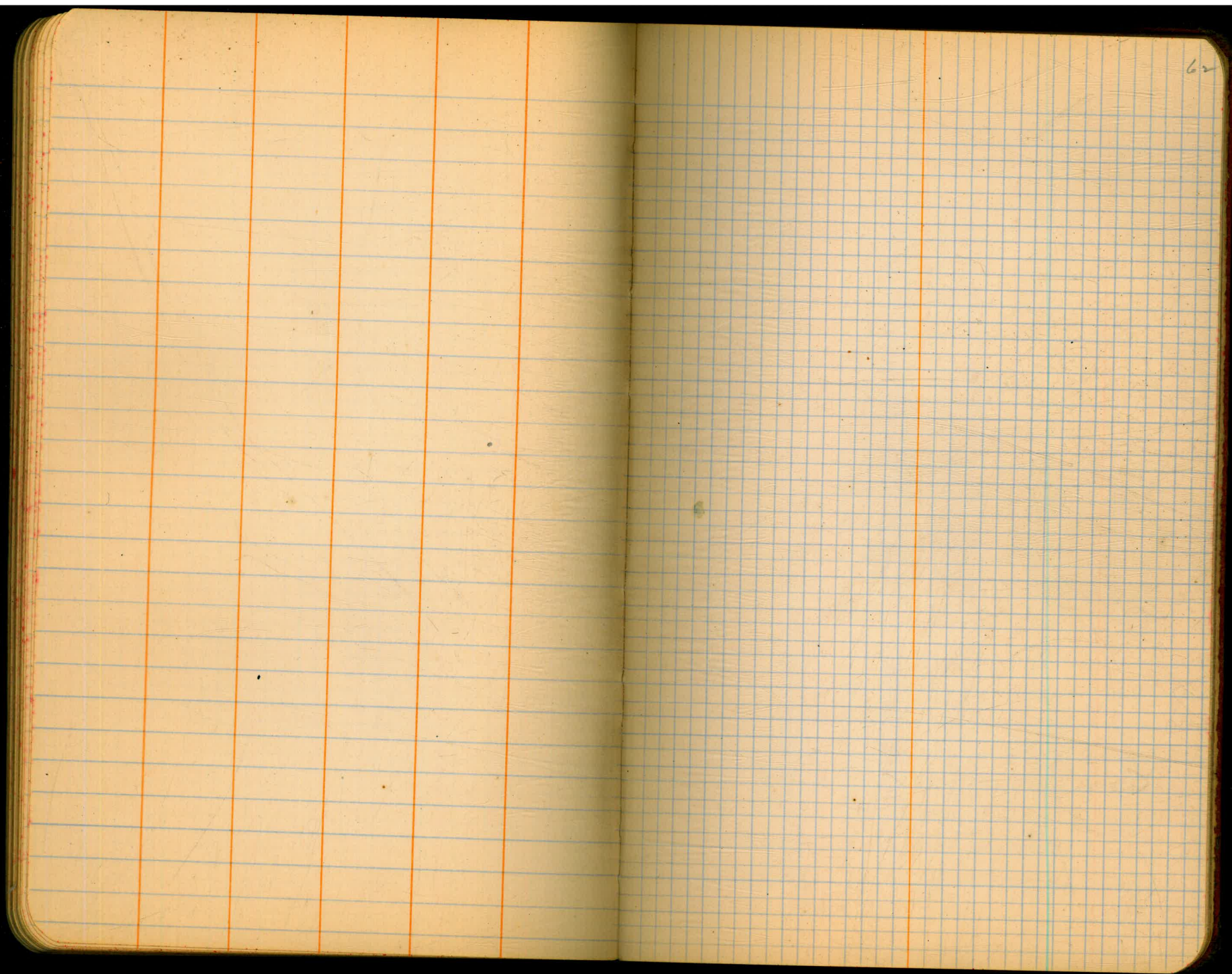























X Sections of Excavation Over-Break  
At Sta. 15+50 - Spillway Extension

South Side of  $\phi$

B.M. 4.97 547.26 542.29

25' South of  $\phi$  is subgrade west of 15+50  
(no overbreak)

West, from 30' South of  $\phi$

0	6.3	541.0	
5	3.1	544.2	
11	+2.9	550.2	on Subgrade?

Subgrade on West.

West, from 50' South of  $\phi$

0	6.3	541.0	
4	3.6	543.7	
14	+22.3	569.6	= O.G.

West, from 76' South of  $\phi$

Slope stake 15+25-c-90! 3.56 575.06 571.50

0	vertical		541.0
0		24.6	550.5
11		16.7	558.4
16		4.6	570.5 = O.G. at stationing m

Sept. 24-1934  
Simpson  
Soper  
Isbell

67

1.1  
 $\gamma < 42^{\circ} 34' - 33''$

See sections on Spillway E  
see Roll  
m

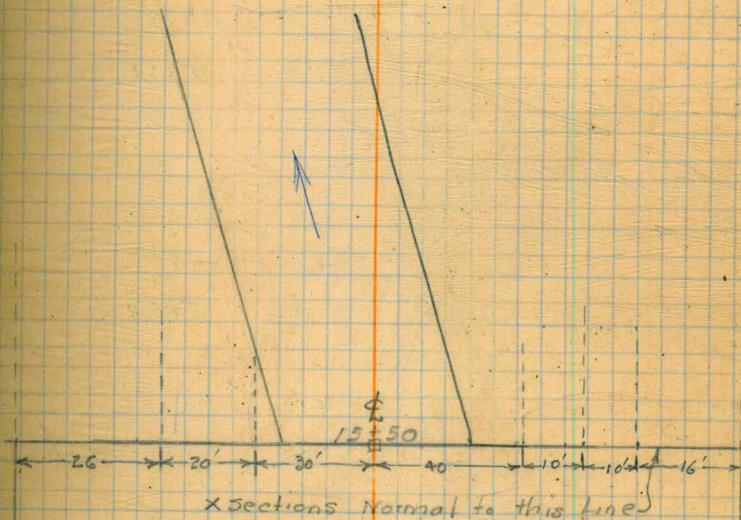



X Sections of Excavation Over-Break at  
Sta. 15+50, Cont'd.

North Side of  $\Phi$

B.M. 7.41      549.70      542.29

25' North of  $\Phi$  is Subgrade at 15+50 and on West.  
(No. Over-break)

West, from 40' North of  $\Phi$

0	8.7	541.0	
1	5.2	544.5	
4 <sup>5</sup>	2.6	547.1	
Slope Stake - N. Side 14+50 - C-31.8      5.95		<u>579.06</u>	573.11
12	11.0	568.1	
15	5.8	573.3	O.G. $\pm$

West, from 30' North of  $\Phi$

0		<u>549.70</u>	
	8.7	541.0	
1	4.8	544.9	
5	2.8	546.9	
		<u>579.06</u>	
11	10.5	568.6	
17	5.1	574.0	O.G.

West from 60' North of  $\Phi$

0		<u>549.70</u>	
	8.7	541.0	
1 <sup>5</sup>	8.7	541.0	
1 <sup>5</sup>	4.7	545.0	
		<u>579.06</u>	
18	4.6	574.5	O.G.

cutting at  
18

Sept. 26 - 1934

68

573.11  
595-  
579.06



X Sections of Excavation Over-Break at  
Sta. 15+50 - Cont'd.

69

North Side of  $\Phi$

549.70

West from 76' North of  $\Phi$

0 8.7 541.0

0.5 5.4 544.3

5 +2.6 552.3

579.06

9 8.3 570.8

14 3.8 575.3 0.6

2.6 576.5 check on slope stake 15+50 - cut 35"  
Elev. 576.4

No Over-break 111' North of  $\Phi$ .

ab  
n



X Sections of Ramp left in South Side  
of channel cut From sta. 19+50 to 20+75

B.M.	11.15	553.44		542.29
T.P.			6.19	547.25
	11.62	558.87		

Sept. 26-1934

Simpson  
Coper  
Isbell

70

✓ 19+50 is Grade

		South of $\Phi$				
		5509.11	5495.7	5493.7	5466.7	
19+75	+10	38	29	15	12.3	Grade $\Phi$

		5568.7	5521.7	551.6	547.0	
20+00	2.1	0.0.36	32	16	13	Grade $\Phi$

		557.3	554.4	553.1	545.7	
+25	1.5	42	36	19	16	Grade $\Phi$

		558.7	554.7	546.1		
+50	0.2	45	23	19		Grade $\Phi$

Platted Sept 27-34 G.R.H.

20+75 is Grade

11.7    547.2    = check on

cut Stake on d cut 11.7  
Elev. 547.2.

starting ch.  
m.



DIRECTIONS FOR USE OF TABLES

TABLE No. 1.

Distance of slope stake from side or shoulder stake for any width roadway, slope  $1\frac{1}{2}$  to 1. If ground is nearly level, the cut or fill at side stake is located by the double entry method in left column and top row. The number in body of table in same row and column gives distance level contains the difference in elevation between the side stake and stake lower by this amount it cut, or higher it fill. Add this amount to cut or fill and you have the distance. Set up at the stake and make the slight adjustment.

**IMPROVED TABLES**  
**AND**  
**INFORMATION**

TABLE No. 2.

To find Tangent and External for curve of any other degree, divide by degree of curve and add correction found in column of correction. Degree of curve with a given  $L$  may be found by dividing tangent (or external) opposite  $L$  by given tangent (or external). The distance from a point on the tangent to the curve is very nearly the square of the tangent length divided by twice the radius.



270

$$\begin{array}{r} 206 \\ 40 \\ \hline 8240 \end{array}$$
$$\begin{array}{r} 305 \\ \hline 27 \overline{) 8240} \\ \underline{81} \\ 140 \\ \underline{135} \end{array}$$