

SERA

522

TIME

San BOOK

Diequito

TWO WEEKLY

No. 596½

W522

Time Book for Half Month or Two Weeks Ending

19

No.	NAME <small>Draw line through Dates or Letters not used</small>	1	2	3	4	5	6	7	8	9	10	11	12	13	14	15	No. of Hours	Rate Per Hour	AMOUNT OF WAGES	AMOUNT PAID
		S 16	M 17	T 18	W 19	T 20	F 21	S 22	S 23	S 24	M 25	T 26	W 27	T 28	F 29	S 30				
	<i>A. Quigda</i>					130														
	<i>John Bradford</i>					117														
	<i>John Domingo</i>					120														
	<i>J. Pear</i>					56														
	<i>150</i>																			
	<i>23</i>																			
	<i>45</i>																			
	<i>300</i>																			
	<i>3450</i>																			
	<i>2040</i>																			
	<i>549</i>																			
	<i>125</i>																			
	<i>20</i>																			
	<i>62</i>																			
	<i>87</i>																			
	<i>937</i>																			
	<i>1742-34</i>																			
	<i>4200</i>																			

\$ 1340.00

Time Book for Half Month or Two Weeks Ending Dec 6th

1974

No.	NAME <small>Draw line through Dates or Letters not used</small>	1	2	3	4	5	6	7	8	9	10	11	12	13	14	15	No. of Hours	Rate Per Hour	AMOUNT OF WAGES	AMOUNT PAID	
		S 16	M 17	T 18	W 19	T 20	F 21	S 22	S 24	M 25	T 26	W 27	T 28	F 29	S 30	31					
12	Bradford Harry					8	4										-	12	60	720	15187
92	Dawson Frank					8	8				8	8					60	32	60	1920	11416
56	Dominguez James					8	8				8	8					24	32	60	1920	15158
48	Gonzalez Antonio					8	8				8	8					16	32	60	1920	11462
32	Osorio Pedro					8	8				8	8	X				-	32	60	1920	15189
16	Owens Cecil					8	8										-	16	60	960	15212
88	Peat John					8	8					8					64	24	60	1440	11401
52	Pardo Edwin					8	8				8	8					20	32	60	1920	15142
56	Quijada Quillem					8	8				8	8					24	32	60	1920	11461
32	Slutz Conrad					8	8				8	8	X				-	32	60	1920	15165
																	27	60		\$16560	

Time Book for Half Month or Two Week Ending *Dec 20th* 19*34*

No.	NAME <small>Draw line through Dates or Letters not used</small>	1	2	3	4	5	6	7	8	9	10	11	12	13	14	15	No. of Hours	Rate Per Hour	AMOUNT OF WAGES	AMOUNT PAID
		S 16	M 17	T 18	W 19	T 20	F 21	S 22	S 24	M 25	T 26	W 27	T 28	F 29	S 30	31				
<i>4</i> 64	<i>Dawson Frank</i>					8					8	8					24	60	1440	11416
<i>8</i> 18	<i>Gonzalez Antonio</i>					8					8	-					16	60	960	11462
<i>8</i>	<i>osorio Pedro</i>					8	-				-	-					8	60	480	15189
<i>56</i>	<i>Peat John</i>					X											-	60		11401
<i>20</i>	<i>Pelto Alvin</i>					8					8						16	60	960	15142
<i>54</i>	<i>Quijada Paul</i>					8					8	8					24	60	1440	11461
<i>8</i>	<i>Stutz Conrad</i>					8	-				-	-					8	60	480	15165
<i>24</i> <i>40</i>	<i>Palmarer Alexander</i>					8						8					16	60	960	7237
<i>60</i>	<i>Cootts Fred</i>					8					8	8					24	60	1440	15180
<i>96</i>	<i>Kleinman Melvin</i>					4											4	60	240	
<i>48</i>	<i>Owens Cicie</i>										8	8					16	60	960	15212
<i>48</i>	<i>Dominguez Jesus</i>										8	8					16	60	960	15188
																	172		\$10320	

Time Book for Half Month or Two Weeks Ending *Jan 2nd* 19*35*

No.	NAME <small>Draw line through Dates or Letters not used</small>	1	2	3	4	5	6	7	8	9	10	11	12	13	14	15	No. of Hours	Rate Per Hour	AMOUNT OF WAGES		AMOUNT PAID								
		S	M	T	W	T	F	S	S	M	T	W	T	F	S	16			17	18	19	20	21	22	23	24	25	26	27
<i>40</i>	<i>Dawson Frank</i>					<i>8</i>	<i>8</i>				<i>8</i>	<i>8</i>	-				<i>32</i>	<i>60</i>	<i>19</i>	<i>20</i>	<i>114</i>	<i>16</i>							
<i>8</i>	<i>Gonzales Antonio</i>					<i>8</i>	-	-									<i>8</i>	<i>60</i>	<i>4</i>	<i>80</i>	<i>114</i>	<i>62</i>							
<i>16</i>	<i>Pelzo Albin</i>					<i>8</i>	<i>8</i>	-									<i>16</i>	<i>60</i>	<i>9</i>	<i>60</i>	<i>151</i>	<i>42</i>							
<i>30</i>	<i>Quijada Q</i>					<i>8</i>	<i>8</i>				<i>8</i>	<i>6</i>	-				<i>30</i>	<i>60</i>	<i>18</i>	<i>00</i>	<i>114</i>	<i>61</i>							
<i>28</i>	<i>Palmation Alex</i>					<i>8</i>	-	-				<i>8</i>	-				<i>16</i>	<i>60</i>	<i>9</i>	<i>60</i>	<i>72</i>	<i>37</i>							
<i>50</i>	<i>Conth Fred</i>					<i>8</i>	<i>8</i>				<i>8</i>	<i>8</i>	<i>8</i>				<i>40</i>	<i>60</i>	<i>24</i>	<i>00</i>	<i>151</i>	<i>80</i>							
<i>92</i>	<i>Kleinman Melina</i>																	<i>60</i>											
<i>32</i>	<i>Owens Cecil</i>					<i>8</i>	<i>8</i>				<i>8</i>	<i>8</i>	-				<i>32</i>	<i>60</i>	<i>19</i>	<i>20</i>	<i>152</i>	<i>12</i>							
<i>26</i>	<i>Dominguez James</i>					<i>8</i>	<i>8</i>				<i>8</i>	<i>8</i>	-				<i>32</i>	<i>60</i>	<i>19</i>	<i>20</i>	<i>151</i>	<i>88</i>							
<i>18</i>	<i>Bradford Harry</i>										<i>8</i>	<i>4</i>	-				<i>12</i>	<i>60</i>	<i>7</i>	<i>20</i>	<i>151</i>	<i>87</i>							
																		<i>60</i>				<i>72</i>	<i>37</i>						
																	<i>218</i>		<i>130</i>	<i>80</i>									

Time Book for Half Month or Two Weeks Ending Jan 16th 1935

No.	NAME <small>Draw line through Dates or Letters not used</small>	1	2	3	4	5	6	7	8	9	10	11	12	13	14	15	No. of Hours	Rate Per Hour	AMOUNT OF WAGES	AMOUNT PAID
		S 16	M 17	T 18	W 19	T 20	F 21	S 22	S 24	M 25	T 26	W 27	T 28	F 29	S 30	31				
48	Bradford Harry					8					8	8					24	60	14 40	151 87
80	Coutts Fred					8					8	8					24	60	14 40	151 80
120	Dawson Frank					8					8	8					24	60	14 40	114 16
88	Dominguez Jesus					8					8	8					24	60	14 40	151 88
80	Sonzales Antonio					8					8	8	-				24	60	14 40	114 62
96	Kleinman Melvin												-					60		
64	Osorio Pedro					8					8	8	-				24	60	14 40	151 89
88	Owens Cecil					8					4	8					20	60	12 00	152 12
64	Palmation Alex					8					8	8					24	60	14 40	72 37
104	Quigada Guillermo					8					8	8					24	60	14 40	114 61
56	Stutz Conrad										8	8	-				16	60	9 60	151 65
																	228		136 80	

Time Book for Half Month or Two Weeks Ending Jan 19th

1925

No.	NAME <small>Draw line through Dates or Letters not used</small>	1	2	3	4	5	6	7	8	9	10	11	12	13	14	15	No. of Hours	Rate Per Hour	AMOUNT OF WAGES		AMOUNT PAID	
		S	M	T	W	T	F	S	S	M	T	W	T	F	S	31						
24	Bradford Harry	-				8	8						8				34	60	14 40	151 87		
88	Caults Fred					8	8				8	8	8				40	60	24 00	151 80		
96	Dawson Frank					8	8				8	8	8				40	60	24 00	114 16		
64	Dominguez Jesus					8	8				8	8	8				40	60	24 00	151 88		
68	Owens Cecil					8	8				8	8	8				40	60	24 00	152 12		
40	Palamater Alex					8	8				8	8	8				40	60	24 00	72 37		
80	Quijada Guillermo					8	8				8	8	8				40	60	24 00	114 61		
																	264		158 40			

Time Book for Half Month or Two Weeks ending

19

No.	NAME	1	2	3	4	5	6	7	8	9	10	11	12	13	14	15	No. of Hours	Rate Per Hour	AMOUNT OF WAGES	AMOUNT PAID
		S 16	M 17	T 18	W 19	T 20	F 21	S 22	S 23	S 24	M 25	T 26	W 27	T 28	F 29	S 30				
1/21	<i>10 am</i> Doubt Spring Ruddy Mallard Cass																			
	20 10 8 4 10																			
	52 19 9 10																			
	11 2 21 36																			
	20 15 14 61																			
	<u>153</u> <u>52</u> <u>8</u> <u>18</u>																			
1/22	<i>10 am</i> 13 33 25 32 4 19 20																			
	10 17 12 6 1																			
	10 10 8 13																			
	9 17 25																			
	<u>10</u> <u>10</u> <u>8</u> <u>13</u>																			
1/23	<i>10 am</i> 12 6 30 20 2 4 7 15 18																			
	16 7 20 3 4 14 15 18																			
	21 10 6 11 18 42																			
	6 9 7 8 4 2 12 14																			
	11 11 12 13 14																			
	<u>42</u> <u>18</u> <u>20</u> <u>5</u> <u>7</u> <u>3</u> <u>10</u> <u>11</u> <u>21</u>																			
1/24	<i>Red Neck</i> 56 6 9 7 8 4 2 12 14 18																			
	18 11 12 13 14																			
	<u>74</u> <u>20</u> <u>12</u> <u>13</u> <u>14</u>																			
1/25	42 18 20 5 7 3 10 11 21																			
	30 9 12 13 14																			
	12 4 10 6 11 21																			
	<u>114</u> <u>21</u> <u>14</u> <u>4</u> <u>4</u> <u>114</u>																			

Time Book for Half Month or Two Weeks Ending

Octy

19

No.

NAME

Draw line through Dates or Letters not used

1 2 3 4 5 6 7 8
S M T W T F S
16 17 18 19 20 21 22 23

9 10 11 12 13 14 15
S M T W T F S
24 25 26 27 28 29 30 31

No. of Hours

Rate Per Hour

AMOUNT OF WAGES

AMOUNT PAID

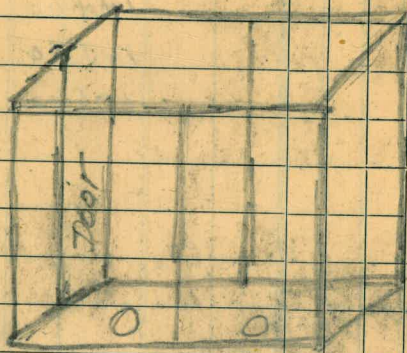

- * 3 Sinker Stills & Blades
- * 4 Sinker Cans & 2 seals
- * 3 Sinker Stills & Blades & 3 7/8" Stills
- 2 water Kegs 100g Linn
- * 1 misc. box 1 Bantam
- 1 Sprinkling Can
- * 1 Short Tail Hatch
- 3 shovels Fred

Time Book for Half Month or Two Weeks

No.	NAME <small>Draw line through Dates or Letters not used</small>	1	2	3	4	5	6	7	8
		S 16	M 17	T 18	W 19	T 20	F 21	S 22	
1	outside Jailer								
5 th	Rubber Boots								
2	Spears								
4	Shoes								
11	6 tin Forks								
3	Crack line handles								
2	Pick handles								
3	Mattings 3 rd kind bases								
SERA									
6	5 tin Forks -								
10	Mattings - Halls								

134450
 4600
 87440
 100
 16460
 144
 46560
 960
 200
 1200
 260
 6
 15600