

W
0/7

JJ-9V
 238
 38.33

DISTANCES FROM SIDE STAKES FOR CROSS-SECTIONING
 Roadway of any Width. Side Slopes 1 1/2 to 1.

In the figure below: opposite 7 under "Cut or Fill" and under 3 read 11.0, the distance out from the side stake at left. Also, opposite 11 under "Cut or Fill" and under .1 read 16.7, the distance out from the side stake at right.

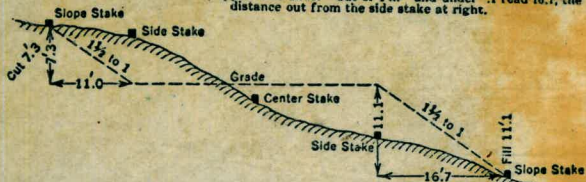

Cut or Fill	Distance out from Side or Shoulder Stake										Cut or Fill
	0	.1	.2	.3	.4	.5	.6	.7	.8	.9	
0	0.0	0.2	0.3	0.5	0.6	0.8	0.9	1.1	1.2	1.4	0
1	1.5	1.7	1.8	2.0	2.1	2.3	2.4	2.6	2.7	2.9	1
2	3.0	3.2	3.3	3.5	3.6	3.8	3.9	4.1	4.2	4.4	2
3	4.5	4.7	4.8	5.0	5.1	5.3	5.4	5.6	5.7	5.9	3
4	6.0	6.2	6.3	6.5	6.6	6.8	6.9	7.1	7.2	7.4	4
5	7.5	7.7	7.8	8.0	8.1	8.3	8.4	8.6	8.7	8.9	5
6	9.0	9.2	9.3	9.5	9.6	9.8	9.9	10.1	10.2	10.4	6
7	10.5	10.7	10.8	11.0	11.1	11.3	11.4	11.6	11.7	11.9	7
8	12.0	12.2	12.3	12.5	12.6	12.8	12.9	13.1	13.2	13.4	8
9	13.5	13.7	13.8	14.0	14.1	14.3	14.4	14.6	14.7	14.9	9
10	15.0	15.2	15.3	15.5	15.6	15.8	15.9	16.1	16.2	16.4	10
11	16.5	16.7	16.8	17.0	17.1	17.3	17.4	17.6	17.7	17.9	11
12	18.0	18.2	18.3	18.5	18.6	18.8	18.9	19.1	19.2	19.4	12
13	19.5	19.7	19.8	20.0	20.1	20.3	20.4	20.6	20.7	20.9	13
14	21.0	21.2	21.3	21.5	21.6	21.8	21.9	22.1	22.2	22.4	14
15	22.5	22.7	22.8	23.0	23.1	23.3	23.4	23.6	23.7	23.9	15
16	24.0	24.2	24.3	24.5	24.6	24.8	24.9	25.1	25.2	25.4	16
17	25.5	25.7	25.8	26.0	26.1	26.3	26.4	26.6	26.7	26.9	17
18	27.0	27.2	27.3	27.5	27.6	27.8	27.9	28.1	28.2	28.4	18
19	28.5	28.7	28.8	29.0	29.1	29.3	29.4	29.6	29.7	29.9	19
20	30.0	30.2	30.3	30.5	30.6	30.8	30.9	31.1	31.2	31.4	20
21	31.5	31.7	31.8	32.0	32.1	32.3	32.4	32.6	32.7	32.9	21
22	33.0	33.2	33.3	33.5	33.6	33.8	33.9	34.1	34.2	34.4	22
23	34.5	34.7	34.8	35.0	35.1	35.3	35.4	35.6	35.7	35.9	23
24	36.0	36.2	36.3	36.5	36.6	36.8	36.9	37.1	37.2	37.4	24
25	37.5	37.7	37.8	38.0	38.1	38.3	38.4	38.6	38.7	38.9	25
26	39.0	39.2	39.3	39.5	39.6	39.8	39.9	40.1	40.2	40.4	26
27	40.5	40.7	40.8	41.0	41.1	41.3	41.4	41.6	41.7	41.9	27
28	42.0	42.2	42.3	42.5	42.6	42.8	42.9	43.1	43.2	43.4	28
29	43.5	43.7	43.8	44.0	44.1	44.3	44.4	44.6	44.7	44.9	29
30	45.0	45.2	45.3	45.5	45.6	45.8	45.9	46.1	46.2	46.4	30
31	46.5	46.7	46.8	47.0	47.1	47.3	47.4	47.6	47.7	47.9	31
32	48.0	48.2	48.3	48.5	48.6	48.8	48.9	49.1	49.2	49.4	32
33	49.5	49.7	49.8	50.0	50.1	50.3	50.4	50.6	50.7	50.9	33
34	51.0	51.2	51.3	51.5	51.6	51.8	51.9	52.1	52.2	52.4	34
35	52.5	52.7	52.8	53.0	53.1	53.3	53.4	53.6	53.7	53.9	35
36	54.0	54.2	54.3	54.5	54.6	54.8	54.9	55.1	55.2	55.4	36
37	55.5	55.7	55.8	56.0	56.1	56.3	56.4	56.6	56.7	56.9	37
38	57.0	57.2	57.3	57.5	57.6	57.8	57.9	58.1	58.2	58.4	38
39	58.5	58.7	58.8	59.0	59.1	59.3	59.4	59.6	59.7	59.9	39
40	60.0	60.2	60.3	60.5	60.6	60.8	60.9	61.1	61.2	61.4	40

KEUFFEL & ESSER CO., N. Y.

10,892-3. km, cc, vs. cM.

MICROFILMED

The paper in this book No. F370A
 is made of 50% high rag stock
 with a WATER RESISTING surface sizing.

JAN 13 1966

SECTIONING
to 1.
d 11.0, the distance out
under .1 read 16.7, the
right.



8	9	5
1.2	1.4	0
2.7	2.9	1
4.2	4.4	2
5.7	5.9	3
7.2	7.4	4
8.7	8.9	5
10.2	10.4	6
11.7	11.9	7
13.2	13.4	8
14.7	14.9	9
16.2	16.4	10
17.7	17.9	11
19.2	19.4	12
20.7	20.9	13
22.2	22.4	14
23.7	23.9	15
25.2	25.4	16
26.7	26.9	17
28.2	28.4	18
29.7	29.9	19
31.2	31.4	20
32.7	32.9	21
34.2	34.4	22
35.7	35.9	23
37.2	37.4	24
38.7	38.9	25
40.2	40.4	26
41.7	41.9	27
43.2	43.4	28
44.7	44.9	29
46.2	46.4	30
47.7	47.9	31
49.2	49.4	32
50.7	50.9	33

JU-9V
238
38.33

No. of Axis	West Slope		BENCH LEVELS			Ramona Highway				
	Elev.	BM	North of Axis	East Slope	South of Axis	North of Axis	South of Axis			
A1	649.55	A9	464.28	A30	700.28	A23	523.8	479.50	A1	472.62
A1	618.32	A10	514.88	A31	663.09	A24	552.1	480.39	A2	462.54
A18	591.43	A11	558.57	A32	626.07	A25	588.2	481.39	A3	467.13
A19	559.78	A12	592.43	A33	594.72	A26	602.3	482.84	#1	476.89
A20	504.10	A13	629. ³³ 34	A34	553.59	A27	641.1	483.67		
A21	469.19	A14	656. ¹³ 14	A35	517.28	A28	707.8			
A22	471.83	A15	680.35	A36	500.92	A29	753.6			

MICRO

INDEX

Levels - East Keyway	1-3
" West "	4-5
Profile of Axis and	6-8
50' South - E. Keyway	
Temporary Bench	10-12
Levels - S of Axis - W side	7
Profile of Axis and	13-14
50' South - and Levels	
on W. Keyway	
Levels for ϕ Outlet	15
Trench - & Fillet Line	
on E. Keyway	
ϕ Profile of Adit	16-17
Levels on W. Keyway	18
ϕ Profile of Adit	19
Levels on E. Keyway	20
Levels on W. Keyway	21

Index (cont.)

Stadia Survey - Locating	
Water Tank - Pipe Lines	46-47
Levels on W. Keyway	48-49
Levels for Edge of Spillway	55
Levels for Fillet Stakes	56
Levels for Fillet Line	57-58
" " " " & wasteway	59
Elevations for Forms Blk #2	62
" " Fillet Line	63-64
" " Spillway	65
" " Forms Blk #1	66-67
" of Grout Holes # 1-375	67
" at Contraction Joint	3+21
" Grout Holes # 1-125, 0-43	68
" For Forms Blk #2	69
" " " Blk #3	70
" Grout Hole # 3-375	70
" For Forms Blk. # 3&4	72

INDEX

Elevations for Valve Chamber & E. Keyway	22
Fillet Line E. Keyway	23
Grader for E. side of Outlet Trench	24
Levels for Slope Stakes in Keyway	25-27
Levels for Spillway	28
Levels for Slope Stakes in Keyway	29-33
Elevations for Excavation of Outlet Trench South of Valve Chamber	34
Profile of 50' and 100' South of Axis (Sta. 7+80 to 9+70)	35-37
Elevations for Fillet Line (7+85-8+60)	38
Levels on East & West Abutments	39-45

LEVELS - KEYWAY ON EAST SLOPE

JAN 5

DICKINSON ①

A-34

B.M. 4.19 5777

553.58

POLACK

LAINO

T.P.

1.15 556.62

KING

11.86 568.48

0.48

568.00

9.4 NORTH

3.48

565.00

9.7 "

8.48

560.00

10.2 "

10.48

558.00

10.4 "

12.48

556.00

10.6 "

T.P.

13.01 555.17

1.32 556.79

4.79

552.00

11.0 North

6.79

550.00

11.2 "

8.79

548.00

11.4

10.79

546.00

11.6

12.79

544.00

11.8

T.P.

13.00 543.79

JAN 5, 1942

(2)

LEVELS - KEYWAY ON EAST SLOPE

T.P.	073	544.52		543.79		
		2.52		542.00	12.0	North
		5.52		539.00	12.3	"
		8.52		536.00	12.6	"
		12.52		532.00	13.0	"
T.P.	056	532.18	12.90	531.62		
		5.18		527.00	13.5	North
		7.18		525.00	13.7	"
		12.18		520.00	15.1	
T.P.	078	520.21	12.75	519.43		
		5.21		515.00	15.6	North
		9.21		511.00	14.0	"
T.P.	089	508.17	12.93	507.28		
T.P.	12.84	520.76	0.25	507.92		
		5.76		515.00	104.4	SOUTH
		0.76		520.00	100.6	"
T.P.			0.25	520.51		

LEVELS-KEYWAY ON EAST SLOPE

JAN 5, 1942

(3)
DICKINSON
Polock
LAIRG
King
Cole

T.P.	12.50	53301		520.51		
			8.01	525.0	96.8	SOUTH
			3.01	530.0	93.0	"
T.P.	12.57	54504	0.54	532.47		
			10.04	535.0	89.2	SOUTH
			0.04	545.0	81.6	"
T.P.	11.96	55671	0.29	544.75		
			6.71	550.0	77.8	SOUTH
			1.71	555.0	74.0	"
T.P.	12.73	56895	0.49	556.22		
			8.95	560.0	70.2	SOUTH
			3.95	565.0	66.4	"
T.P.	674	57521	0.48	568.47		
			5.21	570.0	62.6	SOUTH
			0.21	575.0	58.8	"
T.P.			12.63	567.58		
	212	56470	11.13	553.57	553.58 = Elev. BM #	A.34

1/6/41

Dickinson (4)
Jackson
Polak
Laing
Cole

Levels - Keyway - West Slope

Fair - Cool

Sta	+ H.I.	- I.S.	Elev.
A-11			
B.M.			558.56

9.57 568.13

① 3.13 565.0 66° South of AxN

② 8.13 560.0 70° " " "

③ 13.13 555.0 74° " " "

T.P. 0.01 568.12

10.74 578.86

8.86 570.0 62° " " "

3.86 575.0 58° " " "

T.P. 1.18 577.68

12.75 590.43

10.43 580.0 74° N - 55° " " "

5.43 585.0 69° N - 51° " " "

0.43 590.0 47° " " "

12.43 578.0 76° N of AxN

T.P. 0.04 590.39

Levels - Keyway - West Slope

11/6/41

Fair - Warm

Dickinson
Jackson
Pelok
Lairg
Cole

(5)

Sta + H.I. - 1.5 Elev.

T.P. 590.39

10.76 601.15

6.15 595.0

43.5' South of Axis

1.15 600.0

39.7' " " "

T.P. 9.66 591.59

7.55 599.14

C-2

T.B.M. 2.59 596.55

JAN. 6, 1942

Dickinson
Jackson
Polak
Laing
Cole

6

Profile of Axis-50 S.-E. Slope

Sta	+	HI	-	IS	Elev
A-34					
B.M.					553.58

7.59 561.17

10+30				2.2	559.0
-------	--	--	--	-----	-------

50 S of Axis

10+20				5.5	555.7
-------	--	--	--	-----	-------

" " " - break

T.P.			12.97		548.20
------	--	--	-------	--	--------

13.00 561.20

11+50				28	558.4
-------	--	--	--	----	-------

Axis

11+25				8.5	552.7
-------	--	--	--	-----	-------

"

11+00				106	550.6
-------	--	--	--	-----	-------

"

T.P.			12.93		548.27
------	--	--	-------	--	--------

0.64 548.91

10+75				2.2	546.7
-------	--	--	--	-----	-------

"

10+50				5.1	543.8
-------	--	--	--	-----	-------

10+41				5.0	543.9
-------	--	--	--	-----	-------

"

- break

10+25				9.7	539.2
-------	--	--	--	-----	-------

"

T.P.			12.99		535.92
------	--	--	-------	--	--------

JAN. 6, 1942

7

Profile of Axis - 50' South

Sta + H.I - 15 Elev

T.P. 535.92

4.55 540.47

10+00 11.1 529.4

Axis

T.P. 12.54 527.93

1.02 528.95

9+90 4.6 524.3

50' south of axis

T.P. 0.26 516.44 12.77 516.18

9+75 3.2 513.2

9+60 6.2 510.2

9+63 4.7 511.7

50' SOUTH OF AXIS

T.P. 0.08 503.65 12.87 503.57

9+45 7.2 496.4

9+50 2.5 501.2

50 SOUTH OF AXIS

9+14 7.9 495.8

50' SOUTH OF AXIS

T.P. 12.83 490.82

1.79 492.61

Profile of Axis to 50' South

1/6/42
Fair - Warm

Dickinson 8
Jackson
Polak
Laing
Cole

Sta + HI - 15 Elev
49261

9+00 4.8 487.8

50' J of Axis

9+00 27 489.9

Axis

9+14 1.1 491.5

Axis - Cut = 11.5 - Valve Chamber
Pipe Trench

T.P. 241 490.20

9.91 500.11 498.19

T.B.M. 188 498.23

Error = +0.04

1/6/42

9

Levels for East Keyway

Sta	+	HI	-	15	Elev
T.B.M.					498.19
	4.60	502.79			
①			2.79	500.0	
②			7.79	495.0	
③			12.79	490.0	
④			5.8	497.0	
T.B.M.		460			498.19

171' N. of Axis

176' " " "

181' " " "

174' " " "

Temporary Bench Levels

South of Axis - W. Side

1/7/42
Fair - Warm

Dickinson
Jackson
Polak
Laing
King
Cole

10

B.M.			680.35	
	1.65	682.00		
T.B.M. ₁		8.48	673.52	Painted \odot on rock outcrop @
	0.47	673.99		3+09 - approx 30' south of Axis.
T.B.M. ₂		10.85	663.14	Painted \odot on rock outcrop @
	2.40	665.54		3+29 - approx 24' South of Axis
A-14 B.M.		9.40	656.14	El. of Bench Mark = 656.13
	1.00	657.13		
T.B.M. ₃		5.71	656.42	Top of steel pin on \pm Block #1 -
	2.41	653.83		Sta 3+46 - approx 27' S. of Axis
T.B.M. ₄		11.59	642.24	Painted \odot on rock outcrop @
	0.09	642.33		3+80 \pm - approx 98' South of Axis.
A-13 B.M.		13.00	629.33	El. of B.M. = 629.33
	0.86	630.19		
T.B.M. ₅		8.76	621.43	Painted \odot on rock out-crop @
	0.53	621.96		4+291 - approx 94' South of Axis

Temporary Bench Levels

South of Axis - W. side

Sta	+	HI	-	IS	Elev.
		621.96			
T.B.M. 6		12.86		609.10	
	0.44	609.54			
T.P.		12.63		596.91	
	0.69	597.60			
B.M.		5.17		592.43	

621.96

T.B.M. 6

12.86

609.10

0.44 609.54

T.P.

12.63

596.91

0.69 597.60

B.M.

5.17

592.43

1/7/41

Fair - Warm

Dickinson

Jackson

Palak

Laing

King

Cole

11

Painted \odot on rock outcrop @

4+41+ - approx 90 South of Axis

Elevation of B.M. = 592.43

Temporary Bench Levels

South of Axis E. side

11/7/41
Fair - Warm

Jackson
Laing

12

B.M.			523.86
	0.27	524.13	
T.B.M.	12.40		511.73
	1.00	512.73	
T.B.M.	11.07		501.66
	0.48	502.14	
T.B.M.	12.74		489.40
	0.18	489.58	
T.P.	11.27		478.31
	1.28	479.59	
A-1 B.M.	6.96		472.63
<hr/>			
A-1 B.M.			472.63
	6.95	479.58	
T.B.M.	4.35		475.23
	4.24	479.47	
A-1 B.M.	6.84		472.63

El of B.M. = 472.63

Painted white □ South end of
Culvert headwall - along Ramona Rd.

Profile of Axis & 50 S. of Axis
Levels for Wart Keyway

11/8/42
Fair - Cool

Dickinson
Jackson
Palmer
Laing
King
Cole

13

Sta. + H.I. - I.S. Elev.

A-11
B.M.

558.56

3.05 561.61

①		11.61	550.0	11.2' N - 77.7' South of Axis
②		6.61	555.0	74.0' " " "
③		1.61	560.0	70.1' " " "
④		9.61	552.0	11.0' N. of Axis

Profile

5+40		11.9	549.7	Axis
5+05		9.7	551.9	"
5+35		12.0	549.6	50' South of Axis
4+75		4.5	557.1	" " " "
T.P.	1.00		560.61	
	12.95		573.56	
4+78		14.3	559.3	Axis
4+66		12.9	560.7	"
4+60		6.6	567.0	"
4+49		3.0	570.6	"

Profile of Axis & 50'S of Axis
and Levels for W. Keyway

1/8/42
Fair-Cool

Jackson
Polak
Loring
King
Cole

14

Sta + HI - IS Elev.

573.56

⑤ 3.56 570.0 92' N of Axis

⑥ 8.56 565.0 97' " " "

⑦ 0.56 573.0 8.1' " " "

T.P. 0.75 572.81

12.86 585.67

Profile

4+50 6.3 579.4 50' South of Axis

4+40 +0.9 586.6 " " " "

T.P. 1.44 584.23

12.90 597.13

C-2 596.48
TBM 0.64 596.47

Error = -0.01

Levels for Outlet-Trench
& Fillet Line - E. Keyway

1/8/40
Fair-Cool

Dickinson
Jackson
Palak
Laing
King
Cole

15

Sta + HI - I.S. Elev

T.B.M. 260 492.00 489.40

① 7.2 484.8

② 4.4 487.6

③ 4.6 487.4

Fillet Line

① 4.0 488.0

T.B.M. 260 489.40

¢ of outlet-trench

" " " "

" " " "

18.3' North of Axis

(E. Valve 491)

1/9/42

Fair-Cool

Dickinson 16
Jackson
Polak
Laing
King
Cote

± Profile of Adit Tunnel

Sta.	+	H.I.	-	I.S.	Elev.	
T.B.M.					498.19	
7	1.57	499.76				
0+00				128	4870	F=25
0+18				108	4890	F=05
0+35				45	4952	C=57
0+53				12	4985	C=90
0+72				27	4971	C=76
0+79				09	4989	C=94
0+99				64	4934	C=39
T.P.			10.74		489.02	
	0.64	489.64				
1+13				0.14	489.5	Daylight on E. of Adit
1+18				6.5	483.1	
1+35				6.7	482.9	
1+62				1.4	488.2	
1+74				2.7	486.9	
1+88				9.8	479.8	E. edge of Ramona Road

Plotted

1/10/42

Profile of Adit Tunnel

1/9/42
Fair - Warm

Dickinson 17
Jackson
Polak
Laing
King
Cote

Sta. + H.I. - I.S. Elev.

48964

T.P. 9.95 47969

3.49 48318

T.B.M. 12.22 430.97
430.96

Error = 0.01

Levels for W. Keyway

1/9/42

Fair - Warm

Dickinson 18
 Jackson
 Polak
 Laing
 King
 Cole

Sta	+ HI	-	1.5	Elev
A-11				
B.M.				558.56

293 561.49

①			11.49	550.0	77.7' South of Axis
---	--	--	-------	-------	---------------------

②			6.49	555.0	74.0 " " "
---	--	--	------	-------	------------

③			1.49	560.0	70.1 " " "
---	--	--	------	-------	------------

A-11

B.M.

293

558.56

Profile of Adit (to Valve 510)

1/9/41
Fair - Cool

Dickinson
Jackson
Polak
Laing
King
Cole

Sta + H.L. - 1.5 Elev

T.B.M. 48940

1.45 49085

0+00 39 487.0

Axis at Sta. 9+145

0+17 2.2 488.7

Plotted 1/10/42

0+50 1.1 489.8

0+70 1.35 489.5

Daylight on E of Adit

0+82 2.9 489.5

1+35 11.7 479.2

T.B.M. 1.45 48940

Fillet Line - E Keyway

1/10/42
Fair - Warm

Dickinson
Jackson
Polak
Laird
Cole

20

Sta + H.I. - 15 Elev

T.B.M. 475.23

13.05 488.28

3.28 485.0 18.6' N of Axis

13.28 475.0 19.6' " " "

T.B.M. 1305 475.23

Levels on W. Keyway

1/10/42

Fair-Warm

Jackson
Laing
King

21

Sta + H.I. - I.S. Elev.

A-11
B.M. 558.56

2.28 560.84

① 1084 550.0

11.2' N-77.7' South of Axis

T.P. 1261 548.23

1.82 550.05

② 5.05 545.0

11.7' - 81.5' " " "

③ 10.05 540.0

12.2' - 85.4' " " "

T.P. 1293 537.12

2.22 539.34

④ 6.34 533.0

12.9' North of Axis

T.B.M. 320 536.14

3.80 539.94

T.B.M. 1269 527.25

0.39 527.64

A-10
B.M. 12.76 514.88

Elev of B.M. = 514.88

Error = 0.00

1/12/41
Fair-Cool

Dickinson
Jackson
Polak
Loing
King
Cote 22

Elevations for Valve

Chamber & E Keyway

Sta	+ H.I.	- I.S.	Elev.	
T.B.M.			489.40	
	2.56		491.96	
①		3.2	488.8	S.E. cor of Valve Chamber
②		0.0	492.0	N.E. " " " "
T.P.		12.16	479.80	
	2.44		482.24	
③		8.7	473.5	S.W. " " " "
④		8.0	474.2	N.W. " " " "
T.B.M.		6.99	475.25	Fl = 475.23 - Error = +0.02

Fillet Line - E. Keyway

Sta	+	H.I.	-	I.S.	Elev.
A-21					
B.M.					469.19

5.04 474.24

①				8.24	466.0
A-21					
B.M.		5.04			469.19

B.M.					483.61
------	--	--	--	--	--------

0.10 483.71

①				3.71	480.0
---	--	--	--	------	-------

B.M.		0.10			483.61
------	--	------	--	--	--------

1/12/41

Fair - Warm

Dickinson
Jackson
Polak
Laing
King
Cole

23

21.0' North of Axis

19.1' " " " "

E. Side of Trench
Grades for Outlet Trench

1/14/42
Fair-Warm

Dickinson
Jackson

24

Sta + H.I. - 15 Elev

T.B.M. 489.40

1.44 490.84

①

5.3 485.5

C=6°

N. Edge of Valve Chamber

②

5.0 485.8

C=6°

③

5.3 485.5

C=6°

④

7.7 483.1

C=3°

⑤

4.9 485.9

C=6°

⑥

8.5 482.3

C=2°

✓

⑦

5.9 484.9

C=5°

T.B.M.

1.44

489.40

Levels on W. Keyway

1/14/42
Fair-Warm

Jackson
Polak
Laird
King
Cole

25

Sta	+	H.I.	-	I.S.	Elev.		
A-11 B.M.					558.56		
	9.23	567.79					
①				2.79	565.0	9.7'	North of Axis
②				7.79	560.0	10.2'	" " "
③				12.79	555.0	10.7'	" " "
T.B.M.			4.37		563.42		
	0.80	564.22					
T.P.			12.12		552.10		
	10.06	562.16					
④ A-11 B.M.				12.16	550.0	11.2'	" " "
					558.54	Elev of B.M. = 558.56	

Level on F Keyway

1/14/42
Fair - Warm

Dickinson
Jackson
Polak
Laing
King
Cole

26

Sta + HI - IS Elev

T.B.M. 511.52

12.04 523.56

① 3.56 520.0 15.1' North of Axis

② 8.36 515.0 15.6' " " "

T.B.M. 12.04 511.52

1.18 512.70

2.70 510.0 16.1' " " "

7.70 505.0 16.6' " " "

12.70 500.0 17.1' " " "

T.B.M. 1.18 511.52

T.B.M. 483.61

7.55 491.16

① 1.16 490.0 18.1' " " "

6.0 485.2 6.5' on E. side of Outlet trench

T.B.M. 7.55 483.61

1/15/42
Fair-Warm

Dickinson
Jackson
Polak
Laing
King
Cole

27

Levels on W. Keyway

Sta. + H.I. - I.S. Elev

T.B.M. 0.32 563.74 563.42

0.32 563.74

8.74 555.0

74' South of Axis

5.74 558.0

71.7' " " "

1.74 562.0

68.6' " " "

T.P. 12.21 551.53

0.35 551.88

1.88 550.0

77.7' " " " 11.2' N. of Axis

6.88 545.0

81.5' " " " 11.7' " " "

11.88 540.0

85.3' " " " 12.2' North

T.P. 12.63 539.25

0.98 540.23

6.23 534.0

12.8 North of Axis

4.23 536.0

88.4' South " "

T.P. 10.34 529.89

3.28 533.17

T.B.M. 5.92 527.25

El of B.M. = 527.25

Levels for Spillway

1/15/42
Fair - WarmJackson
Polak
Laird
Kimo
Cole

28

sta + H.I. - I.S. Elev.

A-10

B.M.

514.88

0.68 515.56

T.B.M.

12.69

502.87

1.24 504.11

T.B.M.

12.19

491.92

①

13.19 490.0

123.3' S of AXIN - W. Edge of
Spillway

0.35 492.27

T.P.

11.88 480.39

0.03 480.42

T.B.M.

7.73 472.69

0.81 473.50

A-9

B.M.

9.22 464.28

Elev. of B.M. = 464.29

Elevations on E Keyway

1/15/42
Fair - Warm

Jackson
Polak
Laing
King
Cote

30

sta. + H.I. - I.S. Elev

T.B.M. 489.40

9.15 498.55

① 3.55 495.0

119.6' South of Axis (32.3)

② 8.55 490.0

123.3' " " " (28.6)

12.55 486.0

126.4' " " " (25.5)

T.B.M. 9.15 489.40

T.B.M. 483.61

7.90 491.51

① 8.0 483.5

c=35 E side of Outlet Trench

② 7.1 484.4

c=44 " " " " "

③ 6.8 484.7

c=47 " " " " "

T.B.M. 7.90 483.61

Levels on W Keyway

1/17/42
Fair-Cool

Jackson
Polak
Cole

31

Sta + HI - IS E-lev

T.B.M. 527.25

12.5853983

①

4.83 535.0

892' South of Axis

T.B.M. 0.05 539.78

0.43 540.21

T.B.M. 12.96 527.25

E-lev of T.B.M. = 527.25

LEVELS ON EAST SLOPE

JAN 21st

32

Dickinson
Polack
LAING
KING
COLE

Temp					
7 B.M.	8.49	483.72		475.23	
			2.58	481.14	
			2.48	488.00	18.3 North
			4.48	486.0	18.5 "
			7.48	482.0	18.8 "
7 T.P.	0.66	478.86	12.28	478.20	
			2.86	476.0	19.5 North
T.B.M.			3.63	475.23	Elev = 475.23

LEVELS ON WEST SLOPE

JAN. 21

DICKINSON
POLACK

T. B.M.	0.10	563.52		563.42	
			12.68	550.84	
			2.92	548.0	11.4 North
			5.92	545.0	11.7 "
			10.92	540.0	12.2
T.P.			12.64	538.28	
	0.31	538.59			

LEVELS ON WEST SLOPE

JAN 21

DICKINSON
POLACK
LAING

33

538.59

3.59

535.0

12.7 North 4

8.59

530.0

13.2 "

T.P. 5.03 531.15

12.47 526.16

T.BM

3.91 527.24

ELEV. = 527.25

Slope Stakes for Excavation
of outlet trench South of Valve
Chamber

1/22/42
Cool - Cloudy

Dickinson
Jackson
Polak
Laing
King
Cole

34

Sta. + H.I. - I.S. Elev. Cut Fill Out

T.B.M. 48940

7.81 497.21
174'S. Toe Line = 9+245
of AXU

14.1 4.4 128 32

188'S. 10.0 7.2 100 25

208'S. 5.2 120 32

222'S. 7.6 96 24

233'S. 5.6 116 29

T.B.M. 781 48940

0.23 48963
Toe Line 9+045

176'S. 9.6 Grade

205'S. 9.6 Grade

233'S. 8.4 1.2 03

T.B.M. 023 48940

Sub-Grade = 480.0
East Side of Trench

Sub-Grade = 480.0
West Side of Trench

(Sta 9+70 - 7+80)

Profile of 50'S. of Axis

(Eas
Side)

1/22/42

Cool-Cloudy

Jackson

Polak

Laing

King

Cote

35

Sta	+	HI.	IS	Elev
T.B.M				511.52
	3.86	515.38		
9+70			1.8	513.6
9+61			6.0	509.4
9+52			12.8	502.6
T.P.		1275		502.63
	1.34	503.97		
9+50			4.2	499.8
9+42			7.5	496.5
T.P.		1248		496.49
	1.26	492.75		
9+38			3.8	489.0
9+24			12.6	480.2
T.P.		1265		480.19
	0.04	480.14		
8+89			4.6	475.5

1/22/42
Cool - cloudy

Jackson
Polak
Laird
King
Cole

Profile of 50'S of Axis East Side

Sta.	+	H.I.	-	I.S.	Elev.
		480.14			
T.P.			12.96		467.18
	4.62	471.80			
8+62			7.6		464.2
8+45			10.6		461.2
7+93			10.8		461.0
7+80			1.7		470.1

Profile of 100'S of Axis East Side

7+75			3.0		468.8
7+98			11.0		460.8
8+60			11.7		460.1
8+72			5.6		466.2
T.P.			0.20		471.60
	12.38	483.98			
9+04			10.9		473.1

Profile of 100' S of Axis East Side

1/22/42
Warm-Cloudy

Jackson
Dolak
Laing
King
Cole

37

Sta	+ H.I.	- I.S.	Elev
	483.98		
9+13		5.1	478.9
9+34		1.4	482.6
T.P.	0.39		483.59
	10.24		493.83
T.P.	0.89		492.94
	12.82		505.76
9+49		7.1	498.7
T.P.	0.25		505.51
	13.01		518.52
9+64		7.0	511.5
9+79		2.3	516.2
T.B.M.	6.98		511.54

483.98

9+13

5.1 478.9

9+34

1.4 482.6

T.P.

0.39 483.59

10.24 493.83

T.P.

0.89 492.94

12.82 505.76

9+49

7.1 498.7

T.P.

0.25 505.51

13.01 518.52

9+64

7.0 511.5

9+79

2.3 516.2

T.B.M.

6.98 511.54

F.I. of T.B.M. = 511.52

Elevations for Fillet Line

1/23/42
Cool-Cloudy

JACKSON
POLAK
LAING
KING
COLE

38

Sta. + H.I. - I.S. Elev.

T.B.M. 475.23

1.35 476.58

7+85 7.6 469.0

20.7' North of Axis

8+60 5.6 471.0

200 " " "

LEVELS FOR FILLET - West Slope

1-26-42

DICKINSON
KING
COLE

BM 11.43 574.30 - 502.87

TP 4.22 510.67 7.85 506.45

16.1 North

BM 782 502.85 El. 502.87

Levels on W. Keyway

1/28/42
Cool - Cloudy

Dickinson
Jackson
Palak
Laing
King
Cole

39

Sta.	+	H.I.	-	I.S.	Elev	
T.B.M.					542.08	
		2.83			544.91	
①				4.91	540.0	85.3' S. of Axis
②				9.91	535.0	89.1' " " "
T.P.			12.77		532.14	
		0.38			532.52	
③				2.52	530.0	92.9' " " "
④				7.52	525.0	96.7' " " "
⑤				12.52	520.0	100.5' " " "
T.P.			12.76		519.76	
		0.05			519.81	
				7.81	512.0	107.4' " " "
T.P.			13.02		506.79	
		0.98			507.77	
				11.77	496.0	118.8' " " "
T.B.M.		4.92			502.84	EI of T.B.M. = 502.87

Levels on E Keyway

2/2/42
Cool Cloudy

Dickinson
Jackson
Polak
Loing
King
Cote

40

Sta + H.I. - 1.5 Elev

B.M. 464.3

3.57 467.86

T.P. 2.09 465.7

10.97 476.74

① 11.74 465.0

21.2' North of Axis

② 8.74 468.0

20.8' " " "

T.B.M. 1.49 475.23

Levels on
West Abutement

2/5/42
Fair - Warm

41

Sta. + Hl. - I.S. Elev.

T.B.M. 563.42

0.09 563.51

① 3.51 560.0

70.1' South of Axis

② 8.51 555.0

74.0' " " "

T.P. 12.72 550.73

1.08 551.87

③ 1.87 550.0

77.7' " " "

④ 6.87 545.0

81.5' " " "

⑤ 11.87 540.0

85.3' " " "

T.P. 13.07 538.80

2.96 541.76

⑥ 6.76 535.0

89.2' " " "

⑦ 11.76 530.0

93.0' " " "

T.P. 12.99 528.77

3.06 531.83

⑧ 5.83 526.0

96.0' " " "

⑨ 6.83 525.0

96.7' " " "

Levels on West Abutement

2/5/42
Fair-Warm

Sta.	+	H.I.	-	I.S.	Elev.				
		531.83							
⑩				10.83	521.0	99.8'	South of Axis		
T.P.			12.66		519.17				
	1.40	520.57							
⑪				5.57	515.0	104.3	"	"	"
⑫				10.57	510.0	109.1	"	"	"
⑬				0.57	520.0	100.5	"	"	"
T.P.			12.10		508.47				
	0.94	509.41							
⑭				1.41	508.5	109.7	"	"	"
⑮				6.41	503.0	113.5	"	"	"
⑯				9.41	500.0	115.7	"	"	"
⑰				12.41	497.0	118.0	"	"	"
T.P.			12.56		496.85				
	0.43	497.28							
⑱				3.28	494.0				

2/5/42
Fair-Warm

43

Sta.	+	H.I.	-	IS	F/er			
		497.28						
T.P.			12.37		484.91			
	0.57	485.48						
(19)				10.48	475.0	196'	North of Axis	
(20)				5.48	480.0	19.1	" " "	
(21)				0.48	485.0	18.6'	" " "	
T.B.M.			1.87		483.61	483.61		
	1.87	485.48						
T.P.			1.68		483.80			
	12.92	496.72						
(22)				4.7	492.0	17.9'	" " "	
T.P.			0.92		495.80			
	12.54	508.34						
(23)				6.3	502.0	16.9'	" " "	
(24)				2.34	506.0	16.5'	" " "	
T.P.			0.21		508.13			

Levels on West Abutement

2/5/42
Fair - Warm

Sta	+	H.I.	-	I.S.	Elev				
T.P.					508.13				
	12.72	520.85							
(25)				10.85	510.0	16.1'	North of Axis		
(26)				5.85	515.0	15.6'	"	"	
(27)				0.85	520.0	15.1'	"	"	
T.P.			1.17		519.68				
	11.84	531.52							
(28)				6.52	525.0	13.7'	"	"	
(29)				1.52	530.0	13.2'	"	"	
T.P.			1.31		530.21				
	13.02	543.23							
				10.23	533.0	12.0'	"	"	
				5.23	538.0	12.4'	"	"	
T.B.M.			1.17		542.06	542.08			

2/5/42
Fair-Warm

Dickinson
Jackson
Polak
Lairg
King
Cole

Level on East Abutement

Sta + H.I. - I.S. Elev

T.B.M. 511.73

3.89 515.62

① 0.62 515.0 1043' South of Axis

② 5.62 510.0 108.1' " " "

③ 10.62 505.0 112.0' " " "

T.P. 12.25 503.37

1.16 504.53

④ 4.53 500.0 115.7' " " "

⑤ 9.53 495.0 119.6' " " "

T.P. 13.00 491.53

0.76 492.29

⑥ 2.29 490.0 123.3' " " "

⑦ 7.29 485.0 127.1' " " "

⑧ 12.29 480.0 131.0' " " "

T.B.M. 8.78 483.51

STADIA SURVEY - LOCATING

WATER TANK & PIPE LINES

Sta. Stad. Dist. Az Vert Δ

Δ #13 Backsight #14 Δ

POINT "A" 340 212°11' + 9'35"

Δ AT "A" BACKSIGHTING #13 Δ 's Clockwise

Sta.	Stad. Dist.	Az	Vert	Notes
1.	317	153°43'	+21°04'	OUTLET AT WATER TOWER
2.	308	136°27'	+21°29'	
3.	285	149°31'	+19°42'	
4.	313	152°38'	+21°14'	INLET AT WATER TOWER
5.	272	137°10'	+21°02'	
6.	176	144°47'	+17°15'	
7.	94	160°15'	+10°02'	
8.	85	248°15'	-17°30'	
9.	282	154°15'	+18°04'	
10.	293	166°25'	+12°40'	
11.	300	174°	+9°10'	
12.	342	184°08'	+8°	

Feb 9th 46

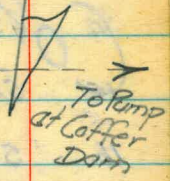
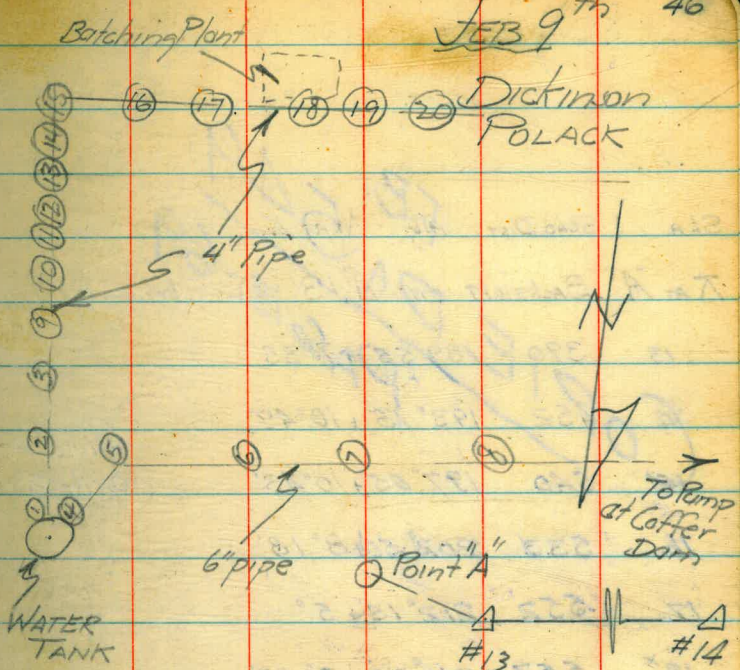

Sta.	Stad. Dist	FB. 549 V. 549 569	Angle	Notes
At "A"	Backsight	13	is Clockwise	
13.	390	189° 50'	+ 2° 35'	
14.	452	193° 18'	+ 10° 49'	
15.	540	197° 05'	+ 10° 43'	Angle Pt. in Outlet Pipe
16.	533	202° 50'	+ 8° 18'	
17.	552	212° 15'	+ 5°	
18. ^x	557	216° 30'	+ 2° 03'	
19.	565	228° 30'	+ 4° 25'	
20.	580	231° 05'	+ 5° 54'	

Levels on West Keyway

2/14/42
Fair-Warm

Jackson
Polak
Cole

48

Sta. + H.I. - I.S. Elev.

T.B.M. 907 511.94 502.85

① 1.94 510.0 108.1' South of Axis

② 6.94 505.0 112.0' " " "

③ 11.94 500.0 115.7' " " "

T.P. 13.05 498.85

0.39 499.28

④ 4.28 495.0 119.6'

⑤ 9.28 490.0 123.3'

T.P. 12.39 486.85

1.63 488.52

12.0 476.5 6+23 Edge of Spillway

10.7 477.8 6+23 N. Edge of Guide Wall

⑥ 3.52 485.0 127.1' South of Axis

⑦ 8.52 480.0 131.0' " " "

Levels on West Keyway

2/14/42
Fair - Warm

49

Sta + H.I. - I.S. Elev

488.52

3.52 485.0

18.6' North of Axis

0.00 488.5

18.2' " " "

T.B.M.

487

483.65

483.63

T.B.M.

475.23

11.14 486.37

①

1.37 485.0

127.1' South of Axis

②

6.37 480.0

131.0' " " "

T.B.M.

11.14

475.23

Leves for Fillet Stakes

3/2/42
Fair - Warm

Jackson
Polak
King
Cole 50

Sta. + H.I. - IS Elev

T.B.M. 362 46546 461.84

① 9.5 4560 22.0' North of Axis

② 10.5 455.0 22.1' " " "

③ 16.5 449.0 22.7' " " "

T.B.M. 362 461.84

3/5/42
Fair - Warm

Jackson
Cole

51

Check Levels on Fillet &

South Face Lines - E. Slope

Sta.	+	H.I.	-	I.S.	Elev.
A-31					
B.M.					663.16

3.21 666.37

① 7.4 6590 Top of Dam

T.P. 13.06 65331

0.11 653.42

② 3.4 6500 22' North & 14' South of Axis

③ 8.4 6450 22' " " 14.0' " "

T.P. 13.07 640.35

0.47 640.82

④ 0.8 6400 27' " " 14.6' " " "

⑤ 5.8 6350 29' " " 16.5' " " "

⑥ 10.8 6300 32' " " 18.9' " " "

T.P. 12.72 628.10

0.38 628.48

Check Levels (cont.)

3/5/42

52

Sta. + H.I. - I.S. Elev. Fair-Warm

62848

3.48 625.00

6.48 620.00

T.P. 1.50 617.07 12.91 615.57

2.07 615.00

7.07 610.00

12.07 605.00

T.

BM

5.37

611.70

Top Rock - South of Keyway

1.05 612.75

I.P. 2.65 603.75 11.65 601.10

A-33

BM.

8.98

594.77

Marked Elev. = 594.72

LEVELS FOR PAINTING DOWNSTR.

SLOPE

March 7 53
Dickinson
King

T. BM	10.48	522.08		511.60		
			2.08	520.0	100.6	Downstream
			7.08	515.0	104.4	" "
			11.08	511.0	107.4	" "
T.P.	1.13	510.42	12.79	509.29		
			5.42	505.0	112.0	" "
			10.42	500.0	115.8	" "
T.P.	0.60	498.54	12.48	497.94		
			3.54	495.0	119.6	" "
			8.54	490.0	123.4	" "
T.P.	0.52	486.40	12.66	485.88		
			1.40	485.0	127.2	
			4.40	482.0	129.4	
			6.40	480.0	131.0	
			11.40	475.0	134.8	
T. BM			11.33	475.07		

MAR 7

T.BM 2.90 477.97

475.07

B.M.

2.71

475.26

Marked E.I. 475.23

DICKINSON
KING

B.M. So. of Keyway on Highway

Levels for Edge of Spillway

0.28	462.12		461.84
		6.0	456.1
		7.6	454.5
		8.7	453.4
		7.9	454.2
10.23	470.83	1.52	460.60
7.73	478.21	0.35	470.48
		2.98	475.23

= 475.23 Marked Rock

6.0
7.6
8.7

Levels For Filled stakes

3-13-42 56
Rogers

T.B.M.	0.4	462.28		461.84	
IP	2.7	451.97	13.05	449.23	
			2.0	450.0	22.7 N. of Axis
			4.0	448.0	22.9 " "
			5.0	447.0	23.2 " "
			6.0	446.0	23.4 " "
			3.0	449.0	22.8 " "
IP	11.31	463.03	0.25	451.78	
T.B.M.			1.18	461.85	check on T.B.M. Above

Elevations for Fillet Line

3-14-42

Rogers
Polak
Cole

57

T.M.	11.83	556.25		544.42	Distance	
			12.25	544.0	11.8	w. of Axis
			11.25	545.0	11.7	" "
			10.25	546.0	11.6	" "
			8.25	548.0	11.4	" "
			6.25	550.0	11.2	" "
			5.2	551.0	11.1	" "
			4.2	552.0	11.0	" "
			2.2	554.0	10.8	" "
T.P.	11.80	567.19	0.86	553.39		
			11.2	556.0	10.6	" "
			9.2	558.0	10.4	" "
			10.2	557.0	10.5	" "
			7.2	560.0	10.2	" "
			5.2	562.0	10.2	" "
			4.2	563.0	9.9	" "

Elevations for Fillet Line (Cont)

3-14-42

58

					Distance
	567.19				
		2.2	565.0		9.7 N. of Axis
		0.2	567.0		9.5 "
T.P.	11.58	577.47	1.30	565.89	
		7.5	570.0		9.2 "
		4.5	573.0		8.1 "
T.P.	5.76	582.26	0.97	576.50	
T.B.M.		1.12	581.14		Marked 581.14

Elevations for Fillet Line

3-20-42

Rogers.
Polak.
Coto
Roberts

59

TBM	1.39	463.28		461.84	Marked Rock
			6.2	457.0	22' W. of Axis
TP	1.57	457.60	12.20	451.03	
			3.6	449.0	22.8 " "
			8.3	444.3	Elev in bottom of cut
TP	11.52	460.17	3.95	448.65	
TP	4.93	463.23	1.87	458.30	
TBM			1.39	461.84	461.84 as above

Elevations For Forms BIK. 2

3-24-42

Papers
calc

60

T.B.M. 8.11 571.58 563.42

T.P. 11.67 582.69 0.51 571.02

11.13 593.40 0.42 582.27

4.90 588.50

2.76 590.64

T.B.M. 9.43 602.68 0.15 598.75

7.63 595.00

6.2 596.5

T.P. 5.05 597.60

5.39 626.82 621.43

T.B.M. 7.24 619.58

T.B.M. 619.58

R. 27 621.85

T.P. 13.02 608.83

0.78 609.61

Revised
 6.59' from Axis to fillet (bottom)
 4.72" to top of Fillet 2.97' from Axis to top of Fillet
 6.03 from Axis to fillet (bottom)
 Grout hole Elevation

0.15

3-24-42

609.61

T.B.M

11.97

597.64

MARKED - 597.63

T.B.M

10.95

598.66

Elevations for Forms Blk 2

3-24-42

Rogers
Cole

62

TBM	1.41	599.05		597.64	
Sta 4+21			10.45	588.60	60' from Axis to fillet (bottom) F 6.90 to fillet
4+08 ³			1.05		588 from Axis to both fillet. F 6.0 to fillet
"			1.05		1.76 from Axis to top of fillet F 12.75 to top fillet
T.P.		1.41		597.64	= 597.64 Above
TBM	11.75	610.41		598.66	
3+96			4.91	605.50	516 from Axis to bot. of fillet F 2.00 to fillet
"			4.53	605.88	154 from Axis to top of fillet. F 13.37 to top fillet
			5.41	605.00	Elev. on Rock at random
			0.41	610.0	" " "
T.P.	12.42	622.04	0.79	609.62	
T.P.			0.28	621.76	
TBM	12.89	632.47	2.46	619.58	= 619.58 Marked Rock

VOID



Elevations for Fillet Line

3-25-42

Rogers 63
 Cole
 Polak
 King
 Roberts

T.B.M. 0.87 462.71 461.84

9.7 455.0 21.7 N of Axis

12

T.P. 0.27 450.85 12.13 450.59

5.8 445.0 23.7 N. of Axis

8.8 442.0 23.5 " "

5.8 440.2 23.2 " "

6.8 444.0 23.3 " "

T.P. 11.63 461.80 0.68 450.17

1.8 460.0 21.7 " "

T.P. 12.49 472.32 1.97 459.83

7.3 465.0

2.3 470.0

T.P. 12.89 483.69 1.52 470.80

8.7 475.0

3.7 480.0

Fillet Line cont'd.

3-25-42.

64

483.69

T.P. 1148 493.93 1.19 482.50

9.0 485.0

40 490.0

T.P. 12.11 502.57 3.52 490.44

10.92 511.77 1.72 500.86

T.B.M. 0.17 511.60 = 511.60 Marked Rock

Elevations for Spillway

3-25-42

T.B.M.	0.77	462.61		461.84	
	3.57	453.83	1235	450.26	
			1.9	451.9	1.1' S. of Spillway Lip
			4.4	449.4	30 " " "
TP	11.30	463.67	151	452.32	
T.B.M.			1.78	461.84	= 461.84 Marked Rock

Elevations for Forms Blk 1

3-25-42

Rogers 66
Cole
Polak
King
Roberts

T.B.M. 1.53 651.08 649.55 Marked Rock

0.74 639.15 12.67 633.41

T.P. 0.18 638.59

12.28 626.31 F 3.69 to top of Pour

8.69 630.0 Top of Lift

~~10.74~~ 627.85

6.43 635.42 9.60 628.91

12.60 622.51

12.36 623.05

T.P. ——— 4.60 630.81

~~3-26-42~~
Marked Rock.

T.B.M. 10.62 632.05 621.43

3-26-42

Blk #1

3+71

5.80 626.25 F 3.75 to of Lift

"

9.03 623.02 F 3.98 to bottom of fillet

"

9.23 622.82 F 9.37 to top of "

3+56

2.17 629.88 F 5.37 to bottom "

"

2.40 629.65 F 10.79 to top "

3+71

9.2 622.3 Elev. to bottom of Copper Waterstop

6.10
20.71
2.69
Top fillet
3.50
9.18
10.74
2.61

Elevations for Form. Bk #1 (Cont'd) 3-26-42

Rogers
Cole 67

632.05

TP 644 637.40 1.09 630.96

2.90 635.00 Elev. marked on Rock.

3+51 582 631.58 F 6.42 to bottom of Fillet

" 567 631.78 F 11.46 to top " "

'Grout Hole
1-37.5

4.4 633.0 Elev. Grout hole Sta 3+58.5

TP 12.75 649.82 0.33 637.07

T.B.M. 0.27 649.55 = 649.55 Marked Rock

Elev. of Grout Hole #

T.B.M. 0.92 462.76 461.84 Marked Rock

Grout Hole
11-23.2

4.8 458.0

T.B.M. 0.92 461.84 check on B.M. above

Elevations at Contraction Joint 3+2 3-26-42

Rogers 68
Cole

TBM	7.54	658.96		651.42	Marked Rock
3+21			6.59	652.37	Elev 7' S. Axis
"			7.64	651.32	" "
			7.96	651.0	" for Paint Line
			3.99	654.97	" 14' S. Axis
Grout Hole #1-12.5			11.33	647.6	" Grout Hole Sta 3+33.5
Grout Hole #0-43			2.8	657.2	" " " " 3+14
TP	5.60	663.42	11.4	657.82	
TBM			0.27	663.15	= 663.14

Elevations for Forms Blk # 2

TBM	0.78	599.44		598.66	Marked Rock	
4+21			9.08	590.36	F 12.06 to Top of Fillet	2.38 N. Axis
"			10.88	588.56	F 6.94 to Bott. of Fillet	5.66 N. Axis
4+11			0.51	598.93	F 4.76 to Top	5.32 N. Axis
"			1.90	597.54	F 13.80 to Bottom	2.04 N. "
4+21			8.6	590.8	Elev. to bottom of Copper water stop	
			4.07	595.47		
TBM	11.36	610.02	0.78	598.66	Above BM	
			5.02	605.0	Contour Paint Line	(610 Elev)
			7.02	603.00	F 7.0 to Top of Lift	32.15 S. of Axis
			+0.22	610.24	F 4.76 to 615 Elev.	28.35 S. of Axis
4+01			6.72	603.30	F 5.80 to Bottom of Fillet	4.98 N. Axis
			8.03	601.99	F 14.03 to Top	1.70 N. "120
TBM		11.36		598.66	As above	

Elevations for Forms Bk #3

3-27-42

Rogers
Blak
Cole
King
Roberts
Foster

70

T.B.M.	+	H1			
				563.02	
4771	6.71	570.13	11.3	558.8	Elev. to Bottom of Copper stop
4771			10.17	559.96	F 4.34 to Bott of Fillet 9.25' N. Axis
"			11.36	558.97	F 13.96 " Top " 5.23 N. "
"			5.65	564.48	Downstream Intersection 66.75' S. Axis
4761			6.07	569.06	F 6.34' to Bottom of Fillet 9.14 N. Axis
			8.85	561.28	F 17.55 to Top " 4.62 N. "
			5.13	565.0	Contour Paint Line on keway
TP ₁		1.04		569.09	
Grout Hole # 3-37 ^E			5.0	565.1	Elev. Grout Hole
TP	12.45	581.54		569.09	Above TP
			11.54	570.0	Paint Line
451			12.56	568.98	F 15.95 to Top of Fillet 4.01 N. Axis
"			10.06	571.98	F 5.02 to Bott. " 8.53 N. Axis
7741			9.84	576.70	F 5.90 to " " 3.40 " "
"			5.49	576.05	F 14.98 to Top " 7.92 " "
			11.54	570.00	D.S. intersection 62.55 S. Axis

Elevations for Forms Blk #3 (Cont'd)

3-27-42

71

581.54

TP 0.67 570.24 11.97 569.57

2.91 567.33

F 7.67' to Elev. 575.0 58.75 S. of Axis.

T.B. 17, 6.81 573 563.43

= 563.42 Marked Rock

Elev. for Forms Blk 4

March 30-42

Rogers
Cole 72
Polak
King
Roberts
Foster.

~~12.62 632.20~~

~~Grade Grad Rod~~

~~619.58~~

Marked Rock

640.44

8.24

T.B.M.

11.53 523.13

511.60

9.64 532.19 0.58

522.55

5+21

4.6

527.6

Elev. of Bottom of Copper Water stop.

"

4.57

529.63

F 19.31 to top of Filled 7.81' N. "

11.69 542.97 0.91

531.28

5+21

10.76

532.21

F 6.29 to Bottom of Filled 12.33' N. "

6.24

536.73

Intersection Downstream 87.84' S. "

6.70

536.21

F 7.23 to Both Filled 11.78' N. "

9.71

533.26

F 19.17 to top " 7.26' N. "

T.P.

12.98 555.34 0.11

542.86

Painted Point on Rock

9.60 564.46 0.98

554.86

T.B.M.

0.99

563.49

= 563.42 Painted Rock

check Levels from Previous Page

March 30-42

73

T.B.M.	0.90	564.32		563.42	
TP	1.47	553.24	12.55	551.79	
TP	0.58	543.40	10.42	542.82	Painted Rock.
	1.67	532.05	13.02	530.38	
	0.62	521.40	11.27	520.98	
T.B.M.	0.93	512.48	9.85	511.55	= 511.60 Described P. 72
	0.22	504.09	8.61	503.87	
	12.38	504.71	11.76	492.33	
T.B.M.			1.89	502.82	= 502.87

T.B.M

498.16 - 498.19

3.29 501.45

486.0

Av. S.

5.6

C=15.8

1st

South

3.8

C=17.6

2nd

South

2.8

C=18.6

3rd

South

5.4

C=16.2

4th

South

7.6

C=19.8

T.P.

0.32

501.13

12.33 513.46

5th

South

11.1

C=22.6

T.P.

1.67

511.79

12.49 524.28

3.12

523.83 523.86

DETAIL OF VALVE CHAMBER

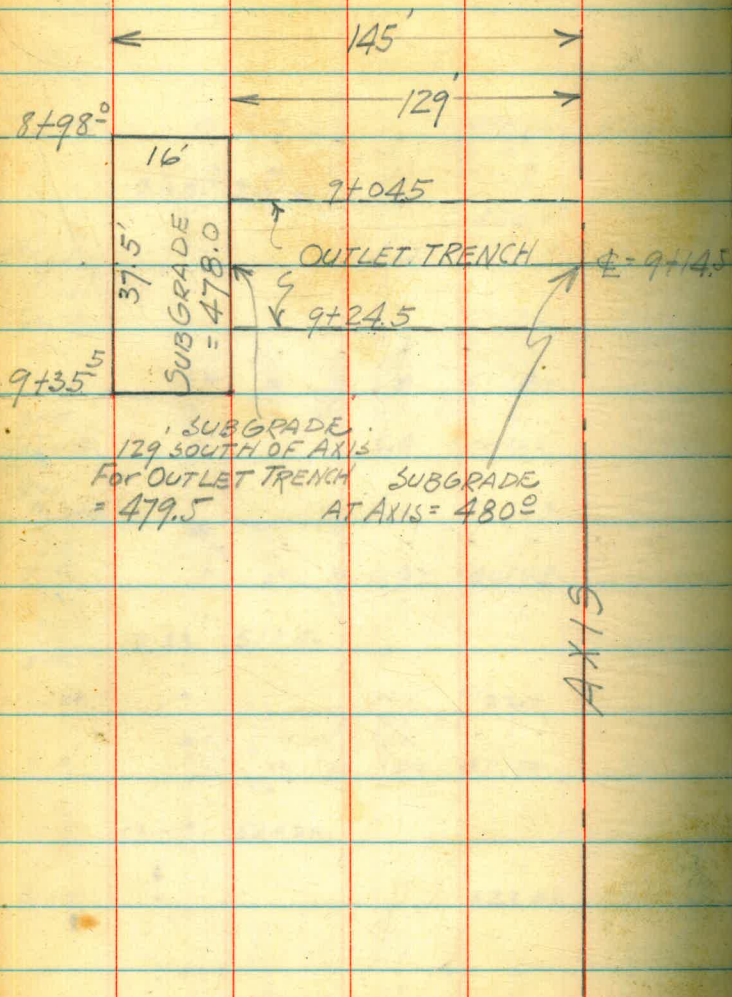

29
 16
 60
 105
 35
 70.16

37.5
 21
 16.5

9+94.5
 8+98
 16.5

T.B.17

489.40 E1

2.67 492.07

- ① 12.3 S.W. Cor 479.8
- ② 8.3 N.W. Cor 483.8
- ③ 6.7 E. Trench 485.4
- ④ 2.7 489.4

9+14.5
 8+98
 16.5

DETAIL OF VALVE CHAMBER

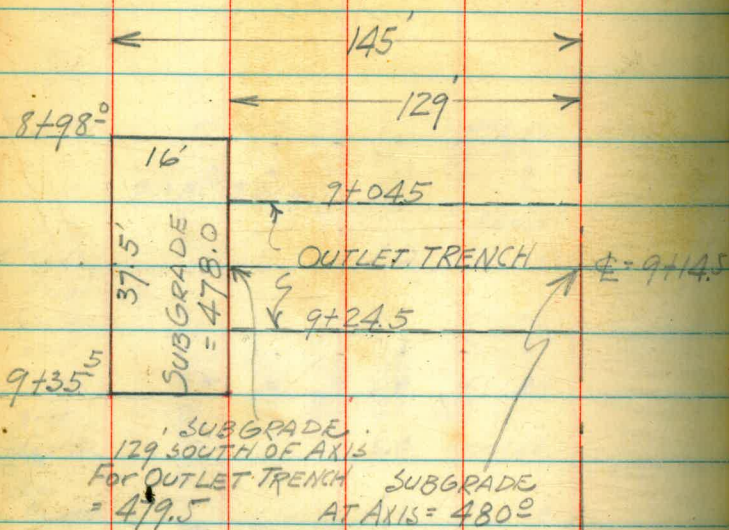

29
 16
 60
 105
 35
 70.16

37.5
 21
 16.5

974.5
 878
 165

T.B.M

489.40 E.I.

2.67 492.07

- ① 12.3 S.W. Cor 479.8
- ② 8.3 N.W. Cor 483.8
- ③ 6.7 E. Trench 485.4
- ④ 2.7 489.4

9+14.5
 8+98
 16.5

6+

46.5
115
350

F.BM 057 449.2

449.3

Hole # 10-31

5.5

444.4

Hole # 10-11.5

7.8

442.1

7+14.0
46.5

5
7.5
6+ 11.6
97+60.5

11.6
48.9

7+14.0
11.6
5.6

7+14.0
11.6
2.4

8+70
46.5
7+60.5
115
720

8+70
115

On Axis Jtd. 7+95.5

On Axis Jtd 7+72.0

8+07.0
7+95.5
46.5
11.5
350

7+60.5

46.5
11.6
4.9

502.87
1143

51430
785

506.45
422

570.67

570.67
0287
78.0

9
7+372
103
61342

51160
1048

52208
1279

509.29

7+072
103
61042

0.75 from 4594

R.P. on Line 50 North

2x2 Hub Sta 9+43.7

971
 895
 76
 508.17
 99
 98.22

Mr. Walsten | No. side of
 | Bowoy Rd. to
 Mr. Bachelder | Mt. Woodrin
 | whitehouse 1 mi. west of
 | Ramona

Bernice Mkt
 Ramona

157.90
 948.54
 60.316
 7. B.M. 483.61
 7-7470
 623
 75120
 440 = 237

1519

TRIGONOMETRIC FORMULÆ

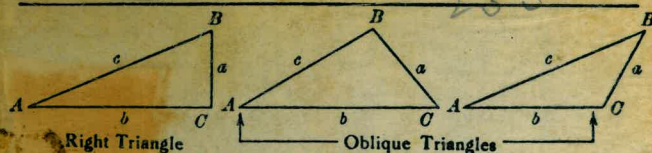

Solution of Right Triangles

For Angle A: $\sin = \frac{a}{c}$, $\cos = \frac{b}{c}$, $\tan = \frac{a}{b}$, $\cot = \frac{b}{a}$, $\sec = \frac{c}{a}$, $\text{cosec} = \frac{c}{b}$

Given	Required	Formula
a, b	A, B, c	$\tan A = \frac{a}{b} = \cot B$, $c = \sqrt{a^2 + b^2} = a \sqrt{1 + \frac{b^2}{a^2}}$
a, c	A, B, b	$\sin A = \frac{a}{c} = \cos B$, $b = \sqrt{(c+a)(c-a)} = c \sqrt{1 - \frac{a^2}{c^2}}$
A, a	B, b, c	$B = 90^\circ - A$, $b = a \cot A$, $c = \frac{a}{\sin A}$
A, b	B, a, c	$B = 90^\circ - A$, $a = b \tan A$, $c = \frac{b}{\cos A}$
A, c	B, a, b	$B = 90^\circ - A$, $a = c \sin A$, $b = c \cos A$

Solution of Oblique Triangles

Given	Required	Formula
A, B, a	b, c, C	$b = \frac{a \sin B}{\sin A}$, $C = 180^\circ - (A + B)$, $c = \frac{a \sin C}{\sin A}$
A, a, b	B, c, C	$\sin B = \frac{b \sin A}{a}$, $C = 180^\circ - (A + B)$, $c = \frac{a \sin C}{\sin A}$
a, b, C	A, B, c	$A + B = 180^\circ - C$, $\tan \frac{1}{2}(A - B) = \frac{(a - b) \tan \frac{1}{2}(A + B)}{a + b}$ $c = \frac{a \sin C}{\sin A}$
a, b, c	A, B, C	$s = \frac{a + b + c}{2}$, $\sin \frac{1}{2}A = \sqrt{\frac{(s - b)(s - c)}{bc}}$ $\sin \frac{1}{2}B = \sqrt{\frac{(s - a)(s - c)}{ac}}$, $C = 180^\circ - (A + B)$
a, b, c	Area	$s = \frac{a + b + c}{2}$, $\text{area} = \sqrt{s(s - a)(s - b)(s - c)}$
A, b, c	Area	$\text{area} = \frac{bc \sin A}{2}$
A, B, C, a	Area	$\text{area} = \frac{a^2 \sin B \sin C}{2 \sin A}$

REDUCTION TO HORIZONTAL



Horizontal distance = Slope distance multiplied by the cosine of the vertical angle. Thus: slope distance = 319.4 ft. Vert. angle = 5° 10'. From Table, Page IX, $\cos 5^\circ 10' = .9959$. Horizontal distance = $319.4 \times .9959 = 318.09$ ft.
 Horizontal distance also = Slope distance minus slope distance times (1 - cosine of vertical angle). With the same figures as in the preceding example, the following result is obtained. $\text{Cosine } 5^\circ 10' = .9959$. $1 - .9959 = .0041$. $319.4 \times .0041 = 1.31$. $319.4 - 1.31 = 318.09$ ft.

When the rise is known, the horizontal distance is approximately:—the slope distance less the square of the rise divided by twice the slope distance. Thus: rise = 14 ft. slope distance = 302.6 ft. Horizontal distance = $302.6 - \frac{14 \times 14}{2 \times 302.6} = 302.6 - 0.32 = 302.28$ ft.