

MICROFILMED

JAN 14 1963  
10.7

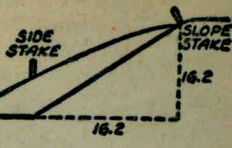

DISTANCES FROM SIDE STAKES FOR CROSS-SECTIONING  
SLOPE 1 TO 1. ROADWAY OF ANY WIDTH

	0	.1	.2	.3	.4	.5	.6	.7	.8	0	
0	0.00	0.10	0.20	0.30	0.40	0.50	0.60	0.70	0.80	0.90	0
1	1.00	1.10	1.20	1.30	1.40	1.50	1.60	1.70	1.80	1.90	1
2	2.00	2.10	2.20	2.30	2.40	2.50	2.60	2.70	2.80	2.90	2
3	3.00	3.10	3.20	3.30	3.40	3.50	3.60	3.70	3.80	3.90	3
4	4.00	4.10	4.20	4.30	4.40	4.50	4.60	4.70	4.80	4.90	4
5	5.00	5.10	5.20	5.30	5.40	5.50	5.60	5.70	5.80	5.90	5
6	6.00	6.10	6.20	6.30	6.40	6.50	6.60	6.70	6.80	6.90	6
7	7.00	7.10	7.20	7.30	7.40	7.50	7.60	7.70	7.80	7.90	7
8	8.00	8.10	8.20	8.30	8.40	8.50	8.60	8.70	8.80	8.90	8
9	9.00	9.10	9.20	9.30	9.40	9.50	9.60	9.70	9.80	9.90	9
10	10.00	10.10	10.20	10.30	10.40	10.50	10.60	10.70	10.80	10.90	10
11	11.00	11.10	11.20	11.30	11.40	11.50	11.60	11.70	11.80	11.90	11
12	12.00	12.10	12.20	12.30	12.40	12.50	12.60	12.70	12.80	12.90	12
13	13.00	13.10	13.20	13.30	13.40	13.50	13.60	13.70	13.80	13.90	13
14	14.00	14.10	14.20	14.30	14.40	14.50	14.60	14.70	14.80	14.90	14
15	15.00	15.10	15.20	15.30	15.40	15.50	15.60	15.70	15.80	15.90	15
16	16.00	16.10	16.20	16.30	16.40	16.50	16.60	16.70	16.80	16.90	16
17	17.00	17.10	17.20	17.30	17.40	17.50	17.60	17.70	17.80	17.90	17
18	18.00	18.10	18.20	18.30	18.40	18.50	18.60	18.70	18.80	18.90	18
19	19.00	19.10	19.20	19.30	19.40	19.50	19.60	19.70	19.80	19.90	19
20	20.00	20.10	20.20	20.30	20.40	20.50	20.60	20.70	20.80	20.90	20
21	21.00	21.10	21.20	21.30	21.40	21.50	21.60	21.70	21.80	21.90	21
22	22.00	22.10	22.20	22.30	22.40	22.50	22.60	22.70	22.80	22.90	22
23	23.00	23.10	23.20	23.30	23.40	23.50	23.60	23.70	23.80	23.90	23
24	24.00	24.10	24.20	24.30	24.40	24.50	24.60	24.70	24.80	24.90	24
25	25.00	25.10	25.20	25.30	25.40	25.50	25.60	25.70	25.80	25.90	25
26	26.00	26.10	26.20	26.30	26.40	26.50	26.60	26.70	26.80	26.90	26
27	27.00	27.10	27.20	27.30	27.40	27.50	27.60	27.70	27.80	27.90	27
28	28.00	28.10	28.20	28.30	28.40	28.50	28.60	28.70	28.80	28.90	28
29	29.00	29.10	29.20	29.30	29.40	29.50	29.60	29.70	29.80	29.90	29
30	30.00	30.10	30.20	30.30	30.40	30.50	30.60	30.70	30.80	30.90	30
31	31.00	31.10	31.20	31.30	31.40	31.50	31.60	31.70	31.80	31.90	31
32	32.00	32.10	32.20	32.30	32.40	32.50	32.60	32.70	32.80	32.90	32
33	33.00	33.10	33.20	33.30	33.40	33.50	33.60	33.70	33.80	33.90	33
34	34.00	34.10	34.20	34.30	34.40	34.50	34.60	34.70	34.80	34.90	34
35	35.00	35.10	35.20	35.30	35.40	35.50	35.60	35.70	35.80	35.90	35
36	36.00	36.10	36.20	36.30	36.40	36.50	36.60	36.70	36.80	36.90	36
37	37.00	37.10	37.20	37.30	37.40	37.50	37.60	37.70	37.80	37.90	37
38	38.00	38.10	38.20	38.30	38.40	38.50	38.60	38.70	38.80	38.90	38
39	39.00	39.10	39.20	39.30	39.40	39.50	39.60	39.70	39.80	39.90	39
40	40.00	40.10	40.20	40.30	40.40	40.50	40.60	40.70	40.80	40.90	40
41	41.00	41.10	41.20	41.30	41.40	41.50	41.60	41.70	41.80	41.90	41
42	42.00	42.10	42.20	42.30	42.40	42.50	42.60	42.70	42.80	42.90	42
43	43.00	43.10	43.20	43.30	43.40	43.50	43.60	43.70	43.80	43.90	43
44	44.00	44.10	44.20	44.30	44.40	44.50	44.60	44.70	44.80	44.90	44
45	45.00	45.10	45.20	45.30	45.40	45.50	45.60	45.70	45.80	45.90	45
46	46.00	46.10	46.20	46.30	46.40	46.50	46.60	46.70	46.80	46.90	46
47	47.00	47.10	47.20	47.30	47.40	47.50	47.60	47.70	47.80	47.90	47
48	48.00	48.10	48.20	48.30	48.40	48.50	48.60	48.70	48.80	48.90	48
49	49.00	49.10	49.20	49.30	49.40	49.50	49.60	49.70	49.80	49.90	49
50	50.00	50.10	50.20	50.30	50.40	50.50	50.60	50.70	50.80	50.90	50

Distance of slope stake from side or shoulder stake for any width roadway, slope 1 to 1. If ground is nearly level, the cut or fill at side stake entry is located by the double entry method in left column and top row. The number in body of table in same row and column gives distance from side stake to slope stake. If ground is not level estimate the difference in elevation between the side stake and slope stake, lower target by this amount if cut, elevate if fill. Add this amount to cut or fill and find distance in table. Set up rod at this point, and line of sight should cut target. If it does not make the slight adjustment necessary.

Book # 775

Please Return to  
City of San Diego Water Dept.  
Room 903 Civic Center



Table XIII - Characteristics of T. ... and Extractions

These characteristics are given in the ... of the ... of ...

Table with multiple columns and rows, containing faint data entries. The table is organized into several vertical sections by red lines.

Table with multiple columns and rows, containing faint data entries. The table is organized into several vertical sections by red lines.

May 9, 1949

BEATTY  
BAKER  
ROGERS

2

E PROFILE & X-SECTIONS  
BAYVIEW - ELECTRIC AVE PIPELINE  
CONNECTING

STATION	* B.C	H.I	- F.S	Elev.	
P.N.	12.60	456.54		443.94	} CONC. MAN. NEAR RADIO ANTENNA Solead Road
H. Rock	0.67	<del>471.07</del>	11.82	<del>458.47</del>	
		459.92		444.72	
0+17 <sup>13</sup>		455.39			
		BEGINNING OF PIPELINE			
+50			1.7	443.7	
1+00			3.5		
1+37 <sup>13</sup>			6.5		
1+50			9.2		
+61			12.9		
H. Rock	0.13	432.82	12.70	432.69	
		<del>449.35</del>		<del>447.22</del>	
+88			3.4		
2+00			7.0		
+18			12.5		
H. Rock	0.74	421.39	12.17	420.65	
		<del>435.92</del>		<del>435.18</del>	
+50			8.5		
3+00			15.8		
H. Rock	0.12	423.34	12.70	422.22	
		408.81		408.69	

NOTE:-

See page 6 for X-Sections. Revised 5/10/49

458.47  
443.94  
14.53

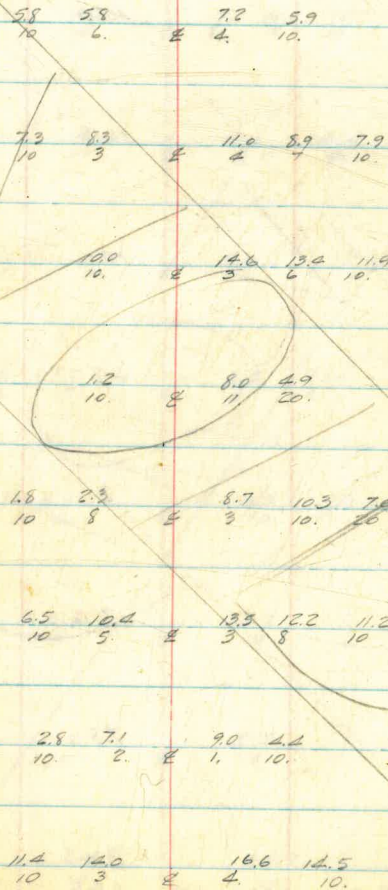

Connecting  
Bayview - Electric Ave Pipeline

5/9/49

3.

	<del>123.34</del> 408.81		
3+11		4.7	
+23		3.7	
+50		10.0	
+72		16.8	
+83 <sup>70</sup>		12.1	
4+00		6.8	
+23		3.7	
+50		7.6	
+66		7.8	
+78		3.4	
W	9.98	431.67	1.65
		417.12	<del>421.69</del> 407.16

+0.1	10	6.3	8.1	6.1	2.9
		1	5	8	12
+1.2	10	9.8	8.3		
		12	17		
6.5	10	14.1	14.1	12.5	
		8	9	12	
12.0	10	16.0	14.4	7.8	
		2	4	10	
15.9	10	8.6			
		10			
12.8	15	9.7	3.5	2.0	
		9	8	10	
8.0	10	0.7			
		10			
11.8	10	2.7			
		10			
11.2	10	5.5			
		10			
2.5	10	+0.9			
		10			

5/9/29

4.

CONNECTING  
Bayview - ~~Electric~~ Ave  
& Profile & X-Sections

+83.  $\frac{431.67}{417.14}$  6.4

5+00 VOID 3.2

(Continue from page 7)

5+13.43 ~~2.55~~ 0.8 416.3 ✓

+50 3.4 416.7

6+00 11.4 405.7

+50 12.1 405.0

7D Top str. 1.21 406.91 ✓  
421.44 11.44 405.70 ✓  
~~420.73~~

7+00 6.4 400.5

+25 8.8 398.1

+50 7.1 397.8

8.5  
10. 23  
10.

5.2  
10. 1.2  
10.

3.6  
10. 1.6  
10.

404.6 410.2 415.8 419.4 ✓  
15.4 12.1 10.4 6.5 1.3 +2.3  
30 29 21 10. 10. 30

15.4 15.8 14.3 8.8 3.6 ✓  
30 19 10 10 30

398.5 402.1 405.0 408.2 413.9 ✓  
23.4 18.8 15.5 15.0 8.9 2.2  
37 24 13 10 10 30

18.0 15.2 10.7 8.4 3.4 1.1 +2.6 ✓  
30 25 15 8 10 17 30

22.0 16.8 12.1 10.5 5.2 0.2 ✓  
30 19 15 7 10 30

21.1 387.8 392.3 396.4 397.8 400.6 406.1 ✓  
30 25 15 5 10 10 30

CONNECTING  
Bayview-Electric Ave E Profile & X-Sections.

+69 ~~421.44~~  
406.91 10.0 396.9

8+00 11.8 395.1  
H 0.76 ~~394.78~~  
~~409.31~~ 12.89 394.02  
408.55

+50 2.3 392.5

9+00 3.8 391.0

+50 8.7 386.1

10+00 13.3 381.5

H rock 13.07 ~~381.71~~  
~~396.24~~

(Continue on page 7.)

428  
393  
3.3

5/9/29

5.

22.0 19.4 15.5 11.2 6.6 3.5 1.7  
30 23 15 5 10 22 30 ✓

22.6 15.2 8.2 6.8 2.2  
30 10 10 14 30 ✓

380.8 387.7  
17.8 14.0 7.1 392.5 393.3 393.8 401.7  
30 23 11 2 10 +6.9  
30 ✓

18.1 15.1 9.4 5.2 1.2 +3.1  
30 25 15 5 10 30 ✓

371.6 373.4 381.1 385.8 386.1 388.9 393.8  
23.2 21.4 13.7 9.0 5.9 1.0  
30 27 13 1 10 30 ✓

31.5 23.5 18.5 17.0 10.0 7.0 5.0  
30 19 12 10 10 23 30 ✓



MAY 10, 1929

6.

IP (Rock)	12.09	444.78 ✓ <del>459.31</del>		432.69 <del>447.22</del>	(See pg. 2)
SET TOM.			0.46	<del>458.85</del>	
0-25 33	Beginning of Pipeline at Reservoir		0.5	444.3	

0+00 1.0 443.8

0+50 2.6 442.2

0+94.49 5.8 439.0

1+00 7.3 437.5

+10 8.9 435.9

+20 12.4 432.4

IP (Rock)	1.51	432.20 ✓ <del>448.73</del>	12.09	432.69 ✓ <del>447.22</del>
-----------	------	-------------------------------	-------	-------------------------------

1+34<sup>38.45</sup> (2 PT.) B.C. 3.8 430.4

+50 11.3 422.9

+65 13.0 421.2

IP (Rock)	6.28	428.09 ✓ <del>435.34</del>	12.39	421.81 ✓ <del>435.34</del>
-----------	------	-------------------------------	-------	-------------------------------

2+00 17.7 420.4

+37 9.6 418.5

+50 12.0 416.1

+58 14.4 413.7

+78 26.2 401.9 ✓

+81 27.8 400.3

+83 } Bottom of gully 27.8 400.3

3.5 5.5 6.4 7.6 6.0 4.4  
30 16 3 4 13 30.

(Section (R) To Back Tonn) +3.0 +0.9 0.5 2.7 4.6 7.2 8.3 5.7 0.0  
30 19 15 4 8 13 17 30.

1.3 2.8 9.8 12.4 11.1 5.7 3.1  
30 21 10 5 6 19 30

6.2 12.6 15.1 10.4 5.1 0.0 +0.5 +3.2  
30 18 15 7 6 18 21 30

15.6 23.6 23.4 16.5 14.5 9.5 6.5 6.0  
40 30 25 13 8 10 20 30

23.7 25.0 30.5 29.3 27.0 25.0  
40 30 23 16 10 30

SEE PG. 22



	382.06		
11+00		8.2	373.9
+23		14.0	368.0
+37		18.7	363.4
+38		19.5	362.6
+40		19.7	362.4
+41		18.8	363.3
11+50		18.1	363.0
+75		2.5	379.6
+75		6.0	376.1
+77		6.0	376.1
+78		2.2	379.9
12+00		14.9	367.2
+05 <sup>57</sup> (BC)		15.0	367.1
+22		14.5	367.6
+50		12.7	369.4
IP (Back)	0.81	371.27	11.60 370.46
+75		2.1	369.2
13+00		3.5	367.8
+04		3.7	367.6

374.00 — 11+~~40~~ ✓

365.4<sup>94</sup> — 11+32

362.5<sup>115</sup> — 11+40

364.1 — 11+50

366.1 — 11+74

362.8 — 11+75

362.8 — 11+77

366.7 — 11+78

367.6 — 12+00 ✓

367.6<sup>94</sup> — 12+20

369.9 — 12+30

Run by Beatty  
w/hand level  
19 May 49.

11.4 6.7 3.2 2.2 3.7 3.9 1.4  
30 7 1 3 1.3 23 26  
20.

	382.06		
11 + 00		8.2	373.9
+ 23		14.0	368.0
+ 37		18.7	363.4
+ 38		19.5	362.6
+ 40		19.7	362.4
+ 41		18.8	363.3
11 + 50		18.1	363.0
+ 75		2.5	379.6
+ 75		6.0	376.1
+ 77		6.0	376.1
+ 78		2.2	379.9
12 + 00		14.9	367.2
+ 05 57 (BC)		15.0	367.1
+ 22		14.5	367.6
+ 50		12.7	369.4
P (Rock)	0.81	371.27	11.60 370.46
+ 75		2.1	369.2
12 + 00		3.5	367.8
+ 04		3.7	367.6

365.0  
17.1  
35

368.7  
13.4  
24

371.8  
10.3  
13

372.9  
4.8  
17

377.3  
4.7  
27

377.4  
30  
30

23.7 23.2 24.4 23.8 22.7  
30 21.5 21 17.3 17

9.7  
30

361.5  
20.2 20.6  
30 28

367.2  
8.5  
30

20.8  
35

8.6 8.6 10.0 9.5 9.8  
12 14 17 29 29  
2.00

359.9  
11.4  
30

364.6  
6.7  
7

367.8  
3.2  
3

367.1  
4.2  
3

367.4  
3.9 1.4  
1.3 23 26  
20

MAY 11, 1949 9.  
13,

	371.27		
13+25		6.8	364.5
+50		9.3	362.0
+92 <sup>06</sup> E.C		12.8	358.5
14+00		13.3	358.0
Set TBM	1.51	364.38 <sup>✓</sup>	8.40 362.87 <sup>✓</sup>
			NAIL IN TEL. POLE #277716-H
+08		6.3	358.1
+50		11.4	353.0
15+00		16.1	348.3
TP	0.24	352.87 <sup>✓</sup>	11.75 352.63 <sup>✓</sup>
			NAIL IN GUY. POLE FOR 5310
+30		5.7	347.2
+50		4.6	348.3
16+00		8.4	344.5
+50		12.5	340.4
TP (Rock)	0.58	340.51 <sup>✓</sup>	12.94 339.93 <sup>✓</sup>
+54		0.5	340.0
+55		6.5	334.0
+56		6.6	333.9
+57		0.8	339.7

20.3 16.6 12.6 8.7 9.4  
35 28 13 4 3

9.1 9.5 5.7  
7 16 18  
ERD

21.1 14.7 12.6  
33 7 1

13.3 13.6 9.8  
9 19 21  
ERD

22.9 18.9 15.0 12.2  
30 26 17 3

8.8 9.8 9.6 10.0 6.5  
4 6 15 24 27  
ERD

26.3 21.1 17.3  
30 15 6

12.2 12.8 12.6 12.7 10.3  
11 13 21 30 32

15.2 10.2  
30 20

2.7 4.1 3.9 2.1  
12 15 23 32  
ERD

12.3 11.7  
31 25

7.6 6.4 8.1 7.7 8.2  
9 14 17 26 36  
ERD

		340.51		
16 +73			2.5	338.0
+75			1.9	338.6
17 +00			2.7	337.8
+37			3.8	336.7
7 +46			5.3	335.2
+50			5.4	335.1
18 +00			7.5	333.0
+50			9.8	330.7
+56.47 BC.			10.1	330.4
19 +00			12.0	328.5
H. (Peak)	0.70	328.73	12.48	328.03 ✓
+50			2.4	326.3
19 + 87.86 BK EC 19 + 37.86 Ah	} Equa. (50' Added) - * ? ! ? *		4.4	324.3
19 + 50			5.1	323.6
20 + 00			7.7	321.0
+16.12 X PT			8.6	320.1
+38 E RD			8.5	320.2
+44			9.4	319.3

Add 50' to all stations  
from here to end of line

1.5  
10    0.9  
5    2.4  
3    C    2.4  
8 E RD

3.4  
10    3.6  
2    C    4.8  
8 E RD

6.0  
10    6.4  
2    C    7.2  
10 E RD

RT BK. Tan

7.0  
10    7.2  
2.5    8.6  
1    C    7.9  
12

No changes made - Add 50' to stations

		328.73			322.06		
20 +45		8.7	320.0		26+50	4.7	317.4
20+76 <sup>10</sup> & PT		10.0	318.7		27+00	4.6	317.5
21+00		10.2	318.5	..	+50	5.1	317.0
+50		10.9	317.8	..	SET TOM	5.08	316.98
22+00		11.1	317.6	..	28+00	8.3	313.8
+50		11.9	316.8	...	+50	12.5	309.6
TP	6.20	322.06	12.87	315.86	TP Top Sta	0.28	310.77
+60		5.6	316.5	..	29+00	4.5	306.3
23+00		8.0	314.1	..	+50	7.4	303.4
+50		9.9	312.2	..	+88	9.2	301.6
24+00		10.2	311.9	..	30+00	10.2	300.6
+50		10.4	311.7	..	+225 N.GED	11.2	299.6
+85		9.6	312.5	..	+225 TOP 4" PIPE	11.29	299.3
+89		10.3	311.8	..	+50	12.9	297.9
25+00		9.1	313.0	..	TP	2.62	300.66
+50		5.5	316.6	..	31+00	5.3	295.4
+69		4.6	317.5	..	+50 <sup>44</sup> & PT	6.8	293.9
26+00		4.9	317.2	..	+60	7.0	293.7
+36 <sup>80</sup> & PT		5.3	316.8	..	+63	7.4	293.3
					+81	6.7	294.0

ON CONC MARK  
 30' PT  
 27+721

Nail in Pe. Pal  
 5' 28+82  
 5203 500'

May 13, 1949 12.

No changes made - Add 50' to stations

300.66

32+00		6.2	294.5
+10 <sup>60</sup>	2 PT.	6.2	294.5
+43 <sup>60</sup>	B.C.	5.6	295.1
+50		5.4	295.3
+69		5.1	295.6
+77		4.5	296.2
33+00		3.9	296.8
+50		2.5	298.2
34+00	(Pole Pole 12 RT.)	2.8	297.9
①	6.26 304.23	2.69	297.97
+12		6.3	297.9
+22		4.3	299.9
+28		5.3	298.9
+37		6.2	298.0
+50		6.8	297.4

5.8 6.0 5.7  
12 7 3 0 7.1 7.7 7.7  
6 8 15

4.7 2.7 3.2  
15 8 3 0 7.9 8.0  
9 15

4.8 2.8 2.6  
15 10 5 0 7.7 8.2 8.1  
6 10 15

5.0 5.3 5.6  
10 8 3 0 8.2 8.4  
7 15

5.2 5.7  
12 4 0 8.5 8.6  
5 10

Greenhouse  
Dirt & Compo  
Pile



MAY 13, 1949 13.

No changes made - Add 50' to stations

34+68		304.23	8.6	295.6
35+00			9.2	295.0
+50			9.9	294.3
35+99.25 (P.C.C.)			10.6	293.6
+50			11.0	293.2
37+00			10.9	293.3
+50			9.0	295.2
38+00			4.4	299.8
+10			3.1	301.1
39	10.85	310.73 ✓	4.35	299.88 ✓
+51.86 EC			6.7	304.0
+78			5.2	305.5
39+00			4.4	306.3
+14			4.1	306.6
+27			3.3	307.4
+50			3.1	307.6
+66			2.0	308.7
+82			1.4	309.3
40+00			1.4	309.3
H. back	1.72	311.71 ✓	0.74	309.99 ✓

4 PILES  
NAIL IN TOP  
500#  
1000# 37107

MAY 13, 1929

14

No changes made - Add 50' to stations

40+50		311.71	1.5	310.2
40+70	Conto Res.		1.9	309.8
41+00			2.8	306.9
+23			7.3	304.4
+42 <sup>33</sup>	4 PT.		10.1	301.6
+50			12.0	299.7
IP (Back)	0.62	299.43 ✓	12.90	298.81 ✓
IP (Back)	0.29	287.22 ✓	12.50	286.93 ✓
42+00			1.2	286.0
+50			9.3	277.9
43+00			13.0	277.2
IP Top sec	4.69	279.49 ✓	12.42	274.80 ✓
+28 <sup>5</sup>	N. Gro		6.4	273.1
+28 <sup>5</sup>	Top 4" Pipe	Crosses 70° LT	7.95	271.54
+43	Top 1 1/2" Water Sec. pipe	Crosses 45° E	7.41	272.08
+43	N. Grid		7.0	272.5
+50			7.0	272.5
+62			5.9	273.6
+72			4.9	274.6

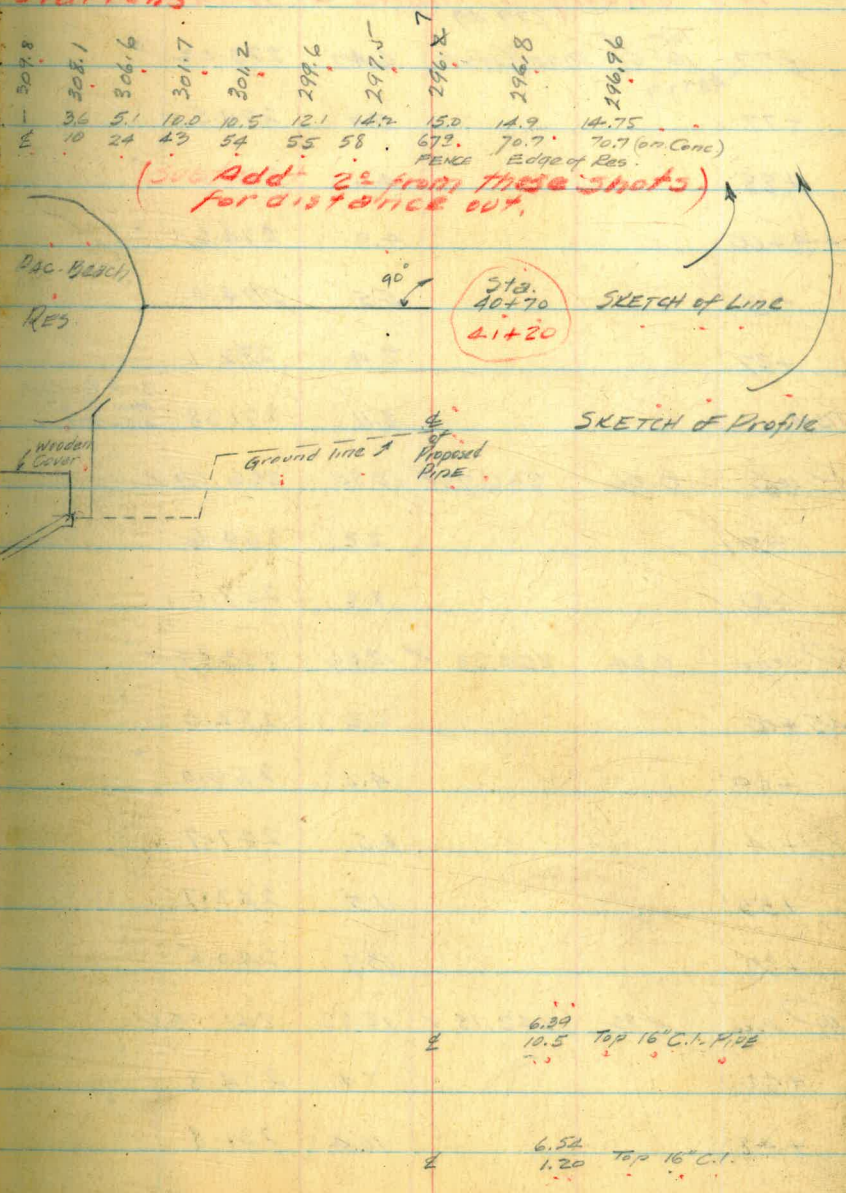

5/13/49

15.

No changes made - Add 50' to stations

		279.29		
+77	Top of 16" C.I. PIPE (Crosses) AA 127	6.47	273.02	
+77		5.0	274.5	
+88		4.6	274.9	
44+00		4.9	274.6	
+13		5.5	274.0	
+27		7.4	272.1	
TBM.		8.11	271.38	B.P. Top Conc Mon 10' LT 44+27.2
P (Rock)	0.06	266.75 ✓ 12.80	266.69 ✓	
+50		2.2	264.6	
+81		8.8	258.0	
P (Rock)	0.34	254.23 ✓ 12.86	253.89 ✓	
45+00		2.2	252.0	
+09		4.2	250.0	
+14		6.5	247.7	
+33		11.5	242.7	
+39		13.7	240.5	
P (Rock)	0.83	242.18 ✓ 12.88	241.35 ✓	
+21		7.4	234.8	
+28		10.4	231.8	

No changes made - Add 50' to Stations

	242.18								
45+50		10.8	231.4						
+54		11.4	230.8						
+60		12.9	229.3						
+68	E Windsor Extended	13.4	228.8						
+78		13.0	229.2						
+80		12.4	229.8						
+91		11.7	230.5						
46+00		12.2	230.2						
+19		12.6	229.6						
+20		14.3	227.9						
TBM (Set)		10.08	230.10						
P (LST)	1.50	231.14	12.54	229.62					
+29		5.6	225.5						
P	1.07	219.68	12.53	218.61					
+50		5.5	214.2						
+54		6.6	213.1						
+55		9.1	210.6						
+57		10.1	209.6						
+76		10.6	209.1						

1/16" C.I. Pipe

60  
 (23' located  
 with pipe finder)

228.65  
 13.53 TOP CONC POINT (End @ E)  
 10

13.7 13.8 15.0 14.0 12.4  
 20 14 11 7 4

12.9 16.8 16.0 16.7 13.1  
 16 10 7 6 3

12.3 14.8  
 4 2 10

Top FH.

LST on G.P.  
 10' offset from  
 line.

No changes made - Add 50' to Stations

	219.68			
46+82		13.0	206.7	
RP Rock	0.60	208.23 ✓	12.05	207.63 ✓
+92		3.0	205.2	
47+00		3.5	204.7	
+50		6.8	201.4	
48+00		6.2	202.0	
+085	Conc. Sidewalk (3")	6.06	202.17	
+115	" "	6.09	202.14	
+25		6.3	201.9	
+50		7.8	200.4	
+82		12.1	196.1	
+85		13.0	195.2	
+865	Conc. Sidewalk (3")	13.02	195.21	
+903	" "	13.18	195.05	
RP (on Sidewalk)	0.50	195.91 ✓	12.82	195.41 ✓
49+00		2.7	193.2	
+30		10.2	185.7	
+34		12.1	183.8	
+36		12.2	183.7	

	195.91			
RP	0.29	183.62 ✓	12.58	183.33 ✓
49+50			3.3	180.3
+55	Conc. Sidewalk		5.12	178.50
+58			5.14	178.48
49+64.95	Bayview Elect. Ave		5.3	178.3
0+07.63	Electric Ave			
P	2.13	174.10 ✓	11.65	171.97 ✓
	Top Fire Hydt.			
BN 52 Car			12.73	161.37 ✓
	Fanuel & Tourmaline			161.28 City BN



July 18 1929

BETTY  
ROGERS  
WEST

CONNECTING  
BAYVIEW - ELECTRIC PIPELINE  
REVISED PROFILE & X-SECTIONS  
Sta 8+45 to 13+55.09

NOTE: - FOR ALIGNMENT SEE BOOK 772  
PAGE 20.

IP (Rock)	10.56	392.27 ✓	381.71	page 5
IP	10.50	401.87 ✓	0.90	391.37 ✓
8+45	POT. P.L.	8.4	393.5	
9+02.58	& RT.	7.9	394.0	
+25.50		4.8	397.1	
+26		5.9	396.0	
+28		5.8	396.1	
+28.50		4.1	397.8	
+43		2.3	399.6	
+50		2.4	399.5	
10+00		2.1	399.8	
+10		2.5	399.4	
+17.3		4.0	397.9	
+29		3.1	398.8	
+50		3.2	398.7	
IP Rock	1.03	399.36 ✓	3.54	398.33 ✓
+75.41	& PT	1.7	397.7	

	22.3	9.2	4.0	+0.4
	30	5	11	30
RT. & TO BACK TANG	18.9	12.7		1.2
	30	17		30
	9.9	5.4	5.8	4.8
	30	10	8.5	8
			7.5	4
				+
				1.4
				30
	5.8	5.0	4.3	2.3
	30	17.5	6	3
				1.2
				13
				+1.3
				30
				4.9
				8.0
				1.9
				3
				+0.8
				30
				3.7
				30
				+0.2
				30
RT. & TO FWD TANG	0.8	1.5	1.7	+0.4
	30	8	10	2.4
				1.4
				2.8
				20
				30
				Edge Road

7/18/49

20.

## REVISED Profiled X-SECTS (Cont'd)

399.36

11	11+00		2.7	396.7
11	+08		3.3	396.1
8+	+20		5.0	394.4
	+50		7.5	391.9
9+				
	12+00		13.5	385.9
11		0.30	12.86	386.50 ✓
	+50		5.9	380.9
	+60.5		6.3	380.5
	+63.54 E.C. (IN EROSION HOLE - ROAD DITCH.)		9.9	376.9
	+66		7.0	379.8
	+70		7.3	379.5
10				
	13+00		10.3	376.5
11		0.43	12.20	374.60 ✓
	+50		3.6	371.4
11				
	14+00		8.2	366.8

LOCAL EROSION HOLE, 50 RT &amp; LT

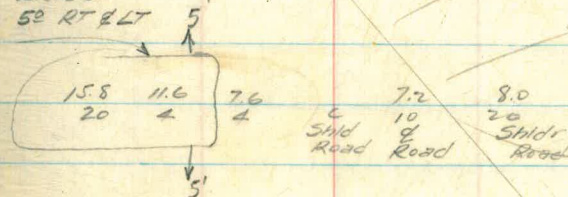

			1.9	2.4	2.0
			30	24	20
					Edge road
			9.3	9.4	6.2
			30	20	22
					7.4
					27
					30
					Edge Road
			21.3	17.9	10.8
			30	22	15
					12.9
					11.6
					30
					Edge Road
			12.4	9.3	4.9
			30	13	6.7
					5.4
					6
					16
					Edge Road
			15.8	11.6	7.2
			20	4	4
					7.2
					10
					8.0
					20
					Edge Road
			15.8	9.4	10.5
			30	8.5	7
					10.4
					11.1
					8.1
					17
					19
					Edge Road
			6.6	2.3	3.6
			30	15	12
					3.5
					2
					8
					10
					Edge Road
			12.7	10.6	7.4
			30	19	12
					8.5
					9
					8.8
					7.5
					12.
					Edge Road





REVISED  
 E PROFILE & Cross-sections  
 Bayview-Connecting Pipeline

July 28, 1949  
 BEATTY  
 ROGERS  
 WEST

Sta. 143845 to 184

11	11 (rock)	0.19	432.88	432.69
11	143845 B.C		2.5	430.4 ✓
8	+50		4.3	428.6 ✓
	2+00		13.7	419.2 ✓
9+	+37		12.8	420.1 ✓
	+50		13.9	419.0 ✓
	3+00		11.0	421.9 ✓
	+50		12.7	420.2 ✓
	3+67 <sup>69</sup> (EG. & PT)		11.4	421.5 ✓
10	4+00		7.1	425.8 ✓
	(11)	2.91	430.84	427.93 ✓
	+25		2.8	428.0 ✓
	+50		2.7	428.1 ✓
	5+00		3.5	427.3 ✓

Note: For ALIGN. SEE BK. 772 pg. 20.

15 3.2 19.5 10.2  
 30 23 10 30

42 7.7 25.0 23.2  
 30 22 22 30

4.7 8.3 21.0  
 30 17 30

3.5 5.8 16.3 23.6  
 34 21 19 30

(RT To Fwd Tang)

4.8 12.8 16.6 17.8  
 30 6.5 26 30  
 FEN.

3.0 8.3 13.0  
 25 6.5 30  
 FEN

4.3 3.5 6.9  
 30 7 30  
 FEN

3.6 7.2  
 FEN

7/28/49

25

4	5+50		430.84	6.7	424.1	✓
7						
8	6+00			10.4	420.4	✓
9	+50			14.1	416.7	✓
	TP	1.20	419.00	13.04	417.80	✓
	7+00			6.3	412.7	✓
	+50			9.8	409.7	✓
	+74			11.2	407.8	✓
	+79 <sup>33</sup> x PT			11.4	407.6	✓
	SET TBM	1.48	408.94	11.54	407.46	✓
						E. Side Conc. Mark 10' RT. x PT
10	8+00			2.5	406.4	✓
	+42			4.9	404.0	✓
	+50			6.0	402.9	✓
	9+00			11.9	397.0	✓
	TP	0.15	396.68	12.41	396.53	✓
	+50			5.5	391.2	✓
	10+00			11.8	384.9	✓
	TP	0.37	384.04	13.01	383.67	✓

7/29/49

7.1  
7  
FEN10.6  
7  
FEN14.2  
7  
FEN6.6  
7  
FEN9.9  
7  
FEN

7/29/49

24.

		384.04		
11	10+50		5.7	378.3 ✓
11	11+00		11.0	373.0 ✓
8	P	0.64	371.86	12.82
				371.22 ✓
	+50		2.6	369.3 ✓
9	12+00		8.7	363.2 ✓
	P	0.16	359.55	12.47
				359.29 ✓
	+30		1.2	358.4 ✓
	+50		5.4	354.2 ✓
	P	0.19	346.89	12.85
				346.70 ✓
	13+00		2.0	344.9 ✓
	+50		8.2	338.7 ✓
	+66		11.3	335.6 ✓
1	P	0.25	334.67	12.47
				334.42 ✓
	14+00		4.9	329.8 ✓
	+50		11.3	323.4 ✓
	+59		12.7	322.0 ✓
	P	0.04	322.16	12.55
				322.12 ✓
9	15+00		16.6	305.6 ✓
	+37		32.1	290.1 ✓

+1.4  
30

c

8.8  
308.8  
30

c

13.0 18.5  
12.5 309.9  
30

c

17.7  
1323.5  
30

7/28/49

25

		322.16							
1	15+50		33.1	289.1					
2	+51		35.1	287.1		35.0 35	33.4 30		32.5 7
	+53		35.1	287.1					34.0 8
	+53		33.3	288.9					32.3 11
9	+58		33.0	289.2					31.5 16
	16+00		15.2	307.0					25.3 30
	IP	9.44	330.45	1.15	321.01		24.2 30		7.0 30
	+50		7.9	322.6					
	+67		6.3	324.2		17.5 30	10.2 12		4.7 30
	+90		4.6	325.9					
	17+00		4.3	326.2					
	+50		6.0	324.5					
	18+00		8.9	321.6					
	+37		10.5	320.0					
	+43		12.1	318.4					
	18+46 <sup>24</sup> BK		12.2	318.3					
	20+83 <sup>65</sup> ALI & PT.								
	21+02 <sup>7</sup>		11.9	318.6					
	21+26 <sup>10</sup> (Formerly & PT.)		11.4	319.1					
	IP	4.93	323.97	11.41	319.04				
	CK BM		8.11	315.86					

NAIL IN  
PO POLE





ELEV. ON TOP OF BAYVIEW 20"  
FEEDER MAIN & PACIFIC BEACH 16" MAIN  
(AS PER SHEET 4 OF 4 FILE NO 4029)

12/18/57  
SHOREY  
KEMP  
SMITH

28.

TBM	4.10	233.74	229.64
{ 46+08	6.10	227.64	
{ 46+08	4.2	229.5	
{ 46+08	6.89	226.85	
{ 46+08	4.5	229.2	
{ 46+56	6.69	227.05	
{ 46+56	4.9	228.8	
{ 46+56	7.72	226.02	
{ 46+56	5.3	228.4	

L&T AT N. END OF E. CURB WINDSOR ST. (SEE PAGE-16)

TOP OF 20" BAYVIEW FEEDER MAIN 10' 20"

GROUND

TOP OF 16" PACIFIC BEACH P/L

TOP OF 20" BAYVIEW FEEDER MAIN

GROUND

TOP OF 16" PACIFIC BEACH P/L

GROUND

NOTE:

16" PACIFIC BEACH MAIN IS 4' NORTH  
OF S/L OF 15' EASEMENT & 20"

BAYVIEW FEEDER MAIN IS 10' NORTH OF

S/L OF 15' EASEMENT

NATURAL GROUND IN EASEMENT HAS

NOT BEEN DISTURBED NOTICEABLY AS

OF THIS DATE 12/18/57







Please Return to  
 City of San Diego Water Dept.  
 Room 903 Civic Center

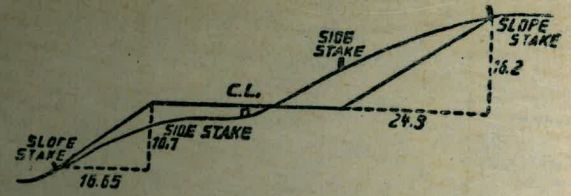

**DISTANCES FROM SIDE STAKES FOR CROSS-SECTIONING.**  
 SLOPE 1 1/2 TO 1. ROADWAY OF ANY WIDTH.

	0	.1	.2	.3	.4	.5	.6	.7	.8	.9	
0	0.00	0.15	0.30	0.45	0.60	0.75	0.90	1.05	1.20	1.35	0
1	1.50	1.65	1.80	1.95	2.10	2.25	2.40	2.55	2.70	2.85	1
2	3.00	3.15	3.30	3.45	3.60	3.75	3.90	4.05	4.20	4.35	2
3	4.50	4.65	4.80	4.95	5.10	5.25	5.40	5.55	5.70	5.85	3
4	6.00	6.15	6.30	6.45	6.60	6.75	6.90	7.05	7.20	7.35	4
5	7.50	7.65	7.80	7.95	8.10	8.25	8.40	8.55	8.70	8.85	5
6	9.00	9.15	9.30	9.45	9.60	9.75	9.90	10.05	10.20	10.35	6
7	10.50	10.65	10.80	10.95	11.10	11.25	11.40	11.55	11.70	11.85	7
8	12.00	12.15	12.30	12.45	12.60	12.75	12.90	13.05	13.20	13.35	8
9	13.50	13.65	13.80	13.95	14.10	14.25	14.40	14.55	14.70	14.85	9
10	15.00	15.15	15.30	15.45	15.60	15.75	15.90	16.05	16.20	16.35	10
11	16.50	16.65	16.80	16.95	17.10	17.25	17.40	17.55	17.70	17.85	11
12	18.00	18.15	18.30	18.45	18.60	18.75	18.90	19.05	19.20	19.35	12
13	19.50	19.65	19.80	19.95	20.10	20.25	20.40	20.55	20.70	20.85	13
14	21.00	21.15	21.30	21.45	21.60	21.75	21.90	22.05	22.20	22.35	14
15	22.50	22.65	22.80	22.95	23.10	23.25	23.40	23.55	23.70	23.85	15
16	24.00	24.15	24.30	24.45	24.60	24.75	24.90	25.05	25.20	25.35	16
17	25.50	25.65	25.80	25.95	26.10	26.25	26.40	26.55	26.70	26.85	17
18	27.00	27.15	27.30	27.45	27.60	27.75	27.90	28.05	28.20	28.35	18
19	28.50	28.65	28.80	28.95	29.10	29.25	29.40	29.55	29.70	29.85	19
20	30.00	30.15	30.30	30.45	30.60	30.75	30.90	31.05	31.20	31.35	20
21	31.50	31.65	31.80	31.95	32.10	32.25	32.40	32.55	32.70	32.85	21
22	33.00	33.15	33.30	33.45	33.60	33.75	33.90	34.05	34.20	34.35	22
23	34.50	34.65	34.80	34.95	35.10	35.25	35.40	35.55	35.70	35.85	23
24	36.00	36.15	36.30	36.45	36.60	36.75	36.90	37.05	37.20	37.35	24
25	37.50	37.65	37.80	37.95	38.10	38.25	38.40	38.55	38.70	38.85	25
26	39.00	39.15	39.30	39.45	39.60	39.75	39.90	40.05	40.20	40.35	26
27	40.50	40.65	40.80	40.95	41.10	41.25	41.40	41.55	41.70	41.85	27
28	42.00	42.15	42.30	42.45	42.60	42.75	42.90	43.05	43.20	43.35	28
29	43.50	43.65	43.80	43.95	44.10	44.25	44.40	44.55	44.70	44.85	29
30	45.00	45.15	45.30	45.45	45.60	45.75	45.90	46.05	46.20	46.35	30
31	46.50	46.65	46.80	46.95	47.10	47.25	47.40	47.55	47.70	47.85	31
32	48.00	48.15	48.30	48.45	48.60	48.75	48.90	49.05	49.20	49.35	32
33	49.50	49.65	49.80	49.95	50.10	50.25	50.40	50.55	50.70	50.85	33
34	51.00	51.15	51.30	51.45	51.60	51.75	51.90	52.05	52.20	52.35	34
35	52.50	52.65	52.80	52.95	53.10	53.25	53.40	53.55	53.70	53.85	35
36	54.00	54.15	54.30	54.45	54.60	54.75	54.90	55.05	55.20	55.35	36
37	55.50	55.65	55.80	55.95	56.10	56.25	56.40	56.55	56.70	56.85	37
38	57.00	57.15	57.30	57.45	57.60	57.75	57.90	58.05	58.20	58.35	38
39	58.50	58.65	58.80	58.95	59.10	59.25	59.40	59.55	59.70	59.85	39
40	60.00	60.15	60.30	60.45	60.60	60.75	60.90	61.05	61.20	61.35	40
41	61.50	61.65	61.80	61.95	62.10	62.25	62.40	62.55	62.70	62.85	41
42	63.00	63.15	63.30	63.45	63.60	63.75	63.90	64.05	64.20	64.35	42
43	64.50	64.65	64.80	64.95	65.10	65.25	65.40	65.55	65.70	65.85	43
44	66.00	66.15	66.30	66.45	66.60	66.75	66.90	67.05	67.20	67.35	44
45	67.50	67.65	67.80	67.95	68.10	68.25	68.40	68.55	68.70	68.85	45
46	69.00	69.15	69.30	69.45	69.60	69.75	69.90	70.05	70.20	70.35	46
47	70.50	70.65	70.80	70.95	71.10	71.25	71.40	71.55	71.70	71.85	47
48	72.00	72.15	72.30	72.45	72.60	72.75	72.90	73.05	73.20	73.35	48
49	73.50	73.65	73.80	73.95	74.10	74.25	74.40	74.55	74.70	74.85	49
50	75.00	75.15	75.30	75.45	75.60	75.75	75.90	76.05	76.20	76.35	50