

W

841

W. B. E. 1922

Please Return to
 City of San Diego Water Dept.
 Room 903 Civic Center

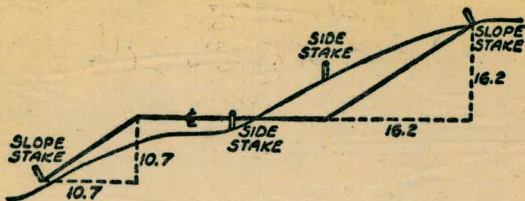

DISTANCES FROM SIDE STAKES FOR CROSS-SECTIONING
 SLOPE 1 TO 1. ROADWAY OF ANY WIDTH

	0	.1	.2	.3	.4	.5	.6	.7	.8	.9	
0	0.00	0.10	0.20	0.30	0.40	0.50	0.60	0.70	0.80	0.90	0
1	1.00	1.10	1.20	1.30	1.40	1.50	1.60	1.70	1.80	1.90	1
2	2.00	2.10	2.20	2.30	2.40	2.50	2.60	2.70	2.80	2.90	2
3	3.00	3.10	3.20	3.30	3.40	3.50	3.60	3.70	3.80	3.90	3
4	4.00	4.10	4.20	4.30	4.40	4.50	4.60	4.70	4.80	4.90	4
5	5.00	5.10	5.20	5.30	5.40	5.50	5.60	5.70	5.80	5.90	5
6	6.00	6.10	6.20	6.30	6.40	6.50	6.60	6.70	6.80	6.90	6
7	7.00	7.10	7.20	7.30	7.40	7.50	7.60	7.70	7.80	7.90	7
8	8.00	8.10	8.20	8.30	8.40	8.50	8.60	8.70	8.80	8.90	8
9	9.00	9.10	9.20	9.30	9.40	9.50	9.60	9.70	9.80	9.90	9
10	10.00	10.10	10.20	10.30	10.40	10.50	10.60	10.70	10.80	10.90	10
11	11.00	11.10	11.20	11.30	11.40	11.50	11.60	11.70	11.80	11.90	11
12	12.00	12.10	12.20	12.30	12.40	12.50	12.60	12.70	12.80	12.90	12
13	13.00	13.10	13.20	13.30	13.40	13.50	13.60	13.70	13.80	13.90	13
14	14.00	14.10	14.20	14.30	14.40	14.50	14.60	14.70	14.80	14.90	14
15	15.00	15.10	15.20	15.30	15.40	15.50	15.60	15.70	15.80	15.90	15
16	16.00	16.10	16.20	16.30	16.40	16.50	16.60	16.70	16.80	16.90	16
17	17.00	17.10	17.20	17.30	17.40	17.50	17.60	17.70	17.80	17.90	17
18	18.00	18.10	18.20	18.30	18.40	18.50	18.60	18.70	18.80	18.90	18
19	19.00	19.10	19.20	19.30	19.40	19.50	19.60	19.70	19.80	19.90	19
20	20.00	20.10	20.20	20.30	20.40	20.50	20.60	20.70	20.80	20.90	20
21	21.00	21.10	21.20	21.30	21.40	21.50	21.60	21.70	21.80	21.90	21
22	22.00	22.10	22.20	22.30	22.40	22.50	22.60	22.70	22.80	22.90	22
23	23.00	23.10	23.20	23.30	23.40	23.50	23.60	23.70	23.80	23.90	23
24	24.00	24.10	24.20	24.30	24.40	24.50	24.60	24.70	24.80	24.90	24
25	25.00	25.10	25.20	25.30	25.40	25.50	25.60	25.70	25.80	25.90	25
26	26.00	26.10	26.20	26.30	26.40	26.50	26.60	26.70	26.80	26.90	26
27	27.00	27.10	27.20	27.30	27.40	27.50	27.60	27.70	27.80	27.90	27
28	28.00	28.10	28.20	28.30	28.40	28.50	28.60	28.70	28.80	28.90	28
29	29.00	29.10	29.20	29.30	29.40	29.50	29.60	29.70	29.80	29.90	29
30	30.00	30.10	30.20	30.30	30.40	30.50	30.60	30.70	30.80	30.90	30
31	31.00	31.10	31.20	31.30	31.40	31.50	31.60	31.70	31.80	31.90	31
32	32.00	32.10	32.20	32.30	32.40	32.50	32.60	32.70	32.80	32.90	32
33	33.00	33.10	33.20	33.30	33.40	33.50	33.60	33.70	33.80	33.90	33
34	34.00	34.10	34.20	34.30	34.40	34.50	34.60	34.70	34.80	34.90	34
35	35.00	35.10	35.20	35.30	35.40	35.50	35.60	35.70	35.80	35.90	35
36	36.00	36.10	36.20	36.30	36.40	36.50	36.60	36.70	36.80	36.90	36
37	37.00	37.10	37.20	37.30	37.40	37.50	37.60	37.70	37.80	37.90	37
38	38.00	38.10	38.20	38.30	38.40	38.50	38.60	38.70	38.80	38.90	38
39	39.00	39.10	39.20	39.30	39.40	39.50	39.60	39.70	39.80	39.90	39
40	40.00	40.10	40.20	40.30	40.40	40.50	40.60	40.70	40.80	40.90	40
41	41.00	41.10	41.20	41.30	41.40	41.50	41.60	41.70	41.80	41.90	41
42	42.00	42.10	42.20	42.30	42.40	42.50	42.60	42.70	42.80	42.90	42
43	43.00	43.10	43.20	43.30	43.40	43.50	43.60	43.70	43.80	43.90	43
44	44.00	44.10	44.20	44.30	44.40	44.50	44.60	44.70	44.80	44.90	44
45	45.00	45.10	45.20	45.30	45.40	45.50	45.60	45.70	45.80	45.90	45
46	46.00	46.10	46.20	46.30	46.40	46.50	46.60	46.70	46.80	46.90	46
47	47.00	47.10	47.20	47.30	47.40	47.50	47.60	47.70	47.80	47.90	47
48	48.00	48.10	48.20	48.30	48.40	48.50	48.60	48.70	48.80	48.90	48
49	49.00	49.10	49.20	49.30	49.40	49.50	49.60	49.70	49.80	49.90	49
50	50.00	50.10	50.20	50.30	50.40	50.50	50.60	50.70	50.80	50.90	50

Distance of slope stake from side or shoulder stake for any width roadway, slope 1 to 1. If ground is nearly level, the cut or fill at side stake is located by the double entry method in left column and top row. The number in body of table in same row and column gives distance from side stake to slope stake. If ground is not level estimate the difference in elevation between the side stake and slope stake, lower target by this amount if cut, elevate if fill. Add this amount to cut or fill and find distance in table. Set up rod at this point, and line of sight should cut target. If it does not make the slight adjustment necessary.

MICROFILMED

JAN 1 0 1965

DIRECTIONS FOR USE OF TABLES

TABLE No. XIV

Distance of slope stake from side of shoulder
stake for any width roadway, slope 1% to 1
is found in this table. The distance between
stake is located by the height of the stake in
feet.

IMPROVED TABLES
AND
INFORMATION

cut target. If it does not make the right cut
adjustment necessary.

TABLE No. VIII

To find Tangent and External for curve of
any other degree, divide by degree of curve, and
add correction found in column of correction.
Degree of curve with a given L may be found
by dividing tangent (or external) opposite L by
given tangent (or external).

The distance from a point on the tangent to
the curve is very nearly the square of the tangent
length divided by twice the radius.

TABLE XIII—CORRECTIONS FOR TANGENTS AND EXTERNALS

These corrections are to be added to the approximate values, found by dividing the tangent, or external, for a 1° curve (Table VIII) by the degree of curve, in order to obtain the true tangents, or externals. Intermediate values may be obtained by interpolation.

FOR TANGENTS ADD

Central Angle	DEGREE OF CURVE													
	5°	10°	15°	20°	25°	30°	35°	40°	45°	50°	55°	60°	65°	70°
10°	.03	.06	.09	.13	.16	.19	.22	.25	.28	.31	.34	.38	.42	.46
15°	.04	.10	.14	.19	.24	.29	.34	.39	.45	.51	.53	.58	.63	.68
20°	.06	.13	.19	.26	.32	.39	.45	.51	.58	.65	.72	.79	.84	.90
25°	.08	.16	.24	.33	.40	.49	.58	.67	.75	.83	.90	.99	1.06	1.14
30°	.10	.19	.29	.39	.49	.59	.69	.79	.89	.99	1.09	1.20	1.29	1.39
35°	.11	.22	.34	.47	.58	.69	.79	.81	.92	1.04	1.29	1.42	1.54	1.66
40°	.13	.26	.40	.53	.67	.80	.93	1.06	1.20	1.34	1.49	1.64	1.79	1.94
45°	.15	.30	.44	.60	.76	.91	1.06	1.21	1.37	1.52	1.70	1.87	2.04	2.21
50°	.17	.34	.51	.68	.85	1.02	1.19	1.36	1.54	1.72	1.91	2.10	2.29	2.48
55°	.19	.38	.57	.76	.95	1.14	1.32	1.52	1.72	1.92	2.14	2.35	2.56	2.77
60°	.21	.42	.63	.84	1.05	1.27	1.49	1.71	1.94	2.17	2.38	2.60	2.83	3.07
65°	.23	.46	.69	.93	1.16	1.40	1.64	1.88	2.13	2.38	2.63	2.88	3.13	3.39
70°	.25	.51	.76	1.02	1.28	1.54	1.80	2.06	2.33	2.60	2.88	3.16	3.44	3.72
75°	.27	.56	.83	1.12	1.40	1.69	1.98	2.27	2.57	2.87	3.16	3.47	3.78	4.09
80°	.30	.61	.91	1.22	1.53	1.84	2.15	2.46	2.78	3.10	3.44	3.78	4.12	4.46
85°	.33	.66	1.00	1.33	1.68	2.02	2.36	2.70	3.05	3.40	3.77	4.14	4.55	4.89
90°	.38	.72	1.09	1.45	1.83	2.20	2.57	2.94	3.32	3.70	4.10	4.50	4.91	5.32
95°	.39	.79	1.19	1.55	1.92	2.30	2.68	3.06	3.44	3.82	4.24	4.64	5.05	5.46
100°	.43	.86	1.30	1.74	2.18	2.62	3.06	3.50	3.95	4.40	4.88	5.37	5.85	6.34
110°	.51	1.03	1.56	2.08	2.61	3.14	3.67	4.21	4.76	5.31	5.86	6.43	7.01	7.60
120°	.62	1.25	1.93	2.52	3.16	3.81	4.45	5.11	5.77	6.44	7.12	7.80	8.50	9.22

FOR EXTERNALS ADD

Central Angle	DEGREE OF CURVE													
	5°	10°	15°	20°	25°	30°	35°	40°	45°	50°	55°	60°	65°	70°
10°	.001	.003	.004	.006	.007	.008	.009	.011	.012	.014	.015	.017	.018	.020
15°	.003	.007	.010	.014	.018	.023	.027	.032	.037	.043	.049	.053	.057	.061
20°	.006	.011	.017	.022	.028	.034	.038	.045	.051	.057	.063	.070	.076	.083
25°	.009	.018	.027	.036	.046	.056	.065	.074	.083	.093	.106	.120	.127	.135
30°	.013	.025	.038	.051	.065	.078	.090	.103	.116	.129	.149	.170	.179	.188
35°	.018	.035	.054	.072	.086	.109	.131	.153	.175	.197	.213	.230	.247	.264
40°	.023	.046	.070	.093	.117	.141	.172	.203	.234	.265	.277	.290	.315	.341
45°	.030	.060	.093	.119	.153	.184	.216	.254	.289	.325	.351	.378	.411	.445
50°	.037	.075	.116	.151	.189	.227	.266	.305	.345	.384	.425	.467	.508	.550
55°	.046	.093	.142	.188	.236	.283	.332	.381	.420	.479	.530	.582	.641	.700
60°	.056	.112	.168	.225	.283	.340	.398	.457	.516	.575	.636	.697	.774	.851
65°	.067	.135	.204	.273	.343	.412	.483	.554	.625	.697	.771	.845	.922	1.01
70°	.080	.159	.240	.321	.403	.485	.568	.652	.735	.819	.906	.994	1.08	1.17
75°	.095	.182	.266	.353	.440	.528	.616	.704	.792	.877	.977	1.07	1.18	1.29
80°	.110	.220	.332	.445	.558	.671	.787	.903	1.02	1.13	1.25	1.38	1.50	1.62
85°	.128	.259	.391	.524	.657	.790	.926	1.06	1.20	1.34	1.47	1.62	1.76	1.91
90°	.149	.299	.450	.603	.756	.910	1.07	1.22	1.38	1.54	1.70	1.87	2.03	2.20
95°	.174	.350	.522	.706	.885	1.06	1.25	1.43	1.62	1.80	1.99	2.18	2.38	2.58
100°	.200	.401	.604	.809	1.01	1.22	1.43	1.64	1.85	2.06	2.28	2.50	2.73	2.96
110°	.268	.536	.806	1.08	1.35	1.63	1.91	2.20	2.48	2.76	3.05	3.35	3.66	3.96
120°	.360	.721	1.08	1.45	1.82	2.19	2.57	2.95	3.33	3.72	4.11	4.50	4.91	5.32

INDEX

57KS For Water Meters Alice
 Grand Ave Cass to Ingram 1-7 ✓
 Byron St Scott to Shafter 8 ✓
 Thorn St Fairmont to 45th 9 ✓
 Group #18 Proposed R2 ✓
 Dwight St Alley E of Boundary to Boundary 10-11 ✓
 34th St Monroe to Alley 5 of Adams 12-13 ✓
 57KS For Meters ✓
 Alley Bk 11 betw 37th & 38th Bk to Orange 14 ✓
 57KS ✓
 MYRTLE AVE 6" A.C. ALLEY E OF 36 TO WILSON 15 ✓
 57KS For 6" Main ✓
 Evans St "L" to Imperial 16 ✓
 57KS For 6" MAIN ✓
 29th St Imperial to Commercial 17 ✓
 57KS For 6" MAIN ✓
 OSBORN ST. COTTONWOOD TO BIRCH 18-19 ✓
 Delta St 45th location of meters 20 ✓
 57KS For 6" AC ✓
 Dwight St Alley E of Boundary 21 ✓
 Town & Country Stadia Survey 22 ✓
 Delta St 45th to 46th 23-25 ✓
 Alice ✓
 Alley Bk 12 City HTS ANNEX 26 ✓
 57KS For 6" AC Main ✓
 East of 45th North of Landis 27 ✓
 Alice ✓
 33rd St Thorn to UPAS 28-29 ✓
 57KS 6" A.C. MAIN ✓
 SAN DIEGO AVE TWIGGS ST TO MASON 30 ✓
 57KS For 6" AC Group 101 ✓
 QUI ST PRINGLE ST TO 240' NW 31 ✓
 Alice ✓

INDEX

STKS FOR 4" A.C. Group 101 alice ✓
Court Way Hawk to 190' East 32 ✓
STKS FOR 6" A.C. Group 101
Upas St Albert to Richmond 33 ✓
STKS. 8" A.C. MAIN Access ✓
MISSION VALLEY INN SUBDIVISION CAMINO DEL RIO ROAD 34-35
STKS. FOR 6" & 4" A.C. ✓
PECK PL. COLLEGE AVE TO 320' EAST 36-37 ✓
Delim Group 28
Iowa St Monroe to Meade 38-40 ✓
alice

Grand Ave
Cass to Ingram
5' x 5' for Water Meters

West
Williams
Varontakis

1

18 Aug 54

636	18.11	11.75		
719	23.39	1.91	16.20	
0+59		6.9	16.5	17.1
+87		5.4	18.0	18.0
1+32		4.9	18.5	18.3
+94		4.4	19.0	19.0
+81		5.7	17.7	18.0
2+17		4.9	18.5	18.4
+77		4.9	18.5	19.0
2+38		3.9	19.5	19.5
+84		3.3	20.1	20.0
3+17		2.9	20.5	20.3
+32		2.8	20.6	20.5
+67		3.1	20.3	20.8
+81		2.4	21.0	21.0
3+37		4.3	19.1	19.6
+75		3.7	19.7	20.0
4+25		3.4	20.0	20.4
+29		2.0	21.4	21.5

BM NE 7' L+T Grand + Bayard #

FO ⁶₀ or 01 East prop line Cass

WM 5

CO ⁰

WM N

CO ²

WM N

CO ⁰

WM N

FO ³

WM 5

CO ¹

WM 5

FO ⁵

WM 5

CO ⁰

WM N

CO ¹

WM N

CO ²

WM N

CO ¹

WM N

FO ⁵

WM N

CO ⁰

WM N

FO ⁵

WM 5

FO ³

WM 5

FO ⁴

WM 5

FO ¹

WM N

Grand Ave Cont

8/18/54

2

2339

6.57 28.25 1.71 21.68

5+79	5.25	23.00	23.00
6+24	4.6	23.7	23.3
+68	4.3	24.0	23.6
5+81	6.6	21.7	22.0
5+93	6.7	21.6	22.1
6+19	6.0	22.3	22.2
+40	5.9	22.4	22.3
+70	5.5	22.8	22.5
7+06	5.9	23.0	22.7
+40	4.8	23.5	22.9
+99	3.9	24.4	23.4
7+75	3.2	25.1	24.2
8+15	2.6	25.7	24.6
+43	3.9	24.4	23.7
+73	3.8	24.5	24.0
9+06	3.2	25.1	24.4
+57	2.9	25.4	25.2
9+39	1.2	27.1	26.0

CO⁰CO⁴CO⁴FO³FO⁵CO¹CO¹CO³CO³CO⁶CI⁰CO⁹CI¹CO⁷CO⁵CO⁷CO²CI¹Check
WMN

WMN

WMN

WMS

WMS

WMS

WMS

WMS

WMS

WMS

WMS

WMN

WMN

WMS

WMS

WMS

WMS

WMN

8/18/54

3.

28.25

Everts

6.47 33.26 1.46 26.79

10+00

6.7 26.6 26.0

CO $\frac{6}{4}$

WMS

+09

6.9 26.4 26.0

CO $\frac{4}{4}$

WMS

5.33 34.42 4.17 29.09

Turn on 7' man 5' E Cor Everts + Grand

8.89 42.83 0.48 33.94

3.32 39.51 = 39.53 Grand + Everts NW RD

Grand Ave Cont Everts to Grand

8/19 54

5.89 34.98 29.09

T man 0+00 on East Line Pass

10+51

7.2 27.8 26.7

CO $\frac{1}{4}$

WMS

+77

8.0 27.0 27.1

FO $\frac{1}{4}$

WMS

11+60

5.5 29.5 28.6

CO $\frac{2}{2}$

WMS

12+00

4.9 30.1 30.3

FO $\frac{2}{2}$

WMN

+37

4.6 30.4 30.0

CO $\frac{4}{4}$

WMS

+50

4.5 30.5 31.1

FO $\frac{6}{6}$

WMN

+85

4.0 31.0 30.9

CO $\frac{1}{4}$

WMS

+84

3.9 31.1 31.6

FO $\frac{5}{5}$

WMN

13+10

3.8 31.2 31.3

FO $\frac{1}{4}$

WMS

+46

3.1 31.9 32.5

FO $\frac{6}{6}$

WMN

14+00

2.4 32.6 32.0

CO $\frac{0}{0}$

WMS

WMS

Grand Ave Cont

4

39.98

13+82	2.4	32.6	32.9	F03	WMN
14+38	2.3	32.7	33.1	F04	WMS
+59	1.9	33.2	33.7	F05	WMN
+69	1.6	33.4	33.8	F04	WMN
+85	1.5	33.5	33.7	F02	WMS
15+02	1.4	33.6	34.0	F04	WMN
+28	1.8	33.7	34.1	F09	WMS
+33	1.2	33.8	34.3	F05	WMN
9.04	42.31	1.71	33.27		
+84	7.1	35.2	34.8	C01	WMN
+98	9.1	33.2	35.0	F12	WMS
16+31	7.0	35.3	35.2	C01	WMN
+45	8.5	33.8	35.5	F12	WMS
17+69	5.7	36.6	36.7	F01	WMS
18+10	5.6	36.7	37.0	F03	WMS
+41	4.8	37.5	37.5	C00	WMN
+58	4.0	38.3	37.4	C02	WMS
+87	4.1	38.2	38.1	C01	WMN
19+08	4.1	38.2	37.9	C03	WMS

Grand Ave Cont.

5

27.31

8/19/54

19+20	5.9	39.4	38.6	CO ⁸	WMN
+60	3.4	38.9	38.4	CO ⁵	WMS
+91	1.9	40.4	39.4	CI ²	WMN
20+22	3.0	39.3	39.1	CO ²	WMS
6.91	46.54	2.18	40.13		
+63	6.2	40.3	39.6	CO ⁷	WMS
+95	5.7	40.8	40.0	CO ⁸	WMS
22+26	2.7	43.8	42.5	CI ³	WMN
+07	3.6	42.9	41.6	CI ³	WMS
+21	3.5	43.0	41.8	CI ²	WMS
	3.12	43.42	=	43.47	NET Man Gresham + Grand

Grand Ave Cont

8-20-54

BM.	9.15	52.62		43.47	NET Man Gresham + Grand
23+76	8.0	44.6	44.6	CO ⁰	WMS
+93	6.3	46.3	45.6	CO ¹	WMN
24+54	5.7	46.9	46.3	CO ⁶	WMS
+46	4.7	47.9	46.7	CI ²	WMN
+79	5.1	47.5	46.8	CO ⁷	WMS
25+26	3.3	49.3	48.3	CI ⁰	WMN

GRAND AVE. CONT.

8/20/54

7

STA	T	HI	EL	EL
31458			3.2	57.4 56.8
+91			4.4	56.8 56.8
+86			3.5	57.7 57.4
32+26			4.1	57.1 56.7
33+24			4.2	57.0 56.8
+98			6.4	54.8 55.1
T.P.	0.88	58.52	7.55	53.64
CHECK				
B.M.			11.06	43.46 = 43.47
	1.39	30.48		29.09
4+75 N			8.3	22.2 22.0
4+75 S			10.2	20.3 21.0
7+17 N			5.6	24.9 23.8
8+54.5 N			4.5	26.0 24.8
9+01.5 N			3.8	26.7 25.2
9+92 N			2.7	27.8 26.7
10+37.5 N			2.0	28.5 27.6
10+84.5 N			1.8	28.7 28.4
			1.39	29.09 = 29.09
	0.94	44.41		43.47
17+79 N			7.4	37.0 36.8
20+49 N			2.4	42.0 40.1
20+99 N			1.9	42.5 40.9
	1.33	55.80	0.44	42.5
24+09 N			8.5	47.3 45.8
24+20 S			10.5	45.3 45.5
24+94 N			6.8	49.0 47.7
25+41 S			6.2	49.6 48.2
27+81.5 S			2.6	53.2 53.3
	7.07	62.24	0.83	54.97
30+12.5 N			3.1	59.1 56.7
32+50 N			1.3	60.9 56.6

CO⁶

CO⁰

CO³

CO⁴

CO²

FO³

W.M. S

W.M. S

W.M. N

W.M. S

W.M. N

W.M. S

(N) Mon. Levels + Quarter Meter stakes

CO²

FO²

CI¹

CI²

CI⁵

CI¹

CO²

CO³

North

South

South North

North

North

North

North

North

NE Mon. Broomham + Grand

CO²

CI²

CI⁶

CI⁵

FO²

CI³

CI⁴

FO¹

CI⁴

CI³

62.24
- 7.50
54.69
+ 1.13
55.81
12.33
13.48 = 43.47

Byron St
Scott to Shafter

STA	+	H ₁	-	F _L
B.M.	3.84	6.41		2.57
T.P.	5.06	8.51	2.96	3.45
0+46			2.3	6.2 5.3
+57			3.2	5.3 5.1
+75			3.7	4.8 4.6
+75			3.1	5.4 4.6
1+01			4.5	4.0 4.1
1+73			6.0	2.5 2.5
2+26			6.0	2.5 2.0
			6.8	
3+95			6.1	2.4 1.3
4+45			6.3	2.2 1.4
4+45			6.6	1.9 1.5
4+95			6.7	1.8 1.7
4+95			6.2	2.3 1.6
5+25			6.4	2.1 1.7
T.P.	5.64	6.95	7.20	1.31
Check B.M.			4.41	2.54 = 2.57

West
Williams X
Yarontakis
Kellhofer †

53

8/23/54 8

23 Aug 54

BNSW 82 Cannon + Shafter

					CO ⁹	W.M.S.
					CO ²	W.M.N.
					CO ² CO ⁰	W.M.N.
					CO ⁸ 1	W.M.S.
					FO	W.M.N.
					CO ² 5	W.M.N.
					CO	W.M.N.
					CI ¹	W.M.S.
					CO ⁸	W.M.S.
					CO ⁴	W.M.N.
					CO ¹	W.M.N.
					CO ⁷	W.M.S.
					CO ⁴	W.M.S.

THORN 56
Fairmont to 45th

West
Williams
Varon Fokis
Kellhofer

9

8/22/54

5
B 1.43 319.45 318.02
7 1+52 8.2 311.3
0 2+28 125 307.0
1.43 318.02 = 318.02

BM SE BP Thorn + Fairmont
311.5 F02 WM N
307.4 F01

Dwight St
Alley E of Boundary to Boundary
Proposed P2

1+85.25 Top of west side Boundary

1+60.90 POT

0+00

East prop line Alley

West
Williams
Varonfakis
Kellhofer

1+60.40
24.35
1+85.25

10

8/24/54

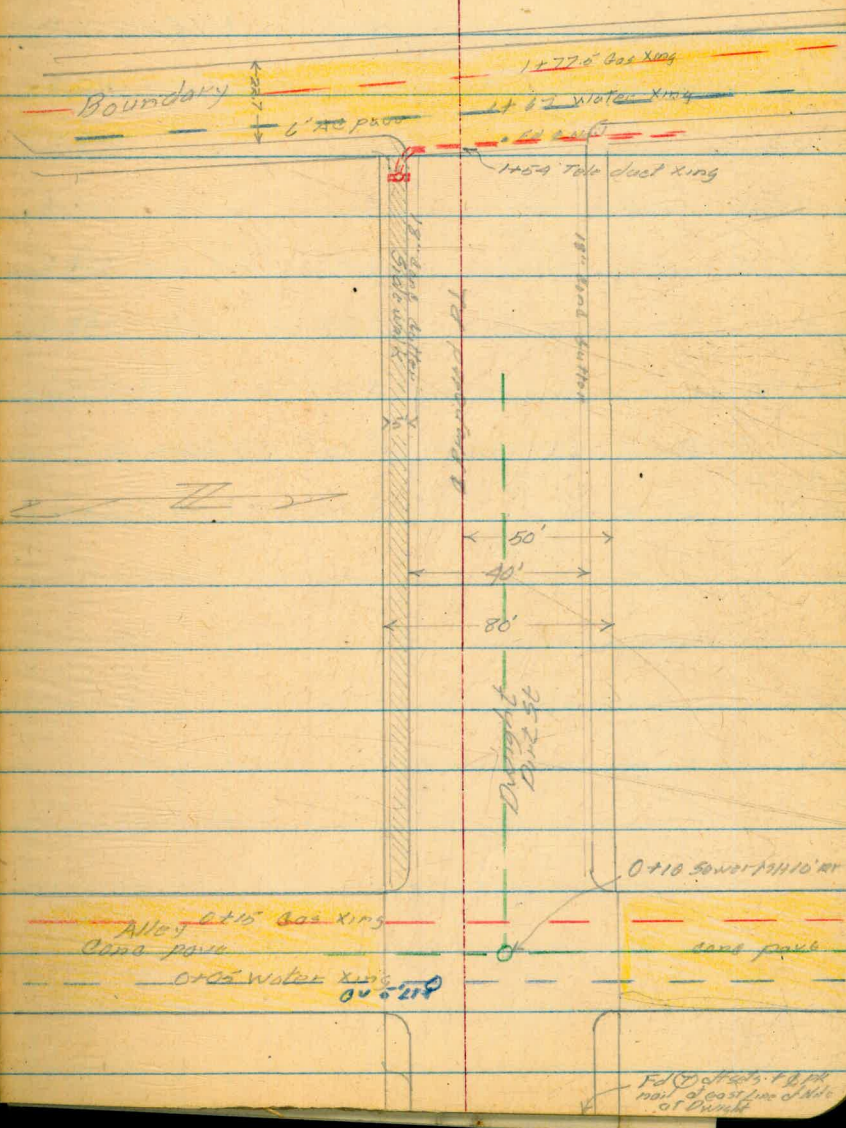

Dwight St
Profile

STA	+	HI	-	EL
B.M.	7.33	324.38		317.05
0+00			2.7	321.7 ✓
0+11			2.08	
0+50	6.25	330.01	0.62	323.76 323.8
1+00			4.7	325.3
+50			5.6	324.4
+55			5.80	324.2
+85.25			5.79	324.2
+85.25			5.30	324.7
T.P. 1.24		325.10	6.15	323.86
CHECK B.M.			8.06	317.04 = 317.05

WEST
WILLIAMS
VARONFAKIS X
KELLHOFER †

8/27/54
CLOUDY

11

NEEP Dwight + Nile

M.H. 10' RT. SOUTH RIM. 4.4 TO FLOW LINE

BEGIN A.C.

BOTTOM CURB

TOP CURB

F.H. ALLEY E. BOUNDARY ON DWIGHT

34th St Monroe to
Alley S of Adams

WEST
WILLIAMS
VARONFAKIS
KELLHOFER

9/1/54

12

	251	391.22	388.71			
0+19			4.8	386.4	382.0	C4 ⁴
+50			5.3	385.9	382.1	C3 ⁸
1+00			4.8	386.4	382.2	C4 ²
+50			4.6	386.6	382.5	C4 ³
2+00			4.2	387.0	382.4	C4 ⁶
+50			4.2	387.0	382.6	C4 ⁴
3+00	5.85	392.88	4.19	387.03	382.7	C4 ³
+50			5.7	387.2	382.9	C4 ³
4+00			5.7	387.2	383.1	C4 ¹
+50			5.5	387.4	383.2	C4 ²
5+00			5.3	387.6	383.4	C4 ²
+50			5.3	387.6	383.5	C4 ¹
6+00			5.1	387.8	383.7	C4 ¹
+50			5.1	387.8	383.9	C3 ⁹
7+00			4.9	388.0	384.0	C3 ⁸
+50			4.5	388.4	384.2	C4 ²
8+00	5.11	393.72	4.27	388.61	384.2	C4 ⁴
+50			5.0	388.7	384.3	C4 ⁴

BM SE BP 34th & Monroe Ave

C4⁴ Begin Work

39372

9+00	4.9	388.8	384.4	C 4 ⁴
+50	4.9	388.8	384.4	C 4 ⁴
10+00	4.9	388.8	384.4	C 4 ⁴
+50	4.9	388.8	384.5	C 4 ³
11+00	5.0	388.7	384.6	C 4 ¹
+50	4.8	388.9	384.6	C 4 ³
12+00	4.9	388.8	384.6	C 4 ²
+50	4.8	388.9	384.7	C 4 ²
13+00	4.6	389.1	384.8	C 4 ³
+50	4.5	389.2	384.8	C 4 ⁴
14+00	4.4	389.3	384.9	C 4 ⁴
+11	4.4	389.3	385.0	C 4 ³

3.76 392.77 4.71 389.01

4.65 391.17 6.25 386.52

2.50 388.67 = 388.71

Alley BIK II Park Co
Orange betw 37th & 38th

West
Williams
Varanfakis T
Kallhofer &

HOT

14

9-7-54

STA	+	Hi	-	Fl
B.M.	4.26	372.37		368.11
T.P.	3.56	367.56	8.37	364.00
0+31W			8.0	359.6 359.2
+34E			8.3	359.3 359.1
+81W			7.4	360.2 359.9
1+11E			7.3	360.3 360.5
+34W			6.4	361.2 361.0
+73E			4.9	362.7 362.2
+79W			5.0	362.6 362.2
T.P.	7.67	372.51	2.72	364.84
CHECK				
B.M.			4.38	368.13 = 368.11

B.M. NWBD 38th & Orange

CO ⁴

CO ²

CO ³

FO ²

CO ²

CO ⁵

CO ⁴

MYRTLE AVE. 6" A.C.
ALLEY E. OF 36TH. TO WILSON AVE

STA	+ HI	- EL		
B.M.	0.69	311.74	311.05	
1+45		1.4	310.3	306.6
+50		1.7	310.0	306.2
+65		2.5	309.2	305.5
+65		2.2	309.5	309.8
2+00		4.7	307.0	303.2
2+05		4.5	307.2	307.7
+50		7.7	304.0	300.5
3+00		9.6	302.1	297.9
+50		11.5	300.2	296.0
+79		13.5	298.2	301.7
4+00		12.6	299.1	295.4
+50		11.5	300.2	296.6
5+00		7.3	304.4	299.6
+16		5.4	306.3	304.7
+50		3.6	308.1	302.6
+75		3.6	308.1	306.1
875		3.4	308.3	302.5
6+00		3.8	307.9	302.0
+35		6.1	305.6	300.5
CHECK B.M.	0.69	311.05 = 311.05		

WEST †
WILLIAMS
VARONFAKIS †

9/8/54

15.

TOP EAST EDGE M.H. ON MYRTLE BETWEEN
CHEROKEE + 36TH

C3 $\frac{7}{8}$ BEGIN WORK

C3 $\frac{8}{8}$

C3 $\frac{7}{3}$ F.H. TEE

F0 $\frac{3}{8}$ (5) FH

C3 $\frac{8}{5}$ W.M.S.

F0 $\frac{5}{5}$

C3 $\frac{2}{2}$

C4 $\frac{2}{2}$

C4 $\frac{5}{5}$

F3 $\frac{7}{7}$ W.M.S.

C3 $\frac{6}{6}$

C3 $\frac{8}{8}$

C4 $\frac{6}{6}$

C1 $\frac{5}{5}$ W.M.S.

C5 $\frac{0}{0}$

C2 $\frac{8}{8}$ W.M.S.

C5 $\frac{9}{9}$

C5 $\frac{1}{1}$

C5 END WORK

Evans St
2 to Imperial

	1.39	78.95	77.46
0+50		3.6	75.3 71.2
1+00		5.0	73.9 70.0
1+50		6.4	72.5 69.0
+63 WME		6.7	72.2 72.8
2+00		7.6	71.3 67.8
+15 WME		8.1	70.8 71.8
2+50		8.5	70.4 66.8
+54 WME		8.9	70.0 71.0
+90 WME		9.4	69.5 70.3
3+00		9.4	69.5 65.8
+01 WME		9.6	69.3 70.1
+50		10.2	68.7 64.9
+75		10.5	68.4 64.4
4+00		10.7	68.2 64.2
+30		10.9	68.0 63.8
	1.39	77.46 = 77.46	

West
Williams
Varan Pakis

16

9/10/54

BM NE BP 27 + '2" St
C4 ¹ Begin work
C3 ⁹
C3 ⁵
F0 ⁶
C3 ⁵
F1 ⁰
C3 ⁶
F1 ⁰
F0 ⁸
C3 ⁷
F0 ⁸
C3 ⁸
C4 ⁰
C4 ⁰
C4 ² End of work

29th St. Imperial
to Commercial

West of
Williams
Voronofsky X

9/10/54

17

STA	SEKS for 6" A.C. Main	HT	EL	Main
B.M.	4.26	76.31		72.05
0+50		4.1	72.2	68.8
1+00		5.3	71.0	67.9
+25		5.6	70.7	67.6
+50		5.8	70.5	67.3
+71		5.5	70.8	70.4
2+00		6.0	70.3	66.8
+50		6.4	69.9	66.3
+80		6.0	70.3	69.6
3+00		6.6	69.7	65.8
+08		6.2	70.1	69.4
+34		6.5	69.8	69.2
+50		7.2	69.1	65.3
+50		6.4	69.9	69.0
+75		7.5	68.8	65.0
4+00		7.5	68.8	63.4
+125		7.1	69.2	63.6
+30		7.3	69.0	64.5
CHECK B.M.	4.26		72.05 =	72.05

B.M. SW/BD 29th + Imperial

C3 ⁴	
C3 ¹	
C3 ¹	
C3 ²	
C0 ⁴	W.M.E
C3 ⁵	
C3 ⁶	
C0 ⁷	W.M.E
C3 ⁹	
C0 ⁷	W.M.E
C0 ⁶	W.M.E
C3 ⁸	
C0 ⁹	W.M.E
C3 ⁸	
C5 ⁴	
C5 ⁶	
C4 ⁵	

OSBORN ST 6" A.C. MAIN

COTTONWOOD TO BIRCH

WEST
WILLIAMS
VARONFARIS X

9/10/54

18.

STA	+ H1	- F1				
B.M.	6.13	15.80	9.67			
0+30			6.7	9.1	6.0	C3 1 S.W. COR 7' OFF COTTONWOOD & OSBORN
0+50			6.5	9.3	6.0	C3 3
1+00			6.0	9.8	6.5	C3 3
1+00			5.8	10.0	10.3	F0 3 W.M.F.
1+47			5.4	10.4	10.7	F0 3 W.M.F.
1+50			5.6	10.2	6.9	C3 3
+55			4.7	11.1	10.6	C0 5 W.M.W.
2+00			4.8	11.0	7.3	C3 7
2+00			4.8	11.0	11.2	F0 2 W.M.F.
+02			4.8	11.0	11.0	C0 0 W.M.W.
+36			4.2	11.6	11.4	C0 2 W.M.W.
2+50			3.5	12.3	7.8	C4 5
+55			4.0	11.8	11.6	C0 2 W.M.W.
3+00			1.7	14.1	9.8	C4 3
T.P.						
+12	12.81	28.41	0.20	15.60	14.7	C0 9 W.M.F.
3+50			10.8	17.5	14.1	C3 4
+59			9.8	18.6	18.3	C0 3 W.M.W.
+70			8.1	20.3	19.3	C1 0 W.M.F.
4+00			6.3	22.1	18.5	C3 6

15.60
13.41
19.01
1.50
18.5

15.6
1.9
17.5

OSBORN ST. CONT.

STA	+ HI	- E1
B. 4+00	28.41	5.522.922.1
O. +07		4.923.522.7
17 +50		2.426.022.8
1+ T.P.	7.18 34.94	0.6527.76
17 4+88		6.428.525.3
17 4+88		5.129.829.4
5+00		5.329.626.0
2- +10 CHECK		4.630.326.4
2- T.B.M.		5.1729.77=29.76

WEST
WILLIAMS
VARONFAKIS

9/10/54

19.

C0 ⁸	W.M.F.
C0 ⁸	W.M.F.
C3 ²	
C3 ²	F.H. TEE
C0 ⁴	(5') & F.H.
C3 ⁶	
C3 ⁹	END WORK
S.W. COR. 7' OFF OSBORN & BIRCH	

Delta St 45th
Location of Water Meters

Note see City Eng Cross Sect FB 2307
Page 52

West
Williams
Varonakis
Kallhofer

9/14/64

12+95.92

20

132

1310.1

12+95.92

16.5

1312.4

12+95.92 ♂ 0° 19' 15" Lt

45th St

13+12.4

1312.4

4+48.51

POT

0+00

E1 43rd St

see FB 2307

Page 52

MEMORANDUM
CITY OF SAN DIEGO, CALIFORNIA

S. DATE

FOR INFO
FOR YOU
RETURN
TO ME
RECORDS
SECTION
COMMENT
DATE
REPORT
TO ME
INFO -
PREPARE
ACTION
FILE

1. FROM (Name and Dept.)

Bob Huntington

2. DATE

9-10-54

3. TO (In order indicated below, for purpose checked at right):

L. Hill

	LOOK TO THIS	ACTION	PREPARE REPLY	INFORM ACTION	REPORT TO ME	WRITTEN COMMENT	SIGNATURE NEEDED	RETURN TO ME	COPY FOR YOU	FILE
1.										
2.										
3.										
4.										
5.										

4. SUBJECT

Request No 295 dated 8-10-54

5. COMMENTS

The location of the south line of Wells Street for 1/2 block East and West of 45th Street was requested. The question at issue was, are the meters on private property or in the street. We haven't heard definitely concerning this.

Delta St 45th
Location of Water Meters

Note see City Eng Cross Sect FB 2307
Page 52

12+95.92 Δ 0° 19' 15" Lt 45th St

4+48.51 POT

0+00 EL 43rd St

See FB 2307
Page 52

West
Williams
Varonakis
Kellhofer

9/14/64

19+18.4 24° Lt to Fire Hyd

EL 5' x 8" Hub

EL 5' x 8" NET

→

Delta St 10' W

19+70.1
12.7 RT
Co Back of
Water Meter

12+97.9
12+96.9
12+95.9 14.25 RT to Back of
Meters

12+62 15 RT Co WM

12+18 13 RT Co WM

11+65 15 RT Co WM

11+13 14 RT to Back of
Water Meter

Transit Line 5' Street

12+90.4
12.2
13+04.1

13+35.9
16.5
13+29.4

20

Property Line
05 ft of 90°

Proposed Driveway

90°

← 20' → 20' →

Dwight St

Alley East of Boundary to
Group 18

B.M.	6.72	330.58	323.86
0+05		8.7	321.9
+25		8.1	322.5 319.0
+50		7.0	323.6 320.0
+75		6.0	324.6 321.0
1+00		5.3	325.3 321.8
+50		6.2	324.4 321.8
+70		6.4	324.2
		6.72	323.86 = 323.86

West
Williams X
Varnforks
Alexander †

21

11:00 P.M.

7-19-55 L.T. RAIN

see page 11

Top FH Alley E of Boundary on Dwight

C3 $\frac{5}{6}$
 C3 $\frac{6}{6}$
 C3 $\frac{6}{6}$
 C3 $\frac{5}{6}$
 C2 $\frac{6}{6}$

Town & Country Hotel
Stadia Survey

Club
Town & Country



West
Williams
Vorontskis
Alexander

27

7-19-65

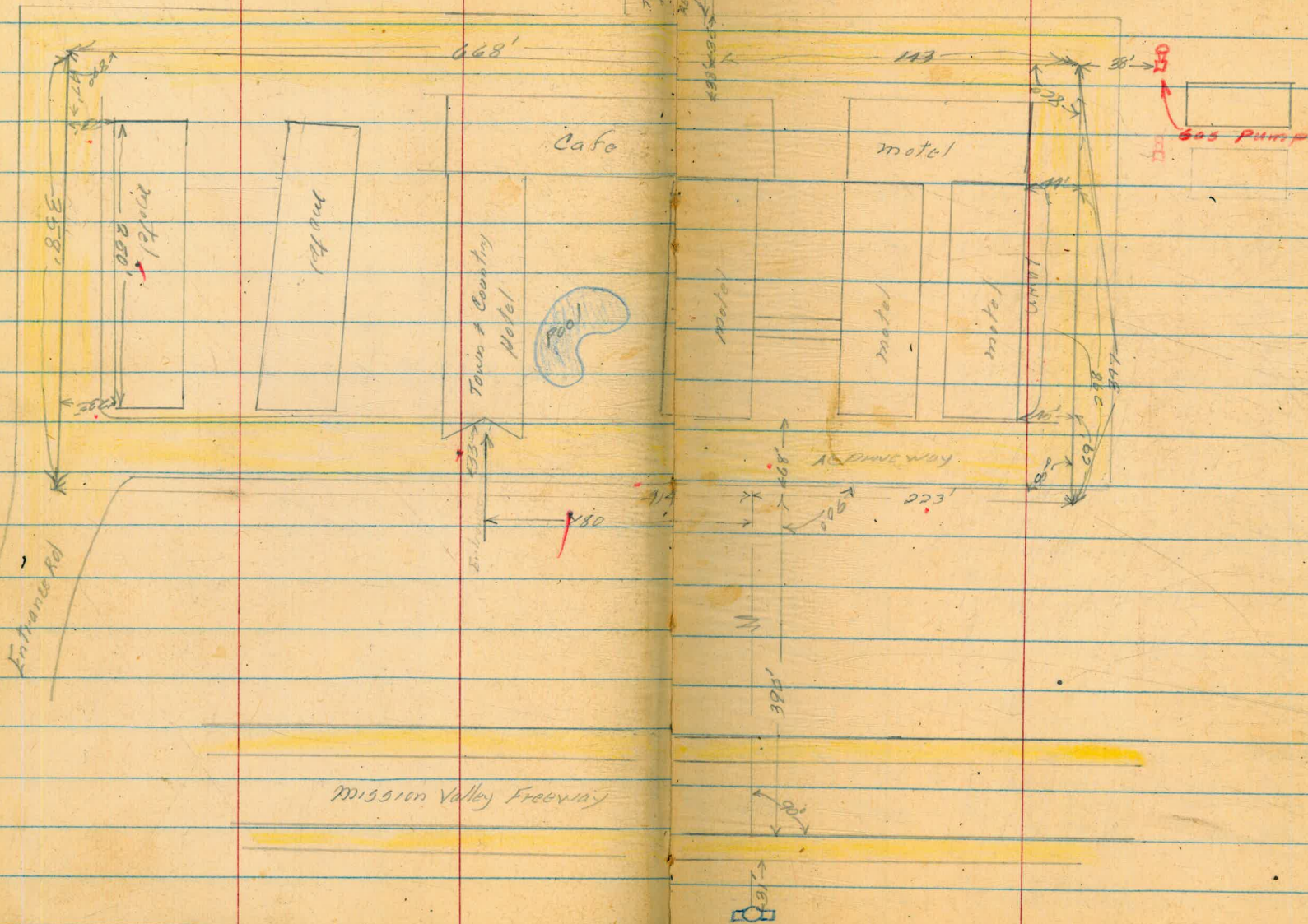

Delta St
45th to 46th
Puljin Group 25

2+00 ± 9 Fly prop line 46th

3+45 ± POT

0+30 ±

0° 19' 10" LT

see FD 2307 P 63

West
Williams
Varonfakis
Alexander

23

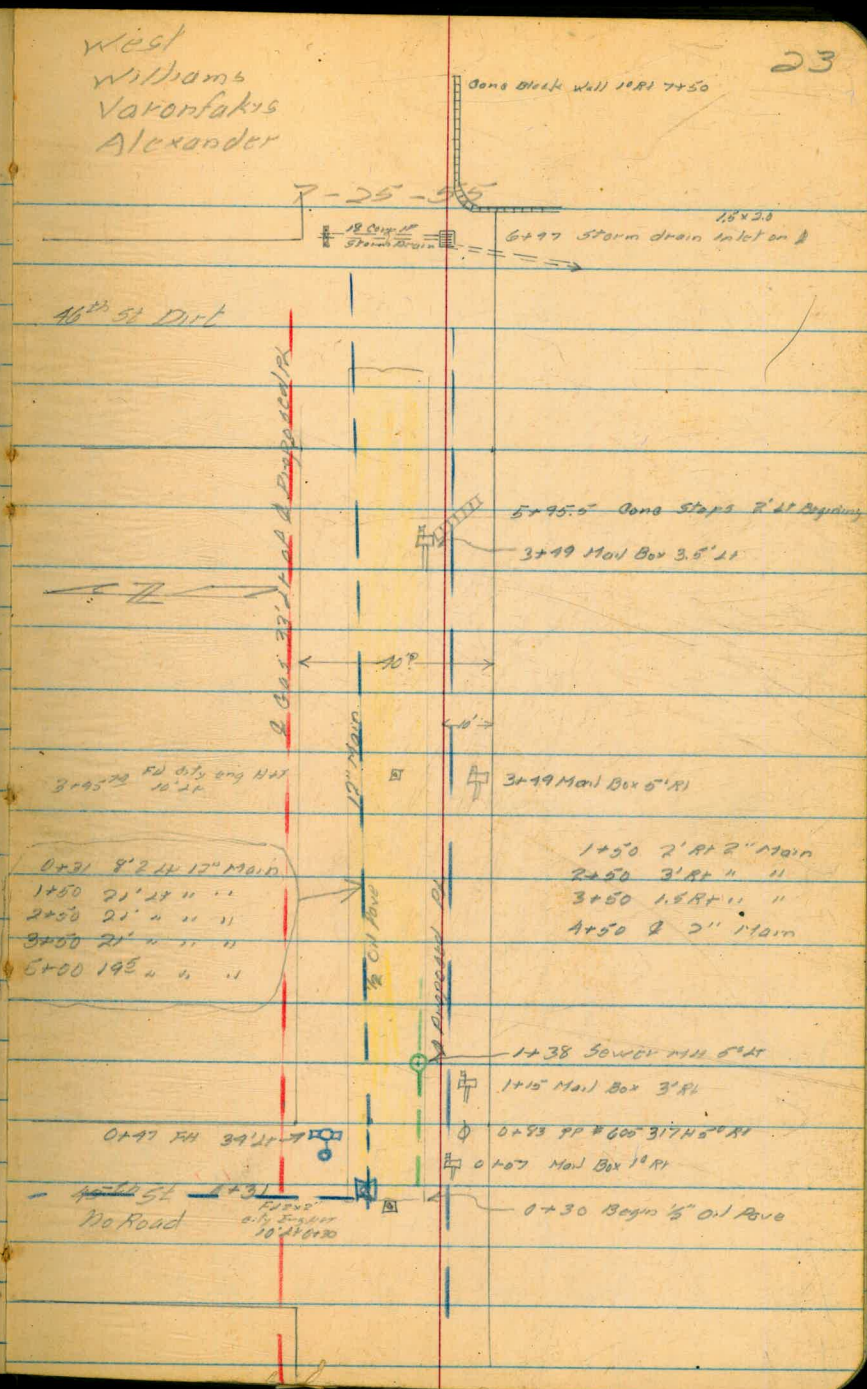

Profile

70.75
10.93
59.82

0+10 34.21 2.4
61.01 Fire Hyd
60.23
70.75 32.20 38.1
70.80
70.79

Lt

Rt

1' Lower than PK No. 1

BM Nail in DP P 975296 30' Lt 0+30

10.83	77.81	61.01
0+00	12.4	59.4
0+30	10.8	61.0
0+50	9.9	61.9
1+00		
1+38	6.77	
1+50	6.5	65.3
2+00	5.2	66.6
2+50	4.1	67.7
3+00	2.85	68.99

14.5
40' Lt

11.8 10.1
5.81 1.4 Rt

11.8 11.1 10.8 10.9
40' Lt 33.2 15' Lt 31.4

9.9
15' Rt

9.9
40' Lt

8.8
15' Rt

8.2 8.2 8.3
40' Lt 25 2' Lt
edge oil →

8.2 8.1
1' Rt 15' Rt

4.9 to flow

Top South side sewer MH 5' Lt

6.3 7.3
40' Lt 28' Lt

6.6
15' Rt

4.9 5.8 5.6 5.24
40' Lt 38.4 35 9' Lt

5.9
15' Rt

4.0
40' Lt

4.4
15' Rt

1.2 2.6 3.08 2.90
40' Lt 32.5 25' Lt 12'

2.8
10' Rt

ALLEY BK 12 CITY HTS ANNEX
 North of Landis East of 45th
 STKS For 6" AC Main (4)

B.M.	2.54	349.91		347.37
T.P.	11.11	354.28	6.74	343.17
0+70			7.0	347.3 344.0
+75			6.7	347.6 344.0
1+00			4.8	349.5 345.5
+50			3.1	351.2 347.2
2+00			2.7	351.6 347.4
T.P.	5.01	356.91	2.38	351.90
+50			5.1	351.8 347.7
+75			5.0	351.9 347.8
3+00			4.9	352.0 347.8
+25			5.1	351.8 347.9
+50			5.2	351.7 347.8
4+00			5.3	351.6 347.6
+50			5.4	351.5 347.4
5+00			5.7	351.2 347.2
+50			5.8	351.1 347.0
6+00			6.1	350.8 346.8
+50			7.5	349.4 345.6

West
 Williams
 Varonfakis &
 Kellhofer &

SUNNY
 3/12/56

26

ON NW BP 45th + Wightman

C3 ³ No CUT BEGIN WORK.

C3 ⁶ 6" G.V.

C4 ⁰

C4 ⁰

C4 ²

C4 ¹

C4 ¹

C4 ²

C3 ⁹

C3 ⁹ (3)

C4 ⁰

C4 ¹

C4 ⁰

C4 ¹

C4 ⁰

C3 ⁸

ALLEY BLK. 12 CONT.

356.91

3/12/56

6+75

8.5 34 8.4 344.3

C4 ¹

7+00

9.1 34 7.8 344.2

C3 ⁶

+30

9.2 34 7.7 344.0

No CUT END WORK

T.P 5.18

353.00

9.09 347.82

CHECK

B.M

4.60 348.40 = 348.37

45+ DWIGHT N.W.B.P.

33rd ST THORN TO UPAS

STKS Per 6" AC Main

West
Williams x
Varonfakis
Kellhofer +

28

3112156

SUNNY

7.83 322.63 319.80

BM SW BR 33rd + THORN

0+35

7.5 315.1

Begin Work

+50

7.4 315.2 311.6

C3

6

1+00

7.5 315.1 311.8

C3

3

+50

6.9 315.7 312.2

C3

5

2+00

6.5 316.1 312.7

C3

4

+50

6.1 316.5 313.1

C3

4

3+00

5.5 317.1 313.6

C3

5

+50

5.1 317.5 314.0

C3

5

4+00

4.6 318.0 314.5

C3

5

+50

4.2 318.4 314.9

C3

5

+73 ³² 50

4.0 318.6 315.2

C3

4

461 323.57 307318.96

5+00

5.1 318.5 315.0

C3

5

+25

5.1 318.5 314.9

C3

6

+50

5.1 318.5 314.7

C3

8

+75

5.2 318.4 314.6

C3

8

6+00

5.2 318.4 314.5

C3

9

+25

5.3 318.3 314.4

C3

9

33RD St. CONT.

323.57

6+50

56 318.0 314.4

C3 ⁶

+75

57 317.9 314.3

C3 ⁶

7+00

58 318.3 313.0

C5 ³

+14

56 318.0

end of work

5.03 323.57 501 318.56

= 318.45 NW BP 33rd + Upas

878 314.81 = 314.80

NW 33rd + Upas
318.45

312/56

29

GUY ST. PRINGLE ST TO 240' NW

STKS For 6" AD

Group 101

276	199.22	196.46	
0+15.		27	196.5 193.5
+20		23	196.9 193.5
+50		2.0	197.2 193.5
1+00		1.9	197.3 193.5
+50		2.9	196.3 192.7
2+00		3.9	195.3 191.9
+25		5.3	193.9 190.6
+50		7.4	191.8 188.5
+90		12.4	186.8 183.0
		2.75	196.47 = 196.46

West
Williams T
Varonfakis
Kellhofer ?

3/13/56

31

Sunny

BM (13') at Guy + Pringle SEly Cor

c3⁰ Begin work

c3⁴ G.V.

c3² 17

c3⁸ 19

c3⁶

c3⁴

c3³

c3³

c3⁸

end of work

COURT WAY
HAWK TO 190' East

STKS FOR 4" AC
Group 101

180	21 6.27	214.47
0+35	28	213.5 209.4
+50	38	212.5 208.6
1+00	6.0	210.3 206.4
+50	9.1	208.2 204.2
+75	9.3	207.0 203.0
2+00	11.3	205.0 201.0
+20	13.0	203.3 199.0
	180	214.47 =

West
Williams &
Varon Pakist
Kellhofer

3/13/56

SUNNY + WARM

32

SE RD HAWK + Court Way
C4 ¹ Begin Work 32 213.1
C3 ² 39 212.7
C3 ³ 61
C4 ⁴ 81
C4 ⁵ 114
C4 ⁶ 132
214.47

UPAS 57 ALBERT TO Richmond
 STKS for 6" AC Main

West
 Williams &
 Varonakis
 Kallhagen &

Sunny + Warm
 3/13/56

NWBP Bill only 293.94

	4.28	291.25	286.97
STUB line on Albert St			
0+30	4.0	287.3	283.2
0+15 End of work	4.1	287.2	283.2
UPAS 31			
0+30	4.2	287.1	283.2
+50	4.5	286.8	283.0
1+00	4.5	286.8	282.5
+50	4.9	286.4	282.0
2+00	5.2	286.1	281.5
+50	5.7	285.6	281.0
3+00	6.8	284.5	280.6
+25	7.0	284.3	280.3
+32 ⁵ FH Tee	6.4	284.9	280.2
+50	7.2	284.1	280.0
+53 Tee	7.3	284.0	279.9
+60	7.4	283.9	279.8
	7.32	283.93	= 283.94

	NWBP Albert + Upas	1
C4	1	6x6 Tee begin work @ pipe
C4	0	
	9	
C3	8	begin work
C3	3	
C4	4	4.9 286.4
C4	6	5.4 285.9
C4	6	5.9 285.5
C4	9	6.2 285.1
C3	0	
C4	7	6.9 284.7
C4	1	
C4	1	
C4	1	
C4	1	end of work

NWBP Upas + Richmond

MISSION VALLEY INN SUBDIVISION
Camino Del Rio Access Rd
8" AC Main

West
Williams x
Varanfakis
Kellhofer +

34.

3/19/56

500 FB 895 PGI

TBM Core Mark 39' East Sta 0+28

Begin Work

7.58	23.60	16.02		
0+19	6.0	17.6	12.0	C5 ⁶
+25 TOP	6.5	17.1	12.0	C5 ¹
+50	7.4	16.2	11.9	C4 ³
+75	7.9	15.7	11.8	C3 ⁹
1+00	7.4	16.2	12.2	C4 ⁰
+23.89 split angle	6.4	17.2	12.6	C4 ⁶
+50	6.6	17.0	13.1	C3 ⁹
2+00	6.0	17.6	14.0	C3 ⁶
+50	4.8	18.8	14.8	C4 ⁰
+98.72 BC	4.5	19.1	15.8	C3 ³
3+50	3.7	19.9	15.5	C4 ⁴
4+00	3.6	20.0	15.3	C4 ⁷
+50	3.1	20.5	15.1	C5 ⁴
+85 FH TCC	4.1	19.5	15.0	C4 ⁵
+85 @ 260 R FH	22.80	34.0	20.20 21.6	F1 ⁴ C5 ² To Ell.
5+00	3.4	19.9	14.9	C4 ⁵
+14.2 EC	3.7	19.1	14.8	C4 ³
+50	4.7	18.1	14.7	C3 ⁴

MISSION VALLEY INN CONT.

35.

3/19/52

22.80

5+165.92 BC	4.8	18.0	14.6
+75	4.9	17.9	14.6
6+00	4.9	17.9	14.5
+25	4.7	18.1	14.4
+50	4.5	18.3	14.3
+66 ⁸⁹ EC	4.7	18.1	14.2
7+00	4.6	18.2	14.0
+50	3.1	19.7	13.8
8+00	2.7	20.1	10.6
+15	5.0	17.8	10.6
	5.04	17.76	= 17.80

C3 ⁴
 C3 ³
 C3 ⁴
 C3 ⁷
 C3 ⁰
 C4 ⁹
 C3 ⁹
 C4 ²
 C5 ⁹
 C9 ⁵
 C7 ²

End of Work

TBM 1" diam pipe 4' RL 8+15 See FB895 p.61

PECK PL College Ave
to 320 East

Stks for A' AC ^{5th vertical Pison} Meters Set 10 81+25 4

3.83 419.95 466.12

5.90 471.58 427 465.68

2.39 467.56 6.41 465.17

0+50 6.0 461.6

=0+70 BK 22% Bend

0+80 AH 6.3 461.3 458.1

0+85 FH Tree 6.2 461.4 458.1

0+85 FH 5.55 462.01 462.01

1+00 6.3 461.3 458.1

+50 7.1 460.5 456.6

1+91.19 AH Split

1+78.46 AH 7.6 460.0 455.6

2+00 9.9 458.7 455.0

South

+23 Wat 10.7 456.9 456.0

+32 11.2 456.4 454.3

+43 10.8 456.8 454.2

+50 10.5 457.1 454.2

Water

+61 South 10.5 457.1 456.1

+67 10.6 457.0 454.1

Wat

+90 North 9.9 457.7 456.9

3+00 10.4 457.2 454.1

West
Williams X

Varon Foster
Kellhofer

36

SUNNY + WARM

3/29/56

BM NWAD 59th + E2 Cajon Blvd

C To EXIST. Begin work

C3 ²

C3 ³

C0 ⁰

on side walk

C3 ²

C3 ⁹

2+32 456.4

C4 ⁴

Top 21' Drgn 453.9

C3 ⁷

C0 ⁹

4593

C2 ¹

C2 ⁶

C2 ⁹

C1 ⁰

61.01

C2 ⁹

C0 ⁸

61.86

C3 ¹

PECK. PL. CONT

87.

467.56

3/29/50

3+19

10.1 457.5 454.0

C3

⁵

4.35 471.55 2.36 465.20

TAM SW Light Signal El Cajon + College

4.30 469.92 6.93 465.68

3.80 466.18 =

466.18

1044A ST Monroe to Meade Ave
Pekin Group 28

7+27³ Sly Cb Line Meade

6+67¹⁴ POT opp (D) 1st NE Cor Meade + Iowa

0+07 POT

0+00 Nly prop line Iowa St to East

West
Williams
Varonfakis
Kellhofer

38

3/30/66

← Meade Ave ← ○

7+27³ South Cb Meade

7" AC Water 9" Ring

7" AC Pave

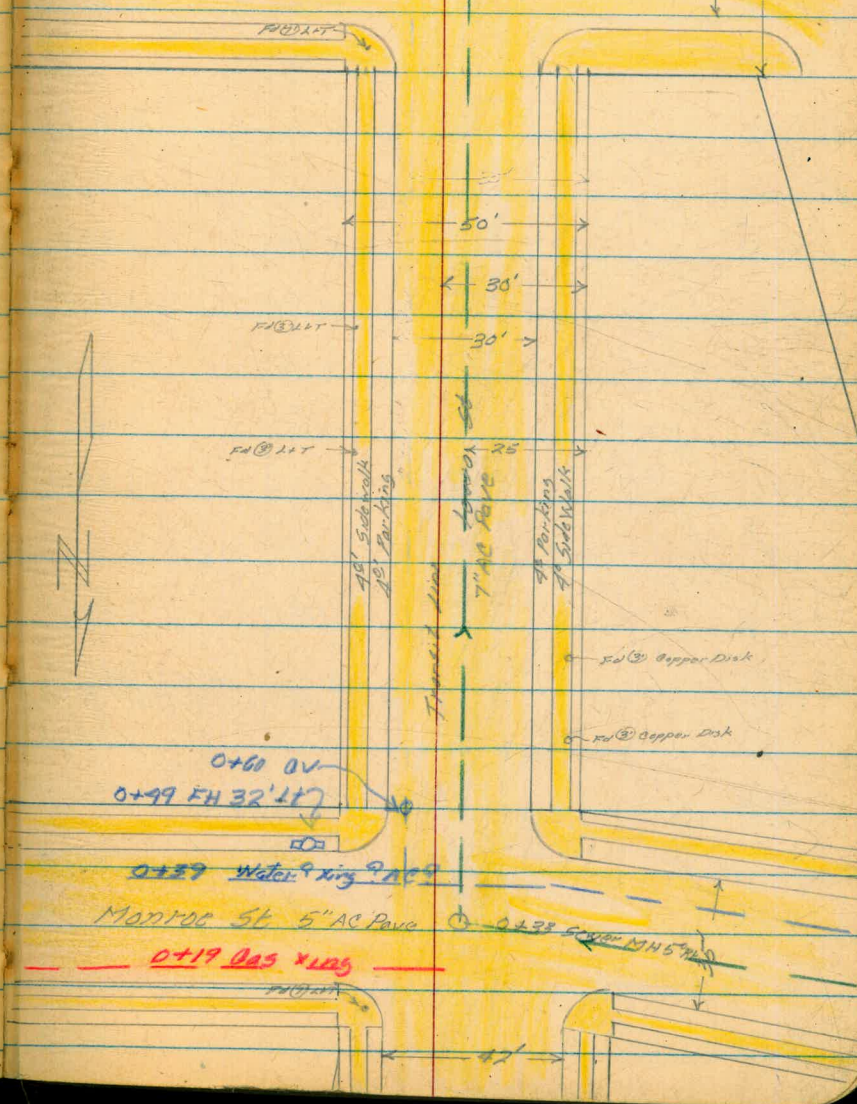

Iowa St Transit Line Profile

Redc'd
by Rocky

Station	Left Column	Right Column	Right Column	Notes
3+19	388.70	385.21		SE BP Boundary St + Monroe
0+00		5.00	383.7	5.15 5' RT NH prop Line Monroe
0+33		4.89	383.7	+5.5' To Flow 4' RT Top east rim Sewer MH
0+50		5.01	383.7	5.2 5' RT
1+00		5.05	383.6	5.30 5' RT
+50		5.12	383.6	5.40 5' RT
2+00		5.34	383.4	5.54 5' RT
+50		5.55	383.2	5.76 5' RT
3+00		5.62	383.1	5.81 5' RT
+50		5.75	383.0	5.98 5' RT
JP	4.45	387.37	5.78	382.92
4+00		4.51	382.9	4.77 5' RT
+50		4.59	382.8	4.94 5' RT
+76		4.51	382.8	5.11 5' RT
5+00		4.69	382.7	4.99 5' RT
+50		4.84	382.5	5.10 5' RT
6+00		4.97	382.4	5.16 5' RT
+50		5.18	382.2	5.16 5' RT
+73		5.64	381.7	5.78 5' RT
7+00		5.05	382.3	5.12 5' RT

5' RT Top South rim Sewer MH

utter line

@ Meade

Transit Line Profile 10win St

387.37

7+00

5.00

+5.9 to flow

+27²

5.63

381.7

7.11

380.26

4.57

382.86

Reck'd
by ROCKY

40

5' Rt top dist Run Sewer MH

5.70

5' Lt Sly ob Line Meade

E 380.46 NW BP 32nd + Meade

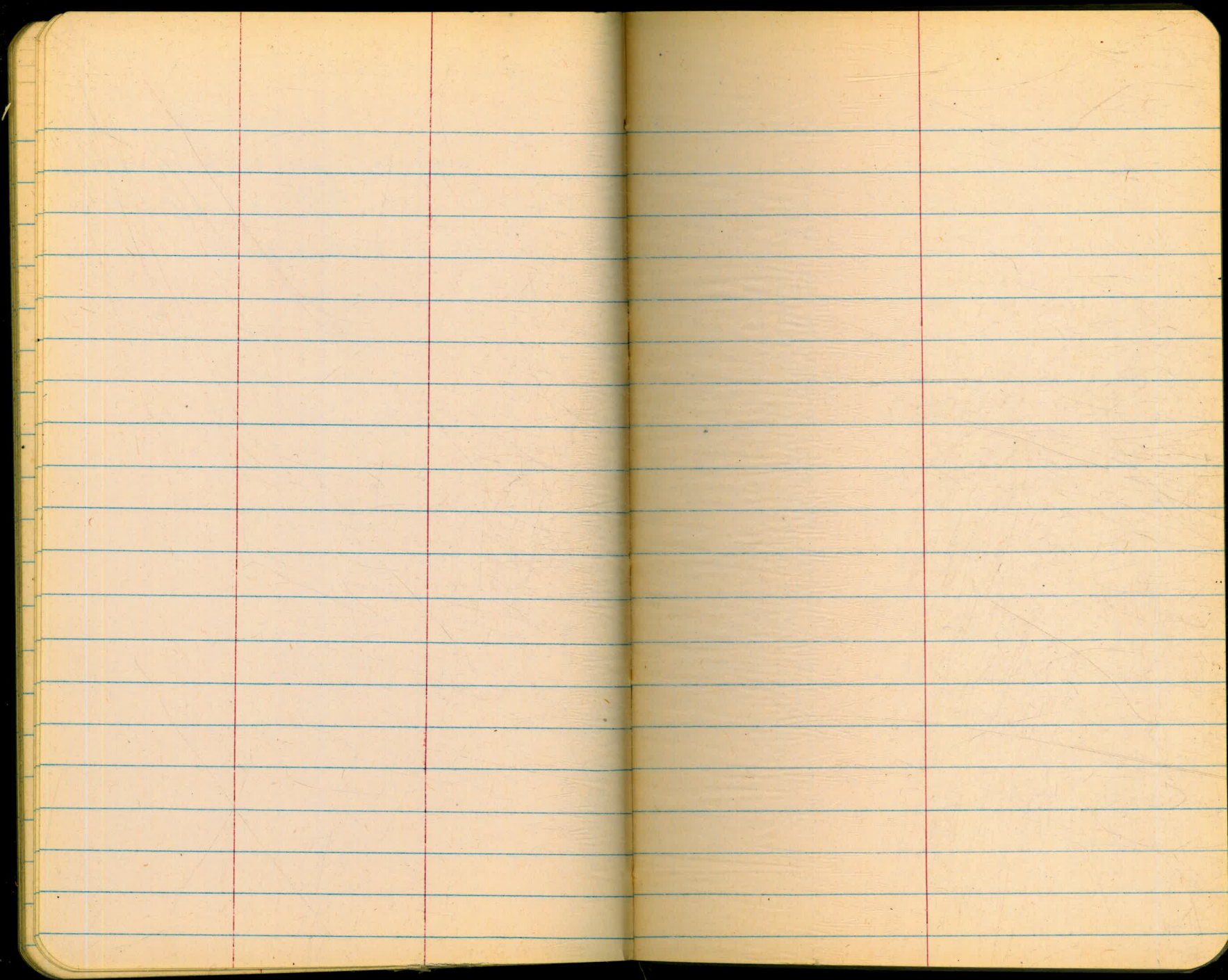

Please Return to
 City of San Diego Water Dept.
 Room 903 Civic Center

391

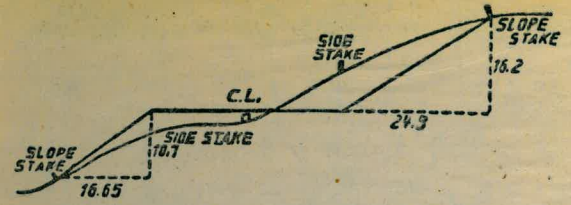

DISTANCES FROM SIDE STAKES FOR CROSS-SECTIONING.
 SLOPE 1 1/2 TO 1. ROADWAY OF ANY WIDTH.

	0	.1	.2	.3	.4	.5	.6	.7	.8	.9	
0	0.00	0.15	0.30	0.45	0.60	0.75	0.90	1.05	1.20	1.35	0
1	1.50	1.65	1.80	1.95	2.10	2.25	2.40	2.55	2.70	2.85	1
2	3.00	3.15	3.30	3.45	3.60	3.75	3.90	4.05	4.20	4.35	2
3	4.50	4.65	4.80	4.95	5.10	5.25	5.40	5.55	5.70	5.85	3
4	6.00	6.15	6.30	6.45	6.60	6.75	6.90	7.05	7.20	7.35	4
5	7.50	7.65	7.80	7.95	8.10	8.25	8.40	8.55	8.70	8.85	5
6	9.00	9.15	9.30	9.45	9.60	9.75	9.90	10.05	10.20	10.35	6
7	10.50	10.65	10.80	10.95	11.10	11.25	11.40	11.55	11.70	11.85	7
8	12.00	12.15	12.30	12.45	12.60	12.75	12.90	13.05	13.20	13.35	8
9	13.50	13.65	13.80	13.95	14.10	14.25	14.40	14.55	14.70	14.85	9
10	15.00	15.15	15.30	15.45	15.60	15.75	15.90	16.05	16.20	16.35	10
11	16.50	16.65	16.80	16.95	17.10	17.25	17.40	17.55	17.70	17.85	11
12	18.00	18.15	18.30	18.45	18.60	18.75	18.90	19.05	19.20	19.35	12
13	19.50	19.65	19.80	19.95	20.10	20.25	20.40	20.55	20.70	20.85	13
14	21.00	21.15	21.30	21.45	21.60	21.75	21.90	22.05	22.20	22.35	14
15	22.50	22.65	22.80	22.95	23.10	23.25	23.40	23.55	23.70	23.85	15
16	24.00	24.15	24.30	24.45	24.60	24.75	24.90	25.05	25.20	25.35	16
17	25.50	25.65	25.80	25.95	26.10	26.25	26.40	26.55	26.70	26.85	17
18	27.00	27.15	27.30	27.45	27.60	27.75	27.90	28.05	28.20	28.35	18
19	28.50	28.65	28.80	28.95	29.10	29.25	29.40	29.55	29.70	29.85	19
20	30.00	30.15	30.30	30.45	30.60	30.75	30.90	31.05	31.20	31.35	20
21	31.50	31.65	31.80	31.95	32.10	32.25	32.40	32.55	32.70	32.85	21
22	33.00	33.15	33.30	33.45	33.60	33.75	33.90	34.05	34.20	34.35	22
23	34.50	34.65	34.80	34.95	35.10	35.25	35.40	35.55	35.70	35.85	23
24	36.00	36.15	36.30	36.45	36.60	36.75	36.90	37.05	37.20	37.35	24
25	37.50	37.65	37.80	37.95	38.10	38.25	38.40	38.55	38.70	38.85	25
26	39.00	39.15	39.30	39.45	39.60	39.75	39.90	40.05	40.20	40.35	26
27	40.50	40.65	40.80	40.95	41.10	41.25	41.40	41.55	41.70	41.85	27
28	42.00	42.15	42.30	42.45	42.60	42.75	42.90	43.05	43.20	43.35	28
29	43.50	43.65	43.80	43.95	44.10	44.25	44.40	44.55	44.70	44.85	29
30	45.00	45.15	45.30	45.45	45.60	45.75	45.90	46.05	46.20	46.35	30
31	46.50	46.65	46.80	46.95	47.10	47.25	47.40	47.55	47.70	47.85	31
32	48.00	48.15	48.30	48.45	48.60	48.75	48.90	49.05	49.20	49.35	32
33	49.50	49.65	49.80	49.95	50.10	50.25	50.40	50.55	50.70	50.85	33
34	51.00	51.15	51.30	51.45	51.60	51.75	51.90	52.05	52.20	52.35	34
35	52.50	52.65	52.80	52.95	53.10	53.25	53.40	53.55	53.70	53.85	35
36	54.00	54.15	54.30	54.45	54.60	54.75	54.90	55.05	55.20	55.35	36
37	55.50	55.65	55.80	55.95	56.10	56.25	56.40	56.55	56.70	56.85	37
38	57.00	57.15	57.30	57.45	57.60	57.75	57.90	58.05	58.20	58.35	38
39	58.50	58.65	58.80	58.95	59.10	59.25	59.40	59.55	59.70	59.85	39
40	60.00	60.15	60.30	60.45	60.60	60.75	60.90	61.05	61.20	61.35	40
41	61.50	61.65	61.80	61.95	62.10	62.25	62.40	62.55	62.70	62.85	41
42	63.00	63.15	63.30	63.45	63.60	63.75	63.90	64.05	64.20	64.35	42
43	64.50	64.65	64.80	64.95	65.10	65.25	65.40	65.55	65.70	65.85	43
44	66.00	66.15	66.30	66.45	66.60	66.75	66.90	67.05	67.20	67.35	44
45	67.50	67.65	67.80	67.95	68.10	68.25	68.40	68.55	68.70	68.85	45
46	69.00	69.15	69.30	69.45	69.60	69.75	69.90	70.05	70.20	70.35	46
47	70.50	70.65	70.80	70.95	71.10	71.25	71.40	71.55	71.70	71.85	47
48	72.00	72.15	72.30	72.45	72.60	72.75	72.90	73.05	73.20	73.35	48
49	73.50	73.65	73.80	73.95	74.10	74.25	74.40	74.55	74.70	74.85	49
50	75.00	75.15	75.30	75.45	75.60	75.75	75.90	76.05	76.20	76.35	50

THE NATIONAL BLANK BOOK COMPANY
 HOLYOKE MASSACHUSETTS
 NEW YORK CHICAGO BOSTON SAN FRANCISCO