

DISTANCES FROM SIDE STAKES FOR CROSS-SECTIONING
SLOPE 1 TO 1. ROADWAY OF ANY WIDTH

	0	.1	.2	.3	.4	.5	.6	.7	.8	.9	
0	0.00	0.10	0.20	0.30	0.40	0.50	0.60	0.70	0.80	0.90	0
1	1.00	1.10	1.20	1.30	1.40	1.50	1.60	1.70	1.80	1.90	1
2	2.00	2.10	2.20	2.30	2.40	2.50	2.60	2.70	2.80	2.90	2
3	3.00	3.10	3.20	3.30	3.40	3.50	3.60	3.70	3.80	3.90	3
4	4.00	4.10	4.20	4.30	4.40	4.50	4.60	4.70	4.80	4.90	4
5	5.00	5.10	5.20	5.30	5.40	5.50	5.60	5.70	5.80	5.90	5
6	6.00	6.10	6.20	6.30	6.40	6.50	6.60	6.70	6.80	6.90	6
7	7.00	7.10	7.20	7.30	7.40	7.50	7.60	7.70	7.80	7.90	7
8	8.00	8.10	8.20	8.30	8.40	8.50	8.60	8.70	8.80	8.90	8
9	9.00	9.10	9.20	9.30	9.40	9.50	9.60	9.70	9.80	9.90	9
10	10.00	10.10	10.20	10.30	10.40	10.50	10.60	10.70	10.80	10.90	10
11	11.00	11.10	11.20	11.30	11.40	11.50	11.60	11.70	11.80	11.90	11
12	12.00	12.10	12.20	12.30	12.40	12.50	12.60	12.70	12.80	12.90	12
13	13.00	13.10	13.20	13.30	13.40	13.50	13.60	13.70	13.80	13.90	13
14	14.00	14.10	14.20	14.30	14.40	14.50	14.60	14.70	14.80	14.90	14
15	15.00	15.10	15.20	15.30	15.40	15.50	15.60	15.70	15.80	15.90	15
16	16.00	16.10	16.20	16.30	16.40	16.50	16.60	16.70	16.80	16.90	16
17	17.00	17.10	17.20	17.30	17.40	17.50	17.60	17.70	17.80	17.90	17
18	18.00	18.10	18.20	18.30	18.40	18.50	18.60	18.70	18.80	18.90	18
19	19.00	19.10	19.20	19.30	19.40	19.50	19.60	19.70	19.80	19.90	19
20	20.00	20.10	20.20	20.30	20.40	20.50	20.60	20.70	20.80	20.90	20
21	21.00	21.10	21.20	21.30	21.40	21.50	21.60	21.70	21.80	21.90	21
22	22.00	22.10	22.20	22.30	22.40	22.50	22.60	22.70	22.80	22.90	22
23	23.00	23.10	23.20	23.30	23.40	23.50	23.60	23.70	23.80	23.90	23
24	24.00	24.10	24.20	24.30	24.40	24.50	24.60	24.70	24.80	24.90	24
25	25.00	25.10	25.20	25.30	25.40	25.50	25.60	25.70	25.80	25.90	25
26	26.00	26.10	26.20	26.30	26.40	26.50	26.60	26.70	26.80	26.90	26
27	27.00	27.10	27.20	27.30	27.40	27.50	27.60	27.70	27.80	27.90	27
28	28.00	28.10	28.20	28.30	28.40	28.50	28.60	28.70	28.80	28.90	28
29	29.00	29.10	29.20	29.30	29.40	29.50	29.60	29.70	29.80	29.90	29
30	30.00	30.10	30.20	30.30	30.40	30.50	30.60	30.70	30.80	30.90	30
31	31.00	31.10	31.20	31.30	31.40	31.50	31.60	31.70	31.80	31.90	31
32	32.00	32.10	32.20	32.30	32.40	32.50	32.60	32.70	32.80	32.90	32
33	33.00	33.10	33.20	33.30	33.40	33.50	33.60	33.70	33.80	33.90	33
34	34.00	34.10	34.20	34.30	34.40	34.50	34.60	34.70	34.80	34.90	34
35	35.00	35.10	35.20	35.30	35.40	35.50	35.60	35.70	35.80	35.90	35
36	36.00	36.10	36.20	36.30	36.40	36.50	36.60	36.70	36.80	36.90	36
37	37.00	37.10	37.20	37.30	37.40	37.50	37.60	37.70	37.80	37.90	37
38	38.00	38.10	38.20	38.30	38.40	38.50	38.60	38.70	38.80	38.90	38
39	39.00	39.10	39.20	39.30	39.40	39.50	39.60	39.70	39.80	39.90	39
40	40.00	40.10	40.20	40.30	40.40	40.50	40.60	40.70	40.80	40.90	40
41	41.00	41.10	41.20	41.30	41.40	41.50	41.60	41.70	41.80	41.90	41
42	42.00	42.10	42.20	42.30	42.40	42.50	42.60	42.70	42.80	42.90	42
43	43.00	43.10	43.20	43.30	43.40	43.50	43.60	43.70	43.80	43.90	43
44	44.00	44.10	44.20	44.30	44.40	44.50	44.60	44.70	44.80	44.90	44
45	45.00	45.10	45.20	45.30	45.40	45.50	45.60	45.70	45.80	45.90	45
46	46.00	46.10	46.20	46.30	46.40	46.50	46.60	46.70	46.80	46.90	46
47	47.00	47.10	47.20	47.30	47.40	47.50	47.60	47.70	47.80	47.90	47
48	48.00	48.10	48.20	48.30	48.40	48.50	48.60	48.70	48.80	48.90	48
49	49.00	49.10	49.20	49.30	49.40	49.50	49.60	49.70	49.80	49.90	49
50	50.00	50.10	50.20	50.30	50.40	50.50	50.60	50.70	50.80	50.90	50

Distance of slope stake from side or shoulder stake for any width roadway, slope 1 to 1. If ground is nearly level, the cut or fill at side stake is located by the double entry method in left column and top row. The number in body of table in same row and column gives distance from side stake to slope stake. If ground is not level estimate the difference in elevation between the side stake and slope stake, lower target by this amount if cut, elevate if fill. Add this amount to cut or fill and find distance in table. Set up rod at this point, and line of sight should cut target. If it does not make the slight adjustment necessary.

Please Return to
City of San Diego Water Dept.
Room 903 Civic Center

TABLE XIII—CORRECTIONS FOR TANGENTS AND EXTERNALS

These corrections are to be added to the approximate values, found by dividing the tangent, or external, for a 1° curve (Table VIII) by the degree of curve, in order to obtain the true tangents, or externals. Intermediate values may be obtained by interpolation.

FOR TANGENTS ADD

Central Angle	DEGREE OF CURVE													
	5°	10°	15°	20°	25°	30°	35°	40°	45°	50°	55°	60°	65°	70°
10°	.03	.06	.09	.13	.16	.19	.22	.25	.28	.31	.34	.38	.42	.46
15°	.04	.10	.14	.19	.24	.29	.34	.39	.45	.51	.53	.58	.63	.68
20°	.06	.13	.19	.26	.32	.39	.45	.51	.58	.65	.72	.79	.84	.90
25°	.08	.16	.24	.33	.40	.49	.58	.67	.75	.83	.90	.99	1.06	1.14
30°	.10	.19	.29	.39	.49	.59	.69	.79	.89	.99	1.09	1.20	1.29	1.39
35°	.11	.22	.34	.47	.58	.69	.79	.81	.92	1.04	1.29	1.42	1.54	1.66
40°	.13	.26	.40	.53	.67	.80	.93	1.06	1.20	1.34	1.49	1.64	1.79	1.94
45°	.15	.30	.44	.60	.76	.91	1.06	1.21	1.37	1.52	1.70	1.87	2.04	2.21
50°	.17	.34	.51	.68	.85	1.02	1.19	1.36	1.54	1.72	1.91	2.10	2.29	2.48
55°	.19	.38	.57	.76	.95	1.14	1.32	1.52	1.72	1.92	2.14	2.35	2.56	2.77
60°	.21	.42	.63	.84	1.05	1.27	1.49	1.71	1.94	2.17	2.38	2.60	2.83	3.07
65°	.23	.46	.69	.93	1.16	1.40	1.64	1.88	2.13	2.38	2.63	2.88	3.13	3.39
70°	.25	.51	.76	1.02	1.28	1.54	1.80	2.06	2.33	2.60	2.88	3.16	3.44	3.72
75°	.27	.56	.83	1.12	1.40	1.69	1.98	2.27	2.57	2.87	3.16	3.47	3.78	4.09
80°	.30	.61	.91	1.22	1.53	1.84	2.15	2.46	2.78	3.10	3.44	3.78	4.12	4.46
85°	.33	.66	1.00	1.33	1.68	2.02	2.36	2.70	3.05	3.40	3.77	4.14	4.55	4.89
90°	.36	.72	1.09	1.45	1.83	2.20	2.57	2.94	3.32	3.70	4.10	4.50	4.91	5.32
95°	.39	.79	1.19	1.55	1.92	2.30	2.67	3.04	3.42	3.81	4.22	4.63	5.04	5.45
100°	.43	.86	1.30	1.74	2.18	2.62	3.06	3.50	3.95	4.40	4.88	5.37	5.85	6.34
110°	.51	1.03	1.56	2.08	2.61	3.14	3.67	4.21	4.76	5.31	5.86	6.43	7.01	7.60
120°	.62	1.25	1.93	2.52	3.16	3.81	4.45	5.11	5.77	6.44	7.12	7.80	8.50	9.22

FOR EXTERNALS ADD

Central Angle	DEGREE OF CURVE													
	5°	10°	15°	20°	25°	30°	35°	40°	45°	50°	55°	60°	65°	70°
10°	.001	.003	.004	.006	.007	.008	.009	.011	.012	.014	.015	.017	.018	.020
15°	.003	.007	.010	.014	.018	.023	.027	.032	.035	.039	.043	.047	.051	.055
20°	.006	.011	.017	.022	.028	.034	.038	.045	.051	.057	.063	.070	.076	.083
25°	.009	.018	.027	.036	.046	.056	.065	.074	.083	.093	.106	.120	.127	.135
30°	.013	.025	.038	.051	.065	.078	.090	.103	.116	.129	.149	.170	.179	.188
35°	.018	.035	.054	.072	.086	.109	.131	.153	.175	.197	.213	.230	.247	.264
40°	.023	.046	.070	.093	.117	.141	.172	.203	.234	.265	.277	.290	.315	.341
45°	.030	.060	.093	.119	.153	.184	.216	.254	.289	.325	.351	.378	.411	.445
50°	.037	.075	.116	.151	.189	.227	.266	.305	.345	.384	.425	.467	.508	.550
55°	.046	.093	.142	.188	.236	.283	.332	.381	.420	.479	.530	.582	.641	.700
60°	.056	.112	.168	.225	.283	.340	.398	.457	.516	.575	.636	.697	.774	.851
65°	.067	.135	.204	.273	.343	.412	.483	.554	.625	.697	.771	.845	.922	1.01
70°	.080	.159	.240	.321	.403	.485	.568	.652	.735	.819	.906	.994	1.08	1.17
75°	.095	.182	.266	.353	.440	.528	.617	.707	.797	.887	1.07	1.18	1.29	1.39
80°	.110	.220	.332	.445	.558	.671	.787	.903	1.02	1.13	1.25	1.38	1.50	1.62
85°	.128	.259	.391	.524	.657	.790	.926	1.06	1.20	1.34	1.47	1.62	1.76	1.91
90°	.149	.299	.450	.603	.756	.910	1.07	1.22	1.38	1.54	1.70	1.87	2.03	2.20
95°	.174	.350	.522	.706	.885	1.06	1.25	1.43	1.62	1.80	1.99	2.18	2.38	2.58
100°	.200	.401	.604	.809	1.01	1.22	1.43	1.64	1.85	2.06	2.28	2.50	2.73	2.96
110°	.268	.536	.806	1.08	1.35	1.63	1.91	2.20	2.48	2.76	3.05	3.35	3.66	3.96
120°	.360	.721	1.08	1.45	1.82	2.19	2.57	2.95	3.33	3.72	4.11	4.50	4.91	5.32

Index

Paving Check (1952-53 Work Program)

SCHEDULE "B-1"

Page

FRANKFORT... MILTON to INGULF 3.

DENVER " 4.

CHICAGO " 5.

ERIE " 6.

GAINES... BENICIA to FRESNO 7.

FRESNO... RILEY to YUMA 8.

MOORE... AMPUDIA to CONDE 9.

JEFFERSON... ARISTA to HARNEY... 10.

WINONA... UNIVERSITY to POLK... 11.

50th " WIGHTMAN... 12.

ISLAND... 30th to 32nd St. 13.

F STREET... 28 to 30 St. 14.

JELLET... MORENA to FRANKFORT... 15.

GROUP 1

ALLEY BIK 7 (CITY HEIGHTS) N of MYRTLE E of Highland 16.

CAPE MAY AVE Abbott to 390' WEST 17.

WARNER ST. SILVERGATE TO CATALINA 18.

INDEX CONT

VISTA PLACE	Copley to Terminus.	19.
Lillian	Viola St. to Gertrude St.	20.
31 st ST.	Cedar St. to Elm St.	21.
TALBOT ST.	300' W OF BANGOR TO BANGOR	22.
SUNCREST DR.	KANSAS to 30 th ST.	23.
UVADA PLACE	Copley to Terminus	24.
PAC. BEACH DR.	LAMONT to MORELL	25.
39 th ST.	HILLTOP DR. TO FEDERAL	26.
44 th ST.	HILLTOP DR. to A St.	27.
50. BANCROFT	OCEAN VIEW to WEBSTER	28.

GROUP 2

MODESTO	JUNIPER TO SUMAC	29.
SHAMROCK	JUNIPER to SYCAMORE	30.
	TULIP TO Tuberose	31.
SYCAMORE	SNOWDROP TO Hollywood	32.
Tuberose	Poplar to Tuberose LANE	33.
PEPPER DR.	Violet to Tuberose	34.
POPPY PLACE	MANZANITA TO MANZANITA	35.
LAUREL ST.	SUMAC DR. to FAIRMOUNT	36.
AZUSA ST.	LAURETTA TO GAINES ST.	37.
EUREKA	RILEY St. to YUMA	38.
MOLLIE &	LINDA Vista Rd. to Lauretta	39.
Lauretta St.	Mollie to Goshen	40-41.

Index Cont.

1.

SUMAS Drive.	Fairmont to Juniper	42.
Weeks Ave	DORCAS to VEGA	43.
	BOND to GRAND	44.
FIGUEROA BLVD.	BOND to W. Boundary	45.
THOMAS AVE.	LAMONT to OLNEY	46.
ROSEWOOD ST.	SANTA FE TO PAC. Hwy.	47.
Group 3		
55 th St.	MONTEZUMA RA. to TERM.	48.
OAKCREST DR.	WINONA to UNIV.	49.
MOANA DR.	VARONA TO Alley E. MOANA ON LA PALOMA	50.
CLOVE ST.	MACAULAY to OLIPHANT	50-A.
QUIMBY	ROSECRANS to EVERGREEN	51.
CARLETON	SCOTT to SHAFTER	52.

GROUP 4

64 th St.	Akins to Brooklyn	53.
STORK	Imperial to "	54.
62 nd St.	Akins to "	55.
61 st St.	Akins to "	56.
Wunderlin	63 rd St to 69 th St.	57.
AKINS	67 th St. to City Limits	58.
Hilger	Klauber to Gibson	59.
VISTA UNIT No. 1.	Feeder main	60.

Index Cont.

Group #5

Fergus St.	Imperial to Brooklyn	61
Naranja St.	Euclid to 54 th	62
Akins St.	(60 th to 61 th) (Fergus to 62 nd) (Starts to 65 th)	63
Alley #55	N. of Wightman E. of 38 th	64
Mallard St.	Springfield to Alcedo	65
Radio Drive	Attix to Winnett	66
Paradise St.	Springfield to Tooley	67
Tooley St.	Paradise to Weaver	68
Toft Ave.	Colima to Forward	69
Weaverly Ave.	Midway to Forward	70
Sterne St.	Willow to Evergreen	71

Questionable Jobs

Bancroft St.	Alley S. of Adams to Copley	72
53 rd St.	" " " " " "	73
Felton St.	" " " " " "	74
54 th St.	Alley S. of Adams to Mt. View	75

Index Cont.

2.

Group #6

61 st St.	Detroit to Benson	77
Alcedo St.	Mallard to Mulberry	76
69 th St.	Tamacha to Madron	78

Frankfort Milton to Ingulf

Ingulf
(Dirt)

3.

West
Martell
Varon Fok's

26 Dec 52

Ad. Pave

Jerlett

Kane
(Dirt)

Frankfort
(Dirt)

Lister
(Dirt)

Milton
(Dirt)

ingulf
(Dirt)

West
Martell
Varonakis

26 Dec 52

5" AC Pav

230' 4"

Jelliffe

Kane
(Dirt)

Denver
(Dirt)

Lister
(Dirt)

Milton
(Dirt)

Chicago Milton to Ingulf

West
martell
Varon fokus

Ingulf
(Dirt)

26 Dec 52

3" AC Dave

Jellett

Kane
(Dirt)

Lister
(Dirt)

Milton
(Dirt)

Chicago 5c
(Dirt)

6
Ingulf Dirt

West
mortell
Varon lakus

26 Dec 52

3" AB Pave

230.3

Jellett

Kane
Dirt

Lister
Dirt

Eric
(Dirt)

Milton
Dirt

Gaines Benecia to Fresno

Fresno (Dirt)

West
Martell
Varonfakis

26 Dec 52

Eureka (Dirt)

Calusa 4" AC

Benecia

Fresno Yuma to Riley

Riley

West
Martell
Varonakis

Fresno Dirt

26 Dec 52

Gaines

4" AC

↑
↓

yuma Dirt

Moore St. Ampudia to Conde
Williams
Kemp

12/52.

9.

CONDE

(Dirt)

St.

ARISTA

(Dirt)

(Dirt)

Moore

AMPUDIA

4" A.C.

Williams
Kemp

Jefferson St.
Arista to Harney

12/52

10.

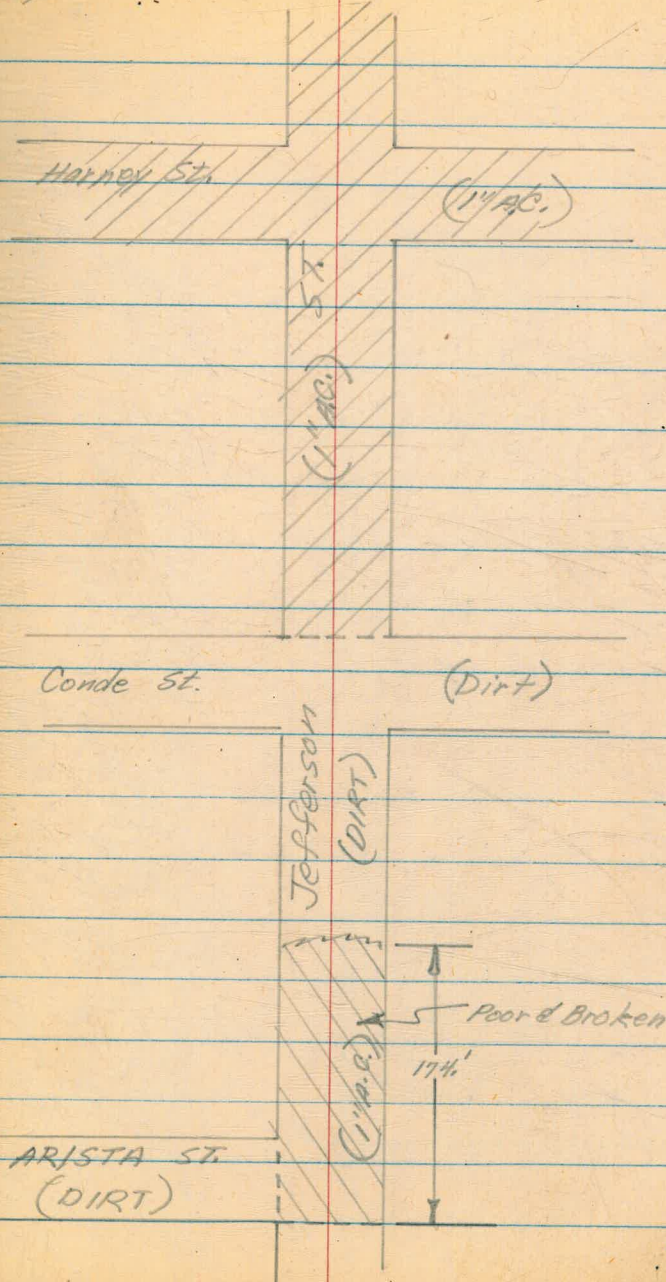

Williams
Kemp

Winona Ave. 12/52
University to Polk

11.

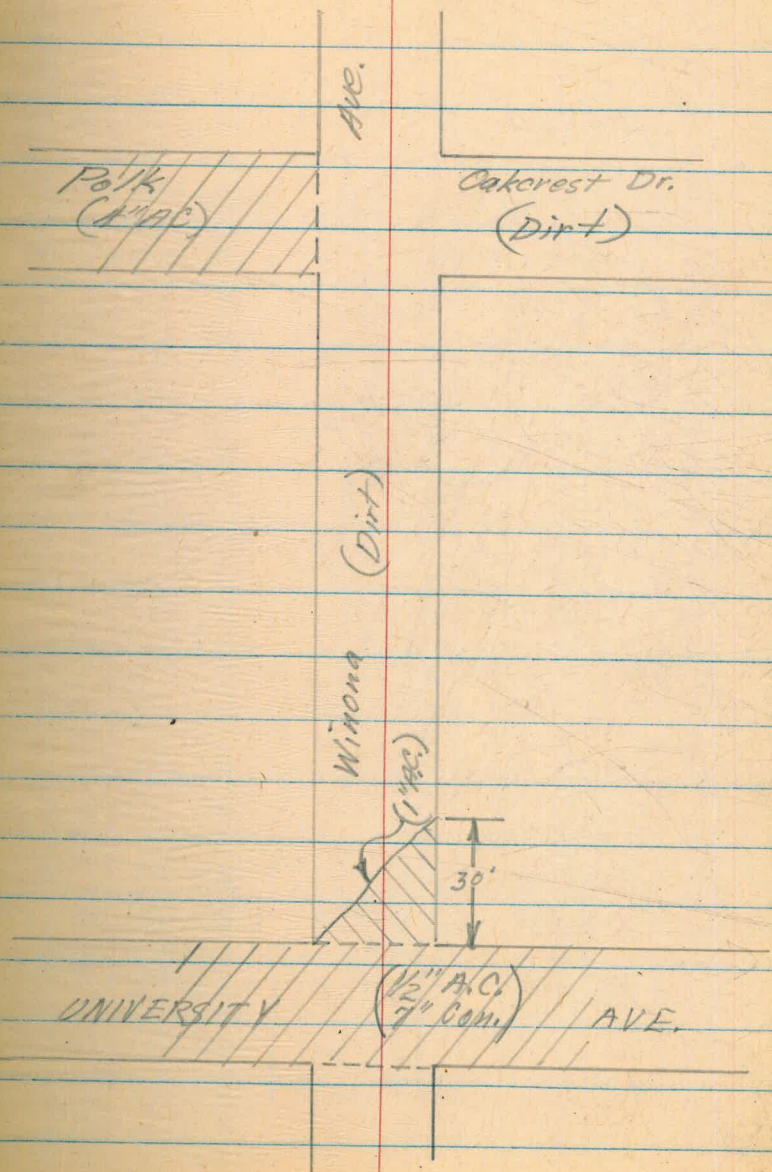

Williams
Kemp

50th St.
University to Wightman

12/52

12.

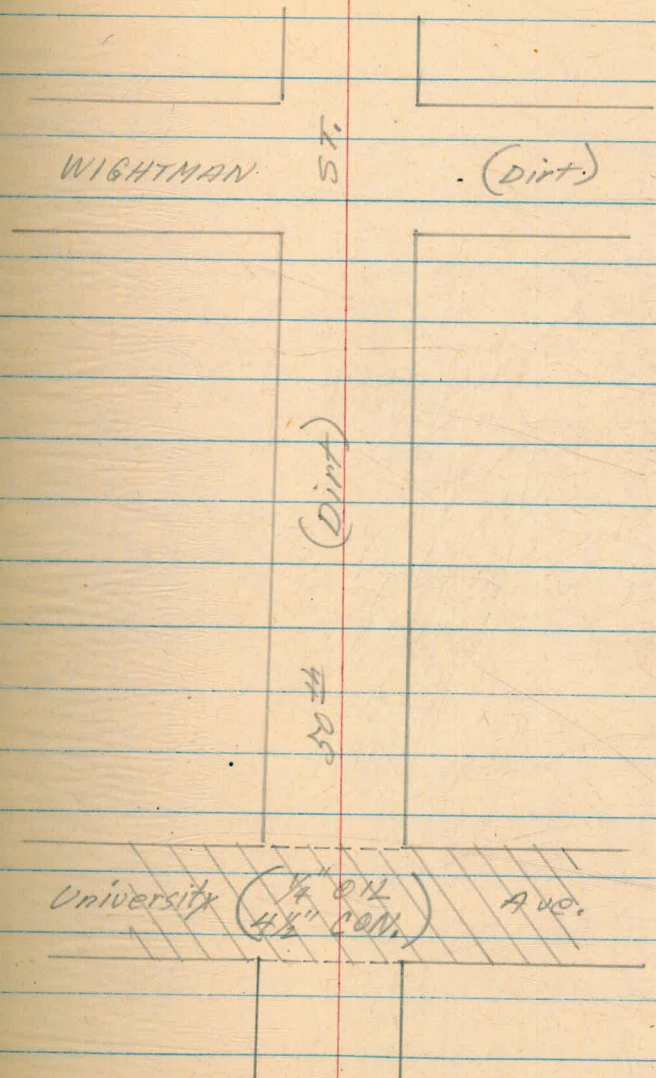

Williams
Kemp

Island Duo.
30th to 32nd

12/52

13.

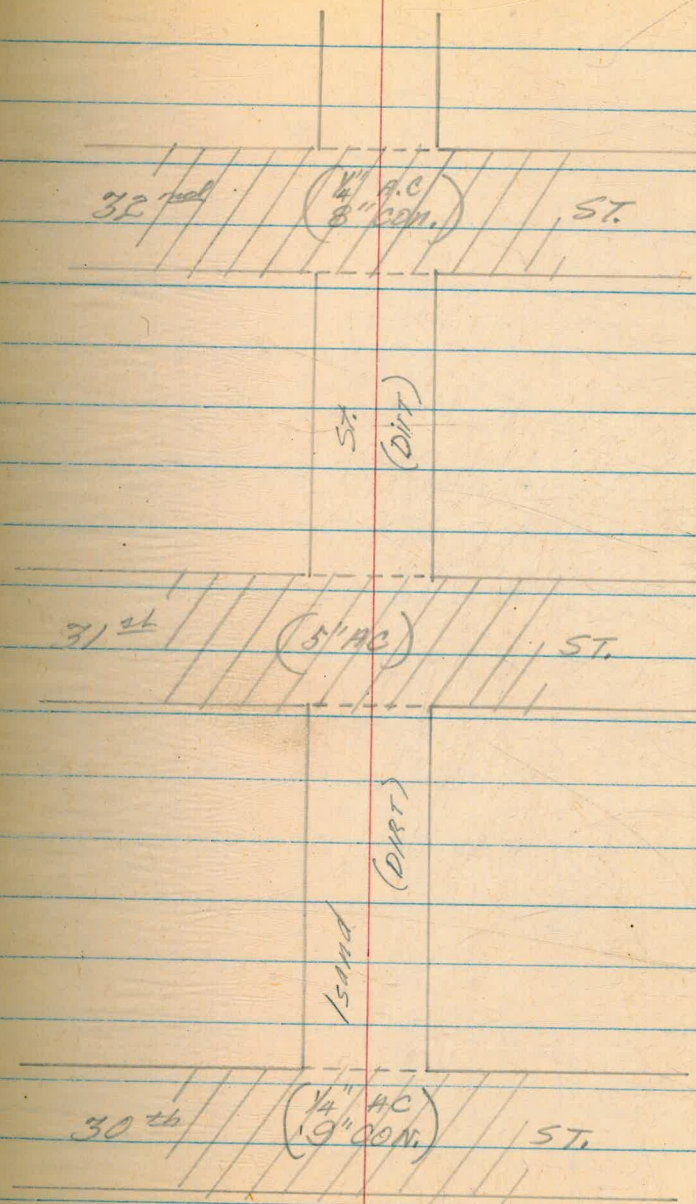

Williams
Kemp

"F" St.
28th to 30th 12/52

14.

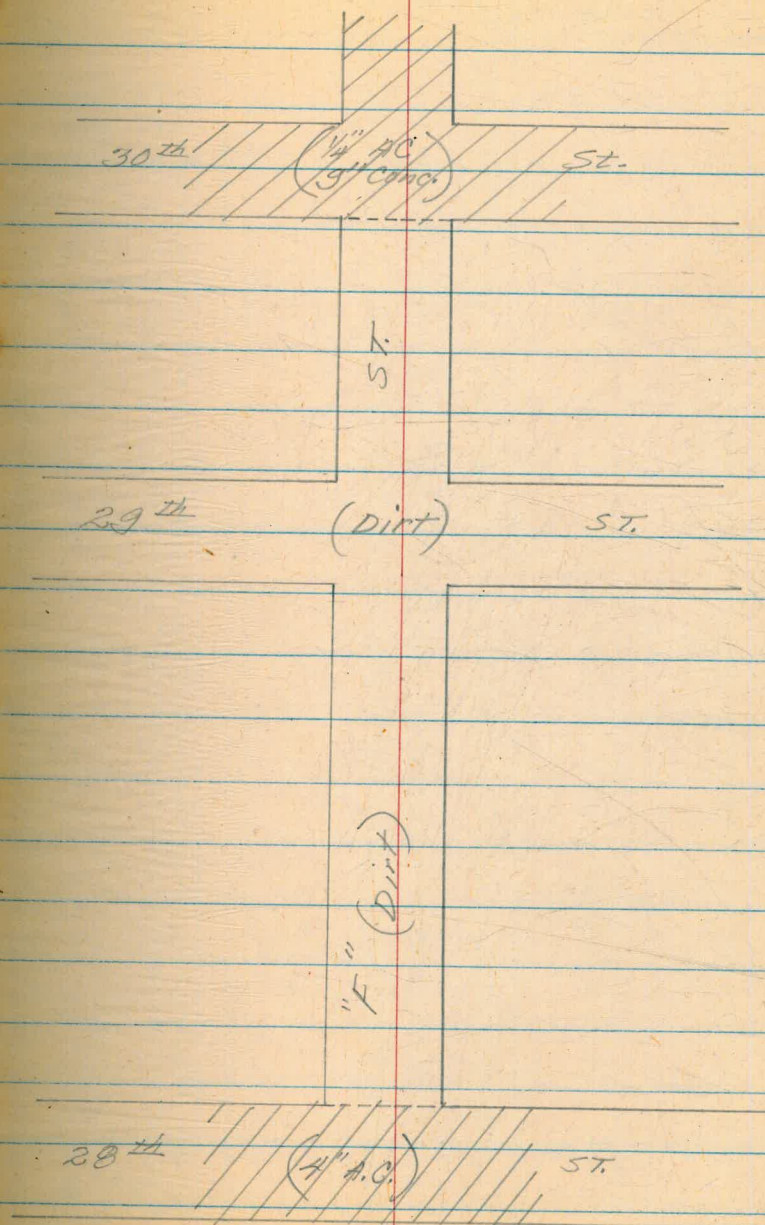

Jellett St
 Morena to Frankfort

West
 Martell
 Varen Forks

34' →

Frankfort^{15.}
 (Dirt)

26 Dec 52

33' →

Erie
 (Dirt)

3" Pav

3" AD

3"

30' →

Denver
 (Dirt)

Jellett

31' →

Chicago
 (Dirt)

3" AD

35' →

Morena

Williams Alley Bk. #7 12/52
Kemp N. of Myrtle, E. of Highland 16.

Dwight

(4" A.C.)

Alley Bk. #7
(Dirt)

Myrtle

(5" A.C.)

Williams
Kemp

Cape May Ave. 12/52
Abbott to 390' W.

17.

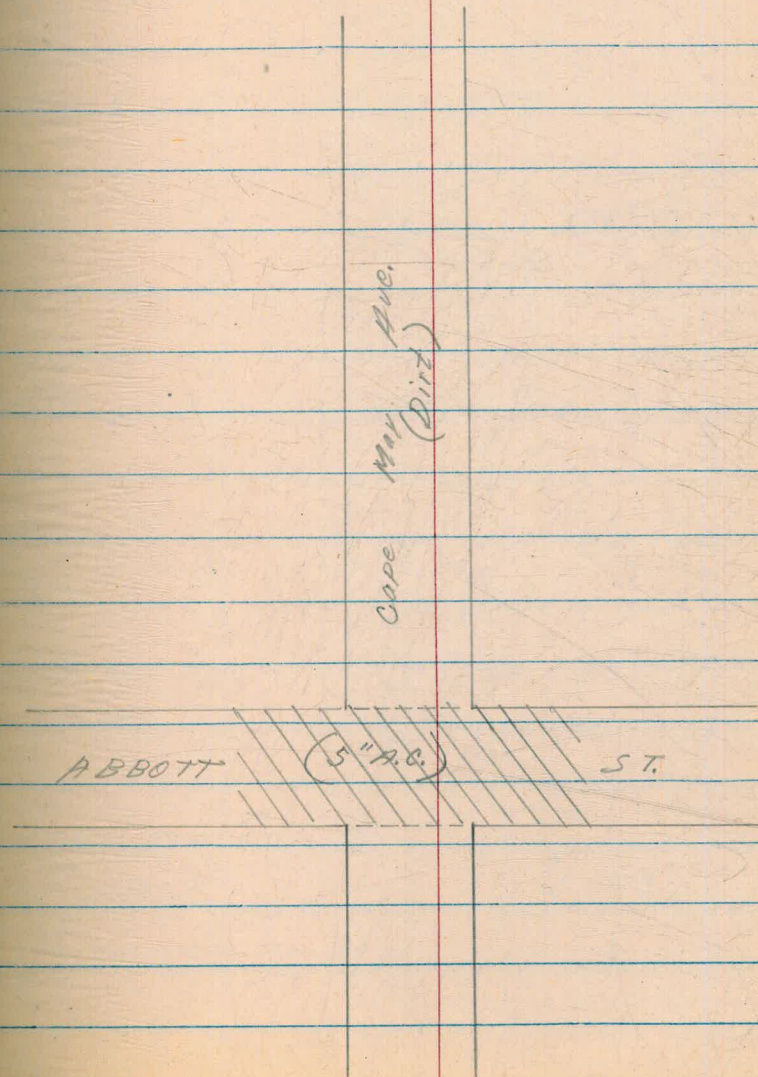

Williams
Kemp

Warner St.
Silvergate to Catalina

12/52

18.

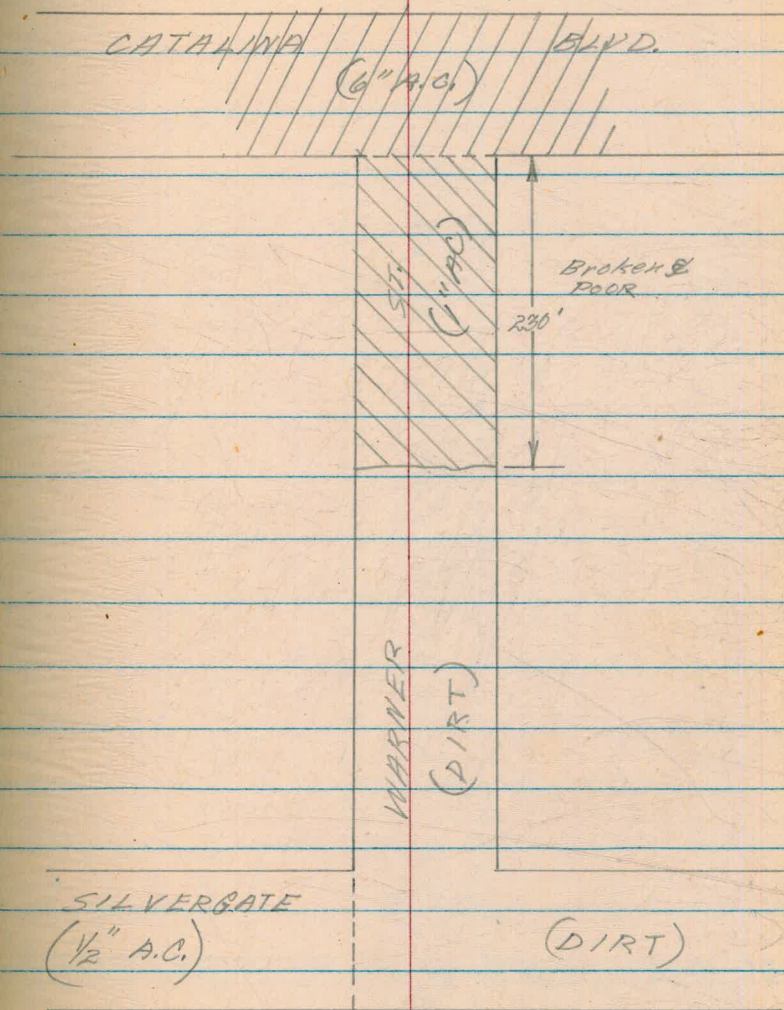

Wust
Martell
Voronfakis

Vista PL

26 Dec 52 19.

Copeley to terminus

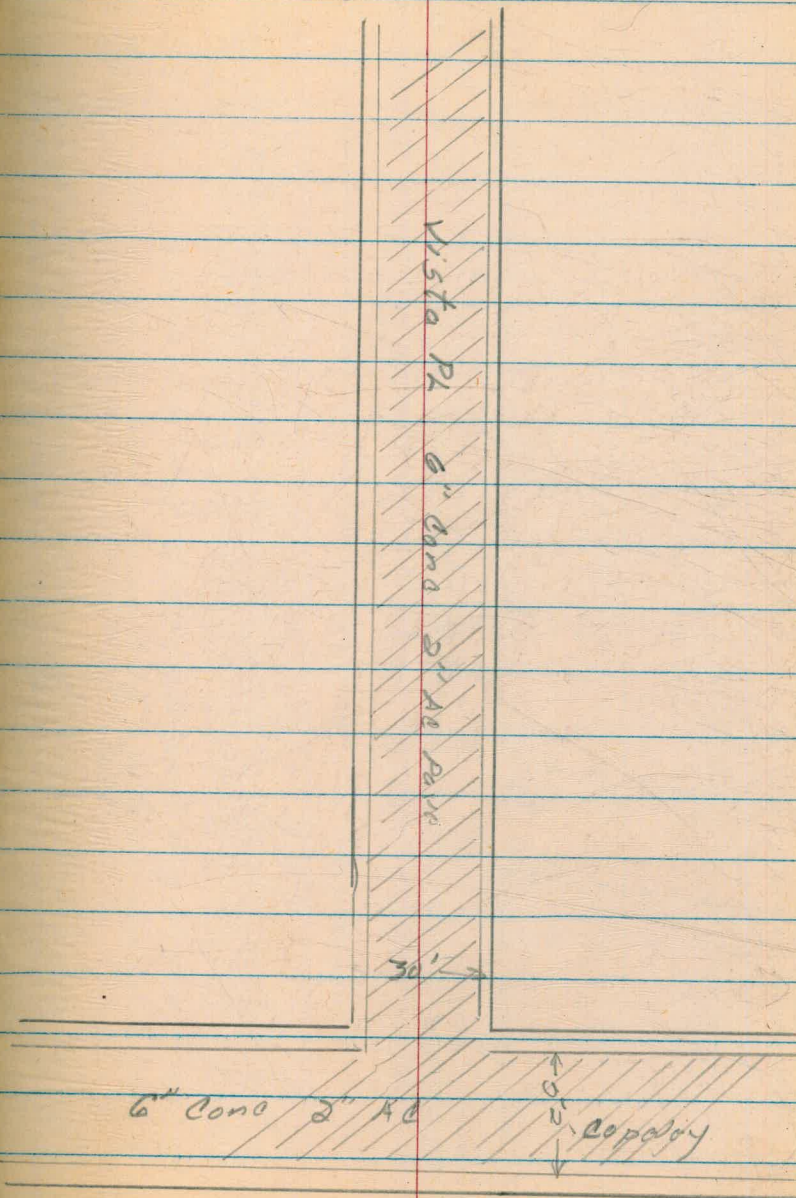

Lillian Gertrude to Viola

West
Martell
Varonakis

Dec 2, 52

20.

Gertrude
(Dirt)

Lillian
(Dirt)

Viola
(Dirt)

Williams
Kemp

31st ST.
Cedar to Elm

12/52

21.

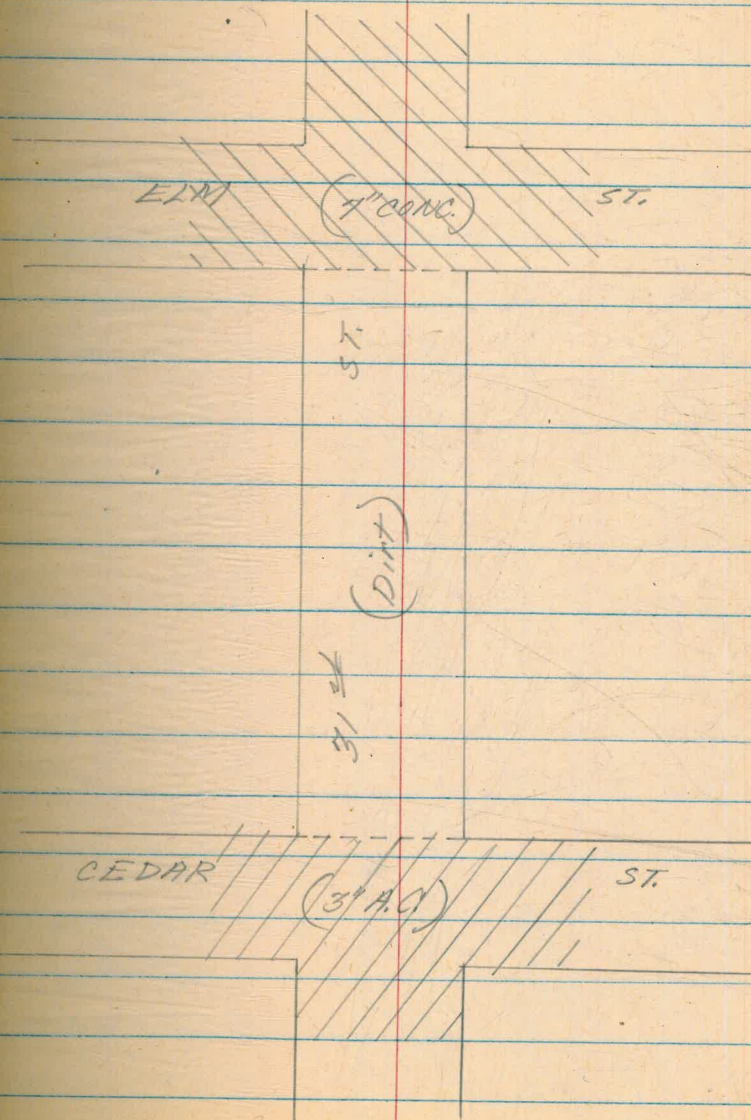

Williams
Kemp

Talbot St.
300' N. of Bangor to Akron

12/52

22.

AKRON ST.
(DIRT)

BANGOR ST.
(DIRT)

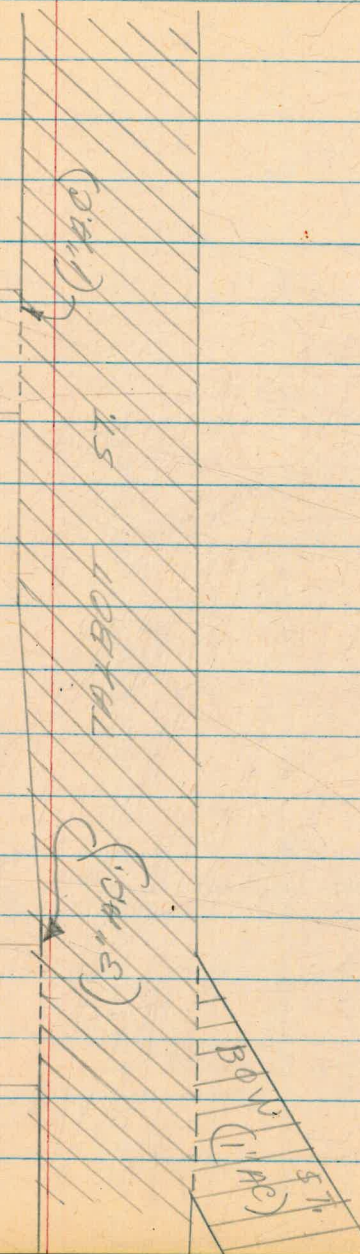

Suncrest Dr

Kansas to 30th

23.

12/52

West
Martell
Varonfakis

30th St

4" AC

Suncrest Dr

4" AC Begins At
Prop Line

Kansas St

5" Conc 2" AC.

end of 1 1/2" oil

24.

West
martell
Varenfakis

6" Cone
6"

26 Dec 52

Grade 12

5" cone 1 1/2 oil

30"

5"

Capeley

Williams
Kemp

Pacific Beach Drive 12/52
Lamont to Morrell

25.

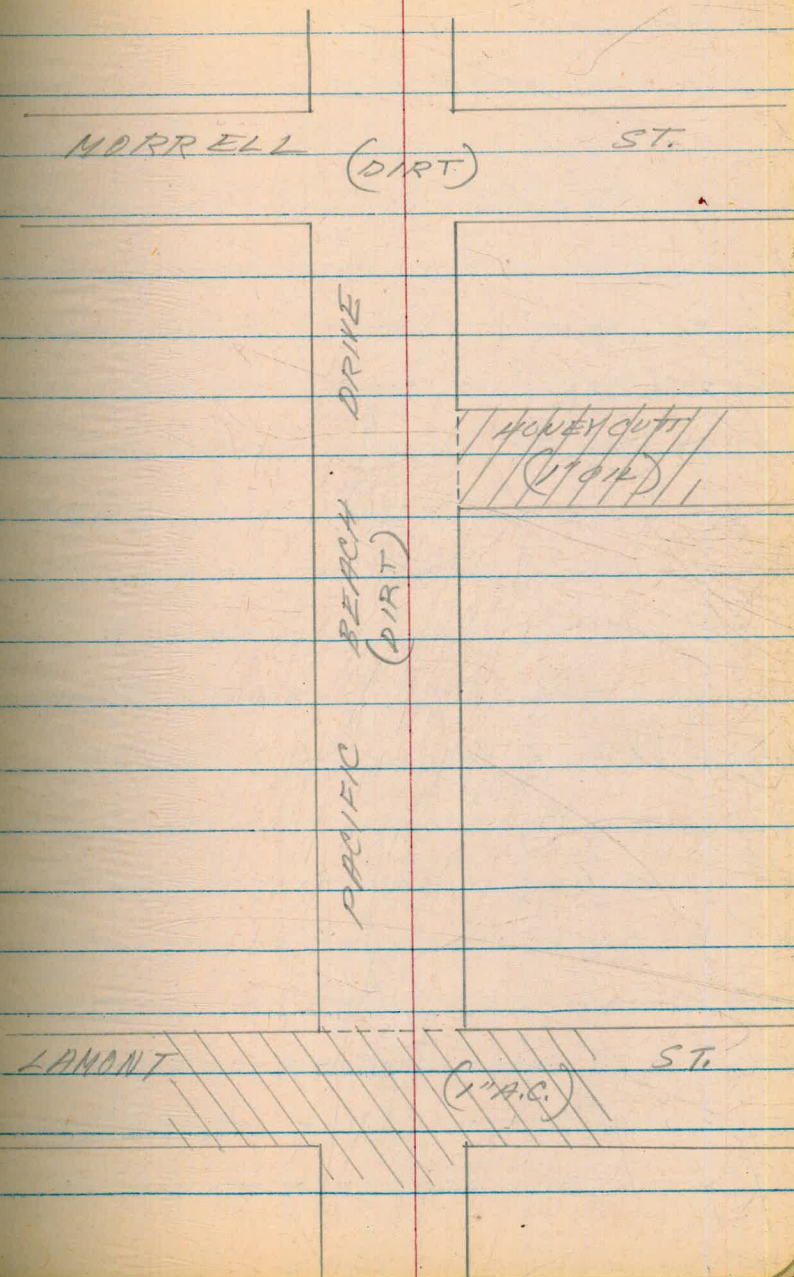

Williams
Kemp

39th St.
Hilltop to Federal

12/52

26a

FEDERAL BLVD.

(9" CONC.)

ST.
(Canyon)

BROADWAY

ST.

(DIRT)

39th
(DIRT)

HILLTOP

DRIVE

(DIRT)

Williams
Kemp

44th St. 12/52
Hilltop to "A"

27.

"A" ST.
(DIRT)

ST.

(Dirt)

"C" ST.
(Dirt)

44th

Hilltop

(4" R.C.)

Dr.

Williams
Kemp

S. Bancroft
Ocean View to Webster

12/52

28

WEBSTER AVE.

(7" A.C.)

ST.

CLAY AVE.

(4" A.C.)

(DIRT)

BANCROFT

OCEAN VIEW BLVD.

(6" CONC.)

Williams
Komp

Modesto St. 12/52
Juniper to Sumac

29.

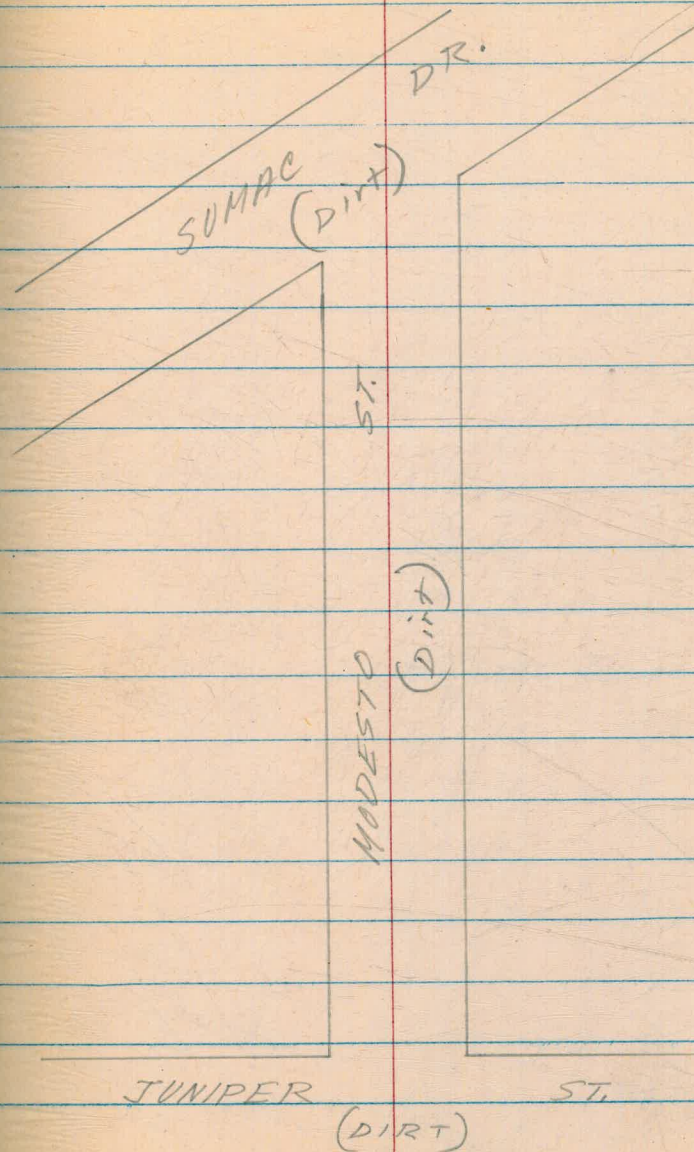

Williams
Kemp

Shamrock St.
Juniper to Scramore

12/52

30.

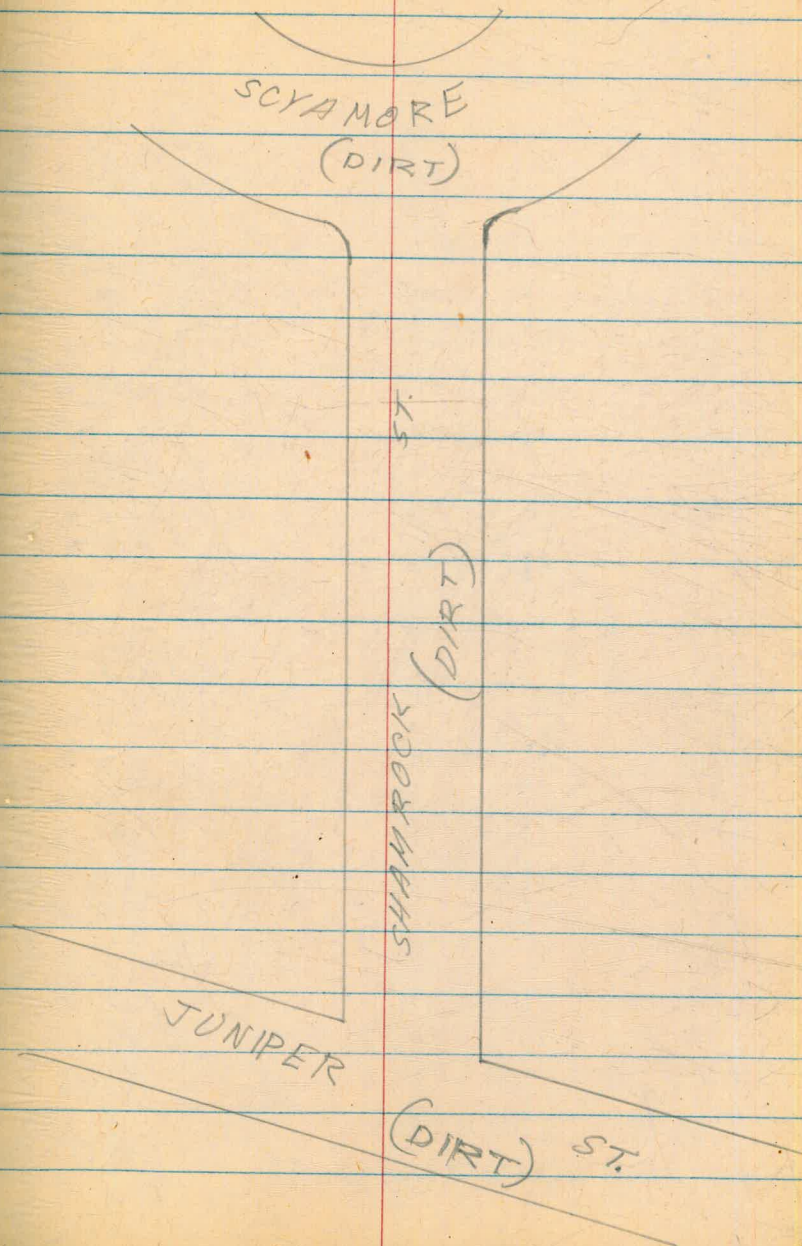

Williams
Kemp.

Soyamore St. 12/52
Tulip to Tuberosa

31.

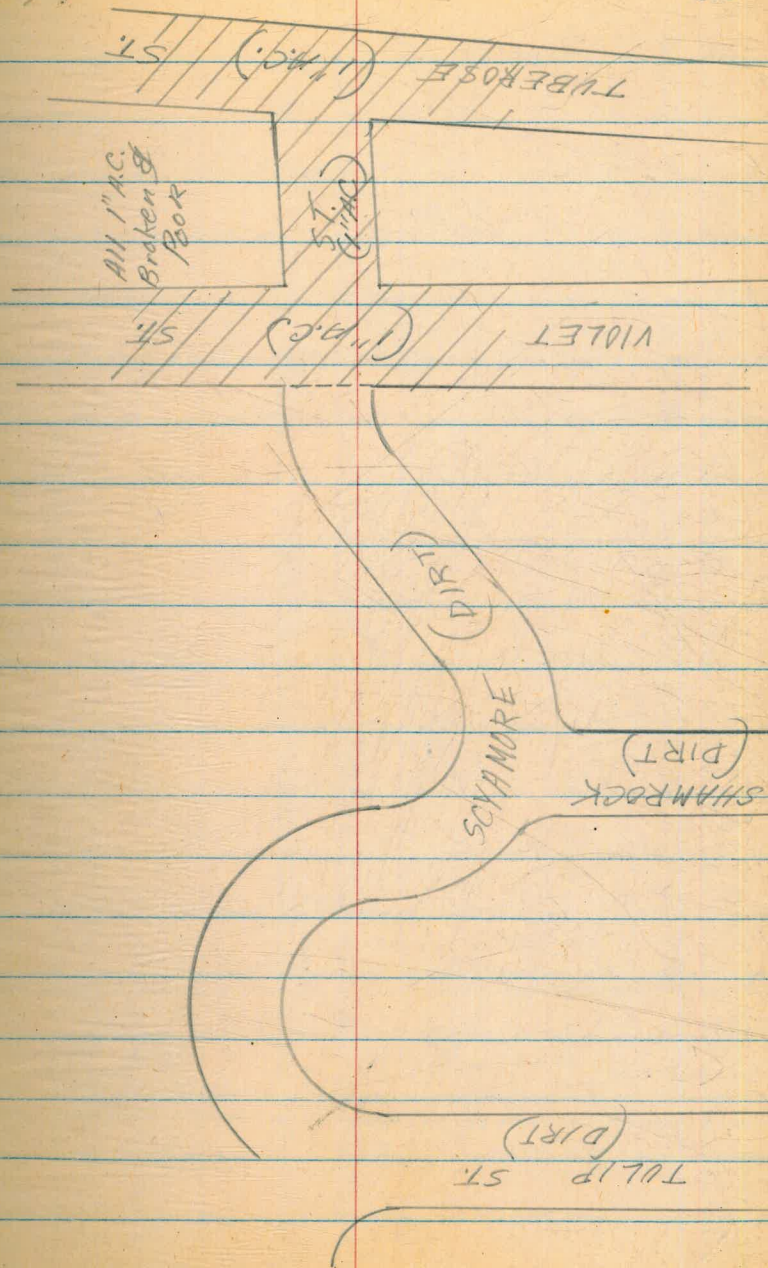

Sycamore St.
Snowdrop to Hollywood

12/52

32.

West
Martell
Varonakis

Jan 7 53

Hollywood Park

Sycamore
(Dirt)

4 AC

Snowdrop.
no Road

Williams
Kemp

Tuberosa St
Poplar to Tuberosa Lane

12/52

33.

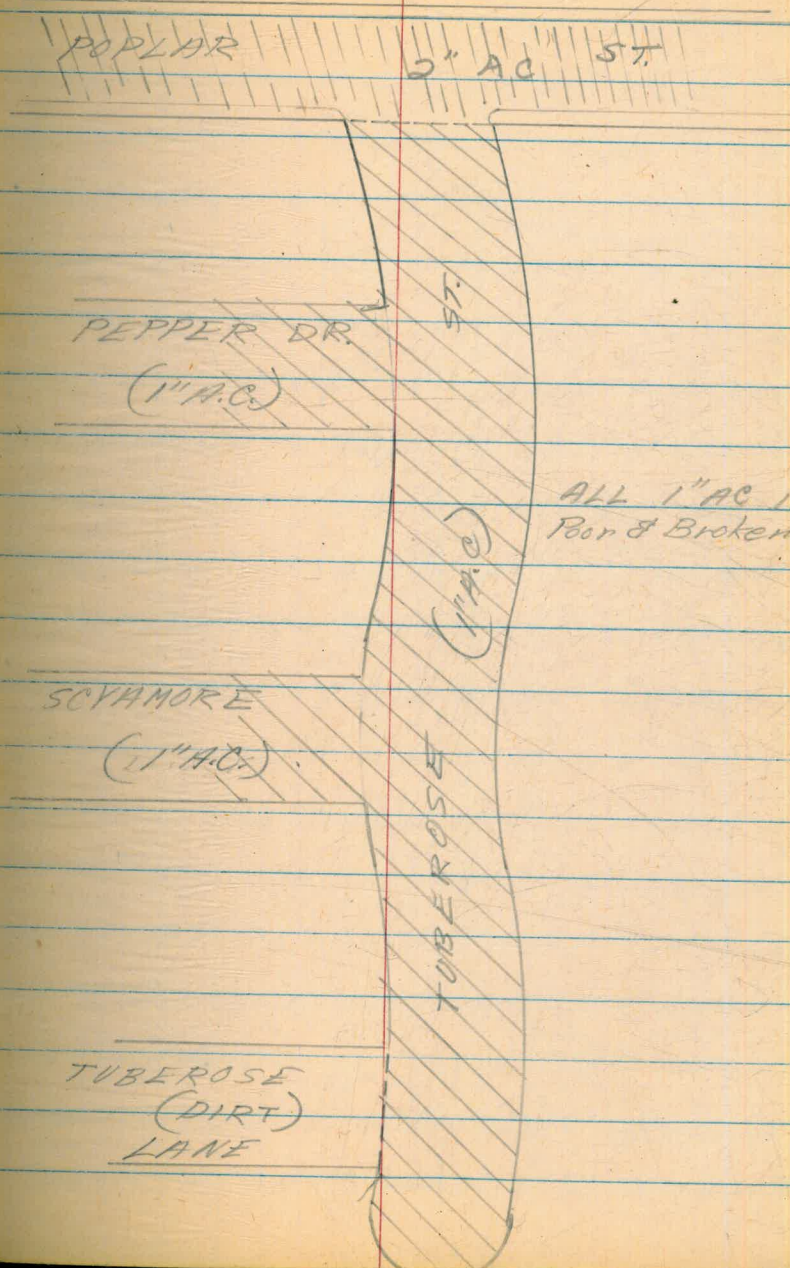

Williams
Kemp

Pepper Drive
Tuberoze to Violet

12/52

34.

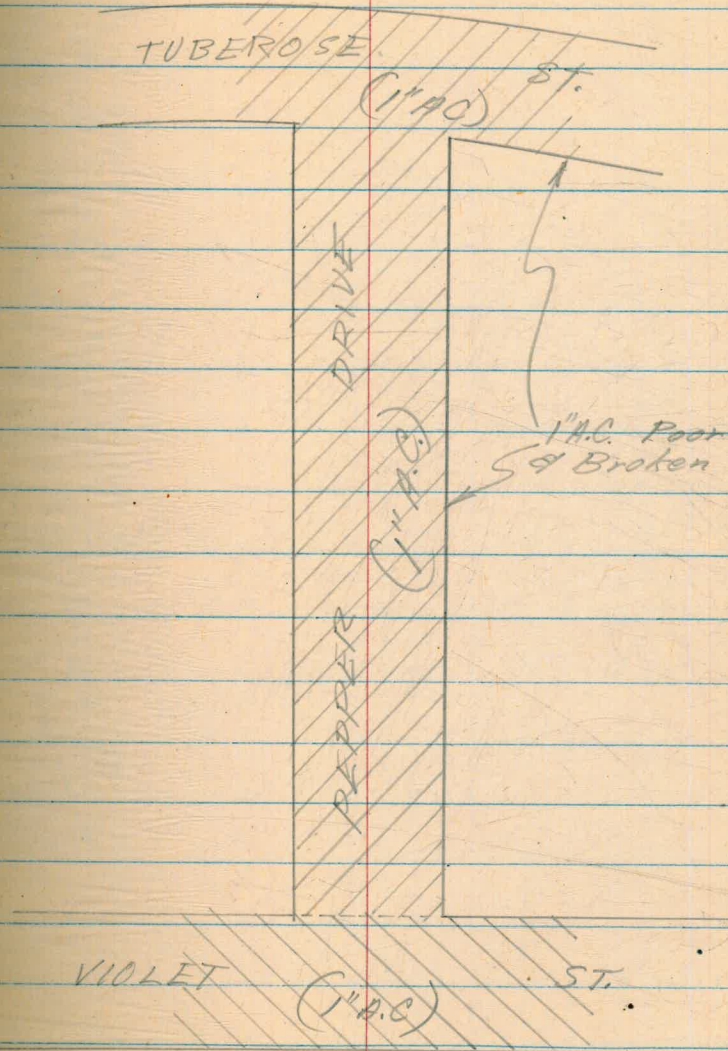

Williams
Kemp

Poppy Place 12/52
Manzanita to Manzanita

35.

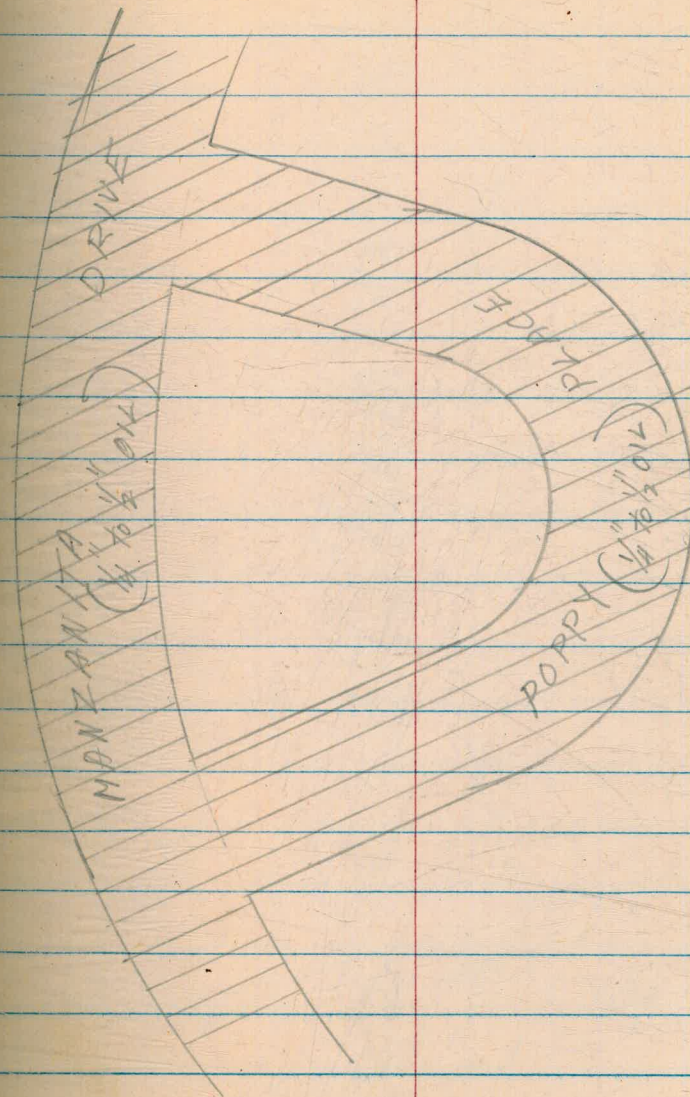

Williams
Kemp

Laurel St.
Fairmont to Sumac

12/52

36.

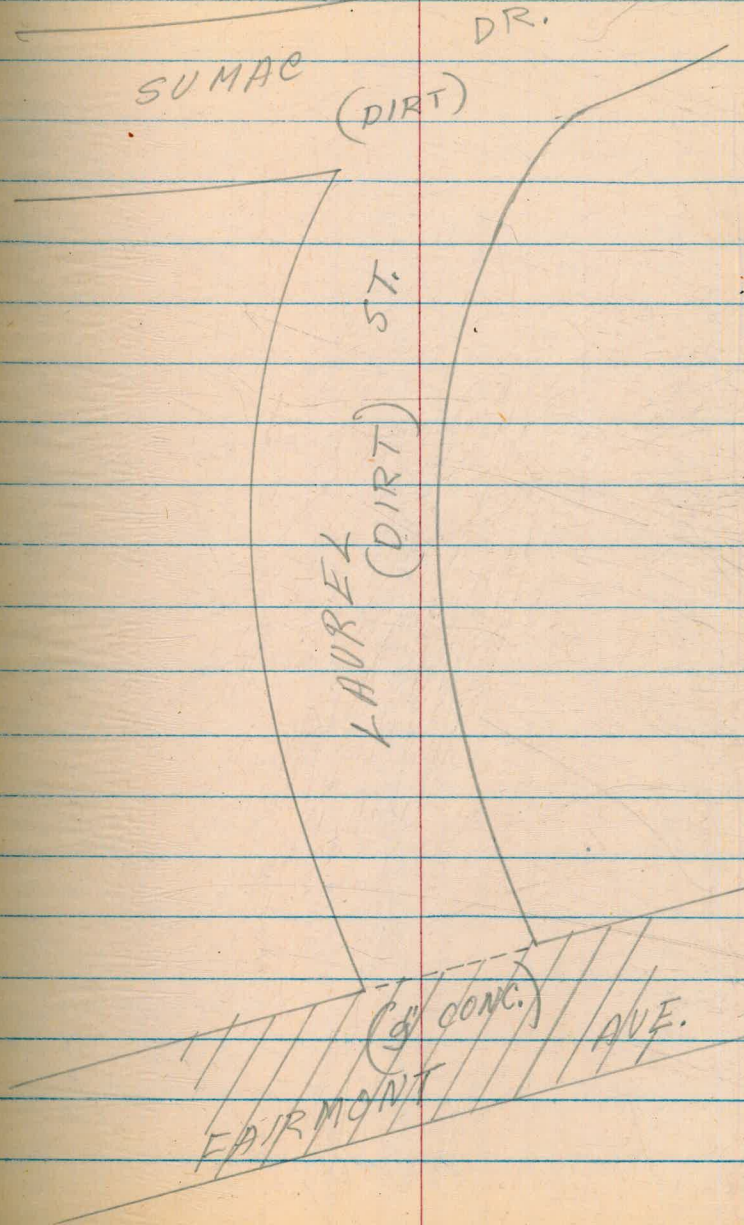

Williams
Kemp

AZUSA ST.
Gaines to Laoretta

12/52

37.

GAINES

ST.

(1" to 2" A.C.)

ST.

RILEY ST.

(2" A.C.)

(2" A.C.)

AZUSA

LAURETTA

(DIRT)

ST.

Williams
Kemp

Eureka St. 12/52
Riley to Yuma

38.

YUMA

ST.

(DIRT)

ST.

FRIARS

OR GAINES

RD.

ST

(1 1/2" A.C.)

EUREKA
(DIRT)

RILEY

(DIRT)

ST.

Williams
Kemp

Mollie St
Linda Vista Rd. to Louretta

12/52

39.

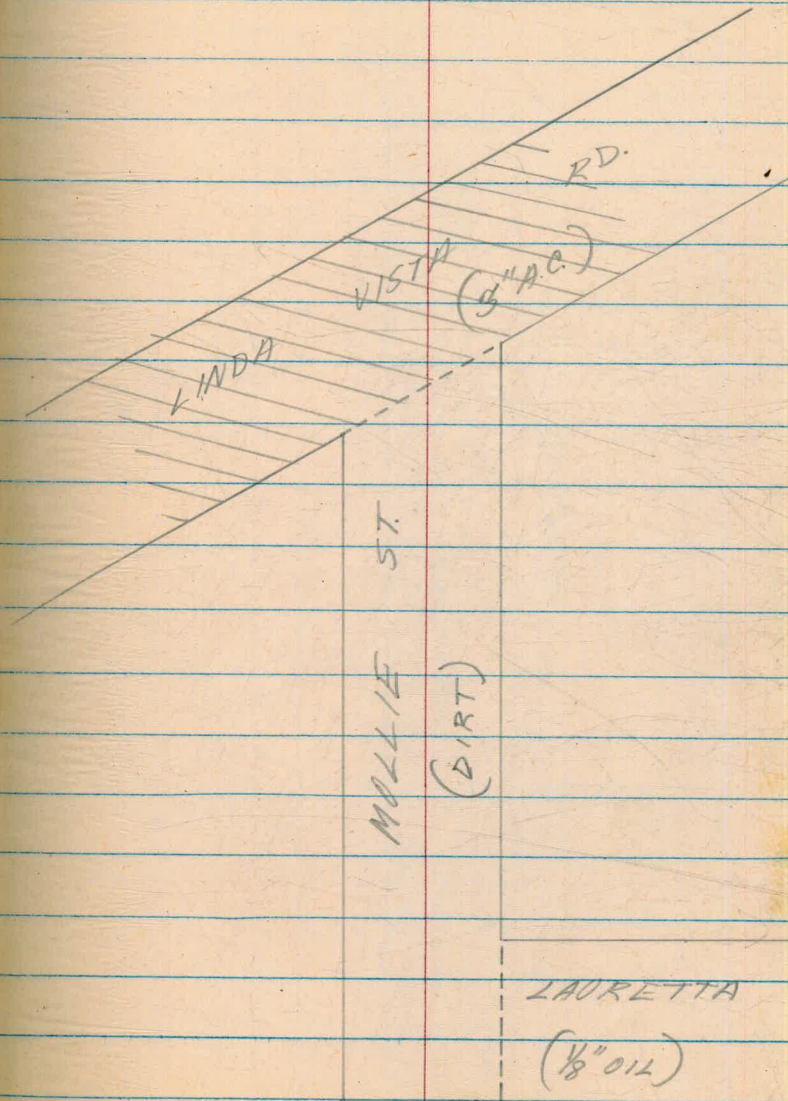

Williams
Kemp

Lauretta St.
Mollie to Goshen

12/52

40.

CONTINUED

Fig. 41

COLUSA

($\frac{1}{2}$ " AC)

ST.

ST.

BENICA

(DIRT)

($\frac{1}{2}$ " AC)

ST.

189'

LAURETTA

AZUSA

($\frac{1}{2}$ " AC)

ST.

MOLLIE ST.

(DIRT)

($\frac{1}{2}$ " AC)

Williams
Kemp

Lauretta St (Cont.) 12/52
Mollie to Goshen

41.

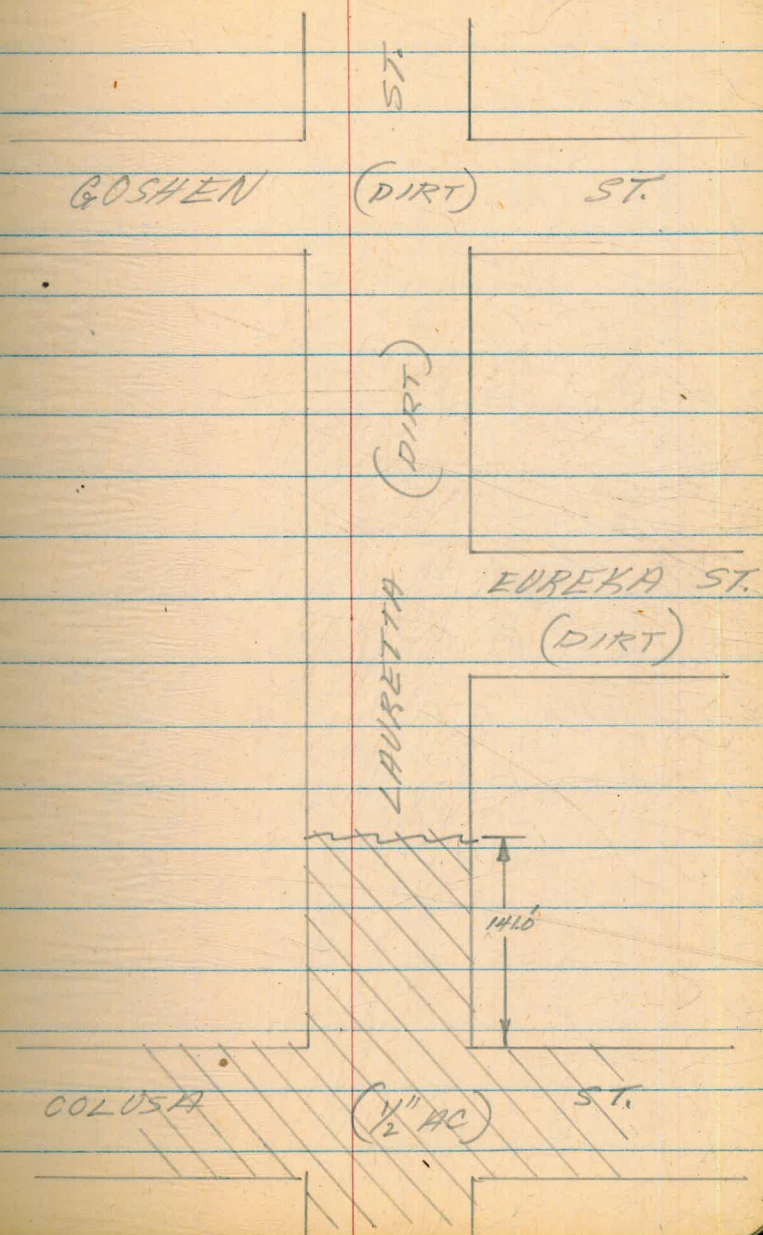

Williams
Kemp

Sumac Drive 12/52
Juniper to Fairmont

42.

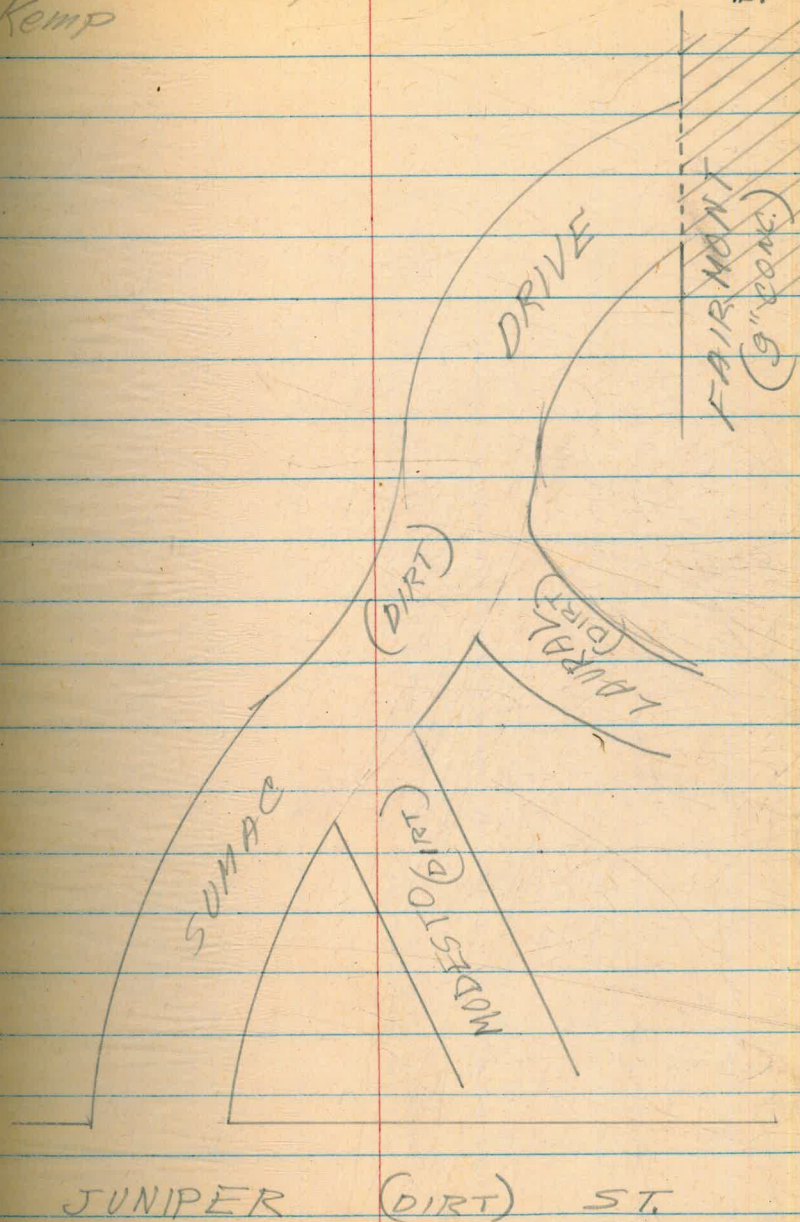

Williams
Kemp

Weeks Ave.
Vega to Dorcas

12/52

43.

VEGA (Dirt)

ST.

AVE.

(Dirt)

DORCAS

ST.

(Dirt)

WEEKS

Williams
Kemp

Figueras Blvd.
Bond to Grand

12/52

44.

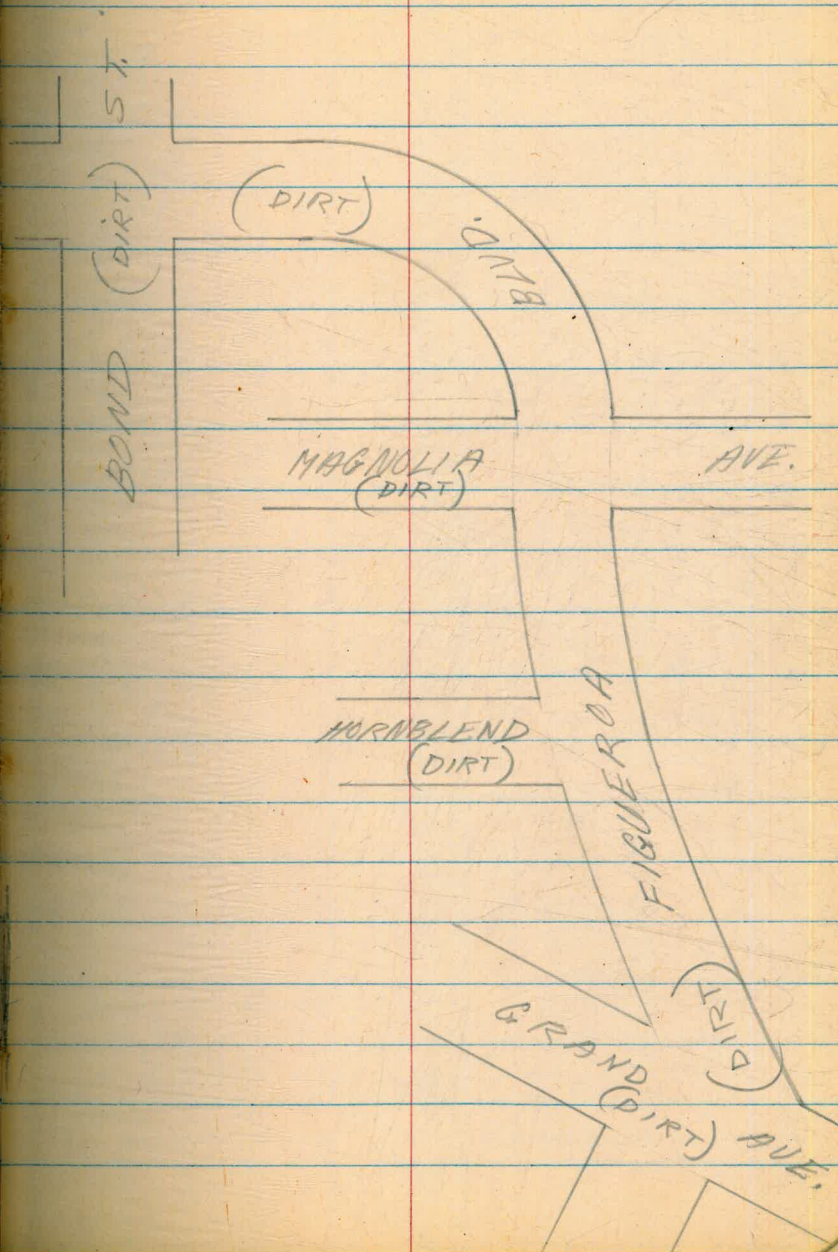

Williams
Kemp

Figueroa Blvd.
Bond to W. Boundry

12/53

45.

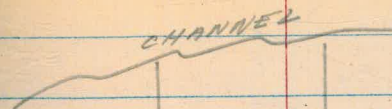

BLVD.

(DIRT)

FIGUEROA

BOND

(DIRT)

ST.

Williams
Kemp

Thomas
Lament to Olney

12/32

46.

OLNEY

(4" A.C.)

ST.

ST.

NOYES

(DIRT)

ST.

THOMAS

(DIRT)

MORRELL

(DIRT)

ST.

LAMONT

(2 1/2" A.C.)

ST.

Williams
Kemp

Rosewood St.
Pacific Hwy. to Santa Fe

12/52

47.

PACIFIC

HWY.

(7" A.C.)

ST.

(DIRT)

DEL RAY

(DIRT)

ST.

ROSEWOOD

SANTA

FE

(DIRT)

ST.

Williams
Kemp

55th St.
Montezuma Rd. to Term.

12/52
48.

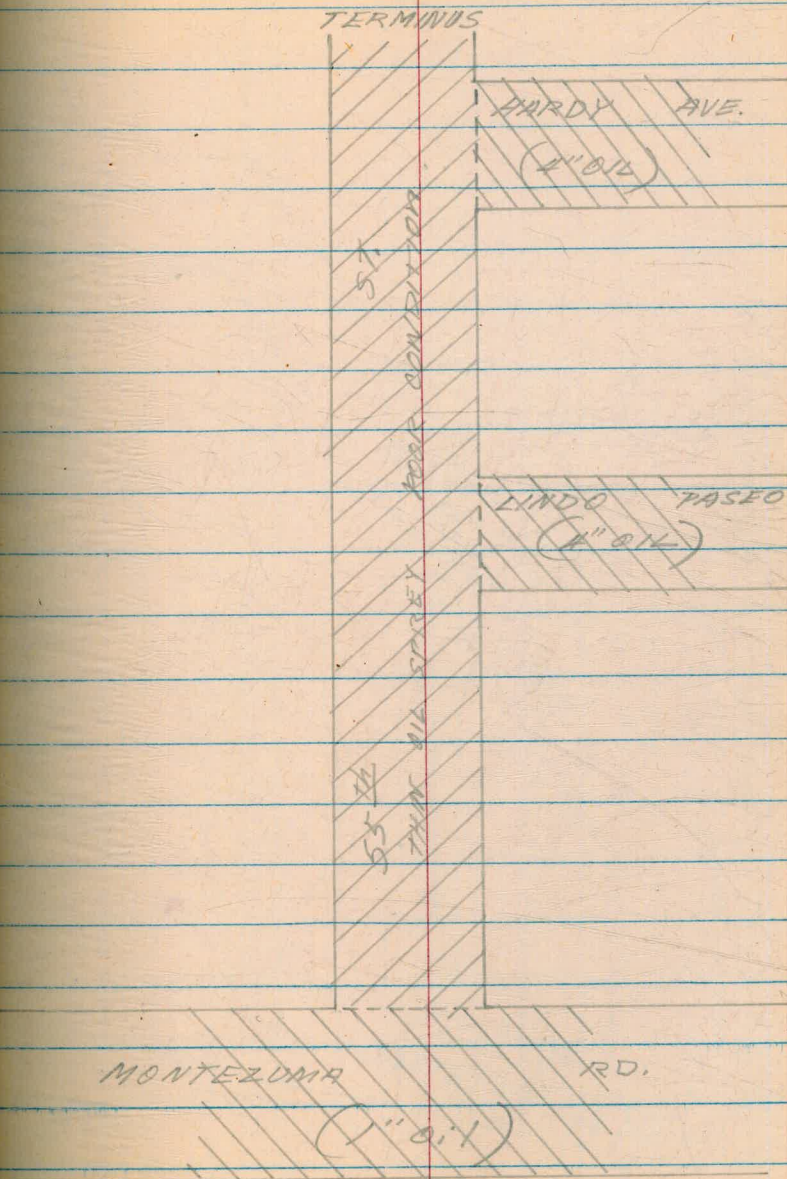

Williams
Kemp

Oakerest Dr.
Winona to University

12/52

49.

AVE.

(DIRT)

WINONA

OAKEREST
(DIRT)

D.R.

UNIVERSITY AVE.
1/4" OIL
9" CONC.

Williams
Kemp

Moana Drive
Varona to alley E. of Moana
Dri. on La Paloma

12/52

50

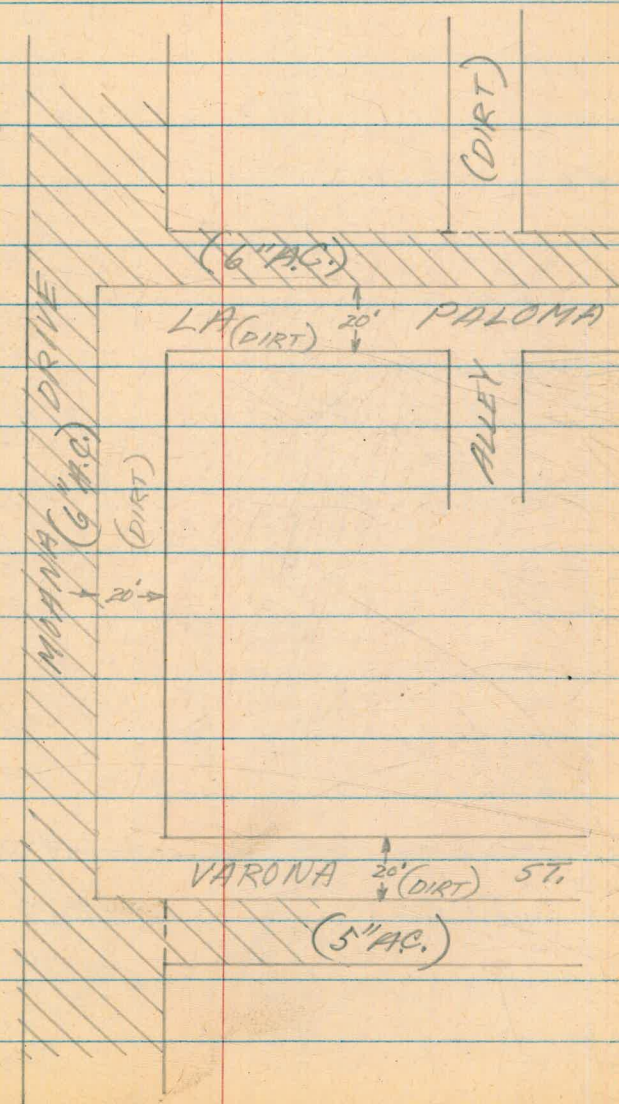

Williams
Kemp

Clove St.
Macaulay to Oliphant

12/52

50-A

OLIPHANT
(DIRT)

ST.

DIRT

NEWELL ST.
(DIRT)

CLOVE

MACAULAY ST.
(P.A.C.)

Williams Quimby St. 12/51
Kemp Rosecrans to Evergreen 51.

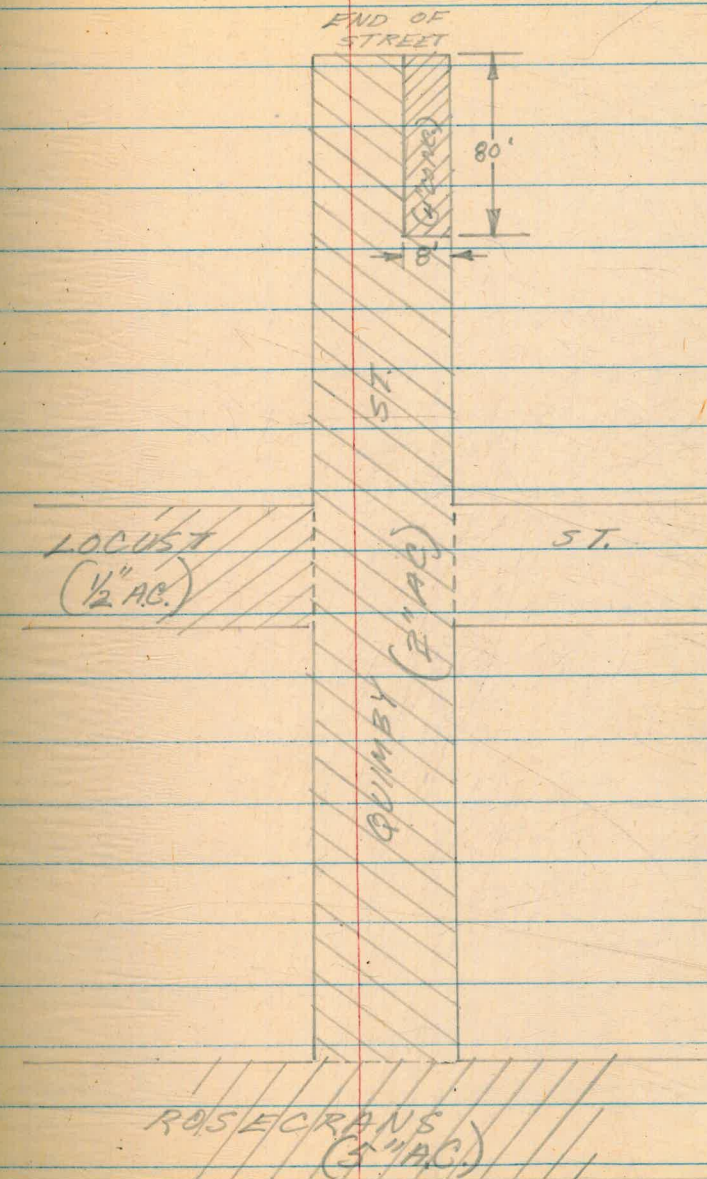

Williams
Kemp

Carelton St.
Scott to Shafter

12/52

52.

SHAFTER ST.

(DIRT)

ST.

CARLETON

SCOTT

(9" CONC.)

ST.

Williams
Kemp

64th St.
Imperial to Brooklyn

12/52

53.

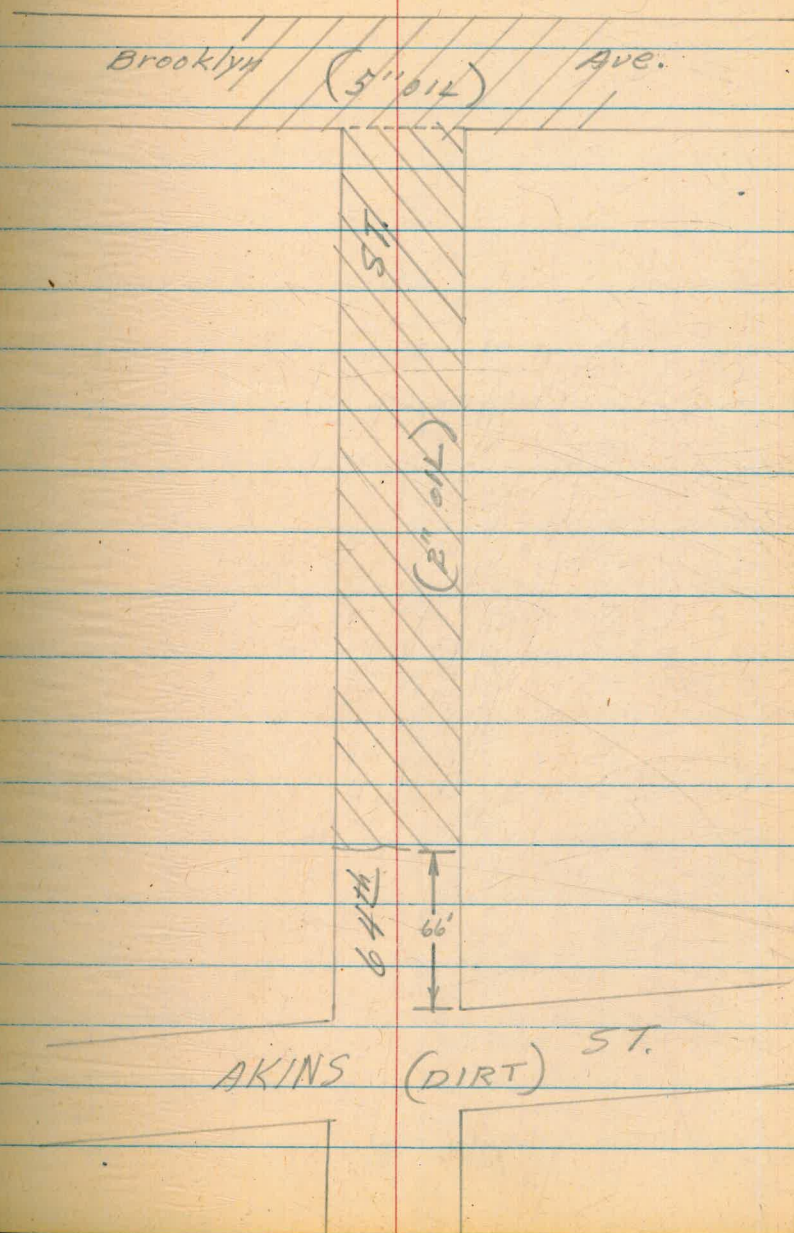

Williams
Kemp

Stork St. 12/52
Imperial to Brooklyn 54.

BROOKLYN (3 1/2" OIL) AVE.

ST.

(OIL VARIES
1" TO 3")

STORK

7 1/4'

AKINS DIRT ST.

R.R. Right of way

IMPERIAL (4" OIL) AVE.

Williams
Kemp

62nd ST.
Brooklyn to Akins

12/52

55.

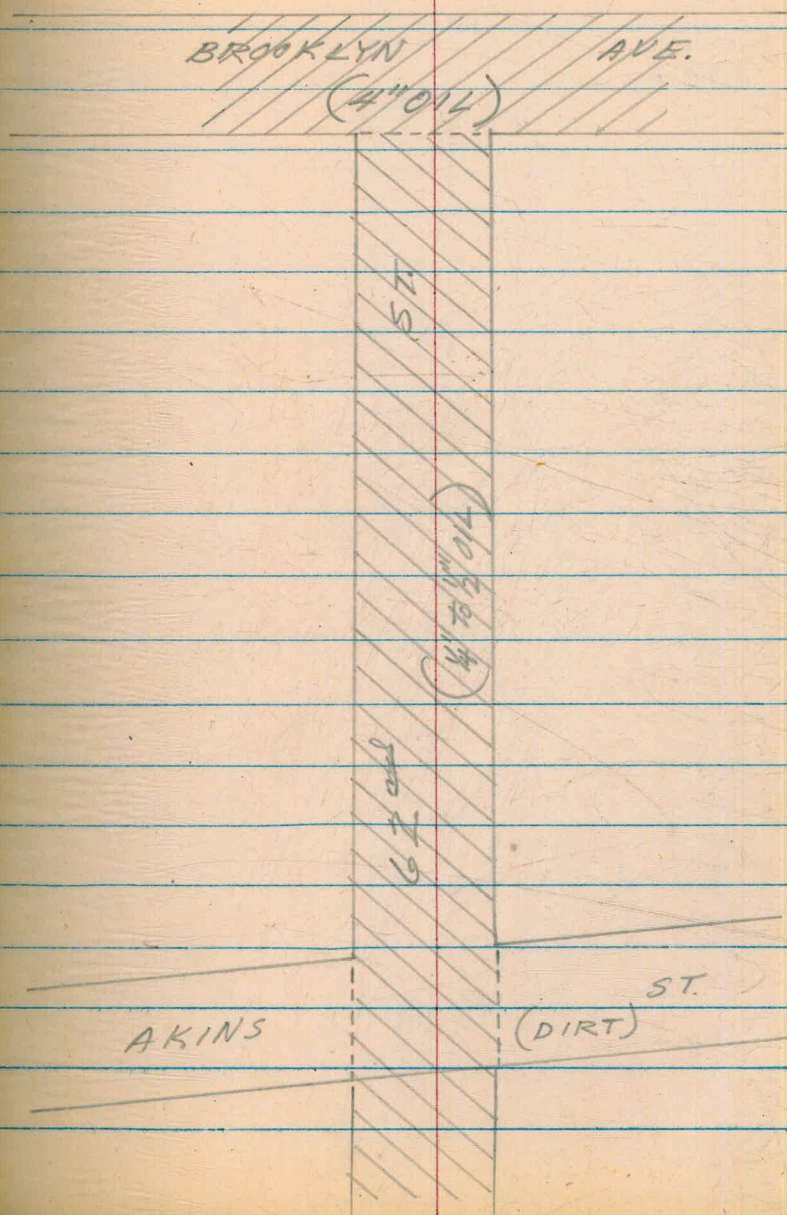

Williams
Kemp

61st ST.
AKINS to Brooklyn

12/52

56.

BROOKLYN

(5 1/2" DIL)

AVE.

ST.

(DIRT)

61st

ST.

AKINS (DIRT)

Williams
Kemp

Wunderlin Ave.
63rd to 69th

12/52

57.

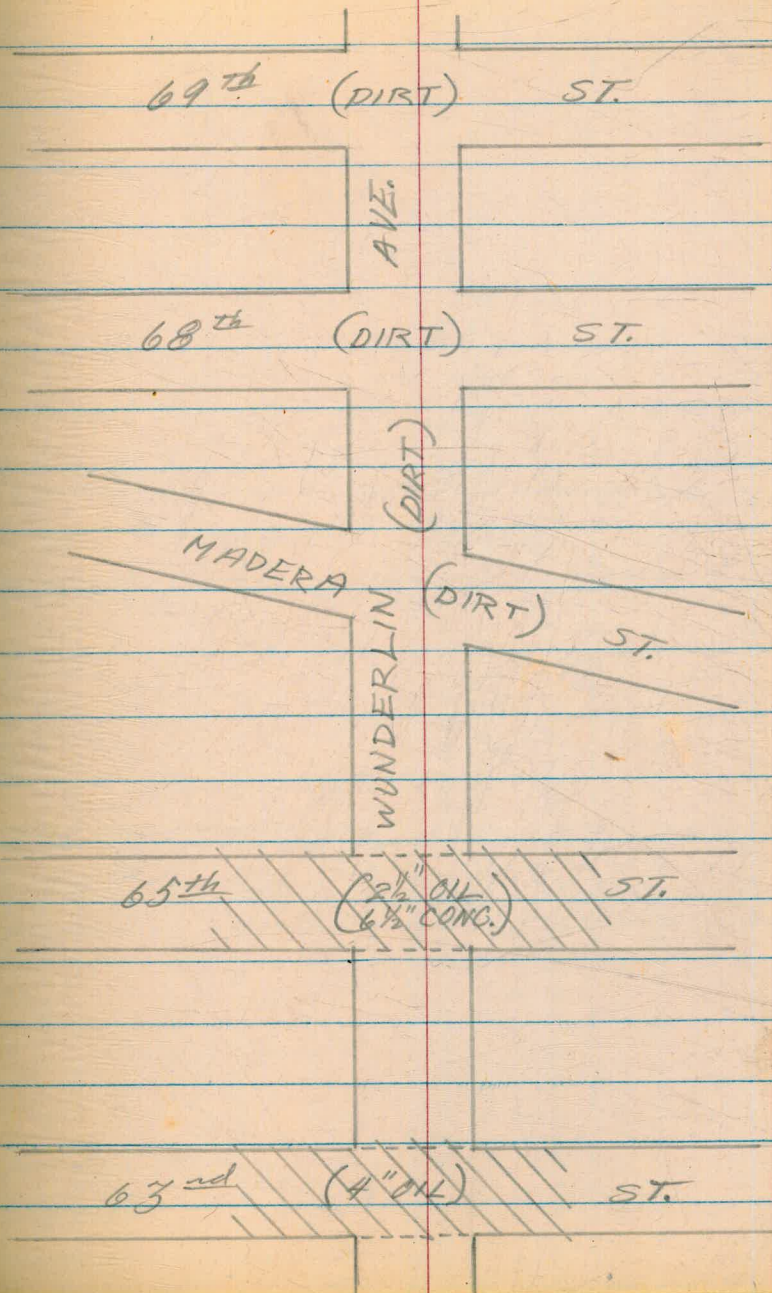

Williams
Kemp

Akins St.
67th to City Limits

12/52
58.

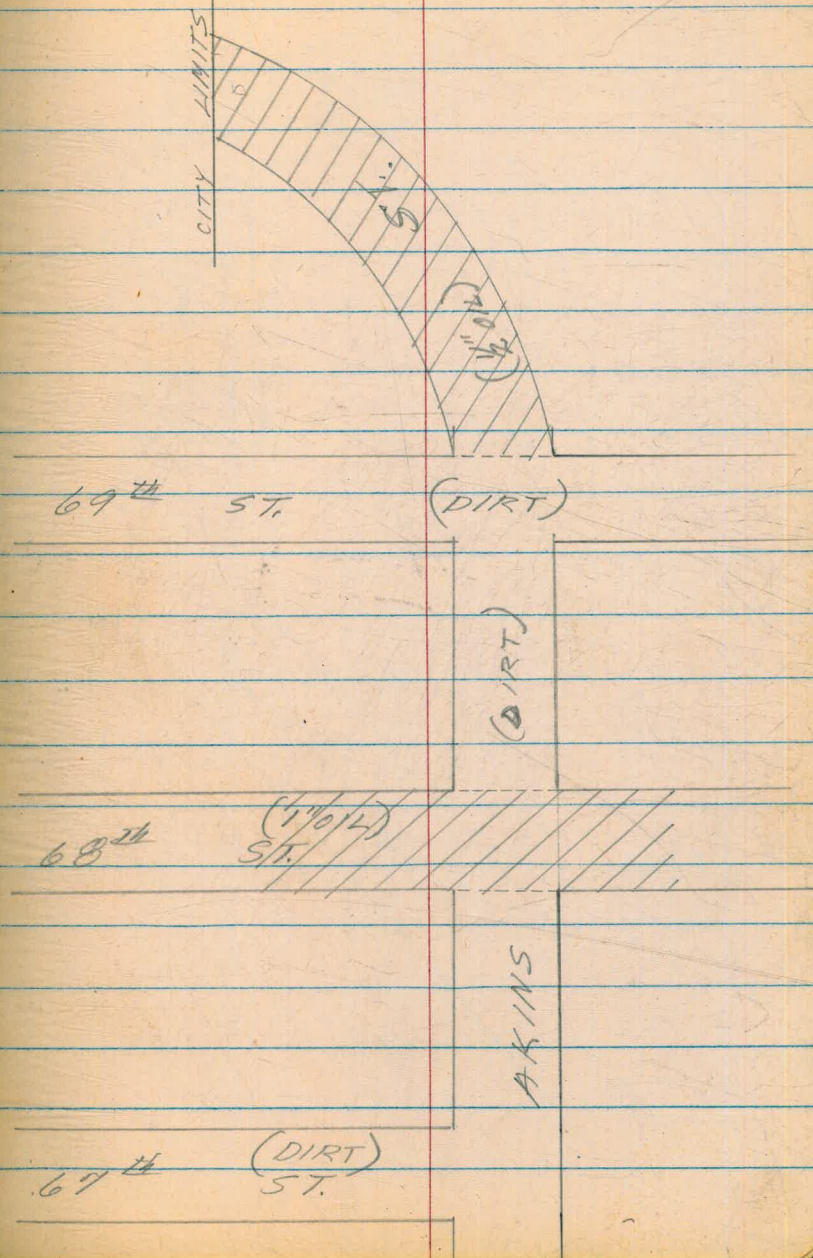

Williams
Kemp

Hilger St.
Klauber to Gibson

12/52

59.

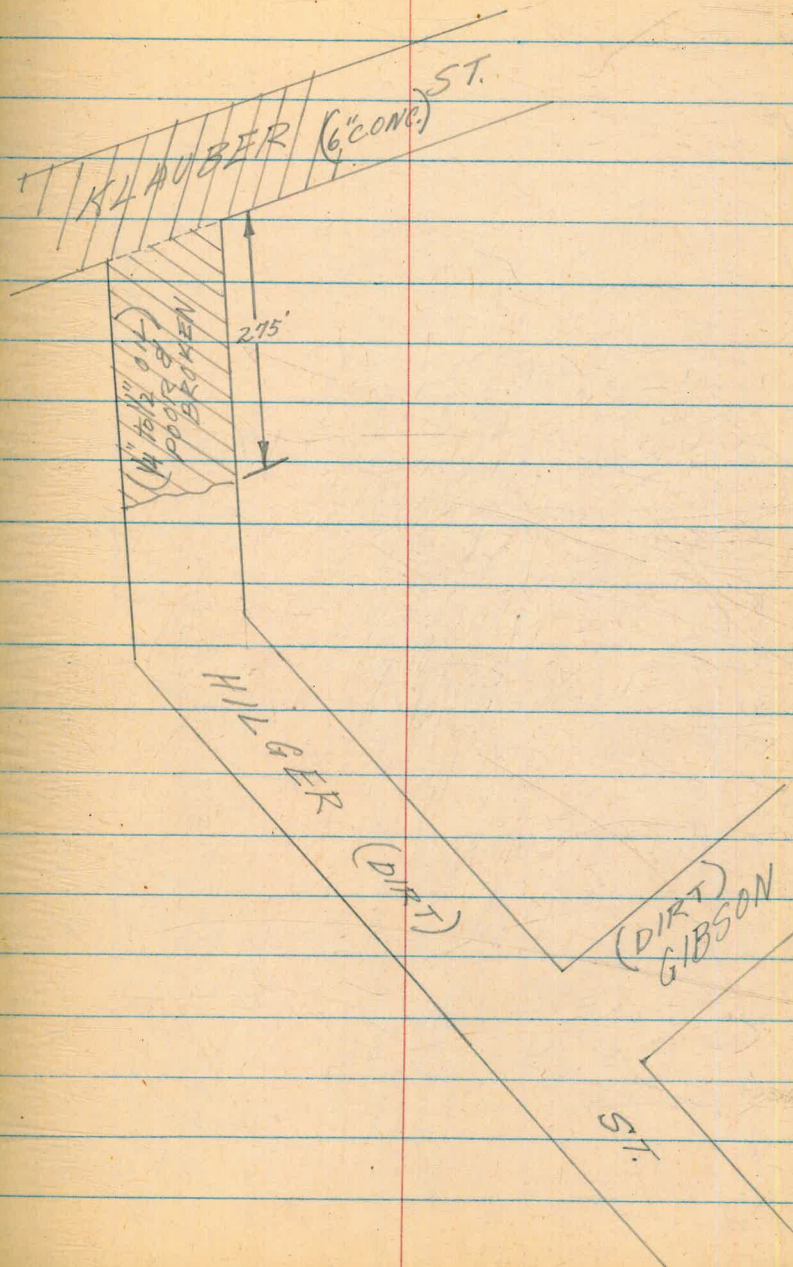

Williams
Kemp

Vista Unit #1
Hwy 395 & Linda Vista Rd.

12/52

60.

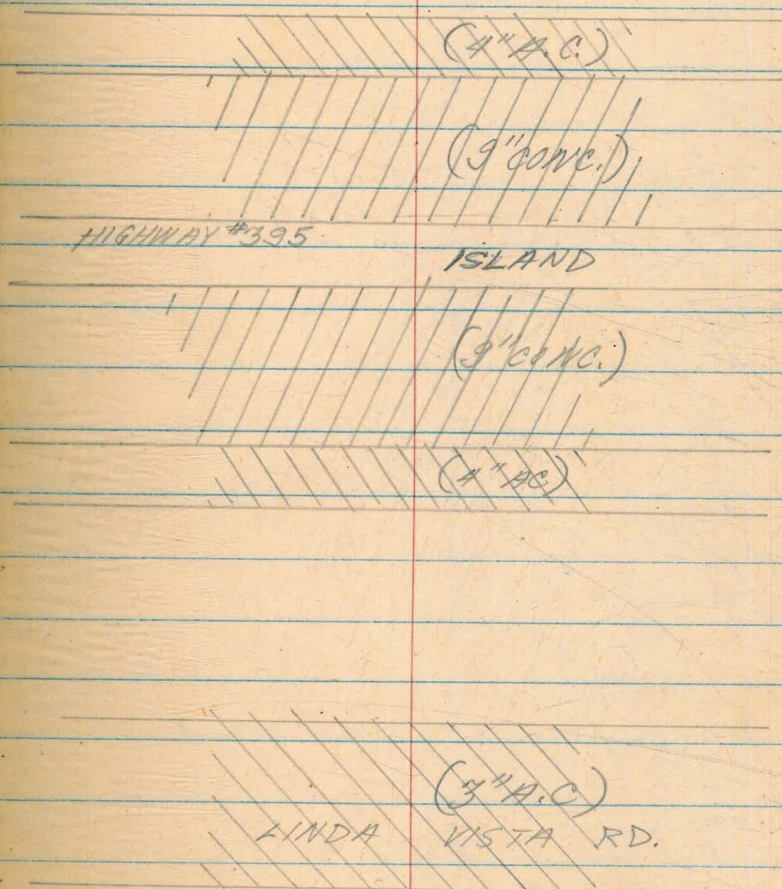

Fergus St Imperial 61.
to Brooklyn

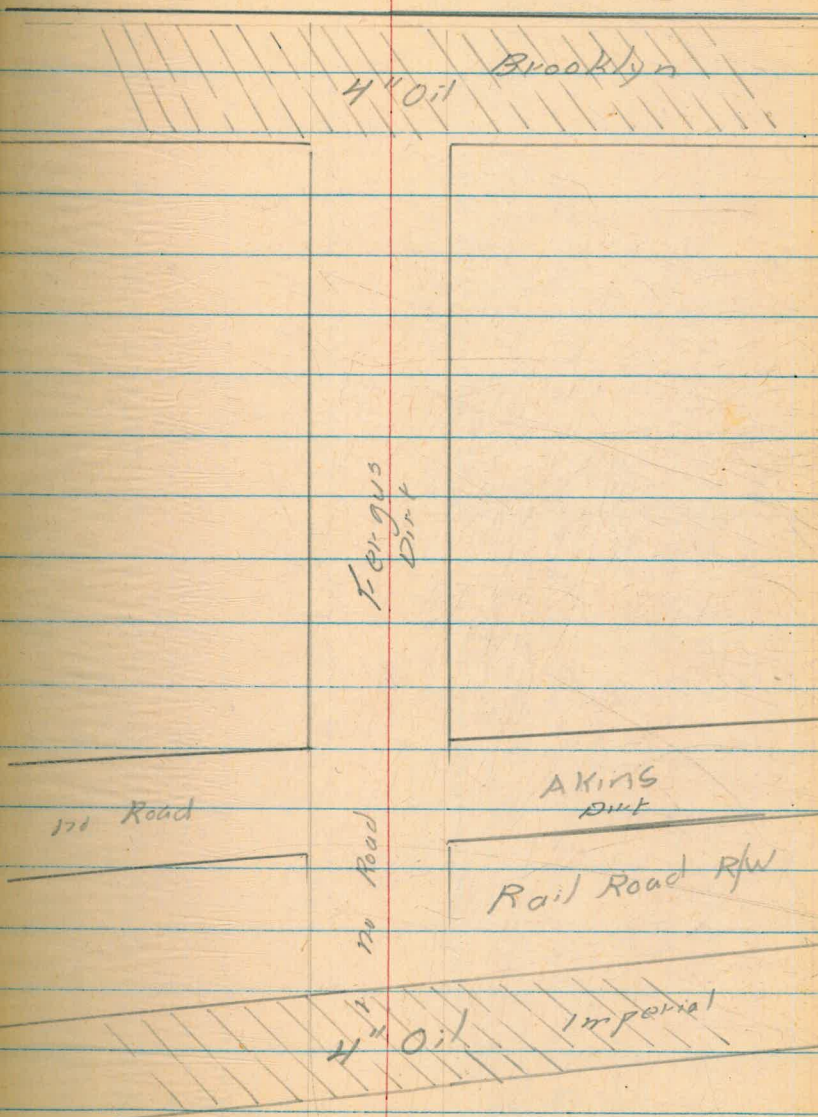

West
Martell
Varon folio

6 Jan 53

Naranja St Euclid to 54 62.

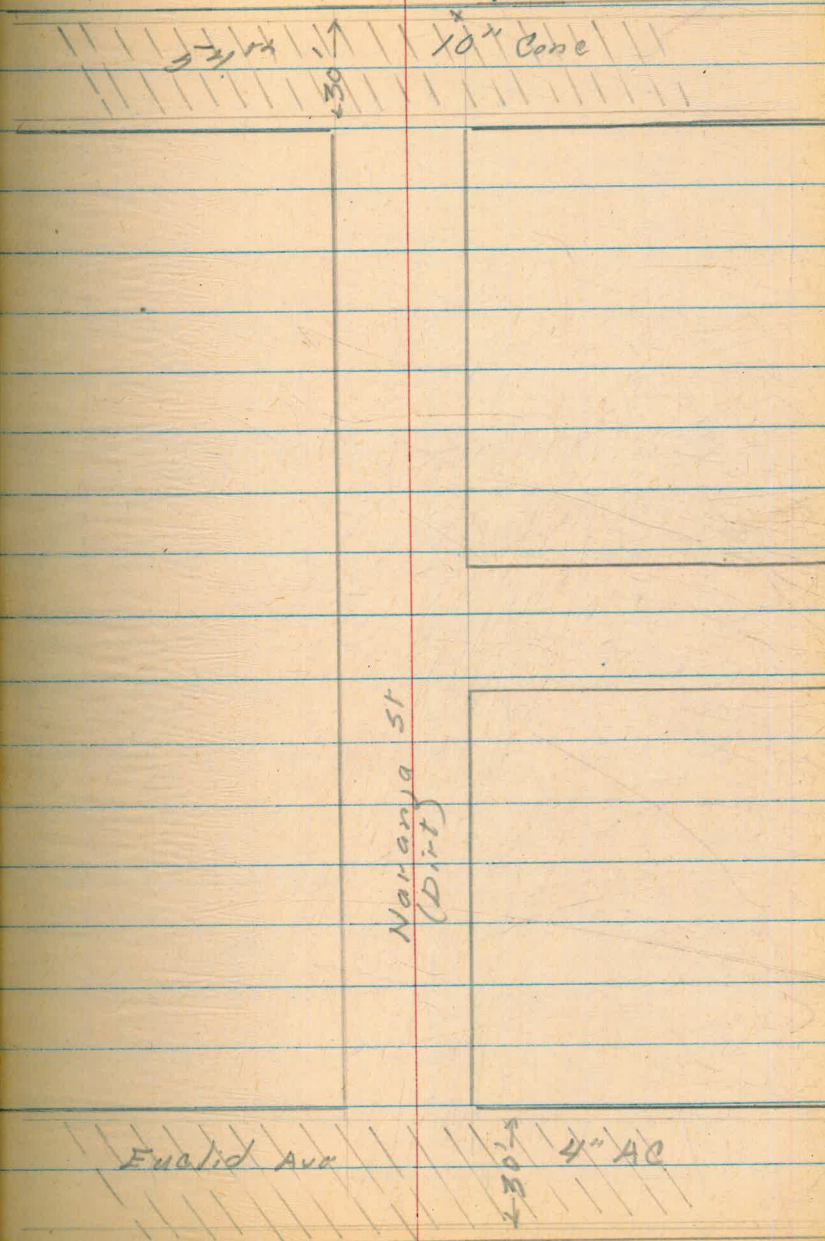

Akins St

631

West
Marble
Vancouver

7 Jan 53

65th

4" AC

500

(Dirt)
Akins

Stork (Dirt)

62nd

1" oil

Dirt 137

Fergus
Dirt

Akins

61st

(poor
road)

(No Road)

60th
Dirt

West
hertall
Valon Fakie

Alley # 55

64.

N of Wightman E of 38th

University Ave

4" Oil over 6" Conc

Prop Line to Prop Line

Alley 55
(Dike)

Wightman 56

4" Co & 1/2 AC Pav Prop Line to Prop Line

Mallard St Springfield to Alcedo 65.

West
mortell
vaion takes

7 Jan 53

Springfield
(Dirt)

Mulberry
(No Road)

Mallard
(Dirt)

Alcedo
(No Road)

Radio Dr

66.

Attrix to Wmsett

Attrix 56
15' Oil to Prop Lin

Radio Dr
(20' to 25')

Wmsett
15 to 20' Oil

Paradise St

Springfield
to Tooloy

67.

West
mortar
Veronakis

7 Jan 63

Tooloy
Dirt

Paradise St

(Dirt)

Mulberry
(100 Road)

Springfield
(Dirt)

Taft

69

Colima to Forward

Colima

5" Conc Pave

Wesley
Martell
Varonakis

31 Dec 52

5" Conc

Poor Condition

Midway

5" Conc Pave

Taft

Dir

Forward

5" Conc Pave

Weaverly Ave
Midway to Forward

70.

West
Martell
Voronfok

31 Dec 52

Forward 5" Conc Pavt

Weaverly Ave
(Dirt)

Midway St

5" Conc Pavt

Sterne St

71.

Willow to Evergreen

2 1/2 Blacktop

5 ft

Evergreen

West
martell
Varenfakis

31 Pools

Sterne St

Willow St

8" Cord Dave

Bancroft

72.

Alley S of Adams to Copley

Thickness of Pav.

6" AC
②

Copley

14+25-10' E. C.
6 1/2" A.C. - All looks same
KING - 4-11-53

Note: Probably 15 1/2" AC

6" Base A.C. KING - 5-11-53
2" AC
8+26-10' East 2

6" AC
②

Collier Ave

Bancroft
②

2" A.C. 4 1/2" A.C. Base - King 5-11
4+75-10' E. 2

0+85-2" A.C. 6" A.C. Base

2" A.C.
6" Comp. Prop. h. to Prop. h.
Adams

6" AC
②

2" A.C. 3" AC Base - King
-1430

Alley S of Adams

33rd St

73.

Alley S of Adams to Copley

Note:

Oil Surface loose
on Top Pav.
Varies 1" - 1 1/2" cold lay.
or oil

Note: Oil Surface

a very poor MixTime

Adams-Copley

2" A.C.
4" CONC.
10' E of 4 - 1+30

1" AC
4" CONC.

Copley

1" Cold Lay
4" CONC. - King

1" AC Collar
OVER 4" CONC.

9+12 - 1" A.C. 4" CONC.
King

1 1/2" AC OVER 4" CONC.

6+00 - 1 1/2" A.C. 4" CONC.
King

2+25 I No. P.L. Adams

2" AC 6" CONC. 33rd
2" A.C. 6" CONC. Adams

1" AC OVER 4" CONC.

Alley S of Adams

Felton St
 Alley S of Adams to Copley
 Copley

26.

Note: Has been

patched & Repatched

Thickness varies with
 Repairs - King-4-11-53

6" AC

14x25 - 10' East of
 1" AC.
 5" AC. Base - King

10' E. of

Collector

4" AC

Note: Same Repairs
 as above.

7+70
 2" AC.
 4" AC. base - King

5" AC

5/7/53 Bushy
 2" AC.
 0+80 6" CONC (B)

Adams

0+100 2" AC (B)
 6" CONC

6" AC

2" AC (B)
 -1+30 4" AC BASE

Alley S of Adams

3456

75.

Alley S of Adams to Mt View

NT View 3" conc soil

King 27+80 - 1 1/2" A.C.

4" CONC.

10' E. 2

1" oil

4" CONC. (W)

Arthur Ave

King 22+15 - 1 1/2" A.C.

4" CONC.

10' E. 2

1 1/4" oil

4" CONC. (W)

10' E. 2

King 16+30 - 1 1/2" A.C.

4" CONC.

Copley Ave

1" oil

4" CONC. - WEST

Collier Ave

King 8+12 - 1 1/2" A.C.

4" CONC.

Good oil

1" oil

4" CONC. (W)

King 2+05 1/2

2" A.C. 4" CONC.

2" A.C. 6" CONC. Adams

P.L. to P.L.

FINE

Adams

King 0+00 2" A.C. 4" CONC.

3" oil

3" CONC. (W)

Alley S. of Adams

76

Alcedo Mollard to Mulberry

West
Martell

31 Dec 52

Varonakis

Mulberry
(no Road)

Alcedo
(no Road)

Mollard
(no Road)

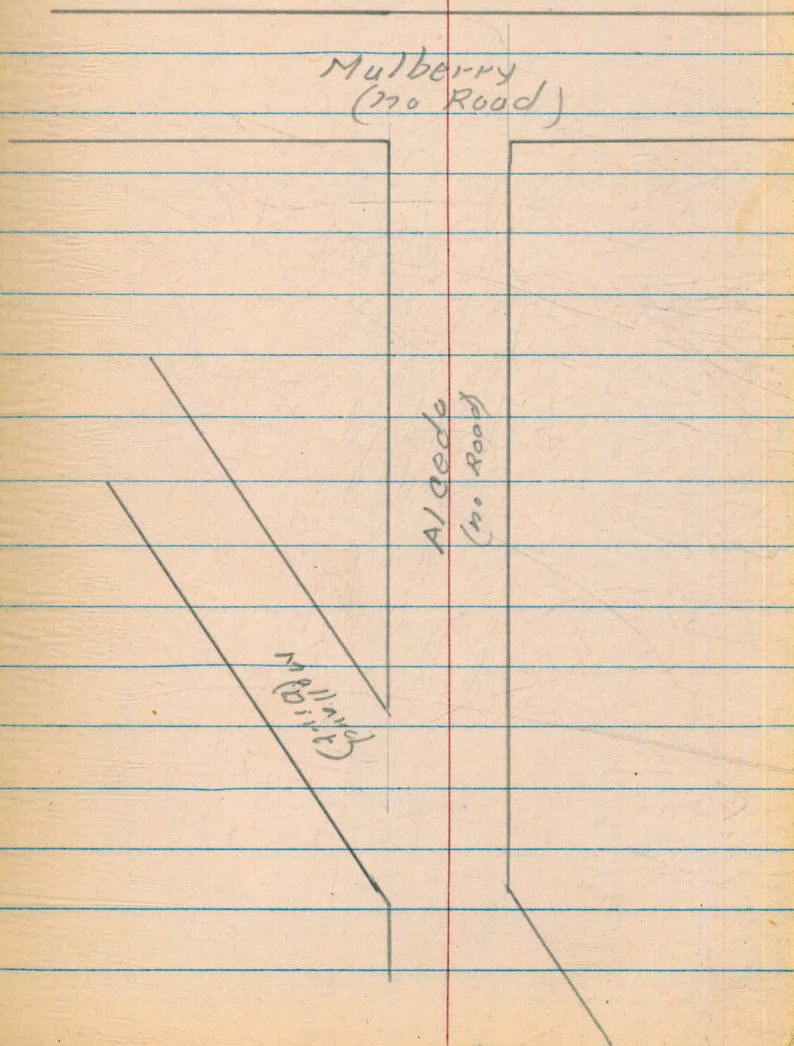

G/31 St 5+ Detroit to Benson 79.

Benson

Dirt (poor road)

75
15
19
(4.10.19)

Detroit St

400

9" cone

Please Return to
City of San Diego Water Dept.
Room 903 Civic Center

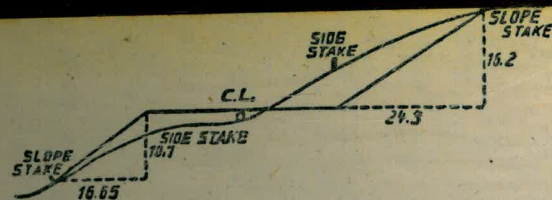

DISTANCES FROM SIDE STAKES FOR CROSS-SECTIONING.
SLOPE $1\frac{1}{2}$ TO 1. ROADWAY OF ANY WIDTH.

	0	.1	.2	.3	.4	.5	.6	.7	.8	.9	
0	0.00	0.15	0.30	0.45	0.60	0.75	0.90	1.05	1.20	1.35	0
1	1.50	1.65	1.80	1.95	2.10	2.25	2.40	2.55	2.70	2.85	1
2	3.00	3.15	3.30	3.45	3.60	3.75	3.90	4.05	4.20	4.35	2
3	4.50	4.65	4.80	4.95	5.10	5.25	5.40	5.55	5.70	5.85	3
4	6.00	6.15	6.30	6.45	6.60	6.75	6.90	7.05	7.20	7.35	4
5	7.50	7.65	7.80	7.95	8.10	8.25	8.40	8.55	8.70	8.85	5
6	9.00	9.15	9.30	9.45	9.60	9.75	9.90	10.05	10.20	10.35	6
7	10.50	10.65	10.80	10.95	11.10	11.25	11.40	11.55	11.70	11.85	7
8	12.00	12.15	12.30	12.45	12.60	12.75	12.90	13.05	13.20	13.35	8
9	13.50	13.65	13.80	13.95	14.10	14.25	14.40	14.55	14.70	14.85	9
10	15.00	15.15	15.30	15.45	15.60	15.75	15.90	16.05	16.20	16.35	10
11	16.50	16.65	16.80	16.95	17.10	17.25	17.40	17.55	17.70	17.85	11
12	18.00	18.15	18.30	18.45	18.60	18.75	18.90	19.05	19.20	19.35	12
13	19.50	19.65	19.80	19.95	20.10	20.25	20.40	20.55	20.70	20.85	13
14	21.00	21.15	21.30	21.45	21.60	21.75	21.90	22.05	22.20	22.35	14
15	22.50	22.65	22.80	22.95	23.10	23.25	23.40	23.55	23.70	23.85	15
16	24.00	24.15	24.30	24.45	24.60	24.75	24.90	25.05	25.20	25.35	16
17	25.50	25.65	25.80	25.95	26.10	26.25	26.40	26.55	26.70	26.85	17
18	27.00	27.15	27.30	27.45	27.60	27.75	27.90	28.05	28.20	28.35	18
19	28.50	28.65	28.80	28.95	29.10	29.25	29.40	29.55	29.70	29.85	19
20	30.00	30.15	30.30	30.45	30.60	30.75	30.90	31.05	31.20	31.35	20
21	31.50	31.65	31.80	31.95	32.10	32.25	32.40	32.55	32.70	32.85	21
22	33.00	33.15	33.30	33.45	33.60	33.75	33.90	34.05	34.20	34.35	22
23	34.50	34.65	34.80	34.95	35.10	35.25	35.40	35.55	35.70	35.85	23
24	36.00	36.15	36.30	36.45	36.60	36.75	36.90	37.05	37.20	37.35	24
25	37.50	37.65	37.80	37.95	38.10	38.25	38.40	38.55	38.70	38.85	25
26	39.00	39.15	39.30	39.45	39.60	39.75	39.90	40.05	40.20	40.35	26
27	40.50	40.65	40.80	40.95	41.10	41.25	41.40	41.55	41.70	41.85	27
28	42.00	42.15	42.30	42.45	42.60	42.75	42.90	43.05	43.20	43.35	28
29	43.50	43.65	43.80	43.95	44.10	44.25	44.40	44.55	44.70	44.85	29
30	45.00	45.15	45.30	45.45	45.60	45.75	45.90	46.05	46.20	46.35	30
31	46.50	46.65	46.80	46.95	47.10	47.25	47.40	47.55	47.70	47.85	31
32	48.00	48.15	48.30	48.45	48.60	48.75	48.90	49.05	49.20	49.35	32
33	49.50	49.65	49.80	49.95	50.10	50.25	50.40	50.55	50.70	50.85	33
34	51.00	51.15	51.30	51.45	51.60	51.75	51.90	52.05	52.20	52.35	34
35	52.50	52.65	52.80	52.95	53.10	53.25	53.40	53.55	53.70	53.85	35
36	54.00	54.15	54.30	54.45	54.60	54.75	54.90	55.05	55.20	55.35	36
37	55.50	55.65	55.80	55.95	56.10	56.25	56.40	56.55	56.70	56.85	37
38	57.00	57.15	57.30	57.45	57.60	57.75	57.90	58.05	58.20	58.35	38
39	58.50	58.65	58.80	58.95	59.10	59.25	59.40	59.55	59.70	59.85	39
40	60.00	60.15	60.30	60.45	60.60	60.75	60.90	61.05	61.20	61.35	40
41	61.50	61.65	61.80	61.95	62.10	62.25	62.40	62.55	62.70	62.85	41
42	63.00	63.15	63.30	63.45	63.60	63.75	63.90	64.05	64.20	64.35	42
43	64.50	64.65	64.80	64.95	65.10	65.25	65.40	65.55	65.70	65.85	43
44	66.00	66.15	66.30	66.45	66.60	66.75	66.90	67.05	67.20	67.35	44
45	67.50	67.65	67.80	67.95	68.10	68.25	68.40	68.55	68.70	68.85	45
46	69.00	69.15	69.30	69.45	69.60	69.75	69.90	70.05	70.20	70.35	46
47	70.50	70.65	70.80	70.95	71.10	71.25	71.40	71.55	71.70	71.85	47
48	72.00	72.15	72.30	72.45	72.60	72.75	72.90	73.05	73.20	73.35	48
49	73.50	73.65	73.80	73.95	74.10	74.25	74.40	74.55	74.70	74.85	49
50	75.00	75.15	75.30	75.45	75.60	75.75	75.90	76.05	76.20	76.35	50

THE NATIONAL BLANK BOOK COMPANY
HOLYOKE MASSACHUSETTS
NEW YORK CHICAGO BOSTON SAN FRANCISCO