

W 870

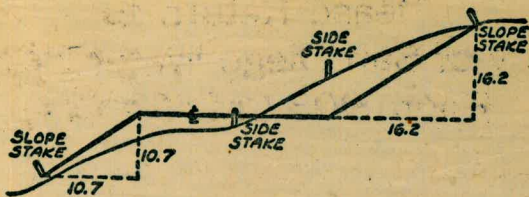



DISTANCES FROM SIDE STAKES FOR CROSS-SECTIONING  
SLOPE 1 TO 1. ROADWAY OF ANY WIDTH

	0	.1	.2	.3	.4	.5	.6	.7	.8	.9	
0	0.00	0.10	0.20	0.30	0.40	0.50	0.60	0.70	0.80	0.90	0
1	1.00	1.10	1.20	1.30	1.40	1.50	1.60	1.70	1.80	1.90	1
2	2.00	2.10	2.20	2.30	2.40	2.50	2.60	2.70	2.80	2.90	2
3	3.00	3.10	3.20	3.30	3.40	3.50	3.60	3.70	3.80	3.90	3
4	4.00	4.10	4.20	4.30	4.40	4.50	4.60	4.70	4.80	4.90	4
5	5.00	5.10	5.20	5.30	5.40	5.50	5.60	5.70	5.80	5.90	5
6	6.00	6.10	6.20	6.30	6.40	6.50	6.60	6.70	6.80	6.90	6
7	7.00	7.10	7.20	7.30	7.40	7.50	7.60	7.70	7.80	7.90	7
8	8.00	8.10	8.20	8.30	8.40	8.50	8.60	8.70	8.80	8.90	8
9	9.00	9.10	9.20	9.30	9.40	9.50	9.60	9.70	9.80	9.90	9
10	10.00	10.10	10.20	10.30	10.40	10.50	10.60	10.70	10.80	10.90	10
11	11.00	11.10	11.20	11.30	11.40	11.50	11.60	11.70	11.80	11.90	11
12	12.00	12.10	12.20	12.30	12.40	12.50	12.60	12.70	12.80	12.90	12
13	13.00	13.10	13.20	13.30	13.40	13.50	13.60	13.70	13.80	13.90	13
14	14.00	14.10	14.20	14.30	14.40	14.50	14.60	14.70	14.80	14.90	14
15	15.00	15.10	15.20	15.30	15.40	15.50	15.60	15.70	15.80	15.90	15
16	16.00	16.10	16.20	16.30	16.40	16.50	16.60	16.70	16.80	16.90	16
17	17.00	17.10	17.20	17.30	17.40	17.50	17.60	17.70	17.80	17.90	17
18	18.00	18.10	18.20	18.30	18.40	18.50	18.60	18.70	18.80	18.90	18
19	19.00	19.10	19.20	19.30	19.40	19.50	19.60	19.70	19.80	19.90	19
20	20.00	20.10	20.20	20.30	20.40	20.50	20.60	20.70	20.80	20.90	20
21	21.00	21.10	21.20	21.30	21.40	21.50	21.60	21.70	21.80	21.90	21
22	22.00	22.10	22.20	22.30	22.40	22.50	22.60	22.70	22.80	22.90	22
23	23.00	23.10	23.20	23.30	23.40	23.50	23.60	23.70	23.80	23.90	23
24	24.00	24.10	24.20	24.30	24.40	24.50	24.60	24.70	24.80	24.90	24
25	25.00	25.10	25.20	25.30	25.40	25.50	25.60	25.70	25.80	25.90	25
26	26.00	26.10	26.20	26.30	26.40	26.50	26.60	26.70	26.80	26.90	26
27	27.00	27.10	27.20	27.30	27.40	27.50	27.60	27.70	27.80	27.90	27
28	28.00	28.10	28.20	28.30	28.40	28.50	28.60	28.70	28.80	28.90	28
29	29.00	29.10	29.20	29.30	29.40	29.50	29.60	29.70	29.80	29.90	29
30	30.00	30.10	30.20	30.30	30.40	30.50	30.60	30.70	30.80	30.90	30
31	31.00	31.10	31.20	31.30	31.40	31.50	31.60	31.70	31.80	31.90	31
32	32.00	32.10	32.20	32.30	32.40	32.50	32.60	32.70	32.80	32.90	32
33	33.00	33.10	33.20	33.30	33.40	33.50	33.60	33.70	33.80	33.90	33
34	34.00	34.10	34.20	34.30	34.40	34.50	34.60	34.70	34.80	34.90	34
35	35.00	35.10	35.20	35.30	35.40	35.50	35.60	35.70	35.80	35.90	35
36	36.00	36.10	36.20	36.30	36.40	36.50	36.60	36.70	36.80	36.90	36
37	37.00	37.10	37.20	37.30	37.40	37.50	37.60	37.70	37.80	37.90	37
38	38.00	38.10	38.20	38.30	38.40	38.50	38.60	38.70	38.80	38.90	38
39	39.00	39.10	39.20	39.30	39.40	39.50	39.60	39.70	39.80	39.90	39
40	40.00	40.10	40.20	40.30	40.40	40.50	40.60	40.70	40.80	40.90	40
41	41.00	41.10	41.20	41.30	41.40	41.50	41.60	41.70	41.80	41.90	41
42	42.00	42.10	42.20	42.30	42.40	42.50	42.60	42.70	42.80	42.90	42
43	43.00	43.10	43.20	43.30	43.40	43.50	43.60	43.70	43.80	43.90	43
44	44.00	44.10	44.20	44.30	44.40	44.50	44.60	44.70	44.80	44.90	44
45	45.00	45.10	45.20	45.30	45.40	45.50	45.60	45.70	45.80	45.90	45
46	46.00	46.10	46.20	46.30	46.40	46.50	46.60	46.70	46.80	46.90	46
47	47.00	47.10	47.20	47.30	47.40	47.50	47.60	47.70	47.80	47.90	47
48	48.00	48.10	48.20	48.30	48.40	48.50	48.60	48.70	48.80	48.90	48
49	49.00	49.10	49.20	49.30	49.40	49.50	49.60	49.70	49.80	49.90	49
50	50.00	50.10	50.20	50.30	50.40	50.50	50.60	50.70	50.80	50.90	50

Distance of slope stake from side or shoulder stake for any width roadway, slope 1 to 1. If ground is nearly level, the cut or fill at side stake is located by the double entry method in left column and top row. The number in body of table in same row and column gives distance from side stake to slope stake. If ground is not level estimate the difference in elevation between the side stake and slope stake, lower target by this amount if cut, elevate if fill. Add this amount to cut or fill and find distance in table. Set up rod at this point, and line of sight should cut target. If it does not make the slight adjustment necessary.

Please Return to  
City of San Diego Water Dept.  
Room 903 Civic Center

90.5" Circ

TT-d

0.2183

31416 / 1.0000.0

94248

50520

31016

267020

251328

97120

3183

90.5

286070

2880615



TABLE XIII—CORRECTIONS FOR TANGENTS AND EXTERNALS

These corrections are to be added to the approximate values, found by dividing the tangent, or external, for a 1° curve (Table VIII) by the degree of curve, in order to obtain the true tangents, or externals. Intermediate values may be obtained by interpolation.

FOR TANGENTS ADD

Central Angle	DEGREE OF CURVE													
	5°	10°	15°	20°	25°	30°	35°	40°	45°	50°	55°	60°	65°	70°
10°	.03	.06	.09	.13	.16	.19	.22	.25	.28	.31	.34	.38	.42	.46
15°	.04	.10	.14	.19	.24	.29	.34	.39	.45	.51	.53	.58	.63	.68
20°	.06	.13	.19	.26	.32	.39	.45	.51	.58	.65	.72	.79	.84	.90
25°	.08	.16	.24	.33	.40	.49	.58	.67	.75	.83	.90	.99	1.06	1.14
30°	.10	.19	.29	.39	.49	.59	.69	.79	.89	.99	1.09	1.20	1.29	1.39
35°	.11	.22	.34	.47	.58	.69	.79	.89	.99	1.04	1.29	1.42	1.54	1.66
40°	.13	.26	.40	.53	.67	.80	.93	1.06	1.20	1.34	1.49	1.64	1.79	1.94
45°	.15	.30	.44	.60	.76	.91	1.06	1.21	1.37	1.52	1.70	1.87	2.04	2.21
50°	.17	.34	.51	.68	.85	1.02	1.19	1.36	1.54	1.72	1.91	2.10	2.29	2.48
55°	.19	.38	.57	.76	.95	1.14	1.32	1.52	1.72	1.92	2.14	2.35	2.56	2.77
60°	.21	.42	.63	.84	1.05	1.27	1.49	1.71	1.94	2.17	2.38	2.60	2.83	3.07
65°	.23	.46	.69	.93	1.16	1.40	1.64	1.88	2.13	2.38	2.63	2.88	3.13	3.39
70°	.25	.51	.76	1.02	1.28	1.54	1.80	2.06	2.33	2.60	2.88	3.16	3.44	3.72
75°	.27	.56	.83	1.12	1.40	1.69	1.98	2.27	2.57	2.87	3.16	3.47	3.78	4.09
80°	.30	.61	.91	1.22	1.53	1.84	2.15	2.46	2.78	3.10	3.44	3.78	4.12	4.46
85°	.33	.66	1.00	1.33	1.68	2.02	2.36	2.70	3.05	3.40	3.77	4.14	4.55	4.89
90°	.36	.72	1.09	1.45	1.83	2.20	2.57	2.94	3.32	3.70	4.10	4.50	4.91	5.32
95°	.39	.79	1.19	1.55	2.00	2.40	2.80	3.20	3.61	4.02	4.40	4.98	5.38	5.83
100°	.43	.86	1.30	1.74	2.18	2.62	3.06	3.50	3.95	4.40	4.88	5.37	5.85	6.34
110°	.51	1.03	1.56	2.08	2.61	3.14	3.67	4.21	4.76	5.31	5.86	6.43	7.01	7.60
120°	.62	1.25	1.93	2.52	3.16	3.81	4.45	5.11	5.77	6.44	7.12	7.80	8.50	9.22

FOR EXTERNALS ADD

Central Angle	DEGREE OF CURVE														
	5°	10°	15°	20°	25°	30°	35°	40°	45°	50°	55°	60°	65°	70°	
10°	.001	.003	.004	.006	.007	.008	.009	.011	.012	.014	.015	.017	.018	.020	
15°	.003	.007	.010	.014	.018	.023	.027	.029	.032	.035	.039	.043	.047	.051	
20°	.006	.011	.017	.022	.028	.034	.038	.045	.051	.057	.063	.070	.076	.083	
25°	.009	.018	.027	.036	.046	.056	.067	.074	.083	.093	.103	.120	.127	.135	
30°	.013	.025	.038	.051	.065	.078	.090	.103	.116	.129	.149	.170	.179	.188	
35°	.018	.035	.054	.072	.086	.109	.131	.153	.175	.197	.213	.230	.247	.264	
40°	.023	.046	.070	.093	.117	.141	.172	.203	.234	.265	.277	.290	.315	.341	
45°	.030	.060	.093	.119	.153	.184	.216	.254	.289	.325	.351	.378	.411	.445	
50°	.037	.075	.116	.151	.189	.227	.266	.305	.345	.384	.425	.467	.508	.550	
55°	.046	.093	.142	.188	.236	.283	.332	.381	.420	.479	.530	.582	.641	.700	
60°	.056	.112	.168	.225	.283	.340	.398	.457	.516	.575	.636	.697	.774	.851	
65°	.067	.135	.204	.273	.343	.412	.483	.554	.625	.697	.711	.845	.922	1.01	
70°	.080	.159	.240	.321	.403	.485	.568	.652	.735	.819	.906	.994	1.08	1.17	
75°	.095	.182	.266	.353	.440	.528	.617	.707	.777	.877	.977	1.07	1.18	1.29	1.39
80°	.110	.220	.332	.445	.558	.671	.787	.903	1.02	1.13	1.25	1.38	1.50	1.62	
85°	.128	.259	.391	.524	.657	.790	.926	1.06	1.20	1.34	1.47	1.62	1.76	1.91	
90°	.149	.299	.450	.603	.756	.910	1.07	1.22	1.38	1.54	1.70	1.87	2.03	2.20	
95°	.174	.350	.522	.706	.885	1.06	1.25	1.43	1.62	1.80	1.99	2.18	2.38	2.58	
100°	.200	.401	.604	.809	1.01	1.22	1.43	1.64	1.85	2.06	2.28	2.50	2.73	2.96	
110°	.268	.536	.806	1.08	1.35	1.63	1.91	2.20	2.48	2.76	3.05	3.35	3.66	3.96	
120°	.360	.721	1.08	1.45	1.82	2.19	2.57	2.95	3.33	3.72	4.11	4.50	4.91	5.32	

INDEX

(prelim)  
 Dickens, Plum to Clove 0-2 ✓  
 (prelim)  
 Imperial, 49th to Churchward 3-7 ✓  
 (prelim)  
 Emerald St. Pundellon St to Olney St 8-10 ✓  
 Jewell St. Beryl St. to Los Altes Road 11-18 ✓  
 (prelim)  
 Monte Vista, Vista De La Playa to Fern Glen 19-21 ✓  
 (prelim)  
 (preliminary) Sixth St Exc. Cabrillo Frece. to Friars Rd. 22-25 ✓  
 ( " ) Stephens St. Arbor Dr. Nly 300' 26-27 ✓  
 ( " ) Cushman Ave, Solar to Plainview 28-32 ✓  
 " Reed Dr. Potomac to Cumberland 33-38 ✓  
 ( " ) Bachman Pl. Lewis to Arbor Drive 39-43 ✓  
 ( " ) E. Palasades Rd. 100' No Palasades Rd. 44-46 ✓  
 " Alley BIK. 21 So Park Pl. & N-Kensington 47-50 ✓  
 ( " ) Myrtle St, Alley E of Nile St to Alley W. of Nile 51-53 ✓  
 ( " ) Alley BIK "E" No. of Monroe Ave. E of Wilson St 54-57 ✓  
 ( " ) Alley BIK "G" No of Monroe Ave E of Cherokee St 58-61 ✓  
 (prelim) Landis St, Alley E of Cherokee to Cherokee St. 62-63 ✓  
 " Oliver St. Olney to Lamont St 64-71 ✓  
 " LANDIS ST, ALLEY E. of 36th TO CHEROKEE ST. 73-74 ✓  
 STKS FOR 6" A.C. ✓  
 REO DRIVE, POTOMAC TO CUMBERLAND 75-76 ✓  
 STKS. FOR 6" A.C. ✓  
 FRANKLIN AVE EVANS TO 28 77-78 ✓  
 alicc



Profile & Proposed Water on  
Dickens St., Plum to Clove

0+00	E/H of Plum
+35	Sewer M.H. 10' Rt
+70	W/H of Plum
1+00	Top of Slope
1+70	E edge of 1" oil surfacing
3+72	E/H of Clove
3+70	W edge of 1" oil surface
3+88	E curb line Clove
+05	Sewer M.H. 10' Rt.
4+22	W curb Clove
4+42	W/H of Clove

Wert  
Kemp  
Holahan 6-30-54

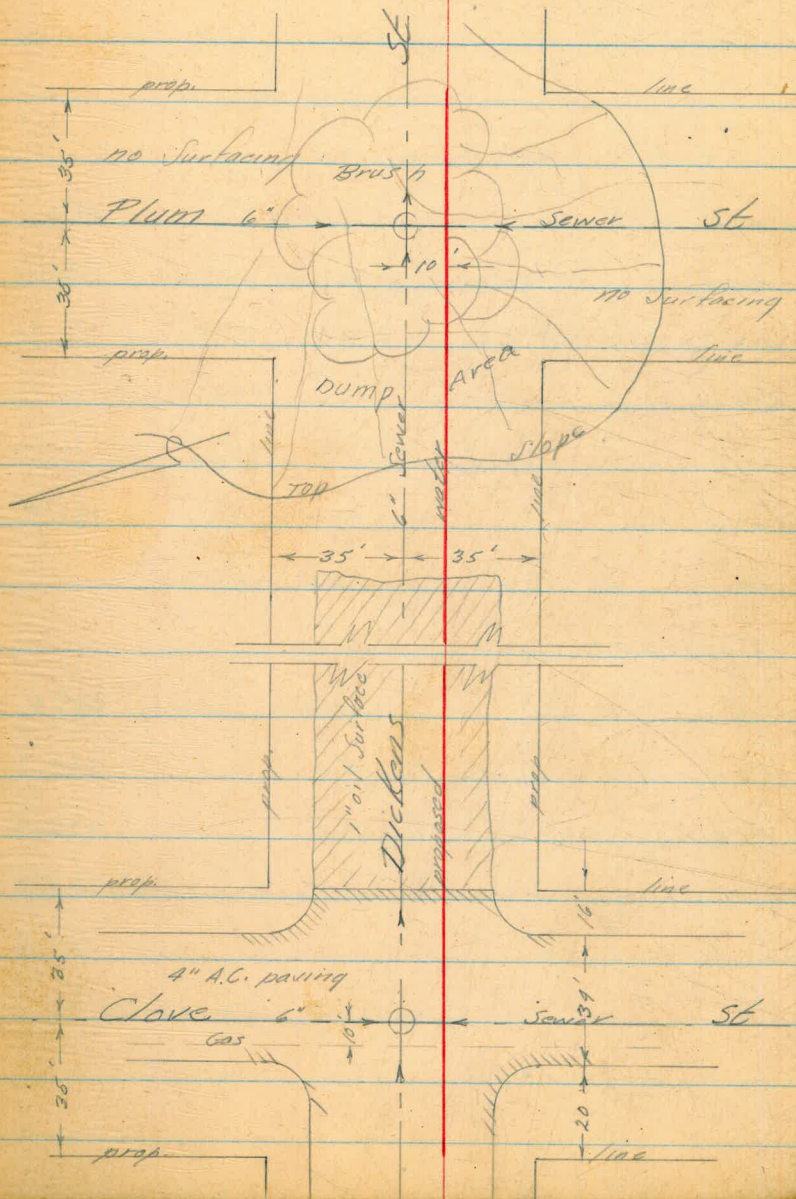



Profile of Dickens Cont.

121.33

1.35 122.68

0+00	11.6	111.1
+25	7.4	115.3
+35	5.2	
T.P.	17.6	120.92

12.0 132.92

0+50	12.0	120.9
T.P.	0.88	132.04

5.86 143.62

1+00	10.0	133.6
+25	9.3	134.3
+50	7.6	136.0
+70	4.8	138.8
2+00	1.8	141.8
T.P.	0.15	143.47

11.65 155.12

H/L & P Plum

P.L. water lines (proposed)

Sewer M.H. 6.2 to flow line

Top Slope

Ea. edge 1" oil surface



## Profile of Dicken Cont.

155.12

2+50	8.1	147.0
3+00	4.3	150.8
4+00	2.9	152.2
4+70	4.2	150.9
4+88	3.3	151.8
4+00	2.9	152.2
4+05	2.90	152.2
4+22	2.6	152.5
4+42	2.2	152.9

0.68 159.26

0.80

155.06

10.95 144.11

0.70 144.81

10.71 134.10

139.09

Sewer 5.2 to Plow

F.H. SE Dickens &amp; Plum Set. T.B.M.

B.M.

S.W. B.P. Carlton &amp; Plum



Profile Imperial Ave.

49th St. to Churchward

- 0+00 8" G.V. 16.5' R.L. of Imperial
- +26 Gas service 5' R.L. existing line
- +65 W. curb line of 49th St.
- +83 G.V. 10' R.L.
- +95 E. curb line
- 1+00 Back 4" sidewalk (concrete)
- 1+15 E edge con paving 6"
- +16 F.H. 15' R.L.
- 3+03.31 W/L of Ozark St.
- 4+23 G.V. 31.5' L.L. and curb line
- 4+33.31 E/L of Ozark
- 4+38 F.H. 15' back of prop.

STATIONS MOVED AHEAD  
40' TO MAKE THE W. LINE  
OF 49TH 0+00.  
REB  
7-19-54

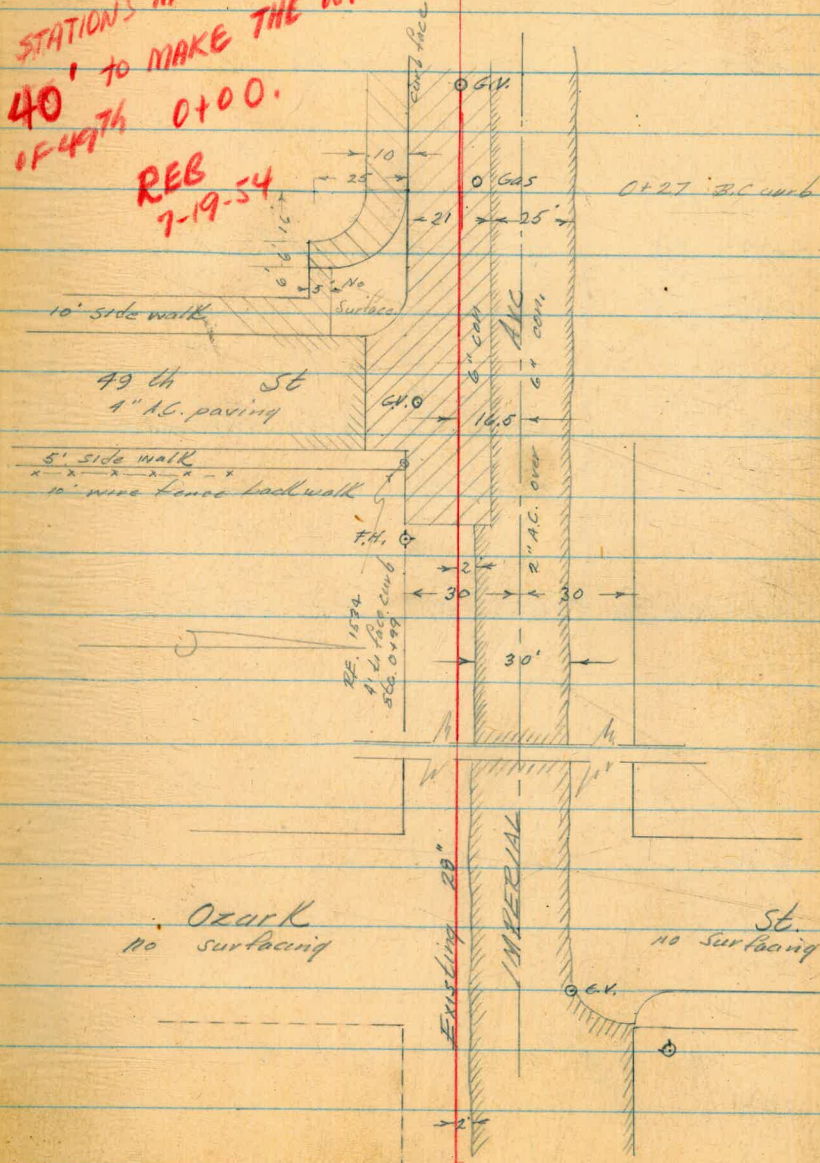

Wert  
Kemp  
Holahan 7-9-54



Group - Group 23  
Imperial Ave  
Pipeline

Filed Map -  
Ocean View Nts # 1341

+ Map # 283

3-3327

6517-W

C.F.

~~6470-L~~

~~2829-D~~

6475-L

6608-L

6818-L

FB 870



LS 200

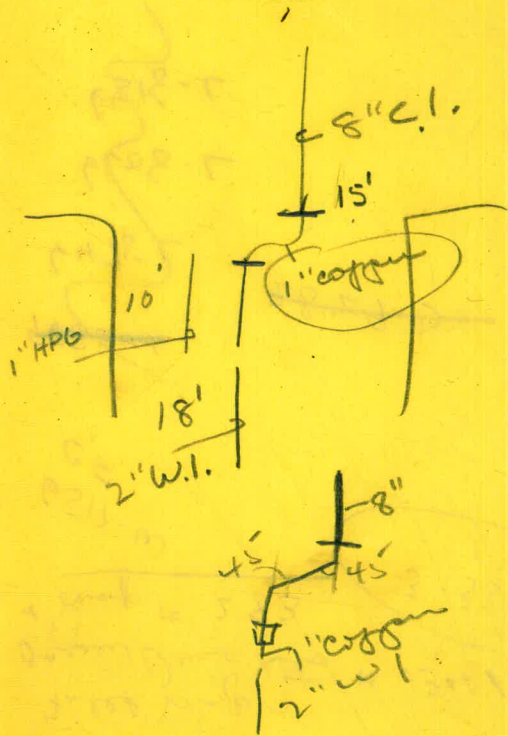



Profile of Imperial Cont.

8+33.31

W/H of 50th St.

8+83.31

E/H of 50th St

9+38

Abandon Valve chamber

4x4' con. (not opened)

9+68.31

iron pin B.C. of curve

10+68.5

C.V. 2' PL.

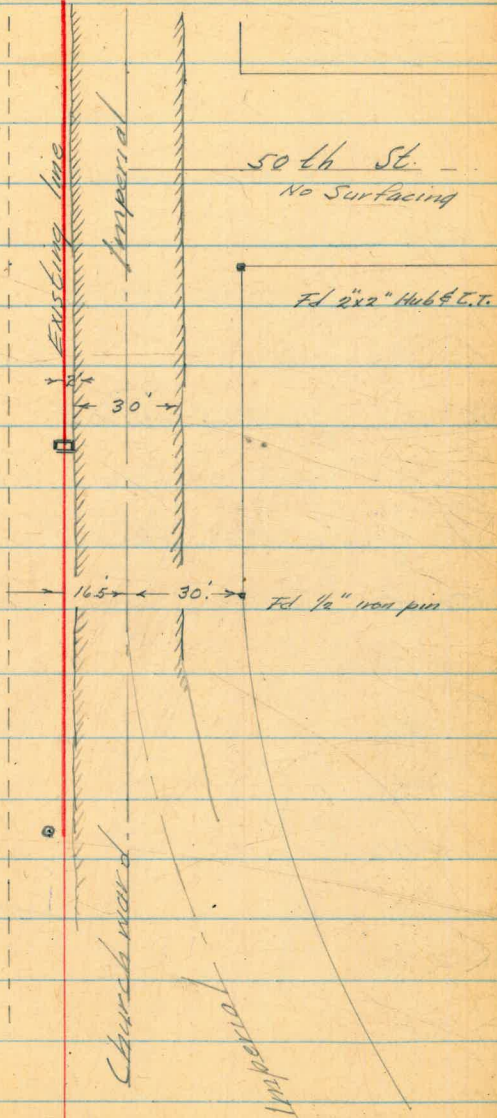



Profile of Imperial Ave

Cont

112.17

S.W. B.P. 47th & Imperial

10.20 122.37 ✓

T.P. 0.82 121.55 ✓

12.05 133.60 ✓

0.10 133.50 ✓

12.55 146.05 ✓

2.08 143.97 ✓

7.05 151.02 ✓

0+00 1.7 146.32

8" G.V.

+50 3.9 147.12

+69 3.5 147.52

W curb line 49th

+95 2.8 148.22

E " " "

1+00 2.7 148.32

+16 2.3 148.72

Edge con. Apron

+50 1.6 149.42

T.P. 0.54 150.48 ✓

12.09 162.52 ✓

Reduced by  
R. E. Barber  
7-22-54



Profile of Imperial Ave

Cont.

	162.52		
2+00	11.7	150.82	
+50	10.0	152.52	2+48 P.P. 4.5' RT. #76080
3+00	8.2	154.32	
+50	6.3	156.22	3+96 P.P. 5.2' RT. #P76081
4+00	3.7	158.82	
+50	1.5	161.02	4+36 1' DIA. TREE, 5' RT.
T.P.	0.02	162.50 <sup>✓</sup>	
	13.03	175.53 <sup>✓</sup>	
5+00	12.3	163.23	
+50	10.1	165.43	5+56 P.P. 5.5' RT. # P76082
6+00	7.8	167.73	
+50	5.3	170.23	
7+00	3.2	172.33	
+50	0.9	174.63	7+27 P.P. 7.0' RT # 76083
T.P.	0.13	175.40 <sup>✓</sup>	
	9.15	184.55 <sup>✓</sup>	
8+00	8.4	176.15	8+42 P.P. 5.5' RT. #JP760841



Profile of Imperial Ave.

184.55

8+50	7.1	177.45
9+00	5.5	179.05
+38	4.14	180.41
+68.31	3.5	181.05
10+00	2.5	182.05
+50	1.3	183.25
+68.5	0.8	183.75
T.P.	1.84	182.71 ✓
3.03		185.74 ✓
	0.70	185.04 ✓

9+36 4x4' CON. BOX ON E

9+38 65' RT. TREE 05' DIA.

Abandon Valve Box on 28" line

B.C. curve Imperial Ave

9+74 4.0' RT. 4'x4' Autoclub Sign

10+32 4.0' RT. 4'x4' City Limit Sign

10+50 P.P. 4.0' RT #300529H

End profile at G.V.

10+76 P.P. 6.0' RT #76085

P.P. So. Curb Imperial Ave, Churchward



9-21-54

Profile of Proposed Water  
Emerald St, Pendleton to Olney

83.11

B.P. S.W. cor. Pendleton & Diamond

0.20 83.31

13.02 70.29

1.40 71.69

0+00	5.2	66.49
+20	5.0	66.69
+20	5.7	65.99
+40	4.9	66.79
+50	5.1	66.59
+60	5.3	66.39
+80	5.1	66.59
1+00	4.8	66.89
+50	4.3	67.39
2+00	4.0	67.69
+50	4.0	67.69
3+00	4.3	67.39
+50	4.5	67.19

E/H of Pendleton

Top East curb

Gutter

E Pendleton & 8" Sewer cross, 12' to flow

West gutter

W/H Pendleton, end of 6" compaving



71.69

T.P. 4.66 67.03

7.44 74.47

4+00 7.7 66.77

+50 7.5 66.97

5+00 6.5 67.97

+50 5.1 69.37

6+00 3.7 70.77

+20 3.7 70.77

+60 1.9 77.57

± Olney St

W/K Olney St

T.P. 0.05 74.42

9.75 84.17

0.87 83.30

7.44 90.74

2.52 88.22

= 88.28 FH SE. Diamond & Olney



0+00 E/W of Pendleton St  
 +20 E curb line  
 +40 E Pendleton & sewer cross  
 +60 W curb line  
 +80 W/W of Pendleton St

5+80 E/W of Olney St  
 5+96 E edge of 4" A.G.  
 6+20 E of Olney  
 6+44 W edge of 4" A.G.  
 6+60 W/W of Olney

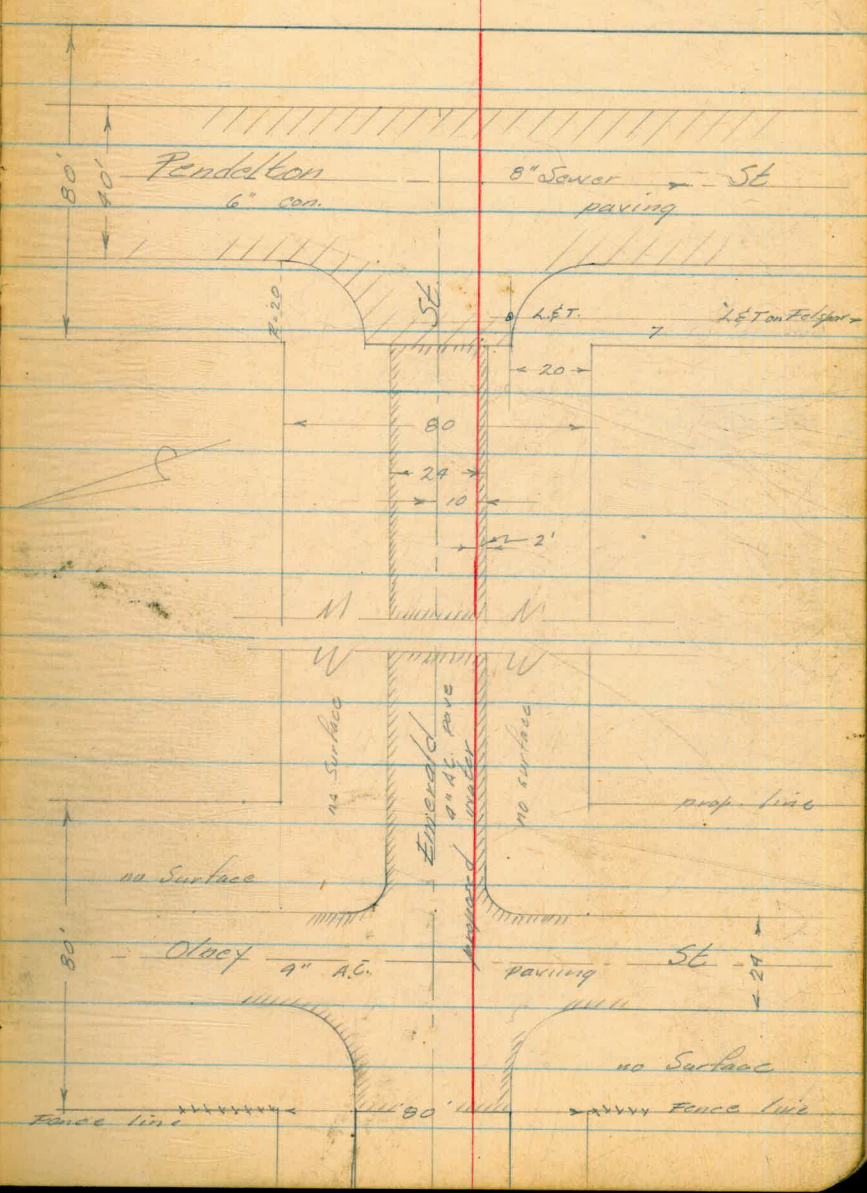



Profile Proposed Water Main  
on Jewell St, Beryl to Los Alamos

2+42 Sewer M.H. 10' 16"

2+42 Angle point in line

2+15 & Alley

0+80 N/H of Beryl

0+60 No curb line

0+40 & Beryl & sewer crossing

0+20 So. curb line

0+00 S/H of Beryl

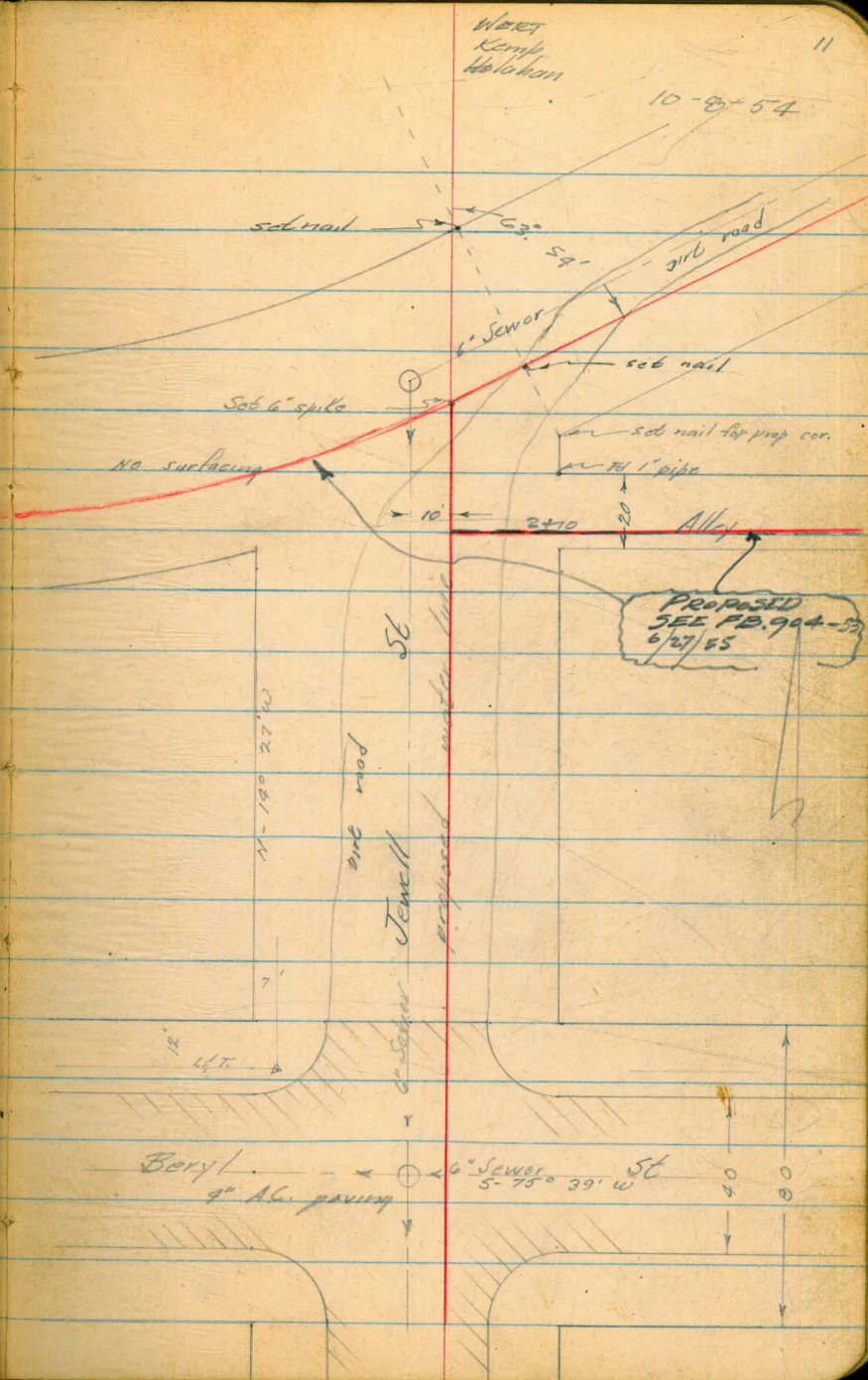



5+32.02

N/H of Collingwood

7d 2" pipe  
bent to left

4+82.02

S/H of Collingwood

Collingwood  
no surfacing

S-78° 39' W

dirt road

St.

no surfacing

4+14

Sewer M.H. 10' L6

4+09.29

Angle point

set nail

90°

158.35 to water

Jewell

proposed water

S-79° 27' W

set nail

set nail at prop. corn.

63° set nail

98°

dirt

set of spike

N



9+72.86 N/L of Los Altos  
 9+70.7 Rock wall @ Pl. water line  
 9+34.86 S/L of Los Altos

7+31.97 N/L of Malden  
 7+06.97 Sewer M.H. 10' dia.  
 6+81.97 S/L of Malden

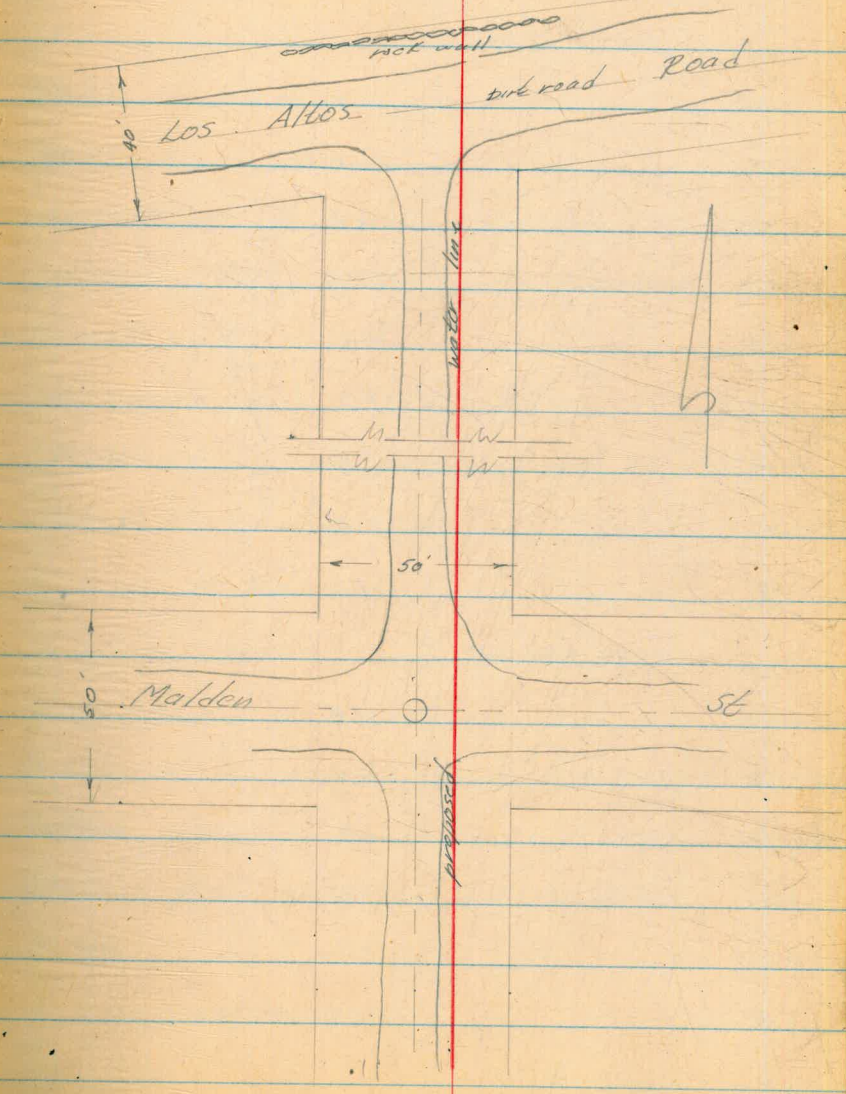



160.15

NE BR. Jewell & Beryl

2.20 169.35

0+00

12.9

156.45

S/H. of Beryl

+20

10.9

158.75

So. curb line

+40

10.3

159.05

1/2 Beryl & Sewer crossing

+60

10.35

159.0

Sewer M.H. 10' ht. 7.9 to flow

+80

10.3

159.05

No. curb line Beryl SE

+100

10.3

159.65

+80

7.9

161.45

End of A.C. paving & N/H of Beryl

1+00

3.6

165.75

T.P.

0.68

168.67

12.83 181.50

1+50

10.4

171.10

2+00

6.5

175.00

2+42

1.7

179.80

Angle point

+42

1.77

179.73

Sewer M.H. 10' ht. 6.4 to flow

2+50

1.2

180.30

T.P.

0.04

181.46

12.65 194.11

Reduced by J. Gray  
6-7-55



194.11  
94.11

3+00 10.5 183.61

+50 7.4 186.71

4+00.29 5.1 189.01

Angle point

4+14 4.2 189.91

Sewer crossing

+14 4.17 189.94

Sewer MH. 10 ft. 7.2 to flow

T.P. 0.55 193.56

12.39 205.95

4+50 10.1 195.85

5+00 7.8 204.15

T.P. 0.19 205.76

12.63 218.39

5+30.9 10.0 208.39

P.O.T.

T.P. 8.59 209.80

566 T.B.M. 2" prop pipe NW cor Jewell & Collingwood

11.75 221.55

5+65.9 7.6 213.95

P.O.T.

6+00 4.1 217.45

T.P. 0.35 221.20

12.55 233.75



233.75

6+50 10.6 223.15

+92 4.1 229.65

7+00 3.6 230.15

+23 1.1 232.65

T.P. 0.13 233.62

12.72 246.34

7+50 7.3 239.04

8+00 1.2 245.14

T.P. 0.22 246.12

11.54 257.66

8+50 7.1 250.56

+21 4.5 253.16

T.P. 0.76 256.90

11.32 268.22

9+00 9.2 259.02

+35 3.0 265.22

+50 2.4 265.82

9+70.70 1.4 266.82 Rock wall



	268.22		
T.P.		0.14	268.08
	0.45	268.53	
		12.15	256.38
	1.30	257.68	
		13.11	244.57
	6.42	244.99	
		13.00	231.99
	0.25	232.24	
		13.00	219.25
	0.36	219.60	
		13.21	206.38
	0.39	206.77	
		12.30	194.47
	0.35	194.82	
		12.42	182.90
	0.57	182.97	

Set T.B.M. Below flagstone steps  
30' East Sta. 9470.70



182.97

10.50 172.47

020 172.67

12.49 160.18

= 160.15



9-22-54

Profile & Proposed Water  
Monte Vista Ave, Vista De La Playa  
to Fern Glen

- 0+00 N/L Arenas
- +10 No. curb line
- +15 gas cross
- +40 So. curb line

- 3+00 End of curb W side Monte Vista
- 3+60 Storm grate 31' RB.
- 4+03 Storm grate 17' LB

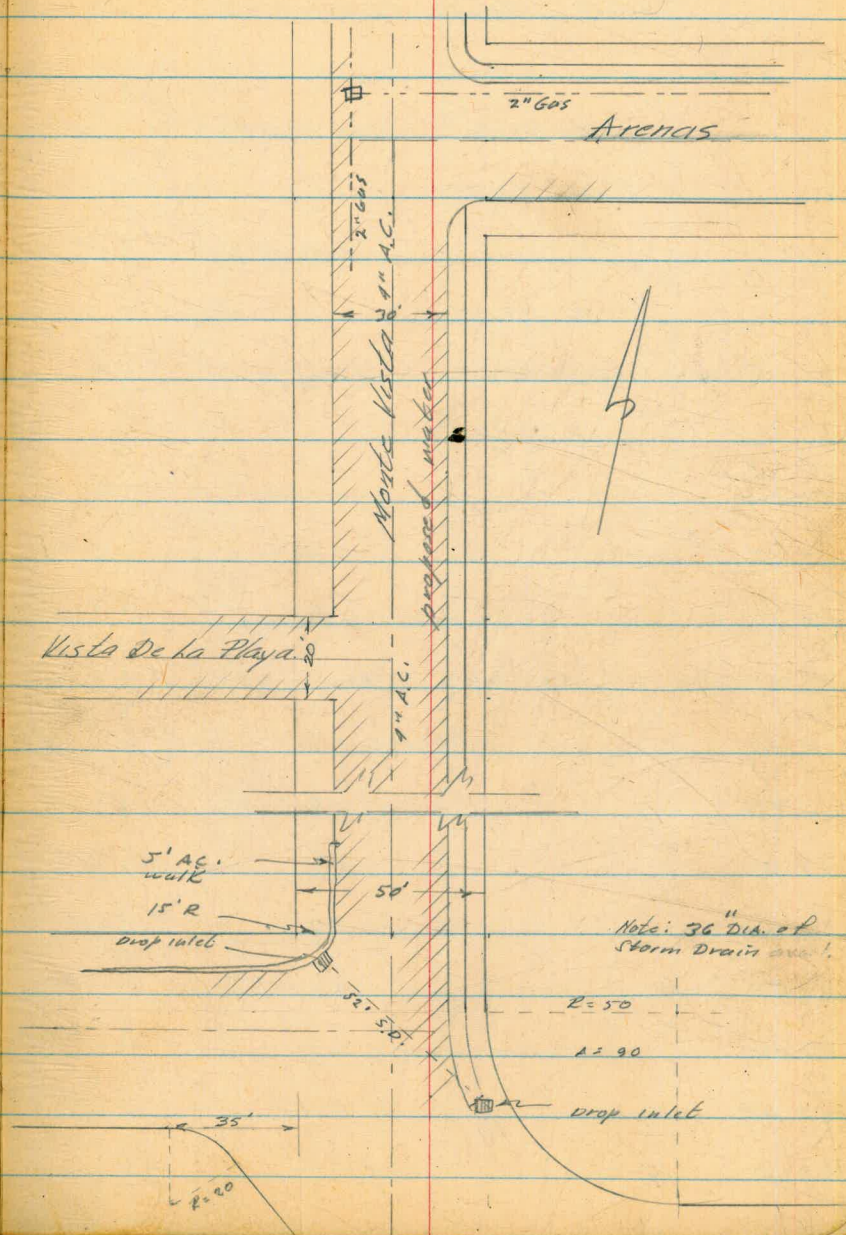



Profile Monte Vista Cont.

59.52

S.W. B.P. Monte Vista & Bolvedere

2.90 62.42

13.00 49.42

2.10 51.52

5.90 46.04

N.E. B.P. Arenas & Monte Vista (No Elev)

5.40 51.94

0+00	6.0	45.44
+10	6.2	45.24
+15	6.2	45.24
+15	6.9	44.54
+40	6.3	45.14
+50	6.2	45.24
1+00	5.5	45.94
+50	5.3	46.14
1+70	5.1	46.34
2+00	4.9	46.54
+50	4.5	46.94
3+00	4.1	47.34

Reduced by J. Gray 5-26-55

N/L Arenas  
 No curb "  
 2" gas crossing  
 Gas M.H. 25' 26' curb 22' 6" pipe  
 So. curb line Arenas

G.V. on line



	51.44			
3+05		3.99		Sewer M.H. 10' (not opened)
+50		3.8	47.64	
+88		3.3	48.14	36" Storm Drain cut 4.0 to flow
+100		2.8	48.64	
+03		2.8	48.64	Storm Drain grate 17' L6
T.P.		1.23	50.21	
	11.56	61.77		
		2.22	59.55	= 59.52



WERT  
HOLAHAN  
KEMP

22

10-27-54

Profile & Proposed Water Main  
Sixth St. Ext. Cabrillo Freeway  
to Friar's Road

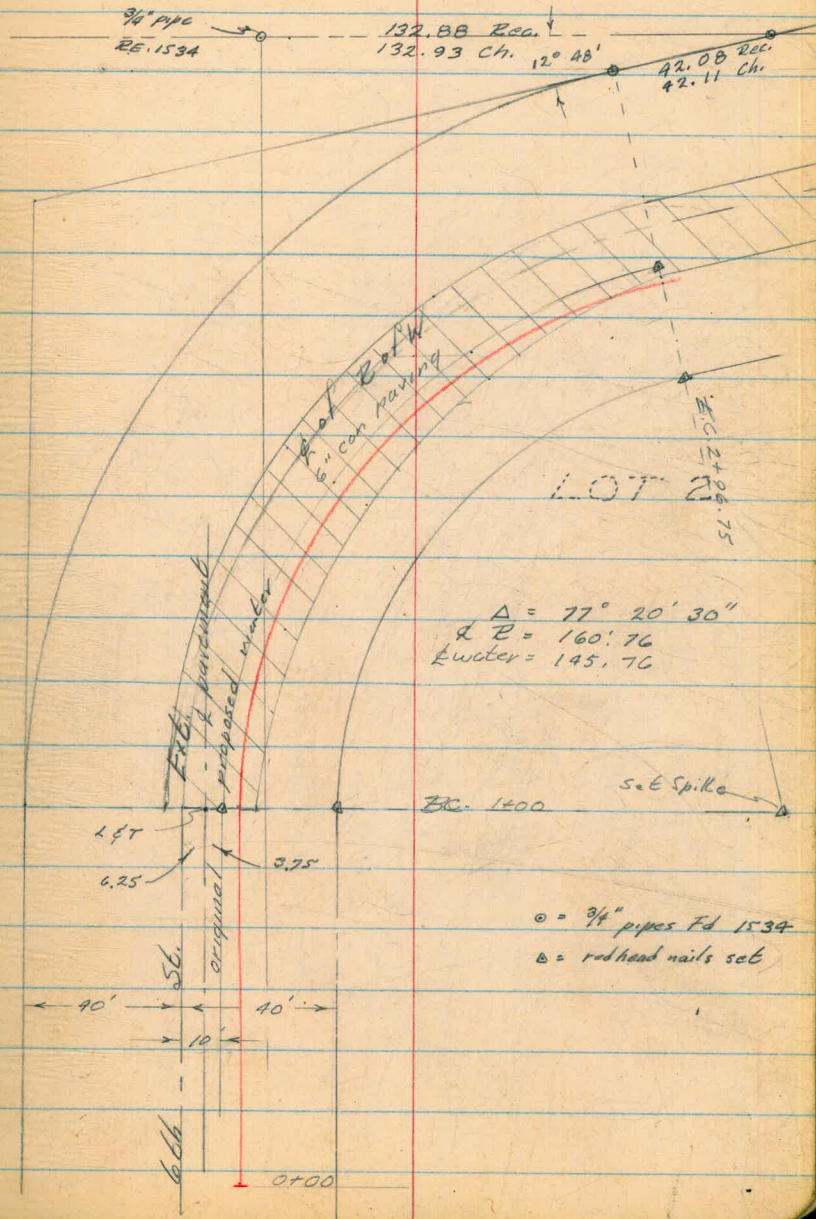



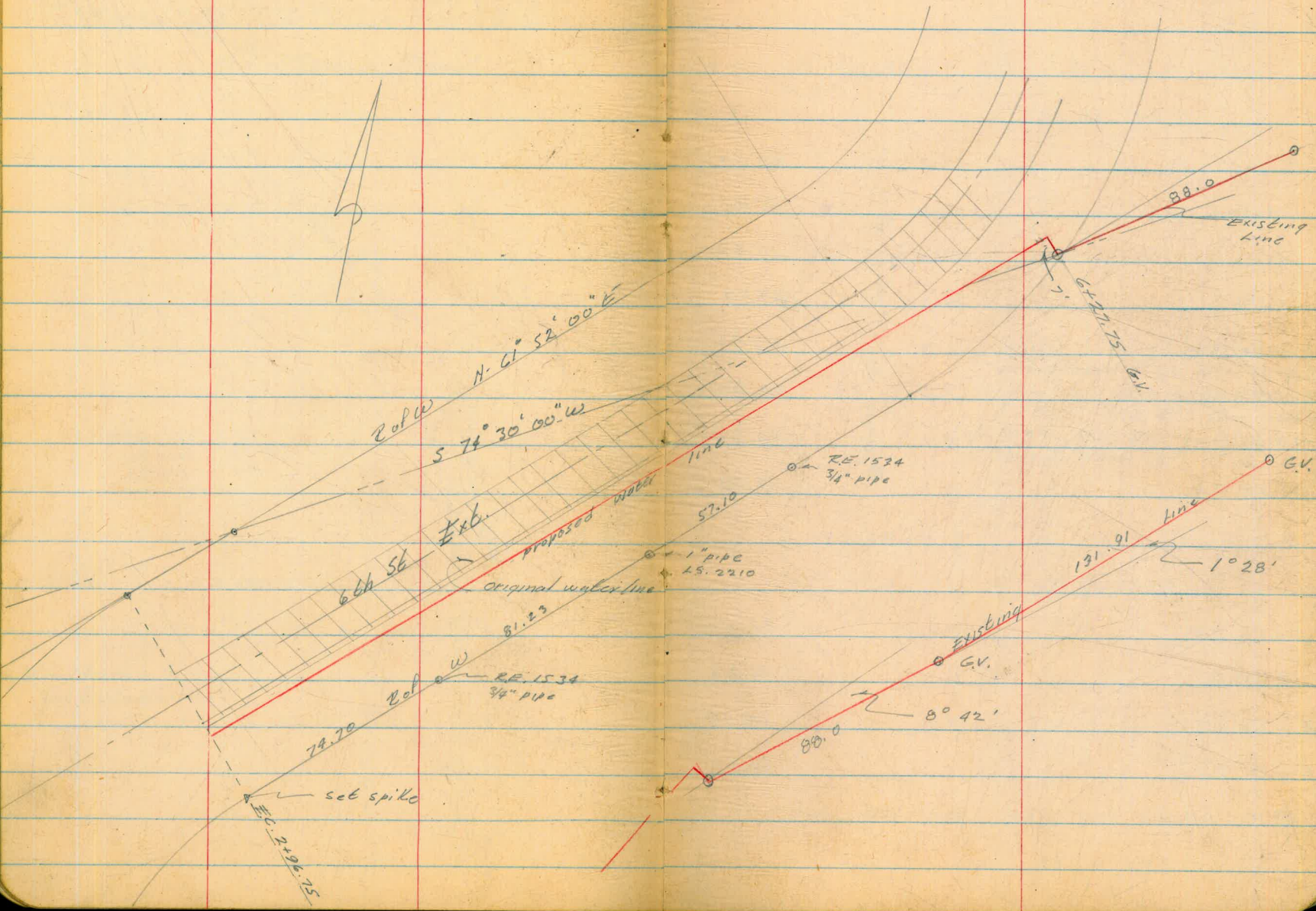



## Profile of Sixth St Ext.

		25.85	
	7.04	32.89	
0+00	7.7	25.19	
+50	7.4	25.49	
1+00	7.1	25.79	
+50	7.1	25.79	
2+00	5.8	27.09	
+50	3.9	28.99	
2+96.75	2.3	30.59	
3+45.74	0.3	32.59	
T.P.	0.16	32.73	
	9.60	42.33	
3+93.75	7.9	34.43	
+45.74	6.0	36.33	
4+95.25	4.2	38.13	
5+45.74	2.3	40.03	
T.P.	3.82	38.51	
	8.82	47.33	

L&amp;T 2 pavement So. end curve (set)

B.C. So. edge con. pavement

Note: Elev. on L&T, 25.85  
 established from level circuit  
 from B.M. Sixth St Ext. RE. 1534  
 & check from B.M. con. mon.  
 (Elev. 16.02 city) Camino Del Rio &  
 Mission Valley Golf club.

Set T.B.M. R.W. mon West end Fence, 25 Pb



47.33

5+93.25

5.3

42.03

6+27.75

4.0

43.33

6+27.75

9.3

38.03

Top of P (actual) G.V. 7' R6

11.2

36.13

" " " " 88.0 &amp; 8° 42' R6

13.8

33.53

" " " " 131.90 &amp; 1° 28' L6

T.P.

10.90 36.43

0.57 37.00

7.14 29.86

2.94 32.80

6.93 25.87

= 25.85



11-3-54

Profile & a.P. Proposed Water Main  
Stephens St. Arbor Dr. N.Y.

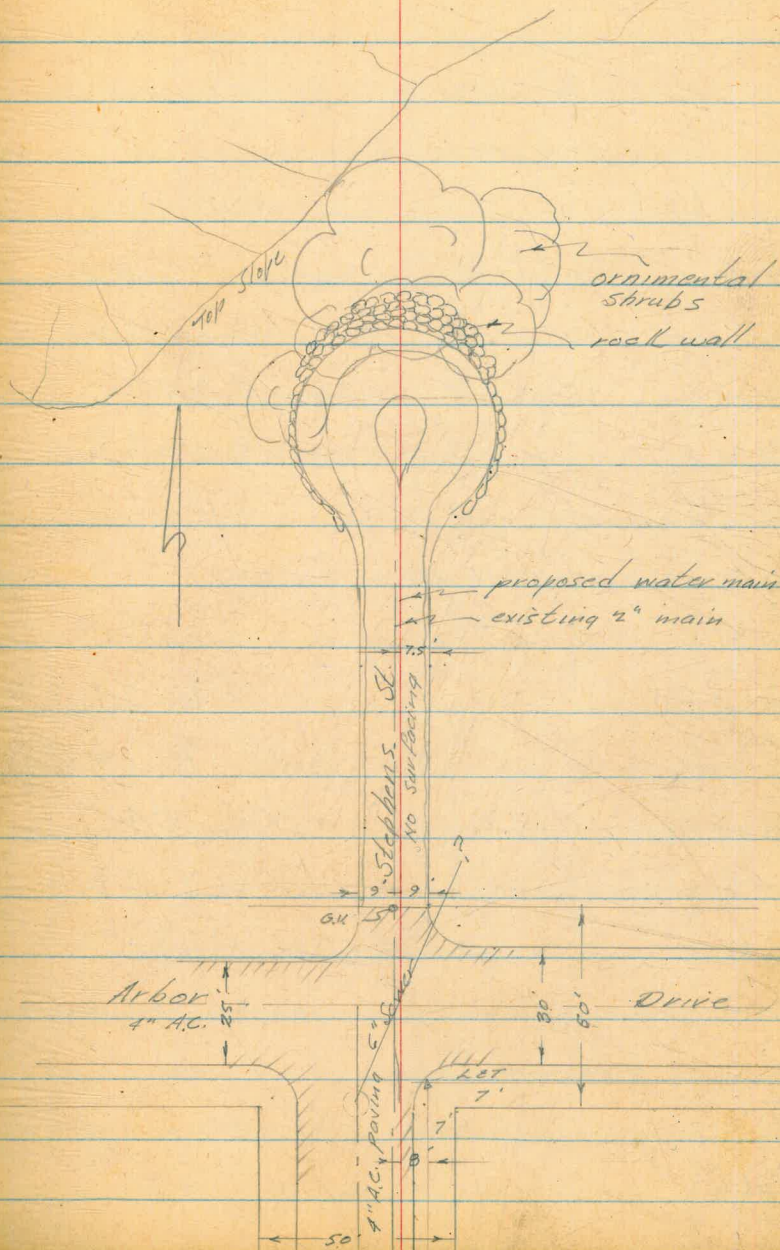

- 0150 Edge A.C. paving & G.V. 65 16
- 0140 No. curb line
- 0110 So. curb line
- 0100 S/W of Arbor Dr. & S.M.H.



			279.01
	3.85	282.86	
0+00		5.4	277.46
+00		5.20	277.66
+10		5.3	277.56
+40		5.6	277.26
+50		5.6	277.26
T.P.		5.03	277.83

2.66 280.49

1+00		3.3	277.19
+50		4.2	276.29
+90		4.8	275.69
2+00		5.0	275.49
+07		9.2	271.29
+40		16.8	263.69
T.P.		3.16	277.33

5.80 283.13

4.11 297.02

Palmetto R.R. 4-855  
S.E. B.P. Arbor Dr. & Palmetto

S/H of Arbor Dr.  
Sewer M.H. 10' 16" 5.6 to flow  
So. curb line Arbor Dr.  
No. curb line " "  
Edge 4" A.C. paving

Edge of Shrubs

Top rock wall

Toe " "

End of line top of 1:1 slope

297.01 B.P.



Profile & Proposed Water Main  
Cushman Ave. Solar St. to Plainview

0+00	W/L of Solar, common 10' Pt.
+12	W curb line Solar
+42	E curb line Solar
+50	F/L Solar St.
+78	E.C. curb

2+28	B.C. curb
2+51.23	W/L of Pl. Brownell
2+61	W curb Brownell St
2+91	E curb Brownell

Went  
Holo hau  
Kemp

11-9-54

28

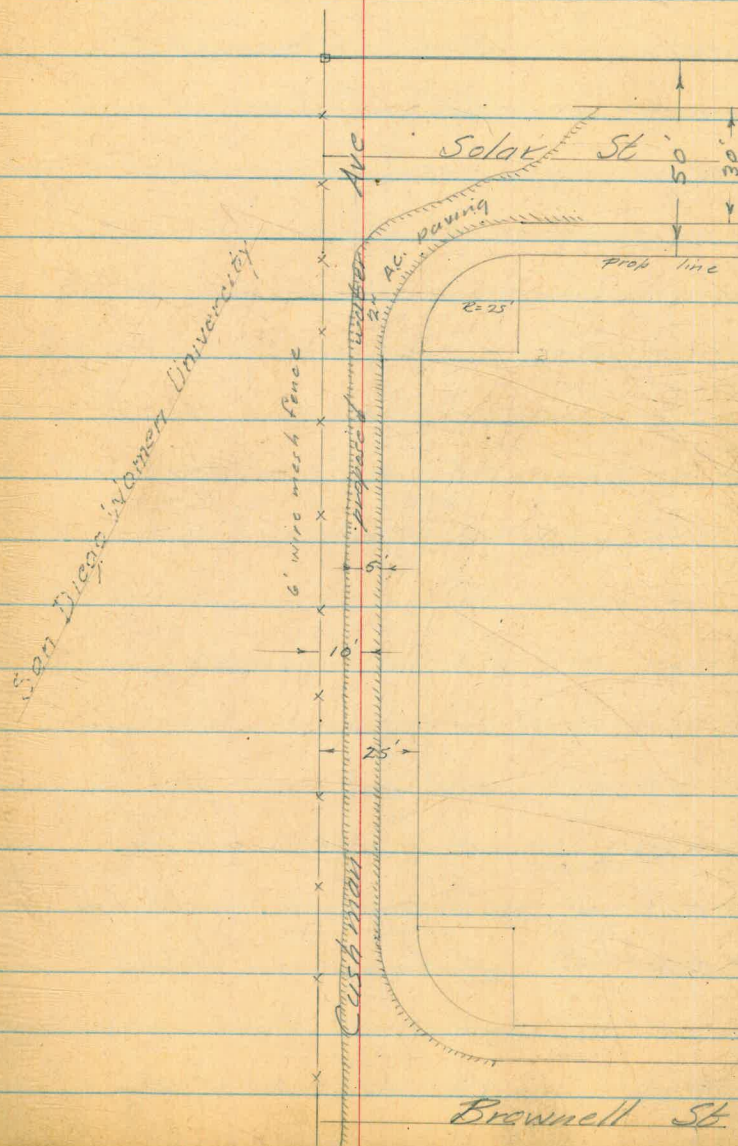



2+91 F curb Brownell St.  
 3+01.23 E/L of Brownell  
 3+28 F.C. curb

4+01 End 5" curb, start rock  
 markers as curb line

5+02.46 W/L Plainview

5+12 W curb line produced  
 Plainview

5+42 E curb line produced

5+52.46 E/L of Plainview

6+52.46 Con mon, end of fence

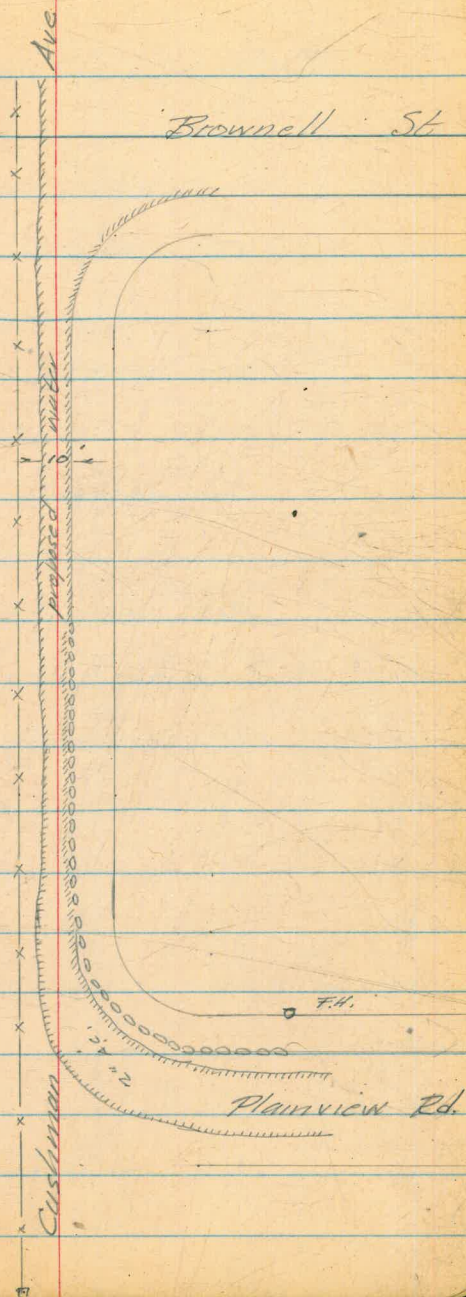



## Profile of P. Cushman Ave. Cont.

		177.69	
5.52	183.16 ✓		
		5.16	178.00 ✓
12.29	190.24 ✓		
		0.19	190.05 ✓
7.17	197.22 ✓		
		10.30	186.92 ✓
0.68	187.60 ✓		
		9.65	177.95 ✓
12.67	190.62 ✓		
0+00		14.1	179.5 ✓
+12		10.3	180.3 ✓
192		8.6	182.0 ✓
+50		7.6	183.0 ✓
1+00		1.9	188.7 ✓
T.P.		0.54	190.08 ✓
13.10	203.18 ✓		

B.P. NW. cor on cen. porch.

Set T.B.M. con mon of Cushman &amp; W. Solar

203.18 ✓

1450 9.2 194.0 ✓

2400 4.4 198.8 ✓

450 0.2 203.0 ✓

T.P. 0.12 203.06 ✓

9.66 212.72 ✓

2461 8.2 203.~~7~~<sup>8</sup> ✓

491 7.2 205.5 ✓

3400 6.8 205.9 ✓

450 4.7 208.0 ✓

4400 2.6 210.1 ✓

450 6.3 211.4 ✓

5400 0.8 211.9 ✓

412 0.5 212.2 ✓

492 1.4 211.3 ✓

452.46 6.7 211.0 ✓

T.P. 0.55 212.17 ✓

1.94 214.11 ✓

9.68 209.43 ✓

Set T.B.M. on main Fence line 1800 No Plainview



204.43

9.91 214.34'

0.80 213.54

2.08 215.62'

9.47 206.15

0.42 206.57'

12.61 193.96

0.16 194.12'

12.83 181.29

2.78 184.07'

6.42 177.65 W =

177.64 /

11-8-54

Profile & Proposed Water Main  
Reo Drive, Patomas to Cumberland

0+00	N/H of Patomas
+20	No. curb line
+38	Sewer Crossing
+60	So. curb line
+80	S/H of Patomas
2+99	Sewer M.H. 6' 16"
4+49	Water chamber 8' 7 1/2"
6+80	N/H of P Albermarle
6+90	No. Curb Albermarle
7+09	Sewer crossing, M.H. 6' 16"
7+30	So. curb
7+	

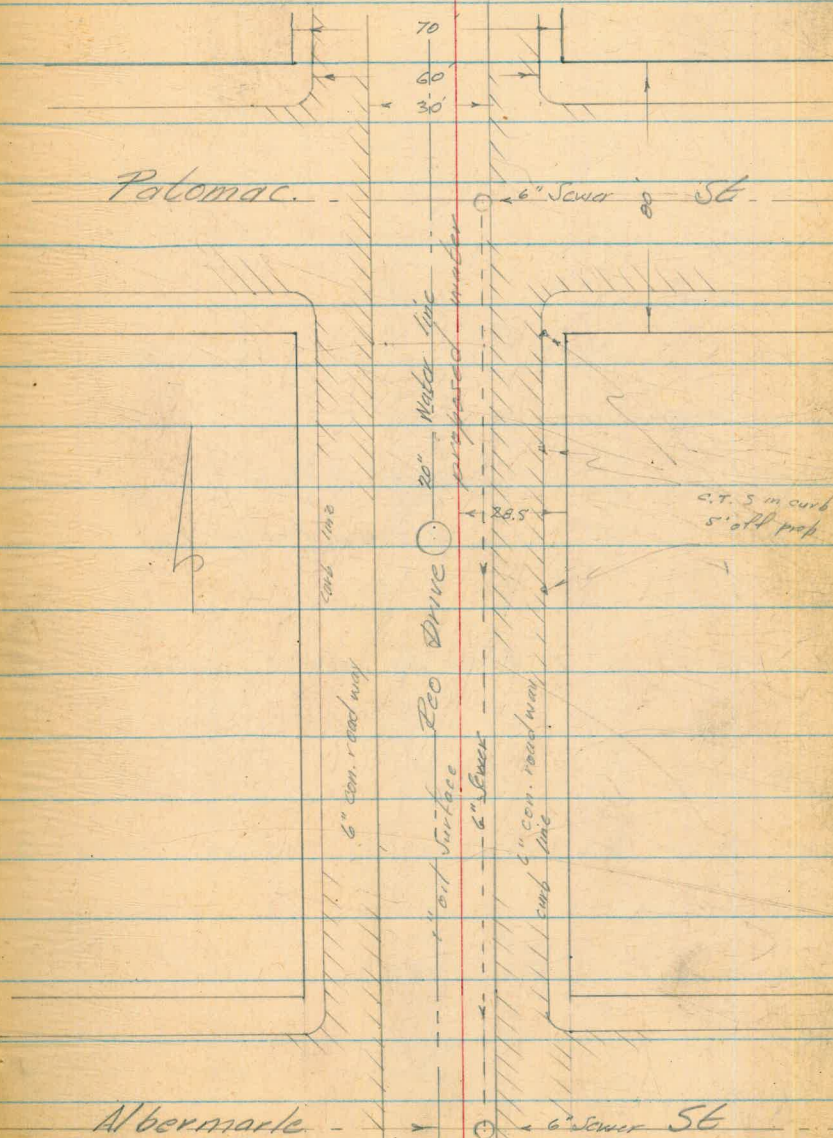



## Poo Drive Cont.

- 9491 No edge of Poo' con valve cham.
- 10431 Sewer M.H. 6' 16
- 10447 Storm Dr. M.H. 19.5 ft
- 11457  $\phi$  Storm Dr. M.H. & grates
- 13460 No curb line Cumberland St.
- 13472 Sewer M.H.
- 14100 For curb line

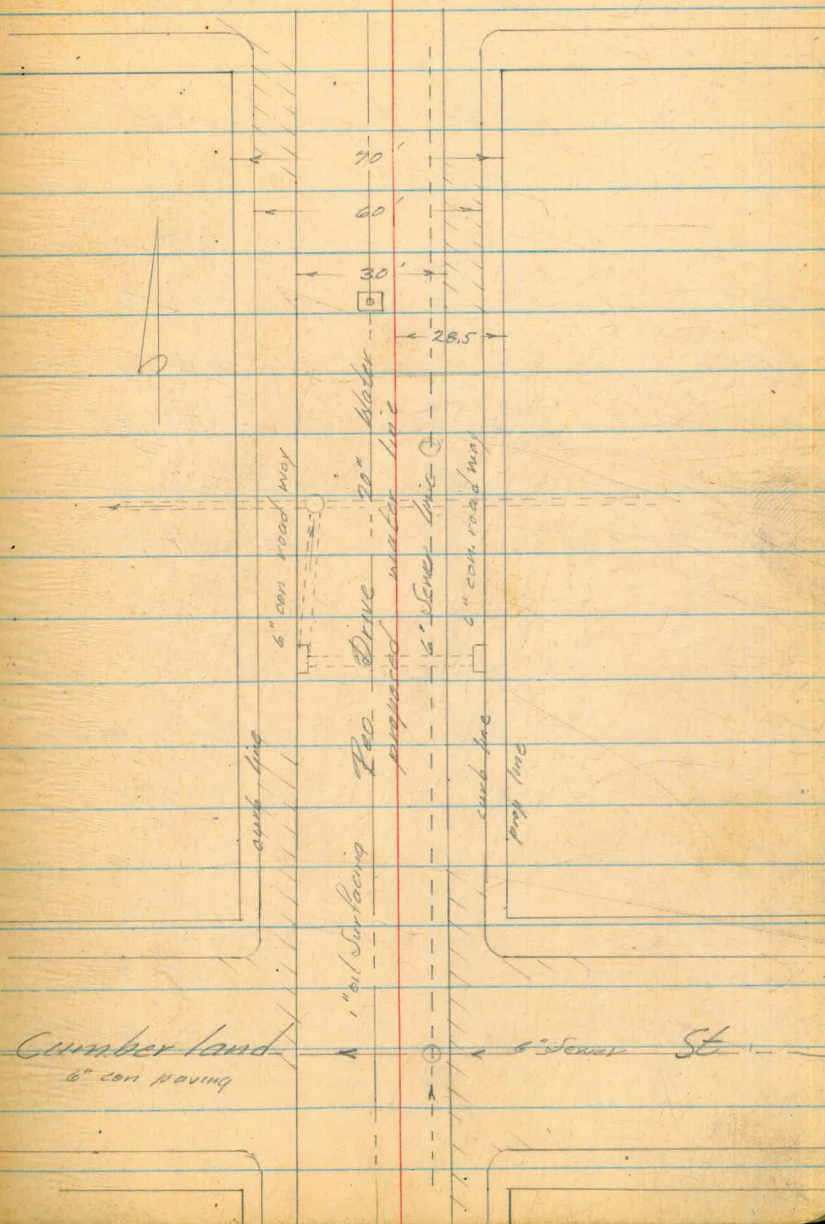



## Red Drive Cont.

203.37

SW. B.P. Patomac &amp; Rancho

820 216.57 ✓

0+00	7.3	204.3 ✓
+20	6.6	205.0 ✓
+38	5.6	206.0 ✓
+38	5.64	205.9 ✓
+60	4.7	206.9 ✓
+75	4.0	207.6 ✓
T.P.	3.91	207.66 ✓

N/H of Patomac

No. curb line

Sewer crossing

Sewer M.H. 6' H. cut 15' to flow

So. curb line Patomac

Tele. crossing cut 2' to top cable

10.73 218.39 ✓

0+00	10.5	207.9 ✓
1+10	9.3	209.1 ✓
+60	7.4	211.0 ✓
2+10	5.2	213.2 ✓
+60	3.1	215.3 ✓
2+99	1.98	216.4 ✓
3+10	1.3	217.1 ✓

S/H of Patomac &amp; E.V. existing line

Sewer M.H. 6' H. cut 9' to flow



218.39 ✓

T.P. 0.61 217.78 ✓

5.70 223.98 ✓

3+60 4.8 218.7 ✓

4+10 3.8 219.7 ✓

4+60 3.8 219.7 ✓

5+10 5.5 218.0 ✓

+60 7.3 216.2 ✓

6+10 9.5 214.0 ✓

+60 11.4 212.1 ✓

+90 12.2 211.3 ✓

No curb line Albermarle

T.P. 12.16 211.32 ✓

0.37 211.69 ✓

7+10 0.9 210.8 ✓

Sewer crossing

+10 0.93 210.8 ✓

Sewer M.H. 6' LE cut 7' DE No. 7 So.

7+60 3.3 208.4 ✓

8+10 7.6 204.1 ✓

+60 10.2 201.5 ✓

211.69 ✓

9+10 13.0 198.7 ✓

T.P. 13.22 198.47 ✓✓

152 199.99 ✓

9+60 3.4 197.6 ✓  
6

10+10 4.3 195.7 ✓

+31 4.56 195.4 ✓

+47 4.8 195.2 ✓

+47 4.96 195.0 ✓

10+60 5.0 195.0 ✓

11+10 5.2 194.8 ✓

+56 5.2 194.8 ✓

+56 5.48 194.5 ✓

+56 5.76 194.2 ✓

+56 6.45 193.5 ✓

+60 5.2 194.7<sup>8</sup> ✓

T.P. 5.00 194.99 ✓

5.68 200.67 ✓

Sewer M.H. 6' R.L. cut 10' to flow

Storm Dr. crossing

Storm Dr. M.H. 18' R.L. 10' to flow, 36" pipe

Storm Dr. crossing

Storm Dr. grade to curb. cut 5' top 30" pipe

" " M.H. 18' R.L.

" " grade R.L. curb cut 5' top 30" pipe



200.67 ✓

12+10	5.6	195.1 ✓
+60	5.2	195.5 ✓
13+10	5.0	195.7 ✓
+60	4.5	196.2 ✓
+72	4.4	196.3 ✓
+72	4.1	196.3 ✓
14+00	4.3	196.4 ✓
+10	4.4	196.3 ✓
	5.78	194.89 ✓

No curb line Cumberland  
 Sewer crossing  
 Sewer M.H. 6' L6 cut 12" (4 way)  
 So. curb  
 S/L of  
 SW 80 Cumberland & Rec Dr.

Profile of Proposed Water Main  
 Bachman Pl. Lewis St. to Arbor Dr.

7+55.28 N/H of Arbor Dr.  
 7+95.28 No curb "  
 7+15.28 So curb "  
 7+05.28 S/H of Arbor Dr.

5+39.38 P.O.T. of water

4+34 Sewer M.H.

WERT  
 Kemp  
 Holahan

39

11-10-54

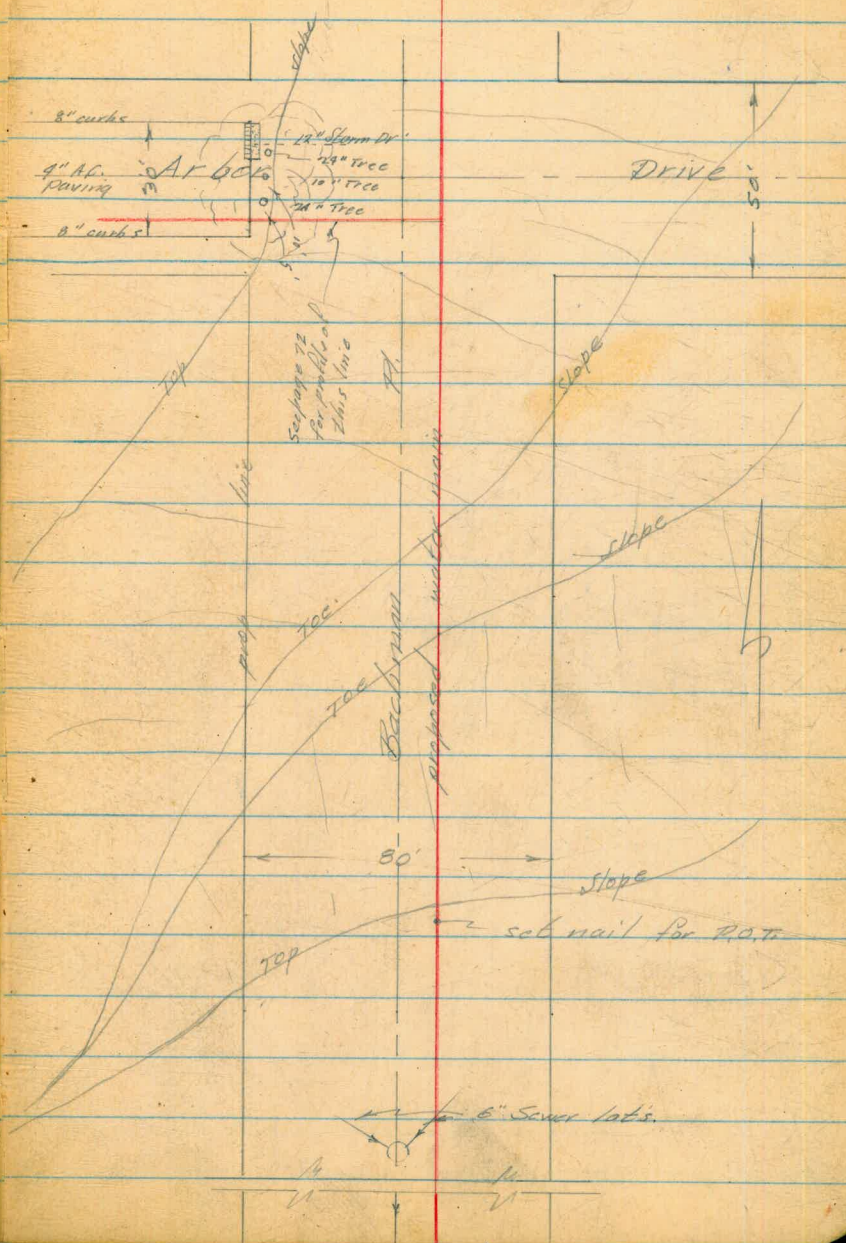



4+05

N/L of Montecito

3+55

S/L of Montecito

0+55

N/L of Lewis

0+27

Sewer M.H.

0+00

S/L of Lewis

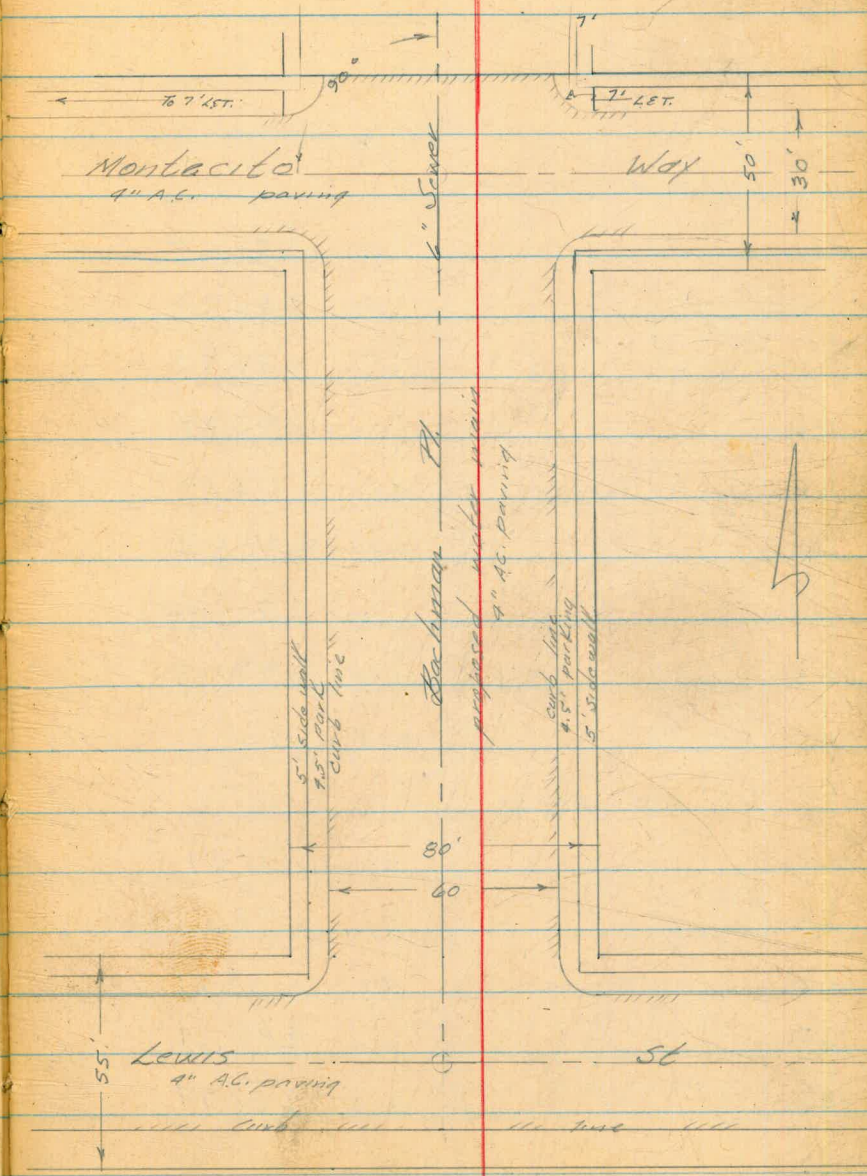

287.27

S.E. cor. Lewis St & First Ave.

8.10 296.07

0+00	4.4	291.67
+10	4.7	291.37
+10	5.1	290.97
+27	4.3	291.77
+27	4.27	291.86
+42	4.1	291.97
+50	4.0	292.07
+55	4.0	292.07
T.P.	4.86	291.21

Se. 1/2 of Lewis  
 Top curb "  
 Gutter "  
 Sewer crossing  
 Sewer M.H. 10' 16" cut 9.6 to Plaw  
 No. curb line of Lewis

M.H. at Lewis & 6th on line

2.70 293.91

1+00	2.7	291.21
+50	3.4	290.51
2+00	4.1	289.81
+50	4.6	289.31
3+00	5.2	288.71

Reduced by Palmetto 1-26-55



293.91

3+50 5.8 288.11

3+65 6.1 287.81

4+02 6.8 287.11

4+12 7.1 286.81

T.P. 6.95 286.96

3.03 289.99

4+34 3.43 286.56

+50 4.2 285.79

5+00 5.5 284.49

5+39.38 7.0 282.99

T.P. 12.80 277.19

0.27 277.46

5+56 4.2 273.26

T.P. 12.96 269.50

0.60 265.10

T.P. 12.67 252.43

2.43 254.86

So curb line of Manlecito

No. " " " "

Edge of AC paving

Sewer M.H. 10' H.

2' to flow

Top Slope

254.86

6+18 10.1 244.76 Toe Slope

+41 12.4 242.46 Toe Slope

6+75 5.8 249.06

7+00 0.9 253.96

T.P. 0.25 254.61

12.06 266.67

7+25.59 12.1 254.57 P.O.T. (set nail)

7+55.28 11.9 254.77 N/L of Arbor Dr.

T.P. 7+20 8.50 258.17 Set T.B.M. on Lead collar 2" water line (exposed)

12.40 270.57 Intersection Bachman &amp; Arbor Dr.

0.82 269.75

12.61 284.36

1.11 281.25

8.32 289.57

1.50 288.07

288.05 SE. CP. Arbor Dr &amp; First Ave.



WERT  
Kemp  
Holohan

11-18-54

44

Profile & Proposed Water Main  
E. Palisades Rd 100' No Palisades Rd

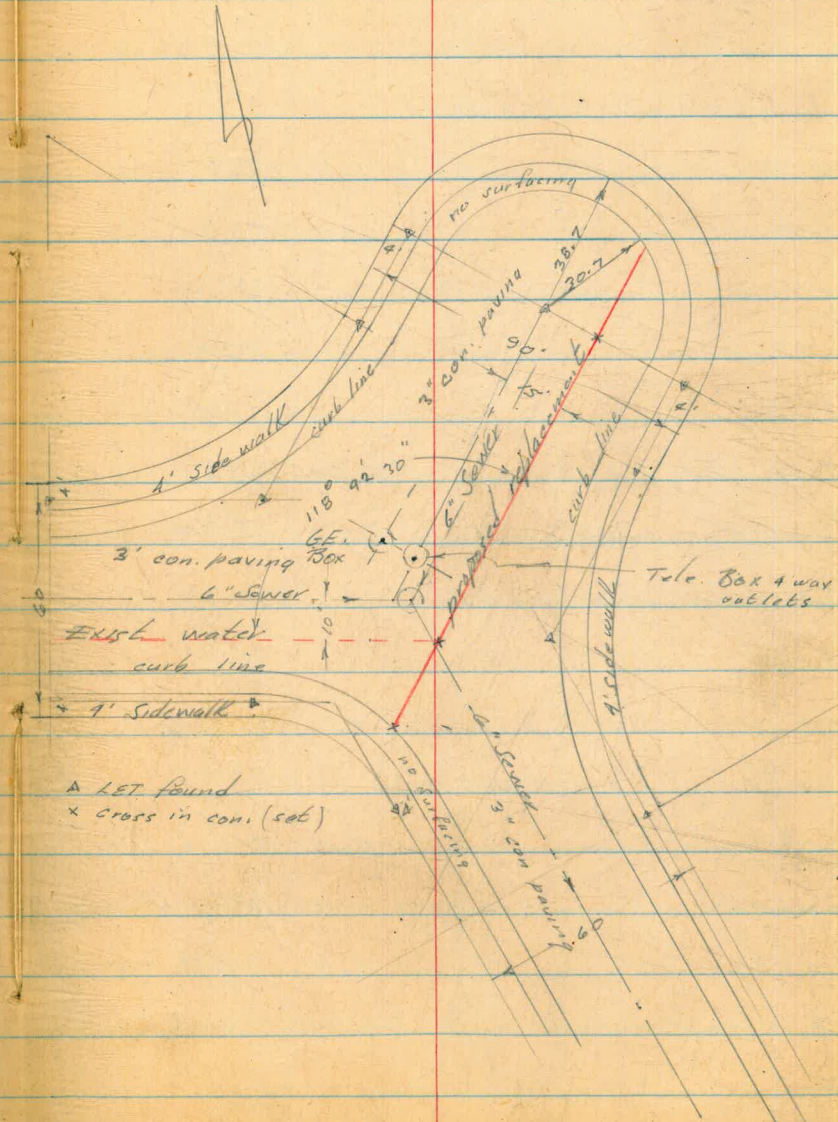

## E Palasades Rd - Cont.

		381.11	S.F. B.P. 381.11 Marlborough & Palasades
	227	383.38 ✓	
0+00		6.1 377.3	Top of face 50' curb line Palasades Rd
+00		6.7 376.7	Gutter
+08		6.3 377.1	? crossing 1' patch in paving
+24		6.0 377.4	Sewer crossing
+27		6.0 377.4	G.V. 5' RT
+30		5.84 377.54	Sewer M.H. 10' Lt 9.7 to flow
+36		5.86 377.52	Tele. M.H. 9' Lt 6'x6' Box, 4 way out lets, cut 2'
+36		5.65 377.73	Gas & Elect M.H. 16' Lt. 8'x8' Box, 4 way outlets, cut 2'
+50		6.0 377.4	
T.P.		6.30 377.08 ✓	
	5.21	382.29 ✓	
1+00		5.0 377.3	
+41.50		5.3 377.0	Gutter No curb line
41.50		4.9 377.4	Top " " "
T.P.		1.87 380.42 ✓	S.W. TH. E Palasades Rd & Palasades Rd.
	3.19	383.61 ✓	



383.61

251 381.10 ✓ (391.11) SERP. Marlborough & Palasader

Profile & Proposed Water Replacement  
 Alley Bk 21 W of Kensington Sa. Park Fl.

0100 E/H Kensington  
 +13 curb face  
 +45 curb face  
 +60 W/H of Kensington  
 1177 E/H of Alley  
 1197 W/H of Alley

3+13 E/H of Marlborough

3+73 W/H of Marlborough

WERT  
 KEMP  
 HOLAHAN

47

11-19-54

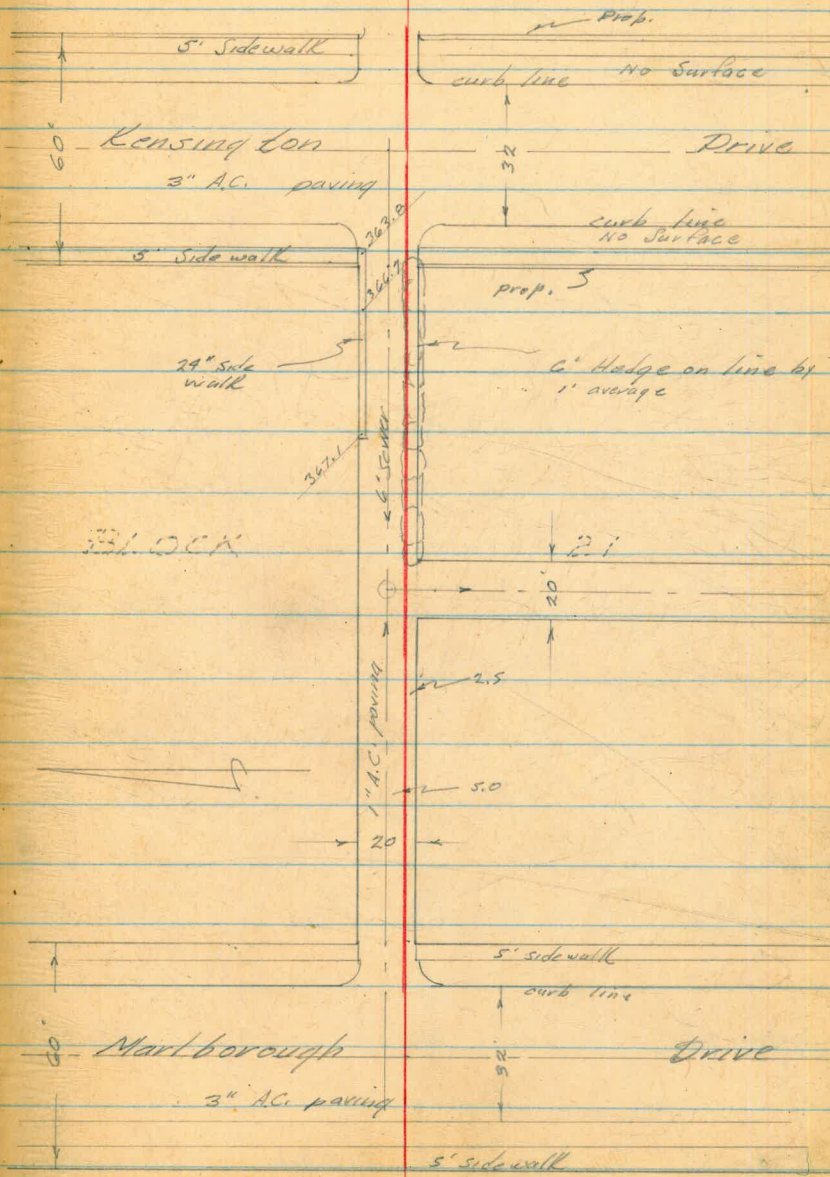



Alley BIK 21 Cont.

362.91

6.01 368.92

T.P.

3.91 365.01

3.54 368.55

T.P.

5.52 363.03

5.15 368.18

4.57 363.61

8.84 372.15

0+00

8.5 363.65

+13

9.6 362.55

+29

8.9 363.25

+45

9.2 362.75

+50

8.8 363.55

+57

8.3 363.85

+70

5.6 366.55

1+00

4.1 368.05

S.W. 22. Alder Dr. &amp; Marlborough

LET 7' off NE. end Alley BIK 21

E/1 of Marlborough

E gutter (driveway no curb on &amp; water)

Street crown

W gutter

16      wider  
    &

26

$\frac{8.3}{2.5}$	$\frac{8.3}{0}$	$\frac{8.9}{5}$	$\frac{8.9}{7.6}$	$\frac{8.9}{11.5}$	$\frac{8.4}{12.5}$
-------------------	-----------------	-----------------	-------------------	--------------------	--------------------

$\frac{4.9}{2.5}$	$\frac{5.6}{0}$	$\frac{6.5}{5}$	$\frac{6.2}{7.6}$	$\frac{5.5}{11.5}$	$\frac{5.5}{12.5}$
-------------------	-----------------	-----------------	-------------------	--------------------	--------------------

$\frac{4.1}{2.5}$	$\frac{4.1}{5}$	$\frac{4.9}{5}$	$\frac{5.0}{5}$	$\frac{5.1}{7.6}$	$\frac{4.6}{11.5}$	$\frac{4.6}{12.5}$
-------------------	-----------------	-----------------	-----------------	-------------------	--------------------	--------------------

372.15

1109	4.5	367.65	W end sidewalk (private)	
			16	
+50	4.6	367.55		$\frac{4.4}{2.5}$ $\frac{4.6}{0}$ $\frac{4.7}{5}$ $\frac{4.6}{10}$ $\frac{4.6}{12.5}$
+82.5	4.4	367.75	Water Gk. 2.5 ll.	
+87	4.5	367.65	Sewer crossing	
+87	4.45	367.70	Sewer M.H. 5' out 4.5 to flow	
1100	4.4	367.55		$\frac{4.3}{2.5}$ $\frac{4.4}{0}$ $\frac{4.5}{5}$ $\frac{4.4}{10}$ $\frac{4.3}{12.5}$
2+50	4.7	367.45		$\frac{4.4}{2.5}$ $\frac{4.7}{0}$ $\frac{5.0}{5}$ $\frac{4.9}{0}$ $\frac{4.5}{10}$ $\frac{4.4}{12.5}$
3+00	6.2	365.95		$\frac{5.2}{2.5}$ $\frac{6.2}{0}$ $\frac{6.8}{7}$ $\frac{7.0}{5}$ $\frac{6.9}{9}$ $\frac{6.5}{10}$ $\frac{4.9}{12.5}$
+16	8.8	363.35	Back sidewalk produced	
+28	9.9	362.25	E gutter Kensington	
+44	2.5	362.65	street crown	



	372.15		
3+60		10.5	361.65
+73		9.6	362.55
T.P.		8.58	363.57
4.24	367.81		
		4.08	363.73
6.10	369.83		
		6.94	362.89

W gutter Kensington

W/HOP Kensington

362.91 S.W. BR. Alder Dr. &amp; Marlborough

Profile & Proposed Water Replacement  
Myrtle St, Alley E. of Nile to Alley  
W of Nile St.

	526	319.82 ✓		319.56
0+00			4.4	315.4
+15			4.4	315.4
+20			4.5	315.3
+50			4.5	315.3
+100			4.5	315.3
+50			4.8	315.6
+60			4.9	314.9
+74			5.1	314.7
2+00			4.9	314.9
2+26			5.2	314.6
2+40			5.3	314.5
2+50			5.3	314.5
3+00			5.6	314.2

J. M. Kemp  
3-15-55

SE. 20 Nile & Myrtle

W/L of Alley

6 ft. 20 ft. on east water of Alley

E/L of Alley

W/L of Nile St.

W curb line

& Nile

E curb line

E/L of Nile



	319.82		
3+50	5.9	313.9	
3+80	6.1	313.7	
3+85	6.2	313.6	
4+00	6.3	313.5	
T.D.	4.04	315.78 ✓	

4.87 320.65 ✓

6.09 314.56 ✓

W/H of Alley

Gas crossing

#11 of Alley

Sub 4 B.M. top #H. Myrtle and Alley E. of Nile

SE B.B. Myrtle E. Nile

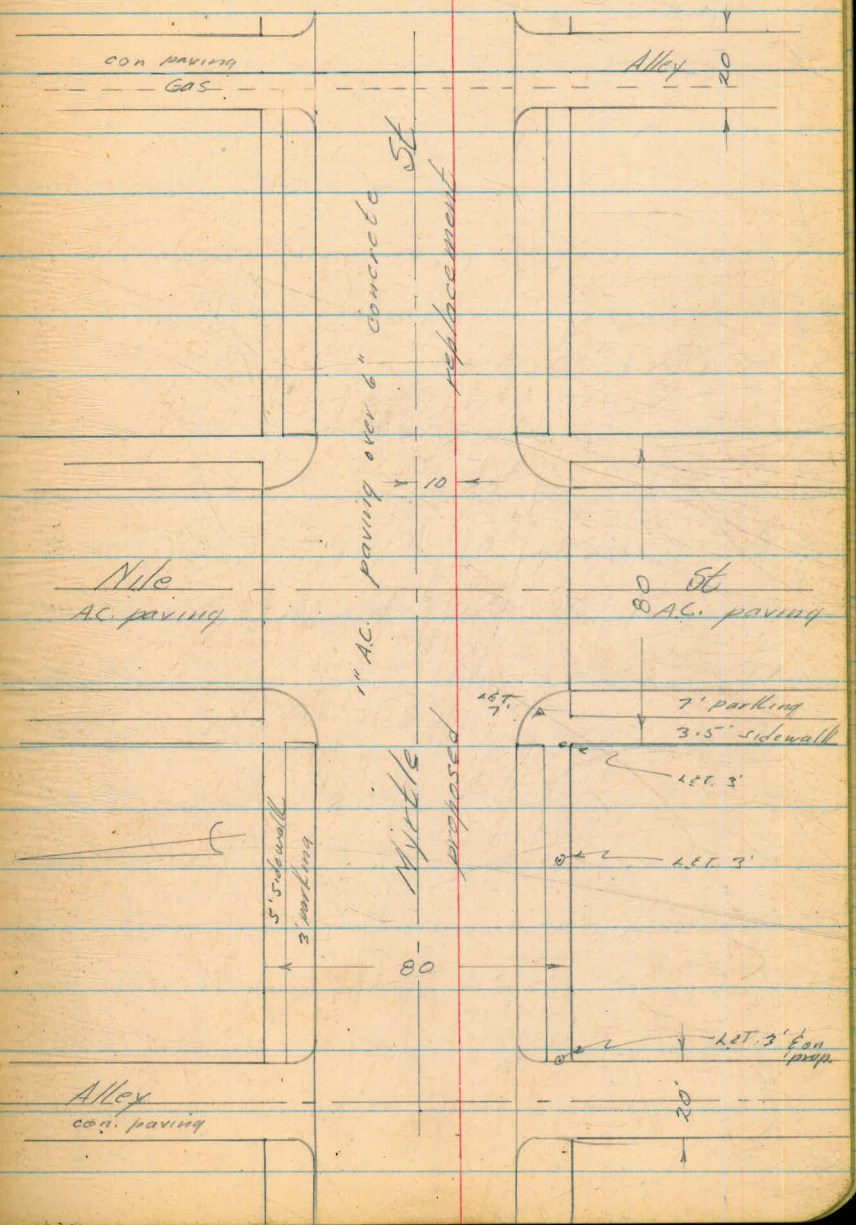



Profile & Proposed Water Replacement  
Alley BKE, N Monroe F. Wilson

		386.68	SE. DP. Monroe & Cherokee	
6.05		392.73		
		3.61	389.12	
6.33		395.45		
		1.23	394.22	
2.24		396.46	SE. FH. Monroe & Wilson	
0+00		6.1	390.36	S/H Monroe, & edge 3" A.C. paving 3"
+12		6.2	390.26	So. curb face & gutter
+30		5.7	390.76	& Monroe
+41.5		5.9	390.56	Gas crossing cut 3.0 top 6" pipe
+46.5		5.79	390.67	Gas M.H. 6" L.L. 6" F.W., 4" N.S.
+48		6.1	390.36	No. curb face & gutter
+50		6.0	390.46	
+60		6.0	390.46	N/H of Monroe & S/H on line
1+00		4.4	392.26	
+50		4.5	391.96	
2+00		4.6	391.86	

Reduced by J Gray 10 Mar 55

396.46

2150 4.8 391.66

160 4.4 392.06

160 4.95 392.01

T.P. 4.37 392.09

5.73 397.82

3100 5.8 392.02

150 5.7 392.12

4100 4.8 393.02

150 4.9 392.92

5100 4.5 393.32

142 4.7 393.12

142 4.65 393.17

150 4.6 393.22

6100 4.8 393.02

150 5.0 392.82

T.P. 4.87 392.95

3.80 396.75

Sewer M.H. 3' 16" cut 5.67 to flow

Sewer M.H. 3' 16" cut 5.33 to flow



	396.75		
7+20		4.1	392.65
7+02, 74		4.5	392.25
7+13		5.0	391.75
7+31		4.4	392.35
+45		4.8	391.95
+51		5.0	391.75
+61		4.6	392.15
T.P.		3.11	393.64
		0.76	395.99
0.52	396.51		
		6.28	390.23
4.80	395.03		
		5.83	389.20
3.49	392.69		
		6.01	386.68

S/L Madison, edge A.C. paving 3"

No. gutter

± Madison (crown)

No. Gutter

N/E of P Madison edge of A.C.

N.E. L & T. Wilson & Madison 393.82  
(sidewalk badly broken)

See T.B.M. SE F.H.

SE B.P. Monroe & Cherokee

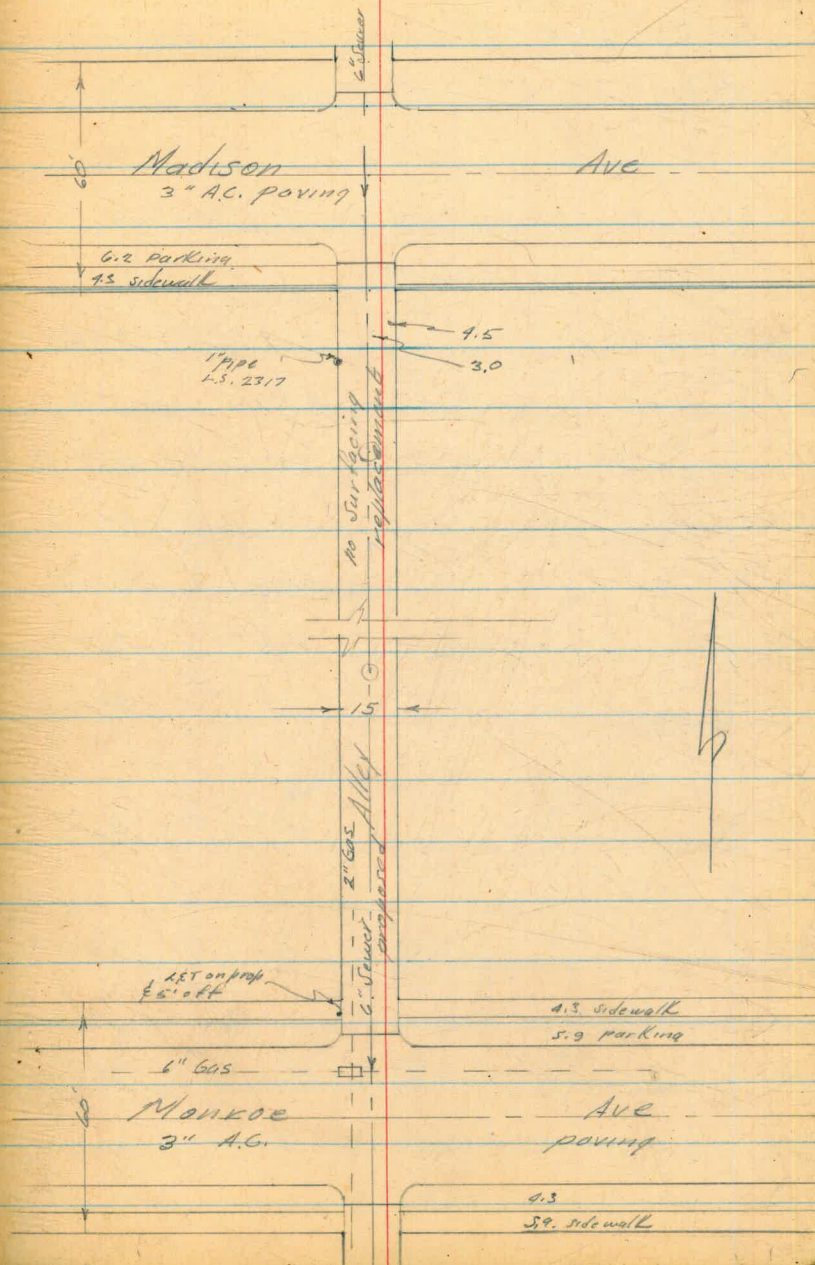

6.2 mark



Profile & Proposed Water Replacement  
Alley, Bk. G E of Cherokee N. of Monroe

			386.68
	2.62		389.30
0+00		5.4	383.9
+12		5.4	383.9
+30		4.9	384.4
+48		5.4	383.9
+49		5.26	384.04
+50		5.4	383.9
+60		5.1	384.2
+60		5.1	384.2
1+00		4.0	385.3
+50		4.3	385.0

10 MEN 55  
J. GREY  
BY  
Reduced

WERT  
Kemp  
Holahan

58

11-23-54

S.E. B.P. Monroe & Cherokee

S/H of Monroe

No gutter & curb face  
& Monroe

No curb line & gutter

Gas cover 4.5-16.

N/H of Monroe, & edge of A.C. paving

LE 384.8  
4.5  
10.5

5.1  
0

RE 384.7  
4.5  
4.5

4.1 385.2  
10.5

4.0  
0

4.4  
4.5

4.1 385.2  
10.5

4.3  
0

4.3  
4.5

384.9

385.0

	389.30		
2+00	4.5	384.8	
150	5.1	384.3	
T.P.	5.19	384.11	
	4.41	388.52	
3+00	4.9	384.12	
150	4.7	383.82	
4+00	4.9	383.62	
150	4.5	384.02	
4+80	6.2	382.32	
4+99	6.5	382.02	
5+28	5.9	382.62	
5+28	5.94		

	LE	RE
	$\frac{4.8}{10.5}$ 384.5	$\frac{4.5}{4.5}$ 384.8
	$\frac{4.5}{10.5}$ 384.8	$\frac{5.9}{4.5}$ 384.0
	$\frac{4.2}{10.5}$ 384.3	$\frac{4.7}{4.5}$ 383.8
	$\frac{4.5}{10.5}$ 384.0	$\frac{4.8}{4.5}$ 382.7
	$\frac{4.6}{10.5}$ 383.9	$\frac{5.0}{4.5}$ 382.5
	$\frac{5.2}{10.5}$ 383.3	$\frac{5.6}{4.5}$ 382.9
	$\frac{5.4}{10.5}$ 383.1	$\frac{5.8}{4.5}$ 382.7

So. curb line of gutter

& Madison & Sewer crossing 9.20 to flow  
8" E.W. 6" N.S.

Sewer M.H. 3' LE



388.52

5+50

5.8

382.72

5+60

6.1

382.42

+60

5.6

382.92

T.P.

3.78

384.74

4.20 388.94

4.58 384.36

5.73 390.09

3.91 386.68

N. curb line &amp; gutter

Top curb

Site T.B.M. Spike P.P. W &amp; N end Alley

SE B.P. Monroe &amp; Cherokee

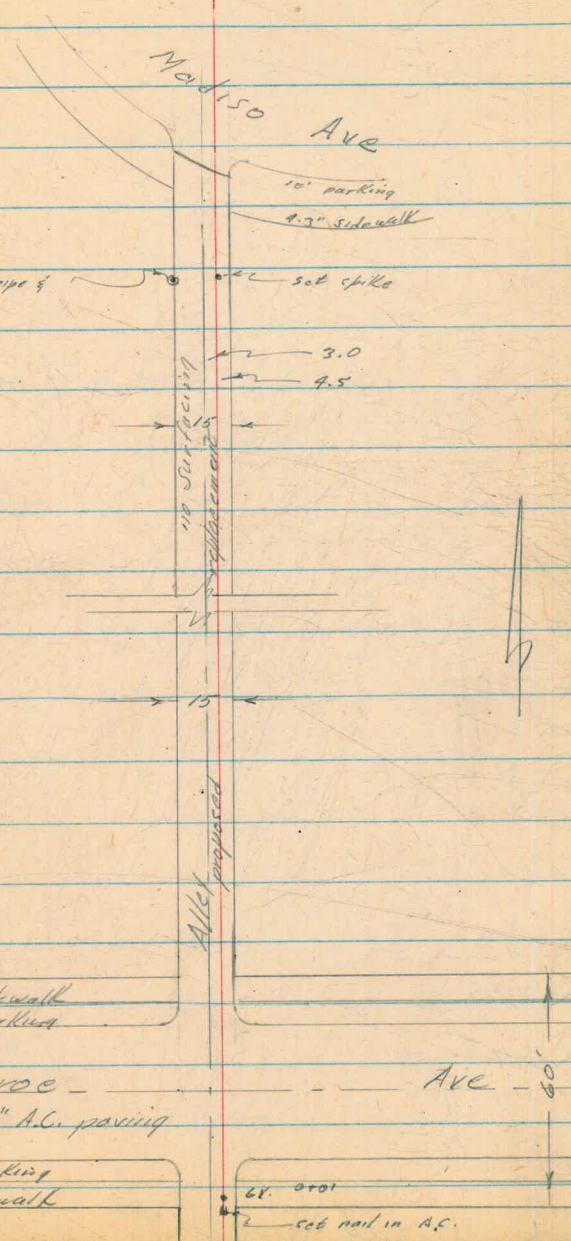



Profile & Proposed Water Replacement  
 Landis St. Alley E. of Cherokee  
 to Cherokee St

		335.25	NW. B.P. 36th & Landis
6.43	341.68	1	
	2.56	339.12	✓ NW RET 7' off Cherokee & Landis
2.97	342.09	1	
0+00	3.7	338.4	W/L of Cherokee & edge of A.C. on concrete
+14	3.7	338.4	N curb face
+40	3.4		of Cherokee
+50	3.5		
+66	3.8		E curb face
+100	4.1		
+50	5.2		
2+00	6.3		
+19.86	6.7		N/L of Alley
+39.86	7.1		E/L of Alley
7.0	3.52	338.57	SW. C.S.T. Cherokee & Landis
3.27	341.84		
6.58	335.26		335.25 B.M. NW. B.P. 36th & Landis

Went  
 Kemp  
 Holahan

11-24-54

64

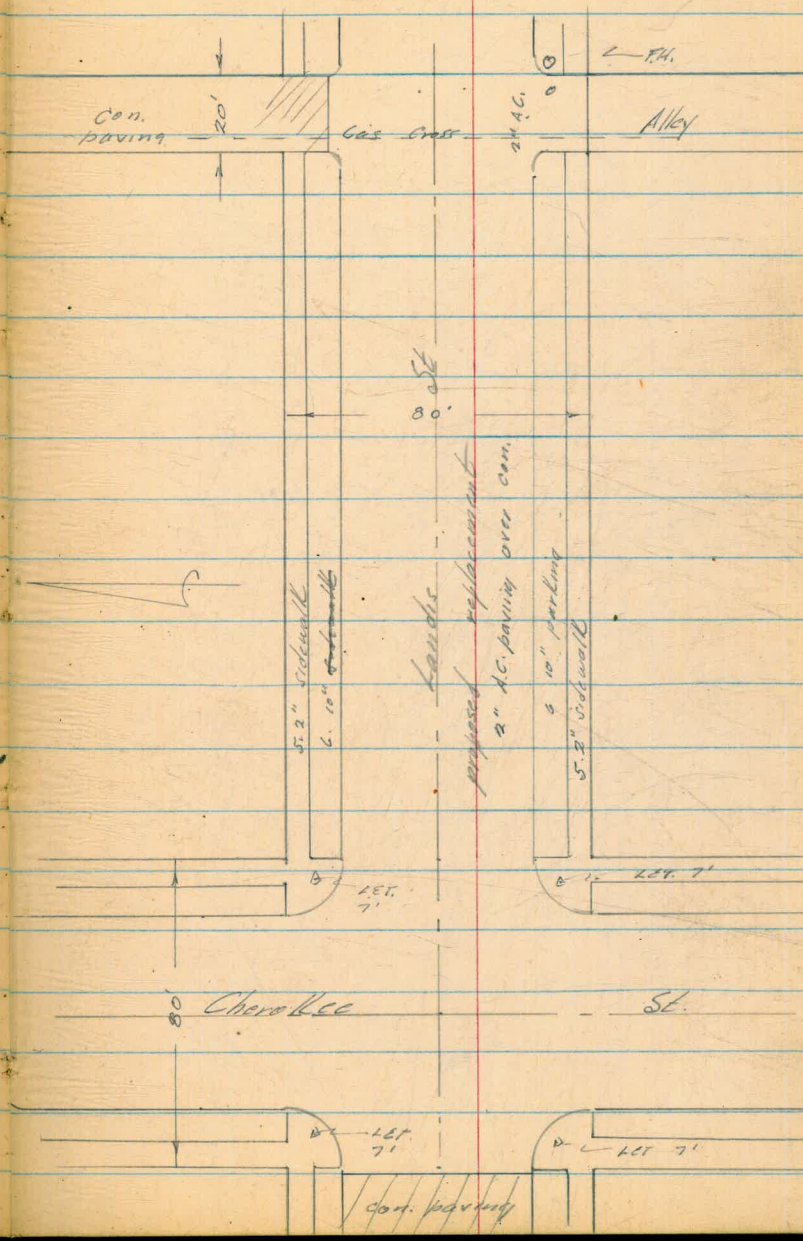



Profile & Proposed Water Replacement  
Oliver St., Olney to Lament

- 0+00 E/W of Olney St
- 0+45 E. Exist. 5' Storm Drain
- 0+80 W/W of Olney
- 1+50 End 1" oil Surfacing

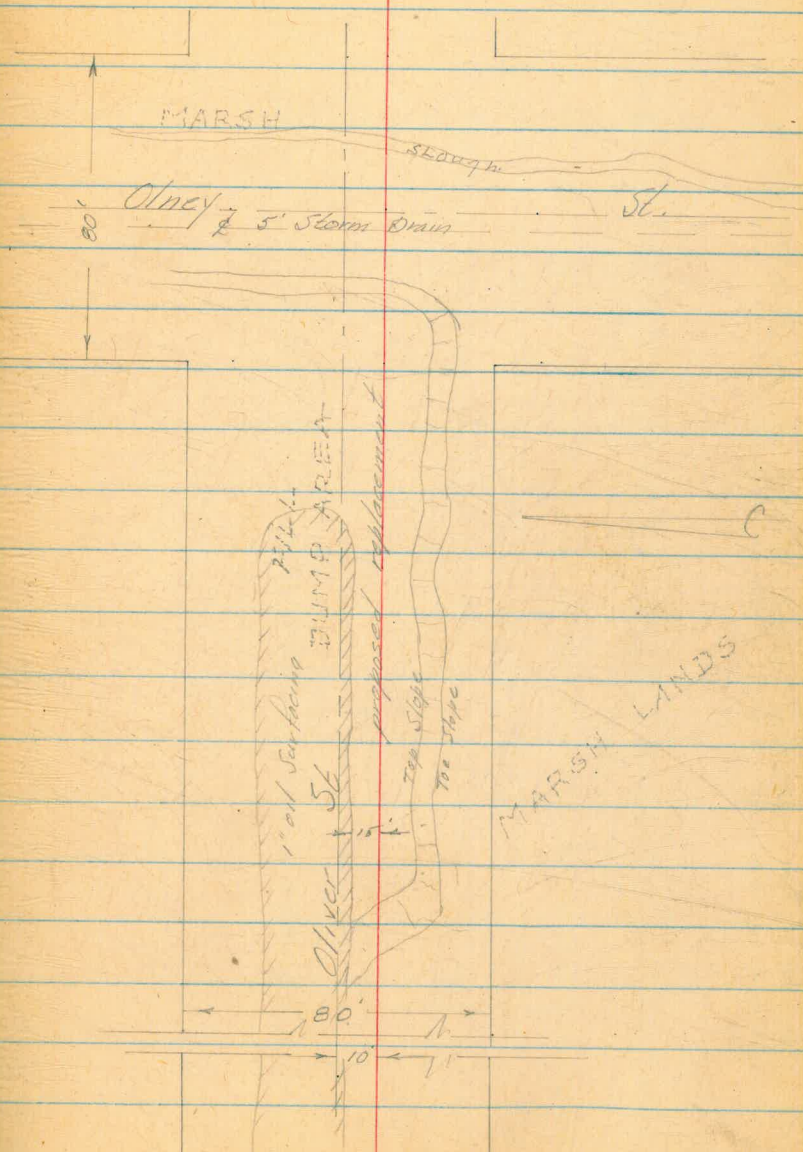

57 79. 45

W/L of Noyes

61 59. 45

W/L of Noyes

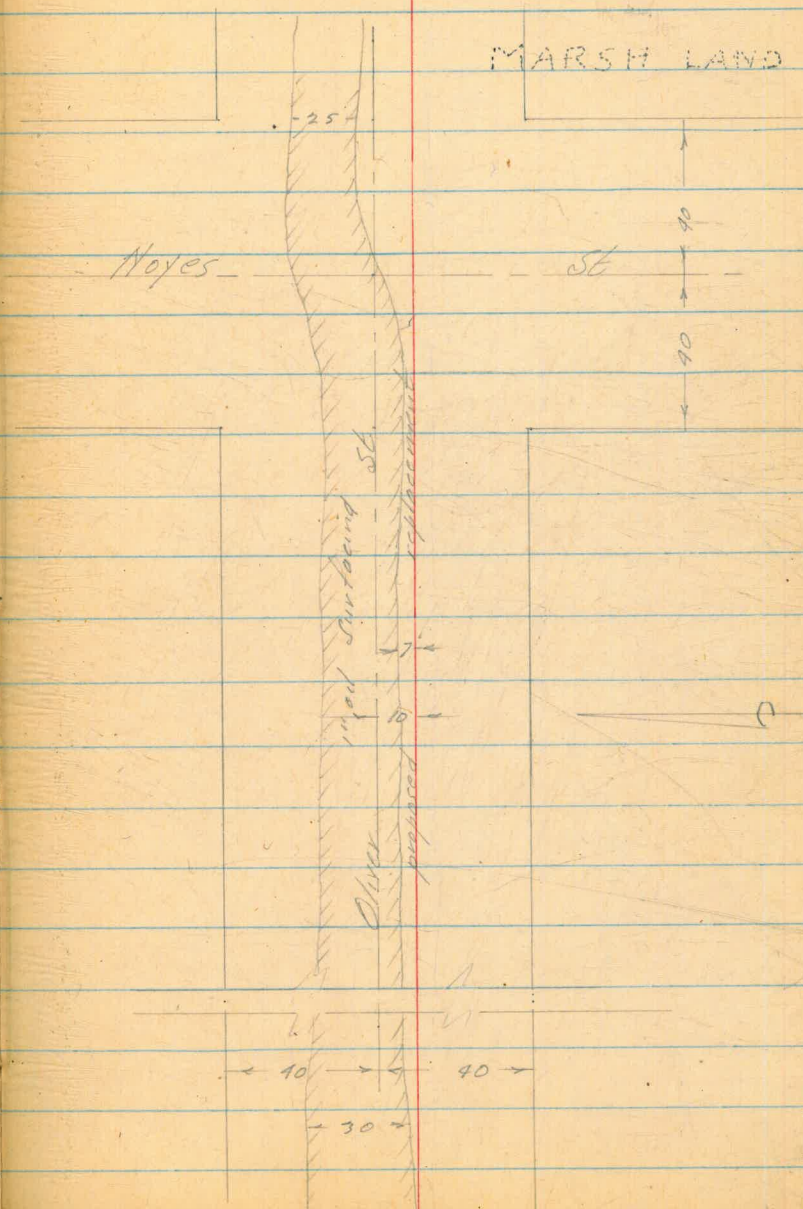



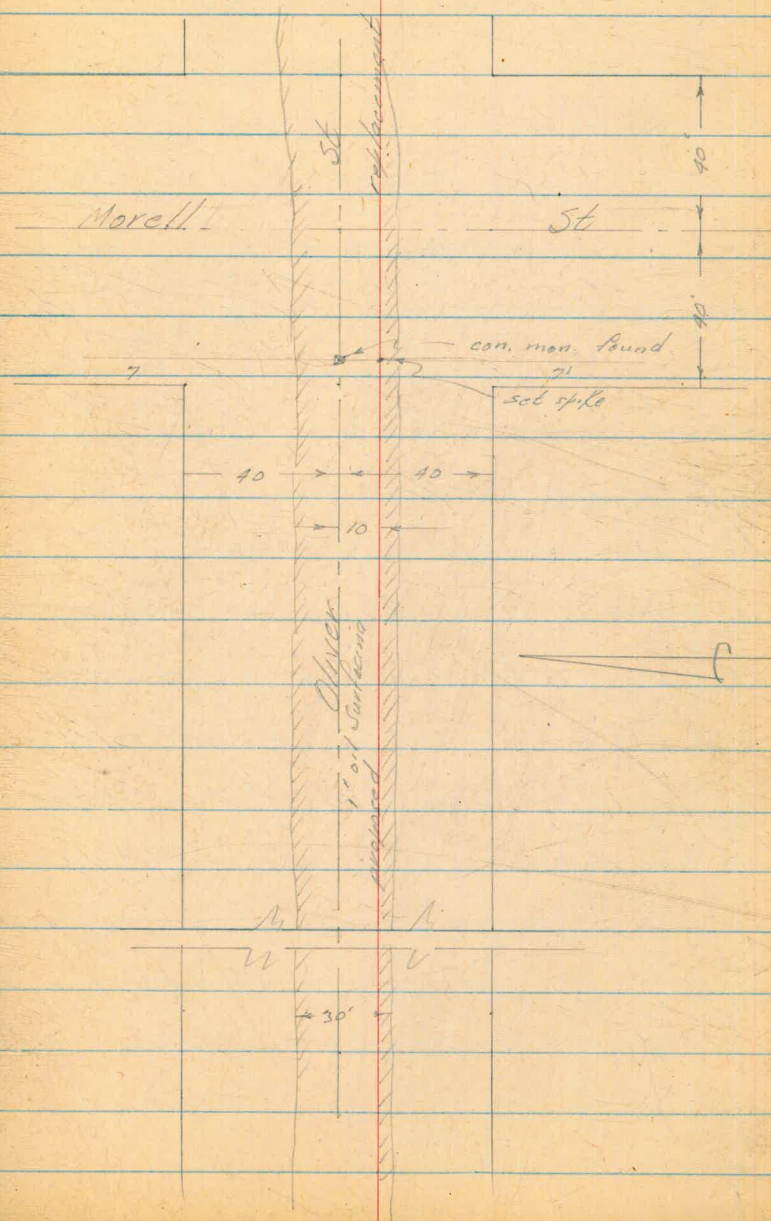

Oliver St. Cont.

17+39.11

#/L of Lament

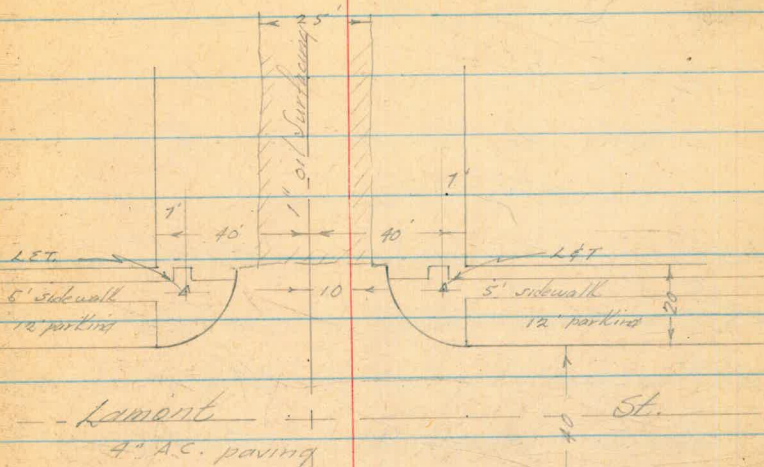

18+19.11

W/L of Lament

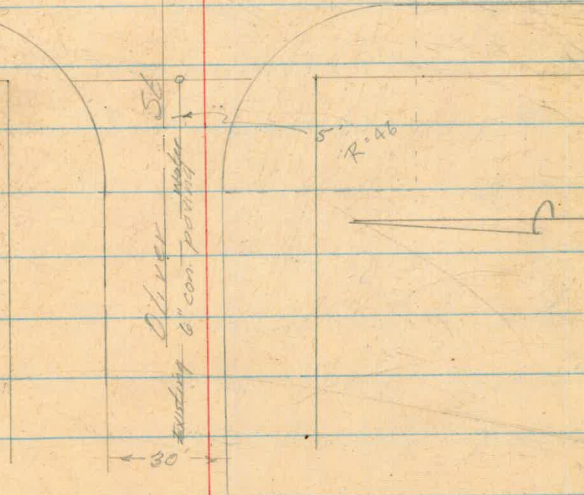



Profile Oliver St. Cont.

0.91

6.76 7.67

0+00	10.4	-2.7
+20	9.5	-1.8
+25	5.8	1.9
+45	5.0	2.7
+50	5.0	2.7
+57	6.9	0.8
+58	3.3	4.4
1+00	4.2	3.5
+50	5.8	1.9
2+00	5.8	1.9
T.P.	7.42	0.25
	3.84	4.09
2+50	3.6	0.5
3+00	5.4	-1.3
+50	5.3	-1.2
4+00	6.0	-1.9

68

T.B.M. Guy pole Sta. 1400 - 60' South

Top of fill covering 5" Storm Drain

Top " " " " "

of Storm Drain, 1.5' to top 5' S.D. pipe  
(5" I.D., 5" shell)

Top of fill covering Storm Drain

Top of fill (Dump area) **A**

4.09

4+50 5.6 -1.5

5+00 5.3 -1.2

+50 5.0 -0.9

6+00 4.1 0

+50 2.1 2.0

T.P. 0.54 3.55

10.69 14.24

7+00 2.0 5.2

+50 6.7 7.5

8+00 5.4 8.8

+50 4.2 10.0

9+00 3.2 11.0

+50 1.9 12.3

T.P. 0.28 13.96

5.48 19.44

10+00 5.9 13.5

+50 5.1 14.3

11+00 5.5 13.9



19.44

11150 5.2 14.2

12100 4.3 15.1

+50 3.2 16.2

T.P. 1.53 17.91

11.49 29.40

13100 2.8 19.6

+50 9.8 24.6

T.P. 0.95 28.95

12.16 46.11

14100 11.7 29.7

+50 7.8 33.3

15100 4.5 36.6

+50 3.0 38.1

16100 2.6 38.5

+50 2.3 38.8

T.P. 1.96 39.15

5.22 44.37

44.37

17+00	5.4	39.0
+50	4.7	39.7
+59.11	4.6	39.8
+79.11	4.5	39.9
17+99.11	4.9	39.5
18+19.11	4.6	39.8
	4.20	40.17

E curb line of Lament  
 & Lament  
 W curb line of Lament  
 W/L of Lament  
 N.E. LET = 40.35 Oliver & Lament



Went  
Lemp  
Alexander

72

2-4-55

Profile of Proposed Water line <sup>or</sup> Bachman  
on Lewis St. Cont. from Page 43

		258.17	
6.00	264.17		
		255.17	
	9.0	ft of water on Bachman	
	4.5	10 ft	259.67
T.P.		2.25	261.92
	12.20		274.62
		10.2	20' H. 269.42
		4.1	30' H. 270.52
T.P.		1.15	273.47
	11.25		284.82
		2.4	45' H. 282.32
		2.0	50' H. 282.72
		2.0	4" AC. 282.12

T.B.M. Leaf patch on exposed 4" water line, 7120  
Bachman & Lewis  
Arbor Dr.

3/23/55  
SHOREY  
MAETEL  
KELLHOFER

73

PROFILE & PROPOSED WATER REPLACEMENT  
LANDIS ST. - ALLEY E. OF 36<sup>th</sup> TO CHEROKEE

B.M. 7.07	342.32	335.25	N.W.B.P. 36 <sup>th</sup> & LANDIS
0+00 = W. LINE ALLEY	5.39		ON CONC. PAVT.
0+10	5.29		"
0+50	4.87		"
1+00	4.47		"
1+50	3.96		"
1+67 <sup>15</sup>	3.85		ON A.C. PAVT. OVER CONC. PAVT.
CK B.M.	7.07	335.25	



1+67<sup>15</sup> = 7' OFFSET L&T.  
1+60<sup>15</sup> = W. PROP. LINE CHEROKEE ST.

Note - main to run under parking area 3' from curb w/s street

already in ground 4-11-55

0+00 = W. LINE OF ALLEY

SEE PAGE 63

36<sup>th</sup> ST.

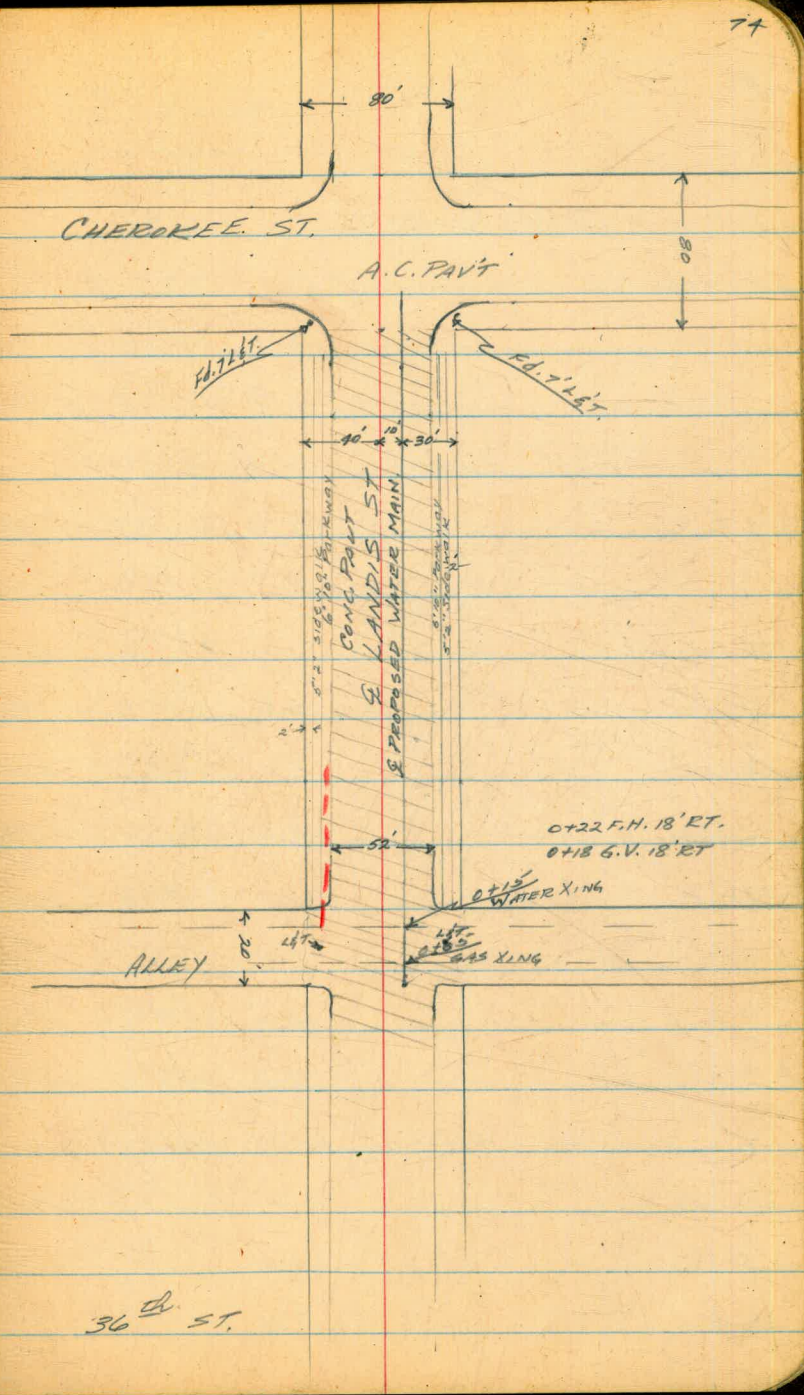



Reo Drive

POTOMAC ST to Cumberland

West

Williams K  
Varonfolkes  
Alexander

75

	9.31	212.68	203.37	
0+50		6.1	206.6	
1+00		4.0	208.7205.0	
+50		1.9	210.8 2070	
	12.65	224.69	0.64 212.04	
2+00		11.7	213.0 209.0	
+50		9.5	215.2 2110	
3+00		7.6	217.1 2130	
+50		6.0	218.7 2144	
4+00		5.0	219.7 215.8	
+50		4.6	220.1 216.0	
5+00		6.1	218.6 214.6	
+50		7.8	216.9 2130	
6+00		10.1	214.6 210.6	
+50		12.0	202.7 208.7	
	0.25	212.18	1276 211.93	
7+00		1.0	211.2 2074	
+50		3.2	209.0 205.2	
8+00		6.4	205.8 201.2	

SW BP Potomac + Rarcho

Begin Work

0 3<sup>3</sup>

0 3<sup>8</sup>

0 4<sup>0</sup>

0 4<sup>2</sup>

0 4<sup>1</sup>

0 4<sup>3</sup>

0 3<sup>9</sup>

0 4<sup>1</sup>

0 4<sup>0</sup>

0 3<sup>9</sup>

0 4<sup>0</sup>

0 4<sup>0</sup>

0 3<sup>8</sup>

0 3<sup>8</sup>

0 4<sup>0</sup>



## REG DRIVE CONT.

76.

212.18

8+50

10.0 202.2 198.3

C3<sup>9</sup>

9+00

13.1 199.1 195.5

C3<sup>6</sup>

1.10 200.18 13.10 199.08

+50

3.2 197.0 193.3

C3<sup>7</sup>

10+00 (4)

4.3 195.9 192.0

C3<sup>9</sup>

+50

5.1 195.1 191.4

C3<sup>7</sup>

11+00

5.3 194.9 191.2

C3<sup>7</sup>

+50

5.5 194.7 191.3

C3<sup>4</sup>

12+00

5.0 195.2 191.4

C3<sup>8</sup>

+50

4.9 195.3 191.6

C3<sup>7</sup>

13+00

4.5 195.7 192.0

C3<sup>7</sup>

+38

4.7 195.9 191.6

C4<sup>3</sup>

end of work

5.28 194.90 - 194.89



Franklin

Evans to 28<sup>th</sup>

0.19 88.78 88.59

4.13

0.60 83.21 6.14 82.64

0+40 11.5 71.7 67.8

0+63 11.6 71.6 68.1

1+08 10.8 72.4 68.8

+50 9.8 73.4 69.8

2+00 8.5 74.7 71.0

+50 7.4 75.8 72.0

3+00 6.4 76.8 73.0

+50 5.1 78.1 74.1

4+00 4.2 79.0 75.2

+50 3.4 79.8 75.9

5+00 2.6 80.6 76.6

+50 2.1 81.1 77.3

6+00 1.5 81.7 77.8

+50 6.76 88.98 1.02 82.22 78.4

7+00 6.0 83.0 78.6

+50 6.6 82.4 78.9

West  
Williams T  
Alexander

77

8/1/55

TBM Top FH 28<sup>th</sup> + Franklin

BP SW Cor 28<sup>th</sup> + Franklin

C3 <sup>9</sup> No Cut

C3 <sup>5</sup> FH Tee

C3 <sup>6</sup>

C3 <sup>6</sup>

C3 <sup>7</sup>

C3 <sup>8</sup>

C3 <sup>8</sup>

C4 <sup>0</sup>

C3 <sup>8</sup>

C3 <sup>9</sup>

C4 <sup>0</sup>

C3 <sup>8</sup>

C3 <sup>9</sup>

C3 <sup>8</sup>

C3 <sup>4</sup>

C4 <sup>5</sup> No Cut 6x6 cross

C3 <sup>5</sup>



## FRANKLIN CONT

78

88.98

8/1/55

8+00 6.7 82.6 79.0

C3  $\frac{6}{6}$ 

+50 6.2 82.8 79.2

C3  $\frac{6}{6}$ 

9+00 6.0 83.0 79.4

C3  $\frac{6}{6}$ 

+50 5.3 83.7 79.5

C4  $\frac{2}{2}$ 

9+93 4.8 84.2 79.8

C4  $\frac{4}{4}$ 

No Cut end of work

0.41 88.57 =

88.59



Please Return to  
 City of San Diego Water Dept.  
 Room 903 Civic Center

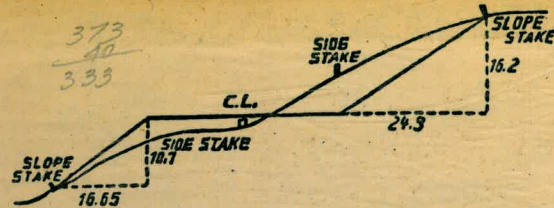

DISTANCES FROM SIDE STAKES FOR CROSS-SECTIONING.  
 SLOPE 1 1/2 TO 1. ROADWAY OF ANY WIDTH.

	0	.1	.2	.3	.4	.5	.6	.7	.8	.9	
0	0.00	0.15	0.30	0.45	0.60	0.75	0.90	1.05	1.20	1.35	0
1	1.50	1.65	1.80	1.95	2.10	2.25	2.40	2.55	2.70	2.85	1
2	3.00	3.15	3.30	3.45	3.60	3.75	3.90	4.05	4.20	4.35	2
3	4.50	4.65	4.80	4.95	5.10	5.25	5.40	5.55	5.70	5.85	3
4	6.00	6.15	6.30	6.45	6.60	6.75	6.90	7.05	7.20	7.35	4
5	7.50	7.65	7.80	7.95	8.10	8.25	8.40	8.55	8.70	8.85	5
6	9.00	9.15	9.30	9.45	9.60	9.75	9.90	10.05	10.20	10.35	6
7	10.50	10.65	10.80	10.95	11.10	11.25	11.40	11.55	11.70	11.85	7
8	12.00	12.15	12.30	12.45	12.60	12.75	12.90	13.05	13.20	13.35	8
9	13.50	13.65	13.80	13.95	14.10	14.25	14.40	14.55	14.70	14.85	9
10	15.00	15.15	15.30	15.45	15.60	15.75	15.90	16.05	16.20	16.35	10
11	16.50	16.65	16.80	16.95	17.10	17.25	17.40	17.55	17.70	17.85	11
12	18.00	18.15	18.30	18.45	18.60	18.75	18.90	19.05	19.20	19.35	12
13	19.50	19.65	19.80	19.95	20.10	20.25	20.40	20.55	20.70	20.85	13
14	21.00	21.15	21.30	21.45	21.60	21.75	21.90	22.05	22.20	22.35	14
15	22.50	22.65	22.80	22.95	23.10	23.25	23.40	23.55	23.70	23.85	15
16	24.00	24.15	24.30	24.45	24.60	24.75	24.90	25.05	25.20	25.35	16
17	25.50	25.65	25.80	25.95	26.10	26.25	26.40	26.55	26.70	26.85	17
18	27.00	27.15	27.30	27.45	27.60	27.75	27.90	28.05	28.20	28.35	18
19	28.50	28.65	28.80	28.95	29.10	29.25	29.40	29.55	29.70	29.85	19
20	30.00	30.15	30.30	30.45	30.60	30.75	30.90	31.05	31.20	31.35	20
21	31.50	31.65	31.80	31.95	32.10	32.25	32.40	32.55	32.70	32.85	21
22	33.00	33.15	33.30	33.45	33.60	33.75	33.90	34.05	34.20	34.35	22
23	34.50	34.65	34.80	34.95	35.10	35.25	35.40	35.55	35.70	35.85	23
24	36.00	36.15	36.30	36.45	36.60	36.75	36.90	37.05	37.20	37.35	24
25	37.50	37.65	37.80	37.95	38.10	38.25	38.40	38.55	38.70	38.85	25
26	39.00	39.15	39.30	39.45	39.60	39.75	39.90	40.05	40.20	40.35	26
27	40.50	40.65	40.80	40.95	41.10	41.25	41.40	41.55	41.70	41.85	27
28	42.00	42.15	42.30	42.45	42.60	42.75	42.90	43.05	43.20	43.35	28
29	43.50	43.65	43.80	43.95	44.10	44.25	44.40	44.55	44.70	44.85	29
30	45.00	45.15	45.30	45.45	45.60	45.75	45.90	46.05	46.20	46.35	30
31	46.50	46.65	46.80	46.95	47.10	47.25	47.40	47.55	47.70	47.85	31
32	48.00	48.15	48.30	48.45	48.60	48.75	48.90	49.05	49.20	49.35	32
33	49.50	49.65	49.80	49.95	50.10	50.25	50.40	50.55	50.70	50.85	33
34	51.00	51.15	51.30	51.45	51.60	51.75	51.90	52.05	52.20	52.35	34
35	52.50	52.65	52.80	52.95	53.10	53.25	53.40	53.55	53.70	53.85	35
36	54.00	54.15	54.30	54.45	54.60	54.75	54.90	55.05	55.20	55.35	36
37	55.50	55.65	55.80	55.95	56.10	56.25	56.40	56.55	56.70	56.85	37
38	57.00	57.15	57.30	57.45	57.60	57.75	57.90	58.05	58.20	58.35	38
39	58.50	58.65	58.80	58.95	59.10	59.25	59.40	59.55	59.70	59.85	39
40	60.00	60.15	60.30	60.45	60.60	60.75	60.90	61.05	61.20	61.35	40
41	61.50	61.65	61.80	61.95	62.10	62.25	62.40	62.55	62.70	62.85	41
42	63.00	63.15	63.30	63.45	63.60	63.75	63.90	64.05	64.20	64.35	42
43	64.50	64.65	64.80	64.95	65.10	65.25	65.40	65.55	65.70	65.85	43
44	66.00	66.15	66.30	66.45	66.60	66.75	66.90	67.05	67.20	67.35	44
45	67.50	67.65	67.80	67.95	68.10	68.25	68.40	68.55	68.70	68.85	45
46	69.00	69.15	69.30	69.45	69.60	69.75	69.90	70.05	70.20	70.35	46
47	70.50	70.65	70.80	70.95	71.10	71.20	71.40	71.55	71.70	71.85	47
48	72.00	72.15	72.30	72.45	72.60	72.75	72.90	73.05	73.20	73.35	48
49	73.50	73.65	73.80	73.95	74.10	74.25	74.40	74.55	74.70	74.85	49
50	75.00	75.15	75.30	75.45	75.60	75.75	75.90	76.05	76.20	76.35	50

Handwritten notes and calculations on the left page:

- 12
- 16
- 28
- 65
- 39
- 34
- 55
- 28
- 25
- 55
- 24
- 70
- 28

THE NATIONAL BLANK BOOK COMPANY  
 HOLYOKE MASSACHUSETTS  
 NEW YORK CHICAGO BOSTON SAN FRANCISCO