

W 914

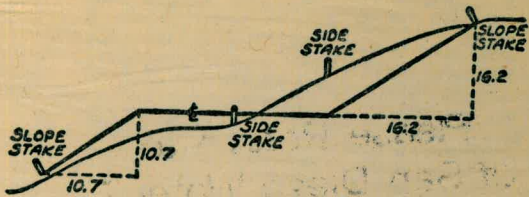

DISTANCES FROM SIDE STAKES FOR CROSS-SECTIONING
SLOPE 1 TO 1. ROADWAY OF ANY WIDTH

	0	.1	.2	.3	.4	.5	.6	.7	.8	.9	
0	0.00	0.10	0.20	0.30	0.40	0.50	0.60	0.70	0.80	0.90	0
1	1.00	1.10	1.20	1.30	1.40	1.50	1.60	1.70	1.80	1.90	1
2	2.00	2.10	2.20	2.30	2.40	2.50	2.60	2.70	2.80	2.90	2
3	3.00	3.10	3.20	3.30	3.40	3.50	3.60	3.70	3.80	3.90	3
4	4.00	4.10	4.20	4.30	4.40	4.50	4.60	4.70	4.80	4.90	4
5	5.00	5.10	5.20	5.30	5.40	5.50	5.60	5.70	5.80	5.90	5
6	6.00	6.10	6.20	6.30	6.40	6.50	6.60	6.70	6.80	6.90	6
7	7.00	7.10	7.20	7.30	7.40	7.50	7.60	7.70	7.80	7.90	7
8	8.00	8.10	8.20	8.30	8.40	8.50	8.60	8.70	8.80	8.90	8
9	9.00	9.10	9.20	9.30	9.40	9.50	9.60	9.70	9.80	9.90	9
10	10.00	10.10	10.20	10.30	10.40	10.50	10.60	10.70	10.80	10.90	10
11	11.00	11.10	11.20	11.30	11.40	11.50	11.60	11.70	11.80	11.90	11
12	12.00	12.10	12.20	12.30	12.40	12.50	12.60	12.70	12.80	12.90	12
13	13.00	13.10	13.20	13.30	13.40	13.50	13.60	13.70	13.80	13.90	13
14	14.00	14.10	14.20	14.30	14.40	14.50	14.60	14.70	14.80	14.90	14
15	15.00	15.10	15.20	15.30	15.40	15.50	15.60	15.70	15.80	15.90	15
16	16.00	16.10	16.20	16.30	16.40	16.50	16.60	16.70	16.80	16.90	16
17	17.00	17.10	17.20	17.30	17.40	17.50	17.60	17.70	17.80	17.90	17
18	18.00	18.10	18.20	18.30	18.40	18.50	18.60	18.70	18.80	18.90	18
19	19.00	19.10	19.20	19.30	19.40	19.50	19.60	19.70	19.80	19.90	19
20	20.00	20.10	20.20	20.30	20.40	20.50	20.60	20.70	20.80	20.90	20
21	21.00	21.10	21.20	21.30	21.40	21.50	21.60	21.70	21.80	21.90	21
22	22.00	22.10	22.20	22.30	22.40	22.50	22.60	22.70	22.80	22.90	22
23	23.00	23.10	23.20	23.30	23.40	23.50	23.60	23.70	23.80	23.90	23
24	24.00	24.10	24.20	24.30	24.40	24.50	24.60	24.70	24.80	24.90	24
25	25.00	25.10	25.20	25.30	25.40	25.50	25.60	25.70	25.80	25.90	25
26	26.00	26.10	26.20	26.30	26.40	26.50	26.60	26.70	26.80	26.90	26
27	27.00	27.10	27.20	27.30	27.40	27.50	27.60	27.70	27.80	27.90	27
28	28.00	28.10	28.20	28.30	28.40	28.50	28.60	28.70	28.80	28.90	28
29	29.00	29.10	29.20	29.30	29.40	29.50	29.60	29.70	29.80	29.90	29
30	30.00	30.10	30.20	30.30	30.40	30.50	30.60	30.70	30.80	30.90	30
31	31.00	31.10	31.20	31.30	31.40	31.50	31.60	31.70	31.80	31.90	31
32	32.00	32.10	32.20	32.30	32.40	32.50	32.60	32.70	32.80	32.90	32
33	33.00	33.10	33.20	33.30	33.40	33.50	33.60	33.70	33.80	33.90	33
34	34.00	34.10	34.20	34.30	34.40	34.50	34.60	34.70	34.80	34.90	34
35	35.00	35.10	35.20	35.30	35.40	35.50	35.60	35.70	35.80	35.90	35
36	36.00	36.10	36.20	36.30	36.40	36.50	36.60	36.70	36.80	36.90	36
37	37.00	37.10	37.20	37.30	37.40	37.50	37.60	37.70	37.80	37.90	37
38	38.00	38.10	38.20	38.30	38.40	38.50	38.60	38.70	38.80	38.90	38
39	39.00	39.10	39.20	39.30	39.40	39.50	39.60	39.70	39.80	39.90	39
40	40.00	40.10	40.20	40.30	40.40	40.50	40.60	40.70	40.80	40.90	40
41	41.00	41.10	41.20	41.30	41.40	41.50	41.60	41.70	41.80	41.90	41
42	42.00	42.10	42.20	42.30	42.40	42.50	42.60	42.70	42.80	42.90	42
43	43.00	43.10	43.20	43.30	43.40	43.50	43.60	43.70	43.80	43.90	43
44	44.00	44.10	44.20	44.30	44.40	44.50	44.60	44.70	44.80	44.90	44
45	45.00	45.10	45.20	45.30	45.40	45.50	45.60	45.70	45.80	45.90	45
46	46.00	46.10	46.20	46.30	46.40	46.50	46.60	46.70	46.80	46.90	46
47	47.00	47.10	47.20	47.30	47.40	47.50	47.60	47.70	47.80	47.90	47
48	48.00	48.10	48.20	48.30	48.40	48.50	48.60	48.70	48.80	48.90	48
49	49.00	49.10	49.20	49.30	49.40	49.50	49.60	49.70	49.80	49.90	49
50	50.00	50.10	50.20	50.30	50.40	50.50	50.60	50.70	50.80	50.90	50

Distance of slope stake from side or shoulder stake for any width roadway, slope 1 to 1. If ground is nearly level, the cut or fill at side stake is located by the double entry method in left column and top row. The number in body of table in same row and column gives distance from side stake to slope stake. If ground is not level estimate the difference in elevation between the side stake and slope stake, lower target by this amount if cut, elevate if fill. Add this amount to cut or fill and estimate distance in table. Set up rod at this point, and line of sight should cut target. If it does not make the slight adjustment necessary.

Please Return to
City of San Diego Water Dept.
Room 903 Civic Center

TABLE XIII—CORRECTIONS FOR TANGENTS AND EXTERNALS

These corrections are to be added to the approximate values, found by dividing the tangent, or external, for a 1° curve (Table VIII) by the degree of curve, in order to obtain the true tangents, or externals. Intermediate values may be obtained by interpolation.

FOR TANGENTS ADD

Central Angle	DEGREE OF CURVE													
	5°	10°	15°	20°	25°	30°	35°	40°	45°	50°	55°	60°	65°	70°
10°	.03	.06	.09	.13	.16	.19	.22	.25	.28	.31	.34	.38	.42	.46
15°	.04	.10	.14	.19	.24	.29	.34	.39	.45	.51	.55	.58	.63	.68
20°	.06	.13	.19	.26	.32	.39	.45	.51	.58	.65	.72	.79	.84	.90
25°	.08	.16	.24	.33	.40	.49	.58	.67	.75	.83	.90	.99	1.06	1.14
30°	.10	.19	.29	.39	.49	.59	.69	.79	.89	.99	1.09	1.20	1.29	1.39
35°	.11	.22	.34	.47	.58	.69	.79	.81	.92	1.04	1.14	1.21	1.29	1.39
40°	.13	.26	.40	.53	.67	.80	.93	1.06	1.20	1.34	1.49	1.64	1.79	1.94
45°	.15	.30	.44	.60	.76	.91	1.06	1.21	1.37	1.52	1.70	1.87	2.04	2.21
50°	.17	.34	.51	.68	.85	1.02	1.19	1.36	1.54	1.72	1.91	2.10	2.29	2.48
55°	.19	.38	.57	.76	.95	1.14	1.32	1.52	1.72	1.92	2.14	2.35	2.56	2.77
60°	.21	.42	.63	.84	1.05	1.27	1.49	1.71	1.94	2.17	2.38	2.60	2.83	3.07
65°	.23	.46	.69	.93	1.16	1.40	1.64	1.88	2.13	2.38	2.63	2.88	3.13	3.39
70°	.25	.51	.76	1.02	1.28	1.54	1.80	2.06	2.33	2.60	2.88	3.16	3.44	3.72
75°	.27	.56	.83	1.12	1.40	1.69	1.98	2.27	2.57	2.87	3.16	3.47	3.78	4.09
80°	.30	.61	.91	1.22	1.53	1.84	2.15	2.46	2.78	3.10	3.44	3.78	4.12	4.46
85°	.33	.66	1.00	1.33	1.68	2.02	2.36	2.70	3.05	3.40	3.77	4.14	4.55	4.89
90°	.36	.72	1.09	1.45	1.83	2.20	2.57	2.94	3.32	3.70	4.10	4.50	4.91	5.32
95°	.39	.79	1.19	1.55	2.00	2.40	2.80	3.20	3.61	4.02	4.40	4.98	5.38	5.83
100°	.43	.86	1.30	1.74	2.18	2.62	3.06	3.50	3.95	4.40	4.88	5.37	5.85	6.34
110°	.51	1.03	1.56	2.08	2.61	3.14	3.67	4.21	4.76	5.31	5.86	6.43	7.01	7.60
120°	.62	1.25	1.93	2.52	3.16	3.81	4.45	5.11	5.77	6.44	7.12	7.80	8.50	9.22

FOR EXTERNALS ADD

Central Angle	DEGREE OF CURVE													
	5°	10°	15°	20°	25°	30°	35°	40°	45°	50°	55°	60°	65°	70°
10°	.001	.003	.004	.006	.007	.008	.009	.011	.012	.014	.015	.017	.018	.020
15°	.003	.007	.010	.014	.018	.023	.027	.029	.032	.035	.039	.043	.047	.051
20°	.006	.011	.017	.022	.028	.034	.038	.045	.051	.057	.063	.070	.076	.083
25°	.009	.018	.027	.036	.046	.056	.065	.074	.083	.093	.106	.120	.127	.135
30°	.013	.025	.038	.051	.065	.078	.090	.103	.116	.129	.149	.170	.179	.188
35°	.018	.035	.054	.072	.086	.109	.131	.153	.175	.197	.213	.230	.247	.264
40°	.023	.046	.070	.093	.117	.141	.172	.203	.234	.265	.277	.290	.315	.341
45°	.030	.060	.093	.119	.153	.184	.216	.254	.289	.325	.351	.378	.411	.445
50°	.037	.075	.116	.151	.189	.227	.266	.305	.345	.384	.425	.467	.508	.550
55°	.046	.093	.142	.188	.236	.283	.332	.381	.420	.479	.530	.582	.641	.700
60°	.056	.112	.168	.225	.283	.340	.398	.457	.516	.575	.636	.697	.774	.851
65°	.067	.135	.204	.273	.343	.412	.483	.554	.625	.697	.771	.845	.922	1.01
70°	.080	.159	.240	.321	.403	.485	.568	.652	.735	.819	.906	.994	1.08	1.17
75°	.095	.182	.286	.383	.480	.578	.678	.777	.877	.977	1.07	1.18	1.29	1.39
80°	.110	.220	.332	.445	.558	.671	.787	.903	1.02	1.13	1.25	1.38	1.50	1.62
85°	.128	.259	.391	.524	.657	.790	.926	1.06	1.20	1.34	1.47	1.62	1.76	1.91
90°	.149	.299	.450	.603	.756	.910	1.07	1.22	1.38	1.54	1.70	1.87	2.03	2.20
95°	.174	.350	.522	.706	.885	1.06	1.25	1.43	1.62	1.80	1.99	2.18	2.38	2.58
100°	.200	.401	.604	.809	1.01	1.22	1.43	1.64	1.85	2.06	2.28	2.50	2.73	2.96
110°	.268	.536	.806	1.08	1.35	1.63	1.91	2.20	2.48	2.76	3.05	3.35	3.66	3.96
120°	.360	.721	1.08	1.45	1.82	2.19	2.57	2.95	3.33	3.72	4.11	4.50	4.91	5.32

INDEX

- Palino Group 24
- IMPERIAL St Plymouth to 190' East ✓ 1-3
- Palino Group 24
- K St Basin to 49th St 4-5 ✓
- Palino Group 25
- Weeks St Baerost to Darcas St 6-7 ✓
- Palino Group
- Bunzica Lauretta to 170' South 8-9 ✓
- Palino Group 25
- Adveston St Jellott to Ingall 10-11 ✓
- Alice
- PITTA ST., MARKET ST. NLY 900' PRELIM. 12-14 ✓
- ALBATROSS ST., UPAS TO 190' SLY. - PRELIM. 15-16 ✓
- MONTECITO WAY, FALCON TO 150' W. PRELIM. 17-18 ✓
- " " EAGLE TO FALCON, Prelim. 19 ✓
- EAGLE ST. LEWIS to Montecito, Prelim. 21-23 ✓
- & PROFILE
- Alice
- MORENA BLYD 16" C.I. RELINE 29-30 ✓
- Alice
- IMPERIAL AVE., PLYMOUTH ST. TO 350' E. - PRELIM. 31-32 ✓
- Alice
- PUMP HOUSE LOCATION & ELEV. - DEL CERRO 33-34 ✓
- Alice
- DEL CERRO RES - Roof panel elev. 35 ✓
- Alice
- DEL CERRO RES - Elev. Top of Walls 36 ✓
- Alice
- DEL CERRO RES. " " " " 37 ✓
- DEL CERRO RES. Roof panels elev. 38 ✓
- Alice

IMPERIAL

Plymouth St to 190' East
Pulm Group 30

30

1+90

Ely Line Panorama Hrs

SEE Pg. 31-32
for Revision.

0+00

Why prop line Plymouth

GROUP 30,
IMPERIAL AVE..

Need = (?), etc...

Proposed 8" A.C. Main

IMPERIAL

6" c.i. (Calif. Water & Teleph. Co.)

AVENUE

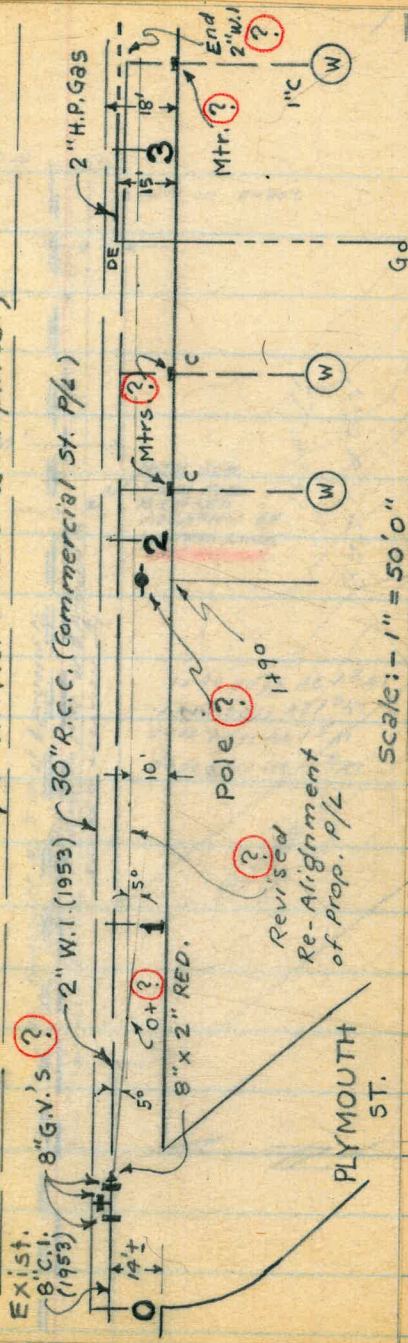

179

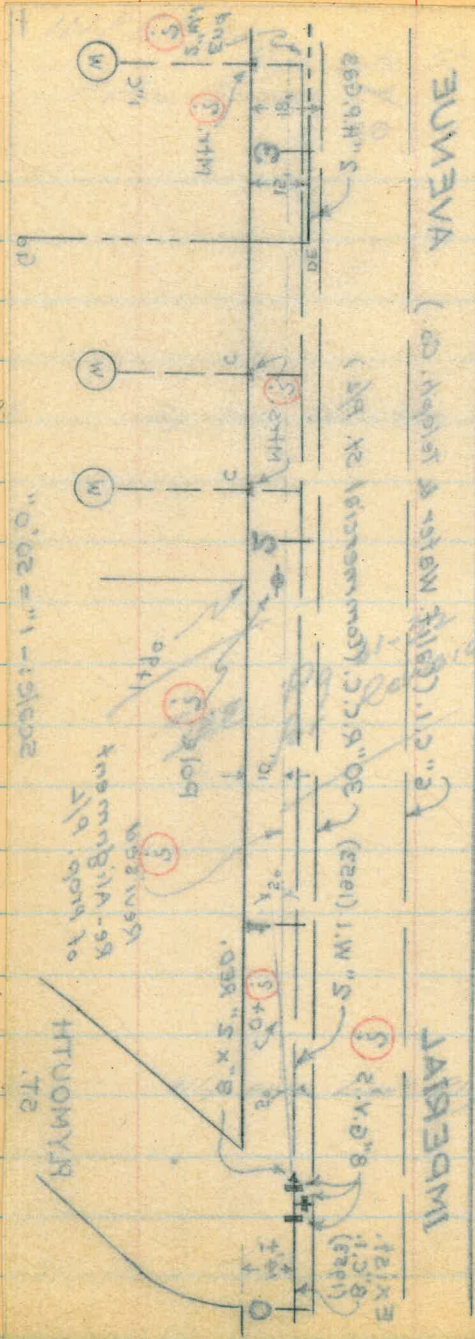

used = 3' etc...

proposed 8" V.C. Main
IMPERIAL AVE.
CROSSING 30

123 South of 2nd St
1-27-52

West
Martell
Varonakis
Kellhofer

6-24-53

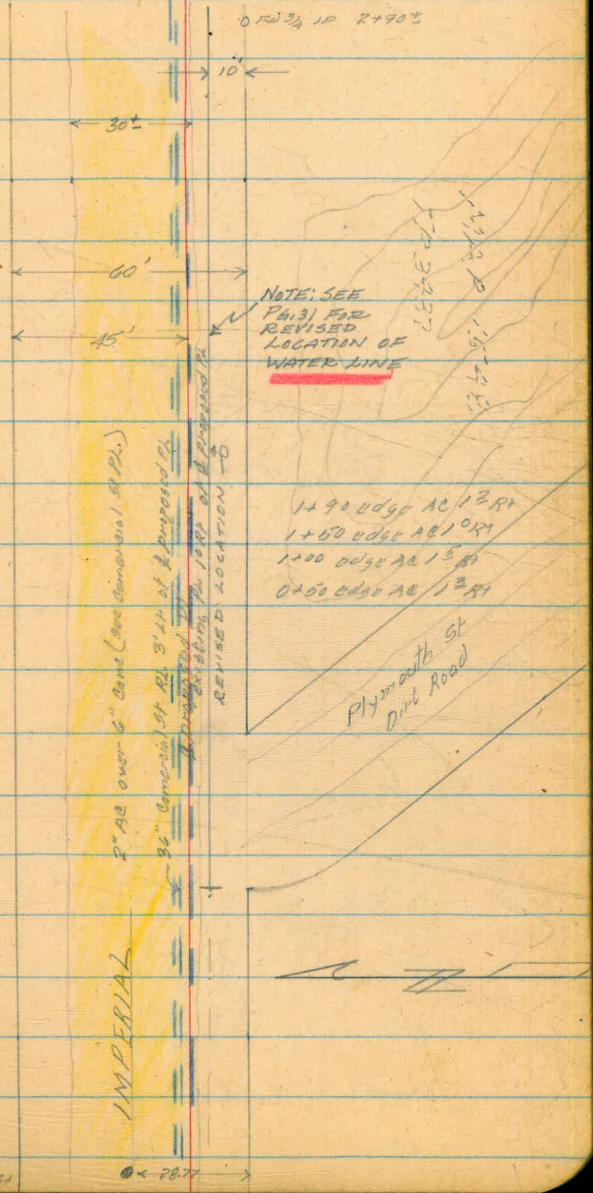

IMPERIAL

2" AC over 6" Cast (see General at P. 1)

36" Commercial St. 3" up at proposed 12' depth of 18" to 10' at proposed 12'

REVISED LOCATION - 3

NOTE: SEE P. 31 FOR REVISED LOCATION OF WATER LINE

- 1+90 edge AC 12 R1
- 1+50 edge AC 10 R1
- 1+00 edge AC 13 R1
- 0+00 edge AC 12 R1

Plymouth St
Dirt Road

Q Profile Proposed P2

1.80	113.97	112.17	
2.35	104.09	1223	101.74
1.01	92.21	12.89	91.20
1.95	81.86	12.30	79.91
13.03	84.01	10.88	70.98
12.57	96.05	0.47	83.54
11.45	106.54	0.96	95.09
6.29	111.93	0.90	105.64
2.13	111.56	2.50	109.43
0+00		2.8	108.8
+50		4.8	106.8
1+00		7.2	104.4
+50		9.5	102.1
+90		11.1	100.5
11.54	121.84	1.26	110.30
12.62	133.08	1.38	120.46
12.92	145.52	0.98	132.60
0.63	139.54	0.61	138.91
0.00	136.67	2.87	130.67

Red'd by Rocky

BM 47th + Imperial SEDE

8' RL 0+15
 Spikem Bay pole #276602
 Wly prop line Plymouth

136.67

7.03 133.47 10.23 126.44

4.63 128.84 =

3

128.74 SW 13P 92nd + Market St

K St
Cavin to 44th
Proposed Pl.



West
mantell
Vanonfakis
Kellhofer

← 3+80¹² Ely ① line
44th St Produced 4

6-29-55

Rat W
5074 PR8

2+312 5" LI PP # 900 69
2+00 2" LI end of existing
2" Main

← 30' →

← 25' →

1+97 Dead man 5' LI

Dist Road

← 0+26 5" Wly ① line
Cavin St Produced

0+00 2" QV 1014

① 12' 11" OLYERK-17723 21' LI

① 350' 2 West

CAVIN ST

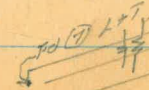

K 51

Q Pro

Red'd
by Rocky

4.46 143.37 134.91

7.47 142.01 8.83 134.54

0+00 7.2 134.8

+50 7.2 134.8

1+00 7.1 134.9

+50 6.1 135.9

2+00 4.9 137.1

+50 5.0 137.0

3+00 4.7 137.3

+50 4.6 137.4

0.99 137.26 5.74 136.27

0.55 136.71 =

6-24-53

TOM Cross page 3

④ LIT 21' RT 0-17

5.6 7.1 8.0 8.3
10' RT 5' RT 10' RT 25' RT

5.6 7.0 7.7 7.8
10' RT 5' RT 10' RT 15' RT

5.3 6.9 7.3
10' RT 5' RT 10' RT

5.8 6.1 6.5
10' RT 5' RT 10' RT

5.2 5.0
5' RT 10' RT

5.1 4.8
5' RT 10' RT

4.7 4.7
5' RT 10' RT

4.9 4.4
5' RT 10' RT

136.67 TOP F.H. S.E. CORNER 43rd & J

Weeks Ave

Dorcas to Buenos Ave

West
Martell
Varanokis

4

6-29-55

4+59⁷⁰ POT

4+05³² 14

(Dirt Road)
Dorcas St

Ed Cons Man ① 4+59⁷⁰

4+50 4" Water 21' R

60'

40'

30'

Proposed

Weeks St (Dirt Road)

Ed Cons Man ① 0+53

0+53 POT

60'

Buenos St

2" Al pave

Weeks
 Prof. 10

West
 Martell
 Varonfakis

7

6-29-55

0.31	28.80		29.49
0+00		0.8	28.0
+21		2.17	26.63
+40		2.10	26.70
+50		1.9	26.90
+100		4.4	24.40
+50		5.9	22.90
2+00		6.3	22.50
+40		5.79	+7.8 To Flow
+50		6.4	22.40
3+00		6.6	22.20
+50		7.7	21.10
4+00		10.6	18.20
6.57	22.42	12.95	15.85
+50		6.9	15.52
+80		6.98	+9.0 To Flow
+97		8.5	13.92
	6.70	15.72	= 15.72
	9.04	13.38	

Nail in PP 55ly Cor Buenos + Works

Ely prop line Buenos

Begin A.E. Pave

end A.E. pave

10' Rt Top South Rim Sewer MH

10' Rt Top South Rim Sewer MH

Wly Prop Line Dorcen

Nail in PP 13 AT 4+59

Turn on SW Cor Meter Vault

J Gray P 12-50'

Reduced by

Benedicta St.

Lauretta to 170' South

Palim Group 25

West
Martell
Varonakis

9

6-29-65

2+20 ±

end of work

Alley 1+00±

Alley

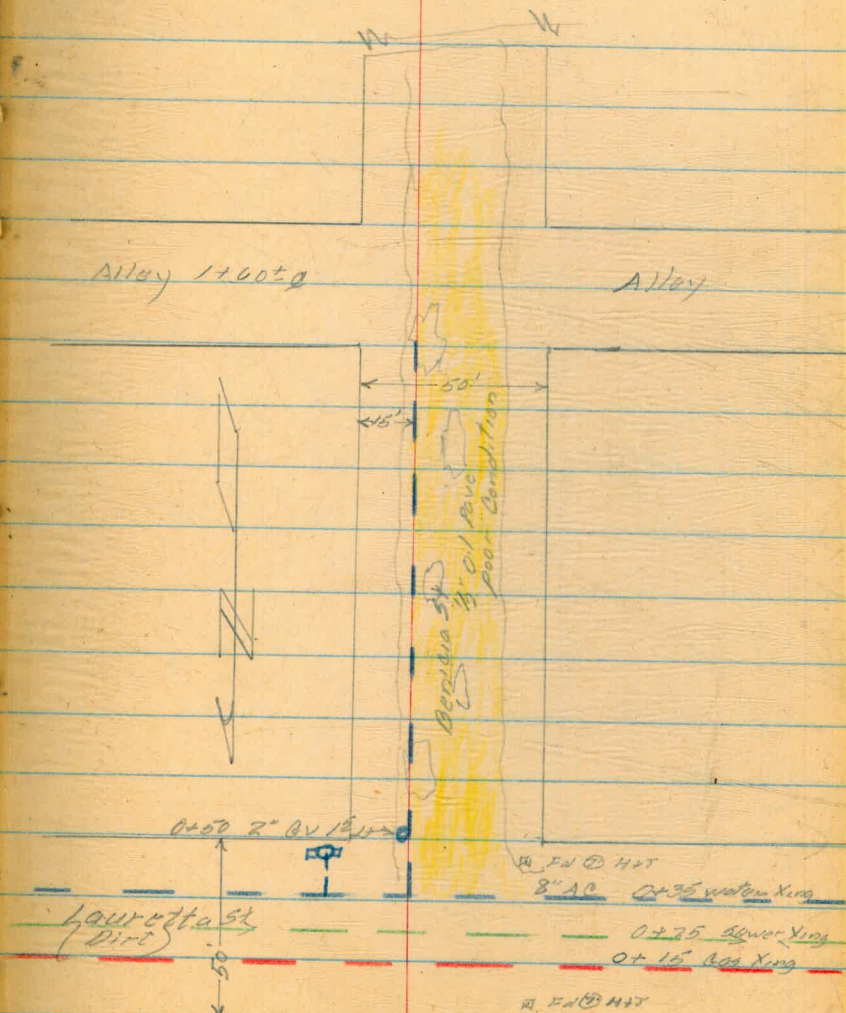

0+07 POT

0+00

Nly prop line Lauretta

Bungoia St
Q Profile

0.35	70.99		70.64
0.59	60.12	11.40	59.53
0+00		3.7	56.42
+50		6.0	54.12
1+00		7.8	52.32
+50		10.2	49.92
2+00		12.2	47.92
+20		12.8	47.32
13.07	71.10	2.09	58.03
		0.44	70.66

Reduced by J. Gray 7/15/55

Top FH SE Cor Colusa Laurus

Nly prop line Laurus

Turn on FH SE Cor Benicia Laurus

Galveston Jewett to Ingulf

Proposed Pl.

Group 25

5+60 14 ±

North prop line Ingulf St

5+20 16

POT

0+40 POT

0+00

South prop line Jewett

West
Williams
Voronfakis

10

Ingulf St
Dirt

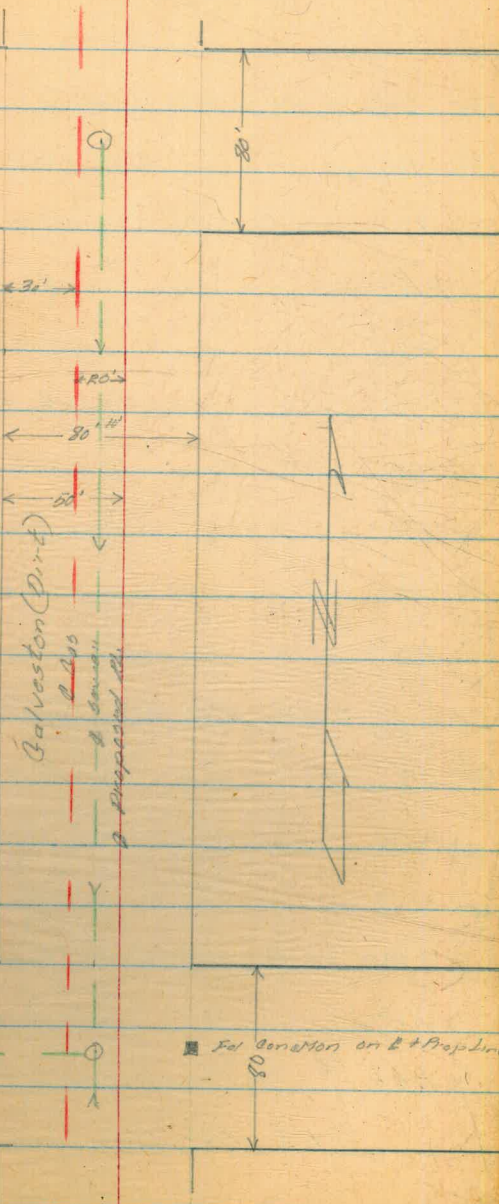

Galveston Jellott to
Ingulf

Profile

6.51 147.34 140.83

0+00 10.9 136.44

+40 9.60 137.74

+50 8.9 138.44

1+00 7.8 139.54

+50 6.9 140.44

2+00 5.9 141.44

+50 4.7 142.64

3+00 3.2 144.14

+50 1.6 145.74

9.58 156.40 0.52 146.82

4+00 8.9 147.50

+50 7.4 149.00

5+00 6.1 150.30

+20 6.80 149.60

+50 6.1 150.3

+60 ¹⁶ 5.9 150.5

2.17 146.73 11.84 144.56

5.91 140.82 = 140.83

West
Williams
Varonfoks

11

7-6-55

Cond Man

Jellott Ct-line intersection w E Line Galveston

South Line Jellott's

Top east rim sewer MH 10' 21"

Top east Rim Sewer MH 18' 11"

North prep line Ingulf St

PITTA ST.
 MARKET ST. NLY 400'
 & PROFILE PROPOSED WATER MAIN

12-2-55
 SHOREY
 MARTELL
 KEMP

12

0+00

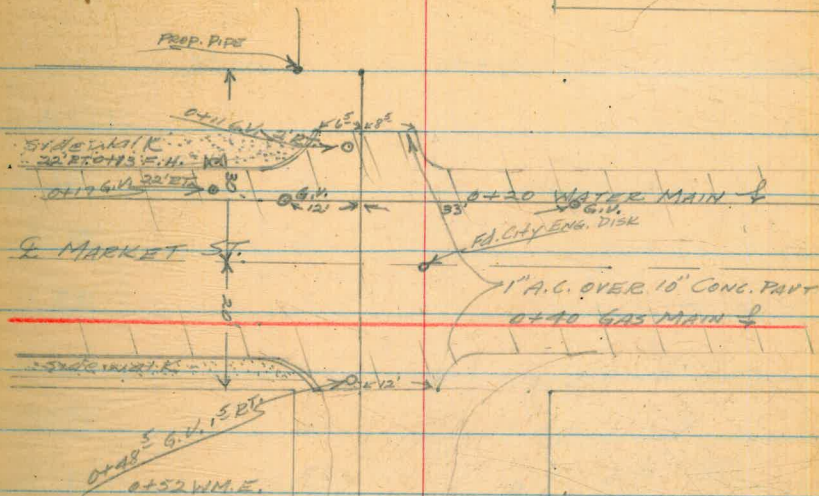

4+50 ³⁰ CONG. MAN.

5+00 ²⁷ 2" X 2" HUB

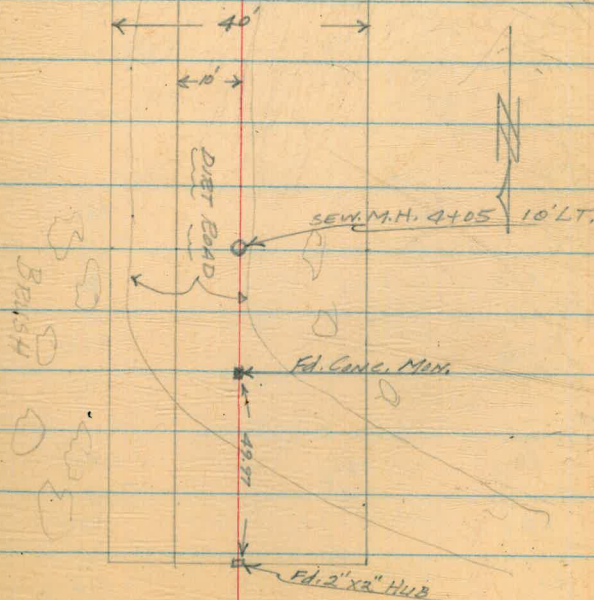

PITTA ST.
(CONT'D)

12-2-55
SHOREY
MARTELL
KEMP

13

BM	11.60	193.43	181.83
0+00			12.6
0+10 Edge Conc.			11.34
0+15 Ch. Line			11.50
0+30 E. MARKET			11.26
0+45 Ch. Line			11.65
0+50 Edge Conc.			11.66
0+51			11.5
0+62			9.7
0+80			6.7
1+00			3.9
TP	12.87	205.52	0.78
1+50			10.7
2+00			6.0
2+50			1.9
TP	11.84	216.76	0.60
3+00			9.7
3+50			7.1
4+00			4.8

181.83

180.8

181.7

181.9

182.1

181.7

181.7

181.9

183.7

186.7

189.5

192.65 ✓

194.8

199.5

203.6

204.92 ✓

207.1

208.7

212.0

LT

RT

S.E.B.P. PITTA & MARKET

182.6
10.5
10

184.0
9.4
10

186.8
6.8
10

189.5
3.9
10

194.9
10.6
10

199.7
5.8
10

203.6
1.9
10

207.2
9.6
10

210.1
6.7
10

212.2
4.6
10

182.0

11.42

6.5

11.2

6

183.9

9.5

4

186.1

6.7

3

189.3

4.1

10

194.9

10.6

10

199.3

6.2

7

203.0

2.5

10

206.6

10.2

5

208.8

7.5

4

211.1

5.1

5

198.9

6.6

10

202.7

2.8

10

206.1

10.7

10

210.2

8.4

10

210.2

6.6

10

6.5 TOP Ch. RETURN

183.2 103.8 183.2

185.2 185.2 185.7

187.0 187.0 187.0

194.9 194.9 194.9

198.9 198.9 198.9

202.7 202.7 202.7

206.1 206.1 206.1

210.2 210.2 210.2

210.2 210.2 210.2

210.2 210.2 210.2

210.2 210.2 210.2

210.2 210.2 210.2

210.2 210.2 210.2

210.2 210.2 210.2

182.0 182.0 182.0

182.0 182.0 182.0

182.0 182.0 182.0

182.0 182.0 182.0

182.0 182.0 182.0

182.0 182.0 182.0

182.0 182.0 182.0

182.0 182.0 182.0

182.0 182.0 182.0

182.0 182.0 182.0

182.0 182.0 182.0

182.0 182.0 182.0

182.0 182.0 182.0

182.0 182.0 182.0

182.0 182.0 182.0

182.0 182.0 182.0

LT

BT

216.76

4+05

4.6

212.2

E. RIM SEW. M.H.

4.20

212.6

£

12.85

204.0

4+50

3.1

213.7

5+00

1.4

215.4

CK. TBM

2.35

214.41 - 214.43

SEW. M.H. 4+05

10' LT.

10" SEW.

£

215.2

211.9

4.6

4.9

216.6

213.8

+0.2

3.0

F.B. 2013-4

CONG. MON. 4+50

10' LT.

ALBATROSS ST.
(CONT'D)

LT.

RT.

BM	3.31	250.28	246.97
0+00		4.3	246.0
0+50		4.9	245.1
0+80	Edge PAVT	5.1	245.2
1+00		5.6	244.7
	E RIM SEW M.H.	{ 6.30 11.30 13.50	
1+50		8.9	241.4
2+00		11.3	239.0
	TP	2.75	240.61
		12.42	237.86
2+50		4.2	236.4
	CATCH BASIN	4.9 6.1	235.7
2+67	FENCE XING	4.7	235.9
2+70		4.5	236.1
	SET TBM	12.63	248.64
		4.60	236.01
CK. BM		1.67	246.97 = 246.97

N.E.B.P. ALBATROSS & WALNUT

				244.6
				5.7 10
				241.6
				8.7 10
				238.9
				11.4 10
				236.4
				4.2 10
				235.4
				5.2 10
				235.4
				5.2 10
				235.4

8.3 8.5 7.9 7.3
10 7 5 BUTT 3" TOP WALL

SEW. M. H. 1+09 5 10' RT.
PROP INLET FROM EAST

14.5 14.5 14.2 11.6
10 7 5" BUTT 3" TOP WALL

16.2 16.2 11.6
10 5" BUTT 5" TOP WALL

3.7 4.2
10 8

CATCH BASIN 2+50 34' RT.
" " " "

7.6 5.7
10 4

END OF Ch. 37⁶ RT. APPROX. 2+80

MONTECITO WAY
(CONT'D)

18

BM.	1.08	267.20		266.12	N.W.B.P. FALCON & FT. STOCKTON
SET TBM	4.30	267.47	4.03	263.17	SW. 7' LFT
0+00	Edge 6" A.C. PAVT.		3.6	263.9	
0+19	CB. LINE		3.7		
	SEW. M.H. 5 RM		{ 3.51 10.60		SEW. M.H. 0+19 10' RT 2 " "
0+40	& FALCON ST.		3.7		
0+50			3.7		
0+66			4.5		
0+80	Edge 6" A.C. PAVT.		4.6	262.9	
1+00			4.0	263.5	
1+40			2.6	264.9	
1+50			2.9	264.6	
2+00			7.7	259.8	
2+30			10.9	256.6	
2+35 [±]	TOP CONC. ABUT.		11.4	256.1	
2+35 [±]	BOTTOM		13.0	254.5	
SET TBM	4.74	267.85	4.36	263.11	S.W.B.P. MONTECITO & FALCON
CK. BM.			174	266.11 = 266.12	

MONTECITO WAY
(CONT'D)

12-9-55

20

TBM	3.14	266.25	263.11
0+00			7.5 258.8
0+10			6.8 259.5
0+15			7.9 258.1
0+20			5.6 260.7
0+25			4.7 261.6
0+50			4.4 261.9
0+58 ³ BARRICADE			3.5 262.8
1+00			3.8 262.5
1+50			4.3 262.0
2+00			3.6 262.7
2+50			2.3 264.0
2+80 EDGE A.G. PAVT.			2.4 263.9
SEW M.H. SO. RIM		2.30	
3+00			2.4 263.9
3+50			3.4 262.9
3+59 ²³ W/L FALCON ST.			3.4 262.9
CK. TBM	3.14	263.11	= 263.11

LT

RT

S.W.B.P. MONTECITO & FALCON

3.3 10	5.5 5	X	12.7 10	
4.8 10	5.8 4 BARRICADE	X	10.3 10	
4.7 10	4.7 4 BARRICADE	X	9.3 10	
3.7 10	4.2 5 BARRICADE	X	7.5 10	
3.0 10	3.1 7	3.6 6	X	4.0 10
3.7 10			4.5 10	
3.5 10			3.7 10	
1.7			2.5 10	

SEW M.H. 2+99 10' RT.

EAGLE ST.
(CONT'D)

12-9-55

22

TBM	1.12	264.23	263.11
TP	8.83	271.32	174 262.49
SETTBM	1.59	271.27	1.64 269.68
0+00			3.6 267.7
0+15	WATER MAIN XING		3.0 267.9
0+25			3.4 267.9
	SEW. M.H. E. RIM	{ 3.02 16.67	
0+50			3.5 267.8
1+00			4.5 266.8
1+50			5.5 265.8
2+00			6.5 264.8
2+50			7.6 263.7
3+00			8.6 262.7
	SEW. M.H. E. RIM	{ 8.27 13.90	
3+50			9.4 261.9
3+50 ⁶⁵	EDGE A.C. PAVT.		9.4 261.9
3+65 ⁶⁵	= 0+30 MONTECITO ST.	10.4	260.9
TP	1.55	259.87	12.95 258.32
3+80			6.1 253.8
3+85			6.9 253.0
3+89			6.0 253.9

(OVER)

S.W.B.R. FALCON & MONTECITO WAY

TOP. E.H. SE. COR. LEWIS & EAGLE

SEW. M.H. 0+25 10' LT.
" " "

SEW. M.H. 3+11 10' LT.
" "

LT

BT

9.9
10

9.0
10

9.8
10

7.8

5.4
10

9.7

4.7
10

7.4

EAGLE ST.
(CONT'D)

12-9-55

23

259.87

LT

BT

4400⁶⁵ N/L MONTECITO Way 14.8 345.1

TP 9.85 266.50 3.22 256.65

CK. TBM 3.38 263.12 = 263.11

MORENA BIVD

16" CI Cement Lining Palis

West
Williams
Varonfakis
Kellbater

21

1/11/36

0-17
0-12
0+50
1+00
+50
2+00
+50
3+00
3+45
+50
4+00
+50
5+00
+50
6+00
+37
+50
7+00
+50

OV 10' LT

edge of RR ROW 50' from Tracks
Side AV CV in Cone Chamber 3' RT
edge Cone pave 4' LT
Barricade 2' LT edge AC pave 6' LT
Ø on edge AC pave 4' LT to edge Cone pave
1' RT " " " 3' " " " "
2' " " " " 2' " " " "
Ø on edge AC pave 3' LT " " " "
1' RT to edge AC pave 3' LT " " " "
2' RT to edge AC pave 2' 5' LT to edge Cone pave
1' RT " " " " 3' 4" " " " "
1' RT " " " " 3' 10" " " " "
1' RT " " " " 3' " " " " "
1' RT " " " " 3' " " " " "
1 1/2' RT " " " " 2' 5' LT " " " "
Water Main to St Nashville AV 1' LT
1 1/2' RT edge AC pave 2' 5' LT to edge Cone
1' RT edge " " 2' 5' LT " " " "
1' RT " " " 2' 5' LT " " " "

8+00		1° RT to edge AC pave	2° LT to edge Concrete
9+50		1° LT to " " "	4° LT " " " "
10+00		10° RT " " " "	3° LT " " " "
+50		2° RT " " " "	3° LT " " " "
11+00		15° RT " " " "	3° LT " " " "
+50		2° RT " " " "	3° LT " " " "
12+00		12° RT " " " "	2° LT " " " "
+50		1° RT " " " "	2° LT " " " "
13+00		05° RT " " " "	2° LT " " " "
+50		05° RT " " " "	3° LT " " " "
14+00		10° RT " " " "	3° LT " " " "
+50		05° RT " " " "	3° LT " " " "
15+00		05° RT " " " "	3° LT " " " "
+50		10° RT " " " "	2° LT " " " "
16+00		10° RT " " " "	3° LT " " " "
+50		15° RT " " " "	2° LT " " " "
17+00		15° RT " " " "	12° LT " " " "
+50		4° RT " " " "	
18+00		40° RT edge AC	Service Sta Driveway

18+50		7 th RT to Edge AC Pave	
19+00		5 th RT " " " "	
+50		6 th RT " " " "	
20+00		4 th RT " " " "	
+50		2 nd RT " " " "	1 st LT to edge Concrete Pave
21+00		2 nd RT " " " "	2 nd LT " " " "
+50		3 rd RT " " " "	2 nd LT " " " "
22+00		2 nd RT " " " "	1 st LT " " " "
+50		4 th RT " " " "	2 nd LT " " " "
23+00		2 nd RT " " " "	3 rd LT " " " "
+50		1 st RT " " " "	2 nd LT " " " "
24+00		1 st RT " " " "	
+50		2 nd RT " " " "	
25+00		2 nd RT " " " "	1 st LT " " " "
+50		2 nd RT " " " "	
26+00		1 st RT " " " "	2 nd LT " " " "
+50		2 nd RT " " " "	2 nd LT " " " "
27+00		2 nd RT " " " "	3 rd LT " " " "
+50		2 nd RT " " " "	2 nd LT " " " "

28+00

+50

29+00

+50

30+00

+50

31+00

+50

32+00

+50

33+00

+50

34+00

+50

35+00

+50

36+00

+50

37+00

6° RT edge Ac pave

4° RT " " "

4° RT edge " " "

4° RT " " "

4° RT " " "

2° RT " " "

3° RT " " "

2° RT " " "

4° RT " " "

In Service Sta Ac Driveway

" " " " "

6° RT edge Ac pave

6° RT edge Ac pave

4° RT " " "

2° RT " " "

1° RT " " "

1.5° RT " " "

1° RT " " "

3° RT " " "

4° RT edge Conc pave

2° LT " " "

2° LT " " "

4° LT " " "

2° LT " " "

2° LT " " "

1° LT " " "

1° LT " " "

2° LT " " "

2° LT " " "

" " " " "

2° LT edge Conc pave

2° LT " " "

2° LT " " "

1.5° LT " " "

2° LT " " "

1.5° LT " " "

37+50

4° RT to edge AD pave 1° LT to edge Cone Pave

38+00

4° RT " " " " 1° LT " " " "

+50

6° RT " " " " 0.5° LT " " " "

39+00

6° RT " " " "

+50

7° RT " " " "

40+00

10° RT " " " "

+50

13° RT " " " "

41+00

17° RT " " " "

+25

Begin Center island 4° LT

+50

18° RT to edge AD pave 2° LT to Cone Cb on Center Island

42+00

18° RT " " " " 2° LT " " " " "

+50

18° RT " " " " 11° LT " " " " "

43+00

18° RT " " " " 17° LT " " " " "

+50

18° RT " " " " 17° LT " " " " "

44+00

18° RT " " " " 17° LT " " " " "

+50

18° RT " " " " 17° LT " " " " "

45+00

23° RT " " " " 16° LT and Cone Cb ^{island} cont

+50

30° RT " " " "

46+00

33° RT " " " "

Morena Blvd cont

46+22			1st end 4° RT Begin Cone Ob on Center
46+50		25° RT edge AC Pave	4° LT Cone Ob on Center Island
47+00		18° RT " " "	30° LT " " " " "
+50		21° RT " " "	0° LT " " " " "
+59		Xing Cone Ob on Island	
48+00		3° RT to Cone Ob Center Island	17½° LT to Cone Ob on Center Island
+50		9° RT " " " " "	17° LT " " " " "
49+00		18° RT " " " " "	16° LT " " " " "
+50		25° RT " " " " "	15° LT " " " " "
50+00		39° RT " " " " "	8° LT " " " " "
+75			

MORENA BLYD. 16" C. I. RELINE

± PROFILE

Reduced by
AL MATHISON
1-13-55

B.M.	1.45	11.49		10.04
T.P.	2.16	8.03	5.62	5.87
0+17			6.6	1.4
0+00			5.0	3.0
0+23			4.49	3.5
0+39			3.49	4.5
0+50			2.9	5.1
1+00	5.06	10.01	3.08	4.95
T.P.	6.99	13.29	3.71	6.30
CHECK				
B.M.			3.25	10.04 = 10.04

WEST
WILLIAMS
VARON FAKIS †
KELLHOFER X

30

1/11/56 Cloudy

B.P. TECOLOTE CRK. CULVERT. (TOP INLET)

±

	5.1	6.6
	10' LT	10' RT
	3.9	5.0
	10' LT	10' RT
EDGE A.C. →	2.91	9.1
CON. OVERFLOW APRON	6' LT	1' RT 10' DRAIN
		6.9
CON. OVERFLOW APRON		
	3.1	4.7
	4' LT	10' RT
		2.8
EDGE A.C.		3' RT 10' RT
		3.8

IMPERIAL AVE.
PLYMOUTH ST. TO EAST
6 PROFILE PROPOSED PIPELINE

2-7-56
SHREY
MARTELL
SMITH

31

3+50 END OF PRELIMINARY



NOTE: FILE MAP 1548
T.P. SHEET 3437

NOTE: SEE PAGES 1 TO 3

0+00 = W/P PLYMOUTH ST.

0+92 4" G.V. 36" LT. 6
4" METED 5' x 8'
VAULT - 435 LT.

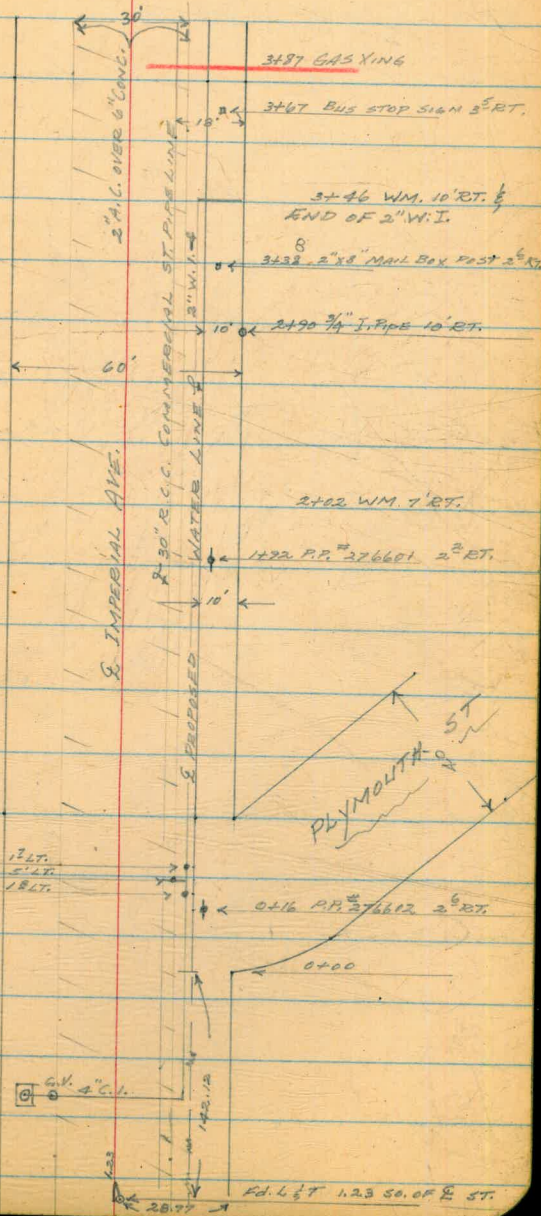

PLYMOUTH ST

FD. 6 1/2' 1.23 SO. OF E ST.

IMPERIAL AVE.
(CONT'D)

Redc'd
by
Rocky.

LT

RT

32

TBM	2.85	112.28	109.43
0+00		3.6	108.7
0+50		5.7	106.6
1+00		8.5	103.8
1+50		2.9	102.4
2+00		12.3	100.0
TP	2.07	102.27	12.08 100.20
2+50		4.1	98.2
3+00		5.8	96.5
3+50		8.4	93.9
TP	10.61	111.38	1.50 100.77
CK, TBM		1.94	109.44 = 109.43

NAIL IN B.P. 276602. 0+16 2⁵ RT. (SEE Pg. 2)

108.6	108.5	108.7	109.3	109.3
3.7	3.8	3.0	3.0	3.0
5 Edge A.C.	0.4	1.4	1.4	1.4
106.7	106.5	106.6	106.9	106.9
5.6	5.8	5.4	5.4	5.4
2 Edge A.C.	0.5	1.1	1.1	1.1
104.3	103.8	105.0	105.0	105.0
8.0	7.3	7.3	7.3	7.3
4 Edge A.C.	2	2	2	2
102.0	101.8	102.4	102.9	102.6
10.3	10.5	9.4	9.4	9.7
3 Edge A.C.	1	1.5	1.5	1.5
99.9	100.0	100.6	100.9	100.9
12.4	11.7	11.4	11.4	11.4
3.5 Edge A.C.	1	1	1	1
98.1	98.2	99.1	99.4	99.4
4.2	3.2	3.2	2.9	2.9
4 Edge A.C.	2	2	5	5
96.3	96.5	96.6	96.6	96.6
6.0	5.7	5.7	5.7	5.7
4 Edge A.C.	5	5	5	5
93.3	93.5	93.9	94.7	95.3
9.0	8.8	7.6	7.6	7.0
5 Edge A.C.	1	2	2	5

DEL CERRO
PUMP PLANT
MISC. ELEV'S

5/2/56

34

TP	0.45	456.61		456.16
TP	4.14	449.29	11.46	445.15
38+86 ⁵²		TOP CB.	4.31	444.98
38+91 ²⁷		TOP SIDEWALK	4.21	445.08
38+95 ²⁴		" "	4.12	445.17
39+18 ⁴⁵		S.W. COR. METER SLAB	9.95	439.34
		N.W. " "	9.98	439.31
		N.E. " "	9.99	439.30
39+16 ⁴⁵		S.E. COR. " "	10.00	439.29
39+09 ¹⁵		15 1/2" I.D. # 16" REDUCER	9.25	440.04
39+28 ⁴⁵		# 18" PIPE I.D.	2.13	440.16
		S.E. COR. CONC. SLAB	4.03	445.26
		S.W. COR. " "	4.04	445.25
		N.E. COR. " "	4.01	445.28
		N.W. COR. " "	4.03	445.26
TP	11.28	456.67	3.90	445.39
CK. TP			0.50	456.17 = 456.16

TP ON ROCK - F.B. 900 Pg. 27

39+18⁴⁵ - 35⁵ RT.

39+06⁴⁵ - 32⁵ RT.

16" REDUCER (27' Wly of Ely edge Met Cham. Slab)

18" I.D. PIPE 10' Wly of Wly edge of Met. Chamb.

FLOOR ELEV. PUMP HOUSE 39+30¹ - 23⁵ RT.

" " " " 39+68¹ - 21⁵ RT.

" " " "

" " " "

(Record Fin. Floor 445.5)

DEL CERRO RESERVOIR ROOF PANEL ELEVATIONS

(See pg. 38 for finished
roof panel elevations)

JUNE 15 1956
Beatty
Kemp

35

Approx - Temp - 70°

BM	13.30	652.73	639.43	Spike 50 RP 5E Cor (City Datum)	M 13	657.93	(N) 5.30	5.325	5.295	.07
TP	6.02	657.93	0.82	651.91	Auer Deflect					
N 11		(M) 5.11	5.12	5.295	.06	5 7	5.50	5.665	5.975	.0725
N 19		5.13	5.15	5.30	.065	5 16	5.48	5.725	6.08	.055
N 22		5.16	5.15	5.31	.085	5 22	5.47	5.59	5.870	.08
N 23		5.16	5.16	5.31	.075	5 24	5.47	5.585	5.815	.0575
N 25		5.15	5.14	5.32	.095	5 39	5.48	5.74	6.155	.1275
N 29		5.125	5.12	5.28	.0825	5 43	5.43	5.66	6.00	.1125
N 33		5.12	5.12	5.28	.08	5 45	5.465	5.63	5.935	.07
N 35		5.115	5.135	5.285	.065	5 48	5.46	5.585	5.84	.065
N 37		5.12	5.16	5.315	.0525	5 50	5.465	5.56	5.74	.0425
N 40		5.095	5.11	5.275	.075	TP	0.13	645.22	12.84	645.09
						TP	0.01	632.95	12.28	632.94
M 40		5.29	5.28	5.46	.095	CK BM	12.02	620.93	= 620.93	
M 37		5.32	5.32	5.47	.075	50' RP SW Cor.				
M 32		5.28	5.31	5.485	.0725					
M 30		5.27	5.285	5.49	.095					
M 25		5.325	5.335	5.51	.0825					
M 15		5.31	5.31	5.44	.125					

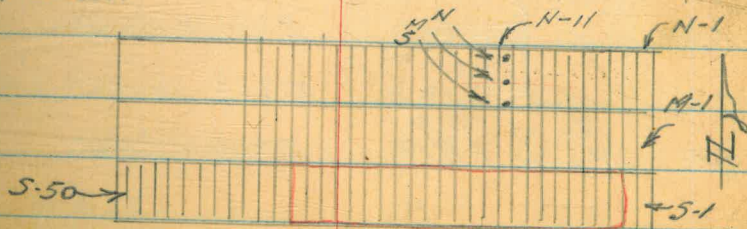

Note: These panels are only layed on, are
not tied together at joints yet.

DEL CERRO RESERVOIR.
ELEVATIONS Top of WALLS.
(To determine settlement after
filling. Reservoir now empty.)

JULY 25 1956

BETTY N.
SHOREY, X
SMITH, ♀

36

Station	+ BC	H.I.	- FS	Elev.	
BM	12.68	652.11		639.43	SPIKE SEC PG 35
set TBM	6.85	654.80	4.16	647.95	on rock near NE Cor
set TBM	4.017	654.687	4.13	650.67	on rock Nly of E RES
0+00	NELY Cor of RES		1.733	652.954	
0+25			1.821	652.866	
0+50			1.856	652.831	
0+75			1.885	652.802	
1+00	<u>NLY WALL</u>		1.889	652.798	
1+25	(Shots taken on edge of roof and painted RED.)		1.858	652.829	
1+50			1.849	652.838	
1+75			1.833	652.854	
2+00	NWly Cor of RES		1.664	653.023	
0+00	"	"	1.464	653.023	
0+25	<u>Wly Wall</u>		1.882	652.805	
0+50			2.033	652.654	
0+75			2.224	652.463	
1+00	Top of Curb SWly Cor of RES.		2.225	652.462	

RED: W.H.B

Station	+ FS	H.I.	- FS	Elev.
0+00		654.687		= SWly Cor RES.
0+01			2.460	652.227
0+25			2.701	651.986
0+50	(& drain Inlet)		2.888	651.799
0+75			2.680	652.007
1+00	<u>Sly Wall</u>		2.459	652.228
1+25			2.688	651.999
1+50	(& drain Inlet)		2.909	651.778
1+75			2.688	651.999
2+00	SEly Cor RES		2.407	652.280
0+00	SEly Cor RES (Top of Curb)		2.090	652.597
0+25			2.172	652.515
0+50	<u>Ely Wall</u>		2.029	652.658
0+75			1.904	652.783
1+00	NELY Cor RES.		1.732	652.955
CK TBM			4.017	650.67
IP	0.56	645.67	9.58	645.11
IP	0.65	633.91	12.41	633.26
CK BM. (30' RP SW Cor.)			12.96	620.95 = 620.93 See pg 35

DEL CERRO RESERVOIR
Elev. & Top of WALLS

AUG 8 1956

BRATTY
SMITH

37

Gauge at 9.2 ft. of Water
(See pg 36 for Originals)

TEMP. 89° (Air)
TEMP. 93° (Concrete)
654.730

TBM	6.78	654.73	647.95		1+00		2.494	652.236	+008		
CK TBM.	4.060	654.730	4.060	650.670	5c pg 36	1+25		2.722	652.008	+009	
0+00	NEWLY COR. RES.		1.772	652.958	+002	1+50	E Drain Sly Wall		2.941	651.789	+009
0+25			1.860	652.870	+006	1+75		2.722	652.008	+009	
0+50			1.893	652.827	+006	2+00		2.438	652.292	+012	
0+75			1.923	652.807	+005	0+00	SE COR. RES. Top curb (rounded off in finishing) paint gone.				
1+00	Sly Wall See sketch pg. 36		1.926	652.804	+006	0+25		2.197	652.533	+018	
1+25			1.892	652.838	+009	0+50	Ely Wall		2.055	652.675	+017
1+50			1.885	652.845	+007	0+75		1.941	652.789	+006	
1+75			1.868	652.862	+008	1+00	NEWLY COR. RES.		1.771	652.959	+002
2+00	NEWLY COR		1.702	653.028	+005	CK TBM		4.060	650.67		
0+00											
0+25			1.915	652.815	+010						
0+50	Wly Wall		2.070	652.660	+006						
0+75			2.262	652.468	+005						
1+00	Top of curb Slyly Cor. RES		2.263	652.467	+005						
0+01			2.498	652.232	+005						
0+25	Sly Wall		2.738	651.992	+006						
0+50	E Drain		2.925	651.805	+006						
0+75			2.716	652.014	+007						

DEL CERRO RESERVOIR
ROOF PANEL ELEVATIONS

Roof completed.
Air Temp. 89° Conc roof Temp. 93°
Gauge 9.2 ft.

TBM. 4.060 654.730 650.670 pg. 36

N-11 (N) 1.871 ^(M) 1.930 2.077(S)

N-19 1.908 1.938 2.075

N-22 1.933 1.960 2.104

N-23 1.936 1.941 2.095

N-25 1.924 1.924 2.105

N-29 1.890 1.912 2.068

N-33 1.903 1.912 2.059

N-35 1.890 1.914 2.074

N-37 1.893 1.958 2.093

N-40 1.861 1.896 2.061

M-10 (N) 2.077 ^(M) 2.070 2.248(S)

M-37 2.104 2.092 2.248

M-32 2.052 2.078 2.250

M-30 2.050 2.064 2.268

M-25 2.110 2.114 2.286

M-15 2.098 2.098 2.240

M-13 2.085 2.114 2.258

Aug. 8, 1956
BEATTY
SMITH

36

654.730 ^(M)

S-7 (N) 2.284 2.455 2.733(S)

S-16 2.276 2.504 2.843

S-22 2.260 2.382 2.622

S-24 2.264 2.373 2.574

S-39 2.262 2.510 2.908

S-43 2.231 2.432 2.756

S-45 2.246 2.397 2.672

S-48 2.246 2.346 2.592

S-50 2.25 2.333 2.513

CK TBM 6.056 650.674

CK TBM 6.78 647.95

DEL CERRO RESERVOIR
ELEVS. TOP OF WALL

GAUGE AT 8' FT.

8/13/56
SHOREY
KEMP
SMITH

39

TBM	3.765	654.435	650.670
0+00 NELY. COR. RES.	1.476	652.959	+0.001
0+25	1.564	652.871	+0.001
0+50	1.601	652.834	-0.003
0+75	1.640	652.795	-0.012
1+00	1.649	652.786	-0.012
1+25	1.665	652.820	-0.013
1+50	1.610	652.825	-0.013
1+75	1.595	652.840	-0.022
2+00 NWLY. COR.	1.427	653.008	-0.020
0+00			
0+25	1.641	652.794	-0.021
0+50 WLY. WALL	1.790	652.645	-0.015
0+75	1.977	652.458	-0.010
1+00	1.977	652.458	-0.008
0+01 } SWLY. COR. RES.	2.209	652.226	-0.006
0+25	2.450	651.985	-0.007
0+50	2.635	651.800	-0.005
0+75	2.422	652.006	-0.002
1+00	2.208	652.227	-0.009
1+25	2.435	652.000	-0.008

SEE Pg. 36

TEMP. 82° (AIR)
TEMP. 94° (CONC.)
654.435

1+50 E DRAIN	2.659	651.776	-0.013
1+75	2.427	652.008	+0.000
2+00	2.143	652.292	+0.000
0+00			
0+25	1.914	652.521	-0.012
0+50	1.775	652.660	-0.015
0+75	1.645	652.790	+0.001
1+00 NELY. COR. RES.	1.474	652.961	+0.003
CK TBM	3.769	650.666	= 650.670

Please Return to
 City of San Diego Water Dept
 Room 903 Civic Center

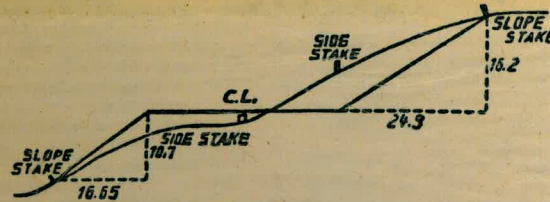

DISTANCES FROM SIDE STAKES FOR CROSS-SECTIONING.
 SLOPE 1 1/2 TO 1. ROADWAY OF ANY WIDTH.

	0	.1	.2	.3	.4	.5	.6	.7	.8	.9	
0	0.00	0.15	0.30	0.45	0.60	0.75	0.90	1.05	1.20	1.35	0
1	1.50	1.65	1.80	1.95	2.10	2.25	2.40	2.55	2.70	2.85	1
2	3.00	3.15	3.30	3.45	3.60	3.75	3.90	4.05	4.20	4.35	2
3	4.50	4.65	4.80	4.95	5.10	5.25	5.40	5.55	5.70	5.85	3
4	6.00	6.15	6.30	6.45	6.60	6.75	6.90	7.05	7.20	7.35	4
5	7.50	7.65	7.80	7.95	8.10	8.25	8.40	8.55	8.70	8.85	5
6	9.00	9.15	9.30	9.45	9.60	9.75	9.90	10.05	10.20	10.35	6
7	10.50	10.65	10.80	10.95	11.10	11.25	11.40	11.55	11.70	11.85	7
8	12.00	12.15	12.30	12.45	12.60	12.75	12.90	13.05	13.20	13.35	8
9	13.50	13.65	13.80	13.95	14.10	14.25	14.40	14.55	14.70	14.85	9
10	15.00	15.15	15.30	15.45	15.60	15.75	15.90	16.05	16.20	16.35	10
11	16.50	16.65	16.80	16.95	17.10	17.25	17.40	17.55	17.70	17.85	11
12	18.00	18.15	18.30	18.45	18.60	18.75	18.90	19.05	19.20	19.35	12
13	19.50	19.65	19.80	19.95	20.10	20.25	20.40	20.55	20.70	20.85	13
14	21.00	21.15	21.30	21.45	21.60	21.75	21.90	22.05	22.20	22.35	14
15	22.50	22.65	22.80	22.95	23.10	23.25	23.40	23.55	23.70	23.85	15
16	24.00	24.15	24.30	24.45	24.60	24.75	24.90	25.05	25.20	25.35	16
17	25.50	25.65	25.80	25.95	26.10	26.25	26.40	26.55	26.70	26.85	17
18	27.00	27.15	27.30	27.45	27.60	27.75	27.90	28.05	28.20	28.35	18
19	28.50	28.65	28.80	28.95	29.10	29.25	29.40	29.55	29.70	29.85	19
20	30.00	30.15	30.30	30.45	30.60	30.75	30.90	31.05	31.20	31.35	20
21	31.50	31.65	31.80	31.95	32.10	32.25	32.40	32.55	32.70	32.85	21
22	33.00	33.15	33.30	33.45	33.60	33.75	33.90	34.05	34.20	34.35	22
23	34.50	34.65	34.80	34.95	35.10	35.25	35.40	35.55	35.70	35.85	23
24	36.00	36.15	36.30	36.45	36.60	36.75	36.90	37.05	37.20	37.35	24
25	37.50	37.65	37.80	37.95	38.10	38.25	38.40	38.55	38.70	38.85	25
26	39.00	39.15	39.30	39.45	39.60	39.75	39.90	40.05	40.20	40.35	26
27	40.50	40.65	40.80	40.95	41.10	41.25	41.40	41.55	41.70	41.85	27
28	42.00	42.15	42.30	42.45	42.60	42.75	42.90	43.05	43.20	43.35	28
29	43.50	43.65	43.80	43.95	44.10	44.25	44.40	44.55	44.70	44.85	29
30	45.00	45.15	45.30	45.45	45.60	45.75	45.90	46.05	46.20	46.35	30
31	46.50	46.65	46.80	46.95	47.10	47.25	47.40	47.55	47.70	47.85	31
32	48.00	48.15	48.30	48.45	48.60	48.75	48.90	49.05	49.20	49.35	32
33	49.50	49.65	49.80	49.95	50.10	50.25	50.40	50.55	50.70	50.85	33
34	51.00	51.15	51.30	51.45	51.60	51.75	51.90	52.05	52.20	52.35	34
35	52.50	52.65	52.80	52.95	53.10	53.25	53.40	53.55	53.70	53.85	35
36	54.00	54.15	54.30	54.45	54.60	54.75	54.90	55.05	55.20	55.35	36
37	55.50	55.65	55.80	55.95	56.10	56.25	56.40	56.55	56.70	56.85	37
38	57.00	57.15	57.30	57.45	57.60	57.75	57.90	58.05	58.20	58.35	38
39	58.50	58.65	58.80	58.95	59.10	59.25	59.40	59.55	59.70	59.85	39
40	60.00	60.15	60.30	60.45	60.60	60.75	60.90	61.05	61.20	61.35	40
41	61.50	61.65	61.80	61.95	62.10	62.25	62.40	62.55	62.70	62.85	41
42	63.00	63.15	63.30	63.45	63.60	63.75	63.90	64.05	64.20	64.35	42
43	64.50	64.65	64.80	64.95	65.10	65.25	65.40	65.55	65.70	65.85	43
44	66.00	66.15	66.30	66.45	66.60	66.75	66.90	67.05	67.20	67.35	44
45	67.50	67.65	67.80	67.95	68.10	68.25	68.40	68.55	68.70	68.85	45
46	69.00	69.15	69.30	69.45	69.60	69.75	69.90	70.05	70.20	70.35	46
47	70.50	70.65	70.80	70.95	71.10	71.25	71.40	71.55	71.70	71.85	47
48	72.00	72.15	72.30	72.45	72.60	72.75	72.90	73.05	73.20	73.35	48
49	73.50	73.65	73.80	73.95	74.10	74.25	74.40	74.55	74.70	74.85	49
50	75.00	75.15	75.30	75.45	75.60	75.75	75.90	76.05	76.20	76.35	50

THE NATIONAL BLANK BOOK COMPANY
 HOLYOKE MASSACHUSETTS
 NEW YORK CHICAGO BOSTON SAN FRANCISCO