

W 928

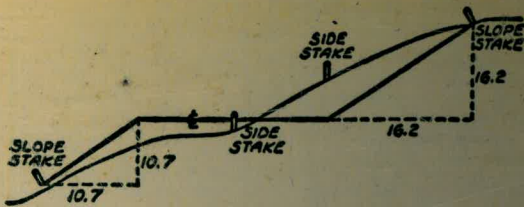

DISTANCES FROM SIDE STAKES FOR CROSS-SECTIONING
SLOPE 1 TO 1. ROADWAY OF ANY WIDTH

	0	.1	.2	.3	.4	.5	.6	.7	.8	.9	0
0	0.00	0.10	0.20	0.30	0.40	0.50	0.60	0.70	0.80	0.90	0
1	1.00	1.10	1.20	1.30	1.40	1.50	1.60	1.70	1.80	1.90	1
2	2.00	2.10	2.20	2.30	2.40	2.50	2.60	2.70	2.80	2.90	2
3	3.00	3.10	3.20	3.30	3.40	3.50	3.60	3.70	3.80	3.90	3
4	4.00	4.10	4.20	4.30	4.40	4.50	4.60	4.70	4.80	4.90	4
5	5.00	5.10	5.20	5.30	5.40	5.50	5.60	5.70	5.80	5.90	5
6	6.00	6.10	6.20	6.30	6.40	6.50	6.60	6.70	6.80	6.90	6
7	7.00	7.10	7.20	7.30	7.40	7.50	7.60	7.70	7.80	7.90	7
8	8.00	8.10	8.20	8.30	8.40	8.50	8.60	8.70	8.80	8.90	8
9	9.00	9.10	9.20	9.30	9.40	9.50	9.60	9.70	9.80	9.90	9
10	10.00	10.10	10.20	10.30	10.40	10.50	10.60	10.70	10.80	10.90	10
11	11.00	11.10	11.20	11.30	11.40	11.50	11.60	11.70	11.80	11.90	11
12	12.00	12.10	12.20	12.30	12.40	12.50	12.60	12.70	12.80	12.90	12
13	13.00	13.10	13.20	13.30	13.40	13.50	13.60	13.70	13.80	13.90	13
14	14.00	14.10	14.20	14.30	14.40	14.50	14.60	14.70	14.80	14.90	14
15	15.00	15.10	15.20	15.30	15.40	15.50	15.60	15.70	15.80	15.90	15
16	16.00	16.10	16.20	16.30	16.40	16.50	16.60	16.70	16.80	16.90	16
17	17.00	17.10	17.20	17.30	17.40	17.50	17.60	17.70	17.80	17.90	17
18	18.00	18.10	18.20	18.30	18.40	18.50	18.60	18.70	18.80	18.90	18
19	19.00	19.10	19.20	19.30	19.40	19.50	19.60	19.70	19.80	19.90	19
20	20.00	20.10	20.20	20.30	20.40	20.50	20.60	20.70	20.80	20.90	20
21	21.00	21.10	21.20	21.30	21.40	21.50	21.60	21.70	21.80	21.90	21
22	22.00	22.10	22.20	22.30	22.40	22.50	22.60	22.70	22.80	22.90	22
23	23.00	23.10	23.20	23.30	23.40	23.50	23.60	23.70	23.80	23.90	23
24	24.00	24.10	24.20	24.30	24.40	24.50	24.60	24.70	24.80	24.90	24
25	25.00	25.10	25.20	25.30	25.40	25.50	25.60	25.70	25.80	25.90	25
26	26.00	26.10	26.20	26.30	26.40	26.50	26.60	26.70	26.80	26.90	26
27	27.00	27.10	27.20	27.30	27.40	27.50	27.60	27.70	27.80	27.90	27
28	28.00	28.10	28.20	28.30	28.40	28.50	28.60	28.70	28.80	28.90	28
29	29.00	29.10	29.20	29.30	29.40	29.50	29.60	29.70	29.80	29.90	29
30	30.00	30.10	30.20	30.30	30.40	30.50	30.60	30.70	30.80	30.90	30
31	31.00	31.10	31.20	31.30	31.40	31.50	31.60	31.70	31.80	31.90	31
32	32.00	32.10	32.20	32.30	32.40	32.50	32.60	32.70	32.80	32.90	32
33	33.00	33.10	33.20	33.30	33.40	33.50	33.60	33.70	33.80	33.90	33
34	34.00	34.10	34.20	34.30	34.40	34.50	34.60	34.70	34.80	34.90	34
35	35.00	35.10	35.20	35.30	35.40	35.50	35.60	35.70	35.80	35.90	35
36	36.00	36.10	36.20	36.30	36.40	36.50	36.60	36.70	36.80	36.90	36
37	37.00	37.10	37.20	37.30	37.40	37.50	37.60	37.70	37.80	37.90	37
38	38.00	38.10	38.20	38.30	38.40	38.50	38.60	38.70	38.80	38.90	38
39	39.00	39.10	39.20	39.30	39.40	39.50	39.60	39.70	39.80	39.90	39
40	40.00	40.10	40.20	40.30	40.40	40.50	40.60	40.70	40.80	40.90	40
41	41.00	41.10	41.20	41.30	41.40	41.50	41.60	41.70	41.80	41.90	41
42	42.00	42.10	42.20	42.30	42.40	42.50	42.60	42.70	42.80	42.90	42
43	43.00	43.10	43.20	43.30	43.40	43.50	43.60	43.70	43.80	43.90	43
44	44.00	44.10	44.20	44.30	44.40	44.50	44.60	44.70	44.80	44.90	44
45	45.00	45.10	45.20	45.30	45.40	45.50	45.60	45.70	45.80	45.90	45
46	46.00	46.10	46.20	46.30	46.40	46.50	46.60	46.70	46.80	46.90	46
47	47.00	47.10	47.20	47.30	47.40	47.50	47.60	47.70	47.80	47.90	47
48	48.00	48.10	48.20	48.30	48.40	48.50	48.60	48.70	48.80	48.90	48
49	49.00	49.10	49.20	49.30	49.40	49.50	49.60	49.70	49.80	49.90	49
50	50.00	50.10	50.20	50.30	50.40	50.50	50.60	50.70	50.80	50.90	50

Distance of slope stake from side or shoulder stake for any width roadway, slope 1 to 1. If ground is nearly level, the cut or fill at side stake is located by the double entry method in left column and top row. The number in body of table in same row and column gives distance from side stake to slope stake. If ground is not level estimate the difference in elevation between the side stake and slope stake, lower target by this amount if cut, elevate if fill. Add this amount to cut or fill and find distance in table. Set up rod at this point, and line of sight should cut target. If it does not make the slight adjustment necessary.

TABLE XIII—CORRECTIONS FOR TANGENTS AND EXTERNALS

These corrections are to be added to the approximate values, found by dividing the tangent, or external, for a 1° curve (Table VIII) by the degree of curve, in order to obtain the true tangents, or externals. Intermediate values may be obtained by interpolation.

FOR TANGENTS ADD

Central Angle	DEGREE OF CURVE													
	5°	10°	15°	20°	25°	30°	35°	40°	45°	50°	55°	60°	65°	70°
10°	.03	.06	.09	.13	.16	.19	.22	.25	.28	.31	.34	.38	.42	.46
15°	04	10	14	19	24	29	34	39	45	51	53	58	63	68
20°	06	13	19	26	32	39	45	51	58	65	72	79	84	90
25°	08	16	24	33	40	49	58	67	75	83	90	99	1.06	1.14
30°	10	19	29	39	49	59	69	79	89	99	1.09	1.20	1.29	1.39
35°	11	22	34	47	58	69	79	89	99	1.09	1.20	1.31	1.41	1.51
40°	13	26	40	53	67	80	93	1.06	1.20	1.34	1.49	1.64	1.79	1.94
45°	15	30	44	60	76	91	1.06	1.21	1.37	1.52	1.70	1.87	2.04	2.21
50°	17	34	51	68	85	1.02	1.19	1.36	1.54	1.72	1.91	2.10	2.29	2.48
55°	19	38	57	76	95	1.14	1.32	1.52	1.72	1.92	2.14	2.35	2.56	2.77
60°	21	42	63	84	1.05	1.27	1.49	1.71	1.94	2.17	2.38	2.60	2.83	3.07
65°	23	46	69	93	1.16	1.40	1.64	1.88	2.13	2.38	2.63	2.88	3.13	3.39
70°	25	51	76	1.02	1.28	1.54	1.80	2.06	2.33	2.60	2.88	3.16	3.44	3.72
75°	27	56	83	1.12	1.40	1.69	1.98	2.27	2.57	2.87	3.16	3.47	3.78	4.09
80°	30	61	91	1.22	1.53	1.84	2.15	2.46	2.78	3.10	3.44	3.78	4.12	4.46
85°	33	66	1.00	1.33	1.68	2.02	2.36	2.70	3.05	3.40	3.77	4.14	4.55	4.89
90°	36	72	1.09	1.45	1.83	2.20	2.57	2.94	3.32	3.70	4.10	4.50	4.91	5.32
95°	39	79	1.19	1.55	2.00	2.40	2.80	3.20	3.61	4.02	4.40	4.98	5.38	5.83
100°	43	86	1.30	1.74	2.18	2.62	3.06	3.50	3.95	4.40	4.88	5.37	5.85	6.34
110°	51	1.03	1.56	2.08	2.61	3.14	3.67	4.21	4.76	5.31	5.86	6.43	7.01	7.60
120°	62	1.25	1.93	2.52	3.16	3.81	4.45	5.11	5.77	6.44	7.12	7.80	8.50	9.22

FOR EXTERNALS ADD

Central Angle	DEGREE OF CURVE													
	5°	10°	15°	20°	25°	30°	35°	40°	45°	50°	55°	60°	65°	70°
10°	.001	.003	.004	.006	.007	.008	.009	.011	.012	.014	.015	.017	.018	.020
15°	.003	.007	.010	.014	.018	.023	.027	.032	.037	.043	.049	.054	.060	.067
20°	.006	.011	.017	.022	.028	.034	.038	.045	.051	.057	.063	.070	.076	.083
25°	.009	.018	.027	.036	.046	.056	.065	.074	.083	.093	.106	1.20	1.27	1.35
30°	.013	.025	.038	.051	.065	.078	.090	.103	.116	.129	.149	.170	.179	.188
35°	.018	.035	.054	.072	.086	.109	.131	.153	.175	.197	.213	.230	.247	.264
40°	.023	.046	.070	.093	.117	.141	.172	.203	.234	.265	.277	.290	.315	.341
45°	.030	.060	.093	.119	.153	.184	.216	.254	.289	.325	.351	.378	.411	.445
50°	.037	.075	.116	.151	.189	.227	.266	.305	.345	.384	.425	.467	.508	.550
55°	.046	.093	.142	.188	.236	.283	.332	.381	.420	.479	.530	.582	.641	.700
60°	.056	.112	.168	.225	.283	.340	.398	.457	.516	.575	.636	.697	.774	.851
65°	.067	.135	.204	.273	.343	.412	.483	.554	.625	.697	.771	.845	.922	1.01
70°	.080	.159	.240	.321	.403	.485	.568	.652	.735	.819	.906	.994	1.08	1.17
75°	.095	.182	.286	.383	.480	.578	.678	.777	.877	.977	1.07	1.18	1.29	1.39
80°	.110	.220	.332	.445	.558	.671	.787	.903	1.02	1.13	1.25	1.38	1.50	1.62
85°	.128	.259	.391	.524	.657	.790	.926	1.06	1.20	1.34	1.47	1.62	1.76	1.91
90°	.149	.299	.450	.603	.756	.910	1.07	1.22	1.38	1.54	1.70	1.87	2.03	2.20
95°	.174	.350	.522	.706	.985	1.06	1.25	1.43	1.62	1.80	1.99	2.18	2.38	2.58
100°	.200	.401	.604	.809	1.01	1.22	1.43	1.64	1.85	2.06	2.28	2.50	2.73	2.96
110°	.268	.536	.806	1.08	1.35	1.63	1.91	2.20	2.48	2.76	3.05	3.35	3.66	3.96
120°	.360	.721	1.08	1.45	1.82	2.19	2.57	2.95	3.33	3.72	4.11	4.50	4.91	5.32

INDEX

28th ST, LOGAN TO IRVING AVE, 2 PROFILE - PRELIM. 1-2 ✓
 ALABAMA ST., MONROE TO ADAMS @ STK'S & GED ✓
 UNIVERSITY AVE., CARTAGENA TO 2800 EAST 12" R.A.C. 6-10 ✓
 OZARK ST. SQ., IMPERIAL TO OCEANVIEW 6" A.C. MAIN 11-13 ✓
 SAN GABRIEL PL. TO @ STK'S & GED. ✓
 BAYSIDE LANE - ALLEY NOR. COENADO CT. 6" A.C. MAIN 14 ✓
 MISSISSIPPI TO ✓
 ADAMS AVE., ALABAMA ST. - @ STK'S & GED 6" A.C. MAIN 15 ✓
 HULLY PLACE, OZARK ST. TO 285' E. 6" A.C. MAIN 16 ✓
 WATER METERS & F.H. GROVELAND ST. EUCLID TO 53' ED 17-18 ✓
 GRADES FOR LOWERING MAIN ON GROVELAND ST. 19 ✓
 ASH ST., 21ST TO FERN ST. - @ STK'S & GED. 8" A.C. MAIN 20-21 ✓
 ELEV FOR GATE VALVES QUINCE & NILE 22 ✓
 N.B. COLLIER ✓
 ELEV. ON EAST 18" A.C. MAIN - ALLEY BLK. 17 - E. OF 34TH 23 ✓
 41ST - LOGAN AVE. TO "T" ST. @ STK'S & GED. 24-25 ✓
 BOUNDARY ST., ADAMS TO SUNCREST ST. @ STK'S & GED. 26-27 ✓
 SUNCREST DR., BOUNDARY TO ADAMS - @ STK'S & GED. 28-29 ✓
 WALTON PLACE, ALLEY BLK. 60 TO OHIO 6" A.C. MAIN 30 ✓
 MEADE AVE., 36TH TO 35TH @ GED. 6" A.C. MAIN 31-32 ✓
 DELTA ST., 45TH TO 46TH @ STK'S & GED. 12" A.C. MAIN 33-34 ✓
 LINWOOD ST., WITHERBY SLY. 450' 4" A.C. MAIN @ STK'S & GED. 35 ✓
 ELEV. TOP 6" A.C. MAIN CASTANA & EUCLID 36 ✓
 aliso

INDEX

- OHIO ST, MADISON To ADAMS AVE. @ STK'S & GRD. ✓
6" A.C. MAIN 37-38
- MARIPOSA ST, MARIPOSA PL. To 460 N. 6" A.C. MAIN 39 ✓
@ STK'S & GRD.
- MARIPOSA PL., MARIPOSA ST. To 545 E. 6" A.C. MAIN 40 ✓
@ STK'S & GRD.
- FRANKFORT ST, MORENA BLVD. ELY. { ELEV. ON TOP ✓
WATER MAIN 41
- ALLEY E. OF 34th & N. OF ARTHUR. { ELEV. ON TOP ✓
WATER MAIN 42
- 32ND ST, BEECH To CEDAR. @ STK'S & GRD. 8" A.C. MAIN 43 ✓
- "C" ST., 34th To WABASH FREEWAY @ STK'S & GRD. ✓
6" A.C. MAIN 44-45
- SEA BREEZE, POTOMAC To ALLEGHANY @ STK'S & GRD. ✓
8" MAIN 46
- EUREKA ST., LAURETTA To RUBY @ STK'S & GRD. ✓
6" A.C. MAIN 47
- RUBY ST., GOSHEN To EUREKA @ STK'S & GRD. ✓
6" A.C. MAIN 48
- MILDRED ST, EUREKA To HUENEME @ STK'S & GRD. ✓
6" A.C. MAIN 49-50
- GLENDORA ST, REVERE To PAL. HYW. @ STK'S & GRD. ✓
6" A.C. MAIN 51
- BUNKER HILL, REVERE To PAL. HYW. @ STK'S & GRD. ✓
6" A.C. MAIN 52
- GALVESTON ST., JELLETT To INGLE @ STK'S & GRD. ✓
6" A.C. MAIN 53
- 35th ST, "E" To PICKWICK ST. @ STK'S & GRD. ✓
6" A.C. MAIN 54
- Island Ave, Bancroft Ely 110' @ STK'S & GRD. ✓
6" A.C. MAIN 55
- Bancroft St., Island to J. St. @ STK'S & GRD. ✓
6" A.C. MAIN 56
- McLaren's Lane, 33rd to Bancroft @ STK'S & GRD. ✓
6" A.C. MAIN 57-58
- LANDIS ST., 52nd to Ogden @ STK'S & GRD. ✓
6" A.C. MAIN 59-60
dive

28th ST.
 LOGAN TO IRVING AVE.
 & PROFILE
 PRELIMINARY

12-21-55
 SHOEY
 MARTEL
 KEMP
 SMITH

5+60²⁵ N/L IRVING ST.

2+74⁵⁰ Δ PT. 00° 07' 15" RT.

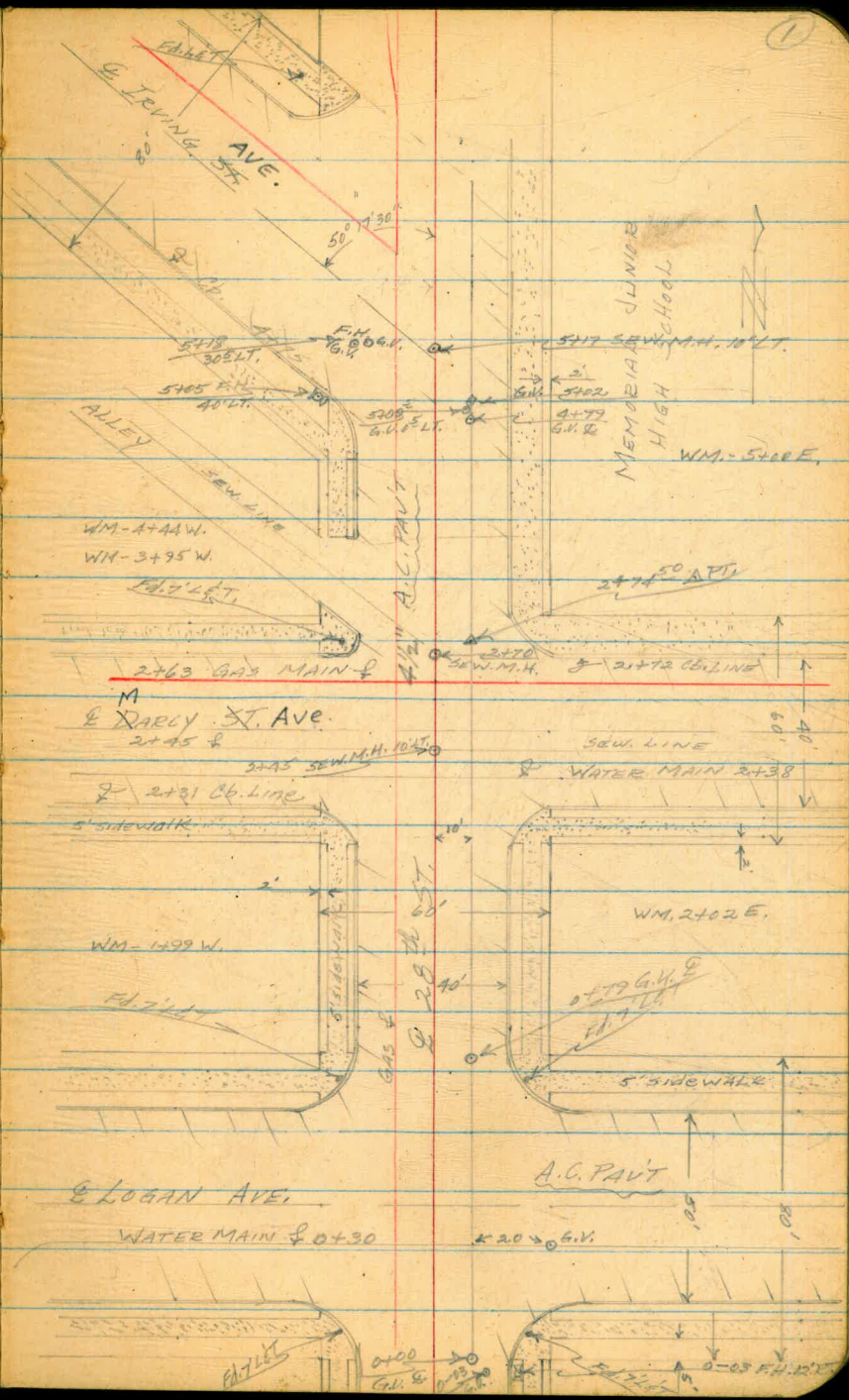

0+00 S/L LOGAN AVE

28th ST.
(CONT'D)

B.M.	8.53	74.55	66.02
0+00		9.8	64.75
0+50		9.1	65.45
1+00		8.2	66.35
1+50		7.0	67.55
2+00		6.3	68.23
	SEW. M.H.	{ 5.19 (12.2)	69.36 62.35
2+50		5.2	69.35
	SEW. M.H.	{ 4.74 { 11.9	69.81 62.65
3+00		4.3	70.25
3+50		3.3	71.25
4+00		2.4	72.15
4+50		1.5	73.05
5+00		0.8	73.75
5+50	SEW. M.H.	{ 0.30 (7.5)	74.25 67.05
5+50	SEW. M.H.	0.0	74.55
5+60 ⁹⁵	END	+0.2	74.75
		8.53	66.02 = 66.02

Reduced by J Gray 2-29-56

M.W.B.P. LOGAN & 28th

SEW. M.H. 2+45 10' LT.
" " "

SEW. M.H. 2+70 10' LT.
" " "

SEW. M.H. 5+17 10' LT.
" " "

(2)

ALABAMA ST.
 MONROE TO ADAMS
 ⑤ STK'S 462D 6" A.C. MAIN

1-9-36
 SHOPEY
 MARTELL
 KEMP
 SMITH

③

B.M.		324.61		S.E. B.P. MONROE & ALABAMA
	8.10 332.71			
0+30	BEGIN WORK	8 ⁵ 324.1	326.2	C 3 2 ±
0+35	G.V. BY CITY	8 ⁵ 324.2	326.2	C 4 0
0+50		8 ⁵ 324.2	326.3	C 3 2
1+00		8 ¹ 324.6	326.8	C 3 8
1+50		7 ⁶ 325.1	321.2	C 3 2
2+00		7 ¹ 325.6	321.5	C 4 1
2+50		6 ⁶ 326.1	322.1	C 4 0
3+00		6 ⁰ 326.7	322.7	C 4 0
3+50		5 ⁵ 327.2	323.3	C 3 2
4+00		4 ² 327.8	323.8	C 4 0
4+50		4 ¹ 328.3	324.4	C 3 2
5+00		3 ² 328.9	325.0	C 3 8
5+50		3 ³ 329.4	325.6	C 3 8
6+00		2 ³ 330.0	326.2	C 3 8
6+50		2 ¹ 330.6	326.8	C 3 8
6+70 ³⁰	F.H. TEE	1 ² 330.8	327.0	C 3 8
	①	1 ⁸ 330.9	327.0	C 0 ⁰⁰ TOP FLANGE C 3 9 ⁰⁰ BOTTOM
7+00		1 ¹ 331.0	327.3	C 3 7
7+05	G.V. BY CITY	1 ⁰ 331.1	327.4	C 3 7

(CONT'D)

④

332.71

7+10	6" x 12" CROSS BY CITY	15	331.2	327.4	C 3 8 +
7+15	G.V. BY CITY	14	331.3	327.5	C 3 8
T.P.	8.09 339.48	1.32	331.39		
7+50		78	331.7	327.9	C 3 8
8+00		71	332.4	328.7	C 3 7
8+50		62	333.3	329.5	C 3 8
9+00		55	334.0	330.2	C 3 8
9+50		47	334.8	331.0	C 3 8
10+00		39	335.6	331.8	C 3 8
10+50		31	336.4	332.5	C 3 9
11+00		22	337.3	333.3	C 4 2
11+50		15	338.0	334.0	C 4 2
T.P.	5.72 343.72	1.48	338.00		
12+00		50	338.7	334.8	C 3 9
12+25		42	338.8	335.1	C 3 9
12+50		47	339.0	335.1	C 3 9
12+52.50	6" CROSS & F.H. SERVICE	46	339.1	335.1	C 4 2 1/2 (0' TO TOP FLANGE)
		43	339.4	335.1	C 4 2 1/2 (4' TO BOT. ELL.)
13+00		40	339.7	335.2	C 4 2
13+25		36	340.1	335.7	C 4 2
13+50		34	340.3	335.9	C 4 2
13+85	G.V. BY CITY	31	340.3	336.2	C 4 1
13+90	6" TEE BY CITY	35	341.2	336.3	C 3 9 1/2

(CONT'D)

343.72

T.P.

6.59337.13

1.60338.73

T.P.

7.68331.05

0.51331.56

CK BM

6.94324.62 = 324.61

SEBP MANROE & ALABAMA

WATER METERS

METERS BEHIND EXIST. CURBS

1+60 W.	5+58 E.	11+56 E.
1+61 W.	5+58 W.	
1+99 W.	6+00 W.	11+87 E.
2+58 W.	6+00 E.	12+23 E.
2+75 W.	6+21 W.	12+60 E.
2+80 E.	7+83 W.	
3+82 W.	8+44 E.	
3+22 E.	8+68 W.	
3+25 W.	8+75 E.	
3+72 W.	9+09 W.	
3+71 E.	9+29 E.	
4+27 W.	9+39 W.	
4+25 E.	9+53 E.	
4+44 W.	9+74 W.	
4+80 W.	10+26 W.	
4+87 E.	10+23 E. 10+42 E.	
5+11 W.	10+55 W.	
5+22 E.	11+07 W.	
	11+12 E.	
	11+53 W.	

UNIVERSITY AVE.
 CARTAGENA DRIVE TO
 (3) STICKS & GED. FOR 12" & 8" A.C. MAIN

1-9-56
 SHOLEY
 KEMP
 SMITH

BM							
	7.22	329.48		322.26			N.W. PROP. DISK COLLEGE & UNIV.
TP	10.94	340.06	0.36	329.12			1-30-56
0+30	BEGIN WORK		3.0	337.1	334.2	C2 ² ±	NOT MK'D (0+30 TOP EXIST. TEE 334.1)
0+35	12" G.V. BY CITY		2.5	337.6	334.2	C3 ⁴	
0+50			2.6	337.5	334.4	C3 ⁴	
0+93	F.H. TEE		1.3	338.8	334.9	C3 ²	
1+00			1.2	338.9	335.0	C3 ²	
TP	5.06	344.86	0.26	339.80			
1+50			5.3	339.6	335.6	C4 ⁰	
2+00			4.8	340.1	336.2	C3 ²	
2+50			4.8	340.1	336.5	C3 ⁶	
3+00			3.8	341.1	337.3	C3 ⁸	
3+50			3.3	341.6	338.1	C3 ⁵	
4+00			1.6	342.3	339.3	C4 ⁰	
4+50			0.2	344.7	340.6	C4 ⁴	
TP	8.97	353.71	0.12	344.74			
5+00			7.7	346.0	342.0	C4 ⁰	
5+50			6.2	347.5	343.7	C3 ⁸	
6+00			4.8	348.9	345.4	C3 ⁵	
6+34			3.8	349.9	346.4	C3 ⁵	
6+50			3.4	350.3	346.6	C3 ⁷	
6+75	G.V.		2.7	351.0	346.7	C4 ⁴	

(CONT'D)

353.71

6+80	12" x 6" T&E & F.H. Assy	2.6	351.1	346.7	CA ⁴
7+00		2.7	351.0	346.9	CA ⁴
7+50		1.8	351.9	347.9	CA ²
8+00		0.6	353.1	349.1	CA ²
TP	7.88 361.13	0.44	353.27		
8+50		6.8	354.4	350.4	CA ²
9+00		5.9	355.3	351.2	CA ⁴
9+50		5.0	356.2	352.0	CA ³
10+00		4.3	356.9	352.6	CA ³
		4.29	356.86	= 356.83	TP ON Cb ₁
10+50		3.8	357.4	353.3	CA ⁴
11+00		3.3	357.9	353.9	CA ²
11+50		3.8	357.4	353.8	CA ⁶
11+75		3.4	357.8	353.7	CA ⁴
11+95	12" B.C.	3.5	357.7	353.4	CA ³
TP	35 2.73 360.40	3.48	357.67		
12+06		3.4	357.0	353.0	CA ²
12+17	58	3.4	357.0	352.9	CA ⁴
12+28	81 P.R.C.	3.4	357.0	352.8	CA ²
12+40	04				
12+51	27	3.6	356.8	352.7	CA ⁴
12+60	61.1	3.7	356.7	352.6	CA ⁴
		3.8	356.6	352.6	CA ² ±
12+62	50 E.C.				
		3.8	356.6	352.6	CA ² ±
12+67	50 B.C.				
		3.8	356.6	352.5	CA ⁴ ±

NOTE: THIS SECTION OF LINE WAS CHANGED TO GO IN STRAIGHT

1-30-56
12+59 ±
Top EXIST. 8" C.L. 352.7

UNIVERSITY AVE.
(CONT'D)

360.40

12+70	G.V.		3.9	356.5	352.4	C4 ¹
12+78	⁷³		4.1	356.3	352.4	C3 ²
12+89	⁹⁶		4.4	356.0	352.2	C3 ⁸
13+01	¹⁴ P.R.C.		4.7	355.7	352.0	C3 ⁷
TP	4.88	361.29	3.99	356.41		
13+01	F.H. TEL		5.6	355.7	352.0	C3 ²
			5.0	356.3		C3 ³
13+12	³⁹		5.8	355.5	352.0	C3 ⁵
13+23	⁶⁴		6.1	355.2	351.9	C3 ³
13+34	⁸⁸ BK } E.C.		6.3	355.0	351.8	C3 ²
13+30	AM. }		6.0	355.3	351.7	C3 ⁶
13+50			6.1	355.2	351.5	C3 ⁷
14+00			5.6	355.7	352.3	C3 ⁴
TP	8.85	362.64	5.50	355.79		
15+00			5.9	356.7	353.0	C3 ⁷
15+50			4.6	358.0	354.4	C4 ⁴
16+00			3.3	359.3	355.7	C3 ⁶
16+50			2.2	360.4	356.7	C3 ²
17+00			1.3	361.3	357.6	C3 ⁷
17+50			1.1	361.5	358.2	C3 ³
18+00			0.2	362.4	358.7	C3 ⁷
TP	5.06	367.57	0.13	362.57		
18+50			4.7	362.9	359.0	C3 ²

NOTE: THIS SECTION OF
LINE WAS CHANGED TO GO IN STRAIGHT

UNIVERSITY AVE.
(CONT'D)

367.57

18+70	G.V.		4.5	363.1	359.2	C3 ²
18+75	F.H. TEE		4.5	363.1	359.2	C3 ²
19+00			4.3	363.3	359.4	C3 ²
19+06	¹⁵ B.C.		4.3	362.3	359.4	C3 ²
OK, TBM	6.62	369.22	4.27	363.30 = 363.25		2 ¹ Disk 4 ² LT. 19+06 ¹⁵ B.C. F.B. 901-58
19+50			6.3	363.6	359.7	C3 ²
20+00			5.9	364.0	360.0	C4 ⁰
20+50			5.6	364.3	360.4	C3 ²
21+00			5.8	364.1	360.8	C3 ³
21+50			5.0	364.9	361.1	C3 ²
22+00			5.0	364.9	361.2	C3 ²
22+25			5.0	364.9	361.2	C3 ⁷
22+50			5.7	364.2	360.8	C3 ⁴
22+88	²⁶ E.C.		5.6	364.3	360.4	C3 ²
23+00			6.2	363.7	360.2	C3 ⁵
23+50			6.9	363.0	359.3	C3 ²
23+92	G.V.		7.5	362.4	358.6	C3 ⁸
23+97	8" TEE		7.7	362.2	358.5	C3 ² +
24+00	TP	1.69	7.7	362.2	358.4	C3 ⁸
		363.94	7.67	362.25		
24+50			2.5	367.4	357.4	C4 ⁰

UNIVERSITY AVE.
(CONT'D)

363.74

24+65 F.H. TEE	2.9	361.0	357.2	C3 ²
25+00	3.7	360.2	356.5	C3 ²
25+50	4.6	359.3	355.6	C3 ²
25+87 ⁵⁰	5.1	358.8	353.5	C5 ³
26+00	5.2	358.7	353.4	C5 ³
26+50	5.3	358.6	353.0	C5 ⁶
26+75	5.2	358.7	352.8	C5 ²
27+00	5.2	358.7	353.6	C5 ¹
27+50	4.9	359.0	355.0	C4 ²
27+84 Δ PT. 38°56'30" LT.	4.6	359.3	355.1	C4 ³
27+95 G.V.			355.2	
28+00 F.H. TEE	5.0	358.9	355.2	C3 ²
①		359.4		
28+23 ³³ END-WYE BY CITY	4.6	359.3	355.6	C3 ² +
	5.2	358.7 = 358.6		
	3.42	360.52 = 360.46		

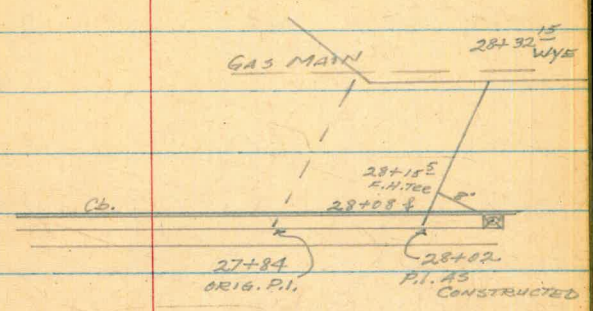

NOTE: REVISED LOCATION OF
MAIN AS CONSTRUCTED
28+02 Δ PT. 38°56'30" LT.
28+15⁵ F.H. TEE
28+32.15 WYE
(ELEV. OF TOP 8" C.I. @
28+32.15 = 355.3)

C4² TO BOTT.

Q STA. 26+53.12 F.B. 901-60
CHISEL X EAST 3' 50" ALLEY F.B. 901-60

WATER METERS

- 0+83 S.
- 2+01 S.
- 2+22 S.
- 3+24 S.
- 8+53 S.
- 19+23 S.
- 22+37 S.

SOUTH OZARK ST.
 IMPERIAL TO OCEANVIEW BLVD
 @ STR'S & GRD 6" A.C. MAIN

1-10-56
 SHOEY
 KEMP
 MARTELL
 SMITH
 W. END S. CB. CHURCH WARD & IMP.
 SPUR IN T.P. NW COR. OCEANVIEW & SO. OZARK ST.

BM	0.23	185.09		184.86	
TP	1.25	173.21	13.13	171.96	
TP	5.90	166.17	12.94	160.27	

0+60 BEGIN WORK.			5.6	160.6	156.4
0+65 8" X 6" REDUCER			6.0	160.2	
1+00			6.4	159.8	156.3

1+50			5.8	160.4	156.1
------	--	--	-----	-------	-------

2+00			5.4	160.8	157.0
------	--	--	-----	-------	-------

2+50			3.8	162.4	157.1
------	--	--	-----	-------	-------

3+00			1.2	165.0	160.3
TP	4.93	169.86	1.24	164.93	

3+50			3.5	166.4	161.4
------	--	--	-----	-------	-------

3+75			3.2	166.7	162.0
------	--	--	-----	-------	-------

3+90 6" TEE			3.7	166.2	161.7
-------------	--	--	-----	-------	-------

4+00 E.W. TEE			4.0	165.9	161.6
---------------	--	--	-----	-------	-------

③			3.1	166.9	
---	--	--	-----	-------	--

4+05 G.V.			4.1	165.8	161.5
-----------	--	--	-----	-------	-------

4+50			5.4	164.5	160.8
------	--	--	-----	-------	-------

4+75			5.8	164.1	160.5
------	--	--	-----	-------	-------

5+00			6.2	163.7	159.2
------	--	--	-----	-------	-------

5+50			7.3	162.6	158.8
------	--	--	-----	-------	-------

6+00			8.8	161.1	157.8
------	--	--	-----	-------	-------

6+50			10.1	159.8	156.7
------	--	--	------	-------	-------

TP	2.14	162.31	9.69	160.17	
----	------	--------	------	--------	--

7+00			3.7	159.6	155.7
------	--	--	-----	-------	-------

C4² ±

C3² ±

C3²

C4³

C3²

C3²

C4²

C5²

C4²

C4²

C4⁵

C4³

C1² C5²

C4³

C3²

C3⁶

C3⁸

C3⁸

C3⁸

C3³

C3¹

C3²

EXIST. MAIN CONN. ELEV.
 2-8-56 155.8

COR. CONC. DRIVE @ 7+03

SOUTH OZARK ST.
(CONT'D)

12

162.31

7+50			3.2	159.1	154.5	C4 ^b	
8+00			4.1	158.2	153.3	C4 ^a	
8+50			5.3	157.0	152.2	C4 ^b	
8+95 F.H. TEE			7.2	155.1	149.6	C5 ^c	
⑤			6.1	156.2		C2 ^a C6 ^b	
9+00 6" G.V.			7.6	154.7	149.5	C5 ^b	
9+50			12.1	150.2	145.5	C4 ^c	
TP	1.44	150.44	13.31	149.00			
10+00			6.0	144.4	140.7	C3 ^b	
10+50			9.7	140.7	137.1	C3 ^b	
TP	4.01	141.72	12.73	137.71			
11+00			3.0	138.7	135.1	C3 ^b	
11+50			3.8	137.9	134.0	C3 ^a	
12+00			4.6	137.1	132.9	C4 ^b	
12+50			6.5	135.2	131.8	C3 ^a	
13+00			7.2	134.5	130.8	C3 ^b	
13+25 F.H. TEE			7.0	134.7	130.3	C4 ^a	
⑤			6.0	135.7		C3 ^b C5 ^a	134.9
CK. TBM			6.83	134.89 = 134.94		NAIL P.P. F.B. 904	

WATER METERS
166.17

2+84 W			6.2	160.0	160.8	F0 ^b	"122, 124, 124"
2+70 E			2.0	164.2	163.9	C0 ^b	"4750" Holiday
2+84 W			1.8	164.4	163.5	C0 ^a	"132, 134, 136"

(SET METERS)
8⁵ LT. & 28⁵ RT.

SOUTH OZARK ST.
(CONT'D)
WATER METERS

	169.86				
3+28 W.		4.0	165.9	164.5	C1 ² "199-196"
3+92 W.		4.5	165.4	165.0	C0 ¹ "202-204"
4+48 W.		6.1	163.8	164.2	F0 ⁴ "214"
5+33 E.		6.0	163.9	163.4	C0 ⁵ "231"
5+71 E.		7.4	162.5	162.4	C0 ¹ "237"
5+76 W.		9.4	160.5	161.2	F0 ² "238"
6+14 E.		8.5	161.4	161.6	F0 ² "243"
6+59 E.		9.7	160.2	160.6	F0 ⁴
7+24 E.	162.31	1.3	161.0	159.2	C1 ⁸
7+77 E.		2.8	159.5	158.1	C1 ⁴
7+78 W.		5.0	157.3	157.3	C0 ⁰
7+82 W.		5.1	157.2	157.2	C0 ⁰
8+35 E.		4.0	158.3	156.6	C1 ²
9+57 E.		11.6	150.7	148.8	C1 ²
10+39 E.	150.44	7.5	142.9	142.6	C0 ³
10+81 E.		11.0	139.4	140.7	F0 ²
10+90 W.		14.2	136.2	139.6	F3 ⁴
11+62 E.	141.72	3.8	137.9	137.8	C0 ¹
13+58 S.		5.1	136.6	133.5	C3 ¹

(SET METERS)
8⁵ LT. & 28⁵ RT.

BAYSIDE LANE
 SAN GABRIEL PL. TO ALLEY N.E. COGNADO CT.
 @ STR'S & 6ED 6" A.C. MAIN

1-12-56

SHIRBY
 KEMP
 MARTELL
 SMITH

14

BM	1.45	8.64	6.99			
TP	5.79	4.47	2.96	-1.32		
0+62	BEGIN WORK		4.7	-0.2	-4.1	C3 ² ± NOT MK'D
1+00			5.0	-0.5	-4.2	C3 ²
1+19	6" TEE		4.8	-0.3	-4.2	C3 ²
1+19	13' WEST - 6" CAP, 2" TAP		4.8	-0.3	-4.2	C3 ² ±
1+50			4.6	-0.1	-4.4	C4 ³
1+75			4.8	-0.3	-4.4	C4 ⁴
2+00			4.8	-0.3	-6.2	C5 ²
2+12			4.8	-0.3	-6.2	C5 ²
2+37			4.8	-0.3	-4.3	C4 ²
TP	4.86	4.57	4.76	-0.29		
2+50			4.9	-0.3	-4.2	C3 ³
3+00			5.0	-0.4	-4.2	C3 ⁸
3+06	10" 6" TEE		5.0	-0.4	-4.1	C3 ²
3+06	10" 13' W. - 6" CAP, 2" TAP		5.0	-0.4	-4.1	C3 ² ±
3+15	6" CAP, 2" TAP		5.0	-0.4	-4.1	C3 ² ±
TP	9.14	8.24	5.47	-0.90		
TP	2.36	9.34	1.26	6.98		
CK. B.M.			2.35	6.99 = 6.99		

S.W.B.P. MISSION BEACH SEAWALL & SAN GABRIEL PL.

ADAMS AVE.
MISSISSIPPI TO ALABAMA
⑤ ST. K'S & GED. 6" A.C. MAIN

1-13 '6
SHOREY
MAFFELL
KEMP
SMITH

TP	13.21	353.41	340.20
0+30 BEGIN WORK	18	351.6	347.4
0+50	2.4	351.0	347.0
0+75	3.3	350.1	346.4
1+00	4.0	349.4	345.5
1+50	5.6	347.8	344.0
2+00	7.1	346.3	342.4
2+50	8.8	344.6	340.8
3+00	10.4	343.0	339.2
3+50	11.5	341.9	337.6
3+75	12.0	341.4	336.9
4+00	12.7	340.7	336.5
4+05 G.V. BY CITY	12.8	340.6	336.4
4+10 END WORK CR. TD	13.21	340.20 = 340.20	336.34

⑤ 13+90 6" TEE ALABAMA ST. (PG. 4)

4² ± NOT MK'D

C4²

C3²

C3²

C3²

C3²

C3²

C3²

C4³

C4²

C4²

C4²

(5) DESTROYED BY FAULT BREAKER

WATER METERS
METERS BEHIND EXIST. CURB

0+70 N.

1+11 S.

1+35 N.

1+84 S.

2+17 N.

2+49 N.

2+91 N.

HOLLY PLACE
 SO. OZARK ST. TO 285 E
 ⑤ STK'S & BLD. 6" A.C. MAIN.

1-13-56
 SHOREY
 MARTELL
 KEMP
 SMITH

16

TP	5.82	170.75		164.93		⑤ HUB 3+00 OZARK ST. (PG. -11)
0+30 BEGIN WORK					161.7	
0+35 G.V.			4.4	166.14	161.8	C4 ⁶
0+50			4.3	166.5	162.1	C4 ⁴
1+00 TP	7.67	175.52	2.92	167.83	163.0	C4 ⁸
1+50			6.4	169.1	164.1	C5 ⁰
2+00			6.0	169.5	165.2	C4 ³
2+50			5.7	169.8	166.2	C5 ⁶
3+00			4.5	171.0	167.3	C3 ²
6" Cap - 2" Tap & B.O.						
3+25 END WORK			3.9	171.6	167.7	C3 ²
TP	1.67	170.83	6.38	169.14		
OK TP			5.89	164.92	= 164.93	

WATER METERS
 175.52

1+48 N.			6.3	169.2	168.0	C1 ²	"4950"	(SET METERS) 8 ⁵ FT. & 28 ⁵ LT.
2+81 N.			5.0	170.5	171.0	F0 ⁵		
3+14 S.			5.1	170.4	170.8	F0 ²		
3+35 S.			3.9	171.6	170.5	C1 ²		
3+36 S.			3.6	171.9	170.4	C1 ⁵		
3+35 N.			3.5	172.0	171.3	C0 ²		

WATER METERS & F.H.
GROVELAND ST.
EUGLID TO 53RD

1-10-56
SHREVEY
MARTIN
KEMP
SMITH

17

W. I. T. GROVELAND & EUGLID

BM.	8.63	141.60		132.97			
0-10 F.H. SO.			7.6	134.0	131.10	C ₂ ²	
0+08 TOP 6" A.C. MAIN			11.33	130.27		E 600. 131.8	
0+67 S.			5.1	136.5	135.4	C ₁ ^L	"5115"
1+10 N.			4.1	137.5	135.8	C ₁ ^Z	"5120"
1+62 S.			3.7	137.9	137.0	C ₀ ²	"5125"
1+77 N.			3.3	138.3	136.6	C ₁ ^Z	"5130"
2+19 N.			3.0	138.6	137.0	C ₁ ⁶	"5136"
2+44 S.			3.2	138.4	137.8	C ₀ ⁶	"5137"
2+89 N.			2.4	139.2	137.8	C ₁ ⁴	"5158"
3+11 S.			2.7	138.9	138.4	C ₀ ⁵	"5157"
3+50 N.			2.8	138.8	138.4	C ₀ ⁴	"5160"
3+81 S.			2.6	139.0	139.2	C ₀ ²	"5161"
4+41 S.			2.0	139.6	139.7	F ₀ ⁴	"5171"
4+63 N.			2.0	139.6	139.5	C ₀ ⁴	"5170"
TP	7.15	146.76	1.99	139.61			
5+48 N.			5.6	141.2	140.4	C ₀ ⁸	
5+49 N.			5.2	141.6	140.4	C ₁ ²	
TP	5.94	148.74	3.76	142.80			
5+70 F.H. SO.			6.1	142.6	141.7	C ₁ ⁵	
5+79 S.			6.4	142.3	141.1	C ₁ ²	
6+17 S.			5.9	142.8	141.4	C ₁ ⁴	"5211"
6+14 N.			5.9	142.8	141.0	C ₁ ⁸	

WATER METERS
GROVELAND ST.
(CONT'D)

18

148.74

6+74 N.			5.6	143.1	141.6	C1 ⁵	"5216"
7+09 S.			4.8	143.9	142.4	C1 ⁵	"5225"
7+44 N.			4.7	144.0	142.3	C1 ²	"5222"
7+73 S.			4.1	144.6	143.0	C1 ⁶	"5235"
8+06 N.			4.6	144.1	143.0	C1 ¹	
9+05 N.			4.2	144.5	143.6	C0 ⁹	"5246"
9+15 S.			3.4	145.3	144.4	C0 ⁹	
9+45 N.			3.8	144.9	144.0	C0 ²	"5258"
9+80 S.			3.7	145.0	144.7	C0 ³	"5255"
10+03 N.			3.4	145.3	144.4	C0 ⁹	
TP	4.70	150.04	3.40	145.34			
10+81 S.			3.9	146.1	145.5	C0 ⁶	"5265"
11+21 S.			3.5	146.5	145.9	C0 ⁶	"5277"
11+33 N.			3.8	146.2	145.6	C0 ⁶	"5290"
11+90 S.			3.8	147.2	146.4	C0 ⁸	
12+36 S.			1.7	148.3	146.6	C1 ²	"5285"
12+41 F.H.S.			1.8	148.2	146.7	C1 ⁵	
OK. TBM	1.63	148.80	2.87	147.17	= 146.91		SPIKE IN P.P. N.W. COR. GROVELAND & 53 rd
OK. TBM	0.22	145.45	3.57	145.23	= 144.97		SPIKE IN P.P. GROVELAND & CASTANA
TP	2.68	141.05	7.08	138.37			
OK. BM			8.07	132.98	= 132.97		LET ENCLID & GROVELAND

19

GRADES FOR LOWERING
6" A.C. MAIN ON GROVELAND ST.
0+00 = 14' BK. OF PROP. ON ENCLID

BM	5.97	138.94		132.97		2' LET GROVELAND & ENCLID (NOT MK'D)	
0-40			6.1	132.8			
0-24			5.6	133.3	127.6	c5 ⁷	
0-14			5.5	133.4	127.4	c6³	c6 ⁰
0-10 F.H.G.V.			5.5	133.4	131.0	c2 ⁴	TOP G.V. CAP
0+00			6.1	132.8	127.4	c5 ⁴	
0+31			5.4	133.5	128.8 127.1	c8	c4 ²
0+71			3.8	135.1	130.6 131.4	c9 ⁷	c4 ⁵
1+11			2.5	136.4	131.6 132.4	c4 ⁰	c4 ⁸

ASH ST.
 31.51 TO FERN ST.
 (5) STK'S 1/2 GRD. FOR 8" A.C. MAIN

1-18-56
 SHORBY
 KEMP
 MARTELL
 SMITH

BM			225.01		
BM	2.18	237.25	235.07		
0+30	BEGIN WORK	2.2	235.1	231.2	
0+35	G.V. By City	2.2	235.1	231.2	
0+50		2.2	235.1	231.2	C32
0+75		2.7	234.6	231.2	C34
1+00		3.4	233.9	230.4	C35
1+50		5.0	232.3	228.6	C37
2+00		6.4	230.9	227.4	C35
2+50		7.8	229.5	226.2	C33
2+75		8.4	228.9	225.5	C34
3+00		8.5	228.8	224.6	C42
3+10	8"X6" CROSS By City	8.1	229.2	236.2 234.2	C49 3 ^e
3+20		7.7	229.6	226.2 224.0	C56 3 ^d
3+50		7.6	229.7	226.0	C37
4+00		7.0	230.3	226.8	C35
4+50		5.9	231.4	227.7	C36
5+00		5.0	232.3	228.8	C35
5+50		3.8	233.5	229.8	C37
5+59	F.H. TEE	3.5	233.8	229.8	C40
(5)		3.1	234.2	224.35 224.15	F02

31.51 ST.
 30 ST.

N.W.B.P. ASH

(227.0)

MOVED 2' BT.

MOVED 2' BT. STK'd 15' BACK of existing curb
 21.5" 51/2" E of street
 11.5" E of pipe

224.35
 224.15
 EXIST
 CURB

Ash St
Cont'd.

2/3/56

21

237.25

5485 8" G.V. By City

3.4 233.9 229.6

C43 ± NOT MK'D

MOVED 3² FT.

5490 16" X 8" REDUCED By City

3.4 233.9 229.6

C43 ± NOT MK'D

MOVED 3² FT.

ELEV. TOP 16" FLUSH

TD 0.50 233.60

4.15 233.10

230.1

CK BM

8.55 225.05 = 225.01

NW Cor Ash & 30th

WATER METERS
(BEHIND EXIST. CB.)

4483 50.

5402 50.

5460 NW. METER NOT EXISTING.

ELEV. FOR GATE VALVES
AT QUINCE & NILE

1-23-56
SHOREY
KEMP
SMITH

22

BM.	4.26	283.89	279.67		NEBP NILE & QUINCE
③ G.V. TO FH	6.00	277.89	278.25	FO ³⁶	TOP G.V. CAP
TOP FH G.V. STEM	6.36	277.53		FO ¹²	
③ WATER MAIN G.V.	5.80	278.09	278.45	FO ³⁶	TOP G.V. CAP
TOP WAT. MAIN G.V. STEM	6.06	277.83		FO ⁶²	

ELEV. ON EXISTING WATER MAIN
IN ALLEY N.W. OF COLLIER E. OF 34th

0+00 = S/L COPLEY ST.
ALLEY BLK. - 17

1-24-56
SHOREY
KEMP
SMITH

23

BM.	6.11	398.29	392.18
0+04	{ TOP OF PIPE	8.7	389.6
	{ GRD.	5.3	392.0
TP	3.75	399.31	2.73 395.56
3+19	{ TOP OF PIPE	8.5	390.8
	{ GRD	4.6	394.7
6+00	{ TOP OF PIPE	10.4	388.9
	{ GRD	7.6	391.7
TP	4.53	394.60	7.24 392.07
TP	5.28	397.29	4.59 392.01
CK. BM		5.09	392.20 = 392.18

S.E.B.P. COPLEY. & 34th ST.

NAIL P.P. AT 2+00

41ST
 LOGAN AVE. TO "T" ST.
 STR'S & GRD 6" A.C. MAIN

1-25-56
 SHARBY
 KEMP
 SMITH

24

TBM	12.47	56.36	43.89		TOP CONC. WALL AT 0+14	
0+30 BEGIN WORK 6" TEE BY CITY			12.2	44.2	36.6	C7 ⁶⁺ (TOP ENT. MAIN 37.3)
0+50			11.1	45.3	38.5	C6 ⁸
1+00			6.1	50.3	44.2	C6 ¹
1+25			2.9	53.5	45.5	C8 ⁰
1+50			+0.1	56.5	46.2	C10 ³
1+67 ⁵⁶			0.0	56.4	46.8	C9 ⁶
2+00			0.5	55.9	47.8	C8 ⁴
TP	10.86	65.02	2.20	54.16		
2+50			7.9	57.1	49.4	C7 ⁷
3+00			4.9	60.1	56.0	C9 ²
3+50			7.0	58.0	52.3	C7 ⁵ C5 ⁷
3+87 ⁵			8.2	56.8	53.2	C3 ⁶
4+00			8.6	56.4	52.9	C3 ⁵
4+50			9.7	55.3	52.2	C3 ⁷ ✓
5+00			8.8	56.2	52.5	C3 ⁷
5+50			5.5	59.5	56.0	C3 ⁵
5+55 ¹⁰ 11/4° BEND			4.7	60.3	56.6	C3 ⁷
5+75			1.3	63.7	60.0	C3 ⁷
TP	7.92	72.64	0.30	64.72		
6+00			6.4	66.2	62.2	C4 ⁰
6+35 G.V. BY CITY			5.6	67.0	63.4	C3 ⁶

68.57 (905-9)

41ST
(CONT'D)

72.64

END WORK - CONN. TO EXIST.

6+40 F.H. SET 6" C.I. SUB BY CITY 5.5 67.1 63.5 C36

F.H. (5) 60 66.6

F1² TO FLANGE
(SET FLANGE 67.6)

OK. TBM 4.87 68.57 = 68.87

NAIL IN P.P. S.W. COR. "T" & BOUNDARY F.B. 705

NOTE: F.H. SET 6⁵/₈ SO. OF
6" C.I. ON "T" ST. 20' W. OF S.W.
COR. "T" & BOUNDARY

WATER METER
56.36

0+12 F 65.02 16.1 40.3 42.4 F2¹ " 705"

2+34 F. 8.5 56.5 52.9 C36 " 725"

3+02 F 3.5 61.5 58.0 C6⁵ " 841"

4+03 F. 7.6 57.4 57.4 C0³ " 729"

BOUNDARY ST.
 SUNCREST DR. TO ADAMS AVE.
 @ STK'S & GRD 6" A.C. MAIN

1-25-56
 SHIREY
 KEMP
 SMITH

26

TBM	687	393.94	386.97		
0+50 BEGIN WORK 6" TEE BY CHY	73	386.5	382.5	C4 ⁰	
0+55 G.V. BY CITY	73	386.5	382.5	C4 ⁰	
0+87 ⁵	72	386.6	383.0	C3 ⁶	
1+00	69	386.9	383.1	C3 ⁸	
1+50	65	387.3	383.6	C3 ²	
2+00	60	387.8	384.1	C3 ²	
2+50	56	388.2	384.6	C3 ⁶	
3+00	50	388.8	385.0	C3 ⁸	
3+12 ⁵	48	389.0	385.2	C3 ⁸	
3+50	45	389.3	385.6	C3 ²	
4+00	39	389.9	386.0	C3 ²	
4+50	33	390.5	386.5	C4 ⁰	
4+87 ⁵	27	391.1	386.9	C4 ²	
5+00	27	391.1	386.9	C4 ²	
5+39 END WORK	26	391.2	386.9	C4 ³⁺	CONN. TO EXIST. 6" G.V.
5+44 ⁵ EXIST. 12" MAIN CK. B.M.	2.62	391.22			

WATER METERS

0+84 W.

"3063"

1+50 E.

"4757"

BOUNDARY ST.
(CONT'D)
WATER METERS
(METERS BEHIND CB)

27

1+55W	" 4756"
1+92W	" 4750"
2+25W	" 4744"
2+26E	" 4743"
2+58E	" 4735"
3+60W	" 4738"
3+92W	" 4730"
3+09E	" 4729"
3+41W	" 4718"
3+57E	" 4715"
4+53E	" 3110-3104"

SUNCREST DR.
 BOUNDARY TO ADAMS AVE.
 (5) STR'S 6" A.C. MAIN

1-25-56

28

TBM	2.41	386.97		(1) 2 1/4 S.E. COR. SUNCREST & BOUNDARY
0+10 BEGIN WORK	2.7	386.7	382.5	C4 ²
0+45 G.V. BY CITY	2.7	386.7	382.5	C4 ²
0+50	2.7	386.7	382.5	C4 ²
0+62 ⁵	2.7	386.7	382.4	C4 ³
0+70 F.H. TEE	2.8	386.6	382.3	C4 ³
(5)				
1+00	3.1	386.3	382.1	C4 ²
1+50	3.9	385.5	381.6	C3 ²
1+57 ⁹⁵ APT. 6 S.C. 22 1/2° BEND	4.2	385.2	381.6	C3 ⁶
ET 4.0	4.0	385.4		C3 ⁸
1+62 ⁵	4.3	385.1	381.6	C3 ⁵
2+00	4.7	384.7	381.3	C3 ⁴
2+50	5.2	384.2	380.9	C3 ³
2+62 ⁵	5.4	384.0	380.9	C3 ¹
3+00	5.7	383.7	380.4	C3 ²
3+50	6.2	383.2	379.8	C3 ⁴
3+62 ⁵	6.4	383.0	379.7	C3 ³
3+70 ⁴² E.C.	6.4	383.0	379.7	C3 ³
TP 590	9.4	383.48		
4+00	10.2	382.7	379.1	C3 ⁶
4+10 6" TEE	10.5	382.4	379.1	C3 ³

392.89

SUNCEST DR.
(CONT'D)

29

392.89

4+10 5' LT. 6" W.	10.5	382.4	379.1	C3 ³
4+10 30' LT. 6" Cap	11.0	381.9	378.4	C3 ⁵
4+37 ⁵	9.9	383.0	379.7	C3 ³
4+50	9.6	383.3	380.0	C3 ³
5+00	8.4	384.5	381.0	C3 ⁵
5+37 ⁵	7.8	385.1	381.8	C3 ³
5+50	7.2	385.7	382.0	C3 ³
5+55	6.2	386.7		
6+00	5.9	387.0	383.2	C3 ⁸
6+50	4.7	388.2	384.2	C4 ⁰
6+62 ⁵	4.3	388.6	384.6	C4 ⁰
7+00	3.1	389.8	385.2	C4 ⁵
7+05 G.V. By City	3.1	389.8	385.2	C4 ⁵
7+15 END WORK - 8" X 6" REDUCE	3.0	389.9	385.4	C4 ⁵⁺
BM	3.80	392.89	389.09	

N.E. COR. W. MTN. VIEW & ADAMS AVE

WATER METERS
 0+92 NLY 0+86 S.
 1+59 NLY
 1+64 SWLY
 2+16 SWLY

3+25 W.
 3+67 W.
 4+24 W.
 4+81 E.
 4+92 W.
 5+25 E.
 5+64 W.
 5+80 E.
 6+06 W.
 6+30 E.

WALTON PLACE
 ALLEY BLK. 60 TO OHIO ST.
 ⑤ STK'S & GRD 6" A.C. MAIN

BM	2.66	394.21	391.55
TP	4.20	392.15	6.26 387.95
0+05 BEGIN WORK - EXIST. TEE	4.8	387.4	383.5
0+10 CITY CONN. TO EXIST. G.V.	5.0	387.2	383.4
0+50	5.5	386.7	383.0
1+00	5.5	386.7	382.8
1+50	5.7	386.5	382.6
1+85 G.V. BY CITY	5.7	386.5	382.5
1+70 6" TEE - G.V. S. OF TEE BY CITY	5.7	386.5	382.4
1+70 G.V. 5' LT.	5.7	386.5	382.4
TP	4.16	387.99	
GK. BM			

WATER METERS
 (METERS BEHIND EXIST. CL.)

0+23 N.

0+58 N.

0+58 S.

1+09 N.

1+17 S.

1+44 N.

1-26-56
 SHREVE
 MARTELL
 KEMP
 SMITH

TOP S.E.F.H. BOUNDARY & MADISON.

C3² ± NOT MKD

C3⁸

C3²

C3²

C3²

C4²

C4² ±

C4² ±

" 3070"

" 3064"

" 3061"

" 3060"

" 3057"

" 3052"

MEADE AVE,
36th TO 35th
⑤ STK'S & STD 6" A.C. MAIN

1-26-56
SHADEY
MARELL
KEMP
SMITH

31

NW B.D. WILSON & MEADE

BM	3.76	391.96	388.20			
0+25 BEGIN WORK		6"x6" CROSS & 6"x4" REDUCER	5.1	386.9	382.8	CA ¹ ± NOT MK'D
0+30 G.V. BY CITY			5.0	387.0	382.8	CA ²
0+50			4.9	387.1	383.0	CA ¹
0+62 ⁵			4.8	387.2	383.1	CA ¹
1+00			4.7	387.3	383.3	CA ²
1+50			4.4	387.6	383.6	CA ²
1+62 ⁵			4.4	387.6	383.6	CA ²
2+00			4.3	387.7	383.6	CA ¹
2+50			4.4	387.6	383.7	CA ²
3+00			4.3	387.7	383.7	CA ²
3+25			4.3	387.7	383.7	CA ²
3+50 ⁵		BY CITY				
3+50 ⁵ 6"x6" CROSS - G.V. SIDE CROSS			4.3	387.7	383.6	CA ¹ ± NOT MK'D
3+50 G.V. 5'50.			4.3	387.7		CA ¹
3+87 ⁵			4.2	387.6	383.4	CA ²
4+00 TP	4.51	392.20	4.27	387.69	383.4	CA ²
4+50			4.6	387.6	383.3	CA ²
5+00			5.0	387.2	383.2	CA ²
5+50			5.1	387.1	383.0	CA ¹
6+00			5.3	386.9	382.9	CA ²
6+50			5.6	386.6	382.8	CA ²

NOTE: MOVED PIPELINE
LOCATION TO BE 5'50. &
MEADE AVE.

MEADE AVE.
(CONT'D)

32

392.20

6+72	6 V. BY CITY	5.5	386.7	382.7	CA ⁰
6+77	6"x6" CROSS-6"x4" REDUCER BY CITY	5.5	386.7	382.7	CA ⁰ ± NOT MK'D
CK BM		5.28	386.92	= 386.81	N.W.B.P. 35 th & MEADE
TP	4.58	392.47	4.31	387.89	
CK BM		4.28	388.19	= 388.20	N.W.B.P. WILSON & MEADE

WATER METERS
(METERS BEHIND EXIST. CB.)

1+40 N.	" 4403"
1+62 S.	" 3579"
2+01 S.	" 3565"
2+50 N.	" 3558"
2+78 S.	" 4393"
2+90 N.	" 3554"
3+99 S.	" 4396"
4+30 N.	" 3582"
4+50 S.	" 3533"
4+90 S.	" 3522"
5+01 N.	" 3522-28"
5+53 S.	" 3519"
5+54 N.	" 3518"
5+83 S.	" 3510"
5+89 N.	" 4385"
6+19 N.	" 4393"
6+24 S.	

DELTA ST.
45th TO 46th ST.
③ STK'S. & BRD. FOR 12" A. C. MAIN.

1/30/56

SHOREY
MARTELL
KEMP

NAIL IN P.P. 0+30 30' LT.

BM	10.97	71.98	61.01	
0+40 BEGIN WORK-EXIST. 0+30 12" X 6" CROSS			57.1	
0+45 0+45 12" G.V. BY CITY	10.7	61.3	57.2	04 ¹
0+50 0+40 45° BEND BY CITY	10.6	61.4	57.3	04 ¹
0+68 ³⁰ BK. = 0+63 AH 45° BEND	9.0	63.0	57.5	05 ⁵
1+00	8.2	63.8	58.8	05 ⁰
1+50	6.6	65.4	60.2	05 ²
2+00	5.4	66.6	61.6	05 ⁰
2+50	4.0	68.0	63.0	05 ⁰
2+75	3.4	68.6	63.7	04 ²
3+00	2.9	69.1	64.2	04 ²
3+25	2.5	69.5	64.6	04 ²
3+75	1.7	70.3	64.8	05 ³
4+00	1.7	70.3	64.7	05 ⁰
4+50 TP 2.85 70.67	4.6	67.82	64.5	05 ³
4+75	3.9	66.8	64.3	02 ⁵
5+00	4.3	66.4	63.8	02 ⁶
5+50	5.2	65.5	63.0	02 ⁵
6+00	6.2	64.5	62.1	02 ⁴
6+50	5.2	65.5	62.0	03 ⁵
6+53 F.H. TRK 4" PLUG	5.5	65.2	62.0	03 ²
③	7.5	63.2		
OK. BM.	9.66	61.01	=61.01	

NET MK'D

C₁² F₁² (0.7)

DELTA ST.
(CONT'D)

1/30/56
SHOREY
MARELL
KEMP
SMITH

34

WATER METERS
71.98

0+42 S.	9.3	62.7	62.2	C0 ⁵	"4503"
0+73 N.	9.6	62.4	61.9	C0 ⁵	"4506"
0+88 S.	8.5	63.5	63.3	C0 ²	"4509"
1+30 N.	7.5	64.5	63.6	C0 ²	"4512"
1+72 N.	5.8	66.2	65.0	C1 ²	"4520"
2+06 N.	5.3	66.7	65.9	C0 ³	"4524"
2+49 N.	4.4	67.6	67.3	C0 ³	"4530"
3+39 S.	2.0	70.0	69.0	C1 ²	"4535"
3+65 N. METER NOT SHOWN ON PLANS	1.5	70.5	69.5	C1 ²	"4566"
5+09 N. " " 70.67 " "	1.8	68.9	68.8	C0 ⁶	
5+36 S.	7.5	63.2	63.0	F4 ⁸	"4589"

LINWOOD ST.
WITHERBY ST. SLY 400'
④ STR'S & GBD. 4" A.C. MAIN
0+00 = NLY LINK. WITHERBY

1-30-56
SHOREY
MARTELL
KEMP
SMITH
2" I. PIPE NLY WITHERBY

BM	12.35	185.61	173.26		
TP	8.56	192.32	185	183.76	
0+30			5.9	186.4	178.6
0+68			6.9	185.4	173.2
1+00			6.2	186.1	177.4
1+50			3.7	188.4	182.0
2+00			1.8	190.5	184.1
2+50			3.8	188.5	184.5
2+75			2.7	189.6	185.2
TP	11.87	204.18	0.01	192.31	186.6
3+00			16.2	194.0	187.3
3+50			3.2	201.0	192.3
4+00			1.5	202.7	198.4
TP	7.23	209.74	1.67	202.51	197.7
4+50			0.6	209.1	201.7
5+80 End Work			0.5	209.2	202.1
5+24.2 = End proposed paving.					
CK. Ch. GBD. STAKE			5.86	203.88	

C7⁸
C12²
C6⁵ C8³
~~C6²~~ C6⁶
C6⁴
C4⁹
C4⁴
~~C7³~~ C7⁴
~~C6⁷~~ C8⁷
~~C7³~~ C4³
C7⁴
C7⁴

NOTE: 4" A.C. MAIN IS
102.40' ELY. OF E. OF
HAYDEN WAY & 22' W. OF E/L
LINWOOD ST.

0+80 MK'D F1⁵ = 204.93 = 205.10 Ch. GBD.

ELEV. TOP 6" A.C. MAIN
CASTANA & EUCLID

1-30-56
SHOKEY
MARTELL
KEMP
SMITH

36

BM	10.68	143.65	132.77
11+64 TOP F.F. TEE	5.36	138.29	137.3
11+91 TOP 6" A.C. MAIN	6.37	137.28	136.8
11+91 GROUND	3.20	140.45	
CKY Ch. GRD	0.16	143.49	

& LET EUCLID & GROVELAND

} GRD. PER WATER PLANS
BOTTOM OF PIPE

GR-19 - DWG. No. 6698-W
SHEET 2 OF 2
F.B. 895

TOP 2" HUB MK'D 0400 5' BK. PROP. MK'D C₂³

OHIO ST.
MADISON TO ADAMS AVE
③ STK'S & GRD. 6" A.C. MAIN

2-1 56
SHOREY
MARTELL
KEMP

37

BM	2.26	393.81	391.55	
0+30	BEGIN WORK	EXIST. CROSS	5.0	388.8
		12"x6"		385.0
0+35	G.V. BY CITY		4.8	389.0
0+50			4.8	389.0
1+00			4.7	389.1
1+50			4.4	389.4
2+00			4.3	389.5
2+50			4.2	389.6
3+00			4.0	389.8
3+50			3.9	389.9
4+00			3.7	390.1
TP	5.25	395.34	3.72	390.09
4+50			5.1	390.2
5+00			5.0	390.3
5+50			4.9	390.4
6+00			4.7	390.6
6+50	WHITE		4.4	390.9
③			4.4	390.9
6+99	5' G.V. BY CITY		4.7	390.6
7+00	5' END WORK	EXIST. CROSS	4.6	390.7
		12"x6"		386.5
TP	3.92	394.17	5.09	390.25
CK. BM			4.82	389.35 = 389.38

S.E.F.H. BOUNDARY & MADISON

C3²⁺ - NOT MK'D

C4²

C3²

C3²

C4¹

C4¹

C4¹

C4²

C4²

C4³

C4³

C4³

C4³

C4⁴

C4⁶

C4⁶ FO^L

C4^L

C4²⁺ NOT MK'D

S.E. COR. 30th & ADAMS

OHIO ST.
(CONT'D)

38

WATER METERS
(METERS BEHIND EXIST. CB.)

1+70 E.	" 4611"
1+95 E.	" 4615"
1+95 W.	" 4616"
2+29 W.	" 4626"
2+59 E.	" 4625"
2+78 E.	" 4635"
2+85 W.	" 4630"
2+95 E.	" 4635 1/2"
3+30 E.	" 4641"
3+33 W.	" 4640"
3+70 W.	" 4648"
3+89 E.	" 4647"
4+23 W.	" 4656"
4+42 E.	" 4655"
4+65 E.	" 4675"
4+72 W.	" 4664"
5+20 E.	" 4675"
5+28 W.	" 4674"
5+58 E.	" 4679"
5+74 W.	" 4678"
6+11 W.	" 4684"
6+41 E.	" 3051"
6+50 W.	" 3043"

MARIPOSA ST.
 MARIPOSA PL. TO 460' N. OR.
 ⑤ STR'S & G.B.D. 6'A.C. MAIN

2-3-56
 SHOREY
 KEMP
 SMITH

39

TBM	6.38	207.79	201.41
0+50 BEGIN WORK	5.2	202.6	198.7
1+00 E.H. TEE	5.3	202.5	198.3
⑤	3.6	204.2	
1+50	4.7	203.1	198.5
2+00	4.8	203.0	198.8
2+50	4.0	203.8	199.1
3+00	3.7	204.1	199.4
3+50	4.0	203.8	199.6
4+00	4.4	203.4	199.3
4+50	5.1	202.7	198.4
5+00	6.4	201.4	196.3
5+40 6" CAP & 2" B.O. ASSEY	8.7	199.1	193.9
OK, TBM	6.3		= 201.41

W. BK.
 NAIL IN P.P. 35' LT. 0180 (P. 875-56)

C3 ²			
C4 ³			(202.4) (STR'D F.H. 9 ⁵ E.)
C5 ² C1 ⁸			
C4 ⁶			
C4 ²			
C4 ²			
C4 ²			
C4 ²			
C4 ¹			
C4 ³			
C5 ¹			
C5 ²			

WATER METERS
 207.79

1+28 W.	6.1	201.7	201.8	F0 ^L	"1446"
1+79 E.	4.1	203.7	202.7	C1 ²	"1461"
2+83 E.	3.6	204.2	203.2	C1 ⁰	"1455"
2+65 W.	5.3	202.5	202.6	F0 ^L	"1448"
3+48 E.	3.6	204.2	203.6	C0 ⁶	"1443"
3+81 W.	5.2	202.6	203.0	F0 ⁴	"1438"
4+23 E.	4.1	203.7	202.9	C0 ⁸	"1435"
4+60 W.	5.9	201.9	201.3	C0 ⁶	"1430"
4+66 E.	5.5	202.3	201.9	C0 ⁴	"1425"
4+83 W.	6.2	201.6	200.5	C1 ^L	"1426"

(STR'D METERS)
 (10⁵ E. & 30⁵ W.)

MARIPOSA PLACE
 MARIPOSA ST. TO 545 EAST
 (S) STK'S & GRD. 6" A.C. MAIN

2-6-56
 SHOREY
 MARTELL
 KEMP
 SMITH

40

TBM	10.46	211.87	201.41		
0+35 6" TEE & PLUG			9.7 202.2	198.7	C3 ⁵
0+50			9.2 202.7	199.4	C3 ³
0+75			8.0 203.9	200.5	C3 ⁴
1+00			6.8 205.1	201.5	C3 ⁶
1+50			5.0 206.9	203.5	C3 ⁴
2+00			3.5 208.4	204.9	C3 ⁵
2+50			2.5 209.4	205.8	C3 ⁶
3+00			1.5 210.4	206.8	C3 ⁶
3+50			0.9 211.0	207.3	C3 ⁷
3+75 P	12.13	223.50	0.50 211.37	207.7	C3 ⁷
4+00			11.8 211.7	208.3	C3 ⁴
4+25			11.1 212.4	209.0	C3 ⁴
4+50			10.1 213.4	210.0	C3 ⁴
4+75			8.9 214.6	210.9	C3 ²
5+00			7.8 215.7	212.0	C3 ²
5+25			6.7 216.8	213.1	C3 ²
5+45 END WORK	{ 8" x 6" REDUCER & 6" G.V. BY CITY		5.0 218.5	214.0	4 ⁵ ± NOT MK'D
CK. TBM			7.47 216.03	216.04	NAIL IN GUY POLE 44 FT. 5415 (F.B. 875-58)

WATER METERS

1+03 N.	211.87	6.8	205.1	205.3	F0 ²
3+36 N.		1.3	210.6	211.0	F0 ⁴
3+82 N.	223.50	12.1	211.4	211.6	F0 ³
4+22 N.		11.5	212.0	212.6	F0 ⁶

"1495"

(STK'D WATER METERS)
 12³ No. 1.

METER NOT SHOWN ON PLANS

"5650"

ELEV. ON TOP WATER MAIN ON
FRANKFORT ST., MORENA BLVD. ELY.
0+00 = E MORENA BLVD.

BM	2.11	12.15	10.04	
TP	7.12	12.61	6.66	5.49
0+50	TOP PIPE		11.7	0.9
0+50	GROUND		7.6	05.0
2+50	TOP PIPE		9.7	2.9
2+50	GROUND		5.3	07.3
CK. PK. NAIL IN P.P.			4.50	8.11 = 8.14
3+63	TOP PIPE		6.2	6.4
3+69	GROUND		1.5	11.1
TP	9.23	20.97	0.87	11.74
4+29	TOP PIPE		11.4	9.6
4+29	GROUND		07.1	13.9
4+68	TOP PIPE		9.5	11.5
4+68	GROUND		4.9	16.1
5+08	TOP PIPE		7.1	13.9
5+08	GROUND		2.3	18.7
CK. PK. NAIL IN P.P.			12.85	8.12 = 8.14

BP TOP INLET TECOLOTE CREEK CULVERT

0+00 = City Edge Disc E Morena
& Frankfort.

0+36 = Edge existing part Morena.

E of pipe 15' Nly of So prop line
& 34' Sly of Nor prop line

ELEV. ON TOP WATER MAIN IN
ALLEY E. OF 34th & NORTH OF
ARTHUR ST.

0+00 = N/L ARTHUR ST.

BM 4.31 399.42 395.11

NWBP HAWLEY & ARTHUR

0+40 Top Pipe 6.92 392.50

CK. BM 4.31 395.11 = 395.11

32ND ST.
 BEECH TO CEDAR
 (10) STK'S & GRD. 8" A.C. MAIN
 (1)

B.M.	0.65	232.12		231.47	
TP	1.76	222.77	11.11	221.01	
1+88 2" B.O. Assy			8.5	214.3	207.6
2+00			8.4	214.4	207.8
2+25			6.2	216.6	213.1
2+50			4.2	218.6	215.1
TP	10.60	233.18	0.19	222.58	
3+00			9.5	223.7	218.8
3+50			5.1	228.1	222.5
3+75			3.9	227.3	224.3
3+88 F.H. TEE			3.7	227.3	225.0
(3)			2.7	230.5	
3+97 8" G.V. By City			3.9	229.3	225.6
4+02 END WORK			3.6	229.6	225.7
CK. B.M.			1.70	231.48 =	231.47

WATER METERS
 222.77

1+66 E.			12.7	210.1	210.1
1+67 E.			11.1	211.7	211.7
2+22 E.			4.1	218.7	218.7
2+46 E.			2.1	220.7	220.7
	233.18				
3+18 E.			3.6	229.6	229.6
3+50 E.			3.7	229.5	229.5

2+56
 SHARBY
 KEMP
 MARTELL
 SMITH

43

NEED 32ND & CEDAR

C6 ²					212.2
CA ⁶					215.0
C3 ⁵					217.9
C3 ⁵					219.9
CA ²					224.8
C5 ⁶					229.3
C5 ⁶					229.6
CA ³					
C5 ⁵					
CO ³					
C3 ² ±					NET MK'D
C3 ² ±					NET MK'D

(SET METERS TO PROP. & GRD. TO EXIST. GROUND)

"C" ST.
 34th TO WABASH FREEWAY
 @ STK'S & BED. 6" A.C. MAIN

2/10/50
 SHOREY
 MARTELL
 KEMP
 SMITH

44

BM	0.26	138.84		137.88		N.E. CONC. MON. 34 th & "C"
0+40 BEGIN WORK			9.8	129.0	124.3	C4 ² ± NOT MK'D
0+45 G.V. BY CITY			9.0	129.8	124.3	C5 ⁵ ± NOT MK'D
0+50			8.6	130.2	124.3	C5 ²
0+62 ⁵			7.6	131.2	124.3	C6 ²
1+00			7.1	131.7	123.4	C8 ³
1+25			10.5	128.3	122.8	C5 ⁵
HP	0.08	125.67	13.25	125.59		
1+50			1.4	124.3	119.0	C4 ⁵
1+62 ⁵			3.7	122.0	117.3	C4 ²
1+75 @ LT.			5.8	119.9	114.2	C5 ²
@ RT.			7.0	118.7		C4 ⁵
1+87 ⁵ @ RT.			10.0	115.7	112.2	C3 ⁵
@ LT.			9.3	116.4		C4 ²
2+00 @ RT.			10.1	115.0	111.7	C3 ²
2+12 ⁵ @			10.0	115.7	112.4	C3 ³
2+37 ⁵ @ LT.			3.5	122.2	117.0	C5 ²
@ RT.			4.1	121.6		C4 ⁰
2+50			1.4	124.3	118.4	C5 ²
HP	5.79	130.58	0.88	124.79		
2+75			2.7	127.9	118.7	C9 ²
3+00			2.6	128.0	117.7	C10 ³
3+37 ⁵			6.4	124.2	114.7	C9 ⁵
HP	0.50	117.74	13.34	117.24		
3+87 ⁵			4.5	113.2	108.0	C5 ²
HP	0.36	105.08	13.02	104.72		
4+25			1.2	103.9	99.8	C4 ²

MK'D LATH AT 2+85 AT NLY.
 EDGE STATE HWY. IMPROVEMENT
 3/5/58 TOP OF CUT
 SHOREY

"C" ST.
(CONT'D)

45

105.08

4450		10.1	95.0	96.8	C3 ³
	TP 1.43	94.30	12.21	92.87	
	STR 0.42	81.91	13.81	81.49	
4487		6.4	75.5	72.3	C3 ²
5400	1 1/4" VERT. BEND	10.9	71.0	67.0	C4 ⁰
5440	6" CAP & 2" B.O. ASSY.	15.7	66.2	61.0	C5 ²
CK BM		9.90	72.01 = 72.03		NAIL IN GUARD RAIL ACCESS ROAD FB. 9/11-39

WATER METERS

138.84

0493 S.		9.5	129.3	127.4	C1 ²
	130.58				
2483 N.		10.2	130.8	122.5	C8 ³
	117.74				
3487 S.		7.2	112.5	112.0	F1 ⁵
	81.91				
4495 S. NO METER		9.3	72.6	69.3	C3 ³

(SET METERS 12⁵ 50.4)
32⁵ NOV.

SEA BREEZE
 PITOMAC TO ALLEGHANY
 @ STK'S & BLD. 8" A.C. MAIN

2/10/56
 SHOREY
 KEMP
 MARTELL

46

S.W.

BM	2.24	276.73	274.49		
0+80 BEGIN WORK	7.87	268.86	264.9	C4 ^e	
0+89 END EXIST. MAIN			264.9		
1+00	7.4	269.3	265.3	C4 ^e	265.1
1+50	6.1	270.6	266.5	C4 ^l	266.2
2+00	4.9	271.8	267.7	C4 ^l	267.1
2+50	3.8	272.9	268.8	C4 ^l	268.2
3+00	2.6	274.1	270.0	C4 ^l	268.8
3+25	1.8	274.9	270.6	C4 ³	269.8
3+35 END EXIST. MAIN	1.8	274.9	271.2	C3 ^l	
3+41 ² G.V. By City	1.4	275.3	271.4	C3 ²	
3+46 ² 12" X 8" TEEL					
3+56 12" X 8" REDUCER	1.3	275.4	271.5	C3 ²	
3+87 8" G.V. & 8" X 4" REDUCER	2.77	273.96	271.4	C2 ⁶⁺	NOT MK'D
	2.25	274.48	274.49		

BOTTOM OF PIPE AS
 INSTALLED 2/14/56

EUREKA ST.
 LAURETTA TO RUBY
 @ STR'S & GED. G.A.C. MAIN

2/14/56
 SHOREY
 KEMP
 MARTELL
 SMITH

47

BM	11.57	122.99		111.42	
0+15 BEGIN WORK			15.8	107.2	102.0 C5 ² NOT MK'D
0+20 6" G.V. BY CITY			15.3	107.7	102.1 C5 ⁶ NOT MK'D
0+40 ³⁹ APT.			14.4	108.6	102.3 C6 ³
0+50			13.0	110.0	102.4 C7 ⁶
1+00			7.0	116.0	107.0 C9 ²
1+50			2.4	120.6	111.8 C8 ⁸
TP 12.53	134.23		1.29	121.70	
1+25			10.8	123.4	112.3 C11 ^L
2+00			8.8	125.4	116.2 C9 ²
2+50			5.5	128.7	121.0 C7 ^Z
2+93 ⁸⁷ 6" CROSS			2.5	131.7	125.3 C6 ⁴
3+00			2.2	132.0	125.9 C6 ^L
TP 12.00	144.06		2.17	132.06	
3+50			8.4	135.7	128.9 C6 ²
4+00			4.9	139.2	131.3 C7 ²
4+50			2.7	142.0	133.7 C8 ³
TP 6.61	147.29		1.38	142.68	
5+00			4.6	144.7	136.1 C8 ⁶
5+50			4.8	144.5	138.5 C6 ²
5+69 ³ 11/4 BEND			4.0	145.3	138.5 C6 ⁸
5+72 ³ END WORK					138.5
CK TBM			5.24	144.05 = 144.02	F.B. 924-5

RUBY ST.

GOSHEN TO EUREKA
 @ STK'S & GRD. G.A.C. MAIN

BM	3.75	183.63		179.88	
0+55	BEGIN WORK		1.8	181.8	175.6
1+00			6.5	177.1	169.9
1+25			11.0	172.6	166.7
TP	0.53	170.91	13.25	170.38	
1+50			1.8	169.1	163.3
2+00			10.2	160.7	156.4
TP	0.35	158.11	13.15	157.76	
2+50			3.2	154.9	149.6
3+00			9.6	148.5	142.8
3+20	G.V. 5.07	150.20	12.98	145.13	139.1
3+25	6" TEE		5.7	144.5	138.5
3+35			7.6	142.6	137.8
3+61	6" CAP & 2" B.O. Assy.		11.9	138.3	133.2
CK. TBM			6.15	144.05 = 144.02	

2/14/56
 SHARPEY
 MARTELL
 KENDR
 SMITH

48

PK NAIL IN R.P. APPROX 20' N.E. RUBY ST. (F.B. 224-2)

C6² ± NOT MK'D

C7²

C5²

C5²

C4³

C5³

C5²

C6⁰

C6⁰

C5²

C5²

(F.B. 224-5)

MILDRED ST.
EUREKA TO HUENEME ST.
@ STRIS & BRO. G.A.C. MAIN

2/15/56
SHOREY
MARTELL
KEMP
SMITH

E. RIM SEW. 10' LT. 4+40 EUREKA ST. (E.B. 924-8)

TBM	5.85	145.07	139.22	
0+35	³⁴ BEGIN WORK		13.7 131.4	125.3 C6 ⁴
0+41	6" G.V.		13.7 131.4	125.6 C5 ⁸
0+43	11/4" BEND		13.2 131.9	125.7 C6 ²
0+50			11.8 133.3	127.0 C6 ³
0+58	F.H. TEE		10.0 135.1	128.3 C6 ²
	Ⓞ		10.5 134.6	C6 ² C3 ²
1+10			2.7 142.4	135.0 C7 ¹
	TP 12.93	157.78	0.22 144.85	
1+25			12.9 144.9	139.0 C5 ²
1+50			10.3 147.5	143.0 C4 ⁵
2+00			5.6 152.2	148.5 C3 ²
2+50			1.7 156.1	152.2 C3 ²
	TP 12.73	170.21	0.30 157.48	
3+00			2.5 160.7	157.3 C3 ⁴
3+50			4.7 165.5	162.2 C3 ³
3+83	CONN. TO EXIST. 6" STUB		2.1 168.1	164.0 C4 ⁴
	TP 12.97	182.58	0.60 169.61	
4+34	" " " " "		11.5 171.1	167.0 C4 ⁴
4+43	F.H. TEE		11.0 171.6	167.4 C4 ²
	Ⓞ		12.4 170.2	C2 ⁸ F1 ² (171.3)
4+50			10.6 172.0	168.0 C4 ⁰
5+00			6.9 175.7	171.0 C4 ⁷
5+50			4.2 178.4	175.0 C3 ⁴
	TP 12.81	194.49	0.90 181.68	
6+00			7.2 187.3	182.9 C4 ⁴

(175.10)

MILDRED ST.
(CONT'D)

TP	12.10	194.49 206.12	0.47	194.02		
6+50			8.5	197.6	191.6	C6 ⁰
7+00			0.6	205.5	209.8	C4 ²
TP	12.44	217.89	0.67	205.45		
7+50			2.8	215.1	209.8	C5 ³
TP	9.48	226.55	0.82	217.07		
7+75			2.3	217.3	213.3	C4 ⁰
8+00			8.0	218.6	215.0	C3 ⁶
8+36			5.0	221.6	217.7	C3 ²
8+40 B.C.			4.8	221.8	217.7	C4 ¹
8+62			3.4	223.2	217.7	C5 ⁵
8+93 6" CAP-2" B.O. ASSY			3.6	224.0	215.2	C8 ⁸
CK. TBM			1.30	225.25 = 225.26		TBM ON E. HUB (FR. 224-9)

WATER METERS

1+82 S.	157.78	149.7	150.1	F0 ⁴	SET METERS 12 ⁵ So. & 32 ⁵ Nor.	
1+59 S.		147.6	147.8	F0²	"5825" NOT SHOWN ON PLANS	
1+83 N.		6.0	151.8	151.2	C0 ⁶	"5826"
	170.21					
2+44 N.		12.2	158.0	157.0	C1 ⁰	"5840-42"
2+92 N.		8.6	161.6	162.0	F0 ⁴	"5850-52"
	182.58					
5+35 S.		6.1	176.5	177.6	F1 ¹	"5717-21"

GLENDORA ST.
REVERE TO FAC. HYW
③ STR'S & GRD. 6" A.C. MAIN

2-16-56
SHOREY
MARTELL
KEMP
SMITH

51

BM	1.15	16.39	15.24	
0+25		3.5	12.9	8.2
0+50		4.4	12.0	7.7
1+00		5.8	10.6	6.6
1+49 2" B.O. Assy.		6.9	9.5	5.6
CK. BM	1.15	15.24	= 15.24	

WATER METER

1+00 S.	16.39	5.8	10.6	10.6	C0 ⁰
---------	-------	-----	------	------	-----------------

BUNKER HILL
 REVERE TO PAC. HYW.
 (3) STR'S & GED. 6" A.C. MAIN

2-16-56

52

TBM	2.59	18.83 ✓	16.24		
0+25			0.9	17.9	13.2 C4 ²
0+50			1.1	17.7	12.6 C5 ¹
1+00			2.6	16.2	11.5 C4 ²
1+50			4.1	14.7	10.4 C4 ³
2+00			5.6	13.2	9.2 C4 ⁰
2+25			6.4	12.4	6.4 C6 ⁰
2+50			7.1	11.7	6.0 C5 ²
3+00			8.1	10.7	04.2 4.9 C5 ³ C6 ⁵
3+26			8.6	10.2	03.2 4.0 C4 ¹ C7 ⁰
3+46	6" Cap - 2" B.O. Assy.		8.7	10.1	4.0
CK. BM			2.60	16.23 = 16.24	

(F.B. 924-11)
 CONC. MAN. S.W. COR. BUNKER HILL & REVERE

2/23/56 B.C. 244

3+325 Top 30" Sewer 07.8
 3+425 Top 16" G25 05.7

GALVESTON ST.
 JELLETT TO INGLEF.
 ③ STKS & GRD. G.A.C. MAIN

2-16-56
 SHOREY
 MARTELL
 KEMP
 SMITH

53

BM	5.62	146.45	140.83			Elev. Ditch Dug ^{1/23/56}
0+86 City-Conn. to Exist. 6" C.I.	6.8	139.7	134.2	5+ Not MK'D		-84 - 131.3 ✓
1+00	6.6	139.9	132.4 137.8	5+ C75 ✓		-83 - 131.6 ✓
1+50	5.8	140.7	135.0 136.5	5+ C57 ✓		-59 - 134.8 ✓
2+00	4.8	141.7	137.8	C3? ✓		-54 - 136.3 ✓
2+50	3.7	142.8	139.1 135.2	5+ C37 ✓		-39 - 138.9 ✓
3+00	2.2	144.3	140.5	C3 ⁸		
3+50	0.5	146.0	142.1	C3 ²		
TP 6.45 152.84	0.06	146.39		C3 ²		
4+00	5.2	147.6	143.7	C3 ²		
4+20 F.H. TEE	4.7	148.1	144.4	C3 ²		
③	4.5	148.3	148.7	FOE C3 ²		
4+50	3.7	149.1	145.4	C3 ²		
4+60 6" Cap-2" B.O. Assy.	3.3	149.5	145.7	C3 ⁸		
CK. BM	12.00	140.84 = 140.83				

WATER METERS

146.45

0+84 W.	9.5	137.0	134.2	C2 ⁸	"2504"
1+21 E.	6.1	140.4	137.6	C2 ⁸	"2505"
1+53 W.	6.7	139.8	139.1	C0 ²	"2514"
1+89 E.	5.0	141.5	141.3	C0 ²	"2517"
1+97 W.	4.0	142.5	141.9	C0 ²	"2524"
2+51 W.	0.2	146.3	143.6	C2 ⁷	"2530"
3+17 E.	1.7	144.8	143.4	FO6	"2537"
3+22 W.	+0.9	147.4	145.9	C1 ⁵	"2536"
3+57 E.	0.4	146.1	146.7	FO6	"2547"
4+00 E.	5.3	147.5	148.1	FO6	"2553"
4+31 W.	2.7	150.1	149.5	C0 ⁶	"2554"

35th ST.
"E" ST. TO PICKWICK ST.
③ STR'S & GRD. 6" A.C. MAIN

2/17/56
SHOREY
KEMP
MARTELL
SMITH

54

BM	5.40	57.27 10" X 6" TAP SLEEVE	51.87		NWBP 35 th & "E" ST.
0+2.5 BEGIN WORK - BY CITY	5.7	51.6	47.7	C3 ² ±	NOT MK'D
0+30 Tap G.V. BY CITY	5.5	51.8	47.7	C4 ¹ ±	NOT MK'D
0+50	5.6	51.7	47.8	C3 ²	
1+00	5.1	52.2	48.0	C4 ²	
1+50	5.4	51.9	48.2	C3 ¹	
2+00	4.9	52.4	48.3	C4 ¹	
2+50	4.6	52.7	48.5	C4 ²	
2+65 F.H. TEE	4.6	52.7	48.5	C4 ²	
⑤	4.6	52.7		C4 ²	F0 ²
2+70 G.V.	4.4	52.9	48.5	C4 ⁴	
2+85 90° BEND - BY CITY	4.4	52.9	48.6	C4 ³ ±	NOT MK'D
CK BM					
		WATER METERS 57.27			
1+60 W.	5.3	52.0	52.3	F0 ³	
2+56 E.	4.7	52.6	53.3	F0 ¹	
		SET METERS 10 ^S E. & 30 ^S W.			

ISLAND AVE.
BANCROFT ST, Ely 110'
③ STK'S & BRED. C.A.C. MAIN

2/2/56
SHOREY
KEMP
MARTEN
SMITH

55

BM 2.37 69.54 67.17

1/2" I. P.N. S.E. COR. ISLAND & BANCROFT

0+20 BEGIN WORK ^{90° BEND} 0.8 68.7 68.2

C8⁵ (10) C8⁵

0+25 1.1 68.4 59.8

C8⁶ (10) C8⁵

0+50 4.6 64.9 55.0

C9² (10) C10³

TP 2.33 59.10 12.77 56.77

0+75 3.8 55.3 50.2

C5¹ (10) C6⁶

0+88⁵ 9.3 49.8 46.5

C3³ (16) C3³

1+00 11.7 47.4 44.7

C2⁷

TP 1.00 46.93 13.17 45.93

1+25 2.6 44.3 41.4

C2²

1+39⁵ 4.2 42.7 40.0

C2⁷ ± NOT MK'D

CK. BM 11.62 35.31 = 35.33

BANCROFT ST.
ISLAND TO "J" ST.
③ STRIS + 6ED. 6" A.C. MAIN

2/21/5
SHOREY
MARTELL
KEMP
SMITH

56

1/2" I. R. S.E. COR. BANCROFT & ISLAND

BM 9.17 76.34 67.17

0+40 BEGIN WORK 7.4 68.9 60.2 C8²

0+50 7.4 68.9 60.5 C8⁴

1+00 6.8 69.5 61.8 C7²

1+39 6" G.V. BY CITY 6.8 69.5 62.6 C6⁹

1+44 6" TEE BY CITY 7.0 69.3 62.8 C6⁵

1+50 7.1 69.2 62.6 C6⁶

1+75 8.2 68.1 61.7 C6⁴

2+00 9.0 67.3 61.4 C5⁹

2+50 9.2 67.1 60.6 C6⁵

3+00 8.0 68.3 59.8 C8⁵

3+50 6.3 70.0 59.0 C11⁰

3+64 G.V. BY CITY 5.9 70.4 58.6 C11⁶

3+69 90° BEND BY CITY 5.8 70.5 58.8 C11⁷ ± NOT MK'D

CK. BM 2.16 67.18 = 67.17

WATER METER
76.34

1+10 E 7.6 68.7 65.4 C9³

1+60 E 7.8 68.5 65.4 C3¹

2+63 E 10.6 65.7 63.8 C1²

2+65 W 3.9 72.4 65.2 C7²

Mc LABENS LANE

33RD TO BANCROFT ST.

⑩ 5TH & 6TH 6" A.C. MAIN

BM	2.82	38.15		35.33	
TP	7.69	38.84	7.00	31.15	
0+20	6" X 6" TREE BY CITY		8.6	30.2	26.9
0+25	G.V. BY CITY		8.7	30.1	26.7
0+50			8.4	30.4	26.7
0+62			8.2	30.6	26.9
1+00			7.4	31.4	27.8
1+50			6.6	32.2	28.3
2+00			5.6	33.2	28.8
2+50			5.0	33.8	29.3
3+00			4.5	34.3	29.8
3+50			4.4	34.4	30.3
4+00			4.3	34.5	30.8
4+50			3.2	35.6	31.7
4+62			2.6	36.2	32.8
TP	12.64	50.76	0.72	38.12	
5+00			5.3	45.5	40.8
TP	12.25	61.85	5.3	45.5	
5+25			1.16	49.60	52.8
TP	13.14	74.34	5.4	51.5	
			0.65	61.20	65.0
5+50			6.1	68.2	67.2
5+58	45° BEND		2.2	72.1	67.8
5+62	1/4" VEE BEND		0.6	73.7	69.7
TP	3.80	77.58	0.50	73.78	
5+67	45° BEND CONN. TO EXIST. 6" MAIN BY CITY		2.6	75.0	70.0
TP	5.84	74.81	8.01	68.97	
CK. BM			7.54	67.27	- 67.17

NWBP 33RD & ISLAND

C3³⁺ NET MK'D

C3²

C3⁵

C3⁷

C3⁶

C3²

C4⁴

C4⁵

C4⁵

C4¹

C3⁷

C3²

C3⁴

C4²

C4²

C3⁷

C4³

C4⁰

C5¹⁺

NET MK'D

S.E. Prop. PIN ISLAND & BANCROFT

(CONT'D)

McLARENS LANE
(CONT'D)

WATER METERS
38.84

1+54 S	6.2	32.6	32.1	CO ⁵	"3288"
1+98 S	5.5	33.3	32.6	CO ⁷	"3284"
2+39 S	5.0	33.8	33.1	CO ⁷	"3278"
3+16 S	4.6	34.2	33.8	CO ⁴	"3268"
3+39 S	4.4	34.4	34.1	CO ³	"3264"
4+11 S	4.0	34.8	34.9	FO ^L	"3254"
4+68 S	2.2	36.6	36.3	CO ²	

2-21-56
(OK METER GUN'S)

LANDIS ST.
52ND TO OGDEN ST.
③ STK'S 6" 6" 6" 6" A.C. MAIN

2/29/56
SHREY
KEMP
MARTELL
SMITH

S.W. PROP. PIPE LANDIS ST. 52ND ST.

BM	10.80	337.90		327.10	
0+37 ⁵	BEGIN WORK	12.0	325.9	322.2	C3 ⁷ ± NOT MK'D
0+42	G.V. BY CITY	12.0	325.9	322.4	C3 ⁵ ± NOT MK'D
0+50		11.7	326.2	322.8	C3 ⁴
0+65	FILTER	11.0	326.9	323.5	C3 ⁴
③		9.8	328.1		C4 ⁶ C0 ⁰
1+00		9.4	328.5	325.0	C3 ⁵
1+50		6.4	331.5	327.9	C3 ⁶
2+00		3.7	335.2	331.6	C3⁶ C3 ⁵ replaced 2/1/56
2+50	10.49	347.69	0.70	337.20	C3 ¹
3+00		4.9	342.8	338.0	C4 ⁸
3+25		3.9	343.8	338.8	C5 ⁰
3+50		2.8	344.9	339.1	C5 ⁸
4+00		2.9	344.8	339.5	C5 ³
4+50		3.0	344.7	340.6	C4 ¹
4+56	G.V.	2.9	344.8	340.6	C4 ³
4+61	22 1/2 BEND	3.0	344.7	340.6	C4 ¹
4+66	6" X 6" WYE	2.9	344.8	340.8	C4 ⁰
4+77	END WORK - CITY TO EXIST. 6" C.I.	2.6	345.1	341.2	C3 ² ± NOT MK'D
		2.39	345.30		END EXIST. CB. ON N.W. SIDE OGDEN & LANDIS

(CONT'D)

LANDIS ST.
(CONT'D)

60

WATER METERS

1431 S.	337.90	7.4	330.5	330.9	F0 ⁴	
1433 S.		7.2	330.7	331.0	F0 ⁴	"5215"
1457 N.		6.4	331.5	332.4	F0 ²	"5218"
1498 N.		3.4	334.5	335.5	F1 ⁰	"5220"
2401 S.		2.5	335.4	335.8	F0 ⁴	"5225"
	347.69					
2451 S.		8.6	339.1	339.7	F0 ⁶	"5233"
2492 N.		5.3	342.4	341.9	C0 ⁵	"5240"
3450 S.		2.6	345.1	343.1	C0⁰ C1 ⁸ replaced	"5243"
3456 N.		0.6	³⁴⁶⁹ 347.1	343.5	C0⁶ C3 ⁴ ^{3/8/56}	"5248"
4456 N.		2.3	345.4	345.0	C0 ⁴	"5258"

15 RT (5)
335

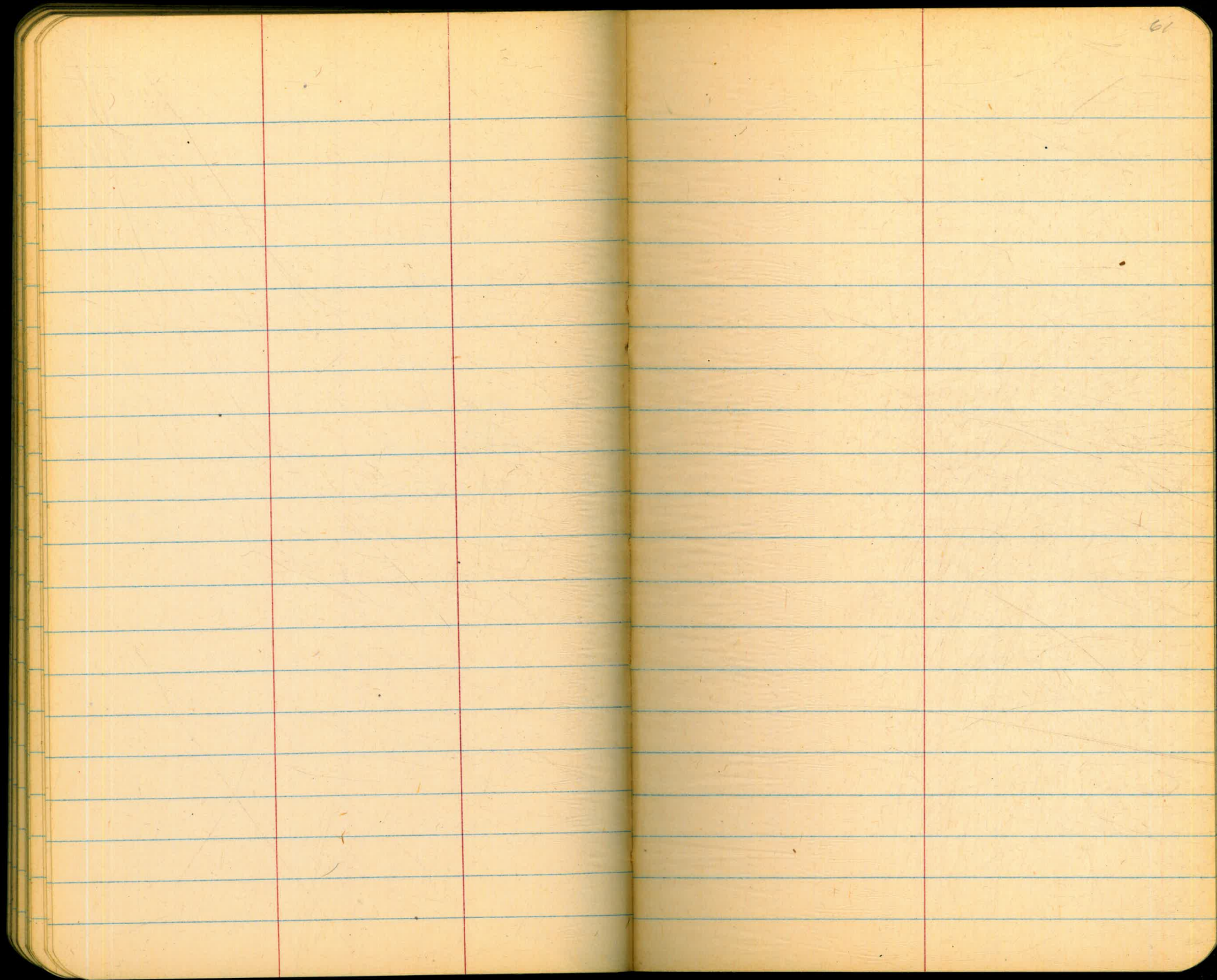

3.5

8.50
2.96
5.54
2.03
3.2

595
29
5471
670
12741

248.40
4.56
143.41
396.37
511
747.37

9.0
5.1
3.9

0.16

5.2

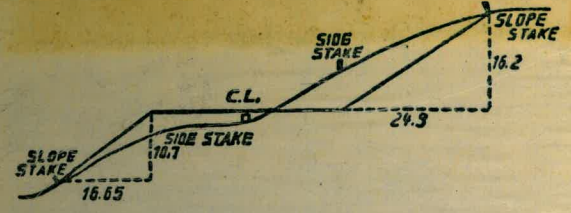

DISTANCES FROM SIDE STAKES FOR CROSS-SECTIONING.
SLOPE 1 1/2 TO 1. ROADWAY OF ANY WIDTH.

	0	.1	.2	.3	.4	.5	.6	.7	.8	.9	
0	0.00	0.15	0.30	0.45	0.60	0.75	0.90	1.05	1.20	1.35	0
1	1.50	1.65	1.80	1.95	2.10	2.25	2.40	2.55	2.70	2.85	1
2	3.00	3.15	3.30	3.45	3.60	3.75	3.90	4.05	4.20	4.35	2
3	4.50	4.65	4.80	4.95	5.10	5.25	5.40	5.55	5.70	5.85	3
4	6.00	6.15	6.30	6.45	6.60	6.75	6.90	7.05	7.20	7.35	4
5	7.50	7.65	7.80	7.95	8.10	8.25	8.40	8.55	8.70	8.85	5
6	9.00	9.15	9.30	9.45	9.60	9.75	9.90	10.05	10.20	10.35	6
7	10.50	10.65	10.80	10.95	11.10	11.25	11.40	11.55	11.70	11.85	7
8	12.00	12.15	12.30	12.45	12.60	12.75	12.90	13.05	13.20	13.35	8
9	13.50	13.65	13.80	13.95	14.10	14.25	14.40	14.55	14.70	14.85	9
10	15.00	15.15	15.30	15.45	15.60	15.75	15.90	16.05	16.20	16.35	10
11	16.50	16.65	16.80	16.95	17.10	17.25	17.40	17.55	17.70	17.85	11
12	18.00	18.15	18.30	18.45	18.60	18.75	18.90	19.05	19.20	19.35	12
13	19.50	19.65	19.80	19.95	20.10	20.25	20.40	20.55	20.70	20.85	13
14	21.00	21.15	21.30	21.45	21.60	21.75	21.90	22.05	22.20	22.35	14
15	22.50	22.65	22.80	22.95	23.10	23.25	23.40	23.55	23.70	23.85	15
16	24.00	24.15	24.30	24.45	24.60	24.75	24.90	25.05	25.20	25.35	16
17	25.50	25.65	25.80	25.95	26.10	26.25	26.40	26.55	26.70	26.85	17
18	27.00	27.15	27.30	27.45	27.60	27.75	27.90	28.05	28.20	28.35	18
19	28.50	28.65	28.80	28.95	29.10	29.25	29.40	29.55	29.70	29.85	19
20	30.00	30.15	30.30	30.45	30.60	30.75	30.90	31.05	31.20	31.35	20
21	31.50	31.65	31.80	31.95	32.10	32.25	32.40	32.55	32.70	32.85	21
22	33.00	33.15	33.30	33.45	33.60	33.75	33.90	34.05	34.20	34.35	22
23	34.50	34.65	34.80	34.95	35.10	35.25	35.40	35.55	35.70	35.85	23
24	36.00	36.15	36.30	36.45	36.60	36.75	36.90	37.05	37.20	37.35	24
25	37.50	37.65	37.80	37.95	38.10	38.25	38.40	38.55	38.70	38.85	25
26	39.00	39.15	39.30	39.45	39.60	39.75	39.90	40.05	40.20	40.35	26
27	40.50	40.65	40.80	40.95	41.10	41.25	41.40	41.55	41.70	41.85	27
28	42.00	42.15	42.30	42.45	42.60	42.75	42.90	43.05	43.20	43.35	28
29	43.50	43.65	43.80	43.95	44.10	44.25	44.40	44.55	44.70	44.85	29
30	45.00	45.15	45.30	45.45	45.60	45.75	45.90	46.05	46.20	46.35	30
31	46.50	46.65	46.80	46.95	47.10	47.25	47.40	47.55	47.70	47.85	31
32	48.00	48.15	48.30	48.45	48.60	48.75	48.90	49.05	49.20	49.35	32
33	49.50	49.65	49.80	49.95	50.10	50.25	50.40	50.55	50.70	50.85	33
34	51.00	51.15	51.30	51.45	51.60	51.75	51.90	52.05	52.20	52.35	34
35	52.50	52.65	52.80	52.95	53.10	53.25	53.40	53.55	53.70	53.85	35
36	54.00	54.15	54.30	54.45	54.60	54.75	54.90	55.05	55.20	55.35	36
37	55.50	55.65	55.80	55.95	56.10	56.25	56.40	56.55	56.70	56.85	37
38	57.00	57.15	57.30	57.45	57.60	57.75	57.90	58.05	58.20	58.35	38
39	58.50	58.65	58.80	58.95	59.10	59.25	59.40	59.55	59.70	59.85	39
40	60.00	60.15	60.30	60.45	60.60	60.75	60.90	61.05	61.20	61.35	40
41	61.50	61.65	61.80	61.95	62.10	62.25	62.40	62.55	62.70	62.85	41
42	63.00	63.15	63.30	63.45	63.60	63.75	63.90	64.05	64.20	64.35	42
43	64.50	64.65	64.80	64.95	65.10	65.25	65.40	65.55	65.70	65.85	43
44	66.00	66.15	66.30	66.45	66.60	66.75	66.90	67.05	67.20	67.35	44
45	67.50	67.65	67.80	67.95	68.10	68.25	68.40	68.55	68.70	68.85	45
46	69.00	69.15	69.30	69.45	69.60	69.75	69.90	70.05	70.20	70.35	46
47	70.50	70.65	70.80	70.95	71.10	71.25	71.40	71.55	71.70	71.85	47
48	72.00	72.15	72.30	72.45	72.60	72.75	72.90	73.05	73.20	73.35	48
49	73.50	73.65	73.80	73.95	74.10	74.25	74.40	74.55	74.70	74.85	49
50	75.00	75.15	75.30	75.45	75.60	75.75	75.90	76.05	76.20	76.35	50

THE NATIONAL BLANK BOOK COMPANY
HOLYOKE MASSACHUSETTS
NEW YORK CHICAGO BOSTON SAN FRANCISCO